

STATE OF CALIFORNIA - THE RESOURCES AGENCY
DEPARTMENT OF WATER RESOURCES

ARNOLD SCHWARZENEGGER, Governor

CENTRAL DISTRICT
901 F Street
Sacramento, CA 95814
(916) 651-0753
(916) 651-0726 (Fax)

NORTHERN DISTRICT
2440 Main Street
Red Bluff, CA 96080
(530) 529-7300
(530) 529-7322 (Fax)

SAN JOAQUIN DISTRICT
3374 E. Shields Ave Ste A7
Fresno, CA 93726
(559) 230-3300
(559) 230-3301 (Fax)

SOUTHERN DISTRICT
770 Fairmont Avenue
Glendale, CA 91203
(818) 500-1645 ext. 233
(818) 543 4604 (Fax)

WELL COMPLETION REPORT RELEASE REQUEST AND CONFIDENTIALITY AGREEMENT
REGULATORY-RELATED ENVIRONMENTAL CLEANUP STUDY

Well Completion Reports associated with wells located within two miles of an area affected or potentially affected by a known unauthorized release of a contaminant will be made available upon request to any person performing an environmental cleanup study associated with the unauthorized release, if the study is conducted pursuant to a regulatory agency order (Water Code Section 13752).

Requests must be made on the form below, signed and submitted to the appropriate DWR District Office. Please provide the township, range, and section of the property where the study is to be conducted. Attach a map or a sketch with a north arrow, and provide as much identifying information requested below as possible; additional paper may be attached if necessary.

By signing below, the requester acknowledges and agrees that, in compliance with Section 13752, the information obtained from these reports will be kept confidential and will not be disseminated, published, or made available for inspection by the public. Copies obtained must be stamped CONFIDENTIAL and kept in a restricted file accessible only to authorized personnel. These reports must not be used for any purpose other than for the purpose of conducting the environmental cleanup study.

Project Name: Vulcan Materials County: Alameda

Street Address: 501 Elcharro Rd. City: Pleasanton

Township, Range, and Section: _____ Radius: 2,000
(Include entire study area and a map that shows the area of interest.) (maximum 2 miles)

Requester's Company: ENV America Incorporated Inc. Regulatory Agency Name: Alameda County - Health Care Services

Requester's Name (please print): Bryan Behr Agency Contact Name (please print): Jerry Wickham

Address: 244 California Street, suite 500 Address: 1131 Harbor Bay Parkway, suite 250

City, State, and Zip Code: San Francisco, CA 94111 City, State, and Zip Code: Alameda, CA 94502

Signature: [Signature] Signature: [Signature]

Title: Geologist Title: Hazardous Materials Specialist

Telephone: (415) 989-9933 Telephone: (510) 567-6791

FAX: (415) 989-9934 FAX: (510) 337-9335

Date: 12-20-2006 Date: 12-20-06

E-mail: bbehre@envamerica.com E-mail: jerry.wickham@acgov.org

ALAMEDA COUNTY
HEALTH CARE SERVICES

AGENCY
DAVID J. KEARS, Agency Director



7

ENVIRONMENTAL HEALTH SERVICES
ENVIRONMENTAL PROTECTION
1131 Harbor Bay Parkway, Suite 250
Alameda, CA 94502-6577
(510) 567-6700
FAX (510) 337-9335

October 31, 2006

Mr. Ken Benson
Vulcan Materials
501 El Charro Road
Pleasanton, CA 94566

Subject: Fuel Leak Case No. [REDACTED] Vulcan Materials, 501 El Charro Road, Pleasanton, CA – Work Plan Approval

Dear Mr. Benson:

Alameda County Environmental Health (ACEH) staff has reviewed the case file for the above referenced site including the document entitled, "Preliminary Site Assessment Work Plan," dated October 17, 2006, prepared on your behalf by ENV America. The work plan proposes advancing four borings to first encountered groundwater or a depth of 50 feet below ground surface to assess the extent of fuel hydrocarbons at the site.

During removal of gasoline and diesel underground storage tanks, total petroleum hydrocarbons (TPH) as diesel were detected in soil samples beneath collected beneath the former tanks at concentrations up to 1,800 milligrams per kilogram (mg/kg). TPH as gasoline was detected in soil at concentrations up to 31 mg/kg. No water samples have been collected to assess whether fuel hydrocarbons have impacted groundwater in the area of the former tanks. As discussed in technical comment 2 below, collection of groundwater samples is a requirement for this site.

ACEH concurs with the proposed scope of work provided the technical comments below are addressed during the field investigation. We request that you address the following technical comments, perform the proposed work, and send us the reports described below. Please provide 72-hour advance written notification to this office (e-mail preferred to jerry.wickham@acgov.org) prior to the start of field activities.

TECHNICAL COMMENTS

1. **Soil Sampling.** ACEH concurs with the proposed soil boring locations and methods for soil sampling. Please present the results in the Soil and Groundwater Investigation Report requested below.
2. **Depth of Borings and Groundwater Sampling.** Collection of groundwater samples will be required to assess the extent of potential contamination at the site. The Work Plan indicates that soil borings will be advanced to first encountered groundwater, a maximum of 50 feet bgs, or refusal using a hollow stem auger drill rig. Review of the case file for a previous fuel leak case that was closed on July 22, 1998, indicates that groundwater was encountered between 63 and 79 feet bgs. Therefore, we request that the soil borings be extended to first-encountered groundwater, which may be greater than 50 feet but is expected to be less than 80 feet bgs. The proposed use of a temporary well point to collect the groundwater samples

is acceptable. Please present the groundwater sampling results in the Soil and Groundwater Investigation Report requested below.

3. **Detailed Well Survey.** We request that you locate all water supply wells (monitoring and production wells: active, inactive, standby, decommissioned, abandoned and dewatering, drainage and cathodic protection wells) within 2,000 ft of the subject site. We recommend that you obtain well information from both the Zone 7 Water Agency and the State of California Department of Water Resources, at a minimum. Submittal of maps showing the location of all wells identified in your study, and the use of tables to report the data, including well construction details, collected as part of your survey are required. Well construction details are to include the well diameter, screen slot size, total depth of the boring, depths of the screened interval, depths of the filter pack, year of installation, and other construction details that may be relevant. The status of the water supply well, whether active, decommissioned, or unknown is to be included where known. Please present your results in the Soil and Groundwater Investigation Report requested below.
4. **Facility Map.** In future reports for this site, please include a map that is intermediate in scale between Figure 1 and Figure 2 to allow the area of investigation to be located within the facility.
5. **Geotracker Submittals.** A review of the SWRCB Geotracker website indicates that no data or reports have been submitted to Geotracker for your site. Pursuant to CCR Sections 2729 and 2729.1, beginning September 1, 2001, all analytical data, including monitoring well samples, submitted in a report to a regulatory agency as part of the LUFT program, must be transmitted electronically to the SWRCB Geotracker website via the internet. Additionally, beginning January 1, 2002, all permanent monitoring points utilized to collect groundwater samples (i.e. monitoring wells) and submitted in a report to a regulatory agency, must be surveyed (top of casing) to mean sea level and latitude and longitude accurate to within 1-meter accuracy, using NAD 83, and transmitted electronically to the SWRCB Geotracker website. Beginning July 1, 2005, electronic submittal of a complete copy of all reports is required in Geotracker (in PDF format). In order to remain in regulatory compliance, please upload all analytical data (collected on or after September 1, 2001) and a copy, in PDF format, of all reports prepared after July 1, 2005.

TECHNICAL REPORT REQUEST

Please submit technical reports to Alameda County Environmental Health (Attention: Mr. Jerry Wickham), according to the following schedule:

- **March 9, 2007** – Soil and Groundwater Investigation Report

These reports are being requested pursuant to California Health and Safety Code Section 25296.10. 23 CCR Sections 2652 through 2654, and 2721 through 2728 outline the responsibilities of a responsible party in response to an unauthorized release from a petroleum UST system, and require your compliance with this request.

ELECTRONIC SUBMITTAL OF REPORTS

The Alameda County Environmental Cleanup Oversight Programs (LOP and SLIC) require submission of all reports in electronic form to the county's ftp site. Paper copies of reports will no longer be accepted. The electronic copy replaces the paper copy and will be used for all public information requests, regulatory review, and compliance/enforcement activities. Instructions for submission of electronic documents to the Alameda County Environmental Cleanup Oversight Program ftp site are provided on the attached "Electronic Report Upload (ftp) Instructions." Please do not submit reports as attachments to electronic mail.

Submission of reports to the Alameda County ftp site is an addition to existing requirements for electronic submittal of information to the State Water Resources Control Board (SWRCB) Geotracker website. Submission of reports to the Geotracker website does not fulfill the requirement to submit documents to the Alameda County ftp site. In September 2004, the SWRCB adopted regulations that require electronic submittal of information for groundwater cleanup programs. For several years, responsible parties for cleanup of leaks from underground storage tanks (USTs) have been required to submit groundwater analytical data, surveyed locations of monitor wells, and other data to the Geotracker database over the Internet. Beginning July 1, 2005, electronic submittal of a complete copy of all necessary reports was required in Geotracker (in PDF format). Please visit the SWRCB website for more information on these requirements (http://www.swrcb.ca.gov/ust/cleanup/electronic_reporting).

PERJURY STATEMENT

All work plans, technical reports, or technical documents submitted to ACEH must be accompanied by a cover letter from the responsible party that states, at a minimum, the following: "I declare, under penalty of perjury, that the information and/or recommendations contained in the attached document or report is true and correct to the best of my knowledge." This letter must be signed by an officer or legally authorized representative of your company. Please include a cover letter satisfying these requirements with all future reports and technical documents submitted for this fuel leak case.

PROFESSIONAL CERTIFICATION & CONCLUSIONS/RECOMMENDATIONS

The California Business and Professions Code (Sections 6735, 6835, and 7835.1) requires that work plans and technical or implementation reports containing geologic or engineering evaluations and/or judgments be performed under the direction of an appropriately registered or certified professional. For your submittal to be considered a valid technical report, you are to present site specific data, data interpretations, and recommendations prepared by an appropriately licensed professional and include the professional registration stamp, signature, and statement of professional certification. Please ensure all that all technical reports submitted for this fuel leak case meet this requirement.

UNDERGROUND STORAGE TANK CLEANUP FUND

Please note that delays in investigation, later reports, or enforcement actions may result in your becoming ineligible to receive grant money from the state's Underground Storage Tank Cleanup Fund (Senate Bill 2004) to reimburse you for the cost of cleanup.

Mr. Ken Benson
October 31, 2006
Page 4

AGENCY OVERSIGHT

If it appears as though significant delays are occurring or reports are not submitted as requested, we will consider referring your case to the Regional Board or other appropriate agency, including the County District Attorney, for possible enforcement actions. California Health and Safety Code, Section 25299.76 authorizes enforcement including administrative action or monetary penalties of up to \$10,000 per day for each day of violation.

If you have any questions, please call me at (510) 567-6791.

Sincerely,

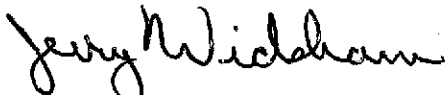

Jerry Wickham
Hazardous Materials Specialist

Enclosure: ACEH Electronic Report Upload (ftp) Instructions

cc: Colleen Winey, QIC 80201
Zone 7 Water Agency
100 North Canyons Parkway
Livermore, CA 94551

Bryan Behr
ENV America
244 California Street, Suite 500
San Francisco, CA 94111

Donna Drogos, ACEH
Jerry Wickham, ACEH
File

ALAMEDA COUNTY
HEALTH CARE SERVICES

AGENCY
DAVID J. KEARS, Agency Director



7

ENVIRONMENTAL HEALTH SERVICES
ENVIRONMENTAL PROTECTION
1131 Harbor Bay Parkway, Suite 250
Alameda, CA 94502-6577
(510) 567-6700
FAX (510) 337-9335

August 28, 2006

Mr. Ken Benson
Vulcan Materials
P.O. Box 636
Pleasanton, CA 94566

Subject: Fuel Leak Case No. [REDACTED], Vulcan Materials, 501 El Charro Road, Pleasanton, CA

Dear Mr. Benson:

In correspondence dated November 28, 2005 (attached), Alameda County Environmental Health (ACEH) conditionally approved a Work Plan entitled, "Draft Preliminary Site Assessment Work Plan," dated May 20, 2003, prepared on your behalf by Brown and Caldwell. The work plan proposed advancing four borings to first encountered groundwater or a depth of 50 feet below ground surface to assess the extent of fuel hydrocarbons at the site. The ACEH correspondence requested that you conduct the proposed soil and groundwater investigation provided that our technical comments were addressed during the field investigation and submit the results by April 19, 2006. To date, we have not received notification that the field investigation was conducted, the Soil and Groundwater Investigation Report, or a request for a time extension. We reiterate the request made in our November 28, 2006 correspondence to conduct the requested work.

Your soil and water investigation Work Plan is late, and your fuel leak site is not in compliance with ACEH directives. In order for your site to return to compliance, please submit the previously requested Soil and Groundwater Investigation Report by November 30, 2006. This date is not an extension of your due date, reports for this site are late and your site is out of compliance. ACEH makes this request pursuant to California Health & Safety Code Section 25296.10. 23 CCR sections 2652 through 2654, and 2721 through 2728 outline the duties of a responsible party in response to a reportable unauthorized release from a petroleum UST system, and require your compliance with this request.

If it appears as though significant delays are occurring, or reports are not submitted as requested, we will consider referring your case to the County District Attorney or other appropriate agency, for enforcement. California Health and Safety Code, Section 25299.76 authorizes ACEH enforcement including administrative action or monetary penalties of up to \$10,000 per day for each day of violation. Please note that further delays in investigation, late reports, or enforcement actions may result in your becoming ineligible to receive cost reimbursement from the State's Underground Storage Tank Cleanup Fund.

Ken Benson
August 28, 2006
Page 2

If you have any questions, please call me at (510) 567-6791.

Sincerely,



Jerry Wickham
Hazardous Materials Specialist

Attachment: ACEH Correspondence Dated November 28, 2005

Enclosure: ACEH Electronic Report Upload (ftp) Instructions

cc: Colleen Winey, QIC 80201, Zone 7 Water Agency, 100 North Canyons Parkway
Livermore, CA 94551

Tina Bauer, Brown and Caldwell, 2701 Prospect Park Drive, Rancho Cordova, CA 95670

Sunil Ramdass, SWRCB Cleanup Fund, 1001 I Street, 17th floor, Sacramento, CA 95814-
2828

Shari Knierem, SWRCB Cleanup Fund, 1001 I Street, 17th floor, Sacramento, CA 95814-
2828

Donna Drogos, ACEH
Jerry Wickham, ACEH
File

ALAMEDA COUNTY
HEALTH CARE SERVICES

AGENCY
DAVID J. KEARS, Agency Director



5/11/07

ENVIRONMENTAL HEALTH SERVICES
ENVIRONMENTAL PROTECTION
1131 Harbor Bay Parkway, Suite 250
Alameda, CA 94502-6577
(510) 567-6700
FAX (510) 337-9335

November 28, 2005

Mr. Ken Benson
Vulcan Materials
501 El Charro Road
Pleasanton, CA 94566

Subject: Fuel Leak Case N [REDACTED], Vulcan Materials, 501 El Charro Road, Pleasanton, CA – Work Plan Approval

Dear Mr. Benson:

I am the caseworker recently assigned to your case. Please send future correspondence or inquiries regarding this case to my attention. Alameda County Environmental Health (ACEH) staff has reviewed the case file for the above referenced site and the document entitled, "Draft Preliminary Site Assessment Work Plan," dated May 20, 2003, prepared on your behalf by Brown and Caldwell. The work plan proposes advancing four borings to first encountered groundwater or a depth of 50 feet below ground surface to assess the extent of fuel hydrocarbons at the site.

During removal of gasoline and diesel underground storage tanks, total petroleum hydrocarbons (TPH) as diesel were detected in soil samples beneath collected beneath the former tanks at concentrations up to 1,800 milligrams per kilogram (mg/kg). TPH as gasoline was detected in soil at concentrations up to 31 mg/kg. No water samples have been collected to assess whether fuel hydrocarbons have impacted groundwater in the area of the former tanks.

ACEH concurs with the proposed scope of work provided the technical comments included below are addressed. We request that you address the following technical comments, perform the proposed work, and send us the reports described below. Please provide 72-hour advance written notification to this office (e-mail preferred to jerry.wickham@accgov.org) prior to the start of field activities.

TECHNICAL COMMENTS

1. **Soil Borings.** ACEH concurs with the proposed soil boring locations. The soils are to be continuously sampled and logged and screened in the field using a photoionization detector (PID). ACEH requests that soil samples be submitted for analyses for all depth intervals where staining, odor, or elevated PID readings are observed. If staining, odor, or elevated PID readings are observed over an interval of several feet, a sufficient number of soil samples from this interval should be submitted for laboratory analyses to characterize the fuel hydrocarbon concentrations within this interval. In addition, one soil sample collected approximately two feet below the interval of observed staining, odor, or elevated PID readings should be submitted for laboratory analysis. If no staining, odor, or elevated PID readings are not observed, please submit one soil sample collected at approximately 15 feet below ground surface and one soil sample collected from the capillary fringe or the total

depth of the boring for laboratory analysis. Soil boring logs are to be presented in the Soil and Groundwater Investigation Report requested below.

2. **Laboratory Analyses.** The proposed laboratory analyses for soil and groundwater samples are acceptable. Please present the results in the Soil and Groundwater Investigation Report requested below.

TECHNICAL REPORT REQUEST

Please submit technical reports to Alameda County Environmental Health (Attention: Mr. Jerry Wickham), according to the following schedule:

- **April 19, 2006** – Soil and Groundwater Investigation Report

These reports are being requested pursuant to California Health and Safety Code Section 25296.10. 23 CCR Sections 2652 through 2654, and 2721 through 2728 outline the responsibilities of a responsible party in response to an unauthorized release from a petroleum UST system, and require your compliance with this request.

ELECTRONIC SUBMITTAL OF REPORTS

ACEH's Environmental Cleanup Oversight Programs (LOP and SLIC) now request submission of reports in electronic form. The electronic copy is intended to replace the need for a paper copy and is expected to be used for all public information requests, regulatory review, and compliance/enforcement activities. Instructions for submission of electronic documents to the Alameda County Environmental Cleanup Oversight Program FTP site are provided on the attached "Electronic Report Upload Instructions." Submission of reports to the Alameda County FTP site is an addition to existing requirements for electronic submittal of information to the State Water Resources Control Board (SWRCB) Geotracker website. In September 2004, the SWRCB adopted regulations that require electronic submittal of information for groundwater cleanup programs. For several years, responsible parties for cleanup of leaks from underground storage tanks (USTs) have been required to submit groundwater analytical data, surveyed locations of monitoring wells, and other data to the Geotracker database over the Internet. Beginning July 1, 2005, electronic submittal of a complete copy of all reports is required in Geotracker (in PDF format). Please visit the State Water Resources Control Board for more information on these requirements (http://www.swrcb.ca.gov/ust/cleanup/electronic_reporting).

PERJURY STATEMENT

All work plans, technical reports, or technical documents submitted to ACEH must be accompanied by a cover letter from the responsible party that states, at a minimum, the following: "I declare, under penalty of perjury, that the information and/or recommendations contained in the attached document or report is true and correct to the best of my knowledge." This letter must be signed by an officer or legally authorized representative of your company. Please include a cover letter satisfying these requirements with all future reports and technical documents submitted for this fuel leak case.

PROFESSIONAL CERTIFICATION & CONCLUSIONS/RECOMMENDATIONS

The California Business and Professions Code (Sections 6735, 6835, and 7835.1) requires that work plans and technical or implementation reports containing geologic or engineering evaluations and/or judgments be performed under the direction of an appropriately registered or certified professional. For your submittal to be considered a valid technical report, you are to present site specific data, data interpretations, and recommendations prepared by an appropriately licensed professional and include the professional registration stamp, signature, and statement of professional certification. Please ensure all that all technical reports submitted for this fuel leak case meet this requirement.

UNDERGROUND STORAGE TANK CLEANUP FUND

Please note that delays in investigation, later reports, or enforcement actions may result in your becoming ineligible to receive grant money from the state's Underground Storage Tank Cleanup Fund (Senate Bill 2004) to reimburse you for the cost of cleanup.

AGENCY OVERSIGHT

If it appears as though significant delays are occurring or reports are not submitted as requested, we will consider referring your case to the Regional Board or other appropriate agency, including the County District Attorney, for possible enforcement actions. California Health and Safety Code, Section 25299.76 authorizes enforcement including administrative action or monetary penalties of up to \$10,000 per day for each day of violation.

If you have any questions, please call me at (510) 567-6791.

Sincerely,



Jerry Wickham
Hazardous Materials Specialist

Enclosure: ACEH Electronic Report Upload (ftp) Instructions

cc: Colleen Winey, QIC 80201, Zone 7 Water Agency, 100 North Canyons Parkway
Livermore, CA 94551

Tina Bauer, Brown and Caldwell, 2701 Prospect Park Drive, Rancho Cordova, CA 95670

Donna Drogos, ACEH
Jerry Wickham, ACEH
File

ALAMEDA COUNTY
HEALTH CARE SERVICES

AGENCY

DAVID J. KEARS, Agency Director



ENVIRONMENTAL HEALTH SERVICES

ENVIRONMENTAL PROTECTION
1131 Harbor Bay Parkway, Suite 250
Alameda, CA 94502-6577
(510) 567-6700
FAX (510) 337-9335

March 25, 2003

RO 2527

Mr. Ken Benson
Vulcan Materials
P.O. Box 636
Pleasanton, CA 94566

RE: Vulcan Materials, 501 El Charro Road, Pleasanton (unincorporated) – Request for Preliminary Site Assessment Work Plan

Dear Mr. Benson:

Two underground storage tanks (UST) were removed from this site on November 5, 2002. One UST was of 12,000-gallon capacity and used to store diesel fuel. The second UST was of 6000-gallon capacity and used to store gasoline. Tank inverts were at reported depths of between 11.5 and 12.5 feet below ground. Samples were collected of native materials at the base of the shared UST excavation and beneath each of the dispensers.

Soil sample results indicated an unauthorized release occurred at this site. Up to 1800 parts per million (ppm) Total Petroleum Hydrocarbons as Diesel (TPH-d) and detectable concentrations of Toluene, Ethylbenzene, and total Xylenes, as well as the fuel oxygenate tert-Butanol (TBA), were identified in collected samples. Consequently, an Unauthorized Release Report (ULR) was completed by your tank removal contractor on November 25, 2002.

This letter constitutes a request for submittal of a Preliminary Site Assessment (PSA) workplan and Site Conceptual Model (SCM).

TECHNICAL COMMENTS

1) **Preliminary Site Assessment Workplan** - Consistent with provisions of Article 11, *Corrective Action Requirements*, Section 2720 et seq., Title 23, California Code of Regulations (CCR), a PSA must be conducted to initially assess the extent of the release at the site. The PSA typically involves the installation of several soil borings and construction of an array of monitoring wells strategically located to track contaminant location. However, in this case it will be acceptable to begin this preliminary phase of the project with a series of push-tool (i.e., GeoProbe) sampling points. Such expedited site assessment tools and methods are a scientifically valid and cost-effective approach to fully define the three-dimensional extent of fuel releases. Technical protocol for expedited site assessments are provide in the US EPA "*Expedited Site Assessment Tools for Underground Storage Tank Sites: A guide for Regulators*" (EPA 510-B-97-001), dated March 1997.

Mr. Ken Benson
Re: 501 El Charro Rd., Pleasanton
March 25, 2003
Page 2 of 3

2) **Site Conceptual Model** – You are to develop an initial three-dimensional SCM of site conditions. A SCM is a set of working hypotheses pertaining to all aspects of the contaminant release, including site geology, hydrogeology, release history, residual and dissolved contamination, attenuation mechanisms, pathways to nearby receptors, and likely impacts to receptors. The SCM is used to identify data gaps that are subsequently filled as the investigation proceeds. As the data gaps are filled, the working hypotheses are modified, and the overall SCM is refined and strengthened. Subsurface investigations continue until the SCM no longer changes as new data are collected. At this point the SCM is considered “validated”. The validated SCM forms the foundation for developing the most cost-effective final Corrective Action Plan (CAP).

Your attention is directed to “*Strategies for Characterizing Subsurface Releases of Gasoline Containing MtBE,*” American Petroleum Institute Publication No. 4699, dated February 2000 as a resource for development of the SCM. Your attention is also directed to the State Water Resources Control Board (SWRCB) “*Guidelines for Investigation and Cleanup of MTBE and Other Ether-Based Oxygenates, Final Draft*”, dated March 27, 2000, as well as the June 2002 ChevronTexaco Energy Research and Technology Company technical bulletin entitled “*Mass Flux Estimates to Assist Decision-Making*” to help in development of the SCM, among other related tasks. I can provide copies of any of these documents if you need them.

You are requested to use this initial SCM to help you determine the appropriate configuration for samplings points in the pending PSA phase of work at this site. Please present and discuss the SCM in the PSA workplan, and explain your rationale for the configuration of proposed sampling points.

TECHINCAL REPORT REQUEST

Please submit technical reports according to, or otherwise comply with, the following schedule:

May 23, 2003 – Work plan for Preliminary Site Assessment

60 Days from PSA Work Plan Approval – Preliminary Site Assessment Report

July 15, 2003 – Quarterly Report for the Second Quarter 2003

October 15, 2003 – Quarterly Report for the Third Quarter 2003

January 15, 2004 – Quarterly Report for the Fourth Quarter 2003

April 15, 2004 – Quarterly Report for the First Quarter 2004

These reports and work plans are being requested pursuant to the Regional Board’s authority under Section 13267(b) of the California Water Code. **Each technical report shall include**

Mr. Ken Benson
Re: 501 El Charro Rd., Pleasanton
March 25, 2003
Page 3 of 3

conclusions and recommendations for the next phases of work required at the site should more appear necessary to refine the SCM. We request that all required work be performed in a prompt and timely manner, as suggested by the noted schedule, above. Revisions to this schedule shall be requested in writing with appropriate justification for anticipated delays.

The California Business and Professions Code (Sections 6735, 6835, and 7835.1) requires that all work plans and technical reports containing professional geologic or engineering evaluations and/or judgments be completed under the direction of an appropriately-registered or certified professional. This registered or certified professional shall sign and wet stamp all such reports and work plans.

All reports and work plans are to be submitted under cover, signed under penalty of perjury, by the Responsible Party(ies) who have taken a lead role in compliance with corrective action directives.

AGENCY OVERSIGHT

If it appears as though significant delays are occurring or reports are not submitted as requested, we will consider referring your case to the Regional Board or other appropriate agency, including the Alameda County District Attorney, for possible enforcement follow up. Enforcement follow up may include administrative action or monetary penalties of up to \$10,000 per day for each day of violation of the California Health and Safety Code, Division 20, Chapter 6.76.

If you have any questions, I can be reached at (510) 567-6783.

Sincerely,

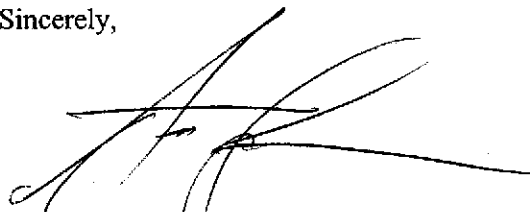

Scott O. Seery, CHMM
Hazardous Materials Specialist

c: Betty Graham, RWQCB
Dave Charter, SWRCB UST Fund
Matt Katen, Zone 7 Water Agency
Donna Drogos, ACDEH LOP
Robert Weston, ACDEH

Transfer of Eligible Local Oversight Case

STID _____ Date of input/By: _____

Date: 1-28-03 From: RUBINSite Name: VULCAN MATERIALSAddress: 501 ELCHAMMA RD City: PLEASANTON Zip: 94588

To be eligible for LOP, case must meet 3 qualifications:

1. Y N Tanks Removed? # of removed? 2 Date removed: 11-5-02
2. Y N Samples received? Contamination level: 1800 ppm HIGHEST
Type of test _____
Contamination should be over 100 ppm TPH to qualify for LOP
3. Y N Petroleum? Circle Type(s): • Avgas • leaded • unleaded • fuel oil • jet
• diesel • waste oil • kerosene • solvents

Procedure to follow should your site meet all the above qualifications:

1.
 - a. _____ Close the deposit refund case.
 - b. _____ Account for **ALL** time you have spent on the case.
 - c. _____ Turn in account sheet to Leslie.

If there are funds still remaining it is still better to transfer the case to LOP as the rate for LOP allows more overhead. **DO NOT** attempt to continue to oversee the site simply because there are funds remaining!

Remaining DepRef \$'s: _____

DepRef Case Closed with Candyce/Leslie? Y N (If no, explain why below.)

2. Submit the completed **A** and **B** permit application forms to **NORMA**.
3. Give the entire case to the proper LOP staff.

DCM, INC. FAX SHEET

FAX TO: Robert Weston DATE: 11/25/02

FAX FROM: JAY CARPENTER TIME: 8:00 AM

COMPANY: Alameda Co. FAX NO.: (510) 337-9335

NUMBER OF PAGES 2

NOTES: Rob, Attached is the Unauthorized Release form for Vulcan.

Thanks, Jay

If there are any questions or missing pages please call (925) 353-0923
Home Office/Fax (510) 278-9137 Office/Fax (925) 803-6969
Mobile Phone (925) 323-0923 e-mail Address - jay@dcnconst.com

UNDERGROUND STORAGE TANK UNAUTHORIZED RELEASE (LEAK) / CONTAMINATION SITE REPORT

EMERGENCY HAS STATE OFFICE OF EMERGENCY SERVICES REPORT BEEN FILED?
 YES NO YES NO

FOR LOCAL AGENCY USE ONLY
 I HEREBY CERTIFY THAT I HAVE DISTRIBUTED THIS INFORMATION ACCORDING TO THE DISTRIBUTION SHOWN ON THE INSTRUCTION SHEET ON THE BACK PAGE OF THIS FORM.
 SIGNED: _____ DATE: _____

REPORT DATE: 11/25/02 CASE # _____

REPORTED BY: NAME OF INDIVIDUAL FILING REPORT: JAY CARPENTER PHONE: (925) 803-6969 SIGNATURE: [Signature]
 REPRESENTING: OWNER/OPERATOR REGIONAL BOARD LOCAL AGENCY OTHER: REMOVAL CONTRACTOR COMPANY OR AGENCY NAME: DCM, INC
 ADDRESS: 7172 REGIONAL ST #139 DUBLIN STATE: CA ZIP: 94588

RESPONSIBLE PARTY: NAME: VULCAN MATERIAL UNKNOWN CONTACT PERSON: KAREN BENSON PHONE: (925) 846-1777
 ADDRESS: 501 EL CHARRO RD PLEASANTON CITY: CA ZIP: 94566

SITE LOCATION: FACILITY NAME (IF APPLICABLE): VULCAN MATERIALS OPERATOR: [Blank] PHONE: (925) 846-1777
 ADDRESS: 501 EL CHARRO RD PLEASANTON CITY: ALAMEDA COUNTY: CA ZIP: 94566
 CROSS STREET: _____

IMPLEMENTING AGENCIES: LOCAL AGENCY: _____ AGENCY NAME: _____ CONTACT PERSON: ROBERT WESTON PHONE: ()
 REGIONAL BOARD: _____ PHONE: ()

SUBSTANCES INVOLVED: (1) UNLEADED GASOLINE NAME: _____ QUANTITY LOST (GALLONS): UNKNOWN UNKNOWN
 (2) _____

DISCOVERY/ABATEMENT: DATE DISCOVERED: 11/05/02 HOW DISCOVERED: TANK TEST TANK REMOVAL INVENTORY CONTROL SUBSURFACE MONITORING NUISANCE CONDITIONS
 DATE DISCHARGE BEGAN: _____ METHOD USED TO STOP DISCHARGE (CHECK ALL THAT APPLY): REMOVE CONTENTS CLOSE TANK & REMOVE REPAIR PIPING
 REPAIR TANK CLOSE TANK & FILL IN PLACE CHANGE PROCEDURE
 REPLACE TANK OTHER: _____
 HAS DISCHARGE BEEN STOPPED? YES NO IF YES, DATE: _____

SOURCE/CAUSE: SOURCE OF DISCHARGE: TANK LEAK UNKNOWN PIPING LEAK OTHER: _____ CAUSE(S): OVERFILL RUPTURE/FAILURE SPILL CORROSION UNKNOWN OTHER: _____

CASE TYPE: CHECK ONE ONLY: UNDETERMINED SOIL ONLY GROUNDWATER DRINKING WATER - (CHECK ONLY IF WATER WELLS HAVE ACTUALLY BEEN AFFECTED)

CURRENT STATUS: CHECK ONE ONLY: NO ACTION TAKEN LEAK BEING CONFIRMED REMEDIATION PLAN PRELIMINARY SITE ASSESSMENT WORKPLAN SUBMITTED PRELIMINARY SITE ASSESSMENT UNDERWAY CASE CLOSED (CLEANUP COMPLETED OR UNNECESSARY) POLLUTION CHARACTERIZATION POST CLEANUP MONITORING IN PROGRESS CLEANUP UNDERWAY

REMEDIAL ACTION: CHECK APPROPRIATE ACTION(S) (SEE BACK FOR DETAILS): CAP SITE (CS) CONTAINMENT BARRIER (CB) VACUUM EXTRACT (VE) EXCAVATE & DISPOSE (ED) EXCAVATE & TREAT (ET) NO ACTION REQUIRED (NA) OTHER (OT) REMOVE FREE PRODUCT (FP) PUMP & TREAT GROUNDWATER (GT) TREATMENT AT HOOKUP (HU) ENHANCED BIO DEGRADATION (BT) REPLACE SUPPLY (RS) VENT SOIL (VS)

COMMENTS: _____

NEW CASE LOP

PREVIOUSLY CLOS
1998
Form RO-913 SHD 2004
closed 7/22/98

UNDERGROUND STORAGE TANK UNAUTHORIZED RELEASE (LEAK) / CONT			
EMERGENCY <input type="checkbox"/> YES <input checked="" type="checkbox"/> NO		HAS STATE OFFICE OF EMERGENCY SERVICES REPORT BEEN FILED? <input type="checkbox"/> YES <input checked="" type="checkbox"/> NO	
REPORT DATE 1/1/2002		CASE #	
NAME OF INDIVIDUAL FILING REPORT JAY CARPENTER		PHONE (925) 803-6969	SIGNATURE
REPRESENTING <input type="checkbox"/> LOCAL AGENCY <input checked="" type="checkbox"/> OTHER REMOVAL CONTRACTOR		COMPANY OR AGENCY NAME DCM, INC	
ADDRESS 7172 REGIONAL ST #139		CITY DUBLIN	STATE CA
NAME VULCAN MATERIAL		CONTACT PERSON KEVIN BENSON	PHONE (925) 846-1777
ADDRESS 501 EL CHARRO RD		CITY PLEASANTON	STATE CA
FACILITY NAME (IF APPLICABLE) VULCAN MATERIALS		OPERATOR	PHONE (925) 846-1777
ADDRESS 501 EL CHARRO RD		CITY PLEASANTON	COUNTY ALAMEDA
CROSS STREET Alameda County			
LOCAL AGENCY DEC 04 2002		CONTACT PERSON ROBERT WESTON	PHONE ()
REGIONAL BOARD Environmental Health		PHONE ()	
(1) UNLEADED GASOLINE		QUANTITY LOST (GALLONS) <input checked="" type="checkbox"/> UNKNOWN	
(2)		<input type="checkbox"/> UNKNOWN	
DATE DISCOVERED 1/1/02		HOW DISCOVERED <input type="checkbox"/> INVENTORY CONTROL <input type="checkbox"/> SUBSURFACE MONITORING <input type="checkbox"/> NUISANCE CONDITIONS <input type="checkbox"/> TANK TEST <input checked="" type="checkbox"/> TANK REMOVAL <input type="checkbox"/> OTHER	
DATE DISCHARGE BEGAN UNKNOWN		METHOD USED TO STOP DISCHARGE (CHECK ALL THAT APPLY) <input type="checkbox"/> REMOVE CONTENTS <input checked="" type="checkbox"/> CLOSE TANK & REMOVE <input type="checkbox"/> REPAIR PIPING <input type="checkbox"/> REPAIR TANK <input type="checkbox"/> CLOSE TANK & FILL IN PLACE <input type="checkbox"/> CHANGE PROCEDURE <input type="checkbox"/> REPLACE TANK <input type="checkbox"/> OTHER	
HAS DISCHARGE BEEN STOPPED? <input type="checkbox"/> YES <input type="checkbox"/> NO IF YES, DATE		SOURCE OF DISCHARGE <input type="checkbox"/> TANK LEAK <input checked="" type="checkbox"/> UNKNOWN <input type="checkbox"/> PIPING LEAK <input type="checkbox"/> OTHER	
SOURCE OF DISCHARGE		CAUSE(S) <input type="checkbox"/> OVERFILL <input type="checkbox"/> RUPTURE/FAILURE <input type="checkbox"/> SPILL <input type="checkbox"/> CORROSION <input checked="" type="checkbox"/> UNKNOWN <input type="checkbox"/> OTHER	
CHECK ONE ONLY <input checked="" type="checkbox"/> UNDETERMINED <input type="checkbox"/> SOIL ONLY <input type="checkbox"/> GROUNDWATER <input type="checkbox"/> DRINKING WATER - (CHECK ONLY IF WATER WELLS HAVE ACTUALLY BEEN AFFECTED)			
CURRENT STATUS CHECK ONE ONLY <input checked="" type="checkbox"/> NO ACTION TAKEN <input type="checkbox"/> PRELIMINARY SITE ASSESSMENT WORKPLAN SUBMITTED <input type="checkbox"/> POLLUTION CHARACTERIZATION <input type="checkbox"/> LEAK BEING CONFIRMED <input type="checkbox"/> PRELIMINARY SITE ASSESSMENT UNDERWAY <input type="checkbox"/> POST CLEANUP MONITORING IN PROGRESS <input type="checkbox"/> REMEDIATION PLAN <input type="checkbox"/> CASE CLOSED (CLEANUP COMPLETED OR UNNECESSARY) <input type="checkbox"/> CLEANUP UNDERWAY			
REMEDIAL ACTION CHECK APPROPRIATE ACTION(S) <input type="checkbox"/> CAP SITE (CS) <input type="checkbox"/> EXCAVATE & DISPOSE (ED) <input type="checkbox"/> REMOVE FREE PRODUCT (FP) <input type="checkbox"/> ENHANCED BIO DEGRADATION (BT) <input type="checkbox"/> CONTAINMENT BARRIER (CB) <input type="checkbox"/> EXCAVATE & TREAT (ET) <input type="checkbox"/> PUMP & TREAT GROUNDWATER (PT) <input type="checkbox"/> REPLACE SUPPLY (RS) <input type="checkbox"/> VACUUM EXTRACT (VE) <input checked="" type="checkbox"/> NO ACTION REQUIRED (NA) <input type="checkbox"/> TREATMENT AT HOOKUP (HU) <input type="checkbox"/> VENT SOIL (VS) <input type="checkbox"/> OTHER (OT)			
COMMENTS			

UNDERGROUND STORAGE TANK CLOSURE/REMOVAL FIELD INSPECTION REPORT

Facility Name: VULCAN MATERIALS	STID:	Date: 11-5-02
Facility Address: 51 EL CHANCO RD, PLEASANTON	Contact on site:	
Inspector: R. WESTON	Contractor/Consultant:	

General Requirements	Yes	No	N/A
Approved closure plan on site.		✓	
Changes to approved plan noted.			✓
Residuals properly stored/transported.			
Receipt for adequate dry ice noted.			

General Requirements	Yes	No	N/A
Site Safety Plan properly signed.			
40B:C fire extinguisher on site.	✓		
"No Smoking" signs posted.			
Gas detector challenged by inspector.			

Tank Observations	T #1	T #2	T #3	T #4
Tank Capacity (gallons)	12K	6K		
Material last stored	DIESEL	GAS		
Dry ice used (pounds)				
Combustible gas concentration as %LEL. (Note time & sampling point)				
(1) 3:45	6	9		
(2) 4:58				
(3)				
Oxygen concentration as % volume. (Note time & sampling point)				
(1) 3:45	7.1	0		
(2) 4:58				
(3)				
Tank Material	ST	ST		
Wrapping/Coating, if any	N	N		
Obvious holes?				

Tank Observations	T #1	T #2	T #3	T #4
Obvious corrosion?				
Obvious odors from tank?				
Seams intact?				
Tank bed backfill material				
Obvious discoloration?				
Obvious odors ex tank bed?				
Water in excavation?				
Sheen/product on water?				
Tank tagged by transporter?				
Tank wrapped for transport?				
Tank plugged w/ vent cap?				
Date/time tank hauled off?				
No. of soil samples taken?				
Depth of soil samples (ft. bgs)				

Piping Removal	Yes	No	N/A
All piping removed hauled off w/ tanks?		✓	
Obvious holes on pipes?			✓
Obvious odors from pipes?			✓
Obvious soil discoloration in piping trench?			✓
Obvious odors from piping trench?			✓
Water in piping trench?		✓	
Number & depth of soil samples from piping trench?			
Number & depth of water samples from piping trench?			

General Observations	Yes	No	N/A
Leak from any tank suspected?		✓	
"Leak Report" form given to the operator?			
Obviously contaminated soil excavated?			
Soil stockpile sampled?	✓		
Stockpile lined AND covered?			
Water in excavation sampled?			
Number/depth of water samples taken?			
All samples properly preserved for transport?			

Additional Observations	Yes	No	N/A
Soil/water sampling protocols acceptable?	✓		
Sampling "chain of custody" noted?	✓		
Tank pit filled in or covered?	✓		
Tank pit fenced or barricaded?		✓	
Transporter a registered HW hauler?	✓		
Uniform HW Manifest completed?	✓		
Contractor/Consultant reminded of complete UST Removal Report due within 30 days?	✓		
Date/Time removal/closure operations completed?	11-5-02 4:30		
OT hours or additional charges due from contractor?			

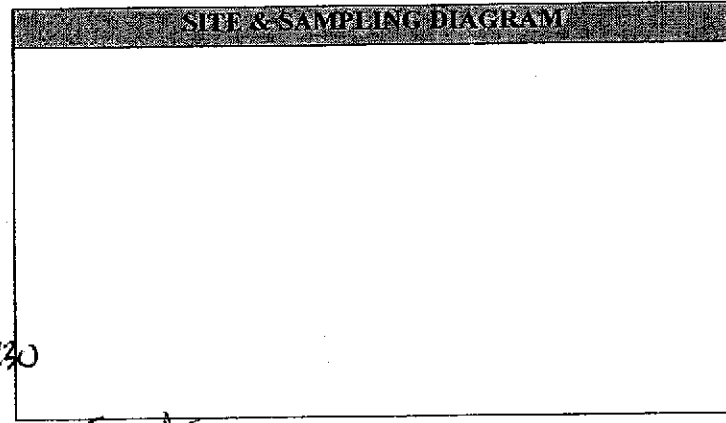

Notes/Comments: POOR MANAGEMENT OF DEBRIS ASSOCIATED W/ TANK REMOVAL. PIECES OF FRP SCATTERED ONSITE.

9848-860
E985-029





ALAMEDA COUNTY HEALTH CARE SERVICES AGENCY
 ENVIRONMENTAL HEALTH SERVICES
 1131 HARBOR BAY PARKWAY, RM 250
 ALAMEDA, CA 94502-6577
 PHONE # 510/567-6700

ACCEPTED

Underground Storage Tank Closure Permit Application
 Alameda County Division of Hazardous Materials
 1131 Harbor Bay Parkway, Suite 250
 Alameda, CA 94502-6577

These closure/removal plans have been received and found to be acceptable and essentially meet the requirements of State and Local Health Laws. Changes to your closure plans indicated by this Department are to assure compliance with State and local laws. The project proposed herein is now released for issuance of any required building permits for construction/destruction.

One copy of the accepted plans must be on the job and available to all contractors and craftsmen involved with the removal.

Any changes or alterations of these plans and specifications must be submitted to the Fire Department and to the Fire and Building Inspections Department to determine if such changes meet the requirements of State and local laws. Notify this Department at least 72 hours prior to the following required inspections:

- Removal of Tank(s) and Piping
- Sampling
- Final Inspection

Issuance of a) permit to operate, b) permanent site closure, is dependent on compliance with accepted plans and all applicable laws and regulations.

THERE IS A FINANCIAL PENALTY FOR NOT OBTAINING THESE INSPECTIONS.

Contract Specialist

Rob Westin
 10-24-02
 SEE TABLE 2
 ATTACHED
 TABLE 2

UNDERGROUND TANK CLOSURE PLAN

* * * Complete plan according to attached instructions * * *

1. Name of Business VULCAN MATERIALS
 Business Owner or Contact Person (PRINT) WARD FIELDING
 2. Site Address 501 EL CHARRO ROAD
 City PLEASANTON Zip 94588 Phone (925)846-2852
 3. Mailing Address P.O. BOX 636
 City PLEASANTON Zip 94566 Phone _____
 4. Property Owner VULCAN MATERIALS
 Business Name (if applicable) _____
 Address P.O. BOX 636
 City, State PLEASANTON, CA Zip 94566
 5. Generator name under which tank will be manifested
VULCAN MATERIALS
- EPA ID# under which tank will be manifested CA L000097968



6. Contractor DCM CONSTRUCTION & SERVICES, INC.
Address 7172 REGIONAL ST. #139
City Dublin, CA, 94568 Phone 925-803-6969
License Type A, HAZ ID# 781351

7. Consultant (if applicable) _____
Address _____
City, State _____ Phone _____

8. Main Contact Person for Investigation (if applicable)
Name JEFF DEAKIN Title PRESIDENT
Company DCM CONSTRUCTION & SERVICES, INC.
Phone 925-803-6969

9. Number of underground tanks being closed with this plan 2
Length of piping being removed under this plan 50 Feet
Total number of underground tanks at this facility (**confirmed with owner or operator) 2

10. State Registered Hazardous Waste Transporters/Facilities (see instructions).

** Underground storage tanks must be handled as hazardous waste **

a) Product/Residual Sludge/Rinsate Transporter
Name CLEARWATER ENVIRONMENTAL EPA I.D. No. CAR000007013
Hauler License No. 3515 License Exp. Date 11/30/02
Address 33204 WESTERN AVE.
City UNION CITY State CA Zip 94587

b) Product/Residual Sludge/Rinsate Disposal Site
Name CLEARWATER ENVIRONMENTAL EPA ID# CAR000007013
Address 2805 COLEMAN AL.
City FREMONT State CA zip 94537-7420

c) Tank and Piping Transporter

Name ECL EPA I.D. No. CAD00946639Z

Hauler License No. 0019 License Exp. Date _____

Address 255 PARR BLVD.

City RICHMOND State CA Zip 94801-1119

d) Tank and Piping Disposal Site

Name ECL EPA I.D. No. _____

Address _____

City _____ State _____ Zip _____

11. Sample Collector

Name TBA

Company ACC ENVIRONMENTAL CONSULTANTS

Address 7977 CARWELL DRIVE #100

City OAKLAND State CA Zip 94621 Phone 6388400

12. Laboratory

Name STL SAN FRANCISCO

Address 1220 QUARRY LANE

City PLEASANTON State CA Zip 94566

State Certification No. 1094

13. Have tanks or pipes leaked in the past? Yes [] No [] Unknown

If yes, describe. _____

14. Describe methods to be used for rendering tank(s) inert:

ALL PRODUCT TO BE REMOVED, TANKS TRIPLE RINSED OR AS NECESSARY, 20 lbs OF DRY ICE PER 1000 GAL OF TANK will then be ADDED

Before tanks are pumped out and inerted, all associated piping must be flushed back into the tank(s). All accessible piping must then be removed. Inaccessible piping must be permanently plugged using grout.

The Bay Area Air Quality Management District, 415/771-6000, along with local Fire and Building Departments, must also be contacted for tank removal permits. Fire departments typically require the use of a combustible gas indicator to verify tank inertness. It is the contractor's responsibility to have a functional combustible gas indicator on-site to verify that the tank(s) is inerted.

15. Tank History and Sampling Information *** (see instructions) ***

Tank		Material to be sampled (tank contents, soil, groundwater)	Location and Depth of Samples
Capacity	Use History include date last used (estimated)		
5000 GAL.	gasoline	SOIL	EACH END AT APPROX - 12'
12,000 GAL	DIESEL	SOIL	EACH END AT APPROX - 12'

One soil sample must be collected for every 20 linear feet of piping that is removed. A ground water sample must be collected if any ground water is present in the excavation.

Excavated/Stockpiled Soil

Stockpiled Soil Volume
(estimated)

150 cu. yds

Sampling Plan

1 composite sample
per 200 cu. yds.

Stockpiled soil must be placed on bermed plastic and must be completely covered by plastic sheeting.

Will the excavated soil be returned to the excavation immediately after tank removal? yes no unknown

If yes, explain reasoning _____

If unknown at this point in time, please be aware that excavated soil may not be returned to the excavation without prior approval from this office. This means that the contractor, consultant, or responsible party must communicate with the Specialist IN ADVANCE of backfilling activities.

16. Chemical methods and associated detection limits to be used for analyzing samples:

The Tri-Regional Board recommended minimum verification analyses and practical quantitation reporting limits should be followed. See attached Table 2.

17. Submit Site Health and Safety Plan (See Instructions)

Contaminant Sought	EPA or Other Sample Preparation Method Number	EPA or Other Analysis Method Number	Method Detection Limit
GASOLINE	TPH-G BTEX EDB & EDC MTBE TOTAL LEAD	8015 8260 ↓ AA	1.0 PPM 0.005 PPM 1.0 mg/kg
DIBSEL	TPH-D BTEX EDB & EDC MTBE	8015 8260 ↓	1.0 PPM 0.005 PPM

18. Submit Worker's Compensation Certificate copy

Name of Insurer STATE FUNDS - 713691102

19. Submit Plot Plan ***** (See Instructions) *****

20. Enclose Deposit (See Instructions)

21. Report all leaks or contamination to this office within 5 days of discovery.

The written report shall be made on an Underground Storage Tank Unauthorized Leak/Contamination Site Report (ULR) form.

22. Submit a closure report to this office within 60 days of the tank removal. The report must contain all information listed in item 22 of the instructions.

23. Submit State (Underground Storage Tank Permit Application) Forms A and B (one-B form for each UST to be removed) (mark box 8 for "tank removed" in the upper right hand corner)

ACORD CERTIFICATE OF LIABILITY INSURANCE

DATE (MM/DD/YYYY)
10/10/2002

PRODUCER (916)443-0200 FAX (916)443-0251
Owen Dunn Insurance Services
 License Number: 0670167
 2831 G Street Suite 200
 Sacramento, CA 95816-3721

INSURED **DCM Construction & Services, Inc.**
 7172 Regional Street #139
 Dublin, CA 94568

THIS CERTIFICATE IS ISSUED AS A MATTER OF INFORMATION ONLY AND CONFERS NO RIGHTS UPON THE CERTIFICATE HOLDER. THIS CERTIFICATE DOES NOT AMEND, EXTEND OR ALTER THE COVERAGE AFFORDED BY THE POLICIES BELOW.

INSURERS AFFORDING COVERAGE

INSURER A: **Everest Indemnity Ins Co c/o Graystone**
 INSURER B: **State Compensation Ins. Fund**
 INSURER C: **Greenwich Insurance c/o Deans & Homer**
 INSURER D:
 INSURER E:

COVERAGES

THE POLICIES OF INSURANCE LISTED BELOW HAVE BEEN ISSUED TO THE INSURED NAMED ABOVE FOR THE POLICY PERIOD INDICATED. NOTWITHSTANDING ANY REQUIREMENT, TERM OR CONDITION OF ANY CONTRACT OR OTHER DOCUMENT WITH RESPECT TO WHICH THIS CERTIFICATE MAY BE ISSUED OR MAY PERTAIN, THE INSURANCE AFFORDED BY THE POLICIES DESCRIBED HEREIN IS SUBJECT TO ALL THE TERMS, EXCLUSIONS AND CONDITIONS OF SUCH POLICIES. AGGREGATE LIMITS SHOWN MAY HAVE BEEN REDUCED BY PAID CLAIMS.

INSR LTR	TYPE OF INSURANCE	POLICY NUMBER	POLICY EFFECTIVE DATE (MM/DD/YYYY)	POLICY EXPIRATION DATE (MM/DD/YYYY)	LIMITS
A	GENERAL LIABILITY	4000000832001	02/01/2002	02/01/2003	EACH OCCURRENCE \$ 5,000,000
	<input checked="" type="checkbox"/> COMMERCIAL GENERAL LIABILITY				FIRE DAMAGE (Any one fire) \$ 50,000
	<input type="checkbox"/> CLAIMS MADE <input checked="" type="checkbox"/> OCCUR				MED EXP (Any one person) \$ 5,000
	<input checked="" type="checkbox"/> Pollution				PERSONAL & ADV INJURY \$ 5,000,000
					GENERAL AGGREGATE \$ 5,000,000
					PRODUCTS - COMP/OP AGG \$ 5,000,000
					GEN'L AGGREGATE LIMIT APPLIES PER: <input type="checkbox"/> POLICY <input type="checkbox"/> PRO-JECT <input type="checkbox"/> LOC
	AUTOMOBILE LIABILITY				COMBINED SINGLE LIMIT (Ea accident) \$
	<input type="checkbox"/> ANY AUTO				BODILY INJURY (Per person) \$
	<input type="checkbox"/> ALL OWNED AUTOS				BODILY INJURY (Per accident) \$
	<input type="checkbox"/> SCHEDULED AUTOS				PROPERTY DAMAGE (Per accident) \$
	GARAGE LIABILITY				AUTO ONLY - EA ACCIDENT \$
	<input type="checkbox"/> ANY AUTO				OTHER THAN AUTO ONLY: EA ACC \$ AGG \$
	EXCESS LIABILITY				EACH OCCURRENCE \$
	<input type="checkbox"/> OCCUR <input type="checkbox"/> CLAIMS MADE				AGGREGATE \$
	<input type="checkbox"/> DEDUCTIBLE				\$
	<input type="checkbox"/> RETENTION \$				\$
					\$
B	WORKERS COMPENSATION AND EMPLOYERS' LIABILITY	713691102	10/01/2002	10/01/2003	<input checked="" type="checkbox"/> WC STATUTORY LIMITS <input type="checkbox"/> OTHER
					E.L. EACH ACCIDENT \$ 1,000,000
					E.L. DISEASE - EA EMPLOYEE \$ 1,000,000
					E.L. DISEASE - POLICY LIMIT \$ 1,000,000
C	OTHER Rented/Leased Equip, Scheduled Equip.	2496164	06/01/2002	06/01/2003	Rented/Leased \$100,000 Scheduled Equip \$29,225 \$1,000 Ded. Special Form

DESCRIPTION OF OPERATIONS/LOCATIONS/VEHICLES/EXCLUSIONS ADDED BY ENDORSEMENTS/SPECIAL PROVISIONS
Evidence of Insurance

* Upon non payment of premium, 10 days notice of cancellation will apply.

CERTIFICATE HOLDER	ADDITIONAL INSURED; INSURER LETTER:	CANCELLATION
FOR INSURED'S RECORDS Mary		SHOULD ANY OF THE ABOVE DESCRIBED POLICIES BE CANCELLED BEFORE THE EXPIRATION DATE THEREOF, THE ISSUING COMPANY WILL ENDEAVOR TO MAIL <u>10*</u> DAYS WRITTEN NOTICE TO THE CERTIFICATE HOLDER NAMED TO THE LEFT, BUT FAILURE TO MAIL SUCH NOTICE SHALL IMPOSE NO OBLIGATION OR LIABILITY OF ANY KIND UPON THE COMPANY, ITS AGENTS OR REPRESENTATIVES.
		AUTHORIZED REPRESENTATIVE Gabriele Hollingsworth/TMS

IMPORTANT

If the certificate holder is an ADDITIONAL INSURED, the policy(ies) must be endorsed. A statement on this certificate does not confer rights to the certificate holder in lieu of such endorsement(s).

If SUBROGATION IS WAIVED, subject to the terms and conditions of the policy, certain policies may require an endorsement. A statement on this certificate does not confer rights to the certificate holder in lieu of such endorsement(s).

DISCLAIMER

The Certificate of Insurance on the reverse side of this form does not constitute a contract between the issuing insurer(s), authorized representative or producer, and the certificate holder, nor does it affirmatively or negatively amend, extend or alter the coverage afforded by the policies listed thereon.

I declare that to the best of my knowledge and belief that the statements and information provided above are correct and true.

I understand that information, in addition to that provided above, may be needed in order to obtain approval from the Environmental Protection Division and that no work is to begin on this project until this plan is approved.

I understand that any changes in design, materials or equipment will void this plan if prior approval is not obtained.

I understand that all work performed during this project will be done in compliance with all applicable OSHA (Occupational Safety and Health Administration) requirements concerning personnel health and safety. I understand that site and worker safety are solely the responsibility of the property owner or his agent and that this responsibility is not shared nor assumed by the County of Alameda.

Once I have received my stamped, accepted closure plan, I will contact the project Hazardous Materials Specialist at least three working days in advance of site work to schedule the required inspections.

CONTRACTOR INFORMATION

Name of Business DCM CONSTRUCTION & SERVICES, INC.

Name of Individual JEFF DEAKIN

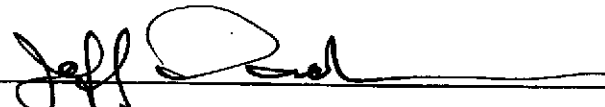
Signature  Date 9-24-02

PROPERTY OWNER OR MOST RECENT TANK OPERATOR (Circle one)

Name of Business VULCAN MATERIALS

Name of Individual Kenneth R Benson JR

Signature  Date 10/9/02

Oct 11 02 08:40a

Jay Carpenter

(510) 278-9137

Alameda County

P. 2

UNIFIED PROGRAM CONSOLIDATED FORM

UNDERGROUND STORAGE TANKS - FACILITY

TANKS

(one page per site)

TYPE OF ACTION 1. NEW SITE PERMIT 3. RENEWAL PERMIT 6. CHANGE OF INFORMATION (Specify change - local use only) 7. PERMANENTLY CLOSED SITE 8. TANK REMOVED

2. AMENDED PERMIT 4. TEMPORARY SITE CLOSURE 5. TANK REMOVED

Page 1 of 1

I. FACILITY / SITE INFORMATION

BUSINESS NAME (Same as FACILITY NAME or DBA - Doing Business As) **VULCAN MATERIALS** 3 FACILITY ID# **01 000 304657** 1

NEAREST CROSS STREET **STANLEY BLVD.** 401 FACILITY OWNER TYPE 4. LOCAL AGENCY/DISTRICT 1. CORPORATION 5. COUNTY AGENCY

BUSINESS TYPE 1. GAS STATION 2. DISTRIBUTOR 3. FARM 4. PROCESSOR 5. COMMERCIAL 6. OTHER 2. INDIVIDUAL 3. PARTNERSHIP 7. FEDERAL AGENCY 402

TOTAL NUMBER OF TANKS REMAINING AT SITE **2** 404 Is facility on Indian Reservation or trustland? Yes No 405 *If owner of UST is public agency, a name of supervisor of division, section or office which operates the UST. (This is the contact person for the tank records.) 406

II. PROPERTY OWNER INFORMATION

PROPERTY OWNER NAME **VULCAN MATERIALS** 407 PHONE **925-846-2852** 408

MAILING OR STREET ADDRESS **P.O. Box 636** 409

CITY **PLEASANTON** 410 STATE **CA** 411 ZIP CODE **94566-0063** 412

PROPERTY OWNER TYPE 1. CORPORATION 2. INDIVIDUAL 3. PARTNERSHIP 4. LOCAL AGENCY / DISTRICT 5. COUNTY AGENCY 6. STATE AGENCY 7. FEDERAL AGENCY 413

III. TANK OWNER INFORMATION

TANK OWNER NAME **VULCAN MATERIALS** 414 PHONE **925-846-2852** 415

MAILING OR STREET ADDRESS **501 EL CHARRO ROAD** 416

CITY **PLEASANTON** 417 STATE **CA** 418 ZIP CODE **94588-9617** 419

TANK OWNER TYPE 1. CORPORATION 2. INDIVIDUAL 3. PARTNERSHIP 4. LOCAL AGENCY / DISTRICT 5. COUNTY AGENCY 6. STATE AGENCY 7. FEDERAL AGENCY 420

IV. BOARD OF EQUALIZATION UNIT STORAGE FEE ACCOUNT NUMBER

TY (TK) HQ **4 4 -** Call (916) 322-0600 if questions arise 421

V. FIDELITY AND FINANCIAL RESPONSIBILITY

INDICATE METHOD(S) 1. SELF INSURED 2. GUARANTEE 3. INSURANCE 4. SURETY BOND 5. LETTER OF CREDIT 6. EXEMPTION 7. STATE FUND 8. STATE FUND & CFO LETTER 9. STATE FUND & CD 10. LOCAL GOVT MECHANISM 11. OTHER: 422

VI. NOTIFICATION AND MAILING ADDRESS

Check one box to indicate which address should be used for legal notification and mailing. Legal notifications and mailings will be sent to the tank owner unless box 1 or 2 is checked. 1. FACILITY 2. PROPERTY OWNER 3. TANK OWNER 423

VII. APPLICANT SIGNATURE

Signature of Applicant: **Kenneth R. Benson Jr.** DATE: **10/11/02** 414 PHONE: **925-580-4043** 425

NAME OF APPLICANT (Print) **Kenneth R. Benson Jr.** 426 TITLE OF APPLICANT **Plant Manager** 427

UNDERGROUND STORAGE TANKS - TANK PAGE 1

(two pages per tank)

Page 1 of 2

- TYPE OF ACTION (check one item only)
- 1. NEW SITE PERMIT
 - 2. RENEWAL PERMIT
 - 3. RENEWAL PERMIT
 - 4. AMENDED PERMIT (Specify reason - for local use only)
 - 5. CHANGE OF INFORMATION (Specify change - for local use only)
 - 6. TEMPORARY SITE CLOSURE
 - 7. PERMANENTLY CLOSED ON SITE
 - 8. TANK REMOVED

430

BUSINESS NAME (Same as FACILITY NAME or DBA - doing Business As)
VULCAN MATERIALS 01 000 304657

LOCATION WITHIN SITE (Optional)

431

TANK ID # 1	432	TANK MANUFACTURER UNK	433	COMPARTMENTALIZED TANK If "Yes," complete one page for each compartment. <input type="checkbox"/> Yes <input type="checkbox"/> No	434
DATE INSTALLED (YEAR/MO) UNK	435	TANK CAPACITY IN GALLONS 12,000	436	NUMBER OF COMPARTMENTS 1	437

ADDITIONAL DESCRIPTION (For local use only) 438

TANK USE <input checked="" type="checkbox"/> 1. MOTOR VEHICLE FUEL (If marked, complete Petroleum Type) <input type="checkbox"/> 2. NON-FUEL PETROLEUM <input type="checkbox"/> 3. CHEMICAL PRODUCT <input type="checkbox"/> 4. HAZARDOUS WASTE (Includes Used Oil) <input type="checkbox"/> 95. UNKNOWN	PETROLEUM TYPE <input type="checkbox"/> 1a. REGULAR UNLEADED <input type="checkbox"/> 2. LEADED <input type="checkbox"/> 5. JET FUEL <input type="checkbox"/> 1b. PREMIUM UNLEADED <input checked="" type="checkbox"/> 3. DIESEL <input type="checkbox"/> 6. AVIATION FUEL <input type="checkbox"/> 1c. MIDGRADE UNLEADED <input type="checkbox"/> 4. GASOHOL <input type="checkbox"/> 99. OTHER _____			440
	COMMON NAME (from Hazardous Materials Inventory page) 441	CAS # (from Hazardous Materials Inventory page) 442	443	

TYPE OF TANK (Check one item only)

- 1. SINGLE WALL
- 2. DOUBLE WALL
- 3. SINGLE WALL WITH EXTERIOR MEMBRANE LINER
- 4. SINGLE WALL IN A VAULT
- 5. SINGLE WALL WITH INTERNAL BLADDER SYSTEM
- 95. UNKNOWN
- 99. OTHER _____

443

TANK MATERIAL - primary tank (Check one item only)

- 1. BARE STEEL
- 2. STAINLESS STEEL
- 3. FIBERGLASS / PLASTIC
- 4. STEEL CLAD W/FIBERGLASS REINFORCED PLASTIC (FRP)
- 5. CONCRETE
- 8. FRP COMPATIBLE W/100% METHANOL
- 95. UNKNOWN
- 99. OTHER _____

444

TANK MATERIAL - secondary tank (Check one item only)

- 1. BARE STEEL
- 2. STAINLESS STEEL
- 3. FIBERGLASS / PLASTIC
- 4. STEEL CLAD W/FIBERGLASS REINFORCED PLASTIC (FRP)
- 5. CONCRETE
- 8. FRP COMPATIBLE W/100% METHANOL
- 9. FRP NON-CORRODIBLE JACKET
- 10. COATED STEEL
- 95. UNKNOWN
- 99. OTHER _____

445

TANK INTERIOR LINING OR COATING (Check one item only)

- 1. RUBBER LINED
- 2. ALKYD LINED
- 3. EPOXY LINING
- 4. PHENOLIC LINING
- 5. GLASS LINING
- 6. UNLINED
- 95. UNKNOWN
- 99. OTHER _____

446

DATE INSTALLED 447

(For local use only)

OTHER CORROSION PROTECTION IF APPLICABLE (Check one item only)

- 1. MANUFACTURED CATHODIC PROTECTION
- 2. SACRIFICIAL ANODE
- 3. FIBERGLASS REINFORCED PLASTIC
- 4. IMPRESSED CURRENT
- 95. UNKNOWN
- 99. OTHER _____

448

DATE INSTALLED 449

(For local use only)

SPILL AND OVERFILL (Check all that apply)

YEAR INSTALLED 450 TYPE (For local use only) 451 OVERFILL PROTECTION EQUIPMENT: YEAR INSTALLED 452

- 1. SPILL CONTAINMENT
- 2. DROP TUBE
- 3. STRIKER PLATE
- 1. ALARM
- 2. BALL FLOAT
- 3. FILL TUBE SHUT OFF VALVE
- 4. EXEMPT

IF SINGLE WALL TANK (Check all that apply): 453 <input type="checkbox"/> 1. VISUAL (EXPOSED PORTION ONLY) <input type="checkbox"/> 2. AUTOMATIC TANK GAUGING (ATG) <input type="checkbox"/> 3. CONTINUOUS ATG <input type="checkbox"/> 4. STATISTICAL INVENTORY RECONCILIATION (SIR)- BIENNIAL TANK TESTING	<input type="checkbox"/> 5. MANUAL TANK GAUGING (MTG) <input type="checkbox"/> 6. VADOSE ZONE <input type="checkbox"/> 7. GROUNDWATER <input type="checkbox"/> 8. TANK TESTING <input type="checkbox"/> 99. OTHER _____	IF DOUBLE WALL TANK OR TANK WITH BLADDER (Check one item only): 454 <input type="checkbox"/> 1. VISUAL (SINGLE WALL IN VAULT ONLY) <input checked="" type="checkbox"/> 2. CONTINUOUS INTERSTITIAL MONITORING <input type="checkbox"/> 3. MANUAL MONITORING
---	---	---

ESTIMATED DATE LAST USED (YR/MO/DAY) 455 ESTIMATED QUANTITY OF SUBSTANCE REMAINING 456 TANK FILLED WITH INERT MATERIAL? 457

10/01 **0** gallons Yes No

Alameda County

UNIFIED PROGRAM CONSOLIDATED FORM UNDERGROUND STORAGE TANKS - TANK PAGE 2

TANKS

Page 2 of 2

VI. PIPING CONSTRUCTION (Check all that apply)

Table with columns for UNDERGROUND PIPING and ABOVEGROUND PIPING. Rows include SYSTEM TYPE, CONSTRUCTION/MANUFACTURER, and MATERIALS AND CORROSION PROTECTION.

VII. PIPING LEAK DETECTION (Check all that apply)

Table with columns for UNDERGROUND PIPING and ABOVEGROUND PIPING. Rows include PRESSURIZED PIPING, CONVENTIONAL SUCTION SYSTEMS, SAFE SUCTION SYSTEMS, GRAVITY FLOW, and SECONDARILY CONTAINED PIPING.

VIII. DISPENSER CONTAINMENT

Form for DISPENSER CONTAINMENT with checkboxes for float mechanism, continuous dispenser pan sensor, and trench liner/monitoring.

IX. OWNER / OPERATOR SIGNATURE

Signature area for OWNER / OPERATOR with fields for SIGNATURE, DATE, and TITLE OF OWNER / OPERATOR.

UNDERGROUND STORAGE TANKS - TANK PAGE 1

(two pages per tank)

Page 1 of 2

TYPE OF ACTION
(Check one item only)

1. NEW SITE PERMIT
 3. RENEWAL PERMIT

4. AMENDED PERMIT

(Specify reason - for local use only)

5. CHANGE OF INFORMATION

(Specify change - for local use only)

6. TEMPORARY SITE CLOSURE
 7. PERMANENTLY CLOSED ON SITE
 8. TANK REMOVED

430

BUSINESS NAME (Same as FACILITY NAME or DBA - doing Business As)

VULCAN MATERIALS

FACILITY ID #

01 000 304657

LOCATION WITHIN SITE (Optional)

431

I. TANK DESCRIPTION

TANK ID #	432	TANK MANUFACTURER	433	COMPARTMENTALIZED TANK	434
2		UNK		<input type="checkbox"/> Yes <input checked="" type="checkbox"/> No	If "Yes," complete one page for each compartment.
DATE INSTALLED (YR/MO)	435	TANK CAPACITY IN GALLONS	436	NUMBER OF COMPARTMENTS	437
UNK		5,000		1	
ADDITIONAL DESCRIPTION (For local use only)					

438

II. TANK CONTENTS

TANK USE	PETROLEUM TYPE		440	
<input checked="" type="checkbox"/> 1. MOTOR VEHICLE FUEL (If marked, complete Petroleum Type)	<input checked="" type="checkbox"/> 1a. REGULAR UNLEADED	<input type="checkbox"/> 2. LEADED	<input type="checkbox"/> 5. JET FUEL	
<input type="checkbox"/> 2. NON-FUEL PETROLEUM	<input type="checkbox"/> 1b. PREMIUM UNLEADED	<input type="checkbox"/> 3. DIESEL	<input type="checkbox"/> 6. AVIATION FUEL	
<input type="checkbox"/> 3. CHEMICAL PRODUCT	<input type="checkbox"/> 1c. MIDGRADE UNLEADED	<input type="checkbox"/> 4. GASOLIN	<input type="checkbox"/> 99. OTHER	
<input type="checkbox"/> 4. HAZARDOUS WASTE (Includes Used Oil)	COMMON NAME (from Hazardous Materials Inventory page)	441	CAS # (from Hazardous Materials Inventory page)	442
<input type="checkbox"/> 95. UNKNOWN				

III. TANK CONSTRUCTION

TYPE OF TANK	443		
<input type="checkbox"/> 1. SINGLE WALL	<input type="checkbox"/> 3. SINGLE WALL WITH EXTERIOR MEMBRANE LINER	<input type="checkbox"/> 5. SINGLE WALL WITH INTERNAL BLADDER SYSTEM	
<input checked="" type="checkbox"/> 2. DOUBLE WALL	<input type="checkbox"/> 4. SINGLE WALL IN A VAULT	<input type="checkbox"/> 95. UNKNOWN	
<input type="checkbox"/> 99. OTHER			
TANK MATERIAL - primary tank	444		
<input type="checkbox"/> 1. BARE STEEL	<input type="checkbox"/> 3. FIBERGLASS / PLASTIC	<input type="checkbox"/> 5. CONCRETE	<input checked="" type="checkbox"/> 95. UNKNOWN
<input type="checkbox"/> 2. STAINLESS STEEL	<input type="checkbox"/> 4. STEEL CLAD W/FIBERGLASS REINFORCED PLASTIC (FRP)	<input type="checkbox"/> 8. FRP COMPATIBLE W/100% METHANOL	<input type="checkbox"/> 99. OTHER
TANK MATERIAL - secondary tank	445		
<input type="checkbox"/> 1. BARE STEEL	<input type="checkbox"/> 3. FIBERGLASS / PLASTIC	<input type="checkbox"/> 8. FRP COMPATIBLE W/100% METHANOL	<input checked="" type="checkbox"/> 95. UNKNOWN
<input type="checkbox"/> 2. STAINLESS STEEL	<input type="checkbox"/> 4. STEEL CLAD W/FIBERGLASS REINFORCED PLASTIC (FRP)	<input type="checkbox"/> 9. FRP NON-CORRODIBLE JACKET	<input type="checkbox"/> 99. OTHER
<input type="checkbox"/> 5. CONCRETE	<input type="checkbox"/> 10. COATED STEEL		
TANK INTERIOR LINING OR COATING	446		
<input type="checkbox"/> 1. RUBBER LINED	<input type="checkbox"/> 3. EPOXY LINING	<input type="checkbox"/> 5. GLASS LINING	<input checked="" type="checkbox"/> 95. UNKNOWN
<input type="checkbox"/> 2. ALKYD LINING	<input type="checkbox"/> 4. PHENOLIC LINING	<input type="checkbox"/> 6. UNLINED	<input type="checkbox"/> 99. OTHER
OTHER CORROSION PROTECTION IF APPLICABLE	448		
<input type="checkbox"/> 1. MANUFACTURED CATHODIC PROTECTION	<input type="checkbox"/> 3. FIBERGLASS REINFORCED PLASTIC	<input checked="" type="checkbox"/> 95. UNKNOWN	
<input type="checkbox"/> 2. SACRIFICIAL ANODE	<input type="checkbox"/> 4. IMPRESSED CURRENT	<input type="checkbox"/> 99. OTHER	

447

449

SPILL AND OVERFILL

YEAR INSTALLED

450 TYPE (For local use only)

OVERFILL PROTECTION EQUIPMENT: YEAR INSTALLED

452

(Check all that apply)

1. SPILL CONTAINMENT
2. DROP TUBE
3. STRIKER PLATE

UNK

1. ALARM
2. BALL FLOAT
3. FILL TUBE SHUT OFF VALVE
4. EXEMPT

IV. TANK LEAK DETECTION

IF SINGLE WALL TANK (Check all that apply):	453	IF DOUBLE WALL TANK OR TANK WITH BLADDER (Check one item only):	454
<input type="checkbox"/> 1. VISUAL (EXPOSED PORTION ONLY)	<input type="checkbox"/> 5. MANUAL TANK GAUGING (MTG)	<input type="checkbox"/> 1. VISUAL (SINGLE WALL IN VAULT ONLY)	
<input type="checkbox"/> 2. AUTOMATIC TANK GAUGING (ATG)	<input type="checkbox"/> 6. VADOSE ZONE	<input checked="" type="checkbox"/> 2. CONTINUOUS INTERSTITIAL MONITORING	
<input type="checkbox"/> 3. CONTINUOUS ATG	<input type="checkbox"/> 7. GROUNDWATER	<input type="checkbox"/> 3. MANUAL MONITORING	
<input type="checkbox"/> 4. STATISTICAL INVENTORY RECONCILIATION (SIR)+ BIENNIAL TANK TESTING	<input type="checkbox"/> 8. TANK TESTING		
	<input type="checkbox"/> 99. OTHER		

V. TANK CLOSURE INFORMATION / PERMANENT CLOSURE IN PLACE

ESTIMATED DATE LAST USED (YR/MO/DAY)	455	ESTIMATED QUANTITY OF SUBSTANCE REMAINING	456	TANK FILLED WITH INERT MATERIAL?	457
10/01		0 gallons		<input type="checkbox"/> Yes <input checked="" type="checkbox"/> No	

Alameda County

UNIFIED PROGRAM CONSOLIDATED FORM UNDERGROUND STORAGE TANKS - TANK PAGE 2

TANKS

VI. PIPING CONSTRUCTION (Check all that apply)

Table with columns for UNDERGROUND PIPING and ABOVEGROUND PIPING, detailing SYSTEM TYPE, CONSTRUCTION MANUFACTURER, and MATERIALS AND CORROSION PROTECTION.

VI. PIPING LEAK DETECTION (Check all that apply)

Table with columns for UNDERGROUND PIPING and ABOVEGROUND PIPING, detailing PRESSURIZED PIPING, CONVENTIONAL SUCTION SYSTEMS, SAFE SUCTION SYSTEMS, GRAVITY FLOW, and SECONDARILY CONTAINED PIPING.

VII. DISPENSER CONTAINMENT

Table for DISPENSER CONTAINMENT with options for float mechanism, continuous dispenser pan sensor, and daily visual check.

DI. OWNER / OPERATOR SIGNATURE

Signature area for KENNETH BENSON, dated 10/11/02, with title PLANT MANAGER.

Form number and permit approval information at the bottom of the page.



DISPENSERS

ISLANDS

CONCRETE PAD

12K
DIESEL

5K
UNL.

VENTS

SUMP

SUMP

FILL

FILL

DISPENSERS

UST REMOVAL
Vulcan Materials
501 El Charro Road
Pleasanton, California

DCM, Inc.

Site: Vulcan Materials
Date: 10/10/02
Drawn By: J. Carpenter
Scale: 1" = 10'

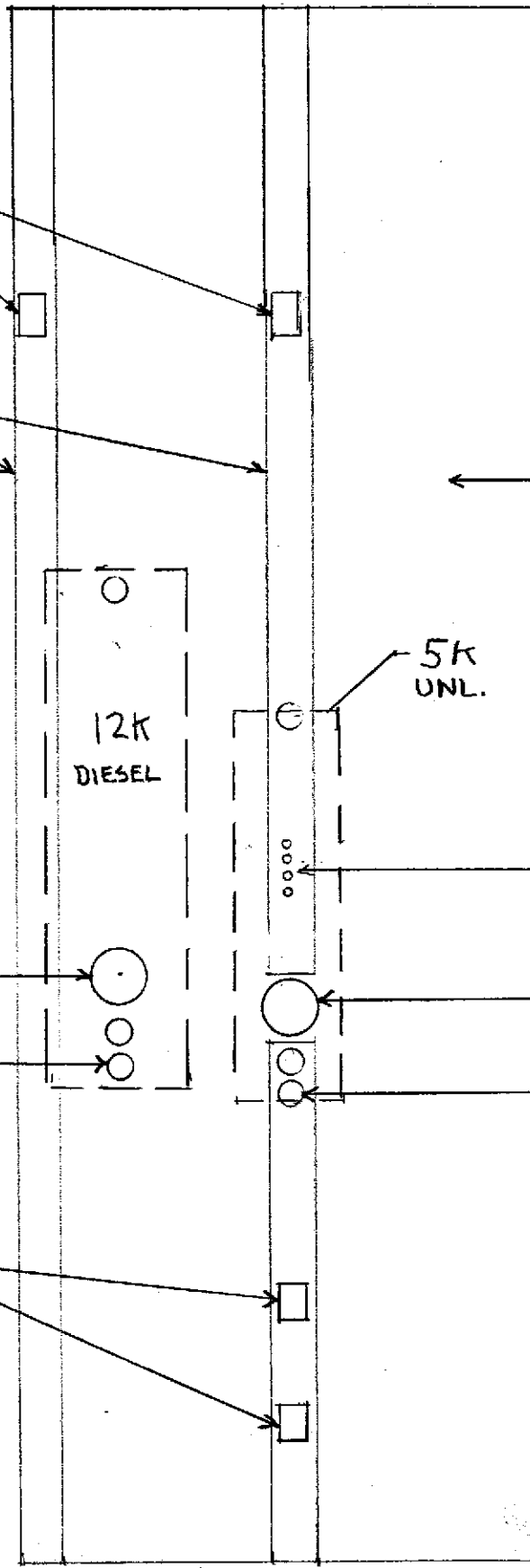

PROJECT SITE: VULCAN MATERIALS COMPANY
 PLEASANTON PLANT
 50 EL CHARRO RD
 PLEASANTON, CA 94566

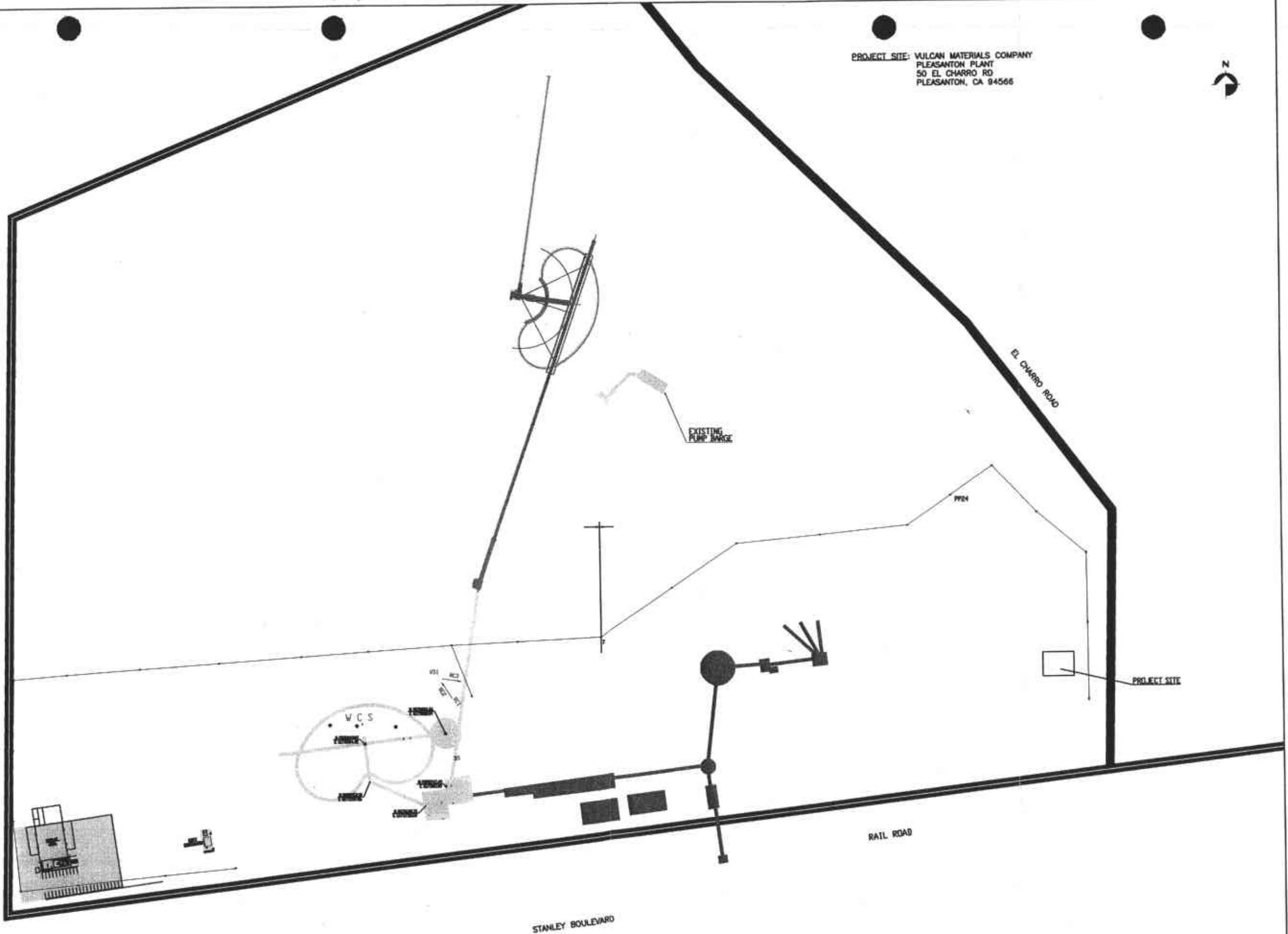

<table border="1"> <tr> <td>D</td> <td></td> <td></td> <td></td> </tr> <tr> <td>C</td> <td></td> <td></td> <td></td> </tr> <tr> <td>B</td> <td></td> <td></td> <td></td> </tr> <tr> <td>A</td> <td></td> <td></td> <td></td> </tr> <tr> <td>1</td> <td></td> <td></td> <td></td> </tr> <tr> <td>DATE</td> <td>REVISION</td> <td>BY</td> <td></td> </tr> </table>		D				C				B				A				1				DATE	REVISION	BY		<p>TOLERANCES - UNLESS NOTED</p> <p>FINISHES - UNLESS NOTED</p> <p>ALL DIMENSIONS TO FACE UNLESS NOTED TO THE CONTRARY</p>		<table border="1"> <tr> <td>PLEASANTON</td> <td>WESTERN DIVISION</td> <td>PLEASANTON</td> </tr> <tr> <td>PLANT SITE</td> <td></td> <td></td> </tr> </table>	PLEASANTON	WESTERN DIVISION	PLEASANTON	PLANT SITE			<table border="1"> <tr> <td>SCALE</td> <td>4" = 100'</td> </tr> <tr> <td>SHEET</td> <td>1 OF 1</td> </tr> </table>	SCALE	4" = 100'	SHEET	1 OF 1
D																																							
C																																							
B																																							
A																																							
1																																							
DATE	REVISION	BY																																					
PLEASANTON	WESTERN DIVISION	PLEASANTON																																					
PLANT SITE																																							
SCALE	4" = 100'																																						
SHEET	1 OF 1																																						