



Atlantic Richfield Company
(a BP affiliated company)

P.O. Box 1257
San Ramon, California 94583
Phone: (925) 275-3801
Fax: (925) 275-3815

18 July 2008

Re: Second Quarter 2008 Status Report
Atlantic Richfield Company Service Station #2107
3310 Park Boulevard
Oakland, California
ACEH Case #RO0002526

RECEIVED

2:33 pm, Jul 29, 2008

Alameda County
Environmental Health



"I declare, that to the best of my knowledge at the present time, that the information and/or recommendations contained in the attached document are true and correct."

Submitted by:

Paul Supple
Environmental Business Manager

18 July 2008

Project No. 06-08-614

Atlantic Richfield Company
P.O. Box 1257
San Ramon, California 94583
Submitted via ENFOS

Attn.: Mr. Paul Supple

Re: Second Quarter 2008 Status Report, Atlantic Richfield Company (a BP affiliated company)
Station #2107, 3310 Park Boulevard, Oakland, California; ACEH Case #RO0002526

Dear Mr. Supple:

Provided herein is the *Second Quarter 2008 Status Report* for Atlantic Richfield Company Station #2107 located at 3310 Park Boulevard, Oakland, Alameda County, California. This report presents a summary of current developments at the Site through the Second Quarter 2008.

Should you have questions regarding this submission, please do not hesitate to contact us at (530) 566-1400.

Sincerely,

BROADBENT & ASSOCIATES, INC.

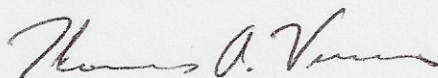

Thomas A. Venus, P.E.
Senior Engineer

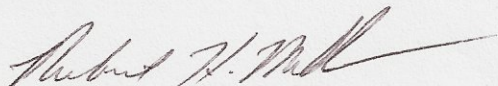

Robert H. Miller, P.G., C.H.G.
Principal Hydrogeologist

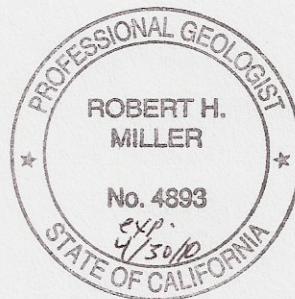

Enclosure

cc: Mr. Paresh Khatri, Alameda County Environmental Health (Submitted via ACEH ftp site)
Electronic copy uploaded to GeoTracker

STATION #2107 QUARTERLY GROUND-WATER STATUS REPORT

Facility: #2107	Address:	3310 Park Boulevard, Oakland, California
Environmental Business Manager:		Mr. Paul Supple
Consulting Company/Contact Person:		Broadbent & Associates, Inc.(BAI)/Rob Miller & Tom Venus (530) 566-1400
Consultant Project No.:		06-08-614
Primary Agency/Regulatory ID No.:		Alameda County Environmental Health (ACEH) ACEH Case # RO0002526

WORK PERFORMED THIS QUARTER (Second Quarter 2008):

1. Prepared and submitted the First Quarter 2008 Status Report.
2. No environmental work was conducted at the Site during the Second Quarter of 2008.

WORK PROPOSED FOR NEXT QUARTER (Third Quarter 2008):

1. Prepared and submitted this Second Quarter 2008 Status Report (contained herein).
2. Prepare and submit Soil & Ground-Water Investigation Work Plan by 2 September 2008.

DISCUSSION:

On 29 August 2007, BAI submitted an Offsite Soil and Ground-Water Investigation Report to Alameda County Environmental Health (ACEH). BP had been awaiting a response from ACEH before proceeding with further environmental work. Mr. Paresh Khatri of ACEH responded to the aforementioned report with a directive letter dated 7 July 2008. Within the letter, Mr. Khatri requested that a Soil & Ground-Water Investigation Work Plan be submitted by 2 September 2008. A site map with the last offsite hydropunch boring locations is provided as Drawing 1.

ATTACHMENTS:

Drawing 1 Offsite Hydropunch Boring Locations, Station #2107, 3310 Park Boulevard, Oakland, California

Oakland High School

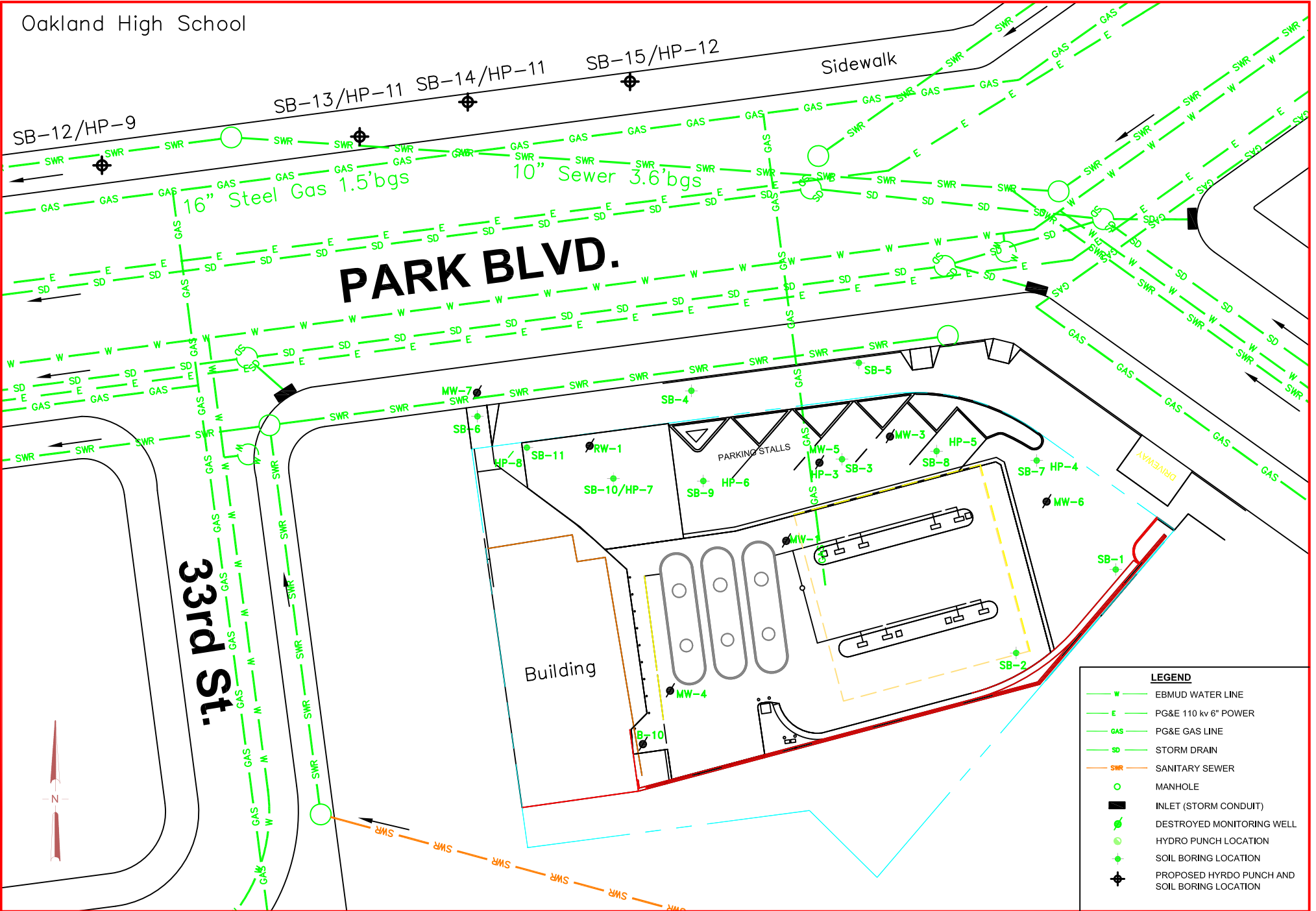

PARK BLVD.

33rd St.

Building

PARKING STALLS

DRIVEWAY

LEGEND	
	EBMUD WATER LINE
	PG&E 110 kv 6" POWER
	PG&E GAS LINE
	STORM DRAIN
	SANITARY SEWER
	MANHOLE
	INLET (STORM CONDUIT)
	DESTROYED MONITORING WELL
	HYDRO PUNCH LOCATION
	SOIL BORING LOCATION
	PROPOSED HYDRO PUNCH AND SOIL BORING LOCATION

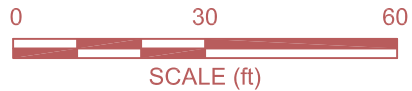

BROADBENT & ASSOCIATES, INC.
 ENGINEERING, WATER RESOURCES & ENVIRONMENTAL
 1324 Mangrove Ave. Suite 212, Chico, California
 Project No.: 06-08-614 Date: 06/27/07

Station #2107
 3310 Park Boulevard
 Oakland, California

Offsite Hydropunch
 Boring Locations

Drawing
1