



Atlantic Richfield Company  
(a BP affiliated company)

P.O. Box 1257  
San Ramon, California 94583  
Phone: (925) 275-3801  
Fax: (925) 275-3815

8 April 2008

Re: First Quarter 2008 Status Report  
Atlantic Richfield Company Service Station #2107  
3310 Park Boulevard  
Oakland, California  
ACEH Case #RO0002526

**RECEIVED**

9:22 am, May 01, 2008

Alameda County  
Environmental Health



"I declare, that to the best of my knowledge at the present time, that the information and/or recommendations contained in the attached document are true and correct."

Submitted by:

Paul Supple  
Environmental Business Manager

8 April 2008

Project No. 06-08-614

Atlantic Richfield Company  
P.O. Box 1257  
San Ramon, California 94583  
Submitted via ENFOS

Attn.: Mr. Paul Supple

Re: First Quarter 2008 Status Report, Atlantic Richfield Company (a BP affiliated company)  
Station #2107, 3310 Park Boulevard, Oakland, California; ACEH Case #RO0002526

Dear Mr. Supple:

Provided herein is the *First Quarter 2008 Status Report* for Atlantic Richfield Company Station #2107 located at 3310 Park Boulevard, Oakland, Alameda County, California. This report presents a summary of current developments at the Site through the First Quarter 2008.

Should you have questions regarding this submission, please do not hesitate to contact us at (530) 566-1400.

Sincerely,

BROADBENT & ASSOCIATES, INC.



Thomas A. Venus, P.E.  
Senior Engineer

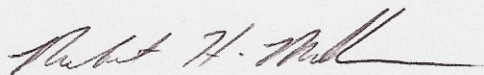

Robert H. Miller, P.G., C.HG.  
Principal Hydrogeologist

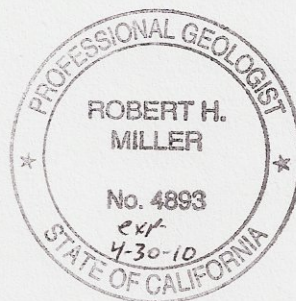

Enclosure

cc: Mr. Paresh Khatri, Alameda County Environmental Health (Submitted via ACEH ftp site)  
Electronic copy uploaded to GeoTracker

## STATION #2107 QUARTERLY GROUND-WATER STATUS REPORT

Facility: #2107	Address:	3310 Park Boulevard, Oakland, California
Environmental Business Manager:		Mr. Paul Supple
Consulting Company/Contact Person:		Broadbent & Associates, Inc.(BAI)/Rob Miller & Tom Venus (530) 566-1400
Consultant Project No.:		06-08-614
Primary Agency/Regulatory ID No.:		Alameda County Environmental Health (ACEH) ACEH Case # RO0002526

### WORK PERFORMED THIS QUARTER (First Quarter 2008):

1. Prepared and submitted the Fourth Quarter 2007 Status Report.
2. No environmental work was conducted at the Site during the First Quarter of 2008.

### WORK PROPOSED FOR NEXT QUARTER (Second Quarter 2008):

1. Prepared and submitted this First Quarter 2008 Status Report (contained herein).
2. No environmental work is scheduled for the site during the Second Quarter 2008.

### DISCUSSION:

On 29 August 2007, BAI submitted an Offsite Soil and Ground-Water Investigation Report to Alameda County Environmental Health (ACEH). A site map with offsite hydropunch boring locations is provided as Drawing 1. BP is currently awaiting a response from ACEH before proceeding with further environmental work.

### ATTACHMENTS:

Drawing 1      Offsite Hydropunch Boring Locations, Station #2107, 3310 Park Boulevard, Oakland, California

Oakland High School

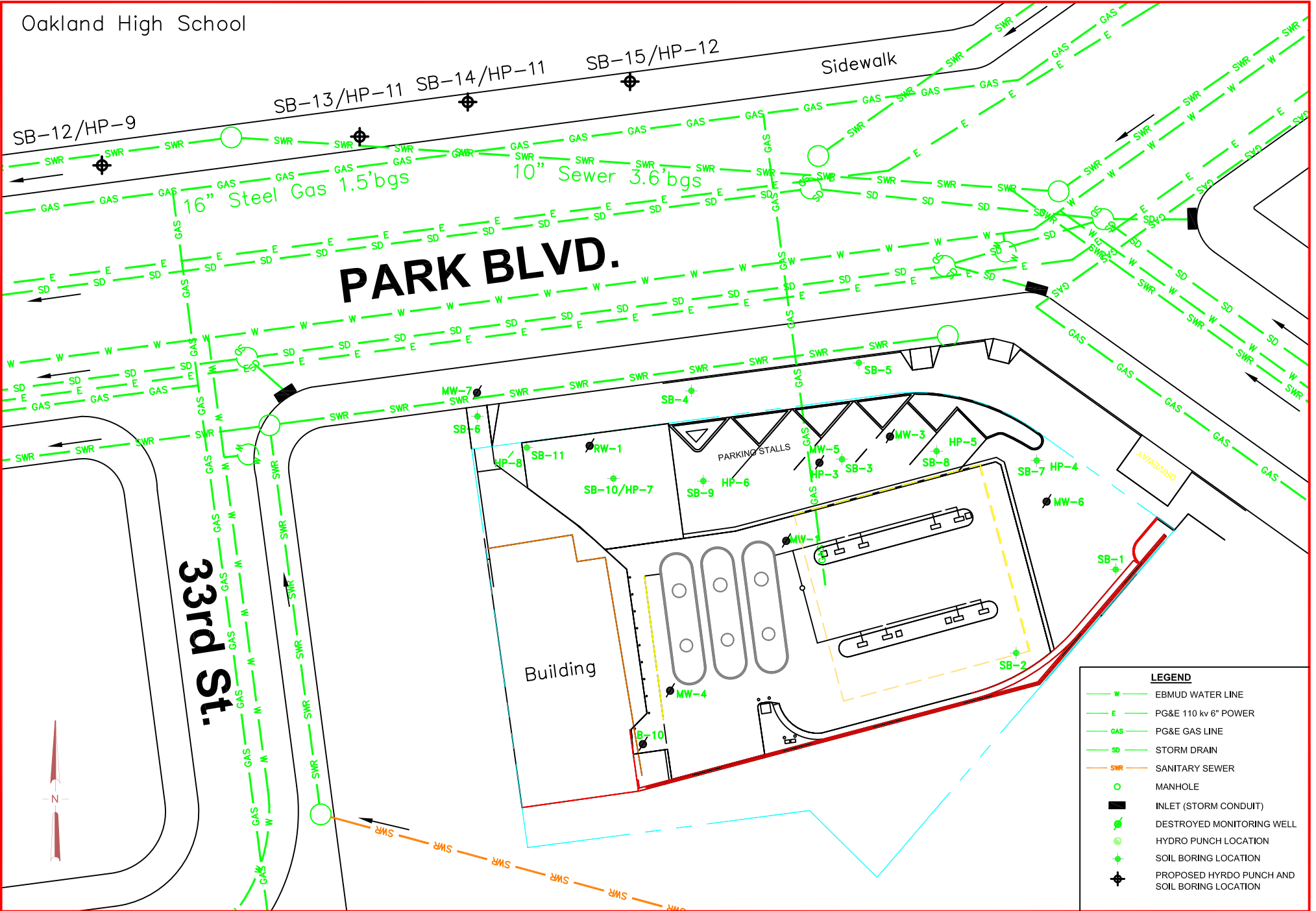

LEGEND	
	EBMUD WATER LINE
	PG&E 110 kv 6" POWER
	PG&E GAS LINE
	STORM DRAIN
	SANITARY SEWER
	MANHOLE
	INLET (STORM CONDUIT)
	DESTROYED MONITORING WELL
	HYDRO PUNCH LOCATION
	SOIL BORING LOCATION
	PROPOSED HYDRO PUNCH AND SOIL BORING LOCATION

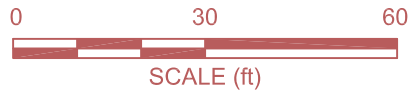

**BROADBENT & ASSOCIATES, INC.**  
 ENGINEERING, WATER RESOURCES & ENVIRONMENTAL  
 1324 Mangrove Ave. Suite 212, Chico, California  
 Project No.: 06-08-614 Date: 06/27/07

Station #2107  
 3310 Park Boulevard  
 Oakland, California

Offsite Hydropunch  
 Boring Locations

Drawing  
**1**