



Atlantic Richfield Company
(a BP affiliated company)

P.O. Box 1257
San Ramon, California 94583
Phone: (925) 275-3801
Fax: (925) 275-3815

18 January 2008

Re: Fourth Quarter 2007 Status Report
Atlantic Richfield Company Service Station #2107
3310 Park Boulevard
Oakland, California
ACEH Case #RO0002526

RECEIVED

2:11 pm, Jan 28, 2008

Alameda County
Environmental Health



"I declare, that to the best of my knowledge at the present time, that the information and/or recommendations contained in the attached document are true and correct."

Submitted by:

Paul Supple
Environmental Business Manager

18 January 2008

Project No. 06-08-614

Atlantic Richfield Company
P.O. Box 1257
San Ramon, California 94583
Submitted via ENFOS

Attn.: Mr. Paul Supple

Re: Fourth Quarter 2007 Status Report, Atlantic Richfield Company (a BP affiliated company)
Station #2107, 3310 Park Boulevard, Oakland, California; ACEH Case #RO0002526

Dear Mr. Supple:

Provided herein is the *Fourth Quarter 2007 Status Report* for Atlantic Richfield Company Station #2107 located at 3310 Park Boulevard, Oakland, Alameda County, California. This report presents a summary of current developments at the Site through the Fourth Quarter 2007.

Should you have questions regarding this submission, please do not hesitate to contact us at (530) 566-1400.

Sincerely,

BROADBENT & ASSOCIATES, INC.

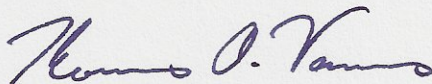

Thomas A. Venus, P.E.
Senior Engineer

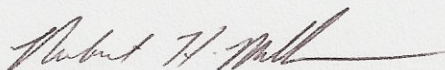

Robert H. Miller, P.G., C.HG.
Principal Hydrogeologist

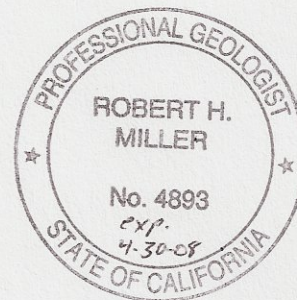

Enclosure

cc: Mr. Stephen Plunkett, Alameda County Environmental Health (Submitted via ACEH ftp site)
Electronic copy uploaded to GeoTracker

STATION #2107 QUARTERLY GROUND-WATER STATUS REPORT

Facility: #2107	Address:	3310 Park Boulevard, Oakland, California
Environmental Business Manager:		Mr. Paul Supple
Consulting Company/Contact Person:		Broadbent & Associates, Inc.(BAI)/Rob Miller & Tom Venus (530) 566-1400
Consultant Project No.:		06-08-614
Primary Agency/Regulatory ID No.:		Alameda County Environmental Health (ACEH) ACEH Case # RO0002526

WORK PERFORMED THIS QUARTER (Fourth Quarter 2007):

1. Prepared and submitted the Third Quarter 2007 Status Report.
2. No environmental work was conducted at the Site during the Fourth Quarter of 2007.

WORK PROPOSED FOR NEXT QUARTER (First Quarter 2008):

1. Prepared and submitted this Fourth Quarter 2007 Status Report (contained herein).
2. No environmental work is scheduled for the site during the First Quarter 2008.

DISCUSSION:

On 29 August 2007, BAI submitted an Offsite Soil and Ground-Water Investigation Report to Alameda County Environmental Health (ACEH). A site map with offsite hydropunch boring locations is provided as Drawing 1. BP is currently awaiting a response from ACEH before proceeding with further environmental work.

ATTACHMENTS:

Drawing 1 Offsite Hydropunch Boring Locations, Station #2107, 3310 Park Boulevard, Oakland, California

Oakland High School

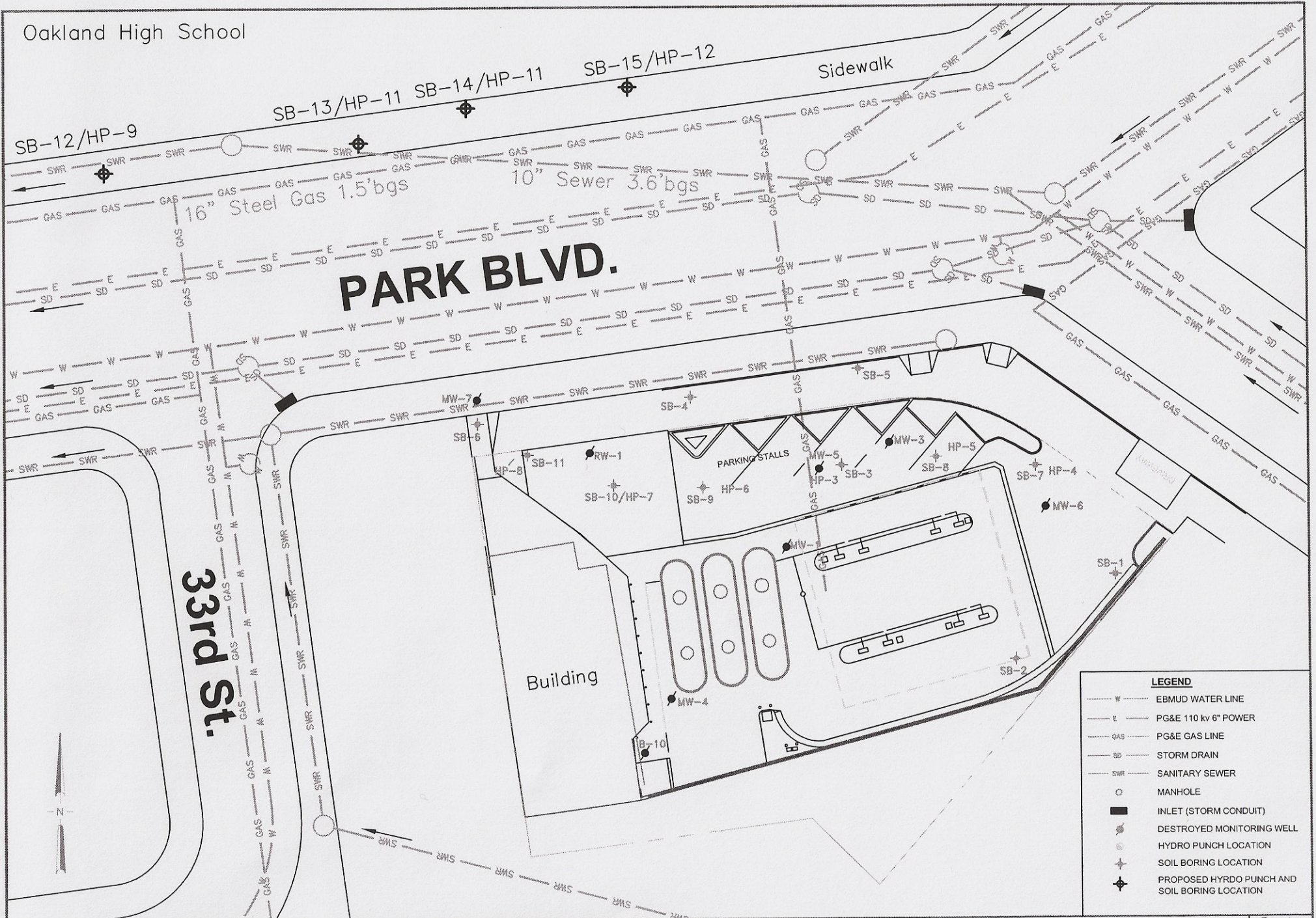

PARK BLVD.

33rd St.

SB-12/HP-9
SB-13/HP-11
SB-14/HP-11
SB-15/HP-12
16" Steel Gas 1.5' bgs
10" Sewer 3.6' bgs

Building

PARKING STALLS

LEGEND

— W —	EBMUD WATER LINE
— E —	PG&E 110 kv 6" POWER
— GAS —	PG&E GAS LINE
— SD —	STORM DRAIN
— SWR —	SANITARY SEWER
○	MANHOLE
■	INLET (STORM CONDUIT)
●	DESTROYED MONITORING WELL
⊙	HYDRO PUNCH LOCATION
+	SOIL BORING LOCATION
⊕	PROPOSED HYDRO PUNCH AND SOIL BORING LOCATION

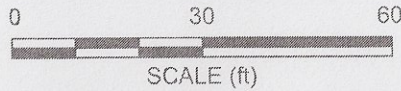

BROADBENT & ASSOCIATES, INC.
 ENGINEERING, WATER RESOURCES & ENVIRONMENTAL
 1324 Mangrove Ave, Suite 212, Chico, California
 Project No.: 06-08-614 Date: 06/27/07

Station #2107
 3310 Park Boulevard
 Oakland, California

Offsite Hydro-punch
 Boring Locations

Drawing
1