



November 22, 1988

Alameda County Health Department  
Hazardous Materials Division  
80 Swan Way, Room 200  
Oakland, California 94621

Attention: Ms. Liz Rose

Dear Ms. Rose:

Enclosed is a copy of the I.T. report on the closure and removal of the two underground storage tanks at our facility. Please excuse my delay in submitting this to you, but my time has been consumed by other responsibilities in our factory.

I would like to thank you for your help in removing these tanks successfully. It is a relief to know that we no longer are in danger of contaminating the soil or ground water beneath us.

If you have any questions or I can be of further assistance, please give me a call.

Very truly yours

A handwritten signature in cursive script that reads "Michael Slessarev". The signature is written in dark ink and is positioned above the typed name.

Michael Slessarev  
Sr. Mfg. Engineer

MS/mas

Enclosure





**INTERNATIONAL  
TECHNOLOGY  
CORPORATION**

June 30, 1988

Mr. Michael Slessarev  
Senior Production Engineer  
FABCO Automotive Corporation  
P.O. Box 8276  
Oakland, California 94662

Dear Mr. Slessarev:

**SUBJECT: UNDERGROUND STORAGE TANK PERMANENT CLOSURE REPORT  
IT PROJECT NUMBER 190317.**

IT Corporation (IT) completed the removal of two UST's at the FABCO Automotive Corporation (FABCO) facility in Oakland. Associated with this work was the remediation of the two excavation sites. This report describes the work completed.

IT recommends FABCO attach a cover letter to copies of this report and submit one to each of the following agencies:

- o Liz Rose  
Alameda County Health Department  
Hazardous Material Division  
80 Swan Way, Room 200  
Oakland, California 94621
- o Regional Water Quality Control Board  
San Francisco Bay Region  
1111 Jackson Street  
Oakland, California 94607

#### **BACKGROUND**

The property located at 1249 67th Street in Oakland had two underground storage tanks (UST's) (Figure 1). The physical descriptions of the UST's are given in Table 1. The FABCO yard was separated into two excavation sites. Support documents are supplied for both sites. These documents include:

- o Removal Permit
- o Chain of Custody Records
- o Request for Analysis
- o Sample Location Maps

Regional Office

4585 Pacheco Boulevard • Martinez, California 94553 • 415-372-9100

*IT Corporation is a wholly owned subsidiary of International Technology Corporation*

- o Laboratory Analytical Results Reports
- o Underground Storage Tank Unauthorized Release (Leak)/Contamination Site Report
- o Copies of Manifests

### SITE I

Site 1 contained a 7,000 gallon concrete waste oil vault. The vault was located on the east side of the garage; adjacent to the structure (Figure 1).

#### Tank Excavation and Demolition

The concrete top to the waste oil vault was cut and removed. All free liquids were removed from the vault prior to excavation; however, heavy sludges remained. Inspection with a Combustible Gas Indicator indicated a zero percent lower explosion level (LEL). IT Engineering accessed the concrete vault and removed the sludges. The vault was then demolished for excavation and disposal. Excavated sludge and rubble were stored in a bin pending analytical results.

#### Tank Inspection

An inspection was conducted from the surface. Inspection was difficult due to discoloration. However, the concrete was in relatively good condition. The demolished vault and solidified sludge was shipped to Casmalia Disposal Site under manifest number 87087151.

#### Remediation

After the vault was excavated, discolored and odorous soil was removed and isolated on visqueen.

Analytical results for samples S1 and N2, collected from the bottom of a ten foot (approximate) deep excavation, indicated no detectable aromatic solvents or halocarbons. No detectable concentrations of diesel or oil were found by gas chromatography using a flame ionization detector for high boiling petroleum hydrocarbon. Concentrations of 10 and 20 ppm were detected for oil and grease using Standard Method 503-E for samples S1 and N2 respectively (Table 2).

A total of 43.91 tons of waste oil contaminated materials (soil, concrete rubble) were transported to IT's PWI Site for disposal, EPA ID Number CAD 080675276, under Manifests 87992136 and 87992137.

A monitoring well will be required within ten feet of the vault site in accordance with California Regional Water Quality Control Board, San Francisco Bay Region Guidelines for Addressing Fuel Leaks, Sept. 1985. IT Corporation would be pleased to submit a proposal for the installation of a monitor well upon request from FABCO.

## SITE II

Site II contained one 1,000 gallon UST which stored unleaded gasoline. The tank was situated adjacent to the east side of the garage (see Figure 1).

### Tank Excavation and Disposal

The asphalt and concrete above the tank was cut and removed. The tank was filled with the appropriate volume of dry ice (15 pounds of ice to each 1000 gal. tank volume) and excavated. Soil above the tank was clean and stockpiled adjacent to the excavation. The tank was brought to the surface without difficulty.

### Tank Inspection

The UST was carefully inspected when brought to the surface. Minor corrosion was evident; however, the tank was in sound condition. No leaks were evident.

The UST was marked and loaded for transport under manifest #87434788 to H & H Ship Services for cleaning and demolition. The tank was then transported as inert scrap steel to Levin Metals Recyclers in Richmond, California.

### Site Analysis

After the USTs were excavated two soil samples were collected from native material beneath each tank location as per the direction of the Alameda County Health Department Inspector. These samples results may be seen in Table 2 and on the IT Santa Clara Laboratory Analytical Report (attached).

The samples collected beneath the gasoline tank had no detectable petroleum hydrocarbons.

### CONCLUSION

The soil conditions at these two sites do not require additional investigation according to the California Regional Water Quality Control Board (RWQCB), San Francisco Bay Region Guidelines. The UST's have been removed and disposed and the sample analytical reports reflect petroleum hydrocarbon concentrations at levels below the 100 ppm threshold level which requires soil excavation. A monitoring well will be required by RWQCB.

Mr. Michael Slessarev  
FABCO Automotive Corporation  
June 30, 1988  
Page 4

INTERNATIONAL TECHNOLOGY CORPORATION

This report concludes the steps necessary for Underground Storage Tank Permanent Closure. Please contact me at (415) 372-9100, if there are any questions.

Sincerely,



R. Dan Friberg  
Assistant Project Engineer



J. R. Mount  
Certified Engineering Geologist No. 1385

RDF:1s/LTR:3721

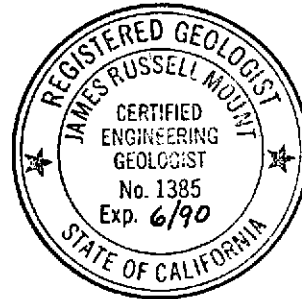

TABLE 1  
UNDERGROUND STORAGE TANK DATA

<u>No.</u>	<u>Volume (gal.)</u>	<u>Length</u>	<u>Diameter</u>	<u>Contents</u>	<u>Material</u>	<u>Inspection Results</u>
1	7,000	10'	6'Wx10'H	Cutting Oil	Concrete	N/A
2	1,000	4'	11'	Unleaded Gasoline	Steel	Sound condition

DRAWING NUMBER 190317-A1

CHECKED BY S/JZ  
APPROVED BY 6-23-88

DRAWN BY

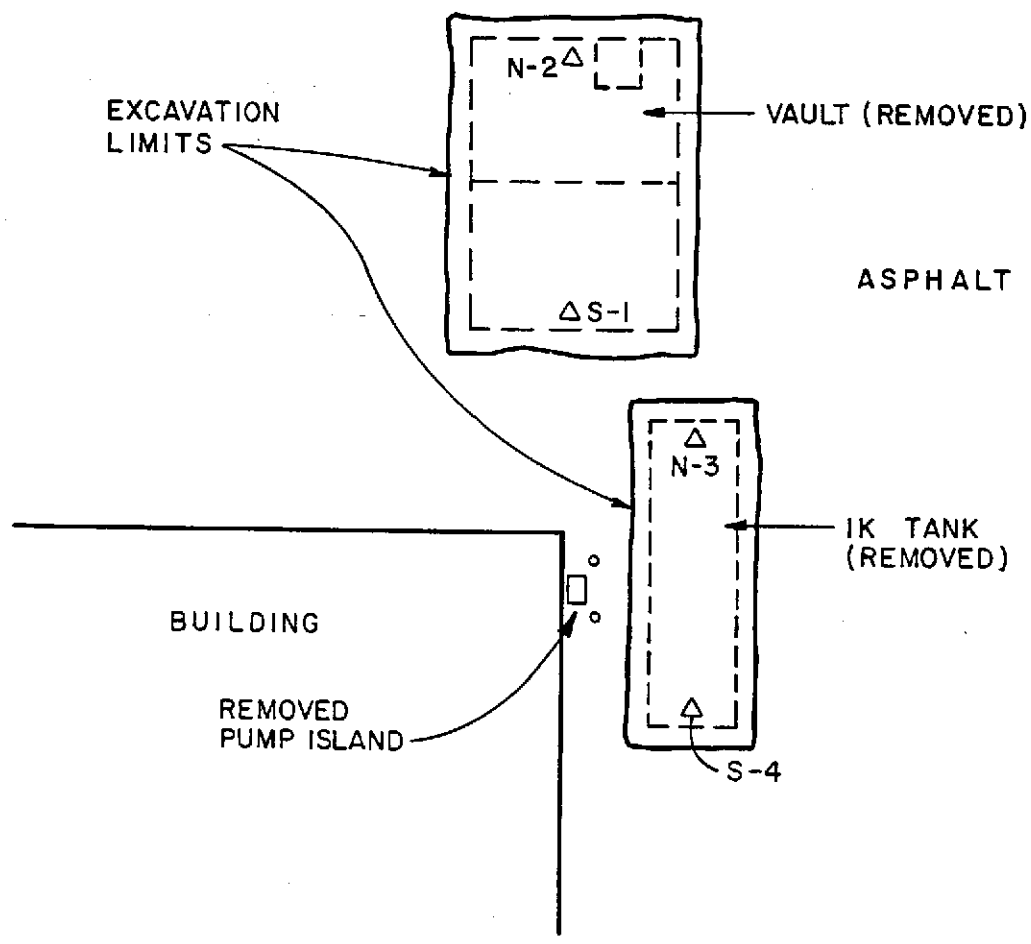

FIGURE 1  
SAMPLE LOCATION MAP

PREPARED FOR  
FABCO AUTOMOTIVE CORP.



7/16/88

**ALAMEDA COUNTY HEALTH CARE SERVICES AGENCY  
DEPARTMENT OF ENVIRONMENTAL HEALTH  
HAZARDOUS MATERIALS DIVISION**  
470 - 27TH ST., RM. 322  
OAKLAND, CA 94612  
PHONE NO. 415/874-7237

**DRAFT**

**ACCEPTED**  
DEPARTMENT OF ENVIRONMENTAL HEALTH  
470 - 27th Street, Third Floor  
Oakland, CA 94612  
Telephone: (415) 874-7237

These plans have been reviewed and found to be acceptable and essentially meet the requirements of State and local health laws. Changes to your plans indicated by this Department are to assure compliance with State and local laws. The project proposed herein is now released for issuance of any required building permits for construction. One copy of these accepted plans must be on the job and available to all contractors and craftsmen involved with the construction and installation. Any change or alteration of these plans and specifications must be submitted to this Department and to the Fire and Building Inspection Department to determine if such changes meet the requirements of State and local laws. Notify this Department at least 48 hours prior to the following required inspections: **PULL TANKS**

~~Permit and Pipework~~  
~~Fire Inspection~~  
Issuance of a permit to operate is dependent on compliance with accepted plans and all applicable regulations.

**THERE IS A FINANCIAL PENALTY FOR NOT OBTAINING THESE INSPECTIONS.**

*J. Lae*  
2/16/88

**RECEIVED**  
FEB 8 1988

**UNDERGROUND TANK CLOSURE/MODIFICATION PLANS**

1. Business Name Fabco Automotive Corporation  
Business Owner Truck Components, Inc.
2. Site Address 1249 67th Street  
City Oakland, California Zip 94608 Phone (415) 658-7070
3. Mailing Address 1249 67th Street  
City Oakland, California Zip 94608 Phone (415) 658-7070
4. Land Owner Fabco Automotive Corporation  
Address Oakland City, State California zip 94608
5. EPA I.D. No. CAD 981389398
6. Contractor International Technology Corporation  
Address 4585 Pacheco Boulevard  
City Martinez, California 94553 Phone (415) 372-9100  
License Type A, C33, C34, C61 - Exp. Oct. 31, 1988
7. Other (Specify) will be provided once determined  
Address \_\_\_\_\_  
City \_\_\_\_\_ Phone \_\_\_\_\_



**DRAFT**

8. Contact Person for Investigation

Name Michael Slessarev Title Sr. Manufacturing Engineer  
Phone (415) 658-7070

9. Total No. of Tanks at facility 2

10. Have permit applications for all tanks been submitted to this office?  
Yes [ ] No [ X ]

11. State Registered Hazardous Waste Transporters/Facilities

a) Product/Waste Tranporter

Name I.T. Transportation Corp. EPA I.D. No. 000058917  
Address 4501 Pacheco Boulevard  
City Martinez State CA Zip 94553

b) Rinsate Transporter

Name See (a) EPA I.D. No. \_\_\_\_\_  
Address \_\_\_\_\_  
City \_\_\_\_\_ State \_\_\_\_\_ Zip \_\_\_\_\_

c) Tank Transporter

Name See (a) or H&H Ship Service EPA I.D. No. CAD004771168  
Address 220 China Basin  
City San Francisco State CA Zip 94102

d) Contaminated Soil Transporter

Name See (a) EPA I.D. No. \_\_\_\_\_  
Address \_\_\_\_\_  
City \_\_\_\_\_ State \_\_\_\_\_ Zip \_\_\_\_\_

12. Sample Collector

Name \_\_\_\_\_  
Company I.T. Engineering  
Address 4585 Pacheco Boulevard  
City Martinez State CA Zip 95443 Phone (415) 372-9100

011

13. Sampling Information for each tank or area

Tank or Area		Material sampled	Location & Depth
Capacity	Historic Contents (past 5 years)		
NO SAMPLING HAS BEEN DONE TO DATE - SEE PLOT PLAN FOR LOCATIONS OF PREDISPOSAL SAMPLING SITES.			

14. Have tanks or pipes leaked in the past? Yes [ ] No [ ] Unknown

If yes, describe. \_\_\_\_\_

\_\_\_\_\_

15. NFPA methods used for rendering tank inert? Yes [x] No [ ]

If yes, describe. Both tanks will be fully evacuated. Gasoline tank will be rendered inert with Carbon Dioxide sublimated from dry ice.

\_\_\_\_\_

16. Laboratories

Name I.T. Corporation Vine Hill Laboratory

Address 896 Waterbird Way

City Martinez State CA Zip 94553

State Certification No. 138

17. Chemical Methods to be used for Analyzing Samples

**DRAFT**

Contaminant Sought	EPA, DHS, or Other Sample Preparation Method Number	EPA, DHS, or Other Analysis Number
AS PER REGIONAL WATER QUALITY CONTROL BOARD GUIDELINES, EXHIBIT (2). (ATTACHED)		

18. Site Safety Plan submitted? Yes  No

19. Workman's Compensation: Yes  No

Copy of Certificate enclosed? Yes  No

Name of Insurer (A) National Union Fire Insurance Company  
(B) Birmingham Fire

20. Plot Plan submitted? Yes  No

21. Deposit enclosed? Yes  No

22. Please forward to this office the following information within 60 days after receipt of sample results.

- a) Chain of Custody Sheets
- b) Original Signed Laboratory Reports
- c) TSD to Generator copies of wastes shipped and received
- d) Attachment A summarizing laboratory results

**DRAFT**

I declare that to the best of my knowledge and belief the statements and information provided above are correct and true. I understand that information in addition to that provided above may be needed in order to obtain an approval from the Department of Environmental Health and that no work is to begin on this project until this plan is approved.

I understand that any changes in design, materials or equipment will void this plan if prior approval is not obtained.

I will notify the Department of Environmental Health at least two (2) working days (48 hours) in advance to schedule any required inspections. I understand that site and worker safety are solely the responsibility of the property owner or his agent and that this responsibility is not shared nor assumed by the County of Alameda.

Signature of Contractor

Name (please type) Peter Merz

Signature 

Date 8 FEB 88

Signature of Site Owner or Operator

Name (please type) Mark A. Niemela

Signature 

Date 2-4-88

NOTES:

1. Any changes in this document must be approved by this Department.
2. Any leaks discovered must be submitted to this office on an underground storage tank unauthorized leak/contamination site report form within 5 days of its discovery.
3. Three (3) copies of this plan must be submitted to this Department. One copy must be at the construction site at all times.
4. A copy of your approved plan must be sent to the landowner.

**DRAFT**

**UNDERGROUND TANK CLOSURE/MODIFICATION PLANS**

**ATTACHMENT A  
SAMPLING RESULTS**

Tank or Area	Contaminant	Location & Depth	Results (specify units)



# REQUEST FOR ANALYSIS

R/A Control No. 031785C/C Control No. 031249

PROJECT NAME FABCO  
 PROJECT NUMBER 190317  
 PROJECT MANAGER PETA MARZ  
 BILL TO 4505 PACHECO - PC 3541  
MARTINEZ CAL 94553

DATE SAMPLES SHIPPED 3-1-88  
 LAB DESTINATION IT Santa Clara  
 LABORATORY CONTACT FRAD ROUSE  
 SEND LAB REPORT TO PETA MARZ / DAN FRIBOY  
4505 PACHECO  
MARTINEZ CAL 94553

PURCHASE ORDER NO. \_\_\_\_\_

DATE REPORT REQUIRED 3-14-88  
 PROJECT CONTACT DAN FRIBOY  
 PROJECT CONTACT PHONE NO. 415-372-9100

Sample No.	Sample Type	Sample Volume	Preservative	Requested Testing Program	Special Instructions
# 51	SOIL	2" X 6" TUBE	KEEP COOL	HBHC, D+B (503E), 8010, 8020 (BIX)	
# 12	"	"	"	" " " "	"
# 13	"	"	"	GAS/BTX (low boiling)	LEAD (7471)
# 54	"	"	"	" " "	" "

TURNAROUND TIME REQUIRED: (Rush must be approved by the Project Manager.)  
 Normal  Rush \_\_\_\_\_ (Subject to rush surcharge)

POSSIBLE HAZARD IDENTIFICATION: (Please indicate if sample(s) are hazardous materials and/or suspected to contain high levels of hazardous substances)  
 Nonhazard \_\_\_\_\_ Flammable \_\_\_\_\_ Skin Irritant \_\_\_\_\_ Highly Toxic \_\_\_\_\_ Other \_\_\_\_\_ (Please Specify)

SAMPLE DISPOSAL: (Please indicate disposition of sample following analysis. Lab will charge for packing, shipping, and disposal.)  
 Return to Client \_\_\_\_\_ Disposal by Lab

FOR LAB USE ONLY  
 Received By \_\_\_\_\_ Date/Time \_\_\_\_\_

WHITE - Original, to accompany samples  
 YELLOW - Field copy

**CHAIN-OF-CUSTODY RECORD**

 R/A Control No. 031785

 C/C Control No. 031249

 PROJECT NAME/NUMBER FABCO - 190317

 LAB DESTINATION IT SANTA CLARA

 SAMPLE TEAM MEMBERS Dan Friberg

CARRIER/WAYBILL NO. \_\_\_\_\_

Sample Number	Sample Location and Description	Date and Time Collected	Sample Type	Container Type	Condition on Receipt (Name and Date)	Disposal Record No.
# 51	South end vault excavation	2-24-88 1530	soil	BRASS TUBE		
# 12	north end vault excavation	2-24-88 1535	soil	"		
# 13	north end Tank excavation	2-25-88 1100	soil	"		
# 54	South end Tank excavation	2-25-88 1105	soil	"		

 Special Instructions: PLEASE call in results ASAP. Dan Friberg 415-372-9100

Possible Sample Hazards: \_\_\_\_\_

**SIGNATURES: (Name, Company, Date and Time)**

 1. Relinquished By: Dan Friberg IT corp 3-1-88 -1500

Received By: \_\_\_\_\_

2. Relinquished By: \_\_\_\_\_

Received By: \_\_\_\_\_

3. Relinquished By: \_\_\_\_\_

Received by: \_\_\_\_\_

4. Relinquished By: \_\_\_\_\_

Received By: \_\_\_\_\_



INTERNATIONAL  
TECHNOLOGY  
CORPORATION

DATE	0	2	2	5	8	8
TIME	1	1	3	0		
PAGE	1		OF 1			
PAGE						
PROJECT NO. 190317						

**SAMPLE COLLECTION LOG**

PROJECT NAME FABCO

SAMPLE NO. N-3

SAMPLE LOCATION NORTH END OF 1,000 GAL. TANK EXCAVATION

SAMPLE TYPE SOIL

COMPOSITE YES  NO

COMPOSITE TYPE       

DEPTH OF SAMPLE 9.0'

WEATHER SUNNY / COOL

CONTAINERS USED	AMOUNT COLLECTED
2x6" BEASTUBE	1602.

COMMENTS:

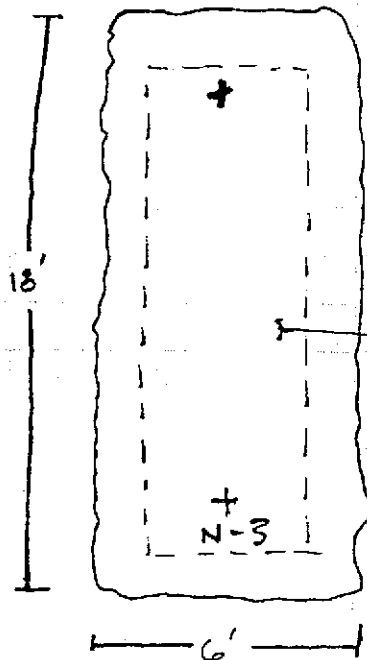
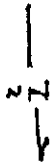

PREPARED BY: [Signature]





**INTERNATIONAL  
TECHNOLOGY  
CORPORATION**

DATE	0	2	2	5	8	8
TIME	1	1	4	5		
PAGE	1 OF 1					
PAGE						
PROJECT NO.	190317					

**SAMPLE COLLECTION LOG**

PROJECT NAME FABCO

SAMPLE NO. S-4

SAMPLE LOCATION SOUTH END OF 1,000 GAL. TANK EXCAVATION

SAMPLE TYPE SOIL

COMPOSITE YES  NO

COMPOSITE TYPE                     

DEPTH OF SAMPLE 9.0'

WEATHER SUNNY / COOL

CONTAINERS USED	AMOUNT COLLECTED
<u>2x6" BESS TUBE</u>	<u>16 OZ.</u>

COMMENTS:

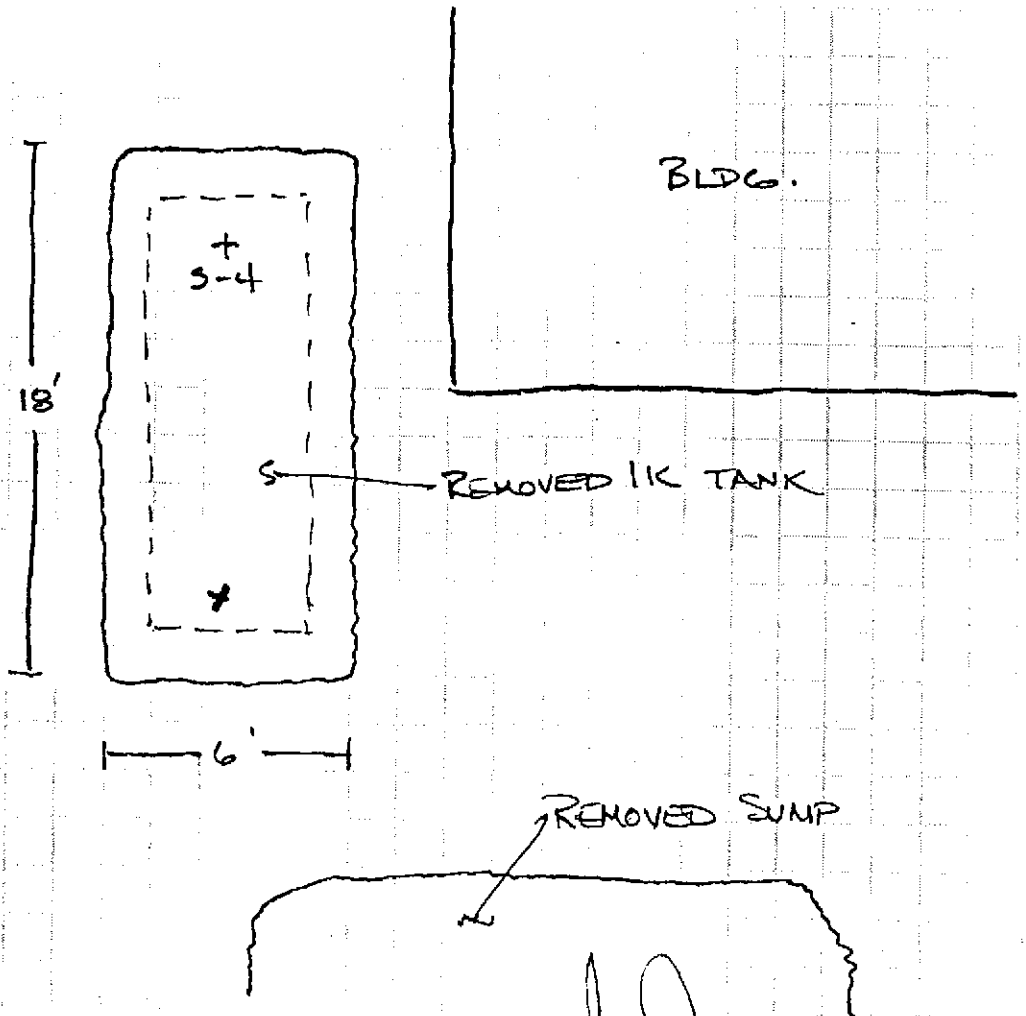

PREPARED BY: [Signature]



INTERNATIONAL  
TECHNOLOGY  
CORPORATION

DATE	0	2	2	4	8	8
TIME	1	5	3	0		
PAGE	1 OF 1					
PAGE						
PROJECT NO.	190317					

### SAMPLE COLLECTION LOG

PROJECT NAME FABCO

SAMPLE NO. A2, S1

SAMPLE LOCATION VAULT EXCAVATION

SAMPLE TYPE SOIL

COMPOSITE YES  NO

COMPOSITE TYPE —

DEPTH OF SAMPLE 18.0

WEATHER CLEAR - WARM

CONTAINERS USED	AMOUNT COLLECTED
<u>BRASS TUBES</u>	<u>2 - 2" x 6" TUBES</u>

COMMENTS:

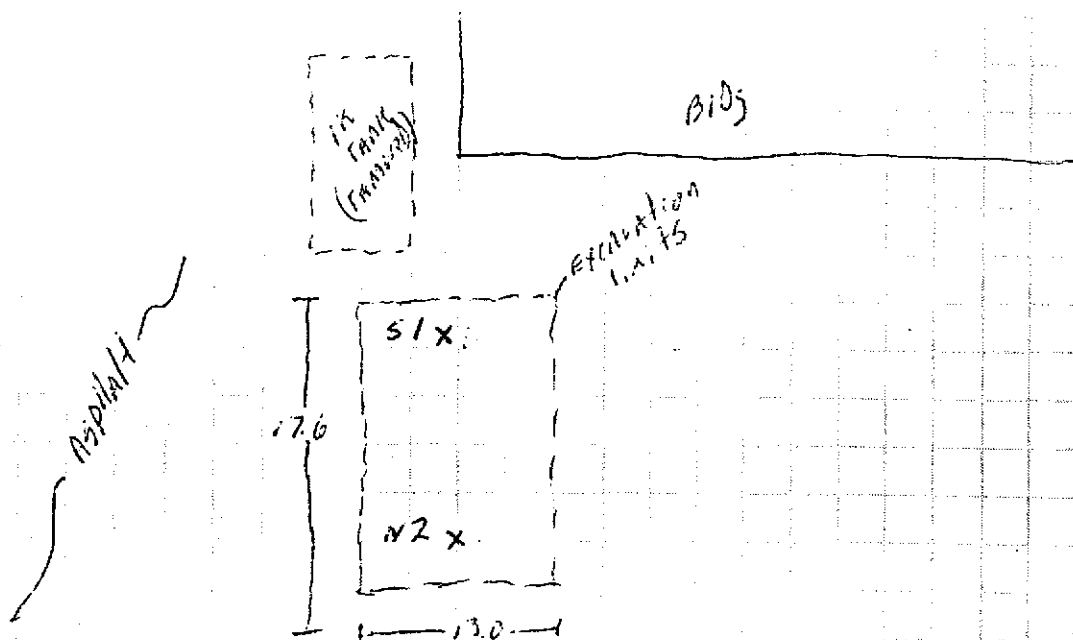

PREPARED BY: Dan Erbey

TABLE 2  
SUMMARY OF UST SOIL SAMPLE ANALYTICAL RESULTS\*

<u>UST Identification</u>	<u>Sample Number</u>	<u>Analysis; description</u>	<u>Detected (ppm)<sup>1</sup></u>	<u>Detection limit (ppm)<sup>1</sup></u>
Spent oil	S1	8010; halocarbons	ND <sup>2</sup>	.05
Spent oil	S1	8020; volatile aromatics	ND	.05
Spent oil	S1	High boiling hydrocarbons; diesel	ND	10
Spent oil	S1	High boiling hydrocarbons; oil	ND	10
Spent oil	S1	Standard Method 503-E; Total oil and grease	10	-
Spent oil	N2	8010; halocarbons	ND	.05
Spent oil	N2	8020; volatile aromatics	ND	.05
Spent oil	N2	High Boiling Hydrocarbons; diesel	ND	10
Spent oil	N2	High Boiling Hydrocarbons; oil	ND	10
Spent oil	N2	Standard Method 503-E; Total oil and grease	20	-
Gasoline	N3	Low Boiling Hydrocarbon; gasoline	ND	5
Gasoline	N3	Low Boiling Hydrocarbon; benzene	ND	.05
Gasoline	N3	Low Boiling Hydrocarbon; toluene	ND	.1
Gasoline	N3	Low Boiling Hydrocarbon; xylenes	ND	.4
Gasoline	N3	Low Boiling Hydrocarbon; ethyl benzene	ND	.4
Gasoline	S4	Low Boiling Hydrocarbon; gasoline	ND	5

TABLE 2 (continued)  
SUMMARY OF UST SOIL SAMPLE ANALYTICAL RESULTS\*

UST Identification	Sample Number	Analysis; description	Detected (ppm) <sup>1</sup>	Detection limit (ppm) <sup>1</sup>
Gasoline	S4	Low Boiling Hydrocarbon; benzene	ND	.05
Gasoline	S4	Low Boiling Hydrocarbon; toluene	ND	.1
Gasoline	S4	Low Boiling Hydrocarbon; xylenes	ND	.4
Gasoline	S4	Low Boiling Hydrocarbon; ethyl benzene	ND	.4

\*Reference Appendix D  
<sup>1</sup>Parts per million (ppm)  
<sup>2</sup>None detected (ND)



INTERNATIONAL  
TECHNOLOGY  
CORPORATION

IT Corporation  
4585 Pacheco Blvd.  
Martinez, CA 94553

March 18, 1988

ATTN: Dan Friberg

Following are the results of analyses on the samples described below.

Project: 190317, FABCO  
Lab Numbers: S8-03-031-01 thru S8-03-031-04  
Number of Samples: 4  
Sample Type: Soil  
Date Received: 3/2/88  
Analyses Requested: Low Boiling Hydrocarbons,  
High Boiling Hydrocarbons, Oil & Grease,  
Volatile Halocarbons, Volatile Aromatics

The method of analysis for low boiling hydrocarbons is taken from EPA Methods 8015, 8020 and 5030. The sample is examined using the purge and trap technique. Final detection is by gas chromatography using a flame ionization detector as well as a photoionization detector.

The result for total low boiling hydrocarbons is calculated as gasoline and includes benzene, toluene, ethyl benzene and xylenes.

The method of analysis for high boiling hydrocarbons in soil involves extracting the sample with acetone. The mixture is partitioned with hexane and the resulting extract is examined by gas chromatography using a flame ionization detector.

The method of analysis for oil and grease in soil is taken from EPA Method 3550 and Standard Methods Section 503E. The sample is extracted with repeated portions of 50:50 methylene chloride:acetone using a horn-type sonicator. The extract is dried with sodium sulfate and treated with silica gel to remove polar compounds. Following evaporation, oil and grease is determined gravimetrically.

I. T. CORPORATION  
MAR 21 1988  
MARTINEZ ENGINEERING

IT/Santa Clara to IT/Martinez  
ATTN: Dan Friberg

March 18, 1988  
Page 2

The method of analysis for volatile halocarbons in soils is taken from E.P.A. Methods 8010 and 5030. The samples are examined using the purge and trap technique. Final detection is by gas chromatography using an electrolytic conductivity detector.

The method of analysis for volatile aromatics in soils is taken from E.P.A. Methods 8020 and 5030. The samples are examined using the purge and trap technique. Final detection is by gas chromatography using a photoionization detector as well as a flame ionization detector.

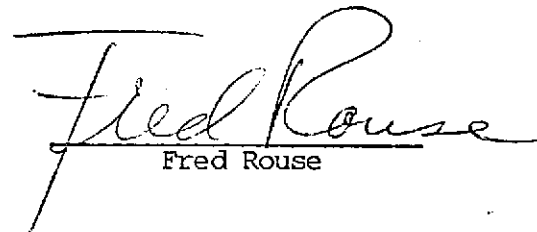
  
Fred Rouse

FR/gg

5 Pages Following - Tables of Results

IT/Santa Clara to IT/Martinez  
 ATTN: Dan Friberg

March 18, 1988  
 Page 1 of 5

Report of Analysis - Volatile Halocarbons and Volatile Aromatics

Project: 190317, FABCO

Sample Code: sl

Method: Modified E.P.A.  
 8010, 8020, 5030

Lab Number: S8-03-031-01

Sample Date: 2/24/88

Results  
 Parts per Million  
 (dry soil basis)

Extraction Date: 3/3/88

Compound Name	Detected	Detection Limit
Bromodichloromethane	None	0.05
Bromoform	None	0.05
Bromomethane	None	0.05
Carbon Tetrachloride	None	0.05
Chlorobenzene	None	0.05
Chloroethane	None	0.05
2-Chloroethylvinyl ether	None	0.05
Chloroform	None	0.05
Chloromethane	None	0.05
Dibromochloromethane	None	0.05
1,2-Dichlorobenzene	None	0.05
1,3-Dichlorobenzene	None	0.05
1,4-Dichlorobenzene	None	0.05
Dichlorodifluoromethane	None	0.05
1,1-Dichloroethane	None	0.05
1,2-Dichloroethane	None	0.05
1,1-Dichloroethene	None	0.05
cis-1,2-Dichloroethene	None	0.05
trans-1,2-Dichloroethene	None	0.05
1,2-Dichloropropane	None	0.05
cis-1,3-Dichloropropene	None	0.05
trans-1,3-Dichloropropene	None	0.05
Methylene Chloride	None	0.05
1,1,2,2,-Tetrachloroethane	None	0.05
Tetrachloroethene	None	0.05
1,1,1-Trichloroethane	None	0.05
1,1,2-Trichloroethane	None	0.05
Trichloroethene	None	0.05
Trichlorofluoromethane	None	0.05
1,1,2-Trichlorotrifluoroethane	None	0.05
Vinyl Chloride	None	0.05
Benzene	None	0.05
Toluene	None	0.05
Ethyl Benzene	None	0.05
Xylenes	None	0.2

IT/Santa Clara to IT/Martinez  
 ATTN: Dan Friberg

March 18, 1988  
 Page 2 of 5

Lab Number: S8-03-031-01  
 Sample Identification: sl  
 Project: 190317, FABCO

Results

Total Petroleum Hydrocarbons	Parts per Million - dry soil basis			
	Detected	Detection Limit	Identity	Calculated as
High Boiling Hydrocarbons	None	10.	Diesel	--
High Boiling Hydrocarbons	None	10.	Oil	--
Oil and Grease	10.	10.	.....Not Applicable.....	



IT/Santa Clara to IT/Martinez  
ATTN: Dan Friberg

March 18, 1988  
Page 3 of 5

Report of Analysis - Volatile Halocarbons and Volatile Aromatics

Project: 190317, FABCO

Method: Modified E.P.A.  
8010, 8020, 5030

Sample Code: n2

Lab Number: S8-03-031-02

Sample Date: 2/24/88

Results  
Parts per Million  
(dry soil basis)

Extraction Date: 3/3/88

Compound Name	Detected	Detection Limit
Bromodichloromethane	None	0.05
Bromoform	None	0.05
Bromomethane	None	0.05
Carbon Tetrachloride	None	0.05
Chlorobenzene	None	0.05
Chloroethane	None	0.05
2-Chloroethylvinyl ether	None	0.05
Chloroform	None	0.05
Chloromethane	None	0.05
Dibromochloromethane	None	0.05
1,2-Dichlorobenzene	None	0.05
1,3-Dichlorobenzene	None	0.05
1,4-Dichlorobenzene	None	0.05
Dichlorodifluoromethane	None	0.05
1,1-Dichloroethane	None	0.05
1,2-Dichloroethane	None	0.05
1,1-Dichloroethene	None	0.05
cis-1,2-Dichloroethene	None	0.05
trans-1,2-Dichloroethene	None	0.05
1,2-Dichloropropane	None	0.05
cis-1,3-Dichloropropene	None	0.05
trans-1,3-Dichloropropene	None	0.05
Methylene Chloride	None	0.05
1,1,2,2,-Tetrachloroethane	None	0.05
Tetrachloroethene	None	0.05
1,1,1-Trichloroethane	None	0.05
1,1,2-Trichloroethane	None	0.05
Trichloroethene	None	0.05
Trichlorofluoromethane	None	0.05
1,1,2-Trichlorotrifluoroethane	None	0.05
Vinyl Chloride	None	0.05
Benzene	None	0.05
Toluene	None	0.05
Ethyl Benzene	None	0.05
Xylenes	None	0.2

IT/Santa Clara to IT/Martinez  
 ATIN: Dan Friberg

March 18, 1988  
 Page 4 of 5

Lab Number: S8-03-031-02  
 Sample Identification: n2  
 Project: 190317, FABCO

Results

Total Petroleum Hydrocarbons	Parts per Million - dry soil basis			
	Detected	Detection Limit	Identity	Calculated as
High Boiling Hydrocarbons	None	10.	Diesel	---
High Boiling Hydrocarbons	None	10.	Oil	---
Oil and Grease	20.	10.	.....Not Applicable.....	

IT/Santa Clara to IT/Martinez  
ATTN: Dan Friberg

March 18, 1988  
Page 5 of 5

## Summary of Results

Project: 190317, FABCO

ND = None Detected

Lab Number	Sample Identification	Parts per Million - dry soil basis			
		Low Boiling Hydrocarbons (Gasoline)	Benzene	Toluene	Ethyl benzene and xylenes
S8-03-031-03	n3	ND	ND	ND	ND
S8-03-031-04	s4	ND	ND	ND	ND
Detection Limit		5.	0.05	0.1	0.4

# UNDERGROUND STORAGE TANK UNAUTHORIZED RELEASE (LEAK)/CONTAMINATION SITE REPORT

EMERGENCY <input type="checkbox"/> YES <input checked="" type="checkbox"/> NO	HAS STATE OFFICE OF EMERGENCY SERVICES REPORT BEEN FILED? <input type="checkbox"/> YES <input type="checkbox"/> NO	STATE TANK ID # _____
--	--	-----------------------

REPORT DATE 01   3   0   3   8   8	LOCAL CASE # _____	REGIONAL BOARD CASE # _____	US EPA ID # _____
---------------------------------------	--------------------	-----------------------------	-------------------

REPORTED BY	NAME OF INDIVIDUAL FILING REPORT Mike Slessarev	PHONE (415) 658-7070	SIGNATURE _____	
	REPRESENTING <input type="checkbox"/> LOCAL AGENCY <input type="checkbox"/> OTHER <input checked="" type="checkbox"/> OWNER/OPERATOR <input type="checkbox"/> REGIONAL BOARD	COMPANY OR AGENCY NAME FABCO Automotive Corporation		
	ADDRESS 1249 67th Street STREET			

RESPONSIBLE PARTY	NAME FABCO Automotive Corporation <input type="checkbox"/> UNKNOWN	CONTACT PERSON Mike Slessarev	PHONE (415) 658-7070
	ADDRESS 1249 67th Street STREET		

SITE LOCATION	FACILITY NAME (IF APPLICABLE) FABCO Automotive Corporation	OPERATOR FABCO	PHONE (415) 658-7070	
	ADDRESS 1249 67th Street STREET			
	CROSS STREET _____			

IMPLEMENTING AGENCIES	LOCAL AGENCY AGENCY NAME Alameda County Health Department	CONTACT PERSON Liz Rose	PHONE (415) 874-7237	
	REGIONAL BOARD _____			
	TSCD _____			

SUBSTANCES INVOLVED	CAS # (ATTACH EXTRA SHEET IF NEEDED) NAME (1) _____ Cutting oils	QUANTITY LOST (GALLONS) <input checked="" type="checkbox"/> UNKNOWN
	(2) _____	

DISCOVERY/ABATEMENT	DATE DISCOVERED 01   3   0   3   8   8	HOW DISCOVERED <input type="checkbox"/> INVENTORY CONTROL <input type="checkbox"/> SUBSURFACE MONITORING <input type="checkbox"/> ROUTINE MONITORING <input checked="" type="checkbox"/> TANK REMOVAL <input type="checkbox"/> NUISANCE CONDITIONS <input type="checkbox"/> OTHER: _____
	DATE DISCHARGE BEGAN M   M   D   D   Y   Y <input checked="" type="checkbox"/> UNKNOWN	
	HAS DISCHARGE BEEN STOPPED? <input checked="" type="checkbox"/> YES <input type="checkbox"/> NO IF YES, DATE 01   3   0   3   8   8	

SOURCE/CAUSE	SOURCE(S) OF DISCHARGE <input type="checkbox"/> TANK LEAK <input checked="" type="checkbox"/> UNKNOWN	TANKS ONLY/CAPACITY 4,000 GAL AGE _____ YRS. <input checked="" type="checkbox"/> UNKNOWN	CAUSE(S) <input type="checkbox"/> OVERFILL <input type="checkbox"/> CORROSION
	<input type="checkbox"/> PIPING LEAK	MATERIAL <input type="checkbox"/> STEEL <input type="checkbox"/> FIBERGLASS	<input type="checkbox"/> RUPTURE/FAILURE <input type="checkbox"/> SPILL
	<input type="checkbox"/> OTHER (SPECIFY) _____	<input checked="" type="checkbox"/> OTHER concrete	<input checked="" type="checkbox"/> UNKNOWN <input type="checkbox"/> OTHER _____

RESOURCES AFFECTED/AT RISK	RESOURCES AFFECTED	WATER SUPPLIES AFFECTED																																																																							
	<table border="1" style="width: 100%; border-collapse: collapse;"> <tr> <th></th> <th>YES</th> <th>NO</th> <th>THREATENED</th> <th>UNKNOWN</th> </tr> <tr> <td>AIR (VAPOR)</td> <td><input type="checkbox"/></td> <td><input checked="" type="checkbox"/></td> <td><input type="checkbox"/></td> <td><input type="checkbox"/></td> </tr> <tr> <td>SOIL (VADOSE ZONE)</td> <td><input type="checkbox"/></td> <td><input type="checkbox"/></td> <td><input type="checkbox"/></td> <td><input checked="" type="checkbox"/></td> </tr> <tr> <td>GROUNDWATER</td> <td><input type="checkbox"/></td> <td><input type="checkbox"/></td> <td><input type="checkbox"/></td> <td><input checked="" type="checkbox"/></td> </tr> <tr> <td>SURFACE WATER OR STORM DRAIN</td> <td><input type="checkbox"/></td> <td><input checked="" type="checkbox"/></td> <td><input type="checkbox"/></td> <td><input type="checkbox"/></td> </tr> <tr> <td>BUILDING OR UTILITY VAULT</td> <td><input type="checkbox"/></td> <td><input checked="" type="checkbox"/></td> <td><input type="checkbox"/></td> <td><input type="checkbox"/></td> </tr> <tr> <td>OTHER (SPECIFY)</td> <td><input type="checkbox"/></td> <td><input checked="" type="checkbox"/></td> <td><input type="checkbox"/></td> <td><input type="checkbox"/></td> </tr> </table>		YES	NO	THREATENED	UNKNOWN	AIR (VAPOR)	<input type="checkbox"/>	<input checked="" type="checkbox"/>	<input type="checkbox"/>	<input type="checkbox"/>	SOIL (VADOSE ZONE)	<input type="checkbox"/>	<input type="checkbox"/>	<input type="checkbox"/>	<input checked="" type="checkbox"/>	GROUNDWATER	<input type="checkbox"/>	<input type="checkbox"/>	<input type="checkbox"/>	<input checked="" type="checkbox"/>	SURFACE WATER OR STORM DRAIN	<input type="checkbox"/>	<input checked="" type="checkbox"/>	<input type="checkbox"/>	<input type="checkbox"/>	BUILDING OR UTILITY VAULT	<input type="checkbox"/>	<input checked="" type="checkbox"/>	<input type="checkbox"/>	<input type="checkbox"/>	OTHER (SPECIFY)	<input type="checkbox"/>	<input checked="" type="checkbox"/>	<input type="checkbox"/>	<input type="checkbox"/>	<table border="1" style="width: 100%; border-collapse: collapse;"> <tr> <th></th> <th>YES</th> <th>NO</th> <th>THREATENED</th> <th>UN- KNOWN</th> <th># OF WELLS</th> </tr> <tr> <td>PUBLIC DRINKING WATER</td> <td><input type="checkbox"/></td> <td><input checked="" type="checkbox"/></td> <td><input type="checkbox"/></td> <td><input type="checkbox"/></td> <td>_____</td> </tr> <tr> <td>PRIVATE DRINKING WATER</td> <td><input type="checkbox"/></td> <td><input checked="" type="checkbox"/></td> <td><input type="checkbox"/></td> <td><input type="checkbox"/></td> <td>_____</td> </tr> <tr> <td>INDUSTRIAL</td> <td><input type="checkbox"/></td> <td><input checked="" type="checkbox"/></td> <td><input type="checkbox"/></td> <td><input type="checkbox"/></td> <td>_____</td> </tr> <tr> <td>AGRICULTURAL</td> <td><input type="checkbox"/></td> <td><input checked="" type="checkbox"/></td> <td><input type="checkbox"/></td> <td><input type="checkbox"/></td> <td>_____</td> </tr> <tr> <td>OTHER (SPECIFY)</td> <td><input type="checkbox"/></td> <td><input checked="" type="checkbox"/></td> <td><input type="checkbox"/></td> <td><input type="checkbox"/></td> <td>_____</td> </tr> </table>		YES	NO	THREATENED	UN- KNOWN	# OF WELLS	PUBLIC DRINKING WATER	<input type="checkbox"/>	<input checked="" type="checkbox"/>	<input type="checkbox"/>	<input type="checkbox"/>	_____	PRIVATE DRINKING WATER	<input type="checkbox"/>	<input checked="" type="checkbox"/>	<input type="checkbox"/>	<input type="checkbox"/>	_____	INDUSTRIAL	<input type="checkbox"/>	<input checked="" type="checkbox"/>	<input type="checkbox"/>	<input type="checkbox"/>	_____	AGRICULTURAL	<input type="checkbox"/>	<input checked="" type="checkbox"/>	<input type="checkbox"/>	<input type="checkbox"/>	_____	OTHER (SPECIFY)	<input type="checkbox"/>	<input checked="" type="checkbox"/>	<input type="checkbox"/>	<input type="checkbox"/>	_____
		YES	NO	THREATENED	UNKNOWN																																																																				
AIR (VAPOR)	<input type="checkbox"/>	<input checked="" type="checkbox"/>	<input type="checkbox"/>	<input type="checkbox"/>																																																																					
SOIL (VADOSE ZONE)	<input type="checkbox"/>	<input type="checkbox"/>	<input type="checkbox"/>	<input checked="" type="checkbox"/>																																																																					
GROUNDWATER	<input type="checkbox"/>	<input type="checkbox"/>	<input type="checkbox"/>	<input checked="" type="checkbox"/>																																																																					
SURFACE WATER OR STORM DRAIN	<input type="checkbox"/>	<input checked="" type="checkbox"/>	<input type="checkbox"/>	<input type="checkbox"/>																																																																					
BUILDING OR UTILITY VAULT	<input type="checkbox"/>	<input checked="" type="checkbox"/>	<input type="checkbox"/>	<input type="checkbox"/>																																																																					
OTHER (SPECIFY)	<input type="checkbox"/>	<input checked="" type="checkbox"/>	<input type="checkbox"/>	<input type="checkbox"/>																																																																					
	YES	NO	THREATENED	UN- KNOWN	# OF WELLS																																																																				
PUBLIC DRINKING WATER	<input type="checkbox"/>	<input checked="" type="checkbox"/>	<input type="checkbox"/>	<input type="checkbox"/>	_____																																																																				
PRIVATE DRINKING WATER	<input type="checkbox"/>	<input checked="" type="checkbox"/>	<input type="checkbox"/>	<input type="checkbox"/>	_____																																																																				
INDUSTRIAL	<input type="checkbox"/>	<input checked="" type="checkbox"/>	<input type="checkbox"/>	<input type="checkbox"/>	_____																																																																				
AGRICULTURAL	<input type="checkbox"/>	<input checked="" type="checkbox"/>	<input type="checkbox"/>	<input type="checkbox"/>	_____																																																																				
OTHER (SPECIFY)	<input type="checkbox"/>	<input checked="" type="checkbox"/>	<input type="checkbox"/>	<input type="checkbox"/>	_____																																																																				
GROUNDWATER BASIN NAME <input checked="" type="checkbox"/> UNKNOWN																																																																									

COMMENTS	COMMENTS: _____
----------	--------------------

**UNIFORM HAZARDOUS WASTE MANIFEST**

1. Generator's US EPA ID No. **CA1D1018113189131918** Manifest Document No. **314171818**

2. Page 1 of Information in the shaded areas is not required by Federal law.

3. Generator's Name and Mailing Address  
**Fabco Automotive Corporation**  
**1249 67th St., Oakland, CA 94608**  
 4. Generator's Phone **(415) 65897070**

A. State Manifest Document Number  
**87434738**

B. State Generator's ID  
**HS1H1013161011815112**

5. Transporter 1 Company Name  
**H & H Ship Service** 6. US EPA ID Number  
**CA1D1010477111618**

C. State Transporter's ID  
**902465**

7. Transporter 2 Company Name 8. US EPA ID Number

D. Transporter's Phone **(415) 543-4835**

9. Designated Facility Name and Site Address  
**H & H Ship Service**  
**220 China Basin St.**  
**San Francisco, CA 94107** 10. US EPA ID Number  
**CA1D1010477111618**

E. State Transporter's ID

F. Transporter's Phone

G. State Facility's ID

H. Facility's Phone

11. US DOT Description (Including Proper Shipping Name, Hazard Class, and ID Number)

12. Containers No. Type 13. Total Quantity 14. Unit Wt/Vol 15. Waste No.

a. **Empty Gasoline Tank, Wasted Flammable Liquid UN 1203 (Inerted)**

**0101** **11** **010001** **6AL** **512**

b.

State EPA/Other

c.

State EPA/Other

d.

State EPA/Other

J. Additional Descriptions for Materials Listed Above

K. Handling Codes for Wastes Listed Above

**Empty underground gasoline storage tank with less than 1 gallon residual liquid**

a. **512** b. c. d.

15. Special Handling Instructions and Additional Information

16. **GENERATOR'S CERTIFICATION:** I hereby declare that the contents of this consignment are fully and accurately described above by proper shipping name and are classified, packed, marked, and labeled, and are in all respects in proper condition for transport by highway according to applicable international and national government regulations.  
 If I am a large quantity generator, I certify that I have a program in place to reduce the volume and toxicity of waste generated to the degree I have determined to be economically practicable and that I have selected the practicable method of treatment, storage, or disposal currently available to me which minimizes the present and future threat to human health and the environment; OR, if I am a small quantity generator, I have made a good faith effort to minimize my waste generation and select the best waste management method that is available to me and that I can afford.

Printed/Typed Name  
**Michael Slassarav**

Signature *Michael Slassarav* Month Day Year **10/21/18**

17. Transporter 1 Acknowledgement of Receipt of Materials  
 Printed/Typed Name  
**EDWARD G MILANO**

Signature *Edward G Milano* Month Day Year **10/21/18**

18. Transporter 2 Acknowledgement of Receipt of Materials  
 Printed/Typed Name

Signature Month Day Year

19. Discrepancy Indication Space

20. Facility Owner or Operator Certification of receipt of hazardous materials covered by this manifest except as noted in Item 19.  
 Printed/Typed Name Signature Month Day Year

IN CASE OF AN EMERGENCY OR SPILL, CALL THE NATIONAL RESPONSE CENTER 1-800-424-8802; WITHIN CALIFORNIA CALL 1-800-852-7550

GENERATOR

TRANSPORTER

FACILITY

**UNIFORM HAZARDOUS WASTE MANIFEST**

1. Generator's US EPA ID No. **CAD971389393** Manifest Document No. **07/1P11**

2. Page 1 of Information in the shaded areas is not required by Federal law.

3. Generator's Name and Mailing Address  
**Fabco Automotive Corporation**  
**P. O. Box 8276, Oakland, California 94662**  
 4. Generator's Phone **(415) 558-7070**

A. State Manifest Document Number  
**87087151**

B. State Generator's ID  
**HSH03618542**

5. Transporter 1 Company Name  
**I T Corp.** 6. US EPA ID Number  
**ICIAID01010153907**

C. State Transporter's ID  
**301601**

7. Transporter 2 Company Name 8. US EPA ID Number

D. Transporter's Phone  
**909 372 2000**

9. Designated Facility Name and Site Address  
**Casmalia Disposal Site**  
**NTU Road**  
**Casmalia, California 93429** 10. US EPA ID Number  
**ICIAID0121017143126**

E. State Transporter's ID

F. Transporter's Phone

G. State Facility's ID  
**CAD020748125**

H. Facility's Phone  
**805 328-4826**

11. US DOT Description (Including Proper Shipping Name, Hazard Class, and ID Number)

12. Containers No. Type 13. Total Quantity 14. Unit Wt/Vol I. Waste No.

a. **Hazardous Waste Solids**  
**9189 ORM-E NOS**

**0,0,1 CM 0,0,0,1,2 Y D** State **491**  
 EPA/Other

b.

State  
 EPA/Other

c.

State  
 EPA/Other

d.

State  
 EPA/Other

J. Additional Descriptions for Materials Listed Above  
**Sump Sludge**  
**Job # 190317**

K. Handling Codes for Wastes Listed Above  
 a. b.  
 c. d.

15. Special Handling Instructions and Additional Information

16. **GENERATOR'S CERTIFICATION:** I hereby declare that the contents of this consignment are fully and accurately described above by proper shipping name and are classified, packed, marked, and labeled, and are in all respects in proper condition for transport by highway according to applicable international and national government regulations.  
 If I am a large quantity generator, I certify that I have a program in place to reduce the volume and toxicity of waste generated to the degree I have determined to be economically practicable and that I have selected the practicable method of treatment, storage, or disposal currently available to me which minimizes the present and future threat to human health and the environment; OR, if I am a small quantity generator, I have made a good faith effort to minimize my waste generation and select the best waste management method that is available to me and that I can afford.

Printed/Typed Name  
**Michael Slessarev**

Signature  
 Month Day Year  
**0 2 29 8 3**

17. Transporter 1 Acknowledgement of Receipt of Materials  
 Printed/Typed Name  
**Frank...**

Signature  
 Month Day Year

18. Transporter 2 Acknowledgement of Receipt of Materials  
 Printed/Typed Name

Signature  
 Month Day Year

19. Discrepancy Indication Space

20. Facility Owner or Operator Certification of receipt of hazardous materials covered by this manifest except as noted in item 19.  
 Printed/Typed Name

Signature  
 Month Day Year

IN CASE OF AN EMERGENCY OR SPILL, CALL THE NATIONAL RESPONSE CENTER 1-800-424-8802; WITHIN CALIFORNIA CALL 1-800-852-7550  
 GENERATOR  
 TRANSPORTER  
 FACILITY

**87087151**

IN CASE OF AN EMERGENCY OR SPILL, CALL THE NATIONAL RESPONSE CENTER 1-800-424-8802; WITHIN CALIFORNIA CALL 1-800-852-7550

<b>UNIFORM HAZARDOUS WASTE MANIFEST</b>		1. Generator's US EPA ID No. C I A I D 19 18 11 13 18 19 13 19 18 9 12 11 13 16			Manifest Document No.		2. Page 1 of		Information in the shaded areas is not required by Federal law.	
		3. Generator's Name and Mailing Address Fabco Automotive Corporation 1249 67th Street, Oakland, California 94662			6. US EPA ID Number		A. State Manifest Document Number <b>87992136</b>			
4. Generator's Phone ( 415 658-7070			7. Transporter 1 Company Name <b>IT TRANSPORTATION AND LOGISTICS</b>			8. US EPA ID Number		C. State Transporter's ID <b>801598</b>		
5. Transporter 2 Company Name			7. Transporter 2 Company Name			8. US EPA ID Number		D. Transporter's Phone <b>415-372-9100</b>		
9. Designated Facility Name and Site Address PWI Lokern Road, Buttonwillow California			10. US EPA ID Number C I A I D 19 18 10 16 17 15 12 17 16			E. State Transporter's ID		F. Transporter's Phone		
11. US DOT Description (Including Proper Shipping Name, Hazard Class, and ID Number)			12. Containers		13. Total Quantity		14. Unit Wt/Vol		1. Waste No.	
a. Soil with Petroleum Hydrocarbon (California Regulated)			No. Type		Quantity		Unit Wt/Vol		State 611 EPA/Other Exempt	
b.			001 BIT		1 1 1 1 1 8		yds		State	
c.									EPA/Other	
d.									State	
									EPA/Other	
J. Additional Descriptions for Materials Listed Above Cutting Oil contaminated soil - 100% Solids						K. Handling Codes for Wastes Listed Above a. 03 b. c. d.				
15. Special Handling Instructions and Additional Information Wear Protective Clothing. PWI waste stream # M216. PWI to invoice ITE-MTZ for Disposal. <span style="float: right;">Project #190317</span>										
16. GENERATOR'S CERTIFICATION: I hereby declare that the contents of this consignment are fully and accurately described above by proper shipping name and are classified, packed, marked, and labeled, and are in all respects in proper condition for transport by highway according to applicable international and national government regulations. If I am a large quantity generator, I certify that I have a program in place to reduce the volume and toxicity of waste generated to the degree I have determined to be economically practicable and that I have selected the practicable method of treatment, storage, or disposal currently available to me which minimizes the present and future threat to human health and the environment; OR, if I am a small quantity generator, I have made a good faith effort to minimize my waste generation and select the best waste management method that is available to me and that I can afford.										
17. Transporter 1 Acknowledgement of Receipt of Materials				Signature <i>Michael Stessure</i>				Month Day Year 03/24/88		
18. Transporter 2 Acknowledgement of Receipt of Materials				Signature <i>Roy L. Olson</i>				Month Day Year 10/31/24/88		
19. Discrepancy Indication Space				Signature <i>Hector L. Morcnd</i>				Month Day Year 10/31/24/88		
20. Facility Owner or Operator Certification of receipt of hazardous materials covered by this manifest except as noted in Item 19.										
Printed/Typed Name <i>Hector L. Morcnd</i>				Signature <i>Hector L. Morcnd</i>				Month Day Year 10/31/24/88		

**UNIFORM HAZARDOUS WASTE MANIFEST**

1. Generator's US EPA ID No. **CA1D19181131819131918** Manifest Document No. **9211317**

2. Page 1 of Information in the shaded areas is not required by Federal law.

3. Generator's Name and Mailing Address  
**FABCO AUTOMOTIVE CORPORATION**  
**1249 67th Street**  
**Oakland, California 94662**

A. State Manifest Document Number  
**87992137**

4. Generator's Phone **415 658 7070**

B. State Generator's ID  
**HSHQ13161011815142**

5. Transporter 1 Company Name  
**E.T. TRANSPORTATION** 6. US EPA ID Number  
**CA1D1000058917**

C. State Transporter's ID  
**801608**

7. Transporter 2 Company Name 8. US EPA ID Number

D. Transporter's Phone **415-372-9100**  
 E. State Transporter's ID

9. Designated Facility Name and Site Address  
**PWI**  
**Lokern Road**  
**Buttonwillow, Calif.** 10. US EPA ID Number  
**CA1D191810161715121716**

F. Transporter's Phone

G. State Facility's ID  
**CA1D191810161715121716**  
 H. Facility's Phone  
**(805) 325-5355 762-7341**

11. US DOT Description (Including Proper Shipping Name, Hazard Class, and ID Number)	12. Containers No.	13. Total Quantity	14. Unit Wt/Vol	15. Waste No.	
				State	EPA/Other
a. Soil with Petroleum Hydrocarbon (California Regulated)	01011	00018	YD	State 611	EPA/Other Exempt N/A
b.				State	EPA/Other
c.				State	EPA/Other
d.				State	EPA/Other

J. Additional Descriptions for Materials Listed Above  
**Cutting oil contaminated soil - 100% Solids**

K. Handling Codes for Wastes Listed Above  
 a. **03**  
 b.  
 c.  
 d.

15. Special Handling Instructions and Additional Information  
**Wear Protective Clothing. PWI waste Stream #M216. PWI to invoice ITE-MTZ For disposal.** Project # 190317

16. GENERATOR'S CERTIFICATION: I hereby declare that the contents of this consignment are fully and accurately described above by proper shipping name and are classified, packed, marked, and labeled, and are in all respects in proper condition for transport by highway according to applicable international and national government regulations.  
 If I am a large quantity generator, I certify that I have a program in place to reduce the volume and toxicity of waste generated to the degree I have determined to be economically practicable and that I have selected the practicable method of treatment, storage, or disposal currently available to me which minimizes the present and future threat to human health and the environment; OR, if I am a small quantity generator, I have made a good faith effort to minimize my waste generation and select the best waste management method that is available to me and that I can afford.

Printed/Typed Name **Michael Stessner** Signature *Michael Stessner* Month Day Year **12/24/88**

17. Transporter 1 Acknowledgement of Receipt of Materials  
 Printed/Typed Name **BILL PRATT** Signature *Bill Pratt* Month Day Year **10/31/88**

18. Transporter 2 Acknowledgement of Receipt of Materials  
 Printed/Typed Name Signature Month Day Year

19. Discrepancy Indication Space

20. Facility Owner or Operator Certification of receipt of hazardous materials covered by this manifest except as noted in Item 19.  
 Printed/Typed Name **HILARIO CAVAZOS** Signature *Hilario Cavazos* Month Day Year **10/31/88**

IN CASE OF AN EMERGENCY OR SPILL, CALL THE NATIONAL RESPONSE CENTER 1-800-424-8802; WITHIN CALIFORNIA CALL 1-800-852-7550

GENERATOR  
TRANSPORTER  
FACILITY



IN CASE OF AN EMERGENCY OR SPILL, CALL THE NATIONAL RESPONSE CENTER 1-800-424-8802; WITHIN CALIFORNIA CALL 1-800-852-7550  
 GENERATOR  
 TRANSPORTER  
 FACILITY

<b>UNIFORM HAZARDOUS WASTE MANIFEST</b>		1. Generator's US EPA ID No. CA1A1D19171131819131918110151216		Manifest Document No. 110151216		2. Page 1 of 1		Information in the shaded areas is not required by Federal law.							
3. Generator's Name and Mailing Address Fabco Automotive Corporation P. O. Box 8276, Oakland, California 94662						A. State Manifest Document Number 87992073									
4. Generator's Phone (415) 658-7070						B. State Generator's ID H1S1H1013161017181514121									
5. Transporter 1 Company Name IT-CORP			6. US EPA ID Number CA1D1001010151819111			C. State Transporter's ID 807930									
7. Transporter 2 Company Name			8. US EPA ID Number			D. Transporter's Phone									
9. Designated Facility Name and Site Address Romic Chemical Corporation 2081 Bay Road East Palo Alto, Calif. 99303			10. US EPA ID Number CA1D101019141512161517			E. State Transporter's ID									
9. Designated Facility Name and Site Address						F. Transporter's Phone									
9. Designated Facility Name and Site Address						G. State Facility's ID CA1D101019141512161517									
9. Designated Facility Name and Site Address						H. Facility's Phone 415-324-1638									
11. US DOT Description (Including Proper Shipping Name, Hazard Class, and ID Number)						12. Containers		13. Total Quantity		14. Unit		15. Waste No.			
a. Waste Combustible Liquid (N.O.S.) Combustible NA 1993						0, 0, 1 TIT		MS 2,000 <del>1,000</del>		G		State 221 EPA/Other			
b.												State EPA/Other			
c.												State EPA/Other			
d.												State EPA/Other			
J. Additional Descriptions for Materials Listed Above Used Oil Lubricants Water						K. Handling Codes for Wastes Listed Above a. 01 b. c. d.									
15. Special Handling Instructions and Additional Information Avoid Skin Contact D.O.T. 5823 MS RCRA Exempt PH 7-9															
16. GENERATOR'S CERTIFICATION: I hereby declare that the contents of this consignment are fully and accurately described above by proper shipping name and are classified, packed, marked, and labeled, and are in all respects in proper condition for transport by highway according to applicable international and national government regulations. If I am a large quantity generator, I certify that I have a program in place to reduce the volume and toxicity of waste generated to the degree I have determined to be economically practicable and that I have selected the practicable method of treatment, storage, or disposal currently available to me which minimizes the present and future threat to human health and the environment; OR, if I am a small quantity generator, I have made a good faith effort to minimize my waste generation and select the best waste management method that is available to me and that I can afford.															
Printed/Typed Name Michael Carlson						Signature <i>Michael Carlson</i>						Month Day Year 10/21/91/818			
17. Transporter 1 Acknowledgement of Receipt of Materials						Printed/Typed Name B. WILLIAMS						Signature <i>B. Williams</i>		Month Day Year 10/21/91/818	
18. Transporter 2 Acknowledgement of Receipt of Materials						Printed/Typed Name						Signature		Month Day Year	
19. Discrepancy Indication Space															
20. Facility Owner or Operator Certification of receipt of hazardous materials covered by this manifest except as noted in Item 19.															
Printed/Typed Name						Signature						Month Day Year			