

Results of Additional Phase II Grab Groundwater Investigation

January 9, 2003

Page 2

We understand that Pulte Home Corporation would like to purchase the property for a high-density residential development. Based on the data collected to date, it appears that shallow groundwater beneath the site has been impacted by VOCs. The source and lateral extent of VOCs in groundwater is unknown. We recommend contacting the appropriate regulatory agency to discuss further action that may be warranted, if any, to implement residential development at this property.

Attachments:

Table 1

Figures 1 – 3

Laboratory Analytical Report

I:\Doc_Safe\8000s\8367.001\Phase 2 memorandum.doc

TABLE 1
GRAB GROUNDWATER SAMPLE ANALYTICAL RESULTS
FOR VOLATILE ORGANIC COMPOUNDS¹

1249 67th Street
Emeryville, California

Concentrations reported in micrograms per liter (µg/l)

Boring/ Sample ID	1,2- Dichloro- benzene	MTBE	cis-1,2- Dichloro- ethene	trans-1,2- Dichloro- ethene	Trichloro- ethene
GMX-01	<0.5	<5	NS ²	NS	NS
GMX-02	NS	NS	NS	NS	NS
GMX-03	NS	NS	NS	NS	NS
GMX-04	<0.5	<5	0.7	<0.5	3.1
GMX-04 Dup ³	<0.5	<5	0.69	<0.5	3.4
GMX-05	NS	NS	NS	NS	NS
GMX-06	NS	NS	NS	NS	NS
GMX-07	NS	NS	NS	NS	NS
GMX-08	<0.5	<5	0.5	<0.5	1.3
GMX-09	<0.5	<5	2.6	2.9	62
GMX-10	NS	NS	NS	NS	NS
GMX-11	<0.5	<5	<0.5	<0.5	<0.5
GMX-12	0.52	<5	7.7	2	49
GMX-13	<0.5	7	<0.5	<0.5	<0.5
GMX-14	<0.5	<5	<0.5	<0.5	<0.5
GMX-15	<0.5	<5	<0.5	<0.5	<0.5

Notes:

¹ Samples collected by Geomatrix Consultants, Inc., and analyzed by STL San Francisco of Pleasanton, California, for volatile organic compounds (VOCs) using EPA Method 8260B. Only those analytes detected are shown; for a complete list of analytes, refer to the laboratory report.

² NS = Not sampled; insufficient water in the temporary well point.

³ Field duplicate of GMX-04.



Base map from the U.S. Geological Survey, Oakland West Quadrangle, 7.5 minute series (topographic), 1959 (photo revised 1980).

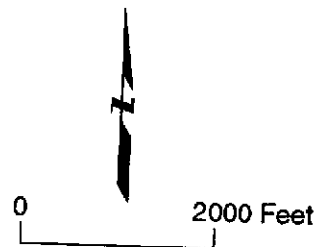

S:\830018367\8367_001\02_1002_phase1_fig_01(03).ai



SITE LOCATION MAP
 Fabco Automotive Corporation
 1249 67th Street
 Emeryville, California

Project No.
 8367.001

Figure
 1

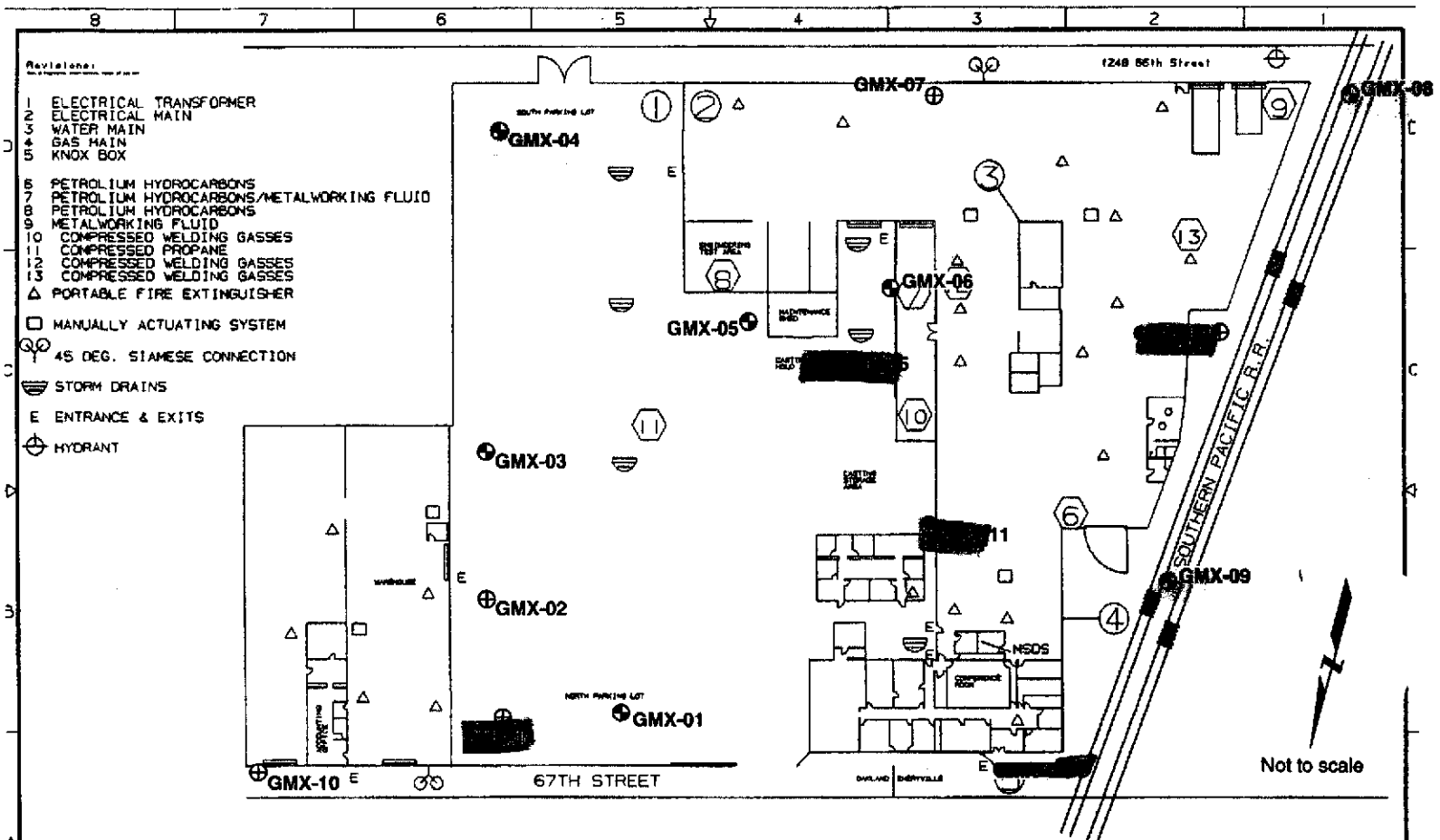

- Revisions:
- 1 ELECTRICAL TRANSFORMER
 - 2 ELECTRICAL MAIN
 - 3 WATER MAIN
 - 4 GAS MAIN
 - 5 KNOX BOX
 - 6 PETROLEUM HYDROCARBONS
 - 7 PETROLEUM HYDROCARBONS/METALWORKING FLUID
 - 8 PETROLEUM HYDROCARBONS
 - 9 METALWORKING FLUID
 - 10 COMPRESSED WELDING GASSES
 - 11 COMPRESSED PROPANE
 - 12 COMPRESSED WELDING GASSES
 - 13 COMPRESSED WELDING GASSES
 - △ PORTABLE FIRE EXTINGUISHER
 - MANUALLY ACTUATING SYSTEM
 - ④ 45 DEG. SIAMESE CONNECTION
 - ☐ STORM DRAINS
 - E ENTRANCE & EXITS
 - ⊕ HYDRANT

- EXPLANATION**
- ⊕ Soil and grab groundwater boring location
 - ⊕ Grab groundwater boring location

292	<i>[Signature]</i>	FABCO PLANT LAYOUT 1998 OAKLAND & EMERYVILLE CALIFORNIA
308		
<small> P.A. AND S.H. REGISTERED ENGINEERS V. 11/23/00 P. 11/23/00 </small>		<small> SHEET NO. 292 308 A OF 1 </small>

Base map provided by Fabco Automotive Corporation.



SITE LAYOUT WITH SOIL AND GRAB GROUNDWATER BORING LOCATIONS
 Fabco Automotive Corporation
 1249 67th Street
 Emeryville, California

Project No.
8367.001
 Figure
2

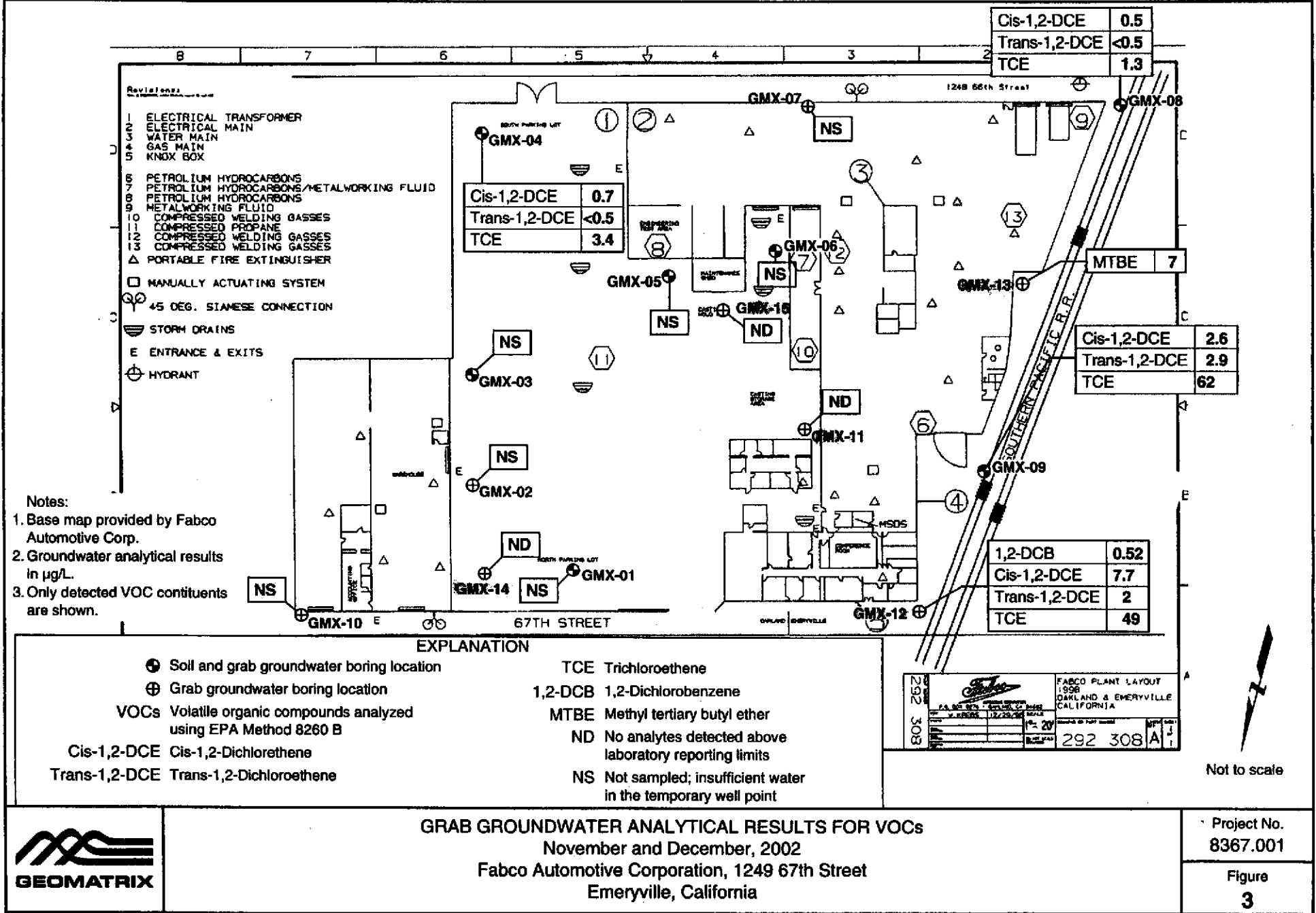

PROJECT: FABCO AUTOMOTIVE CORPORATION Emeryville, California		Log of Boring No. <i>GMX-11</i>	
BORING LOCATION:		ELEVATION AND DATUM: Not surveyed; datum is ground surface	
DRILLING CONTRACTOR: Precision Sampling, Inc.		DATE STARTED: <i>12/3/02</i>	DATE FINISHED:
DRILLING METHOD: Direct push		TOTAL DEPTH: <i>19.0</i>	MEASURING POINT: Ground surface
DRILLING EQUIPMENT: <i>XD-1</i>		DEPTH TO WATER: FIRST <i>12.0</i> COMPL <i>NA</i>	
SAMPLING METHOD: Enviro-core sampling system [3' x 2-8"] <i>1 5/8"</i>		LOGGED BY: <i>S. Mearon</i>	
HAMMER WEIGHT: NA DROP: NA		RESPONSIBLE PROFESSIONAL: REG. NO.	

DEPTH (feet)	SAMPLES			OVM Reading (ppm)	DESCRIPTION NAME (USCS Symbol): color, moist. % by weight, plast., consistency, structure, cementation, react. W/HCl, geo. inter.	REMARKS
	Sample No.	Sample	Blows/ Foot			
					Surface Elevation: Not surveyed	
1				0.0	ASPHALTIC CONCRETE (6 inches) CLAYEY SAND (SC): olive brown (2.5Y 4/3), moist, 60% fine to coarse sand, 35% low plasticity fines, 5% fine gravel	OVM = Thermo Environmental Instruments 580B PID calibrated with 100 ppm isobutylene standard.
2				0.0	LEAN CLAY (CL): black (7.5YR 2.5/1) mottled with grayish green (5G 5/2), moist, 90% fines, 10% fine sand, medium plasticity, firm, trace wood fragments	
3				0.0	↓ black (7.5YR 2.5/1)	
4				0.0		
5				0.0	LEAN CLAY WITH SAND (CL): dark gray (5Y 4/1) mottled with dark yellowish brown (10YR 4/4), moist, 85% fines, 15% fine to coarse sand, medium plasticity, soft	
6						
7				0.0	↓ olive brown (2.5Y 4/3), 80% fines, 20% fine to coarse sand.	
8				0.0	SANDY LEAN CLAY (CL): olive brown (2.5Y 4/3), moist, 60% fines, 40% fine to coarse sand, medium plasticity, firm	
9						
10				0.0	CLAYEY SAND (SC): olive brown (2.5Y 4/3), moist, 70% fine to coarse sand, 25% medium plasticity fines, 5% fine gravel → 80% fine to coarse sand, 15% fines, 5% fine gravel	
11				0.0		
12				0.0	→ wet	
13				0.0	SANDY LEAN CLAY (CL): dark gray (2.5Y 4/1), moist, 65% fines, 35% fine to coarse sand, medium plasticity, firm trace fine gravel	
14						
15				0.0	LEAN CLAY WITH SAND (CL): dark gray (2.5Y 4/1), moist, 85% fines, 15% fine to coarse sand, trace fine gravel, medium plasticity, firm	

PROJECT: FABCO AUTOMOTIVE CORPORATION
California

Emeryville,

Log of Boring No. *GMX-11*

DEPTH (feet)	SAMPLES				OVM Reading (ppm)	DESCRIPTION <small>NAME (USCS Symbol): color, moist, % by weight, plast., consistency, structure, cementation, react. W/HCl, geo. inter.</small>	REMARKS
	Sample No.	Sample	Blows/ Foot				
16					0.0	<p><i>LEAN CLAY (CL): dark gray (2.5 Y 4/1), moist, 90% fines, 10% fine to coarse sand, trace fine gravel, medium plasticity, firm</i></p>	
17				0.0			
18				0.0			
19				0.0			
20						<p><i>Bottom of boring at 19.0 feet</i></p>	<p>Borehole destroyed using Type I-II neat cement grout placed from total depth to ground surface with a tremie pipe.</p>
21							
22							

Project No. *8367-001*

Geomatrix Consultants

Figure

PROJECT: FABCO AUTOMOTIVE CORPORATION Emeryville, California		Log of Boring No. <i>GMX-12</i>	
BORING LOCATION:		ELEVATION AND DATUM: Not surveyed; datum is ground surface	
DRILLING CONTRACTOR: Precision Sampling, Inc.		DATE STARTED: <i>12/3/02</i>	DATE FINISHED:
DRILLING METHOD: Direct push		TOTAL DEPTH: <i>16.0</i>	MEASURING POINT: Ground surface
DRILLING EQUIPMENT: <i>XD-1</i>		DEPTH TO WATER: FIRST <i>8.5</i>	COMPL <i>NA</i>
SAMPLING METHOD: Enviro-core sampling system [3' x 2.6"]		LOGGED BY: <i>S. Mearon</i>	
HAMMER WEIGHT: <i>NA</i> DROP: <i>NA</i>		RESPONSIBLE PROFESSIONAL:	REG. NO.

DEPTH (feet)	SAMPLES			OVM Reading (ppm)	DESCRIPTION NAME (USCS Symbol): color, moist. % by weight, plast., consistency, structure, cementation, react. W/HCl, geo. inter. Surface Elevation: Not surveyed	REMARKS
	Sample No.	Sample	Blows/ Foot			
1				0.0	<i>LEAN CLAY WITH SAND (CL) : black (2.5 Y 2.5/1), moist, 85% fines, 15% fine to coarse sand, medium plasticity, soft, organic color (see)</i>	OVM = Thermo Environmental Instruments 580B PID calibrated with 100 ppm isobutylene standard.
2				0.0	<i>LEAN CLAY (CL) : olive gray (5 Y 4/2), moist, 90% fines, 10% fine to coarse sand, medium plasticity, firm</i>	
3				0.0	<i>↓ olive (5 Y 5/3)</i>	
4				0.0		
5				0.0	<i>LEAN CLAY WITH SAND (CL) : olive (5 Y 5/3), moist, 80% fines, 20% fine to coarse sand, medium plasticity, firm</i>	
6				0.0	<i>LEAN CLAY (CL) : light olive brown (2.5 Y 5/3), moist, 90% fines, 10% fine to coarse sand, medium plasticity, firm</i>	
7				0.0		
8				0.0	<i>CLAYEY SAND (SC) : light olive brown (2.5 Y 5/3), moist, 85% fine to coarse sand, 15% low plasticity fines</i>	
9				0.0	<i>↓ wet</i>	
10				0.0		
11				0.0		
12				0.0	<i>LEAN CLAY (CL) : dark yellowish brown (10 YR 3/4), moist, 90% fines, 10% fine to coarse sand, medium plasticity, very firm</i>	
13				0.0		
14				0.0		
15				0.0		

Project No. 8367.001

Geomatrix Consultants

Figure

PROJECT: FABCO AUTOMOTIVE CORPORATION
California

Emeryville,

Log of Boring No. *GMX-12*

DEPTH (feet)	SAMPLES				OVM Reading (ppm)	DESCRIPTION <small>NAME (USCS Symbol): color, moist. % by weight, plast., consistency, structure, cementation, react. W/HCl, geo. inter.</small>	REMARKS
	Sample No.	Sample	Blows/ Foot	Foot			
16		X				<i>LEAN CLAY (CL) : (Cont.)</i>	<i>Sampling refusal at 16.0 feet.</i>
17						<i>Drilling refusal at 16.0 feet</i>	
18							<i>Borehole destroyed using Type I-II neat cement grout placed from total depth to ground surface with a tremie pipe.</i>
19							
20							
21							
22							

Project No. *8367.001*

Geomatrix Consultants

Figure

PROJECT: FABCO AUTOMOTIVE CORPORATION Emeryville, California		Log of Boring No. <i>GMX-13</i>	
BORING LOCATION:		ELEVATION AND DATUM: Not surveyed; datum is ground surface	
DRILLING CONTRACTOR: Precision Sampling, Inc.		DATE STARTED: <i>12/3/02</i>	DATE FINISHED:
DRILLING METHOD: Direct push		TOTAL DEPTH: <i>19.0</i>	MEASURING POINT: Ground surface
DRILLING EQUIPMENT: <i>XD-1</i>		DEPTH TO WATER: FIRST <i>16.0</i> COMPL <i>NA</i>	
SAMPLING METHOD: Enviro-core sampling system [3' x 2.8"] 1 5/8"		LOGGED BY: <i>S. Mearon</i>	
HAMMER WEIGHT: NA DROP: NA		RESPONSIBLE PROFESSIONAL: REG. NO.	

DEPTH (feet)	SAMPLES			OVM Reading (ppm)	DESCRIPTION NAME (USCS Symbol): color, moist. % by weight, plast., consistency, structure, cementation, react. W/HCl, geo. inter.	REMARKS
	Sample No.	Sample	Blows/ Foot			
Surface Elevation: Not surveyed						
1					<i>CLAYEY SAND WITH GRAVEL (SC): black (1.5 YR 2.5/1), moist, 50% fine to coarse sand, 35% medium plasticity fines, 15% fine to coarse gravel</i>	OVM = Thermo Environmental Instruments 580B PID calibrated with 100 ppm isobutylene standard. Driller comment: hard drilling.
2				0.0	<i>SANDY LEAN CLAY (CL): light olive brown (2.5Y 5/3), moist, 70% fines, 30% fine to coarse sand, medium plasticity, firm</i>	
3						
4				0.0		
5				0.0		
6				0.0	<i>CLAYEY SAND (SC): light olive brown (2.5Y 5/3), moist, 70% fine to coarse sand, 30% medium plasticity fines</i>	
7				0.0	<i>↓ dark gray (2.5Y 4/1)</i>	
8				0.0	<i>↓ 65% fine to coarse sand, 35% fines</i>	
9				0.0		
10				0.0	<i>↓ 85% fine to coarse sand, 15% fines</i>	
11				0.0	<i>LEAN CLAY (CL): brown (10YR 4/3), moist, 90% fines, 10% fine to coarse sand, medium plasticity, firm</i>	
12				0.0		
13				0.0	<i>SANDY LEAN CLAY (CL): brown (10YR 4/3), moist, 65% fines, 35% fine to coarse sand, trace gravel, medium plasticity, firm</i>	
14				0.0	<i>LEAN CLAY WITH SAND (CL): brown (10YR 4/3), moist, 85% fines, 15% fine to coarse sand, medium plasticity, firm</i>	
15				0.0		

DEPTH (feet)	SAMPLES			OVM Reading (ppm)	DESCRIPTION <small>NAME (USCS Symbol): color, moist. % by weight, plast., consistency, structure, cementation, react. W/HCl, geo. inter.</small>	REMARKS
	Sample No.	Sample	Blows/ Foot			
16				0.0	↓ 75% fines, 25% fine to coarse sand	
17				0.0	SANDY LEAN CLAY (CL): olive brown (2.5Y 4/3), wet, 65% fines, 35% fine to coarse sand, medium plasticity, firm	
18				0.0		
19				0.0	CLAYEY SAND (SC): olive brown (2.5Y 4/3), wet, 70% fine to coarse sand, 30% medium plasticity fines	
20					Bottom of boring at 19.0 feet	
21						Borehole destroyed using Type I-II neat cement grout placed from total depth to ground surface with a tremie pipe.
22						

PROJECT: FABCO AUTOMOTIVE CORPORATION
Emeryville, California

Log of Boring No. *GMX-14*

BORING LOCATION: *14' south of northern fence, 14' west of warehouse*

ELEVATION AND DATUM: Not surveyed; datum is ground surface

DRILLING CONTRACTOR: Precision Sampling, Inc.

DATE STARTED:
12/3/02

DATE FINISHED:

DRILLING METHOD: Direct push

TOTAL DEPTH: *19.0*

MEASURING POINT: Ground surface

DRILLING EQUIPMENT: *XD-1*

DEPTH TO WATER:
FIRST *10.5* COMPL *NA*

SAMPLING METHOD: Enviro-core sampling system [3' x 2.6"] *5/8"*

LOGGED BY: *S. Meardon*

HAMMER WEIGHT: NA DROP: NA

RESPONSIBLE PROFESSIONAL: REG. NO.

DEPTH (feet)	SAMPLES			OVM Reading (ppm)	DESCRIPTION NAME (USCS Symbol): color, moist. % by weight, plast., consistency, structure, cementation, react. W/HCI, geo. inter.	REMARKS
	Sample No.	Sample	Blows/ Foot			
					Surface Elevation: Not surveyed	
1				0.0	<i>CLAYEY SAND (SC): very dark grayish brown (10YR 3/2), moist, 75% fine to coarse sand, 25% medium plasticity fines</i>	OVM = Thermo Environmental Instruments 580B PID calibrated with 100 ppm isobutylene standard.
2				0.0	<i>LEAN CLAY (CL): black (7.5 YR 2.5/1), moist, 90% fines, 10% fine to coarse sand, medium plasticity, firm</i>	
3						
4				0.0	<i>LEAN CLAY WITH SAND (CL): dark gray (2.5Y 4/1), moist, 85% fines, 15% fine to coarse sand, medium plasticity, firm</i>	
5				0.0		
6				0.0	<i>↓ dark gray (5Y 4/1)</i>	
7				0.0		
8				0.0	<i>↓ olive gray (5Y 5/2)</i>	
9				0.0		
10				0.0		
11				0.0	<i>↓ wet</i>	
12				0.0	<i>↓ pale olive (5Y 6/3) mottled with strong brown (7.5 YR 5/8), 80% fines, 20% fine to coarse sand, moist</i>	
13				0.0		
14				0.0	<i>SANDY LEAN CLAY (CL): dark yellowish brown (10YR 4/6), moist, 60% fines, 40% fine to coarse sand, medium plasticity, firm</i>	
15				0.0		

PROJECT: FABCO AUTOMOTIVE CORPORATION Emeryville, California		Log of Boring No. <i>GMX-15</i>	
BORING LOCATION:		ELEVATION AND DATUM: Not surveyed; datum is ground surface	
DRILLING CONTRACTOR: Precision Sampling, Inc.		DATE STARTED: <i>12/3/02</i>	DATE FINISHED:
DRILLING METHOD: Direct push		TOTAL DEPTH: <i>19.0</i>	MEASURING POINT: Ground surface
DRILLING EQUIPMENT: <i>XD-1</i>		DEPTH TO WATER: FIRST <i>NA</i>	COMPL <i>NA</i>
SAMPLING METHOD: Enviro-core sampling system [3' x 2.6"] <i>1 5/8"</i>		LOGGED BY: <i>S. Meardon</i>	
HAMMER WEIGHT: NA DROP: NA		RESPONSIBLE PROFESSIONAL:	REG. NO.

DEPTH (feet)	SAMPLES				OVM Reading (ppm)	DESCRIPTION NAME (USCS Symbol): color, moist. % by weight, plast., consistency, structure, cementation, react. WHCI, geo. inter.	REMARKS
	Sample No.	Sample	Blows/ Foot				
						Surface Elevation: Not surveyed	
1						ASPHALTIC CONCRETE (6 inches)	OVM = Thermo Environmental Instruments 580B PID calibrated with 100 ppm isobutylene standard.
				0.0		CLAYEY SAND (SC): very dark grayish brown (10YR 3/2), moist, 70% fine to coarse sand, 25% medium plasticity fines, 5% fine gravel	
2				0.0		LEAN CLAY (CL): black (10YR 2.5/1), moist, 90% fines, 10% fine to coarse sand, trace gravel, medium plasticity, firm	
						↓ dark greenish gray (5GY 4/1)	
3							
4					0.0	↓ black (10YR 2.5/1), 95% fines, 5% fine to coarse sand	
5					0.0	↓ dark greenish gray (5GY 4/1)	
6					0.0		
7					0.0	SANDY LEAN CLAY (CL): dark greenish gray (5GY 4/1), moist, 65% fines, 35% fine to coarse sand, trace fine gravel, medium plasticity, firm	
8					0.0	↓ light olive brown (2.5Y 5/3)	
9					0.0	LEAN CLAY (CL): light olive brown (2.5Y 5/3), moist, 95% fines, 5% fine sand, medium plasticity, firm	
10					0.0		
11					0.0		
12					0.0	SANDY LEAN CLAY (CL): light olive brown (2.5Y 5/3), moist, 60% fines, 40% fine to coarse sand, trace fine gravel, medium plasticity, firm	
13					0.0	LEAN CLAY (CL): pale olive (5Y 6/3) mottled with strong brown (7.5YR 5/8), moist, 95% fines, 5% fine sand, medium plasticity, firm	
14					0.0		
15					0.0		

Project No. 8367.001

Geomatrix Consultants

Figure

DEPTH (feet)	SAMPLES			OVM Reading (ppm)	DESCRIPTION <small>NAME (USCS Symbol); color, moist % by weight, plast., consistency, structure, cementation, react. W/HCl, geo. inter.</small>	REMARKS
	Sample No.	Sample	Blows/ Foot			
16				0.0	LEAN CLAY (CL) : (Cont.)	
17				0.0	LEAN CLAY WITH SAND (CL) : pale olive (5Y6/3) mottled with strong brown (7.5 YR 5/8), moist, 85% fines, 15% fine to coarse sand, medium plasticity, firm	
18				0.0	↓ 75% fines, 25% fine to coarse sand	
19		X			Bottom of boring at 19.0 feet	
20						
21						Borehole destroyed using Type I-II neat cement grout placed from total depth to ground surface with a tremie pipe.
22						

Geomatrix Consultants

December 06, 2002

2101 Webster Street, 12th Floor
Oakland, CA 94612
Attn.: Robert Cheung
Project#: 8367.001

Attached is our report for your samples received on 12/04/2002 16:30
This report has been reviewed and approved for release. Reproduction of this report
is permitted only in its entirety.

Please note that any unused portion of the samples will be discarded after
01/18/2003 unless you have requested otherwise.

We appreciate the opportunity to be of service to you. If you have any questions,
please call me at (925) 484-1919.

You can also contact me via email. My email address is: asalimpour@stl-inc.com

Sincerely,

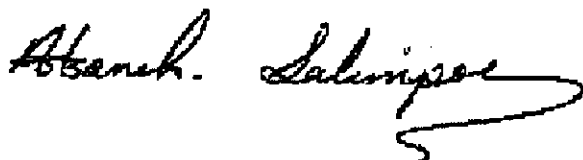

Afsaneh Salimpour
Project Manager

Volatile Organic Compounds by 8260B (Low Level)

Geomatrix Consultants

Attn.: Robert Cheung

2101 Webster Street, 12th Floor
Oakland, CA 94612
Phone: (510) 663-4299 Fax: (510) 663-4141

Project: 8367.001

Received: 12/04/2002 16:30

Samples Reported

Sample Name	Date Sampled	Matrix	Lab #
GMX-11-1202	12/04/2002 12:00	Water	1
GMX-15-1202	12/04/2002 12:25	Water	2
GMX-14-1202	12/04/2002 12:45	Water	3
GMX-12-1202	12/04/2002 13:00	Water	4
GMX-13-1202	12/04/2002 13:20	Water	5

Severn Trent Laboratories, Inc.

STL San Francisco * 1220 Quarry Lane, Pleasanton, CA 94566

Tel 928 484 1919 Fax 925 484 1096 * www.stl-inc.com * CA DHS ELAP# 2496

12/06/2002 14:24

Volatile Organic Compounds by 8260B (Low Level)

Geomatrix Consultants

Attn.: Robert Cheung

2101 Webster Street, 12th Floor

Oakland, CA 94612

Phone: (510) 663-4299 Fax: (510) 663-4141

Project: 8367.001

Received: 12/04/2002 16:30

Prep(s): 5030B Test(s): 8260B
 Sample ID: **GMX-11-1202** Lab ID: 2002-12-0072 - 1
 Sampled: 12/04/2002 12:00 Extracted: 12/5/2002 17:35
 Matrix: Water QC Batch#: 2002/12/05-01.07

Compound	Conc.	RL	Unit	Dilution	Analyzed	Flag
MTBE	ND	5.0	ug/L	1.00	12/05/2002 17:35	
Acetone	ND	50	ug/L	1.00	12/05/2002 17:35	
Benzene	ND	0.50	ug/L	1.00	12/05/2002 17:35	
Bromodichloromethane	ND	0.50	ug/L	1.00	12/05/2002 17:35	
Bromobenzene	ND	1.0	ug/L	1.00	12/05/2002 17:35	
Bromochloromethane	ND	1.0	ug/L	1.00	12/05/2002 17:35	
Bromoform	ND	0.50	ug/L	1.00	12/05/2002 17:35	
Bromomethane	ND	1.0	ug/L	1.00	12/05/2002 17:35	
2-Butanone(MEK)	ND	50	ug/L	1.00	12/05/2002 17:35	
n-Butylbenzene	ND	1.0	ug/L	1.00	12/05/2002 17:35	
sec-Butylbenzene	ND	1.0	ug/L	1.00	12/05/2002 17:35	
tert-Butylbenzene	ND	1.0	ug/L	1.00	12/05/2002 17:35	
Carbon disulfide	ND	5.0	ug/L	1.00	12/05/2002 17:35	
Carbon tetrachloride	ND	0.50	ug/L	1.00	12/05/2002 17:35	
Chlorobenzene	ND	0.50	ug/L	1.00	12/05/2002 17:35	
Chloroethane	ND	1.0	ug/L	1.00	12/05/2002 17:35	
2-Chloroethylvinyl ether	ND	5.0	ug/L	1.00	12/05/2002 17:35	
Chloroform	ND	1.0	ug/L	1.00	12/05/2002 17:35	
Chloromethane	ND	1.0	ug/L	1.00	12/05/2002 17:35	
2-Chlorotoluene	ND	0.50	ug/L	1.00	12/05/2002 17:35	
4-Chlorotoluene	ND	0.50	ug/L	1.00	12/05/2002 17:35	
Dibromochloromethane	ND	0.50	ug/L	1.00	12/05/2002 17:35	
1,2-Dichlorobenzene	ND	0.50	ug/L	1.00	12/05/2002 17:35	
1,3-Dichlorobenzene	ND	0.50	ug/L	1.00	12/05/2002 17:35	
1,4-Dichlorobenzene	ND	0.50	ug/L	1.00	12/05/2002 17:35	
1,3-Dichloropropane	ND	1.0	ug/L	1.00	12/05/2002 17:35	
2,2-Dichloropropane	ND	0.50	ug/L	1.00	12/05/2002 17:35	
1,1-Dichloropropene	ND	0.50	ug/L	1.00	12/05/2002 17:35	
1,2-Dibromo-3-chloropropane	ND	1.0	ug/L	1.00	12/05/2002 17:35	
1,2-Dibromoethane	ND	0.50	ug/L	1.00	12/05/2002 17:35	
Dibromomethane	ND	0.50	ug/L	1.00	12/05/2002 17:35	

Severn Trent Laboratories, Inc.

STL San Francisco * 1220 Quarry Lane, Pleasanton, CA 94566

Tel 928 484 1919 Fax 925 484 1096 * www.stl-inc.com * CA DHS ELAP# 2496

12/06/2002 14:24

Volatile Organic Compounds by 8260B (Low Level)

Geomatrix Consultants

Attn.: Robert Cheung

2101 Webster Street, 12th Floor

Oakland, CA 94612

Phone: (510) 663-4299 Fax: (510) 663-4141

Project: 8367.001

Received: 12/04/2002 16:30

Prep(s):	5030B	Test(s):	8260B
Sample ID:	GMX-11-1202	Lab ID:	2002-12-0072 - 1
Sampled:	12/04/2002 12:00	Extracted:	12/5/2002 17:35
Matrix:	Water	QC Batch#:	2002/12/05-01.07

Compound	Conc.	RL	Unit	Dilution	Analyzed	Flag
Dichlorodifluoromethane	ND	0.50	ug/L	1.00	12/05/2002 17:35	
1,1-Dichloroethane	ND	0.50	ug/L	1.00	12/05/2002 17:35	
1,2-Dichloroethane	ND	0.50	ug/L	1.00	12/05/2002 17:35	
1,1-Dichloroethene	ND	0.50	ug/L	1.00	12/05/2002 17:35	
cis-1,2-Dichloroethene	ND	0.50	ug/L	1.00	12/05/2002 17:35	
trans-1,2-Dichloroethene	ND	0.50	ug/L	1.00	12/05/2002 17:35	
1,2-Dichloropropane	ND	0.50	ug/L	1.00	12/05/2002 17:35	
cis-1,3-Dichloropropene	ND	0.50	ug/L	1.00	12/05/2002 17:35	
trans-1,3-Dichloropropene	ND	0.50	ug/L	1.00	12/05/2002 17:35	
Ethylbenzene	ND	0.50	ug/L	1.00	12/05/2002 17:35	
Hexachlorobutadiene	ND	1.0	ug/L	1.00	12/05/2002 17:35	
2-Hexanone	ND	50	ug/L	1.00	12/05/2002 17:35	
Isopropylbenzene	ND	0.50	ug/L	1.00	12/05/2002 17:35	
p-Isopropyltoluene	ND	1.0	ug/L	1.00	12/05/2002 17:35	
Methylene chloride	ND	5.0	ug/L	1.00	12/05/2002 17:35	
4-Methyl-2-pentanone (MIBK)	ND	50	ug/L	1.00	12/05/2002 17:35	
Naphthalene	ND	1.0	ug/L	1.00	12/05/2002 17:35	
n-Propylbenzene	ND	1.0	ug/L	1.00	12/05/2002 17:35	
Styrene	ND	0.50	ug/L	1.00	12/05/2002 17:35	
1,1,1,2-Tetrachloroethane	ND	0.50	ug/L	1.00	12/05/2002 17:35	
1,1,2,2-Tetrachloroethane	ND	0.50	ug/L	1.00	12/05/2002 17:35	
Tetrachloroethene	ND	0.50	ug/L	1.00	12/05/2002 17:35	
Toluene	ND	0.50	ug/L	1.00	12/05/2002 17:35	
1,2,3-Trichlorobenzene	ND	1.0	ug/L	1.00	12/05/2002 17:35	
1,2,4-Trichlorobenzene	ND	1.0	ug/L	1.00	12/05/2002 17:35	
1,1,1-Trichloroethane	ND	0.50	ug/L	1.00	12/05/2002 17:35	
1,1,2-Trichloroethane	ND	0.50	ug/L	1.00	12/05/2002 17:35	
Trichloroethene	ND	0.50	ug/L	1.00	12/05/2002 17:35	
Trichlorofluoromethane	ND	1.0	ug/L	1.00	12/05/2002 17:35	
Trichlorotrifluoroethane	ND	0.50	ug/L	1.00	12/05/2002 17:35	
1,2,4-Trimethylbenzene	ND	0.50	ug/L	1.00	12/05/2002 17:35	

Severn Trent Laboratories, Inc.

STL San Francisco * 1220 Quarry Lane, Pleasanton, CA 94566

Tel 925 484 1919 Fax 925 484 1096 * www.stl-inc.com * CA DHS ELAP# 2496

12/06/2002 14:24

Volatile Organic Compounds by 8260B (Low Level)

Geomatrix Consultants

Attn.: Robert Cheung

2101 Webster Street, 12th Floor

Oakland, CA 94612

Phone: (510) 663-4299 Fax: (510) 663-4141

Project: 8367.001

Received: 12/04/2002 16:30

Prep(s): 5030B Test(s): 8260B
 Sample ID: **GMX-15-1202** Lab ID: 2002-12-0072 - 2
 Sampled: 12/04/2002 12:25 Extracted: 12/5/2002 17:59
 Matrix: Water QC Batch#: 2002/12/05-01.07

Compound	Conc.	RL	Unit	Dilution	Analyzed	Flag
MTBE	ND	5.0	ug/L	1.00	12/05/2002 17:59	
Acetone	ND	50	ug/L	1.00	12/05/2002 17:59	
Benzene	ND	0.50	ug/L	1.00	12/05/2002 17:59	
Bromodichloromethane	ND	0.50	ug/L	1.00	12/05/2002 17:59	
Bromobenzene	ND	1.0	ug/L	1.00	12/05/2002 17:59	
Bromochloromethane	ND	1.0	ug/L	1.00	12/05/2002 17:59	
Bromoform	ND	0.50	ug/L	1.00	12/05/2002 17:59	
Bromomethane	ND	1.0	ug/L	1.00	12/05/2002 17:59	
2-Butanone(MEK)	ND	50	ug/L	1.00	12/05/2002 17:59	
n-Butylbenzene	ND	1.0	ug/L	1.00	12/05/2002 17:59	
sec-Butylbenzene	ND	1.0	ug/L	1.00	12/05/2002 17:59	
tert-Butylbenzene	ND	1.0	ug/L	1.00	12/05/2002 17:59	
Carbon disulfide	ND	5.0	ug/L	1.00	12/05/2002 17:59	
Carbon tetrachloride	ND	0.50	ug/L	1.00	12/05/2002 17:59	
Chlorobenzene	ND	0.50	ug/L	1.00	12/05/2002 17:59	
Chloroethane	ND	1.0	ug/L	1.00	12/05/2002 17:59	
2-Chloroethylvinyl ether	ND	5.0	ug/L	1.00	12/05/2002 17:59	
Chloroform	ND	1.0	ug/L	1.00	12/05/2002 17:59	
Chloromethane	ND	1.0	ug/L	1.00	12/05/2002 17:59	
2-Chlorotoluene	ND	0.50	ug/L	1.00	12/05/2002 17:59	
4-Chlorotoluene	ND	0.50	ug/L	1.00	12/05/2002 17:59	
Dibromochloromethane	ND	0.50	ug/L	1.00	12/05/2002 17:59	
1,2-Dichlorobenzene	ND	0.50	ug/L	1.00	12/05/2002 17:59	
1,3-Dichlorobenzene	ND	0.50	ug/L	1.00	12/05/2002 17:59	
1,4-Dichlorobenzene	ND	0.50	ug/L	1.00	12/05/2002 17:59	
1,3-Dichloropropane	ND	1.0	ug/L	1.00	12/05/2002 17:59	
2,2-Dichloropropane	ND	0.50	ug/L	1.00	12/05/2002 17:59	
1,1-Dichloropropene	ND	0.50	ug/L	1.00	12/05/2002 17:59	
1,2-Dibromo-3-chloropropane	ND	1.0	ug/L	1.00	12/05/2002 17:59	
1,2-Dibromoethane	ND	0.50	ug/L	1.00	12/05/2002 17:59	
Dibromomethane	ND	0.50	ug/L	1.00	12/05/2002 17:59	

Severn Trent Laboratories, Inc.

STL San Francisco * 1220 Quarry Lane, Pleasanton, CA 94566

Tel 928 484 1919 Fax 925 484 1096 * www.stl-inc.com * CA DHS ELAP# 2496

12/06/2002 14:24

Volatile Organic Compounds by 8260B (Low Level)

Geomatrix Consultants

Attn.: Robert Cheung

2101 Webster Street, 12th Floor
Oakland, CA 94612
Phone: (510) 663-4299 Fax: (510) 663-4141

Project: 8367.001

Received: 12/04/2002 16:30

Prep(s): 5030B Test(s): 8260B
Sample ID: GMX-15-1202 Lab ID: 2002-12-0072 - 2
Sampled: 12/04/2002 12:25 Extracted: 12/5/2002 17:59
Matrix: Water QC Batch#: 2002/12/05-01.07

Compound	Conc.	RL	Unit	Dilution	Analyzed	Flag
Dichlorodifluoromethane	ND	0.50	ug/L	1.00	12/05/2002 17:59	
1,1-Dichloroethane	ND	0.50	ug/L	1.00	12/05/2002 17:59	
1,2-Dichloroethane	ND	0.50	ug/L	1.00	12/05/2002 17:59	
1,1-Dichloroethene	ND	0.50	ug/L	1.00	12/05/2002 17:59	
cis-1,2-Dichloroethene	ND	0.50	ug/L	1.00	12/05/2002 17:59	
trans-1,2-Dichloroethene	ND	0.50	ug/L	1.00	12/05/2002 17:59	
1,2-Dichloropropane	ND	0.50	ug/L	1.00	12/05/2002 17:59	
cis-1,3-Dichloropropene	ND	0.50	ug/L	1.00	12/05/2002 17:59	
trans-1,3-Dichloropropene	ND	0.50	ug/L	1.00	12/05/2002 17:59	
Ethylbenzene	ND	0.50	ug/L	1.00	12/05/2002 17:59	
Hexachlorobutadiene	ND	1.0	ug/L	1.00	12/05/2002 17:59	
2-Hexanone	ND	50	ug/L	1.00	12/05/2002 17:59	
Isopropylbenzene	ND	0.50	ug/L	1.00	12/05/2002 17:59	
p-Isopropyltoluene	ND	1.0	ug/L	1.00	12/05/2002 17:59	
Methylene chloride	ND	5.0	ug/L	1.00	12/05/2002 17:59	
4-Methyl-2-pentanone (MIBK)	ND	50	ug/L	1.00	12/05/2002 17:59	
Naphthalene	ND	1.0	ug/L	1.00	12/05/2002 17:59	
n-Propylbenzene	ND	1.0	ug/L	1.00	12/05/2002 17:59	
Styrene	ND	0.50	ug/L	1.00	12/05/2002 17:59	
1,1,1,2-Tetrachloroethane	ND	0.50	ug/L	1.00	12/05/2002 17:59	
1,1,2,2-Tetrachloroethane	ND	0.50	ug/L	1.00	12/05/2002 17:59	
Tetrachloroethene	ND	0.50	ug/L	1.00	12/05/2002 17:59	
Toluene	ND	0.50	ug/L	1.00	12/05/2002 17:59	
1,2,3-Trichlorobenzene	ND	1.0	ug/L	1.00	12/05/2002 17:59	
1,2,4-Trichlorobenzene	ND	1.0	ug/L	1.00	12/05/2002 17:59	
1,1,1-Trichloroethane	ND	0.50	ug/L	1.00	12/05/2002 17:59	
1,1,2-Trichloroethane	ND	0.50	ug/L	1.00	12/05/2002 17:59	
Trichloroethene	ND	0.50	ug/L	1.00	12/05/2002 17:59	
Trichlorofluoromethane	ND	1.0	ug/L	1.00	12/05/2002 17:59	
Trichlorotrifluoroethane	ND	0.50	ug/L	1.00	12/05/2002 17:59	
1,2,4-Trimethylbenzene	ND	0.50	ug/L	1.00	12/05/2002 17:59	

Severn Trent Laboratories, Inc.

STL San Francisco * 1220 Quarry Lane, Pleasanton, CA 94566

Tel 928 484 1919 Fax 925 484 1096 * www.stl-inc.com * CA DHS ELAP# 2496

12/06/2002 14:24

Volatile Organic Compounds by 8260B (Low Level)

Geomatrix Consultants

Attn.: Robert Cheung

2101 Webster Street, 12th Floor

Oakland, CA 94612

Phone: (510) 663-4299 Fax: (510) 663-4141

Project: 8367.001

Received: 12/04/2002 16:30

Prep(s): 5030B	Test(s): 8260B
Sample ID: GMX-12-1202	Lab ID: 2002-12-0072 - 4
Sampled: 12/04/2002 13:00	Extracted: 12/5/2002 18:47
Matrix: Water	QC Batch#: 2002/12/05-01.07

Compound	Conc.	RL	Unit	Dilution	Analyzed	Flag
MTBE	ND	5.0	ug/L	1.00	12/05/2002 18:47	
Acetone	ND	50	ug/L	1.00	12/05/2002 18:47	
Benzene	ND	0.50	ug/L	1.00	12/05/2002 18:47	
Bromodichloromethane	ND	0.50	ug/L	1.00	12/05/2002 18:47	
Bromobenzene	ND	1.0	ug/L	1.00	12/05/2002 18:47	
Bromochloromethane	ND	1.0	ug/L	1.00	12/05/2002 18:47	
Bromoform	ND	0.50	ug/L	1.00	12/05/2002 18:47	
Bromomethane	ND	1.0	ug/L	1.00	12/05/2002 18:47	
2-Butanone(MEK)	ND	50	ug/L	1.00	12/05/2002 18:47	
n-Butylbenzene	ND	1.0	ug/L	1.00	12/05/2002 18:47	
sec-Butylbenzene	ND	1.0	ug/L	1.00	12/05/2002 18:47	
tert-Butylbenzene	ND	1.0	ug/L	1.00	12/05/2002 18:47	
Carbon disulfide	ND	5.0	ug/L	1.00	12/05/2002 18:47	
Carbon tetrachloride	ND	0.50	ug/L	1.00	12/05/2002 18:47	
Chlorobenzene	ND	0.50	ug/L	1.00	12/05/2002 18:47	
Chloroethane	ND	1.0	ug/L	1.00	12/05/2002 18:47	
2-Chloroethylvinyl ether	ND	5.0	ug/L	1.00	12/05/2002 18:47	
Chloroform	ND	1.0	ug/L	1.00	12/05/2002 18:47	
Chloromethane	ND	1.0	ug/L	1.00	12/05/2002 18:47	
2-Chlorotoluene	ND	0.50	ug/L	1.00	12/05/2002 18:47	
4-Chlorotoluene	ND	0.50	ug/L	1.00	12/05/2002 18:47	
Dibromochloromethane	ND	0.50	ug/L	1.00	12/05/2002 18:47	
1,2-Dichlorobenzene	0.52	0.50	ug/L	1.00	12/05/2002 18:47	
1,3-Dichlorobenzene	ND	0.50	ug/L	1.00	12/05/2002 18:47	
1,4-Dichlorobenzene	ND	0.50	ug/L	1.00	12/05/2002 18:47	
1,3-Dichloropropane	ND	1.0	ug/L	1.00	12/05/2002 18:47	
2,2-Dichloropropane	ND	0.50	ug/L	1.00	12/05/2002 18:47	
1,1-Dichloropropene	ND	0.50	ug/L	1.00	12/05/2002 18:47	
1,2-Dibromo-3-chloropropane	ND	1.0	ug/L	1.00	12/05/2002 18:47	
1,2-Dibromoethane	ND	0.50	ug/L	1.00	12/05/2002 18:47	
Dibromomethane	ND	0.50	ug/L	1.00	12/05/2002 18:47	

Volatile Organic Compounds by 8260B (Low Level)

Geomatrix Consultants

Attn.: Robert Cheung

2101 Webster Street, 12th Floor
Oakland, CA 94612
Phone: (510) 663-4299 Fax: (510) 663-4141

Project: 8367.001

Received: 12/04/2002 16:30

Prep(s): 5030B Test(s): 8260B
Sample ID: **GMX-12-1202** Lab ID: 2002-12-0072 - 4
Sampled: 12/04/2002 13:00 Extracted: 12/5/2002 18:47
Matrix: Water QC Batch#: 2002/12/05-01.07

Compound	Conc.	RL	Unit	Dilution	Analyzed	Flag
1,3,5-Trimethylbenzene	ND	0.50	ug/L	1.00	12/05/2002 18:47	
Vinyl acetate	ND	25	ug/L	1.00	12/05/2002 18:47	
Vinyl chloride	ND	0.50	ug/L	1.00	12/05/2002 18:47	
Total xylenes	ND	1.0	ug/L	1.00	12/05/2002 18:47	
Surrogates(s)						
4-Bromofluorobenzene	99.2	86-115	%	1.00	12/05/2002 18:47	
1,2-Dichloroethane-d4	97.5	76-114	%	1.00	12/05/2002 18:47	
Toluene-d8	96.8	88-110	%	1.00	12/05/2002 18:47	

Severn Trent Laboratories, Inc.

STL San Francisco * 1220 Quarry Lane, Pleasanton, CA 94566

Tel 928 484 1919 Fax 925 484 1096 * www.stl-inc.com * CA DHS ELAP# 2496

12/06/2002 14:24

Volatile Organic Compounds by 8260B (Low Level)

Geomatrix Consultants

Attn.: Robert Cheung

2101 Webster Street, 12th Floor
Oakland, CA 94612
Phone: (510) 663-4299 Fax: (510) 663-4141

Project: 8367.001

Received: 12/04/2002 16:30

Prep(s): 5030B Test(s): 8260B
Sample ID: GMX-13-1202 Lab ID: 2002-12-0072 - 5
Sampled: 12/04/2002 13:20 Extracted: 12/5/2002 19:11
Matrix: Water QC Batch#: 2002/12/05-01.07

Compound	Conc.	RL	Unit	Dilution	Analyzed	Flag
MTBE	7.0	5.0	ug/L	1.00	12/05/2002 19:11	
Acetone	ND	50	ug/L	1.00	12/05/2002 19:11	
Benzene	ND	0.50	ug/L	1.00	12/05/2002 19:11	
Bromodichloromethane	ND	0.50	ug/L	1.00	12/05/2002 19:11	
Bromobenzene	ND	1.0	ug/L	1.00	12/05/2002 19:11	
Bromochloromethane	ND	1.0	ug/L	1.00	12/05/2002 19:11	
Bromoform	ND	0.50	ug/L	1.00	12/05/2002 19:11	
Bromomethane	ND	1.0	ug/L	1.00	12/05/2002 19:11	
2-Butanone(MEK)	ND	50	ug/L	1.00	12/05/2002 19:11	
n-Butylbenzene	ND	1.0	ug/L	1.00	12/05/2002 19:11	
sec-Butylbenzene	ND	1.0	ug/L	1.00	12/05/2002 19:11	
tert-Butylbenzene	ND	1.0	ug/L	1.00	12/05/2002 19:11	
Carbon disulfide	ND	5.0	ug/L	1.00	12/05/2002 19:11	
Carbon tetrachloride	ND	0.50	ug/L	1.00	12/05/2002 19:11	
Chlorobenzene	ND	0.50	ug/L	1.00	12/05/2002 19:11	
Chloroethane	ND	1.0	ug/L	1.00	12/05/2002 19:11	
2-Chloroethylvinyl ether	ND	5.0	ug/L	1.00	12/05/2002 19:11	
Chloroform	ND	1.0	ug/L	1.00	12/05/2002 19:11	
Chloromethane	ND	1.0	ug/L	1.00	12/05/2002 19:11	
2-Chlorotoluene	ND	0.50	ug/L	1.00	12/05/2002 19:11	
4-Chlorotoluene	ND	0.50	ug/L	1.00	12/05/2002 19:11	
Dibromochloromethane	ND	0.50	ug/L	1.00	12/05/2002 19:11	
1,2-Dichlorobenzene	ND	0.50	ug/L	1.00	12/05/2002 19:11	
1,3-Dichlorobenzene	ND	0.50	ug/L	1.00	12/05/2002 19:11	
1,4-Dichlorobenzene	ND	0.50	ug/L	1.00	12/05/2002 19:11	
1,3-Dichloropropane	ND	1.0	ug/L	1.00	12/05/2002 19:11	
2,2-Dichloropropane	ND	0.50	ug/L	1.00	12/05/2002 19:11	
1,1-Dichloropropene	ND	0.50	ug/L	1.00	12/05/2002 19:11	
1,2-Dibromo-3-chloropropane	ND	1.0	ug/L	1.00	12/05/2002 19:11	
1,2-Dibromoethane	ND	0.50	ug/L	1.00	12/05/2002 19:11	
Dibromomethane	ND	0.50	ug/L	1.00	12/05/2002 19:11	

Severn Trent Laboratories, Inc.

STL San Francisco * 1220 Quarry Lane, Pleasanton, CA 94566

Tel 928 484 1919 Fax 925 484 1096 * www.stl-inc.com * CA DHS ELAP# 2496

12/06/2002 14:24

Volatile Organic Compounds by 8260B (Low Level)

Geomatrix Consultants

Attn.: Robert Cheung

2101 Webster Street, 12th Floor
Oakland, CA 94612
Phone: (510) 663-4299 Fax: (510) 663-4141

Project: 8367.001

Received: 12/04/2002 16:30

Prep(s):	5030B	Test(s):	8260B
Sample ID:	GMX-13-1202	Lab ID:	2002-12-0072 - 5
Sampled:	12/04/2002 13:20	Extracted:	12/5/2002 19:11
Matrix:	Water	QC Batch#:	2002/12/05-01.07

Compound	Conc.	RL	Unit	Dilution	Analyzed	Flag
Dichlorodifluoromethane	ND	0.50	ug/L	1.00	12/05/2002 19:11	
1,1-Dichloroethane	ND	0.50	ug/L	1.00	12/05/2002 19:11	
1,2-Dichloroethane	ND	0.50	ug/L	1.00	12/05/2002 19:11	
1,1-Dichloroethene	ND	0.50	ug/L	1.00	12/05/2002 19:11	
cis-1,2-Dichloroethene	ND	0.50	ug/L	1.00	12/05/2002 19:11	
trans-1,2-Dichloroethene	ND	0.50	ug/L	1.00	12/05/2002 19:11	
1,2-Dichloropropane	ND	0.50	ug/L	1.00	12/05/2002 19:11	
cis-1,3-Dichloropropene	ND	0.50	ug/L	1.00	12/05/2002 19:11	
trans-1,3-Dichloropropene	ND	0.50	ug/L	1.00	12/05/2002 19:11	
Ethylbenzene	ND	0.50	ug/L	1.00	12/05/2002 19:11	
Hexachlorobutadiene	ND	1.0	ug/L	1.00	12/05/2002 19:11	
2-Hexanone	ND	50	ug/L	1.00	12/05/2002 19:11	
Isopropylbenzene	ND	0.50	ug/L	1.00	12/05/2002 19:11	
p-Isopropyltoluene	ND	1.0	ug/L	1.00	12/05/2002 19:11	
Methylene chloride	ND	5.0	ug/L	1.00	12/05/2002 19:11	
4-Methyl-2-pentanone (MIBK)	ND	50	ug/L	1.00	12/05/2002 19:11	
Naphthalene	ND	1.0	ug/L	1.00	12/05/2002 19:11	
n-Propylbenzene	ND	1.0	ug/L	1.00	12/05/2002 19:11	
Styrene	ND	0.50	ug/L	1.00	12/05/2002 19:11	
1,1,1,2-Tetrachloroethane	ND	0.50	ug/L	1.00	12/05/2002 19:11	
1,1,2,2-Tetrachloroethane	ND	0.50	ug/L	1.00	12/05/2002 19:11	
Tetrachloroethene	ND	0.50	ug/L	1.00	12/05/2002 19:11	
Toluene	ND	0.50	ug/L	1.00	12/05/2002 19:11	
1,2,3-Trichlorobenzene	ND	1.0	ug/L	1.00	12/05/2002 19:11	
1,2,4-Trichlorobenzene	ND	1.0	ug/L	1.00	12/05/2002 19:11	
1,1,1-Trichloroethane	ND	0.50	ug/L	1.00	12/05/2002 19:11	
1,1,2-Trichloroethane	ND	0.50	ug/L	1.00	12/05/2002 19:11	
Trichloroethene	ND	0.50	ug/L	1.00	12/05/2002 19:11	
Trichlorofluoromethane	ND	1.0	ug/L	1.00	12/05/2002 19:11	
Trichlorotrifluoroethane	ND	0.50	ug/L	1.00	12/05/2002 19:11	
1,2,4-Trimethylbenzene	ND	0.50	ug/L	1.00	12/05/2002 19:11	

Severn Trent Laboratories, Inc.

STL San Francisco * 1220 Quarry Lane, Pleasanton, CA 94566

Tel 928 484 1919 Fax 925 484 1096 * www.stl-inc.com * CA DHS ELAP# 2496

12/06/2002 14:24

Volatile Organic Compounds by 8260B (Low Level)

Geomatrix Consultants

Attn.: Robert Cheung

2101 Webster Street, 12th Floor
Oakland, CA 94612
Phone: (510) 663-4299 Fax: (510) 663-4141

Project: 8367.001

Received: 12/04/2002 16:30

Prep(s): 5030B Test(s): 8260B
Sample ID: **GMX-13-1202** Lab ID: 2002-12-0072 - 5
Sampled: 12/04/2002 13:20 Extracted: 12/5/2002 19:11
Matrix: Water QC Batch#: 2002/12/05-01.07

Compound	Conc.	RL	Unit	Dilution	Analyzed	Flag
1,3,5-Trimethylbenzene	ND	0.50	ug/L	1.00	12/05/2002 19:11	
Vinyl acetate	ND	25	ug/L	1.00	12/05/2002 19:11	
Vinyl chloride	ND	0.50	ug/L	1.00	12/05/2002 19:11	
Total xylenes	ND	1.0	ug/L	1.00	12/05/2002 19:11	
Surrogates(s)						
4-Bromofluorobenzene	100.5	86-115	%	1.00	12/05/2002 19:11	
1,2-Dichloroethane-d4	100.8	76-114	%	1.00	12/05/2002 19:11	
Toluene-d8	99.6	88-110	%	1.00	12/05/2002 19:11	

Severn Trent Laboratories, Inc.

STL San Francisco * 1220 Quarry Lane, Pleasanton, CA 94566

Tel 928 484 1919 Fax 925 484 1096 * www.stl-inc.com * CA DHS ELAP# 2496

12/06/2002 14:24

Volatile Organic Compounds by 8260B (Low Level)

Geomatrix Consultants

Attn.: Robert Cheung

2101 Webster Street, 12th Floor
Oakland, CA 94612
Phone: (510) 663-4299 Fax: (510) 663-4141

Project: 8367.001

Received: 12/04/2002 16:30

Batch QC Report

Prep(s): 5030B

Method Blank

MB: 2002/12/05-01.07-006

Water

Test(s): 8260B

QC Batch # 2002/12/05-01.07

Date Extracted: 12/05/2002 13:12

Compound	Conc.	RL	Unit	Analyzed	Flag
MTBE	ND	5.0	ug/L	12/05/2002 13:12	
Acetone	ND	50	ug/L	12/05/2002 13:12	
Benzene	ND	0.5	ug/L	12/05/2002 13:12	
Bromodichloromethane	ND	0.5	ug/L	12/05/2002 13:12	
Bromobenzene	ND	1.0	ug/L	12/05/2002 13:12	
Bromochloromethane	ND	1.0	ug/L	12/05/2002 13:12	
Bromoform	ND	0.5	ug/L	12/05/2002 13:12	
Bromomethane	ND	1.0	ug/L	12/05/2002 13:12	
2-Butanone(MEK)	ND	50	ug/L	12/05/2002 13:12	
n-Butylbenzene	ND	1.0	ug/L	12/05/2002 13:12	
sec-Butylbenzene	ND	1.0	ug/L	12/05/2002 13:12	
tert-Butylbenzene	ND	1.0	ug/L	12/05/2002 13:12	
Carbon disulfide	ND	5.0	ug/L	12/05/2002 13:12	
Carbon tetrachloride	ND	0.5	ug/L	12/05/2002 13:12	
Chlorobenzene	ND	0.5	ug/L	12/05/2002 13:12	
Chloroethane	ND	1.0	ug/L	12/05/2002 13:12	
2-Chloroethylvinyl ether	ND	5.0	ug/L	12/05/2002 13:12	
Chloroform	ND	1.0	ug/L	12/05/2002 13:12	
Chloromethane	ND	1.0	ug/L	12/05/2002 13:12	
2-Chlorotoluene	ND	0.5	ug/L	12/05/2002 13:12	
4-Chlorotoluene	ND	0.5	ug/L	12/05/2002 13:12	
Dibromochloromethane	ND	0.5	ug/L	12/05/2002 13:12	
1,2-Dichlorobenzene	ND	0.5	ug/L	12/05/2002 13:12	
1,3-Dichlorobenzene	ND	0.5	ug/L	12/05/2002 13:12	
1,4-Dichlorobenzene	ND	0.5	ug/L	12/05/2002 13:12	
1,3-Dichloropropane	ND	1.0	ug/L	12/05/2002 13:12	
2,2-Dichloropropane	ND	0.5	ug/L	12/05/2002 13:12	
1,1-Dichloropropene	ND	0.5	ug/L	12/05/2002 13:12	
1,2-Dibromo-3-chloropropane	ND	1.0	ug/L	12/05/2002 13:12	
1,2-Dibromoethane	ND	0.5	ug/L	12/05/2002 13:12	

Severn Trent Laboratories, Inc.

STL San Francisco * 1220 Quarry Lane, Pleasanton, CA 94566

Tel 928 484 1919 Fax 925 484 1096 * www.stl-inc.com * CA DHS ELAP# 2496

12/06/2002 14:24

Volatile Organic Compounds by 8260B (Low Level)

Geomatrix Consultants

Attn.: Robert Cheung

2101 Webster Street, 12th Floor

Oakland, CA 94612

Phone: (510) 663-4299 Fax: (510) 663-4141

Project: 8367.001

Received: 12/04/2002 16:30

Batch QC Report

Prep(s): 5030B

Method Blank

MB: 2002/12/05-01.07-006

Water

Test(s): 8260B

QC Batch # 2002/12/05-01.07

Date Extracted: 12/05/2002 13:12

Compound	Conc.	RL	Unit	Analyzed	Flag
Dibromomethane	ND	0.5	ug/L	12/05/2002 13:12	
Dichlorodifluoromethane	ND	0.5	ug/L	12/05/2002 13:12	
1,1-Dichloroethane	ND	0.5	ug/L	12/05/2002 13:12	
1,2-Dichloroethane	ND	0.5	ug/L	12/05/2002 13:12	
1,1-Dichloroethene	ND	0.5	ug/L	12/05/2002 13:12	
cis-1,2-Dichloroethene	ND	0.5	ug/L	12/05/2002 13:12	
trans-1,2-Dichloroethene	ND	0.5	ug/L	12/05/2002 13:12	
1,2-Dichloropropane	ND	0.5	ug/L	12/05/2002 13:12	
cis-1,3-Dichloropropene	ND	0.5	ug/L	12/05/2002 13:12	
trans-1,3-Dichloropropene	ND	0.5	ug/L	12/05/2002 13:12	
Ethylbenzene	ND	0.5	ug/L	12/05/2002 13:12	
Hexachlorobutadiene	ND	1.0	ug/L	12/05/2002 13:12	
2-Hexanone	ND	50	ug/L	12/05/2002 13:12	
Isopropylbenzene	ND	0.5	ug/L	12/05/2002 13:12	
p-Isopropyltoluene	ND	1.0	ug/L	12/05/2002 13:12	
Methylene chloride	ND	5.0	ug/L	12/05/2002 13:12	
4-Methyl-2-pentanone (MIBK)	ND	50	ug/L	12/05/2002 13:12	
Naphthalene	ND	1.0	ug/L	12/05/2002 13:12	
n-Propylbenzene	ND	1.0	ug/L	12/05/2002 13:12	
Styrene	ND	0.5	ug/L	12/05/2002 13:12	
1,1,1,2-Tetrachloroethane	ND	0.5	ug/L	12/05/2002 13:12	
1,1,2,2-Tetrachloroethane	ND	0.5	ug/L	12/05/2002 13:12	
Tetrachloroethene	ND	0.5	ug/L	12/05/2002 13:12	
Toluene	ND	0.5	ug/L	12/05/2002 13:12	
1,2,3-Trichlorobenzene	ND	1.0	ug/L	12/05/2002 13:12	
1,2,4-Trichlorobenzene	ND	1.0	ug/L	12/05/2002 13:12	
1,1,1-Trichloroethane	ND	0.5	ug/L	12/05/2002 13:12	
1,1,2-Trichloroethane	ND	0.5	ug/L	12/05/2002 13:12	
Trichloroethene	ND	0.5	ug/L	12/05/2002 13:12	
Trichlorofluoromethane	ND	1.0	ug/L	12/05/2002 13:12	
Trichlorotrifluoroethane	ND	0.5	ug/L	12/05/2002 13:12	

Severn Trent Laboratories, Inc.

STL San Francisco * 1220 Quarry Lane, Pleasanton, CA 94566

Tel 928 484 1919 Fax 925 484 1096 * www.stl-inc.com * CA DHS ELAP# 2496

12/06/2002 14:24

Volatile Organic Compounds by 8260B (Low Level)

Geomatrix Consultants

Attn.: Robert Cheung

2101 Webster Street, 12th Floor
Oakland, CA 94612
Phone: (510) 663-4299 Fax: (510) 663-4141

Project: 8367.001

Received: 12/04/2002 16:30

Batch QC Report

Prep(s): 5030B

Method Blank

MB: 2002/12/05-01.07-006

Water

Test(s): 8260B

QC Batch # 2002/12/05-01.07

Date Extracted: 12/05/2002 13:12

Compound	Conc.	RL	Unit	Analyzed	Flag
1,2,4-Trimethylbenzene	ND	0.5	ug/L	12/05/2002 13:12	
1,3,5-Trimethylbenzene	ND	0.5	ug/L	12/05/2002 13:12	
Vinyl acetate	ND	25	ug/L	12/05/2002 13:12	
Vinyl chloride	ND	0.5	ug/L	12/05/2002 13:12	
Total xylenes	ND	1.0	ug/L	12/05/2002 13:12	
Surrogates(s)					
4-Bromofluorobenzene	99.2	86-115	%	12/05/2002 13:12	
1,2-Dichloroethane-d4	101.9	76-114	%	12/05/2002 13:12	
Toluene-d8	99.9	88-110	%	12/05/2002 13:12	

Severn Trent Laboratories, Inc.

STL San Francisco * 1220 Quarry Lane, Pleasanton, CA 94566

Tel 928 484 1919 Fax 925 484 1096 * www.stl-inc.com * CA DHS ELAP# 2496

12/06/2002 14:24

Volatile Organic Compounds by 8260B (Low Level)

Geomatrix Consultants

Attn.: Robert Cheung

2101 Webster Street, 12th Floor
Oakland, CA 94612
Phone: (510) 663-4299 Fax: (510) 663-4141

Project: 8367.001

Received: 12/04/2002 16:30

Batch QC Report

Prep(s): 5030B

Test(s): 8260B

Laboratory Control Spike

Water

QC Batch # 2002/12/05-01.07

LCS 2002/12/05-01.07-004

Extracted: 12/05/2002

Analyzed: 12/05/2002 12:24

LCSD 2002/12/05-01.07-005

Extracted: 12/05/2002

Analyzed: 12/05/2002 12:48

Compound	Conc. ug/L		Exp. Conc.	Recovery		RPD	Ctrl.Limits %		Flags	
	LCS	LCSD		LCS	LCSD		%	Rec.	RPD	LCS
Benzene	17.8	20.0	20.0	89.0	100.0	11.6	69-129	20		
Chlorobenzene	19.8	21.5	20.0	99.0	107.5	8.2	61-121	20		
1,1-Dichloroethene	16.6	18.5	20.0	83.0	92.5	10.8	65-125	20		
Toluene	19.1	21.6	20.0	95.5	108.0	12.3	70-130	20		
Trichloroethene	17.5	19.3	20.0	87.5	96.5	9.8	74-134	20		
Surrogates(s)										
4-Bromofluorobenzene	498	493	500	99.6	98.6		86-115			
1,2-Dichloroethane-d4	486	489	500	97.2	97.8		76-114			
Toluene-d8	482	487	500	96.4	97.4		88-110			

Severn Trent Laboratories, Inc.

STL San Francisco * 1220 Quarry Lane, Pleasanton, CA 94566

Tel 928 484 1919 Fax 925 484 1096 * www.stl-inc.com * CA DHS ELAP# 2496

12/06/2002 14:24

70609

Chain-of Custody Record

016159

Date: 12/4/02

Page 1 of 1

Project No.: 8367.001

ANALYSES

REMARKS

Samplers (Signature):
Sarah Mearon

Additional Comments
2002-12-0072

Date	Time	Sample Number	EPA Method 8021 (Full Scan)	EPA Method 8021 (Hal. VOCs only)	EPA Method 8021 (BTEX only)	EPA Method 8260 VOCs	EPA Method 8270 (Full Scan)	EPA Method 8270 SIM (PAHS only)	Method 8015m (Gasoline)	Method 8015m (Diesel)	Method 8015m (Motor Oil)	Silica Gel Cleanup	Soil (S), Water (W), Vapor (V), or Other (o)	Filtered	Preserved	Cooled	No. of Containers	REMARKS
12/4/02	1200	GMX-11-1202				X							W		X	X	3	40mL VOAs pres. w/HCl
	1225	GMX-15-1202				X							W		X	X	3	
	1245	GMX-14-1202				X							W		X	X	3	
	1300	GMX-12-1202				X							W		X	X	3	
✓	1320	GMX-13-1202				X							W		X	X	3	
SAF 12/4/02																		

RUSH

Laboratory: *STL San Francisco*

Turnaround Time: *48-hour*

Results to: *Robert Cheung*

Total No. of Containers: *15*

Relinquished by (Signature): *Sarah Mearon*
Printed Name: *Sarah Mearon*
Company: *Geomatrix*

Date: *12/4*
Time: *1415*

Relinquished by (Signature):
Printed Name:
Company:

Date:
Time:

Relinquished by (Signature):
Printed Name:
Company:

Date:
Time:

Method of Shipment: *courier*
Laboratory Comments and Log No.:
cooler rec'd sealed DSF

Received by:
Printed Name:
Company:

Date:
Time:

Received by:
Printed Name:
Company:

Date:
Time:

Received by: *Deuse Harrington*
Printed Name: *D Harrington*
Company: *STL-SF*

Date: *12/4/02*
Time: *1630*

41°C World Courier
 **Geomatrix Consultants**
2101 Webster Street, 12th Floor • Oakland, CA 94612
Phone: 510-663-4100 Fax: 510-663-4141

Sample Receipt Checklist

Submission #: 2002- 12 - 0072

Checklist completed by: (initials) DSH Date: 12/04/02

Courier name: STL San Francisco Client World Courier

Custody seals intact on shipping container/samples

Yes No Not Present

Chain of custody present?

Yes No

Chain of custody signed when relinquished and received?

Yes No

Chain of custody agrees with sample labels?

Yes No

Samples in proper container/bottle?

Yes No

Sample containers intact?

Yes No

Sufficient sample volume for indicated test?

Yes No

All samples received within holding time?

Yes No

Container/Temp Blank temperature in compliance ($4^{\circ}C \pm 2$)?

Temp: 4.1 °C Yes No

Water - VOA vials have zero headspace?

No VOA vials submitted Yes No

(if bubble is present, refer to approximate bubble size and itemize in comments as S (small -), M (medium -) or L (large -)

Water - pH acceptable upon receipt? Yes No

pH adjusted- Preservative used: HNO₃ HCl H₂SO₄ NaOH ZnOAc

For any item check-listed "No", provided detail of discrepancy in comment section below:

Comments:

Project Management [Routing for instruction of indicated discrepancy(ies)]

Project Manager: (initials) _____ Date: ____/____/02

Client contacted: Yes No

Summary of discussion:

Corrective Action (per PM/Client):