

5 November 2004
Project No. 3433.08

Mr. Barney Chan
Alameda County Environmental Health Services
1131 Harbor Bay Parkway, 2nd Floor
Alameda, California 94502

Subject: Final Project Completion
Mandela Gateway
1350-1400 Seventh Street
Oakland, California 94607

Dear Mr. Chan:

This letter report documents the completion of required soil management actions at the Mandela Gateway site in Oakland, California. The report was prepared by Treadwell & Rollo, Inc. (Treadwell & Rollo) on behalf of Mandela Gateway Associates and is based on observations made by Treadwell & Rollo personnel and information provided to Treadwell & Rollo by Mandela Gateway Associates and James E. Roberts-Obayashi Corporation, the general contractor for the development.

Background

The Mandela Gateway site is located at 1350 and 1400 Seventh Street in Oakland, California (Figure 1). The site consists of two partial blocks between Seventh and Eighth Streets (West Block and East Block) and is bisected by Mandela Parkway. Mandela Gateway Associates has redeveloped the site for mixed residential and commercial use, with multi-story structures that include parking garages, retail space, and residential units. A site plan of the redeveloped site is presented in Figure 2.

Extensive environmental sampling was performed by Treadwell & Rollo prior to and in support of site redevelopment. Soil sample locations are shown in Figure 3. The results of this sampling indicated the presence of residual chemicals in some shallow soil locations that exceeded calculated risk-based target levels for future site use. Chemicals found exceeding these concentrations included lead and pesticides in the West Block and lead and petroleum hydrocarbons in the East Block. The occurrence of chemicals in soil with respect to concentrations, location, and depth was reported in the Treadwell & Rollo 5 May 2003 *Soil*

Mr. Barney Chan
Alameda County Environmental Health Services
5 November 2004
Page 2

Management and Removal Plan, Mandela Gateway Redevelopment Site, Seventh Street and Mandela Parkway, Oakland, California (SMRP).

Treadwell & Rollo, in consultation with the Alameda County Environmental Health Services (ACEH), developed soil-management activities for safely managing the site soil in a manner protective of public health and the environment, which were defined in the *SMRP*. The *SMRP* was approved by ACEH in its 23 May 2003 letter titled *Site #RO0002517, Mandela Gateway Redevelopment Site, Seventh Street and Mandela Parkway, Oakland, CA 94607*. In addition to activities to be performed during construction, additional measures to mitigate potential exposure to future site residents included the imposition of a deed restriction on the property and preparation of a Final Soil Management Plan (*FSMP*). The purpose of the *FSMP* was to define practices protective of future site users should future site work, such as underground utility repairs, require disturbance of the site cap. The Treadwell & Rollo *Final Soil Management Plan, Mandela Gateway Redevelopment Site, Seventh Street and Mandela Parkway, Oakland, California*, was submitted to ACEH on 4 April 2004.

Redevelopment of the site required significant excavation and movement of soil. Soil management activities during construction included health and safety procedures, dust control, profiling and off-site disposal of soil meeting criteria for hazardous waste, and capping of soil left on site that contained residual chemicals exceeding the risk-based target levels. The majority of these actions were completed between March 2003 and April 2004. The Treadwell & Rollo report titled *Soil Management and Removal Documentation Report, Mandela Gateway Redevelopment Site, Seventh Street and Mandela Parkway, Oakland, California (SMRDR)*, submitted to ACEH on 13 April 2004, documented these activities.

At the time the *SMRDR* was submitted, all soil management activities were completed, with the exception of soil capping in four discrete and relatively small landscaped areas. The remaining areas containing chemicals exceeding target levels and where soil capping was to be completed included:

- in the West Block: (1) the narrow landscaped area between the podium area and Mandela Parkway, and (2) two areas of the landscaped margins of the parking lot; and
- in the East Block, the Town Square.

In addition, two landscaped areas north of the private drive in the East Block, although not associated with confirmed residual chemical exceedances, were planned for covering with two feet of clean fill. These areas are shown on Figure 4.

This report documents the performance of these final soil management activities and provides final "as-built" figures showing the locations and thicknesses of clean fill at the Site.

Mr. Barney Chan
Alameda County Environmental Health Services
5 November 2004
Page 3

Final Soil Management Activities

Figures 5 and 6 show the final soil placement on the West Block and East Block, respectively. The figures show the locations of fill placed to reach the finished site grade and to replace contaminated soil removed from "focused" excavations. This fill placement took place during the period from March 2003 to September 2004. Fill placement prior to April 2004 was previously described in the *SMRDR*, with the exception of the building pads north of the private drive and initial grading in the Town Square, both in the East Block. These actions are described below, along with fill placement since April 2004.

West Block

During the week of 21 June 2004, approximately 130 cubic yards (cy) of soil was moved from the East Block and placed in the West Block landscaped area between the podium structure and the sidewalk along Mandela Parkway. This soil was generated during excavation for the joint utility trench in the East Block private drive and consisted of previously imported clean fill from the Letterman Digital Arts Center (Letterman site). Documentation that this soil met import requirements for the site was provided in the *SMRDR*.

During the week of 6 September 2004, approximately 45 cy of clean imported fill was placed in the landscaped strips to the north and northeast of the parking lot. The areas capped are shown in Figure 4. The source of this fill was clean imported soil excavated at the Greek Orthodox Church of the Ascension in Oakland, California. This soil was previously approved for import to the site in June 2004. A letter discussing Treadwell & Rollo's evaluation and approval activities and laboratory reports for samples of this soil, are provided in Attachment A (on CD-ROM).

As shown in Figure 5, the thickness of the clean soil cap in the landscaped areas of the West Block is 2 feet in the area east of the podium and from 2 to 2.5 feet in the landscaped strips bordering the parking lot. This completes the soil management activities in the West Block.

East Block

During backfilling of the podium area in June 2003, a working surface was constructed in the Town Square area with clean imported fill from the Letterman site, which was also used as backfill in the podium area. This backfilling covered the native-soil surface in this area with up to three feet of fill in the central part of the Town Square, meeting the requirement for at least two feet of clean fill.

Mr. Barney Chan
Alameda County Environmental Health Services
5 November 2004
Page 4

The building pads for buildings north of the private drive were constructed in October 2003. Because of the natural slope of the site, these pads added more than one foot of soil in the southern part of the pads, decreasing to less than one-half foot in the northern part, as shown in Figure 6. The fill material used was Letterman originally placed in the podium area but later excavated for foundation construction.

During the week of 20 September 2004, approximately 30 cy of clean imported soil was placed in the landscaped areas north of the private drive shown in Figure 4. The source of this soil was the Greek Orthodox Church site discussed above.

As shown in Figure 6, the thickness of the clean soil cap in the landscaped areas of the East Block is two feet in the areas north of the private drive and more than two feet in the landscaped areas of the Town Square. This completes the soil management activities in the West Block.

Summary and Conclusions

The Mandela Gateway site has been redeveloped for mixed residential and commercial use. To protect redevelopment workers and future site users, the 5 May 2003 *Soil Management and Removal Plan, Mandela Gateway Redevelopment Site, Seventh Street and Mandela Parkway, Oakland, California* defined soil management activities necessary to address residual chemicals in site soil. These soil management procedures were approved by the ACEH.

Performance of the required soil management activities from March 2003 to April 2004 were documented in the *Soil Management and Removal Documentation Report, Mandela Gateway Redevelopment Site, Seventh Street and Mandela Parkway, Oakland, California (SMRDR)*, which was submitted to ACEH on 13 April 2004. In this letter, Treadwell & Rollo has documented the final required soil management activities: the capping of discrete landscaped areas in the West and East Blocks of the site.

A *Final Soil Management Plan, Mandela Gateway Redevelopment Site, Seventh Street and Mandela Parkway, Oakland, California (FSMP)* was submitted to ACEH on 4 April 2004 containing procedures for maintaining the cap at the site for continuing protection of site users in the future. A deed restriction has also been submitted to ACEH that, when filed, will ensure procedures stipulated in the *FSMP* will be followed in the future.

With the final capping activities in landscaped areas described in this letter, and the submittal of the *FSMP* and deed restriction, soil management activities have been completed. We request ACEH issue a "No Further Action" letter for the Mandela Gateway site.

Treadwell&Rollo

Mr. Barney Chan
Alameda County Environmental Health Services
5 November 2004
Page 5

We appreciate the opportunity to work with you on this project. If you have any questions, please call.

Sincerely yours,
TREADWELL & ROLLO, INC.

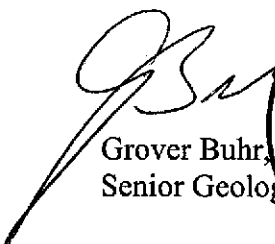
GROVER BUHR
REGISTERED GEOLOGIST
No. 5596
STATE OF CALIFORNIA

Grover Buhr, R.G.
Senior Geologist

34330826.OAK

Attachment

MICHAEL P. MCGUIRE
REGISTERED PROFESSIONAL ENGINEER
No. 42555
Exp. 3-25-04
CIVIL
STATE OF CALIFORNIA

Michael P. McGuire, P.E.
Principal Engineer

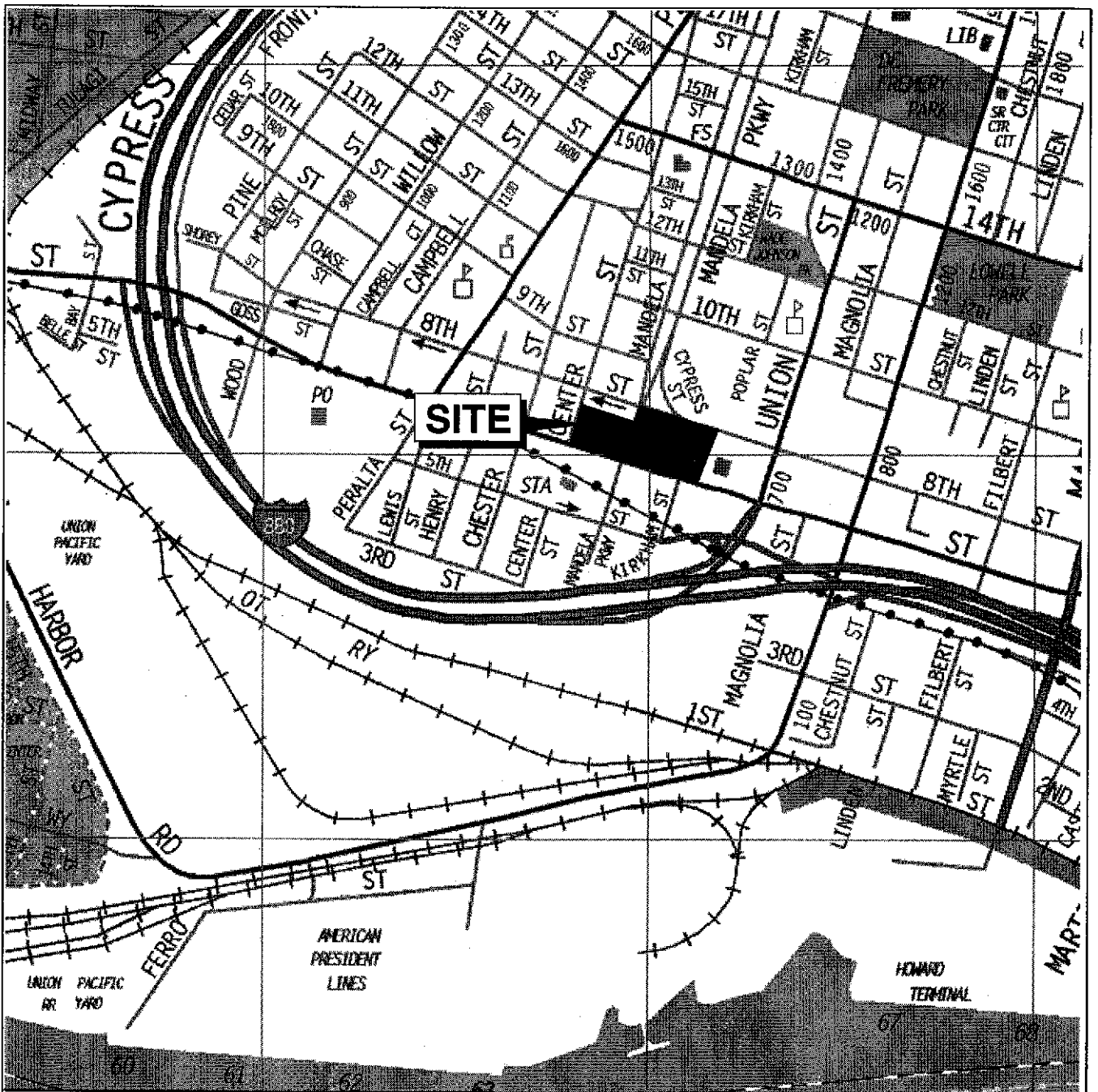

Base map: The Thomas Guide
 Alameda County
 1999



No scale

MANDELA GATEWAY
 1350 - 1400 Seventh Street
 Oakland, California

SITE LOCATION MAP

Treadwell & Rollo

Date 03/16/04

Project No. 3433.08

Figure 1

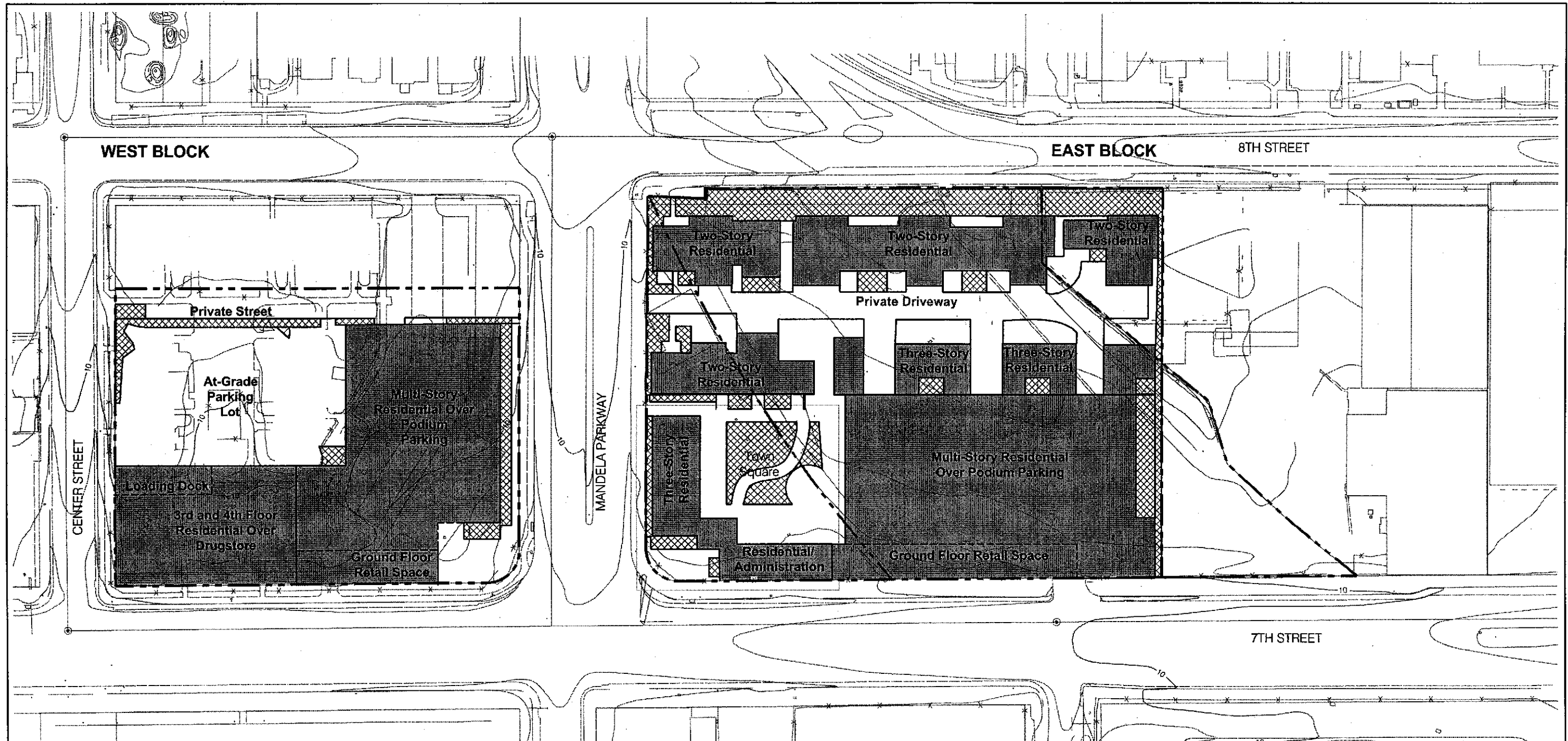

- EXPLANATION
- Existing site boundary
 - - - Former property line
 - Building
 - ▨ Landscaped Areas or Mixed Landscape and Walkways
 - Paved areas

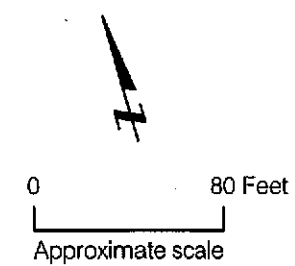

MANDELA GATEWAY 1350 - 1400 Seventh Street Oakland, California		
SITE PLAN		
Date 08/19/04	Project No. 3433.08	Figure 2

343308_SITEPLAN.DWG

Reference: 1. DK Associates, "Topographic Survey - Mandela Gateway", May 30, 2002.
 2. Site plan prepared by Michael Willis Architects, dated 11 July 2002.

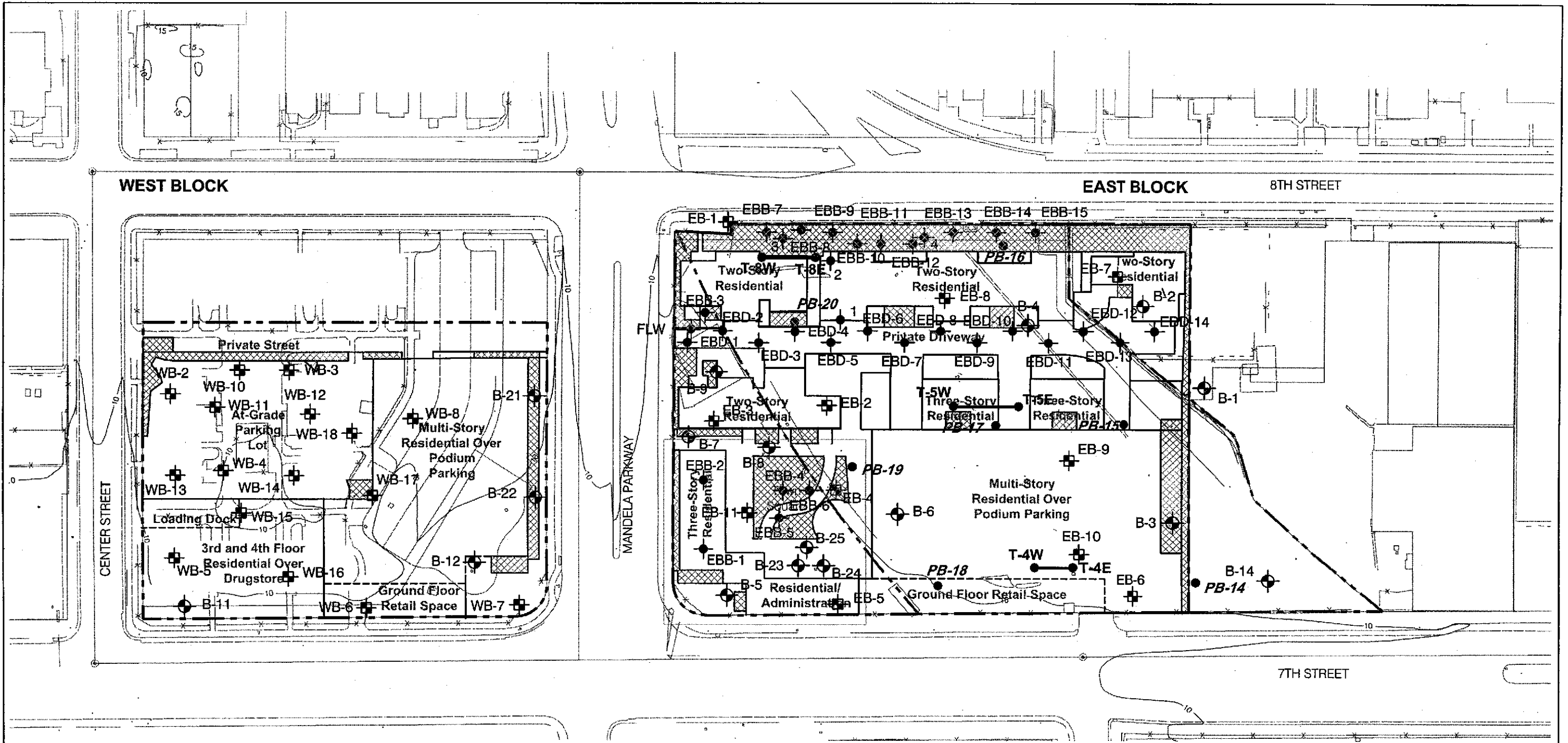

WEST BLOCK

EAST BLOCK

8TH STREET

CENTER STREET

MANDELA PARKWAY

7TH STREET

- EXPLANATION
- Existing site boundary
 - - - Former property line
 - ▨ Landscaped Areas or Mixed Landscape and Walkways
 - ⊕ Approximate locations of soil samples during different phases of investigations

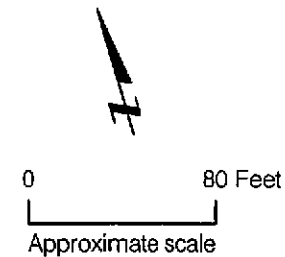





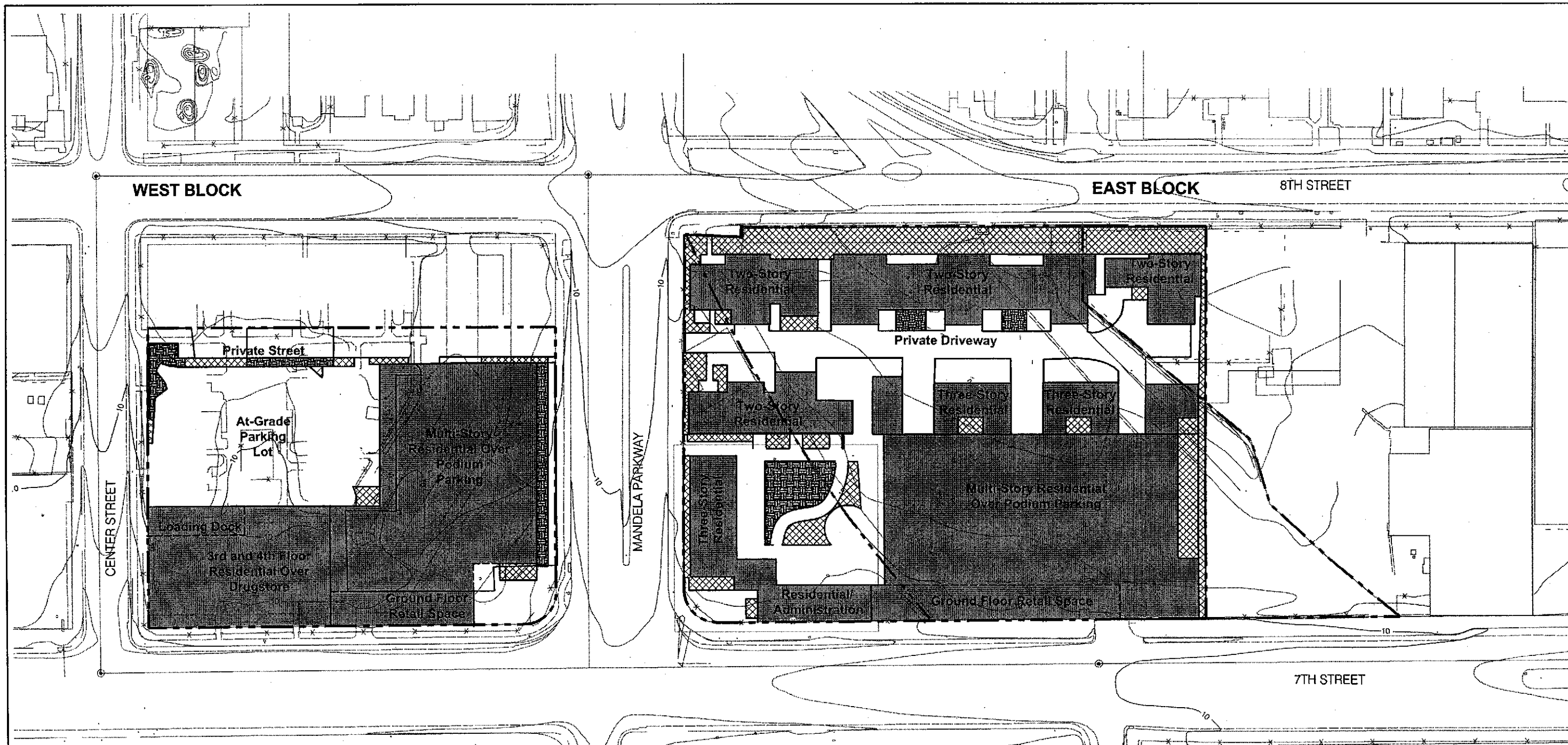

MANDELA GATEWAY 1350 - 1400 Seventh Street Oakland, California		
SAMPLE LOCATION PLAN		
Date 08/19/04	Project No. 3433.08	Figure 3

343308_SampleLocationPlan.DWG

Reference: 1. DK Associates, "Topographic Survey - Mandela Gateway", May 30, 2002.
 2. Site plan prepared by Michael Willis Architects, dated 11 July 2002.



EXPLANATION

-  Existing site boundary
-  Former property line
-  Building
-  Landscaped Areas or Mixed Landscape and Walkways
-  Paved areas
-  Remaining areas capped with clean soil since 13 April 2004

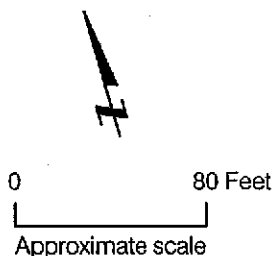

MANDELA GATEWAY 1350 - 1400 Seventh Street Oakland, California		
SOIL CAP AREAS AFTER APRIL 2004		
Date 08/19/04	Project No. 3433.08	Figure 4
Treadwell&Rollo		

Reference: 1. DK Associates, "Topographic Survey - Mandela Gateway", May 30, 2002.
2. Site plan prepared by Michael Willis Architects, dated 11 July 2002.

343308_SoilCapAreas.dwg

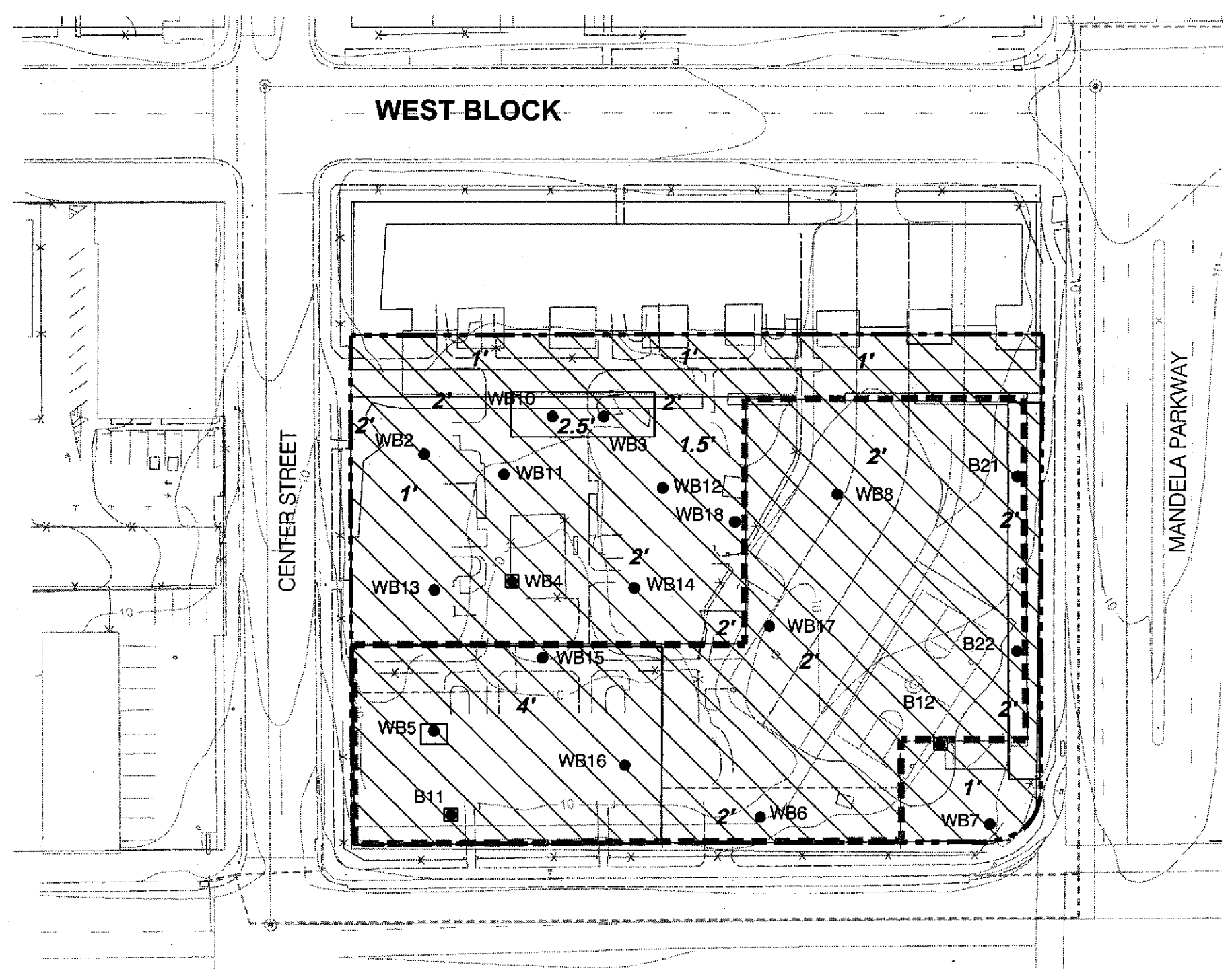

- EXPLANATION
- Existing property line
 - Podium area (soil excavation and recompaction)
 - WB2 ● Approximate location of soil sample
 - ▨ Clean Letterman fill
 - Area of focussed excavation
 - 2' Thickness of fill

34.3308_FinalSoilPlacementEast.dwg

Reference: 1. DK Associates, "Topographic Survey - Mandela Gateway", May 30, 2002.
 2. Site plan prepared by Michael Willis Architects, dated 11 July 2002.

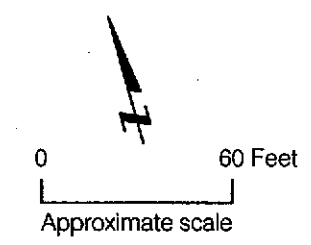

MANDELA GATEWAY 1350 - 1400 Seventh Street Oakland, California		
FINAL SOIL PLACEMENT WEST BLOCK		
Date 08/19/04	Project No. 3433.08	Figure 5

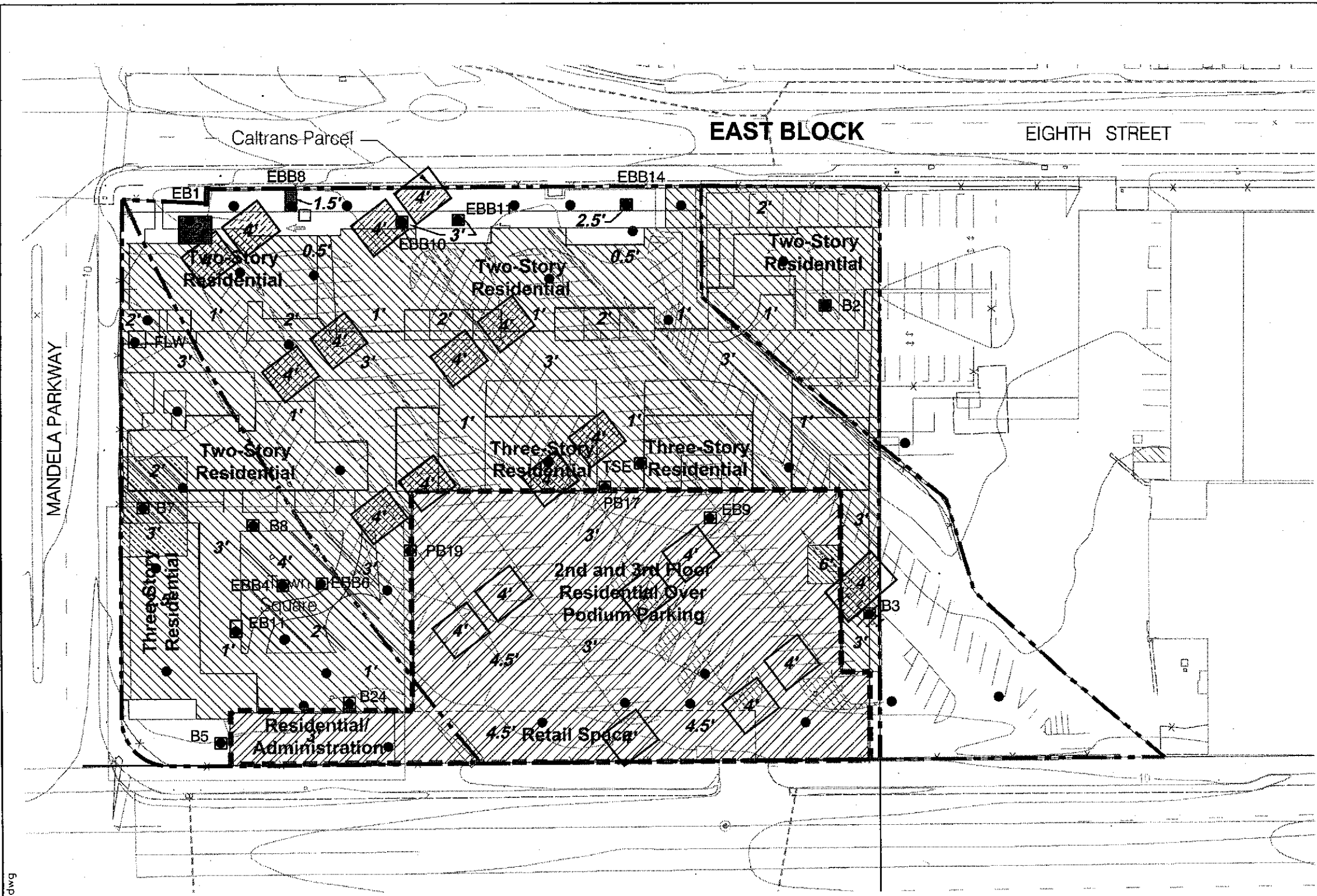

EXPLANATION	
	Existing property line
	Former property lines
	Area of over excavation and recompaction
	Approximate location of former pile cap excavation
	Approximate location of soil sample
	RC Knapp stockyard soil "Hoedown up" fill
	Letterman fill source
	Dune sand (Greyhound) fill
	Dune sand fill topped with Letterman fill
	Podium excavated fill and Letterman fill
2'	Thickness of fill, in feet

MANDELA GATEWAY 1350 - 1400 Seventh Street Oakland, California		
FINAL SOIL PLACEMENT EAST BLOCK		
Date 08/19/04	Project No. 3433.08	Figure 6

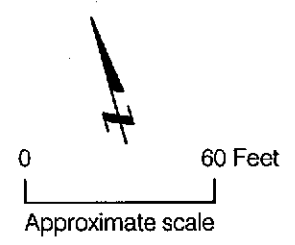

343308_FinalSoilPlacementEastBlock.dwg

Reference: 1. DK Associates, "Topographic Survey - Mandela Gateway", May 30, 2002.
 2. Site plan prepared by Michael Willis Architects, dated 11 July 2002.

FILE COPY

Treadwell & Rollo

10 June 2004
Project No. 3433.09

Mr. Jesse Wu
BRIDGE Housing Corporation
345 Spear Street, Suite 700
San Francisco, California 94105-1673

Subject: Acceptance of Soil from Greek Orthodox Cathedral of the Ascension
Parcel A Townhomes
Eighth Street and Mandela Parkway
Oakland, California

Dear Mr. Wu:

On 7 April 2004, you requested Treadwell & Rollo, Inc. to evaluate approximately 1,500 cubic yards of excavated soil at the Greek Orthodox Cathedral of the Ascension, located at 4700 Lincoln Avenue in Oakland, California, for its appropriateness as imported fill at the Parcel A site.

We evaluated this soil with respect to its chemical constituents and geotechnical properties in conformance with criteria set forth in:

- the Treadwell & Rollo 5 May 2003 *Soil Management and Removal Plan, Mandela Gateway Redevelopment Site, Seventh Street and Mandela Parkway, Oakland, California*;
- the Treadwell & Rollo 8 August 2003 letter *Imported Soil Acceptance Criteria, Mandela Gateway Redevelopment Site, Seventh Street and Mandela Parkway, Oakland, California*;
- the Alameda County Environmental Health Services Division's (ACEH) 14 August 2003 letter *Soil Reuse Criteria for Mandela Gateway Project, Seventh Street and Mandela Parkway, Oakland, CA 94607*;
- the Treadwell & Rollo 10 October 2003 *Geotechnical Investigation, Parcel A - Parcel Map 8058, Oakland, California*.

To evaluate this soil, we reviewed a previous environmental report for the church site, collected and analyzed six soil samples, and reviewed the laboratory results. Soil at the church has been excavated to depths up to 30 feet below the ground surface as part of construction of a parking garage. The soil in question was excavated from depths between 5 and 20 feet bgs, and has not been previously disturbed, so we consider it "native" soil. Based on our review of a 30 October 2003 report titled *Environmental Site Assessment, Greek Orthodox Cathedral of the Ascension, 4700 Lincoln Avenue, Oakland, California*, prepared by RGA Environmental, Inc. of Emeryville, California, there appear to be no environmental conditions at the site that indicate the release of hazardous materials or petroleum products to this soil.

Mr. Jesse Wu
BRIDGE Housing Corporation
10 June 2003
Page 2

On 20 April 2004, Treadwell & Rollo personnel collected six discrete, representative soil samples for analytical testing. These samples were analyzed by STL-San Francisco Laboratory of Pleasanton, California for organochlorine pesticides by EPA Method 3550/8081 and total lead by EPA Method 3050B. No pesticides were detected. Lead was detected at concentrations that ranged from 3.4 milligrams per kilogram (mg/kg) to 23 mg/kg. These concentrations are below remedial target levels for Parcel A, the acceptance criteria for import fill set forth in the documents cited above, and waste disposal criteria.

Based on our observation at the church site, the results of the environmental site assessment report, and our analysis of the samples, this soil is acceptable with respect to chemical criteria for import to Parcel A. As required in the Treadwell & Rollo *SMRP*, the test results, soil volumes, and placement locations for imported fill will be described in the final Soil Management and Removal Documentation Report, to be prepared at the completion of the project.

In addition to the chemical testing, we collected one bulk sample of the proposed import soil to measure the plasticity index (PI) in accordance with the geotechnical acceptance criteria. The results of the testing indicate the sample has a liquid limit of 26 and a PI of 6, which meets the acceptance criteria in our geotechnical investigation report. Therefore, we conclude the soil is also acceptable for use at the site from a geotechnical standpoint.

Please do not hesitate to call if you have any questions.

Sincerely yours,
TREADWELL & ROLLO, INC.

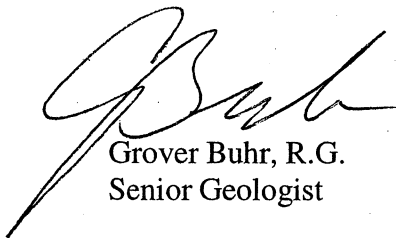

Grover Buhr, R.G.
Senior Geologist



Michael P. McGuire, P.E.
Principal Engineer

34330913.OAK

cc: Mr. John Gregory, Farella Braun + Martel

Treadwell & Rollo Oakland

April 27, 2004

501 14th Street, third floor
Oakland, CA 94612

Attn.: Grover Buhr

Project#: 3433.09

Project: Mandela Import(Greek Orthodox Church)

Dear Mr. Buhr,

Attached is our report for your samples received on 04/20/2004 17:15

This report has been reviewed and approved for release. Reproduction of this report is permitted only in its entirety.

Please note that any unused portion of the samples will be discarded after 06/04/2004 unless you have requested otherwise.

We appreciate the opportunity to be of service to you. If you have any questions, please call me at (925) 484-1919.

You can also contact me via email. My email address is: ssidhu@stl-inc.com

Sincerely,

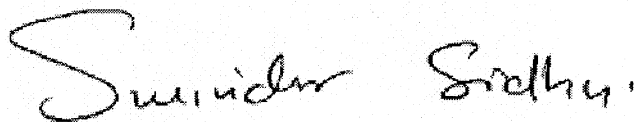

Surinder Sidhu
Project Manager

Severn Trent Laboratories, Inc.

STL San Francisco * 1220 Quarry Lane, Pleasanton, CA 94566

Tel 925 484 1919 Fax 925 484 1096 * www.stl-inc.com * CA DHS ELAP# 2496

Total Lead

Treadwell & Rollo Oakland

Attn.: Grover Buhr

501 14th Street, third floor

Oakland, CA 94612

Phone: (510) 874-4500 Fax: (510) 874-4507

Project: 3433.09

Received: 04/20/2004 17:15

Mandela Import(Greek Orthodox Church)

Samples Reported

Sample Name	Date Sampled	Matrix	Lab #
GC-1	04/20/2004 07:10	Soil	1
GC-2	04/20/2004 07:12	Soil	2
GC-3	04/20/2004 07:14	Soil	3
GC-4	04/20/2004 07:16	Soil	4
GC-5	04/20/2004 07:18	Soil	5
GC-6	04/20/2004 07:20	Soil	6

Total Lead

Treadwell & Rollo Oakland

Attn.: Grover Buhr

501 14th Street, third floor

Oakland, CA 94612

Phone: (510) 874-4500 Fax: (510) 874-4507

Project: 3433.09

Mandela Import(Greek Orthodox Church)

Received: 04/20/2004 17:15

Prep(s): 3050B	Test(s): 6010B
Sample ID: GC-1	Lab ID: 2004-04-0612 - 1
Sampled: 04/20/2004 07:10	Extracted: 4/21/2004 14:22
Matrix: Soil	QC Batch#: 2004/04/21-05.15

Compound	Conc.	RL	Unit	Dilution	Analyzed	Flag
Lead	5.1	1.0	mg/Kg	1.00	04/22/2004 22:20	

Total Lead

Treadwell & Rollo Oakland

Attn.: Grover Buhr

501 14th Street, third floor

Oakland, CA 94612

Phone: (510) 874-4500 Fax: (510) 874-4507

Project: 3433.09

Mandela Import(Greek Orthodox Church)

Received: 04/20/2004 17:15

Prep(s): 3050B	Test(s): 6010B
Sample ID: GC-2	Lab ID: 2004-04-0612 - 2
Sampled: 04/20/2004 07:12	Extracted: 4/21/2004 14:22
Matrix: Soil	QC Batch#: 2004/04/21-05.15

Compound	Conc.	RL	Unit	Dilution	Analyzed	Flag
Lead	5.8	1.0	mg/Kg	1.00	04/22/2004 22:45	

Total Lead

Treadwell & Rollo Oakland

Attn.: Grover Buhr

501 14th Street, third floor

Oakland, CA 94612

Phone: (510) 874-4500 Fax: (510) 874-4507

Project: 3433.09

Mandela Import(Greek Orthodox Church)

Received: 04/20/2004 17:15

Prep(s):	3050B	Test(s):	6010B
Sample ID:	GC-3	Lab ID:	2004-04-0612 - 3
Sampled:	04/20/2004 07:14	Extracted:	4/21/2004 14:22
Matrix:	Soil	QC Batch#:	2004/04/21-05.15

Compound	Conc.	RL	Unit	Dilution	Analyzed	Flag
Lead	3.4	1.0	mg/Kg	1.00	04/22/2004 22:48	

Total Lead

Treadwell & Rollo Oakland

Attn.: Grover Buhr

501 14th Street, third floor

Oakland, CA 94612

Phone: (510) 874-4500 Fax: (510) 874-4507

Project: 3433.09

Mandela Import(Greek Orthodox Church)

Received: 04/20/2004 17:15

Prep(s): 3050B	Test(s): 6010B
Sample ID: GC-4	Lab ID: 2004-04-0612 - 4
Sampled: 04/20/2004 07:16	Extracted: 4/21/2004 14:22
Matrix: Soil	QC Batch#: 2004/04/21-05.15

Compound	Conc.	RL	Unit	Dilution	Analyzed	Flag
Lead	6.6	1.0	mg/Kg	1.00	04/22/2004 22:51	

Total Lead

Treadwell & Rollo Oakland

Attn.: Grover Buhr

501 14th Street, third floor

Oakland, CA 94612

Phone: (510) 874-4500 Fax: (510) 874-4507

Project: 3433.09

Mandela Import(Greek Orthodox Church)

Received: 04/20/2004 17:15

Prep(s):	3050B	Test(s):	6010B
Sample ID:	GC-5	Lab ID:	2004-04-0612 - 5
Sampled:	04/20/2004 07:18	Extracted:	4/21/2004 14:22
Matrix:	Soil	QC Batch#:	2004/04/21-05.15

Compound	Conc.	RL	Unit	Dilution	Analyzed	Flag
Lead	4.8	1.0	mg/Kg	1.00	04/22/2004 22:55	

Total Lead

Treadwell & Rollo Oakland

Attn.: Grover Buhr

501 14th Street, third floor

Oakland, CA 94612

Phone: (510) 874-4500 Fax: (510) 874-4507

Project: 3433.09

Mandela Import(Greek Orthodox Church)

Received: 04/20/2004 17:15

Prep(s): 3050B	Test(s): 6010B
Sample ID: GC-6	Lab ID: 2004-04-0612 - 6
Sampled: 04/20/2004 07:20	Extracted: 4/21/2004 14:22
Matrix: Soil	QC Batch#: 2004/04/21-05.15

Compound	Conc.	RL	Unit	Dilution	Analyzed	Flag
Lead	23	1.0	mg/Kg	1.00	04/22/2004 22:58	

Total Lead

Treadwell & Rollo Oakland

Attn.: Grover Buhr

501 14th Street, third floor

Oakland, CA 94612

Phone: (510) 874-4500 Fax: (510) 874-4507

Project: 3433.09

Mandela Import(Greek Orthodox Church)

Received: 04/20/2004 17:15

Batch QC Report					
Prep(s): 3050B					Test(s): 6010B
Method Blank		Soil			QC Batch # 2004/04/21-05.15
MB: 2004/04/21-05.15-035					Date Extracted: 04/21/2004 14:22

Compound	Conc.	RL	Unit	Analyzed	Flag
Lead	ND	1.0	mg/Kg	04/22/2004 21:14	

Total Lead

Treadwell & Rollo Oakland

Attn.: Grover Buhr

501 14th Street, third floor

Oakland, CA 94612

Phone: (510) 874-4500 Fax: (510) 874-4507

Project: 3433.09

Mandela Import(Greek Orthodox Church)

Received: 04/20/2004 17:15

Batch QC Report										
Prep(s): 3050B							Test(s): 6010B			
Laboratory Control Spike				Soil			QC Batch # 2004/04/21-05.15			
LCS	2004/04/21-05.15-036			Extracted: 04/21/2004			Analyzed: 04/22/2004 21:18			
LCSD	2004/04/21-05.15-037			Extracted: 04/21/2004			Analyzed: 04/22/2004 21:22			
Compound	Conc. mg/Kg		Exp.Conc.	Recovery %		RPD	Ctrl.Limits %		Flags	
	LCS	LCSD		LCS	LCSD		%	Rec.	RPD	LCS
Lead	91.1	92.3	100.0	91.1	92.3	1.3	80-120	20		

Organochlorine Pesticides Analysis

Treadwell & Rollo Oakland

Attn.: Grover Buhr

501 14th Street, third floor

Oakland, CA 94612

Phone: (510) 874-4500 Fax: (510) 874-4507

Project: 3433.09

Received: 04/20/2004 17:15

Mandela Import(Greek Orthodox Church)

Samples Reported

Sample Name	Date Sampled	Matrix	Lab #
GC-1	04/20/2004 07:10	Soil	1
GC-2	04/20/2004 07:12	Soil	2
GC-3	04/20/2004 07:14	Soil	3
GC-4	04/20/2004 07:16	Soil	4
GC-5	04/20/2004 07:18	Soil	5
GC-6	04/20/2004 07:20	Soil	6

Organochlorine Pesticides Analysis

Treadwell & Rollo Oakland

Attn.: Grover Buhr

501 14th Street, third floor

Oakland, CA 94612

Phone: (510) 874-4500 Fax: (510) 874-4507

Project: 3433.09

Mandela Import(Greek Orthodox Church)

Received: 04/20/2004 17:15

Prep(s): 3550/8081	Test(s): 8081
Sample ID: GC-1	Lab ID: 2004-04-0612 - 1
Sampled: 04/20/2004 07:10	Extracted: 4/21/2004 12:59
Matrix: Soil	QC Batch#: 2004/04/21-01.13

Compound	Conc.	RL	Unit	Dilution	Analyzed	Flag
Aldrin	ND	2.0	ug/Kg	1.00	04/23/2004 13:56	
Dieldrin	ND	2.0	ug/Kg	1.00	04/23/2004 13:56	
Endrin aldehyde	ND	2.0	ug/Kg	1.00	04/23/2004 13:56	
Endrin	ND	2.0	ug/Kg	1.00	04/23/2004 13:56	
Endrin ketone	ND	2.0	ug/Kg	1.00	04/23/2004 13:56	
Heptachlor	ND	2.0	ug/Kg	1.00	04/23/2004 13:56	
Heptachlor epoxide	ND	2.0	ug/Kg	1.00	04/23/2004 13:56	
4,4'-DDT	ND	2.0	ug/Kg	1.00	04/23/2004 13:56	
4,4'-DDE	ND	2.0	ug/Kg	1.00	04/23/2004 13:56	
4,4'-DDD	ND	2.0	ug/Kg	1.00	04/23/2004 13:56	
Endosulfan I	ND	2.0	ug/Kg	1.00	04/23/2004 13:56	
Endosulfan II	ND	2.0	ug/Kg	1.00	04/23/2004 13:56	
alpha-BHC	ND	2.0	ug/Kg	1.00	04/23/2004 13:56	
beta-BHC	ND	2.0	ug/Kg	1.00	04/23/2004 13:56	
gamma-BHC (Lindane)	ND	2.0	ug/Kg	1.00	04/23/2004 13:56	
delta-BHC	ND	2.0	ug/Kg	1.00	04/23/2004 13:56	
Endosulfan sulfate	ND	2.0	ug/Kg	1.00	04/23/2004 13:56	
4,4'-Methoxychlor	ND	2.0	ug/Kg	1.00	04/23/2004 13:56	
Toxaphene	ND	100	ug/Kg	1.00	04/23/2004 13:56	
Chlordane (Technical)	ND	50	ug/Kg	1.00	04/23/2004 13:56	
alpha-Chlordane	ND	2.0	ug/Kg	1.00	04/23/2004 13:56	
gamma-Chlordane	ND	2.0	ug/Kg	1.00	04/23/2004 13:56	
Surrogate(s)						
2,4,5,6-Tetrachloro-m-xylene	69.6	50-125	%	1.00	04/23/2004 13:56	
Decachlorobiphenyl (Pest/8081)	84.5	46-142	%	1.00	04/23/2004 13:56	

Organochlorine Pesticides Analysis

Treadwell & Rollo Oakland

Attn.: Grover Buhr

501 14th Street, third floor

Oakland, CA 94612

Phone: (510) 874-4500 Fax: (510) 874-4507

Project: 3433.09

Received: 04/20/2004 17:15

Mandela Import(Greek Orthodox Church)

Prep(s): 3550/8081	Test(s): 8081
Sample ID: GC-2	Lab ID: 2004-04-0612 - 2
Sampled: 04/20/2004 07:12	Extracted: 4/21/2004 12:59
Matrix: Soil	QC Batch#: 2004/04/21-01.13

Compound	Conc.	RL	Unit	Dilution	Analyzed	Flag
Aldrin	ND	2.0	ug/Kg	1.00	04/23/2004 14:27	
Dieldrin	ND	2.0	ug/Kg	1.00	04/23/2004 14:27	
Endrin aldehyde	ND	2.0	ug/Kg	1.00	04/23/2004 14:27	
Endrin	ND	2.0	ug/Kg	1.00	04/23/2004 14:27	
Endrin ketone	ND	2.0	ug/Kg	1.00	04/23/2004 14:27	
Heptachlor	ND	2.0	ug/Kg	1.00	04/23/2004 14:27	
Heptachlor epoxide	ND	2.0	ug/Kg	1.00	04/23/2004 14:27	
4,4`-DDT	ND	2.0	ug/Kg	1.00	04/23/2004 14:27	
4,4`-DDE	ND	2.0	ug/Kg	1.00	04/23/2004 14:27	
4,4`-DDD	ND	2.0	ug/Kg	1.00	04/23/2004 14:27	
Endosulfan I	ND	2.0	ug/Kg	1.00	04/23/2004 14:27	
Endosulfan II	ND	2.0	ug/Kg	1.00	04/23/2004 14:27	
alpha-BHC	ND	2.0	ug/Kg	1.00	04/23/2004 14:27	
beta-BHC	ND	2.0	ug/Kg	1.00	04/23/2004 14:27	
gamma-BHC (Lindane)	ND	2.0	ug/Kg	1.00	04/23/2004 14:27	
delta-BHC	ND	2.0	ug/Kg	1.00	04/23/2004 14:27	
Endosulfan sulfate	ND	2.0	ug/Kg	1.00	04/23/2004 14:27	
4,4`-Methoxychlor	ND	2.0	ug/Kg	1.00	04/23/2004 14:27	
Toxaphene	ND	100	ug/Kg	1.00	04/23/2004 14:27	
Chlordane (Technical)	ND	50	ug/Kg	1.00	04/23/2004 14:27	
alpha-Chlordane	ND	2.0	ug/Kg	1.00	04/23/2004 14:27	
gamma-Chlordane	ND	2.0	ug/Kg	1.00	04/23/2004 14:27	
Surrogate(s)						
2,4,5,6-Tetrachloro-m-xylene	74.5	50-125	%	1.00	04/23/2004 14:27	
Decachlorobiphenyl (Pest/8081)	82.1	46-142	%	1.00	04/23/2004 14:27	

Organochlorine Pesticides Analysis

Treadwell & Rollo Oakland

Attn.: Grover Buhr

501 14th Street, third floor

Oakland, CA 94612

Phone: (510) 874-4500 Fax: (510) 874-4507

Project: 3433.09

Mandela Import(Greek Orthodox Church)

Received: 04/20/2004 17:15

Prep(s): 3550/8081	Test(s): 8081
Sample ID: GC-3	Lab ID: 2004-04-0612 - 3
Sampled: 04/20/2004 07:14	Extracted: 4/21/2004 12:59
Matrix: Soil	QC Batch#: 2004/04/21-01.13

Compound	Conc.	RL	Unit	Dilution	Analyzed	Flag
Aldrin	ND	2.0	ug/Kg	1.00	04/24/2004 08:10	
Dieldrin	ND	2.0	ug/Kg	1.00	04/24/2004 08:10	
Endrin aldehyde	ND	2.0	ug/Kg	1.00	04/24/2004 08:10	
Endrin	ND	2.0	ug/Kg	1.00	04/24/2004 08:10	
Endrin ketone	ND	2.0	ug/Kg	1.00	04/24/2004 08:10	
Heptachlor	ND	2.0	ug/Kg	1.00	04/24/2004 08:10	
Heptachlor epoxide	ND	2.0	ug/Kg	1.00	04/24/2004 08:10	
4,4'-DDT	ND	2.0	ug/Kg	1.00	04/24/2004 08:10	
4,4'-DDE	ND	2.0	ug/Kg	1.00	04/24/2004 08:10	
4,4'-DDD	ND	2.0	ug/Kg	1.00	04/24/2004 08:10	
Endosulfan I	ND	2.0	ug/Kg	1.00	04/24/2004 08:10	
Endosulfan II	ND	2.0	ug/Kg	1.00	04/24/2004 08:10	
alpha-BHC	ND	2.0	ug/Kg	1.00	04/24/2004 08:10	
beta-BHC	ND	2.0	ug/Kg	1.00	04/24/2004 08:10	
gamma-BHC (Lindane)	ND	2.0	ug/Kg	1.00	04/24/2004 08:10	
delta-BHC	ND	2.0	ug/Kg	1.00	04/24/2004 08:10	
Endosulfan sulfate	ND	2.0	ug/Kg	1.00	04/24/2004 08:10	
4,4'-Methoxychlor	ND	2.0	ug/Kg	1.00	04/24/2004 08:10	
Toxaphene	ND	100	ug/Kg	1.00	04/24/2004 08:10	
Chlordane (Technical)	ND	50	ug/Kg	1.00	04/24/2004 08:10	
alpha-Chlordane	ND	2.0	ug/Kg	1.00	04/24/2004 08:10	
gamma-Chlordane	ND	2.0	ug/Kg	1.00	04/24/2004 08:10	
Surrogate(s)						
2,4,5,6-Tetrachloro-m-xylene	79.0	50-125	%	1.00	04/24/2004 08:10	
Decachlorobiphenyl (Pest/8081)	87.0	46-142	%	1.00	04/24/2004 08:10	

Organochlorine Pesticides Analysis

Treadwell & Rollo Oakland

Attn.: Grover Buhr

501 14th Street, third floor

Oakland, CA 94612

Phone: (510) 874-4500 Fax: (510) 874-4507

Project: 3433.09

Received: 04/20/2004 17:15

Mandela Import(Greek Orthodox Church)

Prep(s): 3550/8081	Test(s): 8081
Sample ID: GC-4	Lab ID: 2004-04-0612 - 4
Sampled: 04/20/2004 07:16	Extracted: 4/21/2004 12:59
Matrix: Soil	QC Batch#: 2004/04/21-01.13

Compound	Conc.	RL	Unit	Dilution	Analyzed	Flag
Aldrin	ND	2.0	ug/Kg	1.00	04/24/2004 09:43	
Dieldrin	ND	2.0	ug/Kg	1.00	04/24/2004 09:43	
Endrin aldehyde	ND	2.0	ug/Kg	1.00	04/24/2004 09:43	
Endrin	ND	2.0	ug/Kg	1.00	04/24/2004 09:43	
Endrin ketone	ND	2.0	ug/Kg	1.00	04/24/2004 09:43	
Heptachlor	ND	2.0	ug/Kg	1.00	04/24/2004 09:43	
Heptachlor epoxide	ND	2.0	ug/Kg	1.00	04/24/2004 09:43	
4,4'-DDT	ND	2.0	ug/Kg	1.00	04/24/2004 09:43	
4,4'-DDE	ND	2.0	ug/Kg	1.00	04/24/2004 09:43	
4,4'-DDD	ND	2.0	ug/Kg	1.00	04/24/2004 09:43	
Endosulfan I	ND	2.0	ug/Kg	1.00	04/24/2004 09:43	
Endosulfan II	ND	2.0	ug/Kg	1.00	04/24/2004 09:43	
alpha-BHC	ND	2.0	ug/Kg	1.00	04/24/2004 09:43	
beta-BHC	ND	2.0	ug/Kg	1.00	04/24/2004 09:43	
gamma-BHC (Lindane)	ND	2.0	ug/Kg	1.00	04/24/2004 09:43	
delta-BHC	ND	2.0	ug/Kg	1.00	04/24/2004 09:43	
Endosulfan sulfate	ND	2.0	ug/Kg	1.00	04/24/2004 09:43	
4,4'-Methoxychlor	ND	2.0	ug/Kg	1.00	04/24/2004 09:43	
Toxaphene	ND	100	ug/Kg	1.00	04/24/2004 09:43	
Chlordane (Technical)	ND	50	ug/Kg	1.00	04/24/2004 09:43	
alpha-Chlordane	ND	2.0	ug/Kg	1.00	04/24/2004 09:43	
gamma-Chlordane	ND	2.0	ug/Kg	1.00	04/24/2004 09:43	
Surrogate(s)						
2,4,5,6-Tetrachloro-m-xylene	74.1	50-125	%	1.00	04/24/2004 09:43	
Decachlorobiphenyl (Pest/8081)	81.8	46-142	%	1.00	04/24/2004 09:43	

Organochlorine Pesticides Analysis

Treadwell & Rollo Oakland

Attn.: Grover Buhr

501 14th Street, third floor

Oakland, CA 94612

Phone: (510) 874-4500 Fax: (510) 874-4507

Project: 3433.09

Mandela Import(Greek Orthodox Church)

Received: 04/20/2004 17:15

Prep(s):	3550/8081	Test(s):	8081
Sample ID:	GC-5	Lab ID:	2004-04-0612 - 5
Sampled:	04/20/2004 07:18	Extracted:	4/21/2004 12:59
Matrix:	Soil	QC Batch#:	2004/04/21-01.13

Compound	Conc.	RL	Unit	Dilution	Analyzed	Flag
Aldrin	ND	2.0	ug/Kg	1.00	04/24/2004 10:15	
Dieldrin	ND	2.0	ug/Kg	1.00	04/24/2004 10:15	
Endrin aldehyde	ND	2.0	ug/Kg	1.00	04/24/2004 10:15	
Endrin	ND	2.0	ug/Kg	1.00	04/24/2004 10:15	
Endrin ketone	ND	2.0	ug/Kg	1.00	04/24/2004 10:15	
Heptachlor	ND	2.0	ug/Kg	1.00	04/24/2004 10:15	
Heptachlor epoxide	ND	2.0	ug/Kg	1.00	04/24/2004 10:15	
4,4'-DDT	ND	2.0	ug/Kg	1.00	04/24/2004 10:15	
4,4'-DDE	ND	2.0	ug/Kg	1.00	04/24/2004 10:15	
4,4'-DDD	ND	2.0	ug/Kg	1.00	04/24/2004 10:15	
Endosulfan I	ND	2.0	ug/Kg	1.00	04/24/2004 10:15	
Endosulfan II	ND	2.0	ug/Kg	1.00	04/24/2004 10:15	
alpha-BHC	ND	2.0	ug/Kg	1.00	04/24/2004 10:15	
beta-BHC	ND	2.0	ug/Kg	1.00	04/24/2004 10:15	
gamma-BHC (Lindane)	ND	2.0	ug/Kg	1.00	04/24/2004 10:15	
delta-BHC	ND	2.0	ug/Kg	1.00	04/24/2004 10:15	
Endosulfan sulfate	ND	2.0	ug/Kg	1.00	04/24/2004 10:15	
4,4'-Methoxychlor	ND	2.0	ug/Kg	1.00	04/24/2004 10:15	
Toxaphene	ND	100	ug/Kg	1.00	04/24/2004 10:15	
Chlordane (Technical)	ND	50	ug/Kg	1.00	04/24/2004 10:15	
alpha-Chlordane	ND	2.0	ug/Kg	1.00	04/24/2004 10:15	
gamma-Chlordane	ND	2.0	ug/Kg	1.00	04/24/2004 10:15	
Surrogate(s)						
2,4,5,6-Tetrachloro-m-xylene	55.2	50-125	%	1.00	04/24/2004 10:15	
Decachlorobiphenyl (Pest/8081)	61.4	46-142	%	1.00	04/24/2004 10:15	

Organochlorine Pesticides Analysis

Treadwell & Rollo Oakland

Attn.: Grover Buhr

501 14th Street, third floor

Oakland, CA 94612

Phone: (510) 874-4500 Fax: (510) 874-4507

Project: 3433.09

Mandela Import(Greek Orthodox Church)

Received: 04/20/2004 17:15

Prep(s): 3550/8081	Test(s): 8081
Sample ID: GC-6	Lab ID: 2004-04-0612 - 6
Sampled: 04/20/2004 07:20	Extracted: 4/21/2004 12:59
Matrix: Soil	QC Batch#: 2004/04/21-01.13

Compound	Conc.	RL	Unit	Dilution	Analyzed	Flag
Aldrin	ND	2.0	ug/Kg	1.00	04/24/2004 10:46	
Dieldrin	ND	2.0	ug/Kg	1.00	04/24/2004 10:46	
Endrin aldehyde	ND	2.0	ug/Kg	1.00	04/24/2004 10:46	
Endrin	ND	2.0	ug/Kg	1.00	04/24/2004 10:46	
Endrin ketone	ND	2.0	ug/Kg	1.00	04/24/2004 10:46	
Heptachlor	ND	2.0	ug/Kg	1.00	04/24/2004 10:46	
Heptachlor epoxide	ND	2.0	ug/Kg	1.00	04/24/2004 10:46	
4,4'-DDT	ND	2.0	ug/Kg	1.00	04/24/2004 10:46	
4,4'-DDE	ND	2.0	ug/Kg	1.00	04/24/2004 10:46	
4,4'-DDD	ND	2.0	ug/Kg	1.00	04/24/2004 10:46	
Endosulfan I	ND	2.0	ug/Kg	1.00	04/24/2004 10:46	
Endosulfan II	ND	2.0	ug/Kg	1.00	04/24/2004 10:46	
alpha-BHC	ND	2.0	ug/Kg	1.00	04/24/2004 10:46	
beta-BHC	ND	2.0	ug/Kg	1.00	04/24/2004 10:46	
gamma-BHC (Lindane)	ND	2.0	ug/Kg	1.00	04/24/2004 10:46	
delta-BHC	ND	2.0	ug/Kg	1.00	04/24/2004 10:46	
Endosulfan sulfate	ND	2.0	ug/Kg	1.00	04/24/2004 10:46	
4,4'-Methoxychlor	ND	2.0	ug/Kg	1.00	04/24/2004 10:46	
Toxaphene	ND	100	ug/Kg	1.00	04/24/2004 10:46	
Chlordane (Technical)	ND	50	ug/Kg	1.00	04/24/2004 10:46	
alpha-Chlordane	ND	2.0	ug/Kg	1.00	04/24/2004 10:46	
gamma-Chlordane	ND	2.0	ug/Kg	1.00	04/24/2004 10:46	
Surrogate(s)						
2,4,5,6-Tetrachloro-m-xylene	63.1	50-125	%	1.00	04/24/2004 10:46	
Decachlorobiphenyl (Pest/8081)	69.7	46-142	%	1.00	04/24/2004 10:46	

Organochlorine Pesticides Analysis

Treadwell & Rollo Oakland

Attn.: Grover Buhr

501 14th Street, third floor

Oakland, CA 94612

Phone: (510) 874-4500 Fax: (510) 874-4507

Project: 3433.09

Received: 04/20/2004 17:15

Mandela Import(Greek Orthodox Church)

Batch QC Report		
Prep(s): 3550/8081		Test(s): 8081
Method Blank	Soil	QC Batch # 2004/04/21-01.13
MB: 2004/04/21-01.13-001		Date Extracted: 04/21/2004 12:59

Compound	Conc.	RL	Unit	Analyzed	Flag
Aldrin	ND	2.0	ug/Kg	04/23/2004 11:51	
Dieldrin	ND	2.0	ug/Kg	04/23/2004 11:51	
Endrin aldehyde	ND	2.0	ug/Kg	04/23/2004 11:51	
Endrin	ND	2.0	ug/Kg	04/23/2004 11:51	
Endrin ketone	ND	2.0	ug/Kg	04/23/2004 11:51	
Heptachlor	ND	2.0	ug/Kg	04/23/2004 11:51	
Heptachlor epoxide	ND	2.0	ug/Kg	04/23/2004 11:51	
4,4`-DDT	ND	2.0	ug/Kg	04/23/2004 11:51	
4,4`-DDE	ND	2.0	ug/Kg	04/23/2004 11:51	
4,4`-DDD	ND	2.0	ug/Kg	04/23/2004 11:51	
Endosulfan I	ND	2.0	ug/Kg	04/23/2004 11:51	
Endosulfan II	ND	2.0	ug/Kg	04/23/2004 11:51	
alpha-BHC	ND	2.0	ug/Kg	04/23/2004 11:51	
beta-BHC	ND	2.0	ug/Kg	04/23/2004 11:51	
gamma-BHC (Lindane)	ND	2.0	ug/Kg	04/23/2004 11:51	
delta-BHC	ND	2.0	ug/Kg	04/23/2004 11:51	
Endosulfan sulfate	ND	2.0	ug/Kg	04/23/2004 11:51	
4,4`-Methoxychlor	ND	2.0	ug/Kg	04/23/2004 11:51	
Toxaphene	ND	100	ug/Kg	04/23/2004 11:51	
Chlordane (Technical)	ND	50	ug/Kg	04/23/2004 11:51	
alpha-Chlordane	ND	2.0	ug/Kg	04/23/2004 11:51	
gamma-Chlordane	ND	2.0	ug/Kg	04/23/2004 11:51	
Surrogates(s)					
2,4,5,6-Tetrachloro-m-xylene	81.9	50-125	%	04/23/2004 11:51	
Decachlorobiphenyl (Pest/8081)	88.2	46-142	%	04/23/2004 11:51	

Organochlorine Pesticides Analysis

Treadwell & Rollo Oakland

Attn.: Grover Buhr

501 14th Street, third floor

Oakland, CA 94612

Phone: (510) 874-4500 Fax: (510) 874-4507

Project: 3433.09

Mandela Import(Greek Orthodox Church)

Received: 04/20/2004 17:15

Batch QC Report

Prep(s): 3550/8081

Test(s): 8081

Laboratory Control Spike

Soil

QC Batch # 2004/04/21-01.13

LCS 2004/04/21-01.13-002

Extracted: 04/21/2004

Analyzed: 04/23/2004 12:22

LCSD 2004/04/21-01.13-003

Extracted: 04/21/2004

Analyzed: 04/23/2004 12:53

Compound	Conc. ug/Kg		Exp.Conc.	Recovery %		RPD	Ctrl.Limits %		Flags	
	LCS	LCSD		LCS	LCSD		%	Rec.	RPD	LCS
Aldrin	13.9	14.2	16.6	83.7	85.5	2.1	37-136	35		
Dieldrin	13.9	14.1	16.6	83.7	84.9	1.4	58-135	35		
Endrin	13.7	13.9	16.6	82.5	83.7	1.4	58-134	35		
Heptachlor	14.4	14.7	16.6	86.7	88.6	2.2	40-136	35		
4,4'-DDT	13.4	13.5	16.6	80.7	81.3	0.7	55-132	35		
gamma-BHC (Lindane)	13.9	14.1	16.6	83.7	84.9	1.4	37-137	35		
Surrogates(s)										
2,4,5,6-Tetrachloro-m-xylene	42.6	43.6	50	85.1	87.3		50-125	0		
Decachlorobiphenyl	45.6	45.4	50	91.2	90.8		46-142	0		

Organochlorine Pesticides Analysis

Treadwell & Rollo Oakland

Attn.: Grover Buhr

501 14th Street, third floor
Oakland, CA 94612
Phone: (510) 874-4500 Fax: (510) 874-4507

Project: 3433.09
Mandela Import(Greek Orthodox Church)

Received: 04/20/2004 17:15

Batch QC Report			
Prep(s): 3550/8081			Test(s): 8081
Matrix Spike (MS / MSD)	Soil	QC Batch # 2004/04/21-01.13	
GC-3 >> MS			Lab ID: 2004-04-0612 - 003
MS: 2004/04/21-01.13-004	Extracted: 04/21/2004	Analyzed:	04/26/2004 15:55
		Dilution:	1.00
MSD: 2004/04/21-01.13-005	Extracted: 04/21/2004	Analyzed:	04/26/2004 16:26
		Dilution:	1.00

Compound	Conc. ug/Kg			Spk.Level ug/Kg	Recovery %			Limits %		Flags	
	MS	MSD	Sample		MS	MSD	RPD	Rec.	RPD	MS	MSD
Aldrin	13.9	9.78	ND	16.6	83.7	58.9	34.8	37-136	35		
Dieldrin	14.6	10.2	ND	16.6	88.0	61.4	35.6	58-135	35		mso
Endrin	14.7	10.2	ND	16.6	88.6	61.4	36.3	58-134	35		mso
Heptachlor	14.1	10.1	ND	16.6	84.9	60.8	33.1	40-136	35		
4,4'-DDT	16.4	11.1	ND	16.6	98.8	66.9	38.5	55-132	35		mso
gamma-BHC (Lindane)	14.2	10.4	ND	16.6	85.5	62.7	30.8	37-137	35		
Surrogate(s)											
2,4,5,6-Tetrachloro-m-xylen	43.3	33.1		50	86.6	66.1		50-125	0		
Decachlorobiphenyl	56.6	37.6		50	113.2	75.2		46-142	0		

2004-04-0612

85006



CHAIN OF CUSTODY RECORD

- 555 Montgomery Street, Suite 1300, San Francisco, CA 94111 Ph: 415-955-9040 / Fax: 415-955-9041
- 2 Theatre Square, Suite 216, Orinda CA 94563 Ph: 925-253-4980 / Fax: 925-253-4985
- 501 14th Street, 3rd Floor, Oakland, CA 94612 Ph: 510-874-4500 / Fax: 510-874-4507

Site Name: Mandela Import (Greek Orthodox church)
 Job Number: 3433.09
 Project Manager/Contact: Grover Bahr
 Samplers: Greg Johnson
 Recorder (Signature Required): [Signature]

Turnaround Time
Spencers 5 days

Field Sample Identification No.	Date	Time	Lab Sample No.	Matrix & Preservative										Total Lead	Pesticides	Silica gel clean-up	Hold	Remarks
				Soil	Water	Other	HCL	H ₂ SO ₄	HNO ₃	Ice	Other							
GC-1	4/20/04	0710		X										X	X			
GC-2		0712		X										X	X			
GC-3		0714		X										X	X			
GC-4		0716		X										X	X			
GC-5		0718		X										X	X			
GC-6		0720		X										X	X			
																		4.0°C

Relinquished by: (Signature) <u>[Signature]</u>	Date <u>4/20/04</u>	Time <u>14:45</u>	Received by: (Signature) <u>[Signature]</u>	Date <u>4/20/04</u>	Time <u>14:45</u>
Relinquished by: (Signature)	Date	Time	Received by: (Signature)	Date	Time
Relinquished by: (Signature) <u>[Signature]</u>	Date <u>4/20/04</u>	Time <u>17:15</u>	Received by Lab: (Signature) <u>Nounals</u>	Date <u>4/20/04</u>	Time <u>17:15</u>
Sent to Laboratory (Name):	Method of Shipment <input type="checkbox"/> Lab courier <input type="checkbox"/> Fed Ex <input type="checkbox"/> Airborne <input type="checkbox"/> UPS				
Laboratory Comments/Notes:	<input type="checkbox"/> Hand-Carried <input type="checkbox"/> Private Courier (Co. Name)				