

ALAMEDA COUNTY ENVIRONMENTAL HEALTH DEPARTMENT
Division of Environmental Protection

1131 HARBOR BAY PARKWAY, SUITE 250
ALAMEDA, CA 94502-6577
Telephone (510) 567-6700 FAX (510) 337-9335

FACSIMILE COVER SHEET

To: David Weiss / Shawn Munger

From: ESA CW

2 pages total

Date: 10/31/01

Notes: The large black dots (8-total) are locations
for soil samples. Note that 3 of the locations are
also for collection of grab groundwater samples.
Soil samples should be collected at ~ 1 foot bgs, and at
3 feet bgs. Samples should also be analyzed for Total oil
and grease. Use a silica gel cleanup.

THE ARNOLD LAW PRACTICE

JAMES R. ARNOLD
ATTORNEY AT LAW

225 BUSH STREET, 16TH FLOOR
SAN FRANCISCO, CA 94104

PHONE: 415-439-8831 FACSIMILE: 925-284-2473
DIRECT: 415-307-1128 EMAIL: JARNOLD102@AQL.COM

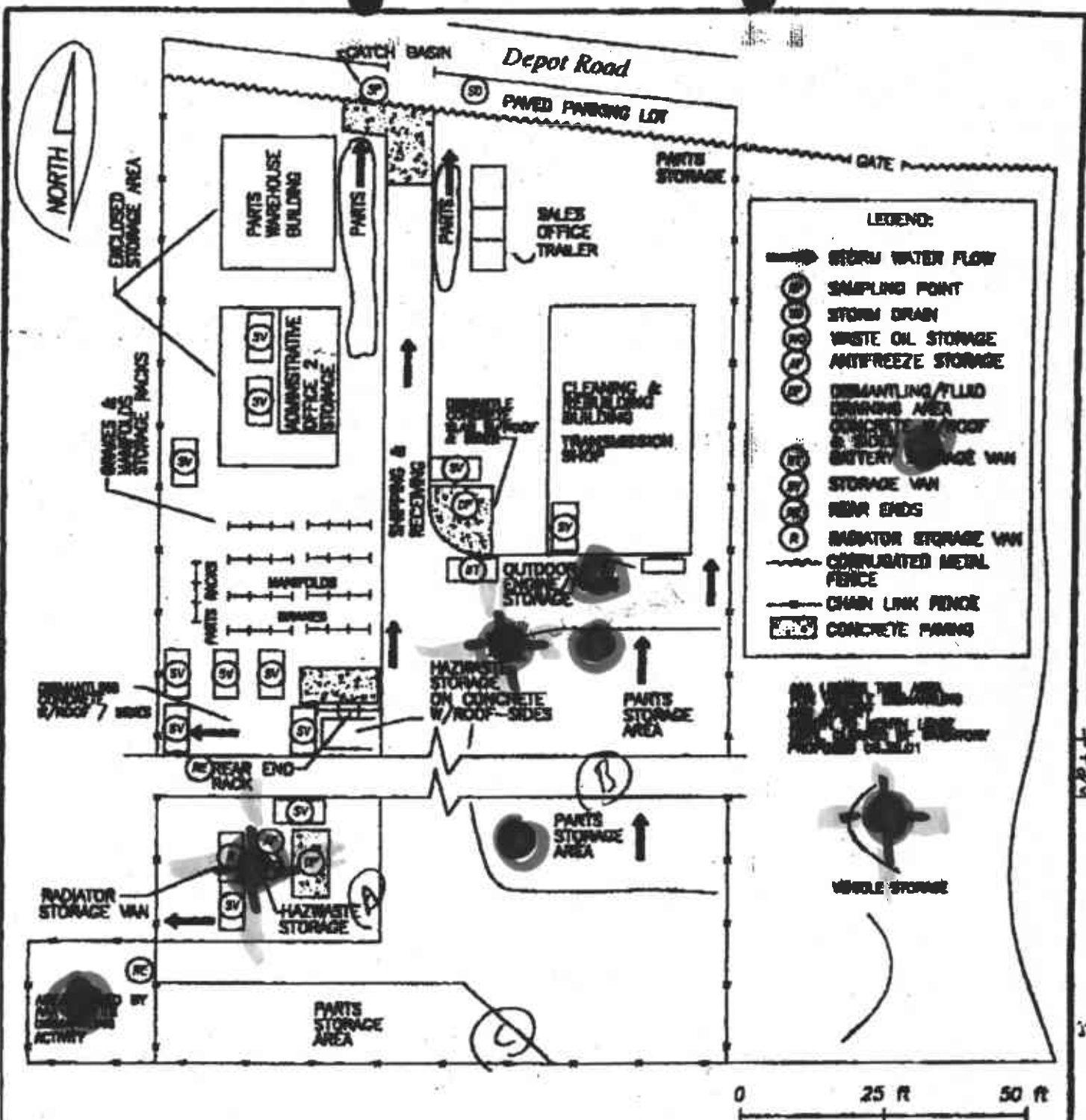

North
West
South

David



AAA TRUCK & 4x4 & VAN PARTS
www.4x4truckparts.com

3884 Depot Rd.
Hayward, CA 94545

(510) 782-9433
fax: (510) 782-8825
aaatruckparts@yahoo.com

AAA TRUCK PARTS CO.

Hayward CA, Alameda County

STORM WATER SITE MAP

● = soil sample
●-○ = soil and groundwater sample