



JONAS & ASSOCIATES INC.
Environmental Consultants

ENVIRONMENTAL
PROTECTION

2815 Mitchell Drive, Suite 209 • Walnut Creek, CA 94598 • Tel: (510) 933-5360 • Fax: (510) 933-5362
925 933-5360 18 PM 11/16/98 925

November 16, 1998

Ms. Madhulla Logan
Alameda County Environmental Health Care Services
1131 Harbor Bay Parkway, 2nd Floor
Alameda, California 94502
(510) 337-9335

Subject: Addendum to the November 10, 1998 "Work Plan for
Additional Site Investigation/Remediation."

Project: Oakland Continental General Tire
J&A #: GT-213

Dear Ms. Logan:

As you requested, presented below are modifications to our November 10, 1998
"Work Plan for Additional Site Investigation/Remediation" for the Continental General
Tire's facility located at 1201 14th Avenue, in Oakland, California.

- » Groundwater in Pit E and Basins B1 and B2 will be pumped for one month. Pumping will occur for three days each week, typically on Mondays, Wednesdays, and Fridays. Each pit or basin will be pumped to remove accumulated groundwater. Pumped groundwater will be discharged into a holding tank.
- » A new monitoring well, identified as MW-4, will be installed downgradient of Basins B1 and B2. Please see Figure 1 for the proposed location of monitoring well MW-4 and Figure 2 with a schematic diagram for well construction. All four monitoring wells shall be sampled as presented in the November 10, 1998 "Work Plan for Additional Site Investigation/Remediation."

Please contact us with your approval or a request for further modification.

Should you have any question or comment, please contact Mark or Romena Jonas at (925) 933-5360.

Sincerely,
JONAS & ASSOCIATES INC.

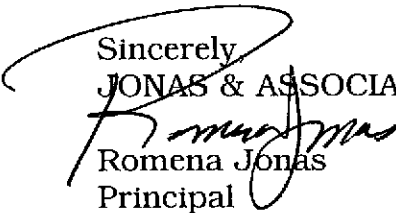
Romena Jonas
Principal

Reviewed by:

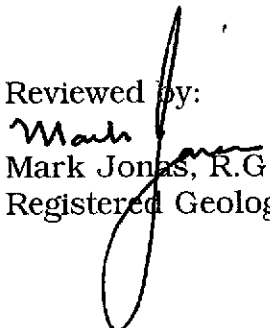
Mark Jonas, R.G.
Registered Geologist #6392

attachments: Figures 1 and 2.

cc: Mike McNally, Continental General Tire, Inc.

8ltr1116.gt3

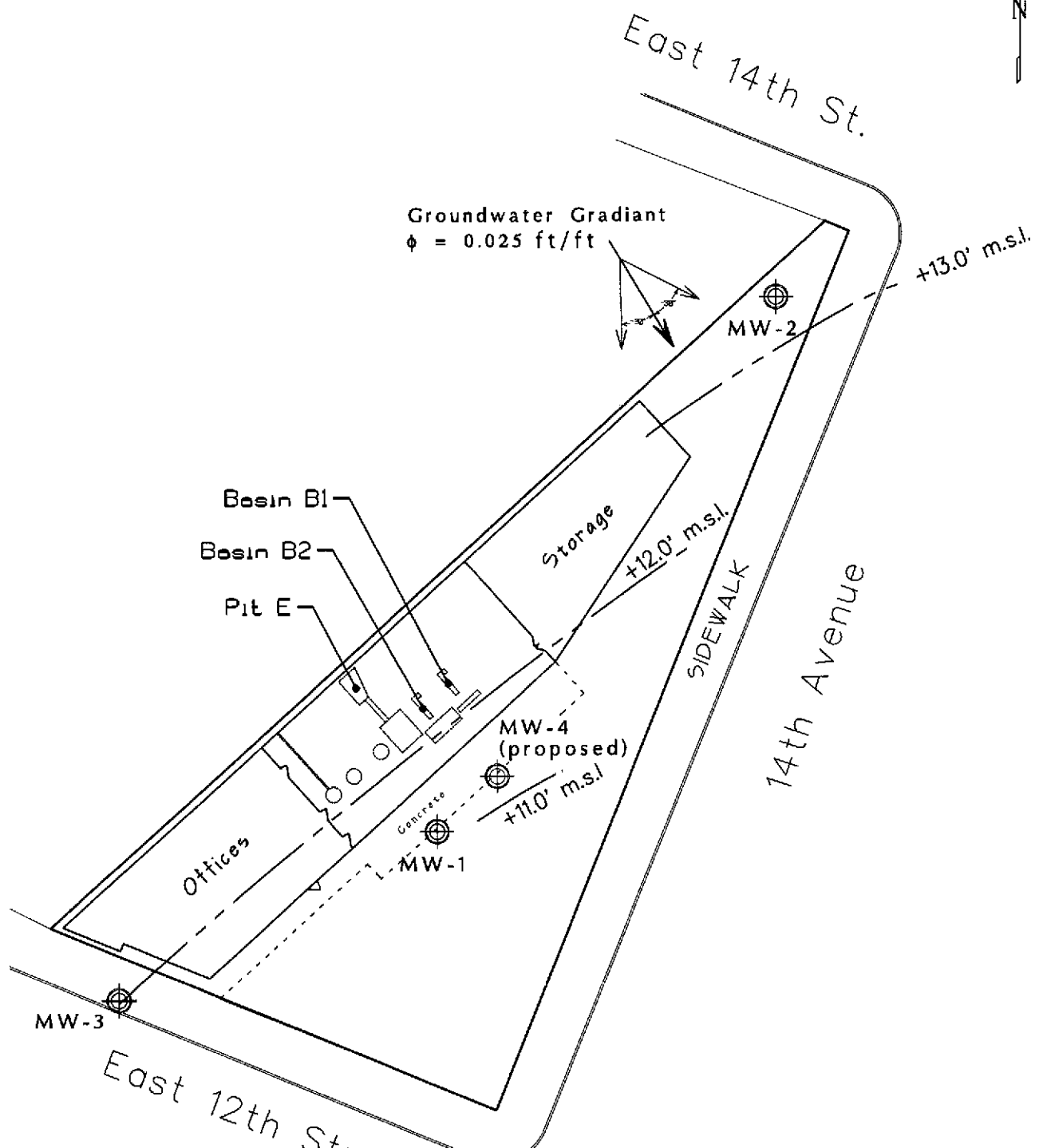

Groundwater Gradient
 $\phi = 0.025 \text{ ft/ft}$

Basin B1

Basin B2

Pit E

Storage

Offices

MW-4
(proposed)

MW-1

MW-3

MW-2

East 12th Street

East 14th St.

SIDEWALK

14th Avenue

Legend:

⊕ Monitoring Well

▭ Excavation

August 1996
Groundwater Elevation
Above Mean Sea Level (m.s.l.)
Equipotential Line

Proposed Location of
Monitoring Well MW-4

Continental General Tire
1201 14th Avenue
Oakland, California

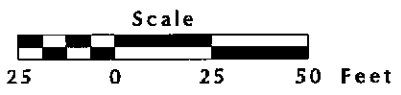

Date: 10/14/98
Locations Approx.

Prepared by
JONAS & ASSOCIATES INC.

Figure 1

Drawing Number
GT213-11/98:F1

Surface

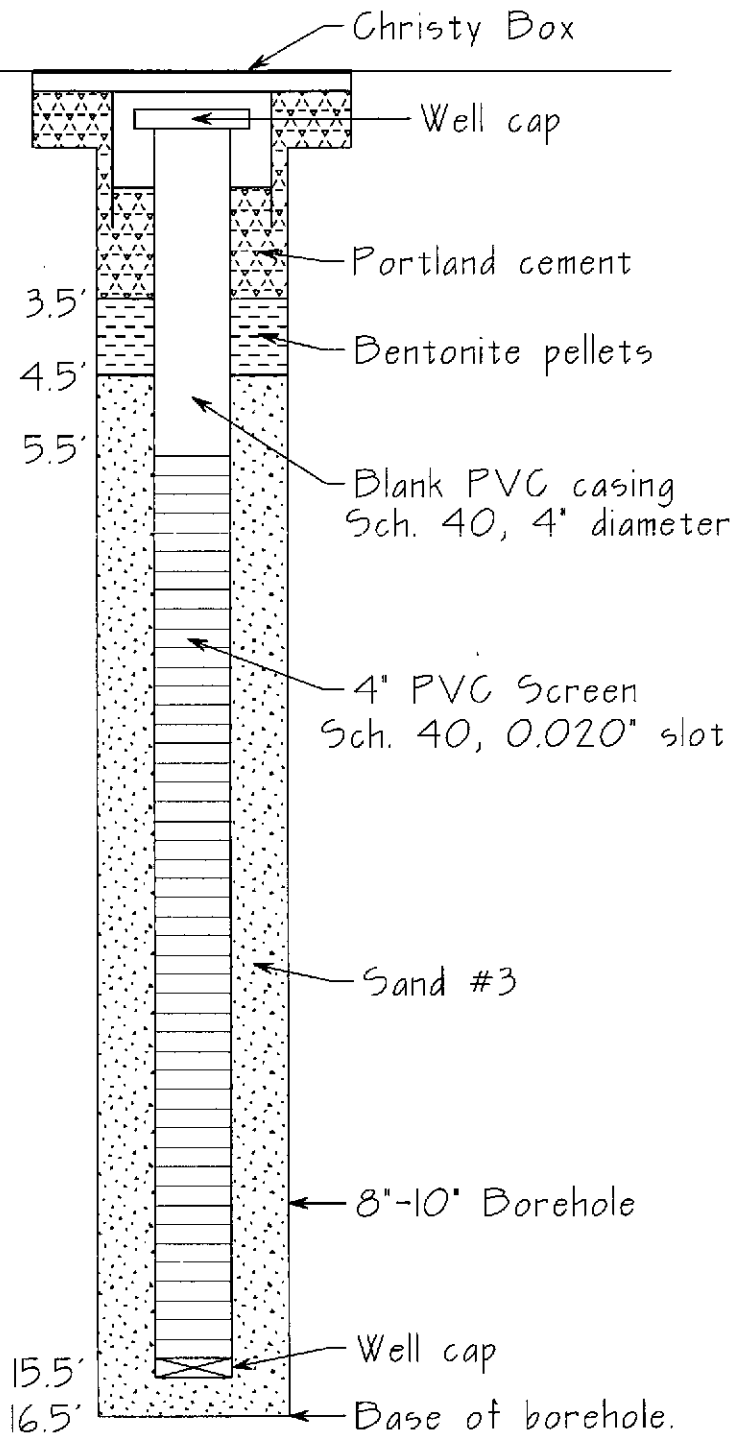

Continental General Tire
1201 14th Avenue
Oakland, California

Schematic Diagram for
Proposed Well Construction

Prepared by
JONAS & ASSOCIATES INC.

Not to Scale

Date: 11-16-1998

Figure 2

Drawing Number
GT213-11/98:F2