



For Pacific Galvanizing

715 - 46th Ave

"Linking Technology with Tradition"

Sanborn® Map Report

Ship to: Kathy Rushmore

PES Environmental, Inc.

1682 Novato Boulevard

Novato, CA 94947

Order Date: 5/21/2001 **Completion Date:** 05/22/2001

Inquiry #: 634304.2s

P.O. #: NA

Site Name: 700 45th Avenue

Address: 700 45th Avenue

City/State: Oakland, CA 94601

1021731RJC

415-899-1600

Cross Streets:

Based on client-supplied information, fire insurance maps for the following years were identified

1912 - 1 - map

1925 - 1 - map

1950 - 1 - map

1952 - 1 - map

1957 - 1 - map

1961 - 1 - map

1966 - 1 - map

1969 - 1 - map

Total Maps: 8

Limited Permission to Photocopy

PES Environmental, Inc. (the client) is permitted to make up to THREE photocopies of this Sanborn Map transmittal and each fire insurance map accompanying this report solely for the limited use of its customer. No one other than the client is authorized to make copies. Upon request made directly to an EDR Account Executive, the client may be permitted to make a limited number of additional photocopies. This permission is conditioned upon compliance by the client, its customer and their agents with EDR's copyright policy; a copy of which is available upon request.

All maps provided pursuant to a Sanborn® Map Report are currently reproducible of fire insurance maps owned or licensed by Environmental Data Resources, Inc. NO WARRANTY, EXPRESSED OR IMPLIED IS MADE WHATSOEVER. ENVIRONMENTAL DATA RESOURCES, INC. SPECIFICALLY DISCLAIMS THE MAKING OF ANY SUCH WARRANTIES, INCLUDING WITHOUT LIMITATION, WARRANTIES AS TO ACCURACY, VALIDITY, COMPLETENESS, SUITABILITY, CONDITION, QUALITY, MERCHANTABILITY, OR FITNESS FOR A PARTICULAR USE OR PURPOSE WITH RESPECT TO THE REPORT, THE MAPS, THE INFORMATION CONTAINED THEREIN, OR THE RESULTS OF A SEARCH OR OTHERWISE. ALL RISK IS ASSUMED BY THE USER. Environmental Data Resources, Inc. assumes no liability to any party for any loss or damage whether arising out of errors or omissions, negligence, accident or any other cause. In no event shall Environmental Data Resources, Inc., its affiliates or agents, be liable to anyone for special, incidental, consequential or exemplary damages.

Copyright 2001, Environmental Data Resources, Inc. All rights reserved. Reproduction in any media or format of any map of Environmental Data Resources, Inc. (whether obtained as a result of a search or otherwise) may be prohibited without prior written permission from Environmental Data Resources, Inc. Sanborn and Sanborn Map are registered trademarks of Environmental Data Resources, Inc.

Electronic Sanborn Map Images USER'S GUIDE

Thank you for your interest in electronic Sanborn Map images. The following are guidelines for accessing the images and for transferring them to your system. If you have any questions about the use of electronic Sanborn Map images, contact your EDR Account Executive at 1-800-352-0050.

Organization of Electronic Sanborn Image File

- First Page Sanborn Map Report, listing years of coverage
- Second Page Electronic Sanborn Map Images USER'S GUIDE
- Third Page Oldest Sanborn Map Image
- Last Page Most recent Sanborn Map Image

Navigating the Electronic Sanborn Image File

- Open file on screen.
- Identify TP (Target Property) on the most recent map.
- Find TP on older printed images.
- To view the image more clearly, zoom to 250%.
 - 200-250% is the approximate equivalent scale of hardcopy Sanborn Maps.
 - Viewing above 400% will tend to pixelate the display.
- Zooming in on an image:
 - Click on the % in the lower left hand corner and type in ____%.
 - Use the magnifying tool and drag a box around the TP area.

Printing a Sanborn Map from the Electronic File

- EDR recommends printing all images at 300 dpi (300 dpi prints faster than 600 dpi).
- To print only the TP area, cut and paste the area from Adobe Acrobat to your word processor.

For Adobe Acrobat Version 3

- Go to the Menu Bar.
- Highlight 'Tools'.
- Highlight 'Select Graphics'.
- Draw a box around the area of interest.
- Go to the Menu Bar.
- Highlight 'Edit'.
- Highlight 'Copy'.
- Go to a word processor such as Microsoft Word and paste. Print from the word processor.

For Adobe Acrobat Version 4

- Go to the Menu Bar.
- Press and hold the 'T' button.
- Choose the Graphics Select Tool.
- Draw a box around the area of interest.
- Go to the Menu Bar.
- Highlight 'Edit'.
- Highlight 'Copy'.
- Go to a word processor such as Microsoft Word and paste. Print from the word processor.



Important Information about Email Delivery of Electronic Sanborn Map Images

- Images are grouped into one file, up to 2MB.
- In cases where in excess of 6-7 map years are available, the file size typically exceeds 2MB. In these cases, you will receive multiple files, labeled as 1 of 3, 2 of 3, etc. including all available map years.
- Due to file size limitations, certain ISPs, including AOL, may occasionally delay or decline to deliver files. Please contact your ISP to identify their specific file size limitations.

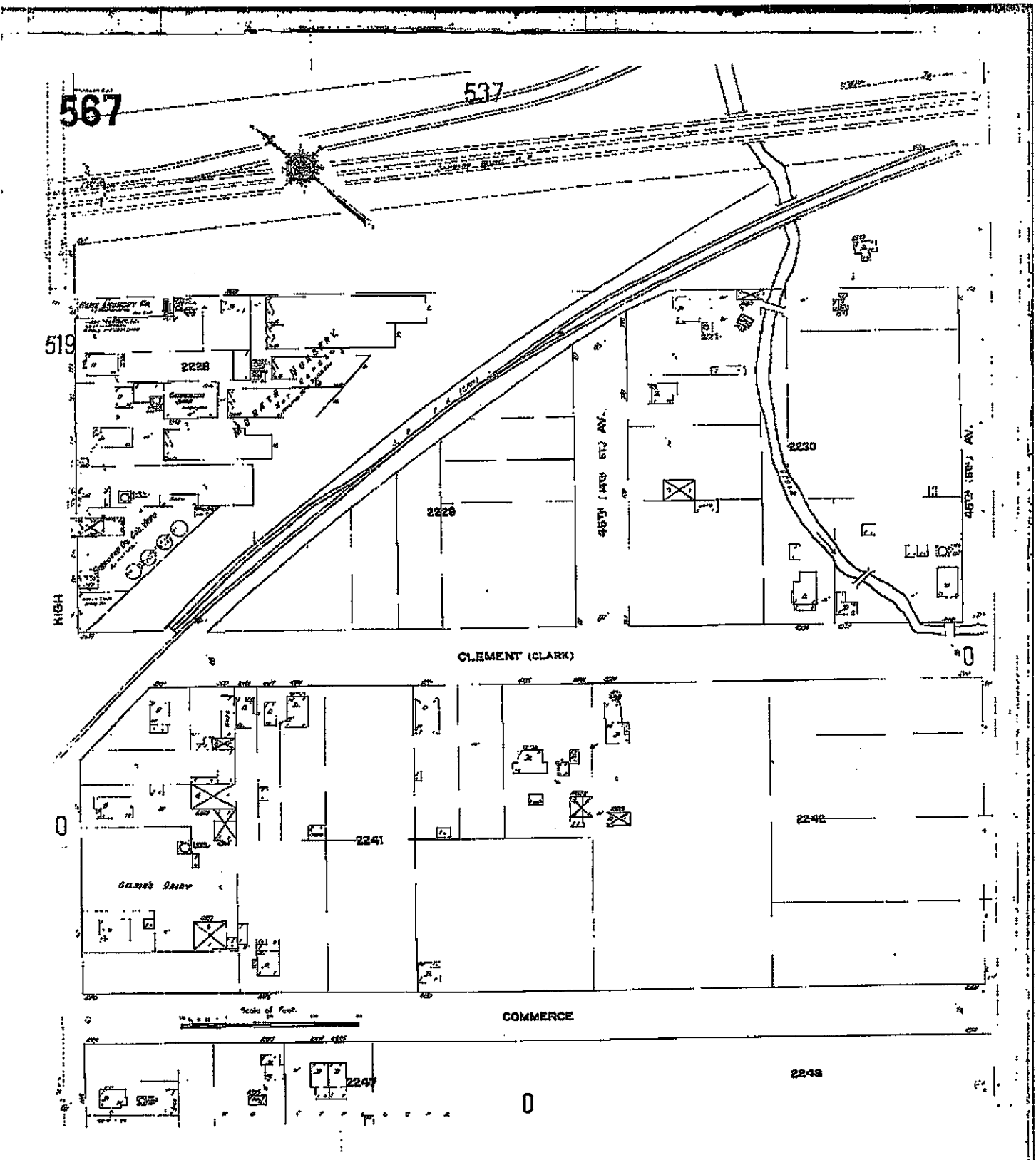

The Sanborn Library, LLC

This Sanborn® Map is a certified copy produced by Environmental Data Resources, Inc. under arrangement with The Sanborn Library, LLC. Information on this Sanborn® Map is derived from Sanborn field surveys conducted in:

Copyright © 1912 The Sanborn Library, LLC CAG
 Year EDR Research Associates

Reproduction in whole or in part of any map of The Sanborn Library, LLC may be prohibited without prior written permission from The Sanborn Library, LLC.

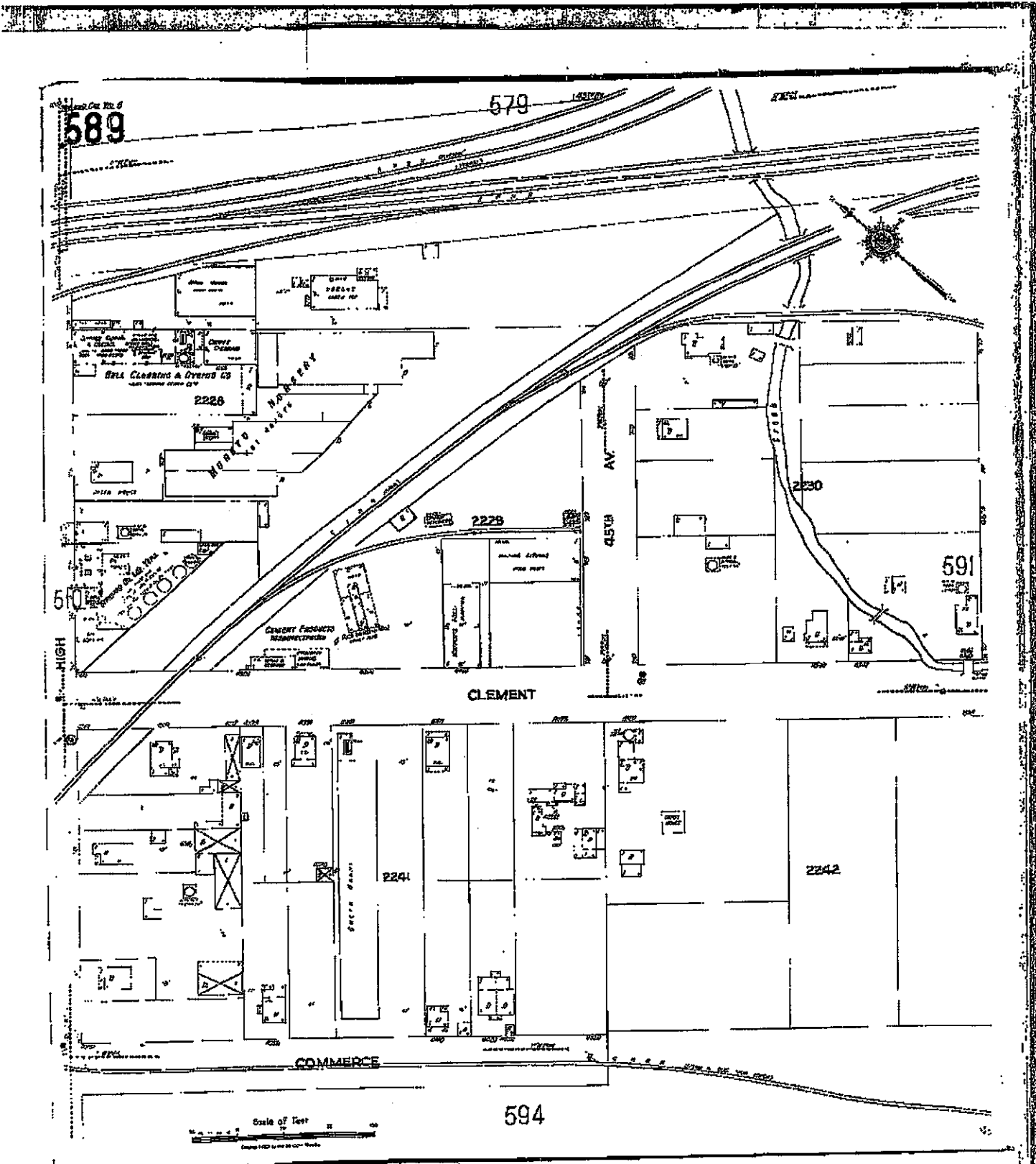



The Sanborn Library, LLC

This Sanborn® Map is a digitized copy produced by Environmental Data Resources, Inc. under arrangement with The Sanborn Library, LLC. Information on this Sanborn® Map is derived from Sanborn field surveys conducted in:

Copyright © 1926 The Sanborn Library, LLC CAD
 Year EDR Research Associates

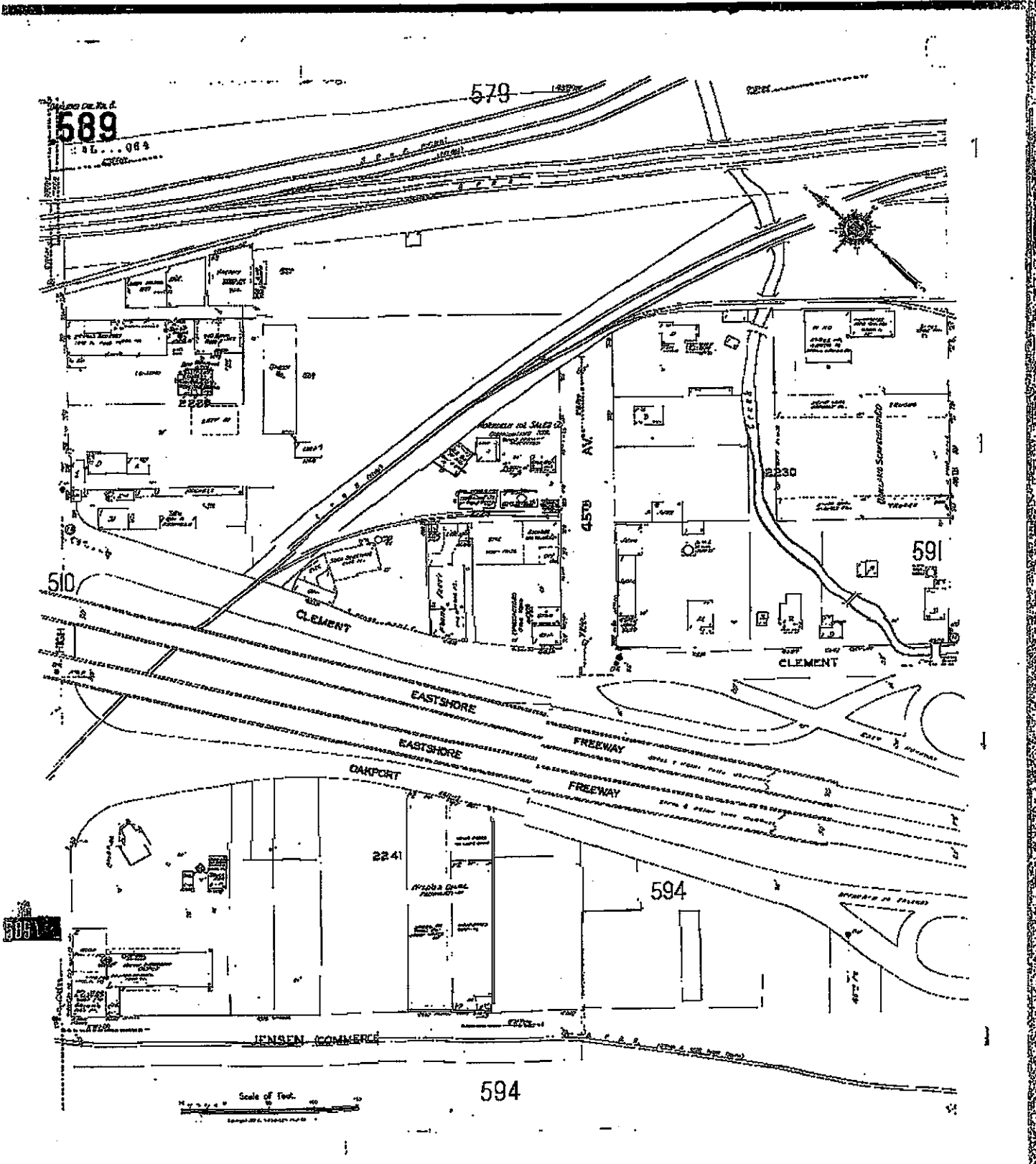
Reproduction in whole or in part of any map of The Sanborn Library, LLC may be prohibited without prior written permission from The Sanborn Library, LLC.



 **The Sanborn Library, LLC**
 This Sanborn® Map is a certified copy produced by Environmental Data Resources, Inc. under arrangement with The Sanborn Library, LLC. Information on this Sanborn® Map is derived from Sanborn field surveys conducted in:
 Copyright © 1960 The Sanborn Library, LLC CAS
 Year ERI Research Associates
 Reproduction in whole or in part of any map of The Sanborn Library, LLC may be published without prior written permission from The Sanborn Library, LLC.

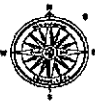
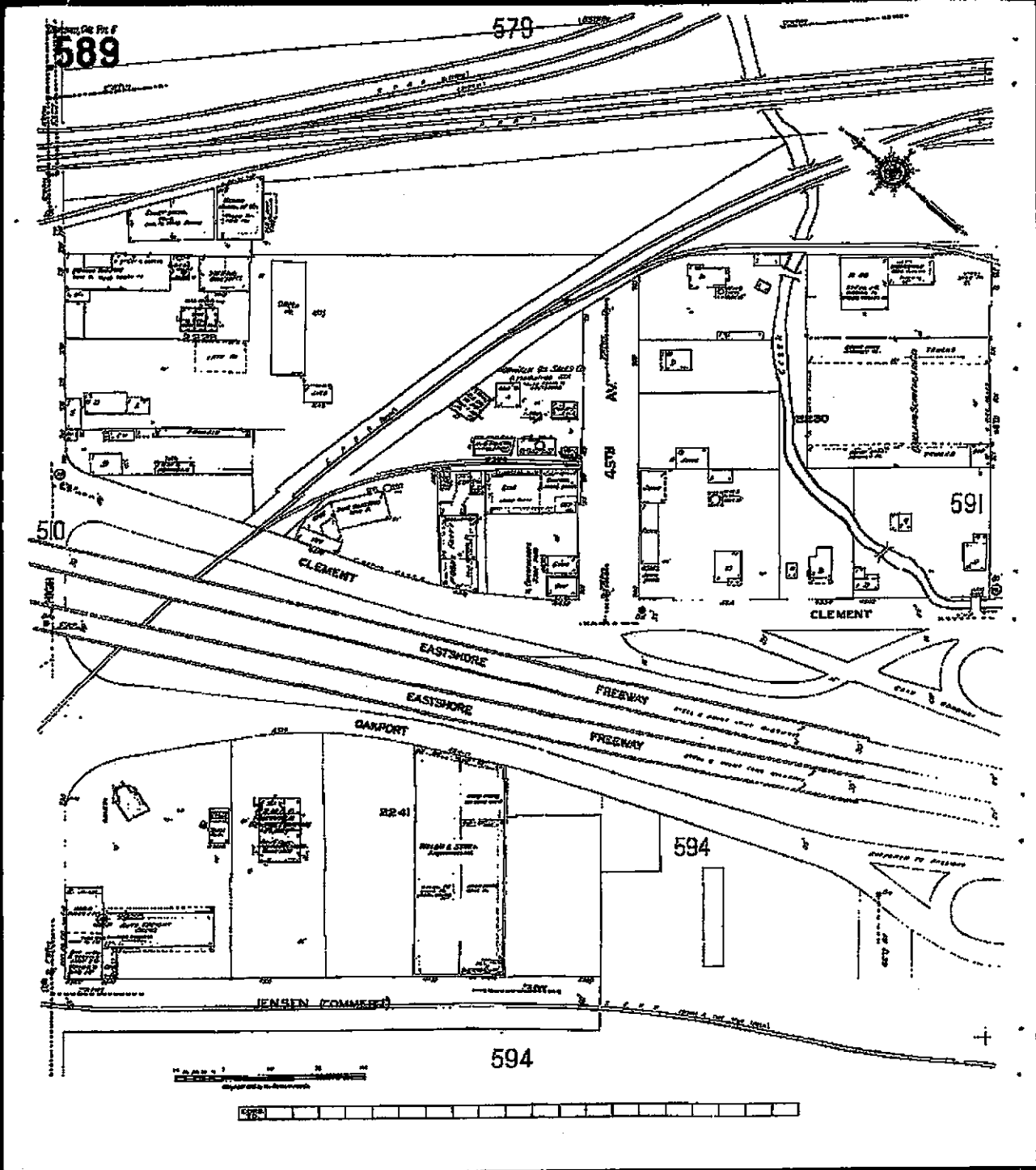

The Sanborn Library, LLC

This Sanborn® Map is a certified copy produced by Environmental Data Resources, Inc. under arrangement with The Sanborn Library, LLC. Information on this Sanborn® Map is derived from Sanborn field surveys conducted in

Copyright © 1992 The Sanborn Library, LLC CAS
 Year ECR Research Associates

Reproduction in whole or in part of any map of The Sanborn Library, LLC may be prohibited without prior written permission from The Sanborn Library, LLC.

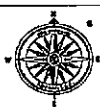
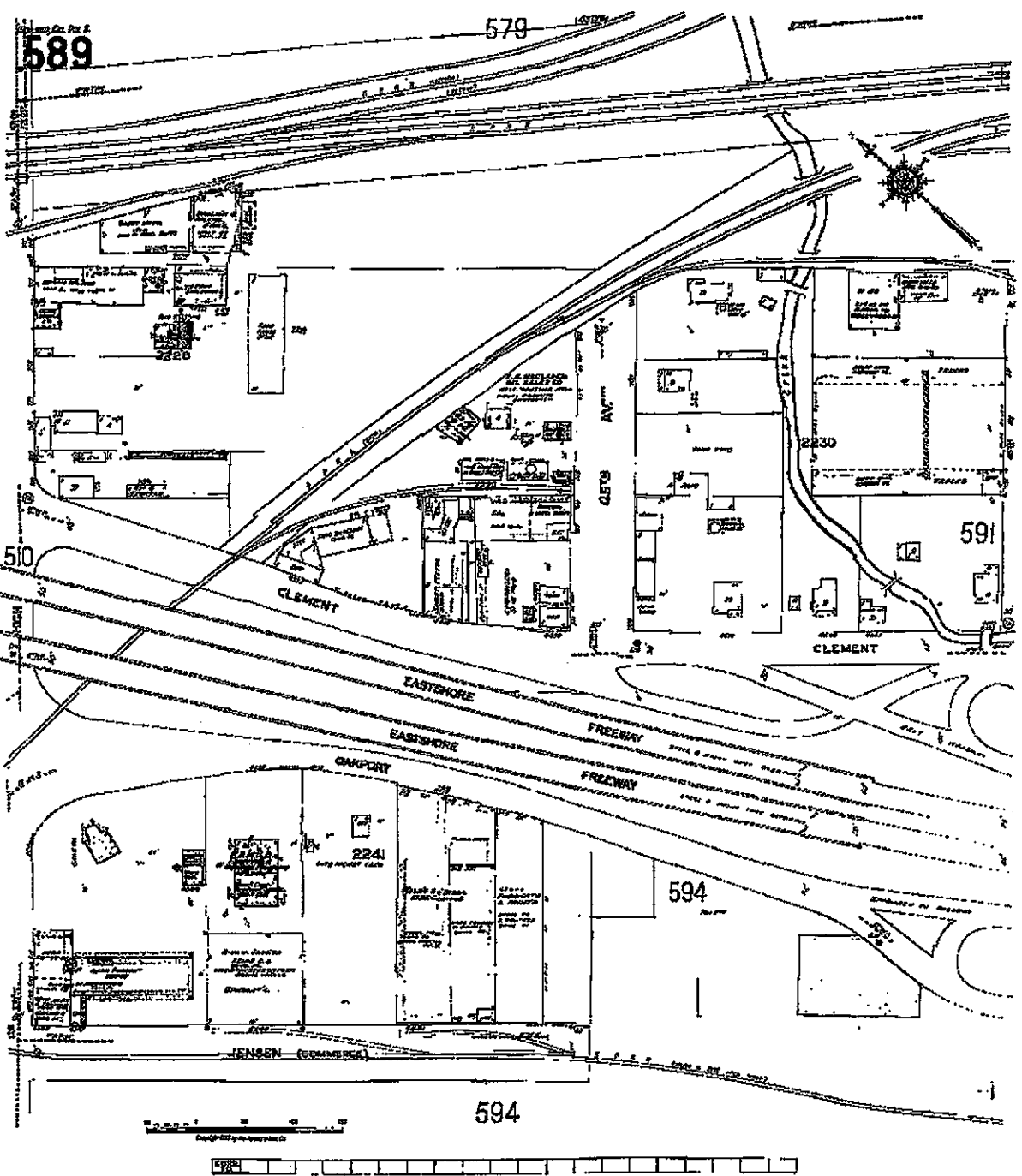

The Sanborn Library, LLC

This Sanborn® map is a certified copy produced by Environmental Data Resources, Inc. under arrangement with The Sanborn Library, LLC. Information on this Sanborn® Map is derived from Sanborn field surveys conducted in:

Copyright © 1957 The Sanborn Library, LLC CAG
 Year EDR Research Associates

Reproduction in whole or in part of any map of The Sanborn Library, LLC may be prohibited without prior written permission from The Sanborn Library, LLC.

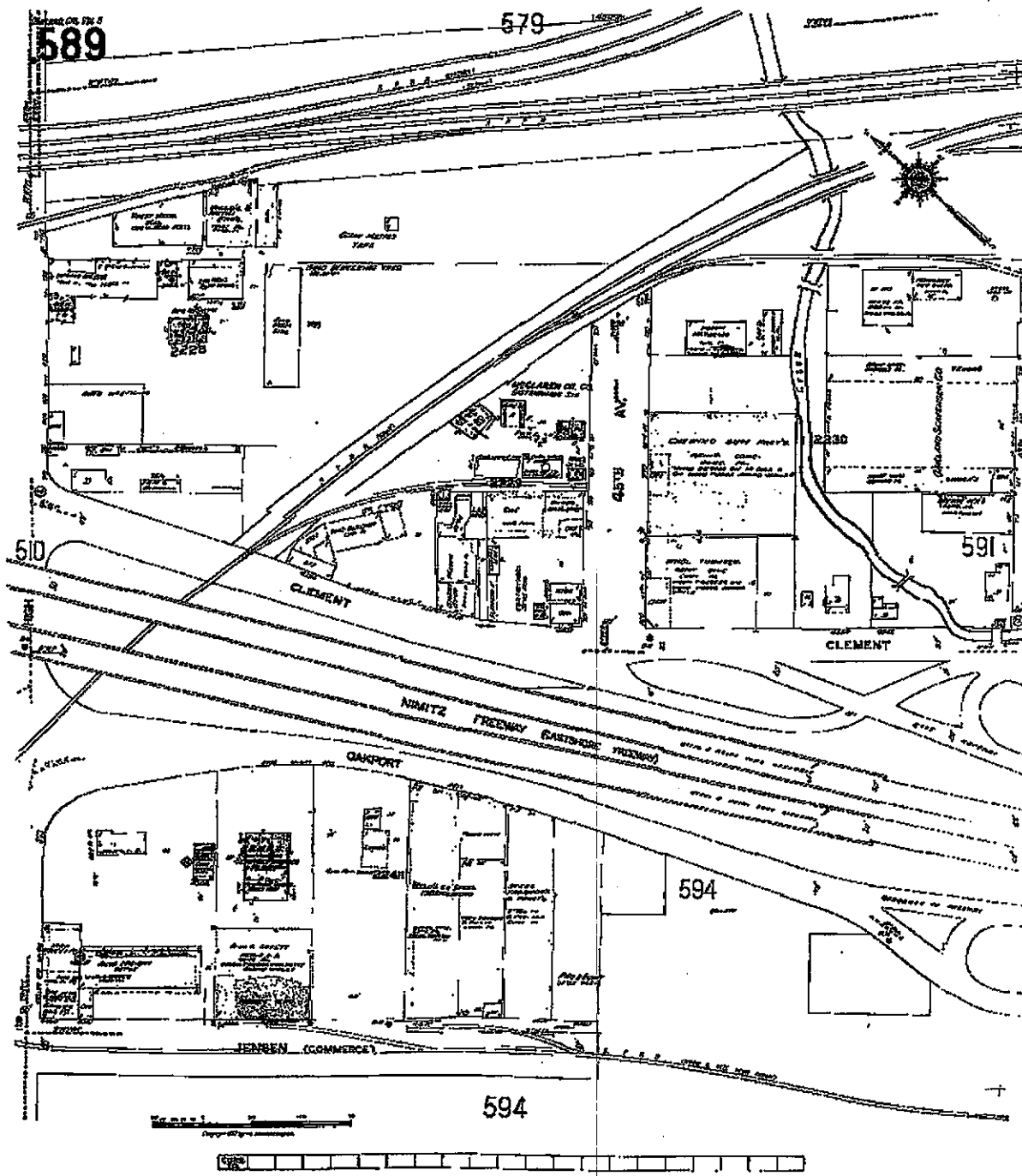

The Sanborn Library, LLC

This Sanborn® Map is a certified copy produced by Environmental Data Resources, Inc. under arrangement with The Sanborn Library, LLC. Information on this Sanborn® Map is derived from Sanborn field surveys conducted in:

Copyright © 1981 The Sanborn Library, LLC CAG
 Year EDI Research Associate

Reproduction in whole or in part of any items of The Sanborn Library, LLC may be prohibited without prior written permission from The Sanborn Library, LLC.

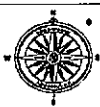
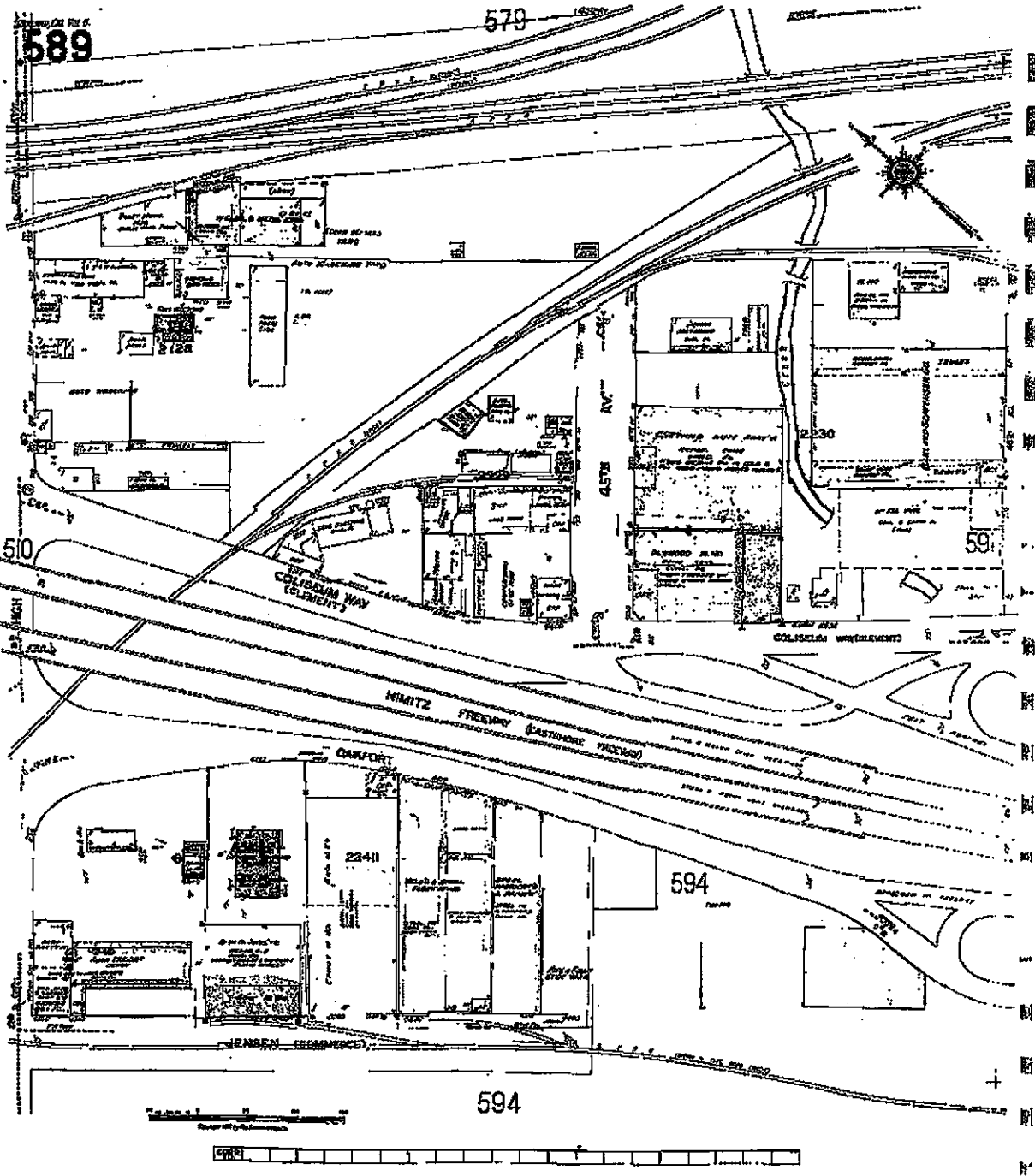

The Sanborn Library, LLC

This Sanborn® Map is a certified copy produced by Environmental Data Resources, Inc. under arrangement with The Sanborn Library, LLC. Information on this Sanborn® Map is derived from Sanborn Aerial surveys conducted in:

Copyright © 1986 The Sanborn Library, LLC CAG
 Year EDR Research Associate

Reproduction in whole or in part of any map of The Sanborn Library, LLC may be prohibited without prior written permission from The Sanborn Library, LLC.

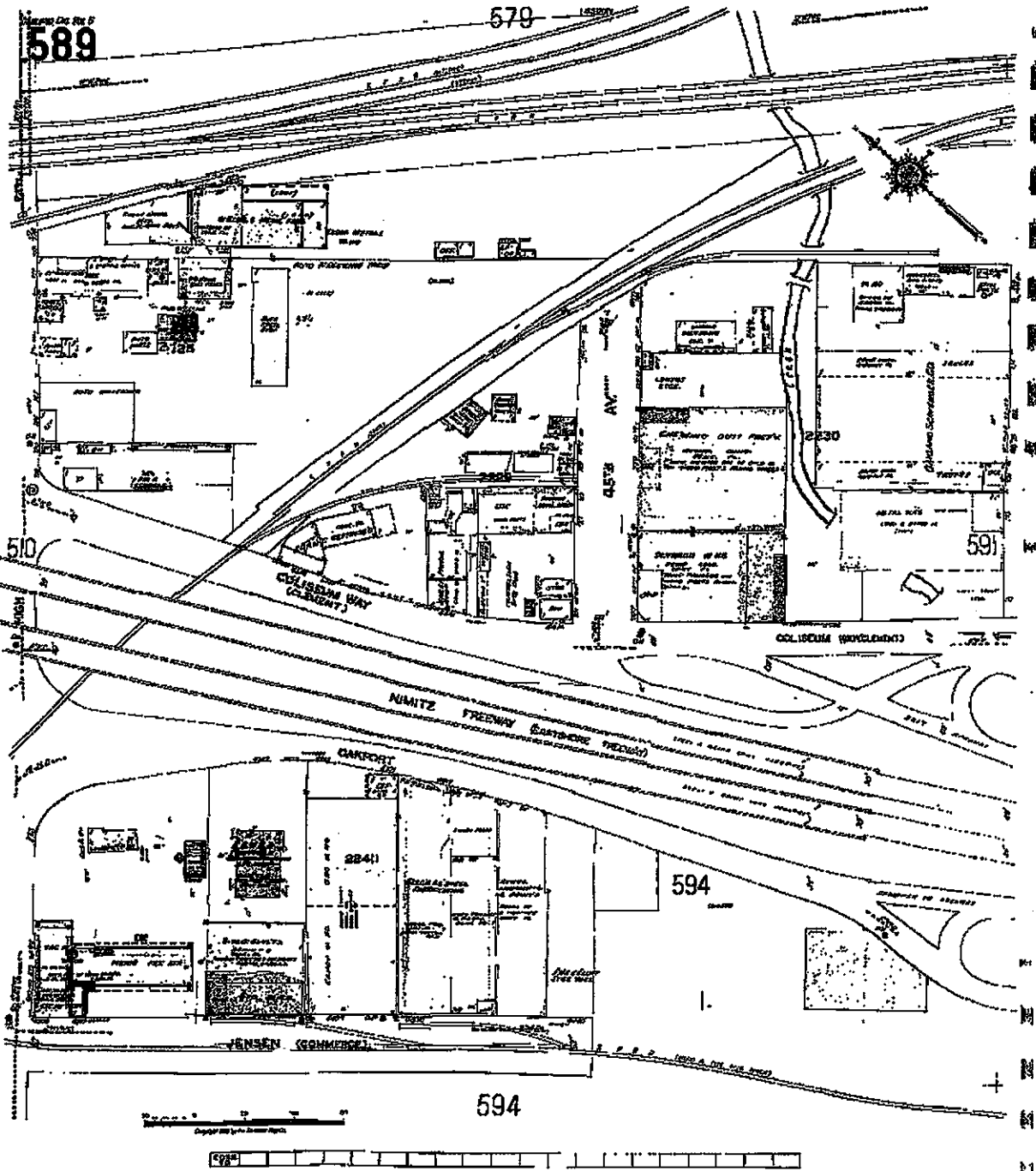

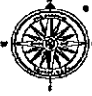
The Sanborn Library, LLC
 This Sanborn® Map is a certified copy produced by Environmental Data Resources, Inc., under arrangement with The Sanborn Library, LLC. Information on this Sanborn® Map is derived from Sanborn field surveys conducted in:
 Copyright © 1999 The Sanborn Library, LLC CAG
 Year SDN District Accession
 Reproduction in whole or in part of any map of The Sanborn Library, LLC may be prohibited without prior written permission from The Sanborn Library, LLC.