

FROM : DeJesus Pump and Well Drilling FAX NO. : 925-634-3422

Feb. 27 2001 02:54PM P5

10-7-99

left yard 10:15  
arrive job 11:38

Well Destructions  
4 @ Berry Ave.  
1 @ Shafer

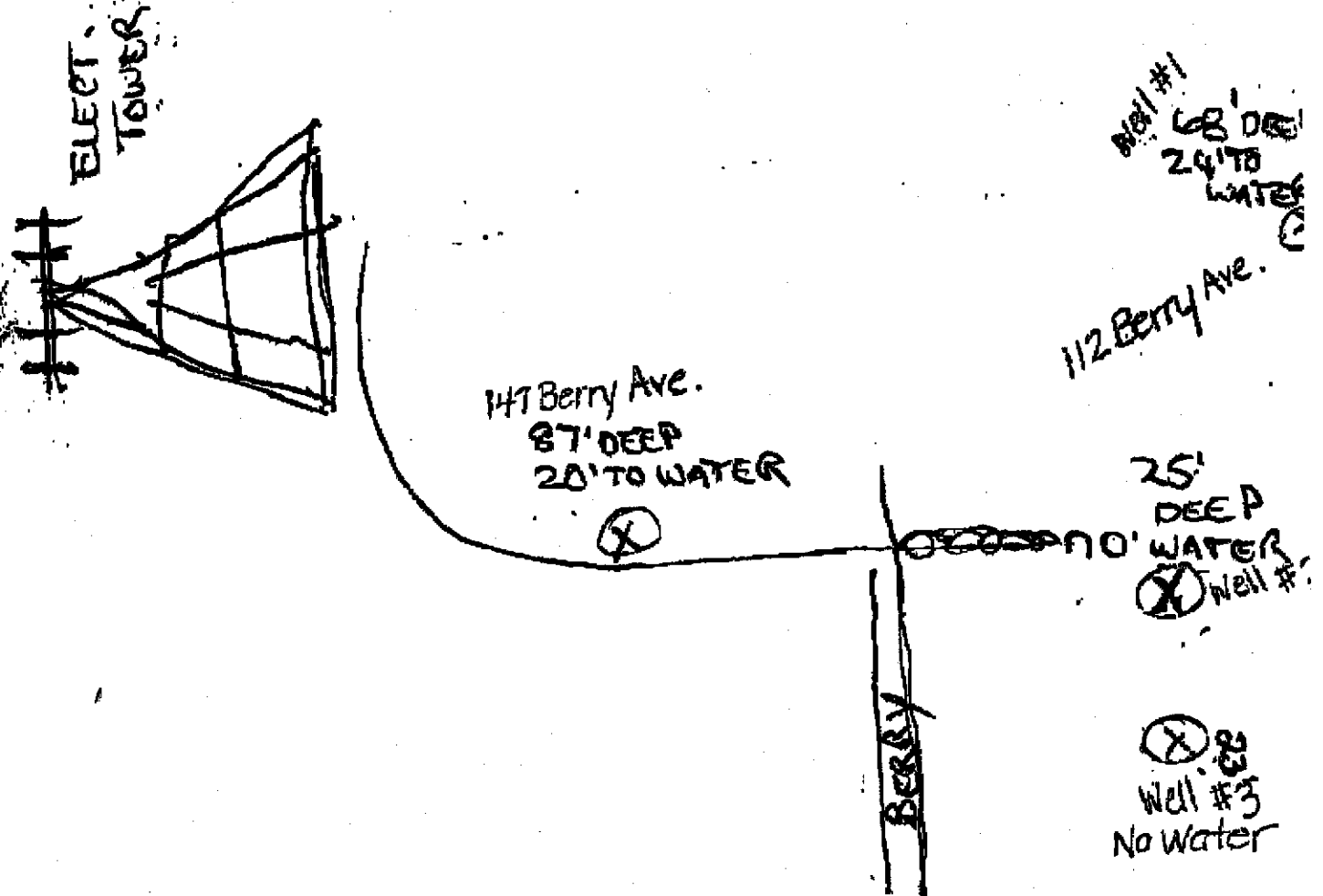

SHAFER WELL  
50' DEEP  
15' TO WATER