

City of San Leandro  
Civic Center, 835 E. 14th Street  
San Leandro, California 94577



July 24, 1989

To: Larry Seto  
Alameda County Hazardous Materials  
80 Swan Way, Room 200  
Oakland, CA 94621

From: Eric W. Staedicke, City of San Leandro Industrial Waste Inspector

Re: Groundwater Contamination on 2000-2100 Williams Street

Background: The Crown Zellerbach Corporation had two underground tank failures. In 1982, 1,500 gallons of N-Propyl acetate was lost, in 1983, 2,000 gallons of isopropyl acetate was lost. Harding Lawson Associates was hired and made a full site investigation. The laboratory results of the 1986 testing is enclosed. November of 1987, the James River Corporation, which had merged with Crown Zellerbach, applied for a Special Discharge Permit with the City of San Leandro to dispose of the groundwater. The City of San Leandro issued a permit in April of 1988; providing that the City's Industrial Waste water Limits were met. As of this date, no discharge under this permit has been made. At present, James River would not be able to meet discharge limits.

Present: James River has replaced Harding Lawson with Brown and Caldwell (contact Paula Diepolder at 937-9010). Brown and Caldwell has conducted its own site investigation using the existing sampling wells. They are finding more pollutants and at much higher concentrations than Harding Lawson. Brown and Caldwell thinks the pollutants may be moving in from the up gradient side (east) of the property. A groundwater test 800 feet to the east by Weiss and Associates (contact Dan Badner at 465-1100) who was working for Kelloggs of 2040 Williams also found elevated numbers of PCE and TCE. This looks to support the idea that pollutants maybe coming from off site. Enclosed is a map of the James River sampling site and on of the immediate area.

Lab results from the latest Brown and Caldwell report are still in final draft form but listed below are some examples of what they have found:

Dave Karp, Mayor

City Council: John E. Faria; Bob Glaze; William F. Jardin;  
Linda Perry; Anthony B. Santos; Edwin J. Suchman; Dick Randall, City Manager



<u>Parameter</u>	<u>Results (ppb)</u>	<u>Alarm Level (ppb)</u>	<u>Prop 65</u>
PCE	5,000	4	*
TCE	600	5	*
1,2 DCE	6,000	1	*
Vinyl Chloride	1,000	2	*
Toluene	2,900	100	
Xylene	400	620	
Acetone	780,000		
2-Hexone	8,200		
2-propyl	30,000		

Communication: Mr. Robert L. Wenning, Engineering Manager  
James River Corporation  
2101 Williams Street  
San Leandro, CA 94577

Phone: (415)895-4356

My meeting with Mr. Wenning was at 10:00 a.m. on the 20th of July, 1989.

Contacted after my meeting was:

Katherine Chesick 1:30 p.m. 7/20/1989  
Alameda County Hazardous Materials

Ray Cahler 2:00 p.m. 7/20/1989  
CRWQCB

Although the amount of information available at the City's Industrial Waste Office is limited, you are more than welcome to inspect our files on James River. If you require further information, feel free to contact me at 577-3434.



Eric W. Staedicke  
Industrial Waste Inspector  
City of San Leandro  
3000 Davis Street  
San Leandro, CA 94577

EWS:sm

CC Lester Feldman  
CRW&CB  
FILE

Table 5. Ground-water Chemical Data  
(milligrams per liter)

Well No.	Date	N-propyl Acetate	I-propyl Acetate	N-propyl Alcohol	I-propyl Alcohol	Acetone	Acetic*** Acid	Propionic*** Acid	Methyl Alcohol	Ethyl Alcohol	Ethyl Acetate	Toluene
W-1	2/05/86	ND	ND	ND	1800	1500	1600	1100	ND	ND	ND	ND
W-2	2/05/86	24	320	510	4800	400	4600	1300	30	1600	80	ND
W-3	2/05/86	ND	ND	41	2500	980	2400	4100	ND	TR	ND	ND
W-4	2/05/86	240	5070	1100	18,000	610	15,600	490	500	8900	1080	ND
W-4D*	2/05/86	NA	3600	NA	18,000	440	NA	NA	NA	NA	NA	NA
W-4**	2/06/86	NA	2100	NA	12,000	460	NA	NA	NA	NA	NA	NA
W-4**	2/06/86	NA	1700	NA	14,000	160	NA	NA	NA	NA	NA	NA
W-4**	2/07/86	NA	1500	NA	9,600	420	NA	NA	NA	NA	NA	NA
W-5	2/04/86	ND	TR	ND	TR	TR	80	ND	ND	10	ND	ND
W-6	2/04/86	ND	ND	ND	ND	ND	ND	ND	ND	ND	ND	ND
W-7	2/04/86	ND	ND	ND	ND	ND	ND	ND	ND	ND	ND	ND
W-8	2/05/86	ND	ND	ND	60	120	60	ND	ND	ND	ND	ND
W-8D	2/05/86	ND	ND	ND	40	140	80	ND	ND	ND	ND	ND
W-9	2/05/86	ND	ND	ND	ND	ND	ND	ND	ND	ND	ND	ND
B-1	2/05/86	ND	ND	ND	ND	ND	ND	ND	ND	ND	ND	ND

## Notes:

Ground-water samples analyzed by Crown Zellerbach Chemical Laboratory unless otherwise noted.

\* Ground-water sample analyzed by Analytical Science Associates (ASA).

\*\* Aquifer test sample analyzed by ASA.

\*\*\* ND, None detected, estimated detection limit less than 30 mg/l.

D = Duplicate sample.

ND = None detected, estimated detection limit less than 10 mg/l.

NA = Not analyzed.

TR = Trace detected, less than estimated detection limit, identity not confirmed.

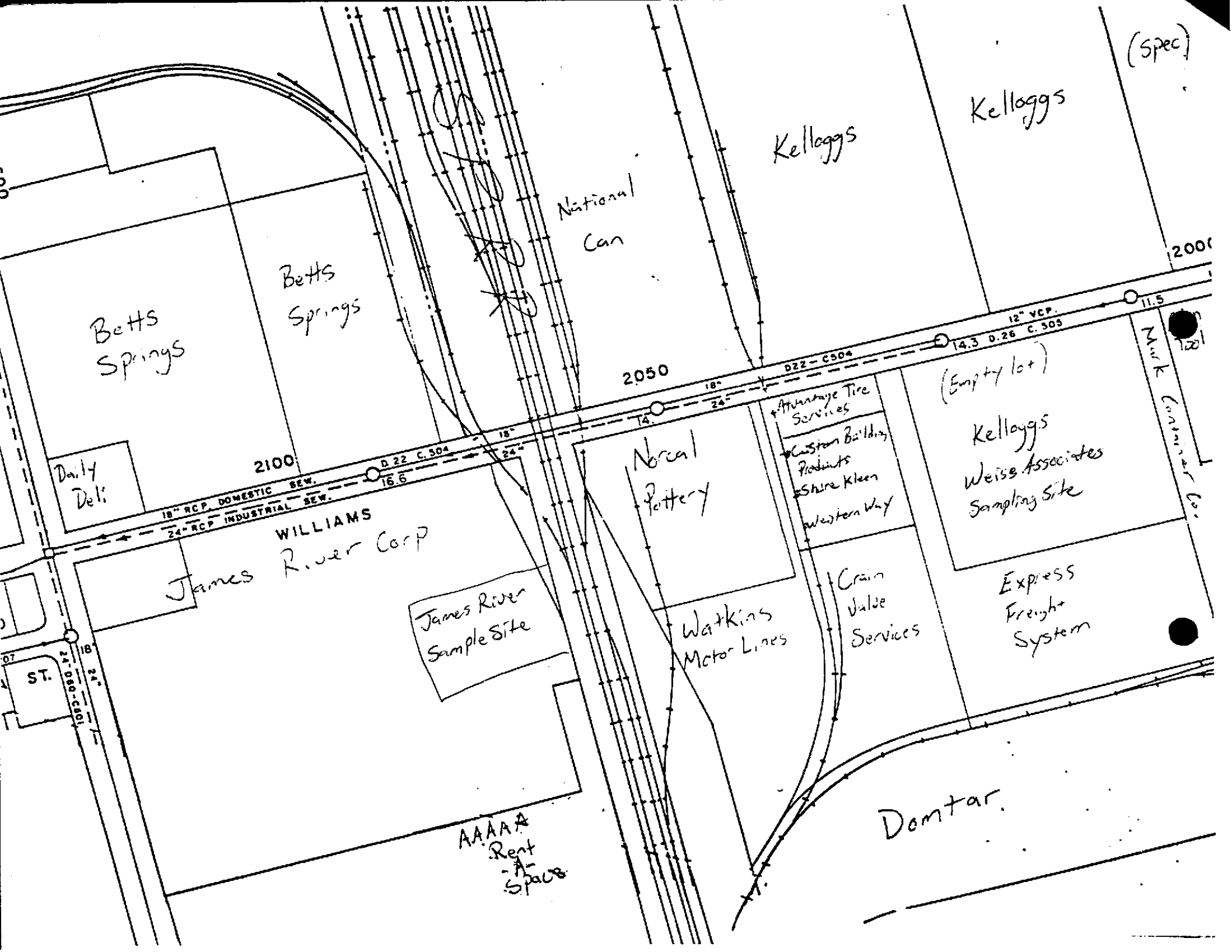

(Spec)

Kelloggs

Kelloggs

National  
Can

Betts  
Springs

Betts  
Springs

2000

11.5

12" VCP  
14.3 D. 26 C. 505

D22 - C504

2050

18"  
24"

2100

18" RCP DOMESTIC SEW.  
24" RCP INDUSTRIAL SEW.  
D. 22 C. 504  
16.6

Daily  
Deli

WILLIAMS  
James River Corp

James River  
Sample Site

Norcal  
Pottery

Advantage Tire  
Services  
Custom Building  
Products  
Shire Klean  
Western Way

(Empty lot)

Kelloggs  
Weiss Associates  
Sampling Site

Nick  
Contractor Co.

Crain  
Valve  
Services

Watkins  
Motor Lines

Express  
Freight  
System

ST.

24" 060 - C601  
18"  
24"

AAAAA  
Rent  
Space

Domtar

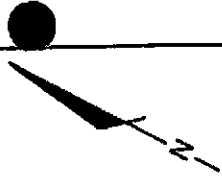
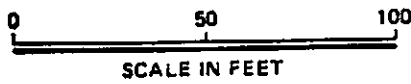

PROPERTY LINE

CROWN ZELLERBACH



ABOVE GROUND STORAGE TANKS

UNDERGROUND STORAGE TANKS

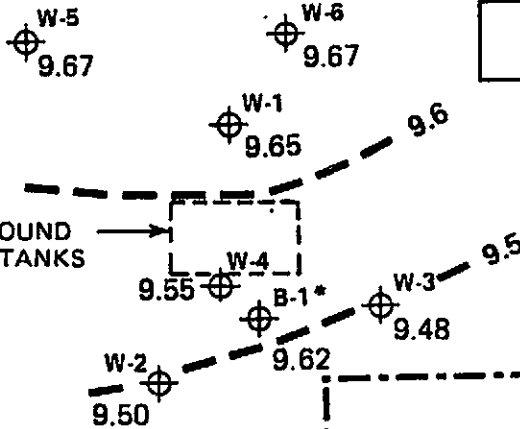

CROWN ZELLERBACH  
FLEXIBLE  
PACKAGING PLANT

AAAAA  
RENT - A - SPACE

EXPLANATION



W-1 Well Location and Identification

9.65 Water Level Elevation on 3-4-86 in Feet above Mean Sea Level

9.5 Line of Equal Water Level Elevation

• Different Aquifer; Data Not Used for Contouring



W-8 9.33



W-7 9.03



W-9 9.11

**HLA** Harding Lawson Associates  
Engineers Geologists  
& Geophysicists

Water-Level Elevation, March 1986  
Crown Zellerbach  
San Leandro, California

8