



**CONESTOGA-ROVERS  
& ASSOCIATES**

10969 Trade Center Drive  
Rancho Cordova, California 95670  
Telephone: (916) 889-8900 Fax: (916) 889-8999  
[www.CRAworld.com](http://www.CRAworld.com)

June 14, 2011

Reference No. 631916

Mr. Jerry Wickham  
Alameda County Environmental Health (ACEH)  
1131 Harbor Bay Parkway, Suite 250  
Alameda, California 94502-6577

Re: Sub-Slab Vapor Probe Destruction Request  
Former Signal Oil Marine Storage and Distribution Facility  
(Former Chevron Bulk Plant 20-6127)  
2301-2311 Blanding Avenue  
Alameda, California  
LOP Case RO0002466

---

**RECEIVED**

11:02 am, Jun 22, 2011

Alameda County  
Environmental Health

Dear Mr. Wickham:

Conestoga-Rovers & Associates (CRA) is submitting this letter to document our telephone conversation earlier today regarding sub-slab vapor probes VP-10 through VP-12 (Figure 1), located within the vacant Suite E of 2307 Blanding Avenue. As discussed, the property lessee is in the process of renting the suite and would like to have the sub-slab vapor probes removed prior to occupancy. During our telephone conversation, it was agreed that the probes will be properly destroyed since ACEH is not currently requiring further sampling of the sub-slab probes; however, ACEH may require that additional probes be installed at some point in the future. Unless otherwise notified, CRA will immediately begin the process of properly destroying sub-slab vapor probes VP-10 through VP-12 to facilitate the property lessee's rental of the suite.

We appreciate your assistance on this project. If you have any questions regarding this extension request, please contact me at (916) 889-8908.

Sincerely,

CONESTOGA-ROVERS & ASSOCIATES

Brian Silva

BS/kw/7

Encl.

Figure 1 Site Map

cc: Mike Bauer, Chevron (*electronic only*)  
Julie Beck Ball  
Peter Reinhold Beck  
Monroe Wingate  
Tom Foley, Gallagher & Miersch

---

Equal  
Employment Opportunity  
Employer

---

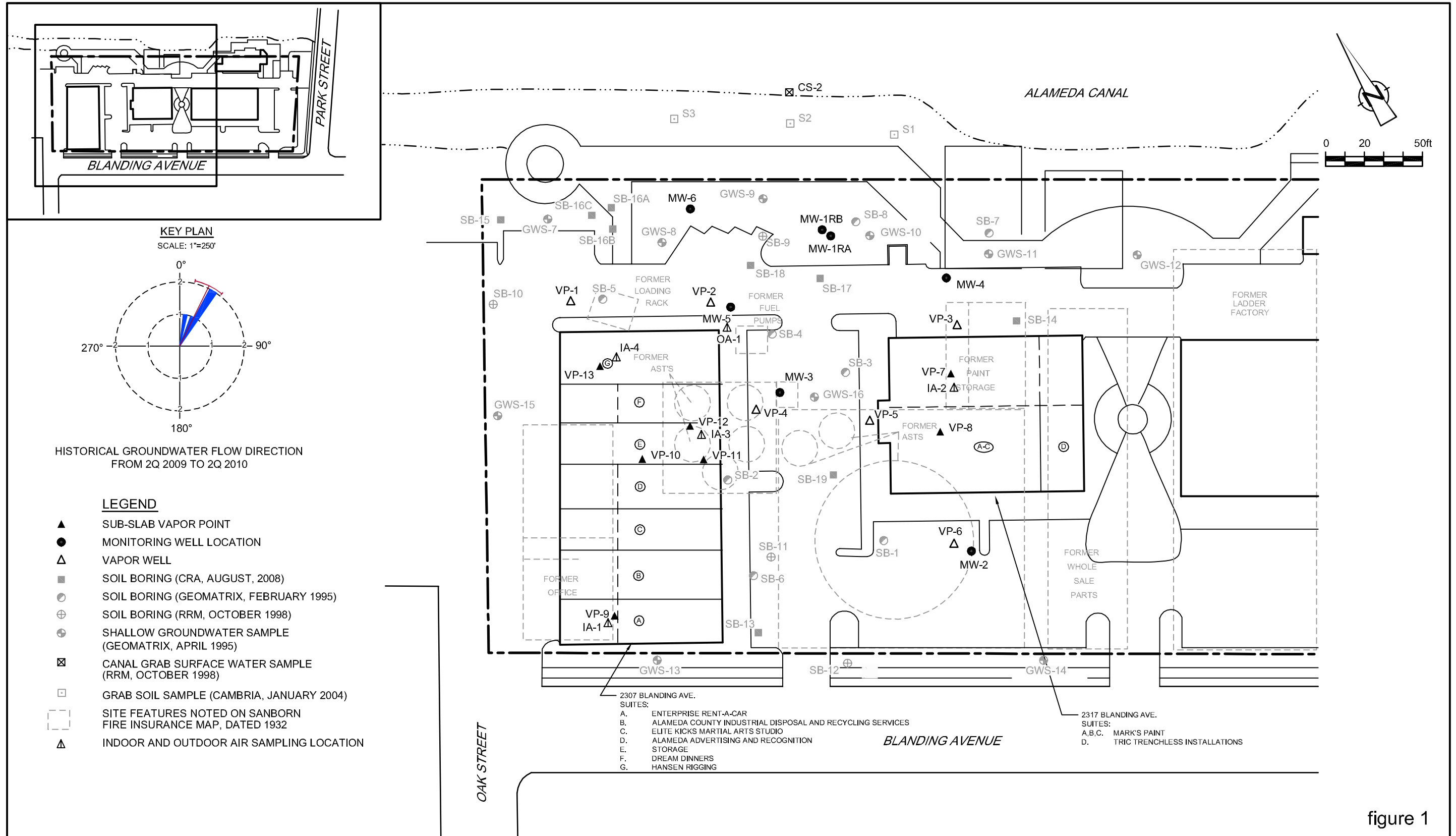

figure 1  
 SITE PLAN  
 FORMER SIGNAL OIL MARINE STORAGE AND DISTRIBUTION FACILITY  
 (CHEVRON FACILITY 20-6127)  
 2301-2311 BLANDING AVENUE  
 Alameda, California

NOTE:  
 WELL LOCATIONS ARE BASED ON MAP PROVIDED BY MORROW SURVEYING  
 (DWG NO.0857-149 ct, DATED 7-30-09).  
 ALL OTHER LOCATIONS ARE APPROXIMATE.

