

**LOWNEY ASSOCIATES**  
Environmental / Geotechnical / Engineering Services

# Fax Transmittal

**Mountain View Office**  
405 Clyde Avenue  
Mountain View, CA 94043  
Tel: 650.967.2365  
Fax: 650.967.2785

**Oakland Office**  
129 Filbert Street  
Oakland, CA 94607  
Tel: 510.267.1970  
Fax: 510.267.1972

**Pasadena Office**  
1785 Locust St., Suite 10  
Pasadena, CA 91106  
Tel: 626.396.1490  
Fax: 626.396.1491

**San Ramon Office**  
2258 Camino Ramon  
San Ramon, CA 94583  
Tel: 925.275.2550  
Fax: 925.275.2555

**To:** Alameda Co. Dept. of Environmental Health  
**Attn:** Susan Hugo  
**Fax:** (510) 337-9335  
**CC:**

**From:** Mark Arniola  
**Date:** April 13, 2001  
**Pages:** 2 (Including Cover)  
**Project:** 1274 65<sup>th</sup> St and 1269 66<sup>th</sup> Street  
**Job #:** 1424-4

Please notify us if you received this fax in error by calling the office indicated above.

**Remarks:**     Urgent     For your review     Reply ASAP     Please comment

Susan,

The proposed types of soil borings are marked on the site plan on the following page. I've also added a couple of railroad spurs that were not on the original site plan. Also, borings which have been relocated are marked with arrows.

Sincerely,

Mark Arniola

*Cost 0000 201  
4/17/01  
Jalil to*

Mail copy to follow:    Yes    No    Time Sent: \_\_\_\_\_ Sent By: \_\_\_\_\_

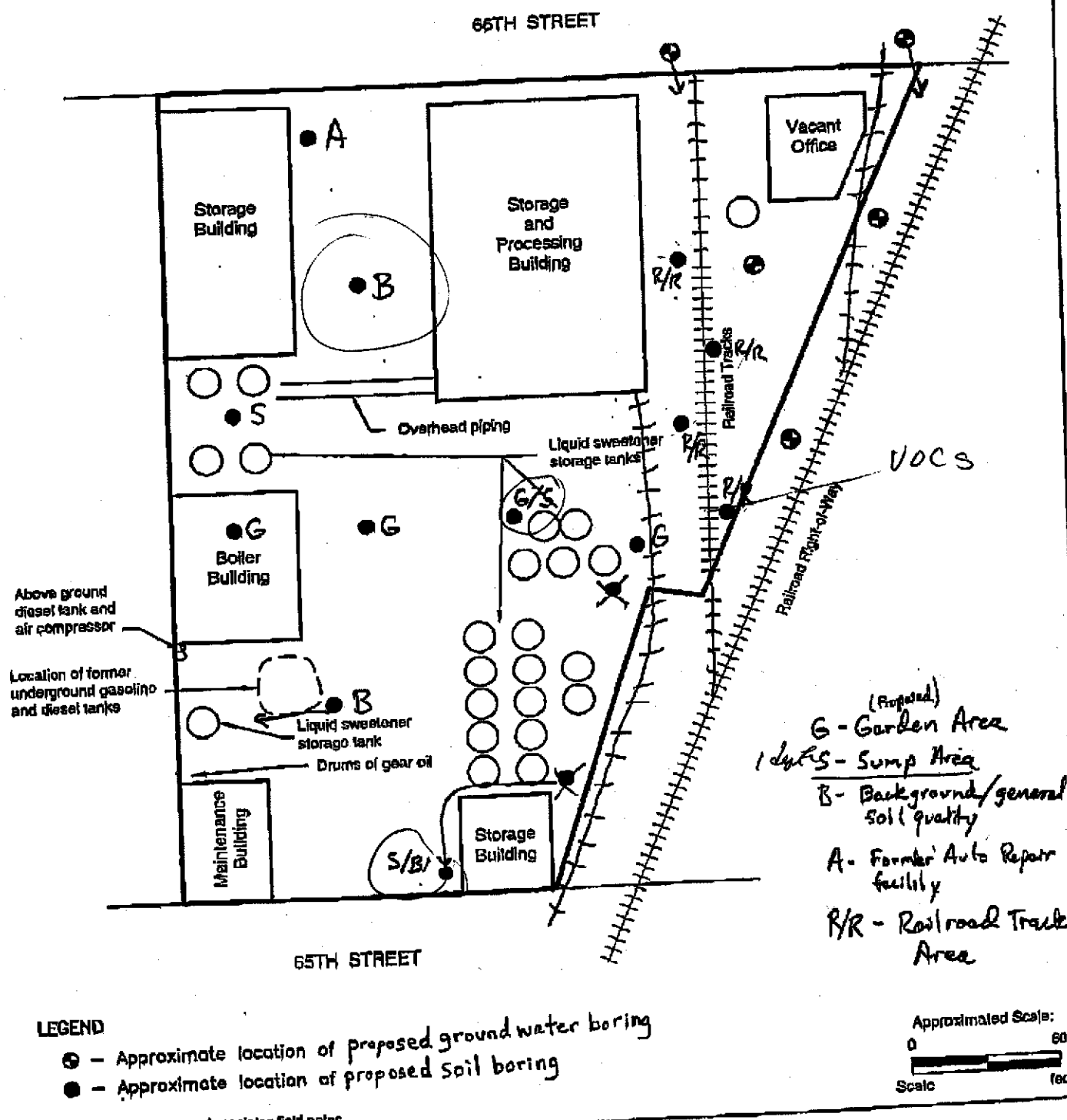

### SITE PLAN

1269 66TH STREET, 1274 65TH STREET  
Emeryville, California

**LOWNEY ASSOCIATES**  
Environmental/Geotechnical/Engineering Services

**FIGURE 1**  
1424-4