



2000 Crow Canyon Place
Suite 400
San Ramon, CA 94583

Phone: (925) 277-2305
Fax: (925) 277-2361

Alameda County

Environmental Department

AUG 21 2003

August 21, 2003

Environmental Health

RO 2444

Re: **Tosco (Unocal) Service Station #7124**
10151 East 14th Street
Oakland, California

"I declare under penalty of perjury, that to the best of my knowledge at the present time, the information and/or recommendations contained in the attached proposal or report is true and correct."

David B. DeWitt
Site Manager
ConocoPhillips



GETTLER-RYAN INC.

TRANSMITTAL

August 6, 2003

G-R #180299

Alameda County

TO: Mr. David B. De Witt
ConocoPhillips
76 Broadway Avenue
Sacramento, California 95818

AUG 8 2003
CC: Mr. Forrest McFarland
Secor International, Inc.
Environmental Health
2501 Leghorn Street
Mountain View, CA 94043

FROM: Deanna L. Harding
Project Coordinator
Gettler-Ryan Inc.
6747 Sierra Court, Suite J
Dublin, California 94568

RE: Tosco (Unocal) Service Station
#7124
10151 East 14th Street
Oakland, California

WE HAVE ENCLOSED THE FOLLOWING:

COPIES	DATED	DESCRIPTION
1	July 29, 2003	Groundwater Monitoring and Sampling Report Third Quarter - Event of July 1, 2003

COMMENTS:

This report is being sent to you for your review/comment, prior to being distributed on your behalf. If no comments are received by **August 20, 2003**, this report will be distributed to the following:

cc: Ms. Eya Chu, Alameda County Health Care Services, 1131 Harbor Bay Parkway, Suite 250 Alameda, CA 94502

AG

Enclosure



GETTLER-RYAN INC.

July 29, 2003
G-R Job #180299

Mr. David B. De Witt
ConocoPhillips
76 Broadway Avenue
Sacramento, California 95818

RE: Third Quarter Event of July 1, 2003
Groundwater Monitoring & Sampling Report
Tosco (Unocal) Service Station #7124
10151 East 14th Street
Oakland, California

Dear Mr. De Witt:

This report documents the most recent groundwater monitoring and sampling event performed by Gettler-Ryan Inc. (G-R) at the referenced site. All field work was conducted in accordance with G-R Standard Operating Procedure - Groundwater Sampling (attached).

Static groundwater levels were measured and all wells were checked for the presence of separate-phase hydrocarbons. Separate-phase hydrocarbons were not present in the wells. Static water level data and groundwater elevations are summarized in Table 1. A Potentiometric Map is included as Figure 1.

Groundwater samples were collected from the monitoring wells and submitted to a state certified laboratory for analyses. The field data sheets for this event are attached. Analytical results are presented in the table(s) listed below. A Concentration Map is included as Figure 2. The chain of custody document and laboratory analytical report are also attached.

Sincerely,

Deanna L. Harding
Project Coordinator

Robert C. Mallory
Registered Geologist, No. 7285

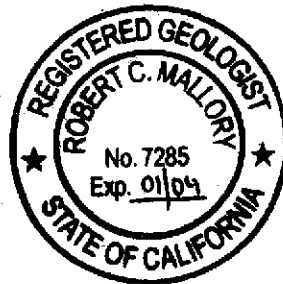
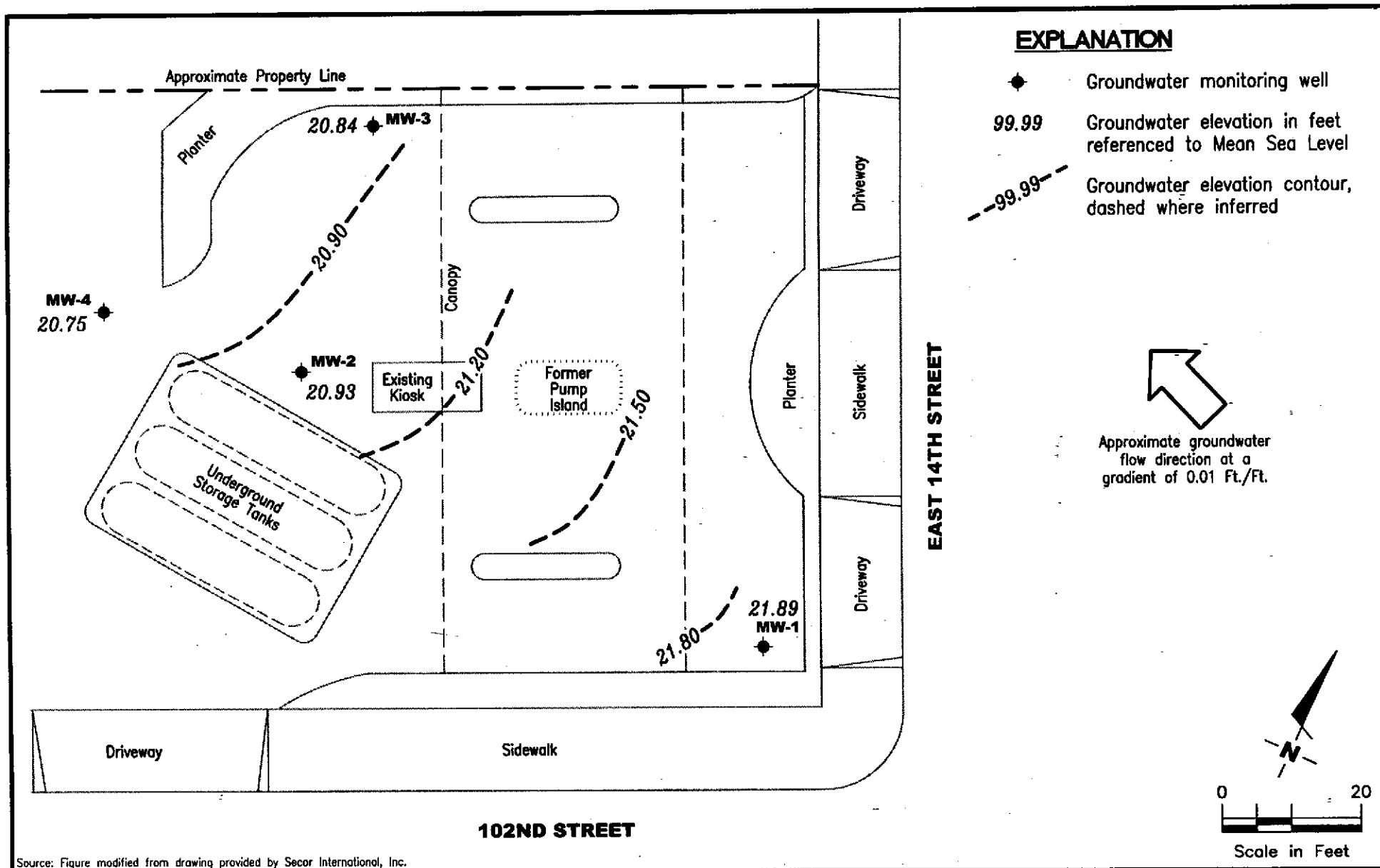

Figure 1: Potentiometric Map
Figure 2: Concentration Map
Table 1: Groundwater Monitoring Data and Analytical Results
Table 2: Groundwater Analytical Results
Attachments: Standard Operating Procedure - Groundwater Sampling
Field Data Sheets
Chain of Custody Document and Laboratory Analytical Reports

7124.qml



Source: Figure modified from drawing provided by Secor International, Inc.

GETTLER - RYAN INC.
 6747 Sierra Ct., Suite J
 Dublin, CA 94568 (925) 551-7555

POTENTIOMETRIC MAP
 Tosco (Unocal) Service Station #7124
 10151 East 14th Street
 Oakland, California

FIGURE
1

PROJECT NUMBER
 180299

REVIEWED BY

DATE
 July 1, 2003

REVISED DATE

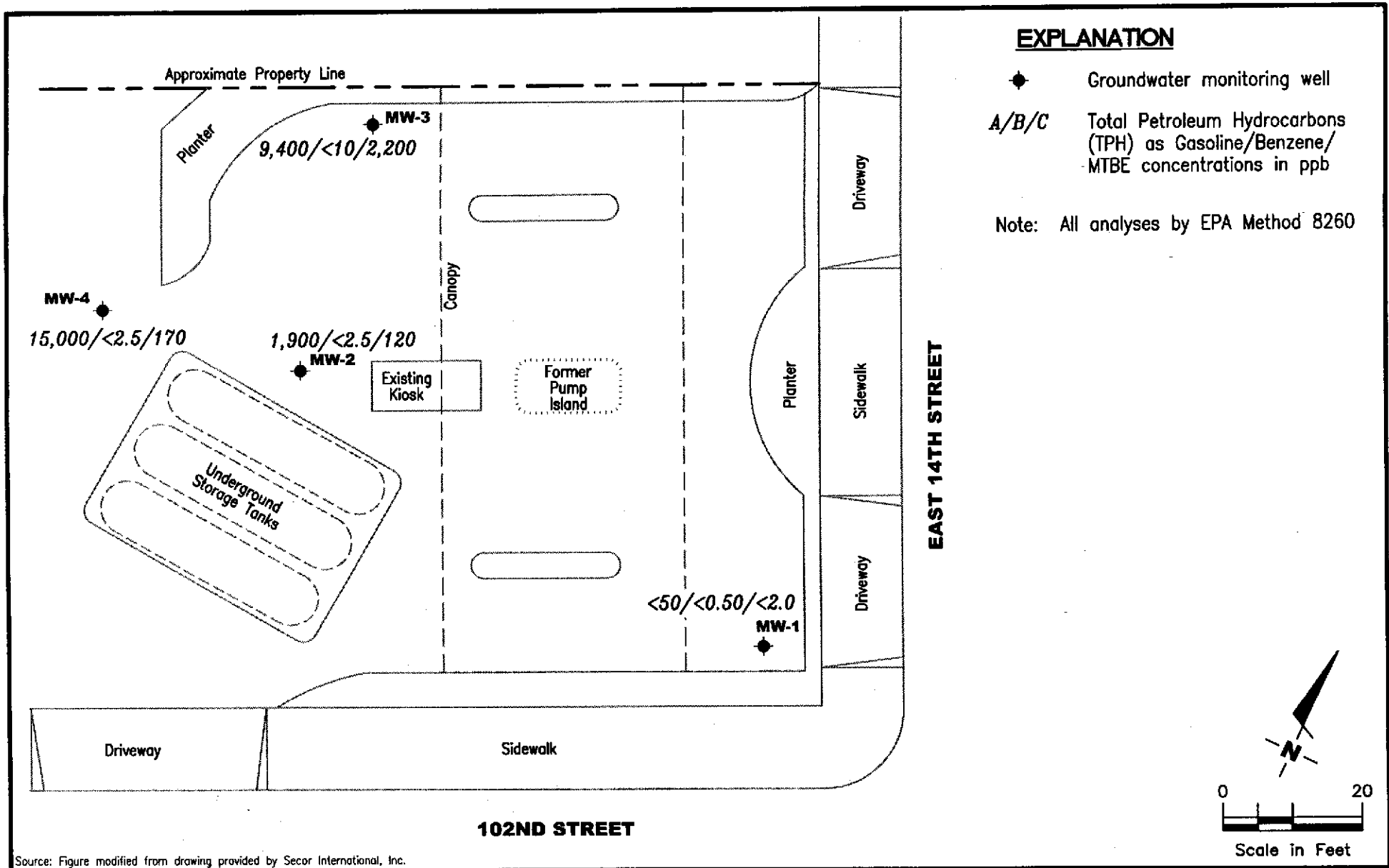

Source: Figure modified from drawing provided by Secor International, Inc.

GETTLER - RYAN INC.
 6747 Sierra Ct., Suite J
 Dublin, CA 94568 (925) 551-7555

CONCENTRATION MAP
 Tosco (Unocal) Service Station #7124
 10151 East 14th Street
 Oakland, California

FIGURE

2

PROJECT NUMBER
 180299

REVIEWED BY

DATE
 July 1, 2003

REVISED DATE

Table 1
Groundwater Monitoring Data and Analytical Results
 Tosco (Unocal) Service Station #7124
 10151 East 14th Street
 Oakland, California

WELL ID/ TOC* (ft.)	DATE	DTW (ft.)	GWE (msl)	TPH-G (ppb)	B (ppb)	T (ppb)	E (ppb)	X (ppb)	MTBE (ppb)
MW-1									
37.37	04/08/02 ¹	14.27	23.10	<50	<0.50	<0.50	<0.50	<0.50	<2.5/<2.0 ²
	07/28/02 ³	15.88	21.49	<50	<0.50	<0.50	<0.50	<1.0	<2.0
	11/03/02 ³	16.75	20.62	<50	<0.50	<0.50	<0.50	<1.0	<2.0
	01/24/03 ³	13.94	23.43	<50	<0.50	<0.50	<0.50	<1.0	<2.0
	04/02/03 ³	14.99	22.38	460 ⁴	<0.50	<0.50	<0.50	<1.0	<2.0
	07/01/03 ³	15.48	21.89	<50	<0.50	<0.50	<0.50	<1.0	<2.0
MW-2									
37.87	04/08/02 ¹	15.86	22.01	4,400	<2.5	<2.5	6.4	<2.5	380/490 ²
	07/28/02 ³	17.28	20.59	3,200 ⁴	<2.5	<2.5	<2.5	<5.0	170
	11/03/02 ³	18.03	19.84	3,800 ⁴	<5.0	<5.0	<5.0	<10	72
	01/24/03 ³	15.59	22.28	410 ⁴	<2.5	<2.5	<2.5	<5.0	490
	04/02/03 ³	16.50	21.37	1,000 ⁴	<5.0	<5.0	<5.0	<10	180
	07/01/03 ³	16.94	20.93	1,900 ⁴	<2.5	<2.5	<2.5	<5.0	120
MW-3									
37.72	04/08/02 ¹	15.86	21.86	8,700	65	<25	400	<25	6,500/8,300 ²
	07/28/02 ³	17.22	20.50	4,500 ⁴	<25	<25	<25	<50	1,100
	11/03/02 ³	17.90	19.82	25,000 ⁴	<5.0	<5.0	25	<10	470
	01/24/03 ³	15.57	22.15	6,000	<25	<25	94	<50	10,000
	04/02/03 ³	16.45	21.27	130,000 ⁴	<100	<100	<100	<200	4,400
	07/01/03 ³	16.88	20.84	9,400 ⁴	<10	<10	<10	<20	2,200
MW-4									
38.36	04/08/01 ¹	16.59	21.77	13,000	<5.0	<5.0	28	<5.0	790/980 ²
	07/28/02 ³	17.93	20.43	18,000 ⁴	<2.5	<2.5	<2.5	<5.0	170
	11/03/02 ³	18.66	19.70	220 ⁴	<0.50	<0.50	<0.50	<1.0	5.7

Table 1
Groundwater Monitoring Data and Analytical Results
 Tosco (Unocal) Service Station #7124
 10151 East 14th Street
 Oakland, California

WELL ID/ TOC* (ft.)	DATE	DTW (ft.)	GWE (msl)	TPH-C (ppb)	B (ppb)	T (ppb)	E (ppb)	X (ppb)	MTBE (ppb)
MW-4	01/24/03 ³	16.27	22.09	<1,000	<10	<10	<10	<20	1,000
(cont)	04/02/03 ³	17.19	21.17	130,000 ⁴	<100	<100	<100	<200	<400
	07/01/03 ³	17.61	20.75	15,000 ⁴	<2.5	<2.5	<2.5	<5.0	170
Trip Blank									
TB-LB	04/08/02	--	--	<50	<0.50	<0.50	<0.50	<0.50	<2.5
QA	07/28/02 ³	--	--	<50	<0.50	<0.50	<0.50	<1.0	<2.0
	11/03/02 ³	--	--	<50	<0.50	<0.50	<0.50	<1.0	<2.0
	01/24/03 ³	--	--	<50	<0.50	<0.50	<0.50	<1.0	<2.0
	04/02/03 ³	--	--	<50	<0.50	<0.50	<0.50	<1.0	<2.0
	07/01/03 ³	--	--	<50	<0.50	<0.50	<0.50	<1.0	<2.0

Table 1
Groundwater Monitoring Data and Analytical Results
Tosco (Unocal) Service Station #7124
10151 East 14th Street
Oakland, California

EXPLANATIONS:

TOC = Top of Casing

(ft.) = Feet

DTW = Depth to Water

GWE = Groundwater Elevation

(msl) = Mean sea level

TPH-G = Total Petroleum Hydrocarbons as Gasoline

B = Benzene

T = Toluene

E = Ethylbenzene

X = Xylenes

MTBE = Methyl tertiary butyl ether

(ppb) = Parts per billion

-- = Not Measured/Not Analyzed

QA = Quality Assurance/Trip Blank

* TOC elevations were surveyed on March 18, 2002, by Mid Coast Engineers. The benchmark used for the survey is HT0281, a benchmark disk in a concrete headwall on the east side of Railroad Avenue approximately 500 feet south of 85th Avenue (Benchmark Elevation = 11.50 feet NGVD 29).

¹ Well development performed.

² MTBE by EPA Method 8260.

³ TPH-G, BTEX and MTBE by EPA Method 8260.

⁴ Laboratory report indicates hydrocarbon pattern is present in the requested fuel quantitation range but does not resemble the pattern of the requested fuel.

Table 2
Groundwater Analytical Results - Oxygenate Compounds
 Tosco (Unocal) Service Station #7124
 10151 East 14th Street
 Oakland, California

WELL ID	DATE	ETHANOL (ppb)	TBA (ppb)	MTBE (ppb)	DIPE (ppb)	ETBE (ppb)	TAME (ppb)	1,2-DCA (ppb)	EDB (ppb)
MW-1	04/08/02	<500	<100	<2.0	<2.0	<2.0	<2.0	<2.0	<2.0
	07/28/02	<500	<100	<2.0	<2.0	<2.0	<2.0	<2.0	<2.0
	11/03/02	<500	<100	<2.0	<2.0	<2.0	<2.0	<2.0	<2.0
	01/24/03	<500	<100	<2.0	<2.0	<2.0	<2.0	<2.0	<2.0
	04/02/03	<500	<100	<2.0	<2.0	<2.0	<2.0	<2.0	<2.0
	07/01/03	<500	<100	<2.0	<2.0	<2.0	<2.0	<2.0	<2.0
MW-2	04/08/02	<10,000	<2,000	490	<40	<40	<40	<40	<40
	07/28/02	<2,500	<500	170	<10	<10	<10	<10	<10
	11/03/02	<5,000	<1,000	72	<20	<20	<20	<20	<20
	01/24/03	<2,500	<500	490	<10	<10	<10	<10	<10
	04/02/03	<5,000	<1,000	180	<20	<20	<20	<20	<20
	07/01/03	<2,500	<500	120	<10	<10	<10	<10	<10
MW-3	04/08/02	<250,000	<50,000	8,300	<1,000	<1,000	<1,000	<1,000	<1,000
	07/28/02	<25,000	<5,000	1,100	<100	<100	<100	<100	<100
	11/03/02	<5,000	<1,000	470	<20	<20	<20	<20	<20
	01/24/03	<25,000	<5,000	10,000	<100	<100	<100	<100	<100
	04/02/03	<100,000	<20,000	4,400	<400	<400	<400	<400	<400
	07/01/03	<10,000	<2,000	2,200	<40	<40	<40	<40	<40
MW-4	04/08/02	<25,000	<5,000	980	<100	<100	<100	<100	<100
	07/28/02	<2,500	<500	170	<10	<10	<10	<10	<10
	11/03/02	<500	<100	5.7	<2.0	<2.0	<2.0	<2.0	<2.0
	01/24/03	<10,000	<2,000	1,000	<40	<40	<40	<40	<40
	04/02/03	<100,000	<20,000	<400	<400	<400	<400	<400	<400
	07/01/03	<2,500	<500	170	<10	<10	<10	<10	<10

Table 2
Groundwater Analytical Results - Oxygenate Compounds
Tosco (Unocal) Service Station #7124
10151 East 14th Street
Oakland, California

EXPLANATIONS:

TBA = Tertiary butyl alcohol
MTBE = Methyl tertiary butyl ether
DIPE = Di-isopropyl ether
ETBE = Ethyl tertiary butyl ether
TAME = Tertiary amyl methyl ether
1,2-DCA = 1,2-Dichloroethane
EDB = 1,2-Dibromoethane
(ppb) = Parts per billion

ANALYTICAL METHOD:

EPA Method 8260 for Oxygenate Compounds

STANDARD OPERATING PROCEDURE - GROUNDWATER SAMPLING

Gettler-Ryan Inc. field personnel adhere to the following procedures for the collection and handling of groundwater samples prior to analysis by the analytical laboratory. Prior to sample collection, the type of analysis to be performed is determined. Loss prevention of volatile compounds is controlled and sample preservation for subsequent analysis is maintained.

Prior to sampling, the presence or absence of free-phase hydrocarbons is determined using an interface probe. Product thickness, if present, is measured to the nearest 0.01 foot and is noted in the field notes. In addition, all depth to water level measurements are collected with a static water level indicator and are also recorded in the field notes, prior to purging and sampling any wells.

After water levels are collected and prior to sampling, temperature, pH and electrical conductivity are measured. If purging is to occur, each well is purged a minimum of three well casing volumes of water using pre-cleaned pumps (stack, suction, Grundfos), or disposable bailers. The measurements are taken a minimum of three times during the purging. Purging continues until these parameters stabilize.

Groundwater samples are collected using disposable bailers. The water samples are transferred from the bailer into appropriate containers. Pre-preserved containers, supplied by analytical laboratories, are used when possible. When pre-preserved containers are not available, the laboratory is instructed to preserve the sample as appropriate. Duplicate samples are collected for the laboratory to use in maintaining quality assurance/quality control standards. The samples are labeled to include the job number, sample identification, collection date and time, analysis, preservation (if any), and the sample collector's initials. The water samples are placed in a cooler, maintained at 4°C for transport to the laboratory. Once collected in the field, all samples are maintained under chain of custody until delivered to the laboratory.

The chain of custody document includes the job number, type of preservation, if any, analysis requested, sample identification, date and time collected, and the sample collector's name. The chain of custody is signed and dated (including time of transfer) by each person who receives or surrenders the samples, beginning with the field personnel and ending with the laboratory personnel.

A laboratory supplied trip blank accompanies each sampling set and is labeled as QA. For sampling sets greater than 20 samples, 5% trip blanks are included. The trip blank is analyzed for some or all of the same compounds as the groundwater samples.

As requested by ConocoPhillips Company, the purge water and decontamination water generated during sampling activities is transported to ConocoPhillips - San Francisco Refinery, located in Rodeo, California.



GETTLER - RYAN INC.

WELL MONITORING/SAMPLING FIELD DATA SHEET

Client/Facility #: ConocoPhillips #7124 Job Number: 180299
 Site Address: 10151 East 14Th Street Event Date: 7-1-03 (inclusive)
 City: Oakland, CA Sampler: BG

Well ID: MW-1 Date Monitored: 7-1-07 Well Condition: OK
 Well Diameter: 4 in.
 Total Depth: 24.50 ft.
 Depth to Water: 15.48 ft.
 Volume Factor (VF): 9.02 x VF .66 = 6 x3 (case volume) = Estimated Purge Volume: 18 gal.

Volume	3/4"= 0.02	1"= 0.04	2"= 0.17	3"= 0.38
Factor (VF)	4"= 0.66	5"= 1.02	6"= 1.50	12"= 5.80

Purge Equipment:
 Disposable Bailer _____
 Stainless Steel Bailer _____
 Stack Pump _____
 Suction Pump _____
 Grundfos _____
 Other: _____

Sampling Equipment:
 Disposable Bailer _____
 Pressure Bailer _____
 Discrete Bailer _____
 Other: _____

Time Started: _____ (2400 hrs)
 Time Bailed: _____ (2400 hrs)
 Depth to Product: _____ ft
 Depth to Water: _____ ft
 Hydrocarbon Thickness: _____ ft
 Visual Confirmation/Description: _____
 Skimmer / Absorbant Sock (circle one)
 Amt Removed from Skimmer: _____ gal
 Amt Removed from Well: _____ gal
 Product Transferred to: _____

Start Time (purge): 1020 Weather Conditions: Sunny
 Sample Time/Date: 1036 7-1-03 Water Color: Brown Odor: No
 Purging Flow Rate: 3 gpm. Sediment Description: light silt
 Did well de-water? No If yes, Time: _____ Volume: _____ gal.

Time (2400 hr.)	Volume (gal.)	pH	Conductivity (umhos/cm)	Temperature (C/F)	D.O. (mg/L)	ORP (mV)
<u>1022</u>	<u>6</u>	<u>7.96</u>	<u>392</u>	<u>18.7</u>		
<u>1024</u>	<u>12</u>	<u>7.91</u>	<u>391</u>	<u>18.9</u>		
<u>1027</u>	<u>18</u>	<u>7.86</u>	<u>392</u>	<u>19.1</u>		

LABORATORY INFORMATION

SAMPLE ID	(#) CONTAINER	REFRIG.	PRESERV. TYPE	LABORATORY	ANALYSES
<u>MW-1</u>	<u>3</u> x vva vial	<u>YES</u>	<u>HCL</u>	<u>STL Pleasanton</u>	<u>TPH-G/BTEX/MTBE/8 Oxy's(8260)</u>

COMMENTS: _____

Add/Replaced Lock: Add/Replaced Plug: _____ Size: _____



GETTLER-RYAN INC.

WELL MONITORING/SAMPLING FIELD DATA SHEET

Client/Facility #: ConocoPhillips #7124 Job Number: 180299
 Site Address: 10151 East 14Th Street Event Date: 7.1-03 (inclusive)
 City: Oakland, CA Sampler: BG

Well ID: MW-2 Date Monitored: 7.1-03 Well Condition: OK
 Well Diameter: 4 in.
 Total Depth: 24.99 ft.
 Depth to Water: 16.94 ft.
 Volume Factor (VF): 0.05 xVF .66 = 5 x3 (case volume) = Estimated Purge Volume: 15 gal.

Volume	3/4"= 0.02	1"= 0.04	2"= 0.17	3"= 0.38
Factor (VF)	4"= 0.66	5"= 1.02	6"= 1.50	12"= 5.80

Purge Equipment:
 Disposable Bailer _____
 Stainless Steel Bailer _____
 Stack Pump _____
 Suction Pump _____
 Grundfos _____
 Other: _____

Sampling Equipment:
 Disposable Bailer _____
 Pressure Bailer _____
 Discrete Bailer _____
 Other: _____

Time Started: _____ (2400 hrs)
 Time Bailed: _____ (2400 hrs)
 Depth to Product: _____ ft
 Depth to Water: _____ ft
 Hydrocarbon Thickness: _____ ft
 Visual Confirmation/Description:
 Skimmer / Absorbant Sock (circle one)
 Amt Removed from Skimmer: _____ gal
 Amt Removed from Well: _____ gal
 Product Transferred to: _____

Start Time (purge): 1039 Weather Conditions: Sunny
 Sample Time/Date: 1049 7.1-03 Water Color: gray Odor: Slight
 Purging Flow Rate: 3 gpm. Sediment Description: _____
 Did well de-water? No If yes, Time: _____ Volume: _____ gal.

Time (2400 hr.)	Volume (gal.)	pH	Conductivity (u mhos/cm)	Temperature (C/F)	D.O. (mg/L)	ORP (mV)
<u>1041</u>	<u>5</u>	<u>7.92</u>	<u>403</u>	<u>19.4</u>		
<u>1043</u>	<u>10</u>	<u>7.80</u>	<u>411</u>	<u>19.4</u>		
<u>1045</u>	<u>15</u>	<u>7.72</u>	<u>408</u>	<u>19.3</u>		

LABORATORY INFORMATION

SAMPLE ID	(#) CONTAINER	REFRIG.	PRESERV. TYPE	LABORATORY	ANALYSES
<u>MW-2</u>	<u>3</u> x voa vial	<u>YES</u>	<u>HCL</u>	<u>STL Pleasanton</u>	<u>TPH-G/BTEX/MTBE/8 Oxy's(8260)</u>

COMMENTS: _____

Add/Replaced Lock: Add/Replaced Plug: Size: 4"



GETTLER-RYAN INC.

WELL MONITORING/SAMPLING FIELD DATA SHEET

Client/Facility #: ConocoPhillips #7124 Job Number: 180299
 Site Address: 10151 East 14Th Street Event Date: 7-1-03 (inclusive)
 City: Oakland, CA Sampler: BG

Well ID: MW-3 Date Monitored: 7-1-07 Well Condition: OK

Well Diameter: 4 in.
 Total Depth: 24.85 ft.
 Depth to Water: 16.88 ft.
7.97

Volume	3/4"= 0.02	1"= 0.04	2"= 0.17	3"= 0.38
Factor (VF)	4"= 0.66	5"= 1.02	6"= 1.50	12"= 5.80

xVF .66 = 5 x3 (case volume) = Estimated Purge Volume: 15 gal.

Purge Equipment:
 Disposable Bailer _____
 Stainless Steel Bailer _____
 Stack Pump _____
 Suction Pump _____
 Grundfos _____
 Other: _____

Sampling Equipment:
 Disposable Bailer _____
 Pressure Bailer _____
 Discrete Bailer _____
 Other: _____

Time Started: _____ (2400 hrs)
 Time Bailed: _____ (2400 hrs)
 Depth to Product: _____ ft
 Depth to Water: _____ ft
 Hydrocarbon Thickness: _____ ft
 Visual Confirmation/Description: _____
 Skimmer / Absorbant Sock (circle one)
 Amt Removed from Skimmer: _____ gal
 Amt Removed from Well: _____ gal
 Product Transferred to: _____

Start Time (purge): 1115 Weather Conditions: Sunny
 Sample Time/Date: 1128 17-1-07 Water Color: 91AM Odor: YES
 Purging Flow Rate: 3 gpm. Sediment Description: _____
 Did well de-water? NO If yes, Time: _____ Volume: _____ gal.

Time (2400 hr.)	Volume (gal.)	pH	Conductivity (u mhos/cm)	Temperature (C/F)	D.O. (mg/L)	ORP (mV)
<u>1117</u>	<u>5</u>	<u>7.32</u>	<u>427</u>	<u>18.8</u>		
<u>1119</u>	<u>10</u>	<u>7.26</u>	<u>431</u>	<u>18.9</u>		
<u>1121</u>	<u>15</u>	<u>7.20</u>	<u>430</u>	<u>18.9</u>		

LABORATORY INFORMATION

SAMPLE ID	(#) CONTAINER	REFRIG.	PRESERV. TYPE	LABORATORY	ANALYSES
<u>MW-3</u>	<u>3</u> x voc vial	<u>YES</u>	<u>HCL</u>	<u>STL Pleasanton</u>	<u>TPH-G/BTEX/MTBE/8 Oxy's(8260)</u>

COMMENTS: _____

Add/Replaced Lock: _____ Add/Replaced Plug: _____ Size: _____



GETTLER-RYAN INC.

WELL MONITORING/SAMPLING FIELD DATA SHEET

Client/Facility #: ConocoPhillips #7124 Job Number: 180299
 Site Address: 10151 East 14Th Street Event Date: 7-1-07 (inclusive)
 City: Oakland, CA Sampler: BB

Well ID: MW-4 Date Monitored: 7-1-07 Well Condition: OK

Well Diameter: 4 in.
 Total Depth: 24.70 ft.
 Depth to Water: 17.61 ft.
7.09

Volume	3/4"= 0.02	1"= 0.04	2"= 0.17	3"= 0.38
Factor (VF)	4"= 0.66	5"= 1.02	6"= 1.50	12"= 5.80

7.09 x VF-66 = 5 x3 (case volume) = Estimated Purge Volume: 15 gal.

Purge Equipment:

Disposable Bailer _____
 Stainless Steel Bailer _____
 Stack Pump _____
 Suction Pump _____
 Grundfos _____
 Other: _____

Sampling Equipment:

Disposable Bailer _____
 Pressure Bailer _____
 Discrete Bailer _____
 Other: _____

Time Started:	_____ (2400 hrs)
Time Bailed:	_____ (2400 hrs)
Depth to Product:	_____ ft
Depth to Water:	_____ ft
Hydrocarbon Thickness:	_____ ft
Visual Confirmation/Description:	_____
Skimmer / Absorbant Sock (circle one)	_____
Amt Removed from Skimmer:	_____ gal
Amt Removed from Well:	_____ gal
Product Transferred to:	_____

Start Time (purge): 1054 Weather Conditions: Sunny
 Sample Time/Date: 1110 7-1-07 Water Color: gray Odor: yes
 Purging Flow Rate: 3 gpm. Sediment Description: _____
 Did well de-water? no If yes, Time: _____ Volume: _____ gal.

Time (2400 hr.)	Volume (gal.)	pH	Conductivity (umhos/cm)	Temperature (C/F)	D.O. (mg/L)	ORP (mV)
<u>1056</u>	<u>5</u>	<u>7.51</u>	<u>430</u>	<u>19.2</u>		
<u>1058</u>	<u>10</u>	<u>7.46</u>	<u>419</u>	<u>19.3</u>		
<u>1101</u>	<u>18</u>	<u>7.46</u>	<u>421</u>	<u>19.3</u>		

LABORATORY INFORMATION

SAMPLE ID	(#) CONTAINER	REFRIG.	PRESERV. TYPE	LABORATORY	ANALYSES
<u>MW-4</u>	<u>3</u> x vva vial	<u>YES</u>	<u>HCL</u>	<u>STL Pleasanton</u>	<u>TPH-G/BTEX/MTBE/8 Oxy's(8260)</u>

COMMENTS:

Add/Replaced Lock: _____

Add/Replaced Plug: Size: 4"

2003-07-045

1112
Gettler-Ryan Inc., Chain-of-Custody

Tosco Corp./ Phillips 66 Co. 2000 Crow Canyon Place Suite 400 San Ramon, CA 94583	Facility Number	17124	Laboratory Name	STL - PLEASANTON, CA
	Facility Address	10151 EAST 14TH STREET, OAKLAND, CA	Consultant	GETTLER-RYAN, INC. DEANNA L. HARDING
	Global ID	Pending	Address	6747 SIERRA CT., SUITE J, DUBLIN CA 94568
	Client Contact	MR. DAVID B. DEWITT	Phone	(925) 551-7555 Fax (925) 551-7899
	Phone	916-558-7666	Samples Collected by	Brian Gan

SAMPLE ID	Number of Containers Matrix	S = Soil A = Air W = Water C = Charcoal	Sample Preservation	Date/Time (2400 Hrs)	TPH-GAS/BTEX/MTBE EPA 8015/8021B	TPH-ENGSEL EPA 8015	TPH-DIESEL w/SIBCS 94 EPA 8015	TPH-GAS EPA 8015	TPH-GAS/BTEX/MTBE EPA 8260	OXYGENATES EPA 8260	METHANOL EPA 8015	TOTAL OIL & GREASE EPA 5520	METALS Cd, Cr, Pb, Zn, Ni	NITRATE/SULFATE/ALKALINITY EPA 300 SERIES	MVOC'S (B010) EPA 8021B	VOC'S (B240) EPA 8260	SVOC'S EPA 8270	Remarks	
QA	1	W	HCL	7-1-03					X										
MW-1	3			1036					X	X									
MW-2	3			1049					X	X									
MW-3	3			1128					X	X									
MW-4	3	↓	↓	1110					X	X									

- OXYGENATES 8260
- 1 - MTBE
 - 2 - TBA
 - 3 - TAME
 - 4 - DIPE
 - 5 - ETBE
 - 6 - 1,2-DCA
 - 7 - EDB
 - 8 - ETHANOL

Relinquished By (Signature)	Organization	Date/Time	Received By (Signature)	Organization	Date/Time	iced Y/N	Turn Around Time (Circle Choice) 24 Hrs. 48 Hrs. 72 Hrs. 5 Days 10 Days As Contracted
<i>Brian Gan</i>	G-R	7-1-03	<i>Brian Gan</i>	G-R	7/1/03	iced <input checked="" type="checkbox"/> Y	
<i>Brian Gan</i>	G-R	7/2/03	<i>Brian Gan</i>	STL	7/2/03	iced Y/N	
Relinquished By (Signature)	Organization	Date/Time	Received For Laboratory By (Signature)		Date/Time	iced Y/N	
<i>Brian Gan</i>	STL	7-2-03 (1740)	<i>Brian Gan</i>		7/2/03 (1740)	iced Y/N	

FILE NAME: P:\ENVIRONMENTAL\CHARLOTTIST\STD-COC.DWG | Layout Tool Made

48

Gettler Ryan

July 18, 2003

6747 Sierra Court Suite J
Dublin, CA 94568

Attn.: Deanna Harding

Project#: 180299.80

Project: Conoco #7124

Site: 10151 East 14th Street, Oakland

RECEIVED

GENERAL CONTRACTOR

Dear Ms. Harding,

Attached is our report for your samples received on 07/02/2003 17:40

This report has been reviewed and approved for release. Reproduction of this report is permitted only in its entirety.

Please note that any unused portion of the samples will be discarded after 08/16/2003 unless you have requested otherwise.

We appreciate the opportunity to be of service to you. If you have any questions, please call me at (925) 484-1919.

You can also contact me via email. My email address is: tgranicher@stl-inc.com

Sincerely,



Tod Granicher
Project Manager

Gas/BTEX Fuel Oxygenates by 8260B

Gettler Ryan

Attn.: Deanna Harding

6747 Sierra Court Suite J

Dublin, CA 94568

Phone: (925) 551-7444 Fax: (925) 551-7899

Project: 180299.80

Conoco #7124

Received: 07/02/2003 17:40

Site: 10151 East 14th Street, Oakland

Samples Reported

Sample Name	Date Sampled	Matrix	Lab #
QA	07/01/2003	Water	1
MW-1	07/01/2003 10:36	Water	2
MW-2	07/01/2003 10:49	Water	3
MW-3	07/01/2003 11:28	Water	4
MW-4	07/01/2003 11:10	Water	5

Severn Trent Laboratories, Inc.

STL San Francisco * 1220 Quarry Lane, Pleasanton, CA 94566

Tel 925 484 1919 Fax 925 484 1096 * www.stl-inc.com * CA DHS ELAP# 2496

07/17/2003 12:50

Gas/BTEX Fuel Oxygenates by 8260B

Gettler Ryan

Attn.: Deanna Harding

6747 Sierra Court Suite J

Dublin, CA 94568

Phone: (925) 551-7444 Fax: (925) 551-7899

Project: 180299.80

Conoco #7124

Received: 07/02/2003 17:40

Site: 10151 East 14th Street, Oakland

Prep(s):	5030B	Test(s):	8260FAB
Sample ID:	QA	Lab ID:	2003-07-0145 - 1
Sampled:	07/01/2003	Extracted:	7/11/2003 10:53
Matrix:	Water	QC Batch#:	2003/07/11-1B.62

Compound	Conc.	RL	Unit	Dilution	Analyzed	Flag
Gasoline	ND	50	ug/L	1.00	07/11/2003 10:53	
Benzene	ND	0.50	ug/L	1.00	07/11/2003 10:53	
Toluene	ND	0.50	ug/L	1.00	07/11/2003 10:53	
Ethylbenzene	ND	0.50	ug/L	1.00	07/11/2003 10:53	
Total xylenes	ND	1.0	ug/L	1.00	07/11/2003 10:53	
Methyl tert-butyl ether (MTBE)	ND	2.0	ug/L	1.00	07/11/2003 10:53	
Surrogates(s)						
1,2-Dichloroethane-d4	86.8	76-114	%	1.00	07/11/2003 10:53	
Toluene-d8	101.6	88-110	%	1.00	07/11/2003 10:53	

Gas/BTEX Fuel Oxygenates by 8260B

Gettler Ryan

Attn.: Deanna Harding

6747 Sierra Court Suite J

Dublin, CA 94568

Phone: (925) 551-7444 Fax: (925) 551-7899

Project: 180299.80

Conoco #7124

Received: 07/02/2003 17:40

Site: 10151 East 14th Street, Oakland

Prep(s): 5030B	Test(s): 8260FAB
Sample ID: MW-1	Lab ID: 2003-07-0145 - 2
Sampled: 07/01/2003 10:36	Extracted: 7/11/2003 17:20
Matrix: Water	QC Batch#: 2003/07/11-1B.62

Compound	Conc.	RL	Unit	Dilution	Analyzed	Flag
Gasoline	ND	50	ug/L	1.00	07/11/2003 17:20	
Benzene	ND	0.50	ug/L	1.00	07/11/2003 17:20	
Toluene	ND	0.50	ug/L	1.00	07/11/2003 17:20	
Ethylbenzene	ND	0.50	ug/L	1.00	07/11/2003 17:20	
Total xylenes	ND	1.0	ug/L	1.00	07/11/2003 17:20	
tert-Butyl alcohol (TBA)	ND	100	ug/L	1.00	07/11/2003 17:20	
Methyl tert-butyl ether (MTBE)	ND	2.0	ug/L	1.00	07/11/2003 17:20	
Di-isopropyl Ether (DIPE)	ND	2.0	ug/L	1.00	07/11/2003 17:20	
Ethyl tert-butyl ether (ETBE)	ND	2.0	ug/L	1.00	07/11/2003 17:20	
tert-Amyl methyl ether (TAME)	ND	2.0	ug/L	1.00	07/11/2003 17:20	
1,2-DCA	ND	2.0	ug/L	1.00	07/11/2003 17:20	
EDB	ND	2.0	ug/L	1.00	07/11/2003 17:20	
Ethanol	ND	500	ug/L	1.00	07/11/2003 17:20	
Surrogates(s)						
1,2-Dichloroethane-d4	88.7	76-114	%	1.00	07/11/2003 17:20	
Toluene-d8	98.0	88-110	%	1.00	07/11/2003 17:20	

Gas/BTEX Fuel Oxygenates by 8260B

Gettler Ryan

Attn.: Deanna Harding

6747 Sierra Court Suite J

Dublin, CA 94568

Phone: (925) 551-7444 Fax: (925) 551-7899

Project: 180299.80

Conoco #7124

Received: 07/02/2003 17:40

Site: 10151 East 14th Street, Oakland

Prep(s): 5030B	Test(s): 8260FAB
Sample ID: MW-2	Lab ID: 2003-07-0145 - 3
Sampled: 07/01/2003 10:49	Extracted: 7/15/2003 16:07
Matrix: Water	QC Batch#: 2003/07/15-01.64
Analysis Flag: o (See Legend and Note Section)	

Compound	Conc.	RL	Unit	Dilution	Analyzed	Flag
Gasoline	1900	250	ug/L	5.00	07/15/2003 16:07	g
Benzene	ND	2.5	ug/L	5.00	07/15/2003 16:07	
Toluene	ND	2.5	ug/L	5.00	07/15/2003 16:07	
Ethylbenzene	ND	2.5	ug/L	5.00	07/15/2003 16:07	
Total xylenes	ND	5.0	ug/L	5.00	07/15/2003 16:07	
tert-Butyl alcohol (TBA)	ND	500	ug/L	5.00	07/15/2003 16:07	
Methyl tert-butyl ether (MTBE)	120	10	ug/L	5.00	07/15/2003 16:07	
Di-isopropyl Ether (DIPE)	ND	10	ug/L	5.00	07/15/2003 16:07	
Ethyl tert-butyl ether (ETBE)	ND	10	ug/L	5.00	07/15/2003 16:07	
tert-Amyl methyl ether (TAME)	ND	10	ug/L	5.00	07/15/2003 16:07	
1,2-DCA	ND	10	ug/L	5.00	07/15/2003 16:07	
EDB	ND	10	ug/L	5.00	07/15/2003 16:07	
Ethanol	ND	2500	ug/L	5.00	07/15/2003 16:07	
Surrogates(s)						
1,2-Dichloroethane-d4	110.4	76-114	%	5.00	07/15/2003 16:07	
Toluene-d8	99.0	88-110	%	5.00	07/15/2003 16:07	

Gas/BTEX Fuel Oxygenates by 8260B

Gettler Ryan

Attn.: Deanna Harding

6747 Sierra Court Suite J
Dublin, CA 94568
Phone: (925) 551-7444 Fax: (925) 551-7899

Project: 180299.80
Conoco #7124

Received: 07/02/2003 17:40

Site: 10151 East 14th Street, Oakland

Prep(s): 5030B	Test(s): 8260FAB
Sample ID: MW-3	Lab ID: 2003-07-0145 - 4
Sampled: 07/01/2003 11:28	Extracted: 7/11/2003 18:04
Matrix: Water	QC Batch#: 2003/07/11-1B.62
Analysis Flag: o (See Legend and Note Section)	

Compound	Conc.	RL	Unit	Dilution	Analyzed	Flag
Gasoline	9400	1000	ug/L	20.00	07/11/2003 18:04	9
Benzene	ND	10	ug/L	20.00	07/11/2003 18:04	
Toluene	ND	10	ug/L	20.00	07/11/2003 18:04	
Ethylbenzene	ND	10	ug/L	20.00	07/11/2003 18:04	
Total xylenes	ND	20	ug/L	20.00	07/11/2003 18:04	
tert-Butyl alcohol (TBA)	ND	2000	ug/L	20.00	07/11/2003 18:04	
Methyl tert-butyl ether (MTBE)	2200	40	ug/L	20.00	07/11/2003 18:04	
Di-isopropyl Ether (DIPE)	ND	40	ug/L	20.00	07/11/2003 18:04	
Ethyl tert-butyl ether (ETBE)	ND	40	ug/L	20.00	07/11/2003 18:04	
tert-Amyl methyl ether (TAME)	ND	40	ug/L	20.00	07/11/2003 18:04	
1,2-DCA	ND	40	ug/L	20.00	07/11/2003 18:04	
EDB	ND	40	ug/L	20.00	07/11/2003 18:04	
Ethanol	ND	10000	ug/L	20.00	07/11/2003 18:04	
Surrogates(s)						
1,2-Dichloroethane-d4	106.2	76-114	%	20.00	07/11/2003 18:04	
Toluene-d8	101.0	88-110	%	20.00	07/11/2003 18:04	

Gas/BTEX Fuel Oxygenates by 8260B

Gettler Ryan

Attn.: Deanna Harding

6747 Sierra Court Suite J

Dublin, CA 94568

Phone: (925) 551-7444 Fax: (925) 551-7899

Project: 180299.80

Conoco #7124

Received: 07/02/2003 17:40

Site: 10151 East 14th Street, Oakland

Prep(s):	5030B	Test(s):	8260FAB
Sample ID:	MW-4	Lab ID:	2003-07-0145 - 5
Sampled:	07/01/2003 11:10	Extracted:	7/11/2003 18:27
Matrix:	Water	QC Batch#:	2003/07/11-1B.62
Analysis Flag: o (See Legend and Note Section)			

Compound	Conc.	RL	Unit	Dilution	Analyzed	Flag
Gasoline	15000	250	ug/L	5.00	07/11/2003 18:27	g
Benzene	ND	2.5	ug/L	5.00	07/11/2003 18:27	
Toluene	ND	2.5	ug/L	5.00	07/11/2003 18:27	
Ethylbenzene	ND	2.5	ug/L	5.00	07/11/2003 18:27	
Total xylenes	ND	5.0	ug/L	5.00	07/11/2003 18:27	
tert-Butyl alcohol (TBA)	ND	500	ug/L	5.00	07/11/2003 18:27	
Methyl tert-butyl ether (MTBE)	170	10	ug/L	5.00	07/11/2003 18:27	
Di-isopropyl Ether (DIPE)	ND	10	ug/L	5.00	07/11/2003 18:27	
Ethyl tert-butyl ether (ETBE)	ND	10	ug/L	5.00	07/11/2003 18:27	
tert-Amyl methyl ether (TAME)	ND	10	ug/L	5.00	07/11/2003 18:27	
1,2-DCA	ND	10	ug/L	5.00	07/11/2003 18:27	
EDB	ND	10	ug/L	5.00	07/11/2003 18:27	
Ethanol	ND	2500	ug/L	5.00	07/11/2003 18:27	
Surrogates(s)						
1,2-Dichloroethane-d4	99.8	76-114	%	5.00	07/11/2003 18:27	
Toluene-d8	103.2	88-110	%	5.00	07/11/2003 18:27	

Gas/BTEX Fuel Oxygenates by 8260B

Gettler Ryan

Attn.: Deanna Harding

6747 Sierra Court Suite J

Dublin, CA 94568

Phone: (925) 551-7444 Fax: (925) 551-7899

Project: 180299.80

Conoco #7124

Received: 07/02/2003 17:40

Site: 10151 East 14th Street, Oakland

Batch QC Report

Prep(s): 5030B

Method Blank

MB: 2003/07/11-1B.62-005

Water

Test(s): 8260FAB

QC Batch # 2003/07/11-1B.62

Date Extracted: 07/11/2003 10:05

Compound	Conc.	RL	Unit	Analyzed	Flag
Gasoline	ND	50	ug/L	07/11/2003 10:05	
Benzene	ND	0.5	ug/L	07/11/2003 10:05	
Toluene	ND	0.5	ug/L	07/11/2003 10:05	
Ethylbenzene	ND	0.5	ug/L	07/11/2003 10:05	
Total xylenes	ND	1.0	ug/L	07/11/2003 10:05	
tert-Butyl alcohol (TBA)	ND	100	ug/L	07/11/2003 10:05	
Methyl tert-butyl ether (MTBE)	ND	2.0	ug/L	07/11/2003 10:05	
Di-isopropyl Ether (DIPE)	ND	2.0	ug/L	07/11/2003 10:05	
Ethyl tert-butyl ether (ETBE)	ND	2.0	ug/L	07/11/2003 10:05	
tert-Amyl methyl ether (TAME)	ND	2.0	ug/L	07/11/2003 10:05	
1,2-DCA	ND	2.0	ug/L	07/11/2003 10:05	
EDB	ND	2.0	ug/L	07/11/2003 10:05	
Ethanol	ND	500	ug/L	07/11/2003 10:05	
Surrogates(s)					
1,2-Dichloroethane-d4	91.4	76-114	%	07/11/2003 10:05	
Toluene-d8	98.9	88-110	%	07/11/2003 10:05	

Gas/BTEX Fuel Oxygenates by 8260B

Gettler Ryan

Attn.: Deanna Harding

6747 Sierra Court Suite J

Dublin, CA 94568

Phone: (925) 551-7444 Fax: (925) 551-7899

Project: 180299.80

Conoco #7124

Received: 07/02/2003 17:40

Site: 10151 East 14th Street, Oakland

Batch QC Report

Prep(s): 5030B

Method Blank

MB: 2003/07/15-01.64-054

Water

Test(s): 8260FAB

QC Batch # 2003/07/15-01.64

Date Extracted: 07/15/2003 13:54

Compound	Conc.	RL	Unit	Analyzed	Flag
Gasoline	ND	50	ug/L	07/15/2003 13:54	
Gasoline	ND	50	ug/L	07/15/2003 13:54	
Benzene	ND	0.5	ug/L	07/15/2003 13:54	
Toluene	ND	0.5	ug/L	07/15/2003 13:54	
Ethylbenzene	ND	0.5	ug/L	07/15/2003 13:54	
Total xylenes	ND	1.0	ug/L	07/15/2003 13:54	
tert-Butyl alcohol (TBA)	ND	100	ug/L	07/15/2003 13:54	
Methyl tert-butyl ether (MTBE)	ND	2.0	ug/L	07/15/2003 13:54	
Di-isopropyl Ether (DIPE)	ND	2.0	ug/L	07/15/2003 13:54	
Ethyl tert-butyl ether (ETBE)	ND	2.0	ug/L	07/15/2003 13:54	
tert-Amyl methyl ether (TAME)	ND	2.0	ug/L	07/15/2003 13:54	
1,2-DCA	ND	2.0	ug/L	07/15/2003 13:54	
EDB	ND	2.0	ug/L	07/15/2003 13:54	
Ethanol	ND	500	ug/L	07/15/2003 13:54	
Surrogates(s)					
1,2-Dichloroethane-d4	109.2	76-114	%	07/15/2003 13:54	
Toluene-d8	100.8	88-110	%	07/15/2003 13:54	

Gas/BTEX Fuel Oxygenates by 8260B

Gettler Ryan

Attn.: Deanna Harding

6747 Sierra Court Suite J

Dublin, CA 94568

Phone: (925) 551-7444 Fax: (925) 551-7899

Project: 180299.80

Conoco #7124

Received: 07/02/2003 17:40

Site: 10151 East 14th Street, Oakland

Batch QC Report

Prep(s): 5030B

Test(s): 8260FAB

Laboratory Control Spike

Water

QC Batch # 2003/07/11-1B.62

LCS 2003/07/11-1B.62-021

Extracted: 07/11/2003

Analyzed: 07/11/2003 09:21

LCSD 2003/07/11-1B.62-043

Extracted: 07/11/2003

Analyzed: 07/11/2003 09:43

Compound	Conc. ug/L		Exp.Conc.	Recovery %		RPD	Ctrl.Limits %		Flags	
	LCS	LCSD		LCS	LCSD		%	Rec.	RPD	LCS
Benzene	27.6	28.0	25	110.4	112.0	1.4	69-129	20		
Toluene	27.2	26.7	25	108.8	106.8	1.9	70-130	20		
Methyl tert-butyl ether (MTBE)	26.0	26.4	25	104.0	105.6	1.5	65-165	20		
Surrogates(s)										
1,2-Dichloroethane-d4	446	454	500	89.2	90.8		76-114			
Toluene-d8	514	524	500	102.8	104.8		88-110			

Severn Trent Laboratories, Inc.

STL San Francisco * 1220 Quarry Lane, Pleasanton, CA 94566

Tel 925 484 1919 Fax 925 484 1096 * www.stl-inc.com * CA DHS ELAP# 2496

07/17/2003 12:50

Gas/BTEX Fuel Oxygenates by 8260B

Gettler Ryan

Attn.: Deanna Harding

6747 Sierra Court Suite J

Dublin, CA 94568

Phone: (925) 551-7444 Fax: (925) 551-7899

Project: 180299.80

Conoco #7124

Received: 07/02/2003 17:40

Site: 10151 East 14th Street, Oakland

Batch QC Report

Prep(s): 5030B

Test(s): 8260FAB

Laboratory Control Spike

Water

QC Batch # 2003/07/15-01.64

LCS 2003/07/15-01.64-009

Extracted: 07/15/2003

Analyzed: 07/15/2003 13:09

LCSD 2003/07/15-01.64-031

Extracted: 07/15/2003

Analyzed: 07/15/2003 13:31

Compound	Conc. ug/L		Exp. Conc.	Recovery %		RPD	Ctrl. Limits %		Flags	
	LCS	LCSD		LCS	LCSD		%	Rec.	RPD	LCS
Benzene	21.5	21.3	25.0	86.0	85.2	0.9	69-129	20		
Toluene	21.9	22.0	25.0	87.6	88.0	0.5	70-130	20		
Methyl tert-butyl ether (MTBE)	25.0	25.5	25.0	100.0	102.0	2.0	65-165	20		
Surrogates(s)										
1,2-Dichloroethane-d4	552	560	500	110.4	112.0		76-114			
Toluene-d8	509	511	500	101.8	102.2		88-110			

Gas/BTEX Fuel Oxygenates by 8260B

Gettler Ryan

Attn.: Deanna Harding

6747 Sierra Court Suite J

Dublin, CA 94568

Phone: (925) 551-7444 Fax: (925) 551-7899

Project: 180299.80

Conoco #7124

Received: 07/02/2003 17:40

Site: 10151 East 14th Street, Oakland

Legend and Notes

Analysis Flag

o

Reporting limits were raised due to high level of analyte present in the sample.

Result Flag

g

Hydrocarbon reported in the gasoline range does not match our gasoline standard.