



2000 Crow Canyon Place
Suite 400
San Ramon, CA 94583

Phone: (925) 277-2305
Fax: (925) 277-2361

Environmental Department

May 22, 2003

RO 2444

Alameda County
MAY 28 2003
Environmental Health

Re: **Tosco (Unocal) Service Station #7124**
10151 east 14th Street
Oakland, California

" I declare under penalty of perjury, that to the best of my knowledge at the present time, the information and/or recommendations contained in the attached proposal or report is true and correct."

David B. DeWitt
Site Manager
ConocoPhillips



GETTLER-RYAN INC.

TRANSMITTAL

Alameda County

May 12, 2003

MAY 28 2003

G-R #180299

Environmental Health

TO: Mr. David B. De Witt
ConocoPhillips
76 Broadway Avenue
Sacramento, California 95818

CC: Mr. Forrest McFarland
Secor International, Inc.
2301 Leghorn Street
Mountain View, CA 94043

FROM: Deanna L. Harding
Project Coordinator
Gettler-Ryan Inc.
6747 Sierra Court, Suite J
Dublin, California 94568

RE: **Tosco (Unocal) Service Station
#7124
10151 East 14th Street
Oakland, California**

WE HAVE ENCLOSED THE FOLLOWING:

| COPIES | DATED | DESCRIPTION |
|--------|-------------|---|
| 1 | May 9, 2003 | Groundwater Monitoring and Sampling Report Second Quarter - Event of April 2, 2003 |

COMMENTS:

This report is being sent to you for your review/comment, prior to being distributed on your behalf. If no comments are received by **May 23, 2003**, this report will be distributed to the following:

cc: Ms. Eva Chu, Alameda County Health Care Services, 1131 Harbor Bay Parkway, Suite 250 Alameda, CA 94502

Enclosure



GETTLER-RYAN INC.

May 9, 2003
G-R Job #180299

Mr. David B. De Witt
ConocoPhillips
76 Broadway Avenue
Sacramento, California 95818

RE: Second Quarter Event of April 2, 2003
Groundwater Monitoring & Sampling Report
Tosco (Unocal) Service Station #7124
10151 East 14th Street
Oakland, California

Dear Mr. De Witt:

This report documents the most recent groundwater monitoring and sampling event performed by Gettler-Ryan Inc. (G-R) at the referenced site. All field work was conducted in accordance with G-R Standard Operating Procedure - Groundwater Sampling (attached).

Static groundwater levels were measured and all wells were checked for the presence of separate-phase hydrocarbons. Separate-phase hydrocarbons were not present in the wells. Static water level data and groundwater elevations are summarized in Table 1. A Potentiometric Map is included as Figure 1.

Groundwater samples were collected from the monitoring wells and submitted to a state certified laboratory for analyses. The field data sheets for this event are attached. Analytical results are presented in the table(s) listed below. A Concentration Map is included as Figure 2. The chain of custody document and laboratory analytical report are also attached.

Sincerely,

Deanna L. Harding
Project Coordinator

Robert C. Mallory
Registered Geologist, No. 7285

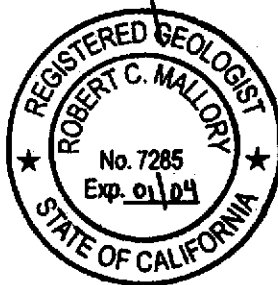

- | | |
|--------------|---|
| Figure 1: | Potentiometric Map |
| Figure 2: | Concentration Map |
| Table 1: | Groundwater Monitoring Data and Analytical Results |
| Table 2: | Groundwater Analytical Results |
| Attachments: | Standard Operating Procedure - Groundwater Sampling Field Data Sheets Chain of Custody Document and Laboratory Analytical Reports |

7124.qml

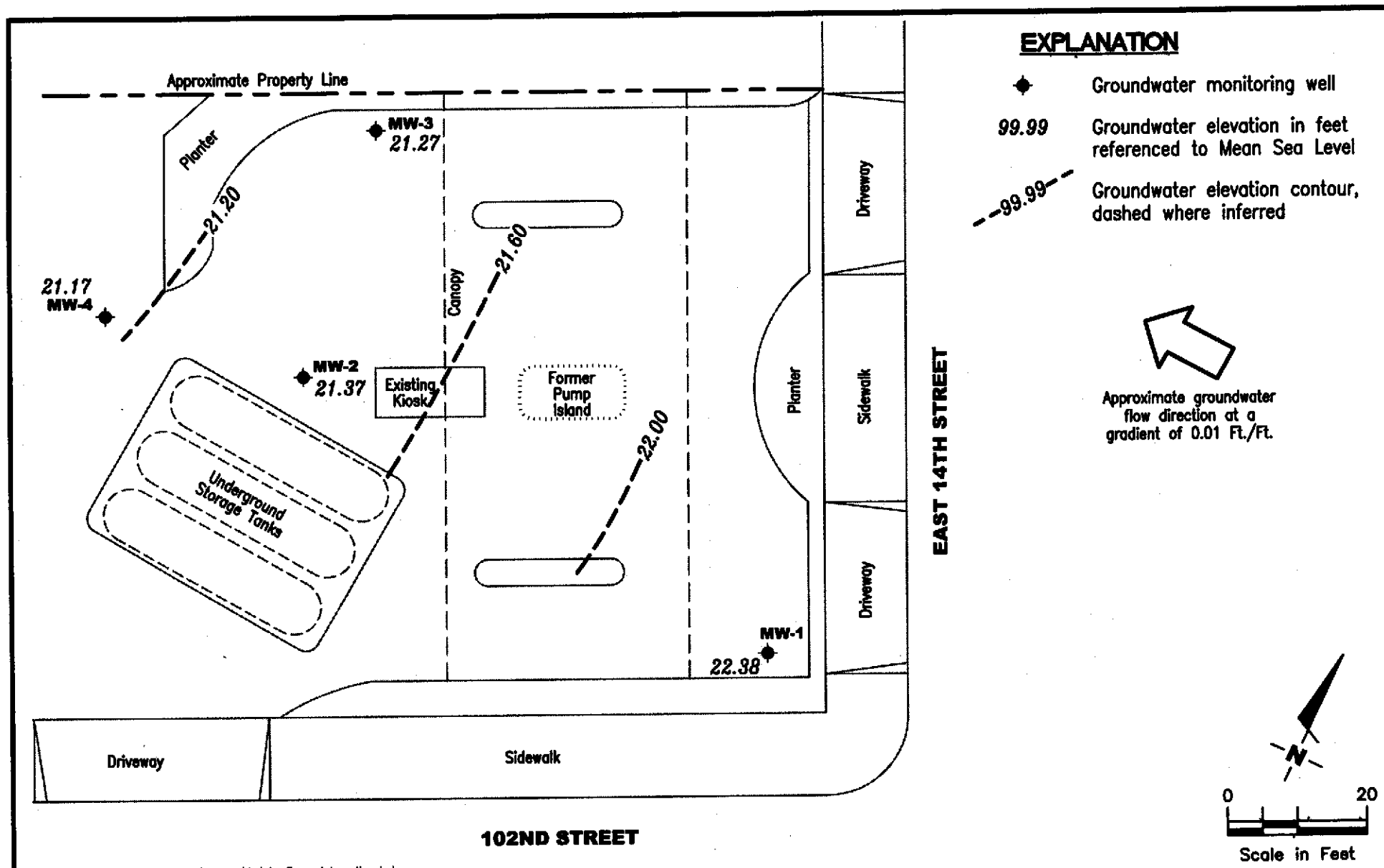

GETTLER - RYAN INC.
 6747 Sierra Ct., Suite J
 Dublin, CA 94568 (925) 551-7555

POTENTIOMETRIC MAP
 Tosco (Unocal) Service Station #7124
 10151 East 14th Street
 Oakland, California

FIGURE
1

PROJECT NUMBER 180299 REVIEWED BY _____ DATE April 2, 2003 REVISED DATE _____

FILE NAME: P:\ENVIRO\TOSCO\7124\003-7124.DWG | Layout Tab: Pot2

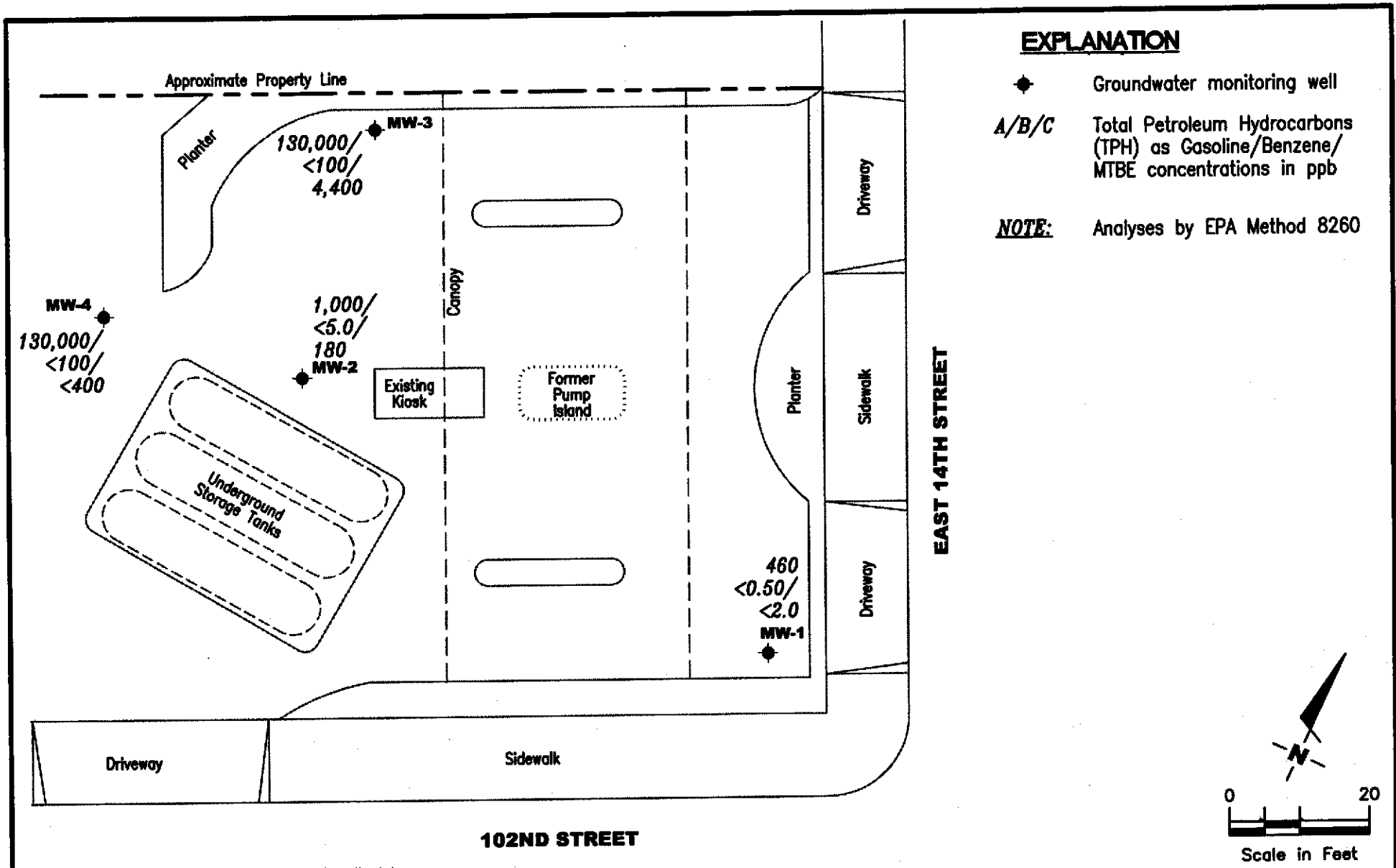

Source: Figure modified from drawing provided by Secor International, Inc.

GETTLER - RYAN INC.
 6747 Sierra Ct., Suite J
 Dublin, CA 94568 (925) 551-7555

CONCENTRATION MAP
 Tosco (Unocal) Service Station #7124
 10151 East 14th Street
 Oakland, California

FIGURE

2

PROJECT NUMBER
 180299

REVIEWED BY

DATE
 April 2, 2003

REVISED DATE

Table 1
Groundwater Monitoring Data and Analytical Results
 Tosco (Unocal) Service Station #7124
 10151 East 14th Street
 Oakland, California

| WELL ID/ TOC* (ft.) | DATE | DTW (ft.) | GWE (msl) | TPH-G (pph) | B (pph) | T (ppb) | E (ppb) | X (ppb) | MTBE (ppb) |
|------------------------|-----------------------|--------------|--------------|----------------------|------------|------------|------------|------------|--------------------------|
| MW-1 37.37 | 04/08/02 ¹ | 14.27 | 23.10 | <50 | <0.50 | <0.50 | <0.50 | <0.50 | <2.5/<2.0 ² |
| | 07/28/02 ³ | 15.88 | 21.49 | <50 | <0.50 | <0.50 | <0.50 | <1.0 | <2.0 |
| | 11/03/02 ³ | 16.75 | 20.62 | <50 | <0.50 | <0.50 | <0.50 | <1.0 | <2.0 |
| | 01/24/03 ³ | 13.94 | 23.43 | <50 | <0.50 | <0.50 | <0.50 | <1.0 | <2.0 |
| | 04/02/03 ³ | 14.99 | 22.38 | 460 ⁴ | <0.50 | <0.50 | <0.50 | <1.0 | <2.0 |
| MW-2 37.87 | 04/08/02 ¹ | 15.86 | 22.01 | 4,400 | <2.5 | <2.5 | 6.4 | <2.5 | 380/490 ² |
| | 07/28/02 ³ | 17.28 | 20.59 | 3,200 ⁴ | <2.5 | <2.5 | <2.5 | <5.0 | 170 |
| | 11/03/02 ³ | 18.03 | 19.84 | 3,800 ⁴ | <5.0 | <5.0 | <5.0 | <10 | 72 |
| | 01/24/03 ³ | 15.59 | 22.28 | 410 ⁴ | <2.5 | <2.5 | <2.5 | <5.0 | 490 |
| | 04/02/03 ³ | 16.50 | 21.37 | 1,000 ⁴ | <5.0 | <5.0 | <5.0 | <10 | 180 |
| MW-3 37.72 | 04/08/02 ¹ | 15.86 | 21.86 | 8,700 | 65 | <25 | 400 | <25 | 6,500/8,300 ² |
| | 07/28/02 ³ | 17.22 | 20.50 | 4,500 ⁴ | <25 | <25 | <25 | <50 | 1,100 |
| | 11/03/02 ³ | 17.90 | 19.82 | 25,000 ⁴ | <5.0 | <5.0 | 25 | <10 | 470 |
| | 01/24/03 ³ | 15.57 | 22.15 | 6,000 | <25 | <25 | 94 | <50 | 10,000 |
| | 04/02/03 ³ | 16.45 | 21.27 | 130,000 ⁴ | <100 | <100 | <100 | <200 | 4,400 |
| MW-4 38.36 | 04/08/01 ¹ | 16.59 | 21.77 | 13,000 | <5.0 | <5.0 | 28 | <5.0 | 790/980 ² |
| | 07/28/02 ³ | 17.93 | 20.43 | 18,000 ⁴ | <2.5 | <2.5 | <2.5 | <5.0 | 170 |
| | 11/03/02 ³ | 18.66 | 19.70 | 220 ⁴ | <0.50 | <0.50 | <0.50 | <1.0 | 5.7 |
| | 01/24/03 ³ | 16.27 | 22.09 | <1,000 | <10 | <10 | <10 | <20 | 1,000 |
| | 04/02/03 ³ | 17.19 | 21.17 | 130,000 ⁴ | <100 | <100 | <100 | <200 | <400 |

Table 1
Groundwater Monitoring Data and Analytical Results
 Tosco (Unocal) Service Station #7124
 10151 East 14th Street
 Oakland, California

| WELL ID/ TOC* (ft.) | DATE | DTW (ft.) | GWE (msl) | TPH-G (ppb) | B (ppb) | T (ppb) | E (ppb) | X (ppb) | MTBE (ppb) |
|------------------------|-----------------------|--------------|--------------|----------------|------------|------------|------------|------------|---------------|
| Trip Blank | | | | | | | | | |
| TB-LB | 04/08/02 | -- | -- | <50 | <0.50 | <0.50 | <0.50 | <0.50 | <2.5 |
| QA | 07/28/02 ³ | -- | -- | <50 | <0.50 | <0.50 | <0.50 | <1.0 | <2.0 |
| | 11/03/02 ³ | -- | -- | <50 | <0.50 | <0.50 | <0.50 | <1.0 | <2.0 |
| | 01/24/03 ³ | -- | -- | <50 | <0.50 | <0.50 | <0.50 | <1.0 | <2.0 |
| | 04/02/03 ³ | -- | -- | <50 | <0.50 | <0.50 | <0.50 | <1.0 | <2.0 |

Table 1
Groundwater Monitoring Data and Analytical Results
Tosco (Unocal) Service Station #7124
10151 East 14th Street
Oakland, California

EXPLANATIONS:

TOC = Top of Casing

(ft.) = Feet

DTW = Depth to Water

GWE = Groundwater Elevation

(msl) = Mean sea level

TPH-G = Total Petroleum Hydrocarbons as Gasoline

B = Benzene

T = Toluene

E = Ethylbenzene

X = Xylenes

MTBE = Methyl tertiary butyl ether

(ppb) = Parts per billion

-- = Not Measured/Not Analyzed

QA = Quality Assurance/Trip Blank

* TOC elevations were surveyed on March 18, 2002, by Mid Coast Engineers. The benchmark used for the survey is HT0281, a benchmark disk in a concrete headwall on the east side of Railroad Avenue approximately 500 feet south of 85th Avenue (Benchmark Elevation = 11.50 feet NGVD 29).

¹ Well development performed.

² MTBE by EPA Method 8260.

³ TPH-G, BTEX and MTBE by EPA Method 8260.

⁴ Laboratory report indicates hydrocarbon pattern is present in the requested fuel quantitation range but does not resemble the pattern of the requested fuel.

Table 2
Groundwater Analytical Results - Oxygenate Compounds
 Tosco (Unocal) Service Station #7124
 10151 East 14th Street
 Oakland, California

| WELL ID | DATE | ETHANOL (ppb) | TBA (ppb) | MTBE (ppb) | DIPE (ppb) | ETBE (ppb) | TAME (ppb) | 1,2-DCA (ppb) | EDB (ppb) |
|---------|----------|------------------|--------------|---------------|---------------|---------------|---------------|------------------|--------------|
| MW-1 | 04/08/02 | <500 | <100 | <2.0 | <2.0 | <2.0 | <2.0 | <2.0 | <2.0 |
| | 07/28/02 | <500 | <100 | <2.0 | <2.0 | <2.0 | <2.0 | <2.0 | <2.0 |
| | 11/03/02 | <500 | <100 | <2.0 | <2.0 | <2.0 | <2.0 | <2.0 | <2.0 |
| | 01/24/03 | <500 | <100 | <2.0 | <2.0 | <2.0 | <2.0 | <2.0 | <2.0 |
| | 04/02/03 | <500 | <100 | <2.0 | <2.0 | <2.0 | <2.0 | <2.0 | <2.0 |
| MW-2 | 04/08/02 | <10,000 | <2,000 | 490 | <40 | <40 | <40 | <40 | <40 |
| | 07/28/02 | <2,500 | <500 | 170 | <10 | <10 | <10 | <10 | <10 |
| | 11/03/02 | <5,000 | <1,000 | 72 | <20 | <20 | <20 | <20 | <20 |
| | 01/24/03 | <2,500 | <500 | 490 | <10 | <10 | <10 | <10 | <10 |
| | 04/02/03 | <5,000 | <1,000 | 180 | <20 | <20 | <20 | <20 | <20 |
| MW-3 | 04/08/02 | <250,000 | <50,000 | 8,300 | <1,000 | <1,000 | <1,000 | <1,000 | <1,000 |
| | 07/28/02 | <25,000 | <5,000 | 1,100 | <100 | <100 | <100 | <100 | <100 |
| | 11/03/02 | <5,000 | <1,000 | 470 | <20 | <20 | <20 | <20 | <20 |
| | 01/24/03 | <25,000 | <5,000 | 10,000 | <100 | <100 | <100 | <100 | <100 |
| | 04/02/03 | <100,000 | <20,000 | 4,400 | <400 | <400 | <400 | <400 | <400 |
| MW-4 | 04/08/02 | <25,000 | <5,000 | 980 | <100 | <100 | <100 | <100 | <100 |
| | 07/28/02 | <2,500 | <500 | 170 | <10 | <10 | <10 | <10 | <10 |
| | 11/03/02 | <500 | <100 | 5.7 | <2.0 | <2.0 | <2.0 | <2.0 | <2.0 |
| | 01/24/03 | <10,000 | <2,000 | 1,000 | <40 | <40 | <40 | <40 | <40 |
| | 04/02/03 | <100,000 | <20,000 | <400 | <400 | <400 | <400 | <400 | <400 |

Table 2
Groundwater Analytical Results - Oxygenate Compounds
Tosco (Unocal) Service Station #7124
10151 East 14th Street
Oakland, California

EXPLANATIONS:

TBA = Tertiary butyl alcohol
MTBE = Methyl tertiary butyl ether
DIPE = Di-isopropyl ether
ETBE = Ethyl tertiary butyl ether
TAME = Tertiary amyl methyl ether
1,2-DCA = 1,2-Dichloroethane
EDB = 1,2-Dibromoethane
(ppb) = Parts per billion

ANALYTICAL METHOD:

EPA Method 8260 for Oxygenate Compounds

STANDARD OPERATING PROCEDURE - GROUNDWATER SAMPLING

Gettler-Ryan Inc. field personnel adhere to the following procedures for the collection and handling of groundwater samples prior to analysis by the analytical laboratory. Prior to sample collection, the type of analysis to be performed is determined. Loss prevention of volatile compounds is controlled and sample preservation for subsequent analysis is maintained.

Prior to sampling, the presence or absence of free-phase hydrocarbons is determined using an interface probe. Product thickness, if present, is measured to the nearest 0.01 foot and is noted in the field notes. In addition, all depth to water level measurements are collected with a static water level indicator and are also recorded in the field notes, prior to purging and sampling any wells.

After water levels are collected and prior to sampling, temperature, pH and electrical conductivity are measured. If purging is to occur, each well is purged a minimum of three well casing volumes of water using pre-cleaned pumps (stack, suction, Grundfos), or disposable bailers. The measurements are taken a minimum of three times during the purging. Purging continues until these parameters stabilize.

Groundwater samples are collected using disposable bailers. The water samples are transferred from the bailer into appropriate containers. Pre-preserved containers, supplied by analytical laboratories, are used when possible. When pre-preserved containers are not available, the laboratory is instructed to preserve the sample as appropriate. Duplicate samples are collected for the laboratory to use in maintaining quality assurance/quality control standards. The samples are labeled to include the job number, sample identification, collection date and time, analysis, preservation (if any), and the sample collector's initials. The water samples are placed in a cooler, maintained at 4°C for transport to the laboratory. Once collected in the field, all samples are maintained under chain of custody until delivered to the laboratory.

The chain of custody document includes the job number, type of preservation, if any, analysis requested, sample identification, date and time collected, and the sample collector's name. The chain of custody is signed and dated (including time of transfer) by each person who receives or surrenders the samples, beginning with the field personnel and ending with the laboratory personnel.

A laboratory supplied trip blank accompanies each sampling set and is labeled as QA. For sampling sets greater than 20 samples, 5% trip blanks are included. The trip blank is analyzed for some or all of the same compounds as the groundwater samples.

As requested by Phillips 66 Company, the purge water and decontamination water generated during sampling activities is transported to Phillips 66 - San Francisco Refinery, located in Rodeo, California.



GETTLER-RYAN INC.

WELL MONITORING/SAMPLING FIELD DATA SHEET

Client/Facility #: ConocoPhillips #7124 Job Number: 180299
 Site Address: 10151 East 14Th Street Event Date: 4-2-03 (inclusive)
 City: Oakland, CA Sampler: BSG

Well ID: MW-1 Date Monitored: 4-2-03 Well Condition: OK
 Well Diameter: 4 in.
 Total Depth: 24.50 ft.
 Depth to Water: 14.99 ft.
9.51 xVF .66 = 6 x3 (case volume) = Estimated Purge Volume: 18 gal.

| | | | | |
|-------------|-------------|-----------|-----------|------------|
| Volume | 3/4" = 0.02 | 1" = 0.04 | 2" = 0.17 | 3" = 0.38 |
| Factor (VF) | 4" = 0.66 | 5" = 1.02 | 6" = 1.50 | 12" = 5.80 |

Purge Equipment:
 Disposable Bailer _____
 Stainless Steel Bailer _____
 Stack Pump _____
 Suction Pump _____
 Grundfos _____
 Other: _____

Sampling Equipment:
 Disposable Bailer _____
 Pressure Bailer _____
 Discrete Bailer _____
 Other: _____

Time Started: _____ (2400 hrs)
 Time Bailed: _____ (2400 hrs)
 Depth to Product: _____ ft
 Depth to Water: _____ ft
 Hydrocarbon Thickness: _____ ft
 Visual Confirmation/Description: _____
 Skimmer / Absorbent Sock (circle one)
 Amt Removed from Skimmer: _____ gal
 Amt Removed from Well: _____ gal
 Product Transferred to: _____

Start Time (purge): 0859 Weather Conditions: Partly Cloudy
 Sample Time/Date: 0912 4-2-03 Water Color: Brown Odor: NO
 Purging Flow Rate: 3 gpm. Sediment Description: _____
 Did well de-water? No If yes, Time: _____ Volume: _____ gal.

| Time (2400 hr.) | Volume (gal.) | pH | Conductivity (u mhos/cm) | Temperature (C/F) | D.O. (mg/L) | ORP (mV) |
|-----------------|---------------|-------------|--------------------------|-------------------|-------------|----------|
| <u>0901</u> | <u>6</u> | <u>7.88</u> | <u>428</u> | <u>16.6</u> | | |
| <u>0902</u> | <u>12</u> | <u>7.84</u> | <u>421</u> | <u>16.5</u> | | |
| <u>0903</u> | <u>18</u> | <u>7.80</u> | <u>422</u> | <u>16.8</u> | | |

LABORATORY INFORMATION

| SAMPLE ID | (#) CONTAINER | REFRIG. | PRESERV. TYPE | LABORATORY | ANALYSES |
|-------------|---------------------|------------|---------------|-----------------------|--------------------------------------|
| <u>MW-1</u> | <u>3</u> x voa vial | <u>YES</u> | <u>HCL</u> | <u>STL Pleasanton</u> | <u>TPH-G/BTEX/MTBE/8 Oxy's(8260)</u> |
| | | | | | |
| | | | | | |

COMMENTS: _____

Add/Replaced Lock: _____ Add/Replaced Plug: _____ Size: _____



GETTLER-RYAN INC.

WELL MONITORING/SAMPLING FIELD DATA SHEET

Client/Facility #: ConocoPhillips #7124 Job Number: 180299
 Site Address: 10151 East 14Th Street Event Date: 4-2-03 (inclusive)
 City: Oakland, CA Sampler: BG

Well ID: MW-2 Date Monitored: 4-2-03 Well Condition: OK

Well Diameter: 4 in.
 Total Depth: 24.99 ft.
 Depth to Water: 16.50 ft.
8.49

| | | | | |
|-------------|------------|----------|----------|-----------|
| Volume | 3/4"= 0.02 | 1"= 0.04 | 2"= 0.17 | 3"= 0.38 |
| Factor (VF) | 4"= 0.66 | 5"= 1.02 | 6"= 1.50 | 12"= 5.80 |

xVF 166 = 6 x3 (case volume) = Estimated Purge Volume: 18 gal.

Purge Equipment:

Disposable Bailer _____
 Stainless Steel Bailer _____
 Stack Pump _____
 Suction Pump _____
 Grundfos _____
 Other: _____

Sampling Equipment:

Disposable Bailer _____
 Pressure Bailer _____
 Discrete Bailer _____
 Other: _____

| | |
|---------------------------------------|------------------|
| Time Started: | _____ (2400 hrs) |
| Time Bailed: | _____ (2400 hrs) |
| Depth to Product: | _____ ft |
| Depth to Water: | _____ ft |
| Hydrocarbon Thickness: | _____ ft |
| Visual Confirmation/Description: | _____ |
| Skimmer / Absorbant Sock (circle one) | _____ |
| Amt Removed from Skimmer: | _____ gal |
| Amt Removed from Well: | _____ gal |
| Product Transferred to: | _____ |

Start Time (purge): 0915 Weather Conditions: Cloudy
 Sample Time/Date: 0926 4-2-03 Water Color: grayish Odor: Slight
 Purging Flow Rate: 3 gpm. Sediment Description: _____
 Did well de-water? No If yes, Time: _____ Volume: _____ gal.

| Time (2400 hr.) | Volume (gal.) | pH | Conductivity (umhos/cm) | Temperature (C/F) | D.O. (mg/L) | ORP (mV) |
|-----------------|---------------|-------------|-------------------------|-------------------|-------------|----------|
| <u>0917</u> | <u>6</u> | <u>7.31</u> | <u>434</u> | <u>18.4</u> | | |
| <u>0919</u> | <u>12</u> | <u>7.25</u> | <u>438</u> | <u>18.1</u> | | |
| <u>0921</u> | <u>18</u> | <u>7.16</u> | <u>431</u> | <u>18.8</u> | | |

LABORATORY INFORMATION

| SAMPLE ID | (#) CONTAINER | REFRIG. | PRESERV. TYPE | LABORATORY | ANALYSES |
|-------------|---------------------|------------|---------------|-----------------------|--------------------------------------|
| <u>MW-2</u> | <u>3</u> x vov vial | <u>YES</u> | <u>HCL</u> | <u>STL Pleesanton</u> | <u>TPH-G/BTEX/MTBE/8 Oxy's(8260)</u> |
| | | | | | |
| | | | | | |

COMMENTS: _____

Add/Replaced Lock: _____ Add/Replaced Plug: _____ Size: _____



GETTLER - RYAN INC.

WELL MONITORING/SAMPLING FIELD DATA SHEET

Client/Facility #: ConocoPhillips #7124 Job Number: 180299
 Site Address: 10151 East 14Th Street Event Date: 4-2-03 (inclusive)
 City: Oakland, CA Sampler: BB

Well ID: MW-3 Date Monitored: 4-2-03 Well Condition: OK
 Well Diameter: 4 in.
 Total Depth: 24.85 ft.
 Depth to Water: 16.45 ft.
8.4 x VF .106 = 6 x3 (case volume) = Estimated Purge Volume: 18 gal.

| | | | | |
|-------------|------------|----------|----------|-----------|
| Volume | 3/4"= 0.02 | 1"= 0.04 | 2"= 0.17 | 3"= 0.38 |
| Factor (VF) | 4"= 0.66 | 5"= 1.02 | 6"= 1.50 | 12"= 5.80 |

Purge Equipment:
 Disposable Bailer _____
 Stainless Steel Bailer _____
 Stack Pump _____
 Suction Pump _____
 Grundfos _____
 Other: _____

Sampling Equipment:
 Disposable Bailer _____
 Pressure Bailer _____
 Discrete Bailer _____
 Other: _____

Time Started: _____ (2400 hrs)
 Time Bailed: _____ (2400 hrs)
 Depth to Product: _____ ft
 Depth to Water: _____ ft
 Hydrocarbon Thickness: _____ ft
 Visual Confirmation/Description: _____
 Skimmer / Absorbant Sock (circle one)
 Amt Removed from Skimmer: _____ gal
 Amt Removed from Well: _____ gal
 Product Transferred to: _____

Start Time (purge): 0947 Weather Conditions: Cloudy
 Sample Time/Date: 0955 4-2-03 Water Color: Gray Odor: Yes
 Purging Flow Rate: 3 gpm. Sediment Description: _____
 Did well de-water? No If yes, Time: _____ Volume: _____ gal.

| Time (2400 hr.) | Volume (gal.) | pH | Conductivity (umhos/cm) | Temperature (C/F) | D.O. (mg/L) | ORP (mV) |
|-----------------|---------------|-------------|-------------------------|-------------------|-------------|----------|
| <u>0949</u> | <u>6</u> | <u>7.51</u> | <u>386</u> | <u>18.2</u> | | |
| <u>0957</u> | <u>12</u> | <u>7.46</u> | <u>381</u> | <u>18.1</u> | | |
| <u>0953</u> | <u>18</u> | <u>7.36</u> | <u>376</u> | <u>18.5</u> | | |

LABORATORY INFORMATION

| SAMPLE ID | (#) CONTAINER | REFRIG. | PRESERV. TYPE | LABORATORY | ANALYSES |
|-------------|---------------------|------------|---------------|-----------------------|--------------------------------------|
| <u>MW-3</u> | <u>3</u> x voa vial | <u>YES</u> | <u>HCL</u> | <u>STL Pleasanton</u> | <u>TPH-G/BTEX/MTBE/B Oxy's(8260)</u> |
| | | | | | |
| | | | | | |

COMMENTS: _____

Add/Replaced Lock: _____ Add/Replaced Plug: _____ Size: _____



GETTLER-RYAN INC.

WELL MONITORING/SAMPLING FIELD DATA SHEET

Client/Facility #: ConocoPhillips #7124 Job Number: 180299
 Site Address: 10151 East 14Th Street Event Date: 4-2-03 (inclusive)
 City: Oakland, CA Sampler: BG

Well ID: MW-4 Date Monitored: 4-2-03 Well Condition: 4-2-03 OK
 Well Diameter: 4 in.
 Total Depth: 29.70 ft.
 Depth to Water: 17.19 ft.
7.51 xVF .66 = 5 x3 (case volume) = Estimated Purge Volume: 15 gal.

| | | | | |
|-------------|------------|----------|----------|-----------|
| Volume | 3/4"= 0.02 | 1"= 0.04 | 2"= 0.17 | 3"= 0.38 |
| Factor (VF) | 4"= 0.66 | 5"= 1.02 | 6"= 1.50 | 12"= 5.80 |

Purge Equipment:
 Disposable Bailer _____
 Stainless Steel Bailer _____
 Stack Pump _____
 Suction Pump
 Grundfos _____
 Other: _____

Sampling Equipment:
 Disposable Bailer
 Pressure Bailer _____
 Discrete Bailer _____
 Other: _____

Time Started: _____ (2400 hrs)
 Time Bailed: _____ (2400 hrs)
 Depth to Product: _____ ft
 Depth to Water: _____ ft
 Hydrocarbon Thickness: _____ ft
 Visual Confirmation/Description: _____
 Skimmer / Absorbant Sock (circle one)
 Amt Removed from Skimmer: _____ gal
 Amt Removed from Well: _____ gal
 Product Transferred to: _____

Start Time (purge): 09:15 Weather Conditions: cloudy
 Sample Time/Date: 09:33 4-2-03 Water Color: gray Odor: yes
 Purging Flow Rate: 1.2 gpm. Sediment Description: _____
 Did well de-water? no If yes, Time: _____ Volume: _____ gal.

| Time (2400 hr.) | Volume (gal.) | pH | Conductivity (umhos/cm) | Temperature (C/F) | D.O. (mg/L) | ORP (mV) |
|-----------------|---------------|-------------|-------------------------|-------------------|-------------|----------|
| <u>09:31</u> | <u>5</u> | <u>6.93</u> | <u>467</u> | <u>18.6</u> | | |
| <u>09:33</u> | <u>10</u> | <u>6.82</u> | <u>451</u> | <u>18.3</u> | | |
| <u>09:35</u> | <u>15</u> | <u>6.76</u> | <u>456</u> | <u>18.2</u> | | |

LABORATORY INFORMATION

| SAMPLE ID | (#) CONTAINER | REFRIG. | PRESERV. TYPE | LABORATORY | ANALYSES |
|-------------|---------------------|------------|---------------|-----------------------|--------------------------------------|
| <u>MW-4</u> | <u>3</u> x voa vial | <u>YES</u> | <u>HCL</u> | <u>STL Pleasanton</u> | <u>TPH-G/BTEX/MTBE/8 Oxy's(8260)</u> |
| | | | | | |
| | | | | | |

COMMENTS: _____

Add/Replaced Lock: _____ Add/Replaced Plug: _____ Size: _____

7003-04-0099

7314
Gettler-Ryan Inc., Chain-of-Custod

| | | |
|---|---|--|
| Tosco Corp./ Phillips 66 Co. 2000 Crow Canyon Place Suite 400 San Ramon, CA 94583 | Facility Number <u>#7124</u> | Laboratory Name <u>STL - PLEASANTON, CA</u> |
| | Facility Address <u>10151 EAST 14TH STREET, OAKLAND, CA</u> | Consultant <u>GETTLER-RYAN, INC. DEANNA L. HARDING</u> |
| | Global ID _____ Project <u>180299.80</u> | Address <u>6747 SIERRA CT., SUITE J, DUBLIN CA 94568</u> |
| | Client Contact <u>MR. DAVID B. DEWITT</u> | Phone <u>(925) 551-7555</u> Fax <u>(925) 551-7899</u> |
| | Phone <u>(925) 277-2384</u> | Samples Collected by <u>Brian Gan</u> |

| SAMPLE ID | Number of Containers Matrix | S = Soil A = Air W = Water C = Charcoal | Sample Preservation | Date/Time (2400 Hrs) | TPH-GAS/BTEX/MTBE EPA 8015/8021B | TPH-DIESEL EPA 8015 | TPH-DIESEL w/Since gel EPA 8015 | TPH-GAS EPA 8015 | TPH-GAS/BTEX/MTBE EPA 8260 | OXYGENATES EPA 8260 | METHANOL EPA 8015 | TOTAL OIL & GREASE EPA 5020 | METALS Cd, Cr, Pb, Zn, Ni | NITRATE/SULFATE/ALKALINITY EPA 300 SERIES | HWOC'S (8010) EPA 8021B | VOC'S (8240) EPA 8260 | SWOC'S EPA 8270 | Remarks |
|-----------|-----------------------------|---|---------------------|----------------------|----------------------------------|---------------------|---------------------------------|------------------|----------------------------|---------------------|-------------------|-----------------------------|---------------------------|---|-------------------------|-----------------------|-----------------|---------|
| QA | 1 | W | HCL | 4-2-03 | | | | | X | X | | | | | | | | |
| MW-1 | 3 | ↓ | ↓ | 0912 | | | | | X | X | | | | | | | | |
| MW-2 | 3 | ↓ | ↓ | 0926 | | | | | X | X | | | | | | | | |
| MW-3 | 3 | ↓ | ↓ | 0959 | | | | | X | X | | | | | | | | |
| MW-4 | 3 | ↓ | ↓ | 0943 | | | | | X | X | | | | | | | | |

- OXYGENATES 8260
- 1 - MTBE
 - 2 - TBA
 - 3 - TAME
 - 4 - DIPE
 - 5 - ETBE
 - 6 - 1,2-DCA
 - 7 - EDB
 - 8 - ETHANOL

| | | | | | | | |
|---|--------------------------|---------------------|--|---------------------|----------------------------|---------------|--|
| Relinquished By (Signature) <i>Brian Gan</i> | Organization G-R | Date/Time 4-2-03 | Received By (Signature) <i>[Signature]</i> | Organization STL | Date/Time 04-03-03 | Lead Y/N Y | Turn Around Time (Circle Choice) 24 Hrs. 48 Hrs. 72 Hrs. 5 Days 10 Days <u>As Contracted</u> |
| Relinquished By (Signature) <i>[Signature]</i> | Organization STL S.P. | Date/Time 4/3/03 | Received By (Signature) | Organization | Date/Time | Lead Y/N | |
| Relinquished By (Signature) | Organization | Date/Time | Received For Laboratory By (Signature) <i>Deanne L. Harding</i> | | Date/Time 4/3/03 @ 1145 | Lead Y/N | |

Gettler Ryan

April 17, 2003

6747 Sierra Court Suite J
Dublin, CA 94568

Attn.: Deanna Harding

Project#: 180299.80

Project: Tosco #7124

Site: 10151 East 14th Street
Oakland, CA

Dear Ms. Harding,

Attached is our report for your samples received on 04/03/2003 11:45

This report has been reviewed and approved for release. Reproduction of this report is permitted only in its entirety.

The report contains a Case Narrative detailing sample receipt and analysis.

Please note that any unused portion of the samples will be discarded after 05/18/2003 unless you have requested otherwise.

We appreciate the opportunity to be of service to you. If you have any questions, please call me at (925) 484-1919.

You can also contact me via email. My email address is: tgranicher@stl-inc.com

Sincerely,



Tod Granicher
Project Manager

Gettler Ryan

April 17, 2003

6747 Sierra Court Suite J
Dublin, CA 94568

Attn.: Deanna Harding

Project#: 180299.80

Project: Tosco #7124

Site: 10151 East 14th Street
Oakland, CA

Case Narrative

General and Sample Comments

We (STL San Francisco) received 5 Water samples , on Thursday, April 03, 2003 11:45 AM.

Analysis Coments and Flags by QC Batch

| | | |
|-----------------------------------|-------|-----------------------------|
| Gas/BTEX Fuel Oxygenates by 8260B | Water | QC Batch#: 2003/04/10-03.62 |
|-----------------------------------|-------|-----------------------------|

- MW-1 2003-04-0099-002
 Compound Flag(s)
 g Hydrocarbon reported in the gasoline range does not match our gasoline standard.
- MW-2 2003-04-0099-003
 Analysis Flag(s)
 o Reporting limits were raised due to high level of analyte present in the sample.
- MW-2 2003-04-0099-003
 Compound Flag(s)
 g Hydrocarbon reported in the gasoline range does not match our gasoline standard.
- MW-3 2003-04-0099-004
 Analysis Flag(s)
 o Reporting limits were raised due to high level of analyte present in the sample.
- MW-3 2003-04-0099-004
 Compound Flag(s)
 g Hydrocarbon reported in the gasoline range does not match our gasoline standard.
- MW-4 2003-04-0099-005
 Analysis Flag(s)
 o Reporting limits were raised due to high level of analyte present in the sample.
- MW-4 2003-04-0099-005
 Compound Flag(s)
 g Hydrocarbon reported in the gasoline range does not match our gasoline standard.

Severn Trent Laboratories, Inc.

STL San Francisco * 1220 Quarry Lane, Pleasanton, CA 94566

Tel 925 464 1919 Fax 925 464 1096 * www.stl-inc.com * CA DHS ELAP# 2496

Gas/BTEX Fuel Oxygenates by 8260B

Gettler Ryan

Attn.: Deanna Harding

6747 Sierra Court Suite J

Dublin, CA 94568

Phone: (925) 551-7444 Fax: (925) 551-7899

Project: 180299.80
Tosco #7124

Received: 04/03/2003 11:45

Site: 10151 East 14th Street
Oakland, CA**Samples Reported**

| Sample Name | Date Sampled | Matrix | Lab # |
|-------------|------------------|--------|-------|
| QA | 04/02/2003 | Water | 1 |
| MW-1 | 04/02/2003 09:12 | Water | 2 |
| MW-2 | 04/02/2003 09:26 | Water | 3 |
| MW-3 | 04/02/2003 09:59 | Water | 4 |
| MW-4 | 04/02/2003 09:43 | Water | 5 |

Severn Trent Laboratories, Inc.

STL San Francisco * 1220 Quarry Lane, Pleasanton, CA 94566

Tel 925 484 1919 Fax 925 484 1096 * www.stl-inc.com * CA DHS ELAP# 2496

04/11/2003 10:34

Page 1 of 12

Gas/BTEX Fuel Oxygenates by 8260B

Gettler Ryan

Attn.: Deanna Harding

6747 Sierra Court Suite J

Dublin, CA 94568

Phone: (925) 551-7444 Fax: (925) 551-7899

Project: 180299.80

Tosco #7124

Received: 04/03/2003 11:45

Site: 10151 East 14th Street
Oakland, CA

Prep(s): 5030B

Sample ID: QA

Sampled: 04/02/2003

Matrix: Water

Test(s): 8260FAB

Lab ID: 2003-04-0099 - 1

Extracted: 4/10/2003 20:54

QC Batch#: 2003/04/10-V1.62

| Compound | Conc. | RL | Unit | Dilution | Analyzed | Flag |
|--------------------------------|-------|--------|------|----------|------------------|------|
| Gasoline | ND | 50 | ug/L | 1.00 | 04/10/2003 20:54 | |
| Benzene | ND | 0.50 | ug/L | 1.00 | 04/10/2003 20:54 | |
| Toluene | ND | 0.50 | ug/L | 1.00 | 04/10/2003 20:54 | |
| Ethylbenzene | ND | 0.50 | ug/L | 1.00 | 04/10/2003 20:54 | |
| Total xylenes | ND | 1.0 | ug/L | 1.00 | 04/10/2003 20:54 | |
| Methyl tert-butyl ether (MTBE) | ND | 2.0 | ug/L | 1.00 | 04/10/2003 20:54 | |
| Surrogates(s) | | | | | | |
| 1,2-Dichloroethane-d4 | 99.4 | 76-114 | % | 1.00 | 04/10/2003 20:54 | |
| Toluene-d8 | 99.8 | 88-110 | % | 1.00 | 04/10/2003 20:54 | |

Gas/BTEX Fuel Oxygenates by 8260B

Gettler Ryan

Attn.: Deanna Harding

6747 Sierra Court Suite J

Dublin, CA 94568

Phone: (925) 551-7444 Fax: (925) 551-7899

Project: 180299.80

Tosco #7124

Received: 04/03/2003 11:45

 Site: 10151 East 14th Street
Oakland, CA

| | |
|---------------------------|-----------------------------|
| Prep(s): 5030B | Test(s): 8260FAB |
| Sample ID: MW-1 | Lab ID: 2003-04-0099 - 2 |
| Sampled: 04/02/2003 09:12 | Extracted: 4/11/2003 02:25 |
| Matrix: Water | QC Batch#: 2003/04/10-03.62 |

| Compound | Conc. | RL | Unit | Dilution | Analyzed | Flag |
|--------------------------------|-------|--------|------|----------|------------------|------|
| Gasoline | 460 | 50 | ug/L | 1.00 | 04/11/2003 02:25 | g |
| Benzene | ND | 0.50 | ug/L | 1.00 | 04/11/2003 02:25 | |
| Toluene | ND | 0.50 | ug/L | 1.00 | 04/11/2003 02:25 | |
| Ethylbenzene | ND | 0.50 | ug/L | 1.00 | 04/11/2003 02:25 | |
| Total xylenes | ND | 1.0 | ug/L | 1.00 | 04/11/2003 02:25 | |
| tert-Butyl alcohol (TBA) | ND | 100 | ug/L | 1.00 | 04/11/2003 02:25 | |
| Methyl tert-butyl ether (MTBE) | ND | 2.0 | ug/L | 1.00 | 04/11/2003 02:25 | |
| Di-isopropyl Ether (DIPE) | ND | 2.0 | ug/L | 1.00 | 04/11/2003 02:25 | |
| Ethyl tert-butyl ether (ETBE) | ND | 2.0 | ug/L | 1.00 | 04/11/2003 02:25 | |
| tert-Amyl methyl ether (TAME) | ND | 2.0 | ug/L | 1.00 | 04/11/2003 02:25 | |
| 1,2-DCA | ND | 2.0 | ug/L | 1.00 | 04/11/2003 02:25 | |
| EDB | ND | 2.0 | ug/L | 1.00 | 04/11/2003 02:25 | |
| Ethanol | ND | 500 | ug/L | 1.00 | 04/11/2003 02:25 | |
| Surrogates(s) | | | | | | |
| 1,2-Dichloroethane-d4 | 102.4 | 76-114 | % | 1.00 | 04/11/2003 02:25 | |
| Toluene-d8 | 97.7 | 88-110 | % | 1.00 | 04/11/2003 02:25 | |

Gas/BTEX Fuel Oxygenates by 8260B

Gettler Ryan

Attn.: Deanna Harding

6747 Sierra Court Suite J

Dublin, CA 94568

Phone: (925) 551-7444 Fax: (925) 551-7899

Project: 180299.80

Tosco #7124

Received: 04/03/2003 11:45

Site: 10151 East 14th Street
Oakland, CA

Prep(s): 5030B

Test(s): 8260FAB

Sample ID: MW-2

Lab ID: 2003-04-0099 - 3

Sampled: 04/02/2003 09:26

Extracted: 4/11/2003 03:31

Matrix: Water

QC Batch#: 2003/04/10-03.62

Analysis Flag: o (See Legend and Note Section)

| Compound | Conc. | RL | Unit | Dilution | Analyzed | Flag |
|--------------------------------|-------|--------|------|----------|------------------|------|
| Gasoline | 1000 | 500 | ug/L | 10.00 | 04/11/2003 03:31 | g |
| Benzene | ND | 5.0 | ug/L | 10.00 | 04/11/2003 03:31 | |
| Toluene | ND | 5.0 | ug/L | 10.00 | 04/11/2003 03:31 | |
| Ethylbenzene | ND | 5.0 | ug/L | 10.00 | 04/11/2003 03:31 | |
| Total xylenes | ND | 10 | ug/L | 10.00 | 04/11/2003 03:31 | |
| tert-Butyl alcohol (TBA) | ND | 1000 | ug/L | 10.00 | 04/11/2003 03:31 | |
| Methyl tert-butyl ether (MTBE) | 180 | 20 | ug/L | 10.00 | 04/11/2003 03:31 | |
| Di-isopropyl Ether (DIPE) | ND | 20 | ug/L | 10.00 | 04/11/2003 03:31 | |
| Ethyl tert-butyl ether (ETBE) | ND | 20 | ug/L | 10.00 | 04/11/2003 03:31 | |
| tert-Amyl methyl ether (TAME) | ND | 20 | ug/L | 10.00 | 04/11/2003 03:31 | |
| 1,2-DCA | ND | 20 | ug/L | 10.00 | 04/11/2003 03:31 | |
| EDB | ND | 20 | ug/L | 10.00 | 04/11/2003 03:31 | |
| Ethanol | ND | 5000 | ug/L | 10.00 | 04/11/2003 03:31 | |
| Surrogates(s) | | | | | | |
| 1,2-Dichloroethane-d4 | 103.8 | 76-114 | % | 10.00 | 04/11/2003 03:31 | |
| Toluene-d8 | 98.9 | 88-110 | % | 10.00 | 04/11/2003 03:31 | |

Severn Trent Laboratories, Inc.

STL San Francisco * 1220 Quarry Lane, Pleasanton, CA 94566

Tel 925 484 1919 Fax 925 484 1096 * www.stl-inc.com * CA DHS ELAP# 2496

04/11/2003 10:34

Page 4 of 12

Gas/BTEX Fuel Oxygenates by 8260B

Gettler Ryan

Attn.: Deanna Harding

6747 Sierra Court Suite J

Dublin, CA 94568

Phone: (925) 551-7444 Fax: (925) 551-7899

Project: 180299.80

Tosco #7124

Received: 04/03/2003 11:45

Site: 10151 East 14th Street

Oakland, CA

| | | | |
|--|------------------|------------|------------------|
| Prep(s): | 5030B | Test(s): | 8260FAB |
| Sample ID: | MW-3 | Lab ID: | 2003-04-0099 - 4 |
| Sampled: | 04/02/2003 09:59 | Extracted: | 4/11/2003 03:53 |
| Matrix: | Water | QC Batch#: | 2003/04/10-03.62 |
| Analysis Flag: o (See Legend and Note Section) | | | |

| Compound | Conc. | RL | Unit | Dilution | Analyzed | Flag |
|--------------------------------|--------|--------|------|----------|------------------|------|
| Gasoline | 130000 | 10000 | ug/L | 200.00 | 04/11/2003 03:53 | g |
| Benzene | ND | 100 | ug/L | 200.00 | 04/11/2003 03:53 | |
| Toluene | ND | 100 | ug/L | 200.00 | 04/11/2003 03:53 | |
| Ethylbenzene | ND | 100 | ug/L | 200.00 | 04/11/2003 03:53 | |
| Total xylenes | ND | 200 | ug/L | 200.00 | 04/11/2003 03:53 | |
| tert-Butyl alcohol (TBA) | ND | 20000 | ug/L | 200.00 | 04/11/2003 03:53 | |
| Methyl tert-butyl ether (MTBE) | 4400 | 400 | ug/L | 200.00 | 04/11/2003 03:53 | |
| Di-isopropyl Ether (DIPE) | ND | 400 | ug/L | 200.00 | 04/11/2003 03:53 | |
| Ethyl teri-butyl ether (ETBE) | ND | 400 | ug/L | 200.00 | 04/11/2003 03:53 | |
| tert-Amyl methyl ether (TAME) | ND | 400 | ug/L | 200.00 | 04/11/2003 03:53 | |
| 1,2-DCA | ND | 400 | ug/L | 200.00 | 04/11/2003 03:53 | |
| EDB | ND | 400 | ug/L | 200.00 | 04/11/2003 03:53 | |
| Ethanol | ND | 100000 | ug/L | 200.00 | 04/11/2003 03:53 | |
| Surrogates(s) | | | | | | |
| 1,2-Dichloroethane-d4 | 104.6 | 76-114 | % | 200.00 | 04/11/2003 03:53 | |
| Toluene-d8 | 97.7 | 88-110 | % | 200.00 | 04/11/2003 03:53 | |

Gas/BTEX Fuel Oxygenates by 8260B

Gettler Ryan

Attn.: Deanna Harding

6747 Sierra Court Suite J

Dublin, CA 94568

Phone: (925) 551-7444 Fax: (925) 551-7899

Project: 180299.80

Tosco #7124

Received: 04/03/2003 11:45

Site: 10151 East 14th Street
Oakland, CA

Prep(s): 5030B Test(s): 8260FAB
 Sample ID: MW-4 Lab ID: 2003-04-0099 - 5
 Sampled: 04/02/2003 09:43 Extracted: 4/11/2003 04:15
 Matrix: Water QC Batch#: 2003/04/10-03.62
 Analysis Flag: o (See Legend and Note Section)

| Compound | Conc. | RL | Unit | Dilution | Analyzed | Flag |
|--------------------------------|--------|--------|------|----------|------------------|------|
| Gasoline | 130000 | 10000 | ug/L | 200.00 | 04/11/2003 04:15 | g |
| Benzene | ND | 100 | ug/L | 200.00 | 04/11/2003 04:15 | |
| Toluene | ND | 100 | ug/L | 200.00 | 04/11/2003 04:15 | |
| Ethylbenzene | ND | 100 | ug/L | 200.00 | 04/11/2003 04:15 | |
| Total xylenes | ND | 200 | ug/L | 200.00 | 04/11/2003 04:15 | |
| tert-Butyl alcohol (TBA) | ND | 20000 | ug/L | 200.00 | 04/11/2003 04:15 | |
| Methyl tert-butyl ether (MTBE) | ND | 400 | ug/L | 200.00 | 04/11/2003 04:15 | |
| Di-isopropyl Ether (DIPE) | ND | 400 | ug/L | 200.00 | 04/11/2003 04:15 | |
| Ethyl tert-butyl ether (ETBE) | ND | 400 | ug/L | 200.00 | 04/11/2003 04:15 | |
| tert-Amyl methyl ether (TAME) | ND | 400 | ug/L | 200.00 | 04/11/2003 04:15 | |
| 1,2-DCA | ND | 400 | ug/L | 200.00 | 04/11/2003 04:15 | |
| EDB | ND | 400 | ug/L | 200.00 | 04/11/2003 04:15 | |
| Ethanol | ND | 100000 | ug/L | 200.00 | 04/11/2003 04:15 | |
| Surrogates(s) | | | | | | |
| 1,2-Dichloroethane-d4 | 105.1 | 76-114 | % | 200.00 | 04/11/2003 04:15 | |
| Toluene-d8 | 99.7 | 88-110 | % | 200.00 | 04/11/2003 04:15 | |

Gas/BTEX Fuel Oxygenates by 8260B

Gettler Ryan

Attn.: Deanna Harding

6747 Sierra Court Suite J

Dublin, CA 94568

Phone: (925) 551-7444 Fax: (925) 551-7899

Project: 180299.80

Tosco #7124

Received: 04/03/2003 11:45

Site: 10151 East 14th Street
Oakland, CA

Batch QC Report

Prep(s): 5030B

Method Blank

MB: 2003/04/10-03.62-034

Water

Test(s): 8260FAB

QC Batch # 2003/04/10-03.62

Date Extracted: 04/11/2003 00:34

| Compound | Conc. | RL | Unit | Analyzed | Flag |
|--------------------------------|-------|--------|------|------------------|------|
| Gasoline | ND | 50 | ug/L | 04/11/2003 00:34 | |
| Benzene | ND | 0.5 | ug/L | 04/11/2003 00:34 | |
| Toluene | ND | 0.5 | ug/L | 04/11/2003 00:34 | |
| Ethylbenzene | ND | 0.5 | ug/L | 04/11/2003 00:34 | |
| Total xylenes | ND | 1.0 | ug/L | 04/11/2003 00:34 | |
| tert-Butyl alcohol (TBA) | ND | 100 | ug/L | 04/11/2003 00:34 | |
| Methyl tert-butyl ether (MTBE) | ND | 2.0 | ug/L | 04/11/2003 00:34 | |
| Di-isopropyl Ether (DIPE) | ND | 2.0 | ug/L | 04/11/2003 00:34 | |
| Ethyl tert-butyl ether (ETBE) | ND | 2.0 | ug/L | 04/11/2003 00:34 | |
| tert-Amyl methyl ether (TAME) | ND | 2.0 | ug/L | 04/11/2003 00:34 | |
| 1,2-DCA | ND | 2.0 | ug/L | 04/11/2003 00:34 | |
| EDB | ND | 2.0 | ug/L | 04/11/2003 00:34 | |
| Ethanol | ND | 500 | ug/L | 04/11/2003 00:34 | |
| Surrogates(s) | | | | | |
| 1,2-Dichloroethane-d4 | 103.9 | 76-114 | % | 04/11/2003 00:34 | |
| Toluene-d8 | 97.9 | 88-110 | % | 04/11/2003 00:34 | |

Gas/BTEX Fuel Oxygenates by 8260B

Gettler Ryan

Attn.: Deanna Harding

6747 Sierra Court Suite J

Dublin, CA 94568

Phone: (925) 551-7444 Fax: (925) 551-7899

Project: 180299.80

Tosco #7124

Received: 04/03/2003 11:45

Site: 10151 East 14th Street
Oakland, CA

Batch QC Report

Prep(s): 5030B

Method Blank

MB: 2003/04/10-V1.62-056

Water

Test(s): 8260FAB

QC Batch # 2003/04/10-V1.62

Date Extracted: 04/10/2003 10:56

| Compound | Conc. | RL | Unit | Analyzed | Flag |
|--------------------------------|-------|--------|------|------------------|------|
| Gasoline | ND | 50 | ug/L | 04/10/2003 10:56 | |
| tert-Butyl alcohol (TBA) | ND | 100 | ug/L | 04/10/2003 10:56 | |
| Methyl tert-butyl ether (MTBE) | ND | 2.0 | ug/L | 04/10/2003 10:56 | |
| Di-isopropyl Ether (DIPE) | ND | 2.0 | ug/L | 04/10/2003 10:56 | |
| Ethyl tert-butyl ether (ETBE) | ND | 2.0 | ug/L | 04/10/2003 10:56 | |
| tert-Amyl methyl ether (TAME) | ND | 2.0 | ug/L | 04/10/2003 10:56 | |
| 1,2-DCA | ND | 2.0 | ug/L | 04/10/2003 10:56 | |
| EDB | ND | 2.0 | ug/L | 04/10/2003 10:56 | |
| Benzene | ND | 0.5 | ug/L | 04/10/2003 10:56 | |
| Toluene | ND | 0.5 | ug/L | 04/10/2003 10:56 | |
| Ethylbenzene | ND | 0.5 | ug/L | 04/10/2003 10:56 | |
| Total xylenes | ND | 1.0 | ug/L | 04/10/2003 10:56 | |
| Ethanol | ND | 500 | ug/L | 04/10/2003 10:56 | |
| Surrogates(s) | | | | | |
| 1,2-Dichloroethane-d4 | 101.3 | 76-114 | % | 04/10/2003 10:56 | |
| Toluene-d8 | 96.8 | 88-110 | % | 04/10/2003 10:56 | |

Gas/BTEX Fuel Oxygenates by 8260B

Gettler Ryan
Attn.: Deanna Harding

6747 Sierra Court Suite J
Dublin, CA 94568
Phone: (925) 551-7444 Fax: (925) 551-7899
Project: 180299.80
Tosco #7124

Received: 04/03/2003 11:45

Site: 10151 East 14th Street
Oakland, CA

Batch QC Report

Prep(s): 5030B

Test(s): 8260FAB

Laboratory Control Spike

Water

QC Batch # 2003/04/10-03.62

LCS 2003/04/10-03.62-050

Extracted: 04/10/2003

Analyzed: 04/10/2003 23:50

LCSD 2003/04/10-03.62-012

Extracted: 04/11/2003

Analyzed: 04/11/2003 00:12

| Compound | Conc. ug/L | | Exp. Conc. | Recovery | | RPD | Ctrl. Limits % | | Flags | |
|--------------------------------|------------|------|------------|----------|-------|-----|----------------|------|-------|-----|
| | LCS | LCSD | | LCS | LCSD | | % | Rec. | RPD | LCS |
| Benzene | 26.8 | 25.1 | 25.0 | 107.2 | 100.4 | 6.6 | 69-129 | 20 | | |
| Toluene | 25.1 | 24.4 | 25.0 | 100.4 | 97.6 | 2.8 | 70-130 | 20 | | |
| Methyl tert-butyl ether (MTBE) | 29.9 | 28.6 | 25.0 | 119.6 | 114.4 | 4.4 | 65-165 | 20 | | |
| Surrogates(s) | | | | | | | | | | |
| 1,2-Dichloroethane-d4 | 510 | 509 | 500 | 102.0 | 101.8 | | 76-114 | | | |
| Toluene-d8 | 518 | 493 | 500 | 103.6 | 98.6 | | 88-110 | | | |

Gas/BTEX Fuel Oxygenates by 8260B

Gettler Ryan
Attn.: Deanna Harding

6747 Sierra Court Suite J
Dublin, CA 94568
Phone: (925) 551-7444 Fax: (925) 551-7899

Project: 180299.80
Tosco #7124

Received: 04/03/2003 11:45

Site: 10151 East 14th Street
Oakland, CA

Batch QC Report

Prep(s): 5030B

Test(s): 8260FAB

Laboratory Control Spike

Water

QC Batch # 2003/04/10-V1.62

LCS 2003/04/10-V1.62-011

Extracted: 04/10/2003

Analyzed: 04/10/2003 10:11

LCSD 2003/04/10-V1.62-034

Extracted: 04/10/2003

Analyzed: 04/10/2003 10:34

| Compound | Conc. ug/L | | Exp.Conc. | Recovery | | RPD | Ctrl.Limits % | | Flags | |
|--------------------------------|------------|------|-----------|----------|-------|-----|---------------|------|-------|-----|
| | LCS | LCSD | | LCS | LCSD | | % | Rec. | RPD | LCS |
| Methyl tert-butyl ether (MTBE) | 32.2 | 30.1 | 25 | 128.8 | 120.4 | 6.7 | 65-165 | 20 | | |
| Benzene | 27.3 | 26.2 | 25 | 109.2 | 104.8 | 4.1 | 69-129 | 20 | | |
| Toluene | 27.9 | 25.5 | 25 | 111.6 | 102.0 | 9.0 | 70-130 | 20 | | |
| Surrogates(s) | | | | | | | | | | |
| 1,2-Dichloroethane-d4 | 527 | 516 | 500 | 105.4 | 103.2 | | 76-114 | | | |
| Toluene-d8 | 533 | 512 | 500 | 106.6 | 102.4 | | 88-110 | | | |

Severn Trent Laboratories, Inc.

STL San Francisco * 1220 Quarry Lane, Pleasanton, CA 94566

Tel 925 484 1919 Fax 925 484 1096 * www.stl-inc.com * CA DHS ELAP# 2496

04/11/2003 10:34

Page 10 of 12

Gas/BTEX Fuel Oxygenates by 8260B

Gettler Ryan
Attn.: Deanna Harding

6747 Sierra Court Suite J
Dublin, CA 94568
Phone: (925) 551-7444 Fax: (925) 551-7899

Project: 180299.80
Tosco #7124

Received: 04/03/2003 11:45

Site: 10151 East 14th Street
Oakland, CA

Batch QC Report

Prep(s): 5030B

Test(s): 8260FAB

Matrix Spike (MS / MSD)

Water

QC Batch # 2003/04/10-03.62

MW-1 >> MS

Lab ID: 2003-04-0099 - 002

MS: 2003/04/10-03.62-051

Extracted: 04/11/2003

Analyzed: 04/11/2003 02:47

Dilution: 1.00

MSD: 2003/04/10-03.62-052

Extracted: 04/11/2003

Analyzed: 04/11/2003 03:09

Dilution: 1.00

| Compound | Conc. ug/L | | | Spk.Level ug/L | Recovery | | | Limits % | | Flags | |
|-------------------------|------------|------|--------|-------------------|----------|-------|------|----------|-----|-------|-----|
| | MS | MSD | Sample | | MS | MSD | RPD | Rec. | RPD | MS | MSD |
| Benzene | 28.4 | 24.3 | ND | 25.0 | 113.6 | 97.2 | 15.6 | 69-129 | 20 | | |
| Toluene | 27.6 | 24.4 | ND | 25.0 | 110.4 | 97.6 | 12.3 | 70-130 | 20 | | |
| Methyl tert-butyl ether | 31.8 | 29.5 | ND | 25.0 | 127.2 | 118.0 | 7.5 | 65-165 | 20 | | |
| Surrogate(s) | | | | | | | | | | | |
| 1,2-Dichloroethane-d4 | 539 | 531 | | 500 | 107.8 | 106.2 | | 76-114 | 0 | | |
| Toluene-d8 | 507 | 516 | | 500 | 101.4 | 103.2 | | 88-110 | 0 | | |

Gas/BTEX Fuel Oxygenates by 8260B

Gettler Ryan

Attn.: Deanna Harding

6747 Sierra Court Suite J

Dublin, CA 94568

Phone: (925) 551-7444 Fax: (925) 551-7899

Project: 180299.80

Tosco #7124

Received: 04/03/2003 11:45

Site: 10151 East 14th Street
Oakland, CA

Legend and Notes

Analysis Flag

0

Reporting limits were raised due to high level of analyte present in the sample.

Result Flag

9

Hydrocarbon reported in the gasoline range does not match our gasoline standard.