



GETTLER-RYAN INC.

Handwritten initials

TRANSMITTAL

Alameda County December 16, 2002
G-R #180299
JAN 03 2003

TO: Mr. David B. De Witt
Phillips 66 Company
2000 Crow Canyon Place, Suite 400
San Ramon, California 94583

Environmental Health
CC: Mr. Forrest McFarland
Secor International, Inc.
2301 Leghorn Street
Mountain View, CA 94043

FROM: Deanna L. Harding
Project Coordinator
Gettler-Ryan Inc.
6747 Sierra Court, Suite J
Dublin, California 94568

NO 2444W

RE: **Tosco (Unocal) Service Station**
#7124
10151 East 14th Street
Oakland, California

WE HAVE ENCLOSED THE FOLLOWING:

COPIES	DATED	DESCRIPTION
1	December 12, 2002	Groundwater Monitoring and Sampling Report Fourth Quarter - Event of November 3, 2002

COMMENTS:

This report is being sent to you for your review/comment, prior to being distributed on your behalf. If no comments are received by **December 30, 2002**, this report will be distributed to the following:

cc: Ms. Eva Chu, Alameda County Health Care Services, 1131 Harbor Bay Parkway, Suite 250 Alameda, CA 94502

Enclosure



GETTLER-RYAN INC.

December 12, 2002

G-R Job #180299

Mr. David B. De Witt
Phillips 66 Company
2000 Crow Canyon Place, Suite 400
San Ramon, California 94583

RE: Fourth Quarter Event of November 3, 2002
Groundwater Monitoring & Sampling Report
Tosco (Unocal) Service Station #7124
10151 East 14th Street
Oakland, California

Dear Mr. De Witt:

This report documents the most recent groundwater monitoring and sampling event performed by Gettler-Ryan Inc. (G-R) at the referenced site. All field work was conducted in accordance with G-R Standard Operating Procedure - Groundwater Sampling (attached).

Static groundwater levels were measured and all wells were checked for the presence of separate-phase hydrocarbons. Separate-phase hydrocarbons were not present in the wells. Static water level data and groundwater elevations are summarized in Table 1. A Potentiometric Map is included as Figure 1.

Groundwater samples were collected from the monitoring wells and submitted to a state certified laboratory for analyses. The field data sheets for this event are attached. Analytical results are presented in the table(s) listed below. A Concentration Map is included as Figure 2. The chain of custody document and laboratory analytical report are also attached.

Sincerely,

Deanna L. Harding
Project Coordinator

Hagop Kevork
P.E. No. C55734



Figure 1: Potentiometric Map
Figure 2: Concentration Map
Table 1: Groundwater Monitoring Data and Analytical Results
Table 2: Groundwater Analytical Results
Attachments: Standard Operating Procedure - Groundwater Sampling
Field Data Sheets
Chain of Custody Document and Laboratory Analytical Reports

7124.qml

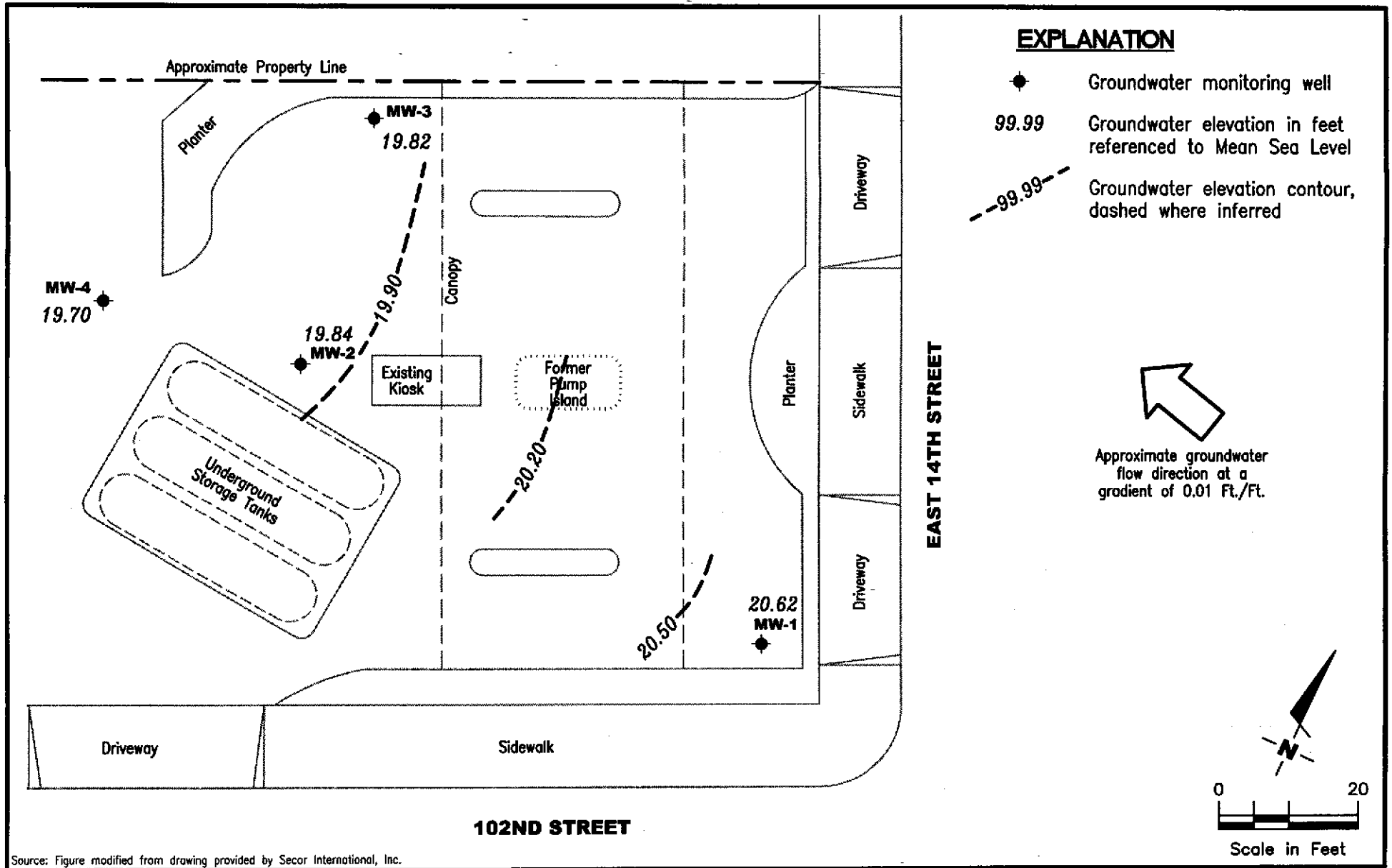

Source: Figure modified from drawing provided by Secor International, Inc.

GETTLER - RYAN INC.
 6747 Sierra Ct., Suite J
 Dublin, CA 94568 (925) 551-7555

POTENTIOMETRIC MAP
 Tosco (Unocal) Service Station #7124
 10151 East 14th Street
 Oakland, California

FIGURE
1

PROJECT NUMBER
 180299

REVIEWED BY

DATE
 November 3, 2002

REVISED DATE

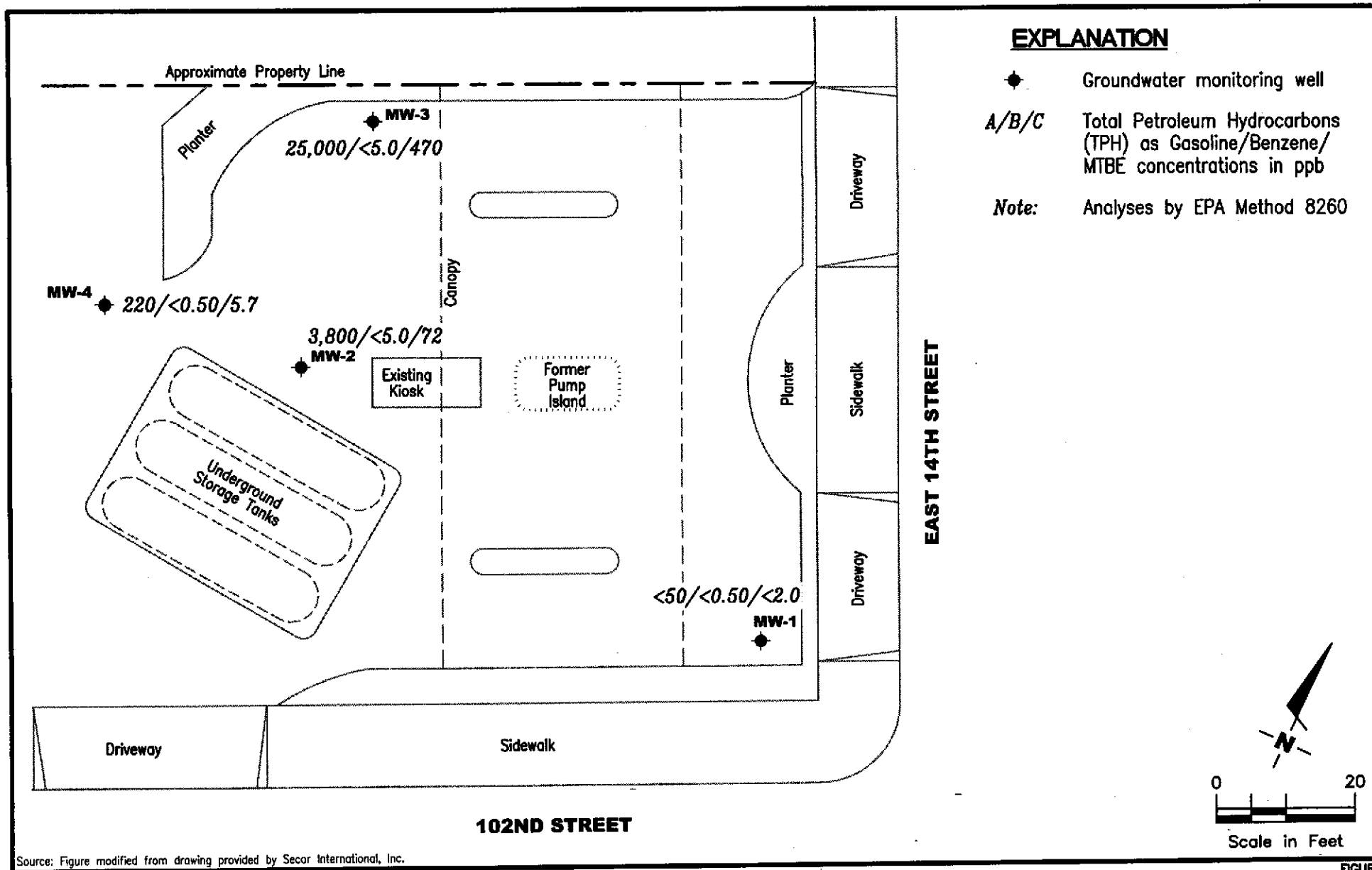

GETTLER - RYAN INC.
 6747 Sierra Ct., Suite J
 Dublin, CA 94568 (925) 551-7555

CONCENTRATION MAP
 Tosco (Unocal) Service Station #7124
 10151 East 14th Street
 Oakland, California

FIGURE

2

PROJECT NUMBER
 180299

REVIEWED BY

DATE
 November 3, 2002

REVISED DATE

Table 1
Groundwater Monitoring Data and Analytical Results
 Tosco (Unocal) Service Station #7124
 10151 East 14th Street
 Oakland, California

WELL ID/ TOC*(ft.)	DATE	DTW (ft.)	GWE (msl)	TPH-G (ppb)	B (ppb)	T (ppb)	E (ppb)	X (ppb)	MTBE (ppb)
MW-1									
37.37	04/08/02 ¹	14.27	23.10	<50	<0.50	<0.50	<0.50	<0.50	<2.5/<2.0 ²
	07/28/02 ³	15.88	21.49	<50	<0.50	<0.50	<0.50	<1.0	<2.0
	11/03/02 ³	16.75	20.62	<50	<0.50	<0.50	<0.50	<1.0	<2.0
MW-2									
37.87	04/08/02 ¹	15.86	22.01	4,400	<2.5	<2.5	6.4	<2.5	380/490 ²
	07/28/02 ³	17.28	20.59	3,200 ⁴	<2.5	<2.5	<2.5	<5.0	170
	11/03/02 ³	18.03	19.84	3,800 ⁴	<5.0	<5.0	<5.0	<10	72
MW-3									
37.72	04/08/02 ¹	15.86	21.86	8,700	65	<25	400	<25	6,500/8,300 ²
	07/28/02 ³	17.22	20.50	4,500 ⁴	<25	<25	<25	<50	1,100
	11/03/02 ³	17.90	19.82	25,000 ⁴	<5.0	<5.0	25	<10	470
MW-4									
38.36	04/08/01 ¹	16.59	21.77	13,000	<5.0	<5.0	28	<5.0	790/980 ²
	07/28/02 ³	17.93	20.43	18,000 ⁴	<2.5	<2.5	<2.5	<5.0	170
	11/03/02 ³	18.66	19.70	220 ⁴	<0.50	<0.50	<0.50	<1.0	5.7
Trip Blank									
TB-LB	04/08/02	--	--	<50	<0.50	<0.50	<0.50	<0.50	<2.5
QA	07/28/02 ³	--	--	<50	<0.50	<0.50	<0.50	<1.0	<2.0
	11/03/02 ³	--	--	<50	<0.50	<0.50	<0.50	<1.0	<2.0

Table 1
Groundwater Monitoring Data and Analytical Results
Tosco (Unocal) Service Station #7124
10151 East 14th Street
Oakland, California

EXPLANATIONS:

TOC = Top of Casing

(ft.) = Feet

DTW = Depth to Water

GWE = Groundwater Elevation

(msl) = Mean sea level

TPH-G = Total Petroleum Hydrocarbons as Gasoline

B = Benzene

T = Toluene

E = Ethylbenzene

X = Xylenes

MTBE = Methyl tertiary butyl ether

(ppb) = Parts per billion

-- = Not Measured/Not Analyzed

QA = Quality Assurance/Trip Blank

* TOC elevations were surveyed on March 18, 2002, by Mid Coast Engineers. The benchmark used for the survey is HT0281, a benchmark disk in a concrete headwall on the east side of Railroad Avenue approximately 500 feet south of 85th Avenue (Benchmark Elevation = 11.50 feet NGVD 29).

¹ Well development performed.

² MTBE by EPA Method 8260.

³ TPH-G, BTEX and MTBE by EPA Method 8260.

⁴ Laboratory report indicates hydrocarbon pattern is present in the requested fuel quantitation range but does not resemble the pattern of the requested fuel.

Table 2
Groundwater Analytical Results - Oxygenate Compounds
 Tosco (Unocal) Service Station #7124
 10151 East 14th Street
 Oakland, California

WELL ID	DATE	ETHANOL (ppb)	TBA (ppb)	MTBE (ppb)	DIPE (ppb)	ETBE (ppb)	TAME (ppb)	1,2-DCA (ppb)	EDB (ppb)
MW-1	04/08/02	<500	<100	<2.0	<2.0	<2.0	<2.0	<2.0	<2.0
	07/28/02	<500	<100	<2.0	<2.0	<2.0	<2.0	<2.0	<2.0
	11/03/02	<500	<100	<2.0	<2.0	<2.0	<2.0	<2.0	<2.0
MW-2	04/08/02	<10,000	<2,000	490	<40	<40	<40	<40	<40
	07/28/02	<2,500	<500	170	<10	<10	<10	<10	<10
	11/03/02	<5,000	<1,000	72	<20	<20	<20	<20	<20
MW-3	04/08/02	<250,000	<50,000	8,300	<1,000	<1,000	<1,000	<1,000	<1,000
	07/28/02	<25,000	<5,000	1,100	<100	<100	<100	<100	<100
	11/03/02	<5,000	<1,000	470	<20	<20	<20	<20	<20
MW-4	04/08/02	<25,000	<5,000	980	<100	<100	<100	<100	<100
	07/28/02	<2,500	<500	170	<10	<10	<10	<10	<10
	11/03/02	<500	<100	5.7	<2.0	<2.0	<2.0	<2.0	<2.0

EXPLANATIONS:

TBA = Tertiary butyl alcohol
 MTBE = Methyl tertiary butyl ether
 DIPE = Di-isopropyl ether
 ETBE = Ethyl tertiary butyl ether
 TAME = Tertiary amyl methyl ether
 1,2-DCA = 1,2-Dichloroethane
 EDB = 1,2-Dibromoethane
 (ppb) = Parts per billion

ANALYTICAL METHOD:

EPA Method 8260 for Oxygenate Compounds



GETTLER - RYAN INC.

WELL MONITORING/SAMPLING FIELD DATA SHEET

Client/Facility #: Tosco #7124 Job Number: 180299
 Site Address: 10151 E. 14Th St. Event Date: 11/3/02 (inclusive)
 City: Oakland, CA Sampler: RL

Well ID: MW-1
 Well Diameter: 4 in.
 Total Depth: 25.40 ft.
 Depth to Water: 16.75 ft.

Well Condition: OK

Volume	3/4" = 0.02	1" = 0.04	2" = 0.17	3" = 0.38
Factor (VF)	4" = 0.66	5" = 1.02	6" = 1.50	12" = 5.80

8.65 xVF .66 = 6 x3 (case volume) = Estimated Purge Volume: 18 gal.

Purge Equipment:
 Disposable Bailer: _____
 Stainless Steel Bailer: _____
 Stack Pump: _____
 Suction Pump: _____
 Grundfos: _____
 Other: _____

Sampling Equipment:
 Disposable Bailer: _____
 Pressure Bailer: _____
 Discrete Bailer: _____
 Other: _____

Time Started: _____ (2400 hrs)
 Time Bailed: _____ (2400 hrs)
 Depth to Product: _____ ft
 Depth to Water: _____ ft
 Hydrocarbon Thickness: _____ ft
 Visual Confirmation/Description: _____
 Skimmer / Absorbant Sock (circle one)
 Amt Removed from Skimmer: _____ gal
 Amt Removed from Well: _____ gal
 Product Transferred to: _____

Start Time (purge): 1056 Weather Conditions: Sunny
 Sample Time/Date: 1111 11/3/02 Water Color: Brown/H Odor: NO
 Purging Flow Rate: 2 gpm. Sediment Description: _____
 Did well de-water? NO If yes, Time: _____ Volume: _____ gal.

Time (2400 hr.)	Volume (gal.)	pH	Conductivity (umhos/cm)	Temperature (C/F)	D.O. (mg/L)	ORP (mV)
<u>1058</u>	<u>6</u>	<u>7.50</u>	<u>497</u>	<u>18.6</u>		
<u>1100</u>	<u>12</u>	<u>7.46</u>	<u>450</u>	<u>18.7</u>		
<u>1103</u>	<u>18</u>	<u>7.41</u>	<u>451</u>	<u>18.9</u>		

LABORATORY INFORMATION

SAMPLE ID	(#) CONTAINER	REFRIG.	PRESERV. TYPE	LABORATORY	ANALYSES
<u>MW-1</u>	<u>5</u> x voa vial	<u>YES</u>	<u>HCL</u>	<u>STL Pleasanton</u>	<u>TPH-G/BTEX/MTBE/8 Oxy's(8260)</u>

COMMENTS: _____

Add/Replaced Lock: _____

Add/Replaced Plug: _____ Size: _____



GETTLER-RYAN INC.

WELL MONITORING/SAMPLING FIELD DATA SHEET

Client/Facility #: Tosco #7124 Job Number: 180299
 Site Address: 10151 E. 14Th St. Event Date: 11.3.02 (inclusive)
 City: Oakland, CA Sampler: BC

Well ID: MW-2
 Well Diameter: 4 in.
 Total Depth: 25.46 ft.
 Depth to Water: 18.03 ft.

Well Condition: OK

Volume	3/4" = 0.02	1" = 0.04	2" = 0.17	3" = 0.38
Factor (VF)	4" = 0.66	5" = 1.02	6" = 1.50	12" = 5.80

7.43 xVF .66 = 5 x3 (case volume) = Estimated Purge Volume: 15 gal.

Purge Equipment:
 Disposable Bailer _____
 Stainless Steel Bailer _____
 Stack Pump _____
 Suction Pump _____
 Grundfos _____
 Other: _____

Sampling Equipment:
 Disposable Bailer _____
 Pressure Bailer _____
 Discrete Bailer _____
 Other: _____

Time Started: _____ (2400 hrs)
 Time Bailed: _____ (2400 hrs)
 Depth to Product: _____ ft
 Depth to Water: _____ ft
 Hydrocarbon Thickness: _____ ft
 Visual Confirmation/Description: _____
 Skimmer / Absorbant Sock (circle one)
 Amt Removed from Skimmer: _____ gal
 Amt Removed from Well: _____ gal
 Product Transferred to: _____

Start Time (purge): 1117 Weather Conditions: Sunny
 Sample Time/Date: 11/27 11.3.02 Water Color: Grayish Odor: Yes
 Purging Flow Rate: 3 gpm. Sediment Description: _____
 Did well de-water? No If yes, Time: _____ Volume: _____ gal.

Time (2400 hr.)	Volume (gal.)	pH	Conductivity (umhos/cm)	Temperature (C/F)	D.O. (mg/L)	ORP (mV)
<u>1119</u>	<u>5</u>	<u>7.21</u>	<u>598</u>	<u>20.0</u>		
<u>1121</u>	<u>10</u>	<u>7.18</u>	<u>596</u>	<u>20.0</u>		
<u>1123</u>	<u>15</u>	<u>7.16</u>	<u>594</u>	<u>20.0</u>		

LABORATORY INFORMATION

SAMPLE ID	(#) CONTAINER	REFRIG.	PRESERV. TYPE	LABORATORY	ANALYSES
<u>MW-2</u>	<u>3</u> x voa vial	<u>YES</u>	<u>HCL</u>	<u>STL Pleasanton</u>	<u>TPH-G/BTEX/MTBE/8 Oxy's(8260)</u>

COMMENTS: _____

Add/Replaced Lock: _____ Add/Replaced Plug: _____ Size:



GETTLER-RYAN INC.

WELL MONITORING/SAMPLING FIELD DATA SHEET

Client/Facility #: Tosco #7124 Job Number: 180299
 Site Address: 10151 E. 14Th St. Event Date: 11-3-02 (inclusive)
 City: Oakland, CA Sampler: BB

Well ID: MW-3
 Well Diameter: 4 in.
 Total Depth: 25.38 ft.
 Depth to Water: 17.90 ft.

Well Condition: OK

Volume	3/4"= 0.02	1"= 0.04	2"= 0.17	3"= 0.38
Factor (VF)	4"= 0.66	5"= 1.02	6"= 1.50	12"= 5.80

7.48 xVF 160 = 5 x3 (case volume) = Estimated Purge Volume: 15 gal.

Purge Equipment:

Disposable Bailer _____
 Stainless Steel Bailer _____
 Stack Pump _____
 Suction Pump _____
 Grundfos _____
 Other: _____

Sampling Equipment:

Disposable Bailer _____
 Pressure Bailer _____
 Discrete Bailer _____
 Other: _____

Time Started: _____ (2400 hrs)
 Time Bailed: _____ (2400 hrs)
 Depth to Product: _____ ft
 Depth to Water: _____ ft
 Hydrocarbon Thickness: _____ ft
 Visual Confirmation/Description: _____
 Skimmer / Absorbant Sock (circle one)
 Amt Removed from Skimmer: _____ gal
 Amt Removed from Well: _____ gal
 Product Transferred to: _____

Start Time (purge): 11:06 Weather Conditions: Sunny
 Sample Time/Date: 11:51 11-3-02 Water Color: grayish Odor: yes
 Purging Flow Rate: 3 gpm. Sediment Description: _____
 Did well de-water? no If yes, Time: _____ Volume: _____ gal.

Time (2400 hr.)	Volume (gal.)	pH	Conductivity (umhos/cm)	Temperature (C/F)	D.O. (mg/L)	ORP (mV)
<u>11:39</u>	<u>5</u>	<u>7.07</u>	<u>45</u>	<u>19.3</u>		
<u>11:40</u>	<u>10</u>	<u>6.99</u>	<u>55</u>	<u>19.6</u>		
<u>11:42</u>	<u>15</u>	<u>6.96</u>	<u>36</u>	<u>19.9</u>		

LABORATORY INFORMATION

SAMPLE ID	(#) CONTAINER	REFRIG.	PRESERV. TYPE	LABORATORY	ANALYSES
<u>MW-3</u>	<u>5</u> x voa vial	<u>YES</u>	<u>HCL</u>	<u>STL Pleasanton</u>	<u>TPH-G/BTEX/MTBE/8 Oxy's(8260)</u>

COMMENTS: _____

Add/Replaced Lock: _____

Add/Replaced Plug: _____ Size: _____



GETTLER-RYAN INC.

WELL MONITORING/SAMPLING FIELD DATA SHEET

Client/Facility #: Tosco #7124 Job Number: 180299
 Site Address: 10151 E. 14Th St. Event Date: 11-3-02 (inclusive)
 City: Oakland, CA Sampler: BC

Well ID: MW-4
 Well Diameter: 4 in.
 Total Depth: 25.44 ft.
 Depth to Water: 18.66 ft.
6.78

Well Condition: OK

Volume	3/4" = 0.02	1" = 0.04	2" = 0.17	3" = 0.38
Factor (VF)	4" = 0.66	5" = 1.02	6" = 1.50	12" = 5.80

xVF: 60 = 4 x3 (case volume) = Estimated Purge Volume: 12 gal.

Purge Equipment:

Disposable Bailer _____
 Stainless Steel Bailer _____
 Stack Pump _____
 Suction Pump _____
 Grundfos _____
 Other: _____

Sampling Equipment:

Disposable Bailer _____
 Pressure Bailer _____
 Discrete Bailer _____
 Other: _____

Time Started: _____ (2400 hrs)
 Time Bailed: _____ (2400 hrs)
 Depth to Product: _____ ft
 Depth to Water: _____ ft
 Hydrocarbon Thickness: _____ ft
 Visual Confirmation/Description: _____
 Skimmer / Absorbant Sock (circle one)
 Amt Removed from Skimmer: _____ gal
 Amt Removed from Well: _____ gal
 Product Transferred to: _____

Start Time (purge): 1157 Weather Conditions: Sunny
 Sample Time/Date: 1200 11-3-02 Water Color: Clear Odor: Gas Slight
 Purging Flow Rate: 3 gpm. Sediment Description: _____
 Did well de-water? No If yes, Time: _____ Volume: _____ gal.

Time (2400 hr.)	Volume (gal.)	pH	Conductivity (umhos/cm)	Temperature (C/F)	D.O. (mg/L)	ORP (mV)
<u>1157</u>	<u>4</u>	<u>7.24</u>	<u>527</u>	<u>20.6</u>	_____	_____
<u>1201</u>	<u>8</u>	<u>7.20</u>	<u>526</u>	<u>20.5</u>	_____	_____
<u>1202</u>	<u>12</u>	<u>7.16</u>	<u>530</u>	<u>20.9</u>	_____	_____

LABORATORY INFORMATION

SAMPLE ID	(#) CONTAINER	REFRIG.	PRESERV. TYPE	LABORATORY	ANALYSES
<u>MW-4</u>	<u>5</u> x voa vial	<u>YES</u>	<u>HCL</u>	<u>STL Pleasanton</u>	<u>TPH-G/BTEX/MTBE/8 Oxy's(8260)</u>

COMMENTS:

Add/Replaced Lock: Add/Replaced Plug: _____ Size: _____

2002-11-0061

Gettler-Ryan Inc., Chain-of-Custody

Toaco Corp./
Phillips 66 Co.
2000 Crow Canyon Place
Suite 400
San Ramon, CA 94583

Facility Number #7124
Facility Address 10151 EAST 14TH STREET, OAKLAND, CA
Global ID _____ Project 180299.80
Client Contact MR. DAVID B. DEWITT
Phone (925) 277-2384

Laboratory Name STL -- PLEASANTON, CA
Consultant GETTLER-RYAN, INC. DEANNA L. HARDING
Address 6747 SIERRA CT., SUITE J, DUBLIN CA 94568
Phone (925) 551-7555 Fax (925) 551-7899
Samples Collected by [Signature]

SAMPLE ID	Number of Containers Matrix	S = Soil A = Air W = Water C = Charcoal	Sample Preservation	Date/Time (2400 Hrs)	TPH-GAS/BTEX/MTBE EPA 8015/8021B	TPH-DIESEL EPA 8015	TPH-DIESEL w/Silica gel EPA 8015	TPH-GAS EPA 8015	TPH-GAS/BTEX/MTBE EPA 8260	OXYGENATES EPA 8260	METHANOL EPA 8015	TOTAL OIL & GREASE EPA 5520	METALS Cd, Cr, Pb, Zn, Ni	NITRATE/SULFATE/ALKALINITY EPA 300 SERIES	HWOC'S (8010) EPA 8021B	VOC'S (8240) EPA 8260	SVOC'S EPA 8270	Remarks
QA	1	X	HL	11-3-02					X	X								
MW-1	5			11/11					X	X								
MW-2	5			11/29					X	X								
MW-3	5			11/5/					X	X								
MW-4	5			12/10					X	X								

- OXYGENATES 8260
- 1 - MTBE
 - 2 - TBA
 - 3 - TAME
 - 4 - DIPE
 - 5 - ETBE
 - 6 - 1,2-DCA
 - 7 - EDB
 - 8 - ETHANOL

Relinquished By (Signature) <u>[Signature]</u>	Organization <u>G.R.</u>	Date/Time <u>11-4-02</u>	Received By (Signature) <u>[Signature]</u>	Organization <u>[Signature]</u>	Date/Time <u>11-4-02</u>	Iced Y/N <u>1605</u>
Relinquished By (Signature)	Organization	Date/Time	Received By (Signature)	Organization	Date/Time	Iced Y/N
Relinquished By (Signature)	Organization	Date/Time	Received For Laboratory By (Signature) <u>[Signature]</u>	Organization	Date/Time <u>11-4-02</u>	Iced Y/N <u>1605</u>

Turn Around Time (Circle Choice)

24 Hrs.
48 Hrs.
72 Hrs.
5 Days
10 Days

As Contracted

5.0°C

Submission#: 2002-11-0067

November 21, 2002

SEVERN

TRENT

LABORATORY

Gettler Ryan

6747 Sierra Court Suite J
Dublin, CA 94568

Attn.: Deanna Harding
Project#: 180299.80
Project: Tosco # 7124
Site: 10151 East 14th Street
Oakland, CA

RECEIVED

NOV 21 2002

GETTLER RYAN INC
GENERAL CONTRACTOR

STL San Francisco
1220 Quarry Ln
Pleasanton CA 94566

Tel.: (925) 484-1919
Fax: (925) 484-1096
www.stl-inc.com
www.chromalab.com

CA DHS ELAP#:2496

Dear Ms. Harding,

Attached is our report for your samples received on 11/04/2002 16:05

This report has been reviewed and approved for release. Reproduction of this report is permitted only in its entirety.

Please note that any unused portion of the samples will be discarded after 12/19/2002 unless you have requested otherwise.

We appreciate the opportunity to be of service to you. If you have any questions, please call me at (925) 484-1919.

You can also contact me via email. My email address is: tgranicher@stl-inc.com

Sincerely,

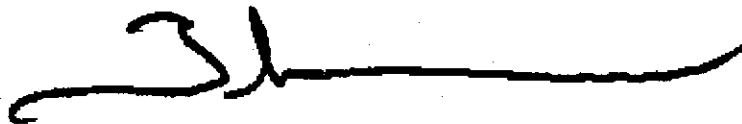

Tod Granicher
Project Manager

Submission #: 2002-11-0067

Gas/BTEX Fuel Oxygenates by 8260B

Gettler Ryan

Attn.: Deanna Harding
6747 Sierra Court Suite J
Dublin, CA 94568

Phone: (925) 551-7444 Fax: (925) 551-7899

Project: 180299.80
Tosco # 7124

Received: 11/04/2002 16:05

Site: 10151 East 14th Street
Oakland, CA

SEVERN

TRENT

LABORATORY

STL San Francisco
1220 Quarry Lane
Pleasanton, CA 94566

Tel: (925) 484-1919
Fax: (925) 484-1096
www.stl-inc.com
www.chromalab.com

CA DHS ELAP# 2496

Samples Reported

Sample Name	Date Sampled	Matrix	Lab #
QA	11/03/2002	Water	1
MW-1	11/03/2002 11:11	Water	2
MW-2	11/03/2002 11:29	Water	3
MW-3	11/03/2002 11:51	Water	4
MW-4	11/03/2002 12:10	Water	5

Submission #: 2002-11-0067

Gas/BTEX Fuel Oxygenates by 8260B

Gettler Ryan

Attn.: Deanna Harding
6747 Sierra Court Suite J
Dublin, CA 94568
Phone: (925) 551-7444 Fax: (925) 551-7899

Project: 180299.80
Tosco # 7124

Received: 11/04/2002 16:05

Site: 10151 East 14th Street
Oakland, CA

SEVERN
TRENT
LABORATORY

STL San Francisco
1220 Quarry Lane
Pleasanton, CA 94566

Tel: (925) 484-1919
Fax: (925) 484-1096
www.stl-inc.com
www.chromalab.com

CA DHS ELAP# 2496

Prep(s):	5030B	Test(s):	8260FAB
Sample ID:	QA	Lab ID:	2002-11-0067 - 1
Sampled:	11/03/2002	Extracted:	11/15/2002 09:07
Matrix:	Water	QC Batch#:	2002/11/15-01.27

Compound	Conc.	RL	Unit	Dilution	Analyzed	Flag
Gasoline	ND	50	ug/L	1.00	11/15/2002 09:07	
Benzene	ND	0.50	ug/L	1.00	11/15/2002 09:07	
Toluene	ND	0.50	ug/L	1.00	11/15/2002 09:07	
Ethylbenzene	ND	0.50	ug/L	1.00	11/15/2002 09:07	
Total xylenes	ND	1.0	ug/L	1.00	11/15/2002 09:07	
Methyl tert-butyl ether (MTBE)	ND	2.0	ug/L	1.00	11/15/2002 09:07	
Surrogates(s)						
1,2-Dichloroethane-d4	97.2	76-114	%	1.00	11/15/2002 09:07	
Toluene-d8	103.8	88-110	%	1.00	11/15/2002 09:07	

Gas/BTEX Fuel Oxygenates by 8260B

Gettler Ryan

Attn.: Deanna Harding
 6747 Sierra Court Suite J
 Dublin, CA 94568
 Phone: (925) 551-7444 Fax: (925) 551-7899

Project: 180299.80
 Tosco # 7124

Received: 11/04/2002 16:05

Site: 10151 East 14th Street
 Oakland, CA

SEVERN
TRENT
LABORATORY

STL San Francisco
 1220 Quarry Lane
 Pleasanton, CA 94566

Tel: (925) 484-1919
 Fax: (925) 484-1096
 www.stl-inc.com
 www.chromalab.com

CA DHS ELAP# 2496

Prep(s):	5030B	Test(s):	8260FAB
Sample ID:	MW-1	Lab ID:	2002-11-0067 - 2
Sampled:	11/03/2002 11:11	Extracted:	11/15/2002 09:30
Matrix:	Water	QC Batch#:	2002/11/15-01-27

Compound	Conc.	RL	Unit	Dilution	Analyzed	Flag
Gasoline	ND	50	ug/L	1.00	11/15/2002 09:30	
Benzene	ND	0.50	ug/L	1.00	11/15/2002 09:30	
Toluene	ND	0.50	ug/L	1.00	11/15/2002 09:30	
Ethylbenzene	ND	0.50	ug/L	1.00	11/15/2002 09:30	
Total xylenes	ND	1.0	ug/L	1.00	11/15/2002 09:30	
tert-Butyl alcohol (TBA)	ND	100	ug/L	1.00	11/15/2002 09:30	
Methyl tert-butyl ether (MTBE)	ND	2.0	ug/L	1.00	11/15/2002 09:30	
Di-isopropyl Ether (DIPE)	ND	2.0	ug/L	1.00	11/15/2002 09:30	
Ethyl tert-butyl ether (ETBE)	ND	2.0	ug/L	1.00	11/15/2002 09:30	
tert-Amyl methyl ether (TAME)	ND	2.0	ug/L	1.00	11/15/2002 09:30	
1,2-DCA	ND	2.0	ug/L	1.00	11/15/2002 09:30	
EDB	ND	2.0	ug/L	1.00	11/15/2002 09:30	
Ethanol	ND	500	ug/L	1.00	11/15/2002 09:30	
Surrogates(s)						
1,2-Dichloroethane-d4	100.1	76-114	%	1.00	11/15/2002 09:30	
Toluene-d8	104.0	88-110	%	1.00	11/15/2002 09:30	

Submission #: 2002-11-0067

SEVERN

TRENT

LABORATORY

Gas/BTEX Fuel Oxygenates by 8260B

Gettler Ryan

Attn.: Deanna Harding
6747 Sierra Court Suite J
Dublin, CA 94568

Phone: (925) 551-7444 Fax: (925) 551-7899

Project: 180299.80
Tosco # 7124

Received: 11/04/2002 16:05

Site: 10151 East 14'th Street
Oakland, CA

STL San Francisco
1220 Quarry Lane
Pleasanton, CA 94566

Tel: (925) 484-1919
Fax: (925) 484-1096
www.stl-inc.com
www.chromalab.com

CA DHS ELAP# 2496

Prep(s):	5030B	Test(s):	8260FAB
Sample ID:	MW-2	Lab ID:	2002-11-0067 - 3
Sampled:	11/03/2002 11:29	Extracted:	11/15/2002 09:51
Matrix:	Water	QC Batch#:	2002/11/15-01.27

Compound	Conc.	RL	Unit	Dilution	Analyzed'	Flag
Gasoline	3800	500	ug/L	10.00	11/15/2002 09:51	g
Benzene	ND	5.0	ug/L	10.00	11/15/2002 09:51	
Toluene	ND	5.0	ug/L	10.00	11/15/2002 09:51	
Ethylbenzene	ND	5.0	ug/L	10.00	11/15/2002 09:51	
Total xylenes	ND	10	ug/L	10.00	11/15/2002 09:51	
tert-Butyl alcohol (TBA)	ND	1000	ug/L	10.00	11/15/2002 09:51	
Methyl tert-butyl ether (MTBE)	72	20	ug/L	10.00	11/15/2002 09:51	
Di-isopropyl Ether (DIPE)	ND	20	ug/L	10.00	11/15/2002 09:51	
Ethyl tert-butyl ether (ETBE)	ND	20	ug/L	10.00	11/15/2002 09:51	
tert-Amyl methyl ether (TAME)	ND	20	ug/L	10.00	11/15/2002 09:51	
1,2-DCA	ND	20	ug/L	10.00	11/15/2002 09:51	
EDB	ND	20	ug/L	10.00	11/15/2002 09:51	
Ethanol	ND	5000	ug/L	10.00	11/15/2002 09:51	
Surrogates(s)						
1,2-Dichloroethane-d4	93.4	76-114	%	10.00	11/15/2002 09:51	
Toluene-d8	105.4	88-110	%	10.00	11/15/2002 09:51	

Submission #: 2002-11-0067

Gas/BTEX Fuel Oxygenates by 8260B

Gettler Ryan

Attn.: Deanna Harding
6747 Sierra Court Suite J
Dublin, CA 94568
Phone: (925) 551-7444 Fax: (925) 551-7899

Project: 180299.80
Tosco # 7124

Received: 11/04/2002 16:05

Site: 10151 East 14th Street
Oakland, CA

SEVERN
TRENT
LABORATORY

STL San Francisco
1220 Quarry Lane
Pleasanton, CA 94566

Tel: (925) 484-1919
Fax: (925) 484-1096
www.stl-inc.com
www.chromalab.com

CA DHS ELAP# 2496

Prep(s):	5030B	Test(s):	8260FAB
Sample ID:	MW-3	Lab ID:	2002-11-0067 - 4
Sampled:	11/03/2002 11:51	Extracted:	11/15/2002 10:13
Matrix:	Water	QC Batch#:	2002/11/15-01-27

Compound	Conc.	RL	Unit	Dilution	Analyzed	Flag
Gasoline	25000	500	ug/L	10.00	11/15/2002 10:13	g
Benzene	ND	5.0	ug/L	10.00	11/15/2002 10:13	
Toluene	ND	5.0	ug/L	10.00	11/15/2002 10:13	
Ethylbenzene	25	5.0	ug/L	10.00	11/15/2002 10:13	
Total xylenes	ND	10	ug/L	10.00	11/15/2002 10:13	
tert-Butyl alcohol (TBA)	ND	1000	ug/L	10.00	11/15/2002 10:13	
Methyl tert-butyl ether (MTBE)	470	20	ug/L	10.00	11/15/2002 10:13	
Di-isopropyl Ether (DIPE)	ND	20	ug/L	10.00	11/15/2002 10:13	
Ethyl tert-butyl ether (ETBE)	ND	20	ug/L	10.00	11/15/2002 10:13	
tert-Amyl methyl ether (TAME)	ND	20	ug/L	10.00	11/15/2002 10:13	
1,2-DCA	ND	20	ug/L	10.00	11/15/2002 10:13	
EDB	ND	20	ug/L	10.00	11/15/2002 10:13	
Ethanol	ND	5000	ug/L	10.00	11/15/2002 10:13	
Surrogates(s)						
1,2-Dichloroethane-d4	93.8	76-114	%	10.00	11/15/2002 10:13	
Toluene-d8	103.4	88-110	%	10.00	11/15/2002 10:13	

Submission #: 2002-11-0067

Gas/BTEX Fuel Oxygenates by 8260B

Gettler Ryan

Attn.: Deanna Harding
6747 Sierra Court Suite J
Dublin, CA 94568
Phone: (925) 551-7444 Fax: (925) 551-7899

Project: 180299.80
Tosco # 7124

Received: 11/04/2002 16:05

Site: 10151 East 14th Street
Oakland, CA

SEVERN
TRENT
LABORATORY

STL San Francisco
1220 Quarry Lane
Pleasanton, CA 94566

Tel: (925) 484-1919
Fax: (925) 484-1096
www.stl-inc.com
www.chromalab.com

CA DHS ELAP# 2496

Prep(s):	5030B	Test(s):	8260FAB
Sample ID:	MW-4	Lab ID:	2002-11-0067 - 5
Sampled:	11/03/2002 12:10	Extracted:	11/15/2002 16:42
Matrix:	Water	QC Batch#:	2002/11/15-01.27

Compound	Conc.	RL	Unit	Dilution	Analyzed	Flag
Gasoline	220	50	ug/L	1.00	11/15/2002 16:42	g
Benzene	ND	0.50	ug/L	1.00	11/15/2002 16:42	
Toluene	ND	0.50	ug/L	1.00	11/15/2002 16:42	
Ethylbenzene	ND	0.50	ug/L	1.00	11/15/2002 16:42	
Total xylenes	ND	1.0	ug/L	1.00	11/15/2002 16:42	
tert-Butyl alcohol (TBA)	ND	100	ug/L	1.00	11/15/2002 16:42	
Methyl tert-butyl ether (MTBE)	5.7	2.0	ug/L	1.00	11/15/2002 16:42	
Di-isopropyl Ether (DIPE)	ND	2.0	ug/L	1.00	11/15/2002 16:42	
Ethyl tert-butyl ether (ETBE)	ND	2.0	ug/L	1.00	11/15/2002 16:42	
tert-Amyl methyl ether (TAME)	ND	2.0	ug/L	1.00	11/15/2002 16:42	
1,2-DCA	ND	2.0	ug/L	1.00	11/15/2002 16:42	
EDB	ND	2.0	ug/L	1.00	11/15/2002 16:42	
Ethanol	ND	500	ug/L	1.00	11/15/2002 16:42	
Surrogates(s)						
1,2-Dichloroethane-d4	96.8	76-114	%	1.00	11/15/2002 16:42	
Toluene-d8	108.7	88-110	%	1.00	11/15/2002 16:42	

Submission #: 2002-11-0067

Gas/BTEX Fuel Oxygenates by 8260B

Gettler Ryan

Attn.: Deanna Harding
6747 Sierra Court Suite J
Dublin, CA 94568
Phone: (925) 551-7444 Fax: (925) 551-7899

Project: 180299.80
Tosco # 7124

Received: 11/04/2002 16:05

Site: 10151 East 14'th Street
Oakland, CA

SEVERN
TRENT
LABORATORY

STL San Francisco
1220 Quarry Lane
Pleasanton, CA 94566

Tel: (925) 484-1919
Fax: (925) 484-1096
www.stl-inc.com
www.chromalab.com

CA DHS ELAP# 2496

Batch QC Report

Prep(s): 5030B

Method Blank

MB: 2002/11/15-01.27-006

Water

Test(s): 8260FAB

QC Batch # 2002/11/15-01.27

Date Extracted: 11/15/2002 07:37

Compound	Conc.	RL	Unit	Analyzed	Flag
Gasoline	ND	50	ug/L	11/15/2002 07:37	
Benzene	ND	0.5	ug/L	11/15/2002 07:37	
Toluene	ND	0.5	ug/L	11/15/2002 07:37	
Ethylbenzene	ND	0.5	ug/L	11/15/2002 07:37	
Total xylenes	ND	1.0	ug/L	11/15/2002 07:37	
tert-Butyl alcohol (TBA)	ND	100	ug/L	11/15/2002 07:37	
Methyl tert-butyl ether (MTBE)	ND	2.0	ug/L	11/15/2002 07:37	
Di-isopropyl Ether (DIPE)	ND	2.0	ug/L	11/15/2002 07:37	
Ethyl tert-butyl ether (ETBE)	ND	2.0	ug/L	11/15/2002 07:37	
tert-Amyl methyl ether (TAME)	ND	2.0	ug/L	11/15/2002 07:37	
1,2-DCA	ND	2.0	ug/L	11/15/2002 07:37	
EDB	ND	2.0	ug/L	11/15/2002 07:37	
Ethanol	ND	500	ug/L	11/15/2002 07:37	
Surrogates(s)					
1,2-Dichloroethane-d4	94.2	76-114	%	11/15/2002 07:37	
Toluene-d8	100.8	88-110	%	11/15/2002 07:37	

Gas/BTEX Fuel Oxygenates by 8260B

Gettler Ryan

Attn.: Deanna Harding
6747 Sierra Court Suite J
Dublin, CA 94568

Phone: (925) 551-7444 Fax: (925) 551-7899

Project: 180299.80
Tosco # 7124

Received: 11/04/2002 16:05

Site: 10151 East 14th Street
Oakland, CA

STL San Francisco
1220 Quarry Lane
Pleasanton, CA 94566

Tel: (925) 484-1919
Fax: (925) 484-1096
www.stl-inc.com
www.chromalab.com

CA DHS ELAP# 2496

Batch QC Report

Prep(s): 5030B

Test(s): 8260FAB

Laboratory Control Spike

Water

QC Batch # 2002/11/15-01.27

LCS 2002/11/15-01.27-003

Extracted: 11/15/2002

Analyzed: 11/15/2002 06:44

LCSD 2002/11/15-01.27-004

Extracted: 11/15/2002

Analyzed: 11/15/2002 07:13

Compound	Conc. ug/L		Exp.Conc.	Recovery		RPD	Ctrl.Limits %		Flags	
	LCS	LCSD		LCS	LCSD		%	Rec.	RPD	LCS
Benzene	20.7	21.0	25.0	82.8	84.0	1.4	69-129	20		
Toluene	22.9	23.0	25.0	91.6	92.0	0.4	70-130	20		
Methyl tert-butyl ether (MTBE)	24.5	20.5	25.0	98.0	82.0	17.8	65-165	20		
Surrogates(s)										
1,2-Dichloroethane-d4	468	465	500	93.6	93.0		76-114			
Toluene-d8	491	492	500	98.2	98.4		88-110			

Submission #: 2002-11-0067

Gas/BTEX Fuel Oxygenates by 8260B

Gettler Ryan

Attn.: Deanna Harding
6747 Sierra Court Suite J
Dublin, CA 94568

Phone: (925) 551-7444 Fax: (925) 551-7899

Project: 180299.80
Tosco # 7124

Received: 11/04/2002 16:05

Site: 10151 East 14th Street
Oakland, CA

SEVERN

TRENT

LABORATORY

STL San Francisco
1220 Quarry Lane
Pleasanton, CA 94566

Tel: (925) 484-1919
Fax: (925) 484-1096
www.stl-inc.com
www.chromalab.com

CA DHS ELAP# 2496

Legend and Notes

Result Flag

g

Hydrocarbon reported in the gasoline range does not match our gasoline standard.