



**CONESTOGA-ROVERS
& ASSOCIATES**

5900 Hollis Street, Suite A
Emeryville, California 94608
Telephone: (510) 420-0700 Fax: (510) 420-9170
www.CRAworld.com

TRANSMITTAL

DATE: January 8, 2009 REFERENCE NO.: 240735
PROJECT NAME: 9750 Golf Links Road, Oakland

TO: Jerry Wickham
Alameda County Health Care Services Agency
1131 Harbor Bay Parkway, Suite 250
Alameda, California 94502-6577

RECEIVED

2:34 pm, Jan 08, 2009

Alameda County
Environmental Health

Please find enclosed: Draft Final
 Originals Other
 Prints

Sent via: Mail Same Day Courier
 Overnight Courier Other

QUANTITY	DESCRIPTION
1	Groundwater Monitoring Report - Fourth Quarter 2008

As Requested For Review and Comment
 For Your Use _____

COMMENTS:
If you have any questions regarding the contents of this document, please call Peter Schaefer at (510) 420-3319.

Copy to: Denis Brown
SF Data Room

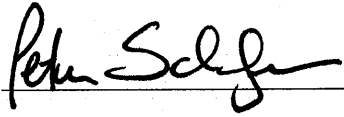
Completed by: Peter Schaefer [Please Print] Signed: 

Filing: **Correspondence File**



Jerry Wickham
Alameda County Health Care Services Agency
1131 Harbor Bay Parkway, Suite 250
Alameda, California 94502-6577

Denis L. Brown
Shell Oil Products US
HSE - Environmental Services
20945 S. Wilmington Ave.
Carson, CA 90810-1039
Tel (707) 865 0251
Fax (707) 865 2542
Email denis.l.brown@shell.com

Re: Shell-branded Service Station
9750 Golf Links Road
Oakland, California
SAP Code 135683
Incident No. 98995744
ACHCSA Case No. RO0002441

Dear Mr. Wickham:

The attached document is provided for your review and comment. Upon information and belief, I declare, under penalty of perjury, that the information contained in the attached document is true and correct.

If you have any questions or concerns, please call me at (707) 865-0251.

Sincerely,

A handwritten signature in cursive script, appearing to read "Denis L. Brown", is written over a horizontal line.

Denis L. Brown
Project Manager



GROUNDWATER MONITORING REPORT - FOURTH QUARTER 2008

**SHELL-BRANDED SERVICE STATION
9750 GOLF LINKS ROAD
OAKLAND, CALIFORNIA**

**SAP CODE 135683
INCIDENT NO. 98995744
AGENCY NO. RO0002441**

**JANUARY 8, 2009
REF. NO. 240735 (2)**
This report is printed on recycled paper.

**Prepared by:
Conestoga-Rovers
& Associates**

5900 Hollis Street, Suite A
Emeryville, California
U.S.A. 94608

Office: (510) 420-0700
Fax: (510) 420-9170

web: <http://www.CRAworld.com>

TABLE OF CONTENTS

	<u>Page</u>
1.0 INTRODUCTION.....	1
1.1 SITE INFORMATION	1
2.0 SITE ACTIVITIES, FINDINGS, AND DISCUSSION.....	2
2.1 CURRENT QUARTER'S ACTIVITIES.....	2
2.2 CURRENT QUARTER'S FINDINGS	2
2.3 PROPOSED ACTIVITIES FOR NEXT QUARTER	2

LIST OF FIGURES
(Following Text)

FIGURE 1 VICINITY MAP

FIGURE 2 GROUNDWATER CONTOUR AND CHEMICAL CONCENTRATION MAP

LIST OF APPENDICES

APPENDIX A BLAINE TECH SERVICES, INC. - GROUNDWATER MONITORING
REPORT

1.0 INTRODUCTION

Conestoga-Rovers & Associates (CRA) prepared this report on behalf of Equilon Enterprises LLC dba Shell Oil Products US (Shell) in accordance with the quarterly reporting requirements of 23 CCR 2652d.

1.1 SITE INFORMATION

Site Address	9750 Golf Links Road, Oakland
Site Use	Shell-branded Service Station
Shell Project Manager	Denis Brown
CRA Project Manager	Peter Schaefer
Lead Agency and Contact	ACHCSA, Jerry Wickham
Agency Case No.	RO0002441
Shell SAP Code	135683
Shell Incident No.	98995744

Date of most recent agency correspondence was August 8, 2008 (electronic).

2.0 SITE ACTIVITIES, FINDINGS, AND DISCUSSION

2.1 CURRENT QUARTER'S ACTIVITIES

Blaine Tech Services, Inc. (Blaine) gauged and sampled the wells according to the established monitoring program for this site.

CRA prepared a vicinity map (Figure 1) and a groundwater contour and chemical concentration map (Figure 2). Blaine's report, presenting the analytical data, is included in Appendix A.

2.2 CURRENT QUARTER'S FINDINGS

Groundwater Flow Direction	Northwesterly to westerly
Hydraulic Gradient	0.11
Depth to Water	5.41 to 10.38 feet below top of well casing

2.3 PROPOSED ACTIVITIES FOR NEXT QUARTER

Blaine will gauge and sample wells according to the established monitoring program for this site.

All of Which is Respectfully Submitted,
CONESTOGA-ROVERS & ASSOCIATES



Peter Schaefer, CHG, CEG
Project Manager

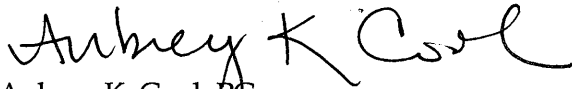

Aubrey K. Cool, PG
Professional Geologist

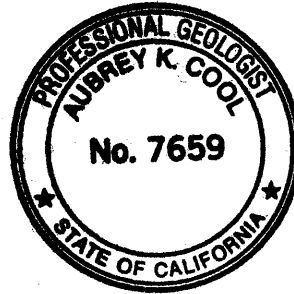

FIGURES

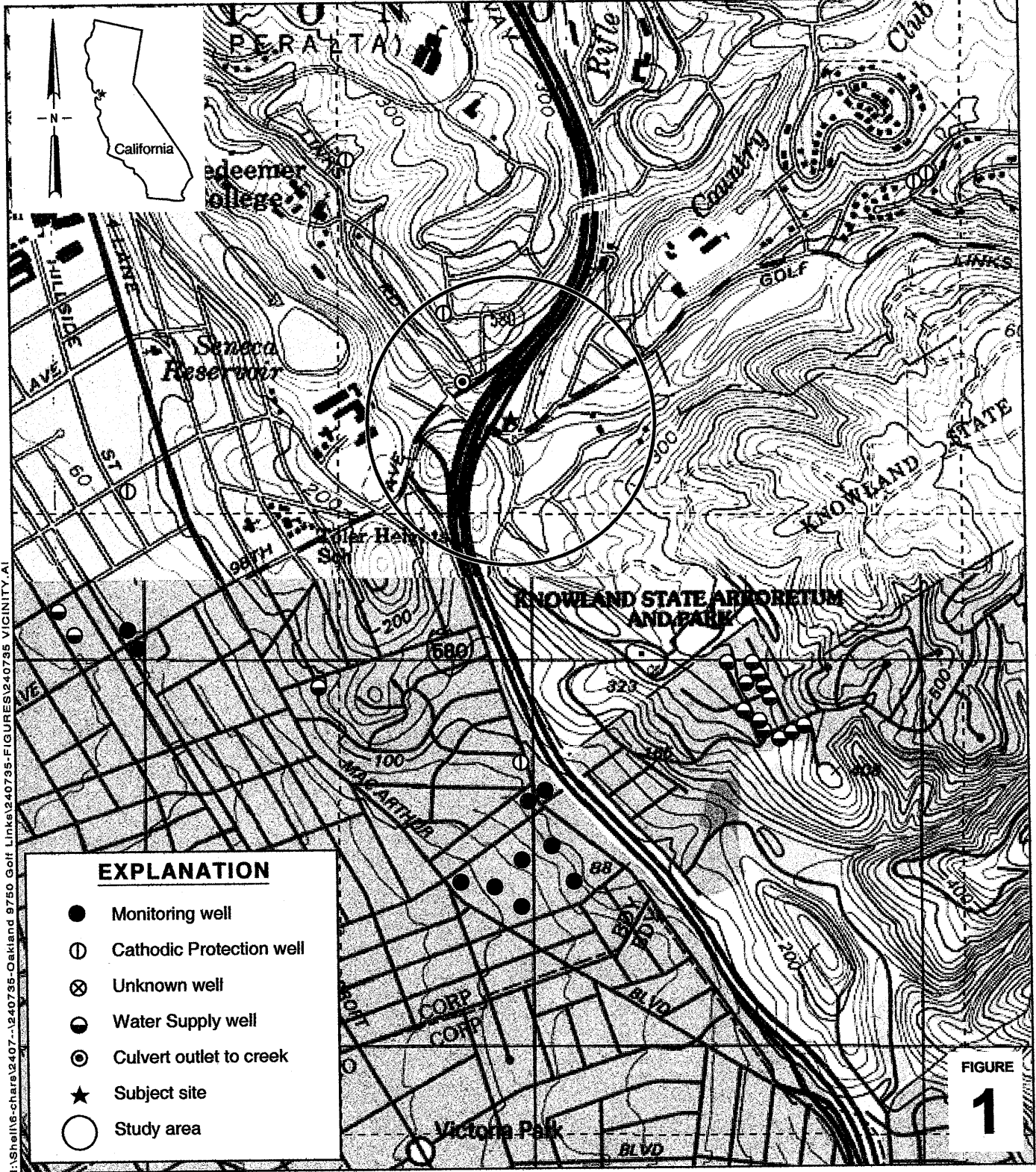

I:\Shell\c-hars\2407--\240795-Oakland 9750 Golf Links\240795-FIGURES\240795 VICINITY.A1

Shell-branded Service Station
 9750 Golf Links Road
 Oakland, California



**CONESTOGA-ROVERS
 & ASSOCIATES**

Vicinity Map

EXPLANATION

- S-1 ● Monitoring well location
- S-3 ⊗ Attempted monitoring well location
- STM --- Storm drain line (STM)
- Former storm drain line
- SAN --- Sanitary sewer line (SAN)
- E --- Electrical line (E)
- W --- Water line (W)
- ▶ Flow direction
- ▶ Groundwater flow direction and gradient
- XX.XX Groundwater elevation contour, in feet above mean sea level (msl)

Well	ELEV	Benzene	MTBE
S-1	153.03	ND	4.5
S-2	154.62	ND	1.4
S-3	149.00	ND	4.3
S-4	147.85	ND	4.3
S-5	152.38	0.53	38

Notes:
ND = Not detected

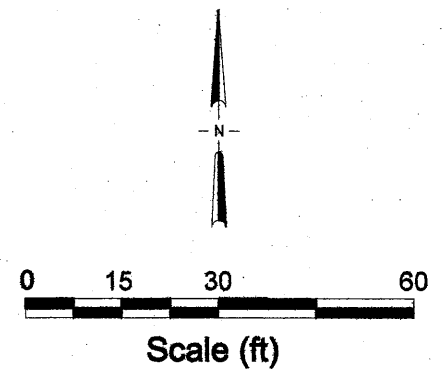
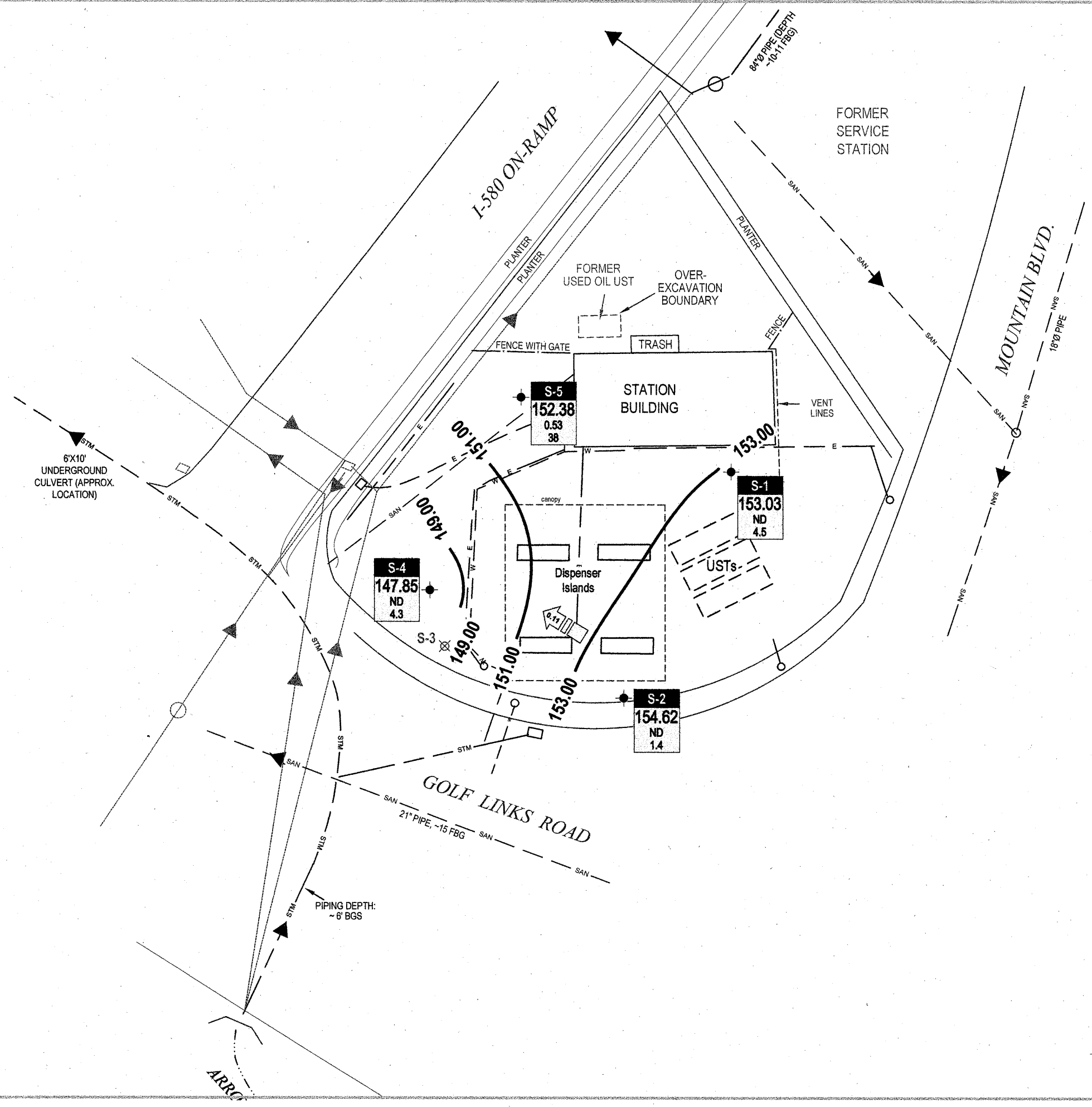

FIGURE
2

**Groundwater Contour and
Chemical Concentration Map**

December 22, 2008



**CONESTOGA-ROVERS
& ASSOCIATES**

Shell-branded Service Station

9750 Golf Links Road
Oakland, California

I:\Shell\6-chars\240735-240735-Oakland 9750 Golf Links\240735-REPORT\13\240735-RPT2-4c08\240735_40M08.DWG

APPENDIX A

BLAINE TECH SERVICES, INC. -
GROUNDWATER MONITORING REPORT

BLAINE

TECH SERVICES INC.

GROUNDWATER SAMPLING SPECIALISTS
SINCE 1985

January 6, 2009

Denis Brown
Shell Oil Products US
20945 South Wilmington Avenue
Carson, CA 90810

Fourth Quarter 2008 Groundwater Monitoring at
Shell-branded Service Station
9750 Golf Links Road
Oakland, CA

Monitoring performed on December 22, 2008

Groundwater Monitoring Report **081222-JP-2**

This report covers the routine monitoring of groundwater wells at this Shell-branded facility. In accordance with standard procedures that conform to Regional Water Quality Control Board requirements, routine field data collection includes depth to water, total well depth, thickness of any separate immiscible layer, water column volume, calculated purge volume (if applicable), elapsed evacuation time (if applicable), total volume of water removed (if applicable), and standard water parameter instrument readings. Sample material is collected, contained, stored, and transported to the laboratory in conformance with EPA standards. Purge water (if applicable) is, likewise, collected and transported to the Martinez Refining Company.

Basic field information is presented alongside analytical values excerpted from the laboratory report in the cumulative table of **WELL CONCENTRATIONS**. The full analytical report for the most recent samples and the field data sheets are attached to this report.

At a minimum, Blaine Tech Services, Inc. field personnel are certified on completion of a forty-hour Hazardous Materials and Emergency Response training course per 29 CFR 1910.120. Field personnel are also enrolled in annual eight-hour refresher courses.

Blaine Tech Services, Inc. conducts sampling and documentation assignments of this type as an independent third party. Our activities at this site consisted of objective data and sample collection only. No interpretation of analytical results, defining of hydrological conditions or formulation of recommendations was performed.

Please call if you have any questions.

Yours truly,

Mike Ninokata
Project Manager

MN/jb

attachments: Cumulative Table of WELL CONCENTRATIONS
Certified Analytical Report
Field Data Sheets

cc: Anni Kreml
Conestoga-Rovers & Associates
5900 Hollis Street, Suite A
Emeryville, CA 94608

WELL CONCENTRATIONS
Shell-branded Service Station
9750 Golf Links Road
Oakland, CA

Well ID	Date	TPPH (ug/L)	B (ug/L)	T (ug/L)	E (ug/L)	X (ug/L)	MTBE 8260 (ug/L)	DIPE (ug/L)	ETBE (ug/L)	TAME (ug/L)	TBA (ug/L)	1,2- DCA (ug/L)	EDB (ug/L)	Ethanol (ug/L)	Methanol (ug/L)	TOC (MSL)	Depth to Water (ft.)	GW Elevation (MSL)
---------	------	----------------	-------------	-------------	-------------	-------------	------------------------	----------------	----------------	----------------	---------------	-----------------------	---------------	-------------------	--------------------	--------------	----------------------------	--------------------------

S-1	03/09/2005	NA	NA	NA	NA	NA	NA	NA	NA	NA	NA	NA	NA	NA	NA	160.54	7.65	152.89
S-1	03/23/2005	13,000	<13	<13	89	70	1,400	<50	<50	<50	460	<13	<13	<1,300	<500	160.54	7.62	152.92
S-1	06/16/2005	9,500	<5.0	<5.0	130	66	860	<20	<20	<20	780	<5.0	<5.0	<500	2,800	160.54	7.91	152.63
S-1	08/02/2005	NA	NA	NA	NA	NA	NA	NA	NA	NA	NA	NA	NA	NA	<500	160.54	8.44	152.10
S-1	08/29/2005	1,300 a	<5.0	<5.0	<5.0	<10	1,300	<20	<20	<20	1,600	<5.0	<5.0	<500	<500	160.54	8.88	151.66
S-1	12/15/2005	3,710	<0.500	<0.500	8.28	<0.500	65.4	<0.500	<0.500	<0.500	847	<0.500	<0.500	<50.0	<10,000	160.54	8.55	151.99
S-1	03/08/2006	2,400 h	1.3	<0.50	6.9	3.8	61 f	<0.50	<0.50 i	<0.50 i	250	<0.50 i	<0.50	<100	<250 d	160.54	7.25	153.29
S-1	06/14/2006	1,300	1.5	<1.0	2.3	<1.0	77	NA	NA	<1.0	400	NA	NA	NA	NA	160.54	8.29	152.25
S-1	09/06/2006	700 k	<1.0 k	<1.0 k	1.7 k	<1.0 k	42 k	<1.0 k	<1.0 k	<1.0 k	630 k	NA	NA	NA	<400 j	160.54	8.92	151.62
S-1	12/27/2006	1,500	<0.50	<0.50	2.2	0.60	15	NA	NA	<0.50	130	NA	NA	NA	NA	160.54	7.40	153.14
S-1	03/19/2007	2,300	<0.50	<0.50	1.4	0.81	13	NA	NA	<0.50	130	NA	NA	NA	NA	160.54	7.91	152.63
S-1	06/19/2007	1,900 l,m	0.20 n	<1.0	0.86 n	0.19 n	12	NA	NA	<2.0	200	NA	NA	NA	NA	160.54	8.30	152.24
S-1	09/12/2007	720 l,m	0.19 n	<1.0	<1.0	<1.0	26	<2.0	<2.0	<2.0	130	NA	NA	NA	<100 i	160.54	8.80	151.74
S-1	12/10/2007	1,100 l	<0.50	<1.0	0.33 n	0.22 n	6.4	NA	NA	<2.0	110	NA	NA	NA	NA	160.54	8.07	152.47
S-1	02/27/2008	2,800 l,m	<0.50	<1.0	<1.0	<1.0	16	NA	NA	<2.0	110	NA	NA	NA	NA	160.54	7.58	152.96
S-1	05/28/2008	680	<0.50	<1.0	<1.0	<1.0	6.7	NA	NA	<2.0	56	NA	NA	NA	NA	160.54	8.60	151.94
S-1	08/29/2008	110	<0.50	<1.0	<1.0	<1.0	5.3	<2.0	<2.0	<2.0	69	NA	NA	NA	<100 i	160.54	11.04	149.50
S-1	12/22/2008	1,100	<0.50	<1.0	<1.0	<1.0	4.5	NA	NA	<2.0	47	NA	NA	NA	NA	160.54	7.51	153.03

S-2	03/09/2005	NA	NA	NA	NA	NA	NA	NA	NA	NA	NA	NA	NA	NA	NA	160.23	5.64	154.59
S-2	03/23/2005	<50	<0.50	<0.50	<0.50	<1.0	5.3	<2.0	<2.0	<2.0	<5.0	<0.50	<0.50	<50	<500	160.23	5.20	155.03
S-2	06/16/2005	<50	<0.50	<0.50	<0.50	<1.0	2.2	<2.0	<2.0	<2.0	<5.0	<0.50	<0.50	<50	<500	160.23	5.94	154.29
S-2	08/29/2005	<50	<0.50	<0.50	<0.50	<1.0	2.7	<2.0	<2.0	<2.0	<5.0	<0.50	<0.50	<50	<500	160.23	6.56	153.67
S-2	12/15/2005	<50.0	<0.500	<0.500 c	<0.500	<0.500	17.9	<0.500	<0.500	<0.500	58.4	<0.500	<0.500	<50.0	<10,000	160.03 b	5.77	154.26
S-2	03/08/2006	<50 f	<0.50	<0.50	<0.50	<0.50	2.5 f	<0.50	<0.50 i	<0.50 i	20	<0.50 i	<0.50	<100	<100	160.03 b	5.10	154.93
S-2	06/14/2006	<50	<0.50	<0.50	<0.50	<0.50	2.8	NA	NA	<0.50	<20	NA	NA	NA	NA	160.03 b	6.00	154.03
S-2	09/06/2006	<50 k	<0.50 k	<0.50 k	<0.50 k	<0.50 k	4.9 k	<0.50 k	<0.50 k	<0.50 k	<20 k	NA	NA	NA	<100	160.03 b	6.49	153.54
S-2	12/27/2006	<50	<0.50	<0.50	<0.50	<0.50	2.0	NA	NA	<0.50	<20	NA	NA	NA	NA	160.03 b	5.50	154.53

WELL CONCENTRATIONS
Shell-branded Service Station
9750 Golf Links Road
Oakland, CA

Well ID	Date	TPPH (ug/L)	B (ug/L)	T (ug/L)	E (ug/L)	X (ug/L)	MTBE 8260 (ug/L)	DIPE (ug/L)	ETBE (ug/L)	TAME (ug/L)	TBA (ug/L)	1,2- DCA (ug/L)	EDB (ug/L)	Ethanol (ug/L)	Methanol (ug/L)	TOC (MSL)	Depth to Water (ft.)	GW Elevation (MSL)
S-2	03/19/2007	<50	<0.50	<0.50	<0.50	<0.50	2.3	NA	NA	<0.50	<20	NA	NA	NA	NA	160.03 b	5.70	154.33
S-2	06/19/2007	<50 l	<0.50	<1.0	<1.0	<1.0	1.1	NA	NA	<2.0	<10	NA	NA	NA	NA	160.03 b	6.19	153.84
S-2	09/12/2007	<50 l	<0.50	<1.0	<1.0	<1.0	2.7	<2.0	<2.0	<2.0	<10	NA	NA	NA	<100 l	160.03 b	6.57	153.46
S-2	12/10/2007	<50 l	<0.50	<1.0	<1.0	<1.0	3.3	NA	NA	<2.0	<10	NA	NA	NA	NA	160.03 b	5.70	154.33
S-2	02/27/2008	<50 l	<0.50	<1.0	<1.0	<1.0	<1.0	NA	NA	<2.0	<10	NA	NA	NA	NA	160.03 b	5.48	154.55
S-2	05/28/2008	<50	<0.50	<1.0	<1.0	<1.0	<1.0	NA	NA	<2.0	<10	NA	NA	NA	NA	160.03 b	6.30	153.73
S-2	08/29/2008	<50	<0.50	<1.0	<1.0	<1.0	3.4	<2.0	<2.0	<2.0	<10	NA	NA	NA	<100 l	160.03 b	8.58	151.45
S-2	12/22/2008	<50	<0.50	<1.0	<1.0	<1.0	1.4	NA	NA	<2.0	<10	NA	NA	NA	NA	160.03 b	5.41	154.62
S-4	03/09/2005	NA	NA	NA	NA	NA	NA	NA	NA	NA	NA	NA	NA	NA	NA	158.23	9.83	148.40
S-4	03/23/2005	<100	<1.0	<1.0	<1.0	<2.0	260	<4.0	<4.0	<4.0	<10	<1.0	<1.0	<100	<500	158.23	9.55	148.68
S-4	06/16/2005	<50	<0.50	<0.50	<0.50	<1.0	8.0	<2.0	<2.0	<2.0	<5.0	<0.50	<0.50	<50	<500	158.23	10.25	147.98
S-4	08/29/2005	<50	<0.50	<0.50	<0.50	<1.0	71	<2.0	<2.0	<2.0	5.6	<0.50	<0.50	<50	<500	158.23	10.60	147.63
S-4	12/15/2005	345	<0.500	<0.500 c	<0.500	<0.500	296	<0.500	<0.500	<0.500	<10.0	<0.500	<0.500	<50.0	<10,000	158.23	10.38	147.85
S-4	03/08/2006	73 g	<0.50	<0.50	<0.50	<0.50	0.72 f	<0.50	<0.50 i	<0.50 i	<20	<0.50 i	<0.50	<100	<100	158.23	9.60	148.63
S-4	06/14/2006	<50	<0.50	<0.50	<0.50	0.51	0.50	NA	NA	<0.50	<20	NA	NA	NA	NA	158.23	10.30	147.93
S-4	09/06/2006	<50 k	<0.50 k	<0.50 k	<0.50 k	<0.50 k	3.6 k	<0.50 k	<0.50 k	<0.50 k	<20 k	NA	NA	NA	<100	158.23	10.57	147.66
S-4	12/27/2006	<50	<0.50	<0.50	<0.50	<0.50	4.7	NA	NA	<0.50	<20	NA	NA	NA	NA	158.23	10.40	147.83
S-4	03/19/2007	<50	<0.50	<0.50	<0.50	<0.50	<0.50	NA	NA	<0.50	<20	NA	NA	NA	NA	158.23	10.43	147.80
S-4	06/19/2007	93 l,m	<0.50	<1.0	<1.0	<1.0	8.4	NA	NA	<2.0	<10	NA	NA	NA	NA	158.23	10.52	147.71
S-4	09/12/2007	<50 l	<0.50	<1.0	<1.0	<1.0	3.7	<2.0	<2.0	<2.0	<10	NA	NA	NA	<100 l	158.23	10.71	147.52
S-4	12/10/2007	<50 l	<0.50	<1.0	<1.0	<1.0	1.7	NA	NA	<2.0	<10	NA	NA	NA	NA	158.23	10.66	147.57
S-4	02/27/2008	<50 l	<0.50	<1.0	<1.0	<1.0	<1.0	NA	NA	<2.0	<10	NA	NA	NA	NA	158.23	10.12	148.11
S-4	05/28/2008	<50	<0.50	<1.0	<1.0	<1.0	<1.0	NA	NA	<2.0	<10	NA	NA	NA	NA	158.23	10.99	147.24
S-4	08/29/2008	<50	<0.50	<1.0	<1.0	<1.0	5.4	<2.0	<2.0	<2.0	<10	NA	NA	NA	<100 l	158.23	11.13	147.10
S-4	12/22/2008	<50	<0.50	<1.0	<1.0	<1.0	4.3	NA	NA	<2.0	<10	NA	NA	NA	NA	158.23	10.38	147.85
S-5	03/09/2005	NA	NA	NA	NA	NA	NA	NA	NA	NA	NA	NA	NA	NA	NA	159.69	10.62	149.07

WELL CONCENTRATIONS
Shell-branded Service Station
9750 Golf Links Road
Oakland, CA

Well ID	Date	TPPH (ug/L)	B (ug/L)	T (ug/L)	E (ug/L)	X (ug/L)	MTBE 8260 (ug/L)	DIPE (ug/L)	ETBE (ug/L)	TAME (ug/L)	TBA (ug/L)	1,2- DCA (ug/L)	EDB (ug/L)	Ethanol (ug/L)	Methanol (ug/L)	TOC (MSL)	Depth to Water (ft.)	GW Elevation (MSL)
S-5	03/23/2005	<1,300	13	<13	26	60	2,800	<50	<50	<50	<130	<13	<13	<1,300	<500	159.69	11.49	148.20
S-5	06/16/2005	<1,300	45	<13	53	<25	2,300	<50	<50	<50	380	<13	<13	<1,300	<500	159.69	10.30	149.39
S-5	08/29/2005	<1,300	31	<13	60	<25	1,700	<50	<50	<50	320	<13	<13	<1,300	<500	159.69	10.70	148.99
S-5	12/15/2005	2,700	11.1	2.31 c	80.2	6.62	823	<0.500	<0.500	<0.500	233	<0.500	<0.500	<50.0	<10,000	159.69	11.20	148.49
S-5	03/08/2006	360 g	<0.50	<0.50	<0.50	<0.50	340 e	<0.50	<0.50 i	1.2 i	49	<0.50 i	<0.50	<100	<250 d	159.69	10.05	149.64
S-5	06/14/2006	510	<5.0	<5.0	<5.0	<5.0	720	NA	NA	<5.0	<200	NA	NA	NA	NA	159.69	10.20	149.49
S-5	09/06/2006	1,100 k	8.6 k	<5.0 k	35 k	<5.0 k	830 k	<5.0 k	<5.0 k	<5.0 k	240 k	NA	NA	NA	<200 j	159.69	10.65	149.04
S-5	12/27/2006	1,000	12	<5.0	38	6.2	510.0	NA	NA	<5.0	<200	NA	NA	NA	NA	159.69	10.42	149.27
S-5	03/19/2007	1,200	18	<10	31	<10	540	NA	NA	<10	<400	NA	NA	NA	NA	159.69	10.20	149.49
S-5	06/19/2007	840 l	0.34 n	<1.0	0.78 n	<1.0	25	NA	NA	<2.0	9.6 n	NA	NA	NA	NA	159.69	10.08	149.61
S-5	09/12/2007	520 l	14	0.46 n	4.7	<1.0	420	<2.0	<2.0	1.1 n	150	NA	NA	NA	<100 l	159.69	10.90	148.79
S-5	12/10/2007	430 l	15	<5.0	9.2	<5.0	390	NA	NA	<10	270	NA	NA	NA	NA	159.69	10.93	148.76
S-5	02/27/2008	120 l	0.93	<1.0	4.6	<1.0	21	NA	NA	<2.0	24	NA	NA	NA	NA	159.69	7.55	152.14
S-5	05/28/2008	310	4.0	1.0	7.4	1.0	85	NA	NA	<2.0	110	NA	NA	NA	NA	159.69	10.30	149.39
S-5	08/29/2008	390	6.6	<1.0	3.2	<1.0	110	<2.0	<2.0	<2.0	140	NA	NA	NA	<100 l	159.69	10.80	148.89
S-5	12/22/2008	130	0.53	<1.0	<1.0	<1.0	38	NA	NA	<2.0	180	NA	NA	NA	NA	159.69	7.31	152.38

WELL CONCENTRATIONS
Shell-branded Service Station
9750 Golf Links Road
Oakland, CA

Well ID	Date	TPPH (ug/L)	B (ug/L)	T (ug/L)	E (ug/L)	X (ug/L)	MTBE 8260 (ug/L)	DIPE (ug/L)	ETBE (ug/L)	TAME (ug/L)	TBA (ug/L)	1,2- DCA (ug/L)	EDB (ug/L)	Ethanol (ug/L)	Methanol (ug/L)	TOC (MSL)	Depth to Water (ft.)	GW Elevation (MSL)
---------	------	----------------	-------------	-------------	-------------	-------------	------------------------	----------------	----------------	----------------	---------------	-----------------------	---------------	-------------------	--------------------	--------------	----------------------------	--------------------------

Abbreviations:

TPPH = Total petroleum hydrocarbons as gasoline by EPA Method 8260B.

BTEX = Benzene, toluene, ethylbenzene, xylenes by EPA Method 8260B.

MTBE = Methyl tertiary butyl ether

DIPE = Di-isopropyl ether, analyzed by EPA Method 8260

ETBE = Ethyl tertiary butyl ether, analyzed by EPA Method 8260

TAME = Tertiary amyl methyl ether, analyzed by EPA Method 8260

TBA = Tertiary butyl alcohol, analyzed by EPA Method 8260

1,2-DCA = 1,2-Dichloroethane, analyzed by EPA Method 8260B

EDB = Ethylene dibromide, analyzed by EPA Method 8260B

TOC = Top of Casing Elevation

GW = Groundwater

ug/L = Parts per billion

MSL = Mean sea level

ft. = Feet

<n = Below detection limit

NA = Not applicable

WELL CONCENTRATIONS
Shell-branded Service Station
9750 Golf Links Road
Oakland, CA

Well ID	Date	TPPH (ug/L)	B (ug/L)	T (ug/L)	E (ug/L)	X (ug/L)	MTBE 8260 (ug/L)	DIPE (ug/L)	ETBE (ug/L)	TAME (ug/L)	TBA (ug/L)	1,2- DCA (ug/L)	EDB (ug/L)	Ethanol (ug/L)	Methanol (ug/L)	TOC (MSL)	Depth to Water (ft.)	GW Elevation (MSL)
---------	------	----------------	-------------	-------------	-------------	-------------	------------------------	----------------	----------------	----------------	---------------	-----------------------	---------------	-------------------	--------------------	--------------	----------------------------	--------------------------

Notes:

a = Quantity of unknown hydrocarbon(s) in sample based on gasoline.

b = Top of casing altered -0.20 ft. due to wellhead maintenance on September 27, 2005.

c = Analyte was detected in the associated Method Blank.

d = The reporting limit for this analyte has been raised to account for interference from coeluting organic compounds present in the sample.

e = Sample was originally analyzed within the EPA recommended hold time. Re-analysis for dilution was performed past the recommended hold time.

f = Sample was originally analyzed within the EPA recommended hold time. Re-analysis for confirmation was performed past the recommended hold time.

g = Result for this hydrocarbon is elevated due to the presence of single analyte peak(s) in the quantitation range.

h = Concentration indicated for this analyte is an estimated value above the calibration range of the instrument.

i = Result was reported with a possible high bias due to the continuing calibration verification falling outside acceptance criteria.

j = The reporting limit for this analyte has been raised to account for matrix interference.

k = There was insufficient preservative to reduce the sample pH to less than 2. The sample was analyzed within 14 days of sampling but beyond the 7 days recommended for Benzene, Toluene, and Ethylbenzene.

l = Analyzed by EPA Method 8015B (M).

m = The sample chromatographic pattern for TPH does not match the chromatographic pattern of the specified standard. Quantitation of the unknown hydrocarbon(s) in the sample was based upon the specified standard.

n = Analyte was detected at a concentration below the reporting limit and above the laboratory method detection limit. Reported value is estimated.

Ethanol and Methanol analyzed by EPA Method 8260B.

Site surveyed March 23, 2005 by Virgil Chavez Land Surveying of Vallejo, CA.

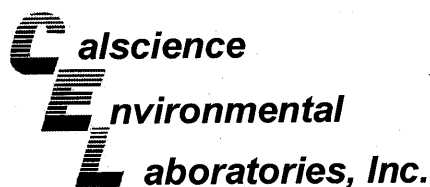

January 05, 2009

Michael Ninokata
Blaine Tech Services, Inc.
1680 Rogers Avenue
San Jose, CA 95112-1105

Subject: **Calscience Work Order No.: 08-12-2393**
Client Reference: 9750 Golf Links Rd., Oakland, CA

Dear Client:

Enclosed is an analytical report for the above-referenced project. The samples included in this report were received 12/24/2008 and analyzed in accordance with the attached chain-of-custody.

Unless otherwise noted, all analytical testing was accomplished in accordance with the guidelines established in our Quality Systems Manual, applicable standard operating procedures, and other related documentation. The original report of subcontracted analysis, if any, is provided herein, and follows the standard Calscience data package. The results in this analytical report are limited to the samples tested and any reproduction thereof must be made in its entirety.

If you have any questions regarding this report, please do not hesitate to contact the undersigned.

Sincerely,

A handwritten signature in black ink, appearing to read "Jessie Kim".

Calscience Environmental
Laboratories, Inc.
Jessie Kim
Project Manager

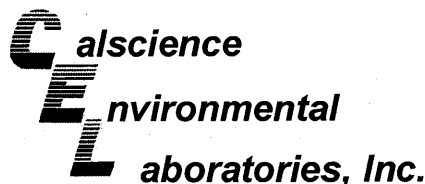

Analytical Report



Blaine Tech Services, Inc.
1680 Rogers Avenue
San Jose, CA 95112-1105

Date Received: 12/24/08
Work Order No: 08-12-2393
Preparation: EPA 5030B
Method: LUFT GC/MS / EPA 8260B
Units: ug/L

Project: 9750 Golf Links Rd., Oakland, CA

Page 1 of 2

Client Sample Number	Lab Sample Number	Date/Time Collected	Matrix	Instrument	Date Prepared	Date/Time Analyzed	QC Batch ID
S-1	08-12-2393-1-A	12/22/08 14:10	Aqueous	GC/MS RR	12/31/08	12/31/08 23:02	081231L01

Parameter	Result	RL	DF	Qual	Parameter	Result	RL	DF	Qual
Benzene	ND	0.50	1		Methyl-t-Butyl Ether (MTBE)	4.5	1.0	1	
Ethylbenzene	ND	1.0	1		Tert-Butyl Alcohol (TBA)	47	10	1	
Toluene	ND	1.0	1		Tert-Amyl-Methyl Ether (TAME)	ND	2.0	1	
p/m-Xylene	ND	1.0	1		TPPH	1100	50	1	
o-Xylene	ND	1.0	1						
<u>Surrogates:</u>	<u>REC (%)</u>	<u>Control Limits</u>		<u>Qual</u>	<u>Surrogates:</u>	<u>REC (%)</u>	<u>Control Limits</u>		<u>Qual</u>
Dibromofluoromethane	109	74-140			1,2-Dichloroethane-d4	93	74-146		
Toluene-d8	100	88-112			Toluene-d8-TPPH	100	88-112		
1,4-Bromofluorobenzene	96	74-110							

Client Sample Number	Lab Sample Number	Date/Time Collected	Matrix	Instrument	Date Prepared	Date/Time Analyzed	QC Batch ID
S-2	08-12-2393-2-A	12/22/08 13:00	Aqueous	GC/MS RR	12/31/08	12/31/08 23:26	081231L01

Parameter	Result	RL	DF	Qual	Parameter	Result	RL	DF	Qual
Benzene	ND	0.50	1		Methyl-t-Butyl Ether (MTBE)	1.4	1.0	1	
Ethylbenzene	ND	1.0	1		Tert-Butyl Alcohol (TBA)	ND	10	1	
Toluene	ND	1.0	1		Tert-Amyl-Methyl Ether (TAME)	ND	2.0	1	
p/m-Xylene	ND	1.0	1		TPPH	ND	50	1	
o-Xylene	ND	1.0	1						
<u>Surrogates:</u>	<u>REC (%)</u>	<u>Control Limits</u>		<u>Qual</u>	<u>Surrogates:</u>	<u>REC (%)</u>	<u>Control Limits</u>		<u>Qual</u>
Dibromofluoromethane	107	74-140			1,2-Dichloroethane-d4	91	74-146		
Toluene-d8	100	88-112			Toluene-d8-TPPH	101	88-112		
1,4-Bromofluorobenzene	95	74-110							

Client Sample Number	Lab Sample Number	Date/Time Collected	Matrix	Instrument	Date Prepared	Date/Time Analyzed	QC Batch ID
S-4	08-12-2393-3-A	12/22/08 13:55	Aqueous	GC/MS RR	12/31/08	12/31/08 23:50	081231L01

Parameter	Result	RL	DF	Qual	Parameter	Result	RL	DF	Qual
Benzene	ND	0.50	1		Methyl-t-Butyl Ether (MTBE)	4.3	1.0	1	
Ethylbenzene	ND	1.0	1		Tert-Butyl Alcohol (TBA)	ND	10	1	
Toluene	ND	1.0	1		Tert-Amyl-Methyl Ether (TAME)	ND	2.0	1	
p/m-Xylene	ND	1.0	1		TPPH	ND	50	1	
o-Xylene	ND	1.0	1						
<u>Surrogates:</u>	<u>REC (%)</u>	<u>Control Limits</u>		<u>Qual</u>	<u>Surrogates:</u>	<u>REC (%)</u>	<u>Control Limits</u>		<u>Qual</u>
Dibromofluoromethane	108	74-140			1,2-Dichloroethane-d4	93	74-146		
Toluene-d8	100	88-112			Toluene-d8-TPPH	101	88-112		
1,4-Bromofluorobenzene	95	74-110							

RL - Reporting Limit , DF - Dilution Factor , Qual - Qualifiers

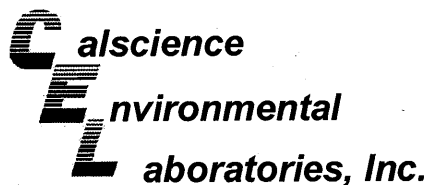

Analytical Report



Blaine Tech Services, Inc.
1680 Rogers Avenue
San Jose, CA 95112-1105

Date Received: 12/24/08
Work Order No: 08-12-2393
Preparation: EPA 5030B
Method: LUFT GC/MS / EPA 8260B
Units: ug/L

Project: 9750 Golf Links Rd., Oakland, CA

Page 2 of 2

Client Sample Number	Lab Sample Number	Date/Time Collected	Matrix	Instrument	Date Prepared	Date/Time Analyzed	QC Batch ID
S-5	08-12-2393-4-A	12/22/08 15:24	Aqueous	GC/MS RR	12/31/08	01/01/09 00:15	081231L01

Parameter	Result	RL	DF	Qual	Parameter	Result	RL	DF	Qual
Benzene	0.53	0.50	1		Methyl-t-Butyl Ether (MTBE)	38	1.0	1	
Ethylbenzene	ND	1.0	1		Tert-Butyl Alcohol (TBA)	180	10	1	
Toluene	ND	1.0	1		Tert-Amyl-Methyl Ether (TAME)	ND	2.0	1	
p/m-Xylene	ND	1.0	1		TPPH	130	50	1	
o-Xylene	ND	1.0	1						
<u>Surrogates:</u>	<u>REC (%)</u>	<u>Control Limits</u>		<u>Qual</u>	<u>Surrogates:</u>	<u>REC (%)</u>	<u>Control Limits</u>		<u>Qual</u>
Dibromofluoromethane	107	74-140			1,2-Dichloroethane-d4	93	74-146		
Toluene-d8	101	88-112			Toluene-d8-TPPH	101	88-112		
1,4-Bromofluorobenzene	96	74-110							

Client Sample Number	Lab Sample Number	Date/Time Collected	Matrix	Instrument	Date Prepared	Date/Time Analyzed	QC Batch ID
Method Blank	099-12-767-728	N/A	Aqueous	GC/MS RR	12/31/08	12/31/08 16:10	081231L01

Parameter	Result	RL	DF	Qual	Parameter	Result	RL	DF	Qual
Benzene	ND	0.50	1		Methyl-t-Butyl Ether (MTBE)	ND	1.0	1	
Ethylbenzene	ND	1.0	1		Tert-Butyl Alcohol (TBA)	ND	10	1	
Toluene	ND	1.0	1		Tert-Amyl-Methyl Ether (TAME)	ND	2.0	1	
p/m-Xylene	ND	1.0	1		TPPH	ND	50	1	
o-Xylene	ND	1.0	1						
<u>Surrogates:</u>	<u>REC (%)</u>	<u>Control Limits</u>		<u>Qual</u>	<u>Surrogates:</u>	<u>REC (%)</u>	<u>Control Limits</u>		<u>Qual</u>
Dibromofluoromethane	103	74-140			1,2-Dichloroethane-d4	89	74-146		
Toluene-d8	100	88-112			Toluene-d8-TPPH	100	88-112		
1,4-Bromofluorobenzene	96	74-110							

RL - Reporting Limit , DF - Dilution Factor , Qual - Qualifiers

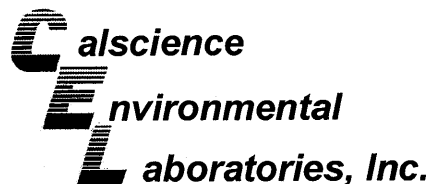

Quality Control - Spike/Spike Duplicate



Blaine Tech Services, Inc.
1680 Rogers Avenue
San Jose, CA 95112-1105

Date Received: 12/24/08
Work Order No: 08-12-2393
Preparation: EPA 5030B
Method: LUFT GC/MS / EPA 8260B

Project 9750 Golf Links Rd., Oakland, CA

Quality Control Sample ID	Matrix	Instrument	Date Prepared	Date Analyzed	MS/MSD Batch Number
08-12-2397-1	Aqueous	GC/MS RR	12/31/08	12/31/08	081231S01

Parameter	MS %REC	MSD %REC	%REC CL	RPD	RPD CL	Qualifiers
Benzene	96	96	88-118	0	0-7	
Carbon Tetrachloride	98	102	67-145	4	0-11	
Chlorobenzene	97	97	88-118	0	0-7	
1,2-Dibromoethane	97	98	70-130	0	0-30	
1,2-Dichlorobenzene	93	92	86-116	1	0-8	
1,1-Dichloroethene	88	88	70-130	0	0-25	
Ethylbenzene	90	90	70-130	0	0-30	
Toluene	99	99	87-123	0	0-8	
Trichloroethene	100	99	79-127	1	0-10	
Vinyl Chloride	83	85	69-129	3	0-13	
Methyl-t-Butyl Ether (MTBE)	90	92	71-131	2	0-13	
Tert-Butyl Alcohol (TBA)	85	86	36-168	1	0-45	
Diisopropyl Ether (DIPE)	85	86	81-123	0	0-9	
Ethyl-t-Butyl Ether (ETBE)	87	88	72-126	2	0-12	
Tert-Amyl-Methyl Ether (TAME)	87	88	72-126	2	0-12	
Ethanol	84	94	53-149	11	0-31	

RPD - Relative Percent Difference, CL - Control Limit

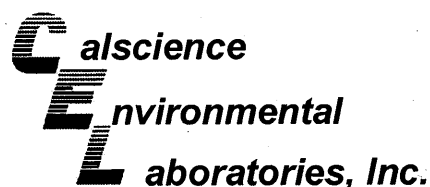

Quality Control - LCS/LCS Duplicate

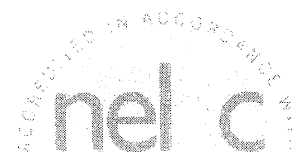

Blaine Tech Services, Inc.
1680 Rogers Avenue
San Jose, CA 95112-1105

Date Received: N/A
Work Order No: 08-12-2393
Preparation: EPA 5030B
Method: LUFT GC/MS / EPA 8260B

Project: 9750 Golf Links Rd., Oakland, CA

Quality Control Sample ID	Matrix	Instrument	Date Prepared	Date Analyzed	LCS/LCSD Batch Number		
099-12-767-728	Aqueous	GC/MS RR	12/31/08	12/31/08	081231L01		
Parameter	LCS %REC	LCSD %REC	%REC CL	ME CL	RPD	RPD CL	Qualifiers
Benzene	100	98	84-120	78-126	2	0-8	
Carbon Tetrachloride	103	105	63-147	49-161	2	0-10	
Chlorobenzene	101	99	89-119	84-124	1	0-7	
1,2-Dibromoethane	101	98	80-120	73-127	3	0-20	
1,2-Dichlorobenzene	97	95	89-119	84-124	1	0-9	
1,1-Dichloroethene	94	92	77-125	69-133	2	0-16	
Ethylbenzene	94	94	80-120	73-127	0	0-20	
Toluene	102	101	83-125	76-132	2	0-9	
Trichloroethene	107	104	89-119	84-124	3	0-8	
Vinyl Chloride	84	89	63-135	51-147	5	0-13	
Methyl-t-Butyl Ether (MTBE)	91	88	82-118	76-124	4	0-13	
Tert-Butyl Alcohol (TBA)	86	82	46-154	28-172	4	0-32	
Diisopropyl Ether (DIPE)	88	82	81-123	74-130	7	0-11	
Ethyl-t-Butyl Ether (ETBE)	87	84	74-122	66-130	4	0-12	
Tert-Amyl-Methyl Ether (TAME)	89	85	76-124	68-132	4	0-10	
Ethanol	90	88	60-138	47-151	2	0-32	
TPPH	100	104	65-135	53-147	4	0-30	

Total number of LCS compounds : 17

Total number of ME compounds : 0

Total number of ME compounds allowed : 1

LCS ME CL validation result : Pass

RPD - Relative Percent Difference , CL - Control Limit

Work Order Number: 08-12-2393

<u>Qualifier</u>	<u>Definition</u>
*	See applicable analysis comment.
1	Surrogate compound recovery was out of control due to a required sample dilution, therefore, the sample data was reported without further clarification.
2	Surrogate compound recovery was out of control due to matrix interference. The associated method blank surrogate spike compound was in control and, therefore, the sample data was reported without further clarification.
3	Recovery of the Matrix Spike (MS) or Matrix Spike Duplicate (MSD) compound was out of control due to matrix interference. The associated LCS and/or LCSD was in control and, therefore, the sample data was reported without further clarification.
4	The MS/MSD RPD was out of control due to matrix interference. The LCS/LCSD RPD was in control and, therefore, the sample data was reported without further clarification.
5	The PDS/PDSD associated with this batch of samples was out of control due to a matrix interference effect. The associated batch LCS/LCSD was in control and, hence, the associated sample data was reported with no further corrective action required.
A	Result is the average of all dilutions, as defined by the method.
B	Analyte was present in the associated method blank.
C	Analyte presence was not confirmed on primary column.
E	Concentration exceeds the calibration range.
H	Sample received and/or analyzed past the recommended holding time.
J	Analyte was detected at a concentration below the reporting limit and above the laboratory method detection limit. Reported value is estimated.
ME	LCS Recovery Percentage is within LCS ME Control Limit range.
N	Nontarget Analyte.
ND	Parameter not detected at the indicated reporting limit.
Q	Spike recovery and RPD control limits do not apply resulting from the parameter concentration in the sample exceeding the spike concentration by a factor of four or greater.
U	Undetected at the laboratory method detection limit.
X	% Recovery and/or RPD out-of-range.
Z	Analyte presence was not confirmed by second column or GC/MS analysis.



Shell Oil Products Chain Of Custody Record

LAB (LOCATION)

- CALSCIENCE ()
- SPL ()
- XENCO ()
- TEST AMERICA ()
- OTHER ()

Please Check Appropriate Box:

<input checked="" type="checkbox"/> ENV. SERVICES	<input type="checkbox"/> MOTIVA RETAIL	<input type="checkbox"/> SHELL RETAIL
<input type="checkbox"/> MOTIVA SD&CH	<input type="checkbox"/> CONSULTANT	<input type="checkbox"/> LUBES
<input type="checkbox"/> SHELL PIPELINE	<input type="checkbox"/> OTHER _____	

Print Bill To Contact Name: Denis Brown

INCIDENT # (ENV SERVICES): 9 8 9 9 5 7 4 4

CHECK IF NO INCIDENT # APPLIES

DATE: 12/22/08

PAGE: 1 of 1

SAMPLING COMPANY: Blaine Tech Services

LOG CODE: BTSS

SITE ADDRESS: Street and City: 9750 Golf Links Rd. Oakland

State: CA

GLOBAL ID NO.: T0600101931

ADDRESS: 1680 Rogers Ave, San Jose, CA 95112

EDF DELIVERABLE TO (Name, Company, Office Location): Annl Krenl, CRA, Emeryville

PHONE NO.: (510) 420-3335

E-MAIL: Shelledf@craworld.com

CONSULTANT PROJECT NO.: BTS # 081222-JP2

PROJECT CONTACT (hardcopy or PDF Report to): Michael Ninokata

SAMPLER NAME(S) (Print): J. PARKER

LAB USE ONLY: 12-2393

TELEPHONE: (408)573-0555

FAX: (408)573-7771

E-MAIL: mninokata@blainetech.com

TURNAROUND TIME (CALENDAR DAYS):

STANDARD (14 DAY) 5 DAYS 3 DAYS 2 DAYS 24 HOURS

RESULTS NEEDED ON WEEKEND

REQUESTED ANALYSIS

LA - RWQCS REPORT FORMAT UST AGENCY:

SPECIAL INSTRUCTIONS OR NOTES :

SHELL CONTRACT RATE APPLIES

STATE REIMBURSEMENT RATE APPLIES

EDD NOT NEEDED

RECEIPT VERIFICATION REQUESTED

R/L Methanol = 500 ppb

													TEMPERATURE ON RECEIPT C°
													Container PID Readings or Laboratory Notes

LAB USE ONLY	Field Sample Identification	SAMPLING		MATRIX	PRESERVATIVE					NO. OF CONT.	TPH - Purgeable (8260B)	TPH - Extractable (8015M)	BTEX (8260B)	5 Oxygenates (8260B)	MTBE (8260B)	TBA (8260B)	DIPE (8260B)	TAME (8260B)	ETBE (8260B)	1,2 DCA (8260B)	EDB (8260B)	Ethanol (8260B)	Methanol (8015M)	
		DATE	TIME		HCL	HNO3	H2SO4	NONE	OTHER															
	S-1	12/22	1410	W	X						3/10	X	X	X	X	X								
	S-2		1300									X	X	X	X	X								
	S-4		1355									X	X	X	X	X								
	S-5		1324									X	X	X	X	X								

Relinquished by: (Signature) Received by: (Signature) (SAMPLE CUSTODIAN) Date: 12/22/08 Time: 1630

Relinquished by: (Signature) Received by: (Signature) C.E.L. Date: 12-23-08 Time: 1330

Relinquished by: (Signature) Received by: (Signature) Precy R. Cruz Date: 12/24/08 Time: 9:30

GSD # 510978940

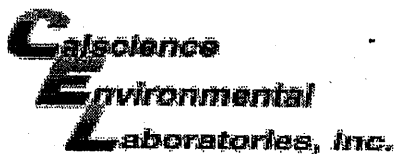

WORK ORDER #: 0 9 - 1 2 - 2 3 9 3

SAMPLE RECEIPT FORM

Cooler 1 of 1

CLIENT: BLAINE TECH

DATE: 12/24/08

TEMPERATURE: (Criteria: 0.0°C – 6.0°C, not frozen)

Temperature 3.5 °C - 0.2°C (CF) = 3.3 °C Blank Sample

Sample(s) outside temperature criteria (PM/APM contacted by: _____).

Sample(s) outside temperature criteria but received on ice/chilled on same day of sampling.

Received at ambient temperature, placed on ice for transport by Courier.

Ambient Temperature: Air Filter Metals Only PCBs Only Initial: PS

CUSTODY SEALS INTACT:

Cooler _____ No (Not Intact) Not Present N/A Initial: PS

Sample _____ No (Not Intact) Not Present Initial: PS

SAMPLE CONDITION:	Yes	No	N/A
Chain-Of-Custody (COC) document(s) received with samples.....	<input checked="" type="checkbox"/>	<input type="checkbox"/>	<input type="checkbox"/>
COC document(s) received complete.....	<input checked="" type="checkbox"/>	<input type="checkbox"/>	<input type="checkbox"/>
Sampler's name indicated on COC.....	<input checked="" type="checkbox"/>	<input type="checkbox"/>	<input type="checkbox"/>
Sample container label(s) consistent with COC.....	<input checked="" type="checkbox"/>	<input type="checkbox"/>	<input type="checkbox"/>
Sample container(s) intact and good condition.....	<input checked="" type="checkbox"/>	<input type="checkbox"/>	<input type="checkbox"/>
Correct containers and volume for analyses requested.....	<input checked="" type="checkbox"/>	<input type="checkbox"/>	<input type="checkbox"/>
Analyses received within holding time.....	<input checked="" type="checkbox"/>	<input type="checkbox"/>	<input type="checkbox"/>
Proper preservation noted on COC or sample container.....	<input checked="" type="checkbox"/>	<input type="checkbox"/>	<input type="checkbox"/>
Volatile analysis container(s) free of headspace.....	<input checked="" type="checkbox"/>	<input type="checkbox"/>	<input type="checkbox"/>
Tedlar bag(s) free of condensation.....	<input type="checkbox"/>	<input type="checkbox"/>	<input checked="" type="checkbox"/>

CONTAINER TYPE:

Solid: 4ozCGJ 8ozCGJ 16ozCGJ Sleeve EnCores® TerraCores® _____

Water: VOA VOA^h VOAn₂ 125AGB 125AGBh 125AGBpo₄ 1AGB 1AGBna₂

1AGBs 500AGB 500AGBs 250CGB 250CGBs 1PB 500PB 500PBna 250PB

250PBn 125PB 125PBz₂na 100PBsterile 100PBna₂ _____ _____ _____

Air: Tedlar® Summa® _____

Container: C:Clear A:Amber P:Poly/Plastic G:Glass J:Jar B:Bottle

Preservative: h:HCL n:HNO₃ na₂:Na₂S₂O₃ na:NaOH po₄:H₃PO₄ s:H₂SO₄ z₂na:ZnAc₂+NaOH

Checked/Labeled by: PS
Reviewed by: WJ
Scanned by: WJ

WELL GAUGING DATA

Project # 081222-JP2 Date 12/22/08 Client SHELL

Site 9750 GOLF LINKS

Well ID	Time	Well Size (in.)	Sheen / Odor	Depth to Immiscible Liquid (ft.)	Thickness of Immiscible Liquid (ft.)	Volume of Immiscibles Removed (ml)	Depth to water (ft.)	Depth to well bottom (ft.)	Survey Point: TOB or TOC	Notes
S-1	1214	4					7.51	17.31		4
S-2	1205	4					5.41	11.73		2
S-4	1158	4					10.98	13.41		1
S-5	1211	4					7.31	13.99	✓	3

SHELL WELL MONITORING DATA SHEET

BTS #: 081222-JP2	Site: 9750 GOLF LINKS RD
Sampler: JP	Date: 12/22/08
Well I.D.: S-4	Well Diameter: 2 3 (4) 6 8
Total Well Depth (TD): 13.41	Depth to Water (DTW): 10.35
Depth to Free Product: —	Thickness of Free Product (feet): —
Referenced to: (PVC) Grade	D.O. Meter (if req'd): — YSI HACH
DTW with 80% Recharge [(Height of Water Column x 0.20) + DTW]: 10.98	

Purge Method: Bailer Waterra Sampling Method: Bailer
 Disposable Bailer Peristaltic Disposable Bailer
 Positive Air Displacement Extraction Pump Extraction Port
 Electric Submersible Other _____ Dedicated Tubing

Other: _____

1.97 (Gals.) X **3** = **5.91** Gals.
 I Case Volume Specified Volumes Calculated Volume

Well Diameter	Multiplier	Well Diameter	Multiplier
1"	0.04	4"	0.65
2"	0.16	6"	1.47
3"	0.37	Other	radius ² * 0.163

Time	Temp (°F)	pH	Cond. (mS or μ S)	Turbidity (NTUs)	Gals. Removed	Observations
1233	65.6	7.04	836.1	212	1.97	
1236	65.8	6.8	829.4	482	3.94	
	WELL DEWATERED @			4.0 GAL	DTW: 11.63	
1355	63.3	7.00	877.2	153	—	

Did well dewater? Yes No Gallons actually evacuated: **4.0**

Sampling Date: **12/22/08** Sampling Time: **1355** Depth to Water: **10.98**

Sample I.D.: **S-4** Laboratory: STL Other: **CALSCIENCE**

Analyzed for: TPH-G BTEX MTBE TPH-D Other: **SEE LOD**

EB I.D. (if applicable): **—** @ Time Duplicate I.D. (if applicable): **—**

Analyzed for: TPH-G BTEX MTBE TPH-D Other: **—**

D.O. (if req'd):	Pre-purge:	— mg/L	Post-purge:	— mg/L
O.R.P. (if req'd):	Pre-purge:	— mV	Post-purge:	— mV

