



Health Care Services

Alameda County Environmental Health Meeting Sign-In Sheet

Chevron #92029; R00002438
890 W. MacArthur Blvd, Oakland, CA

Wednesday, April 22, 2015
10:00 AM

NAME	COMPANY	MAILING ADDRESS	PHONE	Signature	E-MAIL
Dilan Roe	Alameda County	1131 Harbor Bay Pkwy, Suite 250 Alameda, CA 94502	(510) 567-6767	<i>Present</i>	Dilan.roe@acgov.org
Mark Detterman	Alameda County	1131 Harbor Bay Pkwy, Suite 250 Alameda, CA 94502	(510) 567-6876	<i>Mark Detterman</i>	mark.detterman@acgov.org
<i>Gary Messerotes</i>	<i>Stantec</i>	<i>15575 Los Gatos Blvd. Bldg C Los Gatos, CA 95032</i>	<i>(408) 827-3533</i>	<i>Gary Messerotes</i>	<i>Gary.messerotes@stantec.com</i>
<i>TRAVIS FLORA</i>	<i>Stantec</i>	<i>same</i>	<i>(408) 827-3876</i>	<i>Travis Flora</i>	<i>travis.flora@stantec.com</i>
<i>CARRYL MACLEOD</i>	<i>Chevron</i>	<i>6101 Bollinger Canyon Rd</i>	<i>925 490 6506</i>	<i>Caryl Macleod</i>	<i>carylmacleod@yahoo.com</i>

Table 1
Current Soil Analytical Results
Former Chevron-Branded Service Station 92029
890 West MacArthur Boulevard
Oakland, California

Boring ID	Depth (feet bgs)	Date Collected	US EPA Method 8015B		US EPA METHOD 8260									
			TPH-GRO (mg/kg)	Benzene (mg/kg)	Toluene (mg/kg)	Ethylbenzene (mg/kg)	Total Xylenes (mg/kg)	MTBE (mg/kg)	TBA (mg/kg)	DIPE (mg/kg)	EIBE (mg/kg)	TAME (mg/kg)	Ethanol (mg/kg)	Naphthalene (mg/kg)
SB-11	2.5	02/25/15	<0.5	<0.0005	<0.001	<0.001	<0.001	<0.0005	<0.021	<0.001	<0.001	<0.001	<0.10	<0.001
	5		<0.5	<0.0005	<0.001	<0.001	<0.001	<0.0005	<0.020	<0.001	<0.001	<0.001	<0.10	<0.001
	7.5		0.7	<0.0005	<0.001	<0.001	<0.001	<0.0005	<0.021	<0.001	<0.001	<0.001	<0.10	<0.001
	10		65	<0.023	<0.047	<0.047	<0.047	<0.023	<0.94	<0.047	<0.047	<0.047	<4.7	0.46
SB-12	2.5	02/26/15	<0.5	<0.0005	<0.001	<0.001	<0.001	<0.0005	<0.020	<0.001	<0.001	<0.001	<0.10	<0.001
	5		<0.5	<0.0005	<0.001	<0.001	<0.001	<0.0005	<0.021	<0.001	<0.001	<0.001	<0.10	<0.001
	7.5		<0.5	<0.0005	<0.001	<0.001	<0.001	<0.0005	<0.020	<0.001	<0.001	<0.001	<0.10	<0.001
	10		26	<0.0005	<0.001	<0.001	<0.001	<0.0005	<0.020	<0.001	<0.001	<0.001	<0.10	<0.001
SB-13	2.5	02/25/15	<0.5	<0.0005	<0.001	<0.001	<0.001	<0.0005	<0.020	<0.001	<0.001	<0.001	<0.099	<0.001
	14	03/05/15	<0.5	<0.0005	<0.001	<0.001	<0.001	<0.0005	<0.019	<0.001	<0.001	<0.001	<0.097	<0.001
	14.5	03/05/15	<0.5	<0.0005	<0.001	<0.001	<0.001	0.087	<0.021	<0.001	<0.001	<0.001	<0.11	<0.001
SB-14	2.5	02/26/15	<0.5	<0.0005	<0.001	<0.001	<0.001	<0.0005	<0.020	<0.001	<0.001	<0.001	<0.10	<0.001
	5		<0.5	<0.0005	<0.0009	<0.0009	<0.0009	<0.0005	<0.019	<0.0009	<0.0009	<0.0009	<0.094	<0.0009
	7.5		2.4	<0.0005	<0.001	<0.001	<0.001	<0.0005	<0.019	<0.001	<0.001	<0.001	<0.096	<0.001
	10		39	0.004	<0.001	0.005	<0.001	0.0006	<0.021	<0.001	<0.001	<0.001	<0.11	0.002
SB-15	2.5	02/27/15	<0.5	<0.0005	<0.001	<0.001	<0.001	<0.0005	<0.019	<0.001	<0.001	<0.001	<0.096	<0.001
	5		<0.5	<0.0005	<0.001	<0.001	<0.001	<0.0005	<0.020	<0.001	<0.001	<0.001	<0.10	<0.001
	7.5		0.9	<0.0005	<0.001	<0.001	<0.001	<0.0005	<0.022	<0.001	<0.001	<0.001	<0.11	<0.001
	10		480	0.40	<0.053	8.3	14	<0.027	<1.1	<0.053	<0.053	<0.053	<5.3	2.5
SB-17	2.5	02/27/15	<0.5	<0.0005	<0.001	<0.001	<0.001	<0.0005	<0.020	<0.001	<0.001	<0.001	<0.10	<0.001
	5		<0.5	<0.0005	<0.001	<0.001	<0.001	<0.0005	<0.020	<0.001	<0.001	<0.001	<0.10	0.001
	7.5		0.6	<0.0005	<0.0009	<0.0009	<0.0009	<0.0005	<0.019	<0.0009	<0.0009	<0.0009	<0.093	<0.0009
	10		25	0.0008	<0.001	<0.001	<0.001	<0.0005	<0.020	<0.001	<0.001	<0.001	<0.10	<0.001
SB-18	2.5	02/27/15	<0.5	<0.0005	<0.001	<0.001	<0.001	<0.0005	<0.021	<0.001	<0.001	<0.001	<0.10	<0.001
	5		<0.5	<0.0005	<0.001	<0.001	<0.001	<0.0005	<0.020	<0.001	<0.001	<0.001	<0.099	<0.001
	7.5		470	0.064	<0.047	0.24	<0.047	<0.023	<0.94	<0.047	<0.047	<0.047	<4.7	0.11
	10		410	0.17	<0.048	3.8	<0.048	<0.024	<0.96	<0.048	<0.048	<0.048	<4.8	1.2
SB-19	2.5	02/26/15	<0.5	<0.0005	<0.001	<0.001	<0.001	0.001	<0.020	<0.001	<0.001	<0.001	<0.10	<0.001
	5		<0.5	<0.0005	<0.0009	<0.0009	<0.0009	0.0005	<0.019	<0.0009	<0.0009	<0.0009	<0.094	<0.0009
	7.5		<0.5	<0.0005	<0.001	<0.001	<0.001	<0.0005	<0.020	<0.001	<0.001	<0.001	<0.10	<0.001
	10		5.7	<0.0005	<0.001	<0.001	<0.001	<0.0005	<0.020	<0.001	<0.001	<0.001	<0.10	<0.001
SB-20	2.5	02/26/15	<0.5	<0.0005	<0.001	<0.001	<0.001	<0.0005	<0.020	<0.001	<0.001	<0.001	<0.099	<0.001
	5		<0.5	<0.0005	<0.001	<0.001	<0.001	<0.0005	<0.020	<0.001	<0.001	<0.001	<0.098	<0.001
	7.5		<0.5	<0.0005	<0.001	<0.001	<0.001	<0.0005	<0.022	<0.001	<0.001	<0.001	<0.11	<0.001

Table 1
Current Soil Analytical Results
Former Chevron-Branded Service Station 92029
890 West MacArthur Boulevard
Oakland, California

			US EPA Method 8015B	US EPA METHOD 8260										
Boring ID	Depth (feet bgs)	Date Collected	TPH-GRO (mg/kg)	Benzene (mg/kg)	Toluene (mg/kg)	Ethylbenzene (mg/kg)	Total Xylenes (mg/kg)	MTBE (mg/kg)	TBA (mg/kg)	DIPE (mg/kg)	EtBE (mg/kg)	TAME (mg/kg)	Ethanol (mg/kg)	Naphthalene (mg/kg)
SB-21	2.5	02/27/15	<0.5	<0.0005	<0.001	<0.001	<0.001	<0.0005	<0.019	<0.001	<0.001	<0.001	<0.096	<0.001
	5		<0.5	<0.0005	<0.001	<0.001	<0.001	<0.0005	<0.020	<0.001	<0.001	<0.001	<0.098	<0.001
	7.5		<0.5	<0.0005	<0.001	<0.001	<0.001	<0.0005	<0.020	<0.001	<0.001	<0.001	<0.098	<0.001
	10		<0.5	<0.0005	<0.001	<0.001	<0.001	<0.0005	<0.019	<0.001	<0.001	<0.001	<0.096	<0.001
ESLs - Shallow Soil^{1,2}			100	0.044	2.9	3.3	2.3	0.023	0.075	NE	NE	NE	NE	1.2
ESLs - Deep Soil^{1,2}			500	0.044	2.9	3.3	2.3	0.023	0.075	NE	NE	NE	NE	1.2

Notes:

1 = California Regional Water Quality Control Board, San Francisco Bay Region (RWQCB), *Screening For Environmental Concerns at Sites with Contaminated Soil and Groundwater*, Interim Final - December 2013.

2 = Shallow soil refers to soil above 9.84 feet bgs and deep soil refers to soil below 9.84 feet bgs.

Bold text denotes detected concentrations. **bold/blue** text denotes concentrations above RWQCB ESLs for residential land use where groundwater is a current or potential source of drinking water.

Abbreviations:

bgs = below ground surface

US EPA = United States Environmental Protection Agency

TPH-GRO = total petroleum hydrocarbons as gasoline range organics

mg/kg = milligrams per kilogram

MTBE = methyl tertiary-butyl ether

TBA = tertiary-butyl alcohol

DIPE = di-isopropyl ether

EtBE = ethyl tertiary-butyl ether

TAME = tertiary-amyI methyl ether

< = indicates less than stated method detection limit

ESL = Environmental Screening Level

NE = ESL not established for compound

Table 3
Current Grab Groundwater Analytical Results
Former Chevron-Branded Service Station 92029
890 West MacArthur Boulevard
Oakland, California

Boring ID	Date Collected	DTW (feet bgs)	US EPA Method 8015B	US EPA METHOD 8260										
			TPH-GRO (µg/L)	Benzene (µg/L)	Toluene (µg/L)	Ethylbenzene (µg/L)	Total Xylenes (µg/L)	MTBE (µg/L)	TBA (µg/L)	DIPE (µg/L)	EtBE (µg/L)	TAME (µg/L)	Ethanol (µg/L)	Naphthalene (µg/L)
SB-11	02/25/15	6.05	4,800	<0.5	0.9	0.9	<0.5	<0.5	<2	<0.5	<0.5	<0.5	<50	2
SB-12	02/26/15	5.6	3,800	<0.5	<0.5	<0.5	<0.5	0.5	<2	<0.5	<0.5	<0.5	<50	<1
SB-13	03/05/15	7.5	<50	<0.5	<0.5	<0.5	<0.5	4	<2	<0.5	<0.5	<0.5	<50	<1
SB-14	02/26/15	6.2	8,800	0.8	<0.5	11	<0.5	<0.5	<2	<0.5	<0.5	<0.5	<50	4
SB-15	02/27/15	6.5	43,000	210	21	2,700	4,100	1	<2	<0.5	<0.5	<0.5	<50	900
SB-17	02/27/15	5.7	5,300	<0.5	<0.5	4	1	<0.5	<2	<0.5	<0.5	<0.5	<50	<1
SB-18	02/27/15	8.9	43,000	1,200	7	3,100	76	29	29	<1	<1	<1	<100	910
SB-19	02/26/15	9.83	8,300	<0.5	<0.5	3	0.6	<0.5	<2	<0.5	<0.5	<0.5	<50	<1
SB-20	02/26/15	6.30	<50	<0.5	<0.5	<0.5	<0.5	<0.5	<2	<0.5	<0.5	<0.5	<50	<1
SB-21	02/27/15	10.65	<50	<0.5	<0.5	<0.5	<0.5	<0.5	<2	<0.5	<0.5	<0.5	<50	<1
ESLs¹			100	1	40	30	20	5	12	NE	NE	NE	NE	6.1

Notes:

¹ = California Regional Water Quality Control Board, San Francisco Bay Region (RWQCB), *Screening For Environmental Concerns at Sites with Contaminated Soil and Groundwater*, Interim Final - December 2013.

Bold text denotes detected concentrations. **Bold/blue** text denotes concentrations above RWQCB ESLs for groundwater that is a current or potential source of drinking water.

Abbreviations:

DTW = Depth-to-Groundwater

US EPA = United States Environmental Protection Agency

TPH-GRO = total petroleum hydrocarbons as gasoline range organics

(µg/L) = micrograms per liter

MtBE = methyl *tertiary*-butyl ether

TBA = *tertiary*-butyl alcohol

DIPE = di-isopropyl ether

EtBE = ethyl *tertiary*-butyl ether

TAME = *tertiary*-amyl methyl ether

< = indicates less than stated method detection limit

ESL = Environmental Screening Level

NE = ESL not established for compound

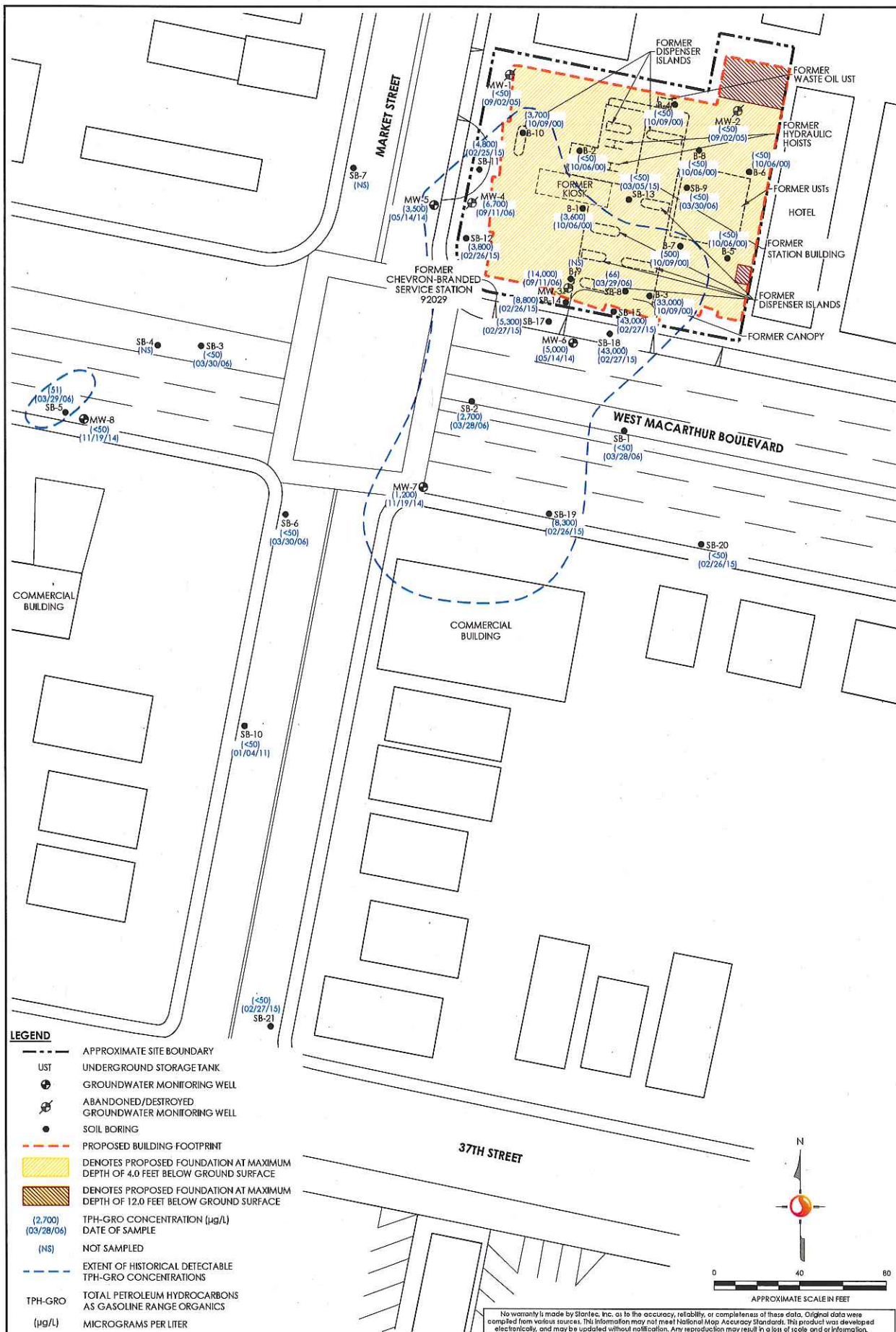

LEGEND

- APPROXIMATE SITE BOUNDARY
- UNDERGROUND STORAGE TANK
- ⊕ GROUNDWATER MONITORING WELL
- ⊖ ABANDONED/DESTROYED GROUNDWATER MONITORING WELL
- SOIL BORING
- - - PROPOSED BUILDING FOOTPRINT
- DENOTES PROPOSED FOUNDATION AT MAXIMUM DEPTH OF 4.0 FEET BELOW GROUND SURFACE
- DENOTES PROPOSED FOUNDATION AT MAXIMUM DEPTH OF 12.0 FEET BELOW GROUND SURFACE
- (2,700) TPH-GRO CONCENTRATION (µg/L)
- (03/28/06) DATE OF SAMPLE
- (NS) NOT SAMPLED
- - - EXTENT OF HISTORICAL DETECTABLE TPH-GRO CONCENTRATIONS
- TPH-GRO TOTAL PETROLEUM HYDROCARBONS AS GASOLINE RANGE ORGANICS (µg/L)
- MICROGRAMS PER LITER

NOTES

FORMER SITE FEATURES ARE IN APPROXIMATE LOCATIONS
 THE MAXIMUM CONCENTRATION OBSERVED WAS USED IN BORINGS WHERE MULTIPLE GROUNDWATER SAMPLES WERE COLLECTED
 CONTOUR ENCOMPASSES ALL DETECTED CONCENTRATIONS



15575 Los Gatos Blvd, Building C
 Los Gatos, CA 95032
 Phone: (408) 356-6124 Fax: (408) 356-6138

FOR:
 FORMER CHEVRON-BRANDED SERVICE STATION 92029
 890 WEST MACARTHUR BOULEVARD
 OAKLAND, CALIFORNIA

TPH-GRO CONCENTRATION MAP

FIGURE

3

JOB NUMBER: 211602398 DRAWN BY: JRC CHECKED BY: SS/EEO APPROVED BY: GPM/TLF DATE: 03/29/15

No warranty is made by Stantec, Inc. as to the accuracy, reliability, or completeness of these data. Original data were compiled from various sources. This information may not meet National Map Accuracy Standards. This product was developed electronically, and may be updated without notification. Any reproduction may result in a loss of scale and/or information.

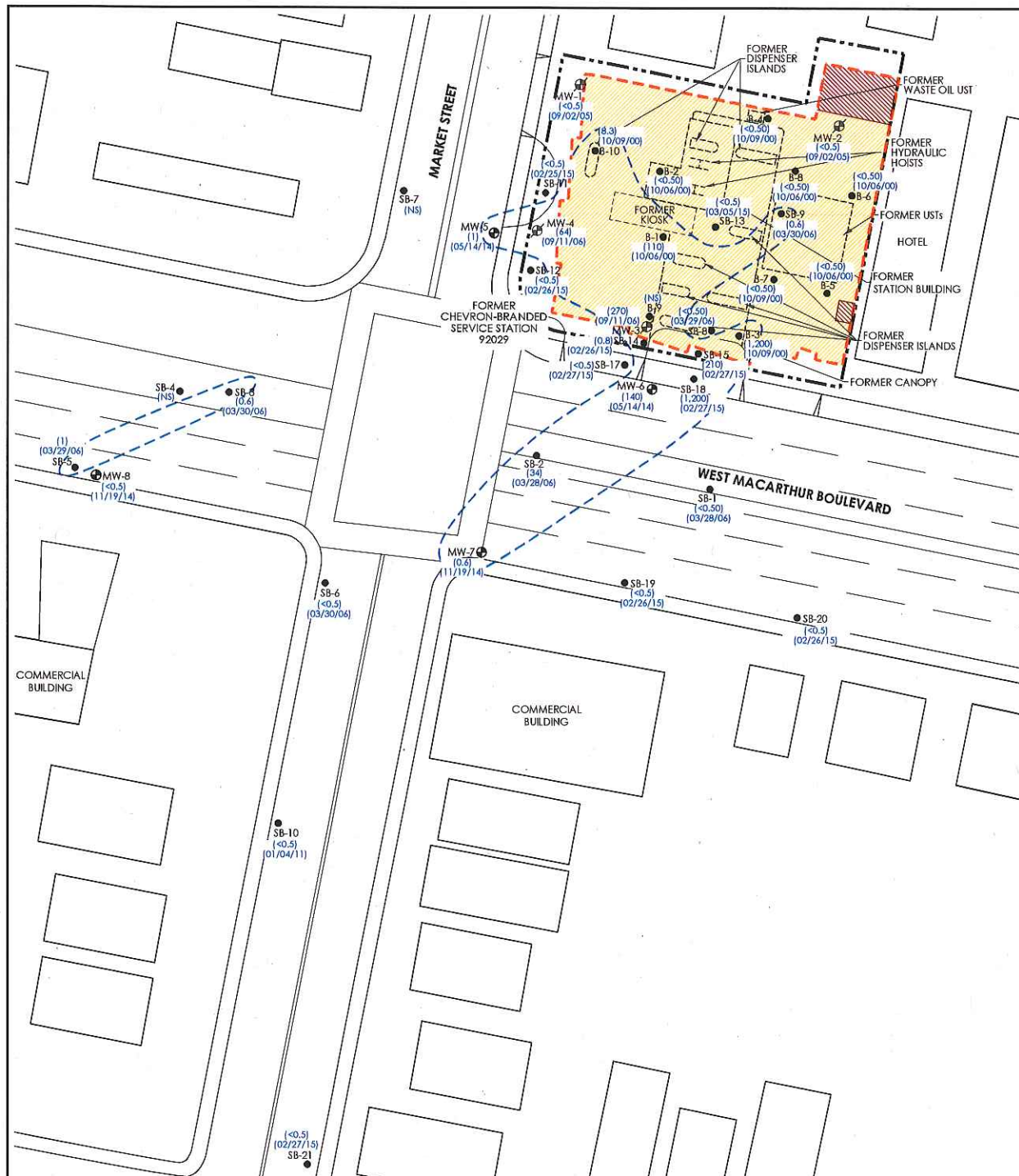

LEGEND

- APPROXIMATE SITE BOUNDARY
- UNDERGROUND STORAGE TANK
- GROUNDWATER MONITORING WELL
- ⊗ ABANDONED/DESTROYED GROUNDWATER MONITORING WELL
- SOIL BORING
- - - PROPOSED BUILDING FOOTPRINT
- DENOTES PROPOSED FOUNDATION AT MAXIMUM DEPTH OF 4.0 FEET BELOW GROUND SURFACE
- DENOTES PROPOSED FOUNDATION AT MAXIMUM DEPTH OF 12.0 FEET BELOW GROUND SURFACE
- (3,600) (10/06/00) BENZENE CONCENTRATION (µg/L) DATE OF SAMPLE
- (NS) NOT SAMPLED
- - - EXTENT OF HISTORICAL DETECTABLE BENZENE CONCENTRATIONS
- (µg/L) MICROGRAMS PER LITER

NOTES

FORMER SITE FEATURES ARE IN APPROXIMATE LOCATIONS
 THE MAXIMUM CONCENTRATION OBSERVED WAS USED IN BORINGS WHERE MULTIPLE GROUNDWATER SAMPLES WERE COLLECTED
 CONTOUR ENCOMPASSES ALL DETECTED CONCENTRATIONS

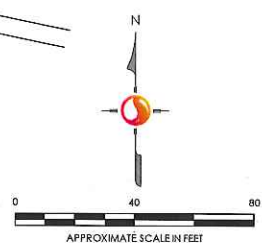

No warranty is made by Stantec, Inc. as to the accuracy, reliability, or completeness of these data. Original data were compiled from various sources. This information may not meet National Map Accuracy Standards. This product was developed electronically, and may be updated without notification. Any reproduction may result in loss of scale and/or information.

<p>15575 Los Gatos Blvd. Building C Los Gatos, CA 95032 Phone: (408) 356-6124 Fax: (408) 356-6138</p>	FOR: FORMER CHEVRON-BRANDED SERVICE STATION 92029 890 WEST MACARTHUR BOULEVARD OAKLAND, CALIFORNIA	BENZENE CONCENTRATION MAP		FIGURE 4
	JOB NUMBER: 211602398	DRAWN BY: JRO	CHECKED BY: SS/EEO	APPROVED BY: GPM/TLF

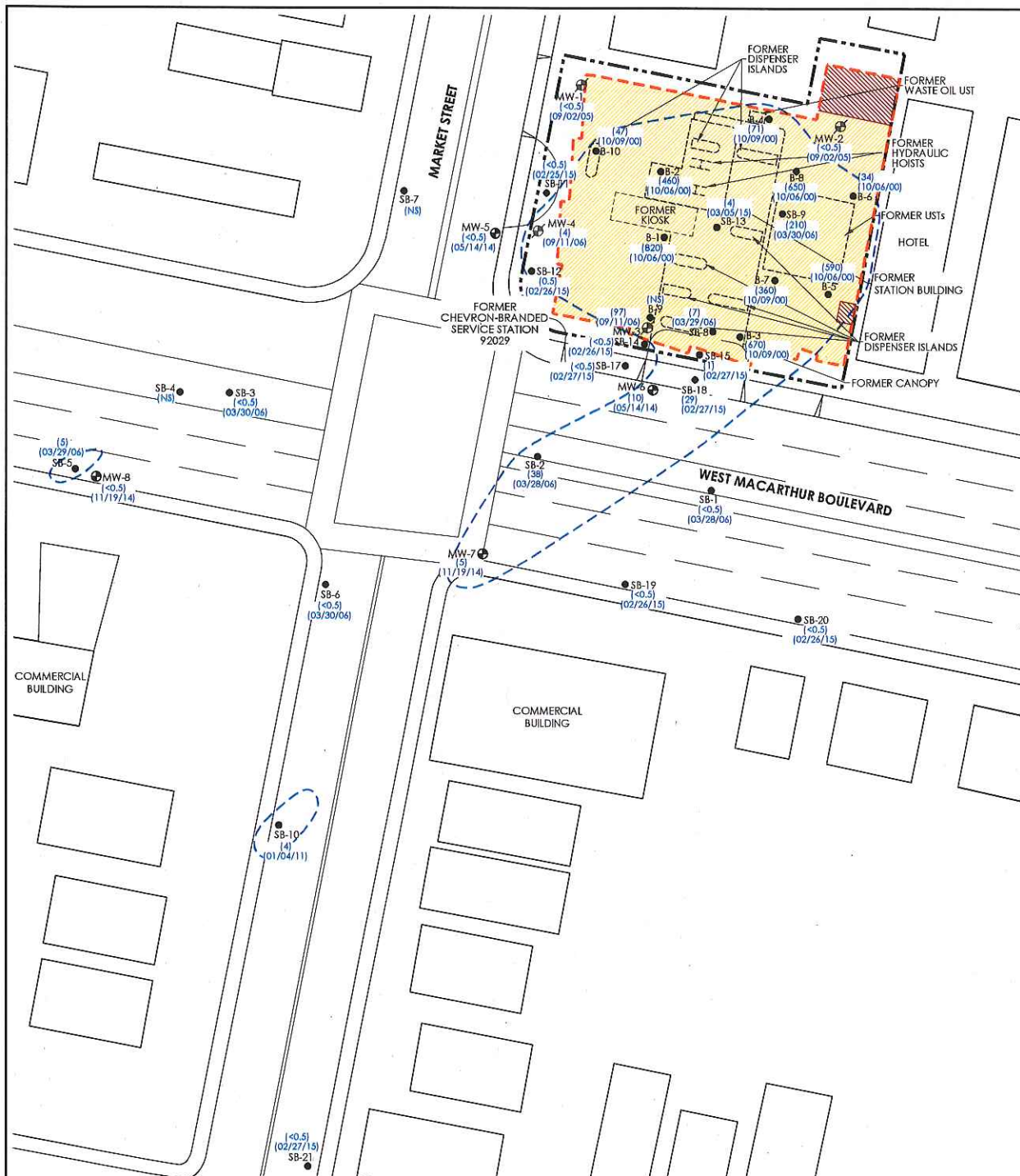

LEGEND

- APPROXIMATE SITE BOUNDARY
- UST UNDERGROUND STORAGE TANK
- GROUNDWATER MONITORING WELL
- ⊗ ABANDONED/DESTROYED GROUNDWATER MONITORING WELL
- SOIL BORING
- - - PROPOSED BUILDING FOOTPRINT
- DENOTES PROPOSED FOUNDATION AT MAXIMUM DEPTH OF 4.0 FEET BELOW GROUND SURFACE
- DENOTES PROPOSED FOUNDATION AT MAXIMUM DEPTH OF 12.0 FEET BELOW GROUND SURFACE
- (810) MIBE CONCENTRATION (µg/L)
- (10/06/00) DATE OF SAMPLE
- - - EXTENT OF HISTORICAL DETECTABLE MIBE CONCENTRATIONS
- MIBE METHYL TERTIARY-BUTYL ETHER
- (µg/L) MICROGRAMS PER LITER

NOTES

FORMER SITE FEATURES ARE IN APPROXIMATE LOCATIONS
 THE MAXIMUM CONCENTRATION OBSERVED WAS USED IN BORINGS WHERE MULTIPLE GROUNDWATER SAMPLES WERE COLLECTED
 CONTOUR ENCOMPASSES ALL DETECTED CONCENTRATIONS

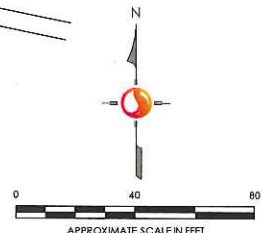

No warranty is made by Stantec, Inc. as to the accuracy, reliability, or completeness of these data. Original data were compiled from various sources. This information may not meet National Map Accuracy Standards. This product was developed electronically, and may be updated without notification. Any reproduction may result in a loss of scale and/or information.

<p>15575 Los Gatos Blvd, Building C Los Gatos, CA 95032 Phone: (408) 356-6124 Fax: (408) 356-6138</p>	FOR:	FORMER CHEVRON-BRANDED SERVICE STATION 92029 890 WEST MACARTHUR BOULEVARD OAKLAND, CALIFORNIA	FIGURE:	5
	JOB NUMBER:	211602398	DRAWN BY:	JRO
	CHECKED BY:	SS/EEO	APPROVED BY:	GPM/TLF
	DATE:	03/29/15		