

Atlantic Richfield Company

Chuck Carmel

Remediation Management Project Manager

RECEIVED

By Alameda County Environmental Health at 10:00 am, Oct 21, 2014

PO Box 1257
San Ramon, CA 94583
Phone: (925) 275-3804
Mobile: (510) 798-8314
E-Mail: chuck.carmel@bp.com

October 17, 2014

Re: Third Quarter 2014 Status Report
Atlantic Richfield Company Station #4977
2770 Castro Valley Blvd., Castro Valley, California
ACEH Case #RO00002436

"I declare, that to the best of my knowledge at the present time, that the information and/or recommendations contained in the attached document are true and correct."

Submitted by,



Chuck Carmel

Remediation Management Project Manager

Attachment:



**THIRD QUARTER 2014 STATUS REPORT
Atlantic Richfield Company Station #4977
2770 Castro Valley Blvd.
Castro Valley, Alameda County, California**

Prepared for:

Mr. Chuck Carmel
Atlantic Richfield Company
P.O. Box 1257
San Ramon, CA 94583

Prepared by:

Broadbent & Associates, Inc.
4820 Business Center Drive, Suite 110
Fairfield, California 94534
(707) 455-7290

October 17, 2014

No. 06-82-625



4820 Business Center Drive, Suite 110
Fairfield, CA 94534
[T] 707-455-7290 [F] 707-863-9046
broadbentinc.com

Creating Solutions. Building Trust.

October 17, 2014

Project No. 06-82-625

Atlantic Richfield Company
P.O. Box 1257
San Ramon, California 94583
Submitted via ENFOS

Attn.: Mr. Chuck Carmel

Re: Third Quarter 2014 Status Report, Atlantic Richfield Company Station No 4977
2770 Castro Valley Blvd, Castro Valley, California; ACEH Case #RO0002436

Dear Mr. Carmel:

Provided herein is the *Third Quarter 2014 Status Report* for Atlantic Richfield Company (a BP affiliated company) Station No. 4977 located at 2770 Castro Valley Blvd., Castro Valley, Alameda County, California (Site). This report presents a summary of current developments regarding the Site through the Third Quarter 2014.

Should you have questions regarding this submission, please do not hesitate to contact me at (707) 455-7290.

Sincerely,

BROADBENT & ASSOCIATES, INC.

Kristene Tidwell, P.G., C.H.G.
Associate Hydrogeologist

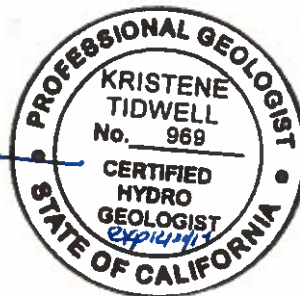

Enclosures

cc: Ms. Karel Detterman, ACEH (Submitted via ACEH ftp Site)
GeoTracker

THIRD QUARTER 2014 STATUS REPORT STATION No. 4977, CASTRO VALLEY, CA

Broadbent & Associates, Inc. (Broadbent) is pleased to present this *Third Quarter 2014 Status Report* on behalf of Atlantic Richfield Company (a BP affiliated company) for Station No. 4977 located in Castro Valley, Alameda County, California. Reporting is being submitted to the Alameda County Environmental Health Services Agency (ACEH) consistent with their requirements under the legal authority of the California Regional Water Quality Control Board as codified by California Code of Regulations Title 23, Section 2652(d). A summary description of current developments regarding the site is provided below.

| | |
|-------------------------------------|---|
| Facility Name / Address: | Station No. 4977 / 2770 Castro Valley Boulevard, Castro Valley, CA |
| Client Project Manager / Title: | Mr. Chuck Carmel / Project Manager |
| Broadbent Contact: | Kristene Tidwell, P.G., C.HG., (707) 455-7290 |
| Broadbent Project No.: | 06-82-625 |
| Primary Regulatory Agency / ID No.: | ACEH, Case #RO0002436 |
| Current phase of project: | Case Closure Evaluation |
| List of Acronyms / Abbreviations: | See end of report text for list of acronyms/abbreviations used in report. |

WORK PERFORMED THIS QUARTER (Third Quarter 2014):

1. Prepared and submitted the *Second Quarter 2014 Status Report* dated July 30, 2014.
2. No environmental work was conducted at the Site during Third Quarter 2014.

WORK PROPOSED FOR NEXT QUARTER (Fourth Quarter 2014):

1. Prepared and submitted this *Third Quarter 2014 Status Report* (contained herein).
2. Conduct well abandonment activities as approved by the ACEH.

GROUNDWATER MONITORING PLAN SUMMARY:

| | |
|--|----------------------------|
| Groundwater level gauging: | Ceased due to case closure |
| Groundwater sample collection: | Ceased due to case closure |
| Biodegradation indicator parameter monitoring: | NA |

DISCUSSION:

No environmental field activities were conducted at the Site during Third Quarter 2014. For reference, a Site Location Map is provided as Drawing 1. Provided as Drawing 2 is the Groundwater Elevation Contour and Analytical Summary Map from the *Fourth Quarter 2013 Semi-Annual Groundwater Monitoring Report* dated January 27, 2014 for groundwater monitoring/sampling conducted on October 9, 2013.

On March 26, 2014, Broadbent submitted the *Conceptual Site Model and Case Closure Request* for Station No. 4977. The ACEH responded asking for an addendum which was prepared and submitted on June 20, 2014. Groundwater monitoring and sampling has been suspended and it is anticipated that the Closure process will be initiated by the ACEH in the near future. Recently, the Ste has been tentatively approved for Case Closure by the ACEH.

ATTACHMENTS:

- Drawing 1 Site Location Map, Station No. 4977, 2770 Castro Valley Boulevard, Castro Valley, California
- Drawing 2. Groundwater Elevation Contour and Analytical Summary Map, Fourth Quarter 2013, Station No. 4977, 2770 Castro Valley Boulevard, Castro Valley, California

LIST OF COMMONLY USED ACCRONYMS/ABBREVIATIONS:

| | | | |
|----------|---|-------------------|--------------------------------|
| ACEH: | Alameda County Environmental Health | gal: | Gallons |
| BTEX: | Benzene, Toluene, Ethylbenzene, Total Xylenes | GRO: | Gasoline-Range Organics |
| 1,2-DCA: | 1,2-Dichloroethane | LNAPL: | Light Non-Aqueous Phase Liquid |
| DIPE: | Di-Isopropyl Ether | MTBE: | Methyl Tertiary Butyl Ether |
| DO: | Dissolved Oxygen | NO ₃ : | Nitrate as Nitrogen |
| DRO: | Diesel-Range Organics | ppb: | parts per billion |
| EDB: | 1,2-Dibromomethane | SO ₄ : | Sulfate |
| ft/ft: | feet per foot | | |

DRAWINGS

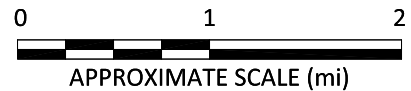
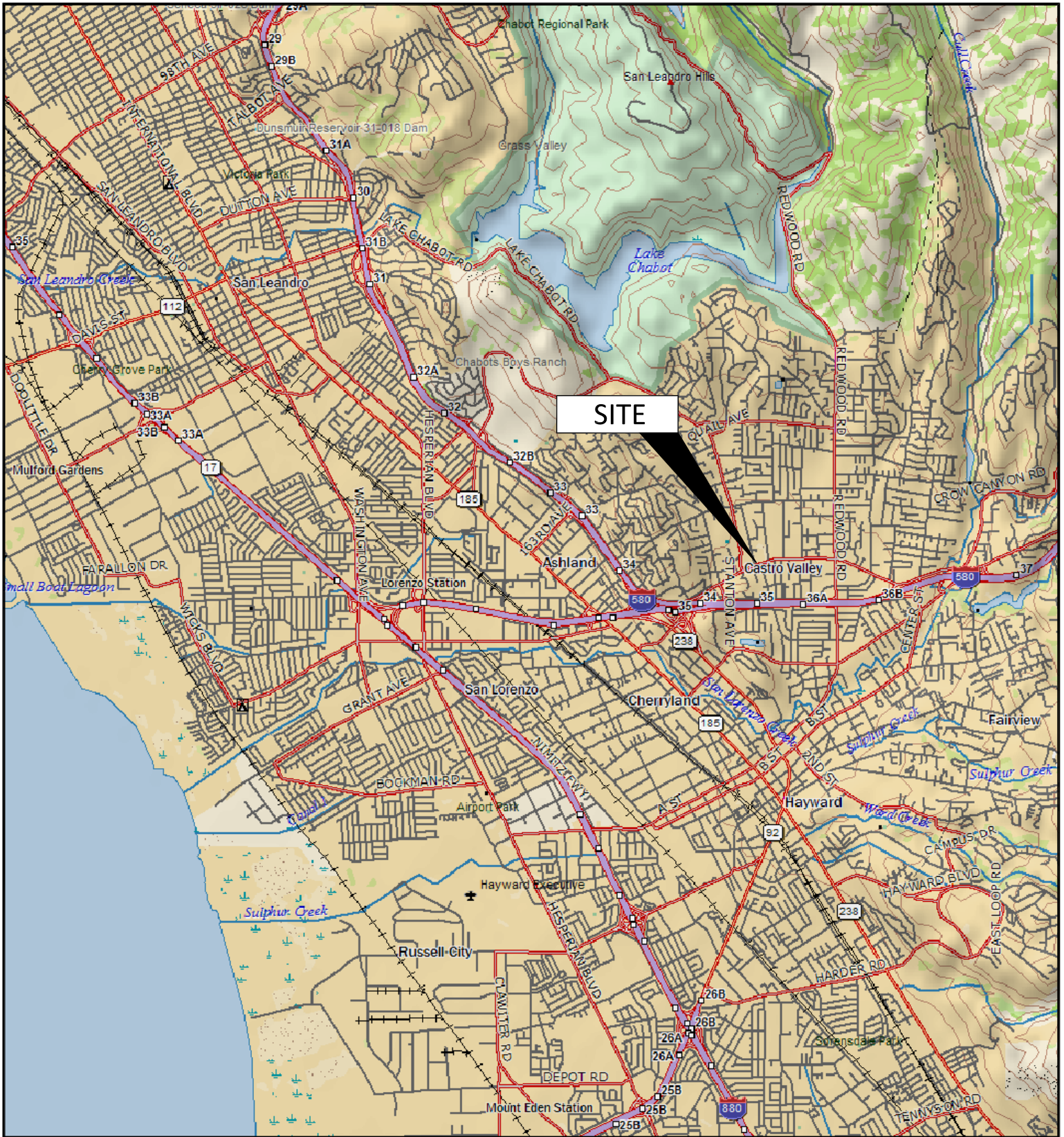

IMAGE SOURCE: DELORME



1370 Ridgewood Dr., Suite 5
Chico, California 95973

Project No.: 06-82-625 Date: 11/29/2012

Station #4977
2770 Castro Valley Blvd.
Castro Valley, California

Site Location Map

Drawing

1

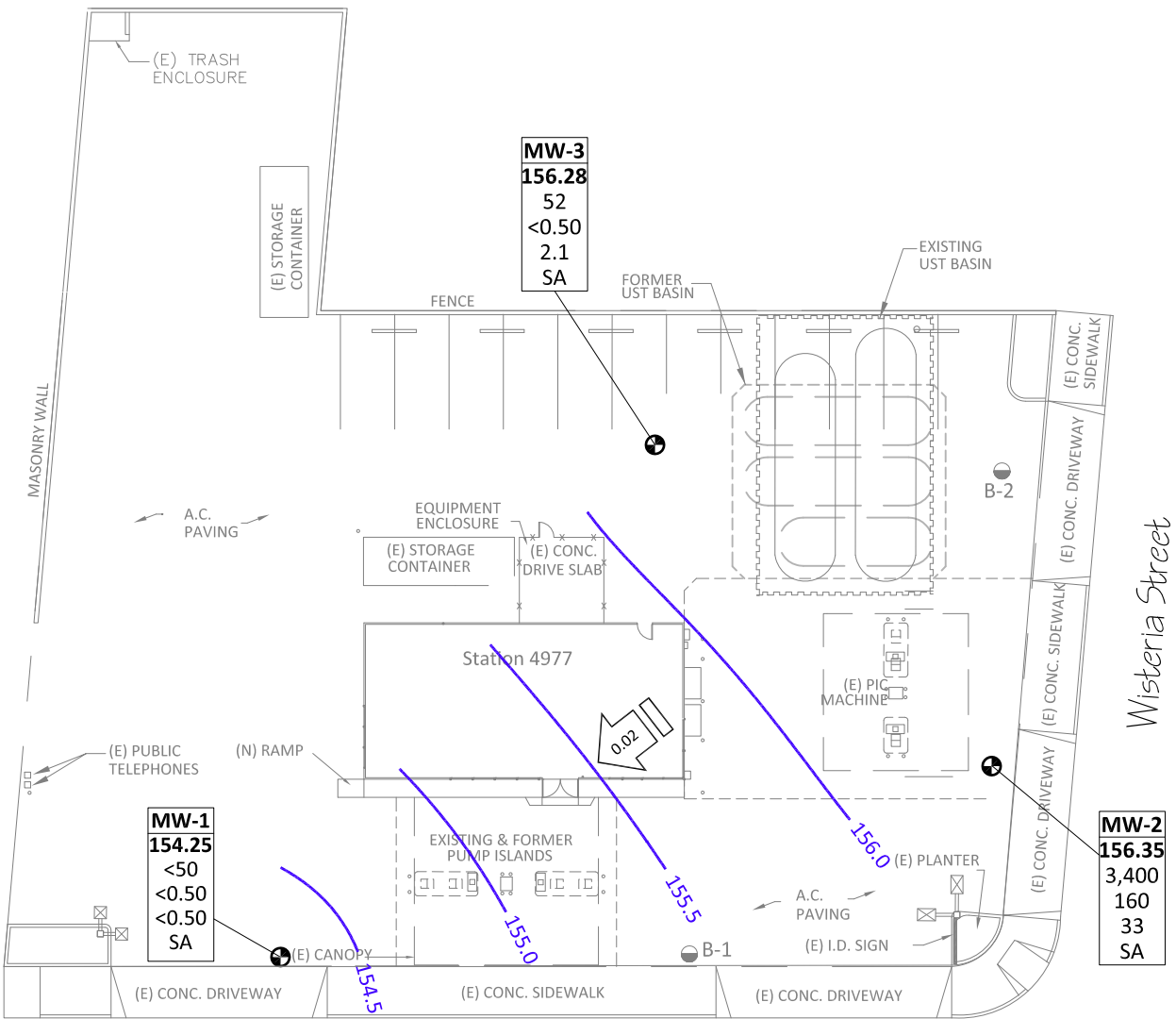

NOTE: SITE MAP ADAPTED FROM DELTA ENVIRONMENTAL FIGURES. SITE DIMENSIONS AND FACILITY LOCATIONS NOT VERIFIED.

Castro Valley Blvd.

LEGEND

⊕ Monitor Well Location

● Soil Boring Location

Well — Well Designation

ELEV — Groundwater Elevation (ft.)

GRO — Concentration of GRO, Benzene and MTBE in Groundwater (µg/L)

SA — Sampling Frequency

< — Not Detected at or Above Laboratory Reporting Limits

SA — Sampled Semi-Annually

155.0 — Groundwater Elevation Contour (ft)

0.02 — Approximate Groundwater Gradient (ft/ft)

