

Atlantic Richfield Company

Chuck Carmel
Environmental Business Manager

PO Box 1257
San Ramon, CA 94583
Phone: (925) 275-3803
Fax: (925) 275-3815
E-Mail: charles.carmel@bp.com

RECEIVED

10:00 am, Apr 26, 2010

Alameda County
Environmental Health

April 20, 2010

Re: First Quarter 2010 Status Report
Atlantic Richfield Company Station #4977
2770 Castro Valley Boulevard, Castro Valley, California
ACEH Case #RO0002436

"I declare, that to the best of my knowledge at the present time, that the information and/or recommendations contained in the attached document are true and correct.

Submitted by,



Chuck Carmel
Environmental Business Manager

Attachment

FIRST QUARTER 2010 STATUS REPORT
Atlantic Richfield Company Station #4977
2770 Castro Valley Boulevard, Castro Valley, California
ACEH Case # RO0002436

Prepared for

Mr. Chuck Carmel
Environmental Business Manager
Atlantic Richfield Company
P.O. Box 1257
San Ramon, California 94583

Prepared by



1324 Mangrove Avenue, Suite 212
Chico, California 95926
(530) 566-1400
www.broadbentinc.com

April 20, 2010

Project No. 06-82-625

April 20, 2010

Project No. 06-82-625

Atlantic Richfield Company
P.O. Box 1257
San Ramon, California 94583
Submitted via ENFOS

Attn.: Mr. Chuck Carmel

Re: First Quarter 2010 Status Report, Atlantic Richfield Company Station #4977
2770 Castro Valley Blvd, Castro Valley, California; ACEH Case #RO0002436

Dear Mr. Carmel:

Provided herein is the *First Quarter 2010 Status Report* for Atlantic Richfield Company (a BP affiliated company) Station #4977 located at 2770 Castro Valley Blvd., Castro Valley, Alameda County, California (Site). This report presents a summary of current developments regarding the Site through the First Quarter 2010.

Should you have questions regarding this submission, please do not hesitate to contact us at (530) 566-1400.

Sincerely,

BROADBENT & ASSOCIATES, INC.



Jason Duda
Project Scientist

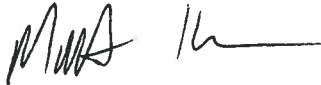

Matthew G. Herrick, P.G., C.HG.
Senior Hydrogeologist

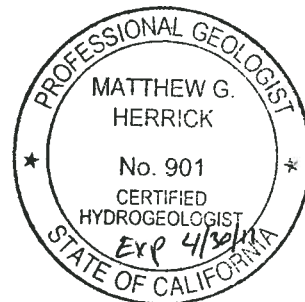

Enclosures

cc: Mr. Paresh Khatri, ACEH (Submitted via ACEH ftp Site)
GeoTracker

STATION #4977 QUARTERLY STATUS REPORT

Facility: #4977	Address:	2770 Castro Valley Boulevard, Castro Valley, California
Environmental Business Manager:		Mr. Chuck Carmel
Consulting Company/Contact Person:		Broadbent & Associates, Inc. (BAI)/ Jason Duda and Matt Herrick (530) 566-1400
Primary Agency/Regulatory ID No.:		Alameda County Environmental Health (ACEH) ACEH Case #RO0002436
Consultant Project No.:		06-82-625

WORK PERFORMED THIS QUARTER (First Quarter 2010):

1. Prepared and submitted the *Fourth Quarter 2009 Ground-Water Monitoring Report* (BAI, 1/05/2010).
2. No environmental field work was conducted at the Site during the First Quarter of 2010.

WORK PROPOSED FOR NEXT QUARTER (Second Quarter 2010):

1. Prepared and submitted this *First Quarter 2010 Status Report* (contained herein).
2. Conduct semi-annual ground-water monitoring/sampling for Second Quarter 2010. Work to be performed by BAI.

QUARTERLY RESULTS SUMMARY:

Current phase of project:	Ground-water monitoring/sampling
Frequency of ground-water monitoring:	Semi-Annually (2Q & 4Q): Wells MW-1, MW-2 and MW-3
Frequency of ground-water sampling:	Semi-Annually (2Q & 4Q): Wells MW-2 and MW-3 Annually (4Q): Well MW-1
Is free product (FP) present on-site:	NA
Current remediation techniques:	NA
Depth to ground water (below TOC):	NA
General ground-water flow direction:	NA
Approximate hydraulic gradient:	NA

DISCUSSION:

No environmental work activities took place at the Site during First Quarter 2010. For reference, a Site Location Map is provided as Drawing 1. Provided as Drawing 2 is the Ground-Water Elevation Contours and Analytical Summary Map from the *Fourth Quarter 2009 Ground-Water Monitoring Report* (BAI, 1/05/2010) for ground-water monitoring/sampling conducted on November 6, 2009.

ATTACHMENTS:

- | | |
|------------|---|
| Drawing 1 | Site Location Map, Station #4977, 2770 Castro Valley Boulevard, Castro Valley, California |
| Drawing 2. | Ground-Water Elevation Contour and Analytical Summary Map, Station #4977, 2770 Castro Valley Boulevard, Castro Valley, California |



APPROXIMATE SCALE (mi)

IMAGE SOURCE: DELORME

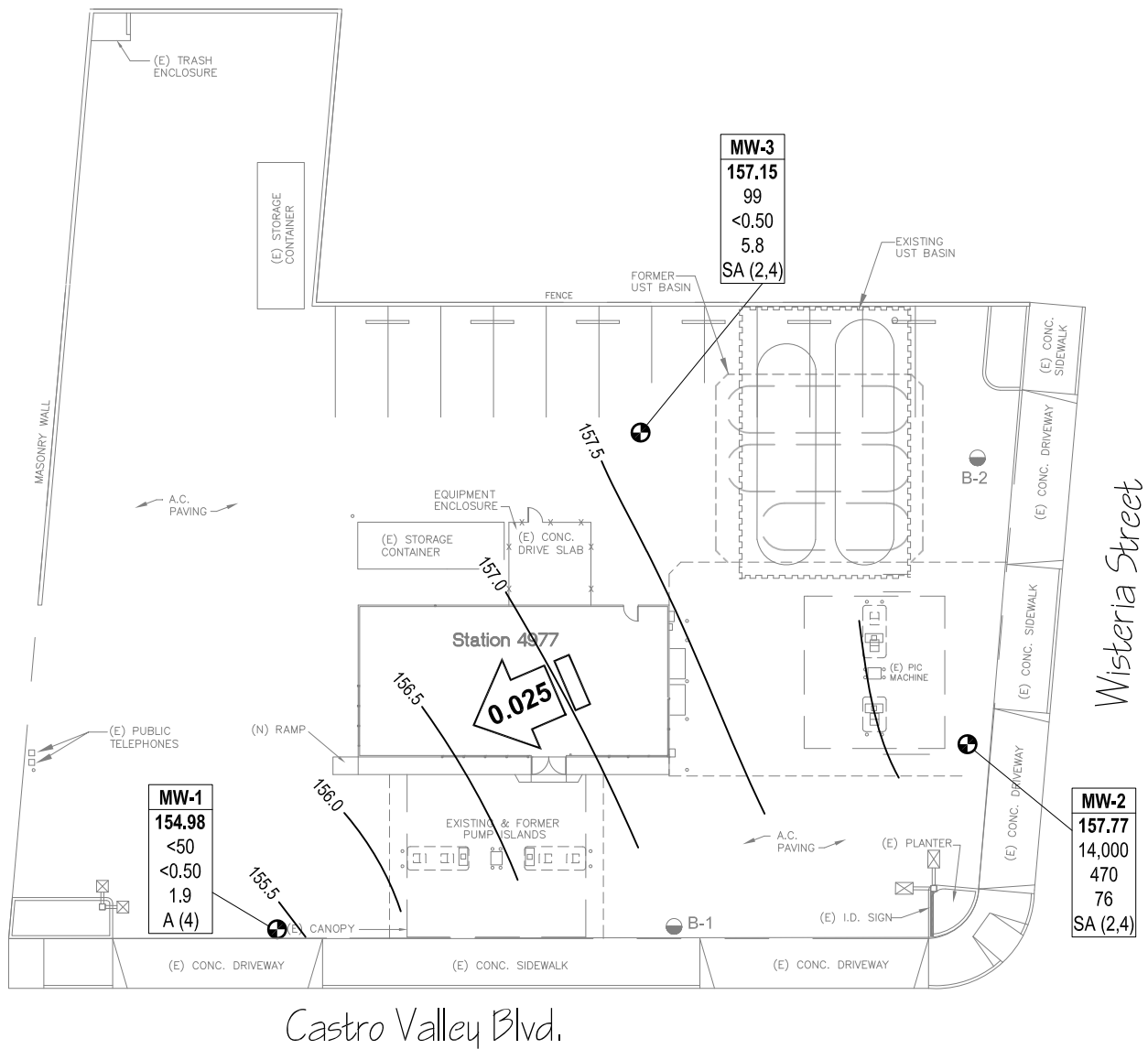

LEGEND

- ⊕ MONITORING WELL
- SOIL BORING

Well	WELL DESIGNATION
ELEV	GROUND-WATER ELEVATION (FT ABOVE MSL)
GRO	CONCENTRATION OF GRO, BENZENE AND MTBE IN GROUND WATER (µg/L)
BZ	
MTBE	
Q	SAMPLING FREQUENCY

- < NOT DETECTED AT OR ABOVE LABORATORY REPORTING LIMITS
- SA/A SAMPLED SEMI-ANNUALLY / SAMPLED ANNUALLY
- 155.5 GROUND-WATER ELEVATION CONTOUR (FT ABOVE MSL)



NOTE: SITE MAP ADAPTED FROM DELTA ENVIRONMENTAL FIGURES. SITE DIMENSIONS AND FACILITY LOCATIONS NOT VERIFIED.

