



Atlantic Richfield Company
(a BP affiliated company)

P.O. Box 1257
San Ramon, CA 94583
Phone: (925) 275-3801
Fax: (925) 275-3815

January 30, 2008

Re: Fourth Quarter, 2007 Ground-Water Monitoring Report
Atlantic Richfield Company Station #4977
2770 Castro Valley Boulevard
Castro Valley, California
ACEH Case No. RO0002436

RECEIVED

2:35 pm, Jan 31, 2008

Alameda County
Environmental Health



“I declare, that to the best of my knowledge at the present time, that the information and/or recommendations contained in the attached document are true and correct.”

Submitted by:

Paul Supple
Environmental Business Manager



A BP affiliated company

Fourth Quarter, 2007 Ground-Water Monitoring Report
Atlantic Richfield Company Station #4977
2770 Castro Valley Boulevard
Castro Valley, California

Prepared for

Mr. Paul Supple
Environmental Business Manager
Atlantic Richfield Company
P.O. Box 1257
San Ramon, California 94583

Prepared by



1324 Mangrove Avenue, Suite 212
Chico, California 95926
(530) 566-1400
www.broadbentinc.com

January 2008

Project No. 06-02-625

Broadbent & Associates, Inc.
1324 Mangrove Ave., Suite 212
Chico, CA 95926
Voice (530) 566-1400
Fax (530) 566-1401



January 30, 2008

Project No. 06-02-625

Atlantic Richfield Company
P.O. Box 1257
San Ramon, California 94583
Submitted via ENFOS

Attn.: Mr. Paul Supple

Re: Fourth Quarter, 2007 Ground-Water Monitoring Report, Atlantic Richfield Company (a BP affiliated company) Station #4977, 2770 Castro Valley Boulevard, Castro Valley, CA. ACEH Case No. RO0002436.

Dear Mr. Supple:

Provided herein is the *Fourth Quarter, 2007 Ground-Water Monitoring Report* for Atlantic Richfield Company Station #4977 (herein referred to as Station #4977) located at 2770 Castro Valley Boulevard, Castro Valley, CA (Property). This report presents a summary of Fourth Quarter, 2007 ground-water monitoring results.

Should you have questions regarding the work performed or results obtained, please do not hesitate to contact us at (530) 566-1400.

Sincerely,

BROADBENT & ASSOCIATES, INC.

A handwritten signature in black ink, appearing to read 'Matt Herrick', written over a horizontal line.

Matthew G. Herrick, P.G.
Project Hydrogeologist

A handwritten signature in black ink, appearing to read 'Robert H. Miller', written over a horizontal line.

Robert H. Miller, P.G., C.H.G.
Principal Hydrogeologist

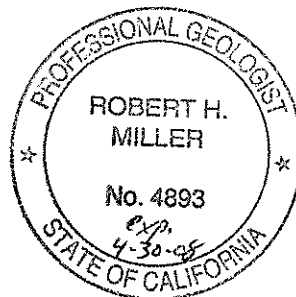

Enclosures

cc: Mr. Steven Plunkett, Alameda County Environmental Health (submitted via ACEH ftp site)

STATION #4977 QUARTERLY GROUND-WATER MONITORING REPORT

Facility: #4977	Address:	2770 Castro Valley Boulevard, Castro Valley, CA
Station #4977	Environmental Business Manager:	Mr. Paul Supple
	Consulting Co./Contact Persons:	Broadbent & Associates, Inc. (BAI) / Rob Miller & Matt Herrick
	Consultant Project No.:	06-02-625
	Facility Permits/Permitting Agency.:	NA

WORK PERFORMED THIS QUARTER (Fourth Quarter, 2007):

1. Submitted Third Quarter, 2007 Ground-Water Monitoring Report. Work performed by BAI.
2. Conducted ground-water monitoring/sampling for Fourth Quarter, 2007. Work performed by Stratus Environmental, Inc.

WORK PROPOSED FOR NEXT QUARTER (First Quarter, 2008):

1. Submit Fourth Quarter, 2007 Ground-Water Monitoring Report (contained herein).
2. Conduct quarterly ground-water monitoring/sampling for First Quarter, 2008.

QUARTERLY RESULTS SUMMARY:

Current phase of project:	Ground-water monitoring/sampling
Frequency of ground-water sampling:	Wells MW-1 through MW-3: Quarterly
Frequency of ground-water monitoring:	Quarterly
Is free product (FP) present on-site:	No
Current remediation techniques:	None
Depth to ground water (below TOC):	6.25 (MW-2) to 8.45 (MW-1) feet
General ground-water flow direction:	South
Approximate hydraulic gradient:	0.027 Feet per foot

DISCUSSION:

Gasoline range organics (GRO) were detected in MW-2 and MW-3 at 16,000 micrograms per liter ($\mu\text{g/L}$) and 460 $\mu\text{g/L}$, respectively. Benzene was detected in MW-2 and MW-3 at 440 $\mu\text{g/L}$ and 3.1 $\mu\text{g/L}$, respectively. Ethylbenzene was detected in MW-2 and MW-3 at 760 $\mu\text{g/L}$ and 15 $\mu\text{g/L}$, respectively. Xylenes were detected in MW-2 and MW-3 at 570 $\mu\text{g/L}$ and 0.89 $\mu\text{g/L}$. Methyl tert-butyl ether (MTBE) was detected in MW-1, MW-2, and MW-3 at concentrations ranging from 2.9 $\mu\text{g/L}$ (MW-1) to 80 $\mu\text{g/L}$ (MW-2). Tert-Butyl alcohol (TBA) was detected in MW-3 at 76 $\mu\text{g/L}$. No other analytes were detected in ground-water samples collected during Fourth Quarter, 2007.

Analytes detected during Fourth Quarter, 2007 were all within the historic minimum and maximum concentration ranges recorded for each well, with the following exceptions: ethylbenzene and xylenes in MW-2 are the lowest concentrations historically detected in the well. Ground-water elevations measured during Fourth Quarter, 2007 were within historic minimum and maximum ranges for each well.

Drawing 1 depicts the ground-water elevation contour and analytical summary map for the Fourth Quarter, 2007. Table 1 includes a summary of ground-water monitoring data including relative water elevations and laboratory analyses. Table 2 provides a summary of fuel additives analytical data. Table 3 presents historical ground-water flow direction and gradient.

CLOSURE:

The findings presented in this report are based upon: observations of Stratus Environmental, Inc. and/or their subcontractor(s) field personnel (see Appendix A), the points investigated, and results of laboratory tests performed by TestAmerica (Morgan Hill, CA). Our services were performed in accordance with the generally accepted standard of practice at the time this report was written. No other warranty, expressed or implied was made. This report has been prepared for the exclusive use of Atlantic Richfield Company. It is possible that variations in soil or ground-water conditions could exist beyond points explored in this investigation. Also, changes in site conditions could occur in the future due to variations in rainfall, temperature, regional water usage, or other factors.

ATTACHMENTS:

- Drawing 1. Ground-Water Elevation Contour and Analytical Summary Map, Station #4977, Castro Valley, CA
- Table 1. Summary of Ground-Water Monitoring Data: Relative Water Elevations and Laboratory Analyses, Station #4977, Castro Valley, CA
- Table 2. Summary of Fuel Additives Analytical Data, Station #4977, Castro Valley, CA
- Table 3. Historical Ground-Water Flow Direction and Gradient, Station #4977, Castro Valley, CA
- Appendix A. Stratus Environmental, Inc. Ground-Water Sampling Data Package (Includes Field Data Sheets, Non-Hazardous Waste Data Form, Chain of Custody Documentation, and Certified Analytical Results)
- Appendix B. GeoTracker Upload Confirmation

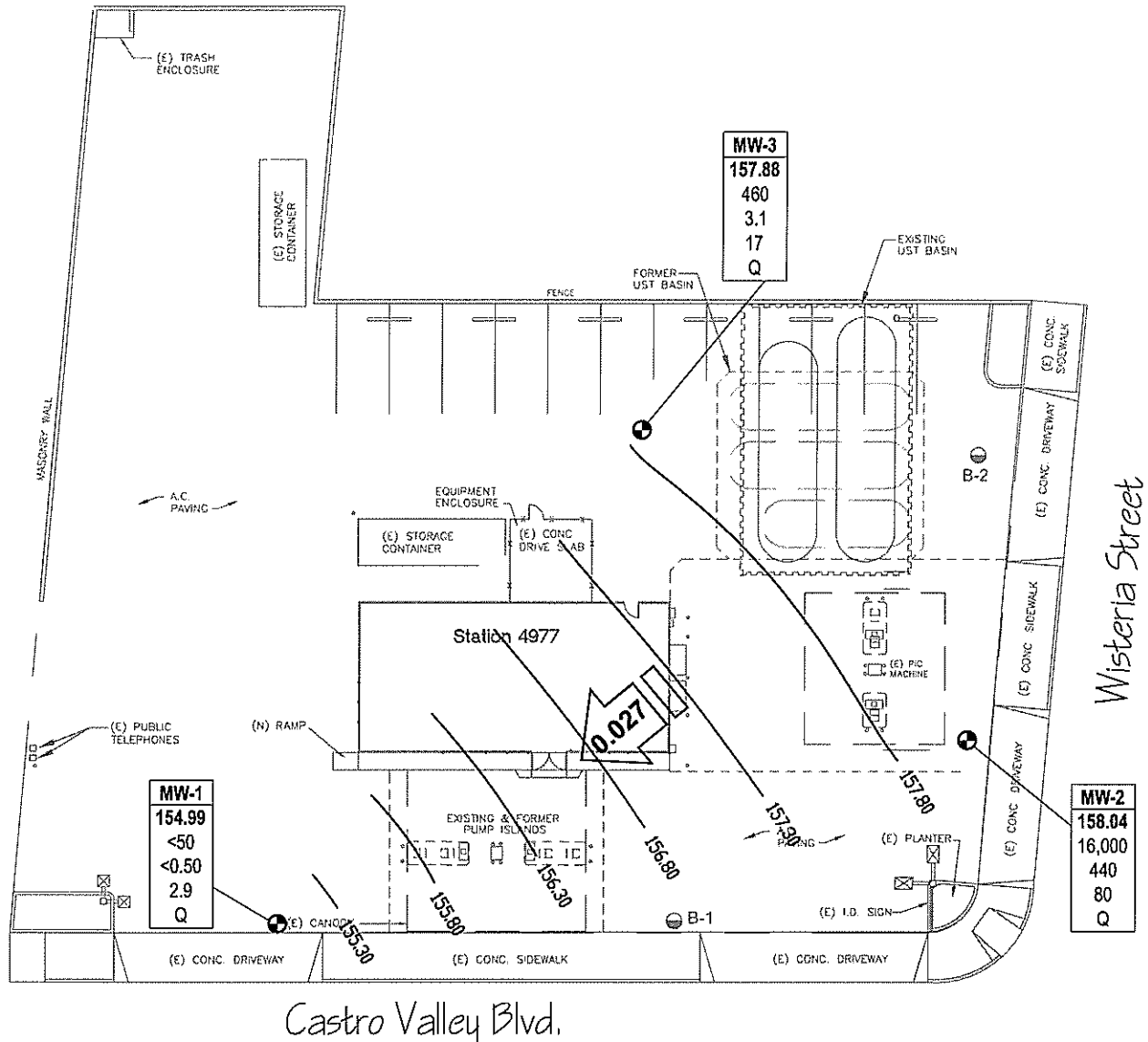

LEGEND

- MONITORING WELL
- SOIL BORING

Well	WELL DESIGNATION
ELEV	GROUND-WATER ELEVATION (FT ABOVE MSL)
GRO	CONCENTRATION OF GRO, BENZENE AND MTBE IN GROUND WATER (µg/L)
BZ	
MTBE	
Q	SAMPLING FREQUENCY

- < NOT DETECTED AT OR ABOVE LABORATORY REPORTING LIMITS
- Q SAMPLED QUARTERLY
- 155.80 GROUND-WATER ELEVATION CONTOUR (FT ABOVE MSL)

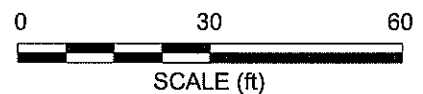
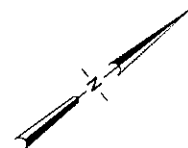

NOTE: SITE MAP ADAPTED FROM DELTA ENVIRONMENTAL FIGURES. SITE DIMENSIONS AND FACILITY LOCATIONS NOT VERIFIED.

Table 1. Summary of Ground-Water Monitoring Data: Relative Water Elevations and Laboratory Analyses

Station #4977, 2770 Castro Valley Blvd., Castro Valley, CA

Well and Sample Date	P/NP	Comments	TOC (feet msl)	Top of Screen (ft bgs)	Bottom of Screen (ft bgs)	DTW (feet bgs)	Water Level Elevation (feet msl)	Concentrations in (µg/L)						DO (mg/L)	pH
								GRO/TPHg	Benzene	Toluene	Ethyl-Benzene	Total Xylenes	MTBE		
MW-1															
4/19/2002	--		161.11	5.0	15.0	11.21	149.90	660	12	1.3	4.3	0.8	38	--	--
9/27/2002	--		161.11	5.0	15.0	9.29	151.82	130	7.7	0.87	5.4	0.79	39	1.7	6.9
12/16/2002	--	a	161.11	5.0	15.0	8.55	152.56	77	1.8	<0.50	0.69	<1.0	42	1.6	6.9
3/11/2003	--		161.11	5.0	15.0	8.07	153.04	140	9.8	<0.50	5.6	<0.50	20	1.4	7.4
6/17/2003	--		161.11	5.0	15.0	8.31	152.80	510	60	1.4	81	<1.0	23	2.2	7
9/18/2003	--	b	161.11	5.0	15.0	9.45	151.66	72	2.4	1.4	1.6	1.5	39	2.7	7
12/11/2003	P		161.11	5.0	15.0	8.80	152.31	79	1.5	<0.50	1.5	4.4	48	2.1	7.0
03/11/2004	P		163.44	5.0	15.0	7.61	155.83	<50	1.3	<0.50	0.77	1.3	17	1.4	6.8
06/02/2004	P		163.44	5.0	15.0	8.95	154.49	53	1.4	<0.50	0.93	<0.50	39	2.3	7.1
09/22/2004	P		163.44	5.0	15.0	9.42	154.02	70	<0.50	<0.50	<0.50	<0.50	48	1.7	6.8
12/15/2004	P		163.44	5.0	15.0	7.88	155.56	63	<0.50	<0.50	<0.50	<0.50	45	1.8	6.9
03/07/2005	P		163.44	5.0	15.0	7.02	156.42	<50	<0.50	<0.50	<0.50	<0.50	4.0	2.4	6.8
06/27/2005	P		163.44	5.0	15.0	7.53	155.91	52	2.0	<0.50	1.9	0.78	8.1	2.8	7.1
09/16/2005	P		163.44	5.0	15.0	9.20	154.24	<50	<0.50	<0.50	<0.50	0.76	14	1.82	6.9
12/27/2005	P		163.44	5.0	15.0	7.60	155.84	<50	1.3	<0.50	1.5	<0.50	9.4	2.02	7.87
03/16/2006	P		163.44	5.0	15.0	6.97	156.47	71	3.0	<0.50	3.5	<0.50	3.4	1.6	7.1
6/26/2006	P		163.44	5.0	15.0	8.58	154.86	71	0.69	<0.50	1.1	3.5	3.2	2.2	6.9
9/29/2006	P		163.44	5.0	15.0	8.85	154.59	<50	<0.50	<0.50	<0.50	<0.50	5.2	2.35	6.7
12/19/2006	P		163.44	5.0	15.0	8.00	155.44	<50	<0.50	<0.50	<0.50	<0.50	4.3	4.80	7.21
3/29/2007	P		163.44	5.0	15.0	7.70	155.74	<50	<0.50	<0.50	<0.50	<0.50	2.3	3.44	7.18
6/5/2007	P		163.44	5.0	15.0	8.77	154.67	<50	<0.50	<0.50	<0.50	<0.50	3.2	3.45	7.29
9/25/2007	P		163.44	5.0	15.0	9.18	154.26	<50	<0.50	<0.50	<0.50	<0.50	5.3	2.61	7.41
12/26/2007	P		163.44	5.0	15.0	8.45	154.99	<50	<0.50	<0.50	<0.50	<0.50	2.9	5.57	7.43
MW-2															
4/19/2002	--		161.87	5.0	15.0	6.59	155.28	28,000	970	120	860	6,900	760	--	--
9/27/2002	--		161.87	5.0	15.0	7.18	154.69	17,000	1,400	<50	1,200	3,700	1,400	1.5	6.8
12/16/2002	--	a	161.87	5.0	15.0	7.31	154.56	17,000	1,000	<50	980	3,300	980	1.9	6.8
3/11/2003	--		161.87	5.0	15.0	6.02	155.85	24,000	1,600	70	1,300	4,300	920	1.7	7.4
6/17/2003	--		161.87	5.0	15.0	6.31	155.56	28,000	1,300	55	1,300	4,500	610	1.4	6.9
9/18/2003	--		161.87	5.0	15.0	7.61	154.26	19,000	960	63	1,100	3,100	580	2.7	6.8

Table 1. Summary of Ground-Water Monitoring Data: Relative Water Elevations and Laboratory Analyses

Station #4977, 2770 Castro Valley Blvd., Castro Valley, CA

Well and Sample Date	P/NP	Comments	TOC (feet msl)	Top of Screen (ft bgs)	Bottom of Screen (ft bgs)	DTW (feet bgs)	Water Level Elevation (feet msl)	Concentrations in (µg/L)						DO (mg/L)	pH
								GRO/TPHg	Benzene	Toluene	Ethyl-Benzene	Total Xylenes	MTBE		
MW-2 Cont.															
12/11/2003	P		161.87	5.0	15.0	6.50	155.37	29,000	710	53	1,300	3,800	490	2.0	7.0
03/11/2004	P		164.29	5.0	15.0	6.02	158.27	19,000	830	49	1,500	4,000	410	0.8	6.5
06/02/2004	P		164.29	5.0	15.0	7.14	157.15	25,000	680	<50	1,300	3,900	240	4.3	7.1
09/22/2004	--		164.29	5.0	15.0	7.63	156.66	15,000	980	<25	980	940	390	--	6.7
12/15/2004	P	c	164.29	5.0	15.0	6.48	157.81	22,000	610	26	1,300	3,200	290	0.3	6.9
03/07/2005	P		164.29	5.0	15.0	6.08	158.21	25,000	570	33	1,400	3,900	120	2.3	6.8
06/27/2005	P		164.29	5.0	15.0	6.90	157.39	24,000	630	32	1,200	2,900	86	2.5	7.2
09/16/2005	P		164.29	5.0	15.0	7.66	156.63	25,000	550	<25	1,400	3,000	82	1.41	7.0
12/27/2005	P		164.29	5.0	15.0	5.60	158.69	33,000	540	<25	1,300	2,700	100	2.26	7.19
03/16/2006	P	c	164.29	5.0	15.0	7.25	157.04	29,000	710	<50	1,400	2,600	78	1.4	7.1
6/26/2006	P	c	164.29	5.0	15.0	6.60	157.69	20,000	630	<25	1,200	1,100	110	0.64	6.8
9/29/2006	P		164.29	5.0	15.0	6.85	157.44	24,000	530	<25	1,300	1,800	86	1.36	6.7
12/19/2006	P		164.29	5.0	15.0	6.02	158.27	21,000	500	<25	1,400	1,700	70	1.11	7.42
3/29/2007	P		164.29	5.0	15.0	6.03	158.26	16,000	530	<25	1,100	1,100	80	2.98	7.18
6/5/2007	P		164.29	5.0	15.0	6.85	157.44	21,000	420	<25	1,100	1,100	50	2.09	7.20
9/25/2007	P		164.29	5.0	15.0	7.15	157.14	25,000	620	<25	1,400	1,200	70	3.25	7.59
12/26/2007	P		164.29	5.0	15.0	6.25	158.04	16,000	440	<5.0	760	570	80	1.84	7.66
MW-3															
4/19/2002	--		162.14	5.0	15.0	6.94	155.20	1,200	29	1.1	43	62	1,700	--	--
9/27/2002	--		162.14	5.0	15.0	8.26	153.88	740	7.8	<2.5	6.8	4.4	1,100	1	6.7
12/16/2002	--	a	162.14	5.0	15.0	6.76	155.38	1,200	13	<10	170	88	910	2.3	6.8
3/11/2003	--		162.14	5.0	15.0	6.92	155.22	<2,500	<25	<25	<25	<25	470	1.7	7.5
6/17/2003	--		162.14	5.0	15.0	7.44	154.70	<1,000	<10	<10	14	<10	530	1.9	7
9/18/2003	--		162.14	5.0	15.0	8.43	153.71	470	4.8	<2.5	10	9.2	300	2.9	6.8
12/11/2003	P		162.14	5.0	15.0	6.72	155.42	<500	<5.0	<5.0	7.0	13	180	1.9	6.9
03/11/2004	P		164.53	5.0	15.0	6.09	158.44	360	1.9	<1.0	5.6	5.0	110	2.6	6.8
06/02/2004	P		164.53	5.0	15.0	7.50	157.03	380	2.8	<0.50	8.0	2.1	43	3.6	7.3
09/22/2004	P		164.53	5.0	15.0	8.00	156.53	270	<0.50	<0.50	0.54	<0.50	50	1.8	6.9
12/15/2004	P		164.53	5.0	15.0	6.43	158.10	390	3.5	<0.50	20	3.7	49	1.1	6.9
03/07/2005	P		164.53	5.0	15.0	6.12	158.41	1,900	13	<1.0	93	29	70	2.3	6.8

Table 1. Summary of Ground-Water Monitoring Data: Relative Water Elevations and Laboratory Analyses

Station #4977, 2770 Castro Valley Blvd., Castro Valley, CA

Well and Sample Date	P/NP	Comments	TOC (feet msl)	Top of Screen (ft bgs)	Bottom of Screen (ft bgs)	DTW (feet bgs)	Water Level Elevation (feet msl)	Concentrations in (µg/L)						DO (mg/L)	pH
								GRO/TPHg	Benzene	Toluene	Ethyl-Benzene	Total Xylenes	MTBE		
MW-3 Cont.															
06/27/2005	P		164.53	5.0	15.0	7.08	157.45	830	4.0	<0.50	13	2.8	33	3.3	7.3
09/16/2005	P		164.53	5.0	15.0	7.28	157.25	320	2.1	<0.50	5.4	0.60	21	2.11	7.0
12/27/2005	P		164.53	5.0	15.0	6.47	158.06	770	6.0	<0.50	33	2.7	36	2.96	7.42
03/16/2006	P		164.53	5.0	15.0	6.10	158.43	1,600	11	<0.50	59	6.4	45	1.4	7.1
6/26/2006	P		164.53	5.0	15.0	6.92	157.61	400	<0.50	<0.50	1.6	2.1	26	2.41	7.0
9/29/2006	P		164.53	5.0	15.0	7.38	157.15	220	0.86	<0.50	2.2	0.58	14	1.95	7.0
12/19/2006	P		164.53	5.0	15.0	6.65	157.88	450	4.3	<0.50	19	1.4	19	3.68	7.30
3/29/2007	P		164.53	5.0	15.0	6.92	157.61	390	3.0	<0.50	9.1	0.60	27	1.98	7.16
6/5/2007	P		164.53	5.0	15.0	7.01	157.52	390	1.9	<0.50	6.9	<0.50	20	1.99	7.34
9/25/2007	P		164.53	5.0	15.0	7.52	157.01	260	1.3	<0.50	2.7	<0.50	12	3.44	7.41
12/26/2007	P		164.53	5.0	15.0	6.65	157.88	460	3.1	<0.50	15	0.89	17	4.05	7.46

SYMBOLS AND ABBREVIATIONS:

< = Not detected at or above specified laboratory reporting limits

-- = Not measured, sampled, analyzed, applicable

ft bgs = Feet below ground surface

DO = Dissolved oxygen

DTW = Depth to water in ft bgs

GRO = Gasoline range organics

GWE = Groundwater elevation in ft MSL

mg/L = Milligrams per liter

ft MSL = Feet above mean sea level

MTBE = Methyl tert-butyl ether analyzed by EPA Method 8021B unless otherwise noted (before 12/16/02)

P/NP = Well was purged/not purged prior to sampling

TPH-g = Total petroleum hydrocarbons as gasoline (C5-C9)

TOC = Top of casing measured in ft MSL

µg/L = Micrograms per liter

FOOTNOTES:

a = TPH, benzene, toluene, ethylbenzene, total xylenes, and MTBE analyzed by EPA Method 8260B beginning on 4th quarter sampling event (12/16/02).

b = This sample was originally analyzed within the EPA recommended hold time. Re-analysis for confirmation or dilution was performed past the recommended hold time. The results may still be used for their intended purpose.

c = Sheen in well.

NOTES:

Beginning in the fourth quarter 2003, the laboratory modified the reported analyte list. TPH-g was changed to GRO. The resulting data may be impacted by the potential inclusion of non-TPH-g analytes within the requested fuel range resulting in a higher concentration being reported.

Wells were re-surveyed on 3/23/2004.

Values for DO and pH were field measurements.

Beginning in the second quarter 2004, the carbon range for GRO was changed from C6-C10 to C4-C12.

Note: The data within this table collected prior to April 2006 was provided to Broadbent & Associates, Inc. by Atlantic Richfield Company and their previous consultants. Broadbent & Associates, Inc. has not verified the accuracy of this information.

Table 2. Summary of Fuel Additives Analytical Data
Station #4977, 2770 Castro Valley Blvd., Castro Valley, CA

Well and Sample Date	Concentrations in (µg/L)								Comments
	Ethanol	TBA	MTBE	DIPE	ETBE	TAME	1,2-DCA	EDB	
MW-1									
12/16/2002	<50	<5.0	42	<0.50	<0.50	<0.50	<0.50	<0.50	
3/11/2003	<100	<20	20	<0.50	<0.50	<0.50	<0.50	<0.50	
6/17/2003	<200	<40	23	<1.0	<1.0	<1.0	<1.0	<1.0	
9/18/2003	<100	<20	39	<0.50	<0.50	<0.50	<0.50	<0.50	a
12/11/2003	<100	<20	48	<0.50	<0.50	<0.50	<0.50	<0.50	
03/11/2004	<100	<20	17	<0.50	<0.50	<0.50	<0.50	<0.50	
06/02/2004	<100	<20	39	<0.50	<0.50	<0.50	<0.50	<0.50	
09/22/2004	<100	<20	48	<0.50	<0.50	<0.50	<0.50	<0.50	
12/15/2004	<100	<20	45	<0.50	<0.50	<0.50	<0.50	<0.50	a
03/07/2005	<100	<20	4.0	<0.50	<0.50	<0.50	<0.50	<0.50	
06/27/2005	<100	<20	8.1	<0.50	<0.50	<0.50	<0.50	<0.50	
09/16/2005	<100	<20	14	<0.50	<0.50	<0.50	<0.50	<0.50	
12/27/2005	<100	<20	9.4	<0.50	<0.50	<0.50	<0.50	<0.50	b
03/16/2006	<300	<20	3.4	<0.50	<0.50	<0.50	<0.50	<0.50	c
6/26/2006	<300	<20	3.2	<0.50	<0.50	<0.50	<0.50	<0.50	
9/29/2006	<300	<20	5.2	<0.50	<0.50	<0.50	<0.50	<0.50	
12/9/2006	<300	<20	4.3	<0.50	<0.50	<0.50	<0.50	—	b
3/29/2007	<300	<20	2.3	<0.50	<0.50	<0.50	<0.50	<0.50	
6/5/2007	<300	<20	3.2	<0.50	<0.50	<0.50	<0.50	<0.50	
9/25/2007	<300	<20	5.3	<0.50	<0.50	<0.50	<0.50	<0.50	
12/26/2007	<300	<20	2.9	<0.50	<0.50	<0.50	<0.50	<0.50	
MW-2									
12/16/2002	<5,000	<500	980	<50	<50	<50	<50	<50	
3/11/2003	<10,000	<2,000	920	<50	<50	<50	<50	<50	
6/17/2003	<10,000	<2,000	610	<50	<50	<50	<50	<50	
9/18/2003	<5,000	<1,000	580	<25	<25	<25	<25	<25	
12/11/2003	<5,000	<1,000	490	<25	<25	<25	<25	<25	
03/11/2004	<2,000	<400	410	<10	<10	<10	<10	<10	
06/02/2004	<10,000	<2,000	240	<50	<50	<50	<50	<50	
09/22/2004	<5,000	<1,000	390	<25	<25	<25	<25	<25	
12/15/2004	<2,000	<400	290	<10	<10	<10	<10	<10	a

**Table 2. Summary of Fuel Additives Analytical Data
Station #4977, 2770 Castro Valley Blvd., Castro Valley, CA**

Well and Sample Date	Concentrations in (µg/L)								Comments
	Ethanol	TBA	MTBE	DIPE	ETBE	TAME	1,2-DCA	EDB	
MW-2 Cont.									
03/07/2005	<5,000	<1,000	120	<25	<25	<25	<25	<25	
06/27/2005	<5,000	<1,000	86	<25	<25	<25	<25	<25	
09/16/2005	<5,000	<1,000	82	<25	<25	<25	<25	<25	
12/27/2005	<5,000	<1,000	100	<25	<25	<25	<25	<25	b
03/16/2006	<30,000	<2,000	78	<50	<50	<50	<50	<50	c
6/26/2006	<15,000	<1,000	110	<25	<25	<25	<25	<25	
9/29/2006	<15,000	<1,000	86	<25	<25	<25	<25	<25	
12/9/2006	<15,000	<1,000	70	<25	<25	<25	<25	--	b
3/29/2007	<15,000	<1,000	80	<25	<25	<25	<25	<25	
6/5/2007	<15,000	<1,000	50	<25	<25	<25	<25	<25	
9/25/2007	<15,000	<1,000	70	<25	<25	<25	<25	<25	
12/26/2007	<3,000	<200	80	<5.0	<5.0	<5.0	<5.0	<5.0	
MW-3									
12/16/2002	<1,000	<100	910	<10	<10	12	<10	<10	
3/11/2003	<5,000	<1,000	470	<25	<25	<25	<25	<25	
6/17/2003	<2,000	<400	530	<10	<10	<10	<10	<10	
9/18/2003	<500	<100	300	<2.5	<2.5	3.2	<2.5	<2.5	
12/11/2003	<1,000	<200	180	<5.0	<5.0	<5.0	<5.0	<5.0	
03/11/2004	<200	570	110	<1.0	<1.0	<1.0	<1.0	<1.0	
06/02/2004	<100	130	43	<0.50	<0.50	0.56	<0.50	<0.50	
09/22/2004	<100	28	50	<0.50	<0.50	0.51	<0.50	<0.50	
12/15/2004	<100	110	49	<0.50	0.52	0.61	<0.50	<0.50	a
03/07/2005	<200	190	70	<1.0	<1.0	<1.0	<1.0	<1.0	
06/27/2005	<100	130	33	<0.50	<0.50	<0.50	<0.50	<0.50	
09/16/2005	<100	44	21	<0.50	<0.50	<0.50	<0.50	<0.50	
12/27/2005	<100	150	36	<0.50	<0.50	<0.50	<0.50	<0.50	b
03/16/2006	<300	160	45	<0.50	<0.50	0.84	<0.50	<0.50	c
6/26/2006	<300	53	26	<0.50	<0.50	<0.50	<0.50	<0.50	
9/29/2006	<300	55	14	<0.50	<0.50	<0.50	<0.50	<0.50	
12/9/2006	<300	<20	19	<0.50	<0.50	<0.50	<0.50	--	b
3/29/2007	<300	130	27	<0.50	<0.50	<0.50	<0.50	<0.50	

Table 2. Summary of Fuel Additives Analytical Data
Station #4977, 2770 Castro Valley Blvd., Castro Valley, CA

Well and Sample Date	Concentrations in (µg/L)								Comments
	Ethanol	TBA	MTBE	DIPE	ETBE	TAME	1,2-DCA	EDB	
MW-3 Cont.									
6/5/2007	<300	77	20	<0.50	<0.50	<0.50	<0.50	<0.50	
9/25/2007	<300	30	12	<0.50	<0.50	<0.50	<0.50	<0.50	
12/26/2007	<300	76	17	<0.50	<0.50	<0.50	<0.50	<0.50	

SYMBOLS AND ABBREVIATIONS:

< = Not detected at or above specified laboratory reporting limit

1,2-DCA = 1,2-Dichloroethane

DIPE = Di-isopropyl ether

EDB = 1,2-Dibromoethane

ETBE = Ethyl tert-butyl ether

MTBE = Methyl tert-butyl ether

TAME = tert-Amyl methyl ether

TBA = tert-Butyl alcohol

µg/L = Micrograms per liter

FOOTNOTES:

a = This sample was originally analyzed within the EPA recommended hold time. Re-analysis for confirmation or dilution was performed past the recommended hold time. The results may still be used for their intended purpose.

b = Calibration verification for ethanol was within method limits but outside contract limits.

c = Possible high bias for DIPE, 1,2-DCA, and ethanol due to CCV falling outside acceptance criteria.

Note: The data within this table collected prior to April 2006 was provided to Broadbent & Associates, Inc. by Atlantic Richfield Company and their previous consultants. Broadbent & Associates, Inc. has not verified the accuracy of this information.

**Table 3. Historical Ground-Water Flow Direction and Gradient
Station #4977, 2770 Castro Valley Blvd., Castro Valley, CA**

Date Sampled	Approximate Flow Direction	Approximate Hydraulic Gradient
4/19/2002	Southwest	0.038
9/27/2002	Southwest	0.021
12/16/2002	Southeast	0.029
3/11/2003	South	0.024
6/17/2003	South-Southwest	0.022
9/18/2003	South-Southwest	0.022
3/11/2004	South-Southwest	0.024
6/2/2004	South	0.025
9/22/2004	South	0.025
12/15/2004	South	0.020
3/7/2005	South	0.02
6/27/2005	South	0.01
9/16/2005	Southeast	0.03
12/27/2005	South-Southeast	0.02
3/16/2006	Southeast	0.02
6/26/2006	South	0.03
9/29/2006	South	0.025
12/19/2006	South	0.024
3/29/2007	South	0.020
6/5/2007	South	0.027
9/25/2007	South	0.023
12/26/2007	South	0.027

Note: The data within this table collected prior to April 2006 was provided to Broadbent & Associates, Inc. by Atlantic Richfield Company and their previous consultants. Broadbent & Associates, Inc. has not verified the accuracy of this information.

APPENDIX A

STRATUS ENVIRONMENTAL, INC. GROUND-WATER SAMPLING DATA PACKAGE
(INCLUDES FIELD DATA SHEETS, NON-HAZARDOUS WASTE DATA FORM,
CHAIN OF CUSTODY DOCUMENTATION, AND CERTIFIED ANALYTICAL
RESULTS)



3330 Cameron Park Drive, Ste 550
Cameron Park, California 95682
(530) 676-6004 ~ Fax: (530) 676-6005

January 15, 2008

Mr. Rob Miller
Broadbent & Associates, Inc.
2000 Kirman Avenue
Reno, NV 89502

Re: Groundwater Sampling Data Package, BP Service Station No. 4977, located at
2770 Castro Valley Road, Castro Valley, California

General Information

Data Submittal Prepared / Reviewed by: Sandy Hayes / Jay Johnson

Phone Number: (530) 676-6000

On-Site Supplier Representative: Jerry Gonzales

Sampling Date: December 26, 2007

Arrival: 08:30 *Departure:* 10:30

Weather Conditions: Clear

Unusual Field Conditions: None

Scope of Work Performed: Quarterly monitoring and sampling

Variations from Work Scope: None

This submittal presents the tabulation of data collected in association with routine groundwater monitoring. The attachments include field data sheets, non-hazardous waste data form, chain of custody documentation, and certified analytical results. The information is being provided to BP-ARCO's Scoping Supplier for use in preparing a report for regulatory submittal. This submittal is limited to presentation of collected data and does not include data interpretation or conclusions or recommendations. Any questions concerning this submittal should be addressed to the Preparer/Reviewer identified above.

Sincerely,

STRATUS ENVIRONMENTAL, INC

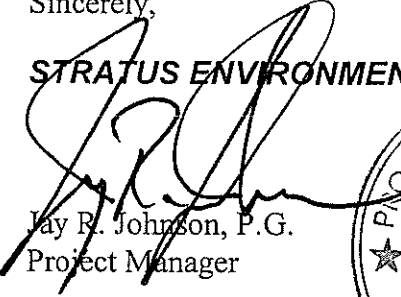
Jay R. Johnson, P.G.
Project Manager

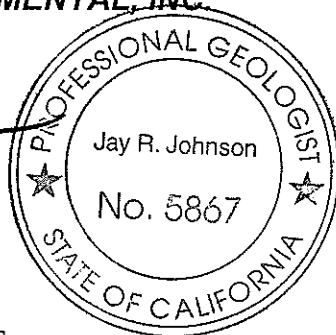

Attachments:

- Field Data Sheets
- Non-Hazardous Waste Data Form
- Chain of Custody Documentation
- Certified Analytical Results

CC: Mr. Paul Supple, BP/ARCO

BP ALAMEDA PORTFOLIO
WATER SAMPLE FIELD DATA SHEET

PROJECT #: 4977 PURGED BY: JG WELL I.D.: MW-1
 CLIENT NAME: _____ SAMPLED BY: JG SAMPLE I.D.: MW-1
 LOCATION: Castro Valley - 2770 Castro Valley Road QA SAMPLES: _____

DATE PURGED 12-26-07 START (2400hr) 9:38 END (2400hr) 9:41
 DATE SAMPLED 12-26-07 SAMPLE TIME (2400hr) 10:20
 SAMPLE TYPE: Groundwater Surface Water _____ Treatment Effluent _____ Other _____

CASING DIAMETER: 2" _____ 3" _____ 4" 5" _____ 6" _____ 8" _____ Other _____
 Casing Volume: (gallons per foot) (0.17) (0.38) (0.67) (1.02) (1.50) (2.60) ()

DEPTH TO BOTTOM (feet) = 15.00 CASING VOLUME (gal) = 4.3
 DEPTH TO WATER (feet) = 8.45 CALCULATED PURGE (gal) = 13.1
 WATER COLUMN HEIGHT (feet) = 6.5 ACTUAL PURGE (gal) = 13.5

FIELD MEASUREMENTS

DATE	TIME (2400hr)	VOLUME (gal)	TEMP. (degrees F)	CONDUCTIVITY (umhos/cm)	pH (units)	COLOR (visual)	TURBIDITY (NTU)
<u>12-26-07</u>	<u>9:38</u>	<u>4.3</u>	<u>20.8</u>	<u>1109</u>	<u>7.57</u>	<u>Clear</u>	
<u>1</u>	<u>9:40</u>	<u>9.0</u>	<u>21.5</u>	<u>1151</u>	<u>7.48</u>	<u>1</u>	
<u>1</u>	<u>9:41</u>	<u>13.5</u>	<u>21.3</u>	<u>1225</u>	<u>7.43</u>	<u>1</u>	

SAMPLE INFORMATION

SAMPLE DEPTH TO WATER: 10:15 SAMPLE TURBIDITY: Clear

80% RECHARGE: YES NO ANALYSES: S.W.O
 ODOR: Yes SAMPLE VESSEL / PRESERVATIVE: 3 Vol. HCC

PURGING EQUIPMENT

Bladder Pump Bailer (Teflon)
 Centrifugal Pump Bailer (PVC)
 Submersible Pump Bailer (Stainless Steel)
 Peristaltic Pump Dedicated _____
 Other: _____
 Pump Depth: 14

SAMPLING EQUIPMENT

Bladder Pump Bailer (Teflon)
 Centrifugal Pump Bailer (PVC or disposable)
 Submersible Pump Bailer (Stainless Steel)
 Peristaltic Pump Dedicated _____
 Other: _____

WELL INTEGRITY: Good LOCK#: Master

REMARKS: Do SSS

SIGNATURE: [Signature] Page _____ of _____

BP ALAMEDA PORTFOLIO
WATER SAMPLE FIELD DATA SHEET

PROJECT #: 4977 PURGED BY: JG WELL I.D.: MW-2
 CLIENT NAME: _____ SAMPLED BY: JG SAMPLE I.D.: MW-2
 LOCATION: Castro Valley - 2770 Castro Valley Road QA SAMPLES: _____

DATE PURGED 12-26-09 START (2400hr) 9:12 END (2400hr) 9:15
 DATE SAMPLED 12-26-09 SAMPLE TIME (2400hr) 9:55
 SAMPLE TYPE: Groundwater Surface Water _____ Treatment Effluent _____ Other _____

CASING DIAMETER: 2" _____ 3" _____ 4" 5" _____ 6" _____ 8" _____ Other _____
 Casing Volume: (gallons per foot) (0.17) (0.38) (0.67) (1.02) (1.50) (2.60) ()

DEPTH TO BOTTOM (feet) = 1458 CASING VOLUME (gal) = 5.5
 DEPTH TO WATER (feet) = 6.25 CALCULATED PURGE (gal) = 16.6
 WATER COLUMN HEIGHT (feet) = 8.3 ACTUAL PURGE (gal) = 17.0

FIELD MEASUREMENTS

DATE	TIME (2400hr)	VOLUME (gal)	TEMP. (degrees F)	CONDUCTIVITY (umhos/cm)	pH (units)	COLOR (visual)	TURBIDITY (NTU)
<u>12-26-09</u>	<u>9:12</u>	<u>5.5</u>	<u>16.7</u>	<u>813</u>	<u>7.73</u>	<u>cloud</u>	_____
<u>1</u>	<u>9:14</u>	<u>11.5</u>	<u>19.7</u>	<u>823</u>	<u>5.90</u>	<u>clear</u>	_____
<u>1</u>	<u>9:15</u>	<u>17.0</u>	<u>19.5</u>	<u>896</u>	<u>7.66</u>	<u>1</u>	<u>DRY</u>

SAMPLE DEPTH TO WATER: 8.19 SAMPLE INFORMATION SAMPLE TURBIDITY: clear

80% RECHARGE: YES NO ANALYSES: S-W-O
 ODOR: Yes SAMPLE VESSEL/PRESERVATIVE: 3 Vol-HCC

PURGING EQUIPMENT
 Bladder Pump Bailer (Teflon)
 Centrifugal Pump Bailer (PVC)
 Submersible Pump Bailer (Stainless Steel)
 Peristaltic Pump Dedicated _____
 Other: _____
 Pump Depth: 1900

SAMPLING EQUIPMENT
 Bladder Pump Bailer (Teflon)
 Centrifugal Pump Bailer (PVC or disposable)
 Submersible Pump Bailer (Stainless Steel)
 Peristaltic Pump Dedicated _____
 Other: _____

WELL INTEGRITY: good LOCK#: MOST-2

REMARKS: DD-1.84

SIGNATURE: _____ Page ____ of ____

BP ALAMEDA PORTFOLIO
WATER SAMPLE FIELD DATA SHEET

PROJECT #: 4977 PURGED BY: JG WELL I.D.: MW 3
 CLIENT NAME: _____ SAMPLED BY: JG SAMPLE I.D.: MW 3
 LOCATION: Castro Valley - 2770 Castro Valley Road QA SAMPLES: _____

DATE PURGED 12.26.07 START (2400hr) 9:26 END (2400hr) 9:31
 DATE SAMPLED 12.26.07 SAMPLE TIME (2400hr) 10:03
 SAMPLE TYPE: Groundwater x Surface Water _____ Treatment Effluent _____ Other _____

CASING DIAMETER: 2" _____ 3" _____ 4" x 5" _____ 6" _____ 8" _____ Other _____
 Casing Volume: (gallons per foot) (0.17) (0.38) (0.67) (1.02) (1.50) (2.60) _____

DEPTH TO BOTTOM (feet) = 14.85 CASING VOLUME (gal) = 5.7
 DEPTH TO WATER (feet) = 6.65 CALCULATED PURGE (gal) = 17.1
 WATER COLUMN HEIGHT (feet) = 8.2 ACTUAL PURGE (gal) = 17.6

FIELD MEASUREMENTS

DATE	TIME (2400hr)	VOLUME (gal)	TEMP. (degrees F)	CONDUCTIVITY (umhos/cm)	pH (units)	COLOR (visual)	TURBIDITY (NTU)
<u>12.26.07</u>	<u>9:28</u>	<u>5.7</u>	<u>21.3</u>	<u>691</u>	<u>7.63</u>	<u>Clear</u>	_____
<u>/</u>	<u>9:30</u>	<u>14.6</u>	<u>21.7</u>	<u>672</u>	<u>7.51</u>	<u>/</u>	_____
<u>/</u>	<u>9:31</u>	<u>17.6</u>	<u>21.5</u>	<u>667</u>	<u>7.46</u>	<u>/</u>	_____

SAMPLE INFORMATION

SAMPLE DEPTH TO WATER: 8.41 SAMPLE TURBIDITY: Clear
 80% RECHARGE: X YES _____ NO _____ ANALYSES: SWD
 ODOR: Yes SAMPLE VESSEL / PRESERVATIVE: 6 Vol-HCC

PURGING EQUIPMENT

Bladder Pump _____ Bailer (Teflon) _____
X Centrifugal Pump _____ Bailer (PVC) _____
 Submersible Pump _____ Bailer (Stainless Steel) _____
 Peristaltic Pump _____ Dedicated _____
 Other: _____
 Pump Depth: 19

SAMPLING EQUIPMENT

Bladder Pump _____ Bailer (Teflon) _____
 Centrifugal Pump _____ Bailer (_____ PVC or Xdisposable) _____
 Submersible Pump _____ Bailer (Stainless Steel) _____
 Peristaltic Pump _____ Dedicated _____
 Other: _____

WELL INTEGRITY: good LOCK#: MOST 4
 REMARKS: DO 4.05

SIGNATURE: [Signature] Page _____ of _____

NO. 665072

NON-HAZARDOUS WASTE DATA FORM

TO BE COMPLETED BY GENERATOR

NAME: BP WEST COAST PRODUCTS LLC ARCO # 4997 EPA I.D. NO. NOT REQUIRED

ADDRESS: P.O. BOX 80249 PROFILE NO. [REDACTED]

RANCHO SANTA MARGARITA

CITY, STATE, ZIP: CA 92658 PHONE NO. () _____

CONTAINERS: No. _____ VOLUME 48.1 WEIGHT _____

TYPE: TANK TRUCK DUMP TRUCK DRUMS CARTONS OTHER _____

WASTE DESCRIPTION COMPONENTS OF WASTE			GENERATING PROCESS COMPONENTS OF WASTE		
	PPM	%		PPM	%
1. <u>WATER</u>	<u>99-100%</u>		5. _____		
2. <u>TPH</u>	<u><1%</u>		6. _____		
3. _____			7. <u>BESI#</u>		
4. _____			8. _____		

PROPERTIES: 7-10 pH SOLID LIQUID SLUDGE SLURRY OTHER _____

HANDLING INSTRUCTIONS: WEAR ALL APPROPRIATE PROTECTIVE CLOTHING

THE GENERATOR CERTIFIES THAT THE WASTE AS DESCRIBED IS 100% NON-HAZARDOUS.

Larry Mochart BESI for BP TYPED OR PRINTED FULL NAME & SIGNATURE DATE 12-26-97

TRANSPORTER

TRANSPORTER #1
NAME: STRATUS ENVIRONMENTAL EPA I.D. NO. [REDACTED]

ADDRESS: 3330 CAMERON PARK DR

CITY, STATE, ZIP: CAMERON PARK, CA 95552 SERVICE ORDER NO. _____

PHONE NO. 530-676-2031 PICK UP DATE _____

TRUCK UNIT I.D. NO. _____ TYPED OR PRINTED FULL NAME & SIGNATURE Jerry Gonzalez DATE 12-26-97

TSD FACILITY

NAME: SEAPORT REFINING & ENVIRONMENTAL, LLC EPA I.D. NO. [REDACTED]

ADDRESS: 700 SEAPORT BLVD.

CITY, STATE, ZIP: REDWOOD CITY, CA 94063 DISPOSAL METHOD LANDFILL OTHER _____

PHONE NO. 650-354-1024

TYPED OR PRINTED FULL NAME & SIGNATURE _____ DATE _____

GEN	OLD/NEW	L	A	TONS
TRANS		S	B	
CO		RT/CO	HW/DF	NONE

DISCREPANCY _____



Chain of Custody Record

Project Name: ARCO 4977
 BP BU/AR Region/Enfos Segment: BP > Americas > West > Retail > Alameda > 4977
 State or Lead Regulatory Agency: _____
 Requested Due Date (mm/dd/yy): _____

On-site Time: <u>8:30</u>	Temp: <u>55</u>
Off-site Time: <u>10:30</u>	Temp: <u>61</u>
Sky Conditions: <u>Clear</u>	
Meteorological Events: <u>None</u>	
Wind Speed: <u>0</u>	Direction: <u>—</u>

Lab Name: <u>TestAmerica</u>	BP/AR Facility No.: <u>4977</u>	Consultant/Contractor: <u>Stratus Environmental, Inc.</u>
Address: <u>885 Jarvis Drive</u>	BP/AR Facility Address: <u>2770 Castro Valley Road, Castro Valley</u>	Address: <u>3330 Cameron Park Drive, Suite 550</u>
<u>Morgan Hill, CA 95937</u>	Site Lat/Long: _____	<u>Cameron Park, CA 95682</u>
Lab PM: <u>Lisa Race</u>	California Global ID No.: <u>T060010089</u>	Consultant/Contractor Project No.: _____
Tele/Fax: <u>408-782-8156 408-782-6308 (fax)</u>	Enfos Project No.: <u>G0C2H-0017</u>	Consultant/Contractor PM: <u>Jay Johnson</u>
BP/AR PM Contact: <u>Paul Supple</u>	Provision or OOC (circle one) <u>Provision</u>	Tele/Fax: <u>(530) 676-6000 / (530) 676-6005</u>
Address: <u>2010 Crow Canyon Place, Suite 150</u>	Phase/WBS: <u>04-Monitoring</u>	Report Type & QC Level: <u>Level I with EDF</u>
<u>San Ramon, CA</u>	Sub Phase/Task: <u>03-Analytical</u>	E-mail EDD To: <u>shaves@stratusinc.net</u>
Tele/Fax: <u>925-275-3506</u>	Cost Element: <u>01-Contractor labor</u>	Invoice to: <u>Atlantic Richfield Co.</u>

Item No.	Sample Description	Time	Date	Matrix			Laboratory No.	No. of Containers	Preservative					Requested Analysis					Sample Point Lat/Long and Comments Oxy = MTBE, TAME, ETBE, DIPE, TBA	
				Soil/Solid	Water/Liquid	Air			Unpreserved	H ₂ SO ₄	HNO ₃	HCl	Methanol	CROBTEX/Oxy*	1,2-DCA	Ethanol by 8260	EDB	DIC		
1	MW-1	10:20	12-26-03	X				3			X			X	X	X	X			
2	MW-2	9:55	1	X				3			X			X	X	X	X			
3	MW-3	10:03	1	X				6			X			X	X	X	X			
4	TB 4977 -	6:00	1	X				3			X			X	X	X	X			
5																				HOLD
6																				
7																				
8																				
9																				
10																				

Sampler's Name: <u>Jerry Godzales</u>	Relinquished By / Affiliation: _____	Date: <u>12/27</u>	Time: <u>1510</u>	Accepted By / Affiliation: _____	Date: <u>12/17</u>	Time: <u>1510</u>
Sampler's Company: <u>Dale 105 FNU</u>						
Shipment Date: _____						
Shipment Method: _____						
Shipment Tracking No: _____						
Special Instructions: <u>Please cc results to rmiller@broadbentinc.com</u>						

Custody Seals in Place: Yes / No | Temp Blank: Yes / No | Cooler Temp on Receipt: _____ °F/C | Trip Blank: Yes / No | MS/MSD Sample Submitted: Yes / No

14 January, 2008

Jay Johnson
Stratus Environmental Inc. [Arco]
3330 Cameron Park Dr., Suite 550
Cameron Park, CA 95682

RE: ARCO #4977, Castro Valley, CA
Work Order: MQL0775

Enclosed are the results of analyses for samples received by the laboratory on 12/27/07 21:30. If you have any questions concerning this report, please feel free to contact me.

Sincerely,



Lisa Race
Senior Project Manager

CA ELAP Certificate # 2682

The results in this laboratory report pertain only to the samples tested in the laboratory. The analyses contained in this report were performed in accordance with the BPGCLN Technical Specifications, applicable Federal, State, local regulations and certification requirements as well as the methodologies as described in laboratory SOPs reviewed by the BPGCLN. This entire report was reviewed and approved for release.

Stratus Environmental Inc. [Arco]
3330 Cameron Park Dr., Suite 550
Cameron Park CA, 95682

Project: ARCO #4977, Castro Valley, CA
Project Number: G0C2H-0017
Project Manager: Jay Johnson

MQL0775
Reported:
01/14/08 15:36

ANALYTICAL REPORT FOR SAMPLES

Sample ID	Laboratory ID	Matrix	Date Sampled	Date Received
MW-1	MQL0775-01	Water	12/26/07 10:20	12/27/07 21:30
MW-2	MQL0775-02	Water	12/26/07 09:55	12/27/07 21:30
MW-3	MQL0775-03	Water	12/26/07 10:03	12/27/07 21:30
TB 4977 -	MQL0775-04	Water	12/26/07 06:00	12/27/07 21:30

The carbon range for the TPH-GRO has been changed from C6-C10 to C4-C12. The carbon range for TPH-DRO has been changed from C10-C28 to C10-C36. EPA 8015B has been modified to better meet the requirements of California regulatory agencies. These samples were received with no custody seals.

Stratus Environmental Inc. [Arco]
3330 Cameron Park Dr., Suite 550
Cameron Park CA, 95682

Project: ARCO #4977, Castro Valley, CA
Project Number: G0C2H-0017
Project Manager: Jay Johnson

MQL0775
Reported:
01/14/08 15:36

Total Purgeable Hydrocarbons by GC/MS (CA LUFT)
TestAmerica Morgan Hill

Analyte	Result	Reporting Limit	Units	Dilution	Batch	Prepared	Analyzed	Method	Notes
MW-1 (MQL0775-01) Water Sampled: 12/26/07 10:20 Received: 12/27/07 21:30									
Gasoline Range Organics (C4-C12)	ND	50	ug/l	1	8A02002	01/02/08	01/02/08	LUFT GCMS	
Surrogate: 1,2-Dichloroethane-d4		94 %	60-150		"	"	"	"	
Surrogate: Dibromofluoromethane		102 %	75-130		"	"	"	"	
Surrogate: Toluene-d8		97 %	75-120		"	"	"	"	
Surrogate: 4-Bromofluorobenzene		91 %	55-130		"	"	"	"	
MW-2 (MQL0775-02) Water Sampled: 12/26/07 09:55 Received: 12/27/07 21:30									
Gasoline Range Organics (C4-C12)	16000	500	ug/l	10	8A02002	01/02/08	01/02/08	LUFT GCMS	
Surrogate: 1,2-Dichloroethane-d4		91 %	60-150		"	"	"	"	
Surrogate: Dibromofluoromethane		100 %	75-130		"	"	"	"	
Surrogate: Toluene-d8		101 %	75-120		"	"	"	"	
Surrogate: 4-Bromofluorobenzene		98 %	55-130		"	"	"	"	
MW-3 (MQL0775-03) Water Sampled: 12/26/07 10:03 Received: 12/27/07 21:30									
Gasoline Range Organics (C4-C12)	460	50	ug/l	1	8A02002	01/02/08	01/02/08	LUFT GCMS	
Surrogate: 1,2-Dichloroethane-d4		94 %	60-150		"	"	"	"	
Surrogate: Dibromofluoromethane		102 %	75-130		"	"	"	"	
Surrogate: Toluene-d8		101 %	75-120		"	"	"	"	
Surrogate: 4-Bromofluorobenzene		108 %	55-130		"	"	"	"	

Stratus Environmental Inc. [Arco]
3330 Cameron Park Dr., Suite 550
Cameron Park CA, 95682

Project: ARCO #4977, Castro Valley, CA
Project Number: G0C2H-0017
Project Manager: Jay Johnson

MLQ0775
Reported:
01/14/08 15:36

Volatile Organic Compounds by EPA Method 8260B

TestAmerica Morgan Hill

Analyte	Result	Reporting Limit	Units	Dilution	Batch	Prepared	Analyzed	Method	Notes
MW-1 (MLQ0775-01) Water Sampled: 12/26/07 10:20 Received: 12/27/07 21:30									
tert-Amyl methyl ether	ND	0.50	ug/l	1	8A02002	01/02/08	01/02/08	EPA 8260B	
Benzene	ND	0.50	"	"	"	"	"	"	
tert-Butyl alcohol	ND	20	"	"	"	"	"	"	
Di-isopropyl ether	ND	0.50	"	"	"	"	"	"	
1,2-Dibromoethane (EDB)	ND	0.50	"	"	"	"	"	"	
1,2-Dichloroethane	ND	0.50	"	"	"	"	"	"	
Ethanol	ND	300	"	"	"	"	"	"	
Ethyl tert-butyl ether	ND	0.50	"	"	"	"	"	"	
Ethylbenzene	ND	0.50	"	"	"	"	"	"	
Methyl tert-butyl ether	2.9	0.50	"	"	"	"	"	"	
Toluene	ND	0.50	"	"	"	"	"	"	
Xylenes (total)	ND	0.50	"	"	"	"	"	"	
<i>Surrogate: Dibromofluoromethane</i>		<i>102 %</i>	<i>75-130</i>		"	"	"	"	
<i>Surrogate: 1,2-Dichloroethane-d4</i>		<i>94 %</i>	<i>60-150</i>		"	"	"	"	
<i>Surrogate: Toluene-d8</i>		<i>97 %</i>	<i>75-120</i>		"	"	"	"	
<i>Surrogate: 4-Bromofluorobenzene</i>		<i>91 %</i>	<i>55-130</i>		"	"	"	"	
MW-2 (MLQ0775-02) Water Sampled: 12/26/07 09:55 Received: 12/27/07 21:30									
tert-Amyl methyl ether	ND	5.0	ug/l	10	8A02002	01/02/08	01/02/08	EPA 8260B	
Benzene	440	5.0	"	"	"	"	"	"	
tert-Butyl alcohol	ND	200	"	"	"	"	"	"	
Di-isopropyl ether	ND	5.0	"	"	"	"	"	"	
1,2-Dibromoethane (EDB)	ND	5.0	"	"	"	"	"	"	
1,2-Dichloroethane	ND	5.0	"	"	"	"	"	"	
Ethanol	ND	3000	"	"	"	"	"	"	
Ethyl tert-butyl ether	ND	5.0	"	"	"	"	"	"	
Ethylbenzene	760	5.0	"	"	"	"	"	"	
Methyl tert-butyl ether	80	5.0	"	"	"	"	"	"	
Toluene	ND	5.0	"	"	"	"	"	"	
Xylenes (total)	570	5.0	"	"	"	"	"	"	
<i>Surrogate: Dibromofluoromethane</i>		<i>100 %</i>	<i>75-130</i>		"	"	"	"	
<i>Surrogate: 1,2-Dichloroethane-d4</i>		<i>91 %</i>	<i>60-150</i>		"	"	"	"	
<i>Surrogate: Toluene-d8</i>		<i>101 %</i>	<i>75-120</i>		"	"	"	"	
<i>Surrogate: 4-Bromofluorobenzene</i>		<i>98 %</i>	<i>55-130</i>		"	"	"	"	

Stratus Environmental Inc. [Arco]
3330 Cameron Park Dr., Suite 550
Cameron Park CA, 95682

Project: ARCO #4977, Castro Valley, CA
Project Number: G0C2H-0017
Project Manager: Jay Johnson

MLQ0775
Reported:
01/14/08 15:36

Volatile Organic Compounds by EPA Method 8260B
TestAmerica Morgan Hill

Analyte	Result	Reporting Limit	Units	Dilution	Batch	Prepared	Analyzed	Method	Notes
MW-3 (MLQ0775-03) Water Sampled: 12/26/07 10:03 Received: 12/27/07 21:30									
tert-Amyl methyl ether	ND	0.50	ug/l	1	8A02002	01/02/08	01/02/08	EPA 8260B	
Benzene	3.1	0.50	"	"	"	"	"	"	
tert-Butyl alcohol	76	20	"	"	"	"	"	"	
Di-isopropyl ether	ND	0.50	"	"	"	"	"	"	
1,2-Dibromoethane (EDB)	ND	0.50	"	"	"	"	"	"	
1,2-Dichloroethane	ND	0.50	"	"	"	"	"	"	
Ethanol	ND	300	"	"	"	"	"	"	
Ethyl tert-butyl ether	ND	0.50	"	"	"	"	"	"	
Ethylbenzene	15	0.50	"	"	"	"	"	"	
Methyl tert-butyl ether	17	0.50	"	"	"	"	"	"	
Toluene	ND	0.50	"	"	"	"	"	"	
Xylenes (total)	0.89	0.50	"	"	"	"	"	"	
<i>Surrogate: Dibromofluoromethane</i>		<i>102 %</i>	<i>75-130</i>		<i>"</i>	<i>"</i>	<i>"</i>	<i>"</i>	
<i>Surrogate: 1,2-Dichloroethane-d4</i>		<i>94 %</i>	<i>60-150</i>		<i>"</i>	<i>"</i>	<i>"</i>	<i>"</i>	
<i>Surrogate: Toluene-d8</i>		<i>101 %</i>	<i>75-120</i>		<i>"</i>	<i>"</i>	<i>"</i>	<i>"</i>	
<i>Surrogate: 4-Bromofluorobenzene</i>		<i>108 %</i>	<i>55-130</i>		<i>"</i>	<i>"</i>	<i>"</i>	<i>"</i>	

Stratus Environmental Inc. [Arco]
3330 Cameron Park Dr., Suite 550
Cameron Park CA, 95682

Project: ARCO #4977, Castro Valley, CA
Project Number: G0C2H-0017
Project Manager: Jay Johnson

MQL0775
Reported:
01/14/08 15:36

Total Purgeable Hydrocarbons by GC/MS (CA LUFT) - Quality Control

TestAmerica Morgan Hill

Analyte	Result	Reporting Limit	Units	Spike Level	Source Result	%REC	%REC Limits	RPD	RPD Limit	Notes
Batch 8A02002 - EPA 5030B P/T / LUFT GCMS										
Blank (8A02002-BLK1)										
Prepared & Analyzed: 01/02/08										
Gasoline Range Organics (C4-C12)	ND	50	ug/l							
Surrogate: 1,2-Dichloroethane-d4	2.28		"	2.50		91	60-150			
Surrogate: Dibromofluoromethane	2.48		"	2.50		99	75-130			
Surrogate: Toluene-d8	2.46		"	2.50		98	75-120			
Surrogate: 4-Bromofluorobenzene	2.29		"	2.50		92	55-130			
Laboratory Control Sample (8A02002-BS2)										
Prepared & Analyzed: 01/02/08										
Gasoline Range Organics (C4-C12)	430	50	ug/l	500		86	55-130			
Surrogate: 1,2-Dichloroethane-d4	2.29		"	2.50		92	60-150			
Surrogate: Dibromofluoromethane	2.51		"	2.50		100	75-130			
Surrogate: Toluene-d8	2.53		"	2.50		101	75-120			
Surrogate: 4-Bromofluorobenzene	2.48		"	2.50		99	55-130			
Laboratory Control Sample Dup (8A02002-BSD2)										
Prepared & Analyzed: 01/02/08										
Gasoline Range Organics (C4-C12)	427	50	ug/l	500		85	55-130	0.7	20	
Surrogate: 1,2-Dichloroethane-d4	2.26		"	2.50		90	60-150			
Surrogate: Dibromofluoromethane	2.50		"	2.50		100	75-130			
Surrogate: Toluene-d8	2.49		"	2.50		100	75-120			
Surrogate: 4-Bromofluorobenzene	2.50		"	2.50		100	55-130			
Matrix Spike (8A02002-MS1)										
Source: MQL0769-02 Prepared & Analyzed: 01/02/08										
Gasoline Range Organics (C4-C12)	554	50	ug/l	550	37.1	94	25-150			
Surrogate: 1,2-Dichloroethane-d4	2.36		"	2.50		94	60-150			
Surrogate: Dibromofluoromethane	2.61		"	2.50		104	75-130			
Surrogate: Toluene-d8	2.49		"	2.50		100	75-120			
Surrogate: 4-Bromofluorobenzene	2.41		"	2.50		96	55-130			
Matrix Spike Dup (8A02002-MSD1)										
Source: MQL0769-02 Prepared & Analyzed: 01/02/08										
Gasoline Range Organics (C4-C12)	533	50	ug/l	550	37.1	90	25-150	4	20	
Surrogate: 1,2-Dichloroethane-d4	2.24		"	2.50		90	60-150			
Surrogate: Dibromofluoromethane	2.57		"	2.50		103	75-130			
Surrogate: Toluene-d8	2.50		"	2.50		100	75-120			
Surrogate: 4-Bromofluorobenzene	2.40		"	2.50		96	55-130			

Stratus Environmental Inc. [Arco]
3330 Cameron Park Dr., Suite 550
Cameron Park CA, 95682

Project: ARCO #4977, Castro Valley, CA
Project Number: G0C2H-0017
Project Manager: Jay Johnson

MQL0775
Reported:
01/14/08 15:36

Volatile Organic Compounds by EPA Method 8260B - Quality Control
TestAmerica Morgan Hill

Analyte	Result	Reporting Limit	Units	Spike Level	Source Result	%REC	%REC Limits	RPD	RPD Limit	Notes
Batch 8A02002 - EPA 5030B P/T / EPA 8260B										
Blank (8A02002-BLK1)										
Prepared & Analyzed: 01/02/08										
tert-Amyl methyl ether	ND	0.50	ug/l							
Benzene	ND	0.50	"							
tert-Butyl alcohol	ND	20	"							
Di-isopropyl ether	ND	0.50	"							
1,2-Dibromoethane (EDB)	ND	0.50	"							
1,2-Dichloroethane	ND	0.50	"							
Ethanol	ND	300	"							
Ethyl tert-butyl ether	ND	0.50	"							
Ethylbenzene	ND	0.50	"							
Methyl tert-butyl ether	ND	0.50	"							
Toluene	ND	0.50	"							
Xylenes (total)	ND	0.50	"							
<i>Surrogate: Dibromofluoromethane</i>	2.48		"	2.50		99	75-130			
<i>Surrogate: 1,2-Dichloroethane-d4</i>	2.28		"	2.50		91	60-150			
<i>Surrogate: Toluene-d8</i>	2.46		"	2.50		98	75-120			
<i>Surrogate: 4-Bromofluorobenzene</i>	2.29		"	2.50		92	55-130			
Laboratory Control Sample (8A02002-BS1)										
Prepared & Analyzed: 01/02/08										
tert-Amyl methyl ether	9.95	0.50	ug/l	10.0		100	75-125			
Benzene	9.75	0.50	"	10.0		98	75-120			
tert-Butyl alcohol	197	20	"	200		98	80-120			
Di-isopropyl ether	9.52	0.50	"	10.0		95	70-130			
1,2-Dibromoethane (EDB)	10.4	0.50	"	10.0		104	75-130			
1,2-Dichloroethane	8.79	0.50	"	10.0		88	65-130			
Ethanol	170	300	"	200		85	50-150			
Ethyl tert-butyl ether	9.78	0.50	"	10.0		98	75-130			
Ethylbenzene	9.75	0.50	"	10.0		98	80-125			
Methyl tert-butyl ether	9.62	0.50	"	10.0		96	80-130			
Toluene	10.3	0.50	"	10.0		103	80-120			
Xylenes (total)	30.7	0.50	"	30.0		102	80-125			
<i>Surrogate: Dibromofluoromethane</i>	2.55		"	2.50		102	75-130			
<i>Surrogate: 1,2-Dichloroethane-d4</i>	2.24		"	2.50		90	60-150			
<i>Surrogate: Toluene-d8</i>	2.50		"	2.50		100	75-120			
<i>Surrogate: 4-Bromofluorobenzene</i>	2.38		"	2.50		95	55-130			

Stratus Environmental Inc. [Arco]
3330 Cameron Park Dr., Suite 550
Cameron Park CA, 95682

Project: ARCO #4977, Castro Valley, CA
Project Number: G0C2H-0017
Project Manager: Jay Johnson

MLQ0775
Reported:
01/14/08 15:36

Volatile Organic Compounds by EPA Method 8260B - Quality Control TestAmerica Morgan Hill

Analyte	Result	Reporting Limit	Units	Spike Level	Source Result	%REC	%REC Limits	RPD	RPD Limit	Notes
---------	--------	-----------------	-------	-------------	---------------	------	-------------	-----	-----------	-------

Batch 8A02002 - EPA 5030B P/T / EPA 8260B

Matrix Spike (8A02002-MS1)	Source: MQL0769-02	Prepared & Analyzed: 01/02/08								
tert-Amyl methyl ether	10.6	0.50	ug/l	10.0	ND	106	75-140			
Benzene	9.81	0.50	"	10.0	ND	98	80-120			
tert-Butyl alcohol	202	20	"	200	4.47	99	80-125			
Di-isopropyl ether	10.1	0.50	"	10.0	ND	101	75-135			
1,2-Dibromoethane (EDB)	11.1	0.50	"	10.0	ND	111	80-135			
1,2-Dichloroethane	10.2	0.50	"	10.0	1.07	91	65-145			
Ethanol	173	300	"	200	ND	86	50-150			
Ethyl tert-butyl ether	10.2	0.50	"	10.0	ND	102	80-135			
Ethylbenzene	9.68	0.50	"	10.0	ND	97	75-130			
Methyl tert-butyl ether	10.0	0.50	"	10.0	ND	100	75-145			
Toluene	10.3	0.50	"	10.0	ND	103	80-125			
Xylenes (total)	30.7	0.50	"	30.0	ND	102	75-125			
<i>Surrogate: Dibromofluoromethane</i>	2.61		"	2.50		104	75-130			
<i>Surrogate: 1,2-Dichloroethane-d4</i>	2.36		"	2.50		94	60-150			
<i>Surrogate: Toluene-d8</i>	2.49		"	2.50		100	75-120			
<i>Surrogate: 4-Bromofluorobenzene</i>	2.41		"	2.50		96	55-130			

Matrix Spike Dup (8A02002-MSD1)	Source: MQL0769-02	Prepared & Analyzed: 01/02/08								
tert-Amyl methyl ether	10.5	0.50	ug/l	10.0	ND	105	75-140	0.9	25	
Benzene	10.1	0.50	"	10.0	ND	101	80-120	3	20	
tert-Butyl alcohol	205	20	"	200	4.47	100	80-125	2	25	
Di-isopropyl ether	10.1	0.50	"	10.0	ND	101	75-135	0.4	25	
1,2-Dibromoethane (EDB)	10.6	0.50	"	10.0	ND	106	80-135	5	30	
1,2-Dichloroethane	10.2	0.50	"	10.0	1.07	91	65-145	0	25	
Ethanol	195	300	"	200	ND	97	50-150	12	25	
Ethyl tert-butyl ether	10.3	0.50	"	10.0	ND	103	80-135	1	25	
Ethylbenzene	9.90	0.50	"	10.0	ND	99	75-130	2	20	
Methyl tert-butyl ether	9.70	0.50	"	10.0	ND	97	75-145	3	25	
Toluene	10.5	0.50	"	10.0	ND	105	80-125	2	25	
Xylenes (total)	30.4	0.50	"	30.0	ND	101	75-125	1	20	
<i>Surrogate: Dibromofluoromethane</i>	2.57		"	2.50		103	75-130			
<i>Surrogate: 1,2-Dichloroethane-d4</i>	2.24		"	2.50		90	60-150			
<i>Surrogate: Toluene-d8</i>	2.50		"	2.50		100	75-120			
<i>Surrogate: 4-Bromofluorobenzene</i>	2.40		"	2.50		96	55-130			

TestAmerica Morgan Hill

The results in this report apply to the samples analyzed in accordance with the chain of custody document. Unless otherwise stated, results are reported on a wet weight basis. This analytical report must be reproduced in its entirety.

Stratus Environmental Inc. [Arco]
3330 Cameron Park Dr., Suite 550
Cameron Park CA, 95682

Project: ARCO #4977, Castro Valley, CA
Project Number: G0C2H-0017
Project Manager: Jay Johnson

MQL0775
Reported:
01/14/08 15:36

Notes and Definitions

DET Analyte DETECTED
ND Analyte NOT DETECTED at or above the reporting limit or MDL, if MDL is specified
NR Not Reported
dry Sample results reported on a dry weight basis
RPD Relative Percent Difference



bp
A BP affiliated company

Chain of Custody Record

Project Name: ARCO 4977
 BP BU/AR Region/Enfos Segment: BP > Americas > West > Retail > Alameda > 4977
 State or Lead Regulatory Agency: _____
 Requested Due Date (mm/dd/yy): _____

On-site Time: <u>8:30</u>	Temp: <u>55</u>
Off-site Time: <u>10:30</u>	Temp: <u>61</u>
Sky Conditions: <u>Clear</u>	
Meteorological Events: <u>None</u>	
Wind Speed: <u>0</u>	Direction: _____

MOL 0775

Lab Name: <u>TestAmerica</u>	BP/AR Facility No.: <u>4977</u>	Consultant/Contractor: <u>Stratus Environmental, Inc.</u>
Address: <u>885 Jarvis Drive</u>	BP/AR Facility Address: <u>2770 Castro Valley Road, Castro Valley</u>	Address: <u>3330 Cameron Park Drive, Suite 550</u>
<u>Morgan Hill, CA 95937</u>	Site Lat/Long: _____	<u>Cameron Park, CA 95682</u>
Lab PM: <u>Lisa Race</u>	California Global ID No.: <u>T060010089</u>	Consultant/Contractor Project No.: _____
Tele/Fax: <u>408-782-8156 408-782-6308 (fax)</u>	Enfos Project No.: <u>G0C2H-0017</u>	Consultant/Contractor PM: <u>Jay Johnson</u>
BP/AR PM Contact: <u>Paul Supple</u>	Provision or OOC (circle one) <u>Provision</u>	Tele/Fax: <u>(530) 676-6000 / (530) 676-6005</u>
Address: <u>2010 Crow Canyon Place, Suite 150</u>	Phase/WBS: <u>04-Monitoring</u>	Report Type & QC Level: <u>Level 1 with EDF</u>
<u>San Ramon, CA</u>	Sub Phase/Task: <u>03-Analytical</u>	E-mail EDD To: <u>shayes@stratusinc.net</u>
Tele/Fax: <u>925-275-3506</u>	Cost Element: <u>01-Contractor labor</u>	Invoice to: <u>Atlantic Richfield Co.</u>

Item No.	Sample Description	Time	Date	Matrix			Laboratory No.	No. of Containers	Preservative					Requested Analysis					Sample Point Lat/Long and Comments Oxy = MTBE, TAME, ETBE, DIPE, TBA		
				Soil/Solid	Water/Liquid	Air			Unpreserved	H ₂ SO ₄	HNO ₃	HCl	Methanol	CRO/BTEX/Oxy*	1,2-DCA	Ethanol by 8260	EDB	DRO			
1	MW-1	10:20	12-26-07	X			01	3						X	X	X	X				
2	MW-2	7:55		X			02	3						X	X	X	X				
3	MW-3	10:03		X			03	6						X	X	X	X				
4	TB 4977 -	6:00		X			04	3						X	X	X	X				
5																					
6																					
7																					
8																					
9																					
10																					

Sampler's Name: <u>Jerry Gonzalez</u>	Relinquished By / Affiliation: _____	Date: <u>12/27</u>	Time: <u>1510</u>	Accepted By / Affiliation: _____	Date: <u>12/27</u>	Time: <u>1510</u>
Sampler's Company: <u>Doc's ENV</u>	_____	<u>12/27</u>	<u>1750</u>	_____	<u>12/27</u>	<u>1745</u>
Shipment Date: _____	_____	<u>12/27</u>	<u>2130</u>	_____	<u>12/27</u>	<u>2130</u>
Shipment Method: _____	_____			_____		
Shipment Tracking No: _____	_____			_____		

Special Instructions: Please cc results to rmler@broadbentinc.com

Custody Seals In Place: Yes No | Temp Blank: Yes No | Cooler Temp on Receipt: 53°F/C | Trip Blank: Yes No | MS/MSD Sample Submitted: Yes No

TEST AMERICA SAMPLE RECEIPT LOG

CLIENT NAME: ARL
 REC. BY (PRINT) DJ
 WORKORDER: MOLO775

DATE REC'D AT LAB: 12/27/07
 TIME REC'D AT LAB: 2:30
 DATE LOGGED IN: 12/28/07

For Regulatory Purposes?
 DRINKING WATER
 WASTE WATER
 OTHER

CIRCLE THE APPROPRIATE RESPONSE	LAB SAMPLE #	CLIENT ID	CONTAINER DESCRIPTION	PRESERVATIVE	pH	SAMPLE MATRIX	DATE SAMPLED	REMARKS: CONDITION (ETC.)
1. Custody Seal(s) Present <input checked="" type="checkbox"/> Absent Intact / Broken*								<div style="position: absolute; top: 50%; left: 50%; transform: translate(-50%, -50%); opacity: 0.5;"> <p>12/27/07 5:00</p> </div>
2. Chain-of-Custody Present <input checked="" type="checkbox"/> Absent*								
3. Traffic Reports or Packing List: Present <input checked="" type="checkbox"/> Absent								
4. Airbill: Airbill / Sticker Present <input checked="" type="checkbox"/> Absent								
5. Airbill #:								
6. Sample Labels: Present <input checked="" type="checkbox"/> Absent								
7. Sample IDs: Listed <input checked="" type="checkbox"/> / Not Listed on Chain-of-Custody								
8. Sample Condition: Intact <input checked="" type="checkbox"/> / Broken* / Leaking*								
9. Does information on chain-of-custody, traffic reports and sample labels agree? Yes <input checked="" type="checkbox"/> / No*								
10. Sample received within hold time? Yes <input checked="" type="checkbox"/> / No*								
11. Adequate sample volume received? Yes <input checked="" type="checkbox"/> / No*								
12. Proper preservatives used? Yes <input checked="" type="checkbox"/> / No*								
13. Trip Blank / Temp Blank Received? (circle which, if yes) Yes <input checked="" type="checkbox"/> / No*								
14. Read Temp: <u>4.3</u> Correction Factor: <u>-1.0</u> Corrected Temp: <u>3.3</u> Is corrected temp. 0-6°C? Yes <input checked="" type="checkbox"/> / No**								
**Exception (if any): Metals / Perchlorate DFF on Ice or Problem COC								

*IF CIRCLED, CONTACT PROJECT MANAGER AND ATTACH RECORD OF RESOLUTION.

APPENDIX B

GEOTRACKER UPLOAD CONFIRMATION

Electronic Submittal Information

[Main Menu](#) | [View/Add Facilities](#) | [Upload EDD](#) | [Check EDD](#)

Your EDF file has been successfully uploaded!

Confirmation Number: 4035636723
Date/Time of Submittal: 1/28/2008 8:42:48 AM
Facility Global ID: T0600100089
Facility Name: ARCO #4977
Submittal Title: 4Q07 GW Monitoring
Submittal Type: GW Monitoring Report

Click [here](#) to view the detections report for this upload.

ARCO #4977 2770 CASTRO VALLEY CASTRO VALLEY, CA 94546	Regional Board - Case #: 01-0097 SAN FRANCISCO BAY RWQCB (REGION 2) Local Agency (lead agency) - Case #: RO0002436 ALAMEDA COUNTY LOP - (SP)
--	---

CONF # 4035636723	TITLE 4Q07 GW Monitoring	QUARTER Q4 2007
SUBMITTED BY Broadbent & Associates, Inc.	SUBMIT DATE 1/28/2008	STATUS PENDING REVIEW

SAMPLE DETECTIONS REPORT

# FIELD POINTS SAMPLED	3
# FIELD POINTS WITH DETECTIONS	3
# FIELD POINTS WITH WATER SAMPLE DETECTIONS ABOVE MCL	2
SAMPLE MATRIX TYPES	WATER

METHOD QA/QC REPORT

METHODS USED	8260FA,8260TPH
TESTED FOR REQUIRED ANALYTES?	Y
LAB NOTE DATA QUALIFIERS	N

QA/QC FOR 8021/8260 SERIES SAMPLES

TECHNICAL HOLDING TIME VIOLATIONS	0
METHOD HOLDING TIME VIOLATIONS	0
LAB BLANK DETECTIONS ABOVE REPORTING DETECTION LIMIT	0
LAB BLANK DETECTIONS	0
DO ALL BATCHES WITH THE 8021/8260 SERIES INCLUDE THE FOLLOWING?	
- LAB METHOD BLANK	Y
- MATRIX SPIKE	Y
- MATRIX SPIKE DUPLICATE	Y
- BLANK SPIKE	Y
- SURROGATE SPIKE	Y

WATER SAMPLES FOR 8021/8260 SERIES

MATRIX SPIKE / MATRIX SPIKE DUPLICATE(S) % RECOVERY BETWEEN 65-135%	Y
MATRIX SPIKE / MATRIX SPIKE DUPLICATE(S) RPD LESS THAN 30%	Y
SURROGATE SPIKES % RECOVERY BETWEEN 85-115%	Y
BLANK SPIKE / BLANK SPIKE DUPLICATES % RECOVERY BETWEEN 70-130%	Y

SOIL SAMPLES FOR 8021/8260 SERIES

MATRIX SPIKE / MATRIX SPIKE DUPLICATE(S) % RECOVERY BETWEEN 65-135%	n/a
MATRIX SPIKE / MATRIX SPIKE DUPLICATE(S) RPD LESS THAN 30%	n/a
SURROGATE SPIKES % RECOVERY BETWEEN 70-125%	n/a
BLANK SPIKE / BLANK SPIKE DUPLICATES % RECOVERY BETWEEN 70-130%	n/a

FIELD QC SAMPLES

<u>SAMPLE</u>	<u>COLLECTED</u>	<u>DETECTIONS > REPD</u>
QCTB SAMPLES	N	0
QCEB SAMPLES	N	0
QCAB SAMPLES	N	0

Logged in as BROADBENT-C (CONTRACTOR)

CONTACT SITE ADMINISTRATOR.

Electronic Submittal Information

[Main Menu](#) | [View/Add Facilities](#) | [Upload EDD](#) | [Check EDD](#)

UPLOADING A GEO_WELL FILE

Processing is complete. No errors were found!
Your file has been successfully submitted!

<u>Submittal Title:</u>	4Q07 GEO_WELL 4977
<u>Facility Global ID:</u>	T0600100089
<u>Facility Name:</u>	ARCO #4977
<u>Submittal Date/Time:</u>	1/24/2008 11:42:15 AM
<u>Confirmation Number:</u>	3517761707

[Back to Main Menu](#)

Logged in as BROADBENT-C
(CONTRACTOR)

[CONTACT SITE ADMINISTRATOR.](#)