

**RECEIVED**

By dehloptoxic at 9:00 am, Jan 31, 2007



Atlantic Richfield Company  
(a BP affiliated company)



P.O. Box 1257  
San Ramon, CA 94583  
Phone: (925) 275-3801  
Fax: (925) 275-3815

January 30, 2007

Re: Fourth Quarter, 2006 Ground-Water Monitoring Report  
Atlantic Richfield Company Station #4977  
2770 Castro Valley Boulevard  
Castro Valley, California  
ACEH Case No. RO0002436

"I declare, that to the best of my knowledge at the present time, that the information and/or recommendations contained in the attached document are true and correct."

Submitted by:

Paul Supple  
Environmental Business Manger



A BP affiliated company

**Fourth Quarter, 2006 Ground-Water Monitoring Report**  
Atlantic Richfield Company Station #4977  
2770 Castro Valley Boulevard  
Castro Valley, California

Prepared for

Mr. Paul Supple  
Environmental Business Manager  
Atlantic Richfield Company  
P.O. Box 1257  
San Ramon, California 94583

Prepared by



1324 Mangrove Avenue, Suite 212  
Chico, California 95926  
(530) 566-1400  
*www.broadbentinc.com*

January 2007

Project No. 06-02-625

Broadbent & Associates, Inc.  
1324 Mangrove Ave., Suite 212  
Chico, CA 95926  
Voice (530) 566-1400  
Fax (530) 566-1401



January 30, 2007

Project No. 06-02-625

Atlantic Richfield Company  
P.O. Box 1257  
San Ramon, California 94583  
Submitted via ENFOS

Attn.: Mr. Paul Supple

Re: Fourth Quarter, 2006 Ground-Water Monitoring Report, Atlantic Richfield Company (a BP affiliated company) Station #4977, 2770 Castro Valley Boulevard, Castro Valley, CA. ACEH Case No. RO0002436.

Dear Mr. Supple:

Provided herein is the *Fourth Quarter, 2006 Ground-Water Monitoring Report* for Atlantic Richfield Company Station #4977 (herein referred to as Station #4977) located at 2770 Castro Valley Boulevard, Castro Valley, CA (Property). This report presents a summary of Fourth Quarter, 2006 ground-water monitoring results.

Should you have questions regarding the work performed or results obtained, please do not hesitate to contact us at (530) 566-1400.

Sincerely,

BROADBENT & ASSOCIATES, INC.

A handwritten signature in black ink, appearing to read 'Matthew Herrick', written over a horizontal line.

Matthew Herrick, P.G.  
Project Hydrogeologist

A handwritten signature in black ink, appearing to read 'Robert H. Miller', written over a horizontal line.

Robert H. Miller, P.G., C.H.G.  
Principal Hydrogeologist

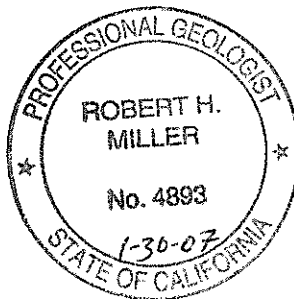

Enclosures

cc: Mr. Steven Plunkett, Alameda County Environmental Health (submitted via ACEH ftp site)

## STATION #4977 QUARTERLY GROUND-WATER MONITORING REPORT

Facility: #4977	Address:	2770 Castro Valley Boulevard, Castro Valley, CA
Station #4977 Environmental Business Manager:		Mr. Paul Supple
Consulting Co./Contact Persons:		Broadbent & Associates, Inc. (BAI)/Rob Miller & Matt Herrick
Consultant Project No.:		06-02-625
Facility Permits/Permitting Agency.:		NA

### WORK PERFORMED THIS QUARTER (Fourth Quarter, 2006):

1. Submitted Third Quarter, 2006 Ground-Water Monitoring Report. Work performed by BAI.
2. Conducted ground-water monitoring/sampling for Fourth Quarter, 2006. Work performed by Stratus Environmental, Inc.

### WORK PROPOSED FOR NEXT QUARTER (First Quarter, 2007):

1. Submit Fourth Quarter, 2006 Ground-Water Monitoring Report (contained herein).
2. Conduct quarterly ground-water monitoring/sampling for First Quarter, 2007.

### QUARTERLY RESULTS SUMMARY:

Current phase of project:	<b>Ground-water monitoring/sampling</b>
Frequency of ground-water sampling:	<b>Wells MW-1 through MW-3: Quarterly</b>
Frequency of ground-water monitoring:	<b>Quarterly</b>
Is free product (FP) present on-site:	<b>No</b>
Current remediation techniques:	<b>None</b>
Depth to ground water (below TOC):	<b>6.02 (MW-2) to 8.00 (MW-1) feet</b>
General ground-water flow direction:	<b>South</b>
Approximate hydraulic gradient:	<b>0.024 Feet per foot</b>

### DISCUSSION:

Gasoline range organics (GRO) were detected in MW-2 and MW-3 at 21,000 micrograms per liter ( $\mu\text{g/L}$ ) and 450  $\mu\text{g/L}$ , respectively. Benzene was detected in MW-2 and MW-3 at 500  $\mu\text{g/L}$  and 4.3  $\mu\text{g/L}$ , respectively. Ethylbenzene was detected in MW-2 and MW-3 at 1,400  $\mu\text{g/L}$  and 19  $\mu\text{g/L}$ , respectively. Xylenes were detected in MW-2 and MW-3 at 1,700  $\mu\text{g/L}$  and 1.4  $\mu\text{g/L}$ , respectively. Methyl tert-butyl ether (MTBE) was detected in MW-1, MW-2, and MW-3 at concentrations ranging from 4.3  $\mu\text{g/L}$  (MW-1) to 70  $\mu\text{g/L}$  (MW-2). Ground-water samples were inadvertently not analyzed for 1,2-Dibromoethane (EDB) during the Fourth Quarter, 2006. We have directed Stratus Environmental, Inc. to include EDB in all future sample analysis for the site. No other analytes were detected in ground-water samples collected during Fourth Quarter, 2006.

Drawing 1 depicts the ground-water elevation contour and an analytical summary map for the Fourth Quarter, 2006. Table 1 includes a summary of ground-water monitoring data including relative water elevations and laboratory analyses. Table 2 provides a summary of fuel additives analytical data. Table 3 presents historical groundwater flow directions and gradients.

**CLOSURE:**

The findings presented in this report are based upon: observations of Stratus Environmental, Inc. and/or their subcontractor(s) field personnel (see Appendix A), the points investigated, and results of laboratory tests performed by TestAmerica (Morgan Hill, CA). Our services were performed in accordance with the generally accepted standard of practice at the time this report was written. No other warranty, expressed or implied was made. This report has been prepared for the exclusive use of Atlantic Richfield Company. It is possible that variations in soil or ground-water conditions could exist beyond points explored in this investigation. Also, changes in site conditions could occur in the future due to variations in rainfall, temperature, regional water usage, or other factors.

**ATTACHMENTS:**

- Drawing 1. Ground-Water Elevation Contour and Analytical Summary Map, Station #4977, Castro Valley, CA
- Table 1. Summary of Ground-Water Monitoring Data: Relative Water Elevations and Laboratory Analyses, Station #4977, Castro Valley, CA
- Table 2. Summary of Fuel Additives Analytical Data, Station #4977, Castro Valley, CA
- Table 3. Historical Ground-Water Flow Direction and Gradient, Station #4977, Castro Valley, CA
- Appendix A. Stratus Environmental, Inc. Ground-Water Sampling Data Package (Includes Bill of Lading, Field Data Sheets, and Laboratory Report and Chain of Custody Documentation)
- Appendix B. GeoTracker Upload Confirmation

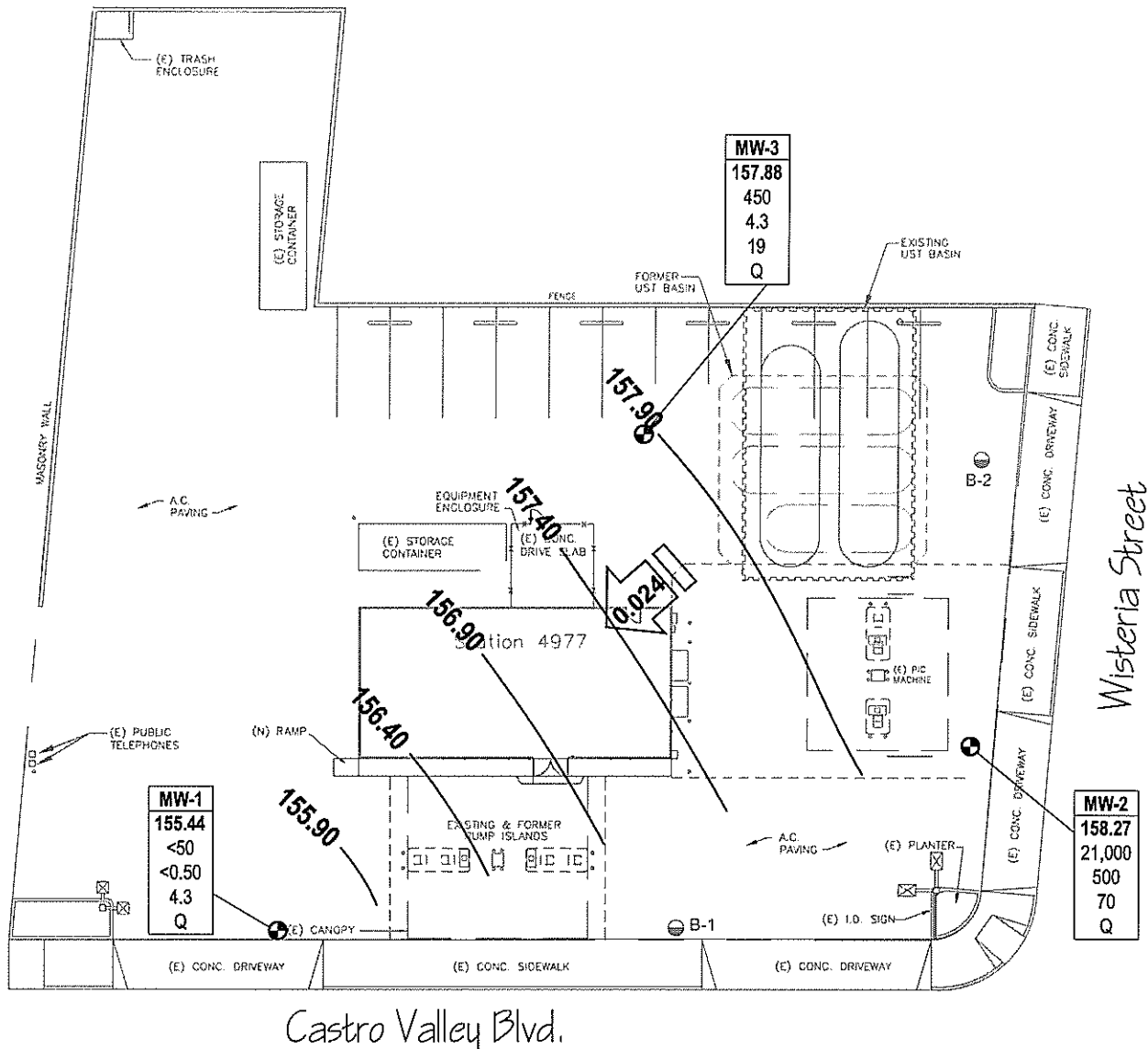

**LEGEND**

- MONITORING WELL
- SOIL BORING

Well	WELL DESIGNATION
ELEV	GROUND-WATER ELEVATION (FT ABOVE MSL)
GRO	CONCENTRATION OF GRO, BENZENE AND MTBE IN GROUND WATER (µg/L)
BZ	
MTBE	
Q	SAMPLING FREQUENCY

< NOT DETECTED AT OR ABOVE LABORATORY REPORTING LIMITS

Q SAMPLED QUARTERLY

— 156.90 GROUND-WATER ELEVATION CONTOUR (FT ABOVE MSL)

0.024 GROUND-WATER FLOW DIRECTION AND GRADIENT (FT/FT)

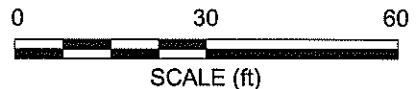
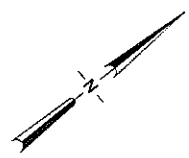

NOTE: SITE MAP ADAPTED FROM DELTA ENVIRONMENTAL FIGURES. SITE DIMENSIONS AND FACILITY LOCATIONS NOT VERIFIED.

**Table 1. Summary of Ground-Water Monitoring Data: Relative Water Elevations and Laboratory Analyses**  
**Station #4977, 2770 Castro Valley Blvd., Castro Valley, CA**

Well and Sample Date	P/NP	Comments	TOC (feet msl)	Top of Screen (ft bgs)	Bottom of Screen (ft bgs)	DTW (feet bgs)	Water Level Elevation (feet msl)	Concentrations in (µg/L)						DO (mg/L)	pH
								GRO/TPHg	Benzene	Toluene	Ethyl-Benzene	Total Xylenes	MTBE		
<b>MW-1</b>															
4/19/2002	--		161.11	5.0	15.0	11.21	149.90	660	12	1.3	4.3	0.8	38	--	--
9/27/2002	--		161.11	5.0	15.0	9.29	151.82	130	7.7	0.87	5.4	0.79	39	1.7	6.9
12/16/2002	--	a	161.11	5.0	15.0	8.55	152.56	77	1.8	<0.50	0.69	<1.0	42	1.6	6.9
3/11/2003	--		161.11	5.0	15.0	8.07	153.04	140	9.8	<0.50	5.6	<0.50	20	1.4	7.4
6/17/2003	--		161.11	5.0	15.0	8.31	152.80	510	60	1.4	81	<1.0	23	2.2	7
9/18/2003	--	b	161.11	5.0	15.0	9.45	151.66	72	2.4	1.4	1.6	1.5	39	2.7	7
12/11/2003	P		161.11	5.0	15.0	8.80	152.31	79	1.5	<0.50	1.5	4.4	48	2.1	7.0
03/11/2004	P		163.44	5.0	15.0	7.61	155.83	<50	1.3	<0.50	0.77	1.3	17	1.4	6.8
06/02/2004	P		163.44	5.0	15.0	8.95	154.49	53	1.4	<0.50	0.93	<0.50	39	2.3	7.1
09/22/2004	P		163.44	5.0	15.0	9.42	154.02	70	<0.50	<0.50	<0.50	<0.50	48	1.7	6.8
12/15/2004	P		163.44	5.0	15.0	7.88	155.56	63	<0.50	<0.50	<0.50	<0.50	45	1.8	6.9
03/07/2005	P		163.44	5.0	15.0	7.02	156.42	<50	<0.50	<0.50	<0.50	<0.50	4.0	2.4	6.8
06/27/2005	P		163.44	5.0	15.0	7.53	155.91	52	2.0	<0.50	1.9	0.78	8.1	2.8	7.1
09/16/2005	P		163.44	5.0	15.0	9.20	154.24	<50	<0.50	<0.50	<0.50	0.76	14	1.82	6.9
12/27/2005	P		163.44	5.0	15.0	7.60	155.84	<50	1.3	<0.50	1.5	<0.50	9.4	2.02	7.87
03/16/2006	P		163.44	5.0	15.0	6.97	156.47	71	3.0	<0.50	3.5	<0.50	3.4	1.6	7.1
6/26/2006	P		163.44	5.0	15.0	8.58	154.86	71	0.69	<0.50	1.1	3.5	3.2	2.2	6.9
9/29/2006	P		163.44	5.0	15.0	8.85	154.59	<50	<0.50	<0.50	<0.50	<0.50	5.2	2.35	6.7
12/19/2006	P		163.44	5.0	15.0	8.00	155.44	<50	<0.50	<0.50	<0.50	<0.50	4.3	4.80	7.21
<b>MW-2</b>															
4/19/2002	--		161.87	5.0	15.0	6.59	155.28	28,000	970	120	860	6,900	760	--	--
9/27/2002	--		161.87	5.0	15.0	7.18	154.69	17,000	1,400	<50	1,200	3,700	1,400	1.5	6.8
12/16/2002	--	a	161.87	5.0	15.0	7.31	154.56	17,000	1,000	<50	980	3,300	980	1.9	6.8
3/11/2003	--		161.87	5.0	15.0	6.02	155.85	24,000	1,600	70	1,300	4,300	920	1.7	7.4
6/17/2003	--		161.87	5.0	15.0	6.31	155.56	28,000	1,300	55	1,300	4,500	610	1.4	6.9
9/18/2003	--		161.87	5.0	15.0	7.61	154.26	19,000	960	63	1,100	3,100	580	2.7	6.8
12/11/2003	P		161.87	5.0	15.0	6.50	155.37	29,000	710	53	1,300	3,800	490	2.0	7.0
03/11/2004	P		164.29	5.0	15.0	6.02	158.27	19,000	830	49	1,500	4,000	410	0.8	6.5
06/02/2004	P		164.29	5.0	15.0	7.14	157.15	25,000	680	<50	1,300	3,900	240	4.3	7.1
09/22/2004	--		164.29	5.0	15.0	7.63	156.66	15,000	980	<25	980	940	390	--	6.7

**Table 1. Summary of Ground-Water Monitoring Data: Relative Water Elevations and Laboratory Analyses**  
**Station #4977, 2770 Castro Valley Blvd., Castro Valley, CA**

Well and Sample Date	P/NP	Comments	TOC (feet msl)	Top of Screen (ft bgs)	Bottom of Screen (ft bgs)	DTW (feet bgs)	Water Level Elevation (feet msl)	Concentrations in (µg/L)						DO (mg/L)	pH
								GRO/TPHg	Benzene	Toluene	Ethyl-Benzene	Total Xylenes	MTBE		
<b>MW-2 Cont.</b>															
12/15/2004	P	c	164.29	5.0	15.0	6.48	157.81	22,000	610	26	1,300	3,200	290	0.3	6.9
03/07/2005	P		164.29	5.0	15.0	6.08	158.21	25,000	570	33	1,400	3,900	120	2.3	6.8
06/27/2005	P		164.29	5.0	15.0	6.90	157.39	24,000	630	32	1,200	2,900	86	2.5	7.2
09/16/2005	P		164.29	5.0	15.0	7.66	156.63	25,000	550	<25	1,400	3,000	82	1.41	7.0
12/27/2005	P		164.29	5.0	15.0	5.60	158.69	33,000	540	<25	1,300	2,700	100	2.26	7.19
03/16/2006	P	c	164.29	5.0	15.0	7.25	157.04	29,000	710	<50	1,400	2,600	78	1.4	7.1
6/26/2006	P	c	164.29	5.0	15.0	6.60	157.69	20,000	630	<25	1,200	1,100	110	0.64	6.8
9/29/2006	P		164.29	5.0	15.0	6.85	157.44	24,000	530	<25	1,300	1,800	86	1.36	6.7
12/19/2006	P		<b>164.29</b>	<b>5.0</b>	<b>15.0</b>	<b>6.02</b>	<b>158.27</b>	<b>21,000</b>	<b>500</b>	<b>&lt;25</b>	<b>1,400</b>	<b>1,700</b>	<b>70</b>	<b>1.11</b>	<b>7.42</b>
<b>MW-3</b>															
4/19/2002	--		162.14	5.0	15.0	6.94	155.20	1,200	29	1.1	43	62	1,700	--	--
9/27/2002	--		162.14	5.0	15.0	8.26	153.88	740	7.8	<2.5	6.8	4.4	1,100	1	6.7
12/16/2002	--	a	162.14	5.0	15.0	6.76	155.38	1,200	13	<10	170	88	910	2.3	6.8
3/11/2003	--		162.14	5.0	15.0	6.92	155.22	<2,500	<25	<25	<25	<25	470	1.7	7.5
6/17/2003	--		162.14	5.0	15.0	7.44	154.70	<1,000	<10	<10	14	<10	530	1.9	7
9/18/2003	--		162.14	5.0	15.0	8.43	153.71	470	4.8	<2.5	10	9.2	300	2.9	6.8
12/11/2003	P		162.14	5.0	15.0	6.72	155.42	<500	<5.0	<5.0	7.0	13	180	1.9	6.9
03/11/2004	P		164.53	5.0	15.0	6.09	158.44	360	1.9	<1.0	5.6	5.0	110	2.6	6.8
06/02/2004	P		164.53	5.0	15.0	7.50	157.03	380	2.8	<0.50	8.0	2.1	43	3.6	7.3
09/22/2004	P		164.53	5.0	15.0	8.00	156.53	270	<0.50	<0.50	0.54	<0.50	50	1.8	6.9
12/15/2004	P		164.53	5.0	15.0	6.43	158.10	390	3.5	<0.50	20	3.7	49	1.1	6.9
03/07/2005	P		164.53	5.0	15.0	6.12	158.41	1,900	13	<1.0	93	29	70	2.3	6.8
06/27/2005	P		164.53	5.0	15.0	7.08	157.45	830	4.0	<0.50	13	2.8	33	3.3	7.3
09/16/2005	P		164.53	5.0	15.0	7.28	157.25	320	2.1	<0.50	5.4	0.60	21	2.11	7.0
12/27/2005	P		164.53	5.0	15.0	6.47	158.06	770	6.0	<0.50	33	2.7	36	2.96	7.42
03/16/2006	P		164.53	5.0	15.0	6.10	158.43	1,600	11	<0.50	59	6.4	45	1.4	7.1
6/26/2006	P		164.53	5.0	15.0	6.92	157.61	400	<0.50	<0.50	1.6	2.1	26	2.41	7.0
9/29/2006	P		164.53	5.0	15.0	7.38	157.15	220	0.86	<0.50	2.2	0.58	14	1.95	7.0
12/19/2006	P		<b>164.53</b>	<b>5.0</b>	<b>15.0</b>	<b>6.65</b>	<b>157.88</b>	<b>450</b>	<b>4.3</b>	<b>&lt;0.50</b>	<b>19</b>	<b>1.4</b>	<b>19</b>	<b>3.68</b>	<b>7.30</b>



SYMBOLS AND ABBREVIATIONS:

< = Not detected at or above specified laboratory reporting limits

-- = Not measured, sampled, analyzed, applicable

ft bgs = Feet below ground surface

DO = Dissolved oxygen

DTW = Depth to water in ft bgs

GRO = Gasoline range organics

GWE = Groundwater elevation in ft MSL

mg/L = Milligrams per liter

ft MSL = Feet above mean sea level

MTBE = Methyl tert-butyl ether analyzed by EPA Method 8021B unless otherwise noted (before 12/16/02)

P/NP = Well was purged/not purged prior to sampling

TPH-g = Total petroleum hydrocarbons as gasoline (C5-C9)

TOC = Top of casing measured in ft MSL

µg/L = Micrograms per liter

FOOTNOTES:

a = TPH, benzene, toluene, ethylbenzene, total xylenes, and MTBE analyzed by EPA Method 8260B beginning on 4th quarter sampling event (12/16/02).

b = This sample was originally analyzed within the EPA recommended hold time. Re-analysis for confirmation or dilution was performed past the recommended hold time. The results may still be used for their intended purpose.

c = Sheen in well.

NOTES:

Beginning in the fourth quarter 2003, the laboratory modified the reported analyte list. TPH-g was changed to GRO. The resulting data may be impacted by the potential inclusion of non-TPH-g analytes within the requested fuel range resulting in a higher concentration being reported.

Wells were re-surveyed on 3/23/2004.

Values for DO and pH were field measurements.

Beginning in the second quarter 2004, the carbon range for GRO was changed from C6-C10 to C4-C12.

Note: The data within this table collected prior to April 2006 was provided to Broadbent & Associates, Inc. by Atlantic Richfield Company and their previous consultants. Broadbent & Associates, Inc. has not verified the accuracy of this information.

**Table 2. Summary of Fuel Additives Analytical Data**  
**Station #4977, 2770 Castro Valley Blvd., Castro Valley, CA**

Well and Sample Date	Concentrations in (µg/L)								Comments
	Ethanol	TBA	MTBE	DIPE	ETBE	TAME	1,2-DCA	EDB	
<b>MW-1</b>									
12/16/2002	<50	<5.0	42	<0.50	<0.50	<0.50	<0.50	<0.50	
3/11/2003	<100	<20	20	<0.50	<0.50	<0.50	<0.50	<0.50	
6/17/2003	<200	<40	23	<1.0	<1.0	<1.0	<1.0	<1.0	
9/18/2003	<100	<20	39	<0.50	<0.50	<0.50	<0.50	<0.50	a
12/11/2003	<100	<20	48	<0.50	<0.50	<0.50	<0.50	<0.50	
03/11/2004	<100	<20	17	<0.50	<0.50	<0.50	<0.50	<0.50	
06/02/2004	<100	<20	39	<0.50	<0.50	<0.50	<0.50	<0.50	
09/22/2004	<100	<20	48	<0.50	<0.50	<0.50	<0.50	<0.50	
12/15/2004	<100	<20	45	<0.50	<0.50	<0.50	<0.50	<0.50	a
03/07/2005	<100	<20	4.0	<0.50	<0.50	<0.50	<0.50	<0.50	
06/27/2005	<100	<20	8.1	<0.50	<0.50	<0.50	<0.50	<0.50	
09/16/2005	<100	<20	14	<0.50	<0.50	<0.50	<0.50	<0.50	
12/27/2005	<100	<20	9.4	<0.50	<0.50	<0.50	<0.50	<0.50	b
03/16/2006	<300	<20	3.4	<0.50	<0.50	<0.50	<0.50	<0.50	c
6/26/2006	<300	<20	3.2	<0.50	<0.50	<0.50	<0.50	<0.50	
9/29/2006	<300	<20	5.2	<0.50	<0.50	<0.50	<0.50	<0.50	
12/9/2006	<300	<20	4.3	<0.50	<0.50	<0.50	<0.50	--	b
<b>MW-2</b>									
12/16/2002	<5,000	<500	980	<50	<50	<50	<50	<50	
3/11/2003	<10,000	<2,000	920	<50	<50	<50	<50	<50	
6/17/2003	<10,000	<2,000	610	<50	<50	<50	<50	<50	
9/18/2003	<5,000	<1,000	580	<25	<25	<25	<25	<25	
12/11/2003	<5,000	<1,000	490	<25	<25	<25	<25	<25	
03/11/2004	<2,000	<400	410	<10	<10	<10	<10	<10	
06/02/2004	<10,000	<2,000	240	<50	<50	<50	<50	<50	
09/22/2004	<5,000	<1,000	390	<25	<25	<25	<25	<25	
12/15/2004	<2,000	<400	290	<10	<10	<10	<10	<10	a
03/07/2005	<5,000	<1,000	120	<25	<25	<25	<25	<25	
06/27/2005	<5,000	<1,000	86	<25	<25	<25	<25	<25	
09/16/2005	<5,000	<1,000	82	<25	<25	<25	<25	<25	
12/27/2005	<5,000	<1,000	100	<25	<25	<25	<25	<25	b

**Table 2. Summary of Fuel Additives Analytical Data**  
**Station #4977, 2770 Castro Valley Blvd., Castro Valley, CA**

Well and Sample Date	Concentrations in (µg/L)								Comments
	Ethanol	TBA	MTBE	DIPE	ETBE	TAME	1,2-DCA	EDB	
<b>MW-2 Cont.</b>									
03/16/2006	<30,000	<2,000	78	<50	<50	<50	<50	<50	c
6/26/2006	<15,000	<1,000	110	<25	<25	<25	<25	<25	
9/29/2006	<15,000	<1,000	86	<25	<25	<25	<25	<25	
12/9/2006	<15,000	<1,000	70	<25	<25	<25	<25	--	b
<b>MW-3</b>									
12/16/2002	<1,000	<100	910	<10	<10	12	<10	<10	
3/11/2003	<5,000	<1,000	470	<25	<25	<25	<25	<25	
6/17/2003	<2,000	<400	530	<10	<10	<10	<10	<10	
9/18/2003	<500	<100	300	<2.5	<2.5	3.2	<2.5	<2.5	
12/11/2003	<1,000	<200	180	<5.0	<5.0	<5.0	<5.0	<5.0	
03/11/2004	<200	570	110	<1.0	<1.0	<1.0	<1.0	<1.0	
06/02/2004	<100	130	43	<0.50	<0.50	0.56	<0.50	<0.50	
09/22/2004	<100	28	50	<0.50	<0.50	0.51	<0.50	<0.50	
12/15/2004	<100	110	49	<0.50	0.52	0.61	<0.50	<0.50	a
03/07/2005	<200	190	70	<1.0	<1.0	<1.0	<1.0	<1.0	
06/27/2005	<100	130	33	<0.50	<0.50	<0.50	<0.50	<0.50	
09/16/2005	<100	44	21	<0.50	<0.50	<0.50	<0.50	<0.50	
12/27/2005	<100	150	36	<0.50	<0.50	<0.50	<0.50	<0.50	b
03/16/2006	<300	160	45	<0.50	<0.50	0.84	<0.50	<0.50	c
6/26/2006	<300	53	26	<0.50	<0.50	<0.50	<0.50	<0.50	
9/29/2006	<300	55	14	<0.50	<0.50	<0.50	<0.50	<0.50	
12/9/2006	<300	<20	19	<0.50	<0.50	<0.50	<0.50	--	b

SYMBOLS AND ABBREVIATIONS:

< = Not detected at or above specified laboratory reporting limit

1,2-DCA = 1,2-Dichloroethane

DIPE = Di-isopropyl ether

EDB = 1,2-Dibromoethane

ETBE = Ethyl tert-butyl ether

MTBE = Methyl tert-butyl ether

TAME = tert-Amyl methyl ether

TBA = tert-Butyl alcohol

µg/L = Micrograms per liter

FOOTNOTES:

a = This sample was originally analyzed within the EPA recommended hold time. Re-analysis for confirmation or dilution was performed past the recommended hold time. The results may still be used for their intended purpose.

b = Calibration verification for ethanol was within method limits but outside contract limits.

c = Possible high bias for DIPE, 1,2-DCA, and ethanol due to CCV falling outside acceptance criteria.

Note: The data within this table collected prior to April 2006 was provided to Broadbent & Associates, Inc. by Atlantic Richfield Company and their previous consultants. Broadbent & Associates, Inc. has not verified the accuracy of this information.

**Table 3. Historical Ground-Water Flow Direction and Gradient  
Station #4977, 2770 Castro Valley Blvd., Castro Valley, CA**

<b>Date Sampled</b>	<b>Approximate Flow Direction</b>	<b>Approximate Hydraulic Gradient</b>
4/19/2002	Southwest	0.038
9/27/2002	Southwest	0.021
12/16/2002	Southeast	0.029
3/11/2003	South	0.024
6/17/2003	South-Southwest	0.022
9/18/2003	South-Southwest	0.022
3/11/2004	South-Southwest	0.024
6/2/2004	South	0.025
9/22/2004	South	0.025
12/15/2004	South	0.020
3/7/2005	South	0.02
6/27/2005	South	0.01
9/16/2005	Southeast	0.03
12/27/2005	South-Southeast	0.02
3/16/2006	Southeast	0.02
6/26/2006	South	0.03
9/29/2006	South	0.025
12/19/2006	South	0.024

Note: The data within this table collected prior to April 2006 was provided to Broadbent & Associates, Inc. by Atlantic Richfield Company and their previous consultants. Broadbent & Associates, Inc. has not verified the accuracy of this information.

**APPENDIX A**

**STRATUS ENVIRONMENTAL, INC. GROUND-WATER SAMPLING DATA PACKAGE  
(INCLUDES BILL OF LADING, FIELD DATA SHEETS, AND LABORATORY  
REPORT AND CHAIN OF CUSTODY DOCUMENTATION)**

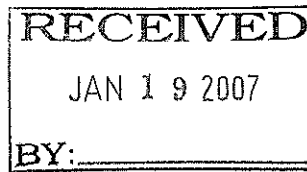

3330 Cameron Park Drive, Ste 550  
Cameron Park, California 95682  
(530) 676-6004 ~ Fax: (530) 676-6005

January 11, 2007

Mr. Rob Miller  
Broadbent & Associates  
2000 Kirman Ave.  
Reno, NV 89502

Re: Groundwater Sampling Data Package, BP Service Station No. 4977, located at 2770 Castro Valley Road, Castro Valley, California (Quarterly Monitoring performed on December 19, 2006)

**General Information**

*Data Submittal Prepared / Reviewed by:* Sandy Hayes / Jay Johnson  
*Phone Number:* (530) 676-6000  
*On-Site Supplier Representative:* Jerry Gonzales  
*Date:* December 19, 2006  
*Arrival:* 13:10                      *Departure:* 15:25  
*Weather Conditions:* Clear  
*Unusual Field Conditions:* None  
*Scope of Work Performed:* Quarterly monitoring and sampling  
*Variations from Work Scope:* None noted

This submittal presents the tabulation of data collected in association with routine groundwater monitoring. The attachments include bill of lading, field data sheets, chain of custody documentation, and certified analytical results. The information is being provided to BP-ARCO's Scoping Supplier for use in preparing a report for regulatory submittal. This submittal is limited to presentation of collected data and does not include data interpretation or conclusions or recommendations. Any questions concerning this submittal should be addressed to the Preparer/Reviewer identified above.

Sincerely,

**STRATUS ENVIRONMENTAL INC.**

Jay R. Johnson, P.G.  
Project Manager



**Attachments:**

- Bill of Lading
- Field Data Sheets
- Chain of Custody Documentation
- Certified Analytical Results

CC: Mr. Paul Supple, BP/ARCO



BP GEM OIL COMPANY

TYPE **A** BILL OF LADING

**SOURCE RECORD BILL OF LADING FOR NON-  
HAZARDOUS PURGEWATER RECOVERED FROM  
GROUNDWATER WELLS AT BP GEM OIL COMPANY  
FACILITIES IN THE STATE OF CALIFORNIA. THE NON-  
HAZARDOUS PURGEWATER WHICH HAS BEEN  
RECOVERED FROM GROUNDWATER WELLS IS  
COLLECTED BY THE CONTRACTOR, MADE UP INTO  
LOADS OF APPROPRIATE SIZE AND HAULED BY  
BELSHIRE ENVIRONMENTAL TO SEAPORT  
ENVIRONMENTAL IN REDWOOD CITY, CALIFORNIA.**

The contractors performing this work are Stratus Environmental, Inc. [Stratus, 3330 Cameron Park Drive, Suite 550, Cameron Park, CA 95682, (530) 676-6004], and Doulos Environmental, Inc. [Doulos, PO Box 2559, Orangevale, CA 95662, (916) 990-0333]. Stratus is authorized by BP GEM OIL COMPANY to recover, collect, and apportion into loads the non-hazardous well purgewater that is drawn from wells at BP GEM Oil Company facilities and deliver that purgewater to BP GEM Oil Company facility 5786 located in West Sacramento, California. Doulos also performs these services under subcontract to Stratus. Transport routing of the non-hazardous well purgewater may be direct from one BP GEM facility to the designated destination point; from one BP GEM facility to the designated destination point via another BP GEM facility; from a BP GEM facility to the designated destination point via the contractor's facility, or any combination thereof. The non-hazardous well purgewater is and remains the property of BP GEM Oil Company.

This **Source Record BILL OF LADING** was initiated to cover the recovery of non-hazardous well purgewater from wells at the BP GEM Oil Company facility described below:

4977

Station #

Castro Valley - 2770 Castro Valley Rd.

Station Address

Total Gallons Collected From Groundwater Monitoring Wells:

46

Added Equipment  
Rinse Water

5

Any Other  
Adjustments

0

**TOTAL GALS.  
RECOVERED**

51

loaded onto  
Doulos vehicle #

Stratus Project #

time date

1545 12/19/06

Signature

Jerry G.

\*\*\*\*\*

RECEIVED AT

time date

BP 5786

1800 12/19/06

Unloaded by

Signature

Jerry G.



# BP ALAMEDA PORTFOLIO

## WATER SAMPLE FIELD DATA SHEET

PROJECT #: 4977 PURGED BY: JG WELL I.D.: MW-1  
 CLIENT NAME: \_\_\_\_\_ SAMPLED BY: [Signature] SAMPLE I.D.: MW1  
 LOCATION: Castro Valley - 2770 Castro Valley Road QA SAMPLES: \_\_\_\_\_

DATE PURGED 12-19-06 START (2400hr) 14:15 END (2400hr) 14:18  
 DATE SAMPLED 12-19-06 SAMPLE TIME (2400hr) 15:05  
 SAMPLE TYPE: Groundwater  Surface Water \_\_\_\_\_ Treatment Effluent \_\_\_\_\_ Other \_\_\_\_\_

CASING DIAMETER: 2" \_\_\_\_\_ 3" \_\_\_\_\_ 4"  5" \_\_\_\_\_ 6" \_\_\_\_\_ 8" \_\_\_\_\_ Other \_\_\_\_\_  
 Casing Volume: (gallons per foot) (0.17) (0.38) (0.67) (1.02) (1.50) (2.60) ( )

DEPTH TO BOTTOM (feet) = 75.00 CASING VOLUME (gal) = 4.6  
 DEPTH TO WATER (feet) = 8.00 CALCULATED PURGE (gal) = 14.0  
 WATER COLUMN HEIGHT (feet) = 1.0 ACTUAL PURGE (gal) = 15.0

### FIELD MEASUREMENTS

DATE	TIME (2400hr)	VOLUME (gal)	TEMP. (degrees F)	CONDUCTIVITY (umhos/cm)	pH (units)	COLOR (visual)	TURBIDITY (NTU)
<u>12-19-06</u>	<u>14:18</u>	<u>5</u>	<u>22.4</u>	<u>1160</u>	<u>7.21</u>	<u>Clear</u>	<u>-</u>
<u>1</u>	<u>14:17</u>	<u>10</u>	<u>21.4</u>	<u>1245</u>	<u>7.20</u>	<u>1</u>	<u>-</u>
	<u>14:18</u>	<u>15</u>	<u>21.2</u>	<u>1275</u>	<u>7.21</u>	<u>1</u>	<u>-</u>

SAMPLE DEPTH TO WATER: 10.71 SAMPLE INFORMATION SAMPLE TURBIDITY: \_\_\_\_\_

80% RECHARGE:  YES  NO ANALYSES: \_\_\_\_\_  
 ODOR: No SAMPLE VESSEL / PRESERVATIVE: Voa-HCC

### PURGING EQUIPMENT

- Bladder Pump
- Centrifugal Pump
- Submersible Pump
- Peristaltic Pump
- Other: \_\_\_\_\_

Pump Depth: 13.00

### SAMPLING EQUIPMENT

- Bladder Pump
- Centrifugal Pump
- Submersible Pump
- Peristaltic Pump
- Other: \_\_\_\_\_

- Bailer (Teflon)
- Bailer (PVC)
- Bailer (Stainless Steel)
- Dedicated \_\_\_\_\_

WELL INTEGRITY: good LOCK#: MW1-00

REMARKS: DO 4.80

SIGNATURE: [Signature] Page \_\_\_\_\_ of \_\_\_\_\_

# BP ALAMEDA PORTFOLIO

## WATER SAMPLE FIELD DATA SHEET

PROJECT #: 4977 PURGED BY: JC WELL I.D.: mw-2  
 CLIENT NAME: \_\_\_\_\_ SAMPLED BY: JS SAMPLE I.D.: mw-2  
 LOCATION: Castro Valley - 2770 Castro Valley Road QA SAMPLES: \_\_\_\_\_

DATE PURGED 12-18-06 START (2400hr) 13:44 END (2400hr) 13:19  
 DATE SAMPLED 12-18-06 SAMPLE TIME (2400hr) 14:27  
 SAMPLE TYPE: Groundwater  Surface Water \_\_\_\_\_ Treatment Effluent \_\_\_\_\_ Other \_\_\_\_\_

CASING DIAMETER: 2" \_\_\_\_\_ 3" \_\_\_\_\_ 4"  5" \_\_\_\_\_ 6" \_\_\_\_\_ 8" \_\_\_\_\_ Other \_\_\_\_\_  
 Casing Volume: (gallons per foot) (0.17) (0.38) (0.67) (1.02) (1.50) (2.60) ( )

DEPTH TO BOTTOM (feet) = 1458 CASING VOLUME (gal) = 4.4  
 DEPTH TO WATER (feet) = 700 CALCULATED PURGE (gal) = 13.2  
 WATER COLUMN HEIGHT (feet) = 658 ACTUAL PURGE (gal) = 13.5

### FIELD MEASUREMENTS

DATE	TIME (2400hr)	VOLUME (gal)	TEMP. (degrees F)	CONDUCTIVITY (umhos/cm)	pH (units)	COLOR (visual)	TURBIDITY (NTU)
<u>12-19-06</u>	<u>1345</u>	<u>4.5</u>	<u>19.9</u>	<u>874</u>	<u>7.70</u>	<u>clear</u>	_____
<u>1</u>	<u>1346</u>	<u>9.0</u>	<u>20.1</u>	<u>856</u>	<u>7.50</u>	<u>clear</u>	_____
<u>1</u>	<u>1347</u>	<u>13.5</u>	<u>21.1</u>	<u>866</u>	<u>7.42</u>	<u>1</u>	_____

### SAMPLE INFORMATION

SAMPLE DEPTH TO WATER: 9.22 SAMPLE TURBIDITY: \_\_\_\_\_

80% RECHARGE:  YES  NO ANALYSES: \_\_\_\_\_  
 ODOR: yes SAMPLE VESSEL / PRESERVATIVE: vac-HCL

#### PURGING EQUIPMENT

#### SAMPLING EQUIPMENT

Bladder Pump \_\_\_\_\_ Bailer (Teflon) \_\_\_\_\_  
 Centrifugal Pump \_\_\_\_\_ Bailer (PVC) \_\_\_\_\_  
 Submersible Pump \_\_\_\_\_ Bailer (Stainless Steel) \_\_\_\_\_  
 Peristaltic Pump \_\_\_\_\_ Dedicated \_\_\_\_\_  
 Other: \_\_\_\_\_  
 Pump Depth: 13.00

Bladder Pump \_\_\_\_\_ Bailer (Teflon) \_\_\_\_\_  
 Centrifugal Pump \_\_\_\_\_ Bailer (  PVC or  disposable )  
 Submersible Pump \_\_\_\_\_ Bailer (Stainless Steel) \_\_\_\_\_  
 Peristaltic Pump \_\_\_\_\_ Dedicated \_\_\_\_\_  
 Other: \_\_\_\_\_

WELL INTEGRITY: COG LOCK#: 16574

REMARKS: DO 1-11

SIGNATURE: [Signature] Page \_\_\_\_\_ of \_\_\_\_\_

# BP ALAMEDA PORTFOLIO

## WATER SAMPLE FIELD DATA SHEET

PROJECT #: 4977 PURGED BY: J. WELL I.D.: MW-3  
 CLIENT NAME: \_\_\_\_\_ SAMPLED BY: J. SAMPLE I.D.: MW-3  
 LOCATION: Castro Valley - 2770 Castro Valley Road QA SAMPLES: \_\_\_\_\_

DATE PURGED 12-19-06 START (2400hr) 14:00 END (2400hr) 14:03  
 DATE SAMPLED \_\_\_\_\_ SAMPLE TIME (2400hr) 14:35  
 SAMPLE TYPE: Groundwater  Surface Water \_\_\_\_\_ Treatment Effluent \_\_\_\_\_ Other \_\_\_\_\_

CASING DIAMETER: 2" \_\_\_\_\_ 3" \_\_\_\_\_ 4"  5" \_\_\_\_\_ 6" \_\_\_\_\_ 8" \_\_\_\_\_ Other \_\_\_\_\_  
 Casing Volume: (gallons per foot) (0.17) (0.38) (0.67) (1.02) (1.50) (2.60) ( )

DEPTH TO BOTTOM (feet) = 14.85 CASING VOLUME (gal) = 5.9  
 DEPTH TO WATER (feet) = 6.65 CALCULATED PURGE (gal) = 16.8  
 WATER COLUMN HEIGHT (feet) = 8.2 ACTUAL PURGE (gal) = 16.7

### FIELD MEASUREMENTS

DATE	TIME (2400hr)	VOLUME (gal)	TEMP. (degrees F)	CONDUCTIVITY (umhos/cm)	pH (units)	COLOR (visual)	TURBIDITY (NTU)
<u>12-19-06</u>	<u>14:01</u>	<u>5.5</u>	<u>21.2</u>	<u>750</u>	<u>7.29</u>	<u>clear</u>	_____
<u>1</u>	<u>14:02</u>	<u>11.2</u>	<u>21.0</u>	<u>720</u>	<u>7.31</u>	<u>1</u>	_____
<u>1</u>	<u>14:03</u>	<u>16.7</u>	<u>21.8</u>	<u>725</u>	<u>7.30</u>	<u>1</u>	_____

SAMPLE DEPTH TO WATER: 9.69 SAMPLE INFORMATION SAMPLE TURBIDITY: \_\_\_\_\_

80% RECHARGE:  YES  NO ANALYSES: \_\_\_\_\_  
 ODOR: NO SAMPLE VESSEL / PRESERVATIVE: VOR-HCL

#### PURGING EQUIPMENT

Bladder Pump  Bailer (Teflon)  
 Centrifugal Pump  Bailer (PVC)  
 Submersible Pump  Bailer (Stainless Steel)  
 Peristaltic Pump  Dedicated \_\_\_\_\_  
 Other: \_\_\_\_\_  
 Pump Depth: 14.01

#### SAMPLING EQUIPMENT

Bladder Pump  Bailer (Teflon)  
 Centrifugal Pump  Bailer (  PVC or  disposable)  
 Submersible Pump  Bailer (Stainless Steel)  
 Peristaltic Pump  Dedicated \_\_\_\_\_  
 Other: \_\_\_\_\_

WELL INTEGRITY: \_\_\_\_\_ LOCK#: Master

REMARKS: D.O 368

SIGNATURE: \_\_\_\_\_ Page \_\_\_ of \_\_\_



bp  
A BP affiliated company

### Chain of Custody Record

Project Name: ARCO 4977  
 BP BU/AR Region/Enfos Segment: BP > Americas > West > Retail > Alameda > 4977  
 State or Lead Regulatory Agency: \_\_\_\_\_  
 Requested Due Date (mm/dd/yy): \_\_\_\_\_

On-site Time: <u>13:10</u>	Temp: <u>65</u>
Off-site Time: <u>15:25</u>	Temp: <u>65</u>
Sky Conditions: <u>Clear</u>	
Meteorological Events: <u>none</u>	
Wind Speed: <u>5</u>	Direction: <u>WA</u>

Lab Name: <u>TestAmerica</u>	BP/AR Facility No.: <u>4977</u>	Consultant/Contractor: <u>Stratus Environmental, Inc.</u>
Address: <u>885 Jarvis Drive</u> <u>Morgan Hill, CA 95937</u>	BP/AR Facility Address: <u>2770 Castro Valley Road, Castro Valley</u>	Address: <u>3330 Cameron Park Drive, Suite 550</u> <u>Cameron Park, CA 95682</u>
Lab PM: <u>Lisa Race</u>	California Global ID No.: <u>T060010089</u>	Consultant/Contractor Project No.:
Tele/Fax: <u>408-782-8156 408-782-6308 (fax)</u>	Enfos Project No.: <u>G0C2H-0017</u>	Consultant/Contractor PM: <u>Jay Johnson</u>
BP/AR PM Contact: <u>Paul Supple</u>	Provision or OOC (circle one) <u>Provision</u>	Tele/Fax: <u>(530) 676-6000 / (530) 676-6005</u>
Address: <u>2010 Crow Canyon Place, Suite 150</u> <u>San Ramon, CA</u>	Phase/WBS: <u>04-Monitoring</u>	Report Type & QC Level: <u>Level I with EDF</u>
Tele/Fax: <u>925-275-3506</u>	Sub Phase/Task: <u>03-Analytical</u>	E-mail EDD To: <u>cjewitt@stratusinc.net</u>
	Cost Element: <u>01-Contractor labor</u>	Invoice to: <u>Atlantic Richfield Co.</u>

Lab Bottle Order No:				Matrix			Laboratory No.	Preservative					Requested Analysis					Sample Point Lat/Long and Comments
Item No.	Sample Description	Time	Date	Soil/Solid	Water/Liquid	Air		Unpreserved	H <sub>2</sub> SO <sub>4</sub>	HNO <sub>3</sub>	HCl	Methanol	GRO/BTEX/Oxy*	1,2-DCA	Ethanol	EDE	DRO	
1	MW-1	1505	12-18-06	X			3			X		X	X	X				
2	MW-2	1427		X			3			X		X	X	X				
3	MW-3	1435		X			6			X		X	X	X				
4	TB-4977-12-19-06	6:00		X			2			X		X	X	X				
5																		
6																		
7																		
8																		
9																		
10																		

\*Oxy = MTBE, TAME, ETBE, DIPE, TBA

14010L

1900

Sampler's Name: <u>Jerry Gwartz</u>	Relinquished By / Affiliation: _____	Date: <u>12/26</u>	Time: <u>11:10</u>	Accepted By / Affiliation: _____	Date: <u>12/26</u>	Time: <u>11:10</u>
Sampler's Company: <u>Douglas Env</u>						
Shipment Date:						
Shipment Method:						
Shipment Tracking No:						

Special Instructions: Please cc results to rmiller@broadbentinc.com

Custody Seals In Place: Yes / No	Temp Blank: Yes / No	Cooler Temp on Receipt: _____ °F/C	Trip Blank: Yes / No	MS/MSD Sample Submitted: Yes / No
----------------------------------	----------------------	------------------------------------	----------------------	-----------------------------------

10 January, 2007

Jay Johnson  
Stratus Environmental Inc. [Arco]  
3330 Cameron Park Dr., Suite 550  
Cameron Park, CA 95682

RE: ARCO #4977, Castro Valley, CA  
Work Order: MPL0745

Enclosed are the results of analyses for samples received by the laboratory on 12/26/06 13:30. If you have any questions concerning this report, please feel free to contact me.

Sincerely,

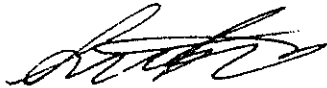

Lisa Race  
Senior Project Manager

CA ELAP Certificate # 1210

The results in this laboratory report pertain only to the samples tested in the laboratory. The analyses contained in this report were performed in accordance with the BPGCLN Technical Specifications, applicable Federal, State, local regulations and certification requirements as well as the methodologies as described in laboratory SOPs reviewed by the BPGCLN. This entire report was reviewed and approved for release.

Stratus Environmental Inc. [Arco] 3330 Cameron Park Dr., Suite 550 Cameron Park CA, 95682	Project: ARCO #4977, Castro Valley, CA Project Number: G0C2H-0017 Project Manager: Jay Johnson	MPL0745 Reported: 01/10/07 15:14
---	--	--

ANALYTICAL REPORT FOR SAMPLES

Sample ID	Laboratory ID	Matrix	Date Sampled	Date Received
MW-1	MPL0745-01	Water	12/19/06 15:05	12/26/06 13:30
MW-2	MPL0745-02	Water	12/19/06 14:27	12/26/06 13:30
MW-3	MPL0745-03	Water	12/19/06 14:35	12/26/06 13:30
TB-4977-12-19-06	MPL0745-04	Water	12/19/06 06:00	12/26/06 13:30

The carbon range for the TPH-GRO has been changed from C6-C10 to C4-C12. The carbon range for TPH-DRO has been changed from C10-C28 to C10-C36. EPA 8015B has been modified to better meet the requirements of California regulatory agencies.

These samples were received with intact custody seals.



Stratus Environmental Inc. [Arco]  
3330 Cameron Park Dr., Suite 550  
Cameron Park CA, 95682

Project: ARCO #4977, Castro Valley, CA  
Project Number: G0C2H-0017  
Project Manager: Jay Johnson

MPL0745  
Reported:  
01/10/07 15:14

**Total Purgeable Hydrocarbons by GC/MS (CA LUFT)**  
**TestAmerica - Morgan Hill, CA**

Analyte	Result	Reporting Limit	Units	Dilution	Batch	Prepared	Analyzed	Method	Notes
<b>MW-1 (MPL0745-01) Water</b> Sampled: 12/19/06 15:05 Received: 12/26/06 13:30									
Gasoline Range Organics (C4-C12)	ND	50	ug/l	1	6L31005	12/31/06	01/01/07	LUFT GCMS	
Surrogate: 1,2-Dichloroethane-d4		81 %	60-145		"	"	"	"	
<b>MW-2 (MPL0745-02) Water</b> Sampled: 12/19/06 14:27 Received: 12/26/06 13:30									
Gasoline Range Organics (C4-C12)	21000	2500	ug/l	50	6L31005	12/31/06	01/01/07	LUFT GCMS	
Surrogate: 1,2-Dichloroethane-d4		82 %	60-145		"	"	"	"	
<b>MW-3 (MPL0745-03) Water</b> Sampled: 12/19/06 14:35 Received: 12/26/06 13:30									
Gasoline Range Organics (C4-C12)	450	50	ug/l	1	6L31005	12/31/06	01/01/07	LUFT GCMS	
Surrogate: 1,2-Dichloroethane-d4		84 %	60-145		"	"	"	"	

Stratus Environmental Inc. [Arco]  
3330 Cameron Park Dr., Suite 550  
Cameron Park CA, 95682

Project: ARCO #4977, Castro Valley, CA  
Project Number: G0C2H-0017  
Project Manager: Jay Johnson

MPL0745  
Reported:  
01/10/07 15:14

**Volatile Organic Compounds by EPA Method 8260B**  
**TestAmerica - Morgan Hill, CA**

Analyte	Result	Reporting Limit	Units	Dilution	Batch	Prepared	Analyzed	Method	Notes
<b>MW-1 (MPL0745-01) Water</b> <b>Sampled: 12/19/06 15:05</b> <b>Received: 12/26/06 13:30</b>									
tert-Amyl methyl ether	ND	0.50	ug/l	1	6L31005	12/31/06	01/01/07	EPA 8260B	
Benzene	ND	0.50	"	"	"	"	"	"	
tert-Butyl alcohol	ND	20	"	"	"	"	"	"	
Di-isopropyl ether	ND	0.50	"	"	"	"	"	"	
1,2-Dichloroethane	ND	0.50	"	"	"	"	"	"	
Ethanol	ND	300	"	"	"	"	"	"	IC
Ethyl tert-butyl ether	ND	0.50	"	"	"	"	"	"	
Ethylbenzene	ND	0.50	"	"	"	"	"	"	
<b>Methyl tert-butyl ether</b>	<b>4.3</b>	<b>0.50</b>	"	"	"	"	"	"	
Toluene	ND	0.50	"	"	"	"	"	"	
Xylenes (total)	ND	0.50	"	"	"	"	"	"	-
<i>Surrogate: Dibromofluoromethane</i>		95 %	75-130	"	"	"	"	"	
<i>Surrogate: 1,2-Dichloroethane-d4</i>		81 %	60-145	"	"	"	"	"	
<i>Surrogate: Toluene-d8</i>		101 %	70-130	"	"	"	"	"	
<i>Surrogate: 4-Bromofluorobenzene</i>		98 %	60-120	"	"	"	"	"	
<b>MW-2 (MPL0745-02) Water</b> <b>Sampled: 12/19/06 14:27</b> <b>Received: 12/26/06 13:30</b>									
tert-Amyl methyl ether	ND	25	ug/l	50	6L31005	12/31/06	01/01/07	EPA 8260B	
<b>Benzene</b>	<b>500</b>	25	"	"	"	"	"	"	
tert-Butyl alcohol	ND	1000	"	"	"	"	"	"	
Di-isopropyl ether	ND	25	"	"	"	"	"	"	
1,2-Dichloroethane	ND	25	"	"	"	"	"	"	
Ethanol	ND	15000	"	"	"	"	"	"	IC
Ethyl tert-butyl ether	ND	25	"	"	"	"	"	"	
<b>Ethylbenzene</b>	<b>1400</b>	25	"	"	"	"	"	"	
<b>Methyl tert-butyl ether</b>	<b>70</b>	25	"	"	"	"	"	"	
Toluene	ND	25	"	"	"	"	"	"	
<b>Xylenes (total)</b>	<b>1700</b>	25	"	"	"	"	"	"	
<i>Surrogate: Dibromofluoromethane</i>		95 %	75-130	"	"	"	"	"	
<i>Surrogate: 1,2-Dichloroethane-d4</i>		82 %	60-145	"	"	"	"	"	
<i>Surrogate: Toluene-d8</i>		103 %	70-130	"	"	"	"	"	
<i>Surrogate: 4-Bromofluorobenzene</i>		100 %	60-120	"	"	"	"	"	

Stratus Environmental Inc. [Arco]  
3330 Cameron Park Dr., Suite 550  
Cameron Park CA, 95682

Project: ARCO #4977, Castro Valley, CA  
Project Number: G0C2H-0017  
Project Manager: Jay Johnson

MPL0745  
Reported:  
01/10/07 15:14

**Volatile Organic Compounds by EPA Method 8260B**  
**TestAmerica - Morgan Hill, CA**

Analyte	Result	Reporting Limit	Units	Dilution	Batch	Prepared	Analyzed	Method	Notes
<b>MW-3 (MPL0745-03) Water Sampled: 12/19/06 14:35 Received: 12/26/06 13:30</b>									
tert-Amyl methyl ether	ND	0.50	ug/l	1	6L31005	12/31/06	01/01/07	EPA 8260B	
<b>Benzene</b>	<b>4.3</b>	<b>0.50</b>	"	"	"	"	"	"	
tert-Butyl alcohol	ND	20	"	"	"	"	"	"	
Di-isopropyl ether	ND	0.50	"	"	"	"	"	"	
1,2-Dichloroethane	ND	0.50	"	"	"	"	"	"	
Ethanol	ND	300	"	"	"	"	"	"	IC
Ethyl tert-butyl ether	ND	0.50	"	"	"	"	"	"	
<b>Ethylbenzene</b>	<b>19</b>	<b>0.50</b>	"	"	"	"	"	"	
<b>Methyl tert-butyl ether</b>	<b>19</b>	<b>0.50</b>	"	"	"	"	"	"	
Toluene	ND	0.50	"	"	"	"	"	"	
<b>Xylenes (total)</b>	<b>1.4</b>	<b>0.50</b>	"	"	"	"	"	"	-
<i>Surrogate: Dibromofluoromethane</i>		94 %		75-130	"	"	"	"	
<i>Surrogate: 1,2-Dichloroethane-d4</i>		84 %		60-145	"	"	"	"	
<i>Surrogate: Toluene-d8</i>		102 %		70-130	"	"	"	"	
<i>Surrogate: 4-Bromofluorobenzene</i>		99 %		60-120	"	"	"	"	

Stratus Environmental Inc. [Arco]  
3330 Cameron Park Dr., Suite 550  
Cameron Park CA, 95682

Project: ARCO #4977, Castro Valley, CA  
Project Number: G0C2H-0017  
Project Manager: Jay Johnson

MPL0745  
Reported:  
01/10/07 15:14

**Total Purgeable Hydrocarbons by GC/MS (CA LUFT) - Quality Control**  
**TestAmerica - Morgan Hill, CA**

Analyte	Result	Reporting Limit	Units	Spike Level	Source Result	%REC	%REC Limits	RPD	RPD Limit	Notes
---------	--------	-----------------	-------	-------------	---------------	------	-------------	-----	-----------	-------

**Batch 6L31005 - EPA 5030B P/T / LUFT GCMS**

<b>Blank (6L31005-BLK1)</b>										
					Prepared: 12/31/06 Analyzed: 01/01/07					
Gasoline Range Organics (C4-C12)	ND	50	ug/l							
Surrogate: 1,2-Dichloroethane-d4	2.08		"	2.50		83	60-145			
<b>Laboratory Control Sample (6L31005-BS2)</b>										
					Prepared: 12/31/06 Analyzed: 01/01/07					
Gasoline Range Organics (C4-C12)	535	50	ug/l	500		107	75-140			
Surrogate: 1,2-Dichloroethane-d4	2.09		"	2.50		84	60-145			
<b>Laboratory Control Sample Dup (6L31005-BSD2)</b>										
					Prepared: 12/31/06 Analyzed: 01/01/07					
Gasoline Range Organics (C4-C12)	519	50	ug/l	500		104	75-140	3	20	-
Surrogate: 1,2-Dichloroethane-d4	2.13		"	2.50		85	60-145			

Stratus Environmental Inc. [Arco]  
3330 Cameron Park Dr., Suite 550  
Cameron Park CA, 95682

Project: ARCO #4977, Castro Valley, CA  
Project Number: G0C2H-0017  
Project Manager: Jay Johnson

MPL0745  
Reported:  
01/10/07 15:14

**Volatile Organic Compounds by EPA Method 8260B - Quality Control**  
**TestAmerica - Morgan Hill, CA**

Analyte	Result	Reporting Limit	Units	Spike Level	Source Result	%REC	%REC Limits	RPD	RPD Limit	Notes
---------	--------	-----------------	-------	-------------	---------------	------	-------------	-----	-----------	-------

**Batch 6L31005 - EPA 5030B P/T / EPA 8260B**

**Blank (6L31005-BLK1)**

Prepared: 12/31/06 Analyzed: 01/01/07

tert-Amyl methyl ether	ND	0.50	ug/l							
Benzene	ND	0.50	"							
tert-Butyl alcohol	ND	20	"							
Di-isopropyl ether	ND	0.50	"							
1,2-Dichloroethane	ND	0.50	"							
Ethanol	ND	300	"							
Ethyl tert-butyl ether	ND	0.50	"							
Ethylbenzene	ND	0.50	"							
Methyl tert-butyl ether	ND	0.50	"							
Toluene	ND	0.50	"							
Xylenes (total)	ND	0.50	"							

<i>Surrogate: Dibromofluoromethane</i>	2.32		"	2.50		93	75-130			
<i>Surrogate: 1,2-Dichloroethane-d4</i>	2.08		"	2.50		83	60-145			
<i>Surrogate: Toluene-d8</i>	2.49		"	2.50		100	70-130			
<i>Surrogate: 4-Bromofluorobenzene</i>	2.27		"	2.50		91	60-120			

**Laboratory Control Sample (6L31005-BS1)**

Prepared: 12/31/06 Analyzed: 01/01/07

tert-Amyl methyl ether	9.72	0.50	ug/l	10.0		97	65-135			
Benzene	9.96	0.50	"	10.0		100	70-125			
tert-Butyl alcohol	184	20	"	200		92	60-135			
Di-isopropyl ether	9.66	0.50	"	10.0		97	70-130			
1,2-Dichloroethane	8.94	0.50	"	10.0		89	75-125			
Ethanol	244	300	"	200		122	15-150			
Ethyl tert-butyl ether	9.74	0.50	"	10.0		97	65-130			
Ethylbenzene	10.7	0.50	"	10.0		107	70-130			
Methyl tert-butyl ether	8.97	0.50	"	10.0		90	50-140			
Toluene	10.3	0.50	"	10.0		103	70-120			
Xylenes (total)	33.5	0.50	"	30.0		112	80-125			

<i>Surrogate: Dibromofluoromethane</i>	2.45		"	2.50		98	75-130			
<i>Surrogate: 1,2-Dichloroethane-d4</i>	2.12		"	2.50		85	60-145			
<i>Surrogate: Toluene-d8</i>	2.56		"	2.50		102	70-130			
<i>Surrogate: 4-Bromofluorobenzene</i>	2.45		"	2.50		98	60-120			

Stratus Environmental Inc. [Arco]  
3330 Cameron Park Dr., Suite 550  
Cameron Park CA, 95682

Project: ARCO #4977, Castro Valley, CA  
Project Number: G0C2H-0017  
Project Manager: Jay Johnson

MPL0745  
Reported:  
01/10/07 15:14

**Volatile Organic Compounds by EPA Method 8260B - Quality Control**  
**TestAmerica - Morgan Hill, CA**

Analyte	Result	Reporting Limit	Units	Spike Level	Source Result	%REC	%REC Limits	RPD	RPD Limit	Notes
---------	--------	-----------------	-------	-------------	---------------	------	-------------	-----	-----------	-------

**Batch 6L31005 - EPA 5030B P/T / EPA 8260B**

Matrix Spike (6L31005-MS1)	Source: MPL0745-03			Prepared: 12/31/06 Analyzed: 01/01/07						
tert-Amyl methyl ether	9.63	0.50	ug/l	10.0	ND	96	65-135			
Benzene	14.3	0.50	"	10.0	4.3	100	70-125			
tert-Butyl alcohol	233	20	"	200	ND	116	60-135			
Di-isopropyl ether	9.64	0.50	"	10.0	ND	96	70-130			
1,2-Dichloroethane	8.84	0.50	"	10.0	ND	88	75-125			
Ethanol	231	300	"	200	ND	116	15-150			
Ethyl tert-butyl ether	9.80	0.50	"	10.0	ND	98	65-130			
Ethylbenzene	29.6	0.50	"	10.0	19	106	70-130			
Methyl tert-butyl ether	28.3	0.50	"	10.0	19	93	50-140			
Toluene	10.4	0.50	"	10.0	ND	104	70-120			
Xylenes (total)	35.0	0.50	"	30.0	1.4	112	80-125			
<i>Surrogate: Dibromofluoromethane</i>	<i>2.39</i>		<i>"</i>	<i>2.50</i>		<i>96</i>	<i>75-130</i>			
<i>Surrogate: 1,2-Dichloroethane-d4</i>	<i>2.11</i>		<i>"</i>	<i>2.50</i>		<i>84</i>	<i>60-145</i>			
<i>Surrogate: Toluene-d8</i>	<i>2.54</i>		<i>"</i>	<i>2.50</i>		<i>102</i>	<i>70-130</i>			
<i>Surrogate: 4-Bromofluorobenzene</i>	<i>2.48</i>		<i>"</i>	<i>2.50</i>		<i>99</i>	<i>60-120</i>			

Matrix Spike Dup (6L31005-MSD1)	Source: MPL0745-03			Prepared: 12/31/06 Analyzed: 01/01/07						
tert-Amyl methyl ether	9.85	0.50	ug/l	10.0	ND	98	65-135	2	25	
Benzene	14.8	0.50	"	10.0	4.3	105	70-125	3	15	
tert-Butyl alcohol	255	20	"	200	ND	128	60-135	9	35	
Di-isopropyl ether	9.91	0.50	"	10.0	ND	99	70-130	3	35	
1,2-Dichloroethane	9.12	0.50	"	10.0	ND	91	75-125	3	10	
Ethanol	275	300	"	200	ND	138	15-150	17	35	
Ethyl tert-butyl ether	10.0	0.50	"	10.0	ND	100	65-130	2	35	
Ethylbenzene	29.9	0.50	"	10.0	19	109	70-130	1	15	
Methyl tert-butyl ether	28.6	0.50	"	10.0	19	96	50-140	1	25	
Toluene	10.6	0.50	"	10.0	ND	106	70-120	2	15	
Xylenes (total)	34.7	0.50	"	30.0	1.4	111	80-125	0.9	15	
<i>Surrogate: Dibromofluoromethane</i>	<i>2.46</i>		<i>"</i>	<i>2.50</i>		<i>98</i>	<i>75-130</i>			
<i>Surrogate: 1,2-Dichloroethane-d4</i>	<i>2.14</i>		<i>"</i>	<i>2.50</i>		<i>86</i>	<i>60-145</i>			
<i>Surrogate: Toluene-d8</i>	<i>2.64</i>		<i>"</i>	<i>2.50</i>		<i>106</i>	<i>70-130</i>			
<i>Surrogate: 4-Bromofluorobenzene</i>	<i>2.53</i>		<i>"</i>	<i>2.50</i>		<i>101</i>	<i>60-120</i>			

Stratus Environmental Inc. [Arco]  
3330 Cameron Park Dr., Suite 550  
Cameron Park CA, 95682

Project: ARCO #4977, Castro Valley, CA  
Project Number: G0C2H-0017  
Project Manager: Jay Johnson

MPL0745  
Reported:  
01/10/07 15:14

**Notes and Definitions**

IC      Calib. verif. is within method limits but outside contract limits  
DET     Analyte DETECTED  
ND      Analyte NOT DETECTED at or above the reporting limit or MDL, if MDL is specified  
NR      Not Reported  
dry      Sample results reported on a dry weight basis  
RPD     Relative Percent Difference



### Chain of Custody Record

Project Name: ARCO 4977  
 BP BU/AR Region/Enfos Segment: BP > Americas > West > Retail > Alameda > 4977  
 State or Lead Regulatory Agency: \_\_\_\_\_  
 Requested Due Date (mm/dd/yy): \_\_\_\_\_

On-site Time: <u>13:10</u>	Temp: <u>65</u>
Off-site Time: <u>15:25</u>	Temp: <u>63</u>
Sky Conditions: <u>Clear</u>	
Meteorological Events: <u>none</u>	
Wind Speed: <u>0</u>	Direction: <u>WA</u>

Lab Name: <u>TestAmerica</u>	BP/AR Facility No.: <u>4977</u>	Consultant/Contractor: <u>Stratus Environmental, Inc.</u>
Address: <u>885 Jarvis Drive</u>	BP/AR Facility Address: <u>2770 Castro Valley Road, Castro Valley</u>	Address: <u>3330 Cameron Park Drive, Suite 550-</u>
<u>Morgan Hill, CA 95937</u>	Site Lat/Long:	<u>Cameron Park, CA 95682</u>
Lab PM: <u>Lisa Race</u>	California Global ID No.: <u>T060010089</u>	Consultant/Contractor Project No.:
Tele/Fax: <u>408-782-8156 408-782-6308 (fax)</u>	Enfos Project No.: <u>G0C2H-0017</u>	Consultant/Contractor PM: <u>Jay Johnson</u>
BP/AR PM Contact: <u>Paul Supple</u>	Provision or OOC (circle one) <u>Provision</u>	Tele/Fax: <u>(530) 676-6000 / (530) 676-6005</u>
Address: <u>2010 Crow Canyon Place, Suite 150</u>	Phase/WBS: <u>04-Monitoring</u>	Report Type & QC Level: <u>Level 1 with EDF</u>
<u>San Ramon, CA</u>	Sub Phase/Task: <u>03-Analytical</u>	E-mail EDD To: <u>cjewitt@stratusinc.net</u>
Tele/Fax: <u>925-275-3506</u>	Cost Element: <u>01-Contractor labor</u>	Invoice to: <u>Atlantic Richfield Co.</u>

Item No.	Sample Description	Time	Date	Matrix			Laboratory No.	No. of Containers	Preservative					Requested Analysis					Sample Point Lat/Long and Comments			
				Soil/Solid	Water/Liquid	Air			Unpreserved	H <sub>2</sub> SO <sub>4</sub>	HNO <sub>3</sub>	HCl	Methanol	GRO/BTEX/Oxy*	1,2-DCA	Ethanol	EDB	DRO				
1	MW-1	1505	12/18/06	X			01	3			X			X	X	X						
2	MW-2	1427		X			02	3			X			X	X	X						*Oxy = MTBE, TAME, ETBE, DIPE, TBA
3	MW-3	1435		X			03	6			X			X	X	X						
4	IB-4977-12-19-06	6:00		X			04	2				X		X	X							Hold
5																						
6																						
7																						
8																						
9																						
10																						

Sampler's Name: <u>Jerry Gonzalez</u>	Relinquished By / Affiliation	Date	Time	Accepted By / Affiliation	Date	Time
Sampler's Company: <u>Doulos Env</u>	<u>[Signature]</u>	<u>12/26</u>	<u>11:10</u>	<u>[Signature]</u>	<u>12/26</u>	<u>11:00</u>
Shipment Date:					<u>12/26</u>	<u>15:30</u>
Shipment Method:						
Tracking No:						

Please cc results to [rmiller@broadbentinc.com](mailto:rmiller@broadbentinc.com)

Yes/No | Temp Blank Yes/No | Cooler Temp on Receipt: 7.1 °F/C | Trip Blank Yes/No | MS/MSD Sample Submitted: Yes/No



## TEST AMERICA SAMPLE RECEIPT LOG

CLIENT NAME: Bo  
 REC. BY (PRINT): EL  
 WORKORDER: MPL0745

DATE REC'D AT LAB: 12/26/06  
 TIME REC'D AT LAB: 1330  
 DATE LOGGED IN: 12/27/06

For Regulatory Purposes?  
 DRINKING WATER YES / NO  
 WASTE WATER YES / NO

CIRCLE THE APPROPRIATE RESPONSE		LAB SAMPLE #	CLIENT ID	CONTAINER DESCRIPTION	PRESERVATIVE	pH	SAMPLE MATRIX	DATE SAMPLED	REMARKS: CONDITION (ETC.)
1. Custody Seal(s)	<input checked="" type="radio"/> Present / <input type="radio"/> Absent <input type="radio"/> Intact / <input type="radio"/> Broken*								
2. Chain-of-Custody	<input checked="" type="radio"/> Present / <input type="radio"/> Absent*								
3. Traffic Reports or Packing List:	Present / <input checked="" type="radio"/> Absent								
4. Airbill:	Airbill / Sticker Present / <input checked="" type="radio"/> Absent								
5. Airbill #:									
6. Sample Labels:	<input checked="" type="radio"/> Present / <input type="radio"/> Absent								
7. Sample IDs:	<input checked="" type="radio"/> Listed / <input type="radio"/> Not Listed on Chain-of-Custody								
8. Sample Condition:	<input checked="" type="radio"/> Intact / <input type="radio"/> Broken* / <input type="radio"/> Leaking*								
9. Does information on chain-of-custody, traffic reports and sample labels agree?	<input checked="" type="radio"/> Yes / <input type="radio"/> No*								
10. Sample received within hold time?	<input checked="" type="radio"/> Yes / <input type="radio"/> No*								
11. Adequate sample volume received?	<input checked="" type="radio"/> Yes / <input type="radio"/> No*								
12. Proper preservatives used?	<input checked="" type="radio"/> Yes / <input type="radio"/> No*								
13. Trip Blank / Temp Blank Received? (circle which, if yes)	<input checked="" type="radio"/> Yes / <input type="radio"/> No*								
14. Read Temp: <u>2.4°C</u> Corrected Temp: <u>" "</u> Is corrected temp 4 +/-2°C? <input checked="" type="radio"/> Yes / <input type="radio"/> No** <small>(tolerance range for samples requiring thermal pres.)</small>									
(if any): METALS / DFF ON ICE									

\*IF CIRCLED, CONTACT PROJECT MANAGER AND ATTACH RECORD OF RESOLUTION.

**APPENDIX B**

**GEOTRACKER UPLOAD CONFIRMATION**

# Electronic Submittal Information

[Main Menu](#) | [View/Add Facilities](#) | [Upload EDD](#) | [Check EDD](#)

Your EDF file has been successfully uploaded!

**Confirmation Number:** 1707891285  
**Date/Time of Submittal:** 1/26/2007 12:01:58 PM  
**Facility Global ID:** T0600100089  
**Facility Name:** ARCO #4977  
**Submittal Title:** 4Q06 GW Monitoring  
**Submittal Type:** GW Monitoring Report

[Click here](#) to view the detections report for this upload.

<b>ARCO #4977</b> 2770 CASTRO VALLEY CASTRO VALLEY, CA 94546	<b>Regional Board - Case #: 01-0097</b> SAN FRANCISCO BAY RWQCB (REGION 2) <b>Local Agency (lead agency) - Case #: RO0002436</b> ALAMEDA COUNTY LOP - (SP)
--	---

<u>CONF #</u>	<u>TITLE</u>	<u>QUARTER</u>
1707891285	4Q06 GW Monitoring	Q4 2006
<u>SUBMITTED BY</u>	<u>SUBMIT DATE</u>	<u>STATUS</u>
Broadbent & Associates, Inc.	1/26/2007	PENDING REVIEW

## SAMPLE DETECTIONS REPORT

# FIELD POINTS SAMPLED	3
# FIELD POINTS WITH DETECTIONS	3
# FIELD POINTS WITH WATER SAMPLE DETECTIONS ABOVE MCL	2
SAMPLE MATRIX TYPES	WATER

## METHOD QA/QC REPORT

METHODS USED	8260FA,8260TPH
TESTED FOR REQUIRED ANALYTES?	Y
LAB NOTE DATA QUALIFIERS	Y

## QA/QC FOR 8021/8260 SERIES SAMPLES

TECHNICAL HOLDING TIME VIOLATIONS	0
METHOD HOLDING TIME VIOLATIONS	0
LAB BLANK DETECTIONS ABOVE REPORTING DETECTION LIMIT	0
LAB BLANK DETECTIONS	0
DO ALL BATCHES WITH THE 8021/8260 SERIES INCLUDE THE FOLLOWING?	
- LAB METHOD BLANK	Y
- MATRIX SPIKE	N
- MATRIX SPIKE DUPLICATE	N
- BLANK SPIKE	Y
- SURROGATE SPIKE	Y

## WATER SAMPLES FOR 8021/8260 SERIES

MATRIX SPIKE / MATRIX SPIKE DUPLICATE(S) % RECOVERY BETWEEN 65-135%	Y
MATRIX SPIKE / MATRIX SPIKE DUPLICATE(S) RPD LESS THAN 30%	Y
SURROGATE SPIKES % RECOVERY BETWEEN 85-115%	Y
BLANK SPIKE / BLANK SPIKE DUPLICATES % RECOVERY BETWEEN 70-130%	Y

**SOIL SAMPLES FOR 8021/8260 SERIES**

MATRIX SPIKE / MATRIX SPIKE DUPLICATE(S) % RECOVERY BETWEEN 65-135%	n/a
MATRIX SPIKE / MATRIX SPIKE DUPLICATE(S) RPD LESS THAN 30%	n/a
SURROGATE SPIKES % RECOVERY BETWEEN 70-125%	n/a
BLANK SPIKE / BLANK SPIKE DUPLICATES % RECOVERY BETWEEN 70-130%	n/a

**FIELD QC SAMPLES**

<u>SAMPLE</u>	<u>COLLECTED</u>	<u>DETECTIONS &gt; REPD</u>
QCTB SAMPLES	N	0
QCEB SAMPLES	N	0
QCAB SAMPLES	N	0

Logged in as BROADBENT-C (CONTRACTOR)

CONTACT SITE ADMINISTRATOR.

Station #4977

## Electronic Submittal Information

[Main Menu](#) | [View/Add Facilities](#) | [Upload EDD](#) | [Check EDD](#)

### UPLOADING A GEO\_WELL FILE

**Processing is complete. No errors were found!  
Your file has been successfully submitted!**

**Submittal Title:** 4Q06 GEO\_WELL  
**Submittal Date/Time:** 1/24/2007 3:33:11 PM  
**Confirmation Number:** 3302523553

[Back to Main Menu](#)

Logged in as BROADBENT-C  
(CONTRACTOR)

[CONTACT SITE ADMINISTRATOR](#)