

RECEIVED

By Alameda County Environmental Health at 4:34 pm, Oct 29, 2013

Atlantic Richfield Company

Chuck Carmel
Project Manager

PO Box 1257
San Ramon, CA 94583
Phone: (925) 275-3803
Fax: (925) 275-3815
E-Mail: charles.carmel@bp.com

October 23, 2013

Re: Third Quarter 2013 Status Report
Atlantic Richfield Company Station #4977
2770 Castro Valley Boulevard, Castro Valley, California
ACEH Case #RO0002436

"I declare, that to the best of my knowledge at the present time, that the information and/or recommendations contained in the attached document are true and correct.

Submitted by,



Chuck Carmel
Project Manager

Attachment

THIRD QUARTER 2013 STATUS REPORT
Atlantic Richfield Company Station #4977
2770 Castro Valley Blvd, Castro Valley, California
ACEH Case #RO0002436

Prepared for

Mr. Chuck Carmel
Project Manager
Atlantic Richfield Company
P.O. Box 1257
San Ramon, California 94583

Prepared by



1370 Ridgewood Drive, Suite 5
Chico, California 95973
(530) 566-1400
www.broadbentinc.com

October 23, 2013

Project No. 06-82-625



BROADBENT

1370 Ridgewood Drive, Suite 5, Chico, CA 95973

[T] 530-566-1400 [F] 530-566-1401

broadbentinc.com

CREATING SOLUTIONS. BUILDING TRUST.

October 23, 2013

Project No. 06-82-625

Atlantic Richfield Company
P.O. Box 1257
San Ramon, California 94583
Submitted via ENFOS

Attn.: Mr. Chuck Carmel

Re: Third Quarter 2013 Status Report, Atlantic Richfield Company Station #4977
2770 Castro Valley Blvd, Castro Valley, California; ACEH Case #RO0002436

Dear Mr. Carmel:

Provided herein is the *Third Quarter 2013 Status Report* for Atlantic Richfield Company (a BP affiliated company) Station #4977 located at 2770 Castro Valley Blvd., Castro Valley, Alameda County, California (Site). This report presents a summary of current developments regarding the Site through the Third Quarter 2013.

Should you have questions regarding this submission, please do not hesitate to contact us at (530) 566-1400.

Sincerely,

BROADBENT & ASSOCIATES, INC.

Jason Duda
Project Scientist

Robert H. Miller, P.G., C.HG.
Principal Hydrogeologist



Enclosures

cc: Ms. Dilan Roe, ACEH (Submitted via ACEH ftp Site)
GeoTracker

**THIRD QUARTER 2013 STATUS REPORT
STATION #4977, CASTRO VALLEY, CA**

Broadbent & Associates, Inc. (Broadbent) is pleased to present this *Third Quarter 2013 Status Report* on behalf of Atlantic Richfield Company (a BP affiliated company) for Station #4977 located in Castro Valley, Alameda County, California. Reporting is being submitted to the Alameda County Environmental Health Services Agency (ACEH) consistent with their requirements under the legal authority of the California Regional Water Quality Control Board as codified by California Code of Regulations Title 23, Section 2652(d). A summary description of current developments regarding the site is provided below.

Facility Name / Address:	Station #4977 / 2770 Castro Valley Boulevard, Castro Valley, CA
Client Project Manager / Title:	Mr. Chuck Carmel / Project Manager
Broadbent Contact:	Jason Duda, (530) 566-1400
Broadbent Project No.:	06-82-625
Primary Regulatory Agency / ID No.:	ACEH, Case #RO0002436
Current phase of project:	Monitoring and Site Evaluation
List of Acronyms / Abbreviations:	See end of report text for list of acronyms/abbreviations used in report.

WORK PERFORMED THIS QUARTER (Third Quarter 2013):

1. Prepared and submitted the *Second Quarter 2013 Semi-Annual Groundwater Monitoring Report* (Broadbent, 7/26/2013).
2. No environmental work was conducted at the Site during Second Quarter 2013.

WORK PROPOSED FOR NEXT QUARTER (Fourth Quarter 2013):

1. Prepared and submitted this *Third Quarter 2013 Status Report* (contained herein).
2. Conduct semi-annual groundwater monitoring/sampling for Fourth Quarter 2013.
3. Prepare and submit Conceptual Site Model and Case Closure Evaluation Report.

GROUNDWATER MONITORING PLAN SUMMARY:

Groundwater level gauging:	MW-1 through MW-3	(2Q & 4Q)
Groundwater sample collection:	MW-1 through MW-3	(2Q & 4Q)
Biodegradation indicator parameter monitoring:	NA	

DISCUSSION:

No environmental field activities were conducted at the Site during Third Quarter 2013. For reference, a Site Location Map is provided as Drawing 1. Provided as Drawing 2 is the Groundwater Elevation Contour and Analytical Summary Map from the *Second Quarter 2013 Semi-Annual Groundwater Monitoring Report* (Broadbent, 7/26/2013) for groundwater monitoring/sampling conducted on April 24, 2013. The next groundwater monitoring/sampling event is scheduled to be conducted during Fourth Quarter 2013.

Following additional review of current Site conditions and a meeting with ACEH, preparation and submittal of a Conceptual Site Model and Case Closure Evaluation is anticipated to be completed during Fourth Quarter 2013.

ATTACHMENTS:

- Drawing 1 Site Location Map, Station #4977, 2770 Castro Valley Boulevard, Castro Valley, California
- Drawing 2. Groundwater Elevation Contour and Analytical Summary Map, Second Quarter 2013,
Station #4977, 2770 Castro Valley Boulevard, Castro Valley, California

LIST OF COMMONLY USED ACCRONYMS/ABBREVIATIONS:

ACEH:	Alameda County Environmental Health	gal:	Gallons
BTEX:	Benzene, Toluene, Ethylbenzene, Total Xylenes	GRO:	Gasoline-Range Organics
1,2-DCA:	1,2-Dichloroethane	LNAPL:	Light Non-Aqueous Phase Liquid
DIPE:	Di-Isopropyl Ether	MTBE:	Methyl Tertiary Butyl Ether
DO:	Dissolved Oxygen	NO ₃ :	Nitrate as Nitrogen
DRO:	Diesel-Range Organics	ppb:	parts per billion
EDB:	1,2-Dibromomethane	SO ₄ :	Sulfate
ft/ft:	feet per foot		

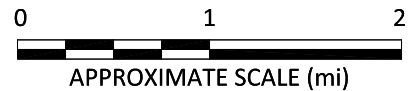

IMAGE SOURCE: DELORME



1370 Ridgewood Dr., Suite 5
Chico, California 95973

Project No.: 06-82-625 Date: 11/29/2012

Station #4977
2770 Castro Valley Blvd.
Castro Valley, California

Site Location Map

Drawing

1

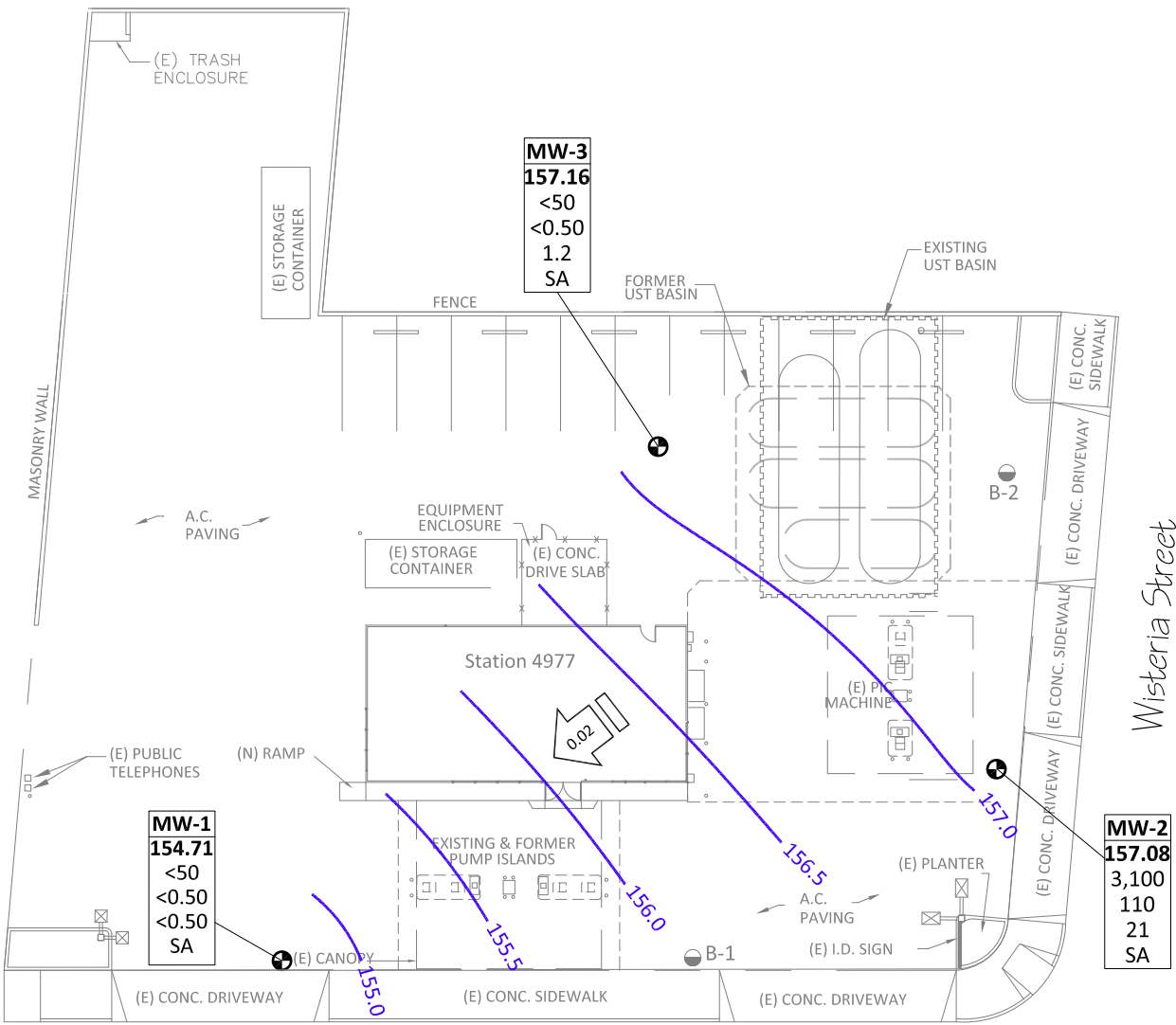

NOTE: SITE MAP ADAPTED FROM DELTA ENVIRONMENTAL FIGURES.
SITE DIMENSIONS AND FACILITY LOCATIONS NOT VERIFIED.

LEGEND

⊕ Monitor Well Location

● Soil Boring Location

Well — Well Designation

ELEV — Groundwater Elevation (ft.)

GRO — Concentration of GRO, Benzene and MTBE in Groundwater (µg/L)

SA — Sampling Frequency

< — Not Detected at or Above Laboratory Reporting Limits

SA — Sampled Semi-Annually

155.0 — Groundwater Elevation Contour (ft)

0.02 — Approximate Groundwater Gradient (ft/ft)

