

ExxonMobil
Refining & Supply Company
Global Remediation

25A Crescent Drive, #407
Pleasant Hill, California
(925) 246-8768 Telephone
(925) 246-7822 Facsimile
gene.n.ortega@exxonmobil.com

Alameda County

MAY 21 2004

Environmental Health

Gene. N. Ortega
Project Manager
Global Remediation – US Retail

202426

ExxonMobil
Refining & Supply

May 19, 2004

Mr. Scott Seery
Alameda County Health Care Services Agency
Department of Environmental Health
1131 Harbor Bay Parkway, Suite 250
Alameda, California 94502-6577

RE: Former Exxon RAS #7-3567/3192 Santa Rita Road, Pleasanton, California.

Dear Mr. Seery:

Attached for your review and comment is a letter report entitled *Groundwater Monitoring Report, First Quarter 2004*, dated May 5, 2002, for the above-referenced site. The report was prepared by Environmental Resolutions, Inc. (ERI) of Novato, California, and details groundwater monitoring and sampling activities for the subject site.

If you have any questions or comments, please contact me at (925) 246-8747.

Sincerely,



Gene N. Ortega
Project Manager

Attachment: ERI's Groundwater Monitoring Report, First Quarter 2004, dated May 5, 2002.

cc: w/ attachment
Ms. Colleen Morf, Zone 7 Water Agency
Mr. Joseph A. Aldridge, Valero Energy Corporation
Mr. Eddy So, California Regional Water Quality Control Board, San Francisco Bay Region

w/o attachment
Mr. Robert A. Saur, Environmental Resolutions, Inc.

MAY 21 2004

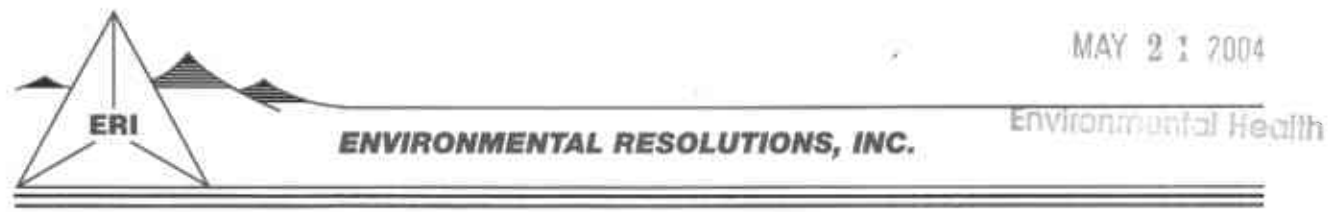

May 5, 2004
ERI 243113.Q041

Mr. Gene N. Ortega
ExxonMobil Refining & Supply - Global Remediation
25A Crescent Drive, #407
Pleasant Hill, California 94523

Subject: Groundwater Monitoring Report, First Quarter 2004, Former Exxon
Service Station 7-3567, 3192 Santa Rita Road, Pleasanton, California.

Mr. Ortega:

At the request of ExxonMobil Oil Corporation (ExxonMobil), Environmental Resolutions, Inc. (ERI) performed first quarter 2004 groundwater monitoring and sampling at the subject site. The purpose of quarterly monitoring and sampling is to evaluate the concentrations of hydrocarbons in the groundwater and the groundwater flow direction and hydraulic gradient. The location of the site is shown on the Site Vicinity Map (Plate 1). The location of groundwater monitoring wells and select site features are shown on the Generalized Site Plan (Plate 2).

GROUNDWATER MONITORING AND SAMPLING

On January 21, 2004, ERI measured depth to water (DTW) in select wells and collected groundwater samples from these wells for laboratory analyses. Work was performed in accordance with ERI's groundwater sampling protocol provided in Attachment A.

The calculated hydraulic gradient and groundwater flow direction for the lower water-bearing zone and upper water-bearing zone are presented on Plate 3 and Plate 4, respectively. Historical and recent monitoring data are summarized in Tables 1A and 1B.

Laboratory Analyses And Results

ERI submitted groundwater samples to a California state-certified laboratory, under Chain-of-Custody protocol. The samples were analyzed using the methods listed in the notes in Tables 1A and 1B. The laboratory analysis report and Chain-of-Custody record are attached (Attachment B). Cumulative results of laboratory analyses of groundwater samples are summarized in Tables 1A and 1B. Select analytical results of recent groundwater samples are presented on Plate 2.

DOCUMENT DISTRIBUTION

ERI recommends forwarding copies of this report to:

Mr. Scott Seery
Alameda County Health Care Services Agency
Department of Environmental Health
1131 Harbor Bay Parkway, Suite 250
Alameda, California 94502-6577

Mr. Eddy So
California Regional Water Quality Control Board
San Francisco Bay Region
1515 Clay Street, Suite 1400
Oakland, California 94612

Ms. Colleen Morf
Zone 7 Water Agency
5997 Parkside Drive
Pleasanton, California 94588

Mr. Joseph A. Aldridge
Valero Energy Corporation
685 West Third Street
Hanford, California 93230

LIMITATIONS

This report was prepared in accordance with generally accepted standards of environmental practice in California at the time this investigation was performed. This report has been prepared for ExxonMobil, and any reliance on this report by third parties shall be at such party's sole risk.

Please call Mr. Robert A. Saur, ERI's project manager for this site, at (415) 382-9105 with any questions regarding this project.

Sincerely,
Environmental Resolutions, Inc.



Lyz A. Cullmann
Senior Staff Geologist



John B. Bobbitt
R.G. 4313



- Attachments: Table 1A: Cumulative Groundwater Monitoring and Sampling Data
Table 1B: Additional Cumulative Groundwater Monitoring and Sampling Data
- Plate 1: Site Vicinity Map
Plate 2: Generalized Site Plan
Plate 3: Groundwater Elevation Map Lower Water-Bearing Zone
Plate 4: Groundwater Elevation Map Upper Water-Bearing Zone
- Attachment A: Groundwater Sampling Protocol
Attachment B: Laboratory Analysis Report and Chain-of-Custody Record

TABLE 1A
CUMULATIVE GROUNDWATER MONITORING AND SAMPLING DATA
Former Exxon Service Station 7-3567
3192 Santa Rita Road
Pleasanton, California
(Page 1 of 4)

Well ID# (TOC)	Sampling Date	SUBJ	DTW feet.	Elev.	TPHd	TPHg	MTBE	B ug/L	T	E	X	
(340.86)	11/17/98	NLPH	21.90	318.96	<50	<50	<2.5	<0.5	<0.5	<0.5	<0.5	
	03/15/99	NLPH	21.15	319.71	<50	<50	<2.5	<0.5	<0.5	<0.5	<0.5	
	06/25/99	NLPH	20.34	320.52	a	<50	<2.0	<0.5	<0.5	<0.5	<0.5	
	09/24/99	NLPH	20.42	320.44	<50	<50	24.6	<0.5	<0.5	<0.5	<0.5	
	12/22/99	NLPH	21.11	319.75	<61	<50	<2	<0.5	<0.5	<0.5	<0.5	
	03/07/00	NLPH	14.12	326.74	57	<50	220	<0.5	<0.5	<0.5	<0.5	
	06/06/00	NLPH	17.79	323.07	<50	<50	5.4	<0.5	<0.5	<0.5	<0.5	
	06/16/00	Property transferred to Valero Refining Company.										
	07/31/00	NLPH	19.02	321.84	<50	<50	51/38d	<0.5	<0.5	<0.5	<0.5	
	10/10/00	NLPH	18.56	322.30	<50	<50	63	<0.5	<0.5	<0.5	<0.5	
	01/11/01	NLPH	21.43	319.43	<50	<50	110/98d	<0.5	<0.5	<0.5	<0.5	
	04/11/01	NLPH	19.83	321.03	960e	<50	29/33d	<0.5	<0.5	<0.5	<0.5	
	07/20/01	NLPH	20.50	320.36	<50	<50	27/20d	<0.5	<0.5	<0.5	<0.5	
	10/19/01	NLPH	19.48	321.38	<50	<50	390/420d	<0.5	<0.5	<0.5	<0.5	
	Nov-2001	Well surveyed in compliance with AB 2886 requirements.										
	01/28/02	NLPH	19.72	321.14	<100	178	196	<0.50	<0.50	<0.50	<0.50	
	04/17/02	NLPH	22.17	318.69	<50	124	116.1/131d	<0.5	<0.50	<0.50	<0.50	
	07/17/02	NLPH	22.51	318.35	<50	<50.0	5.1/8.76d	<0.5	<0.5	<0.5	<0.5	
	10/24/02	NLPH	22.51	318.35	<50	217	574/302d	<0.5	<0.5	<0.5	<0.5	
	03/21/03	NLPH	21.32	319.54	<50	70.9	83.4d	<0.50	<0.5	<0.5	<0.5	
04/10/03	NLPH	21.27	319.59	<51	67.2	71.0d	<0.50	<0.5	<0.5	<0.5		
07/17/03	NLPH	21.13	319.73	<50	88.9	44.6d	<0.50	<0.5	<0.5	<0.5		
10/09/03	NLPH	21.55	319.31	<50	<50.0	32.3/41.2d	<0.50	<0.5	<0.5	<0.5		
01/21/04	NLPH	19.96	320.90	<50	625	970/974d	<0.50	<0.5	<0.5	<0.5		
(340.61)	11/17/98	NLPH	20.42	320.19	91	<50	17/23d	1.5	<0.5	0.98	2.6	
	03/15/99	NLPH	28.35	312.26	90	<50	12/12.5d	0.73	1.1	2.4	2.2	
	06/25/99	NLPH	25.20	315.41	a	<50	<2.0	<0.5	<0.5	<0.5	<0.5	
	09/24/99	NLPH	23.93	316.68	<50	<50	3.06	<0.5	<0.5	<0.5	<0.5	
	12/22/99	NLPH	23.39	317.22	<56	<50	<2	<0.5	<0.5	<0.5	<0.5	
	03/07/00	NLPH	17.08	323.53	52	<50	<2	<0.5	0.80	<0.5	<0.5	
	06/06/00	NLPH	21.01	319.60	<50	<50	<2	<0.5	<0.5	<0.5	<0.5	
	06/16/00	Property transferred to Valero Refining Company.										
	07/31/00	NLPH	22.08	318.53	<50	<50	6.8/<5d	<0.5	<0.5	<0.5	<0.5	
	10/10/00	NLPH	22.35	318.26	<50	<50	<2	<0.5	<0.5	<0.5	<0.5	
	01/11/01	NLPH	23.74	316.87	<50	<50	<2	0.54	<0.5	<0.5	<0.5	
	04/11/01	NLPH	22.34	318.27	760e	<50	<2	<0.5	1.4	<0.5	<0.5	
	07/20/01	NLPH	23.74	316.87	<50	<50	<2	<0.5	<0.5	<0.5	<0.5	
	10/19/01	NLPH	22.68	317.93	<50	<50	<2	<0.5	<0.5	<0.5	<0.5	
	Nov-2001	Well surveyed in compliance with AB 2886 requirements.										
	01/28/02	NLPH	20.79	319.37	<50.0	<50.0	0.70	<0.50	<0.50	<0.50	<0.50	
	04/17/02	NLPH	25.52	314.64	<50	<50.0	4.20/4.35d	<0.5	0.90	<0.50	<0.50	
	07/17/02	NLPH	28.18	311.98	<50	<50.0	9.4/10.3d	<0.5	0.6	2.4	2.0	
	10/24/02	NLPH	28.42	311.74	<50	<50.0	8.6/9.30d	<0.5	<0.5	<0.5	<0.5	
	03/21/03	NLPH	23.54	316.62	<50	<50.0	<0.50d	1.10	0.5	1.3	2.2	
04/10/03	NLPH	28.19	311.97	<50	<50.0	2.10d	0.60	0.5	0.8	1.0		
7/17/2003	NLPH	24.13	316.03	<50	<50.0	<0.50d	<0.50	<0.5	<0.5	<0.5		
10/9/2003	NLPH	26.21	313.95	90	<50.0	0.6/0.60d	<0.50	<0.5	<0.5	<0.5		
1/21/2004	NLPH	22.40	317.76	<50	<50.0	<0.5/<0.50d	0.50	<0.5	<0.5	<0.5		

TABLE 1A
CUMULATIVE GROUNDWATER MONITORING AND SAMPLING DATA
Former Exxon Service Station 7-3567
3192 Santa Rita Road
Pleasanton, California
(Page 2 of 4)

Well ID# (TOC)	Sampling Date	SUBJ <.....>	DTW feet	Elev. <.....>	TPHd <.....>	TPHg <.....>	MTBE <.....>	B ug/L	T ug/L	E ug/L	X ug/L	
(342.95)	11/17/98	NLPH	36.58	306.37	120	<50	180/220d	<0.5	<0.5	<0.5	<0.5	
	03/15/99	NLPH	40.01	302.94	180	<50	290/314d	<0.5	<0.5	<0.5	<0.5	
	06/25/99	NLPH	46.83	296.12	a	<50	107/113d	<0.5	<0.5	<0.5	<0.5	
	9/24/99 ^b	NLPH	47.71	295.24	---	---	---	---	---	---	---	
	12/22/99	NLPH	43.82	299.13	140	<50	65	<0.5	<0.5	<0.5	<0.5	
	03/07/00	NLPH	32.75	310.20	<50	<50	82	<0.5	0.88	<0.5	<0.5	
	06/06/00	NLPH	36.05	306.90	<50	<50	140	<0.5	<0.5	0.82	<0.5	
	06/16/00	Property transferred to Valero Refining Company.										
	07/31/00	NLPH	36.77	306.18	<50	<50	230/160d	<0.5	<0.5	<0.5	<0.5	
	10/10/00	NLPH	35.82	307.13	<50	<50	200	<0.5	<0.5	<0.5	<0.5	
	01/11/01	NLPH	38.08	304.87	<50	<50	280/230d	<0.5	<0.5	<0.5	<0.5	
	04/11/01	NLPH	36.03	306.92	1,000e	<50	240/280d	<0.5	<0.5	<0.5	<0.5	
	07/20/01	NLPH	36.05	306.90	<50	270	240/190d	<0.5	<0.5	<0.5	<0.5	
	10/19/01	NLPH	34.58	308.37	<50	<50	180/190d	<0.5	<0.5	<0.5	<0.5	
	Nov-2001	Well surveyed in compliance with AB 2886 requirements.										
	01/28/02	NLPH	34.96	307.99	<100	167	179	<0.50	<0.50	<0.50	<0.50	
04/17/02	NLPH	38.21	304.74	<50	194	179.3/216d	<0.5	<0.50	<0.50	<0.50		
07/17/02	g	g	g	<50h	163h	185/198d,h	<0.5h	<0.5h	<0.5h	<0.5h		
10/24/02	NLPH	38.68	304.27	<50	128	163/183d	<0.5	<0.5	<0.5	<0.5		
03/21/03	NLPH	36.50	306.45	<50	119	141d	<0.50	<0.5	<0.5	<0.5		
04/10/03	NLPH	36.82	306.13	<53	119	130d	<0.50	<0.5	<0.5	<0.5		
07/17/03	NLPH	37.98	304.97	---	---	---	---	---	---	---		
07/18/03	NLPH	---	---	<50	142	123d	<0.50	<0.5	<0.5	<0.5		
10/09/03	NLPH	38.5	304.45	<50	120	122/147d	<0.50	<0.5	<0.5	<0.5		
01/21/04	NLPH	35.45	307.50	94	90.6	118/148d	<0.50	<0.5	<0.5	<0.5		
(342.96)	11/17/98	NLPH	50.20	292.76	72	<50	4.1/3.5d	<0.5	<0.5	<0.5	<0.5	
	03/15/99	NLPH	47.93	295.03	91	<50	280/260d	<0.5	<0.5	<0.5	<0.5	
	6/25/99 ^b	NLPH	48.15	294.81	---	---	---	---	---	---	---	
	9/24/99 ^b	NLPH	49.29	293.67	---	---	---	---	---	---	---	
	12/22/99	NLPH	49.33	293.63	b	---	---	---	---	---	---	
	03/07/00	NLPH	49.05	293.91	190	<50	710	<0.5	0.84	<0.5	<0.5	
	06/06/00	NLPH	49.02	293.94	110	<50	460	<0.5	<0.5	<0.5	<0.5	
	06/16/00	Property transferred to Valero Refining Company.										
	07/31/00	NLPH	49.13	293.83	<50	<50	480/490d	<0.5	<0.5	<0.5	<0.5	
	10/10/00	NLPH	40.08	302.88	c	c	c	c	c	c	c	
	01/11/01	NLPH	36.41	306.55	110	<50	27/21d	<0.5	<0.5	<0.5	<0.5	
	04/11/01	NLPH	35.43	306.53	870e	<50	3.6/14d	<0.5	0.56	<0.5	<0.5	
	07/20/01	f	---	---	---	---	---	---	---	---	---	
	10/19/01	NLPH	33.67	309.29	71	<50	15/16d	<0.5	<0.5	<0.5	<0.5	
	Nov-2001	Well surveyed in compliance with AB 2886 requirements.										
	01/28/02	NLPH	33.11	309.85	148	<50.0	18.7	<0.50	<0.50	<0.50	<0.50	
04/17/02	NLPH	36.03	306.93	<50	<50.0	19.10/23.4d	<0.5	<0.50	<0.50	<0.50		
07/17/02	NLPH	37.65	305.31	<50	<50.0	16.7/15.8d	<0.5	<0.5	<0.5	<0.5		
10/24/02	NLPH	37.41	305.55	<50	<50.0	8.7/8.90d	<0.5	<0.5	<0.5	<0.5		
03/21/03	NLPH	36.18	306.78	<56	<50.0	14.2d	<0.50	<0.5	<0.5	<0.5		
04/10/03	NLPH	36.55	306.41	<51	<50.0	15.3d	<0.50	<0.5	<0.5	<0.5		
07/17/03	NLPH	36.45	306.51	<50	<50.0	11.4d	<0.50	<0.5	<0.5	<0.5		
10/09/03	NLPH	37.7	305.26	<50	<50.0	8.5/6.90d	<0.50	<0.5	<0.5	<0.5		
01/21/04	NLPH	35.78	307.18	<50	<50.0	8.4/9.40d	<0.50	<0.5	<0.5	<0.5		

TABLE 1A
CUMULATIVE GROUNDWATER MONITORING AND SAMPLING DATA
Former Exxon Service Station 7-3567
3192 Santa Rita Road
Pleasanton, California
(Page 3 of 4)

Well ID# (TOC)	Sampling Date	SUBJ <.....>	DTW feet	Elev. >	TPHd <	TPHg	MTBE	B ug/L	T	E	X >
MW5 (342.87)	06/16/00	Property transferred to Valero Refining Company.									
	07/31/00	--	dry	dry	b	b	b	b	b	b	b
	10/10/00	NLPH	29.12	313.75	150	<50	4.2	<0.5	<0.5	<0.5	<0.5
	01/11/01	NLPH	28.89	313.98	b	b	b	b	b	b	b
	04/11/01	NLPH	28.23	314.64	b	b	b	b	b	b	b
	07/20/01	f	---	---	---	---	---	---	---	---	---
	10/19/01	NLPH	27.62	315.25	86	<50	3.4/5d	<0.5	<0.5	<0.5	<0.5
(342.87)	Nov-2001	Well surveyed in compliance with AB 2886 requirements.									
	01/28/02	NLPH	28.04	314.83	<100	<50.0	5.90	<0.50	<0.50	<0.50	<0.50
	04/17/02	NLPH	29.10	313.77	85	<50.0	5.60/6.7d	<0.5	<0.50	<0.50	<0.50
	07/17/02	NLPH	29.37	313.50	b	b	b	b	b	b	b
	10/24/02	NLPH	29.36	313.51	b	b	b	b	b	b	b
	03/21/03	NLPH	28.55	314.32	b	57.8	8.70d	2.50	1.0	3.5	5.9
	04/10/03	NLPH	29.10	313.77	b	56.1	7.20d	5.50	3.0	2.9	4.3
	07/17/03	NLPH	28.91	313.96	b	<0.50	12.0d	1.00	<0.50	0.7	1.2
	10/09/03	NLPH	29.17	313.70	<100	<50.0	5.5/4.50d	<0.50	<0.5	<0.5	<0.5
	01/21/04	NLPH	28.75	314.12	<50	<50.0	3.7/4.00d	1.30	1.40	<0.5	2.4
MW6 (341.05)	06/16/00	Property transferred to Valero Refining Company.									
	07/31/00	NLPH	39.72	301.33	<50	<50	<2/<5	<0.5	<0.5	<0.5	<0.5
	10/10/00	NLPH	40.12	300.93	<50	c	c	c	c	c	c
	01/11/01	NLPH	46.13	294.92	<50	<50	<2	<0.5	<0.5	<0.5	<0.5
	04/11/01	NLPH	45.40	295.65	b	b	b	b	b	b	b
	07/20/01	NLPH	41.75	299.30	<50	<50	<5	<0.3	<0.3	<0.6	<0.6
	10/19/01	NLPH	44.10	296.95	<50	<50	<2	<0.5	<0.5	<0.5	<0.5
(341.05)	Nov-2001	Well surveyed in compliance with AB 2886 requirements.									
	01/28/02	NLPH	39.57	301.48	<100	<50.0	<0.50	<0.50	<0.90	<0.50	<0.50
	04/17/02	NLPH	41.84	299.21	52	<50.0	<0.50	<0.5	<0.50	<0.50	<0.50
	07/17/02	NLPH	42.85	298.20	<50	<50.0	<0.5	<0.5	<0.5	<0.5	<0.5
	10/24/02	NLPH	42.10	298.95	<50	<50.0	<0.5	<0.5	<0.5	<0.5	<0.5
	03/21/03	NLPH	44.81	296.24	107	<50.0	<0.50	<0.50	<0.5	<0.5	<0.5
	04/10/03	NLPH	44.28	296.77	60	<50.0	0.80d	<0.50	<0.5	<0.5	<0.5
	07/17/03	NLPH	41.56	299.49	<50	<50.0	<0.50d	<0.50	<0.5	<0.5	<0.5
	10/09/03	NLPH	41.54	299.51	452	<50.0	0.5/0.60d	<0.50	<0.5	<0.5	<0.5
	01/21/04	NLPH	38.20	302.85	<50	<50.0	<0.5/<0.50d	<0.50	<0.5	<0.5	<0.5
MW7 (341.73)	06/16/00	Property transferred to Valero Refining Company.									
	07/31/00	NLPH	24.22	317.51	150	<50	13/8d	<0.5	<0.5	<0.5	<0.5
	10/10/00	NLPH	24.09	317.64	1,500	c	c	c	c	c	c
	01/11/01	NLPH	25.86	315.87	330	<50	6.9/7d	0.55	<0.5	<0.5	<0.5
	04/11/01	NLPH	24.28	317.45	980e	<250	<10	<2.5	<2.5	<2.5	<2.5
	07/20/01	NLPH	25.52	316.21	300	<50	8.2/6d	<0.5	<0.5	<0.5	<0.5
	10/19/01	NLPH	24.99	316.74	120	<50	4.9/<5d	<0.5	<0.5	<0.5	<0.5
(341.73)	Nov-2001	Well surveyed in compliance with AB 2886 requirements.									
	01/28/02	NLPH	23.84	317.89	<100	<50.0	8.50	<0.50	<0.50	<0.50	<0.50
	04/17/02	NLPH	28.19	313.54	55	<50.0	9.70/11.6d	<0.5	2.10	<0.50	<0.50
	07/17/02	NLPH	29.74	311.99	69	<50.0	9.7/9.00d	<0.5	<0.5	<0.5	<0.5
	10/24/02	NLPH	29.50	312.23	262	<50.0	5.4/6.00d	<0.5	<0.5	<0.5	<0.5
	03/21/03	NLPH	26.07	315.66	<50	<50.0	6.00	<0.50	0.8	<0.5	<0.5
	04/10/03	NLPH	26.06	315.67	<50	<50.0	9.00d	<0.50	<0.5	<0.5	<0.5
	07/17/03	NLPH	27.18	314.55	<50	<50.0	9.10d	<0.50	<0.5	<0.5	<0.5
	10/09/03	NLPH	28.27	313.46	<50	<50.0	12.5/5.60d	<0.50	<0.5	<0.5	<0.5
	01/21/04	NLPH	24.51	317.22	140	<50.0	15.1/17.6d	<0.50	<0.5	<0.5	<0.5

**TABLE 1A
CUMULATIVE GROUNDWATER MONITORING AND SAMPLING DATA**

Former Exxon Service Station 7-3567

3192 Santa Rita Road

Pleasanton, California

(Page 4 of 4)

Well ID# (TOC)	Sampling Date	SUBJ <.....>	DTW feet	Elev. >.....<	TPHd <.....>	TPHg <.....>	MTBE <.....>	B ug/L	T	E	X
MW8 (341.44)	06/16/00	Property transferred to Valero Refining Company.									
	04/11/01	---	dry	dry	b	b	b	b	b	b	b
	04/11/01	---	b	---	b	b	b	b	b	b	b
	07/20/01	---	dry	dry	b	b	b	b	b	b	b
	10/19/01	---	dry	dry	b	b	b	b	b	b	b
	01/28/02	---	dry	dry	b	b	b	b	b	b	b
	04/17/02	---	dry	dry	b	b	b	b	b	b	b
	07/17/02	---	dry	dry	b	b	b	b	b	b	b
	10/24/02	---	dry	dry	b	b	b	b	b	b	b
	03/21/03	---	dry	dry	b	b	b	b	b	b	b
	04/10/03	---	dry	dry	b	b	b	b	b	b	b
	07/17/03	---	dry	dry	b	b	b	b	b	b	b
	10/09/03	---	dry	dry	b	b	b	b	b	b	b
	01/21/04	---	dry	dry	b	b	b	b	b	b	b

Notes:

TOC	=	Elevation of top of well casing, in feet above mean sea level.
SUBJ	=	Results of subjective evaluation, liquid-phase hydrocarbon thickness (HT) in feet.
DTW	=	Depth to water.
Elev.	=	Elevation of groundwater in feet above mean sea level.
NLPH	=	No liquid-phase hydrocarbons present in well.
TPHd	=	Total petroleum hydrocarbons as diesel analyzed using modified EPA Method 8015.
TPHg	=	Total petroleum hydrocarbons as gasoline analyzed using modified EPA Method 5020/8015 (modified).
BTEX	=	Benzene, toluene, ethylbenzene, and total xylenes analyzed using EPA Method 8021B.
MTBE	=	Methyl tertiary butyl ether analyzed using EPA Method 8021B.
ETBE	=	Ethyl tertiary butyl ether analyzed using EPA Method 8260B.
TAME	=	Tertiary amyl methyl ether analyzed using EPA Method 8260B.
TBA	=	Tertiary butyl alcohol analyzed using EPA Method 8260B.
EDB	=	1,2-dibromoethane analyzed using EPA Method 8260B.
1,2-DCA	=	1,2-dichloroethane analyzed using EPA Method 8260B.
DIPE	=	Di-isopropyl ether analyzed using EPA Method 8260B.
ug/L	=	Micrograms per liter.
<	=	Not detected at or above the stated laboratory method reporting limit.
---	=	Not analyzed/Not applicable.
a	=	No result because of sample loss during laboratory fire.
b	=	Well contained an insufficient amount of water to collect a sample or well was dry.
c	=	Samples were damaged during transportation to laboratory.
d	=	MTBE confirmed using EPA Method 8260.
e	=	Diesel-range hydrocarbons detected in bailer blank; result is suspect.
f	=	Well inaccessible.
g	=	Due to equipment failure, DTW was not measured.
h	=	Grab sample, Equipment failure unable to purge well.

TABLE 1B
ADDITIONAL CUMULATIVE GROUNDWATER MONITORING AND SAMPLING DATA

Former Exxon Service Station 7-3567

3192 Santa Rita Road

Pleasanton, California

(Page 1 of 4)

Well ID #	Sampling Date	ETBE	TAME	TBA	EDB	1,2-DCA	DIPE
		←-----ug/L----->					
MW1	11/17/98	---	---	---	---	---	---
	03/15/99	---	---	---	---	---	---
	06/25/99	---	---	---	---	---	---
	09/24/99	---	---	---	---	---	---
	12/22/99	---	---	---	---	---	---
	03/07/00	---	---	---	---	---	---
	06/06/00	---	---	---	---	---	---
	06/16/00	---	---	---	---	---	---
	07/31/00	<10	<10	<500	<5	<5	<10
	10/10/00	---	---	---	---	---	---
	01/11/01	---	---	---	---	---	---
	04/11/01	---	---	---	---	---	---
	07/20/01	---	---	---	---	---	---
	10/19/01	---	---	---	---	---	---
	Nov-2001	---	---	---	---	---	---
	01/28/02	---	---	---	---	---	---
	04/17/02	---	---	---	---	---	---
	07/17/02	---	---	---	---	---	---
	10/24/02	---	---	---	---	---	---
	03/21/03	<0.50	<0.50	<10	<0.50	<0.50	<0.50
04/10/03	<0.50	<0.50	<10	<0.50	<0.50	<0.50	
07/17/03	<0.50	<0.50	<10	<0.50	<0.50	<0.50	
10/09/03	<0.50	<0.50	<10	<0.50	<0.50	<0.50	
01/21/04	<0.50	2.20	57.9	<0.50	<0.50	<0.50	
MW2	11/17/98	---	---	---	---	---	---
	03/15/99	---	---	---	---	---	---
	06/25/99	---	---	---	---	---	---
	09/24/99	---	---	---	---	---	---
	12/22/99	---	---	---	---	---	---
	03/07/00	---	---	---	---	---	---
	06/06/00	---	---	---	---	---	---
	06/16/00	---	---	---	---	---	---
	07/31/00	<10	<10	<500	<5	<5	<10
	10/10/00	---	---	---	---	---	---
	01/11/01	---	---	---	---	---	---
	04/11/01	---	---	---	---	---	---
	07/20/01	---	---	---	---	---	---
	10/19/01	---	---	---	---	---	---
	Nov-2001	---	---	---	---	---	---
	01/28/02	---	---	---	---	---	---
	04/17/02	---	---	---	---	---	---
	07/17/02	---	---	---	---	---	---
	10/24/02	---	---	---	---	---	---
	03/21/03	<0.50	<0.50	<10	<0.50	<0.50	<0.50
04/10/03	<0.50	<0.50	<10	<0.50	<0.50	<0.50	
7/17/2003	<0.50	<0.50	<10	<0.50	<0.50	<0.50	
10/9/2003	<0.50	<0.50	<10	<0.50	<0.50	<0.50	
01/21/04	<0.50	<0.50	<10	<0.50	<0.50	<0.50	

TABLE 1B
ADDITIONAL CUMULATIVE GROUNDWATER MONITORING AND SAMPLING DATA

Former Exxon Service Station 7-3567
 3192 Santa Rita Road
 Pleasanton, California
 (Page 2 of 4)

Well ID #	Sampling Date	ETBE	TAME	TBA	EDB	1,2-DCA	DIPE
MW3	11/17/98	---	---	---	---	---	---
	03/15/99	---	---	---	---	---	---
	06/25/99	---	---	---	---	---	---
	9/24/99 ^b	---	---	---	---	---	---
	12/22/99	---	---	---	---	---	---
	03/07/00	---	---	---	---	---	---
	06/06/00	---	---	---	---	---	---
	06/16/00	---	---	---	---	---	---
	07/31/00	<10	<10	<500	<5	<5	<10
	10/10/00	---	---	---	---	---	---
	01/11/01	---	---	---	---	---	---
	04/11/01	---	---	---	---	---	---
	07/20/01	---	---	---	---	---	---
	10/19/01	---	---	---	---	---	---
	Nov-2001	---	---	---	---	---	---
	01/28/02	---	---	---	---	---	---
	04/17/02	---	---	---	---	---	---
	07/17/02	---	---	---	---	---	---
	10/24/02	---	---	---	---	---	---
	03/21/03	<0.50	<0.50	<10	<0.50	<0.50	<0.50
04/10/03	<0.50	<0.50	<10	<0.50	<0.50	<0.50	
07/17/03	<0.50	<0.50	<10	<0.50	<0.50	<0.50	
07/18/03	<0.50	<0.50	<10	<0.50	<0.50	<0.50	
10/09/03	<0.50	<0.50	<10	<0.50	<0.50	<0.50	
01/21/04	<0.50	<0.50	<10	<0.50	<0.50	<0.50	
MW4	11/17/98	---	---	---	---	---	---
	03/15/99	---	---	---	---	---	---
	6/25/99 ^b	---	---	---	---	---	---
	9/24/99 ^b	---	---	---	---	---	---
	12/22/99	---	---	---	---	---	---
	03/07/00	---	---	---	---	---	---
	06/06/00	---	---	---	---	---	---
	06/16/00	---	---	---	---	---	---
	07/31/00	<10	<10	<500	<5	<5	<10
	10/10/00	---	---	---	---	---	---
	01/11/01	---	---	---	---	---	---
	04/11/01	---	---	---	---	---	---
	07/20/01	---	---	---	---	---	---
	10/19/01	---	---	---	---	---	---
	Nov-2001	---	---	---	---	---	---
	01/28/02	---	---	---	---	---	---
	04/17/02	---	---	---	---	---	---
	07/17/02	---	---	---	---	---	---
	10/24/02	---	---	---	---	---	---
	03/21/03	<0.50	<0.50	<10	<0.50	<0.50	<0.50
04/10/03	<0.50	<0.50	<10	<0.50	<0.50	<0.50	
07/17/03	<0.50	<0.50	<10	<0.50	<0.50	<0.50	
10/09/03	<0.50	<0.50	<10	<0.50	<0.50	<0.50	
01/21/04	<0.50	<0.50	<10	<0.50	<0.50	<0.50	

TABLE 1B
ADDITIONAL CUMULATIVE GROUNDWATER MONITORING AND SAMPLING DATA
 Former Exxon Service Station 7-3567
 3192 Santa Rita Road
 Pleasanton, California
 (Page 3 of 4)

Well ID #	Sampling Date	ETBE	TAME	TBA	EDB	1,2-DCA	DIPE
MW5	06/16/00	---	---	---	---	---	---
	07/31/00	<10	<10	<500	<5	<5	<10
	10/10/00	---	---	---	---	---	---
	01/11/01	---	---	---	---	---	---
	04/11/01	---	---	---	---	---	---
	07/20/01	---	---	---	---	---	---
	10/19/01	---	---	---	---	---	---
	Nov-2001	---	---	---	---	---	---
	01/28/02	---	---	---	---	---	---
	04/17/02	---	---	---	---	---	---
	07/17/02	---	---	---	---	---	---
	10/24/02	---	---	---	---	---	---
	03/21/03	<0.50	<0.50	<10	<0.50	<0.50	<0.50
	04/10/03	<0.50	<0.50	<10	<0.50	<0.50	<0.50
	07/17/03	<0.50	<0.50	<10	<0.50	<0.50	<0.50
10/09/03	<0.50	<0.50	<10	<0.50	<0.50	<0.50	
01/21/04	<0.50	<0.50	<10	<0.50	<0.50	<0.50	
MW6	06/16/00	---	---	---	---	---	---
	07/31/00	<10	<10	<500	<5	<5	<10
	10/10/00	---	---	---	---	---	---
	01/11/01	---	---	---	---	---	---
	04/11/01	---	---	---	---	---	---
	07/20/01	---	---	---	---	---	---
	10/19/01	---	---	---	---	---	---
	Nov-2001	---	---	---	---	---	---
	01/28/02	---	---	---	---	---	---
	04/17/02	---	---	---	---	---	---
	07/17/02	---	---	---	---	---	---
	10/24/02	---	---	---	---	---	---
	03/21/03	<0.50	<0.50	<10	<0.50	<0.50	<0.50
	04/10/03	<0.50	<0.50	<10	<0.50	<0.50	<0.50
	07/17/03	<0.50	<0.50	<10	<0.50	<0.50	<0.50
10/09/03	<0.50	<0.50	<10	<0.50	<0.50	<0.50	
01/21/04	<0.50	<0.50	<10	<0.50	<0.50	<0.50	
MW7	06/16/00	---	---	---	---	---	---
	04/11/01	---	---	---	---	---	---
	04/11/01	---	---	---	---	---	---
	07/20/01	---	---	---	---	---	---
	10/19/01	---	---	---	---	---	---
	01/28/02	---	---	---	---	---	---
	04/17/02	---	---	---	---	---	---
	07/17/02	---	---	---	---	---	---
	10/24/02	---	---	---	---	---	---
	03/21/03	<0.50	<0.50	<10	<0.50	<0.50	<0.50
	04/10/03	<0.50	<0.50	<10	<0.50	<0.50	<0.50
	07/17/03	<0.50	<0.50	<10	<0.50	<0.50	<0.50
	10/09/03	<0.50	<0.50	<10	<0.50	<0.50	<0.50
	01/21/04	<0.50	<0.50	<10	<0.50	<0.50	<0.50

TABLE 1B
ADDITIONAL CUMULATIVE GROUNDWATER MONITORING AND SAMPLING DATA
Former Exxon Service Station 7-3567
3192 Santa Rita Road
Pleasanton, California
(Page 4 of 4)

Well ID #	Sampling Date	ETBE	TAME	TBA	EDB	1,2-DCA	DIPE
MW8	06/16/00	b	b	b	b	b	b
	07/31/00	<10	<10	<500	<5	<5	<10
	10/10/00	b	b	b	b	b	b
	01/11/01	b	b	b	b	b	b
	04/11/01	b	b	b	b	b	b
	07/20/01	b	b	b	b	b	b
	10/19/01	b	b	b	b	b	b
	Nov-2001	b	b	b	b	b	b
	01/28/02	b	b	b	b	b	b
	04/17/02	b	b	b	b	b	b
	07/17/02	b	b	b	b	b	b
	10/24/02	b	b	b	b	b	b
	03/21/03	b	b	b	b	b	b
	04/10/03	b	b	b	b	b	b
	07/17/03	b	b	b	b	b	b
	10/09/03	b	b	b	b	b	b
	01/21/04	b	b	b	b	b	b

Notes:

TOC	=	Elevation of top of well casing, in feet above mean sea level.
SUBJ	=	Results of subjective evaluation, liquid-phase hydrocarbon thickness (HT) in feet.
DTW	=	Depth to water.
Elev.	=	Elevation of groundwater in feet above mean sea level.
NLPH	=	No liquid-phase hydrocarbons present in well.
TPHd	=	Total petroleum hydrocarbons as diesel analyzed using modified EPA Method 8015.
TPHg	=	Total petroleum hydrocarbons as gasoline analyzed using modified EPA Method 5030/8015 (modified).
BTEX	=	Benzene, toluene, ethylbenzene, and total xylenes analyzed using EPA Method 8021B.
MTBE	=	Methyl tertiary butyl ether analyzed using EPA Method 8021B.
ETBE	=	Ethyl tertiary butyl ether analyzed using EPA Method 8260B.
TAME	=	Tertiary amyl methyl ether analyzed using EPA Method 8260B.
TBA	=	Tertiary butyl alcohol analyzed using EPA Method 8260B.
EDB	=	1,2-dibromoethane analyzed using EPA Method 8260B.
1,2-DCA	=	1,2-dichloroethane analyzed using EPA Method 8260B.
DIPE	=	Di-isopropyl ether analyzed using EPA Method 8260B.
ug/L.	=	Micrograms per liter.
<	=	Not detected at or above the stated laboratory method reporting limit.
---	=	Not analyzed/Not applicable.
a	=	No result because of sample loss during laboratory fire.
b	=	Well contained an insufficient amount of water to collect a sample or well was dry.
c	=	Samples were damaged during transportation to laboratory.
d	=	MTBE confirmed using EPA Method 8260.
e	=	Diesel-range hydrocarbons detected in bailer blank; result is suspect.
f	=	Well inaccessible.
g	=	Due to equipment failure, DTW was not measured.
h	=	Grab sample; Equipment failure unable to purge well.

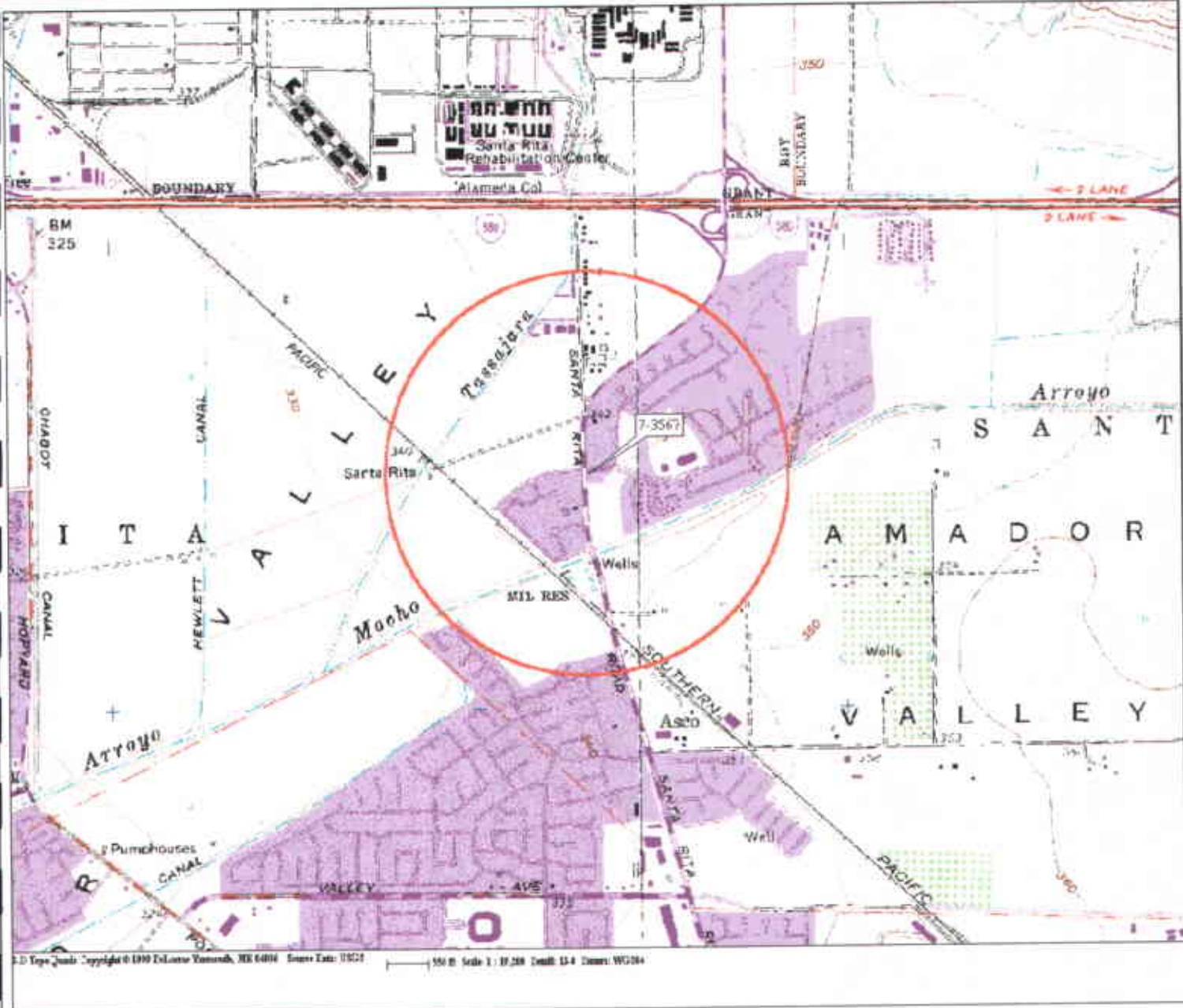

FN 2431Topo

EXPLANATION

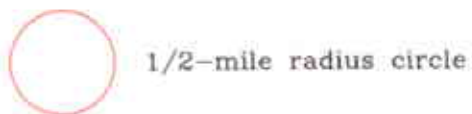

APPROXIMATE SCALE

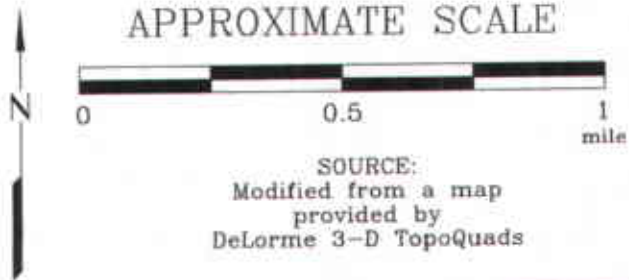

SITE VICINITY MAP

FORMER EXXON SERVICE STATION 7-3567
3192 Santa Rita Road
Pleasanton, California

PROJECT NO.

2431

PLATE

1

APPROXIMATE SCALE



LAS POSITAS BOULEVARD



SANTA RITA ROAD

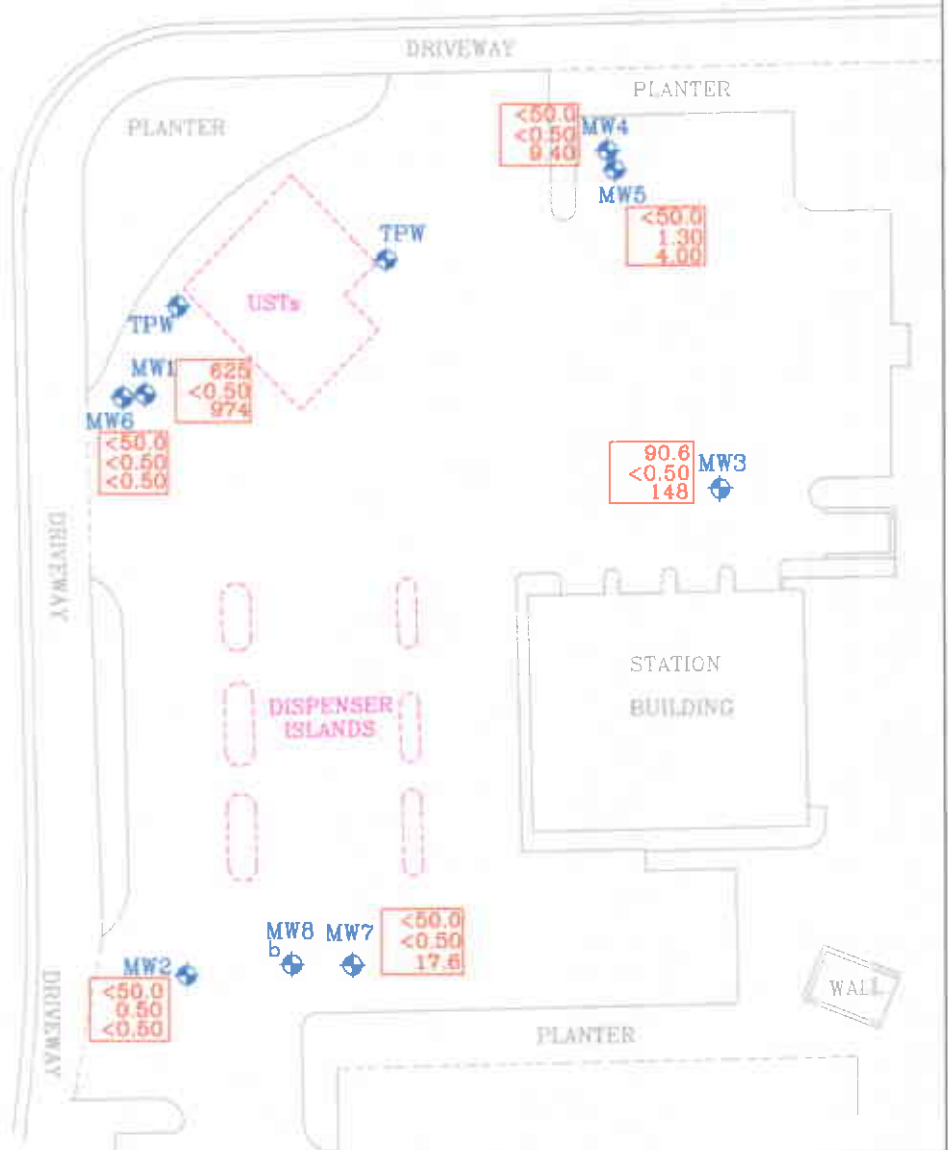

SOURCE:
Modified from a map
provided by
Morrow Surveying

FN 24310003_QM

EXPLANATION

- Groundwater Monitoring Well
- Tank Pit Well

- 625** Total Petroleum Hydrocarbons as Gasoline
- <0.50** Benzene
- 974** Methyl Tertiary Butyl Ether (EPA Method 8260B)
- <** Less Than the Stated Laboratory Reporting Limit
- ug/L** Micrograms per Liter
- b** Well contained an insufficient amount of water to collect a sample or well was dry.



GENERALIZED SITE PLAN

FORMER EXXON SERVICE STATION 7-3567
3192 Santa Rita Road
Pleasanton, California

PROJECT NO.

2431

PLATE

2

APPROXIMATE SCALE

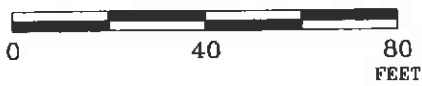

LAS POSITAS BOULEVARD



SANTA RITA ROAD

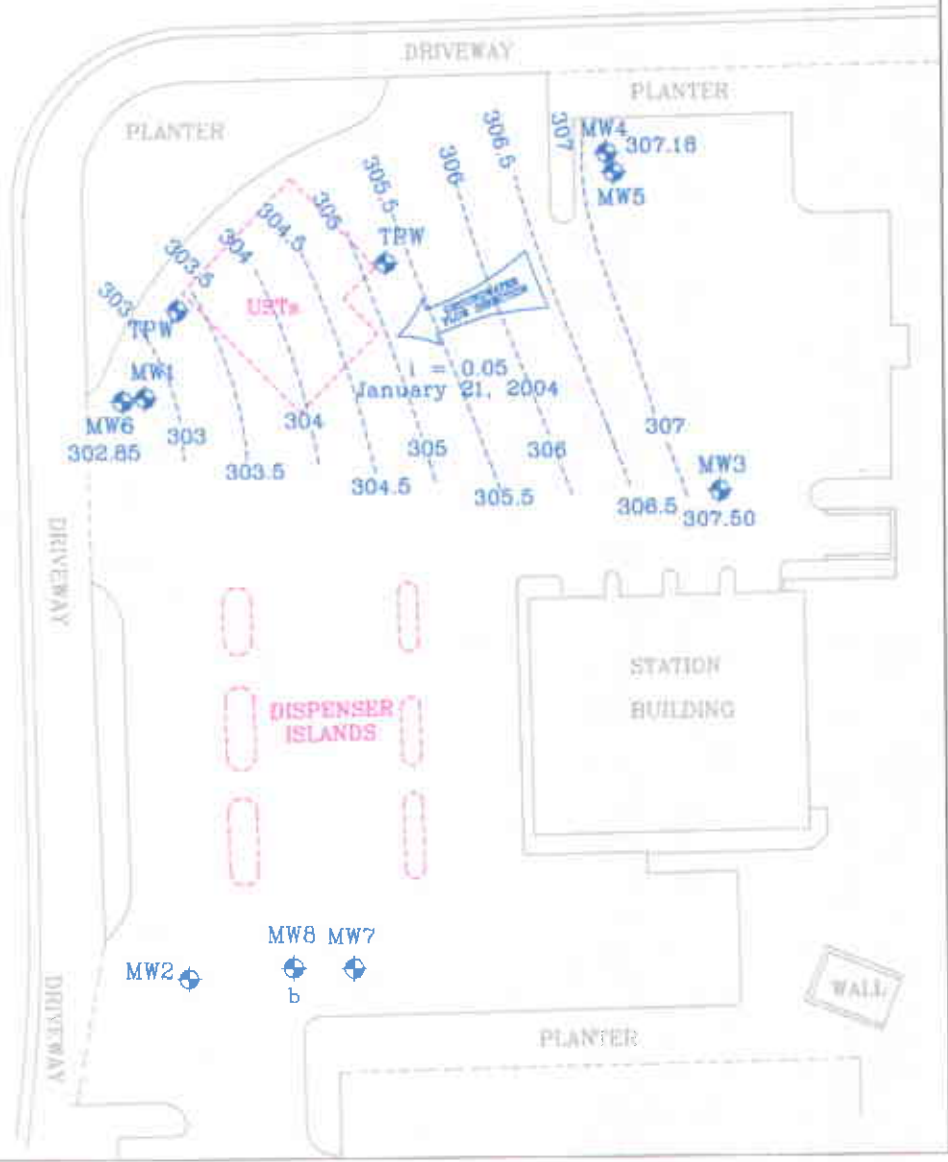

SOURCE:
Modified from a map
provided by
Morrow Surveying

FN 24310003_QM

EXPLANATION

- MW6 Groundwater Monitoring Well
- 299.51 Groundwater elevation in feet; datum is mean sea level
- TPW Tank Pit Well
- b Well contained an insufficient amount of water to collect a sample or well was dry
- 305.0----Line of Equal Groundwater Elevation; datum is mean sea level
- i = Interpreted Hydraulic Gradient



**GROUNDWATER ELEVATION MAP
LOWER WATER-BEARING ZONE
January 21, 2004**

FORMER EXXON SERVICE STATION 7-3567
3192 Santa Rita Road
Pleasanton, California

PROJECT NO.

2431

PLATE

3

APPROXIMATE SCALE



LAS POSITAS BOULEVARD



SANTA RITA ROAD

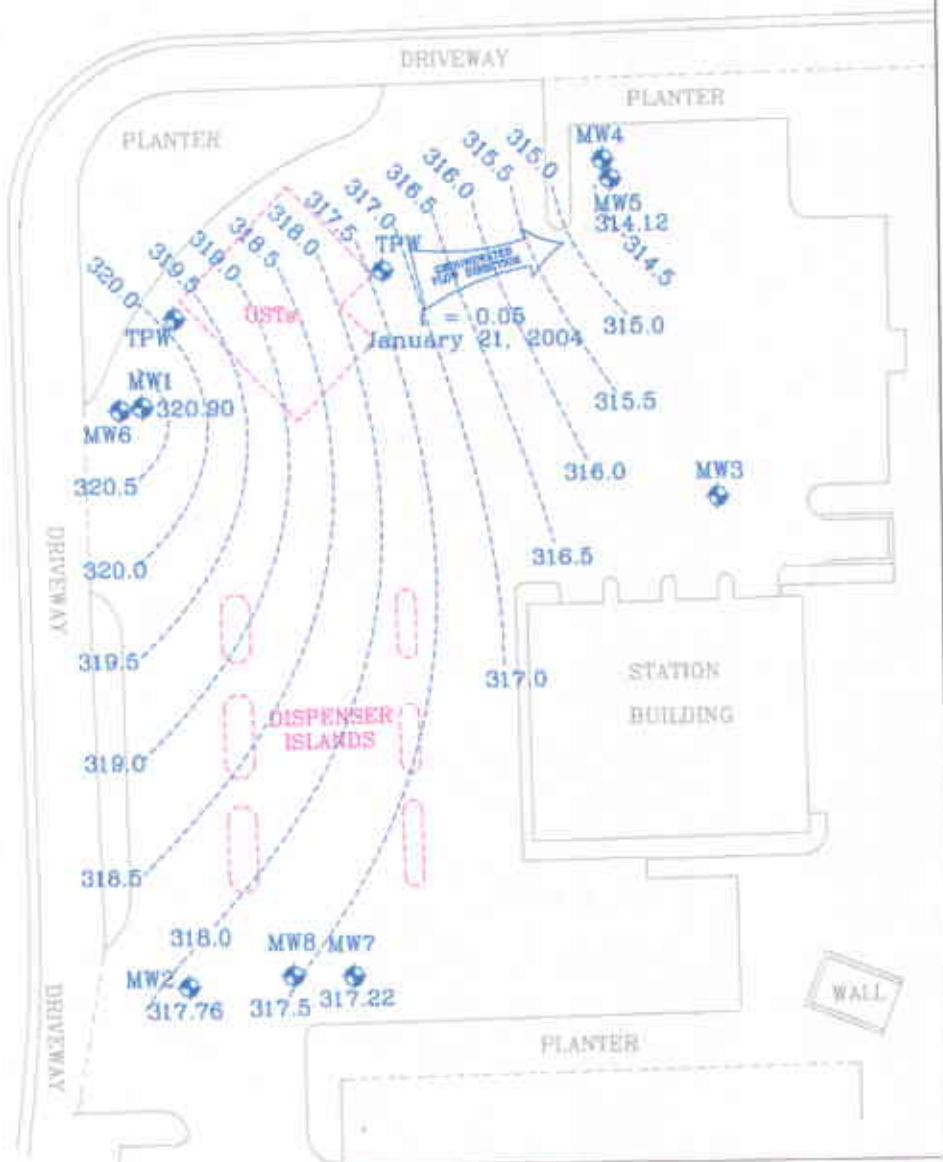

SOURCE:
Modified from a map
provided by
Morrow Surveying

FN 24310003_QM

EXPLANATION

- MW7 Groundwater Monitoring Well
- 317.22 Groundwater elevation in feet:
datum is mean sea level
- TPW Tank Pit Well

i = Interpreted Hydraulic Gradient

320.5-----Line of Equal Groundwater Elevation:
datum is mean sea level



**GROUNDWATER ELEVATION MAP
UPPER WATER-BEARING ZONE
January 21, 2004**

FORMER EXXON SERVICE STATION 7-3567
3192 Santa Rita Road
Pleasanton, California

PROJECT NO.

2431

PLATE

4

ATTACHMENT A

GROUNDWATER SAMPLING PROTOCOL

GROUNDWATER SAMPLING PROTOCOL

The static water level and separate-phase product level, if present, in each well that contains water and/or separate-phase product are measured with an ORS Interface Probe, which is accurate to the nearest 0.01 foot. To calculate groundwater elevations and evaluate groundwater gradient, depth to water (DTW) levels are subtracted from top of casing elevations.

Groundwater samples collected for subjective evaluation are collected by gently lowering approximately half the length of a clean Teflon® or polypropylene bailer past the air-water interface (if possible) and collecting a sample from near the surface of the water in the well. The samples are checked for measurable free-phase hydrocarbons or sheen. If appropriate, free-phase hydrocarbons are removed from the well.

Before water samples are collected from the groundwater monitoring wells, the wells are purged until a minimum of three well casing volumes is purged and stabilization of the temperature, pH, and conductivity is obtained. Water samples from the wells that do not obtain stability of the temperature, pH, and conductivity are considered to be "grab samples". The quantity of water purged from each well is calculated as follows:

1 well casing volume = $\pi r^2 h (7.48)$ where:

r	=	radius of the well casing in feet.
h	=	column of water in the well in feet (depth to bottom - depth to water)
7.48	=	conversion constant from cubic feet to gallons
π	=	ratio of the circumference of a circle to its diameter

Gallons of water purged/gallons in 1 well casing volume = well casing volumes removed.

After purging, each well is allowed to recharge to at least 80% of the initial water level. Water samples from wells that do not recover at least 80% (due to slow recharging of the well) between purging and sampling are considered to be "grab samples". Water samples are collected with a new, disposable Teflon® or polypropylene bailer. The groundwater is carefully poured into selected sample containers (40-milliliter [ml] glass vials, 1,000-ml glass amber bottles, etc.), which are filled so as to produce a positive meniscus.

Depending on the required analysis, each sample container is preserved with hydrochloric acid, nitric acid, etc., or it is preservative free. The type of preservative used for each sample is specified on the Chain-of-Custody form.

Each vial and glass amber bottle is sealed with a cap containing a Teflon® septum, and subsequently examined for air bubbles to avoid headspace, which would allow volatilization to occur. The samples are promptly transported in iced storage in a thermally-insulated ice chest, accompanied by a Chain-of-Custody record, to a California state-certified laboratory.

ATTACHMENT B

**LABORATORY ANALYSIS REPORT
AND CHAIN-OF-CUSTODY RECORD**

1/31/04 CASE NARRATIVE

RECEIVED
FEB 05 2004

ERI - NORTHERN CA 3876
ROB SAUR
73 DIGITAL DRIVE, SUITE 100
NOVATO, CA 94949

BY:.....

This report includes the analytical certificates of analysis for all samples listed below. These samples relate to your project identified below:

Project Name: EXXONMOBIL 7-3567
Project Number: 243113X.
Laboratory Project Number: 361763.

An executed copy of the chain of custody, the project quality control data, and the sample receipt form are also included as an addendum to this report. Any QC recoveries outside laboratory control limits are flagged individually with an #. Sample specific comments and quality control statements are included in the Laboratory notes section of the analytical report for each sample report. If you have any questions relating to this analytical report, please contact your Laboratory Project Manager at 1-800-765-0980. Any opinions, if expressed, are outside the scope of the Laboratory's accreditation.

Page 1

Sample Identification	Lab Number	Collection Date
MW1	04-A9696	1/21/04
MW2	04-A9697	1/21/04
MW3	04-A9698	1/21/04
MW4	04-A9699	1/21/04
MW5	04-A9700	1/21/04
MW6	04-A9701	1/21/04
MW7	04-A9702	1/21/04
BB	04-A9703	1/21/04

Sample Identification	Lab Number	Collection Date
-----------------------	------------	-----------------

These results relate only to the items tested.
This report shall not be reproduced except in full and with permission of the laboratory.

Report Approved By: *Gail A. Lage* Report Date: 1/31/04

- Ashley Morris, Lab Director
- Michael H. Dunn, M.S., QA/QC Director
- Johnny A. Mitchell, Operations Manager Organics
- Eric S. Smith, Assistant Technical Director
- Roxanne L. Connor, Technical Services
- Gail A. Lage, Technical Serv.
- Glenn L. Norton, Technical Serv.
- Kelly S. Comstock, Technical Serv.
- Pamela A. Langford, Technical Serv.

Laboratory Certification Number: 01168CA

This material is intended only for the use of the individual(s) or entity to whom it is addressed, and may contain information that is privileged and confidential. If you are not the intended recipient, or the employee or agent responsible for delivering this material to the intended recipient, you are hereby notified that any dissemination, distribution, or copying of this material is strictly prohibited. If you have received this material in error, please notify us immediately at 615-726-0177.

ANALYTICAL REPORT

ERI - NORTHERN CA 3876
ROB SAUR
73 DIGITAL DRIVE, SUITE 100
NOVATO, CA 94949

Lab Number: 04-A9696
Sample ID: MW1
Sample Type: Water
Site ID: 7-3567

Project: 243113X
Project Name: EXXONMOBIL 7-3567
Sampler: DAVID MADDAN

Date Collected: 1/21/04
Time Collected: 14:30
Date Received: 1/23/04
Time Received: 8:05
Page: 1

Analyte	Result	Units	Report Limit	Dil Factor	Analysis Date	Analysis Time	Analyst	Method	Batch
ORGANIC PARAMETERS									
Benzene	ND	ug/L	0.50	1.0	1/25/04	7:18	F.Gundi	8021B	6391
Ethylbenzene	ND	ug/L	0.5	1.0	1/25/04	7:18	F.Gundi	8021B	6391
Toluene	ND	ug/L	0.5	1.0	1/25/04	7:18	F.Gundi	8021B	6391
Xylenes (Total)	ND	ug/L	0.5	1.0	1/25/04	7:18	F.Gundi	8021B	6391
Methyl-t-butylether	970.	ug/L	2.5	5.0	1/26/04	19:17	F.Gundi	8021B	9126
TPH (Gasoline Range)	625.	ug/L	50.0	1.0	1/25/04	7:18	F.Gundi	8015B	6391
TPH (Diesel Range)	ND	ug/L	50.	1.0	1/25/04	2:50	Weatherly	8015B/3510	7248
VOLATILE ORGANICS									
Ethyl-t-butylether	ND	ug/L	0.50	1.0	1/24/04	14:10	S. Davis	8260B	7062
tert-amyl methyl ether	2.20	ug/L	0.50	1.0	1/24/04	14:10	S. Davis	8260B	7062
Tertiary butyl alcohol	57.9	ug/L	10.0	1.0	1/24/04	14:10	S. Davis	8260B	7062
1,2-Dibromoethane	ND	ug/L	0.50	1.0	1/24/04	14:10	S. Davis	8260B	7062
1,2-Dichloroethane	ND	ug/L	0.50	1.0	1/24/04	14:10	S. Davis	8260B	7062
Methyl-t-butyl ether	974.	ug/L	5.00	10.0	1/25/04	15:55	M.Himelick	8260B	9698
Diisopropyl ether	ND	ug/L	0.50	1.0	1/24/04	14:10	S. Davis	8260B	7062

Silica Gel Cleanup performed for TPH-DRO analysis.

Sample Extraction Data

Parameter	Wt/Vol		Date	Time	Analyst	Method
	Extracted	Extract Vol				

Sample report continued . . .

ANALYTICAL REPORT

Laboratory Number: 04-A9696
 Sample ID: MW1
 Project: 243113X
 Page 2

 Sample Extraction Data

Parameter	Wt/Vol		Date	Time	Analyst	Method
	Extracted	Extract Vol				
EPH	1000 ml	1.00 ml	1/24/04		K. Turner	3510

Surrogate	% Recovery	Target Range
TPH Hi Surr., o-Terphenyl	77.	50. - 141.
BTEX/GRO Surr., a,a,a-TFT	98.	70. - 124.
VOA Surr 1,2-DCA-d4	100.	71. - 128.
VOA Surr Toluene-d8	103.	77. - 119.
VOA Surr, 4-BFB	108.	79. - 123.
VOA Surr, DBFM	104.	78. - 124.

LABORATORY COMMENTS:

- ND = Not detected at the report limit.
- B = Analyte was detected in the method blank.
- J = Estimated Value below Report Limit.
- E = Estimated Value above the calibration limit of the instrument.
- # = Recovery outside Laboratory historical or method prescribed limits.

End of Sample Report.

ANALYTICAL REPORT

ERI - NORTHERN CA 3876
 ROB SAUR
 73 DIGITAL DRIVE, SUITE 100
 NOVATO, CA 94949

Lab Number: 04-A9697
 Sample ID: MW2
 Sample Type: Water
 Site ID: 7-3567

Project: 243113X
 Project Name: EXXONMOBIL 7-3567
 Sampler: DAVID MADDAN

Date Collected: 1/21/04
 Time Collected: 13:55
 Date Received: 1/23/04
 Time Received: 8:05
 Page: 1

Analyte	Result	Units	Report Limit	Dil Factor	Analysis		Analyst	Method	Batch
					Date	Time			
ORGANIC PARAMETERS									
Benzene	0.50	ug/L	0.50	1.0	1/26/04	20:17	F.Gundi	8021B	9126
Ethylbenzene	ND	ug/L	0.5	1.0	1/26/04	20:17	F.Gundi	8021B	9126
Toluene	ND	ug/L	0.5	1.0	1/26/04	20:17	F.Gundi	8021B	9126
Xylenes (Total)	ND	ug/L	0.5	1.0	1/26/04	20:17	F.Gundi	8021B	9126
Methyl-t-butylether	ND	ug/L	0.5	1.0	1/26/04	20:17	F.Gundi	8021B	9126
TPH (Gasoline Range)	ND	ug/L	50.0	1.0	1/26/04	20:17	F.Gundi	8015B	9126
TPH (Diesel Range)	ND	ug/L	50.	1.0	1/25/04	3:11	Weatherly	8015B/3510	7248
VOLATILE ORGANICS									
Ethyl-t-butylether	ND	ug/L	0.50	1.0	1/24/04	14:40	S. Davis	8260B	7062
tert-amyl methyl ether	ND	ug/L	0.50	1.0	1/24/04	14:40	S. Davis	8260B	7062
Tertiary butyl alcohol	ND	ug/L	10.0	1.0	1/24/04	14:40	S. Davis	8260B	7062
1,2-Dibromoethane	ND	ug/L	0.50	1.0	1/24/04	14:40	S. Davis	8260B	7062
1,2-Dichloroethane	ND	ug/L	0.50	1.0	1/24/04	14:40	S. Davis	8260B	7062
Methyl-t-butyl ether	ND	ug/L	0.50	1.0	1/24/04	14:40	S. Davis	8260B	7062
Diisopropyl ether	ND	ug/L	0.50	1.0	1/24/04	14:40	S. Davis	8260B	7062

Silica Gel Cleanup performed for TPH-DRO analysis.

Sample Extraction Data

Parameter	Wt/Vol		Date	Time	Analyst	Method
	Extracted	Extract Vol				

Sample report continued . . .

ANALYTICAL REPORT

Laboratory Number: 04-A9697

Sample ID: MW2

Project: 243113X

Page 2

Sample Extraction Data

Parameter	Wt/Vol		Date	Time	Analyst	Method
	Extracted	Extract Vol				
EPH	1000 ml	1.00 ml	1/24/04		K. Turner	3510

Surrogate	% Recovery	Target Range
TPH Hi Surr., o-Terphenyl	84.	50. - 141.
BTEX/GRO Surr., a,a,a-TFT	97.	70. - 124.
VOA Surr 1,2-DCA-d4	103.	71. - 128.
VOA Surr Toluene-d8	99.	77. - 119.
VOA Surr, 4-BFB	109.	79. - 123.
VOA Surr, DBFM	103.	78. - 124.

LABORATORY COMMENTS:

ND = Not detected at the report limit.

B = Analyte was detected in the method blank.

J = Estimated Value below Report Limit.

E = Estimated Value above the calibration limit of the instrument.

= Recovery outside Laboratory historical or method prescribed limits.

End of Sample Report.

ANALYTICAL REPORT

ERI - NORTHERN CA 3876
 ROB SAUR
 73 DIGITAL DRIVE, SUITE 100
 NOVATO, CA 94949

Lab Number: 04-A9698
 Sample ID: MW3
 Sample Type: Water
 Site ID: 7-3567

Project: 243113X
 Project Name: EXXONMOBIL 7-3567
 Sampler: DAVID MADDAN

Date Collected: 1/21/04
 Time Collected: 14:50
 Date Received: 1/23/04
 Time Received: 8:05
 Page: 1

Analyte	Result	Units	Report Limit	Dil Factor	Analysis Date	Analysis Time	Analyst	Method	Batch
ORGANIC PARAMETERS									
Benzene	ND	ug/L	0.50	1.0	1/25/04	8:18	F.Gundi	8021B	6391
Ethylbenzene	ND	ug/L	0.5	1.0	1/25/04	8:18	F.Gundi	8021B	6391
Toluene	ND	ug/L	0.5	1.0	1/25/04	8:18	F.Gundi	8021B	6391
Xylenes (Total)	ND	ug/L	0.5	1.0	1/25/04	8:18	F.Gundi	8021B	6391
Methyl-t-butylether	118.	ug/L	0.5	1.0	1/25/04	8:18	F.Gundi	8021B	6391
TPH (Gasoline Range)	90.6	ug/L	50.0	1.0	1/25/04	8:18	F.Gundi	8015B	6391
TPH (Diesel Range)	94.	ug/L	50.	1.0	1/25/04	3:32	Weatherly	8015B/3510	7248
VOLATILE ORGANICS									
Ethyl-t-butylether	ND	ug/L	0.50	1.0	1/24/04	15:10	S. Davis	8260B	7062
tert-amyl methyl ether	ND	ug/L	0.50	1.0	1/24/04	15:10	S. Davis	8260B	7062
Tertiary butyl alcohol	ND	ug/L	10.0	1.0	1/24/04	15:10	S. Davis	8260B	7062
1,2-Dibromoethane	ND	ug/L	0.50	1.0	1/24/04	15:10	S. Davis	8260B	7062
1,2-Dichloroethane	ND	ug/L	0.50	1.0	1/24/04	15:10	S. Davis	8260B	7062
Methyl-t-butyl ether	148.	ug/L	0.50	1.0	1/24/04	15:10	S. Davis	8260B	7062
Diisopropyl ether	ND	ug/L	0.50	1.0	1/24/04	15:10	S. Davis	8260B	7062

Silica Gel Cleanup performed for TPH-DRO analysis.

Sample Extraction Data

Parameter	Wt/Vol Extracted	Extract Vol	Date	Time	Analyst	Method
-----------	---------------------	-------------	------	------	---------	--------

Sample report continued . . .

ANALYTICAL REPORT

Laboratory Number: 04-A9698
Sample ID: MW3
Project: 243113X
Page 2

Sample Extraction Data

Parameter	Wt/Vol		Date	Time	Analyst	Method
	Extracted	Extract Vol				
EPH	1000 ml	1.00 ml	1/24/04		K. Turner	3510

Surrogate	% Recovery	Target Range
TPH Hi Surr., o-Terphenyl	97.	50. - 141.
BTEX/GRO Surr., a,a,a-TFT	99.	70. - 124.
VOA Surr 1,2-DCA-G4	103.	71. - 128.
VOA Surr Toluene-d8	98.	77. - 119.
VOA Surr, 4-BFB	108.	79. - 123.
VOA Surr, DBFM	105.	78. - 124.

LABORATORY COMMENTS:

ND = Not detected at the report limit.
B = Analyte was detected in the method blank.
J = Estimated Value below Report Limit.
E = Estimated Value above the calibration limit of the instrument.
= Recovery outside Laboratory historical or method prescribed limits.
TPH-Diesel result was not consistent with diesel fuel.

End of Sample Report.

ANALYTICAL REPORT

ERI - NORTHERN CA 3876
 ROB SAUR
 73 DIGITAL DRIVE, SUITE 100
 NOVATO, CA 94949

Lab Number: 04-A9699
 Sample ID: MW4
 Sample Type: Water
 Site ID: 7-3567

Project: 243113X
 Project Name: EXXONMOBIL 7-3567
 Sampler: DAVID MADDAN

Date Collected: 1/21/04
 Time Collected: 14:10
 Date Received: 1/23/04
 Time Received: 8:05
 Page: 1

Analyte	Result	Units	Report Limit	Dil Factor	Analysis		Analyst	Method	Batch
					Date	Time			
ORGANIC PARAMETERS									
Benzene	ND	ug/L	0.50	1.0	1/25/04	8:47	F.Gundi	8021B	6391
Ethylbenzene	ND	ug/L	0.5	1.0	1/25/04	8:47	F.Gundi	8021B	6391
Toluene	ND	ug/L	0.5	1.0	1/25/04	8:47	F.Gundi	8021B	6391
Xylenes (Total)	ND	ug/L	0.5	1.0	1/25/04	8:47	F.Gundi	8021B	6391
Methyl-t-butylether	8.4	ug/L	0.5	1.0	1/25/04	8:47	F.Gundi	8021B	6391
TPH (Gasoline Range)	ND	ug/L	50.0	1.0	1/25/04	8:47	F.Gundi	8015B	6391
TPH (Diesel Range)	ND	ug/L	50.	1.0	1/25/04	3:52	Weatherly	8015B/3510	7248
VOLATILE ORGANICS									
Ethyl-t-butylether	ND	ug/L	0.50	1.0	1/24/04	15:40	S. Davis	8260B	7062
tert-amyl methyl ether	ND	ug/L	0.50	1.0	1/24/04	15:40	S. Davis	8260B	7062
Tertiary butyl alcohol	ND	ug/L	10.0	1.0	1/24/04	15:40	S. Davis	8260B	7062
1,2-Dibromoethane	ND	ug/L	0.50	1.0	1/24/04	15:40	S. Davis	8260B	7062
1,2-Dichloroethane	ND	ug/L	0.50	1.0	1/24/04	15:40	S. Davis	8260B	7062
Methyl-t-butyl ether	9.40	ug/L	0.50	1.0	1/24/04	15:40	S. Davis	8260B	7062
Diisopropyl ether	ND	ug/L	0.50	1.0	1/24/04	15:40	S. Davis	8260B	7062

Silica Gel Cleanup performed for TPH-DRO analysis.

Sample Extraction Data

Parameter	Wt/Vol		Date	Time	Analyst	Method
	Extracted	Extract Vol				

Sample report continued . . .

ANALYTICAL REPORT

Laboratory Number: 04-A9699

Sample ID: MW4

Project: 243113X

Page 2

Sample Extraction Data

Parameter	Wt/Vol Extracted	Extract Vol	Date	Time	Analyst	Method
EPH	1000 ml	1.00 ml	1/24/04		K. Turner	3510

Surrogate	% Recovery	Target Range
TPH Hi Surr., o-Terphenyl	97.	50. - 141.
BTEX/GRO Surr., a,a,a-TFT	99.	70. - 124.
VOA Surr 1,2-DCA-d4	104.	71. - 128.
VOA Surr Toluene-d8	97.	77. - 119.
VOA Surr, 4-BFB	107.	79. - 123.
VOA Surr, DBFM	104.	78. - 124.

LABORATORY COMMENTS:

ND = Not detected at the report limit.

B = Analyte was detected in the method blank.

J = Estimated Value below Report Limit.

E = Estimated Value above the calibration limit of the instrument.

= Recovery outside Laboratory historical or method prescribed limits.

End of Sample Report.

ANALYTICAL REPORT

ERI - NORTHERN CA 3876
ROB SAUR
73 DIGITAL DRIVE, SUITE 100
NOVATO, CA 94949

Lab Number: 04-A9700
Sample ID: MW5
Sample Type: Water
Site ID: 7-3567

Project: 243113X
Project Name: EXXONMOBIL 7-3567
Sampler: DAVID MADDAN

Date Collected: 1/21/04
Time Collected: 14:05
Date Received: 1/23/04
Time Received: 8:05
Page: 1

Analyte	Result	Units	Report Limit	Dil Factor	Analysis		Analyst	Method	Batch
					Date	Time			
ORGANIC PARAMETERS									
Benzene	1.30	ug/L	0.50	1.0	1/25/04	9:17	F.Gundi	8021B	6391
Ethylbenzene	ND	ug/L	0.5	1.0	1/25/04	9:17	F.Gundi	8021B	6391
Toluene	1.4	ug/L	0.5	1.0	1/25/04	9:17	F.Gundi	8021B	6391
Xylenes (Total)	2.4	ug/L	0.5	1.0	1/25/04	9:17	F.Gundi	8021B	6391
Methyl-t-butylether	3.7	ug/L	0.5	1.0	1/25/04	9:17	F.Gundi	8021B	6391
TPH (Gasoline Range)	ND	ug/L	50.0	1.0	1/25/04	9:17	F.Gundi	8015B	6391
TEH (Diesel Range)	ND	ug/L	50.	1.0	1/25/04	4:13	Weatherly	8015B/3510	7248
VOLATILE ORGANICS									
Ethyl-t-butylether	ND	ug/L	0.50	1.0	1/24/04	16:09	S. Davis	8260B	7062
tert-amyl methyl ether	ND	ug/L	0.50	1.0	1/24/04	16:09	S. Davis	8260B	7062
Tertiary butyl alcohol	ND	ug/L	10.0	1.0	1/24/04	16:09	S. Davis	8260B	7062
1,2-Dibromoethane	ND	ug/L	0.50	1.0	1/24/04	16:09	S. Davis	8260B	7062
1,2-Dichloroethane	ND	ug/L	0.50	1.0	1/24/04	16:09	S. Davis	8260B	7062
Methyl-t-butyl ether	4.00	ug/L	0.50	1.0	1/24/04	16:09	S. Davis	8260B	7062
Diisopropyl ether	ND	ug/L	0.50	1.0	1/24/04	16:09	S. Davis	8260B	7062

Silica Gel Cleanup performed for TPH-DRO analysis.

Sample Extraction Data

Parameter	Wt/Vol		Date	Time	Analyst	Method
	Extracted	Extract Vol				

Sample report continued . . .

ANALYTICAL REPORT

Laboratory Number: 04-A9700
Sample ID: MW5
Project: 243113X
Page 2

Sample Extraction Data

Parameter	Wt/Vol		Date	Time	Analyst	Method
	Extracted	Extract Vol				
EPH	1000 ml	1.00 ml	1/24/04		K. Turner	3510

Surrogate	% Recovery	Target Range
TPH Hi Surr., o-Terphenyl	97.	50. - 141.
BTEX/GRO Surr., a,a,a-TFT	99.	70. - 124.
VOA Surr 1,2-DCA-d4	104.	71. - 128.
VOA Surr Toluene-d8	98.	77. - 119.
VOA Surr, 4-BFB	106.	79. - 123.
VOA Surr, DBFM	105.	78. - 124.

LABORATORY COMMENTS:

- ND = Not detected at the report limit.
- B = Analyte was detected in the method blank.
- J = Estimated Value below Report Limit.
- E = Estimated Value above the calibration limit of the instrument.
- # = Recovery outside Laboratory historical or method prescribed limits.

End of Sample Report.

ANALYTICAL REPORT

ERI - NORTHERN CA 3876
ROB SAUR
73 DIGITAL DRIVE, SUITE 100
NOVATO, CA 94949

Lab Number: 04-A9701
Sample ID: MW6
Sample Type: Water
Site ID: 7-3567

Project: 243113X
Project Name: EXXONMOBIL 7-3567
Sampler: DAVID MADDAN

Date Collected: 1/21/04
Time Collected: 13:45
Date Received: 1/23/04
Time Received: 8:05
Page: 1

Analyte	Result	Units	Report Limit	Dil Factor	Analysis Date	Analysis Time	Analyst	Method	Batch
ORGANIC PARAMETERS									
Benzene	ND	ug/L	0.50	1.0	1/25/04	9:46	F.Gundi	8021B	6391
Ethylbenzene	ND	ug/L	0.5	1.0	1/25/04	9:46	F.Gundi	8021B	6391
Toluene	ND	ug/L	0.5	1.0	1/25/04	9:46	F.Gundi	8021B	6391
Xylenes (Total)	ND	ug/L	0.5	1.0	1/25/04	9:46	F.Gundi	8021B	6391
Methyl-t-butylether	ND	ug/L	0.5	1.0	1/25/04	9:46	F.Gundi	8021B	6391
TPH (Gasoline Range)	ND	ug/L	50.0	1.0	1/25/04	9:46	F.Gundi	8015B	6391
TPH (Diesel Range)	ND	ug/L	50.	1.0	1/25/04	4:34	Weatherly	8015B/3510	7248
VOLATILE ORGANICS									
Ethyl-t-butylether	ND	ug/L	0.50	1.0	1/24/04	16:39	S. Davis	8260B	7062
tert-amyl methyl ether	ND	ug/L	0.50	1.0	1/24/04	16:39	S. Davis	8260B	7062
Tertiary butyl alcohol	ND	ug/L	10.0	1.0	1/24/04	16:39	S. Davis	8260B	7062
1,2-Dibromoethane	ND	ug/L	0.50	1.0	1/24/04	16:39	S. Davis	8260B	7062
1,2-Dichloroethane	ND	ug/L	0.50	1.0	1/24/04	16:39	S. Davis	8260B	7062
Methyl-t-butyl ether	ND	ug/L	0.50	1.0	1/24/04	16:39	S. Davis	8260B	7062
Diisopropyl ether	ND	ug/L	0.50	1.0	1/24/04	16:39	S. Davis	8260B	7062

Silica Gel Cleanup performed for TPH-DRO analysis.

Sample Extraction Data

Parameter	Wt/Vol Extracted	Extract Vol	Date	Time	Analyst	Method
-----------	------------------	-------------	------	------	---------	--------

Sample report continued . . .

ANALYTICAL REPORT

Laboratory Number: 04-A9701

Sample ID: MW6

Project: 243113X

Page 2

Sample Extraction Data

Parameter	Wt/Vol Extracted	Extract Vol	Date	Time	Analyst	Method
EPH	1000 ml	1.00 ml	1/24/04		K. Turner	3510

Surrogate	% Recovery	Target Range
TPH Hi Surr., o-Terphenyl	96.	50. - 141.
BTEX/GRO Surr., a,a,a-TFT	98.	70. - 124.
VOA Surr 1,2-DCA-d4	105.	71. - 128.
VOA Surr Toluene-d8	99.	77. - 119.
VOA Surr, 4-BFB	106.	79. - 123.
VOA Surr, DBEM	105.	78. - 124.

LABORATORY COMMENTS:

ND = Not detected at the report limit.

B = Analyte was detected in the method blank.

J = Estimated Value below Report Limit.

E = Estimated Value above the calibration limit of the instrument.

= Recovery outside Laboratory historical or method prescribed limits.

End of Sample Report.

ANALYTICAL REPORT

ERI - NORTHERN CA 3876
ROB SAUR
73 DIGITAL DRIVE, SUITE 100
NOVATO, CA 94949

Lab Number: 04-A9702
Sample ID: MW7
Sample Type: Water
Site ID: 7-3567

Project: 243113X
Project Name: EXXONMOBIL 7-3567
Sampler: DAVID MADDAN

Date Collected: 1/21/04
Time Collected: 14:20
Date Received: 1/23/04
Time Received: 8:05
Page: 1

Analyte	Result	Units	Report Limit	Dil Factor	Analysis Date	Analysis Time	Analyst	Method	Batch
ORGANIC PARAMETERS									
Benzene	ND	ug/L	0.50	1.0	1/27/04	20:00	F.Gundi	8021B	8697
Ethylbenzene	ND	ug/L	0.5	1.0	1/27/04	20:00	F.Gundi	8021B	8697
Toluene	ND	ug/L	0.5	1.0	1/27/04	20:00	F.Gundi	8021B	8697
Xylenes (Total)	ND	ug/L	0.5	1.0	1/27/04	20:00	F.Gundi	8021B	8697
Methyl-t-butylether	15.1	ug/L	0.5	1.0	1/27/04	20:00	F.Gundi	8021B	8697
TPH (Gasoline Range)	ND	ug/L	50.0	1.0	1/27/04	20:00	F.Gundi	8015B	8697
TPH (Diesel Range)	140.	ug/L	50.	1.0	1/25/04	4:54	Weatherly	8015B/3510	7248
VOLATILE ORGANICS									
Ethyl-t-butylether	ND	ug/L	0.50	1.0	1/24/04	17:11	S. Davis	8260B	7066
tert-amyl methyl ether	ND	ug/L	0.50	1.0	1/24/04	17:11	S. Davis	8260B	7066
Tertiary butyl alcohol	ND	ug/L	10.0	1.0	1/24/04	17:11	S. Davis	8260B	7066
1,2-Dibromoethane	ND	ug/L	0.50	1.0	1/24/04	17:11	S. Davis	8260B	7066
1,2-Dichloroethane	ND	ug/L	0.50	1.0	1/24/04	17:11	S. Davis	8260B	7066
Methyl-t-butyl ether	17.6	ug/L	0.50	1.0	1/24/04	17:11	S. Davis	8260B	7066
Diisopropyl ether	ND	ug/L	0.50	1.0	1/24/04	17:11	S. Davis	8260B	7066

Silica Gel Cleanup performed for TPH-DRO analysis.

Sample Extraction Data

Parameter	Wt/Vol		Date	Time	Analyst	Method
	Extracted	Extract Vol				

Sample report continued . . .

ANALYTICAL REPORT

Laboratory Number: 04-A9702
Sample ID: MW7
Project: 243113X
Page 2

Sample Extraction Data

Parameter	Wt/Vol		Date	Time	Analyst	Method
	Extracted	Extract Vol				
EPH	1000 ml	1.00 ml	1/24/04		K. Turner	3510

Surrogate	% Recovery	Target Range
TPH Hi Surr., o-Terphenyl	109.	50. - 141.
BTEX/GRO Surr., a,a,a-TFT	97.	70. - 124.
VOA Surr 1,2-DCA-d4	106.	71. - 128.
VOA Surr Toluene-d8	108.	77. - 119.
VOA Surr, 4-BFB	113.	79. - 123.
VOA Surr, DBFM	104.	78. - 124.

LABORATORY COMMENTS:

ND = Not detected at the report limit.
B = Analyte was detected in the method blank.
J = Estimated Value below Report Limit.
E = Estimated Value above the calibration limit of the instrument.
= Recovery outside Laboratory historical or method prescribed limits.
TPH-Diesel result was not consistent with diesel fuel.

End of Sample Report.

ANALYTICAL REPORT

ERI - NORTHERN CA 3876
ROB SAUR
73 DIGITAL DRIVE, SUITE 100
NOVATO, CA 94949

Lab Number: 04-A9703
Sample ID: BB
Sample Type: Water
Site ID: 7-3567

Project: 243113X
Project Name: EXXONMOBIL 7-3567
Sampler: DAVID MADDAN

Date Collected: 1/21/04
Time Collected: 15:00
Date Received: 1/23/04
Time Received: 8:05
Page: 1

Analyte	Result	Units	Report Limit	Dil Factor	Analysis Date	Analysis Time	Analyst	Method	Batch
---------	--------	-------	--------------	------------	---------------	---------------	---------	--------	-------

Silica Gel Cleanup performed for TPH-DRO analysis.

Sample Extraction Data

Parameter	Wt/Vol Extracted	Extract Vol	Date	Time	Analyst	Method
EPH	1000 ml	1.00 ml	1/24/04		K. Turner	3510

LABORATORY COMMENTS:

- ND = Not detected at the report limit.
- B = Analyte was detected in the method blank.
- J = Estimated Value below Report Limit.
- E = Estimated Value above the calibration limit of the instrument.
- # = Recovery outside Laboratory historical or method prescribed limits.

End of Sample Report.

PROJECT QUALITY CONTROL DATA

Project Number: 243113X
Project Name: EXXONMOBIL 7-3567
Page: 1
Laboratory Receipt Date: 1/23/04

Matrix Spike Recovery

Note: If Blank is referenced as the sample spiked, insufficient volume was received for the defined analytical batch for MS/MSD analysis on an true sample matrix. Laboratory reagent water was used for QC purposes.

Analyte	units	Orig. Val.	MS Val	Spike Conc	Recovery	Target Range	Q.C. Batch	Spike Sample
UST ANALYSIS								
Benzene	mg/l	0.0101	0.0567	0.0500	93	53. - 159.	6391	04-A9715
Benzene	mg/l	< 0.00050	0.0578	0.0500	116	53. - 159.	8697	04-A11229
Toluene	mg/l	< 0.0005	0.0546	0.0500	109	54. - 156.	6391	04-A9715
Toluene	mg/l	0.0017	0.0583	0.0500	113	54. - 156.	8697	04-A11229
Ethylbenzene	mg/l	< 0.0005	0.0522	0.0500	104	50. - 159.	6391	04-A9715
Ethylbenzene	mg/l	0.0005	0.0577	0.0500	114	50. - 159.	8697	04-A11229
Xylenes (Total)	mg/l	0.0082	0.112	0.100	104	53. - 151.	6391	04-A9715
Xylenes (Total)	mg/l	0.0021	0.114	0.100	112	53. - 151.	8697	04-A11229
Methyl-t-butylether	mg/l	0.0045	0.0559	0.0500	103	36. - 158.	6391	04-A9715
Methyl-t-butylether	mg/l	0.0399	0.0811	0.0500	82	36. - 158.	8697	04-A11229
TPH (Gasoline Range)	mg/l	0.137	0.915	1.00	78	70. - 157.	6391	04-A9715
TPH (Gasoline Range)	mg/l	0.0624	0.956	1.00	89	70. - 157.	8697	04-A11229
TPH (Diesel Range)	mg/l	< 0.050	0.646	1.00	65	10. - 143.	7248	blank
BTEX/GRO Surr., a,a,a-TFT	% Recovery				101	70 - 124	6391	
BTEX/GRO Surr., a,a,a-TFT	% Recovery				106	70 - 124	8697	

Matrix Spike Duplicate

Analyte	units	Orig. Val.	Duplicate	RPD	Limit	Q.C. Batch
UST PARAMETERS						
Benzene	mg/l	0.0567	0.0602	5.99	21.	6391
Benzene	mg/l	0.0578	0.0583	0.86	21.	8697

Project QC continued . . .

PROJECT QUALITY CONTROL DATA

Project Number: 243113X
Project Name: EXXONMOBIL 7-3567
Page: 2
Laboratory Receipt Date: 1/23/04

Matrix Spike Duplicate

Analyte	units	Orig. Val.	Duplicate	RPD	Limit	Q.C. Batch
Toluene	mg/l	0.0546	0.0597	8.92	25.	6391
Toluene	mg/l	0.0583	0.0577	1.03	25.	8697
Ethylbenzene	mg/l	0.0522	0.0589	12.06	25.	6391
Ethylbenzene	mg/l	0.0577	0.0552	4.43	25.	8697
Xylenes (Total)	mg/l	0.112	0.130	14.88	24.	6391
Xylenes (Total)	mg/l	0.114	0.112	1.77	24.	8697
Methyl-t-butylether	mg/l	0.0559	0.0561	0.36	24.	6391
Methyl-t-butylether	mg/l	0.0811	0.0912	11.72	24.	8697
TPH (Gasoline Range)	mg/l	0.915	0.982	7.06	24.	6391
TPH (Gasoline Range)	mg/l	0.956	0.908	5.15	24.	8697
TPH (Diesel Range)	mg/l	0.646	0.700	8.02	57.	7248
BTEX/GRO Surr., a,a,a-TFT	% Recovery		101.			6391
BTEX/GRO Surr., a,a,a-TFT	% Recovery		106.			8697
VOA Surr 1,2-DCA-d4	% Rec		101.			7062
VOA Surr 1,2-DCA-d4	% Rec		98.			7066
VOA Surr 1,2-DCA-d4	% Rec		95.			9698
VOA Surr Toluene-d8	% Rec		97.			7062
VOA Surr Toluene-d8	% Rec		106.			7066
VOA Surr Toluene-d8	% Rec		98.			9698
VOA Surr, 4-BFB	% Rec		105.			7062
VOA Surr, 4-BFB	% Rec		106.			7066
VOA Surr, 4-BFB	% Rec		103.			9698
VOA Surr, DBFM	% Rec		104.			7062
VOA Surr, DBFM	% Rec		99.			7066
VOA Surr, DBFM	% Rec		100.			9698

Project QC continued . . .

PROJECT QUALITY CONTROL DATA

Project Number: 243113X
Project Name: EXXONMOBIL 7-3567
Page: 3
Laboratory Receipt Date: 1/23/04

Laboratory Control Data

Analyte	units	Known Val.	Analyzed Val	% Recovery	Target Range	Q.C. Batch
UST PARAMETERS						
Benzene	mg/l	0.100	0.103	103	76 - 118	6391
Benzene	mg/l	0.100	0.104	104	76 - 118	9126
Benzene	mg/l	0.100	0.106	106	76 - 118	8697
Toluene	mg/l	0.100	0.100	100	72 - 119	6391
Toluene	mg/l	0.100	0.102	102	72 - 119	9126
Toluene	mg/l	0.100	0.103	103	72 - 119	8697
Ethylbenzene	mg/l	0.100	0.101	101	72 - 119	6391
Ethylbenzene	mg/l	0.100	0.102	102	72 - 119	9126
Ethylbenzene	mg/l	0.100	0.104	104	72 - 119	8697
Xylenes (Total)	mg/l	0.200	0.197	98	71 - 123	6391
Xylenes (Total)	mg/l	0.200	0.200	100	71 - 123	9126
Xylenes (Total)	mg/l	0.200	0.204	102	71 - 123	8697
Methyl-t-butylether	mg/l	0.100	0.0941	94	63 - 120	6391
Methyl-t-butylether	mg/l	0.100	0.0953	95	63 - 120	9126
Methyl-t-butylether	mg/l	0.100	0.0922	92	63 - 120	8697
TPH (Gasoline Range)	mg/l	1.00	0.915	92	72 - 122	6391
TPH (Gasoline Range)	mg/l	1.00	0.873	87	72 - 122	9126
TPH (Gasoline Range)	mg/l	1.00	0.956	96	72 - 122	8697
BTEX/GRO Surr., a,a,a-TFT	% Recovery			102	70 - 124	6391
BTEX/GRO Surr., a,a,a-TFT	% Recovery			102	70 - 124	9126
BTEX/GRO Surr., a,a,a-TFT	% Recovery			105	70 - 124	8697
UST PARAMETERS						
TPH (Diesel Range)	mg/l	1.00	0.665	66	10 - 143	7248

Project QC continued . . .

PROJECT QUALITY CONTROL DATA

Project Number: 243113X
 Project Name: EXXONMOBIL 7-3567
 Page: 4
 Laboratory Receipt Date: 1/23/04

****VOA PARAMETERS****

Ethyl-t-butylether	mg/l	0.0500	0.0574	115	72 - 127	7062
Ethyl-t-butylether	mg/l	0.0500	0.0538	108	72 - 127	7066
tert-amyl methyl ether	mg/L	0.0500	0.0583	117	61 - 129	7062
tert-amyl methyl ether	mg/L	0.0500	0.0538	108	61 - 129	7066
Tertiary butyl alcohol	mg/l	0.500	0.556	111	39 - 156	7062
Tertiary butyl alcohol	mg/l	0.500	0.691	138	39 - 156	7066
1,2-Dibromoethane	mg/l	0.0500	0.0504	101	78 - 133	7062
1,2-Dibromoethane	mg/l	0.0500	0.0525	105	78 - 133	7066
1,2-Dichloroethane	mg/l	0.0500	0.0524	105	72 - 133	7062
1,2-Dichloroethane	mg/l	0.0500	0.0477	95	72 - 133	7066
Methyl-t-butyl ether	mg/l	0.0500	0.0558	112	70 - 130	7062
Methyl-t-butyl ether	mg/l	0.0500	0.0538	108	70 - 130	7066
Methyl-t-butyl ether	mg/l	0.0500	0.0558	112	70 - 130	9698
Diisopropyl ether	mg/l	0.0500	0.0533	107	73 - 127	7062
Diisopropyl ether	mg/l	0.0500	0.0500	100	73 - 127	7066
VOA Surr 1,2-DCA-d4	% Rec			98	71 - 128	7062
VOA Surr 1,2-DCA-d4	% Rec			92	71 - 128	7066
VOA Surr 1,2-DCA-d4	% Rec			99	71 - 128	9698
VOA Surr Toluene-d8	% Rec			98	77 - 119	7062
VOA Surr Toluene-d8	% Rec			107	77 - 119	7066
VOA Surr Toluene-d8	% Rec			99	77 - 119	9698
VOA Surr, 4-BFB	% Rec			102	79 - 123	7062
VOA Surr, 4-BFB	% Rec			104	79 - 123	7066
VOA Surr, 4-BFB	% Rec			101	79 - 123	9698
VOA Surr, DBFM	% Rec			102	78 - 124	7062
VOA Surr, DBFM	% Rec			103	78 - 124	7066
VOA Surr, DBFM	% Rec			102	78 - 124	9698

Duplicates

Analyte	units	Orig. Val.	Duplicate	RPD	Limit	Q.C. Batch	Sample Dup'd
---------	-------	------------	-----------	-----	-------	------------	--------------

Project QC continued . . .

PROJECT QUALITY CONTROL DATA

Project Number: 243113X

Project Name: EXXONMOBIL 7-3567

Page: 5

Laboratory Receipt Date: 1/23/04

Blank Data

Analyte	Blank Value	Units	Q.C. Batch	Date Analyzed	Time Analyzed
UST PARAMETERS					
Benzene	< 0.00050	mg/l	6391	1/24/04	22:55
Benzene	< 0.00050	mg/l	9126	1/26/04	16:19
Benzene	< 0.00050	mg/l	8697	1/27/04	19:30
Toluene	< 0.0005	mg/l	6391	1/24/04	22:55
Toluene	< 0.0005	mg/l	9126	1/26/04	16:19
Toluene	< 0.0005	mg/l	8697	1/27/04	19:30
Ethylbenzene	< 0.0005	mg/l	6391	1/24/04	22:55
Ethylbenzene	< 0.0005	mg/l	9126	1/26/04	16:19
Ethylbenzene	< 0.0005	mg/l	8697	1/27/04	19:30
Xylenes (Total)	< 0.0005	mg/l	6391	1/24/04	22:55
Xylenes (Total)	< 0.0005	mg/l	9126	1/26/04	16:19
Xylenes (Total)	< 0.0005	mg/l	8697	1/27/04	19:30
Methyl-t-butylether	< 0.0005	mg/l	6391	1/24/04	22:55
Methyl-t-butylether	< 0.0005	mg/l	9126	1/26/04	16:19
Methyl-t-butylether	< 0.0005	mg/l	8697	1/27/04	19:30
TPH (Gasoline Range)	< 0.0500	mg/l	6391	1/24/04	22:55
TPH (Gasoline Range)	< 0.0500	mg/l	9126	1/26/04	16:19
TPH (Gasoline Range)	< 0.0500	mg/l	8697	1/27/04	19:30
TPH (Diesel Range)	< 0.050	mg/l	7248	1/25/04	1:27
BTEX/GRO Surr., a,a,a-TFT	100.	% Recovery	6391	1/24/04	22:55
BTEX/GRO Surr., a,a,a-TFT	93.	% Recovery	9126	1/26/04	16:19
BTEX/GRO Surr., a,a,a-TFT	98.	% Recovery	8697	1/27/04	19:30

Project QC continued . . .

PROJECT QUALITY CONTROL DATA

Project Number: 243113X
 Project Name: EXXONMOBIL 7-3567
 Page: 6
 Laboratory Receipt Date: 1/23/04

****VOA PARAMETERS****

Ethyl-t-butylether	< 0.00010	mg/l	7062	1/24/04	8:12
Ethyl-t-butylether	< 0.00010	mg/l	7066	1/24/04	14:20
tert-amyl methyl ether	< 0.00019	mg/L	7062	1/24/04	8:12
tert-amyl methyl ether	< 0.00019	mg/L	7066	1/24/04	14:20
Tertiary butyl alcohol	< 0.00257	mg/l	7062	1/24/04	8:12
Tertiary butyl alcohol	< 0.00257	mg/l	7066	1/24/04	14:20
1,2-Dibromoethane	< 0.00018	mg/l	7062	1/24/04	8:12
1,2-Dibromoethane	< 0.00018	mg/l	7066	1/24/04	14:20
1,2-Dichloroethane	< 0.00021	mg/l	7062	1/24/04	8:12
1,2-Dichloroethane	< 0.00021	mg/l	7066	1/24/04	14:20
Methyl-t-butyl ether	< 0.00014	mg/l	7062	1/24/04	8:12
Methyl-t-butyl ether	< 0.00014	mg/l	7066	1/24/04	14:20
Methyl-t-butyl ether	< 0.00014	mg/l	9698	1/25/04	8:58
Diisopropyl ether	< 0.00030	mg/l	7062	1/24/04	8:12
Diisopropyl ether	< 0.00030	mg/l	7066	1/24/04	14:20
VOA Surr 1,2-DCA-d4	103.	% Rec	7062	1/24/04	8:12
VOA Surr 1,2-DCA-d4	106.	% Rec	7066	1/24/04	14:20
VOA Surr 1,2-DCA-d4	103.	% Rec	9698	1/25/04	8:58
VOA Surr Toluene-d8	101.	% Rec	7062	1/24/04	8:12
VOA Surr Toluene-d8	105.	% Rec	7066	1/24/04	14:20
VOA Surr Toluene-d8	101.	% Rec	9698	1/25/04	8:58
VOA Surr, 4-BFB	105.	% Rec	7062	1/24/04	8:12
VOA Surr, 4-BFB	107.	% Rec	7066	1/24/04	14:20
VOA Surr, 4-BFB	104.	% Rec	9698	1/25/04	8:58
VOA Surr, DBFM	102.	% Rec	7062	1/24/04	8:12
VOA Surr, DBFM	103.	% Rec	7066	1/24/04	14:20
VOA Surr, DBFM	104.	% Rec	9698	1/25/04	8:58

- Value outside Laboratory historical or method prescribed QC limits.

End of Report for Project 361763

Nashville Division

COOLER RECEIPT FORM

BC#



Client: ERI

Cooler Received On: 1/23/04 And Opened On: 1/23/04 By: James Jacobs

(Signature)

1. Temperature of Cooler when opened 2.6 Degrees Celsius
2. Were custody seals on outside of cooler?.....YES...NO...NA
 - a. If yes, how many, what kind and where: 1 Tape Fast
3. Were custody seals on containers and intact?.....NO...YES...NA
4. Were the seals intact, signed, and dated correctly?.....YES...NO...NA
5. Were custody papers inside cooler?.....YES...NO...NA
6. Were custody papers properly filled out (ink,signed,etc)?.....YES...NO...NA
7. Did you sign the custody papers in the appropriate place?.....YES...NO...NA
8. What kind of packing material used? Bubblewrap Peanuts Vermiculite Other None
9. Cooling process: Ice Ice pack Ice(direct contact) Dry ice Other None
10. Did all containers arrive in good condition(unbroken)?.....YES...NO...NA
11. Were all container labels complete (#,date,signed,pres,etc)?.....YES...NO...NA
12. Did all container labels and tags agree with custody papers?.....YES...NO...NA
13. Were correct containers used for the analysis requested?.....YES...NO...NA
14. a. Were VOA vials received?.....YES...NO...NA
 - b. Was there any observable head space present in any VOA vial?.....NO...YES...NA
15. Was sufficient amount of sample sent in each container?.....YES...NO...NA
16. Were correct preservatives used?.....YES...NO...NA
If not, record standard ID of preservative used here _____

17. Was residual chlorine present?.....NO...YES..NA

18. See attached for resolution of non-conformance:

- | | | | | | | |
|---|---------------------------|--------------------------------|--------------------------------|-----------------------------|----------------------------------|-----------------------------|
| <input checked="" type="radio"/> Fed-Ex | <input type="radio"/> UPS | <input type="radio"/> Velocity | <input type="radio"/> Airborne | <input type="radio"/> Route | <input type="radio"/> Off-street | <input type="radio"/> Misc. |
|---|---------------------------|--------------------------------|--------------------------------|-----------------------------|----------------------------------|-----------------------------|

TestAmerica
INCORPORATED
361763

(615) 726-0177

Nashville Division

2960 Foster Creighton

Nashville, TN 37204

ExxonMobil

Consultant Name: Environmental Resolutions, Inc.

Address: 73 Digital Drive, Suite 100

City/State/Zip: Novato, California 94949

Project Manager Rob Saur

Telephone Number: (415) 382-3591

ERI Job Number: 243113X

Sampler Name: (Print) David Maddan

Sampler Signature: [Signature]

ExxonMobil Engineer Gene N. Ortega

Telephone Number (925) 246-8747

Account #: 3876

PO #: 4504239075

Facility ID # 7-3567

Global ID# T0600191822

Site Address 3192 Santa Rita Road

City, State Zip Pleasanton, California, 94566

TAT	PROVIDE:	Special Instructions:						Matrix			Analyze For:									
								Water	Soil	Vapor	TPHd 8015	TPHg 8015	BTEX 8021B	MTBE 8021B	confirm mtbe 8260	Oxygenates 8260	VOCs 8260	Total Lead 6010	HVOCs 801	Lead Scavengers
<input type="checkbox"/> 24 hour	<input type="checkbox"/> 72 hour	Please use Silica gel clean-up on the TPHd samples. Oxygenates (MTBE, TAME, ETBE, DIPE, & TBA) using 8260 Lead Scavengers (1,2 DCA and EDB) using 8260																		
<input type="checkbox"/> 48 hour	<input type="checkbox"/> 96 hour																			
<input checked="" type="checkbox"/> 8 day	EDF Report		DATE	TIME	COMP	GRAB	PRESERV	NUMBER												
	FAX Results		MW1	9696	1/21/2004	1430		X	HCL	6/2	X			X	X	X	X	X		X
			MW2	9697	1/21/2004	1355		X	HCL	6/2	X			X	X	X	X	X		X
			MW3	9698	1/21/2004	1450		X	HCL	6/2	X			X	X	X	X	X		X
			MW4	9699	1/21/2004	1410		X	HCL	6/2	X			X	X	X	X	X		X
			MW5	9700	1/21/2004	1405		X	HCL	6/2	X			X	X	X	X	X		X
			MW6	9701	1/21/2004	1345		X	HCL	6/2	X			X	X	X	X	X		X
			MW7	9702	1/21/2004	1420		X	HCL	6/2	X			X	X	X	X	X		X
			MW8		1/21/2004			X	HCL	6/2	X			X	X	X	X	X		X
			BB	9703	1/21/2004	1500		X	HCL	2/1-6/2	X			H	O	L	D			

Relinquished by: [Signature] Date: 1-22-04 Time: 800 am

Received by: _____ Time: _____

Received by TestAmerica: [Signature] Date: 1/23/04 Time: 805

Laboratory Comments:

Temperature Upon Receipt: 2.6°C

Sample Containers Intact? Yes

VOAs Free of Headspace? Yes

361007

CHAIN OF CUSTODY RECORD



615) 726-0177

lansville Division

960 Foster Creighton

lansville, TN 37204



Consultant Name: Environmental Resolutions, Inc.

Address: 73 Digital Drive, Suite 100

City/State/Zip: Novato, California 94949

Project Manager: Rob Saur

Telephone Number: (415) 382-3591

ERI Job Number: 222913X

Sampler Name: (Print) David Maddan

Sampler Signature: *David A. Maddan*

ExxonMobil Engineer Gene Ortega

Telephone Number (925) 246-8747

Account #: 3876

PO #: 4504239052

Facility ID #: 70235

Global ID#: T0600101354

Site Address 2225 Telegraph Avenue

City, State Zip Oakland, California

Shipping Method: Lab Courier Hand Deliver Commercial Express Other:

AT
 24 hour 72 hour
 48 hour 96 hour
 8 day

PROVIDE:
 EDF Report
 FAX Results

Special Instructions:
Hold analyses on sample "QCBB". Analyze oxygenates and lead scavengers by 8260B (include MTBE, ETBE, TAME, DIPE, TBA, ethanol, EDB, and EDC).

Sample ID / Description	DATE	TIME	COMP	GRAB	PRESERV	NUMBER	Matrix			Analyze For:								
							Water	Soil	Vapor	TPHd 8015B	TPHg 8015B	BTEX 8021B	MTBE 8021B	Confirm MTBE 8260B	Oxygenates 8260B	Lead Scavengers 8260B	TPH motor oil 8015B	
QCBB	1-14-04	1500			HCL	2 VOAs	X			H	O	L	D					
MW6B		1532			HCL	8 VOAs/ 2 AMBs	X			X	X	X		X	X	X		65 25
MW6E		1438			HCL	8 VOAs/ 2 AMBs	X			X	X	X		X	X	X		26
MW6F		1422			HCL	8 VOAs/ 2 AMBs	X			X	X	X		X	X	X		27
MW6G		1503			HCL	8 VOAs/ 2 AMBs	X			X	X	X		X	X	X		28
MW6H		1626			HCL	8 VOAs/ 2 AMBs	X			X	X	X		X	X	X		29
MW6J		1102			HCL	8 VOAs/ 2 AMBs	X			X	X	X		X	X	X		30
RW1		1618			HCL	8 VOAs/ 2 AMBs	X			X	X	X		X	X	X		31
RW2		1602			HCL	8 VOAs/ 2 AMBs	X			X	X	X		X	X	X		32
RW3A		1548			HCL	8 VOAs/ 2 AMBs	X			X	X	X		X	X	X		33
MW6I		1518			HCL	8 VOA 2 AMB	X			X	X	X		X	X	X		65 34

Relinquished by: *David A. Maddan* Date: 1-15-04 Time: 900am Received by: _____ Time: _____
 Relinquished by: _____ Date: _____ Time: _____ Received by TestAmerica: *MWB* 11604 Time: 0210

Laboratory Comments:
 Temperature Upon Receipt: 28c
 Sample Containers Intact? yes
 VOAs Free of Headspace? yes