



ENVIRONMENTAL HEALTH SERVICES
ENVIRONMENTAL PROTECTION
1131 Harbor Bay Parkway, Suite 250
Alameda, CA 94502-6577
(510) 567-6700
FAX (510) 337-9335

**PUBLIC NOTIFICATION OF POTENTIAL CASE CLOSURE
VALERO#3827
March 23, 2010**

**Site Location: 3192 Santa Rita Road, Pleasanton, CA 94566
Fuel Leak Case RO0002426 and Geotracker Global ID T0600100539**

Summary – This fact sheet has been prepared to inform community members and other interested parties of potential case closure for a fuel leak case at 3192 Santa Rita Road in Pleasanton, California (see attached map on back). Site investigation and cleanup activities have been completed and it does not appear that the fuel release presents a risk to human health based upon current and projected future land use. Case closure will be granted for commercial land use only. Site investigation activities, which have been conducted at various times since 1998, have defined the extent of petroleum hydrocarbons in soil and groundwater beneath the site. Groundwater monitoring has been conducted since November 1998 using 14 groundwater monitoring wells at the site. The groundwater monitoring data indicate that the concentrations of petroleum hydrocarbons in groundwater have decreased since 1998 and that water quality is expected to be restored to water quality objectives through natural attenuation processes within a reasonable period of time. During the most recent groundwater sampling event in August 2009, the maximum concentration of methyl tert-butyl ether (MTBE) detected in groundwater beneath the site was 15 micrograms per liter (parts per billion). Groundwater contamination from the site is not expected to affect the nearest water supply well which is located approximately 1,000 feet south of the site.

Background – The site, which is located at the corner of Santa Rita Road and Las Positas Boulevard in Pleasanton, California (see attached map on back), has operated as a gasoline service station since 1969. A release of gasoline from the fueling system was discovered during tank removal operations in 1988. Following excavation of contaminated soils in 1988, four new tanks were installed. Fuel system components consisting of the dispensers and product piping were also removed and replaced in August 2002. Site investigation activities consisting of monitoring well installation and soil and groundwater sampling were conducted at the site at various times between 1998 and 2009.

Next Step – The public is invited to review and comment on the potential closure of the fuel leak case. The entire case file can be viewed over the Internet on the ACEH website (<http://www.acgov.org/aceh/lop/ust.htm>) or the State of California Water Resources Control Board Geotracker website (<http://geotracker.swrcb.ca.gov>). Please send written comments to Jerry Wickham at the address below; all comments will be forwarded to the responsible parties. **Comments received by April 29, 2010** will be considered and responded to prior to a final determination on the proposed case closure.

Additional information: Contact Jerry Wickham of the Alameda County Department of Environmental Health, 1131 Harbor Bay Parkway, Alameda, CA 94502 at 510-567-6791 or by email at jerry.wickham@acgov.org

LEGEND

- ⊕ Groundwater monitoring well
- ⊕ Tank pit well
- ⊙ Direct-push soil boring
- TPH-g Total Petroleum Hydrocarbons as gasoline
- TPH-d Total Petroleum Hydrocarbons as diesel
- MTBE Methyl tertiary butyl ether
- TBA Tertiary butyl ether

Benzene	<0.50
Toluene	<0.50
Ethylbenzene	<0.50
Xylenes	<1.0
TPH-g	<50
TPH-d	<50
MTBE	0.17
TBA	<10

Benzene	<0.50
Toluene	<0.50
Ethylbenzene	<0.50
Xylenes	<1.0
TPH-g	<50
TPH-d	<50
MTBE	0.21
TBA	<10

Notes: Analytical results in micrograms per liter (ug/L).

Benzene	<0.50
Toluene	<0.50
Ethylbenzene	<0.50
Xylenes	<1.0
TPH-g	<50
TPH-d	<50
MTBE	0.36
TBA	<10

Benzene	<0.50
Toluene	0.21
Ethylbenzene	0.31
Xylenes	1.0
TPH-g	<50
TPH-d	<50
MTBE	0.17
TBA	<10

Benzene	<0.50
Toluene	<0.50
Ethylbenzene	<0.50
Xylenes	0.33
TPH-g	<50
TPH-d	<50
MTBE	0.073
TBA	<10

Benzene	<0.50
Toluene	<0.50
Ethylbenzene	<0.50
Xylenes	<1.0
TPH-g	<50
TPH-d	<50
MTBE	15
TBA	<10

Benzene	<0.50
Toluene	0.20
Ethylbenzene	0.34
Xylenes	1.0
TPH-g	<50
TPH-d	<50
MTBE	0.14
TBA	<10

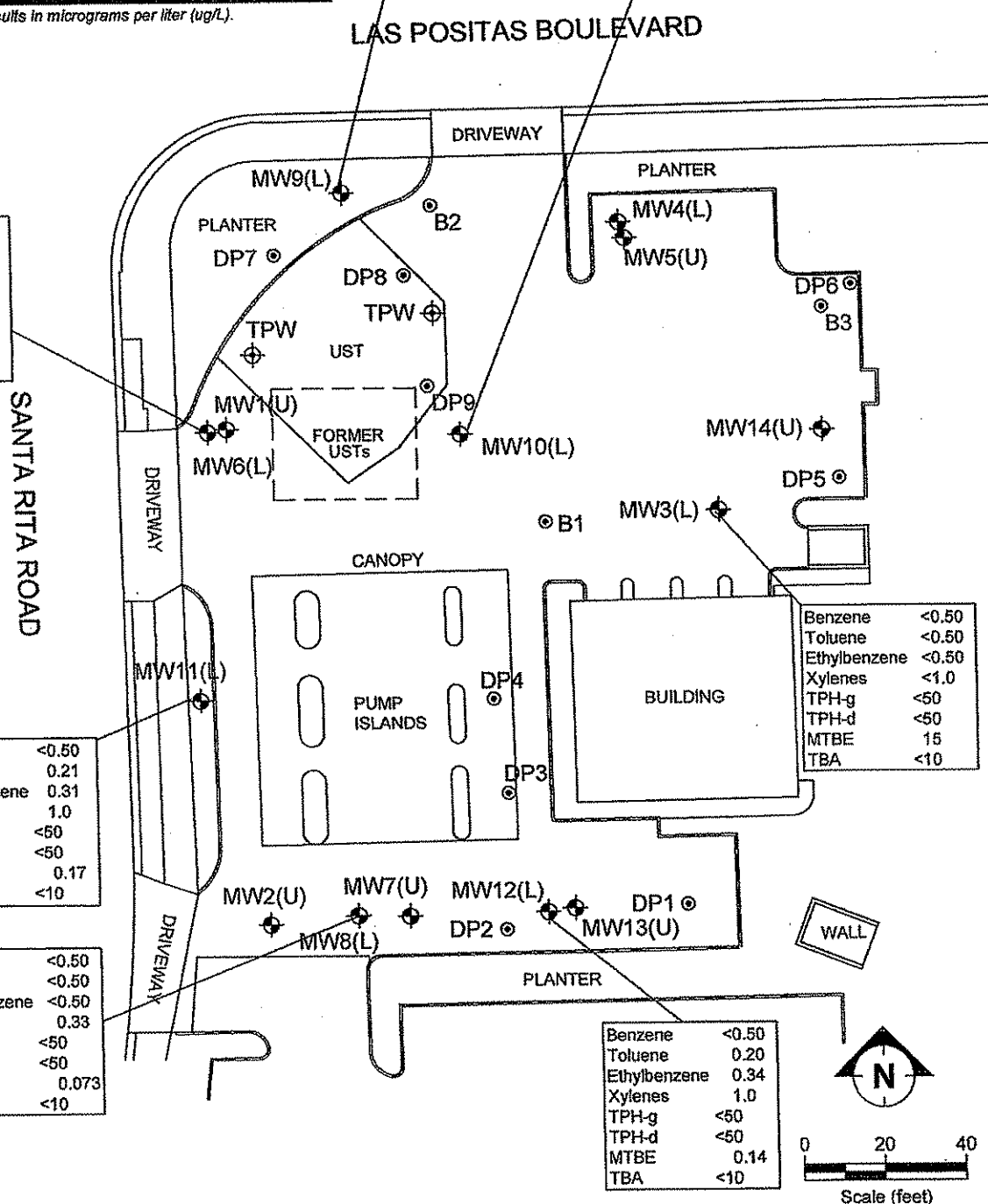

FILENAME: 3-2009.DWG 08/21/09



SITE MAP SHOWING ANALYTICAL DATA FOR LOWER WATER-BEARING ZONE
 FORMER EXXON RS 73587
 3192 SANTA RITA ROAD, PLEASANTON, CALIFORNIA
 10 AUGUST 2009

FIGURE:
4

CITY OF PLEASANTON
Parcel #: 946-1109-56
123 MAIN ST
PLEASANTON CA 94566

COMMON AREA OF TRACT
Parcel #: 946-3201-103
3146 PAWNEE WAY
PLEASANTON CA 94588

GUERRERO SUSAN
Parcel #: 946-1109-61
4337 W LAS POSITAS BLVD
PLEASANTON CA 94588

HE LIPING
Parcel #: 946-1109-60
4321 W LAS POSITAS BLVD
PLEASANTON CA 94588

MHCB (USA_LEASING &
Parcel #: 946-1105-38-4
P.O. BOX 690110
SAN ANTONIO TX 78269

PLEASANTON MEADOWS
Parcel #: 946-1109-73
4463 FAIRLANDS DR
PLEASANTON CA 94588

RESIDENT
Parcel #: 946-1105-39
3180 SANTA RITA RD
PLEASANTON CA 94566

RESIDENT
Parcel #: 946-1105-38-4
3192 SANTA RITA RD
PLEASANTON CA 94566

RESIDENT
Parcel #: 946-1105-41
3160 SANTA RITA RD
PLEASANTON CA 94566

RESIDENT
Parcel #: 946-1105-42
3170 SANTA RITA RD
PLEASANTON CA 94566

RESIDENT
Parcel #: 946-3201-103
APACHE CT
PLEASANTON CA 94566

RESIDENT
Parcel #: 946-1109-56
3200 SANTA RITA RD
PLEASANTON CA 94566

RESIDENT
Parcel #: 946-1105-43-1
3150 SANTA RITA RD
PLEASANTON CA 94566

ROSENTHAL HARVEY &
Parcel #: 946-1105-41
101 ELLINWOOD DR
PLEASANT HILL CA 94523

SANTA RITA SQUARE I LLC
Parcel #: 946-1105-39
101 ELLINWOOD DR
PLEASANT HILL CA 94523

~~SANTA RITA SQUARE I LLC
Parcel #: 946-1105-42
101 ELLINWOOD DR
PLEASANT HILL CA 94523~~

~~SANTA RITA SQUARE I LLC
Parcel #: 946-1105-43-1
101 ELLINWOOD DR
PLEASANT HILL CA 94523~~

SILVA MELISSA K
Parcel #: 946-1109-62
4353 W LAS POSITAS BLVD
PLEASANTON CA 94588