



Pleasanton • Gilroy • Stockton • Sacramento

151 Wyoming Street • Pleasanton, CA 94566-6277
(925) 846-1833 • FAX (925) 846-2243
License 286411

July 25, 2012

Alameda County Environmental Health
1131 Harbor Bay Parkway, Suite 250
Alameda, CA 94502-6577

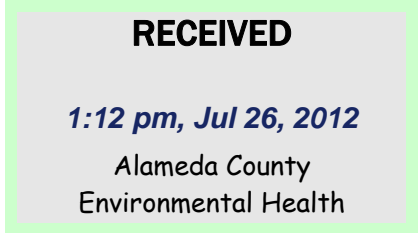

**Subject: Can-Am Plumbing
151 Wyoming Street
Pleasanton, California.**

I have reviewed the attached Well Destruction Report dated July 25, 2012.

The information in this report is accurate to the best of my knowledge. This report was prepared by Gettler-Ryan Inc. I relied upon their expertise, assistance and advice.

I declare under penalty of perjury that the foregoing is true and correct.

Sincerely,

CAN-AM PLUMBING INC.

Martin O'Gara
Chief Financial Officer



July 25, 2012

Mr. Jerry Wickham
Alameda County Environmental Health
1131 Harbor Bay Parkway, Suite 250
Alameda, California 94502-6577

Subject: Well Destruction at Can-Am Plumbing, 151 Wyoming Street, Pleasanton, California.

Mr. Wickham:

At the request of Can-Am Plumbing Inc., Gettler-Ryan Inc. (GR) supervised the destruction of ten groundwater monitoring wells, seven piezometers and one excavation backfill well at the above referenced site (Figure 1). The work was requested by Alameda County Environmental Health (ACEH) in a letter to Can-Am Plumbing Inc. dated April 25, 2012. The monitoring wells were destroyed as required by the California Department of Water Resources' (DWR) *California Well Standards* (Bulletins 74-81 and 74-90) and Zone 7 Water Agency requirements. The excavation backfill well was destroyed by a method approved by the Zone 7 Water Agency prior to the field work.

Well Permits

Well destruction activities were conducted under Drilling Permit number 2012067, issued on July 9, 2012 by the Zone 7 Water Agency and Encroachment Permit number E12-0378, issued July 10, 2012 by the City of Pleasanton Engineering Department. Copies of the permits are attached to this report. The permitting agencies were notified of the well destruction dates prior to the field work. Locations of the former wells and piezometers are shown on the Extended Site Plan (Figure 2) and the Site Plan (Figure 3).

Well Destruction

On July 12 and 13, 2012, a GR geologist observed Gregg Drilling and Testing Incorporated (C-57 #485165) destroy ten groundwater monitoring wells (MW-1, MW-1A, MW-2, MW-2A, MW-3, MW-3A, and MW-4 through MW-7), seven piezometers (PZ-1 through PZ-7), and excavation backfill well W-1.

The monitoring wells and piezometers were destroyed by in-situ pressure grouting. Neat cement grout was pumped into the well casings from the bottom to the top. In wells MW-1 and MW-2 the grout was placed through one-inch diameter tremie pipes as significant quantities of groundwater were present only in these wells. Once filled, additional grout was added and pressure was applied at the surface to further place the grout in the filter pack and casing per the Drilling Permit requirements (attached).. After applying pressure, additional grout was added and allowed to spill over the tops of the casings.

Excavation backfill well W-1 consisted of a nine foot long casing installed within the gravel backfill of the former underground storage tank excavation at the site. W-1 was sealed with hydrated bentonite chips to within one foot below ground surface as agreed to by the Zone 7 Water Agency.

948162.09

After grouting and sealing activities were completed, the flush-mounted well covers were removed from all wells and the excavations were finished to surface grade with concrete, except for piezometer PZ-5 and monitoring well MW-5, which were covered by soil in the landscaped areas. Wells MW-6 and MW-7 were finished with high-strength rapid-set concrete per City of Pleasanton Requirements.

If you have any questions regarding this report please contact us at (925) 551-7555.

Sincerely,
Gettler-Ryan Inc.

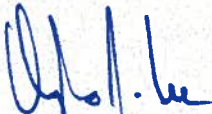

Douglas J. Lee
Senior Geologist
P.G. No. 6882

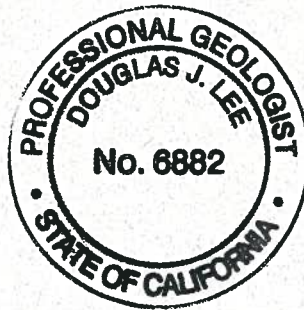

Attachments: Figure 1 – Vicinity Map
 Figure 2 – Extended Site Plan
 Figure 3 - Site Plan
 Well Details
 Drilling Permit
 Encroachment Permit

cc: Mr. Marty O’Gara – Can-Am Plumbing Inc.

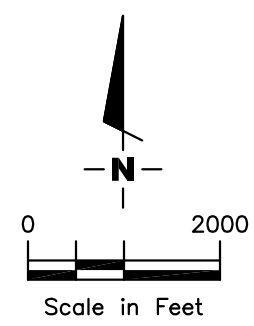
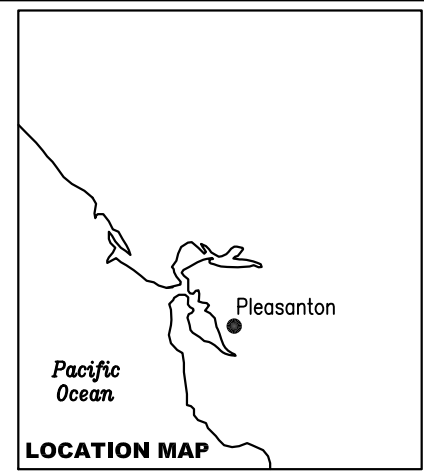
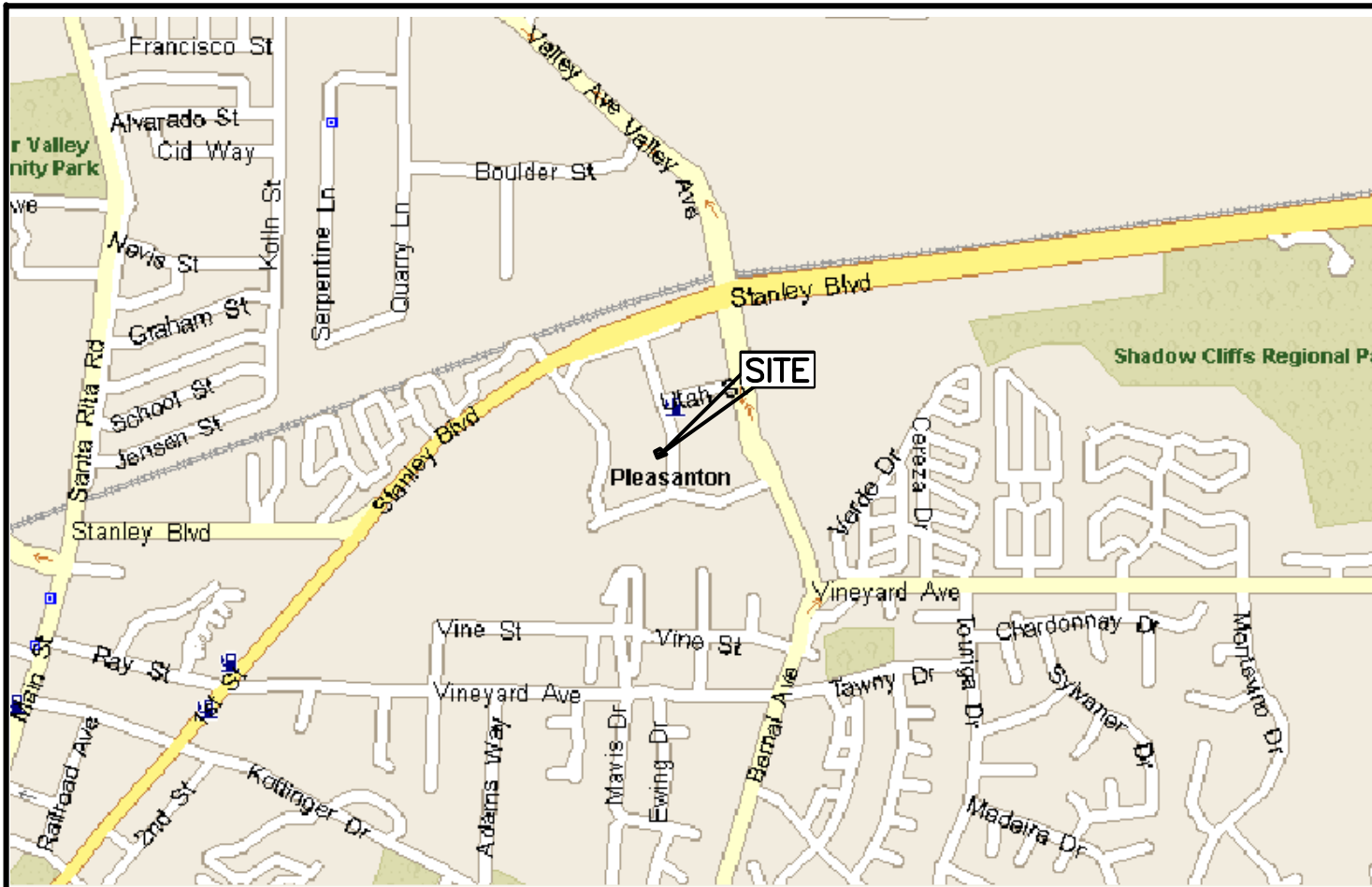

Source: Microsoft Streets 2005

GETTLER - RYAN INC.
 6747 Sierra Court, Suite J
 Dublin, CA 94568 (925) 551-7555

VICINITY MAP
 Can-Am Plumbing
 151 Wyoming Street
 Pleasanton, California

FIGURE
1

PROJECT NUMBER
 948162.04

REVIEWED BY

DATE
 01/06

REVISED DATE

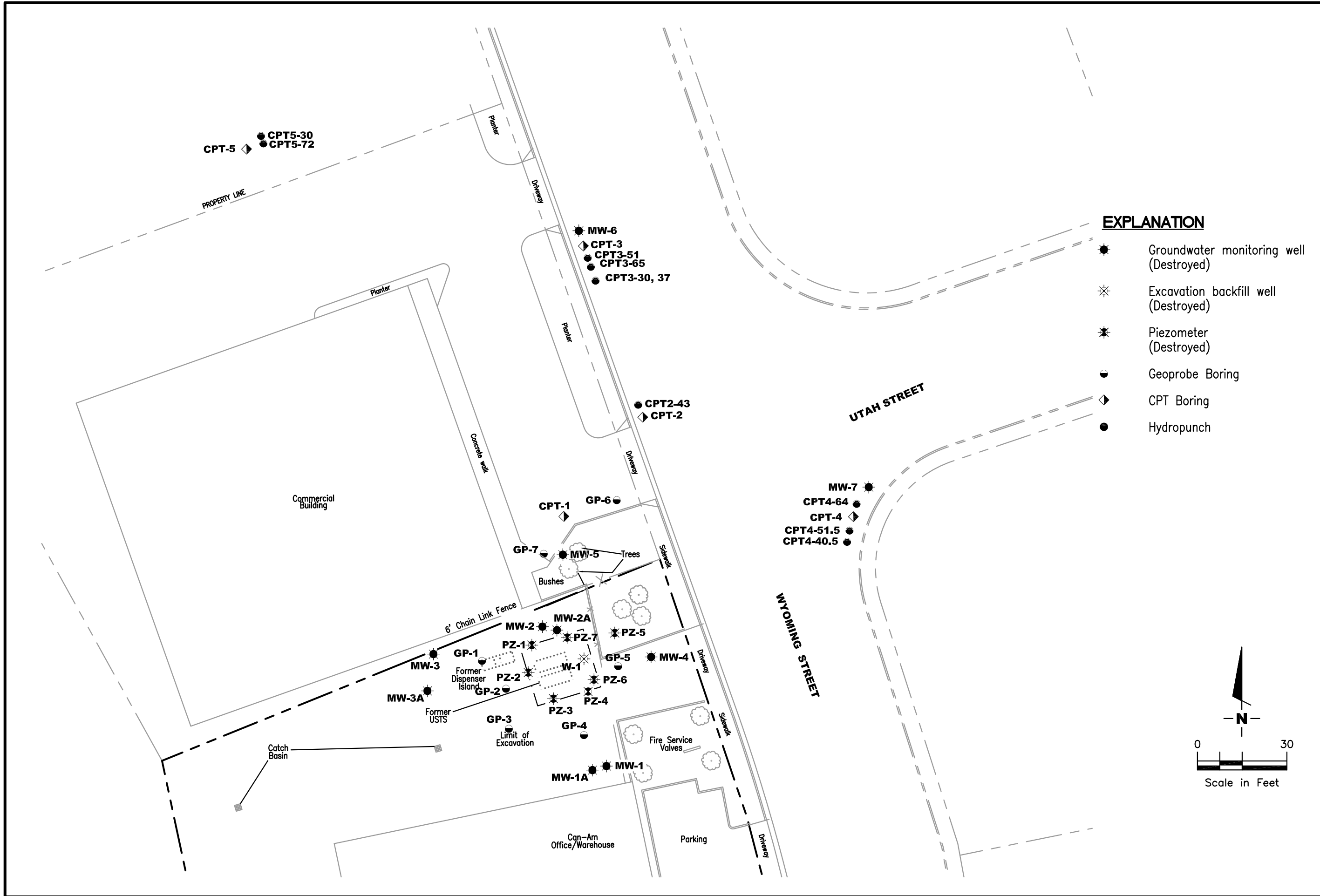

EXPLANATION

- ☼ Groundwater monitoring well (Destroyed)
- ☼ Excavation backfill well (Destroyed)
- ☼ Piezometer (Destroyed)
- Geoprobe Boring
- ◊ CPT Boring
- Hydropunch

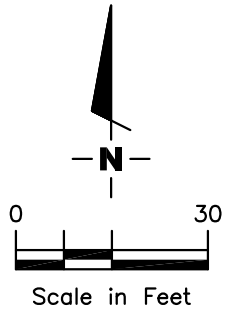

FIGURE 2

EXTENDED SITE PLAN
 Can-Am Plumbing
 151 Wyoming Street
 Pleasanton, California

GETTLER - RYAN INC.
 6747 Sierra Court, Suite J
 Dublin, CA 94568
 (925) 551-7555

PROJECT NUMBER: 9481629
 REVIEWED BY: [Signature]
 DATE: July 13, 2012
 REVISED DATE: [Blank]
 .../Environmental/CAD drawings/Can-Am Plumbing/VIC-Can-Am Plumbing 9-20-07.dwg/Ext.SitePlan09-07

EXPLANATION

- Groundwater monitoring well (Destroyed)
- ⊗ Excavation backfill well (Destroyed)
- ✱ Piezometer (Destroyed)

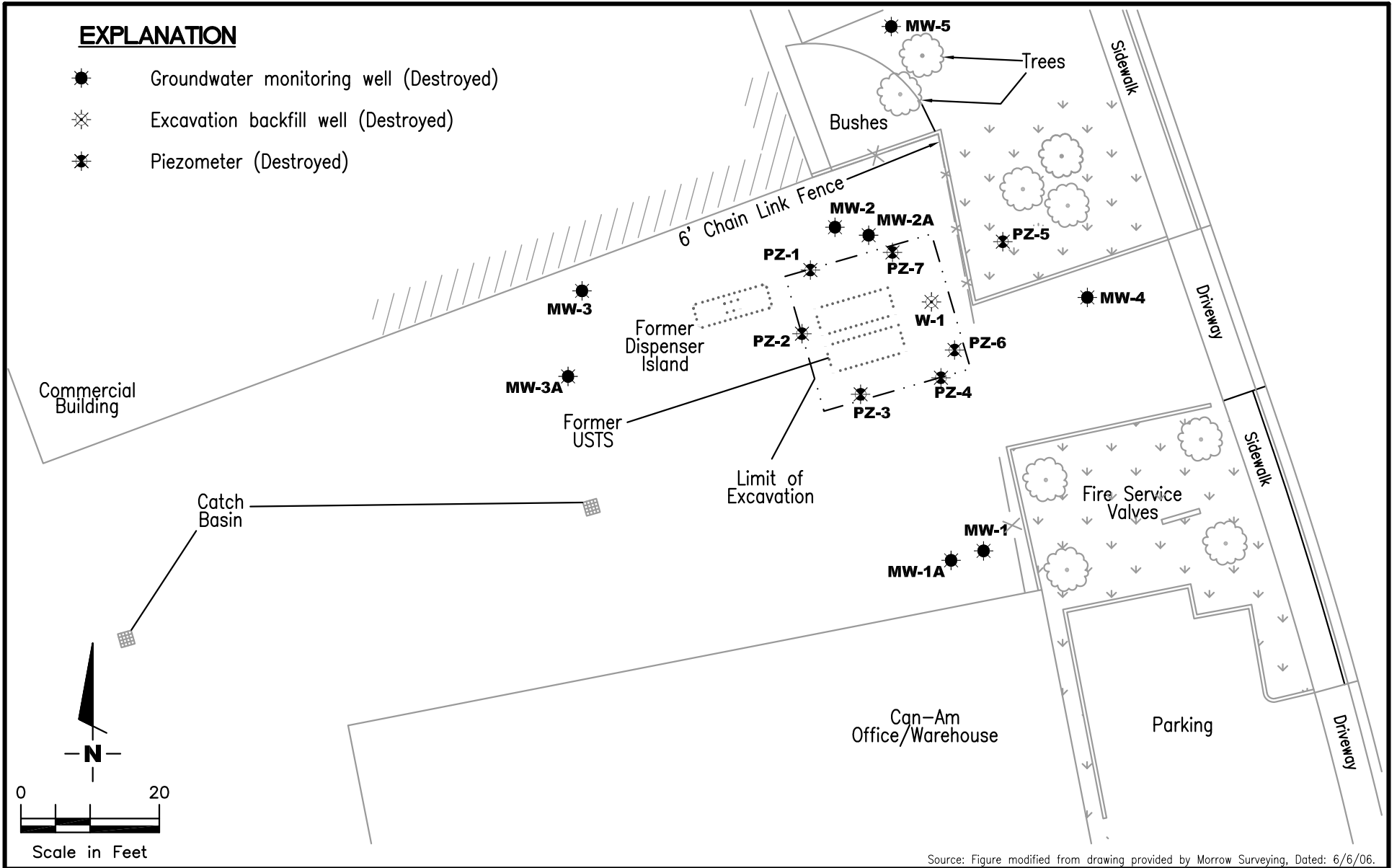

Source: Figure modified from drawing provided by Morrow Surveying, Dated: 6/6/06.

GETTLER - RYAN INC.
 6747 Sierra Court, Suite J
 Dublin, CA 94568 (925) 551-7555

SITE PLAN
 Can-Am Plumbing Inc.
 151 Wyoming Street
 Pleasanton, California

FIGURE

3

JOB NUMBER

REVIEWED BY

DATE

REVISED DATE

948162.9

July 13, 2012

WELL DETAILS
 Can-Am Plumbing
 151 Wyoming Street
 Pleasanton, California

WELL ID.	Total Depth (feet)	Boring Diameter (inches)	Casing Diameter (inches)	Scr. Interval (feet)	Seal Interval (feet)
MW-1	32	8	2	12-32	0-9
MW-2	32	8	2	12-32	0-8
MW-3	25	8	2	15-25	0-11
MW-1A	50	8	2	40-50	0-36
MW-2A	50	8	2	40-50	0-37
MW-3A	50	8	2	40-50	0-36
MW-4	53.5	8	2	46-53.5	0-42
MW-5	52	8	2	46-52	0-42
MW-6	50	8	2	44-50	0-40
MW-7	51	8	2	46-51	0-42
PZ-1	10	7	0.75	5-10	0-3
PZ-2	10	7	0.75	5-10	0-3
PZ-3	10	7	0.75	5-10	0-3
PZ-4	10	7	0.75	5-10	0-3
PZ-5	10	7	0.75	5-10	0-3
PZ-6	10	7	0.75	5-10	0-3
PZ-7	10	7	0.75	5-10	0-3
W-1	9	N/A	4	0-9	None



ZONE 7 WATER AGENCY

100 NORTH CANYONS PARKWAY, LIVERMORE, CALIFORNIA 94551 VOICE (925) 454-5000 FAX (925) 245-9306
E-MAIL whong@zone7water.com

DRILLING PERMIT APPLICATION

FOR APPLICANT TO COMPLETE

FOR OFFICE USE

LOCATION OF PROJECT 151 UNCOMING STREET
PLEASANTON, CA

PERMIT NUMBER 2012067
WELL NUMBER 3S/1E-15N2, 3S/1E-15N4 to 15N19
APN 946-4542-005-01

Coordinates Source _____ ft Accuracy/V _____ ft
LAT: 37° 66' 7.800" - 57° 40' 0.000" N LONG: 122° 51' 23.900" W
APN 946-4542-005-01

PERMIT CONDITIONS (Circled Permit Requirements Apply)

CLIENT
Name CAN-AM PLUMBING INC.
Address 151 UNCOMING STREET Phone (925) 846-7833
City PLEASANTON, CA Zip 94566

- A. GENERAL**
1. A permit application should be submitted so as to arrive at the Zone 7 office five days prior to your proposed starting date.
 2. Submit to Zone 7 within 60 days after completion of permitted work the original **Department of Water Resources Water Well Drillers Report (DWR Form 188), signed by the driller.**
 3. Permit is void if project not begun within 90 days of approval date.
 4. **Notify Zone 7 at least 24 hours before the start of work.**

APPLICANT
Name DEYLER-RYAN INC.
Email dlee@grinc.com Fax (925) 881-7889
Address 6747 HEARST CT, SUITE 3 Phone (925) 881-7885
City DUBLIN, CA Zip 94568

- B. WATER SUPPLY WELLS**
1. Minimum surface seal diameter is four inches greater than the well casing diameter.
 2. Minimum seal depth is 50 feet for municipal and industrial wells or 20 feet for domestic and irrigation wells unless a lesser depth is specially approved.
 3. Grout placed by tremie.
 4. An access port at least 0.5 inches in diameter is required on the wellhead for water level measurements.
 5. A sample port is required on the discharge pipe near the wellhead.

TYPE OF PROJECT:
Well Construction Geotechnical Investigation _____
Well Destruction Contamination Investigation _____
Cathodic Protection _____ Other _____

- C. GROUNDWATER MONITORING WELLS INCLUDING PIEZOMETERS**
1. Minimum surface seal diameter is four inches greater than the well or piezometer casing diameter.
 2. Minimum seal depth for monitoring wells is the maximum depth practicable or 20 feet.
 3. Grout placed by tremie.

PROPOSED WELL USE:
Domestic _____ Irrigation _____
Municipal _____ Remediation _____
Industrial _____ Groundwater Monitoring _____
Dewatering _____ Other _____

- D. GEOTECHNICAL.** Backfill bore hole with compacted cuttings or heavy bentonite and upper two feet with compacted material. In areas of known or suspected contamination, tremied cement grout shall be used in place of compacted cuttings.

DRILLING METHOD:
Mud Rotary _____ Air Rotary _____ Hollow Stem Auger _____
Cable Tool _____ Direct Push Other PRESSURE GROUT

- E. CATHODIC.** Fill hole above anode zone with concrete placed by tremie.

DRILLING COMPANY GREED DRILLING & TESTING INC.
950 HUME ROAD, MARTINEZ, CA 94553
DRILLER'S LICENSE NO. 485165

- F. WELL DESTRUCTION.** See attached.

WELL SPECIFICATIONS: PLEASE SEE ATTACHED TABLE
Drill Hole Diameter _____ in. Maximum _____
Casing Diameter _____ in. Depth _____ ft.
Surface Seal Depth _____ ft. Number 17

- G. SPECIAL CONDITIONS.** Submit to Zone 7 within 60 days after completion of permitted work the well installation report **including all soil and water laboratory analysis results.**

SOIL BORINGS:
Number of Borings _____ Maximum _____
Hole Diameter _____ in. Depth _____ ft.

Approved Wyman Hong Date 7/9/12

ESTIMATED STARTING DATE 7-12-12
ESTIMATED COMPLETION DATE 7-13-12

I hereby agree to comply with all requirements of this permit and Alameda County Ordinance No. 7-88.

APPLICANT'S SIGNATURE [Signature] Date 7-2-12

ATTACH SITE PLAN OR SKETCH

July 9, 2012

**Zone 7
Water Resources Engineering
Groundwater Protection Ordinance**

**Can-Am Plumbing
151 Wyoming Street
Pleasanton**

**Wells 3S/1E-15N2 (MW-1), 3S/1E-15N4 to 15N19 (MW-2, MW-3, MW-1A to MW-3A, MW-4 to MW-7 & PZ-1 to PZ-7)
Permit 2012067**

Destruction Requirements:

1. Remove from the well any pump, appurtenances, debris, or other materials.
2. Sound the well as deeply as practicable and record for your report.
3. Fill casing with neat cement or cement grout sealing material to two feet below the finished grade and pressurize to 25 psi and maintain for 5 minutes, forcing the sealing material through the existing perforations and into the surrounding formation.
4. Release the pressure and refill the empty portion of the casing with grouting material allowing it to spill over the top of the casing to form a cap.
5. Cut and remove any casing(s) to two feet below the finished grade or original ground, whichever is the lower elevation (optional).
6. After seal has set, backfill the remaining hole with compacted material.

EXPLANATION

- ◆ Groundwater monitoring well
- ⊕ Existing tank backfill casing
- ⊗ Piezometer

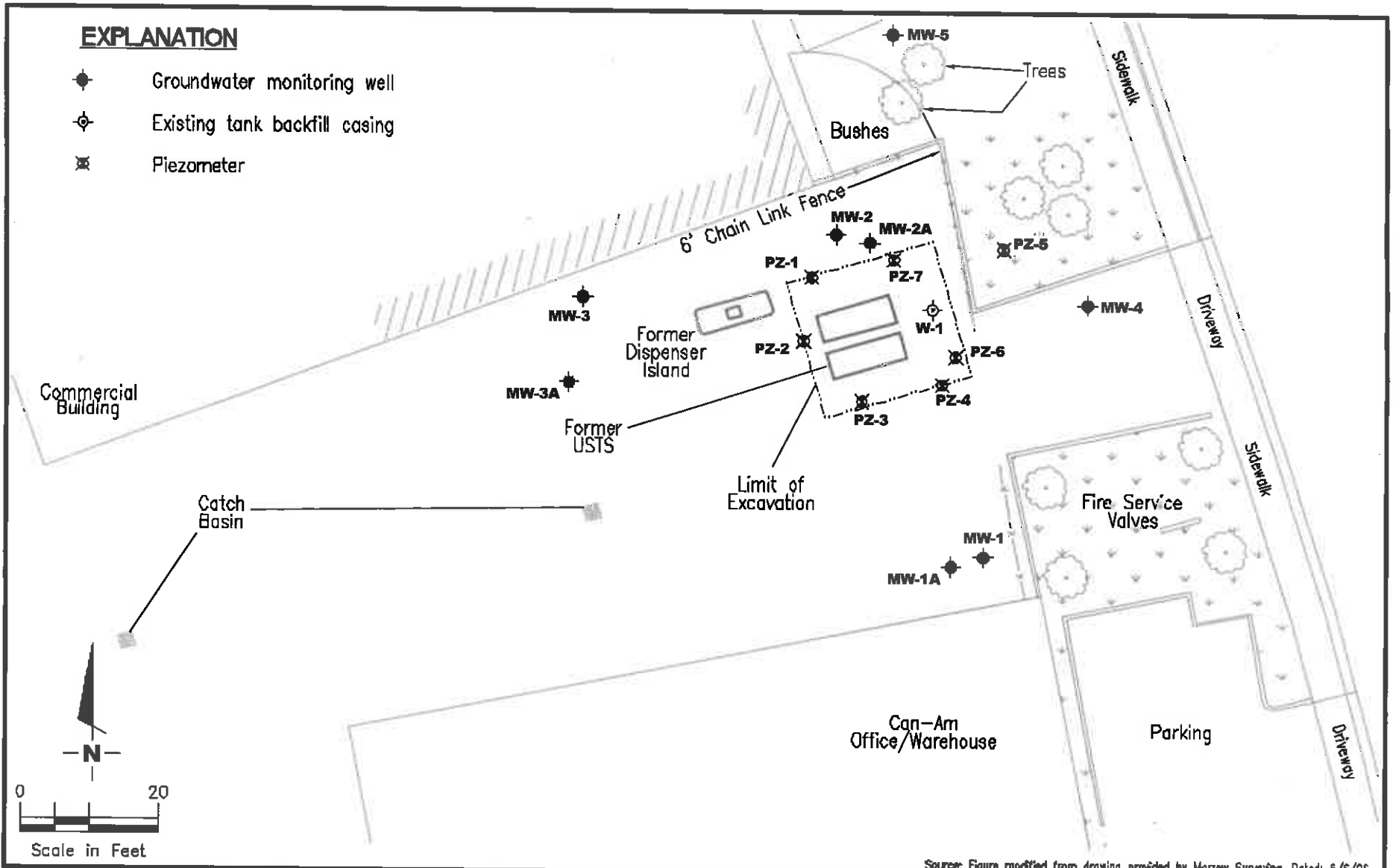

Source: Figure modified from drawing provided by Marrow Surveying, Dated: 6/5/06.

GR GETTLER - RYAN INC.
 6747 Sierra Court, Suite J
 Dublin, CA 94568 (925) 551-7555

SITE PLAN
 Can-Am Plumbing Inc.
 151 Wyoming Street
 Pleasanton, California

FIGURE

1

JOB NUMBER
 948162.4

REVIEWED BY

DATE
 06/07

REVISED DATE

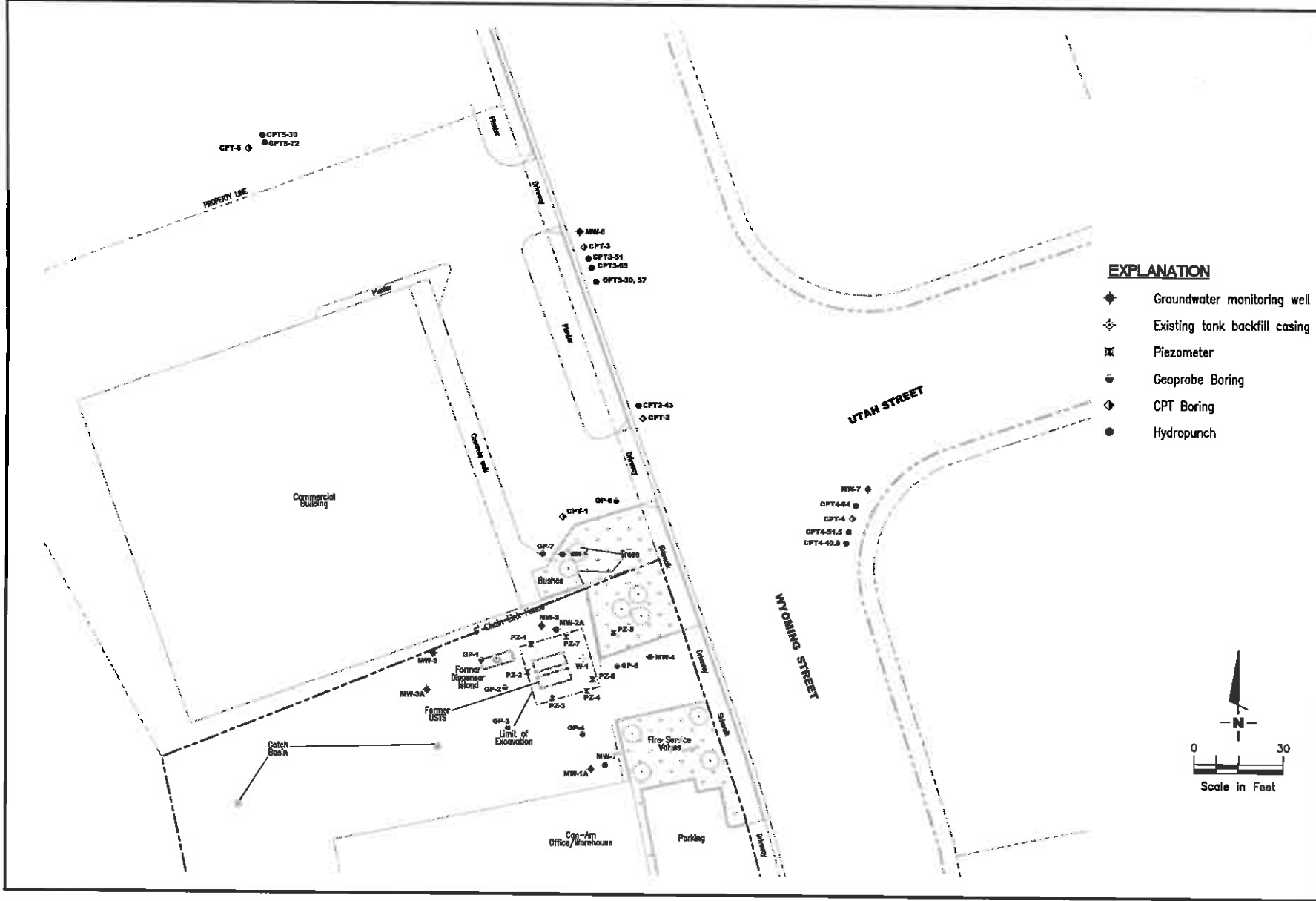

- EXPLANATION**
- ◆ Groundwater monitoring well
 - ⊕ Existing tank backfill casing
 - ⊗ Piezometer
 - Geoprobe Boring
 - ◊ CPT Boring
 - Hydropunch

WELL SPECIFICATIONS - CAN-AM PLUMBING

WELL ID.	Total Depth (feet)	Boring Diameter (inches)	Casing Diameter (inches)	Scr. Interval (feet)	Seal Interval (feet)
3S/IE-15N2 MW-1	32	8	2	12-32	0-9
3S/IE-15N4 MW-2	32	8	2	12-32	0-8
3S/IE-15N5 MW-3	25	8	2	15-25	0-11
3S/IE-15N6 MW-1A	50	8	2	40-50	0-36
3S/IE-15N7 MW-2A	50	8	2	40-50	0-37
3S/IE-15N8 MW-3A	50	8	2	40-50	0-36
3S/IE-15N16 MW-4	53.5	8	2	46-53.5	0-42
3S/IE-15N17 MW-5	52	8	2	46-52	0-42
3S/IE-15N18 MW-6	50	8	2	44-50	0-40
3S/IE-15N19 MW-7	51	8	2	46-51	0-42
3S/IE-15N9 PZ-1	10	7	0.75	5-10	0-3
3S/IE-15N10 PZ-2	10	7	0.75	5-10	0-3
3S/IE-15N11 PZ-3	10	7	0.75	5-10	0-3
3S/IE-15N12 PZ-4	10	7	0.75	5-10	0-3
3S/IE-15N13 PZ-5	10	7	0.75	5-10	0-3
3S/IE-15N14 PZ-6	10	7	0.75	5-10	0-3
3S/IE-15N15 PZ-7	10	7	0.75	5-10	0-3



ENCROACHMENT PERMIT

0

-Inspections must be requested 24 Hours prior to Starting Work-

Call (925) 931 - 5680

Project Address 151 WYOMING ST PLEASANTON, CA 94566	Parcel #	Permit # E12-0378	Applicant CAN-AM PLUMBING
--	-----------------	-----------------------------	-------------------------------------

Project: Permit for distruction of monitoring well

Owner	Contractor Gregg Drilling and testing License #: 485165 Expires: 1-31-13
--------------	---

Scope of Work
This permit is for the distruction of monitoring well. Attached approved traffic control plan.

Issuance Comments

Total Fees: \$115.00

Total Payments: \$115.00

All work to be performed to City of Pleasanton Standard Details and Specifications. This permit is issued pursuant to all provisions of the City of Pleasanton Municipal Code, Chapter 13.04, Encroachment.

Issued By: Jayasree Santhosh

Date of Issue: 7/10/2012

Applicant/Agent:

Building: (925) 931-5300 Planning: (925) 931-5600 Engineering: (925) 931-5650 Construction Insp.: (925) 931-5680