



GETTLER-RYAN INC.

FACSIMILE COVER SHEET

DATE: 2-9-00

TO: Scott Seery
AGENCY: ACHCSA, Environmental Health Services
FAX: (510) 337-9335

RE: Can-Am Plumbing, Pleasanton

FROM: Doug Lee

PHONE: (925) 551-7444 Ext. 123

FAX: (925) 551-7888

5 PAGES INCLUDING COVER

Attached are the preliminary results of our investigation at the subject site. The data indicates that impacted groundwater in the former UST pit is perched. ~~MW-2 is 15 feet~~
to 32 feet bgs. The behavior of the water encountered in MW-1 suggests perched water
in that well also. ~~Continued pumping at the UST backfill well will cause the water to rise~~
~~of the water table.~~ I will be in contact with you to discuss further action. If you have
any questions, please give me a call.

Call w/ Doug Lee 2/16/00:

- ① pump pit + resample
- ② destroy MW-1 approved
- ③ check for H₂O in MW-2 and sample if present

If there are any problems with this transmission, please call (925) 551-7555.

TABLE 1 - GROUNDWATER MONITORING AND CHEMICAL ANALYTICAL DATA

Can-Am Plumbing Inc.
151 Wyoming Street
Pleasanton, California

Sample No.	Sample Date	Total Well Depth (ft.)	Well Elevation ¹ (ft. MSL)	Depth to Water (ft.)	Floating Product (ft.)	Groundwater Elevation (ft. MSL)	TPHg (ppb)	Benzene (ppb)	Toluene (ppb)	Ethyl-benzene (ppb)	Xylenes (ppb)	MTBE (ppb)
W-1		9.35 ²	--	6.55 ²	0.00	--		<50	<50	110	630	
MW-1	1/31/00	31.63	--	28.19	0.00	--	<50	<0.50	<0.50	<0.50	<0.50	<2.5

EXPLANATION:

ft. = feet
ft. MSL = feet relative to Mean Sea Level.
ppm = parts per million

ANALYTICAL LABORATORY:

Sequoia Analytical (ELAP #1271)

ANALYTICAL DATA:

TPHg = Total Petroleum Hydrocarbons as gasoline according to EPA Method 8015 Modified
MTBE = Methyl tertiary butyl ether according to EPA Method 8020

¹ Well casing elevations have not been surveyed.
² Total well depth and depth to water are measured from top of well box

Table 2 - Soil Sample Analytical Results

Can-Am Plumbing Inc.
 151 Wyoming Street
 Pleasanton, California

Sample Location and ID	Date Collected	Sample Depth (feet)	TPHg (ppm)	Benzene (ppm)	Toluene (ppm)	Ethyl-Benzene (ppm)	Xylenes (ppm)	MtBE (ppm)
Well Boring MW-1								
MW-1-6	1/21/2000	6	ND	ND	ND	ND	ND	ND
MW-1-13.5	1/21/2000	13.5	ND	ND	ND	ND	ND	ND
MW-1-19	1/21/2000	19	ND	ND	ND	ND	ND	ND
MW-1-25	1/21/2000	25	ND	ND	ND	ND	ND	ND
Well Boring MW-2								
MW-2-6.5	1/21/2000	6.5	ND	ND	ND	ND	ND	3.6
MW-2-11	1/21/2000	11	ND	ND	ND	ND	ND	0.97
MW-2-15.5	1/21/2000	15.5	ND	ND	ND	ND	ND	0.12
MW-2-21	1/21/2000	21	ND	ND	ND	ND	ND	0.14
MW-2-26.5	1/21/2000	26.5	ND	ND	ND	ND	ND	0.12
MW-2-31	1/21/2000	31	ND	ND	ND	ND	ND	ND

EXPLANATION:

ppm = parts per million
 ppb = parts per billion
 ND = Not Detected
 -- = not applicable

ANALYTICAL METHODS:

TPHg = Total Petroleum Hydrocarbons as gasoline according to EPA Method 8015 Modified
 MtBE = Methyl tertiary butyl ether according to EPA Method 8020
 Lead = According to EPA Method 6010

ANALYTICAL LABORATORY:

Sequoia Analytical (ELAP #1271)

A GEOLOGIC CROSS-SECTION
 MW-1

1" = 10' ↕

U-1 (PROJECTED)

B
 MW-2

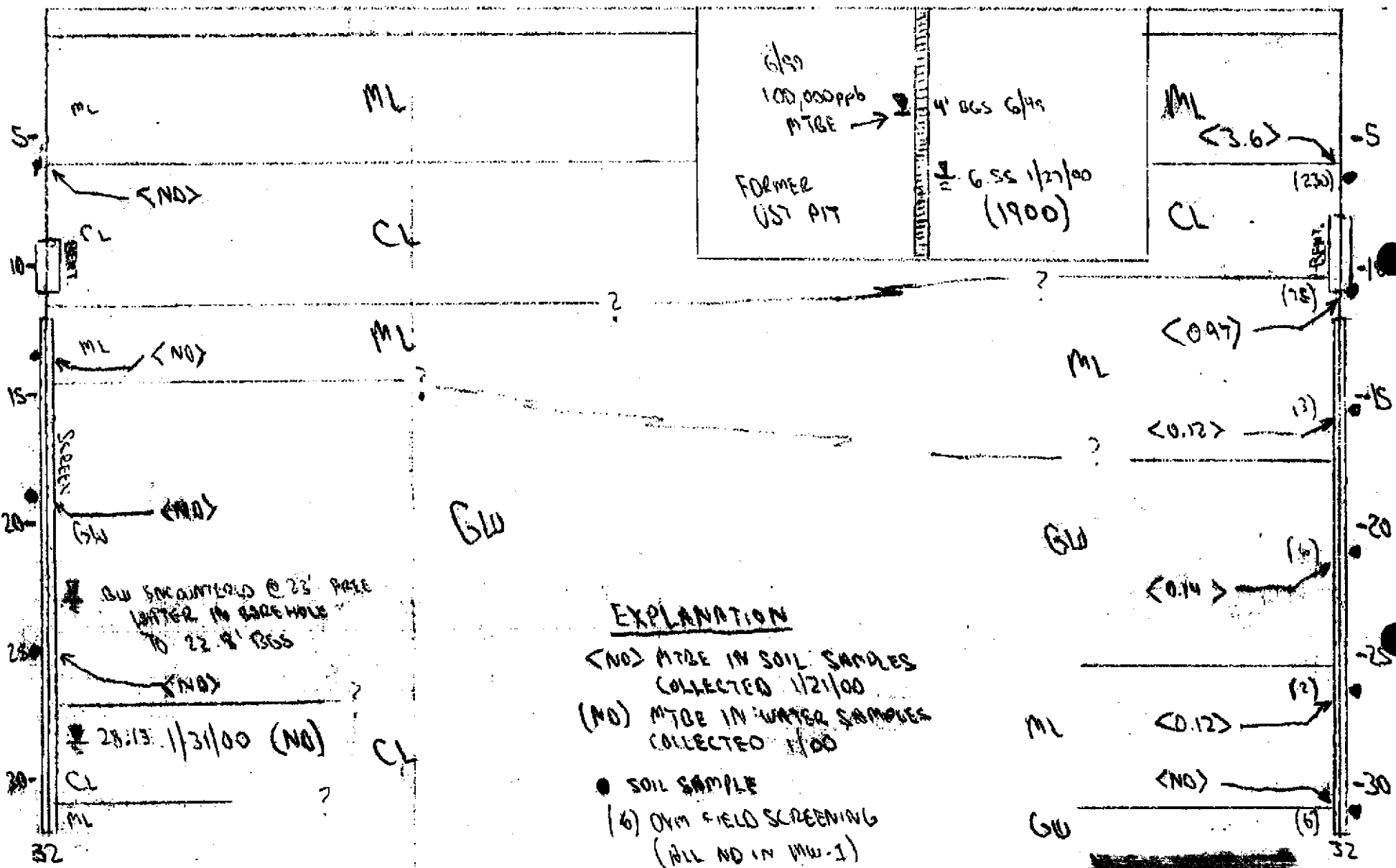

EXPLANATION
 <NO> MTBE IN SOIL SAMPLES COLLECTED 1/21/00
 (NO) MTBE IN WATER SAMPLES COLLECTED 1/00
 ● SOIL SAMPLE
 (6) OVM FIELD SCREENING (ALL NO IN MW-1)

CAN-AM PLUMBING

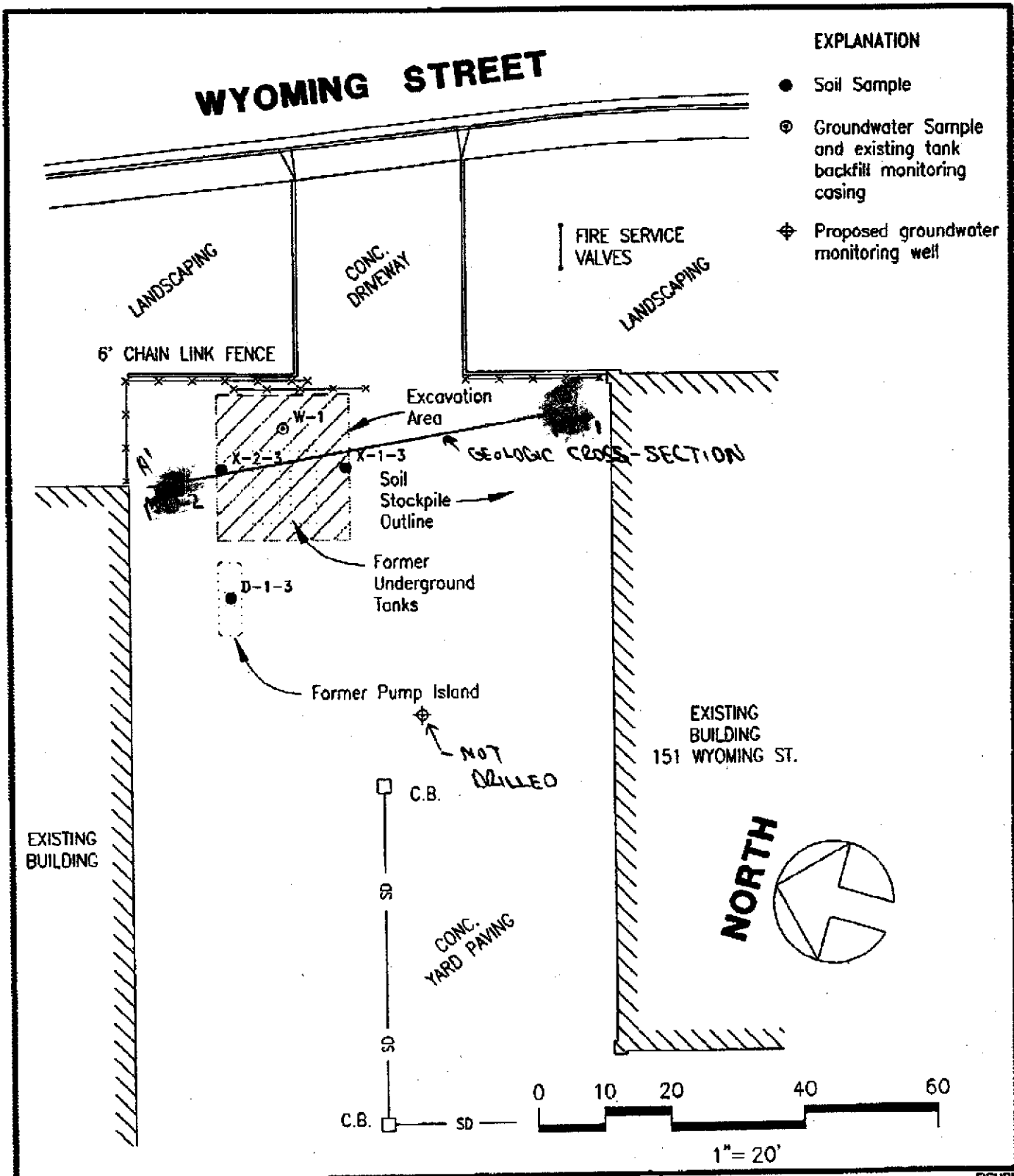

Gettler - Ryan Inc.

6747 Sierra Ct., Suite J (925) 551-7555
Dublin, CA 94568

SITE PLAN
Can-Am Plumbing Inc.
151 Wyoming Street
Pleasanton, California 94566

FIGURE

2

JOB NUMBER
948162.02

REVIEWED BY

DATE
12/99

REVISED DATE