

EXPLANATION
 RC1  Monitoring well location

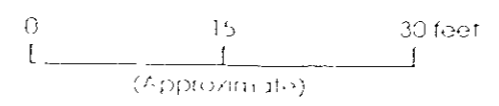
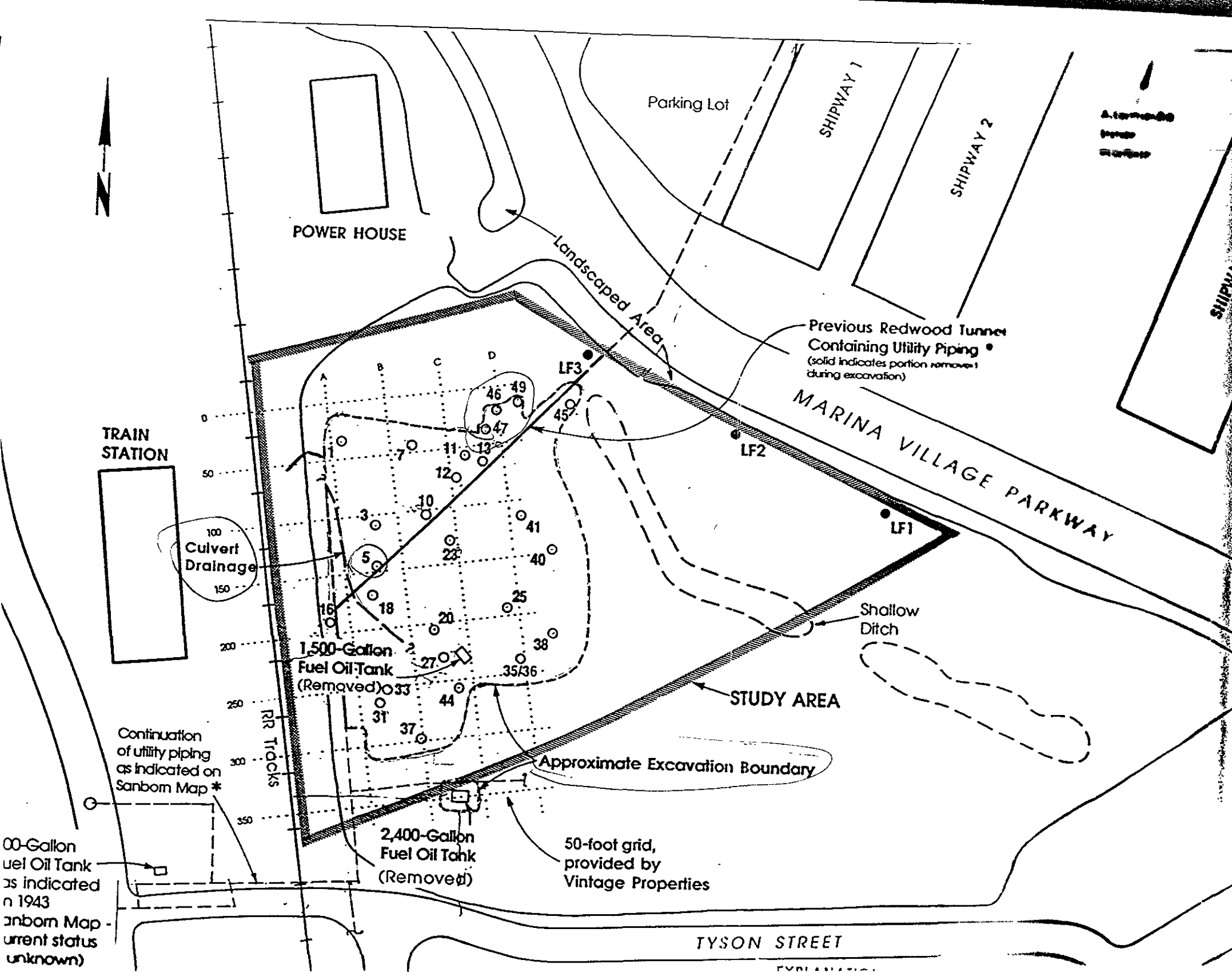

Figure 4 :
 MONITORING WELL
 LOCATION MAP FOR RC1
 (PERMIT # 88063)



POWER HOUSE

Parking Lot

SHIPWAY 1

SHIPWAY 2

Legend

Landscaped Area

Previous Redwood Tunnel
Containing Utility Piping
(solid indicates portion removed
during excavation)

MARINA VILLAGE PARKWAY

TRAIN STATION

100
Culvert
Drainage
150

LF3

LF2

LF1

Shallow
Ditch

STUDY AREA

1,500-Gallon
Fuel Oil Tank
(Removed)

Approximate Excavation Boundary

Continuation
of utility piping
as indicated on
Sanborn Map *

RR Tracks

2,400-Gallon
Fuel Oil Tank
(Removed)

50-foot grid,
provided by
Vintage Properties

00-Gallon
Fuel Oil Tank
as indicated
on 1943
Sanborn Map
(current status
unknown)

TYSON STREET

EXPLANATION

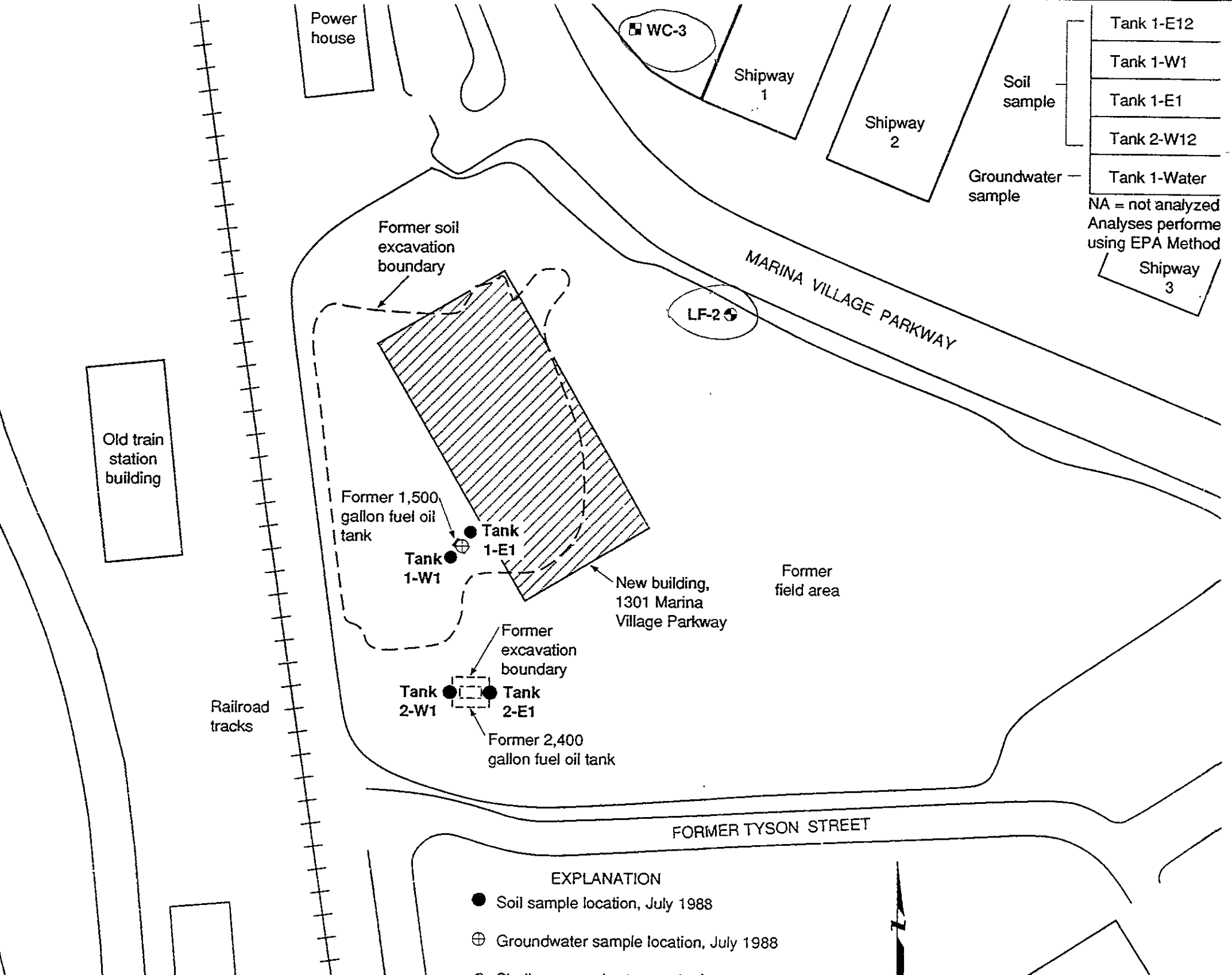

Tank 1-E12
Tank 1-W1
Tank 1-E1
Tank 2-W12
Tank 1-Water

NA = not analyzed
 Analyses performed using EPA Method

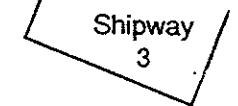

EXPLANATION

- Soil sample location, July 1988
- ⊕ Groundwater sample location, July 1988

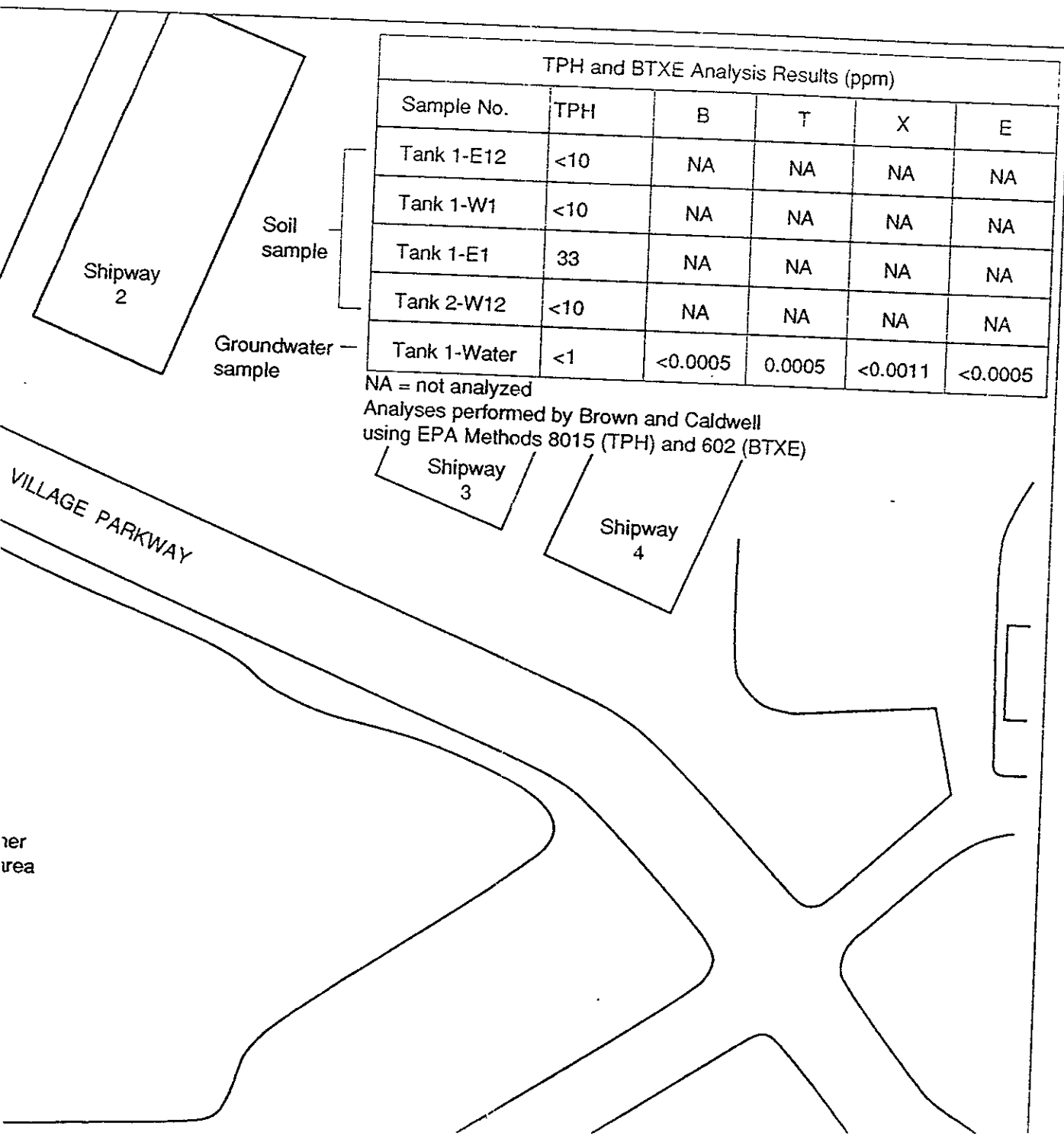

TPH and BTXE Analysis Results (ppm)

Sample No.	TPH	B	T	X	E
Tank 1-E12	<10	NA	NA	NA	NA
Tank 1-W1	<10	NA	NA	NA	NA
Tank 1-E1	33	NA	NA	NA	NA
Tank 2-W12	<10	NA	NA	NA	NA
Tank 1-Water	<1	<0.0005	0.0005	<0.0011	<0.0005

NA = not analyzed
 Analyses performed by Brown and Caldwell
 using EPA Methods 8015 (TPH) and 602 (BTXE)

Soil sample

Groundwater sample

Shipway 2

Shipway 3

Shipway 4

VILLAGE PARKWAY

her
area

North
↑

Building

Sidewalk

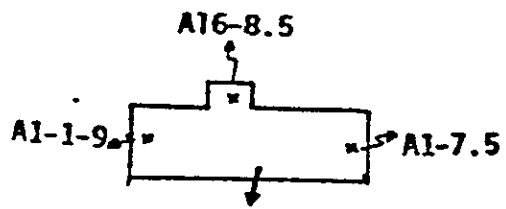

Approx. Location of
The Excavated Tank

Parking Area

Planter Street

site plan showing
the location of
3 soil samples
collected near the
excavated tank
at 1150
marina
village.

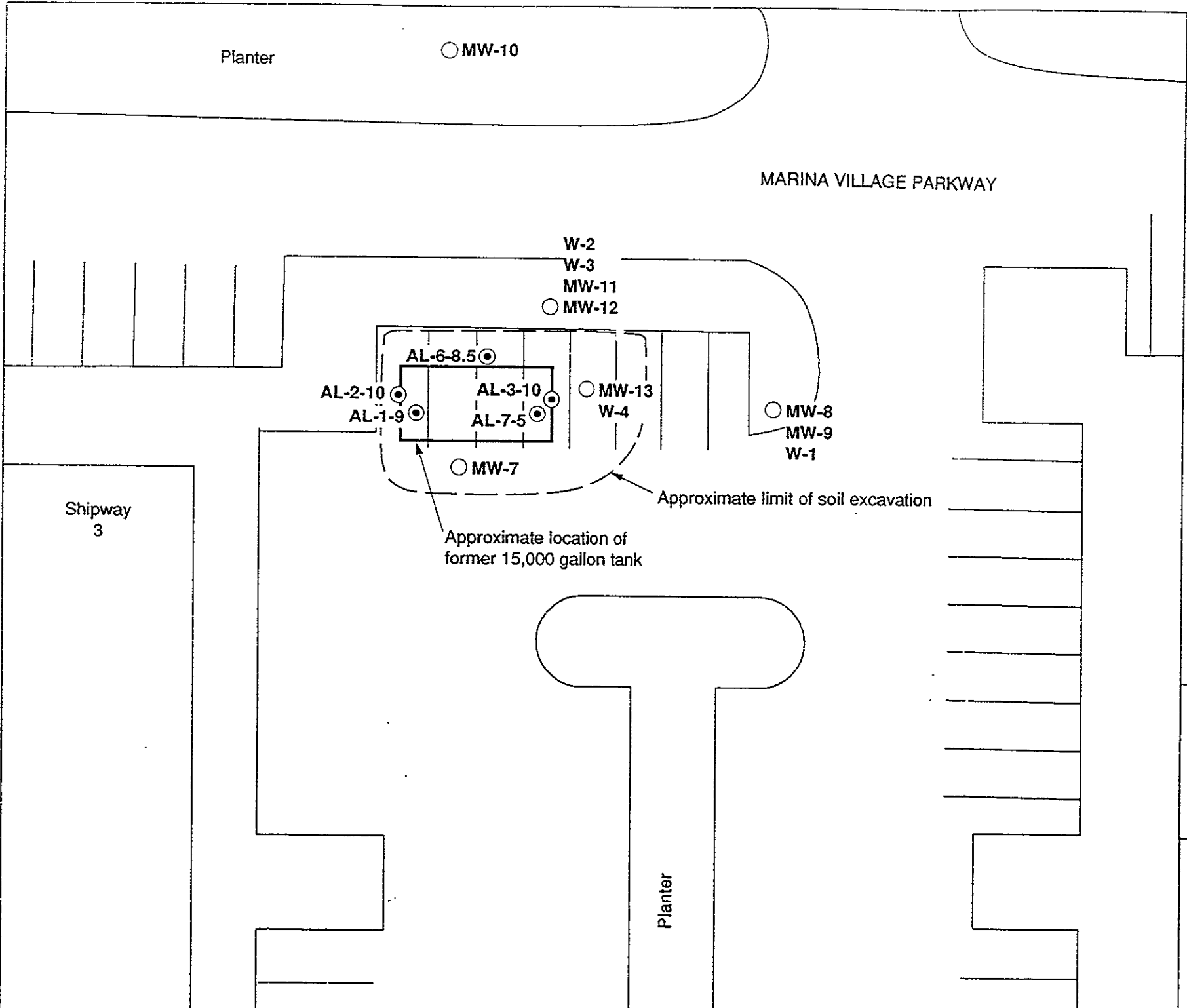

S
ANA
SOIL
MW-
MW-
MW-
MW-
MW-
MW-
WAT
W-1
W-2
W-3
W-4
ANA
SOIL
AL-2-
AL-3-
AL-6-
WAT
AL-1-
AL-7-

SUMMARY OF ANALYTICAL DATA

Sample No.	Depth (ft.)	TPH - gasoline	TPH - diesel	TOG ⁽¹⁾	Benzene	Toluene	Ethybenzene	Xylenes
ANALYTICAL DATA FOR SAMPLES OBTAINED BEFORE TANK REMOVAL IN AUGUST 1988 ⁽³⁾								
SOIL (mg/kg)								
MW-7	7.5	<10	39					
MW-8	6	<10	<10					
MW-9	10	<10	<10					
MW-10	8	<10	<10					
MW-11	6	<10	<10					
MW-12	10	<10	<10					
MW-13	7.5	<10	<10					
WATER (µg/l)								
W-1		<700	<700					
W-2		<250	<250					
W-3		<250	<250					
W-4		<10	130 ⁽²⁾					
ANALYTICAL DATA FOR SAMPLES OBTAINED FOLLOWING TANK REMOVAL IN JANUARY 1989 ⁽⁴⁾								
SOIL (mg/kg)								
AL-2-10	10 ⁽³⁾	ND	9.1	5300	ND	ND		ND
AL-3-10	10 ⁽³⁾	6.9	5300	1400	ND	ND		ND
AL-6-8.5	8.5 ⁽³⁾	1.0	2300	34	ND	ND		ND
WATER (µg/l)								
AL-1-9 ⁽⁵⁾					ND	ND	ND	ND
AL-7-5 ⁽⁶⁾		270	6400		4.8	8.8	2.2	12

Notes

1. TOG = total oil and grease.
2. Degraded diesel.
3. Test data referenced from AREI files.
4. Test data referenced from Safety Specialists, Inc., letter dated 13 February 1989.
5. BTEX results based on EPA Method 8240 analysis.
6. BTEX results based on EPA Method 8020 analysis.

EXPLANATION

- Approximate location of sample(s) obtained before tank removal. Based on unpublished data from AREI files
- Approximate location of sample(s) obtained during tank removal. Based on Safety Specialists, Inc., letter dated 13