

73 Digital Drive
Novato, CA 94949
Phone: (415) 382-7400
Fax: (415) 382-7415

SH

Exxon Company, U.S.A.
QUARTERLY STATUS REPORT
October - December 1993
Date: December 30, 1993

RAS # 7-0234
3450 35th Avenue
Oakland, California
RESNA No. 170078

Work Performed During This Quarter

October through December 1993

- Performed Quarterly Groundwater Monitoring for fourth quarter 1993 on October 19, 1993. Report submitted to Exxon on November 19, 1993.

Quarterly Groundwater Sampling (10/19/94) Results (µg/L)

Well No.	B	T	E	X	TPHg	Historical Trend
MW-1	<0.5	<0.5	<0.5	<0.5	<50	Unchanged
MW-2	<0.5	<0.5	<0.5	<0.5	<50	Unchanged
MW-3	<0.5	<0.5	<0.5	<0.5	<50	Unchanged

Separate Phase Product Recovery

Not Applicable

Work to be Performed Next Quarter

Estimated Completion Date: 03/31/94

- Perform quarterly monitoring event and submit report.
- Meet with Regional Water Quality Control Board to present case for site closure.
- Prepare and submit closure workplan.

Work to be Performed Next 12 Months

Estimated Completion Date: 12/31/94

- Continue quarterly groundwater monitoring and sampling program.

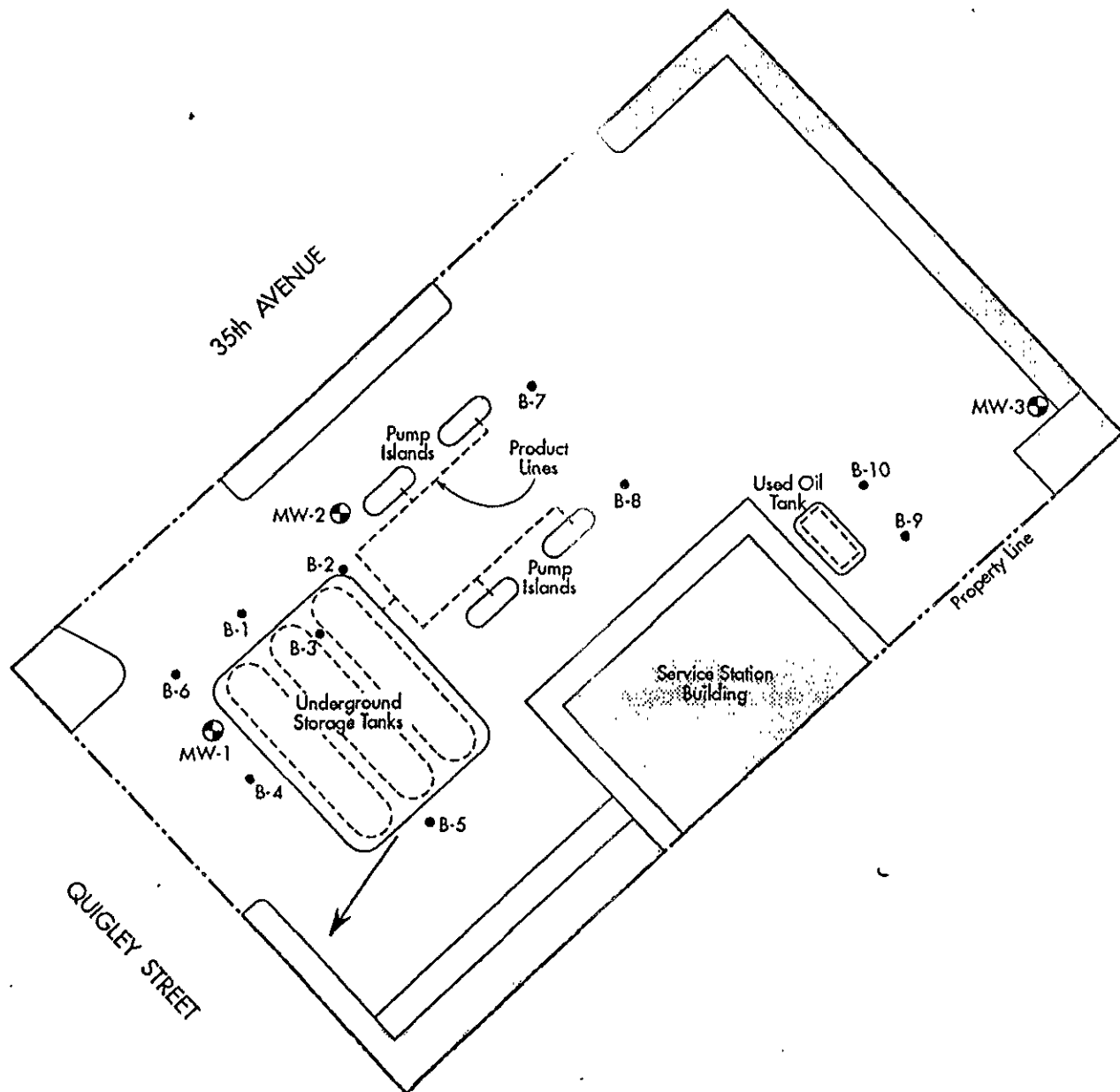

EXPLANATION

- ⊕ MW-1 Monitor Well location
- B-4 Boring location
- ← Estimated direction of groundwater flow



Map Source. Site map by International Technology Corporation



PROJECT NO. 170078.01

10/93

GENERALIZED SITE PLAN
 Exxon Service Station No. 7-0234
 3450 35th Avenue
 Oakland, California



73 Digital Drive
Novato, CA 94949
Phone: (415) 382-7400
Fax: (415) 382-7415

Exxon Company, U.S.A.
QUARTERLY STATUS REPORT
July - September 1993
Date: September 30, 1993

RAS # 7-0234
3450 35th Avenue
Oakland, California
RESNA No. 170078

Work Performed During This Quarter

94619

July through September 1993

- o Performed Quarterly Groundwater Monitoring for third quarter 1993 on July 30, 1993. Report submitted to Exxon on September 7, 1993.

Quarterly Groundwater Sampling (7/30/93) Results (µg/L)

<u>Well No.</u>	<u>B</u>	<u>T</u>	<u>E</u>	<u>X</u>	<u>TPHg</u>	<u>Historical Trend</u>
MW-1	<0.5	<0.5	<0.5	<0.5	<50	Decreased
MW-2	<0.5	<0.5	<0.5	<0.5	<50	Unchanged
MW-3	<0.5	<0.5	<0.5	<0.5	<50	Unchanged

Separate Phase Product Recovery

Not Applicable

Work to be Performed Next Quarter

Estimated Completion Date: 12/31/93

- o Perform quarterly monitoring event and submit report.

Work to be Performed Next 12 Months

Estimated Completion Date: 9/30/94

- o Submit closure letter.

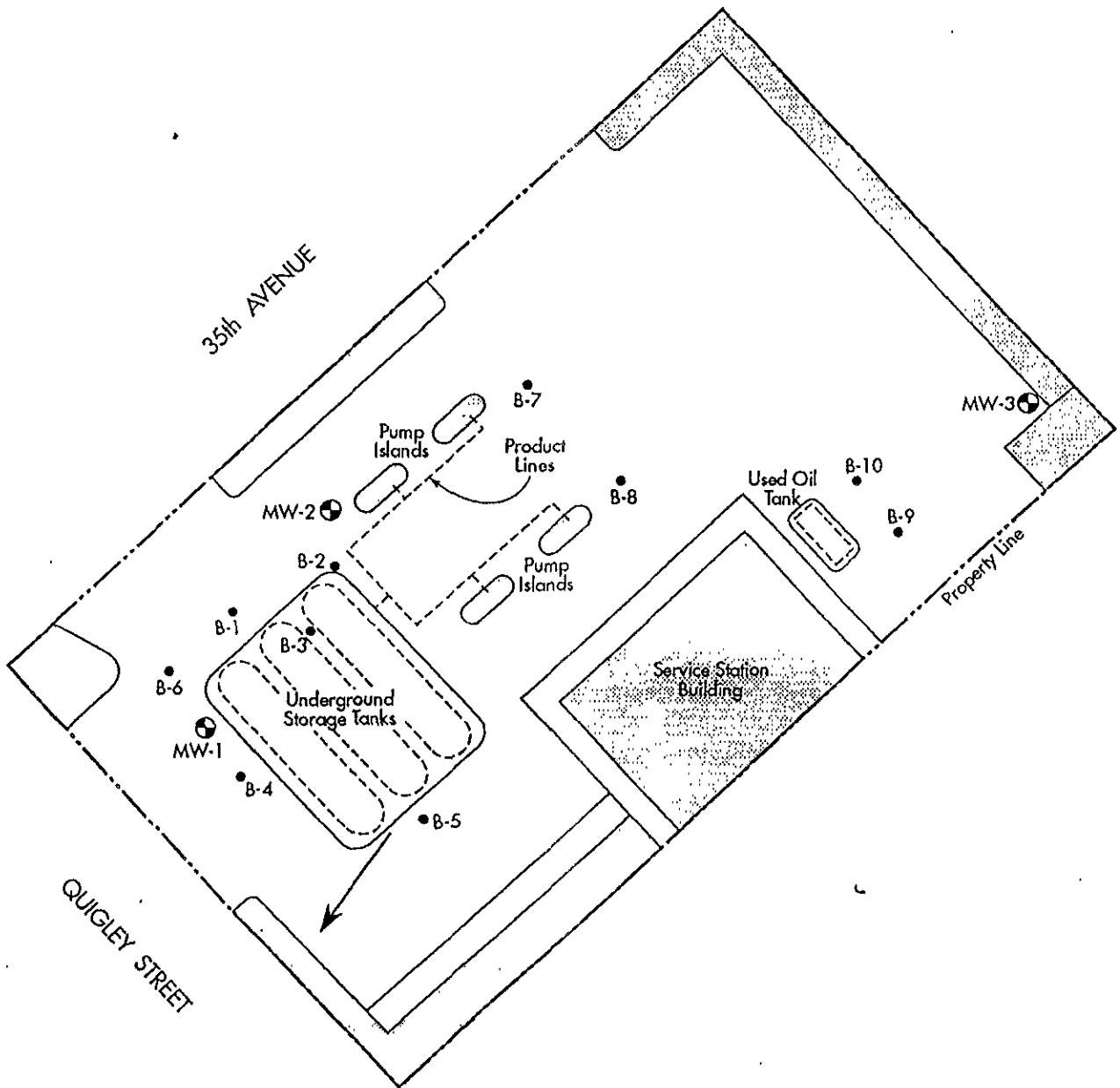

EXPLANATION

- ⊕ MW-1 Monitor Well location
- B-4 Boring location
- ← Estimated direction of groundwater flow

Map Source: Site map by International Technology Corporation



RESNA

PROJECT NO. 170Q78.01

10/93

GENERALIZED SITE PLAN
 Exxon Service Station No. 7-0234
 3450 35th Avenue
 Oakland, California

SH



73 Digital Drive
Novato, CA 94949
Phone: (415) 382-7400
FAX: (415) 382-7415

Exxon Company, U.S.A.
QUARTERLY STATUS REPORT
April - June 1993
Date: June 25, 1993

RAS # 7-0234
3450 35th Avenue
Oakland, California
RESNA No. 170078

Work Performed During This Quarter

April through June 1993

- o Performed Quarterly Groundwater Monitoring for second quarter 1993 on May 3, 1993

Quarterly Groundwater Sampling (5/3/93) Results (µg/L)

<u>Well No.</u>	<u>B</u>	<u>T</u>	<u>E</u>	<u>X</u>	<u>TPHg</u>	<u>Historical Trend</u>
✓ MW-1	2.8	7.2	2.2	22	71	Increase
MW-2	<0.5	<0.5	<0.5	<0.5	<50	Unchanged
MW-3	<0.5	<0.5	<0.5	<0.5	<50	Unchanged

Separate Phase Product Recovery

Not Applicable

Work to be Performed Next Quarter

Estimated Completion Date: 9/30/93

- o Submit quarterly monitoring report and perform quarterly monitoring event.

Work to be Performed Next 12 Months

Estimated Completion Date: 6/30/94

- o Continue quarterly groundwater monitoring and sampling program to evaluate the trends of gasoline hydrocarbons and groundwater flow direction and gradient.

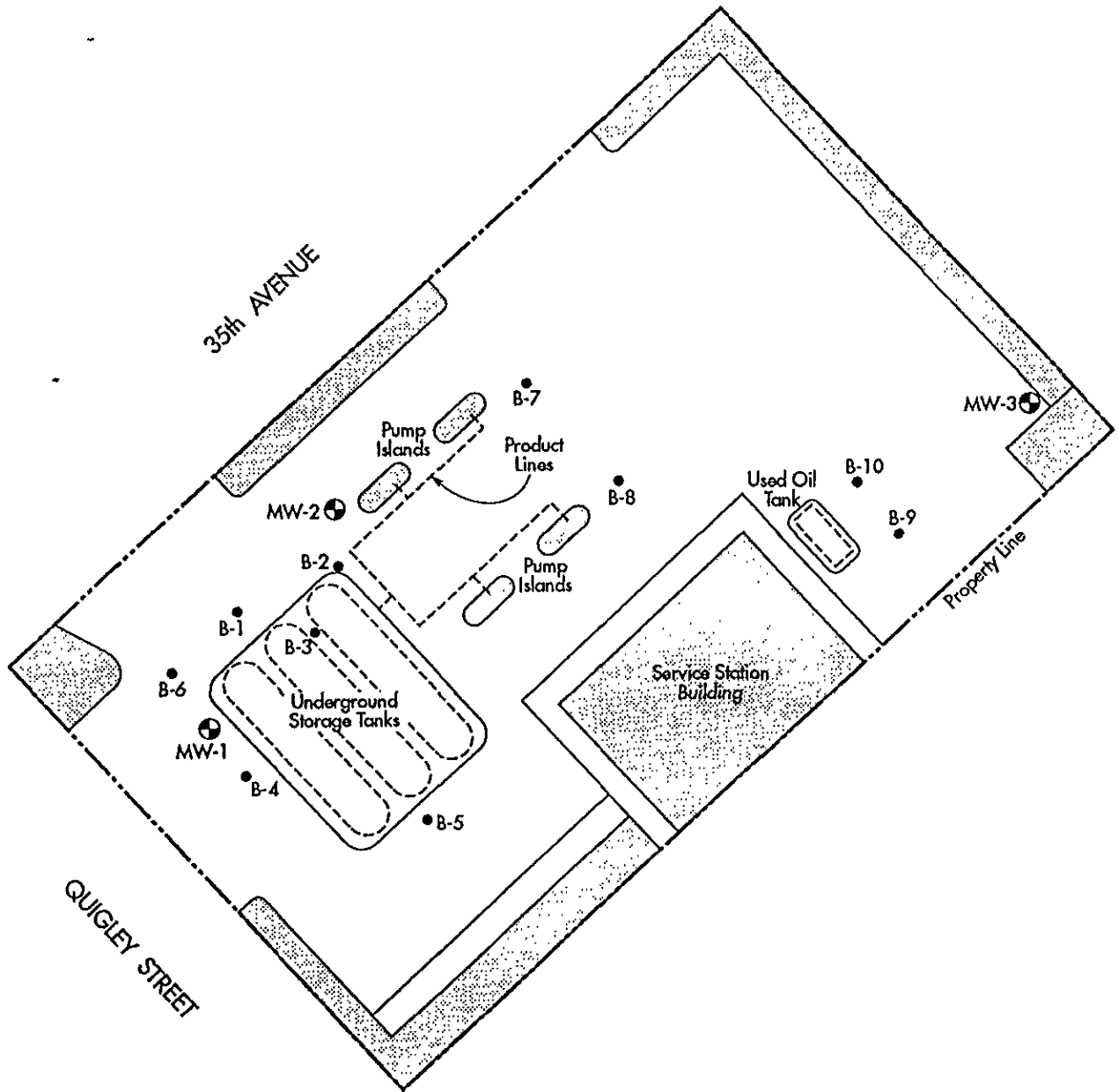

EXPLANATION

- ⊕ MW-1 Monitor Well location
- B-4 Boring location

Map Source: Site map by International Technology Corporation



PROJECT NO. 170078.01

1/93

GENERALIZED SITE PLAN
 Exxon Service Station No. 7-0234
 3450 35th Avenue
 Oakland, California

PLATE

2



73 Digital Drive
Novato, CA 94949
Phone: (415) 382-7400
FAX: (415) 382-7415

Exxon Company, U.S.A.
QUARTERLY STATUS REPORT
January - March 1993
Date: April 12, 1993

RAS # 7-0234
3450 35th Avenue
Oakland, California
RESNA No. 170078

Work Performed During This Quarter

January through March 1993

- o Performed Quarterly Groundwater Monitoring for first quarter 1993 on February 4, 1993.

Quarterly Groundwater Sampling (2/4/93) Results (ug/L)

Well No.	B	T	E	X	TPHg	Historical Trend
MW-1	0.8	<0.5	<0.5	<0.5	<50	Decrease
MW-2	<0.5	<0.5	<0.5	<0.5	<50	Decrease
MW-3	<0.5	<0.5	<0.5	<0.5	<50	Decrease

Free Phase Product Recovery

Not Applicable

Work to be Performed Next Quarter

Estimated Completion Date: 6/30/93

- o Submit quarterly monitoring report and perform quarterly monitoring event.

Work to be Performed Next 12 Months

Estimated Completion Date: 3/31/94

- o Continue quarterly groundwater monitoring and sampling program to evaluate the trends of gasoline hydrocarbons and groundwater flow direction and gradient.

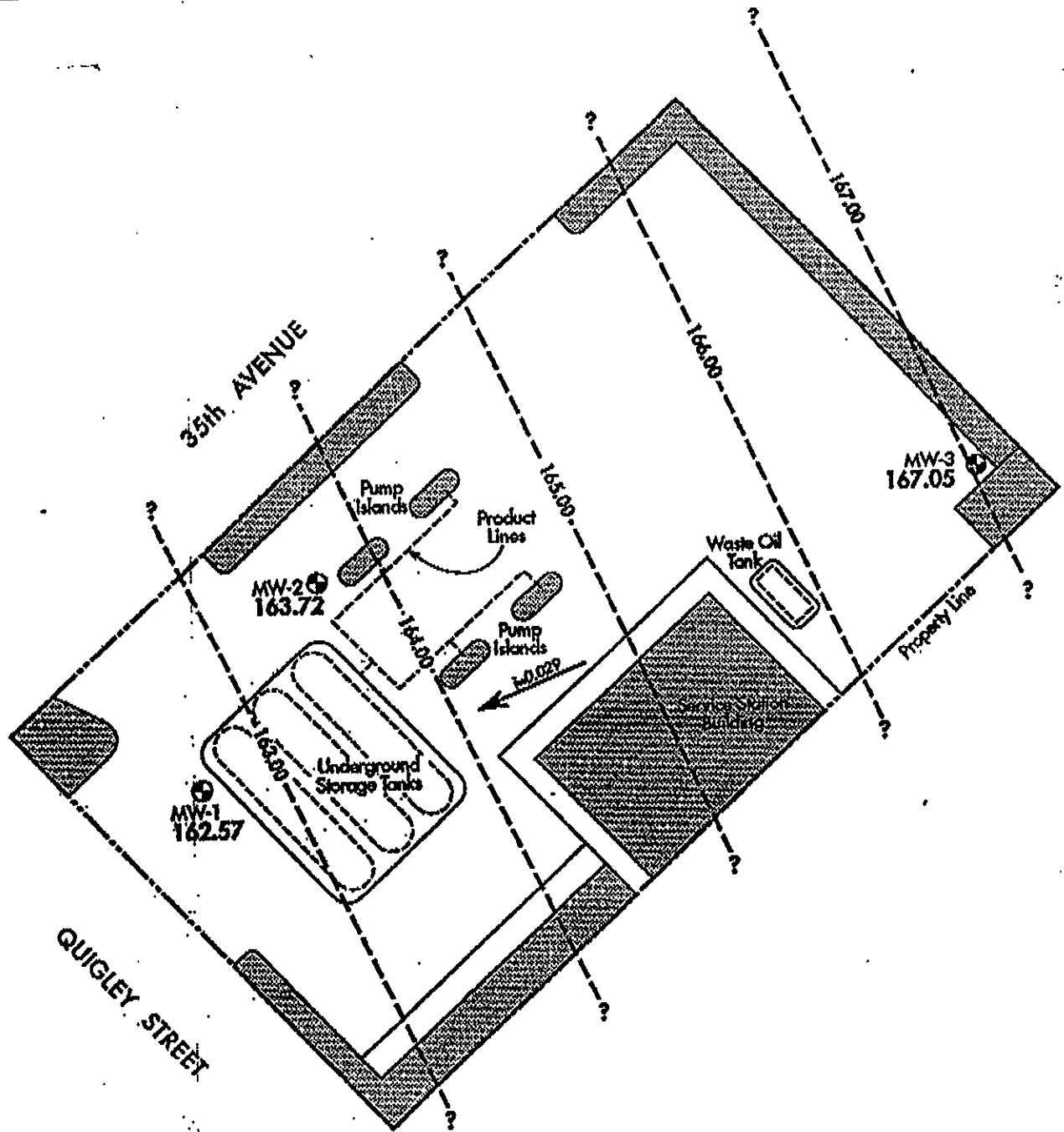

EXPLANATION

- MW-1
 167.05 Monitoring well and groundwater elevation, feet above mean sea level
- 165.00 - - - ? Groundwater elevation contour, feet above mean sea level, dashed where inferred, queried where uncertain
- 0.029 Estimated direction of groundwater flow with evaluated gradient

Map Source: Site map by International Technology Corporation



PROJECT NO. 170078.01

3/93

POTENTIOMETRIC SURFACE MAP
 February 4, 1993
 Exxon Service Station No. 7-0234
 3450 35th Avenue
 Oakland, California

PLATE
2

EXXON COMPANY, U.S.A.
QUARTERLY SUMMARY REPORT

Quarter: October - December 1992
Date: December 27, 1992

RAS #7-0234
3450 35th Avenue
Oakland, CA

WORK PERFORMED THIS QUARTER

- 1) Completed initial site investigation
- 2) Issued Site Assessment Report

QUARTERLY GROUNDWATER SAMPLING (10/22/92) RESULTS ($\mu\text{g/L}$)

Well No.	B	T	E	X	Historical TPHgTrend
MW-1	2.9	<0.5	<0.5	<50	Not Applicable
MW-2	<0.5	<0.5	<0.5	<50	Not Applicable
MW-3	<0.5	<0.5	<0.5	<50	Not Applicable

FREE PHASE PRODUCT RECOVERY

Not Applicable

WORK TO BE PERFORMED NEXT QUARTER

Activity	Estimated Completion Date
1) Perform quarterly monitoring	01/22/93
2) Confirm groundwater flow direction	01/22/93

WORK TO BE PERFORMED NEXT 12 MONTHS

Activity	Estimated Completion Date
1) Continue site investigation, if needed	February 1992
2) Perform quarterly monitoring	1993

191081-A11

DRAWING NUMBER

12-2-92
12-2-92

SJZ

CHECKED BY
APPROVED BY

12-2-92

DRAWN BY

35th AVENUE

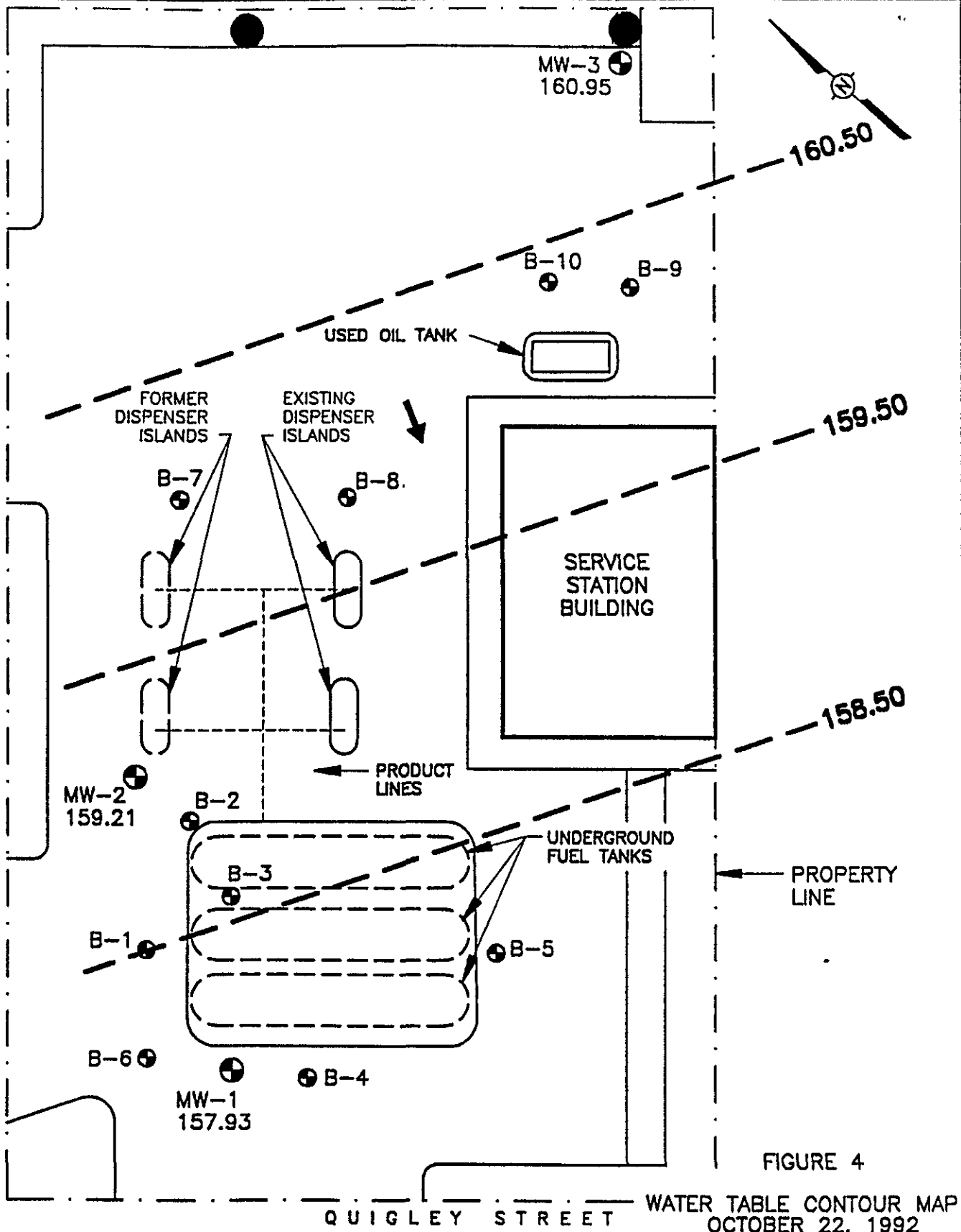

FIGURE 4

WATER TABLE CONTOUR MAP
OCTOBER 22, 1992

RAS# 7-0234
3450 35th AVENUE
OAKLAND, CALIFORNIA
PREPARED FOR

EXXON COMPANY, U.S.A.

LEGEND

- ⊕ IT CORPORATION MONITOR WELL (7-92)
- ⊙ ALTON GEOSCIENCES BORINGS (3-91)
- WATER TABLE CONTOUR
- ← GROUNDWATER FLOW DIRECTION

APPROXIMATE SCALE

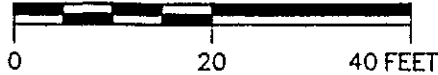

INTERNATIONAL
TECHNOLOGY
CORPORATION

EXXON COMPANY, U.S.A.
QUARTERLY SUMMARY REPORT

3112519

Quarter: July - September, 1992
Date: October 05, 1992

RAS #7-0234
3450 35th Avenue
Oakland, CA 94619

WORK PERFORMED THIS QUARTER

- 1) Completed initial site investigation
- 2) Issued Site Assessment Report

INITIAL QUARTERLY GROUNDWATER SAMPLING (07/17/92) RESULTS (µg/L)

Well No.	B	T	E	X	TPHg	Historical Trend
MW-1	6.6	6.9	2.0	4.5	67	Not Applicable
MW-2	<0.5	<0.5	<0.5	<0.5	<50	Not Applicable
MW-3	<0.5	<0.5	<0.5	<0.5	<50	Not Applicable

FREE PHASE PRODUCT RECOVERY

Not Applicable

WORK TO BE PERFORMED NEXT QUARTER

<u>Activity</u>	<u>Estimated Completion Date</u>
1) Perform Quarterly Monitoring	10/17/92
2) Confirm Groundwater Flow Direction	10/17/92

WORK TO BE PERFORMED NEXT 12 MONTHS

<u>Activity</u>	<u>Estimated Completion Date</u>
1) Continue site investigation, if needed	November 1992
2) Perform Quarterly Monitoring	1993

DRAWING NUMBER 191081-A6

9-24-92 9-24-92

SM DD

CHECKED BY I.R.S. 9-24-92 APPROVED BY DD

DRAWN BY

35th AVENUE

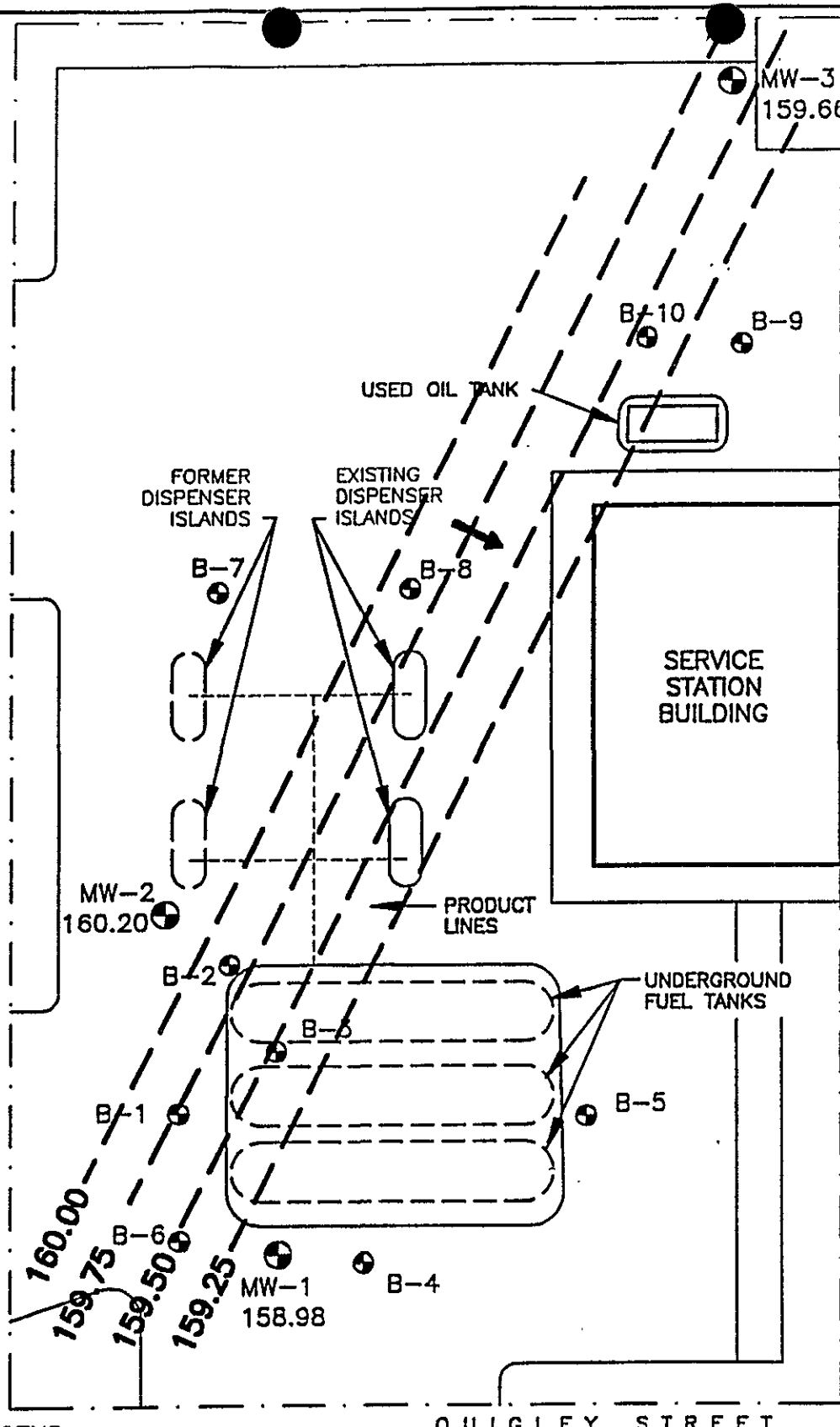

FIGURE 4
 WATER TABLE
 CONTOUR MAP
 JULY 17, 1992
 RAS# 7-0234
 3450 35th AVENUE
 OAKLAND, CALIFORNIA

PREPARED FOR
 EXXON COMPANY, U.S.A.



INTERNATIONAL
 TECHNOLOGY
 CORPORATION

LEGEND

- IT CORPORATION MONITOR WELL (7-92)
- ALTON GEOSCIENCES BORINGS (3-91)
- 158.98 WATER TABLE ELEVATION IN FEET MSL
- WATER TABLE CONTOURS IN FEET MSL
- GROUNDWATER FLOW DIRECTION

APPROXIMATE SCALE

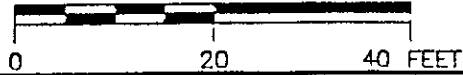

EXXON COMPANY, U.S.A.
QUARTERLY SUMMARY REPORT

Quarter: January - March, 1992
Date: April 09, 1992

STID # 519

RAS #7-0234
3450 35th Avenue
Oakland, CA

94619

WORK PERFORMED THIS QUARTER

- 1) Completed work plan for initial site investigation

QUARTERLY GROUNDWATER SAMPLING (03/31/92) RESULTS (µg/L)

Well No.	B	T	E	X	TPHg	Historical Trend
----------	---	---	---	---	------	------------------

No Groundwater Monitoring Wells Installed

FREE PHASE PRODUCT RECOVERY

Not Applicable

WORK TO BE PERFORMED NEXT QUARTER

<u>Activity</u>	<u>Estimated Completion Date</u>
1) Perform site investigation. Drill three borings, install three groundwater monitoring wells	05/30/92
2) Perform Quarterly Monitoring	06/30/92

WORK TO BE PERFORMED NEXT 12 MONTHS

<u>Activity</u>	<u>Estimated Completion Date</u>
1) Continue site investigation, if needed	Summer 1992
2) Perform Quarterly Monitoring	1992

DRAWING NUMBER 191081-A3

CHECKED BY
APPROVED BY

SJZ
4-2-92

DRAWN BY

35th AVENUE

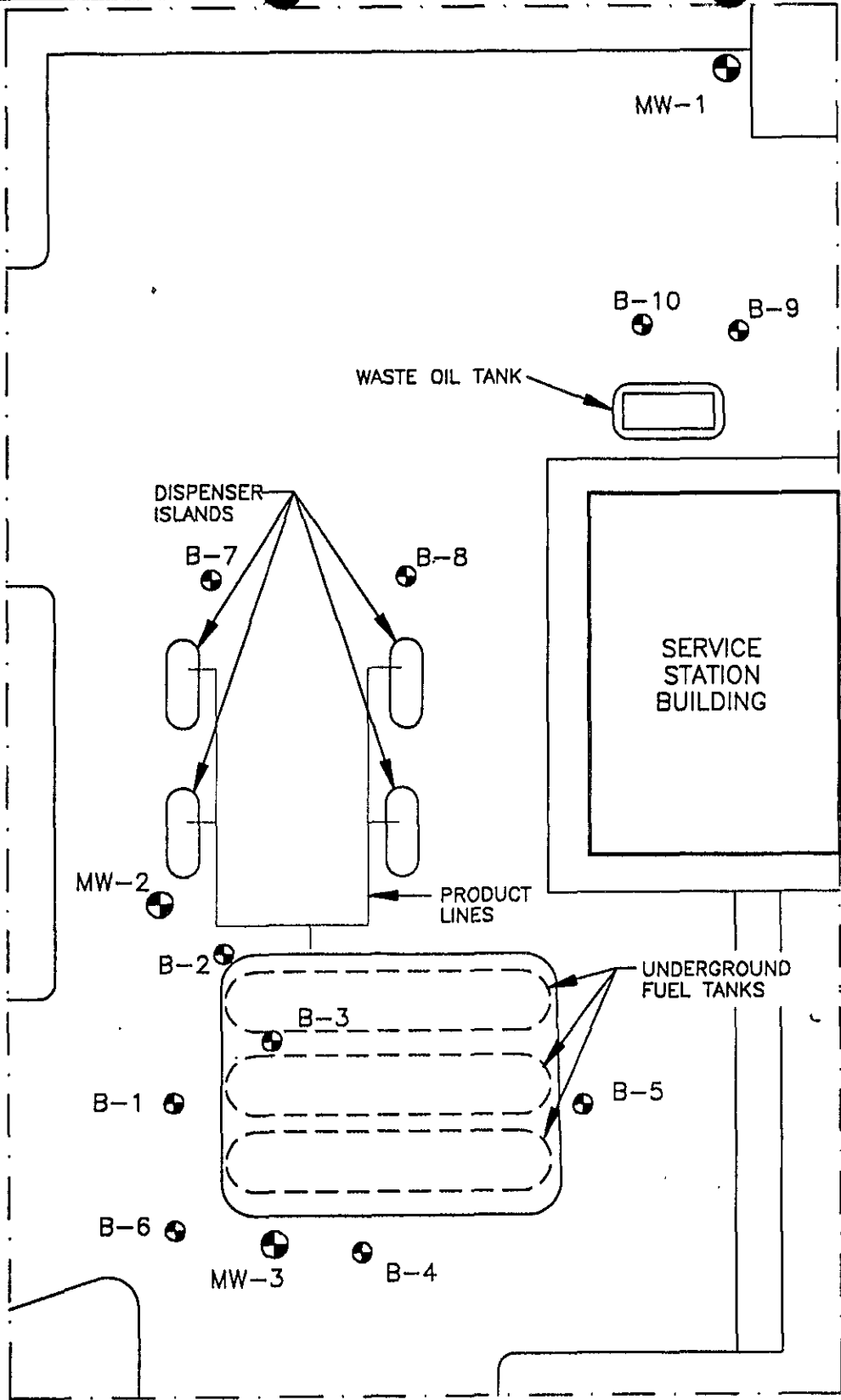
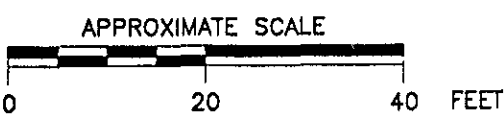

FIGURE 3
 SITE MAP
 RAS# 7-0234
 3450 35th AVENUE
 OAKLAND, CALIFORNIA

LEGEND

- ⊕ PROPOSED MONITOR WELL
- ALTON GEOSCIENCES BORINGS (B-1 TO B-10)



PREPARED FOR
 EXXON COMPANY, U.S.A.

