



August 6, 1992

Mr. Scott Seery  
Alameda County Health Care Services Agency  
Division of Hazardous Materials  
Department of Environmental Health  
80 Swan Way, Room 200  
Oakland, CA 94621

92 AUG 23 11 23 AM

Re: Second Quarterly Sampling, 21065 Foothill Blvd., Hayward, CA

Mr. Seery,

Enclosed please find the analytical results of a water sample taken from the monitoring well at 21065 Foothill Blvd., Hayward, CA. The enclosed site plan shows the location of monitoring well MW1 in relation to site buildings and right-of-ways. This sample routine represents the second quarter sampling round of a one year program initiated in February of 1992 with the placement and initial sampling of the well. To date, all sampling results have been N.D.

If you have any questions regarding the enclosed information, please contact me at my offices.

Respectfully,  
AQUA SCIENCE ENGINEERS, INC.

Gerald Sasse.  
Vice President

encl. (1)

cc. Mr. Roy Breitenbach

685-6760



August 6, 1992

92 AUG 12 11:19

**REPORT OF QUARTERLY WELL SAMPLING**

Performed at:

21065 Foothill Blvd.  
Hayward, CA

Prepared for:

Mr. Roy Breitenbach  
2358 Loma Vista Drive  
Prescott, AZ 86301

Prepared by:

Aqua Science Engineers, Inc.  
Concord, CA.



August 6, 1992

Mr. Scott Seery  
Alameda County Health Care Services Agency  
Division of Hazardous Materials  
Department of Environmental Health  
80 Swan Way, Room 200  
Oakland, CA 94621

Re: Second Quarterly Sampling, 21065 Foothill Blvd., Hayward, CA

Mr. Seery,

Enclosed please find the analytical results of a water sample taken from the monitoring well at 21065 Foothill Blvd., Hayward, CA. The enclosed site plan shows the location of monitoring well MW1 in relation to site buildings and right-of-ways. This sample routine represents the second quarter sampling round of a one year program initiated in February of 1992 with the placement and initial sampling of the well. To date, all sampling results have been N.D.

If you have any questions regarding the enclosed information, please contact me at my offices.

Respectfully,  
AQUA SCIENCE ENGINEERS, INC.

Gerald Sasse.  
Vice President

encl. (1)

cc. Mr. Roy Breitenbach

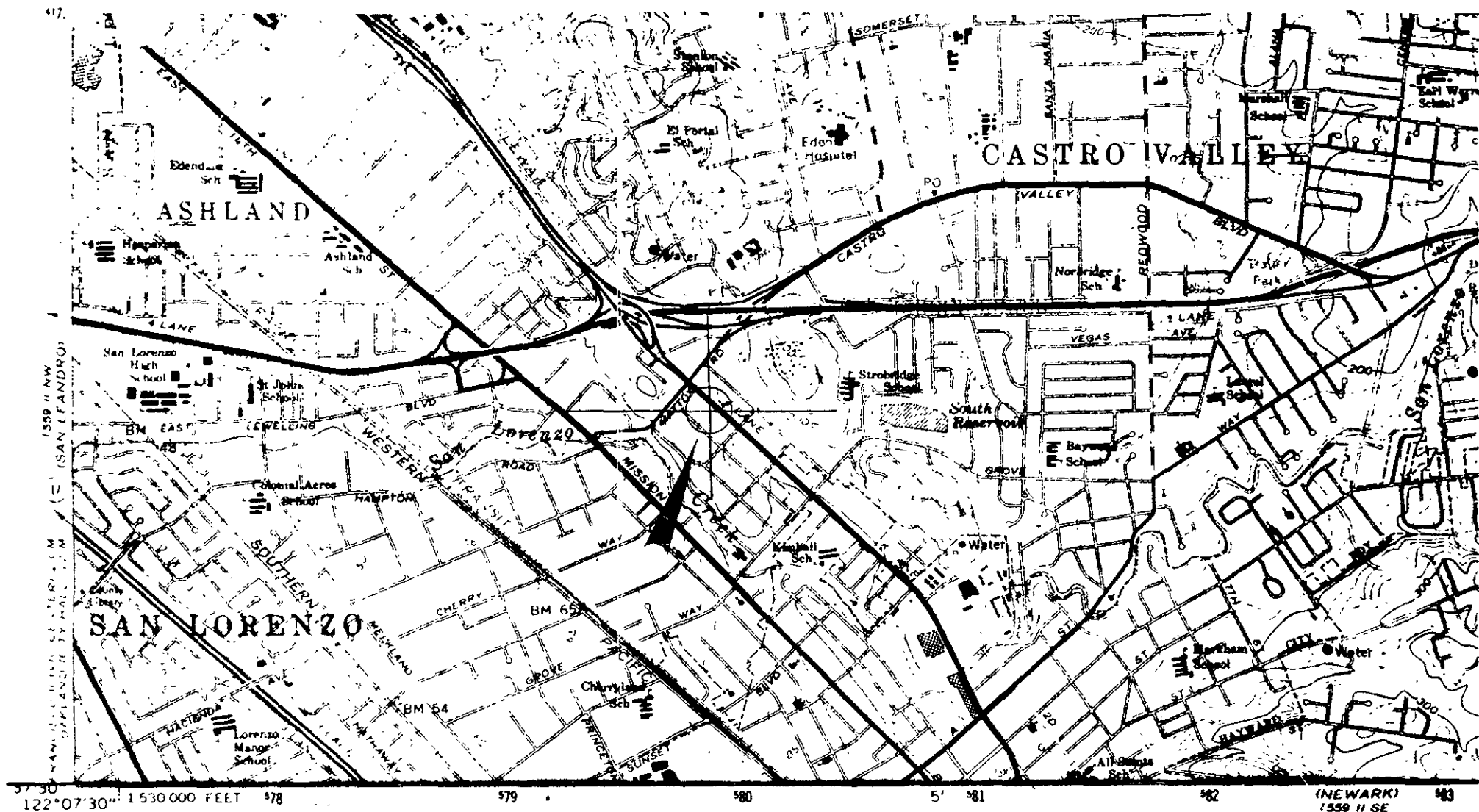

Mapped, edited, and published by the Geological Survey

Control by USGS, USC&GS, USCE, and Alameda County

Topography from aerial photographs by photogrammetric methods and by plane-table surveys 1947 Revised from aerial photographs taken 1958 Field check 1959

Polyconic projection

10,000 foot grid based on California coordinate system, zone 3

1000 meter Universal Transverse Mercator grid ticks, zone 10 shown in blue 1927 North American Datum

To place on the predicted North American Datum 1983

move the printed lines 14 meters north and 95 meters east as shown by dashed corner ticks

Red tint indicates areas in which only landmark buildings are shown

There may be private inholdings within the boundaries of the National or State reservations shown on this map

UTM GRID AND 1980 MAGNETIC NORTH DECLINATION AT CENTER OF SHEET

Revisions shown in purple and woodland hatched from aerial photographs taken 1979 and other source data. This information not field checked. Map edited 1980

SCALE 1:24000

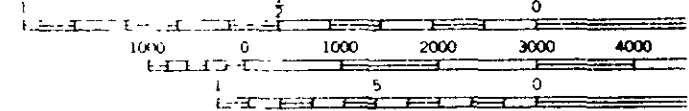

CONTOUR INTERVAL 20 FEET

AQUA SCIENCE ENGINEERS, INC.

FIGURE 1:  
Site Location Map

21065 Foothill Blvd.  
Hayward, Ca

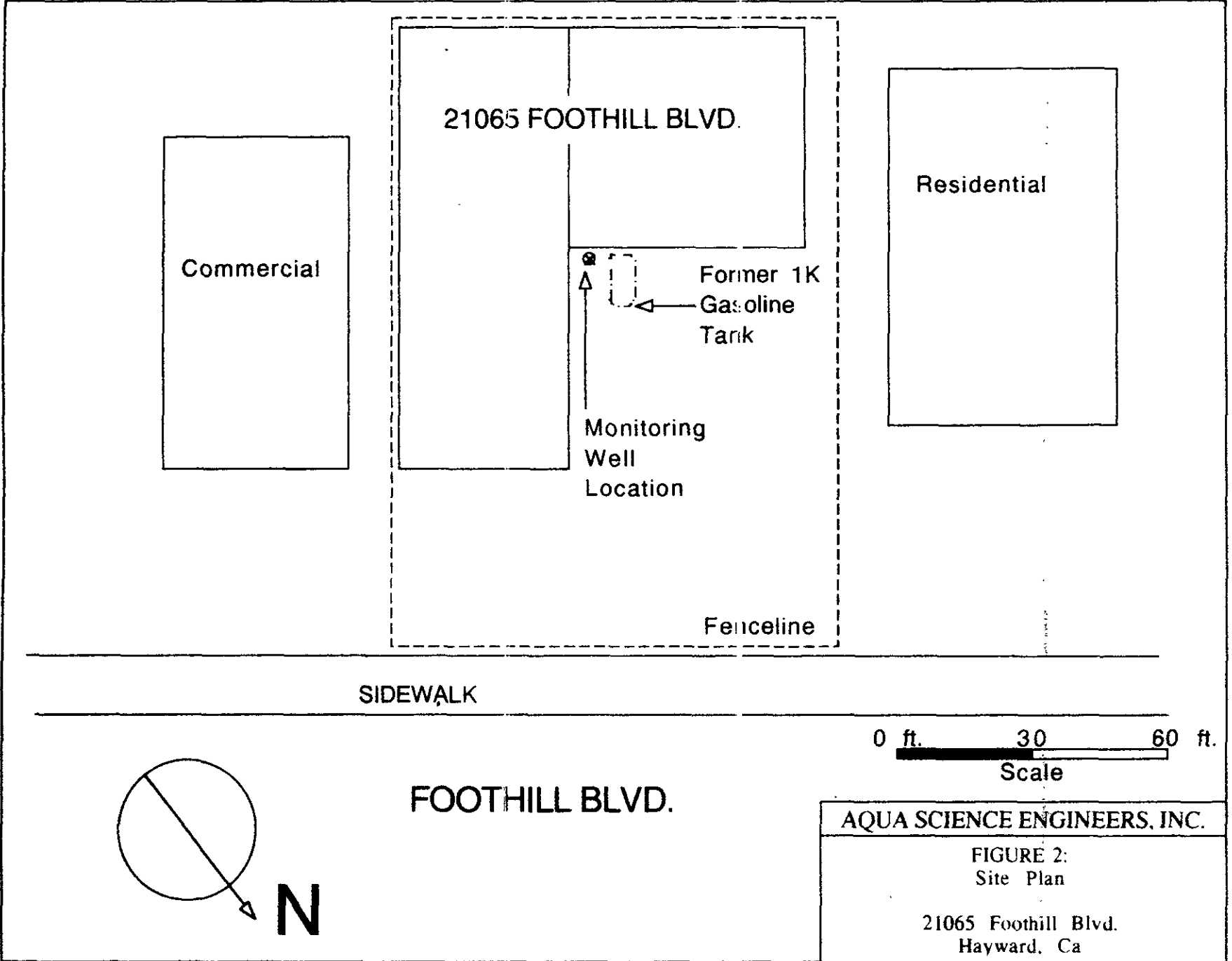

SIDEWALK

FOOTHILL BLVD.

0 ft. 30 60 ft.  
Scale

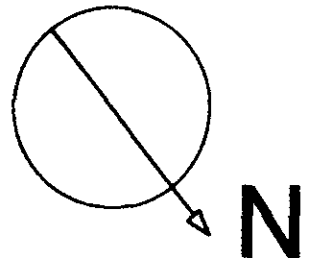

AQUA SCIENCE ENGINEERS, INC.  
FIGURE 2:  
Site Plan  
21065 Foothill Blvd.  
Hayward, Ca

TABLE ONE: RESULTS OF WATER SAMPLE ANALYSES  
21065 Foothill Blvd., Hayward, CA

Monitoring Well MW-1

Sample Date	TPH gas mg/l	benzene mg/l	toluene ug/l	ethyl benzene ug/l	total xylenes ug/l
2/3/92	N.D.	N.D.	N.D.	N.D.	N.D.
4/29/92	N.D.	N.D.	N.D.	N.D.	N.D.
7/10/92	N.D.	N.D.	N.D.	N.D.	N.D.

WELL SAMPLING FIELD LOG

**ASE environmental**

1041 Shary Circle  
Concord, CA 94518  
(510) 685-6700

Project:

Project Name: Breitenbach III

Project Address: 21065 Foothill Blvd., Hayward, CA

Job # 2544 Date of sampling: 7-10-92 Completed by: S.D.

Well Number / Designation: MW-1

Top of casing elevation: -4" from portland cement sanitary seal

Total depth of well casing: 43' 9" Well diameter: 2"

Depth to water (before sampling): 33' 9"

Depth of floating product if any: none

Depth of well casing in water: 10

Req'd volume of groundwater to be purged before sampling: 8 gallon

Approximate volume of groundwater purged: 8 gallons

Type of seal at grade: Portland Cement

Type of cap on the casing: Locking Cap

Is the seal water tight? Yes Is the cap water tight? Yes

Number of samples (containers) collected (2) 40 ml VOA

Did 40 ml VOA vials have headspace: No

Were sample containers chilled after sampling & for delivery ? Yes

Are Chain of Custody documents accompanying the samples: Yes

Sample temperature: 68

Sample pH: 7.5 Test method: \_\_\_\_\_

Physical description of water during initial bailing period:  
Cloudy & Clearing

Physical description of water sample: Clear

Type of analysis requested: TPH Gas BTEX

\_\_\_\_\_

\_\_\_\_\_

\_\_\_\_\_

Type of bailer/sampling equipment used: 1.67' x 3' PVC Bailer

Equipment cleaning procedures: TSP wash tap water rinse

Disposition of bailed water volume: Temp stored on site discharged to the ground subsurface



# PRIORITY ENVIRONMENTAL LABS

Precision Environmental Analytical Laboratory

July 16, 1992

PEL # 079205

AQUA SCIENCE ENGINEERS, INC.

Attn: Steve DeHope  
Re: One water sample for Gasoline/BTEX analysis.

Project name: Breitenbach  
Project location: 21065 Foothill Blvd.  
Project number: 2544

Date sampled: July 10, 1992  
Date extracted: July 15, 1992

Date submitted: July 15, 1992  
Date analyzed: July 15, 1992

## RESULTS:

SAMPLE I.D.	Gasoline (ug/L)	Benzene (ug/L)	Toluene (ug/L)	Ethyl Benzene (ug/L)	Total Xylenes (ug/L)
BRIT MW-1	N.D.	N.D.	N.D.	N.D.	N.D.
Blank	N.D.	N.D.	N.D.	N.D.	N.D.
Spiked Recovery	85.5%	90.2%	94.1%	93.8%	97.9%
Detection limit	50	0.5	0.5	0.5	0.5
Method of Analysis	5030 / 8015	602	602	602	602

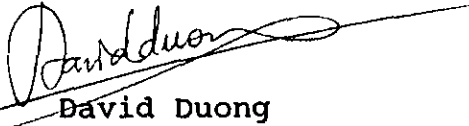
  
David Duong  
Laboratory Director





# PRIORITY ENVIRONMENTAL LABS

Precision Environmental Analytical Laboratory

July 23, 1992

PEL # 079205

AQUA SCIENCE ENGINEERS

Attn: Steve DeHope

Re: One water sample for pH and Conductivity analyses.

Project name: Breitenbach

Project location: 21065 Foothill Blvd.

Project number: 2544

Date sampled: July 10 1992

Date submitted: July 15, 1992

Date extracted: July 21, 1992

Date analyzed: July 21, 1992

## RESULTS:

SAMPLE I.D.	pH	CONDUCTIVITY (uS)
BRIT MW-1	7.5	1030
Blank	7.0	0

  
David Duong  
Laboratory Director

