



92 MAY 11 11:10:34

May 8, 1992

REPORT OF QUARTERLY WELL SAMPLING

Performed at:

**21065 Foothill Blvd.
Hayward, CA**

Prepared for:

**Mr. Roy Breitenbach
2358 Loma Vista Drive
Prescott, AZ 86301**

Prepared by:

**Aqua Science Engineers, Inc.
Concord, CA.**



May 18, 1992

Mr. Scott Seery
Alameda County Health Care Services Agency
Division of Hazardous Materials
Department of Environmental Health
80 Swan Way, Room 200
Oakland, CA 94621

Re: First Quarterly Sampling, 21065 Foothill Blvd., Hayward, CA.

Mr. Seery,

Enclosed please find the analytical results of a water sample taken from the monitoring well at 21065, Hayward, CA. The enclosed site plan shows the location of monitoring well MW1 in relation to site buildings and right-of-ways. This sample routine represents the first quarter sampling round of a one year program initiated in February of 1992 with the placement and initial sampling of the well. Second quarterly sampling is tentatively scheduled for execution in August of 1992.

If you have any questions regarding the enclosed information, please contact me at my offices.

Respectfully,
AQUA SCIENCE ENGINEERS, INC.

David C. Prull
Project Manager

encl. (1)

cc. Mr. Roy Breitenbach, Property Owner

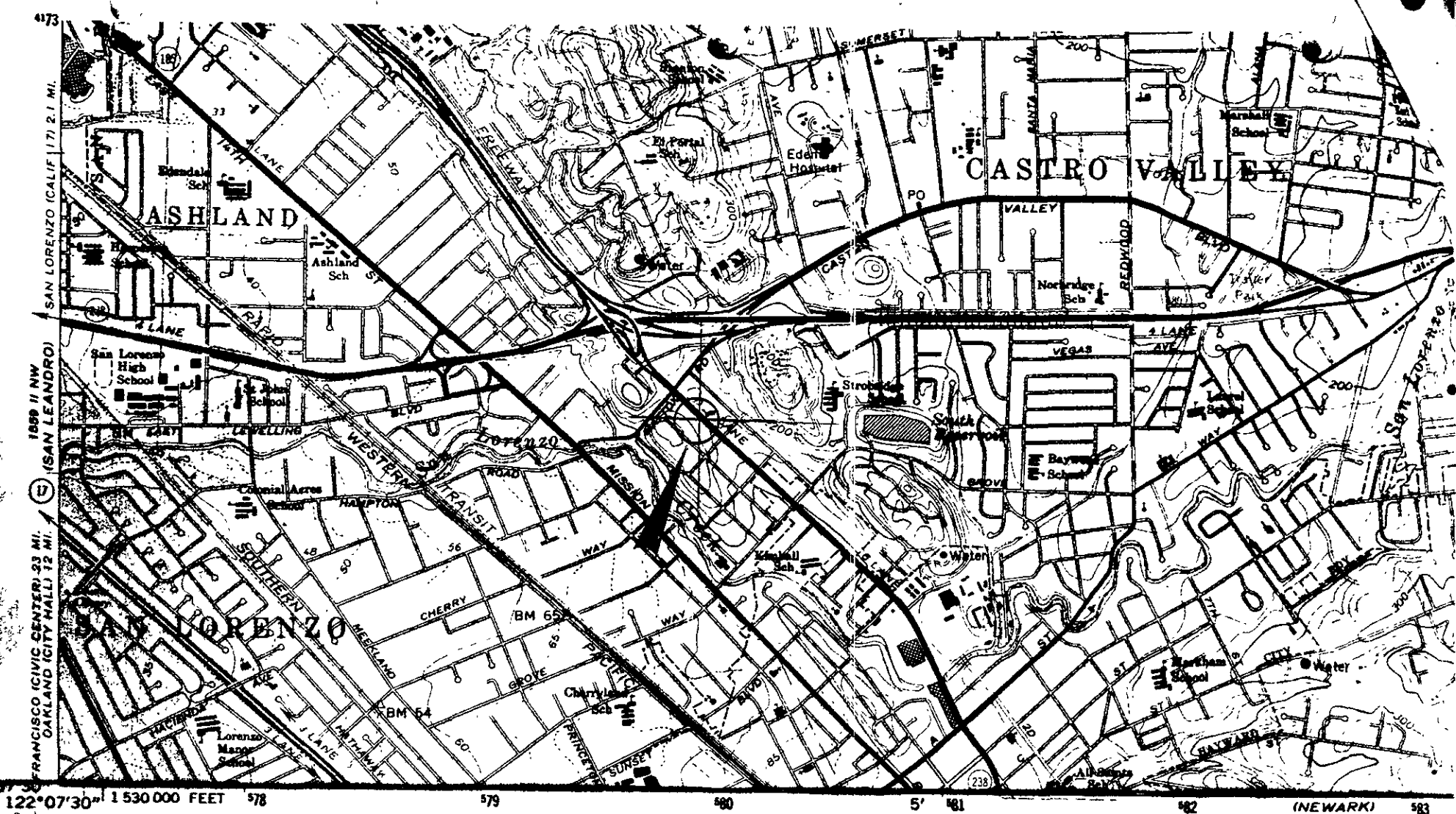

Mapped, edited, and published by the Geological Survey

Control by USGS, USC&GS, USCE, and Alameda County

Topography from aerial photographs by photogrammetric methods and by planetable surveys 1947. Revised from aerial photographs taken 1958. Field check 1959

Polyconic projection

10,000-foot grid based on California coordinate system, zone 3

1000-meter Universal Transverse Mercator grid ticks, zone 10, shown in blue 1927 North American Datum

To place on the predicted North American Datum 1983

move the projection lines 14 meters north and

95 meters east as shown by dashed corner ticks

Red tint indicates areas in which only landmark buildings are shown

There may be private inholdings within the boundaries of the National or State reservations shown on this map

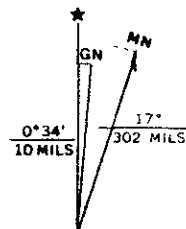

UTM GRID AND 1980 MAGNETIC NORTH DECLINATION AT CENTER OF SHEET

Revisions shown in purple and woodland compiled from aerial photographs taken 1979 and other source data This information not field checked. Map edited 1980

AQUA SCIENCE ENGINEERS, INC.

FIGURE 1:
Site Location Map

21065 Foothill Blvd.
Hayward, Ca

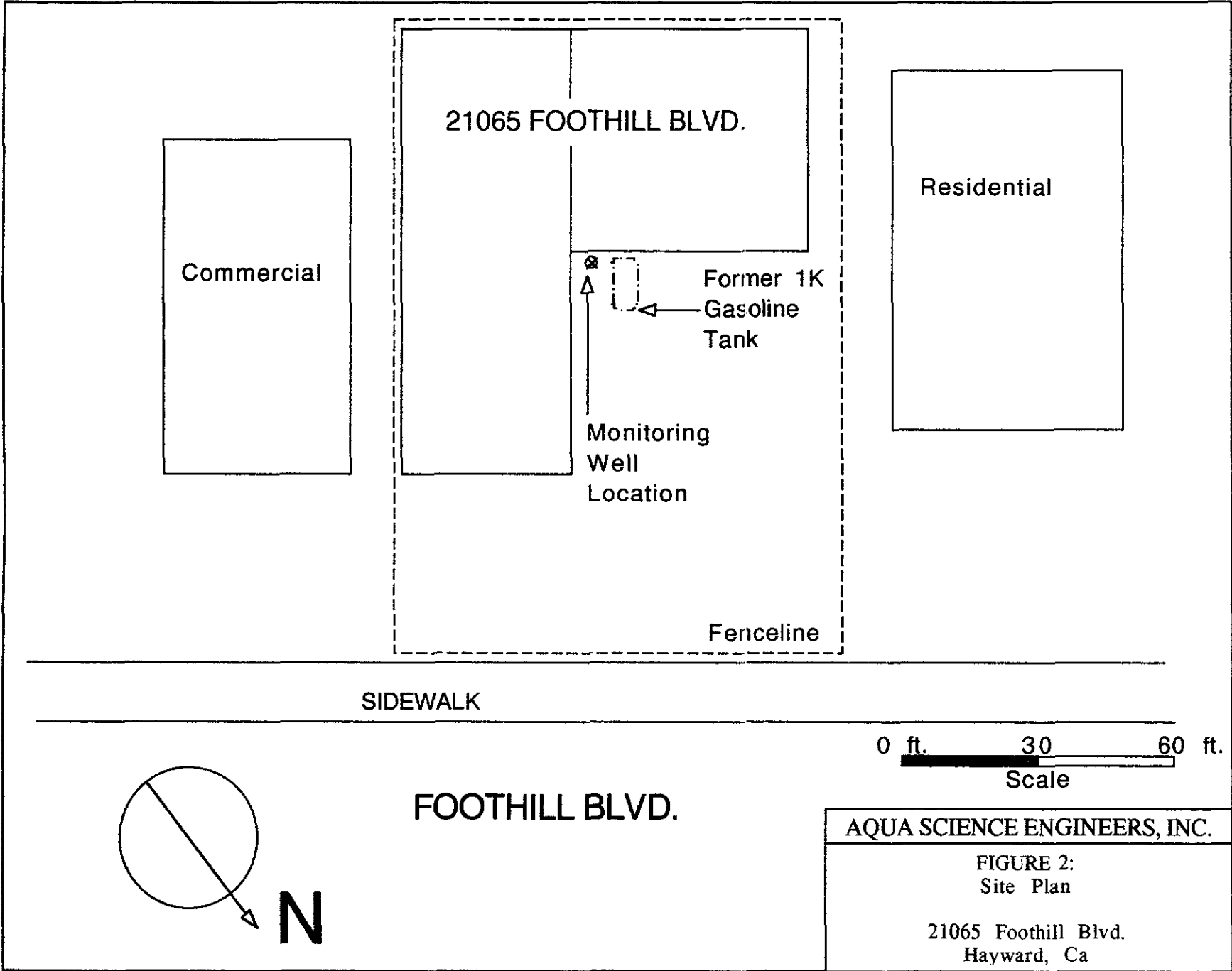

21065 FOOTHILL BLVD.

Commercial

Residential

Former 1K
Gasoline
Tank

Monitoring
Well
Location

Fenceline

SIDEWALK

0 ft. 30 60 ft.
Scale

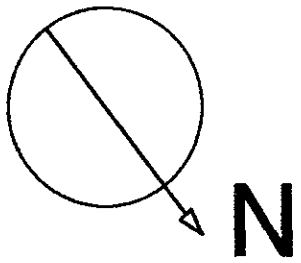

FOOTHILL BLVD.

AQUA SCIENCE ENGINEERS, INC.

FIGURE 2:
Site Plan

21065 Foothill Blvd.
Hayward, Ca

TABLE ONE: RESULTS OF WATER SAMPLE ANALYSES
21065 Foothill Blvd., Hayward, CA

Monitoring Well MW-1

Sample Date	TPH gas mg/l	benzene mg/l	toluene ug/l	ethyl benzene ug/l	total xylenes ug/l
2/3/92	N.D.	N.D.	N.D.	N.D.	N.D.
4/29/92	N.D.	N.D.	N.D.	N.D.	N.D.

WELL SAMPLING FIELD LOG

ASE environmental

Project: Breitenbach III
21065 Foothill Blvd.
Hayward, CA

1041 Shary Circle
Concord, CA 94518
(510) 685-6700

Project Name: *Breitenbach III*

Project Address: *21065 Foothill Blvd., Hayward, CA*

Job # *2544* Date of sampling: *4/29/92* Completed by: *S. DeHope*

Well Number / Designation: *MW-1*

Top of casing elevation: *Not measured*

Total depth of well casing: *43'-9"*

Well diameter: *2"*

Depth to water (before sampling): *33'-0"*

Depth of floating product if any: *None*

Depth of well casing in water: *10'-9"*

Req'd volume of groundwater to be purged before sampling: *8.5 gallons*

Approximate volume of groundwater purged: *8.5 gallons*

Type of seal at grade: *portland cement at grade*

Type of cap on the casing: *locking type expanded plug*

Is the seal water tight? *yes* Is the cap water tight? *yes*

Number of samples (containers) collected: *(2) VOA vials.*

Did 40 ml VOA vials have headspace: *No*

Were sample containers chilled after sampling & for delivery?: *Yes*

Are Chain of Custody documents accompanying the samples?: *Yes*

Sample temperature: *not tested*

Sample pH: *not tested*

Test method: *N/A*

Physical description of water during initial bailing period: *turbid lt. brown.*

Physical description of water sample: *turbid lt. brown.*

Type of analysis requested: *TPH Gasoline (EPA 5030/8015)*
BTEX (EPA 602)

Type of bailer/sampling equipment used: *1.5" x 3' PVC bailer*

Equipment cleaning procedures: *TSP wash, tap water rinse*

Disposition of bailed water volume: *temporarily retained, discharged to the ground surface.*

CHROMALAB, INC.

5 DAYS TURNAROUND

Analytical Laboratory (E694)

May 6, 1992

ChromaLab File No.: 0492274

AQUA SCIENCE ENGINEERS, INC.

Attn: Steve DeHope

RE: One water sample for Gas/BTEX analysis

Project Name: BREITENBACK III

Project Number: 2544

Date Sampled: April 29, 1992

Date Submitted: April 29, 1992

Date Extracted: May 5, 1992

Date Analyzed: May 5, 1992

RESULTS:

Sample I.D.	Gasoline ($\mu\text{g/L}$)	Benzene ($\mu\text{g/L}$)	Toluene ($\mu\text{g/L}$)	Ethyl Benzene ($\mu\text{g/L}$)	Total Xylenes ($\mu\text{g/L}$)
MW-1	N.D.	N.D.	N.D.	N.D.	N.D.
BLANK	N.D.	N.D.	N.D.	N.D.	N.D.
SPIKE RECOVERY	98%	94%	100%	97%	102%
DUP. SPIKE RECOVERY	----	93%	96%	99%	102%
DETECTION LIMIT	50	0.5	0.5	0.5	0.5
METHOD OF ANALYSIS	5030/8015	602	602	602	602

ChromaLab, Inc.

Mary Cappelli
Analytical Chemist

Eric Tam
Laboratory Director

