



November 26, 1991

Larry Seto
Alameda County Health Agency

Re: Work to date at 5775 Broadway, Oakland

Dear Mr. Seto:

This letter outlines the soil boring and excavation work performed to date at the former Chevron Station at 5775 Broadway, Oakland.

Attached are the site map and laboratory reports. Soil boring and sampling was conducted on November 7, 1991. As indicated in the laboratory report, only oil and grease was detected, and only in soil collected from borings B-1, B-2, B-3, and B-6. Mr. Mohammed Ali of California Pacific Investments, the owner, decided to excavate in the area of the borings to remove the soil with oil and grease.

Excavation was conducted on November 15, 1991. Samples collected from the pits retained the boring names, B-1 through B-3, and B-6. Samples collected on the north side of the pit were designated A, on the east side B, on the south side C, and on the west side D. The depth at which the sample was collected is added to the sample name. Pits B-1, B-3, and B-6 were excavated to bedrock. Pit B-2 was excavated to 10 feet below surface. The soil sample collected at 10 feet below surface from boring B-2 in which oil and grease was not detected is considered a bottom confirmatory sample for that pit. The upper 5 feet of soil from pits B-1 and B-6 were stockpiled separately as "clean" soil based on soil boring sample results.

During excavation of pit B-6, soil with gasoline odor was noted between 8 and 11 feet below surface. The former tank pit was dug into the bedrock to 11 feet. All of the soil was removed from the tank pit and stockpiled. The sides and bottom of pit B-6 are bedrock and therefore it was not possible to collect confirmatory samples.

On November 21, 1991, additional excavation was conducted along sides of excavation where oil and grease was detected in the previous excavation soil samples. The laboratory reports indicate that oil and grease was detected on the north, south, and west sides of pit B-2, but under 20 mg/kg. However, in the center portion of the south side of pit B-2, a "veinlet" of dark, presumably oil and grease bearing, soil continues to the south.



RIEDEL ENVIRONMENTAL
SERVICES INC

Riedel Environmental Services, Inc., requests, on behalf of California Pacific Investments (CPI), that removal of oil and grease from the soil be considered complete, except for the apparent oil and grease "veinlet" extending south of pit B-2. Additionally, it is requested that CPI be allowed to backfill B-1, B-3, B-6, and part of B-2 with the "clean" stockpiled soil so that sufficient space can be made to continue excavation along the south side of B-2.

Please let me know your thoughts on the matter at your earliest convenience. I may be reached at 222-7810.

Thank You.

Sincerely,
RIEDEL ENVIRONMENTAL SERVICES, INC.

Gail M. Jones
Senior Geologist



Scale

0 10 20 Feet

DRAWING NUMBER
CHECKED BY
APPROVED BY
DATE
BY

HP Hydropunch
 CP Cone Penetrometer
 S Hand Auger Samples
 B Proposed Soil Boring



Outline excavation with sample location and initial excavation boundary

(4) Former 1,000 gal. Tanks

Former 6,000 gal. Tank

Former Piping

Former 7,500 gal. Tank

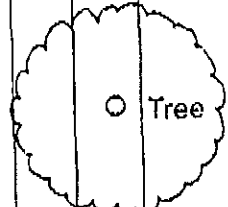
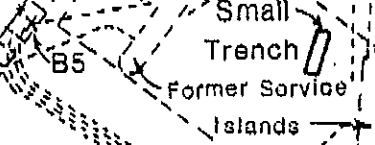
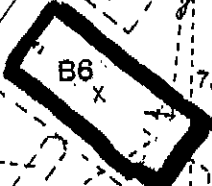

Lawton Ave.

Broadway

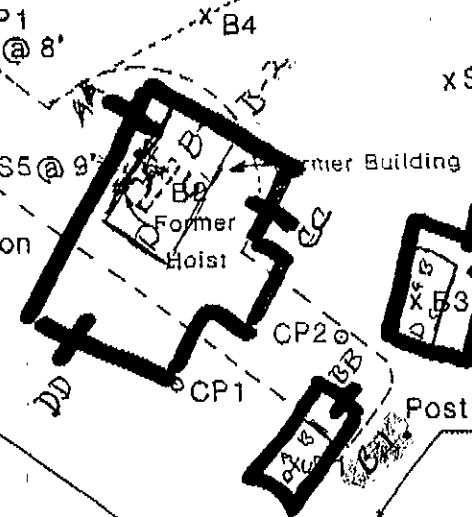
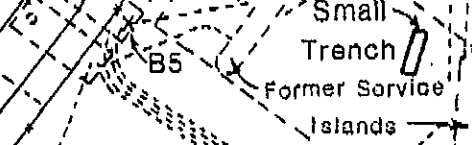

Former Building

Former Hoist

Former Waste Oil Tank

Excavation

HP1

S4 @ 8'

S2

S5 @ 9'

B4

x S3

CP2

CP1

Post

Fence

Gate

Driveway

Site Plan

Broadway at Lawton
 Oakland, CA

FIGURE
 1

CHROMALAB, INC.

6 DAYS TURNAROUND

Analytical Laboratory (E694)

November 8, 1991

ChromaLab File No.: 1191073

RIEDEL ENVIRONMENTAL SERVICES, INC.

Attn: Gail Jones

RE: Thirteen rush soil samples for Gasoline/BTEX, Diesel, and Oil & Grease analyses

Project Name: CAL. PACIFIC INVESTMENT

Project Number: 4209-9110

Date Sampled: Nov. 7, 1991

Date Extracted: Nov. 8, 1991

Date Submitted: Nov. 7, 1991

Date Analyzed: Nov. 8, 1991

RESULTS:

Sample I.D.	Gasoline (mg/kg)	Diesel (mg/kg)	Benzene (µg/kg)	Toluene (µg/kg)	Ethyl Benzene (µg/kg)	Total Xylenes (µg/kg)	Oil & Grease (mg/kg)
B1, 4.5-5.0'	N.D.	N.D.	N.D.	N.D.	N.D.	N.D.	N.D.
B1, 9.0-9.5'	N.D.	N.D.	N.D.	N.D.	N.D.	N.D.	17
B2, 5.0-5.5'	N.D.	N.D.	N.D.	N.D.	N.D.	N.D.	140
B2, 10.0-10.5'	N.D.	N.D.	N.D.	N.D.	N.D.	N.D.	N.D. <i>original sample</i>
B2, 14.0-14.5'	N.D.	N.D.	N.D.	N.D.	N.D.	N.D.	N.D.
B3, 2.0-2.5'	N.D.	N.D.	N.D.	N.D.	N.D.	N.D.	14
B4, 4.0-4.5'	N.D.	N.D.	N.D.	N.D.	N.D.	N.D.	N.D.
B4, 8.5-9.0'	N.D.	N.D.	N.D.	N.D.	N.D.	N.D.	N.D.
B5, 5.0-5.5'	N.D.	N.D.	N.D.	N.D.	N.D.	N.D.	N.D.
B5, 9.5-10.0'	N.D.	N.D.	N.D.	N.D.	N.D.	N.D.	N.D.
B5, 15.5-16.0'	N.D.	N.D.	N.D.	N.D.	N.D.	N.D.	N.D.
B6, 4.5-5.0'	N.D.	N.D.	N.D.	N.D.	N.D.	N.D.	N.D.
B6, 7.5-8.0'	N.D.	N.D.	N.D.	N.D.	N.D.	N.D.	150
BLANK	N.D.	N.D.	N.D.	N.D.	N.D.	N.D.	N.D.
SPIKE REC.	96.8%	89.7%	98.9%	105.4%	106.9%	107.2%	----
DUP SPIKE REC	82.7%	92.8%	85.4%	88.9%	90.3%	93.8%	----
DET. LIMIT	1.0	1.0	5.0	5.0	5.0	5.0	10
METHOD OF ANALYSIS	5030/ 8015	3550/ 8015	8020	8020	8020	8020	5520 E&F

ChromaLab, Inc.

David Duong
David Duong
Chief Chemist

Eric Tam
Eric Tam
Laboratory Director

CHROMALAB, INC.

Analytical Laboratory (E694)

5 DAYS TURNAROUND

November 18, 1991

ChromaLab File No.: 1191161

RIEDEL ENVIRONMENTAL SERVICES

Attn: Gail Jones

RE: Twelve rush soil samples for Oil & Grease analysis

Project Name: CAL PACIFIC INVESTMENT

Project Number: 4209-9110

Date Sampled: Nov. 15, 1991

Date Submitted: Nov. 15, 1991

Date Extracted: Nov. 18, 1991

Date Analyzed: Nov. 18, 1991

RESULTS:

Sample I.D.	Oil & Grease (mg/kg)
-------------	----------------------

B-1-A-12	N.D.
B-1-B-11	14
B-1-C-11.6	N.D.
B-1-D-10.5	<u>N.D.</u>
B-2-A-5	13
B-2-B-5	N.D.
B-2-C-5	18
B-2-D-5	<u>280 west side</u>
B-3-A-2.5	N.D.
B-3-B-2.5	11
B-3-C-2.6	19
B-3-D-3	N.D.

BLANK

N.D.

DETECTION LIMIT

10

METHOD OF ANALYSIS

5520 E&F

ChromaLab, Inc.

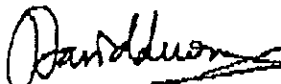
David Duong
Chief Chemist

Eric Tam
Laboratory Director

CHROMALAB, INC.

5 DAYS TURNAROUND

Analytical Laboratory (E694)

November 22, 1991

ChromaLab File No.: 1191230

RIEDEL ENVIRONMENTAL SERVICES, INC.

Attn: Gail Jones

RE: Six rush soil samples for Oil & Grease analysis

*Agtr additional
Excavation.*

Project Name: CAL PAC INVESTMENTS

Project Number: 4709-9110

Date Sampled: Nov. 21, 1991

Date Submitted: Nov. 21, 1991

Date Extracted: Nov. 22, 1991

Date Analyzed: Nov. 22, 1991

RESULTS:

Sample I.D. Oil & Grease (mg/kg)

B1-BB-11	N.D.
B2-AA-6	14
B2-CC-5	19
B2-DD-6	11
B3-BB	N.D.
B3-CC-3	N.D.

BLANK	N.D.
DETECTION LIMIT	10
METHOD OF ANALYSIS	6520 E&F

ChromaLab, Inc.

David Duong
David Duong
Chief Chemist

Eric Tam (by TD)
Eric Tam
Laboratory Director