

DUBLIN HONDA
7099 AMADOR PLAZA RD., DUBLIN CA. 94568

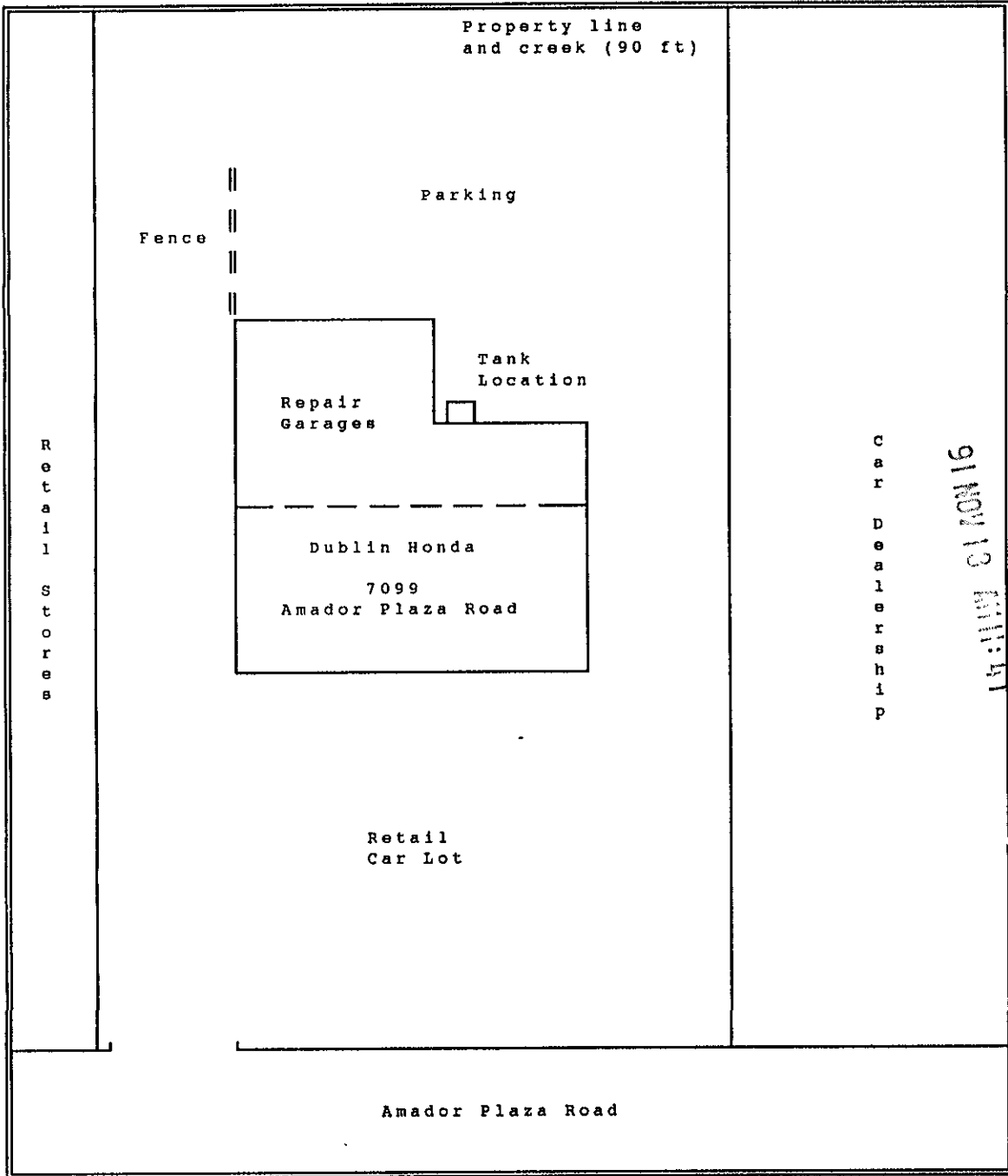

91 NOV 13 09:11:41

SITE CHARACTERIZATION MAP

Figure 2

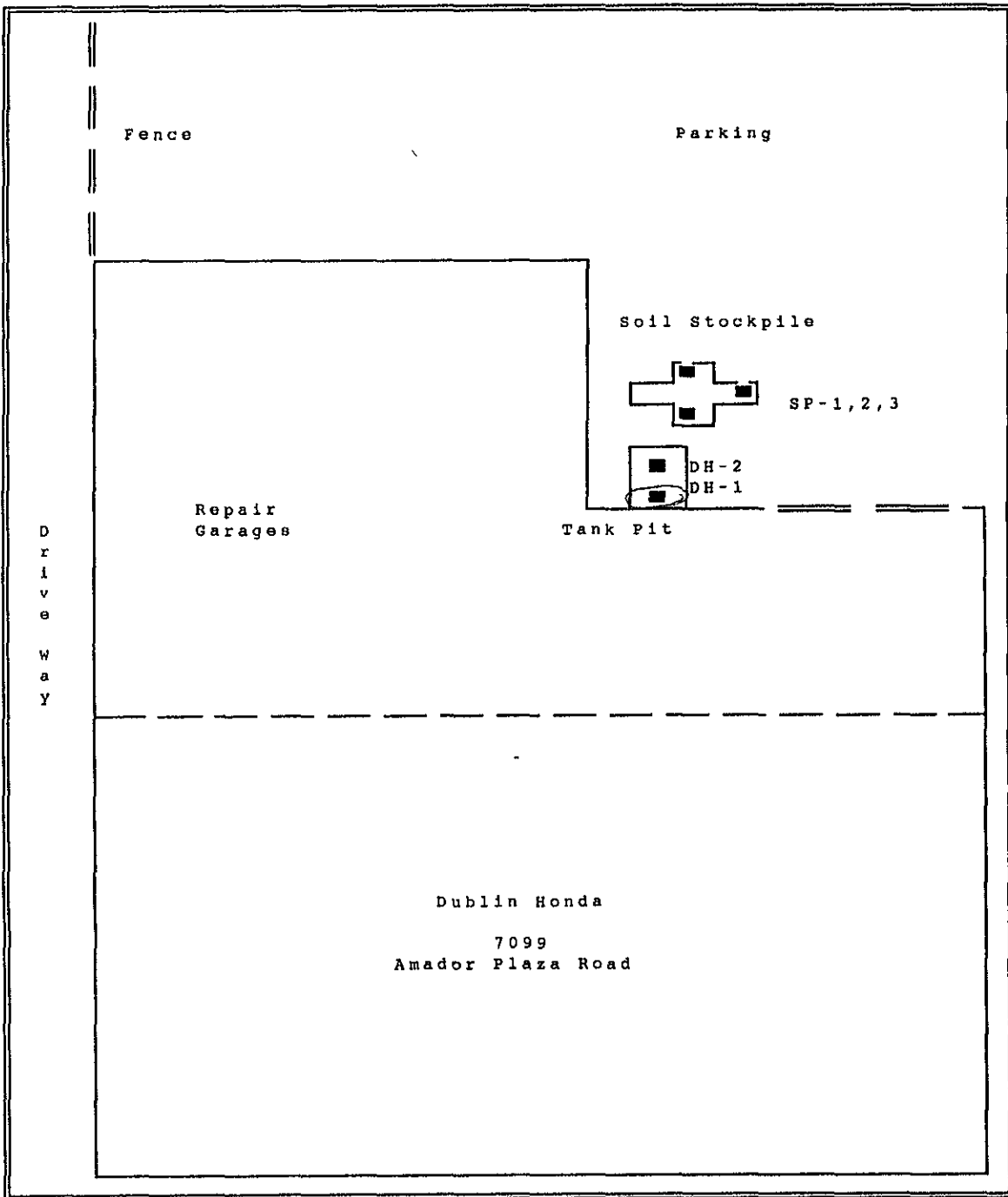

Scale: 1" = 20 feet

SAMPLING LOCATION MAP

Figure 3

CHROMALAB, INC.

5 DAYS TURNAROUND

Analytical Laboratory (E694)

October 8, 1991

ChromaLab File No.: 1091014

THE ENVIRONMENTAL CONSTRUCTION CO. Attn: Ron LeGue

RE: Three soil samples for Gasoline/BTEX, Diesel, Oil & Grease, Cadmium, Chromium, Lead, Nickel, and Zinc analyses

Project Name: DUBLIN HONDA
Project Location: 7099 Amador Plaza Rd.
Project Number: 319
Date Sampled: Oct. 1, 1991
Date Extracted: Oct. 3-7, 1991

Date Submitted: Oct. 1, 1991
Date Analyzed: Oct. 3-7, 1991

RESULTS:

TPHG/BTEX 130
TPHd 130
O&G 95

Sample I.D.	Gasoline (mg/kg)	Diesel (mg/kg)	Benzene (µg/kg)	Toluene (µg/kg)	Ethyl Benzene (µg/kg)	Total Xylenes (µg/kg)
DH-1	82	N.D.	23	11	130	670
DH-2	11	N.D.	N.D.	N.D.	17	100
SP-1,2,3*	2.6	N.D.	5.0	34	16	140
BLANK	N.D.	N.D.	N.D.	N.D.	N.D.	N.D.
SPIKE REC.	98.0%	93.0%	89.3%	88.3%	89.5%	90.8%
DUP SPIKE REC	91.8%	100.7%	83.3%	84.2%	87.2%	82.7%
DET. LIMIT	1.0	1.0	5.0	5.0	5.0	5.0
METHOD OF ANALYSIS	5030/ 8015	3550/ 8015	8020	8020	8020	8020

Sample I.D.	Oil & Grease (mg/kg)	Cadmium (mg/kg)	Chromium (mg/kg)	Lead (mg/kg)	Nickel (mg/kg)	Zinc (mg/kg)
DH-1	2700	0.412	3.19	3.38	2.70	7.03
DH-2	820	0.483	3.59	3.79	3.04	7.26
SP-1,2,3*	3000	0.549	3.27	4.76	3.19	14.5
BLANK	N.D.	N.D.	N.D.	N.D.	N.D.	N.D.
SPIKE REC.	----	91.4%	88.7%	95.2%	94.6%	100.8%
DUP SPIKE REC	----	89.5%	90.1%	101.5%	93.0%	103.5%
DET. LIMIT	10	0.005	0.05	0.05	0.04	0.005
METHOD OF ANALYSIS	5520 E&F	7130	7190	7420	7520	7950

*Composited soil sample.

ChromaLab, Inc.

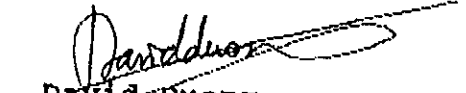
David Duong
Chief Chemist

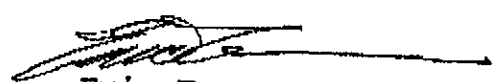
Eric Tam
Laboratory Director

Analytical Laboratory (E694)

October 8, 1991

ChromaLab File # 1091014 A

Client: The Environmental Construction Company

Attn: Ron LeGue

Date Sampled: Oct. 01, 1991

Date Submitted: Oct. 01, 1991

Date Analyzed: Oct. 08, 1991

Project Name: Dublin Honda

Project Number: 319

Sample I.D.: DH-1

Method of Analysis: 8010

Detection Limit: 5.0 µg/kg

COMPOUND NAME	µg/kg	Spike Recovery	
CHLOROMETHANE	N.D.	---	---
VINYL CHLORIDE	N.D.	---	---
BROMOMETHANE	N.D.	---	---
CHLOROETHANE	N.D.	---	---
TRICHLOROFLUOROMETHANE	N.D.	91.8%	92.5%
1,1-DICHLOROETHENE	N.D.	---	---
METHYLENE CHLORIDE	N.D.	---	---
1,2-DICHLOROETHENE (TOTAL)	N.D.	---	---
1,1-DICHLOROETHANE	N.D.	---	---
CHLOROFORM	N.D.	96.8%	97.2%
1,1,1-TRICHLOROETHANE	N.D.	---	---
CARBON TETRACHLORIDE	N.D.	---	---
1,2-DICHLOROETHANE	N.D.	---	---
TRICHLOROETHENE	N.D.	---	---
1,2-DICHLOROPROPANE	N.D.	---	---
BROMODICHLOROMETHANE	N.D.	---	---
2-CHLOROETHYL VINYLETHER	N.D.	---	---
TRANS-1,3-DICHLOROPROPENE	N.D.	---	---
CIS-1,3-DICHLOROPROPENE	N.D.	---	---
1,1,2-TRICHLOROETHANE	N.D.	90.5%	93.7%
TETRACHLOROETHENE	85	---	---
DIBROMOCHLOROMETHANE	N.D.	---	---
CHLOROBENZENE	N.D.	---	---
BROMOFORM	N.D.	---	---
1,1,2,2-TETRACHLOROETHANE	N.D.	---	---
1,3-DICHLOROBENZENE	N.D.	---	---
1,4-DICHLOROBENZENE	N.D.	---	---
1,2-DICHLOROBENZENE	N.D.	96.1%	98.2%

ChromaLab, Inc.

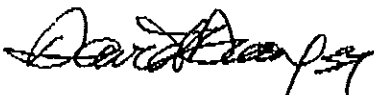
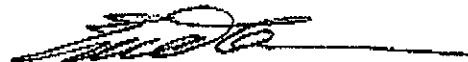
David Duong
Senior ChemistEric Tam
Lab Director

Analytical Laboratory (L684)

October 8, 1991

ChromaLab File # 1091014 B

Client: The Environmental Construction Company

Attn: Ron LeGue

Date Sampled: Oct. 01, 1991

Date Submitted: Oct. 01, 1991

Date Analyzed: Oct. 08, 1991

Project Name: Dublin Honda

Project Number: 319

Sample I.D.: DH-2

Method of Analysis: 8010

Detection Limit: 5.0 µg/kg

COMPOUND NAME	µg/kg	Spike Recovery	
CHLOROMETHANE	N.D.	---	---
VINYL CHLORIDE	N.D.	---	---
BROMOMETHANE	N.D.	---	---
CHLOROETHANE	N.D.	---	---
TRICHLOROFLUOROMETHANE	N.D.	91.8%	92.5%
1,1-DICHLOROETHENE	N.D.	---	---
METHYLENE CHLORIDE	N.D.	---	---
1,2-DICHLOROETHENE (TOTAL)	N.D.	---	---
1,1-DICHLOROETHANE	N.D.	---	---
CHLOROFORM	N.D.	96.8%	97.2%
1,1,1-TRICHLOROETHANE	N.D.	---	---
CARBON TETRACHLORIDE	N.D.	---	---
1,2-DICHLOROETHANE	N.D.	---	---
TRICHLOROETHENE	N.D.	---	---
1,2-DICHLOROPROPANE	N.D.	---	---
BROMODICHLOROMETHANE	N.D.	---	---
2-CHLOROETHYL VINYLETHER	N.D.	---	---
TRANS-1,3-DICHLOROPROPENE	N.D.	---	---
CIS-1,3-DICHLOROPROPENE	N.D.	---	---
1,1,2-TRICHLOROETHANE	N.D.	90.5%	93.7%
TETRACHLOROETHENE	20	---	---
DIBROMOCHLOROMETHANE	N.D.	---	---
CHLOROBENZENE	N.D.	---	---
BROMOFORM	N.D.	---	---
1,1,2,2-TETRACHLOROETHANE	N.D.	---	---
1,3-DICHLOROBENZENE	N.D.	---	---
1,4-DICHLOROBENZENE	N.D.	---	---
1,2-DICHLOROBENZENE	N.D.	96.1%	98.2%

ChromaLab, Inc.



David Duong
Senior Chemist



Eric Tam
Lab Director

2299 Omega Road, #1 • San Ramon, California 94583
510/831-1788 • Facsimile 510/831-8798
Federal ID #68-0140157

CHROMALAB, INC.

Analytical Laboratory (E694)

5 DAYS TURNAROUND

October 8, 1991

ChromaLab File # 1091014 C

Client: The Environmental Construction Company

Attn: Ron LeGue

Date Sampled: Oct. 01, 1991

Date Submitted: Oct. 01, 1991

Date Analyzed: Oct. 08, 1991

Project Name: Dublin Honda

Project Number: 319

Sample I.D.: SP-1,2,3 (COMPOSITE)

Method of Analysis: 8010

Detection Limit: 5.0 µg/kg

COMPOUND NAME	µg/kg	Spike Recovery	
CHLOROMETHANE	N.D.	---	---
VINYL CHLORIDE	N.D.	---	---
BROMOMETHANE	N.D.	---	---
CHLOROETHANE	N.D.	---	---
TRICHLOROFLUOROMETHANE	N.D.	---	---
1,1-DICHLOROETHENE	N.D.	91.8%	92.5%
METHYLENE CHLORIDE	N.D.	---	---
1,2-DICHLOROETHENE (TOTAL)	N.D.	---	---
1,1-DICHLOROETHANE	N.D.	---	---
CHLOROFORM	N.D.	---	---
1,1,1-TRICHLOROETHANE	N.D.	96.8%	97.2%
CARBON TETRACHLORIDE	N.D.	---	---
1,2-DICHLOROETHANE	N.D.	---	---
TRICHLOROETHENE	N.D.	---	---
1,2-DICHLOROPROPANE	N.D.	---	---
BROMODICHLOROMETHANE	N.D.	---	---
2-CHLOROETHYL VINYLETHER	N.D.	---	---
TRANS-1,3-DICHLOROPROPENE	N.D.	---	---
CIS-1,3-DICHLOROPROPENE	N.D.	---	---
1,1,2-TRICHLOROETHANE	N.D.	---	---
TETRACHLOROETHENE	84	90.5%	93.7%
DIBROMOCHLOROMETHANE	N.D.	---	---
CHLOROBENZENE	N.D.	---	---
BROMOFORM	N.D.	---	---
1,1,2,2-TETRACHLOROETHANE	N.D.	---	---
1,3-DICHLOROBENZENE	N.D.	---	---
1,4-DICHLOROBENZENE	N.D.	---	---
1,2-DICHLOROBENZENE	N.D.	96.1%	98.2%

ChromaLab, Inc.

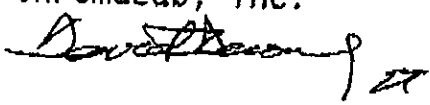
David Duong
Senior Chemist

Eric Tam
Lab Director