

ENVIRONMENTAL
PROTECTION

95 AUG -7 PM 3:39



August 1, 1995

Ms. Eva Chu
Department of Environmental Health
Hazardous Materials Division
80 Swan Way, Room 200
Oakland, CA 94621

Dear Ms. Chu:

Enclosed for your review and file is a copy of the report from Environmental Technical Services that references the July 10, 1991 removal of two underground gas tanks and the June 29, 1995 testing of stockpiled soil which show no traces of contamination.

Please remove the Alameda Golf Course from the Hazardous Materials Division's UGT Cleanup Sites list, or in future reports list this removal project as completed.

Thank you for your assistance. If you have any questions, please call me at 748-4653.

Very truly yours,

A handwritten signature in cursive script that reads "Fred C. Framsted".

Fred C. Framsted
Golf Operations Manager

FCF:jaa
Attachment

Chuck Corica Golf Complex

#1 Clubhouse Memorial Drive · 94501
Tel: 510-748-4653 Fax: 510-522-0848



ENVIRONMENTAL TECHNICAL SERVICES

AN ENVIRONMENTAL CONSULTING FIRM

(800) 200-4ETS

A REPORT DOCUMENTING PREVIOUS
ENVIRONMENTAL INVESTIGATIONS AND
THE SAMPLING OF STOCKPILED SOIL:

AT:

ALAMEDA GOLF COURSE
ONE MEMORIAL CLUBHOUSE DRIVE
ALAMEDA, CALIFORNIA

DATE OF SAMPLING: JUNE 29, 1995

ENVIRONMENTAL
PROTECTION
95 MAR 29 PM 1:26



ENVIRONMENTAL TECHNICAL SERVICES

AN ENVIRONMENTAL CONSULTING FIRM

(800) 200-4ETS

A REPORT DOCUMENTING PREVIOUS ENVIRONMENTAL
INVESTIGATIONS AND THE SAMPLING OF
STOCKPILED SOIL:

AT:

ALAMEDA GOLF COURSE
ONE MEMORIAL CLUBHOUSE DRIVE
ALAMEDA, CALIFORNIA

prepared by:

Helen Mawhinney
ENVIRONMENTAL TECHNICAL SERVICES
Helen A. Mawhinney
Senior Environmental Specialist

07-19-95
Date

JUNE 29, 1995

TABLE OF CONTENTS

1.0	INTRODUCTION	1
2.0	PREVIOUS ENVIRONMENTAL INVESTIGATIONS	1
2.1	TANK REMOVAL	1
2.2	EXCAVATION OF CONTAMINATION SOIL	1
2.3	ORIGINAL TANK REMOVAL, ANALYTICAL RESULTS	
	TABLE IA, ORIGINAL EXCAVATION, TANK PIT SOIL ANALYTICAL RESULTS, 7/10/91	2
2.4	STOCKPILED SOIL	3
2.5	STOCKPILE SOIL ANALYTICAL RESULTS	3
	TABLE IB, STOCKPILE ANALYTICAL RESULTS, 7/10/91	3
2.6	GROUNDWATER SAMPLE COLLECTION AND ANALYTICAL RESULTS	3
	TABLE IC, GROUNDWATER ANALYTICAL RESULTS, 7/10/91	3
2.7	INSTALLATION, PURGING AND SAMPLING OF GROUNDWATER MONITORING WELLS	4
	TABLE II, MONITORING WELL INSTALLATION ANALYTICAL RESULTS, 8/20/92	4
2.8	GROUNDWATER ANALYTICAL RESULTS	
	TABLE III, FOUR CONSECUTIVE QUARTERS	5
3.0	SCOPE OF SERVICES	6
3.1	STOCKPILED SOIL/SAMPLE COLLECTION	6
3.2	SOIL SAMPLE QA/QC	6
3.3	STOCKPILED SOIL ANALYSIS	6
3.4	STOCKPILED SOIL ANALYTICAL RESULTS	
	TABLE IV, STOCKPILED SOIL ANALYTICAL RESULTS JUNE 29, 1995	6
4.0	RELEASE REPORTING	7

APPENDICES

Appendix A

MAPS

Figure 1. Site Location Map

Figure 2. Former Tank Location Map

Figure 3. Excavation and Stockpile Sampling Map

Figure 4. Monitoring Well Location Map

Figure 5. Stockpile Sample Location Map

Appendix B

Stockpile Soil Samples

Analytical Results, June 29, 1995

1.0 INTRODUCTION

The following report documents previous environmental investigations and the sampling of the existing stockpiled soil at the Alameda Golf Course, One Memorial Clubhouse Drive, Alameda, California.

Refer to Appendix A, Figure 1, Site Location Map.

The work was performed at the request of Ms. Eva Chu, Inspector for the Alameda County Office of Environmental Health Department, Hazardous Materials Division.

2.0 PREVIOUS ENVIRONMENTAL INVESTIGATIONS

2.1 Tank Removal

On July 10, 1991 two underground storage tanks (USTs) were removed from the above referenced site. These were one 500-gallon gasoline and one 125-gallon gasoline UST. Groundwater was encountered at 5 feet within the tank pit excavation. Soil samples were collected from the tank pit wall vadose/saturated capillary zone and were analyzed for total petroleum hydrocarbons as gasoline with benzene, toluene, ethylbenzene, and total xylenes (TPH-G, BTEX, EPA Method 5030/8020).

2.2 EXCAVATION OF CONTAMINATED SOIL

The excavation and stockpiling of contaminated soils was performed the same day by Zaccor Corporation. Confirmatory soil samples were collected subsequent to excavation and were found to be without detectable concentrations of previously noted contaminants, with the exception of sample no. 6. The excavation of soil within this area was limited by the presence of an existing monitoring well.

Results of these analysis are located in Table 1A, 1B, and 1C.

2.3 ORIGINAL TANK REMOVAL, ANALYTICAL RESULTS

TABLE IA
SOIL ANALYTICAL RESULTS, ORIGINAL TANK REMOVAL
Total Petroleum Hydrocarbons as Gasoline
with Benzene, Toluene, Ethylbenzene, and Xylenes
July 10, 1991

TPHg and BTEX results reported in ppm

<u>Sample #</u>	<u>TPH-G</u>	<u>B</u>	<u>T</u>	<u>E</u>	<u>X</u>
2	960	3.5	0.10	3.0	13
4	ND	0.011	ND	ND	0.005
5	ND	ND	ND	ND	ND
6	3.0	0.030	0.006	0.023	0.059
7	ND	ND	ND	ND	ND
8	ND	ND	ND	ND	ND

ND = not detected at the lower detection limit

2.4 STOCKPILE SOIL

During the excavation of July 10, 1991, approximately 40 cubic yards of contaminated soil was stockpiled and placed on Visqueen. Composite stockpile soil samples were collected and analyzed for total petroleum hydrocarbons as gasoline with benzene, toluene, ethylbenzene, and total xylenes. See Table 1B for analytical results. The stockpiled soil was covered with Visqueen pending analysis and disposal.

2.5 STOCKPILE ANALYTICAL RESULTS

TABLE 1B
STOCKPILE ANALYTICAL RESULTS
JULY 10, 1991

TPHg and BTEX results reported in ppm

<u>Composite Sample#</u>	<u>TPH-G</u> mg/kg	<u>B</u> mg/kg	<u>T</u> mg/kg	<u>E</u> mg/kg	<u>X</u> mg/kg
1A, 1B, 1C	2000	1.2	2.8	2.6	26
3A-3C	250	0.52	0.45	0.65	5.4
9A-9D	ND	ND	ND	ND	ND
10A-10D	11	0.13	0.48	0.29	1.9

ND = not detected at the lower detection limit

2.6 GROUNDWATER SAMPLE COLLECTION AND ANALYTICAL RESULTS

One groundwater sample was collected from the tank excavation using a clean stainless steel bailer. The groundwater sample was decanted into a one-liter amber bottle and two volatile organic analysis vials (VOAs) to a positive meniscus eliminating headspace. Refer to Table 1C, Groundwater Analytical Results.

TABLE 1C
GROUNDWATER ANALYTICAL RESULTS
JULY 10, 1991

Results in ug/L

<u>Sample#</u>	<u>TPH-G</u>	<u>B</u>	<u>T</u>	<u>E</u>	<u>X</u>
TPW-1	8,200	210	ND	270	1,200

ND = not detected at the lower detection limit

**2.7 INSTALLATION, PURGING AND SAMPLING OF GROUNDWATER
MONITORING WELLS**

Three groundwater monitoring wells were installed on August 20, 1992. These wells were purged and sampled for four consecutive quarters beginning September 5, 1992, January 11, 1993, May 4, 1993, and July 29, 1993. The wells were purged using a clean stainless steel bailer (1.5" diameter by 3.0' length). Subsequent to purging each well was sampled using a clean stainless steel bailer. The groundwater sample collected was analyzed for total petroleum hydrocarbons as gasoline with benzene, toluene, ethylbenzene, and total xylenes (TPHg & BTEX using EPA Method 5030/602).

**TABLE II
MONITORING WELL INSTALLATION
SOIL ANALYTICAL RESULTS
Total Petroleum Hydrocarbons as Gasoline
with Benzene, Toluene, Ethylbenzene, and Xylenes
August 20, 1992**

TPHg and BTEX results reported in ppm

<u>Sample#</u>	<u>Depth</u>	<u>TPH-G</u>	<u>B</u>	<u>T</u>	<u>E</u>	<u>X</u>
MW-1	4.0-4.5'	ND	ND	ND	ND	ND
MW-2	4.0-4.5'	ND	ND	ND	ND	ND
MW-3	4.5-5.0'	ND	ND	ND	ND	ND
SB-1	4.5-5.0'	1.8	ND	ND	ND	ND

ND = not detected at the lower detection limit

2.8 GROUNDWATER ANALYTICAL RESULTS

TABLE III
 GROUNDWATER ANALYTICAL RESULTS
 TOTAL PETROLEUM HYDROCARBONS AS GASOLINE
 WITH BENZENE, TOLUENE, ETHYLBENZENE, AND TOTAL XYLENES
 Results reported in ug/L

<u>Sample#</u>	<u>TPHg</u>	<u>B</u>	<u>T</u>	<u>E</u>	<u>X</u>	<u>Total Lead</u>
MW-1						
DATE						
9-5-92	ND	ND	ND	ND	ND	ND
1-11-93	ND	ND	ND	ND	ND	NA
5-04-93	ND	ND	ND	ND	ND	NA
7-29-93	ND	ND	ND	ND	ND	NA
MW-2						
DATE						
9-5-92	ND	ND	ND	ND	ND	6.3
1-11-93	ND	ND	ND	ND	ND	NA
5-04-93	ND	ND	ND	ND	ND	NA
7-29-93	ND	ND	ND	ND	ND	NA
MW-3						
DATE						
9-5-92	ND	ND	ND	ND	ND	ND
1-11-93	ND	ND	ND	ND	ND	NA
5-04-93	ND	ND	ND	ND	ND	NA
7-29-93	ND	ND	ND	ND	ND	NA

ND - not detected at lower detection limit
 NA - not analyzed for this constituent

3.0 SCOPE OF SERVICES

Environmental Technical Services was retained by Mr. Fred Framsted of the Alameda Golf Course to perform the following scope of work. On June 29, 1995 three discrete stockpile soil samples were collected and transported to a certified analytical laboratory for analysis.

3.1 STOCKPILED SOIL/SAMPLE COLLECTION

Three stockpiled soil samples were collected and designated as SP1, SP2, and SP3. Stockpile sample SP1 was collected four feet below the stockpile surface; SP2 was collected three feet below the surface and SP3 was collected two feet below the surface. Each sample was collected using a shovel to remove the soil from each sample location. A clean six-inch stainless steel sleeve was driven into the remaining soil.

3.2 SOIL SAMPLE QA/QC

Soil sampling was accomplished by packing the soil into the stainless steel sleeve to eliminate headspace. Each end of the sleeve was immediately covered with a teflon sheet, fitted with a plastic cap, sealed with teflon tape, labeled, and placed on ice under chain of custody and transported to a certified hazardous waste analytical laboratory.

3.3 STOCKPILED SOIL ANALYSIS

Each stockpile soil sample was analyzed for total petroleum hydrocarbons as gasoline with benzene, toluene, ethylbenzene, and xylenes using EPA Method 5020/8015.

3.4 STOCKPILED SOIL ANALYTICAL RESULTS

TABLE IV
STOCKPILED SOIL ANALYTICAL RESULTS
TOTAL PETROLEUM HYDROCARBONS AS GASOLINE
WITH BENZENE, TOLUENE, ETHYLBENZENE, AND TOTAL XYLENES
JUNE 29, 1995

Results reported in ppm

<u>Sample#</u>	<u>TPHg</u>	<u>B</u>	<u>T</u>	<u>E</u>	<u>X</u>
SP1	ND	ND	ND	ND	ND
SP2	ND	ND	ND	ND	ND
SP3	ND	ND	ND	ND	ND

ND = not detected at the lower detection limit

4.0 REPORT

Please forward copies of this report, chain of custody documentation, and laboratory analytical reports to the San Francisco Regional Water Quality Control Board, and the Alameda County Department of Environmental Health Department Hazardous Materials Division.

Alameda County
Department of Environmental Health
Hazardous Materials Division
80 Swan Way,
Room 200
Oakland, CA 94621
Attn: Ms. Eva Chu

San Francisco Regional
Water Quality Control Board
2101 Webster Street, Rm 500
Oakland, CA 94621

APPENDIX A

MAPS

VICINITY MAP

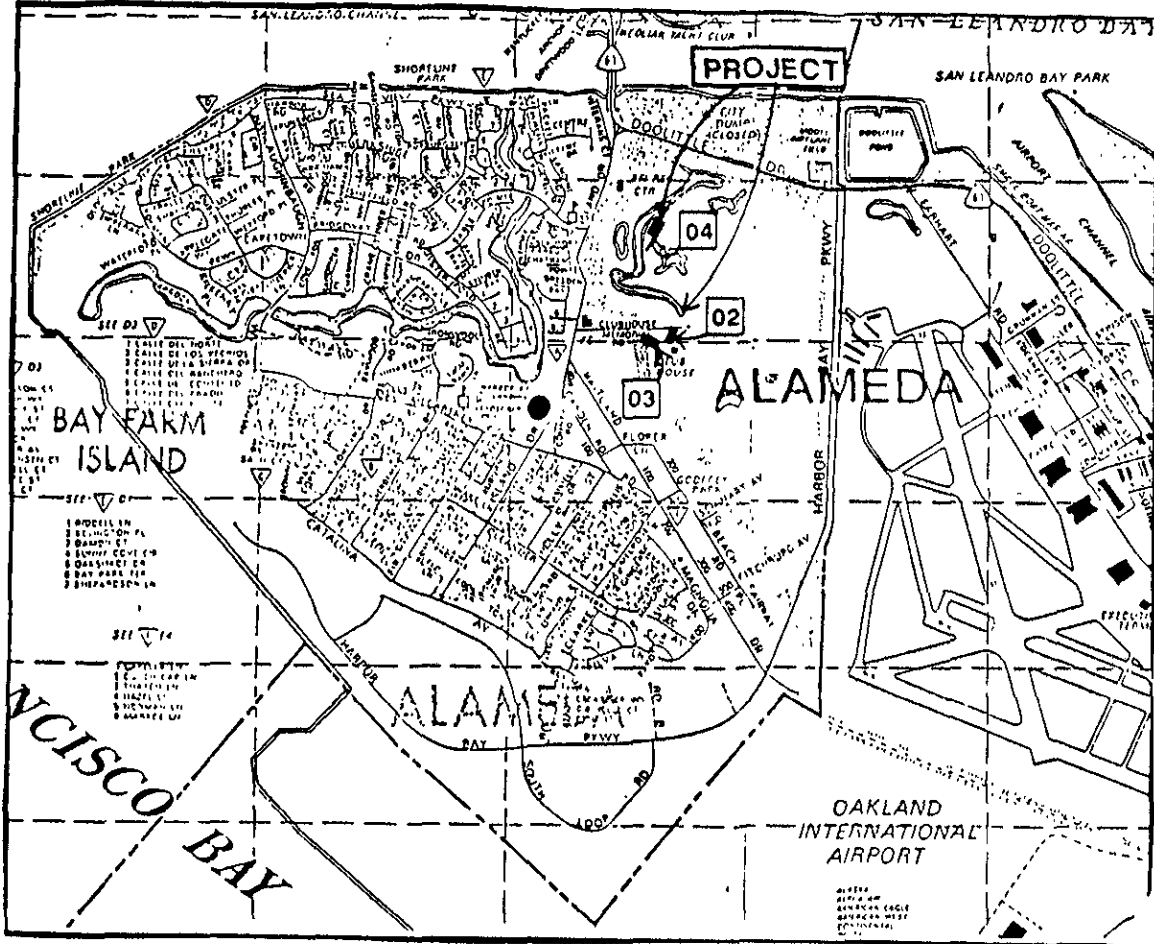

ENVIRONMENTAL
TECHNICAL
SERVICES

Site:

ALAMEDA GOLF COURSE
1 MEMORIAL CLUB HOUSE DRIVE
ALAMEDA, CALIFORNIA

Figure 1.

Site Location Map

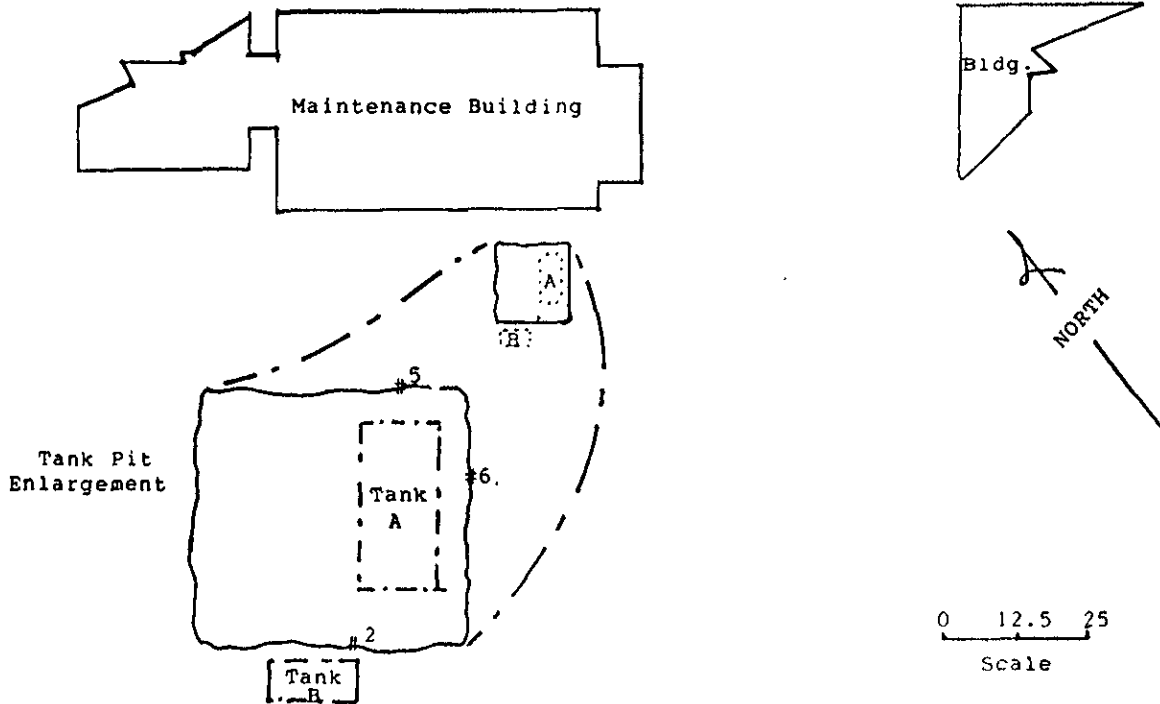

ENVIRONMENTAL
TECHNICAL
SERVICES

SITE:
ALAMEDA GOLF COURSE
ONE MEMORIAL CLUBHOUSE DRIVE
ALAMEDA, CALIFORNIA

FIGURE 2.

TANK LOCATION MAP.

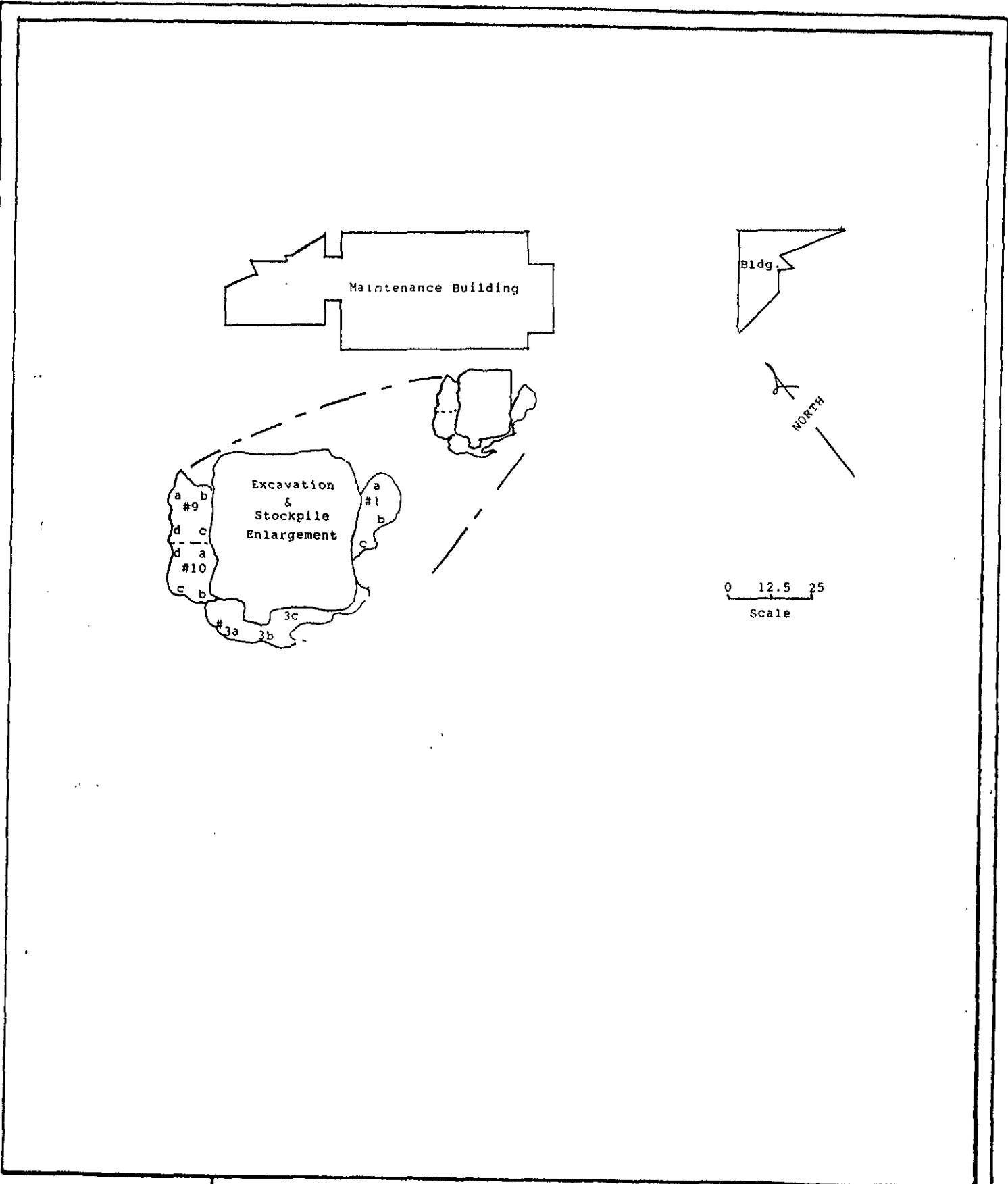

ENVIRONMENTAL
TECHNICAL
SERVICES

SITE:
ALAMEDA GOLF COURSE
ONE MEMORIAL CLUBHOUSE DRIVE
ALAMEDA, CALIFORNIA

FIGURE 3.

EXCAVATION AND STOCKPILE LOCATION MAP

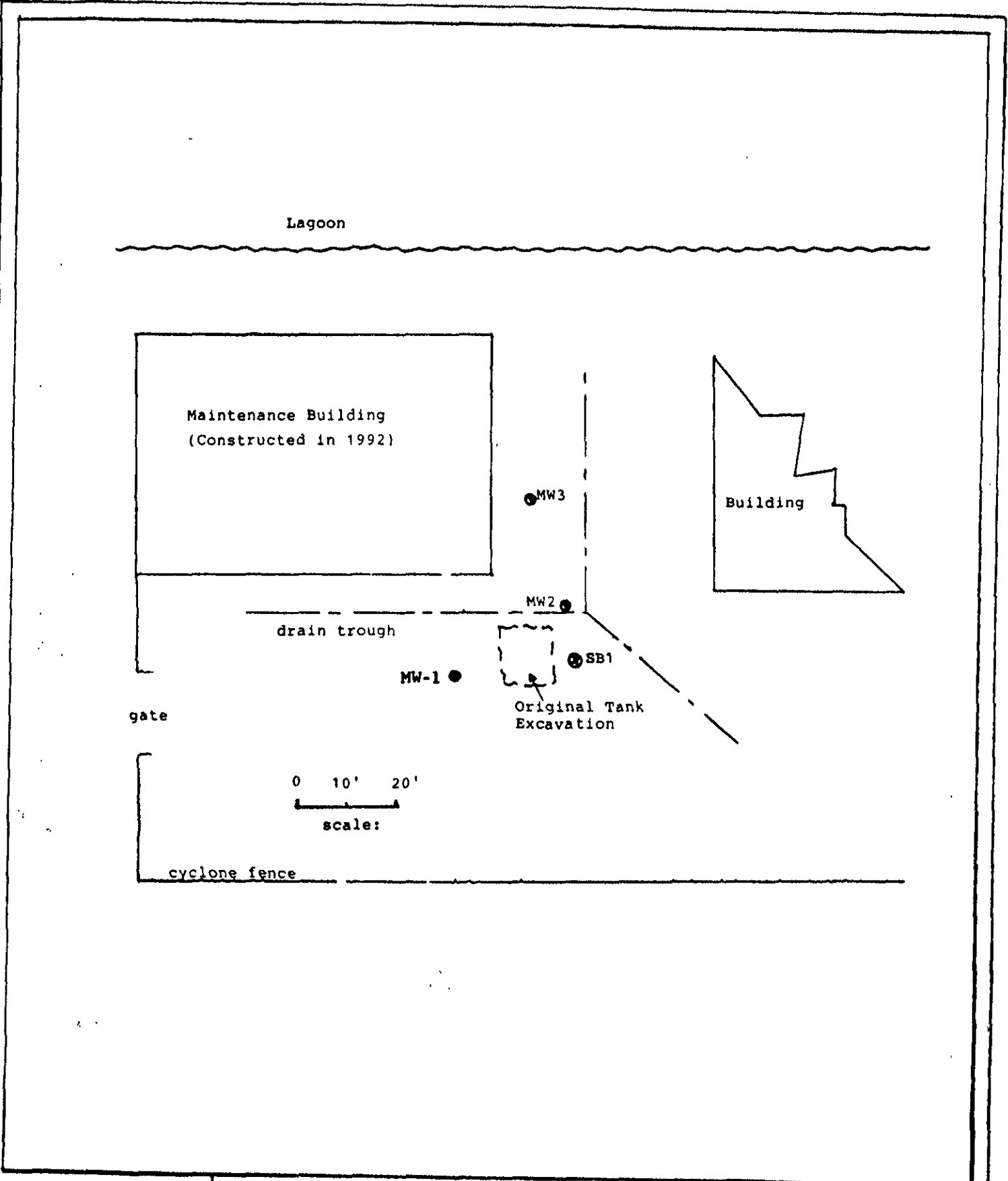

ENVIRONMENTAL
TECHNICAL
SERVICES

SITE:
ALAMEDA GOLF COURSE
ONE MEMORIAL CLUBHOUSE DRIVE
ALAMEDA, CALIFORNIA

FIGURE 4.

MONITORING WELL LOCATION MAP

MEMORIAL CLUBHOUSE DRIVE

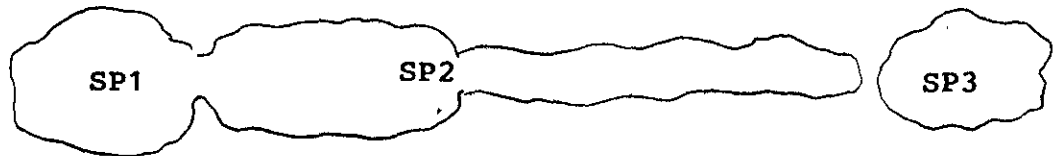

0 10'
scale

ENVIRONMENTAL
TECHNICAL
SERVICES

SITE:
ALAMEDA GOLF COURSE
ONE MEMORIAL CLUBHOUSE DRIVE
ALAMEDA, CALIFORNIA

FIGURE 5.

STOCKPILE SAMPLE LOCATION MAP

APPENDIX B

STOCKPILED SOIL SAMPLES
ANALYTICAL RESULTS

JUNE 29, 1995

Laboratory Report

S&W

**Soil and Water
Environmental
Laboratory, Inc.**

Drinking Water
Waste Water ◊ Asbestos
Hazardous Waste - Soil
Calderon Testing - Air

14072 W. Park Avenue
Boulder Creek, CA 95006
(408) 338-3053

Client: **Environmental Tech. Services** Report Date: **07/07/95**
1548 Jacob Ave.
San Jose CA 95118

Sample Site: **Alameda Golf Course** Date Received: **06/30/95**
111 Club House Dr.
AlamGolf BP

Analysis Requested: **Total Hydrocarbons - Gas** Procedure: **HPA 5020** Date Analyzed: **07/04/95**
BTMX Procedure: **HPA 8020**

S&W Ref. #	Client Ref. #	Matrix/Analysis	Concentration	Detection Limit
063095-1A	SP1	Soil/TPH-G	*	1 ppm
063095-1A	SP1	Soil/BTEX	*	5 ppb
		Benzene	*	5 ppb
		Toluene	*	5 ppb
		Ethylbenzene	*	5 ppb
		Xylenes	*	5 ppb

063095-1B	SP2	Soil/TPH-G	*	1 ppm
063095-1B	SP2	Soil/BTEX	*	5 ppb
		Benzene	*	5 ppb
		Toluene	*	5 ppb
		Ethylbenzene	*	5 ppb
		Xylenes	*	5 ppb

063095-1C	SP3	Soil/TPH-G	*	1 ppm
063095-1C	SP3	Soil/BTEX	*	5 ppb
		Benzene	*	5 ppb
		Toluene	*	5 ppb
		Ethylbenzene	*	5 ppb
		Xylenes	*	5 ppb

* No detectable amount @ detection limit

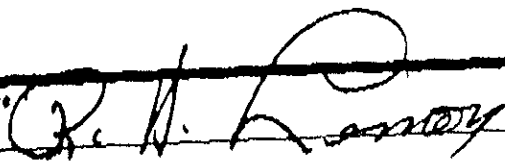
Analyst Signature: 

Environmental Technical Services

(408) 267-6427

267 9729

CHAIN - OF - CUSTODY

Project Number		Site Name and Address				Type and Number of Containers	Analysis Required				Laboratory ID	Comments
Alam Golf Sp		Alam Golf Course 111 Club House Drive Alam, Florida					TPHC - BTEX	TPH D -	TOG		063095-	
Witnessing Agency/Inspector Name and Date												
EVA Chow/Alan G Eno Health												
Sample ID	Date	Time	Matrix	Sample Location							Condition of Samples 1 - Good 2 - See Reverse	
SP1	6/29/95		Soil	Stock pile Discrete	1 BRASS	✓	✓				F	Analyze
SP2	"		" "	Stockpile Discrete	" "	✓	✓				B	Discrete
SP3	6/29/95		" "	Stockpile Discrete	" "	✓	✓				C	Discrete
<p>Lab. received 6/29/95 Helena</p>												
Relinquished by: (Signature)		Date/Time		Received by: (Signature)		Date/Time		Remarks:				
Helena M. Murray		6/29/95 7:32		ETS FRIDG		6/29/95		---				
Helena M. Murray		6/30/95 7:51		x Alan G Eno		6/30/95 NISS		COMPANY: ETS				
Alan G Eno		6/30/95		R. A. Demoy		6/30 9pm		ADDRESS: PHONE FAX:				