

ALAMEDA COUNTY
HEALTH CARE SERVICES

AGENCY

DAVID J. KEARNS, Agency Director



RAFAT A. SHAHID, ASST. AGENCY DIRECTOR
DEPARTMENT OF ENVIRONMENTAL HEALTH
State Water Resources Control Board
Division of Clean Water Programs
UST Local Oversight Program
80 Swan Way, Rm 200
Oakland, CA 94612
(510) 271-4530

REMEDIAL ACTION COMPLETION CERTIFICATION

January 28, 1994

John Watson
American Red Cross
2017 Central Ave.
Alameda, CA 94501

Y

STID 4571

Re: American Red Cross, 2017 Central Ave., Alameda, CA

Dear Mr. Watson:

This letter confirms the completion of site investigation and remedial action for the one 250-gallon former underground storage tank at the above site. With the provision that the information provided to this agency was accurate and representative of existing conditions, this office has determined that no further action is required at this time.

Based on the information submitted and current requirements, the RWQCB has also accepted the determination of this agency that no further action is required at this time. Further work could be required if conditions change or a water quality threat is discovered at the site.

If you have any questions regarding this letter, please give Juliet Shin a call at (510) 271-4530.

Very truly yours,

Rafat A. Shahid

Rafat A. Shahid
Assistant Agency Director

RAS:TP:st

c: Edgar B. Howell, Chief, Hazardous Materials Division
Rich Hiatt, RWQCB
Mike Harper, SWRCB
File

10-24-94

Post-It™ brand fax transmittal memo 7671 # of pages > 4

To	Tom Keacock	From	Joni
Co.		Co.	
Dept.		Phone #	
Fax #	510-337-9335	Fax #	

LOP\Completion

*Sorry for the delay
Joni*

*03-07-94
V*

CASE CLOSURE SUMMARY
Leaking Underground Fuel Storage Tank Program

I. AGENCY INFORMATION

Date:

Agency name: Alameda County-HazMat Address: 80 Swan Wy., Rm 200
 City/State/Zip: Oakland Phone: (510) 271-4320
 Responsible staff person: Juliet Shin Title: Hazardous Materials Spec.

II. CASE INFORMATION

Site facility name: American Red Cross
 Site facility address: 2017 Central Ave., Alameda, CA 94501
 RB LUSTIS Case No: N/A Local Case No./LOP Case No.: STID 4571
 URF filing date: 6/17/92 SWEEPS No: N/A

<u>Responsible Parties:</u>	<u>Addresses:</u>	<u>Phone Numbers:</u>
John Watson American Red Cross	2017 Central Ave. Alameda, CA 94501	(510)202-0661

<u>Tank No:</u>	<u>Size in gal.:</u>	<u>Contents:</u>	<u>Closed in-place or removed?:</u>	<u>Date:</u>
1	250-gallon	heating oil	removed	12/22/92

III. RELEASE AND SITE CHARACTERIZATION INFORMATION

Cause and type of release: No holes observed in USTs, so release may have been due to overspill.

Site characterization complete? YES NO

Date approved by oversight agency:

Monitoring Wells installed? YES NO Number: Two hydropunches placed at site

Proper screened interval? YES NO

Depth to ground water : 9.5 to 10 feet below ground surface

Flow direction: Not taken

Most sensitive current use: Unknown

Are drinking water wells affected? YES NO Aquifer name:

Leaking Underground Fuel Storage Tank Program

Is surface water affected? YES (NO) Nearest affected SW name:

Off-site beneficial use impacts (addresses/locations):

Report(s) on file? YES Where is report(s) filed? Alameda County
80 Swan Wy., Rm 200
Oakland CA 94621

Treatment and Disposal of Affected Material:

<u>Material</u>	<u>Amount</u> (include units)	<u>Action (Treatment of Disposal w/destination)</u>	<u>Date</u>
Tank	One 250-gallon UST	Hauled by H & H Service Co 220 China Basin, S.F., CA	12/22/92
Piping	Associated piping	" " "	"
Free Product			
Soil	108 cubic yards	BFI Vasco Rd. Landfill Livermore, CA	12/29/92
Groundwater			
Barrels			

III. RELEASE AND SITE CHARACTERIZATION INFORMATION (Continued)

Maximum Documented Contaminant Concentrations - - Before and After Cleanup

Contaminant	Soil (ppm)		Water (ppm)	
	Before	After	Before	After
TPH (Gas)	NA	NA		NA
TPH (Diesel)	1,000	70		ND
Benzene	0.1	ND		ND
Toluene	0.3	ND		ND
Xylene	0.3	ND		ND
Ethylbenzene	ND	ND		ND
Oil & Grease	NA	NA		NA
Heavy metals	NA	NA		NA

Other
Comments (Depth of Remediation, etc.): Overexcavation was conducted down to approximately 10.5 feet below ground surface, and the approximate dimensions of the excavation was 15 feet x 25 feet. Approximately 108 cubic yards of soil was excavated.

IV. CLOSURE

Does completed corrective action protect existing beneficial uses per the Regional Board Basin Plan? Undetermined

Does completed corrective action protect potential beneficial uses per the Regional Board Basin Plan? Undetermined

Does corrective action protect public health for current land use? YES
 Site management requirements: NA

Leaking Underground Fuel Storage Tank Program

Should corrective action be reviewed if land use changes? YES **(NO)**

Monitoring wells Decommissioned: YES NO *Not Any*

Number Decommissioned:--

Number Retained: ..

List enforcement actions taken: None

List enforcement actions rescinded: None

V. LOCAL AGENCY REPRESENTATIVE DATA

Name: Juliet Shin

Title: Hazardous Materials Spec.

Signature: *Juliet Shin*

Date: *12/27/93*

Reviewed by

Name: Jennifer Eberle

Title: Hazardous Materials Spec.

Signature: *J Eberle*

Date: *12-27-93*

Name: Tom Peacock

Title: Supervising HMS

Signature: *Tom Peacock*

Date: *12-27-93*

VI. RWQCB NOTIFICATION

Date Submitted to RB: *12/27/93*

RB Response:

RWQCB Staff Name: Rich Hiett

Title: San. Engineering Asso. Date:

VII. ADDITIONAL COMMENTS, DATA, ETC.

One 250-gallon heating oil UST was removed from the above site, and RWQCB designated this site as a residential home heating oil tank site. Up to 210 ppm TPHd was initially identified from beneath the tank during the tank removal. Consequently, source removal or overexcavation was conducted to the extent feasible and confirmatory samples identified up to 1,000 ppm diesel, from the bottom of the tank pit beneath the water table, and 0.1 ppm benzene. These concentrations were left in place. Due to elevated levels of diesel and traces of BTEX, RWQCB and this office decided to require hydropunches to determine extent of soil contamination and to determine whether this contaminated soil was impacting ground water. The hydropunches were located within five feet of where diesel-contaminated soil, at 240 ppm and 69 ppm, were identified in the past, along the sidewall of the former excavation. The soil samples collected from the hydropunches identified much lower levels of soil contamination than were identified from the overexcavation soil samples in the past. Additionally, the water samples collected from the hydropunches did not detect any contaminants. It appears that since source removal was conducted to the extent feasible and the remaining soil contamination does not appear to be leaching into the ground water, this site can be certified closed.

ALAMEDA COUNTY HEALTH CARE SERVICES
 DEPARTMENT OF ENVIRONMENTAL HEALTH
 HAZARDOUS MATERIALS DIVISION
 80 SWAN WAY, ROOM 200
 OAKLAND, CA 94621
 PHONE NO. 510/271-4120

ALCO
HAZMAT

94 MAY 11 AM 11:39

Robert Stein 6/1/94
7-15-87 SWW
Please refer to comments in
red ink. Plans to notify
his office at least 48 hrs in
advance of tank removal.

ACCEPTED
 DEPARTMENT OF ENVIRONMENTAL HEALTH
 470 - 27th Street, Third Floor
 Oakland, CA 94612
 Telephone: (415) 874-7237

These plans have been reviewed and found to be acceptable and essentially meet the requirements of State and local health laws. Changes to your plans indicated by this Department are to assure compliance with State and local laws. The project proposed herein is now released for issuance of any required building permits for construction. One copy of these accepted plans must be on the job and available to all contractors and craftsmen involved with the removal. Any change or alterations of these plans and specifications must be submitted to this Department and to the Fire and Building Inspection Department to determine if such changes meet the requirements of State and local laws. Notify this Department at least 48 hours prior to the following required inspections:

- _____ Removal of Tank and Piping
 - _____ Sampling
 - _____ Final Inspection
- Issuance of a permit to operate is dependent on compliance with accepted plans and all applicable laws and regulations.
 THERE IS A FINANCIAL PENALTY FOR NOT OBTAINING THESE INSPECTIONS.

UNDERGROUND TANK CLOSURE PLAN

*** Complete according to attached instructions ***

1. Business Name RED CROSS
- Business Owner RED CROSS
2. Site Address 20-17 Central Avenue
 City ALAMEDA Zip 94501 Phone 415 2020600
3. Mailing Address 1550 Sutter Street
 City SAN FRANCISCO Zip 94109 Phone 415-2020600
4. Land Owner RED CROSS
 Address 1550 SUTTER ST City, state S.F. CA Zip 94109
5. Generator name under which tank will be manifested _____
RED CROSS
- EPA I.D. No. under which tank will be manifested CAC 000900808

6. Contractor GOLDEN WEST ENVIRONMENTAL ✓
Address 367 EXCHANGE COURT
City LIVERMORE CA Phone 510 447 2484
License Type ABC-9 HAZMAT ID# 432103

Effective January 1, 1992, Business and Professional Code Section 7058.7 requires prime contractors to also hold Hazardous Waste Certification issued by the State Contractors License Board. Indicate that the certificate has been received, in addition, to holding the appropriate contractors license type.

7. Consultant N/A
Address _____
City _____ Phone _____

8. Contact Person for Investigation
Name N/A Title _____
Phone _____

9. Number of tanks being closed under this plan 1
Length of piping being removed under this plan _____
Total number of tanks at facility 1

10. State Registered Hazardous Waste Transporters/Facilities (see instructions).

** Underground tanks are hazardous waste and must be handled **
as hazardous waste

a) Product/Residual Sludge/Rinsate Transporter
Name ERICKSON EPA I.D. No. CAD009466392
Hauler License No. 0219 License Exp. Date 5-31-94
Address 255 PARR ROAD
City Richmond State CA Zip 94801

b) Product/Residual Sludge/Rinsate Disposal Site TSD
Name Gibson Pilot Petro EPA I.D. No. CAD048260702³
Address 475 SEADORT
City REDWOOD CITY State CA Zip 94063

c) Tank and Piping Transporter

Name Erickson EPA I.D. No. CATD009466392
Hauler License No. 0019 License Exp. Date 5-31-94
Address 255 PARR Road
City Richmond State CA Zip 94801

d) Tank and Piping Disposal Site

Name Erickson EPA I.D. No. CATD009466392
Address 255 Richmond PARR Road
City Richmond State CA Zip 94801

11. Experienced Sample Collector

Name Harold Speelman
Company Golden West Environmental
Address 507 Exchange Court
City Livermore State CA Zip 94550 Phone 510 447-5484

12. Laboratory

Name Superior Analytical
Address 825 Arnold Drive
City Martinez State CA Zip 94553
State Certification No. _____

13. Have tanks or pipes leaked in the past? Yes [] No [X]

If yes, describe. _____

14. Describe methods to be used for rendering tank inert

TANK WILL BE DRY ICED + SHIPPED
WITH HAZARDOUS WASTE MANIFEST TO
ERICKSON.

Before tanks are pumped out and inerted, all associated piping must be flushed out into the tanks. All accessible associated piping must then be removed. Inaccessible piping must be plugged.

The Bay Area Air Quality Management District (771-6000), along with local Fire and Building Departments, must also be contacted for tank removal permits. Fire departments typically require the use of explosion proof combustible gas meters to verify tank inertness. It is the contractor's responsibility to bring a working combustible gas meter on site to verify tank inertness.

15. Tank History and Sampling Information

Tank		Material to be sampled (tank contents, soil, ground-water, etc.)	Location and Depth of Samples
Capacity	Use History (see instructions)		
500 gal	Fuel oil for Generator	Soil G.W. sample of g.w. encountered	2 ft below tank

One soil sample must be collected for every 20 feet of piping that is removed. A ground water sample must be collected should any ground water be present in the excavation.

Excavated/Stockpiled Soil	
stockpiled Soil Volume (Estimated) 10 C.Y.	Sampling Plan As Directed by Alameda County Representative for full analysis

Stockpiled soil must be placed on bermed plastic and must be completely covered by plastic sheeting.

16. Chemical methods and associated detection limits to be used for analyzing samples -

The Tri-Regional Board recommended minimum verification analyses and practical quantitation reporting limits should be followed. See attached Table 2.

Contaminant Sought	EPA, DHS, or Other Sample Preparation Method Number	EPA, DHS, or Other Analysis Method Number	Method Detection Limit
Fuel oil	TPH-D BTX+E modified 8015		1 ppm 0.005 to 0.5 ppm

17. Submit Site Health and Safety Plan (See Instructions)

Post-It brand fax transmission memo 7671 # of pages >	
To: John Watson	From: Beckie
Co: RED CROSS	Golden West
Dept:	Phone: 510 447 2484
Fax: 415 202 0714	Fax: 510 447 4745

Facilities
SF -
data copy
end of California

FXED
5/10/94

- 20. Enclose Deposit (See Instructions)
- 21. Report any leaks or contamination to this office within 5 days of discovery. The report shall be made on an Underground Storage Tank Unauthorized Leak/Contamination Site Report form. (see Instructions)
- 22. Submit a closure report to this office within 60 days of the tank removal. This report must contain all the information listed in item 21 of the instructions.

I declare that to the best of my knowledge and belief the statements and information provided above are correct and true.

I understand that information in addition to that provided above may be needed in order to obtain an approval from the Department of Environmental Health and that no work is to begin on this project until this plan is approved.

I understand that any changes in design, materials or equipment will void this plan if prior approval is not obtained.

I understand that all work performed during this project will be done in compliance with all applicable OSHA (Occupational Safety and Health Administration) requirements concerning personnel health and safety. I understand that site and worker safety are solely the responsibility of the property owner or his agent and that this responsibility is not shared nor assumed by the County of Alameda.

Once I have received my stamped, accepted closure plan, I will contact the project Hazardous Materials Specialist at least three working days in advance of site work to schedule the required inspections.

Signature of Contractor
 Name (please type): REBECCA Hamblin
 Signature: Rebecca Hamblin
 Date: 5/10/94

X Signature of Site Owner or Operator
 Name (please type): JOHN W.M. WATSON
 Signature: J Watson
 Date: 5/10/94

rev 1/92

- 5 -

18. Submit Worker's Compensation Certificate copy

Name of Insurer State Fund of California

19. Submit Plot Plan (See Instructions)

20. Enclose Deposit (See Instructions)

21. Report any leaks or contamination to this office within 5 days of discovery. The report shall be made on an Underground Storage Tank Unauthorized Leak/Contamination Site Report form. (see Instructions)

22. Submit a closure report to this office within 60 days of the tank removal. This report must contain all the information listed in item 22 of the instructions.

I declare that to the best of my knowledge and belief the statements and information provided above are correct and true.

I understand that information in addition to that provided above may be needed in order to obtain an approval from the Department of Environmental Health and that no work is to begin on this project until this plan is approved.

I understand that any changes in design, materials or equipment will void this plan if prior approval is not obtained.

I understand that all work performed during this project will be done in compliance with all applicable OSHA (Occupational Safety and Health Administration) requirements concerning personnel health and safety. I understand that site and worker safety are solely the responsibility of the property owner or his agent and that this responsibility is not shared nor assumed by the County of Alameda.

Once I have received my stamped, accepted closure plan, I will contact the project Hazardous Materials Specialist at least three working days in advance of site work to schedule the required inspections.

Signature of Contractor

Name (please type) _____

Signature Rebecca Hamblin

Date _____

X Signature of Site Owner or Operator

Name (please type) _____

Signature _____

Date _____

SITE WORK HEALTH AND SAFETY PLAN

JOB NAME: Red Cross/Alameda
2017 Central Ave.

EMERGENCY TELEPHONE NUMBERS

Fire.....911
First Aid.....911
Ambulance.....911
Police.....911
Poison Control Center.....911

HOSPITAL
Name: Alameda Hosp. PHONE #
Address: 2077 Clinton
Alameda (510)522-3700

From project site proceed North on Central to Willow Street
and turn left. Continue on Willow St. to Clinton Street.
The hospital is on the corner of Willow and Clinton.

Golden West Environmental Services, Builders, General Contractors
D. Bailey Neff.....(510) 447-2484 ext 102
Rick Henderson.....(510) 447-2484 ext 106

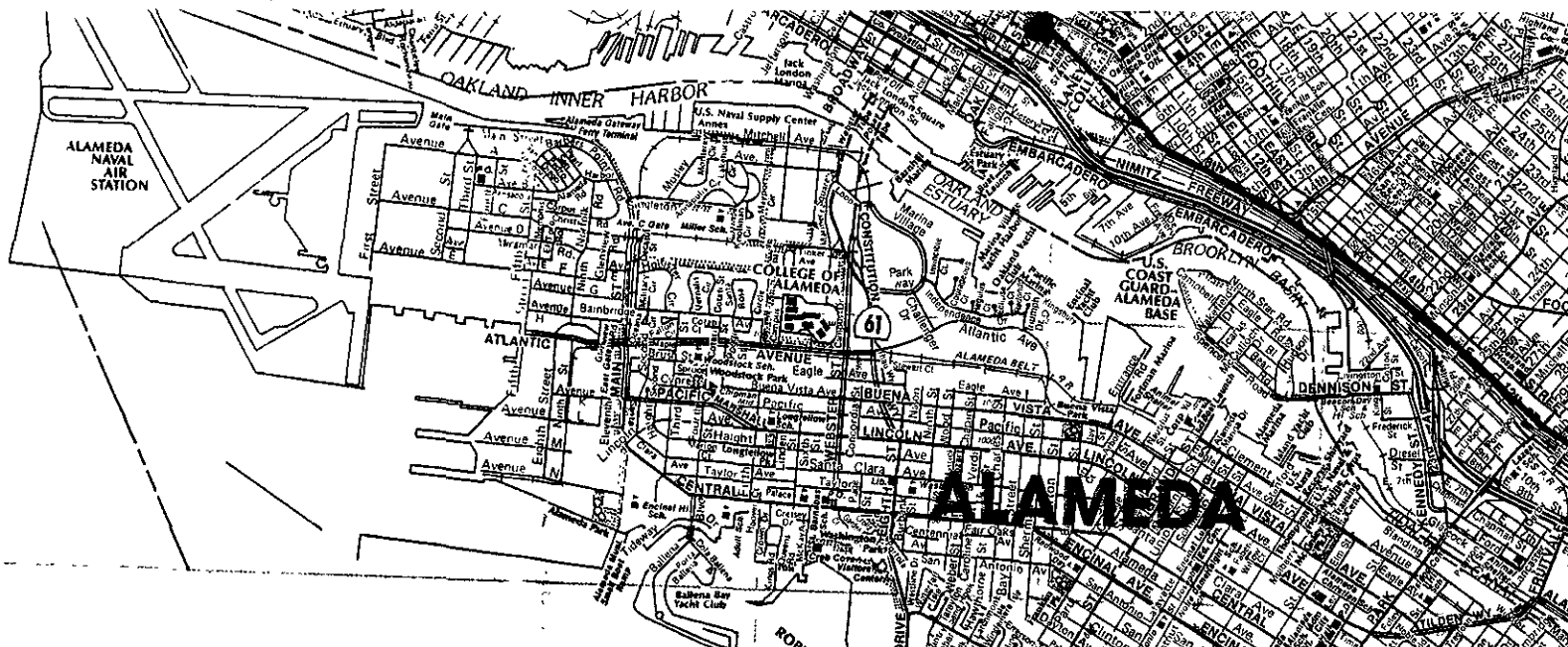

OAKLAND-RICHMOND STREET & ROAD INDEX

Table listing street names and their corresponding grid coordinates (e.g., Alameda, Alder St, Alameda Blvd, etc.) for navigation purposes.

SITE WORK HEALTH AND SAFETY PLAN

1. GENERAL

This Health and Safety Plan has been designed to conform to and/or exceed guidance standards promulgated by EPA and the California Department of Health Services, Federal OSHA regulations (29CFR1910.120) and CAL/OSHA regulations. Because considerable experienced judgement must be applied to decisions that will be made while actually working on site, it is the goal of this plan to provide maximum work efficiency while maintaining an uncompromisingly safe working environment. This plan is not a substitute for experienced judgement and direction, or for common sense during the implementation of the tank and equipment removal effort or the safety procedures outlined herein.

Golden West will provide services and equipment for the tank and equipment removal work. Golden West (as well as all subcontractors and independent contractors) will adhere to the Site Work Health and Safety Plan.

2. SITE/WORK DESCRIPTION

A site location map is provided in Figure 1-1. All buried tanks, lines and contaminated soil, (if any), will be excavated from the site.

3. WORK OBJECTIVE

The overall work objective is to provide for proper and safe removal of any residual product stock, removal of underground storage tank(s) and contaminated soil (if any) to achieve proper site closure in accordance with existing local and state regulations. To achieve these objectives, the following subordinate objectives must be accomplished:

- o Monitor tank interiors for flammable or explosive concentrations.
- o Provide for safe removal of flammable or combustible vapors from tanks. —
- o Provide for safe tank removal.
- o Provide for safe and proper tank disposal.

4. SAFETY MANAGEMENT

The field supervisor, Lupe Jauregui is the site and safety officer and will ensure that all personnel comply with all applicable regulations and requirements of this plan. Due to the various aspects of the work specific personnel are not assigned to this project at present. Basic requirements are:

1. Personnel shall be physically able (and mentally willing) to comply with safety requirements.
2. A copy of this safety plan shall be posted at the job site, and a copy made available to each individual who will work at the site.
3. These plans should also include and/or address as a separate plan, the following:
 - a. A Worker Hazard Communication Program.
4. Periodically scheduled "tailgate safety" meetings shall be held to review the safety program. Attenders will sign the Safety Meeting notice.
5. Unsafe acts shall be stopped when discovered.
6. Required safety equipment shall be present on site and shall be checked to verify completeness and function prior to being put into service.
7. Sources of ignitions will be eliminated where possible. Smoking will be strictly forbidden on site.
8. The field supervisor is Lupe Jauregui. Personnel may change depending on field conditions. Changes will be noted in the field log book.

5. HAZARDS

Identified Hazards

- o Hazards associated with general construction may occur

during the course construction. Personnel should be alert and prevent as well as avoid these hazards.

- o During tank removal, there is a significant potential for hazards from falling loads when lifting and removing tanks. Workers must be especially alert to this hazard.

- o During general construction activities, there is also a potential for general (construction type) safety hazards. This plan does not address general safety in detail. If personnel are frequently reminded and will cooperate in being courteous, careful, alert, and thoughtful of outlined safety procedures, and, if they use common sense in actions and in considering probable consequences, much will already have been accomplished to insure a safe working environment.

- o Fires may occur from sources of ignition.

- o Contamination exposure is negligible on this project. Activities will cease and proper notification made if contamination is found.

- o No noise or electrical hazards are known to exist at the present time.

6. EXCLUDED WORK ZONE

The boundary of the site shall be an excluded work zone. Personnel not actively involved in site work activities (other than inspectors from concerned regulatory agencies) shall not be allowed within the excluded work zone.

7. HAZARD COMMUNICATION

All personnel are to be familiar with this Site Work Health and Safety Plan.

Field supervisor will telephone for emergency service and notify office when needed.

8. ON-SITE WORK PLAN

Removal of Flammable Vapors and Removal of Tanks

Removal of flammable vapors and removal of tanks will be performed in accordance with the requirements of Local Regulatory Agencies. The following are general guide lines.

A review of available codes, standards, and recommended procedures produces the following consensus:

1. All possible sources of ignition must be kept from impacting the tank or the area in which flammable vapors may reside during excavation or after removal.
2. Drain and flush all piping into tank. Flammable or combustible free standing liquid production stock will be

removed from the tank prior to removal. Avoid spilling product on the ground during disconnection of the tank from its associated lines.

3. Vent lines should not be sealed and should be cut last. Keep all sources of ignition away from vent lines as well as tanks.
4. Once all liquid has been removed from the tank, any tank with flammable vapors in excess of 10% of the LEL or 5% oxygen will be purged with dry ice (CO₂). Twenty pounds of dry ice per 1,000 gallons of tank capacity is added to render the tank inert. All piping except the vent pipe should be disconnected.

Emergency Services

The address and telephone number of the local hospital, ambulance and medical emergency room should be prominently posted. In addition, the telephone number of a fire department/rescue unit should be posted.

General information regarding emergency services may be found on page 2.

Emergency Equipment

The following emergency equipment will be available:

- o A 20-unit first aid kit.
- o ABC fire extinguishers (2).

9. DECONTAMINATION

The requirement for decontamination will be determined by the specific site conditions.

Pre-moistened tissues will be available.

10. SAFETY TRAINING REQUIREMENTS

The minimum training requirements specified in Federal OSHA 1910.120 Hazardous Waste Operations and Emergency Response will be met for all remediation personnel. (If required)

11. EQUIPMENT

Personal Safety Equipment

Workers engaged in the remediation work shall wear/have available personal protective safety equipment as minimum:

- o Hard hats
- o Safety glasses and/or goggles
- o Respirators
- o Work boots
- o Gloves
- o Coveralls

Facility Safety Equipment

The following safety equipment shall be continuously available at the job site:

- o First aid kit (20-unit).
- o Fire extinguishers (2) ABC.
- o "No Smoking" signs.
- o Barricade tape.
- o Explosimeter (LEL)/Organic Vapor Analyzer.

12. PERSONAL HEALTH AND HYGIENE

- o Personal safety and the safety of fellow workers require mental alertness on the part of all employees. No alcohol or drugs shall be permitted at any job site. Intake of alcohol and prescription drugs should be limited when an employee is assigned to hazardous material remediation projects, due to the potential for synergistic effects. Prescription drugs should not be taken without the express approval of a physician with knowledge of project/site activities.
- o Eating and smoking will only take place in an approved break area.

SIGN OFF SHEET

WORK PARTY: Members of the work party must initial to indicate that they have and will comply with the Golden West Environmental Services, Builders, General Contractors Site and Safety Plan.

<u>NAME</u>	<u>RESPONSIBILITY</u>	<u>LEVEL OF PROTECTION</u>	<u>INITIAL</u>
_____	_____	_____	_____
_____	_____	_____	_____
_____	_____	_____	_____
_____	_____	_____	_____
_____	_____	_____	_____
_____	_____	_____	_____
_____	_____	_____	_____
_____	_____	_____	_____
_____	_____	_____	_____
_____	_____	_____	_____
_____	_____	_____	_____
_____	_____	_____	_____
_____	_____	_____	_____
_____	_____	_____	_____
_____	_____	_____	_____
_____	_____	_____	_____
_____	_____	_____	_____
_____	_____	_____	_____
_____	_____	_____	_____
_____	_____	_____	_____
_____	_____	_____	_____
_____	_____	_____	_____

ALAMEDA COUNTY HEALTH CARE SERVICES AGENCY
 DEPARTMENT OF ENVIRONMENTAL HEALTH
 HAZARDOUS MATERIALS DIVISION
 80 SWAN WAY, ROOM 200
 OAKLAND, CA 94621
 PHONE NO. 510/271-4320

ACCEPTED
 DEPARTMENT OF ENVIRONMENTAL HEALTH
 470 - 27th Street, Third Floor
 Oakland, CA 94612
 Telephone: (415) 874-7237

These plans have been reviewed and found to be acceptable and essentially meet the requirements of State and local health laws. Changes to your plans indicated by this Department are to assure compliance with State and local laws. The project proposed herein is now released for issuance of any required building permits for construction.

One copy of these accepted plans must be on the job and available to all contractors and craftsmen involved with the removal.

Any change or alterations of these plans and specifications must be submitted to this Department and to the fire and Building Inspection Department to determine if such changes meet the requirements of State and local laws. Notify this Department at least 48 hours prior to the following required inspections:

- _____ Removal of Tank and Piping
- _____ Sampling
- _____ Final Inspection

Issuance of a permit to operate is dependent on compliance with accepted plans and all applicable laws and regulations.

THERE IS A FINANCIAL PENALTY FOR NOT OBTAINING THESE INSPECTIONS.

Refer to completion & noted Feb 12/14/92

UNDERGROUND TANK CLOSURE PLAN

***** Complete according to attached instructions *****

1. Business Name Golden West Environmental Services
 Business Owner D.B. Neff, President
 2. Site Address 2017 Central Avenue
 City Alameda Zip 94501 Phone 510-535-2882
 3. Mailing Address 567 Exchange Court
 City Livermore Zip 94550 Phone 510-~~2~~447-2484
 4. Land Owner American Red Cross
 Address 2111 E. 14th St City, State Oakland, CA Zip 94606
 5. Generator name under which tank will be manifested _____
Red Cross
- EPA I.D. No. under which tank will be manifested CAL 000781688

12-9-92 ; Phone call to Pat Calvin of E.S.E. to send a copy of Contractors Haz. Mat. Certificate and Wakman's comp. insurance certificate. Will also send initial site assessment which shows contamination and leak report. 12/11/92 Copus Rec'd.

12-14-92 You must call for an inspector from this office to be on site during removal. Request must be rec'd 48 hours prior to starting work.

6. Contractor Golden West Environmental Services
Address 567 Exchange Court
City Livermore Phone 510-447-2484
License Type* A, B, C-9, Haz. Mat. ID# 942851128

*Effective January 1, 1992, Business and Professional Code Section 7058.7 requires prime contractors to also hold Hazardous Waste Certification issued by the State Contractors License Board. Indicate that the certificate has been received, in addition, to holding the appropriate contractors license type.

7. Consultant NONE
Address _____
City _____ Phone _____

8. Contact Person for Investigation
Name Rick Henderson Title Division Manager
Phone 510-447-2484

9. Number of tanks being closed under this plan 1
Length of piping being removed under this plan unknown
Total number of tanks at facility 2

10. State Registered Hazardous Waste Transporters/Facilities (see instructions).

** Underground tanks are hazardous waste and must be handled **
as hazardous waste

a) Product/Residual Sludge/Rinsate Transporter
Name Erickson EPA I.D. No. CAD009466392
Hauler License No. 0019 License Exp. Date 5/93
Address 255 Parr Blvd.
City Richmond State CA Zip 94801

b) Product/Residual Sludge/Rinsate Disposal Site
Name Erickson EPA I.D. No. CAD009466392
Address 255 Parr Blvd
City Richmond State CA Zip 94801

c) Tank and Piping Transporter

Name Erickson EPA I.D. No. CA0009466392
Hauler License No. 0019 License Exp. Date 5/93
Address 255 Parr Blvd
City Richmond State CA Zip 94801

d) Tank and Piping Disposal Site

Name Erickson EPA I.D. No. CA0009466392
Address 255 Parr Blvd
City Richmond State CA Zip 94801

11. Experienced Sample Collector

Name Pat Galvin
Company ESE
Address 4090 Nelson Ave, Suite J
City Concord State CA Zip 94520 Phone 510-685-4053

12. Laboratory

Name Curtis Tompkins 510-426-0900
Address 2323 Fifth Street
City Berkeley State CA Zip 94710
State Certification No. 1459

13. Have tanks or pipes leaked in the past? Yes [] No []

If yes, describe. Surface staining, subsurface samples
show release of fuel

14. Describe methods to be used for rendering tank inert

Dry Ice, 15 lbs per 1000 gal capacity

Before tanks are pumped out and inerted, all associated piping must be flushed out into the tanks. All accessible associated piping must then be removed. Inaccessible piping must be plugged.

The Bay Area Air Quality Management District (771-6000), along with local Fire and Building Departments, must also be contacted for tank removal permits. Fire departments typically require the use of explosion proof combustible gas meters to verify tank inertness. It is the contractor's responsibility to bring a working combustible gas meter on site to verify tank inertness.

15. Tank History and Sampling Information

Tank		Material to be sampled (tank contents, soil, ground-water, etc.)	Location and Depth of Samples
Capacity	Use History (see instructions)		
300 gallon	Heating oil unknown age, not currently in use	soil	Per guidelines

One soil sample must be collected for every 20 feet of piping that is removed. A ground water sample must be collected should any ground water be present in the excavation.

Excavated/Stockpiled Soil	
<i>ES</i> Stockpiled Soil Volume (Estimated) Aprox. 20 yards	Sampling Plan 1 Sample undertank Pipeline samples, 1 every 20ft. and at fill line

Stockpiled soil must be placed on bermed plastic and must be completely covered by plastic sheeting.

16. Chemical methods and associated detection limits to be used for analyzing samples

The Tri-Regional Board recommended minimum verification analyses and practical quantitation reporting limits should be followed. See attached Table 2.

Contaminant Sought	EPA, DHS, or Other Sample Preparation Method Number	EPA, DHS, or Other Analysis Method Number	Method Detection Limit
Diesel fuel <i>change sample test</i> →	8015 Mod (T.P.H.D) 80120 BTex (8240)	(3550) } 8260 	

17. Submit Site Health and Safety Plan (See Instructions)

18. Submit Worker's Compensation Certificate copy

Name of Insurer State Comp. Insurance Fund

19. Submit Plot Plan (See Instructions)

20. Enclose Deposit (See Instructions)

21. Report any leaks or contamination to this office within 5 days of discovery. The report shall be made on an Underground Storage Tank Unauthorized Leak/Contamination Site Report form. (see Instructions)

22. Submit a closure report to this office within 60 days of the tank removal. This report must contain all the information listed in item 22 of the instructions.

I declare that to the best of my knowledge and belief the statements and information provided above are correct and true.

I understand that information in addition to that provided above may be needed in order to obtain an approval from the Department of Environmental Health and that no work is to begin on this project until this plan is approved.

I understand that any changes in design, materials or equipment will void this plan if prior approval is not obtained.

I understand that all work performed during this project will be done in compliance with all applicable OSHA (Occupational Safety and Health Administration) requirements concerning personnel health and safety. I understand that site and worker safety are solely the responsibility of the property owner or his agent and that this responsibility is not shared nor assumed by the County of Alameda.

Once I have received my stamped, accepted closure plan, I will contact the project Hazardous Materials Specialist at least three working days in advance of site work to schedule the required inspections.

Signature of Contractor

Name (please type) Golden West Environmental Services

Signature Rick Anderson

Date 12/3/92

Signature of Site Owner or Operator

Name (please type) John Wm. Watson

Signature Watson

Date 12/2/92

JOB #92-292

SITE WORK HEALTH AND SAFETY PLAN

PREPARED FOR

ALAMEDA COUNTY
HEALTH CARE SERVICES AGENCY
DEPARTMENT OF ENVIRONMENTAL HEALTH
HAZARDOUS MATERIAL DIVISION
80 SWAN WAY, ROOM 200, OAKLAND, CA 94621

PREPARED BY

GOLDEN WEST

ENVIRONMENTAL SERVICES,
BUILDERS, GENERAL CONTRACTORS

567 EXCHANGE COURT

LIVERMORE, CA 94550

(510) 447-2484

NOVEMBER 1992

SITE WORK HEALTH AND SAFETY PLAN

TANK AND LINE REMOVAL

EMERGENCY TELEPHONE NUMBERS

Fire.....911
First Aid.....911
Ambulance.....911
Police.....911
Poison Control Center.....911
Alameda Hospital.....510-522-3700
2070 Clinton, at Willow, Alameda, CA 94501

PREFACE

This Site Work Health and Safety Plan has been prepared for tank and equipment removal.

SITE WORK HEALTH AND SAFETY PLAN
UNDERGROUND TANK AND EQUIPMENT REMOVAL

(3)

1. GENERAL

This Health and Safety Plan has been designed to conform to and/or exceed guidance standards promulgated by EPA and the California Department of Health Services, Federal OSHA regulations (29CFR1910.120) and CAL/OSHA regulations. Because considerable experienced judgement must be applied to decisions that will be made while actually working on site, it is the goal of this plan to provide maximum work efficiency while maintaining an uncompromisingly safe working environment. This plan is not a substitute for experienced judgement and direction, or for common sense during the implementation of the tank and equipment removal effort or the safety procedures outlined herein.

Golden West will provide services and equipment for the tank and equipment removal work. Golden West (as well as all subcontractors and independent contractors) will adhere to the Site Work Health and Safety Plan.

2. SITE/WORK DESCRIPTION

Remove and dispose of one 300 gallon underground storage tank and all lines. Sample for possible contamination.

3. WORK OBJECTIVE

The overall work objective is to provide for proper and safe removal of any residual product stock, removal of underground storage tank(s) and contaminated soil (if any) to achieve proper site closure in accordance with existing local and state regulations. To achieve these objectives, the following subordinate objectives must be accomplished:

- o Monitor tank interiors for flammable or explosive concentrations.
- o Provide for safe removal of flammable or combustible vapors from tanks.
- o Provide for safe tank removal.
- o Provide for safe and proper tank disposal.

4. SAFETY MANAGEMENT

The field supervisor is the Site and Safety Officer and will ensure that all personnel comply with all applicable regulations and requirements of this plan. Due to the various aspects of the work specific personnel are not assigned to this project at present. Basic requirements are:

1. Personnel shall be physically able (and mentally willing) to comply with safety requirements.
2. A copy of this safety plan shall be posted at the job site, and a copy made available to each individual who will work at the site.
3. These plans should also include and/or address as a separate plan, the following:
 - a. A Worker Hazard Communication Program.
4. Periodically scheduled "tailgate safety" meetings shall be held to review the safety program. Attenders will sign the Safety Meeting notice to be held by Harold Speelman. Meetings will be held once a week.
5. Unsafe acts shall be stopped when discovered.
6. Required safety equipment shall be present on site and shall be checked to verify completeness and function prior to being put into service.
7. Sources of ignitions will be eliminated where possible. Smoking will be strictly forbidden on site.
8. The field supervisor is Harold Speelman. Personnel may change depending on field conditions. Changes will be noted in the field log book.

5. HAZARDSIdentified Hazards

- o Hazards associated with general construction may occur during the course construction. Personnel should be alert and prevent as well as avoid these hazards.
- o During tank removal, there is a significant potential for hazards from falling loads when lifting and removing tanks. Workers must be especially alert to this hazard.
- o During general construction activities, there is also a potential for general (construction type) safety hazards. This plan does not address general safety in detail. If personnel are frequently reminded and will cooperate in being courteous, careful, alert, and thoughtful of outlined safety procedures, and, if they use common sense in actions and in considering probable consequences, much will already have been accomplished to insure a safe working environment.
- o Fires may occur from sources of ignition.
- o Contamination exposure is negligible on this project. Activities will cease and proper notification made if contamination is found.

- o No noise or electrical hazards are known to exist at the present time.

6. EXCLUDED WORK ZONE

The boundary of the site shall be an excluded work zone. Personnel not actively involved in site work activities (other than inspectors from concerned regulatory agencies) shall not be allowed within the excluded work zone.

7. HAZARD COMMUNICATION

All personnel are to be familiar with this Site Work Health and Safety Plan.

Field supervisor will telephone for emergency service and notify office when needed.

8. ON-SITE WORK PLAN

Removal of Flammable Vapors and Removal of Tanks

Removal of flammable vapors and removal of tanks will be performed in accordance with the requirements of the City of Alameda Fire Department and Haz. Mat. Office. The following are general guide lines.

A review of available codes, standards, and recommended procedures produces the following consensus:

1. All possible sources of ignition must be kept from impacting the tank or the area in which flammable vapors may reside during excavation or after removal.
2. Drain and flush all piping into tank. Flammable or combustible free standing liquid production stock will be removed from the tank prior to removal. Avoid spilling product on the ground during disconnection of the tank from its associated lines.
3. Vent lines should not be sealed and should be cut last. Keep all sources of ignition away from vent lines as well as tanks.
4. Once all liquid has been removed from the tank, any tank with flammable vapors in excess of 10% of the LEL or 5% oxygen will be purged with dry ice (CO₂). Thirty pounds of dry ice per 1,000 gallons of tank capacity is added to render the tank inert. All piping except the vent pipe should be disconnected.

Emergency Services

The address and telephone number of the local hospital, ambulance and medical emergency room should be prominently posted. In addition, the telephone number of a fire department/rescue unit should be posted. General information regarding emergency services may be found on page 2.

Emergency Equipment

The following emergency equipment will be available:

- o A 20-unit first aid kit.
- o ABC fire extinguishers (2)

9. DECONTAMINATION

The requirement for decontamination will be determined by the specific site conditions.

Pre-moistened tissues will be available.

10. SAFETY TRAINING REQUIREMENTS

The minimum training requirements specified in Federal OSHA 1910.120 Hazardous Waste Operations and Emergency Response will be met for all remediation personnel. (If required)

11. EQUIPMENT

Personal Safety Equipment

Workers engaged in the remediation work shall wear/have available personal protective safety equipment as minimum:

- o Hard hats
- o Safety glasses and/or goggles
- o Respirators
- o Work boots
- o Gloves
- o Coveralls

The following safety equipment shall be continuously available at the job site:

- o First aid kit (20-unit).
- o Fire extinguishers (2) ABC.
- o "No Smoking" signs.
- o Barricade tape.
- o Explosimeter (LEL)/Organic Vapor Analyzer.

12. PERSONAL HEALTH AND HYGIENE

- o Personal safety and the safety of fellow workers require mental alertness on the part of all employees. No alcohol or drugs shall be permitted at any job site. Intake of alcohol and prescription drugs should be limited when an employee is assigned to hazardous material remediation projects, due to the potential for synergistic effects. Prescription drugs should not be taken without the express approval of a physician with knowledge of project/site activities.
- o Eating and smoking will only take place in an approved break area.

Plot
Plan

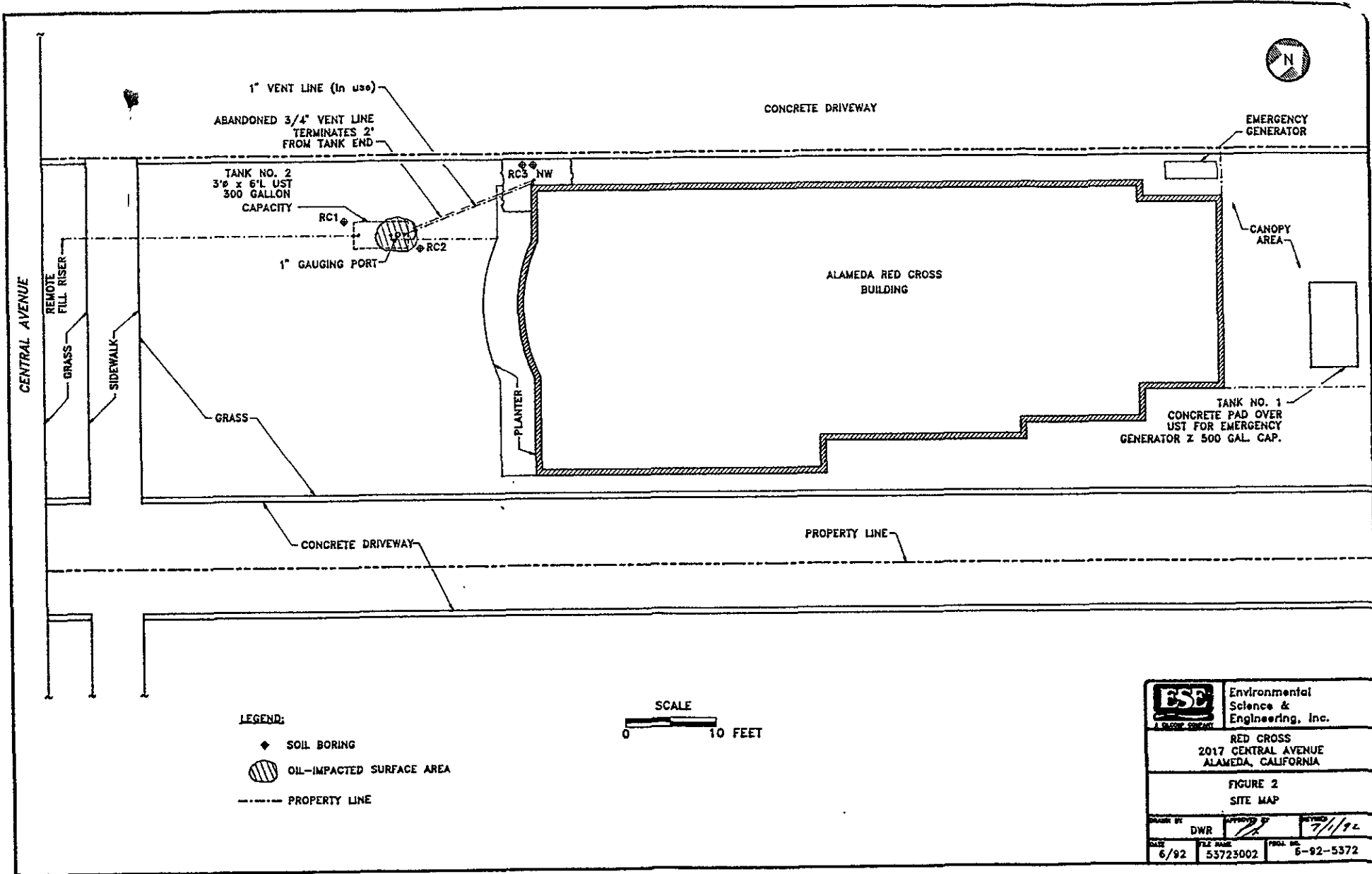

LEGEND:

- ◆ SOIL BORING
- ▨ OIL-IMPACTED SURFACE AREA
- - - - - PROPERTY LINE

SCALE
0 10 FEET

BSE A BAKER COMPANY	Environmental Science & Engineering, Inc.		
	RED CROSS 2017 CENTRAL AVENUE ALAMEDA, CALIFORNIA		
FIGURE 2 SITE MAP			
DESIGNED BY DWR	APPROVED BY <i>[Signature]</i>	DATE 7/1/92	
DATE 6/92	FILE NO. 53725002	PROJ. NO. 6-92-5372	