

Attachment A

Laboratory Analytic Report



Sequoia Analytical

680 Chesapeake Drive
1000 Bates Avenue, Suite L
819 Hiriker Avenue, Suite B

Redwood City, CA 94063
Concord, CA 94520
Sacramento, CA 95834

(415) 364-9800
(510) 686-9600
(916) 921-9600

FAX (415) 364-9233
FAX (510) 686-9689
FAX (916) 921-0100

Accutite
35 South Linden Avenue
South San Francisco, CA 94080
Attention: Amy Breckenridge

Client Project ID: Z-Rentals, Albany
Sample Descript: Soil, E5'
Analysis Method: EPA 8080
Lab Number: 4BC6301

Sampled: Feb 15, 1994
Received: Feb 17, 1994
Extracted: Feb 24, 1994
Analyzed: Feb 24, 1994
Reported: Mar 3, 1994

ORGANOCHLORINE PESTICIDES AND PCB'S (EPA 8080)

Analyte	Detection Limit µg/kg	Sample Results µg/kg
Aldrin.....	1.0	N.D.
alpha-BHC.....	1.0	N.D.
beta-BHC.....	1.0	N.D.
delta-BHC.....	1.0	N.D.
gamma-BHC (Lindane).....	1.0	N.D.
Chlordane.....	20	N.D.
4,4'-DDD.....	6.0	N.D.
4,4'-DDE.....	2.0	N.D.
4,4'-DDT.....	6.0	N.D.
Dieldrin.....	2.0	N.D.
Endosulfan I.....	2.0	N.D.
Endosulfan II.....	2.0	N.D.
Endosulfan sulfate.....	6.0	N.D.
Endrin.....	2.0	N.D.
Endrin aldehyde.....	6.0	N.D.
Heptachlor.....	1.0	N.D.
Heptachlor epoxide.....	1.0	N.D.
Methoxychlor.....	20	N.D.
Toxaphene.....	80	N.D.
PCB-1016.....	20	N.D.
PCB-1221.....	80	N.D.
PCB-1232.....	20	N.D.
PCB-1242.....	20	N.D.
PCB-1248.....	20	N.D.
PCB-1254.....	20	N.D.
PCB-1260.....	20	N.D.

Analytes reported as N.D. were not present above the stated limit of detection.

SEQUOIA ANALYTICAL

Suzanne Chin
Project Manager

4BC6301.ACC <11>





Sequoia Analytical

680 Chesapeake Drive
1900 Bates Avenue, Suite L
819 Stoker Avenue, Suite B

Redwood City, CA 94063
Concord, CA 94520
Sacramento, CA 95834

(415) 864-9600
(510) 686-9600
(916) 921-9600

FAX (415) 364-9233
FAX (510) 486-9689
FAX (916) 921-0100

Accutite	Client Project ID: Z-Rentals, Albany	Sampled: Feb 15, 1994
35 South Linden Avenue	Sample Descript: Soil, B11.5'	Received: Feb 17, 1994
South San Francisco, CA 94080	Analysis Method: EPA 8080	Extracted: Feb 24, 1994
Attention: Amy Breckenridge	Lab Number: 4BC6302	Analyzed: Feb 24, 1994
		Reported: Mar 3, 1994

ORGANOCHLORINE PESTICIDES AND PCB'S (EPA 8080)

Analyte	Detection Limit µg/kg	Sample Results µg/kg
Aldrin.....	1.0	N.D.
alpha-BHC.....	1.0	N.D.
beta-BHC.....	1.0	N.D.
delta-BHC.....	1.0	N.D.
gamma-BHC (Lindane).....	1.0	N.D.
Chlordane.....	20	N.D.
4,4'-DDD.....	6.0	N.D.
4,4'-DDE.....	2.0	N.D.
4,4'-DDT.....	6.0	N.D.
Dieldrin.....	2.0	N.D.
Endosulfan I.....	2.0	N.D.
Endosulfan II.....	2.0	N.D.
Endosulfan sulfate.....	6.0	N.D.
Endrin.....	2.0	N.D.
Endrin aldehyde.....	6.0	N.D.
Heptachlor.....	1.0	N.D.
Heptachlor epoxide.....	1.0	N.D.
Methoxychlor.....	20	N.D.
Toxaphene.....	60	N.D.
PCB-1016.....	20	N.D.
PCB-1221.....	80	N.D.
PCB-1232.....	20	N.D.
PCB-1242.....	20	N.D.
PCB-1248.....	20	N.D.
PCB-1254.....	20	N.D.
PCB 1260.....	20	N.D.

Analytes reported as N.D. were not present above the stated limit of detection.

SEQUOIA ANALYTICAL

Suzanne Chin
Project Manager





Sequoia Analytical

680 Chesapeake Drive Redwood City, CA 94063 (415) 364-9600 FAX (415) 364-9333
 1900 Bates Avenue, Suite L Concord, CA 94520 (510) 686-9600 FAX (510) 686-9689
 819 Striker Avenue, Suite 8 Sacramento, CA 95834 (916) 921-9600 FAX (916) 921-0100

Accutite	Client Project ID: Z-Rentals, Albany	Sampled: Feb 15, 1994
35 South Linden Avenue	Sample Descript: Soil, 2E7	Received: Feb 17, 1994
South San Francisco, CA 94080	Analysis Method: EPA 8080	Extracted: Feb 24, 1994
Attention: Amy Breckenridge	Lab Number: 4BC6303	Analyzed: Feb 24, 1994
		Reported: Mar 3, 1994

ORGANOCHLORINE PESTICIDES AND PCB'S (EPA 8080)

Analyte	Detection Limit µg/kg	Sample Results µg/kg
Aldrin.....	1.0	N.D.
alpha-BHC.....	1.0	N.D.
beta-BHC.....	1.0	N.D.
delta-BHC.....	1.0	N.D.
gamma-BHC (Lindane).....	1.0	N.D.
Chlordane.....	20	N.D.
4,4'-DDD.....	6.0	N.D.
4,4'-DDE.....	2.0	N.D.
4,4'-DDT.....	6.0	N.D.
Dieldrin.....	2.0	N.D.
Endosulfan I.....	2.0	N.D.
Endosulfan II.....	2.0	N.D.
Endosulfan sulfate.....	6.0	N.D.
Endrin.....	2.0	N.D.
Endrin aldehyde.....	6.0	N.D.
Heptachlor.....	1.0	N.D.
Heptachlor epoxide.....	1.0	N.D.
Methoxychlor.....	20	N.D.
Toxaphene.....	80	N.D.
PCB-1016.....	20	N.D.
PCB-1221.....	80	N.D.
PCB-1232.....	20	N.D.
PCB-1242.....	20	N.D.
PCB-1248.....	20	N.D.
PCB-1254.....	20	N.D.
PCB-1260.....	20	N.D.

Analytes reported as N.D. were not present above the stated limit of detection.

SEQUOIA ANALYTICAL

Suzanne Chin
Project Manager





Sequoia Analytical

680 Chesapeake Drive Redwood City, CA 94063 (415) 364-9600 FAX (415) 364-9333
 1900 Hates Avenue, Suite I, Concord, CA 94520 (510) 686-9600 FAX (510) 686-9689
 819 Suiker Avenue, Suite B Sacramento, CA 95834 (916) 921-9600 FAX (916) 921-0100

Accutite	Client Project ID: Z-Rentals, Albany	Sampled: Feb 15, 1994
35 South Linden Avenue	Sample Descript: Soil, S7	Received: Feb 17, 1994
South San Francisco, CA 94080	Analysis Method: EPA 8080	Extracted: Feb 24, 1994
Attention: Amy Breckenridge	Lab Number: 4BC6305	Analyzed: Feb 24, 1994
		Reported: Mar 3, 1994

ORGANOCHLORINE PESTICIDES AND PCB'S (EPA 8080)

Analyte	Detection Limit µg/kg	Sample Results µg/kg
Aldrin.....	5.0	N.D.
alpha-BHC.....	5.0	N.D.
beta-BHC.....	5.0	N.D.
delta-BHC.....	5.0	N.D.
gamma-BHC (Lindane).....	5.0	N.D.
Chlordane.....	100	N.D.
4,4'-DDT.....	5.0	4.1
4,4'-DDE.....	10	N.D.
4,4'-DDT.....	30	N.D.
Dieldrin.....	10	N.D.
Endosulfan I.....	10	N.D.
Endosulfan II.....	10	N.D.
Endosulfan sulfate.....	30	N.D.
Endrin.....	10	N.D.
Endrin aldehyde.....	30	N.D.
Heptachlor.....	5.0	N.D.
Heptachlor epoxide.....	5.0	N.D.
Methoxychlor.....	100	N.D.
Toxaphene.....	400	N.D.
PCB-1016.....	100	N.D.
PCB-1221.....	400	N.D.
PCB-1232.....	100	N.D.
PCB-1242.....	100	N.D.
PCB-1248.....	100	N.D.
PCB-1254.....	100	N.D.
PCB-1260.....	100	N.D.

Analytes reported as N.D. were not present above the stated limit of detection. Because matrix effects and/or other factors required additional sample dilution, detection limits for this sample have been raised.

SEQUOIA ANALYTICAL

 Suzanne Chin
 Project Manager

4BC6301.ACC <14>





Sequoia Analytical

680 Chesapeake Drive
1900 Banc Avenue, Suite 1
819 Striker Avenue, Suite 8

Redwood City, CA 94063
Concord, CA 94530
Sacramento, CA 95834

(415) 364-9600
(510) 686-9600
(916) 921-9600

FAX (415) 364-9233
FAX (510) 686-9589
FAX (916) 921-0100

Accutite	Client Project ID: Z-Rentals, Albany	Sampled: Feb 15, 1994
35 South Linden Avenue	Sample Descript: Soil, E5'	Received: Feb 17, 1994
South San Francisco, CA 94080	Lab Number: 4BC6301	Analyzed: see below
Attention: Amy Breckenridge		Reported: Mar 3, 1994

LABORATORY ANALYSIS

Analyte	Date Analyzed	Detection Limit mg/kg	Sample Result mg/kg
Lead.....	2/24/94	5.0	N.D.

Analytes reported as N.D. were not present above the stated limit of detection.

SEQUOIA ANALYTICAL

Suzanna Chin
Project Manager

4BC6301.ACC <15>





Client Acct: 10190
 Client Name: Subsurface Environmental
 NET Job No: 94.02027

Date: 06/06/1994
 ELAP Certificate: 1386
 Page: 2

Ref: Frank Zilmichi-2 Rental Properties, Albany, Proj: 94153

SAMPLE DESCRIPTION: 711-001
 Date Taken: 05/12/1994
 Time Taken: 14:20
 NET Sample No: 194424

Parameter	Results	Flags	Reporting		Method	Date	Date
			Limit	Units		Extracted	Analyzed
METHOD 8080 (GC,Solid)						05/20/1994	
DILUTION FACTOR*	1						05/26/1994
Aldrin	6.6		1.2	ug/kg	8080		05/26/1994
alpha-BHC	ND		0.3	ug/kg	8080		05/26/1994
beta-BHC	ND		0.3	ug/kg	8080		05/26/1994
delta-BHC	ND		0.3	ug/kg	8080		05/26/1994
gamma-BHC (Lindane)	ND		1.2	ug/kg	8080		05/26/1994
Chlordane	ND		25	ug/kg	8080		05/26/1994
4,4'-DDD	9.3		3	ug/kg	8080		05/26/1994
4,4'-DDE	ND		3	ug/kg	8080		05/26/1994
4,4'-DDT	ND		3	ug/kg	8080		05/26/1994
Dieldrin	ND		3	ug/kg	8080		05/26/1994
Endosulfan I	ND		3	ug/kg	8080		05/26/1994
Endosulfan II	ND		3	ug/kg	8080		05/26/1994
Endosulfan sulfate	ND		3	ug/kg	8080		05/26/1994
Endrin	ND		3	ug/kg	8080		05/26/1994
Endrin aldehyde	ND		3	ug/kg	8080		05/26/1994
Heptachlor	ND		3	ug/kg	8080		05/26/1994
Heptachlor epoxide	ND		3	ug/kg	8080		05/26/1994
Methoxychlor	ND		5	ug/kg	8080		05/26/1994
Toxaphene	ND		60	ug/kg	8080		05/26/1994
POLYCHLORINATED BIPHENYLS	--						05/26/1994
Aroclor 1016	ND		100	ug/kg	8080		05/26/1994
Aroclor 1221	ND		500	ug/kg	8080		05/26/1994
Aroclor 1221	ND		200	ug/kg	8080		05/26/1994
Aroclor 1232	ND		100	ug/kg	8080		05/26/1994
Aroclor 1242	ND		100	ug/kg	8080		05/26/1994
Aroclor 1248	ND		100	ug/kg	8080		05/26/1994
Aroclor 1254	ND		50	ug/kg	8080		05/26/1994
Aroclor 1260	ND		50	ug/kg	8080		05/26/1994
SURROGATE RESULTS	--						05/26/1994
Tetrachlorometaxylene (SURR)	70			% Rec.			05/26/1994
Decachlorobiphenyl (SURR)	81			% Rec.			05/26/1994

NOTE: Results apply only to the samples analyzed. Reproduction of this report is permitted only in its entirety.



Client Acct: 10190
 Client Name: Subsurface Environmental
 NET Job No: 94.02027

Date: 06/06/1994
 ELAP Certificate: 1385
 Page: 3

Ref: Frank Zilmichi-Z Rental Properties, Albany, Proj: 94153

SAMPLE DESCRIPTION: 711-002
 Date Taken: 05/12/1994
 Time Taken: 14:30
 NET Sample No: 194425

Parameter	Results	Flags	Reporting		Method	Data	Date
			Limit	Units		Extracted	Analyzed
METHOD 8080 (GC,Solid)						05/20/1994	
DILUTION FACTOR*	1						05/26/1994
Aldrin	ND		1.2	ug/kg	8080		05/26/1994
alpha-BHC	ND		0.3	ug/kg	8080		05/26/1994
beta-BHC	ND		0.3	ug/kg	8080		05/26/1994
delta-BHC	ND		0.3	ug/kg	8080		05/26/1994
gamma-BHC (Lindane)	ND		1.2	ug/kg	8080		05/26/1994
Chlordane	ND		25	ug/kg	8080		05/26/1994
4,4'-DDD	ND		3	ug/kg	8080		05/26/1994
4,4'-DDE	ND		3	ug/kg	8080		05/26/1994
4,4'-DDT	ND		3	ug/kg	8080		05/26/1994
Dieldrin	ND		3	ug/kg	8080		05/26/1994
Endosulfan I	ND		3	ug/kg	8080		05/26/1994
Endosulfan II	ND		3	ug/kg	8080		05/26/1994
Endosulfan sulfate	ND		3	ug/kg	8080		05/26/1994
Endrin	ND		3	ug/kg	8080		05/26/1994
Endrin aldehyde	ND		3	ug/kg	8080		05/26/1994
Heptachlor	ND		3	ug/kg	8080		05/26/1994
Heptachlor epoxide	ND		3	ug/kg	8080		05/26/1994
Methoxychlor	ND		5	ug/kg	8080		05/26/1994
Toxaphene	ND		60	ug/kg	8080		05/26/1994
POLYCHLORINATED BIPHENYLS	--						05/26/1994
Aroclor 1016	ND		100	ug/kg	8080		05/26/1994
Aroclor 1221	ND		500	ug/kg	8080		05/26/1994
Aroclor 1222	ND		200	ug/kg	8080		05/26/1994
Aroclor 1232	ND		100	ug/kg	8080		05/26/1994
Aroclor 1242	ND		100	ug/kg	8080		05/26/1994
Aroclor 1248	ND		100	ug/kg	8080		05/26/1994
Aroclor 1254	ND		50	ug/kg	8080		05/26/1994
Aroclor 1260	ND		50	ug/kg	8080		05/26/1994
SURROGATE RESULTS	--						05/26/1994
Tetrachloroethaxylene (SURR)	46			% Rec.			05/26/1994
Decachlorobiphenyl (SURR)	73			% Rec.			

NOTE: Results apply only to the samples analyzed. Reproduction of this report is permitted only in its entirety.



Client Acct: 10190
 Client Name: Subsurface Environmental
 NET Job No: 94.02027

Date: 06/06/1994
 ELAP Certificate: 1386
 Page: 4

Ref: Frank Zilmichi-Z Rental Properties, Albany, Proj: 94153

SAMPLE DESCRIPTION: 711-003
 Date Taken: 05/12/1994
 Time Taken: 14:35
 NET Sample No: 194426

Parameter	Results	Flags	Reporting Limit	Units	Method	Date	Date
						Extracted	Analyzed
METHOD 8080 (GC, Solid)						05/20/1994	
DILUTION FACTOR*	1						05/26/1994
Aldrin	2.9		1.2	ug/kg	8080		05/26/1994
alpha-BHC	ND		0.3	ug/kg	8080		05/26/1994
beta-BHC	ND		0.3	ug/kg	8080		05/26/1994
delta-BHC	ND		0.3	ug/kg	8080		05/26/1994
gamma-BHC (Lindane)	ND		1.2	ug/kg	8080		05/26/1994
Chlordane	ND		25	ug/kg	8080		05/26/1994
4,4'-DDD	19		3	ug/kg	8080		05/26/1994
4,4'-DDE	ND		3	ug/kg	8080		05/26/1994
4,4'-DDT	ND		3	ug/kg	8080		05/26/1994
Dieldrin	ND		3	ug/kg	8080		05/26/1994
Endosulfan I	ND		3	ug/kg	8080		05/26/1994
Endosulfan II	ND		3	ug/kg	8080		05/26/1994
Endosulfan sulfate	ND		3	ug/kg	8080		05/26/1994
Endrin	ND		3	ug/kg	8080		05/26/1994
Endrin aldehyde	ND		3	ug/kg	8080		05/26/1994
Heptachlor	ND		3	ug/kg	8080		05/26/1994
Heptachlor epoxide	ND		5	ug/kg	8080		05/26/1994
Methoxychlor	ND		50	ug/kg	8080		05/26/1994
Toxaphene	ND						05/26/1994
POLYCHLORINATED BIPHENYLS	--						05/26/1994
Aroclor 1016	ND		100	ug/kg	8080		05/26/1994
Aroclor 1221	ND		500	ug/kg	8080		05/26/1994
Aroclor 1221	ND		200	ug/kg	8080		05/26/1994
Aroclor 1232	ND		100	ug/kg	8080		05/26/1994
Aroclor 1242	ND		100	ug/kg	8080		05/26/1994
Aroclor 1248	ND		50	ug/kg	8080		05/26/1994
Aroclor 1254	ND		50	ug/kg	8080		05/26/1994
Aroclor 1260	ND						05/26/1994
SURROGATE RESULTS	--						05/26/1994
Tetrachlorometaxylene (SURR)	71			% Rec.			05/26/1994
Decachlorobiphenyl (SURR)	85			% Rec.			05/26/1994

NOTE: Results apply only to the samples analyzed. Reproduction of this report is permitted only in its entirety.



Client Acct: 10190
 Client Name: Subsurface Environmental
 NET Job No: 94.02027

Date: 06/06/1994
 ELAP Certificate: 1386
 Page: 5

Ref: Frank Zilmichi-Z Rental Properties, Albany, Proj: 94153

SAMPLE DESCRIPTION: 711-004
 Date Taken: 05/12/1994
 Time Taken: 14:45
 NET Sample No: 194427

Parameter	Results	Flags	Reporting			Date	Date
			Limit	Units	Method	Extracted	Analyzed
METHOD 8080 (GC,Solid)						05/20/1994	05/26/1994
DILUTION FACTOR*	1						
Aldrin	9.5		1.2	ug/kg	8080		05/26/1994
alpha-BHC	ND		0.3	ug/kg	8080		05/26/1994
beta-BHC	ND		0.3	ug/kg	8080		05/26/1994
delta-BHC	ND		0.3	ug/kg	8080		05/26/1994
gamma-BHC (Lindane)	ND		1.2	ug/kg	8080		05/26/1994
Chlordane	ND		25	ug/kg	8080		05/26/1994
4,4'-DDD	17		3	ug/kg	8080		05/26/1994
4,4'-DDE	ND		3	ug/kg	8080		05/26/1994
4,4'-DDT	ND		3	ug/kg	8080		05/26/1994
Dieldrin	ND		3	ug/kg	8080		05/26/1994
Endosulfan I	ND		3	ug/kg	8080		05/26/1994
Endosulfan II	ND		3	ug/kg	8080		05/26/1994
Endosulfan sulfate	ND		3	ug/kg	8080		05/26/1994
Endrin	ND		3	ug/kg	8080		05/26/1994
Endrin aldehyde	ND		3	ug/kg	8080		05/26/1994
Heptachlor	ND		3	ug/kg	8080		05/26/1994
Heptachlor epoxide	ND		3	ug/kg	8080		05/26/1994
Methoxychlor	ND		5	ug/kg	8080		05/26/1994
Toxaphene	ND		60	ug/kg	8080		05/26/1994
POLYCHLORINATED BIPHENYLS	--						05/26/1994
Aroclor 1016	ND		100	ug/kg	8080		05/26/1994
Aroclor 1221	ND		500	ug/kg	8080		05/26/1994
Aroclor 1221	ND		200	ug/kg	8080		05/26/1994
Aroclor 1232	ND		100	ug/kg	8080		05/26/1994
Aroclor 1242	ND		100	ug/kg	8080		05/26/1994
Aroclor 1248	ND		100	ug/kg	8080		05/26/1994
Aroclor 1254	ND		50	ug/kg	8080		05/26/1994
Aroclor 1260	ND		50	ug/kg	8080		05/26/1994
SURROGATE RESULTS	--						05/26/1994
Tetrachlorometaxylene (SURR)	70			% Rec.			05/26/1994
Decachlorobiphenyl (SURR)	74			% Rec.			05/26/1994

NOTE: Results apply only to the samples analyzed. Reproduction of this report is permitted only in its entirety.



Client Acct: 10190
 Client Name: Subsurface Environmental
 NET Job No: 94.02027

Date: 06/06/1994
 ELAP Certificate: 1386
 Page: 6

Ref: Frank Zilmichi-Z Rental Properties, Albany. Proj: 94153

SAMPLE DESCRIPTION: 711-005
 Date Taken: 05/12/1994
 Time Taken: 14:55
 NET Sample No: 194428

Parameter	Results	Flags	Reporting Limit	Units	Method	Date	Date
						Extracted	Analyzed
METHOD 8080 (GC,Solid)						05/20/1994	
DILUTION FACTOR*	1						05/26/1994
Aldrin	5.2		1.2	ug/kg	8080		05/26/1994
alpha-BHC	ND		0.3	ug/kg	8080		05/26/1994
beta-BHC	ND		0.3	ug/kg	8080		05/26/1994
delta-BHC	ND		0.3	ug/kg	8080		05/26/1994
gamma-BHC (Lindane)	ND		1.2	ug/kg	8080		05/26/1994
Chlordane	ND		25	ug/kg	8080		05/26/1994
4,4'-DDD	0.9		3	ug/kg	8080		05/26/1994
4,4'-DDE	ND		3	ug/kg	8080		05/26/1994
4,4'-DDT	ND		3	ug/kg	8080		05/26/1994
Dieldrin	ND		3	ug/kg	8080		05/26/1994
Endosulfan I	ND		3	ug/kg	8080		05/26/1994
Endosulfan II	ND		3	ug/kg	8080		05/26/1994
Endosulfan sulfate	ND		3	ug/kg	8080		05/26/1994
Endrin	ND		3	ug/kg	8080		05/26/1994
Endrin aldehyde	ND		3	ug/kg	8080		05/26/1994
Heptachlor	ND		3	ug/kg	8080		05/26/1994
Heptachlor epoxide	ND		5	ug/kg	8080		05/26/1994
Methoxychlor	ND		60	ug/kg	8080		05/26/1994
Toxaphene	--						05/26/1994
POLYCHLORINATED BIPHENYLS							
Aroclor 1016	ND		100	ug/kg	8080		05/26/1994
Aroclor 1221	ND		500	ug/kg	8080		05/26/1994
Aroclor 1222	ND		200	ug/kg	8080		05/26/1994
Aroclor 1232	ND		100	ug/kg	8080		05/26/1994
Aroclor 1242	ND		100	ug/kg	8080		05/26/1994
Aroclor 1248	ND		50	ug/kg	8080		05/26/1994
Aroclor 1254	ND		50	ug/kg	8080		05/26/1994
Aroclor 1260	ND						05/26/1994
SURROGATE RESULTS	--						05/26/1994
Tetrachlorometaxylene (SURR)	74			% Rec.			05/26/1994
Decachlorobiphenyl (SURR)	98			% Rec.			05/26/1994

NOTE: Results apply only to the samples analyzed. Reproduction of this report is permitted only in its entirety.



Client Acct: 10190
 Client Name: Subsurface Environmental
 NET Job No: 94.02027

Date: 05/06/1994
 SLAP Certificate: 1386
 Page: 7

Ref: Frank Zilmichi-2 Rental Properties, Albany, Proj: 94153

SAMPLE DESCRIPTION: 711-006
 Date Taken: 05/12/1994
 Time Taken: 15:00
 NET Sample No: 194429

Parameter	Results	Flags	Reporting Limit	Units	Method	Date	Date
						Extracted	Analyzed
METHOD 8080 (GC.Solid)						05/20/1994	05/26/1994
DILUTION FACTOR*	1						05/26/1994
Aldrin	7.7		1.2	ug/kg	8080		05/26/1994
alpha-BHC	ND		0.3	ug/kg	8080		05/26/1994
beta-BHC	ND		0.3	ug/kg	8080		05/26/1994
delta-BHC	ND		0.3	ug/kg	8080		05/26/1994
gamma-BHC (Lindane)	ND		1.2	ug/kg	8080		05/26/1994
Chlordane	ND		25	ug/kg	8080		05/26/1994
4,4'-DDD	9.0		3	ug/kg	8080		05/26/1994
4,4'-DDE	ND		3	ug/kg	8080		05/26/1994
4,4'-DDT	ND		3	ug/kg	8080		05/26/1994
Dieldrin	ND		3	ug/kg	8080		05/26/1994
Endosulfan I	ND		3	ug/kg	8080		05/26/1994
Endosulfan II	ND		3	ug/kg	8080		05/26/1994
Endosulfan sulfate	ND		3	ug/kg	8080		05/26/1994
Endrin	ND		3	ug/kg	8080		05/26/1994
Endrin aldehyde	ND		3	ug/kg	8080		05/26/1994
Heptachlor	ND		3	ug/kg	8080		05/26/1994
Heptachlor epoxide	ND		5	ug/kg	8080		05/26/1994
Methoxychlor	ND		60	ug/kg	8080		05/26/1994
Toxaphene	--						05/26/1994
POLYCHLORINATED BIPHENYLS							
Aroclor 1016	ND		100	ug/kg	8080		05/26/1994
Aroclor 1221	ND		500	ug/kg	8080		05/26/1994
Aroclor 1222	ND		200	ug/kg	8080		05/26/1994
Aroclor 1232	ND		100	ug/kg	8080		05/26/1994
Aroclor 1242	ND		100	ug/kg	8080		05/26/1994
Aroclor 1248	ND		100	ug/kg	8080		05/26/1994
Aroclor 1254	ND		50	ug/kg	8080		05/26/1994
Aroclor 1260	ND		50	ug/kg	8080		05/26/1994
SURROGATE RESULTS							
Tetrachlorometaxylene (SURR)	66			% Rec.			05/26/1994
Decachlorobiphenyl (SURR)	81			% Rec.			05/26/1994

NOTE: Results apply only to the samples analyzed. Reproduction of this report is permitted only in its entirety.



Client Acct: 10190
 Client Name: Subsurface Environmental
 NET Job No: 94.02027

Date: 06/06/1994
 ELAP Certificate: 1386
 Page: 8

Ref: Frank Zilmichi-Z Rental Properties, Albany, Proj: 94153

SAMPLE DESCRIPTION: 711-007
 Date Taken: 05/12/1994
 Time Taken: 15:10
 NET Sample No: 194430

Parameter	Results	Flags	Reporting		Method	Date	Date
			Limit	Units		Extracted	Analyzed
METHOD 8080 (GC,Solid)						05/20/1994	
DILUTION FACTOR*	1						05/26/1994
Aldrin	ND		1.2	ug/kg	8080		05/26/1994
alpha-BHC	ND		0.3	ug/kg	8080		05/26/1994
beta-BHC	ND		0.3	ug/kg	8080		05/26/1994
delta-BHC	ND		0.3	ug/kg	8080		05/26/1994
gamma-BHC (Lindane)	ND		1.2	ug/kg	8080		05/26/1994
Chlordane	ND		25	ug/kg	8080		05/26/1994
4,4'-DDD	3.8		3	ug/kg	8080		05/26/1994
4,4'-DDE	ND		3	ug/kg	8080		05/26/1994
4,4'-DDT	ND		3	ug/kg	8080		05/26/1994
Dieldrin	ND		3	ug/kg	8080		05/26/1994
Endosulfan I	ND		3	ug/kg	8080		05/26/1994
Endosulfan II	ND		3	ug/kg	8080		05/26/1994
Endosulfan sulfate	ND		3	ug/kg	8080		05/26/1994
Endrin	ND		3	ug/kg	8080		05/26/1994
Endrin aldehyde	ND		3	ug/kg	8080		05/26/1994
Heptachlor	ND		3	ug/kg	8080		05/26/1994
Heptachlor epoxide	ND		5	ug/kg	8080		05/26/1994
Methoxychlor	ND		60	ug/kg	8080		05/26/1994
Toxaphene	--						05/26/1994
POLYCHLORINATED BIPHENYLS							
Aroclor 1016	ND		100	ug/kg	8080		05/26/1994
Aroclor 1221	ND		500	ug/kg	8080		05/26/1994
Aroclor 1232	ND		200	ug/kg	8080		05/26/1994
Aroclor 1242	ND		100	ug/kg	8080		05/26/1994
Aroclor 1248	ND		100	ug/kg	8080		05/26/1994
Aroclor 1254	ND		50	ug/kg	8080		05/26/1994
Aroclor 1260	ND		50	ug/kg	8080		05/26/1994
SURROGATE RESULTS	--						05/26/1994
Tetrachlorometaxylene (SRR)	52			% Rec.			05/26/1994
Decachlorobiphenyl (SRR)	76			% Rec.			05/26/1994

NOTE: Results apply only to the samples analyzed. Reproduction of this report is permitted only in its entirety.



Client Acct: 10190
 Client Name: Subsurface Environmental
 NET Job No: 94.02027

Date: 06/06/1994
 ELAP Certificate: 1386
 Page: 9

Ref: Frank Zilmichi-Z Rental Properties, Albany, Proj: 94153

CONTINUING CALIBRATION VERIFICATION STANDARD REPORT

Parameter	CCV	CCV	CCV	Units	Date Analyzed	Analyst Initials
	Standard % Recovery	Standard Amount Found	Standard Amount Expected			
METHOD #080 (GC,Solid)						
Aldrin	87.5	35.0	40.0	ug/kg	05/26/1994	nds
alpha-BHC	90.0	36.0	40.0	ug/kg	05/26/1994	nds
beta-BHC	95.0	38.0	40.0	ug/kg	05/26/1994	nds
delta-BHC	89.0	35.6	40.0	ug/kg	05/26/1994	nds
gamma-BHC (Lindane)	91.3	36.5	40.0	ug/kg	05/26/1994	nds
Chlordane		N/A	500	ug/kg	05/26/1994	nds
4,4'-DDD	91.0	72.8	80.0	ug/kg	05/26/1994	nds
4,4'-DDE	89.3	71.4	80.0	ug/kg	05/26/1994	nds
4,4'-DDT	84.5	67.6	80.0	ug/kg	05/26/1994	nds
Dieldrin	87.1	69.7	80.0	ug/kg	05/26/1994	nds
Endosulfan I	89.5	35.8	40.0	ug/kg	05/26/1994	nds
Endosulfan II	93.9	75.1	80.0	ug/kg	05/26/1994	nds
Endosulfan sulfate	84.5	67.6	80.0	ug/kg	05/26/1994	nds
Endrin	90.4	72.3	80.0	ug/kg	05/26/1994	nds
Endrin aldehyde	88.5	70.8	80.0	ug/kg	05/26/1994	nds
Heptachlor	85.0	35.6	40.0	ug/kg	05/26/1994	nds
Heptachlor epoxide	89.3	35.7	40.0	ug/kg	05/26/1994	nds
Methoxychlor	92.8	371	400	ug/kg	05/26/1994	nds
Toxaphene		N/A	1000	ug/kg	05/26/1994	nds
Aroclor 1016		N/A	500	ug/kg	05/26/1994	nds
Aroclor 1221		N/A	500	ug/kg	05/26/1994	nds
Aroclor 1232		N/A	500	ug/kg	05/26/1994	nds
Aroclor 1242		N/A	500	ug/kg	05/26/1994	nds
Aroclor 1248		N/A	500	ug/kg	05/26/1994	nds
Aroclor 1254		N/A	500	ug/kg	05/26/1994	nds
Aroclor 1260		N/A	500	ug/kg	05/26/1994	nds
Tetrachlorometaxylene (SURR)	93.0	93	100	% Rec.	05/26/1994	nds
Decachlorobiphenyl (SURR)	86.0	86	100	% Rec.	05/26/1994	nds

NOTE: Results apply only to the samples analyzed. Reproduction of this report is permitted only in its entirety.



Client Acct: 10190
 Client Name: Subsurface Environmental
 NET Job No: 94.02027

Date: 06/06/1994
 BLAP Certificate: 1386
 Page: 10

Ref: Frank Zilmichi-Z Rental Properties, Albany, Proj: 94153

METHOD BLANK REPORT

Parameter	Method	Reporting	Units	Date	Analyst
	Blank			Amount	Analyzed
	Found	Limit			
METHOD 8080 (GC.Solid)					
Aldrin	ND	1.2	ug/kg	05/26/1994	nds
Alpha-BHC	ND	0.3	ug/kg	05/26/1994	nds
Beta-BHC	ND	0.3	ug/kg	05/26/1994	nds
delta-BHC	ND	0.3	ug/kg	05/26/1994	nds
gamma-BHC (Lindane)	ND	1.2	ug/kg	05/26/1994	nds
Chlordane	ND	25	ug/kg	05/26/1994	nds
4,4'-DDD	ND	3	ug/kg	05/26/1994	nds
4,4'-DDE	ND	3	ug/kg	05/26/1994	nds
4,4'-DDT	ND	3	ug/kg	05/26/1994	nds
Dieldrin	ND	3	ug/kg	05/26/1994	nds
Endosulfan I	ND	3	ug/kg	05/26/1994	nds
Endosulfan II	ND	3	ug/kg	05/26/1994	nds
Endosulfan sulfate	ND	3	ug/kg	05/26/1994	nds
Endrin	ND	3	ug/kg	05/26/1994	nds
Endrin aldehyde	ND	3	ug/kg	05/26/1994	nds
Heptachlor	ND	3	ug/kg	05/26/1994	nds
Heptachlor epoxide	ND	5	ug/kg	05/26/1994	nds
Methoxychlor	ND	60	ug/kg	05/26/1994	nds
Toxaphene	ND	100	ug/kg	05/26/1994	nds
Aroclor 1016	ND	500	ug/kg	05/26/1994	nds
Aroclor 1221	ND	200	ug/kg	05/26/1994	nds
Aroclor 1232	ND	100	ug/kg	05/26/1994	nds
Aroclor 1242	ND	100	ug/kg	05/26/1994	nds
Aroclor 1248	ND	50	ug/kg	05/26/1994	nds
Aroclor 1254	ND	50	ug/kg	05/26/1994	nds
Aroclor 1260	ND	50	ug/kg	05/26/1994	nds
Tetrachlorometaxylene (SURR)	51		% Rec.	05/26/1994	nds
Decachlorobiphenyl (SURR)	92		% Rec.	05/26/1994	nds

NOTE: Results apply only to the samples analyzed. Reproduction of this report is permitted only in its entirety.



Client Acct: 10190
 Client Name: Subsurface Environmental
 NET Job No: 94.02027

Date: 06/06/1994
 ELAP Certificate: 1386
 Page: 11

Ref: Frank Zilmichi-2 Rental Properties, Albany, Proj: 94153

MATRIX SPIKE / MATRIX SPIKE DUPLICATE

PARAMETER	Matrix Spike			Spike Amount	Sample Conc.	Matrix Spike		Units	Date Analyzed	Analyst Initials
	Matrix Spike % Rec.	Dup % Rec.	RPD			Matrix Spike Conc.	Dup. Conc.			
METHOD 8080 (GC,Solid)										
Aldrin	39.2	43.2	9.7	5.33	2.9	4.99	5.20	ug/kg	05/26/1994	nds
gamma-BHC (Lindane)	47.5	56.5	17.3	5.33	ND	2.53	3.01	ug/kg	05/26/1994	nds
4,4'-DDT	82.5	83.7	1.4	10.7	ND	8.83	8.96	ug/kg	05/26/1994	nds
Dieldrin	83.4	86.1	3.2	10.7	ND	8.92	9.21	ug/kg	05/26/1994	nds
Endrin	99.1	104.7	5.4	10.7	ND	10.6	11.2	ug/kg	05/26/1994	nds
Heptachlor	42.0	61.9	38.3	5.33	ND	2.24	3.3	ug/kg	05/26/1994	nds

NOTE: Results apply only to the samples analyzed. Reproduction of this report is permitted only in its entirety.



Client Acct: 10190
 Client Name: Subsurface Environmental
 NSF Job No: 94.02027

Date: 06/06/1994
 ELAP Certificate: 1386
 Page: 12

Ref: Frank Zilmichi-Z Rental Properties, Albany, Proj: 94153

LABORATORY CONTROL SAMPLE REPORT

Parameter	LCS		LCS	LCS	Units	Date Analyzed	Analyst Initials
	% Recovery	RPD	Amount Found	Amount Expected			
METHOD 8080 (GC,Solid)							
Aldrin	57.6		3.07	5.33	ug/kg	05/26/1994	nds
gamma-BHC (Lindane)	67.7		3.61	5.33	ug/kg	05/26/1994	nds
4,4'-DDT	88.1		9.43	10.7	ug/kg	05/26/1994	nds
Dieldrin	73.6		7.87	10.7	ug/kg	05/26/1994	nds
Endrin	74.3		7.95	10.7	ug/kg	05/26/1994	nds
Heptachlor	60.2		3.21	5.33	ug/kg	05/26/1994	nds
Tetrachlorometaxylene (SURR)	54.0		54	100	% Rec.	05/26/1994	nds
Decachlorobiphenyl (SURR)	95.0		95	100	% Rec.	05/26/1994	nds

NOTE: Results apply only to the samples analyzed. Reproduction of this report is permitted only in its entirety.



KEY TO ABBREVIATIONS and METHOD REFERENCES

- < : Less than; When appearing in results column indicates analyte not detected at the value following. This datum supercedes the listed Reporting Limit.
- * : Reporting Limits are a function of the dilution factor for any given sample. Actual reporting limits and results have been multiplied by the listed dilution factor. Do not multiply the reporting limits or reported values by the dilution factor.
- dw : Result expressed as dry weight.
- mean : Average; sum of measurements divided by number of measurements.
- mg/Kg (ppm) : Concentration in units of milligrams of analyte per kilogram of sample, wet-weight basis (parts per million).
- mg/L : Concentration in units of milligrams of analyte per liter of sample.
- mL/L/hr : Milliliters per liter per hour.
- MPN/100 mL : Most probable number of bacteria per one hundred milliliters of sample.
- N/A : Not applicable.
- NA : Not analyzed.
- ND : Not detected; the analyte concentration is less than the applicable listed reporting limit.
- NTU : Nephelometric turbidity units.
- RPD : Relative percent difference, $100 \text{ (Value 1 - Value 2) / mean value}$.
- SNA : Standard not available.
- ug/Kg (ppb) : Concentration in units of micrograms of analyte per kilogram of sample, wet-weight basis (parts per billion).
- ug/L : Concentration in units of micrograms of analyte per liter of sample.
- umhos/cm : Micromhos per centimeter.

Method References

Methods 100 through 493: see "Methods for Chemical Analysis of Water & Wastes", U.S. EPA, 600/4-79-020, Rev. 1983.

Methods 601 through 625: see "Guidelines Establishing Test Procedures for the Analysis of Pollutants" U.S. EPA, 40 CFR, Part 136, Rev. 1988.

Methods 1000 through 9999: see "Test Methods for Evaluating Solid Waste", U.S. EPA SW-846, 3rd edition, 1986., Rev. 1, December 1987.

SM: see "Standard Methods for the Examination of Water & Wastewater, 17th Edition, APHA, 1989.

Revised September, 1993
abb.93

9352

SUBSURFACE ENVIRONMENTAL CORP. (1311 + Report to SE office)
11072 San Pablo Ave., Suite 315, El Cerrito, CA 94530
Tele: (510) 215-6553 • Fax: (510) 234-7521

CHAIN OF CUSTODY RECORD

Owner: FRANK ZUMICHEZ RENTAL PROPERTIES
Address: 545 CLEVELAND AVE, ALBANY
Phn: (510) 525-9652 Fax: N/A

Sampler: Michael Goeman
Sampler Signature: Michael B Goeman

Project Location: 711 CLEVELAND, ALBANY
Project #: 94153
Bill To: SUBSURFACE ENVIRONMENTAL

TURN AROUND TIME: STANDARD

ANALYSIS REQUEST

BTEX & TPH as Gasoline	
TPH as Diesel	
Total Petroleum Oil & Grease	
Total Petroleum Hydrocarbons	
Lead STLC	
PCI	
Other: <u>EPA 3070</u>	

Laboratory Number	Sample ID Number	Sampling		# of Containers	Type Containers	Matrix				Method Preserved			FIELD REMARKS:
		Date	Time			Water	Soil	Sludge	Other	HCL	HNO3	ICE	
	711-001	5/12/94	2:30	4	ST	X						X	STOCKPILE GRID SECTION #1
	711-002	5/12/94	2:30	4	ST	X						X	STOCKPILE GRID SECTION #2
	711-003	5/12/94	2:25	4	ST	X						X	STOCKPILE GRID SECTION #3
	711-004	5/12/94	2:45	4	ST	X						X	STOCKPILE GRID SECTION #4
	711-005	5/12/94	2:55	4	ST	X						X	STOCKPILE GRID SECTION #5
	711-006	5/12/94	3:00	4	ST	X						X	STOCKPILE GRID SECTION #6
	711-007	5/12/94	3:10	4	ST	X						X	STOCKPILE GRID SECTION #7

NOTES: STOCKPILE WEST OF TANK EXCAVATION

Temp Read: 0.70c, 1.70c

CUSTODY SEALED
5/13/94 [Signature]

see attach

RELINQUISHED BY: [Signature] Date: 5/12/94 Time: 13:30 RECEIVED BY: [Signature]

RELINQUISHED BY: [Signature] Date: 5/13/94 Time: 19:00 RECEIVED BY: [Signature]

RELINQUISHED BY: (VIANES) Date: 5/14/94 Time: 10:00 RECEIVED BY: [Signature]

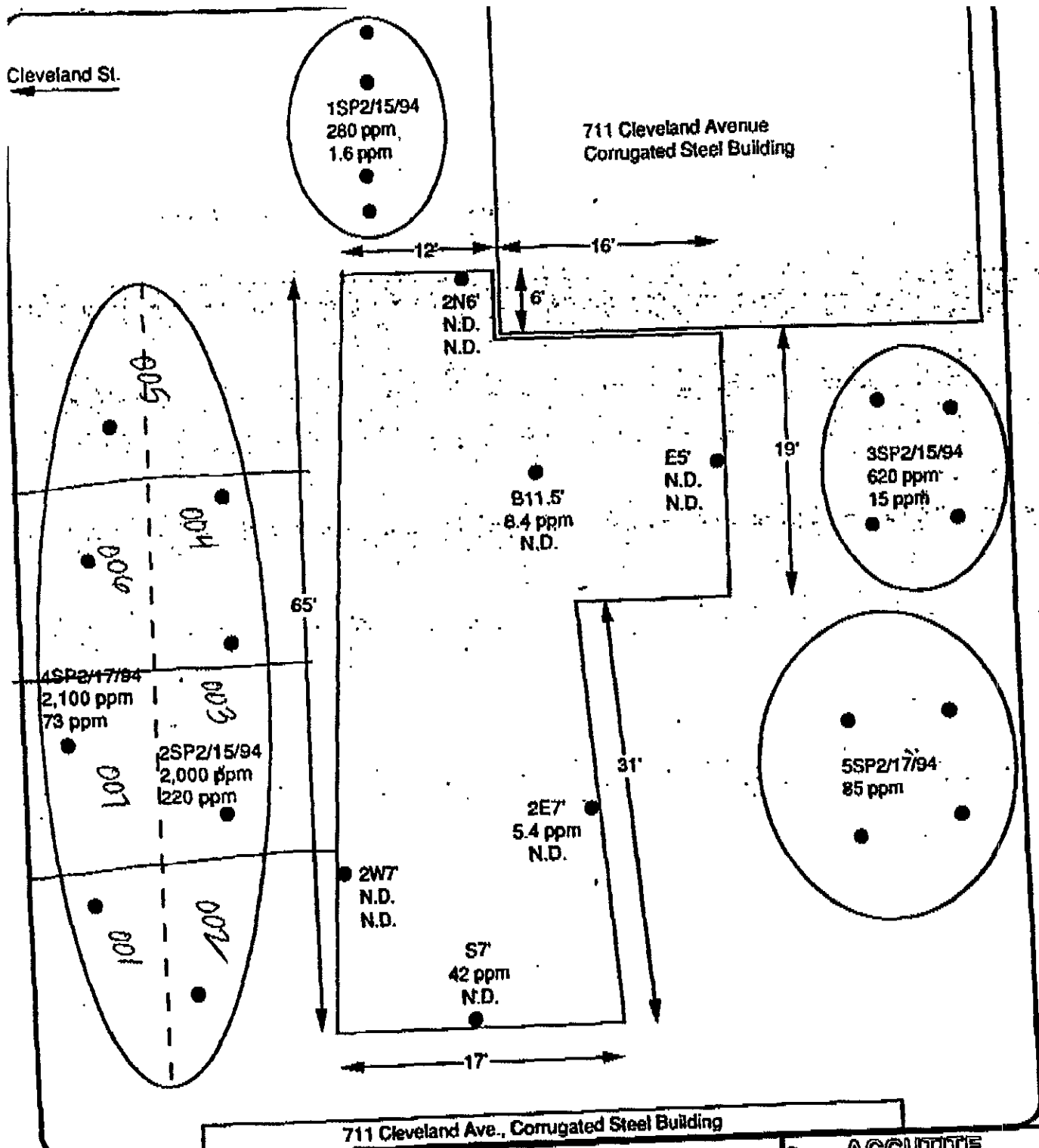

711 Cleveland Ave., Corrugated Steel Building

Revisions	Date	Page
	Over Dig	
	15 Feb 94	of

NORTH

Not to SCALE

Fig. 5

Site: Z Rental
711 Cleveland Street
Albany, CA

Key:
● Soil sample location
S7 = label
42 ppm = results for TPH-D
N.D. = results for TPH-G

By: ACCUTTE
**ENVIRONMENTAL
ENGINEERING**

35 South Linden Avenue
South San Francisco
California 94080