

white - env. health  
yellow - facility  
pink - files

ALAMEDA COUNTY, DEPARTMENT OF  
ENVIRONMENTAL HEALTH  
Hazardous Materials Inspection Form

1131 Harbor Bay Pkwy  
Alameda CA 94502  
510/567-6700

II, III

Site ID # 426 Site Name Kraft Automotive Today's Date 2/23/95

Site Address 1345 Grand Ave

City Piedmont Zip 94610 Phone \_\_\_\_\_

\_\_\_\_\_ MAX AMT stored > 500 lbs, 55 gal., 200 cft.?

**Inspection Categories:**

- \_\_\_\_\_ I. Haz. Mat/Waste GENERATOR/TRANSPORTER  
\_\_\_\_\_ II. Hazardous Materials Business Plan, Acutely Hazardous Materials  
 III. Under ground Storage Tanks site assessment (LOP)

\* Calif. Administration Code (CAC) or the Health & Safety Code (HS&C)

**Comments:**

3 Sbs advanced

TW-1 to 10' depth - dense sandy clay - refusal at 10'  
no obvious GW in boring

TW-2 to 13' depth - dense sandy clay (w/ gravelly sand lens)

TW-3 to 13' depth - HC odor at 3-5' depth - then no odor  
beginning 5' -

Contact \_\_\_\_\_

Title \_\_\_\_\_

Signature \_\_\_\_\_

Inspector \_\_\_\_\_

Signature \_\_\_\_\_

II, III

ALAMEDA COUNTY  
HEALTH CARE SERVICES

AGENCY

DAVID J. KEARS, Agency Director



RAFAT A. SHAHID, Assistant Agency Director

StID 426

February 16, 1995

Mr. Thomas Echols  
Subsurface Consultants, Inc  
171 12th Street, Suite 201  
Oakland, CA 94607

ALAMEDA COUNTY CC4580  
DEPT. OF ENVIRONMENTAL HEALTH  
ENVIRONMENTAL PROTECTION DIV.  
1131 HARBOR BAY PKWY., #250  
ALAMEDA CA 94502-6577

**RE: Workplan Approval for 1345-1375 Grand Ave, Piedmont 94610**

Dear Mr. Echols:

I have completed review of Subsurface Consultants, Inc's (SCI) February 1995 Workplan for Groundwater Contamination Assessment for the above referenced site. The proposal to install three temporary wells and collect soil and grab groundwater samples is acceptable. Since SCI believes groundwater flows in the southerly direction beneath this site, the well proposed in the northeast corner of the property should be relocated so it is south of the former tank complex (and as agreed, it will be moved to the other side of the office building).

Be advised, if groundwater contamination is detected, permanent monitoring wells may be required. Field work is planned for February 23, 1995. Please notify me of any changes in this schedule. If you have any questions, I can be reached at (510) 567-6762.

A handwritten signature in cursive script, appearing to read "eva chu".

eva chu  
Hazardous Materials Specialist

cc: Patrick Ellwood, Grand Ave Development, 1345 Grand Ave.  
Piedmont, CA 94610  
Larry Blazer, Alameda County District Attorney's Office  
files

**Subsurface Consultants, Inc.**  
Consulting Engineers

**FAX TRANSMISSION COVER SHEET**

To: Eva Chu

Receiver's Fax: 337 - 9335

Company: ACHCSA

From: Tom Echols

**RUSH!**  
Please Deliver Immediately

Date: 2/13/95 SCI Job No.: 740.003 Pages Transmitted: 1

Project: 1345-1375 Grand Ave., Piedmont Subject: Workplan dated 2/8/95

- For Your Review and Comment
- Original Will Be Mailed
- For Your Information

- As Requested
- Please Return an Executed Copy
- \_\_\_\_\_

Copies have also been sent to: \_\_\_\_\_  
\_\_\_\_\_

Remarks: Clarification on workplan for 1345 Grand Ave. :  
"monitoring wells" are temporary, will be grouted  
after grab water samples are collected.  
Please call if you have any questions.

**Subsurface Consultants, Inc.**  
171 - 12th Street, Suite 201  
Oakland, California 94607  
510-268-0461 FAX 510-268-0137

ALAMEDA COUNTY  
HEALTH CARE SERVICES  
AGENCY

DAVID J. KEARS, Agency Director



RAFAT A. SHAHID, ASST. AGENCY DIRECTOR

DEPARTMENT OF ENVIRONMENTAL HEALTH  
State Water Resources Control Board  
Division of Clean Water Programs  
UST Local Oversight Program  
80 Swan Way, Rm 200  
Oakland, CA 94621  
(510) 271-4530

StID 426

April 8, 1994

Mr. Patrick Ellwood  
Grand Ave Development  
1345 Grand Ave  
Piedmont, CA 94610

**Subject: SWI for 1345-1375 Grand Ave, Piedmont, CA 94610**

Dear Mr. Ellwood:

On February 18, 1993, this agency requested a Soil and Water Investigation work plan to evaluate groundwater quality beneath the above referenced site. This office concurred with the Alameda County District Attorney's Office that the use of a "power core" or "hydropunch" to obtain groundwater grab samples would be acceptable for this investigation. To date, we have received no communication from you regarding this matter.

According to Section 25298 of the California Health and Safety Code, underground storage tank closure is incomplete until the responsible party characterizes and remediates the contamination resulting from product discharge. Therefore, you, as the responsible party are in violation of this section of the Code, for which Section 25299 specifies civil penalties of up to \$5,000, for each day of violation, upon conviction. Also, failure to furnish technical reports regarding documented or potential groundwater contamination violates Section 13267(b) of the California Water Code. The Regional Water Quality Control Board (RWQCB) can impose civil penalties of up to \$1,000 per day that such a violation continues.

You are required to submit the requested workplan to this office **by May 10, 1994**. Modification of required tasks or extensions of stated deadlines must be confirmed in writing by either this agency or the RWQCB.

Should you have any questions about the content of this letter, please contact me at (510) 271-4530.

Sincerely,

A handwritten signature in cursive script, appearing to read "Eva Chu".

eva chu  
Hazardous Materials Specialist

cc: Larry Blazer, Alameda County District Attorney's Office  
files (kraft2)



Alameda County  
District Attorney's Office  
John J. Meehan, District Attorney

93 JUL 15 11:12:00

JRC  
7/16/93

July 15, 1993

STD 426

Robert K. Lane, Esq.  
The Ordway Building  
One Kaiser Plaza, Suite 301  
Oakland, CA 94612-3603

Re: 1345-1375 Grand Avenue  
Piedmont, California

Dear Mr. Lane:

Pursuant to our conversation on Tuesday regarding the need for a site investigation at the above location, this is an explanation of what is wanted by the County's Hazardous Materials Division.

There are two areas of concern. The first is in the area of the former waste oil tank located at the southwest portion of the site. The initial soil sample at that point indicated 3000 parts per million (ppm) oil and grease. After further excavation, another sample was apparently taken with no detection of oil and grease. Unfortunately there was, at that time, no effort to look for chlorinated hydrocarbons, metal, diesel, BTEX or semi-volatile compounds (some of which migrate through soil much more readily than oil and grease).

As I mentioned, given the financial constraints on your client, the Hazardous Materials Division, in consultation with the Regional Water Quality Control Board, has agreed to forego their standard requirement of monitoring wells, and accept the use of a "power core" for the necessary sampling (within 10 feet of the former waste pit, in the downgradient direction). The boring should be continuously logged (discrete samples taken at regular intervals - to determine soil type) and a groundwater grab sample taken once the boring reaches it. The water sample then needs to be analyzed for TPH-G, TPH-D, BTEX, and chlorinated hydrocarbons, metals and semi-volatile compounds.

Second, a gasoline storage tank used to exist in the northeast portion of the site. Soil from the pit apparently had no detectable gasoline, but water in the pit contained gasoline (14,000 ppb TPH-H) and benzene (580 ppb). It is unclear whether or not the groundwater was pumped out and allowed to recharge before sampling.

Robert K. Lane, Esq.  
July 15, 1993  
Page 2

In this case, the boring should be advanced within 10-20 feet of the former tank, and again continuously logged and a groundwater grab sample taken. The water sample must be analyzed for TPH-G and BTEX.

Enclosed are copies of some listed prices for the type of borings and analyses contemplated. These are presented to you, at your request, without making any representations about the quality of the firms.

As I also mentioned, it is necessary that this investigation be done, at least in the streamlined method outlined above. The responsibility of the property owner to do so is set forth in section 2724 of Title 23 of the California Code of Regulations. It is illegal to "close" an underground storage tank without doing so. (California Health and Safety Code § 25298). Violation of these regulations or statutes can lead to penalties of between \$500 and \$5,000 per day (Health and Safety Code § 25299).

Although your client is in Chapter 11 bankruptcy, there is nonetheless a continuing obligation of the debtor-in-possession to comply with state laws (28 U.S.C. § 959(b)). Although you and I have agreed that it would be a bit of a waste to actually litigate this matter, your client should be aware that the automatic stay in bankruptcy would not apply in this case, because of our status as a governmental unit, enforcing it's police or regulatory power (11 U.S.C. § 362(b)(4); see e.g. *Penn Terra Ltd. v. Department of Environmental Resources*, 733 F.2d 267 (3d Cir. 1984)). Moreover, any penalties assessed for failure to comply with the underground tank laws would not be dischargeable in bankruptcy. (11 U.S.C. § 523(a)(7))

Normally, I would simply suggest that this investigation be commenced within the next 30 days. However, as this necessarily entails expenditures, the bankruptcy complicates things. I therefore suggest that we enter into a stipulated judgment, including an injunction embracing the terms mentioned above. You can then endeavor to elicit the permission of the court to spend the money, as an administrative expense.

I would like this agreement to be memorialized within the next 30 days, because, if this bogs down, I do want to get a complaint filed. As I said, if we can resolve this amicably, I will not be seeking any penalties.

Robert K. Lane, Esq.  
July 15, 1993  
Page 3

After reviewing this letter with your client and co-counsel,  
please give me a call.

Very truly yours,

JOHN J. MEEHAN  
District Attorney

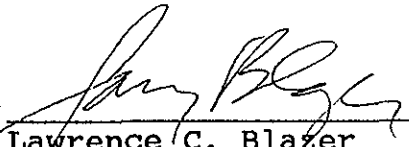
By:   
Lawrence C. Blazer  
Deputy District Attorney

JJM:LCB:rf

Enclosure

cc: Eva Chu, Alaco HazMat

SAMPLING REPORT 86156MI 6-5-86 BAY EXCAVATORS, GRAND AVENUE STATIONS, PIEDMONT, CA

MAP REF: THOMAS BROS.  
ALAMEDA COUNTY  
P. 9 A-2

LEGEND: F = FILL END

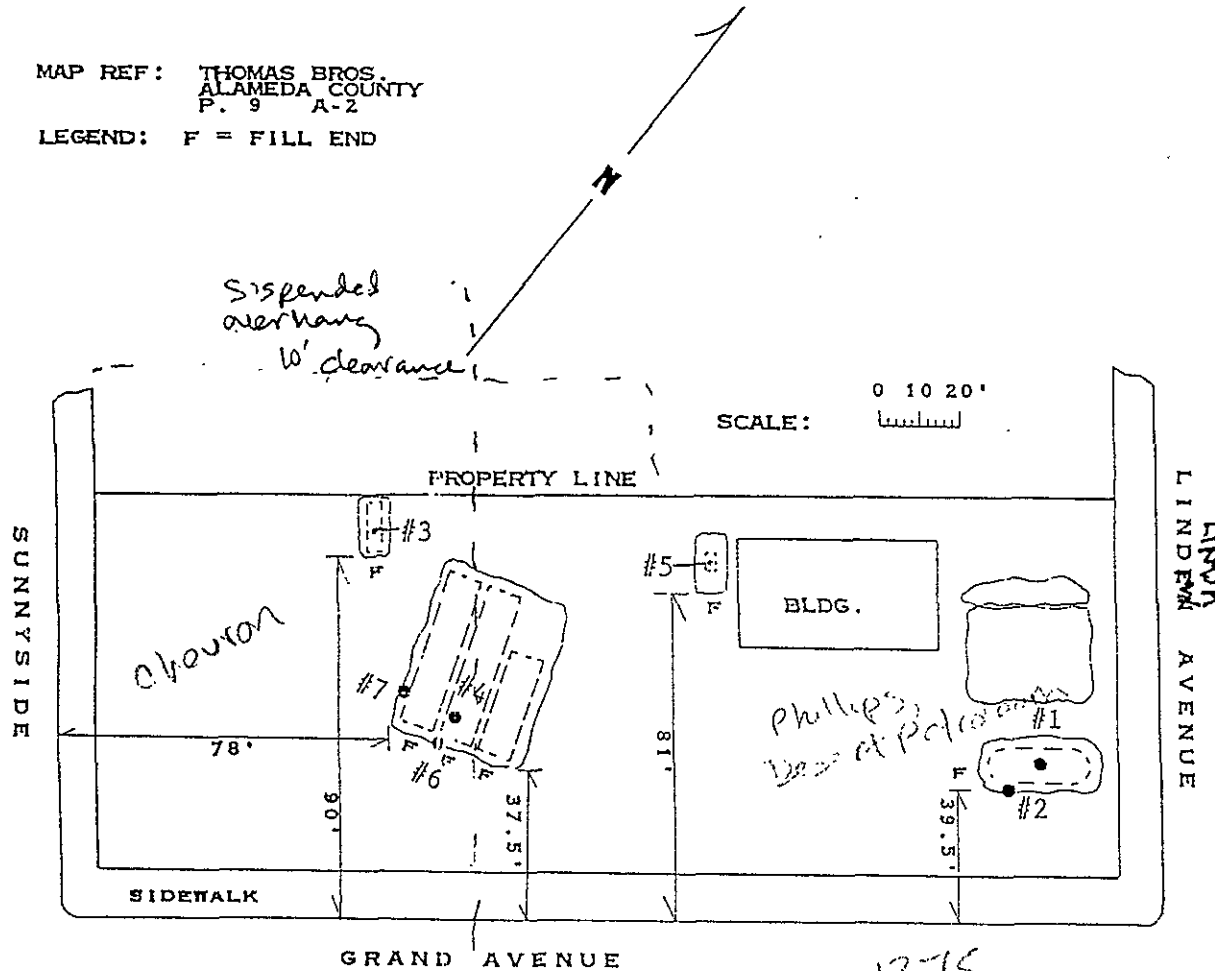

- #1 SUBSURFACE WATER SAMPLE ANALYSIS FOR GASOLINE, BENZENE, TOLUENE, AND XYLENE AT SEQUOIA ANALYTICAL LABORATORY SEQUOIA LAB NO. 6060153
- #2 SOIL FROM PIT WALL AT 6' ANALYSIS FOR GASOLINE SEQUOIA LAB NO. 6060154
- #3 SOIL FROM 7.5' ANALYSIS FOR WASTE OIL SEQUOIA LAB NO. 6060155
- #4 SUBSURFACE WATER SAMPLE ANALYSIS FOR GASOLINE, BENZENE, TOLUENE, XYLENE, AND DIESEL SEQUOIA LAB NO. 6060156
- #5 SOIL FROM 8.5' ANALYSIS FOR WASTE OIL SEQUOIA LAB NO. 6060157
- #6 SOIL FROM PIT WALL AT 6.5' ANALYSIS FOR DIESEL AND GASOLINE SEQUOIA LAB NO. 6060158
- #7 SOIL FROM 6.5' ANALYSIS FOR DIESEL AND GASOLINE SEQUOIA LAB NO. 6060159

SAMPLING PERFORMED BY  
HELEN MAWHINNEY

DIAGRAM PREPARED BY  
TAMMIE STALLINGS

*Tammie Stallings*



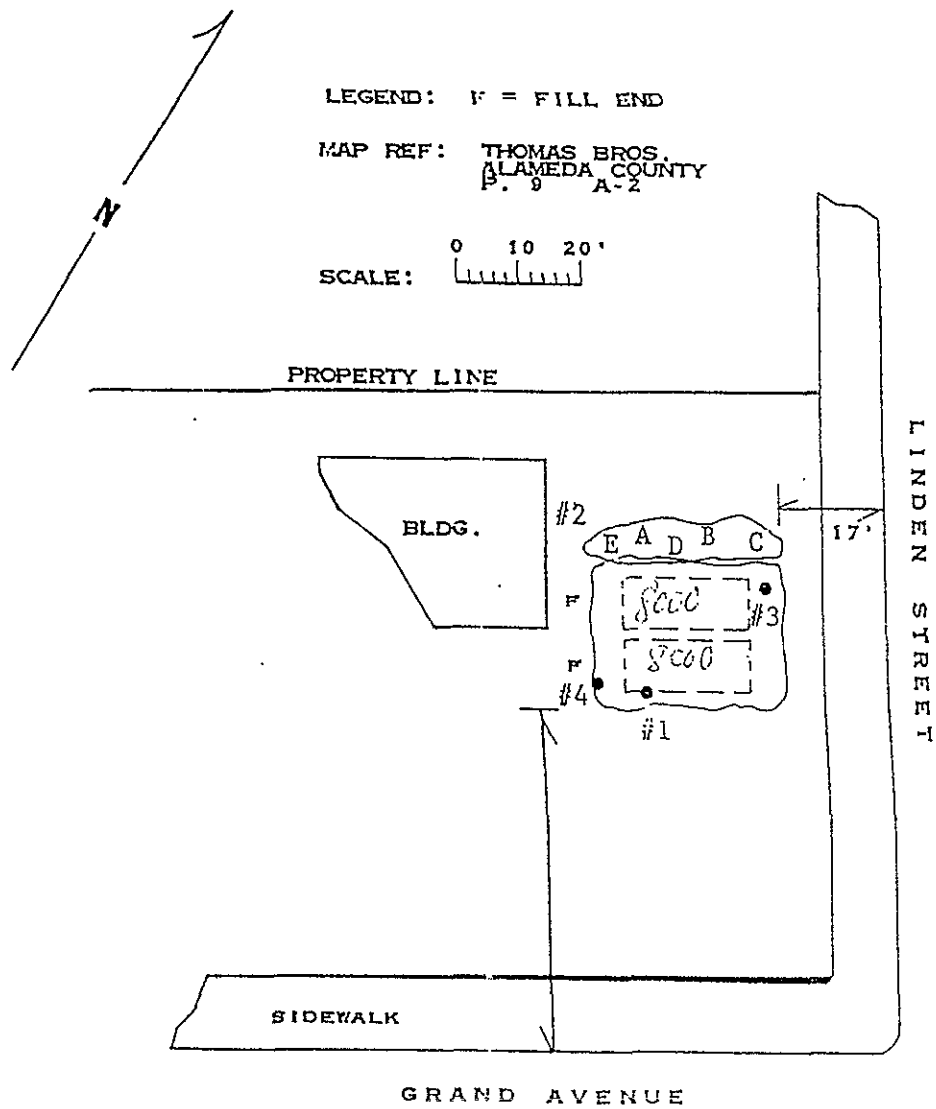

LEGEND: F = FILL END  
MAP REF: THOMAS BROS.  
ALAMEDA COUNTY  
P. 9 A-2  
SCALE: 0 10 20'

- #1 RECHARGE WATER SAMPLE FROM 7-8' ANALYSIS FOR GASOLINE AT SEQUOIA ANALYTICAL LABORATORY SEQUOIA LAB NO. 6051311
- #2 STOCKPILE SOIL COMPOSITE FROM SAMPLE POINTS A-E AT 12-18" BELOW SURFACE ANALYSIS FOR GASOLINE SAMPLE PLACED ON 'HOLD'
- #3 SOIL FROM 13' ANALYSIS FOR GASOLINE SEQUOIA LAB NO. 6051311-2
- #4 SOIL FROM 13' ANALYSIS FOR GASOLINE SEQUOIA LAB NO. 6051311-3

SAMPLING PERFORMED BY  
RICHARD C. BLAINE  
DIAGRAM PREPARED BY  
TAMMIE STALLINGS

*Tammie Stallings*

## SCHEDULE OF FEES



**ELECTRONIC CONE PENETRATION TESTING (CPT)  
DOWNHOLE SEISMIC VELOCITY SURVEY  
SOIL, GROUNDWATER AND SOIL GAS SAMPLING**

January 1991

**Base Rate for 20-Ton Rig and 2-Person Crew**

1. Travel and Time On Site . . . . . Per Hour . . . . \$ 130.00

**Additional Charges (As Applicable)**

2. CPT Data Acquisition and Processing

a. Basic CPT Data (Includes On-Site Plot of Cone Tip  
Resistance, Sleeve Friction, and Friction Ratio) . . . . . Per Foot . . . . 4.00

b. Addition of Pore Pressure Logging to CPT Data  
(Piezometric CPT) . . . . . Per Foot . . . . 0.50

c. Pore Pressure Dissipation Data Plot . . . . . Per Dissipation . . . . 25.00

d. Computer Processing of CPT Data to Derive Soil Type . . . . . Per Foot . . . . 0.25

e. Computer Processing of CPT Data to Derive Soil Type,  
Equivalent SPT Blowcounts, Relative Density and  
Drained and Undrained Shear Strength Parameters . . . . . Per Foot . . . . 0.50

f. CPT Data On Floppy Diskettes . . . . . Per Foot . . . . 0.10

3. Downhole Seismic Velocity Survey

a. Travel and Time On Site for Geophysicist  
and Equipment . . . . . Per Hour . . . . 130.00

b. Data Interpretation . . . . . Per Test . . . . 35.00

c. Report Describing Procedures (Optional) . . . . . Lump Sum . . . . 750.00

4. Soil Sampling Using Piston Sampler

a. Mobilization . . . . . Lump Sum . . . . 475.00

b. Sampling Equipment and Expendables  
(Including Capped Sample Liners) . . . . . Per Penetration . . . . 135.00

5. Groundwater Sampling Using Hydropunch<sup>™</sup> Probe

a. Mobilization . . . . . Lump Sum . . . . 475.00

b. Sampling Equipment and Expendables  
(Not Including Sample Vials) . . . . . Per Penetration . . . . 135.00

6. Groundwater Sampling Using BAT Enviroprobe<sup>®</sup> System

a. Mobilization . . . . . Lump Sum . . . . 950.00

b. Sampling Equipment and Expendables  
(Not Including Sample Vials) . . . . . Per Sample Point . . . . 150.00

7. Soil Gas Sampling Using Active Sampling System . . . . . Quoted Upon Request

8. Small-Diameter Well Point Installation . . . . . Quoted Upon Request

9. Decontamination Support Equipment

a. Automatic Rod Washing System, Generator,  
Pump, Steam Cleaner, and Water Tank . . . . . Per Day . . . . 175.00

b. D.O.T.-Approved Drums for Rinsate Containment  
(Typically Require 1 Drum Per 1 to 2 Days) . . . . . Per Drum . . . . 50.00

10. Health and Safety Protective Gear	
a. Level "D" .....	Per Day . . . . \$ 50.00
b. Level "C" .....	Per Day . . . . 200.00
c. Level "B" .....	Quoted Upon Request
11. Personnel Exposure Monitoring Equipment	
a. Organic Vapor Analyzer (OVA) .....	Per Day . . . . 75.00
b. Photo-Ionization Device (PID) .....	Per Day . . . . 75.00
c. Combustible Gas Indicator (CGI) .....	Per Day . . . . 50.00
d. Drager Tubes .....	Per Day . . . . 30.00
12. Other Charges	
a. Pump, Tremie Pipe and Bentonite for Backfilling Open Probe Holes .....	Per Day . . . . 125.00
b. Coring Machine .....	Per Day . . . . 150.00
c. Travel and Time On Site for Third Technician .....	Per Hour . . . . 55.00
d. Per Diem (May Be Higher in Certain Locations) .....	Per Person Per Day . . . . 80.00
e. Extra Charge for Weekend or Holiday Work .....	Per Hour . . . . 50.00
f. Shift Change for Night Work .....	Lump Sum . . . . 1,500.00

Minimum Average Daily Charge ..... 1,500.00

**Terms and Conditions**

1. Earth Technology quotations and/or proposals for in situ testing services are valid for a maximum period of 90 days from the date of the initial quote. Written authorization to perform services must be provided prior to the start of work.
2. The Client shall obtain all necessary permits and access agreements, including, but not limited to, private road or site access and permission to conduct work. Any additional costs associated with non-availability of the required permits (including, but not limited to, standby time, transportation charges, mobilization, demobilization) that are incurred by Earth Technology shall be paid by the Client.
3. The Client shall provide adequate access to the site and the test locations on the site. In the event access is not adequate, the costs incurred in providing suitable access (including, but not limited to, standby time, transportation charges, and subcontractor charges) shall be paid by the Client.
4. Prior to in situ testing activities, the Client will to the best of its knowledge, disclose the locations of any man-made underground structures (including but not limited to: pipes, utility lines, tanks, drums, drains, etc.). Client will further identify or otherwise properly mark all locations intended for subsurface penetrations. Client acknowledges that Earth Technology retains no responsibility or liability for any loss or damage resulting to such underground structures or arising from any damage to such underground structures.
5. All samples and decontamination rinsate generated on site are the property and responsibility of the Client. Earth Technology will not be responsible for disposal or transportation of such materials from the site.
6. Achievable probe penetration depth is subject to geologic conditions. Probe penetrations will be halted upon reaching refusal, as determined by Earth Technology. Deeper penetration may be attempted upon the Client's written request. In doing so, the Client accepts responsibility for any lost and/or damaged equipment. All penetrated footage will incur charges based on the unit rates specified in this Schedule of Fees.

**THE EARTH TECHNOLOGY CORPORATION**  
**TESTING SERVICES GROUP**  
 18411 Gothard Street, Suite F, Huntington Beach, CA 92648  
 Telephone (714) 842-7011 Fax (714) 842-3735  
 (415) 649-9191

OTHER U.S. CITIES

Long Beach, CA	Irving, CA	San Bernardino, CA	Berkeley, CA
Sacramento, CA	Portland, OR	Las Vegas, NV	Phoenix, AZ
Houston, TX	Milwaukee, WI	Oak Ridge, TN	Washington, DC
Cherry Hill, NJ	Bethmawr, NJ	New York, NY	



# FEE SCHEDULE

July 1992

from Curtis & Tompkins, Ltd. • Berkeley (510) 486-0900 • Los Angeles (213) 269-7421  
California's Premier Analytical Laboratory Since 1878

## Underground Storage Tank

	Total Volatile Hydrocarbons - Gas	EPA 8015/LUFT	\$85.00
	Total Extractable Hydrocarbons - Diesel	EPA 8015/LUFT	\$85.00
	Aromatic Hydrocarbons (BTEX only)	EPA 8020	\$85.00
① ②	Total Volatile Hydrocarbons/BTEX	EPA 8015/8020	\$125.00
	Ethylene Dibromide (EDB)	EPA 8010/504	\$90.00
②	Oil and Grease (Gravimetric)	SMWW 5520BF/EF	\$60.00
	Oil and Grease (IR)	EPA 413.2	\$60.00
	Total Recoverable Petroleum Hydrocarbons	EPA 418.1	\$60.00
① ②	Organic Lead <i>All but Gasoline</i>	DHS LUFT Manual	\$60.00

## Organic Chemistry

	Halogenated Volatile Organics	EPA 8010	\$100.00
	Aromatic Volatile Organics	EPA 8020	\$100.00
②	Halogenated/Aromatic Volatile Organics	EPA 8010/8020	\$180.00
	PCBs	EPA 8080	\$80.00
	Organochlorine Pesticides & PCBs	EPA 8080	\$150.00
	Organophosphorus Pesticides	EPA 8140	\$150.00
	Chlorinated Herbicides	EPA 8150	\$200.00
	Volatile Organics	EPA 8240	\$225.00
	Volatile Organics (Modified List)	EPA 8260	\$275.00
	Polynuclear Aromatic Hydrocarbons	EPA 8270	\$175.00
	Pentachlorophenol	EPA 8270	\$150.00
	Phenols	EPA 8270	\$175.00
	Phthalates Esters	EPA 8270	\$175.00
②	Semivolatile Organics (BNAs)	EPA 8270	\$400.00
	Polynuclear Aromatic Hydrocarbons	EPA 8310	\$200.00

C&T reserves the right to change pricing without advance notice. All Terms & Conditions apply.

ROBERT K. LANE  
ATTORNEY AT LAW

R. KINGSBURY LANE  
CORPORATION  
THE ORDWAY BUILDING  
ONE KAISER PLAZA, SUITE 301  
OAKLAND, CALIFORNIA 94612-3603  
(510) 465-1933

93061237 11/1/93

April 27, 1993

Ms. Eva Chu  
Alameda County Health Care Services  
Department of Environmental Health  
80 Swan Way - Room 200  
Oakland, CA 94621

Re: 1345-1375 Grand Avenue, Piedmont, California

Dear Ms. Chu:

This office has been asked by Grand Avenue Development to respond to your correspondence requesting a soil and water investigation at the above referenced site. As you are aware, there is a Chapter 11 Bankruptcy filing with regard to this site which is likely to proceed for some time. While Grand Avenue Development is desirous of cooperating with you, two rather important issues must be resolved. The first is that this matter was under your department's control and supervision in May of 1986. Tests were performed at the direction of the County, all sources of discharge were removed, and the test results at that time were satisfactory with the County. Thereafter, the County took no other action nor was any further action requested at any level until mid-February of this year, some seven (7) years later.

At the time the County was last involved, the County was well aware that Grand Avenue Development was going to construct buildings and other improvements on the property. As you know, those buildings and improvements have been in fact constructed and finished. I think it is appropriate to ask why the County deemed the matter closed for 7 years only to reopen it now? Further, I understand that the sinking of any test wells on this property may be an exercise in regulatory futility in any case, since, even if some condition were discovered, no viable solution could be found for remediation. That begs the question, why begin a process that has as its end, the means?

That brings us to the second issue: Grand Avenue Development does not have the means to accomplish any investigation. Grand Avenue Development is presently unable to meet the demands of even the administrative expenses of the Bankruptcy, much less embark on an investigation of unknown duration and cost. I can only

Ms Eva Chu  
April 27, 1993

Page 2

suggest that if the County feels the matter important enough to proceed, that the County do the investigation and file a claim in the bankruptcy for the cost.

However, the County should consider that it is Chevron and Phillips Petroleum that are the responsible persons for any discharges in this matter. They undoubtedly have the financial wherewithal to respond to your request. Grand Avenue Development acted in good faith and in reliance on the County's actions and inactions of 7 years ago. Please consider whether or not there is a true benefit to the public or anyone else in spending County funds on this matter.

Thank you for your consideration. If you have any questions, please call or write.

~~Very truly yours,~~

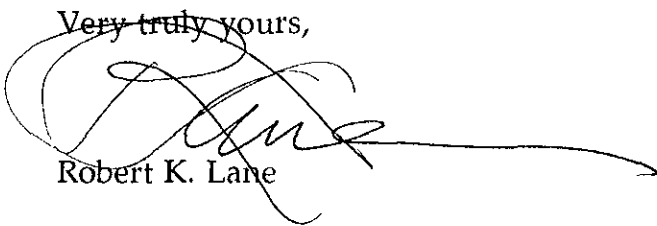
A handwritten signature in black ink, appearing to read "R. Lane", with a long horizontal flourish extending to the right.

Robert K. Lane

RKL:ja  
ccc

**Alameda County Department of Environmental Health  
Hazardous Materials Division**

80 Swan Way, Rm. 200, Oakland, CA 94621  
Ph: 510-271-4320

**BILLING FOR SERVICES**

STD# 426

A. Site Name Kraft Automotive Service / Pat Ellwood Phone \_\_\_\_\_  
 Site Address 1345 Grand Ave Piedmont 94610  
(If no address, description of area) Number Street City Zip  
 Prior Business Name Kraft Automotive Service Prior Owner's Name \_\_\_\_\_

B. Service Requestor Jose Bermudez - Subsurface Consultants  
Contact Person Company Name Phone  
 Billing Address 171 - 12th St. Oakland 94607  
Number Street City Zip

<u>Category of Service</u>		#Hours	x \$	/Hr	\$
<input checked="" type="checkbox"/> Site Search		<u>75</u>		<u>1</u>	<u>75</u>
<input type="checkbox"/> File Search					
<input type="checkbox"/> Other					
		<u>Other</u>			
<b>TOTAL CHARGE:</b>					<u>\$ 75<sup>00</sup></u>

REMARKS: \_\_\_\_\_  
 \_\_\_\_\_  
 \_\_\_\_\_  
 \_\_\_\_\_  
 \_\_\_\_\_

**You will receive an invoice in accordance with Article 11 of Chapter 6, Title 3 of the Ordinance Code of Alameda County**

Service Requestor Jose Bermudez [Signature] Date 3/19/93  
printed name signature  
 HazMat Specialist Evachin [Signature] Date 3/19/93  
printed name signature

ALAMEDA COUNTY  
HEALTH CARE SERVICES  
AGENCY

DAVID J. KEARS, Agency Director



RAFAT A. SHAHID, ASST. AGENCY DIRECTOR

StID 426

February 18, 1993

Mr. Patrick Ellwood  
Grand Ave Development  
1345 Grand Ave  
Piedmont, CA 94610

DEPARTMENT OF ENVIRONMENTAL HEALTH  
State Water Resources Control Board  
Division of Clean Water Programs  
UST Local Oversight Program  
80 Swan Way, Rm 200  
Oakland, CA 94621  
(510) 271-4530

**Subject: SWI for 1345-1375 Grand Ave., Piedmont, CA 94610**

Dear Mr. Ellwood:

This office has completed review of the file for the above referenced site. In May 1986 work began to remove four underground storage tanks (USTs) from each of the above sites. A water sample taken from the easternmost pit at 1375 Grand Ave exhibited 14 parts per million (ppm) total petroleum hydrocarbons as gasoline (TPH-G) and 580 parts per billion (ppb) as benzene. An initial soil sample taken from native soil beneath the waste oil UST at 1345 Grand Ave exhibited up to 3,000 ppm waste oil. This pit was subsequently over-excavated where confirmatory soil sample collected was non-detectable for waste oil.

Clearly an unauthorized release of petroleum products has occurred at the site. At this time further investigations are required to determine the lateral and vertical extent, and severity of contamination to soil and groundwater which may have resulted from the release.

Such an investigation shall be in the form of a **Soil and Water Investigation**, or SWI. The information gathered by the SWI will be used to determine an appropriate course of action to remediate the site, if deemed necessary. The SWI must be conducted in accordance with the RWQCB Staff Recommendations for the Initial Evaluation and Investigation of Underground Tanks, the State Water Resources Control Board LUFT Field Manual, and Article 11 of Title 23, California Code of Regulations. The major elements of such an investigation are summarized in the attached Appendix A.

The SWI proposal is due **within 45 days** of the date of this letter. Once the proposal is approved, field work should commence within 60 days. A report must be submitted within 45 days after the completion of this phase of work at the site. Subsequent reports are to be submitted quarterly until this site qualifies for RWQCB "sign off." All reports and proposals must be submitted under seal of a California Registered Geologist, Certified Engineering Geologist, or Registered Civil Engineer.



P. Ellwood  
1345-1375 Grand Ave., Piedmont  
February 18, 1993

Page 2

Please be advised that this is a formal request for technical reports pursuant to Title 23, CCR, Section 2722(c). Any extensions of the stated deadlines, or modifications of the required tasks, must be confirmed in writing by either this agency or the RWQCB. Copies of all proposals and reports must also be sent to Mr. Richard Hiatt of the RWQCB.

Should you have any questions about the content of this letter, please contact me at (510) 271-4530.

Sincerely,

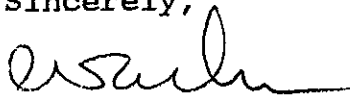

Eva Chu  
Hazardous Materials Specialist

enclosure

cc: Rich Hiatt, RWQCB  
Gil Jensen, Alameda County District Attorney's Office  
Edgar Howell/files 

kraft

1/29/93

Norma -

Please transfer to LOP so I can get  
out reimbursement / notification letter for  
the following site :

SHD # 426

# Site Name: Kraft Automotive Service

Contact: L.W. Kraft

Address: 1345 Grand Av.  
Piedmont, ~~CA~~ CA 94610

Return to Eva Chw - Thanks -

Contains waste oil

1st discovered 6-10-86

reported 6-10-86

Former Chevron tanks

Sunny side

3000 0 G



Linden

1575

0746

Ed Ralston

1345

~~0746~~

Spud's Broadway

W

3

DATE: 1-8-93  
TO : Local Oversight Program  
FROM: Larry Selb  
SUBJ: Transfer of Eligible Oversight Case

Site name: Kraft Automotive Service  
Address: 1345 Grand Ave. city Bismarck zip 58101  
Closure plan attached?  Y  N DepRef remaining \$ None  
DepRef Project # \_\_\_\_\_ STID #(if any) \_\_\_\_\_  
Number of Tanks: 5 removed?  Y  N Date of removal 6-10-86  
Leak Report filed? Y  N Date of Discovery \_\_\_\_\_  
Samples received?  Y  N Contamination: Waste Oil  
Petroleum  Y  N Types: Avgas Jet leaded unleaded Diesel  
fuel oil waste oil kerosene solvents  
Monitoring wells on site  Monitoring schedule? Y  N  
LUFT category 1 2 3 \* H S C A R W G O  
Briefly describe the following:  
Preliminary Assessment None  
Remedial Action None  
Post Remedial Action Monitoring None  
Enforcement Action None

