

CERTIFICATE OF REMEDIATION
OF HYDROCARBON CONTAMINATED SOILS

SUPPLIER:

Scott Company
1919 Market Street
Oakland, Ca. 94607

GENERATOR:

Felix King Knight Company
6202 Christie
Emeryville, Ca.

CERTIFICATE #: S02221-2

JOB #: 91 - 9913

In accordance with Title 22 CDOHS, REMCO has excepted and has caused 37.605 tons of H.C. soil to be recycled under the guidelines of federal, state, and local laws and regulations. The H.C. soil was received 2 / 26 / 1991. In receiving and processing the H.C. soil and in providing this certificate, REMCO has relied upon and is relying upon (a) the representation of the generator that the H.C. soil does not contain any materials classified as, and is not classified as "Hazardous Waste" under the applicable provisions of federal and California law and has been managed and may be treated as other than Hazardous Waste, and (b) the generator has independent written certifications from applicable governmental agencies of certified independent testing laboratories that the H.C. soil does not contain any materials classified as, and is not classified as, "Hazardous Waste" under said applicable law.

REMCO shall indemnify, defend and hold harmless the generator from and against any enforcement actions by any governmental authority in the event that any of the representations by REMCO set forth in this certificate are materially inaccurate. Provided however that this indemnity shall be limited to a maximum of the amount paid to REMCO by the generator for processing this H.C. soil.

R E M C O

Recycling for the future
2717 Goodrick Ave.
Richmond, Ca 94804
(415) 237-5866

By: 

Gene Haynes,
Vice President

Date: 3 / 28 / 91



January 21, 1991
Sample Log 2199

Jay Groh
Scott Company
1919 Market Street
Oakland, CA 94607

Subject: Analytical Results for 1 Soil Sample(s)
Identified as: Felix
Received: 01/14/91
Purchase Order: 106236-58468-72-7001

Dear Mr. Groh:

Analysis of the sample(s) referenced above has been completed. This report is written to confirm results communicated on January 21, 1991 and describes procedures used to analyze the samples.

Sample(s) were received in brass sleeves that were sealed with aluminum foil and plastic endcaps. Each sample was transported and received under documented chain of custody and stored at 4 degrees C until analysis was performed.

Sample(s) were analyzed using the following method(s):

- "BTEX" (EPA Method 8020/Purge-and-Trap)
- "TPH as Gasoline" (Modified EPA Method 8015/Purge-and-Trap)
- "TPH as Diesel, Motor Oil, Jet/Kerosene" (Mod. 8015/Extraction)
- "Organochlorine Pesticides (EPA Method 8080/Extraction)
- "Polychlorinated Biphenyls (PCBs)" (EPA Method 8080/Extraction)
- "Halogenated Solvents" (EPA Method 8010)

Please refer to the following table(s) for summarized analytical results and contact us if you have questions regarding procedures or results. The chain-of-custody document is enclosed.

Approved by:

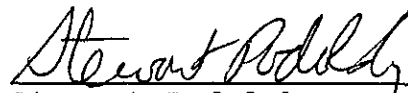
Stewart Podolsky
Senior Chemist



January 21, 1991
Sample Log 2199

Sample: Composite 1

2A
2B
2C
2D

From : Felix
Received : 01/14/91
Matrix: Soil

--all concentrations are units of mg/kg--

Parameter / (Reporting Limit)	Measured Value
Benzene (.005)	<.005
Toluene (.005)	<.005
Ethylbenzene (.005)	<.005
Total Xylenes (.005)	<.005
TPH as Gasoline (.5)	<.5
Extractable TPH (10)	Diesel : <100* Motor Oil : 4200
PCB 1016 (.02)	<.20*
PCB 1221 (.02)	<.20*
PCB 1232 (.02)	<.20*
PCB 1242 (.02)	<.20*
PCB 1248 (.02)	<.20*
PCB 1254 (.02)	<.20*
PCB 1260 (.02)	<.20*

* Increased Reporting Limit due to dilution of extract.



January 21, 1991
Sample Log 2199

Sample: Composite 1
2A
2B
2C
2D

From : Felix
Received 01/14/91
Matrix : Soil

--all concentrations are units of mg/kg--

8010 - Halogenated Volatile Organics

Parameter /	(Reporting Limit)	Measured Value
Chloromethane	(0.01)	<0.01
Chloroethane	(0.01)	<0.01
Vinyl Chloride	(0.01)	<0.01
Bromomethane	(0.01)	<0.01
Trichlorofluoromethane	(.001)	<.001
1,1-Dichloroethene	(.001)	<.001
Dichloromethane	(.001)	<.001
t-1,2-Dichloroethene	(.001)	<.001
1,1-Dichloroethane	(.001)	<.001
Chloroform	(.001)	<.001
1,1,1-Trichloroethane	(.001)	<.001
1,2-Dichloroethane	(.001)	<.001
Carbon Tetrachloride	(.001)	<.001
1,2-Dichloropropane	(.001)	<.001
Trichloroethene	(.001)	<.001
Bromodichloromethane	(.001)	<.001
2-Chloroethylvinyl Ether	(0.01)	<0.01
c-1,3-Dichloropropene	(.001)	<.001
t-1,3-Dichloropropene	(.001)	<.001
1,1,2-Trichloroethane	(.001)	<.001
Tetrachloroethene	(.001)	<.001
Dibromochloromethane	(.001)	<.001
Chlorobenzene	(.001)	<.001
Bromoform	(.001)	<.001
1,1,2,2-Tetrachloroethane	(.001)	<.001
1,4-Dichlorobenzene	(.001)	<.001
1,3-Dichlorobenzene	(.001)	<.001
1,2-Dichlorobenzene	(.001)	<.001



January 21, 1991
Sample Log 2199

Sample: Composite 1

2A
2B
2C
2D

From : Felix
Received 01/14/91
Matrix : Soil

--all concentrations are units of mg/kg--

8080 - Organochlorine Pesticides

Parameter /	(Reporting Limit)	Measured Value
Aldrin	(0.01)	<0.01
alpha-BHC	(0.01)	<0.01
beta-BHC	(0.01)	<0.01
delta-BHC	(0.01)	<0.01
gamma-BHC	(0.01)	<0.01
Chlordane	(0.20)	<0.20
4,4'-DDD	(0.01)	<0.01
4,4'-DDE	(0.01)	<0.01
4,4'-DDT	(0.01)	<0.01
Dieldrin	(0.01)	<0.01
Endosulfan 1	(0.01)	<0.01
Endodulfan 2	(0.01)	<0.01
Endosulfan Sulfate	(0.01)	<0.01
Endrin	(0.01)	<0.01
Endrin Aldehyde	(0.01)	<0.01
Heptachlor	(0.01)	<0.01
Heptachlor Epoxide	(0.01)	<0.01
Toxaphene	(0.20)	<0.20

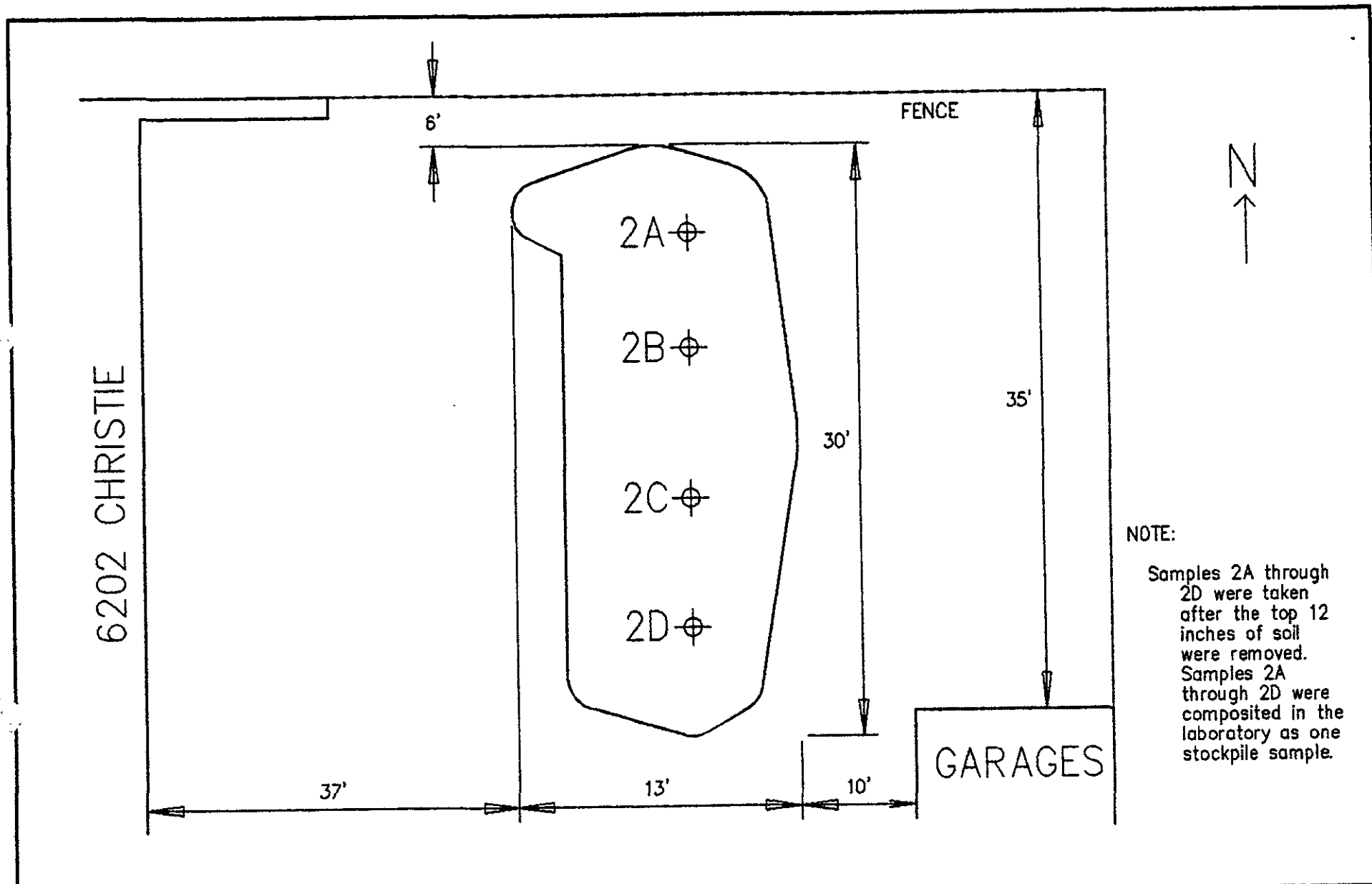

NOTE:

Samples 2A through 2D were taken after the top 12 inches of soil were removed. Samples 2A through 2D were composited in the laboratory as one stockpile sample.

FELIX (SCOTT)
6202 CHRISTIE
EMERYVILLE, CALIFORNIA

Sample Log#: 2199
DATE: 1/14/1991

WEST Western Environmental
Science & Technology
1046 Olive Drive #3, Davis, CA 95616
Phone: (916) 753-9500

Drawn by: TGT



1046 Olive Drive, Suite 3 916-753-9500
 Davis, CA 95616 FAX #: 916-753-6091

CHAIN-OF-CUSTODY RECORD AND ANALYSIS REQUEST

Project Manager: Jay Groh - Scott Co. Phone #: _____

Address: _____ FAX #: _____

Project Number: _____ Project Name: Felix

Project Location: _____ Sampler Signature: *[Signature]*

ANALYSIS REQUEST	OTHER	SPECIAL HANDLING
------------------	-------	------------------

Sample ID	Lab # (Lab use only)	# CONTAINERS Volume/Amount	Matrix					Method Preserved					Sampling		BTEX (602/8020)	BTEX/TPH as Gasoline (602/8020/8015)	TPH as Diesel (8015 or 8270)	TPH as Jetfuel (8015 or 8270)	Total Oil & Grease (413.1)	Total Oil & Grease (413.2)	Total Petroleum Hydrocarbons (418.1)	EPA 601/8010	EPA 602/8020	EPA 608/8080	EPA 608/8080-PCBs Only	EPA 624/8240	EPA 625/8270	CAM - 17 Metals	Waste Extraction Test (WET)	EPA - Priority Pollutant Metals	LEAD(7420/7421/239.2)	ORGANIC LEAD	RUSH SERVICE (12 hr) or (24 hr)	EXPEDITED SERVICE (48 hr) or (1 wk)	VERBALS/FAX	SPECIAL DETECTION LIMITS (SPECIFY)	SPECIAL RECEIVING REQUIREMENTS
			WATER	SOIL	AIR	SLUDGE	OTHER	HCl	HNO ₃	ICE	NONE	OTHER	DATE	TIME																							
2A		1		X							X		1-14-91	1300	X	X						X															
2B		1																																			
2C		1																																			
2D		1																																			

Composite

Relinquished by: <i>[Signature]</i>	Date Time 1-14-91 1600	Received by: <i>[Signature]</i>
Relinquished by:	Date Time	Received by:
Relinquished by:	Date Time	Received by Laboratory:

Remarks: 2 hr Sampling



Air, Water & Hazardous Waste Sampling, Analysis & Consultation
Certified Hazardous Waste, Chemistry, Bacteriology & Bioassay Laboratories

141 Suburban Road • San Luis Obispo, CA 93401 • (805) 543-2553 • Fax (805) 543-2685
751 S. Kellogg, Suite A • Goleta, CA 93117 • (805) 964-7838 • Fax (805) 967-4386
1885 North Kelly Road • Napa, CA 94558 • (707) 257-7211 • Fax (707) 226-1001
9333 Tech Center Dr., Ste. 800 • Sacramento, CA 95826 • (916) 368-1333 • Fax (916) 362-2484
2400 Cumberland Dr. • Valparaiso, Indiana 46383 • (219) 464-2389 • Fax (219) 462-2953

CLIENT: Troy Turpen
Western Environmental Science & Tech
1046 Olive Drive, Suite 3
Davis, CA 95616

Lab Number : H-0249-1
Project : 101-359 FELIX

REPORT OF ANALYTICAL RESULTS

Page 1 of 1

SAMPLE DESCRIPTION	MATRIX	SAMPLED BY		SAMPLED DATE RECEIVED			
2A, 2B, 2C & 2D	Soil	Unknown		01/14/91	01/16/91		
CONSTITUENT	*PQL	RESULT	UNITS	METHOD	ANALYZED	BY	NOTES
Antimony	0.3	1.1	mg/Kg	EPA 7040	01/29/91	LR	1
Arsenic	0.1	2.3	mg/Kg	EPA 7061	01/29/91	LR	1
Chromium, Hexavalent	32.	ND	mg/Kg	CALC			
Lead	1.	34.	mg/Kg	EPA 7420	01/25/91	LR	2
Mercury	0.002	0.048	mg/Kg	EPA 7471	01/28/91	KS	3
Selenium	0.1	0.1	mg/Kg	EPA 7741	01/24/91	LR	1
Silver	0.1	0.8	mg/Kg	EPA 7760	01/25/91	LR	1
Thallium	3.	ND	mg/Kg	EPA 7840	01/24/91	LR	2
PRIORITY POLLUTANT METALS BY ICP							2
Beryllium	0.5	ND	mg/Kg	EPA 6010	01/29/91	KS	
Cadmium	3.	ND	mg/Kg	EPA 6010	01/29/91	KS	
Chromium	3.	31.	mg/Kg	EPA 6010	01/29/91	KS	
Copper	3.	34.	mg/Kg	EPA 6010	01/29/91	KS	
Nickel	3.	31.	mg/Kg	EPA 6010	01/29/91	KS	
Zinc	3.	80.	mg/Kg	EPA 6010	01/29/91	KS	

CCAS is Certified by CA Department of Health Services: Laboratory #131

*RESULTS listed as 'ND' were not detected at or above the listed PQL (Practical Quantitation Limit)

- (1) Sample Preparation on 01/23/91 by JLW using EPA 3050
- (2) Sample Preparation on 01/24/91 by AR using EPA 3050
- (3) Sample Preparation on 01/23/91 by JLW

01/31/91

MH/jmw/kes/wjm

CC: Jay Groh
Scott Co
1919 Market Street
Oakland, CA 93607

Respectfully submitted,
COAST-TO-COAST ANALYTICAL SERVICES, INC.

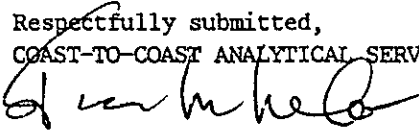
James White, Group Leader

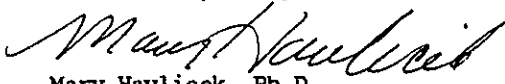
Mary Havlicek, Ph.D.
President



141 Suburban Road	• San Luis Obispo, CA 93401	• (805) 543-2553	• Fax (805) 54
751 S. Kellogg, Suite A	• Goleta, CA 93117	• (805) 964-7838	• Fax (805) 96.
1885 North Kelly Road	• Napa, CA 94558	• (707) 257-7211	• Fax (707) 226
9333 Tech Center Dr., Ste. 800	• Sacramento, CA 95826	• (916) 368-1333	• Fax (916) 362-
2400 Cumberland Dr.	• Valparaiso, Indiana 46383	• (219) 464-2389	• Fax (219) 462-2.

ADAPTED FROM

22 CAC SECTION 66699. PERSISTENT AND BIOACCUMULATIVE TOXIC SUBSTANCE

Any waste is a hazardous waste which contains a substance listed below:

- (1) at a concentration in milligrams per liter as determined pursuant to Section 66700 which exceeds its listed Soluble Threshold Limit Concentration (STLC) or
- (2) at a concentration in milligrams per kilogram in the waste which exceeds its listed Total Threshold Limit Concentration (TTLc).

Inorganic Persistent and Bioaccumulative Toxic Substances
and their STLC and TTLc Values

Substance	STLC* mg/L	TTLc* Wet-Weight mg/Kg
Antimony and or antimony compounds	15	500
Arsenic and/or arsenic compounds	5.0	500
Asbestos	-	1.0 (as percent)
Barium and/or barium compounds (excluding barite) ..	100	10,000 ¹
Beryllium and/or beryllium compounds	0.75	75
Cadmium and/or cadmium compounds	1.0	100
Chromium (VI) compounds	5	500
Chromium and/or chromium (III) compounds	560	2,500
Cobalt and/or cobalt compounds	80	8,000
Copper and/or copper compounds	25	2,500
Fluoride salts	180	18,000
Lead and/or lead compounds	5.0	1,000
Mercury and/or mercury compounds	0.2	20
Molybdenum and/or molybdenum compounds	350	3,500
Nickel and/or nickel compounds	20	2,000
Selenium and/or selenium compounds	1.0	100
Silver and/or silver compounds	5	500
Thallium and/or thallium compounds	7.0	700
Vanadium and/or vanadium compounds	24	2,400
Zinc and/or zinc compounds	250	5,000

¹ Excluding barium sulfate.

* STLC and TTLc values are calculated on the concentrations of the elements, not the compounds.



1046 Olive Drive, Suite 3
Davis, CA 95616

916-753-9500
FAX #: 916-753-6091

CHAIN-OF-CUSTODY RECORD AND ANALYSIS REQUEST

Project Manager: **JAY GROH** Phone #: **415-834-2333**
 Address: **Scott Co** FAX #:
 Project Number: **101-359** Project Name: **FELIX**
 Project Location: **PO# 100236-58468-72-7001** Sampler Signature: *[Signature]*

ANALYSIS REQUEST | **OTHER** | **SPECIAL HANDLING**

Sample ID	Lab # (Lab use only)	# CONTAINERS	Volume/Amount	Matrix					Method Preserved					Sampling		BTEX (602/8020)	BTEX/TPH as Gasoline (602/8020/8015)	TPH as Diesel (8015 or 8270)	TPH as Jetfuel (8015 or 8270)	Total Oil & Grease (413.1)	Total Oil & Grease (413.2)	Total Petroleum Hydrocarbons (418.1)	EPA 601/8010	EPA 602/8020	EPA 608/8080	EPA 608/8080-PCBs Only	EPA 824/8240	EPA 825/8270	CAM - 17 Metals	Waste Extraction Test (WET)	EPA - Priority Pollutant Metals	LEAD(7420/7421/239.2)	ORGANIC LEAD	RUSH SERVICE (12 hr) or (24 hr)	EXPEDITED SERVICE (48 hr) or (1 wk)	VERBALS/FAX	SPECIAL DETECTION LIMITS (SPECIFY)	SPECIAL REPORTING REQUIREMENTS				
				WATER	SOIL	AIR	SLUDGE	OTHER	HCl	HNO3	ICE	NONE	OTHER	DATE	TIME																											
2A	#0249	1																																								
2B	#0217	1																																								
2C		1																																								
2D		1																																								

1/2 Called Tracy Tompa - Invoice + Copy to Scott Co Reports to WEST
AK

Relinquished by: *[Signature]* Date: | Time: | Received by: *[Signature]* Remarks: Bill To Scott Co / Results needed by 1/28/91.

Relinquished by: *[Signature]* Date: | Time: | Received by: *[Signature]* Composite 4 samples into 1 sample for analyses.

Relinquished by: | Date: | Time: | Received by Laboratory: *[Signature]* 1-16-91 11:00 sealed in metal can!

Coast-to-Coast
Analytical
Services

Coast-to-Coast
Analytical Services
141 Suburban Road, Suite C-4
San Luis Obispo, California 93401
(805) 543-2553

Lab Number: H-0249-1
Collected: 01/14/91 Comp.
Received: 01/16/91 @ 1630
Tested: As Listed
Collected by:

ATTN: Troy Turpen
Western Environmental Science & Tech.
1046 Olive Drive, Suite 3
Davis, CA 95616

Sample Description:

Project #101-359 FELIX,
2A,2B,2C,2D, Solid

AQUATIC TOXICITY

Species: Pimephales promelas
Common Name: Fathead Minnow
Supplier: Thomas Fish Co.
x Length 3.1 cm x Weight 0.32 g
Acclimation Period >10 days
Acclimation Temperature 16-22 degrees C
Dead in Acclimation Tank <1%

Test Type: Static 96 hr LC50
Dilution Water: Freshwater (soft)
Number per Tank: 10
Max. Length 3.3 cm Min. Length 2.9 cm
Max. Weight 0.45 g Min. Weight 0.24 g
Tank Volume: 10 liters
Hardness: 38 mg/L
Alkalinity: 28 mg/L

DATE:	INITIAL			24 HOUR				48 HOUR				72 HOUR				96 HOUR				No. Dead
	DO	C	pH	DO	C	pH	#M	DO	C	pH	#M	DO	C	pH	#M	DO	C	pH	#M	
01/24/91	8.8	18	7.5	8.2	20	7.4	0	8.0	19	7.0	0	8.9	18	7.3	0	8.9	18	7.3	0	0
01215 JRH																				
750 mg/L	8.6	18	7.6	8.3	20	7.3	0	8.2	19	7.3	0	9.0	18	7.2	0	9.2	18	7.4	0	0
750 mg/L	8.8	18	7.6	8.2	20	7.3	0	7.9	19	7.3	0	8.6	18	7.2	0	8.7	18	7.4	0	0
500 mg/L	8.6	18	7.5	7.8	20	7.2	0	7.5	19	7.2	0	8.5	18	7.3	0	8.6	18	7.3	0	0
500 mg/L	8.7	18	7.6	7.8	20	7.2	0	7.6	19	7.2	0	8.3	18	7.3	0	8.5	18	7.3	0	0
250 mg/L	8.7	18	7.6	6.7	20	7.2	0	6.7	19	7.1	0	7.5	18	7.2	0	7.8	18	7.3	0	0
250 mg/L	8.7	18	7.5	7.4	20	7.2	0	7.1	19	7.1	0	7.7	18	7.2	0	7.9	18	7.3	0	0

REMARKS: Sample Alkalinity Before: 32 mg/L After: 30 mg/L
@750 mg/L Hardness Before: 46 mg/L After: 44 mg/L
LC50: >750 mg/L LC50

This material does not have an acute aquatic 96-hr LC50 less than 500 mg/l with fathead minnows and according to 22 Cal Adm Code Art 11 Sec. 66696 (4) is not hazardous or toxic by this criterion.

01/28/91
H0249-1W.WR1/#2
MH/ke

Respectfully submitted,
COAST-TO-COAST ANALYTICAL SERVICES
Mary Havlicek
Mary Havlicek, Ph.D., President