

REMOVAL PLAN NOTES:

- ① - REMOVE EXIST CONC PUMP PAD
3'-0" X 4'-0" X 6" HIGH.
- ② - REMOVE EXIST 4" ϕ PIPE BOLLARD
3'-4" HIGH.
- ③ - REMOVE & DISPOSE EXIST UNLEADED GAS
METAL CABINET, PUMP & APPURTENANCES.
- ④ - REMOVE & DISPOSE EXIST REGULAR GAS
METAL CABINET, PUMP & APPURTENANCES.
- ⑤ - REMOVE & DISPOSE EXIST DIESEL METAL
CABINET, PUMP & APPURTENANCES.
- ⑥ - REMOVE EXIST CONC PUMP PAD
3'-0" X 8'-0" X 6" HIGH.
- ⑦ - REMOVE EXIST FILL PIPE & CAP.
- ⑧ - REMOVE EXIST 4" ϕ AREA DRAIN.
- ⑨ - EXIST ELECTRICAL SERVICE TO REMAIN FOR
CONNECTION TO ABOVE GROUND FUEL DISPENSER
PUMPS

EXIST MAINTENANCE
BUILDING
FIN. FLOOR ELEV. 842.30

EXIST EMERGENCY FUEL
PUMPS SHUT-OFF SWITCH

EXIST UNDERGROUND
ELECTRICAL SERVICE
TO REMAIN

REMOVE & DISPOSE EXIST
BURIED 1,000 GALS UNLEADED
GAS, STEEL TANK & SUCTION
LINE

EXIST 1 1/2" VENTS FOR
FUEL TANKS UP TO
ROOF TO REMAIN

EXIST GATE
EDGE OF EXIST
A.C. PAVEMENT

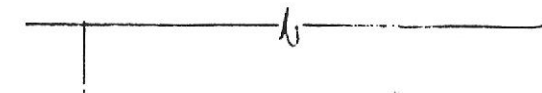

842.28

CONTRACTOR SHALL LEAVE ACCESS CLEAR FOR VEHICLES TO MAINTENANCE BLDG

SERVICE YARD

EXIST PARKING AREA

841.15

840.90 ← EXIST SPOT ELEV. TYP

840.45

SAW CUT EXIST A.C. PAVEMENT 2" DEEP & REMOVE A.C. ADJUST SAW CUT LINE AS REQUIRED FOR REMOVAL WORK

841.00

840.62

EXIST A.C. PAVEMENT

REMOVE & DISPOSE EXIST BURIED 1,000 GALS DIESEL STEEL TANK & SUCTION LINE

EDGE OF EXIST A.C. PAVEMENT

EXIST 9" OAK TREE TO REMAIN. CONTRACTOR SHALL USE CAUTION TO CUT TREE ROOTS WHEN EXCAVATING FOR EXIST FUEL TANKS

EXIST TREE

839.78

EXIST UNPAVED AREA

839.03

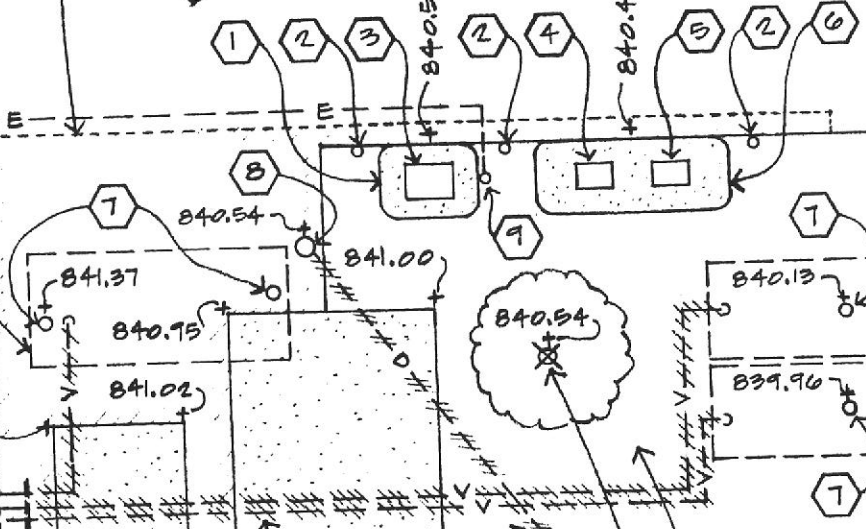

- EXIST 1/2" VENTS TO BE ABANDONED IN PLACE
- PLUG EXIST 1/2" VENTS TYP
- REMOVE EXIST CONC PAD APPROX. 6'-0" X 5'-0" X 0"
- REMOVE EXIST 1/2" VENT PIPE TYP
- REMOVE EXIST CONC PAD APPROX. 11'-0" X 8'-8" X 0"
- REMOVE EXIST 4" DRAIN LINE
- REMOVE EXIST 6" TREE & ROOTS
- INSTALL FUEL TANKS IN THIS AREA

REMOVE & DISPOSE EXIST BURIED 1,000 GALS REGULAR GAS STEEL TANK & SUCTION LINE

1
4

REMOVAL PLAN - DEL VALLE SERVICE YARD

ADD ALTERNATE "A"

SCALE: 1/8" = 1'-0"

EXIST MAINTENANCE
BUILDING
FIN. FLOOR ELEV. 042.50

EXIST UNDERGROUND
ELECTRICAL SERVICE

EXIST EMERGENCY FUEL
PUMPS SHUT-OFF SWITCH

TACK COAT EXIST EDGE
OF A.C. PAVMT & MATCH
EXIST GRADES

2" A.C. PAVING OVER
4" COMP. BASE. ROCK

EXIST 1/2" VENTS

EXIST GATE
EDGE OF EXIST
A.C. PAVEMENT

842



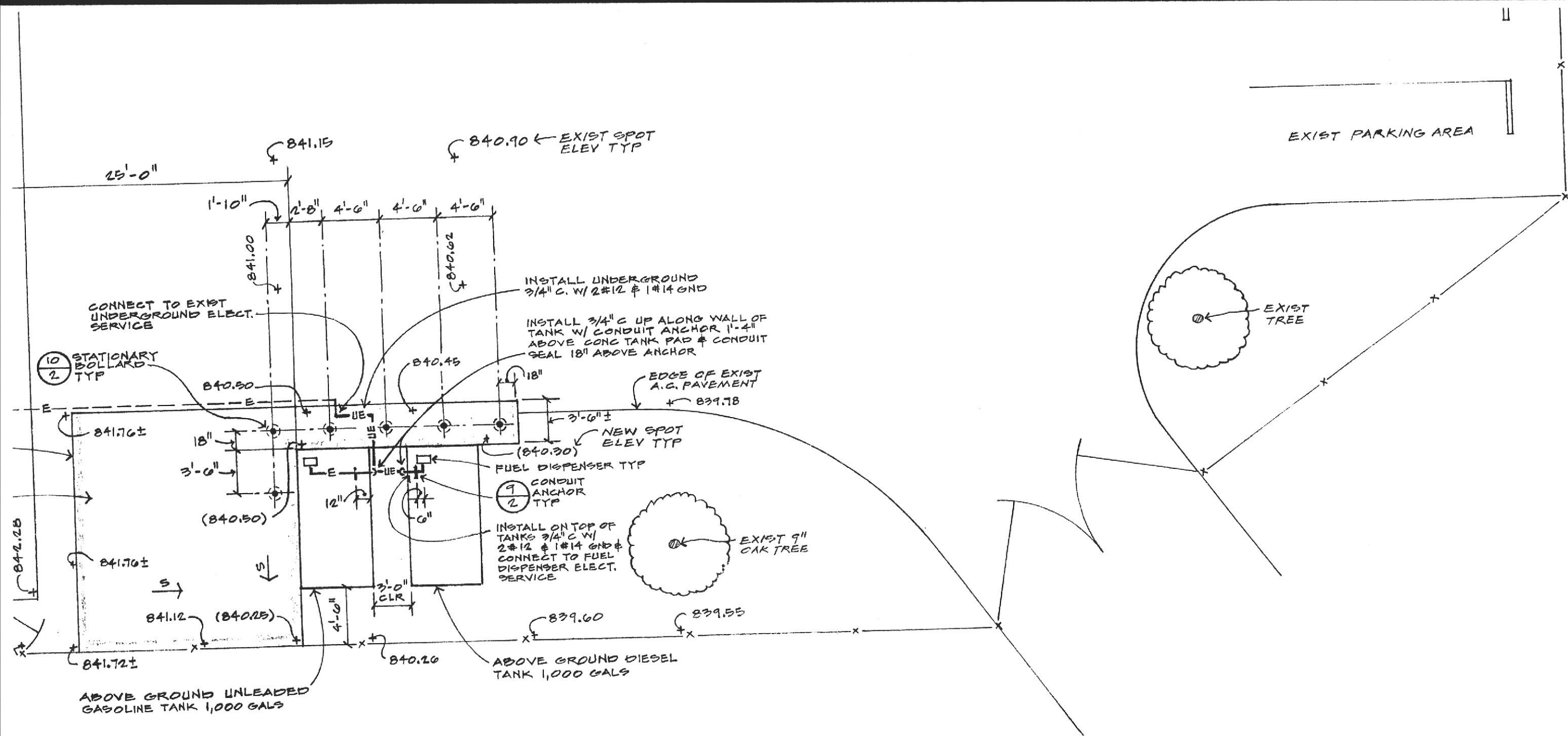

2 PLAN - ABOVE GROUND FUEL STORAGE DEL VALLE
 4 ADD ALTERNATE "A"

SCALE: 1/8" = 1'-0"

APPROVED

planning and design:

[Signature]

scale: AS NOTED
 drawn: W.G.
 checked: E.C.

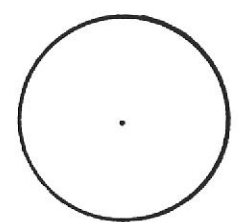

ABOVE GROUND FUEL TANK WORK
 DEL VALLE REGIONAL PARK

CONTRACT NO. 48-91-03/09/22/47/75

SHEET NO.

4

OF: 4
 NO.

EXIST STORAGE
BLDG ON SKIDS

EXIST WOOD FRAME SHED
& GRAPE STAKE SCREEN ON
3 SIDES TO REMAIN

REMOVE EXIST GAS
DISPENSER &
APPURTENANCES
COMPLETE. CAP
SUCTION LINES &
ELECTRICAL CONDUIT
FLUSH W/ TOP OF
CONC ISLAND

EXIST CONC
PAD ON GRADE
TO REMAIN

EXIST CONC
ISLAND 6" HIGH
TO REMAIN

6
3 ABOVE GRADE
CONC PAD

UNPAVED
AREA

SCORE JOINT
1/2" DEEP

PRECAST
CONC
BARRIER
10'-0" LONG

FUEL DISPENSER

EXIST GRAPE
STAKE FENCE

¢ OF TANK

6"

ABOVE GROUND
UNLEADED GASOLINE
TANK 1,000 GALS

EXIST
TREE TYP

30'-0"

4 3 PLAN - EXIST GAS PUMP FACILITY

SCALE: 1"=5'

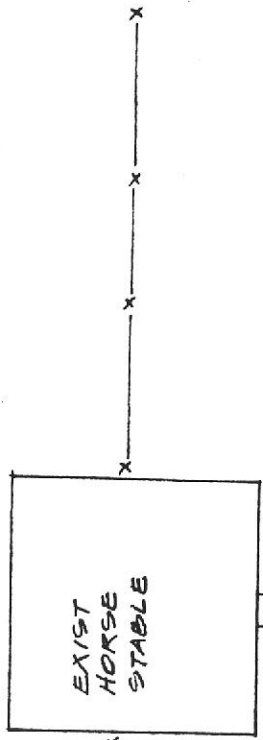

HORSE
CORRAL

EXIST FENCE

SERVICE YARD

EXIST 2 RAIL
WOOD FENCE

EXIST 2" VENT UP 15'± TYP

EXIST 2" FILL CAP
UP 12" TYP

EXIST 2 1/2" FILL CAP
UP 12" TYP

2 (TWO) EXIST UNDERGROUND GASOLINE
STEEL STORAGE TANKS 1,000 GALS
EACH. FOR WORK TO TANK FACILITY
SEE TECH. SPECS.

EXIST GAS PUMP FACILITY
FOR REMOVAL WORK SEE 4
3

EXIST MAINTENANCE BUILDING

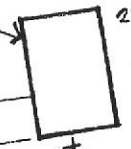

EXIST VALVE W/
HOSE BIBB

EXIST TRANSF.

P.B.

P.B.

P.B.

EXIST UNDERGND
TELEPHONE

EXIST UNDERGND

UE

W

W

UE & UT

UE

UT

UE

UE

UE

UE

UE

UE

UE & UT

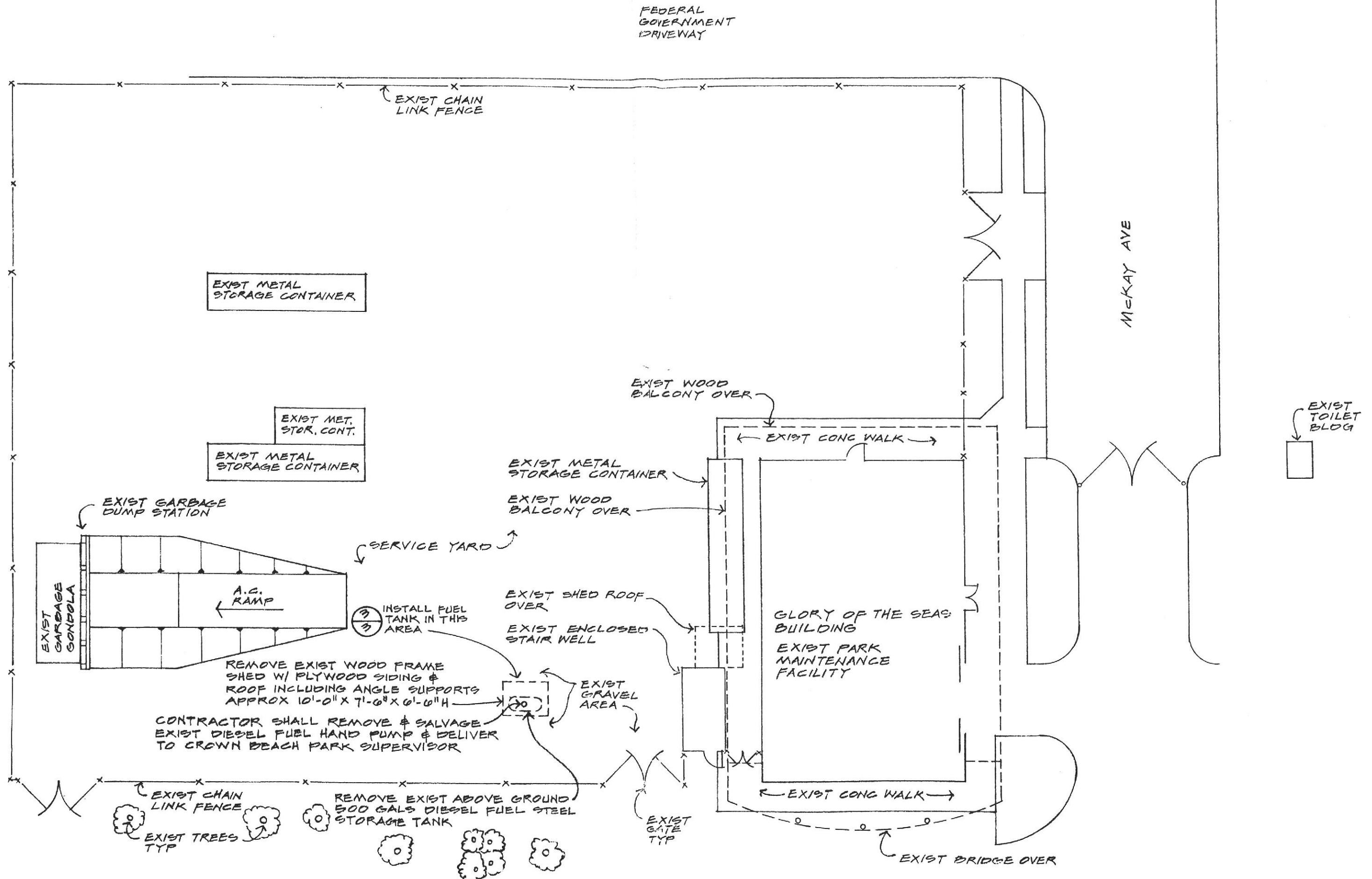

① REMOVAL PLAN - CROWN BEACH SERVICE YARD SCALE: 1"=20'

5
3

PLAN-ABOVE GROUND FUEL STORAGE SUNOL ADD ALTERNATE "A"

SCALE: 1"=20'

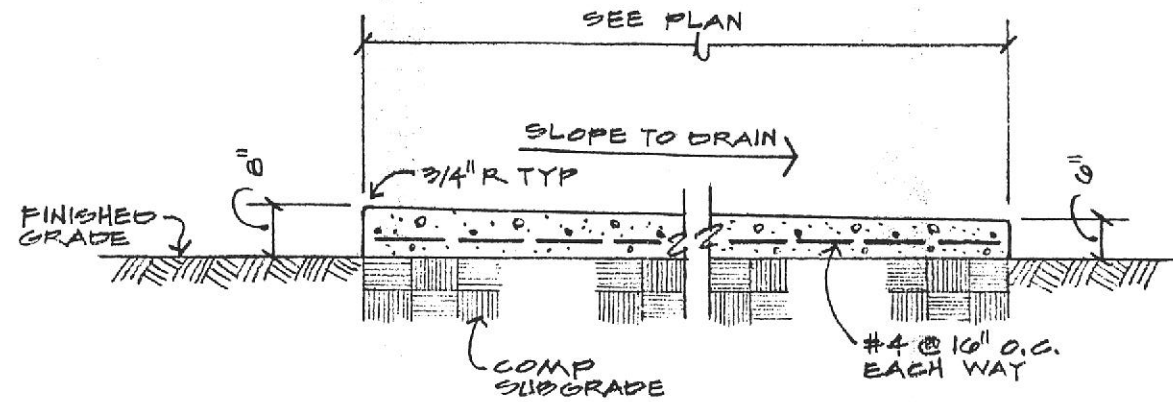

SECTION NO SCALE

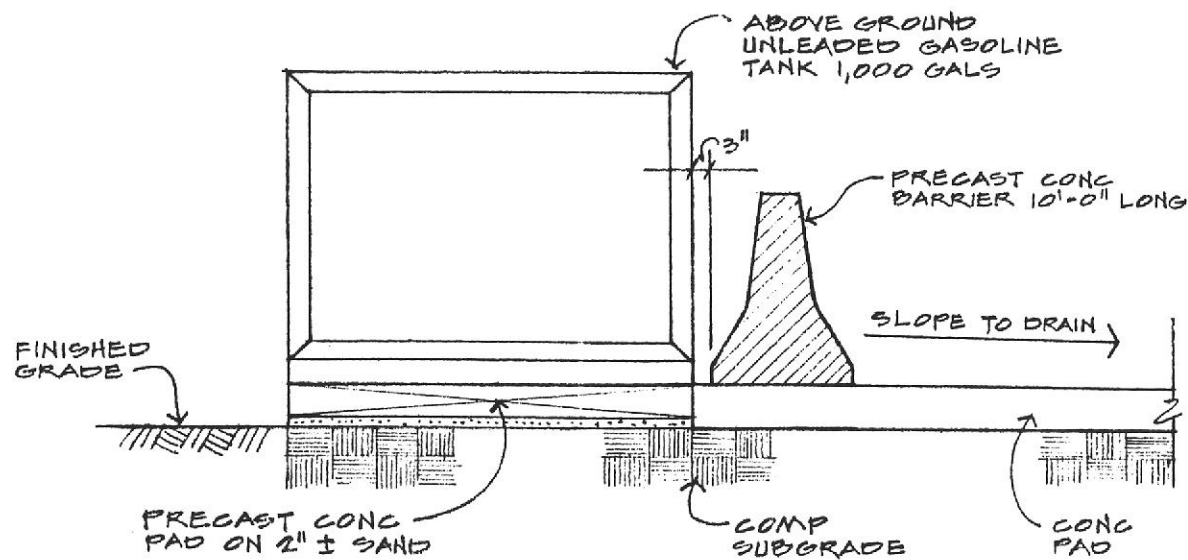

ELEVATION NO SCALE

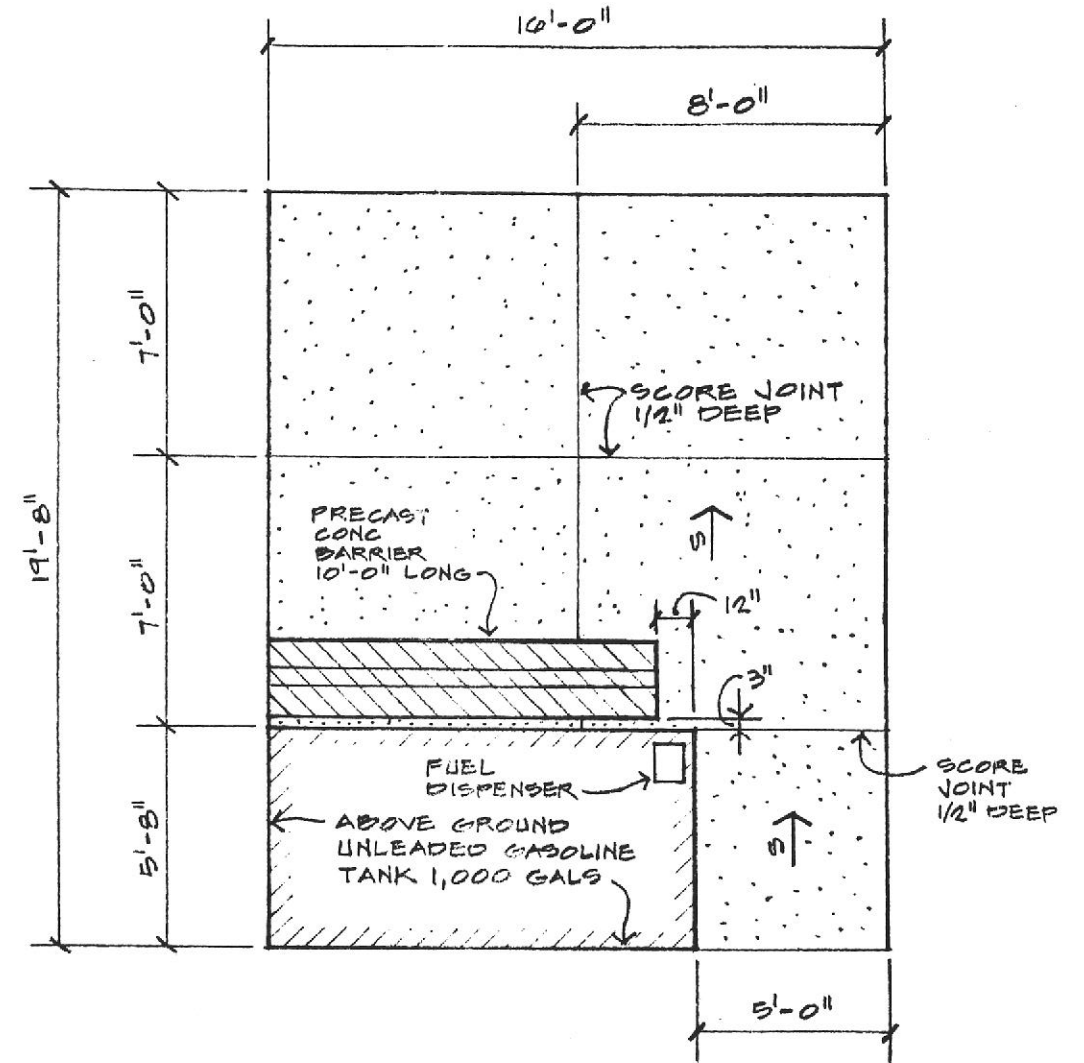

PLAN SCALE: 1"=5'

6
3

ABOVE GRADE CONCRETE PAD ADD ALTERNATE "A"



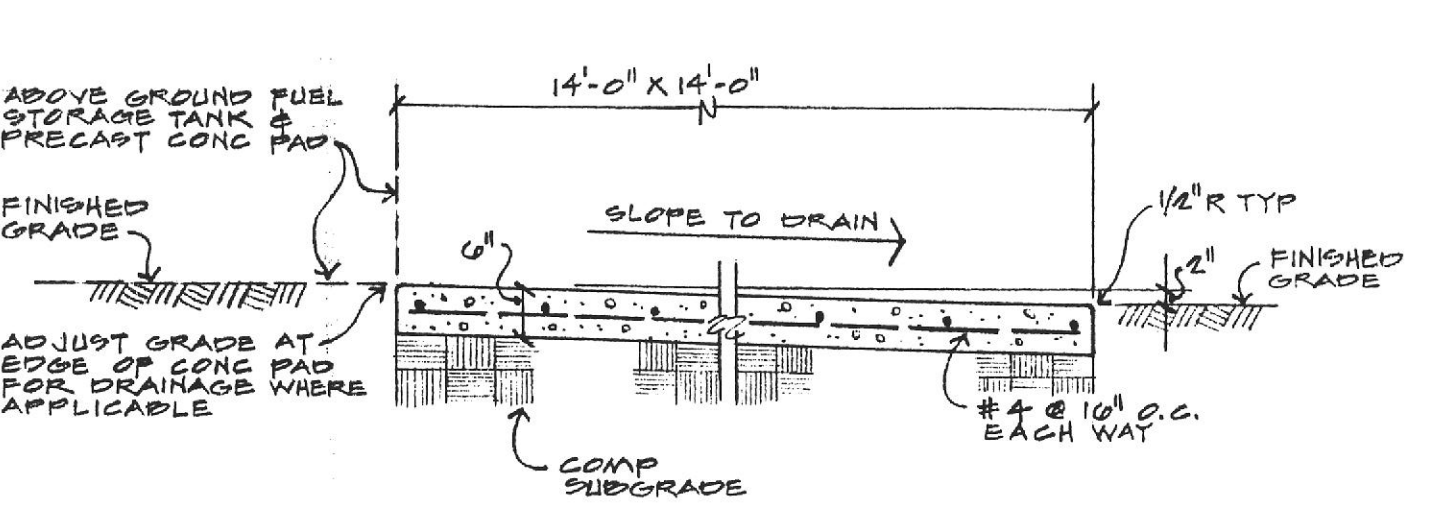

2
3 CONCRETE PAD NO SCALE

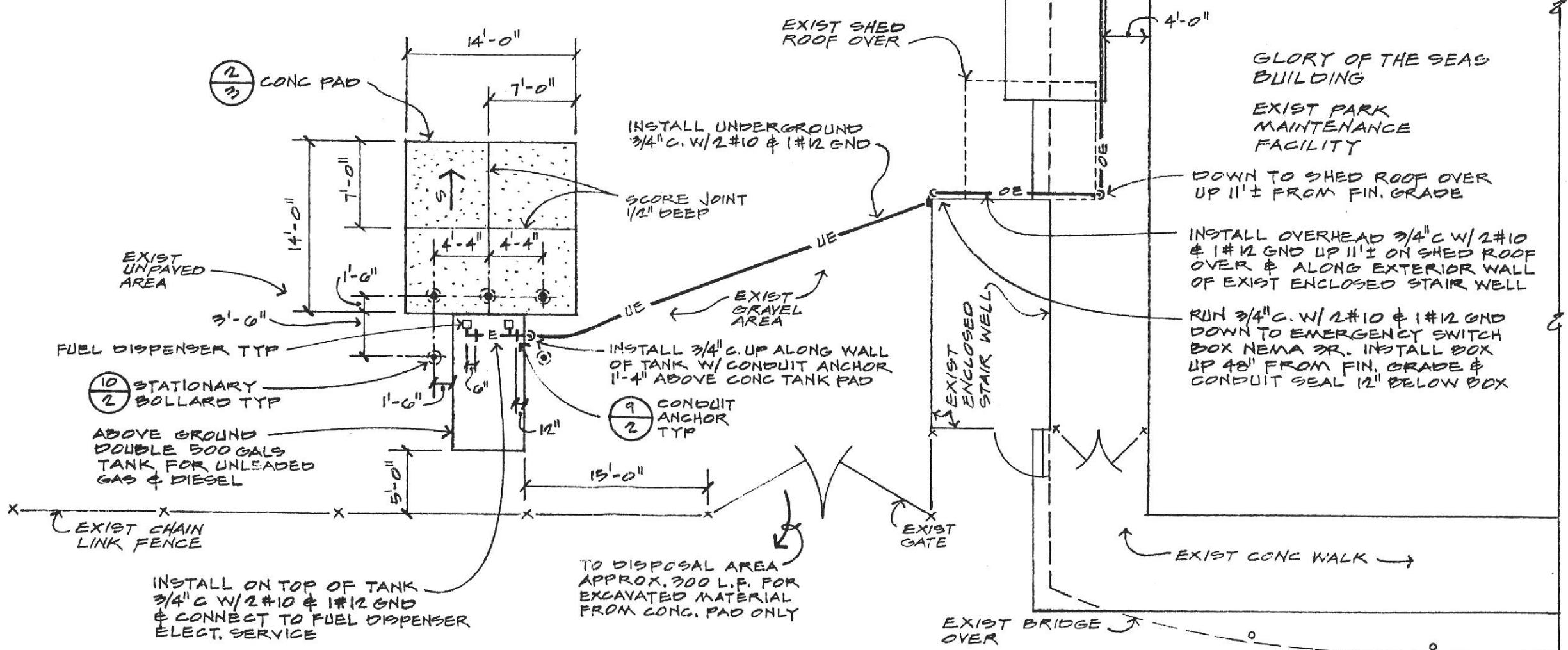

3
3 PLAN - ABOVE GROUND FUEL STORAGE CROWN BEACH SCALE: 1"=10'

APPROVED
 planning and design: *[Signature]*
 operations: *[Signature]*

scale: AS NOTED
 drawn: W.G.
 checked: E.C.

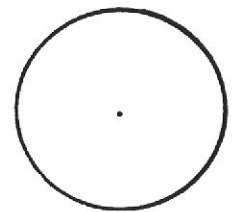

ABOVE GROUND FUEL TANK WORK
 CROWN MEMORIAL STATE BEACH
 SUNOL REGIONAL WILDERNESS
 CONTRACT NO. 48-91-03/09/22/47/75

SHEET NO. 3
 OF 4

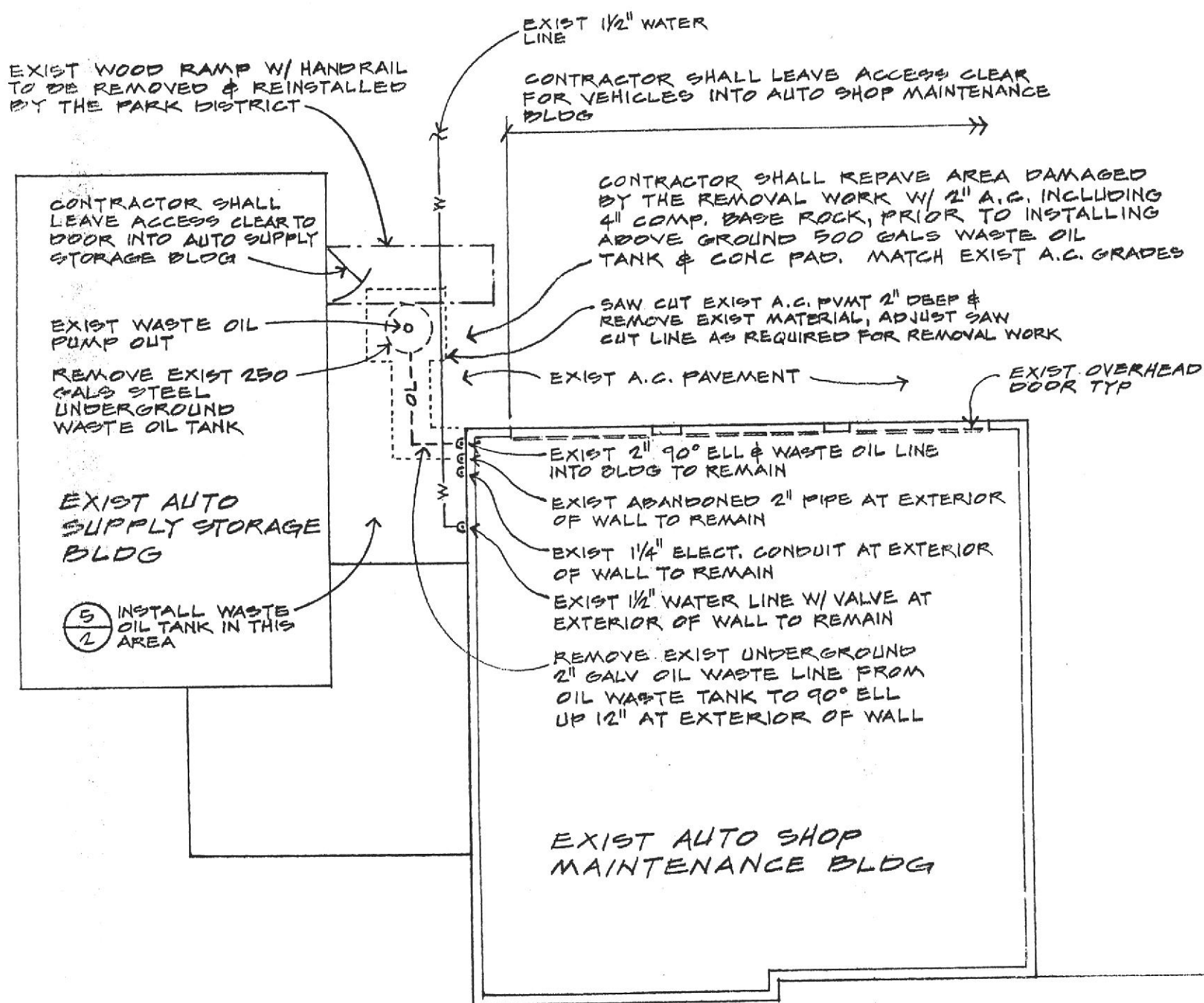

4 REMOVAL PLAN - SOUTH COUNTY CORP. YARD
 2 ADD ALTERNATE "B"

SCALE: 1"

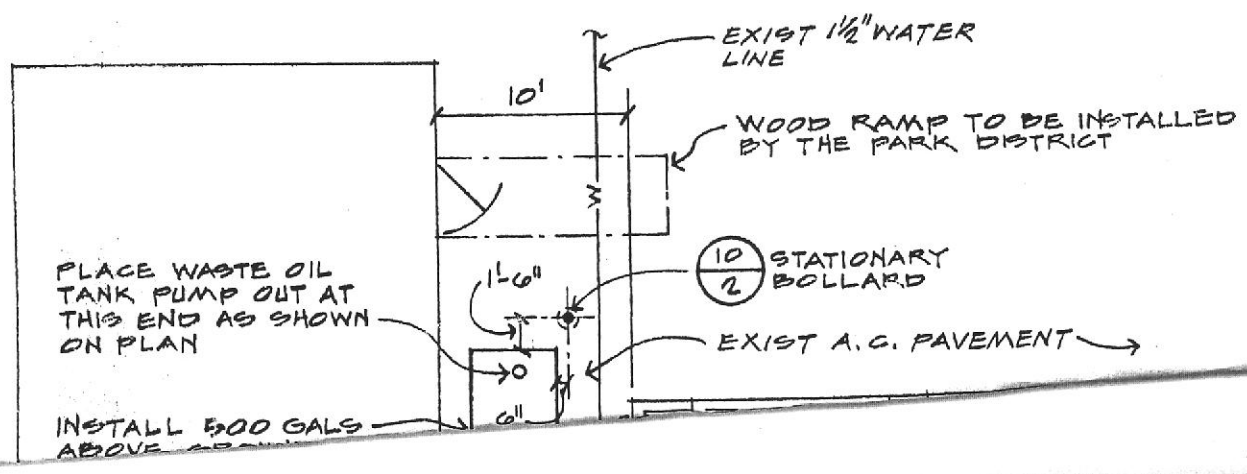

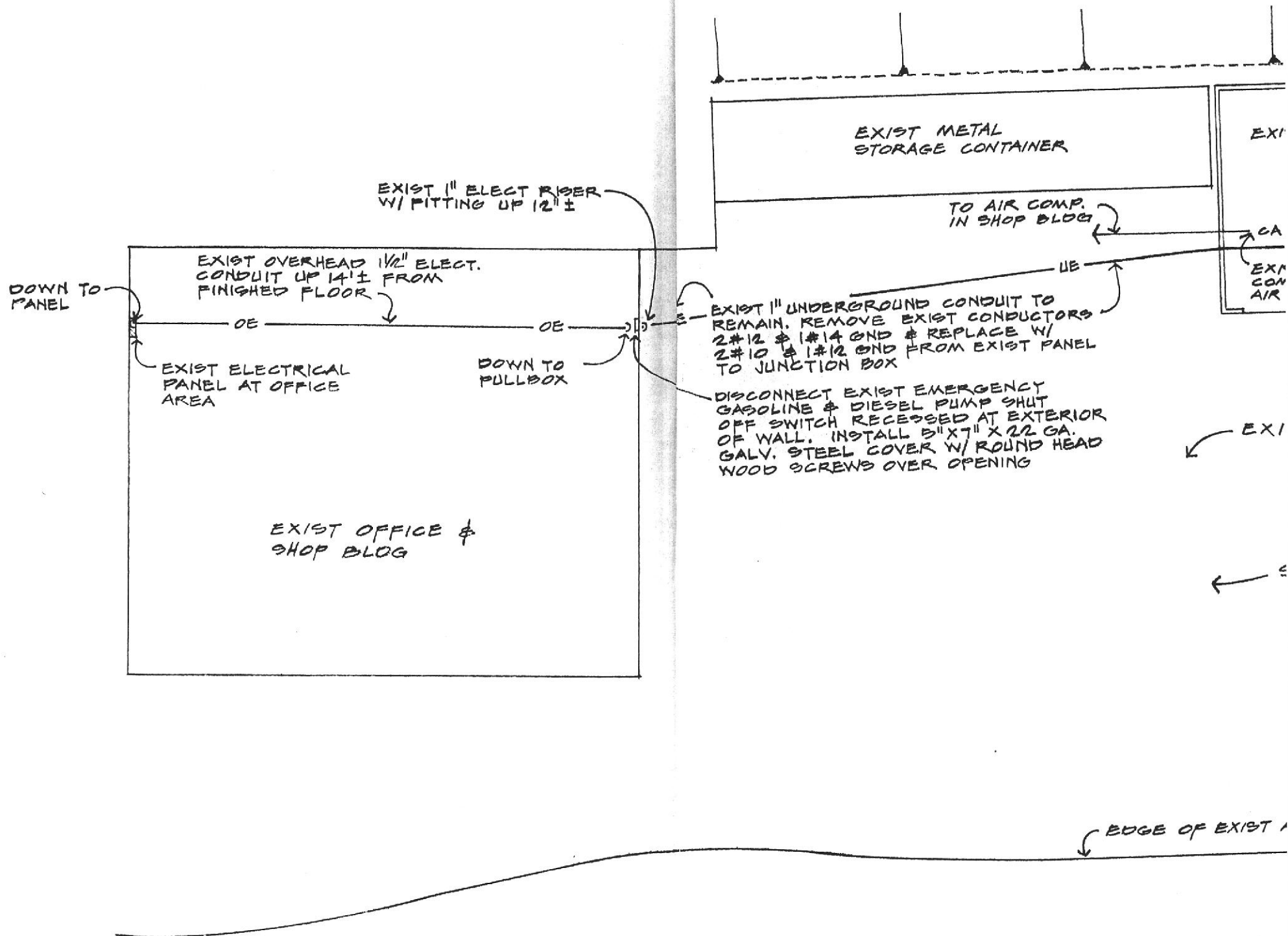

1
2

PLAN

EXIST EQUIP

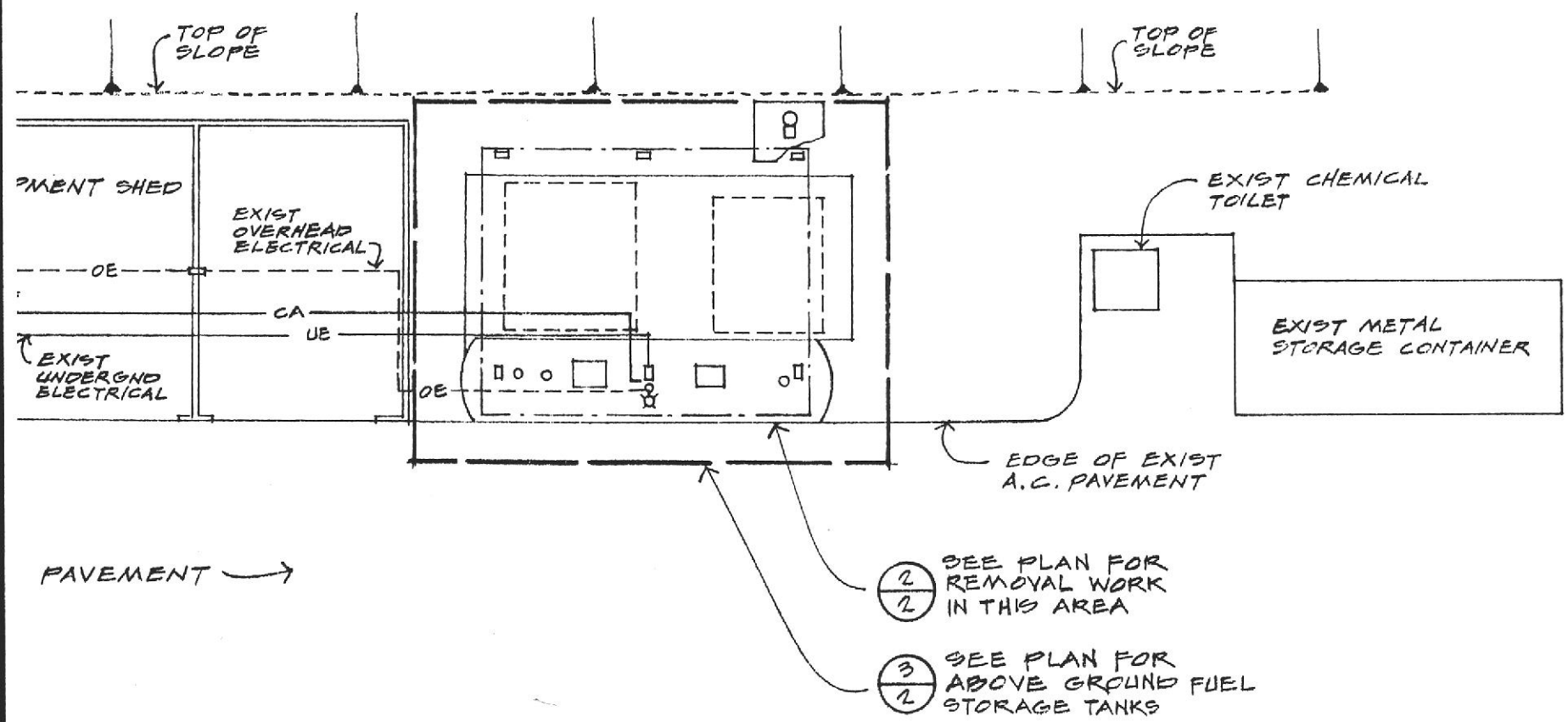

PAVEMENT →

YARD →

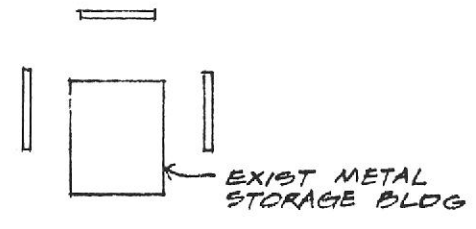

IT

EDWOOD SERVICE YARD

SCALE: 1" = 10'

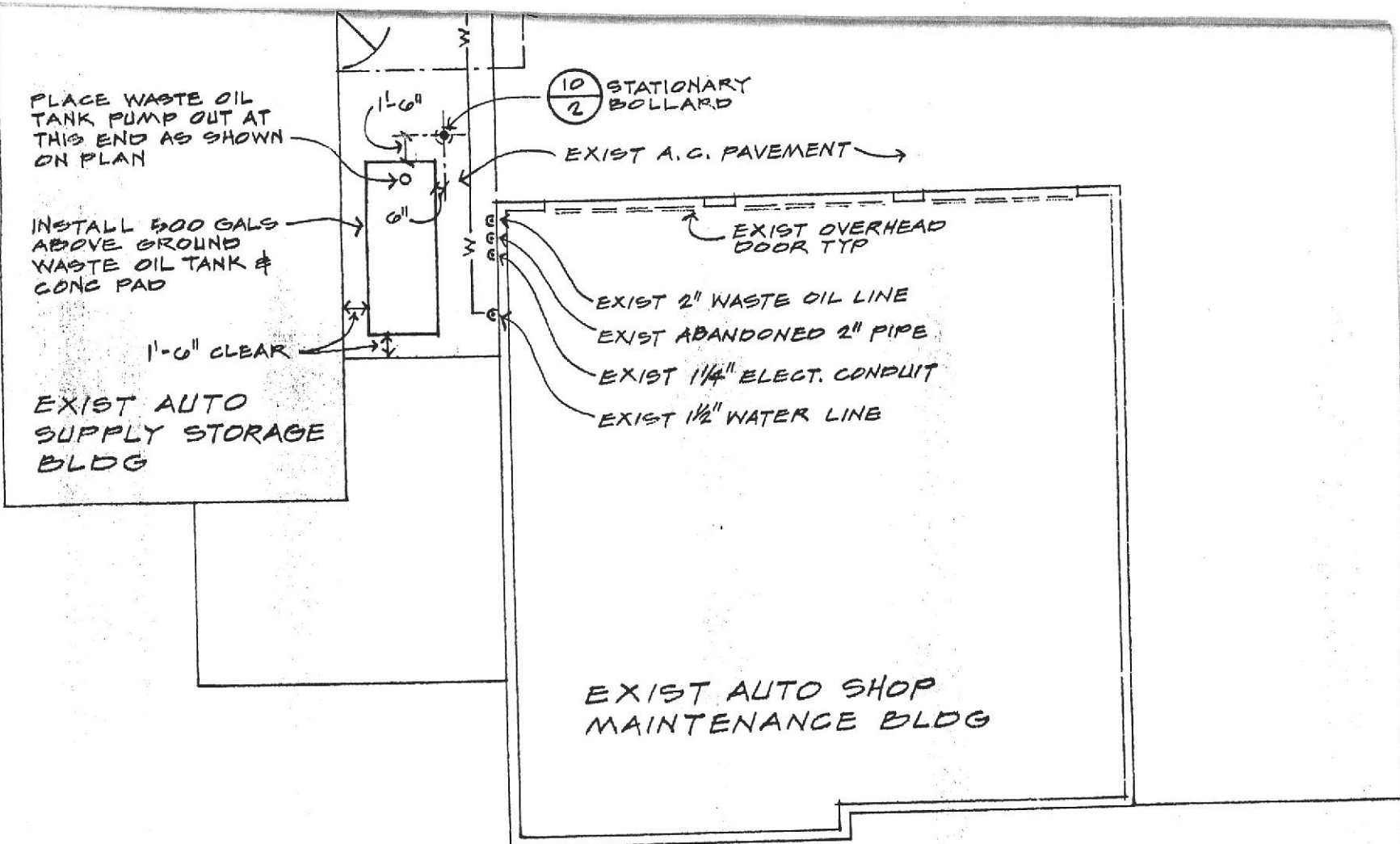

5
2
 WASTE OIL TANK - SOUTH COUNTY CORP. YARD SCALE: 1" = 10'
 ADD ALTERNATE "B"

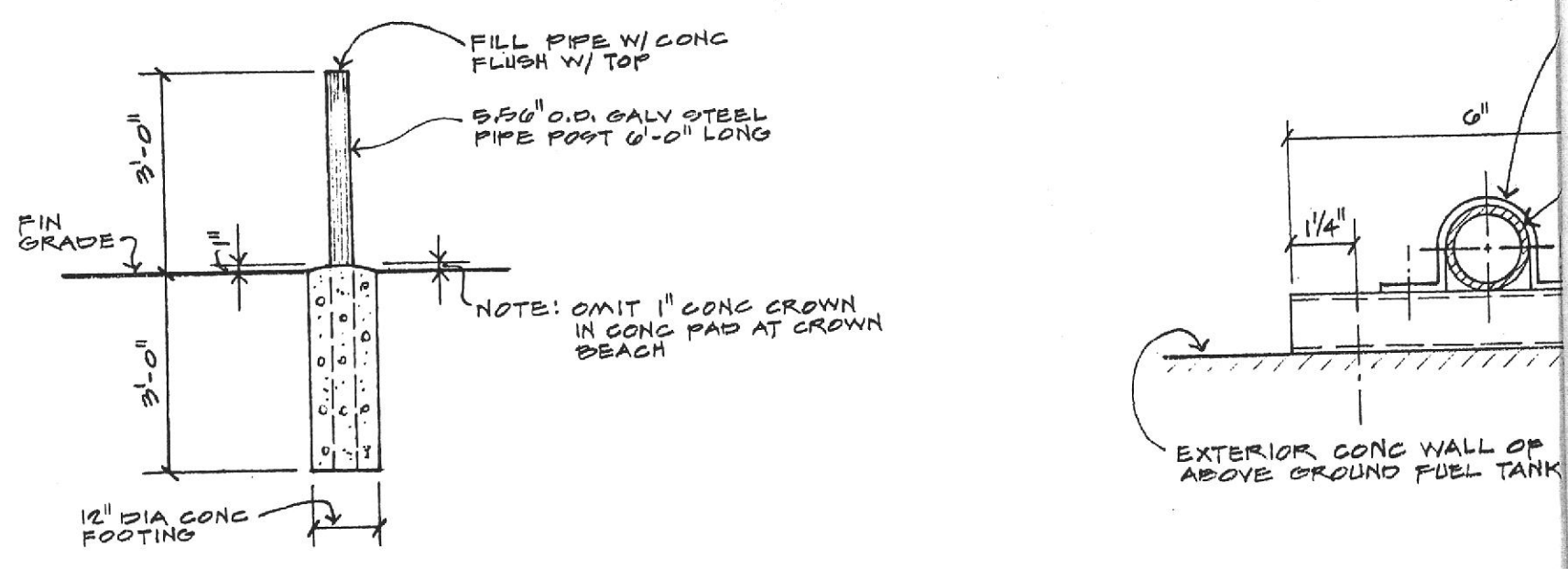

10
2
 STATIONARY BOLLARD NO SCALE

9
2
 CONDUIT

REVISIONS



EA
115

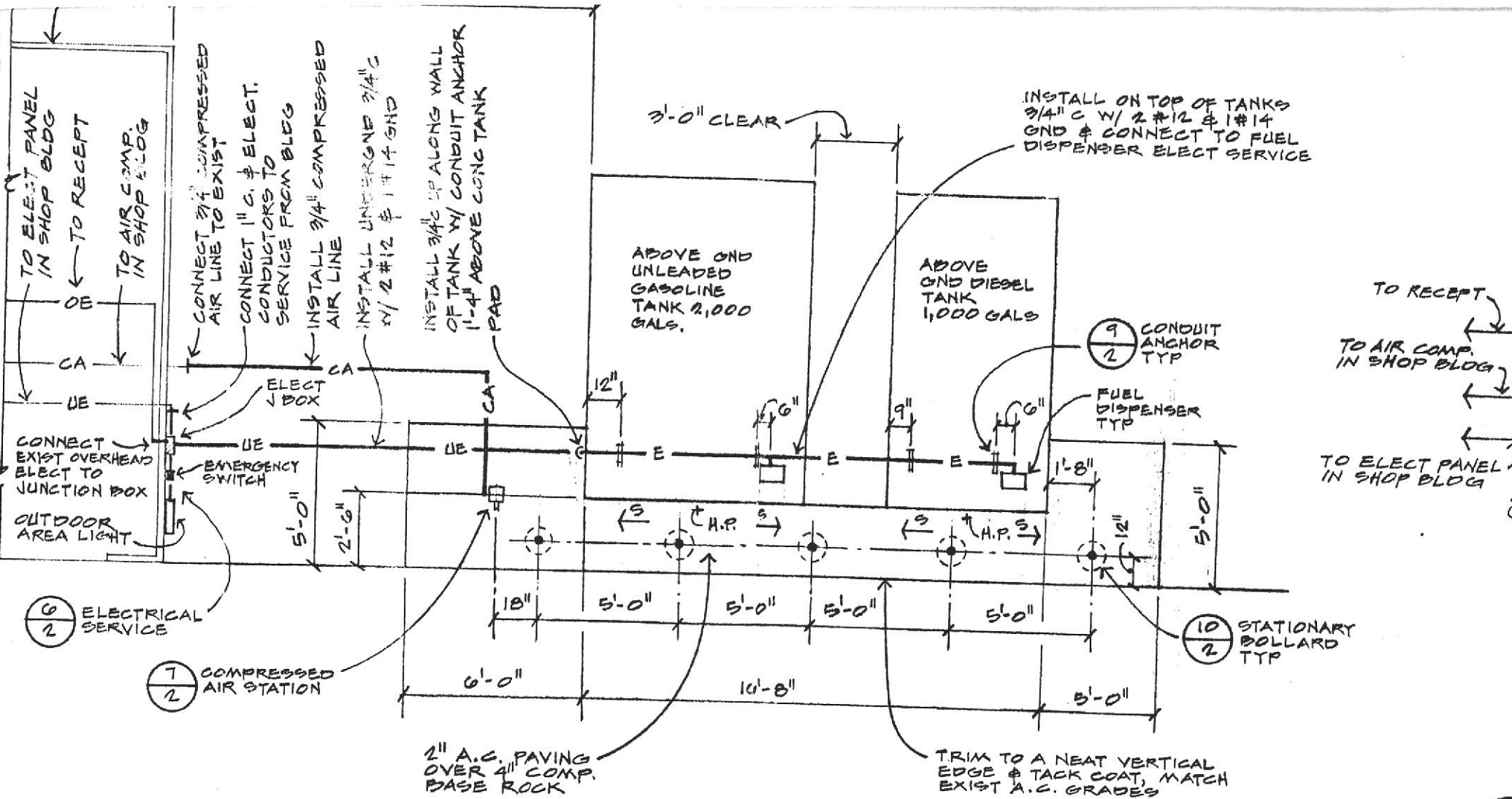

3 PLAN-ABOVE GROUND FUEL STORAGE REDWOOD
 2 SCALE: 1"=5'

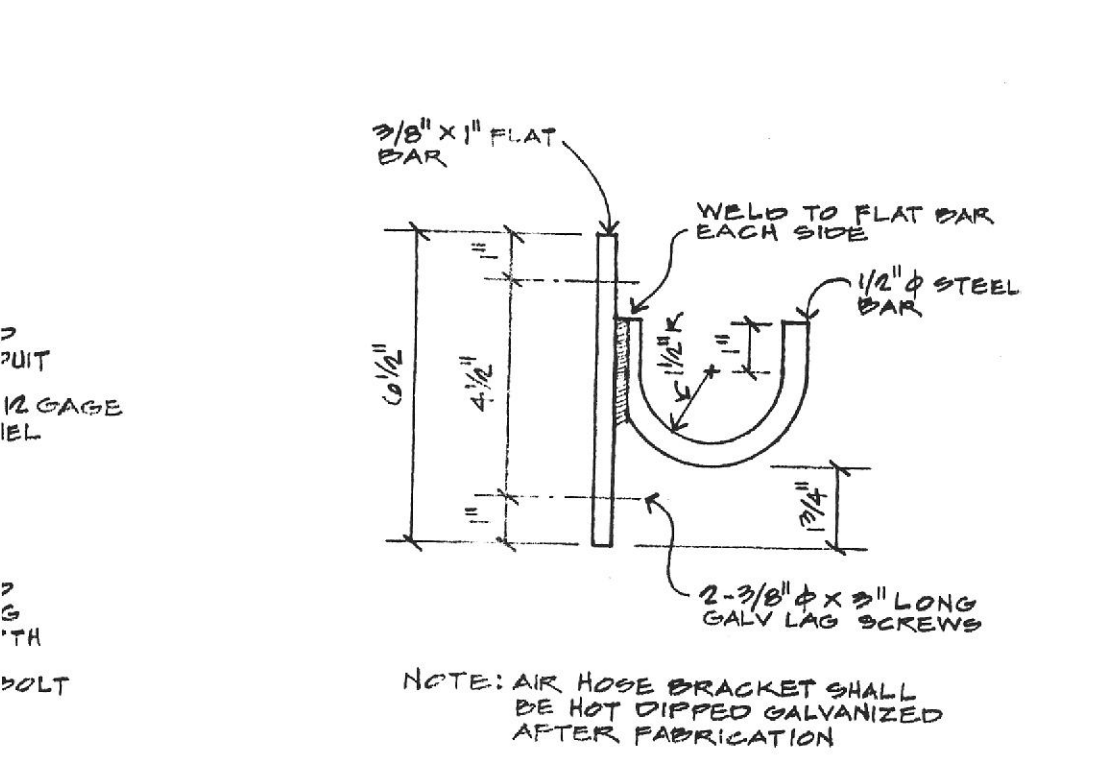

8 AIR HOSE BRACKET NO SCALE
 2

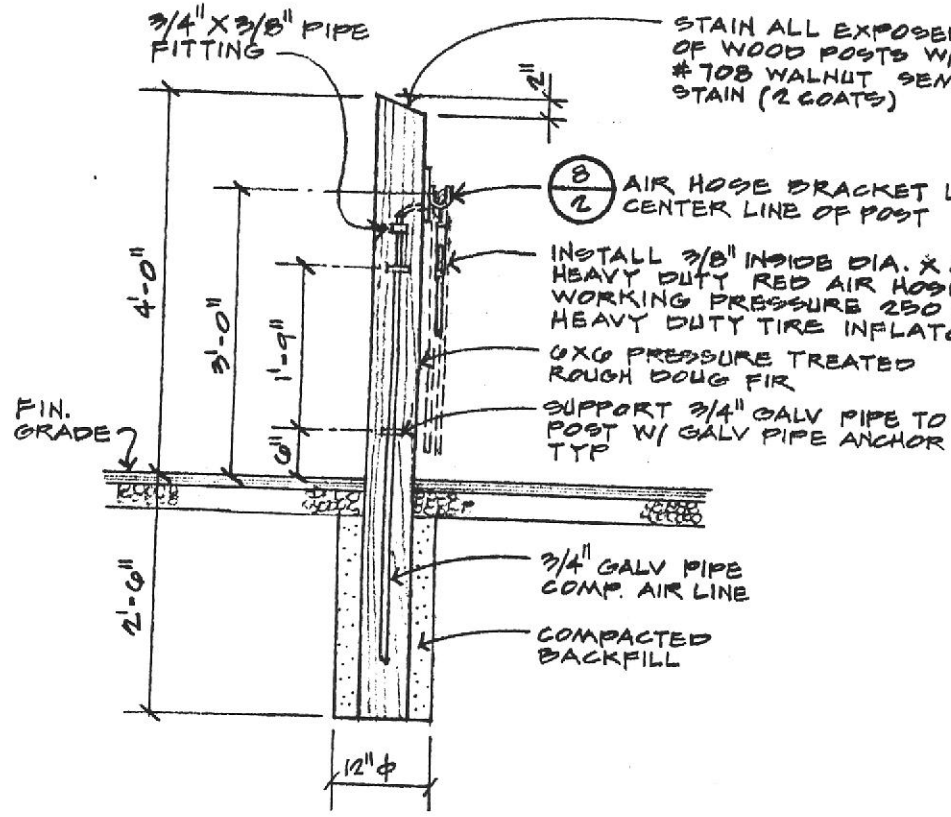

7 COMPRESSED AIR STATION
 2

REGIONAL PARK DISTRICT
 EVARD, OAKLAND, CALIF. 94619 510/531-300

APPROVED
 planning and design: [Signature]
 operations: [Signature]

scale: A
 drawn:
 checked
 date: 1/0

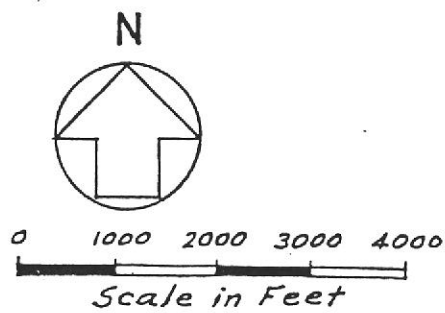
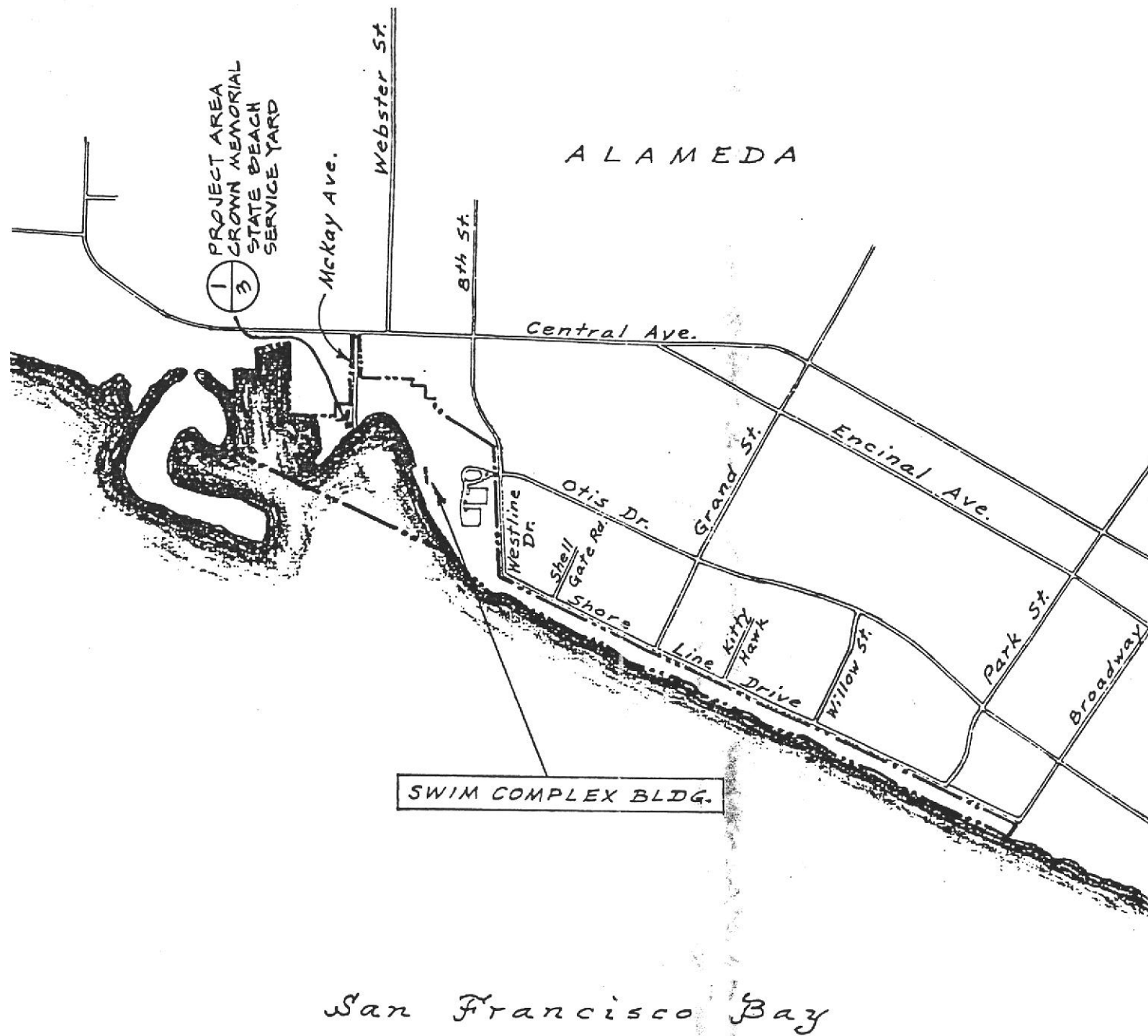

SITE VICINITY MAP
CROWN MEMORIAL STATE BEACH

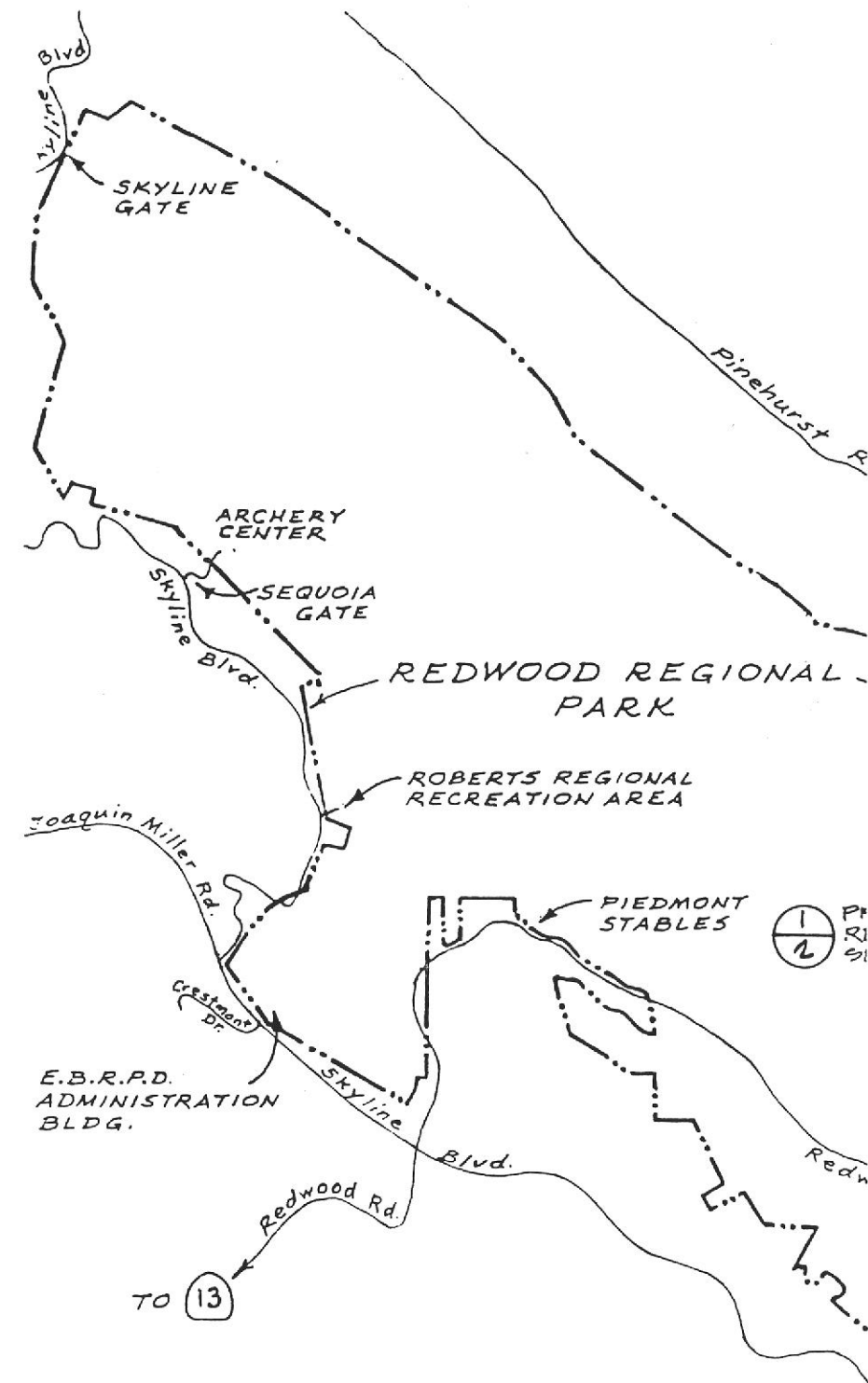

SITE VICINITY
REDWOOD REGIONAL PARK

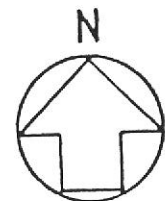

1000 2000 3000 4000
Scale in Feet

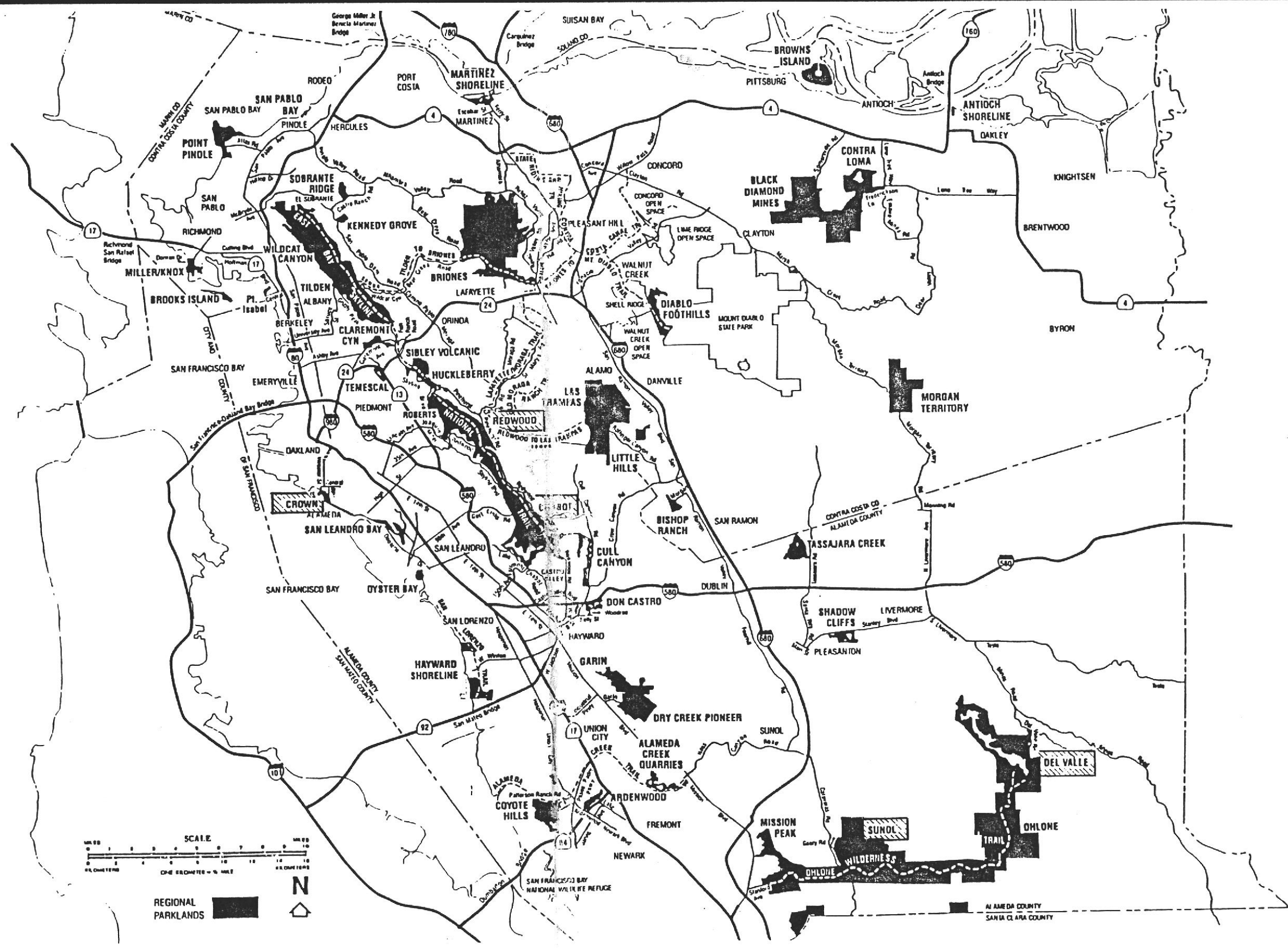
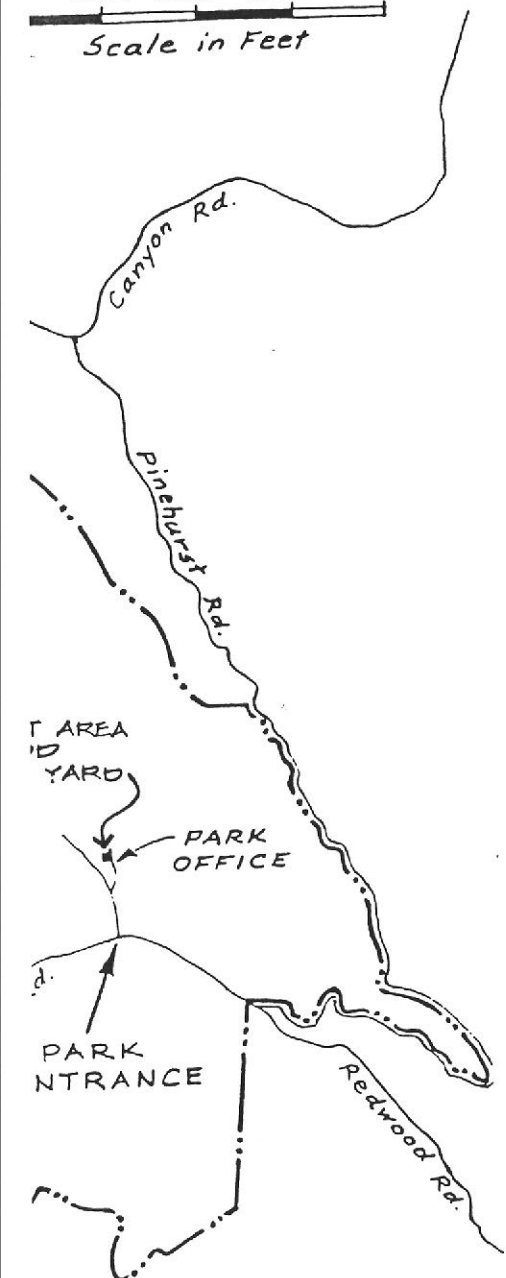

SCALE
ONE INCHES = 10 MILES

REGIONAL PARKLANDS

SITE LOCATION MAP

MAP VAL PARK

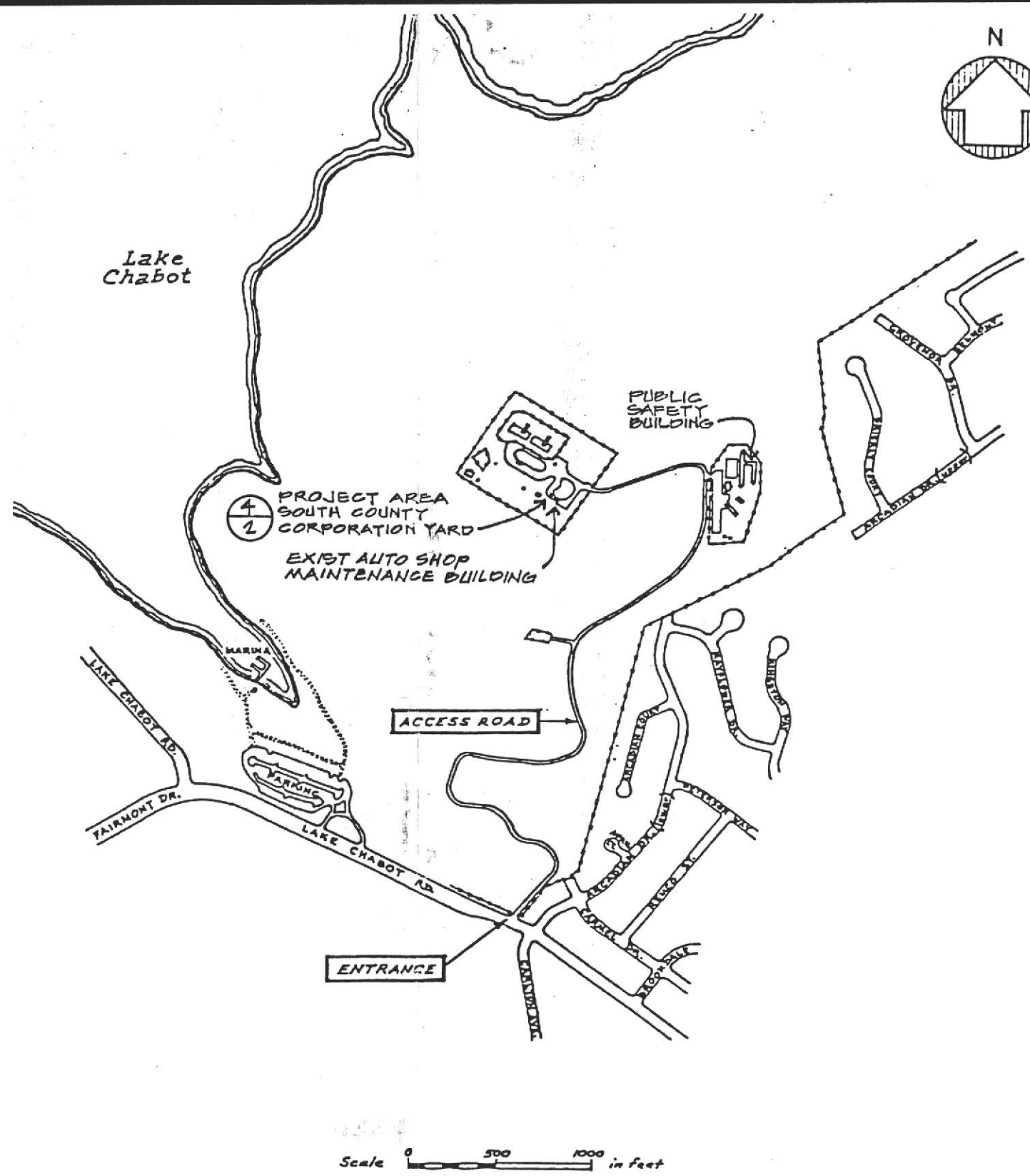

Scale 0 500 1000 in feet

SITE VICINITY MAP
SOUTH COUNTY CORPORATION YARD
 ADD ALTERNATE "C"

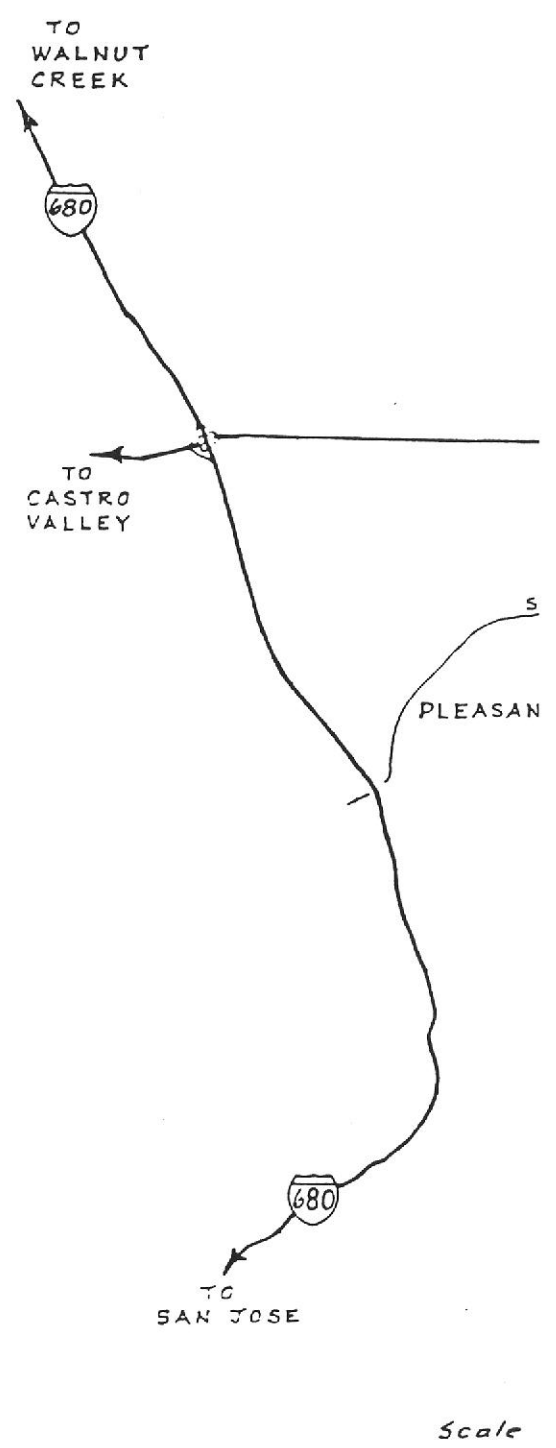

SITE
DEL VALL
 ADD ALTEI

REVISIONS



EAST BAY REGIONAL PARK DISTRICT

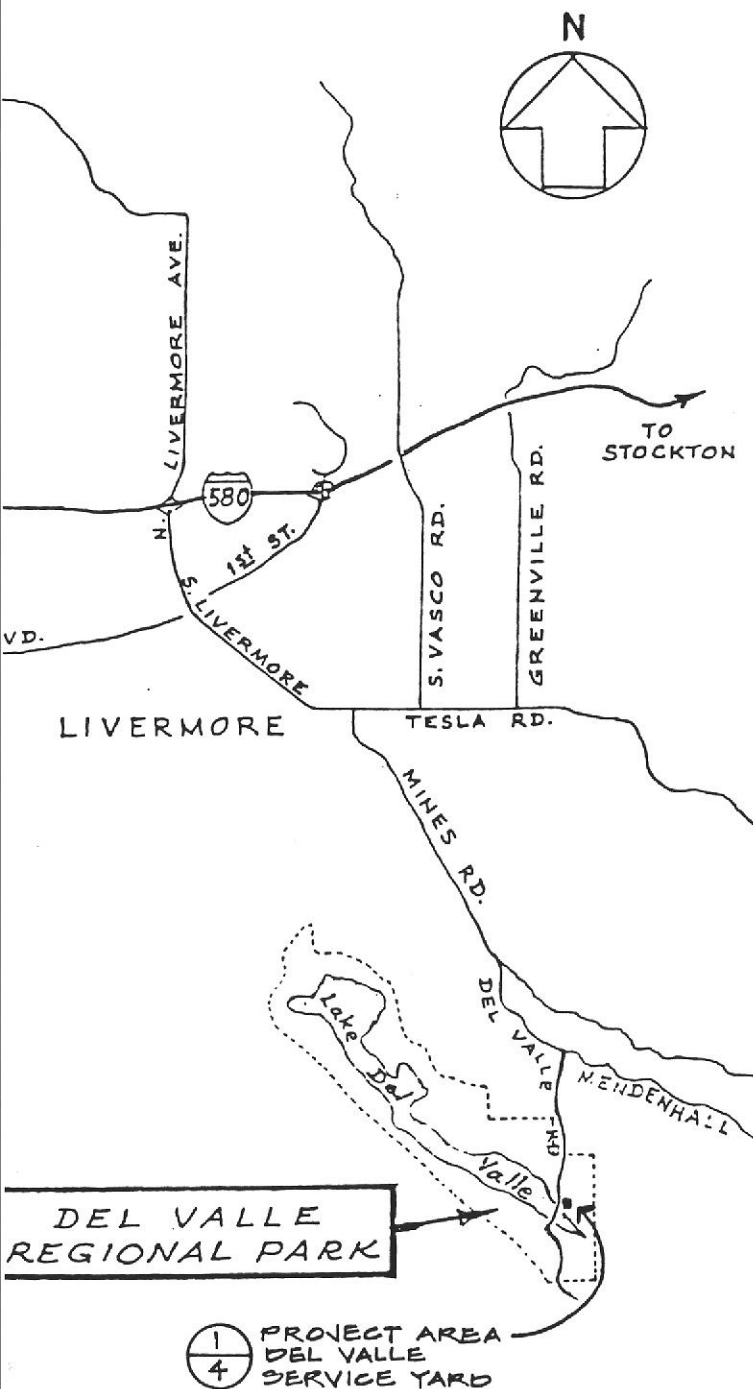

DEL VALLE REGIONAL PARK

PROJECT AREA DEL VALLE SERVICE YARD

3 4 in miles

INITIATION MAP
DEL VALLE REGIONAL PARK
ADD ALTERNATE "B"

APPROVED

scale: AS NOTED

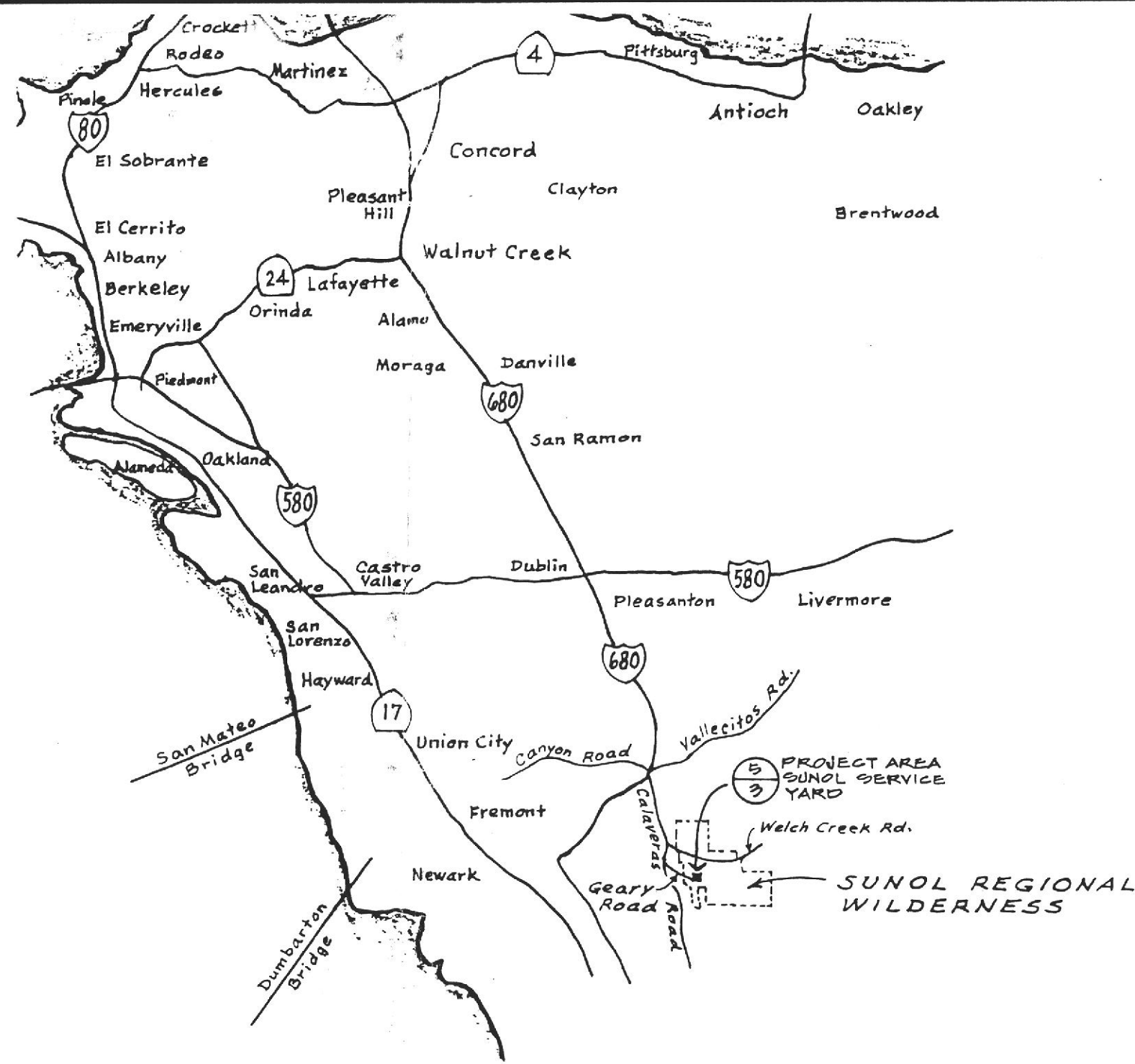

0 1 2 3 4 5 10
Scale in Miles

SITE VICINITY MAP
SUNOL REGIONAL WILDERNESS
ADD ALTERNATE "A"

ABOVE GROUND FUEL TANK WORK
DEL VALLE REGIONAL PARK

PRELIMINARY
NOT FOR CONSTRUCTION

SHEET NO.