



NATIONAL ENVIRONMENTAL TESTING, INC.

NET Pacific, Inc. 435 Tesconi Circle Santa Rosa, CA 95401 Tel: (707) 526-7200 Fax: (707) 526-9623

John Hom John C. Hom & Assoc., Inc. 1618 Second St San Rafael, CA 94901

Date: 11-13-90 NET Client Acct No: 589 NET Pacific Log No: 4623 Received: 10-26-90 1610

Client Reference Information

Sample analysis in support of the project referenced above has been completed and results are presented on following pages. Please refer to the enclosed "Key to Abbreviations" for definition of terms. Should you have questions regarding procedures or results, please feel welcome to contact Client Services.

Approved by:

Jules Skamarack Laboratory Manager (with signature)

Enclosure(s)



NET Pacific, Inc.

Client Acct: 589
Client Name: John C. Hom & Assoc., Inc.
NET Log No: 4623

Date: 11-13-90
Page: 2

Ref:

Descriptor, Lab No. and Results

Parameter	Reporting Limit	MW-1	MW-2	MW-3	Units
		10-26-90 1155	10-26-90 1235	10-26-90 1315	
		66546	66547	66548	
PETROLEUM HYDROCARBONS		--	--	--	
VOLATILE (WATER)		--	--	--	
DILUTION FACTOR *		1	1	1	
DATE ANALYZED		11-08-90	11-08-90	11-08-90	
METHOD GC FID/5030		--	--	--	
as Gasoline	0.05	ND	ND	ND	mg/L
METHOD 602		--	--	--	
DILUTION FACTOR *		1	1	1	
DATE ANALYZED		11-08-90	11-08-90	11-08-90	
Benzene	0.5	ND	0.8	0.7	ug/L
Ethylbenzene	0.5	ND	ND	ND	ug/L
Toluene	0.5	ND	1.1	0.8	ug/L
Xylenes, total	0.5	ND	2.1	2.2	ug/L



NET Pacific, Inc.

KEY TO ABBREVIATIONS and METHOD REFERENCES

- < : Less than; When appearing in results column indicates analyte not detected at the value following. This datum supercedes the listed Reporting Limit.
- * : Reporting Limits are a function of the dilution factor for any given sample. To obtain the actual reporting limits for this sample, multiply the stated Reporting Limits by the dilution factor (but do not multiply reported values).
- ICVS : Initial Calibration Verification Standard (External Standard).
- mean : Average; sum of measurements divided by number of measurements.
- mg/Kg (ppm) : Concentration in units of milligrams of analyte per kilogram of sample, (parts per million).
- mg/L : Concentration in units of milligrams of analyte per liter of sample.
- mL/L/hr : Milliliters per liter per hour.
- MPN/100 mL : Most probable number of bacteria per one hundred milliliters of sample.
- N/A : Not applicable.
- NA : Not analyzed.
- ND : Not detected; the analyte concentration is less than applicable listed reporting limit.
- NTU : Nephelometric turbidity units.
- RPD : Relative percent difference, $100 \text{ [Value 1 - Value 2] / mean value}$.
- SNA : Standard not available.
- ug/Kg (ppb) : Concentration in units of micrograms of analyte per kilogram of sample, (parts per billion).
- ug/L : Concentration in units of micrograms of analyte per liter of sample.
- umhos/cm : Micromhos per centimeter.

Method References

Methods 100 through 493: see "Methods for Chemical Analysis of Water & Wastes", U.S. EPA, 600/4-79-020, rev. 1983.

Methods 601 through 625: see "Guidelines Establishing Test Procedures for the Analysis of Pollutants" U.S. EPA, 40 CFR, Part 136, rev. 1988.

Methods 1000 through 9999: see "Test Methods for Evaluating Solid Waste", U.S. EPA SW-846, 3rd edition, 1986.

SM: see "Standard Methods for the Examination of Water & Wastewater, 16th Edition, APHA, 1985.

CHAIN OF CUSTODY RECORD

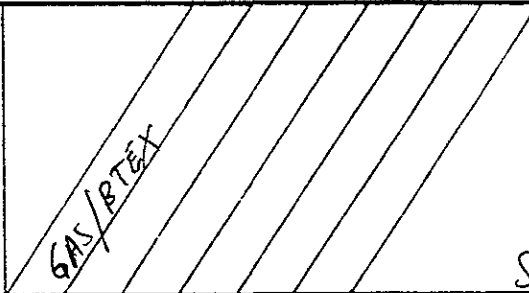
PROJ NO.		PROJECT NAME				NO. OF CON- TAINERS											REMARKS	
		JOHN C. HOM & ASSOCIATES (415) 258-9027 1618 2nd St SAN RAFAEL, CA															4623	
		SAMPLERS - (Signature) Eric J. Kueper															STAT	
STA NO	DATE	TIME	COMP	GRAB	STATION LOCATION													
MW 1	10/26/90	11:55		X	19051 19010 LAKE CHABOT RD CASTRO VALLEY (See map)	3	X											
MW 2	10/26/90	12:35		X			3	X										
MW 3	10/26/90	13:15		X			3	X										
Relinquished by (Signature)		Date / Time		Received by: (Signature)		Relinquished by: (Signature)		Date / Time		Received by: (Signature)								
Eric J. Kueper		10/26/90 16:10																
Relinquished by (Signature)		Date / Time		Received by: (Signature)		Relinquished by: (Signature)		Date / Time		Received by: (Signature)								
Relinquished by (Signature)		Date / Time		Received for Laboratory by (Signature)		Date / Time		Remarks										
				Schwartz		10/26/90 16:10												

ERIK
 JOHN C. HOM & ASSOCIATES
 1618 2nd ST.
 SAN RAFAEL, CA.
 19010 LAKE CHABOT RD, CASTRO VALLEY
 19051

10/26/90
 8:00-10:45 LOCATE WELLS (two covered with dirt & map is inaccurate)
 10:45-13:30 SAMPLE
 3 VOAS EACH WELL
 GAS/BTEX

MW1: WELL DEPTH: 19.08' #A 2" casing .1632
 DEPTH TO WATER: 14.45' collection date & time: 10/26/90 11:55
 WATER COLUMN: 4.63' purge equipment: bailer
 ONE VOLUME: .76 gal sample equipment: bailer
 TOTAL PURGE: 3.04

	PURGE 1	PURGE 2	PURGE 3	PURGE 4
TEMP °C:	18.4	18.7	18.6	18.6
pH:	6.5	6.7	6.8	6.8
umhos:	1529	1530	1518	1470

MW2: WELL DEPTH: 17.50' 2" casing
 DEPTH TO WATER: 7.96' collection date & time: 10/26/90 12:35
 WATER COLUMN: 9.54' purge equip: bailer
 ONE VOLUME: 1.56 sample equip: bailer
 TOTAL PURGE: 6.24

	PURGE 1	PURGE 2	PURGE 3	PURGE 4
TEMP °C	19.1	18.8	18.7	18.6
pH:	7.1	7.1	7.1	7.1
umhos	1544	1541	1539	1520

MW3: WELL DEPTH: 19.25' 2" casing
 DEPTH TO WATER: 8.74' collection date & time: 10/26/90 13:15
 WATER COLUMN: 10.51' purge equip: bailer
 ONE VOLUME: 1.72 sample equip: bailer
 TOTAL PURGE: 6.88

	PURGE 1	PURGE 2	PURGE 3	PURGE 4
TEMP °C	19.3	18.8	18.8	18.7
pH:	7.3	7.3	7.3	7.3
umhos	1349	1349	1352	1352

10/26/90

MW 1 & MW 3 were buried under dirt
and the map was inaccurate. I called John Home
and he said he would pay for a shovel and to
try and locate and to rent a metal detector. I didn't
have to rent a metal detector, but I did get a shovel
and finally uncovered the lost wells.

Erik J. Kuehner

3624958

PayLess
DRUG STORES

PAYLESS DRUGS
4225 15 1200034
102690 09:26

4019012118676093
EXP. DT-0191
CREDIT CARD 5.57

PAYLESS DRUGS
3848 CASTRO VLY
CASTRO VALLEY CA

*SHOVEL 5.19
TAX 1 .38
AMT DUE 5.57
CHRG CRD 5.57
CHANGE .00

10/26/90 09:26
120034 15 THANKS

x *Erik J. Kuehner*
Customer Signature

The owner of the card identified on this item is authorized to pay the amount shown as TOTAL upon proper presentation. I promise to pay such TOTAL (together with any other charges due thereon) subject to and in accordance with the Agreement governing the use of such card.

Thank You for shopping
PayLess

OUR NAME IS THE PROMISE OF VALUE
BUT WE KNOW PEOPLE MAKE THE DIFFERENCE
CUSTOMER COPY

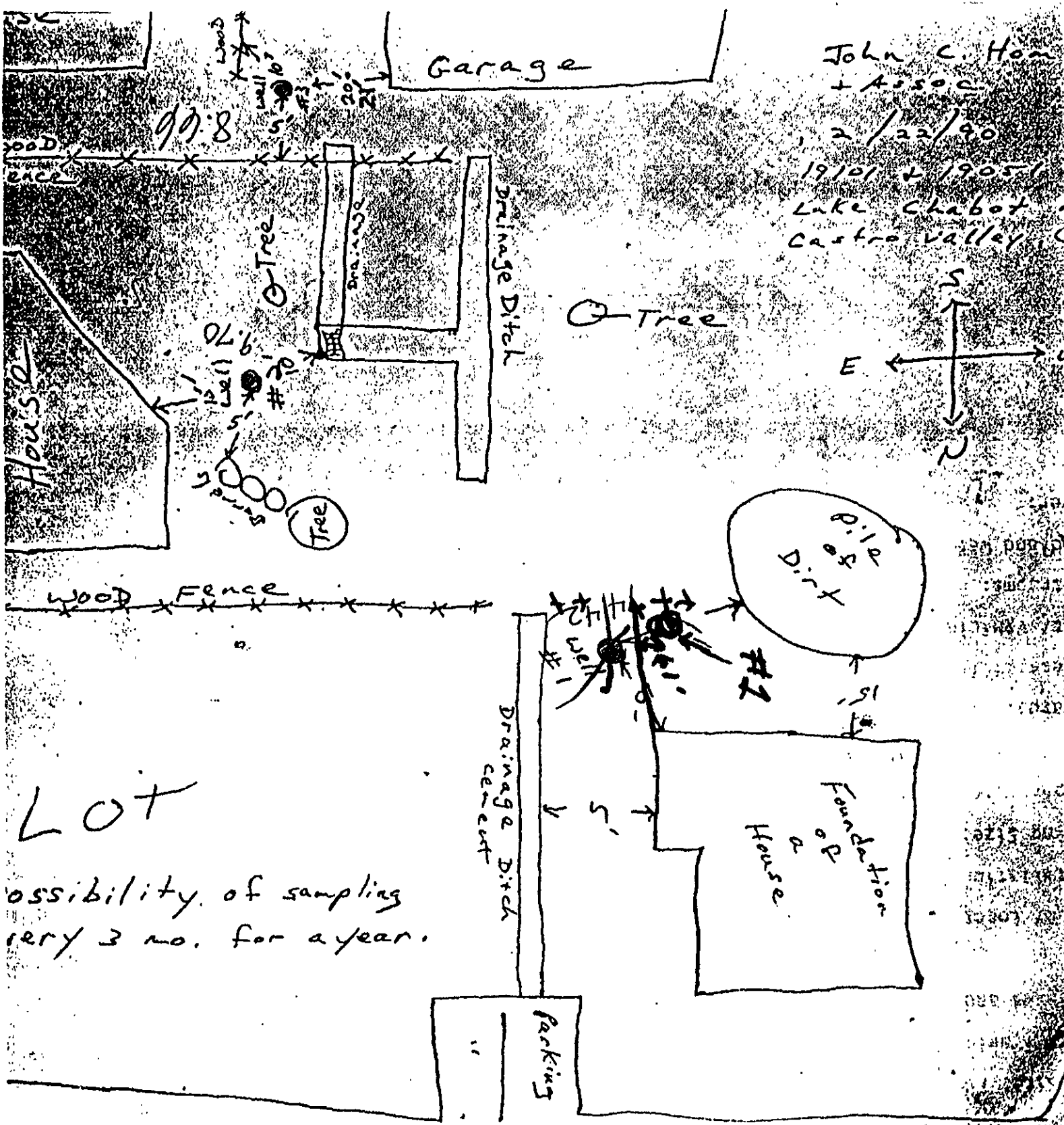

John C. Horn
 + Assoc.
 2/22/90
 19101 + 19051
 Lake Chabot
 Castro Valley, C

LOT
 Possibility of sampling
 every 3 mo. for a year.

HERTLEIN PL.