

*Reviewed  
Jeff H 11/13/96*

November 26, 1996

7-308

Mr. Henry Hertlein  
P.O. Box 824  
West Point, CA 95255

Re: Well Destruction Report for Wells 2S/2W 32C80 through 32C83  
19051 Lake Chabot Road  
Castro Valley, CA

Dear Mr. Hertlein:

Under permit number 96778 issued by the Alameda Flood Control and Water Conservation District (ACFCWCD), Zone 7, a total of four monitoring wells, (2S/2W 32C80 through 32C83) were destroyed on November 1, 1996 at the above-referenced site. A Site Location Map (Figure 1) and a Site Plan (Figure 2), showing the well locations, are included. Copies of the Zone 7 Water Agency's drilling permit and State of California, Well Completion Reports are also included.

Prior to grouting each well, the locking manhole cover was removed. The wells were destroyed by pressure grouting within the well casings. A high pressure hose connected to the well casing was used to force the water in the well and the bentonite/cement grout mixture through the well screen and into the void space surrounding the well. The bentonite/cement grout mixture filled the casing to the surface. Upon completion, the work area was backfilled with soil.

If you have any questions or require additional information, please feel free to call me at (510) 521-2684.

Sincerely,  
HYDRO-ENVIRONMENTAL TECHNOLOGIES, INC.

*FRANCES MARONI*

Frances Maroni  
Project Engineer

*Gary Pischke*

Gary Pischke  
Senior Geologist

enclosures

cc: Wyman Hong, ACFCWCD, Zone 7



# ZONE 7 WATER AGENCY

5997 PARKSIDE DRIVE

PLEASANTON, CALIFORNIA 94588

VOICE (510) 464-2600

FAX (510) 462-3914

## DRILLING PERMIT APPLICATION

FOR APPLICANT TO COMPLETE

FOR OFFICE USE

LOCATION OF PROJECT 19057 to 19101 Lake  
Chabot Road, Castro Valley

PERMIT NUMBER 96778  
LOCATION NUMBER 2S/2W 32080 to 32083

CLIENT  
Name Henry Hertlein  
Address P.O. Box 1824 Phone (209) 298-1305  
City Castro West Point Zip 95255

### PERMIT CONDITIONS

Circled Permit Requirements Apply

APPLICANT  
Name Hydro Environmental Tech.  
Address 2394 Marina St. Phone 510-521-2004  
City Alameda Zip 94501  
Fax: (510) 521-5078

### A. GENERAL

1. A permit application should be submitted so as to arrive at the Zone 7 office five days prior to proposed starting date.
2. Submit to Zone 7 within 60 days after completion of permitted work the original Department of Water Resources Water Well Drillers Report or equivalent for well Projects, or drilling logs and location sketch for geotechnical projects.
3. Permit is void if project not begun within 90 days of approval date.

### TYPE OF PROJECT

Well Construction	Geotechnical Investigation
Cathodic Protection <input type="checkbox"/>	General <input type="checkbox"/>
Water Supply <input type="checkbox"/>	Contamination <input type="checkbox"/>
Monitoring <input type="checkbox"/>	Well Destruction <u>(4) X</u>

HW-16 HW-4

### B. WATER WELLS, INCLUDING PIEZOMETERS

1. Minimum surface seal thickness is two inches of cement grout placed by tremie.
2. Minimum seal depth is 50 feet for municipal and industrial wells or 20 feet for domestic and irrigation wells unless a lesser depth is specially approved. Minimum seal depth for monitoring wells is the maximum depth practicable or 20 feet.

### PROPOSED WATER SUPPLY WELL USE

Domestic  Industrial  Other   
Municipal  Irrigation

C. GEOTECHNICAL. Backfill bore hole with compacted cuttings or heavy bentonite and upper two feet with compacted material. In areas of known or suspected contamination, tremied cement grout shall be used in place of compacted cuttings.

D. CATHODIC. Fill hole above anode zone with concrete placed by tremie.

E. WELL DESTRUCTION. See attached.

### DRILLING METHOD:

Mud Rotary  Air Rotary  Auger   
Cable  Other pressure grout

DRILLER'S LICENSE NO. 582696

### WELL PROJECTS

Drill Hole Diameter	<u>8</u> in.	Maximum	
Casing Diameter	<u>2</u> in.	Depth	<u>16</u> ft.
Surface Seal Depth	<u>2</u> ft.	Number	<u>4</u>

### GEOTECHNICAL PROJECTS

Number of Borings		Maximum	
Hole Diameter	<input type="checkbox"/> in.	Depth	<input type="checkbox"/> ft.

ESTIMATED STARTING DATE 10/29 11/1/96  
ESTIMATED COMPLETION DATE 10/29 11/1/96

Approved Wyman Hong Date 29 Oct  
Wyman Hong

I hereby agree to comply with all requirements of this permit and Alameda County Ordinance No. 73-68.

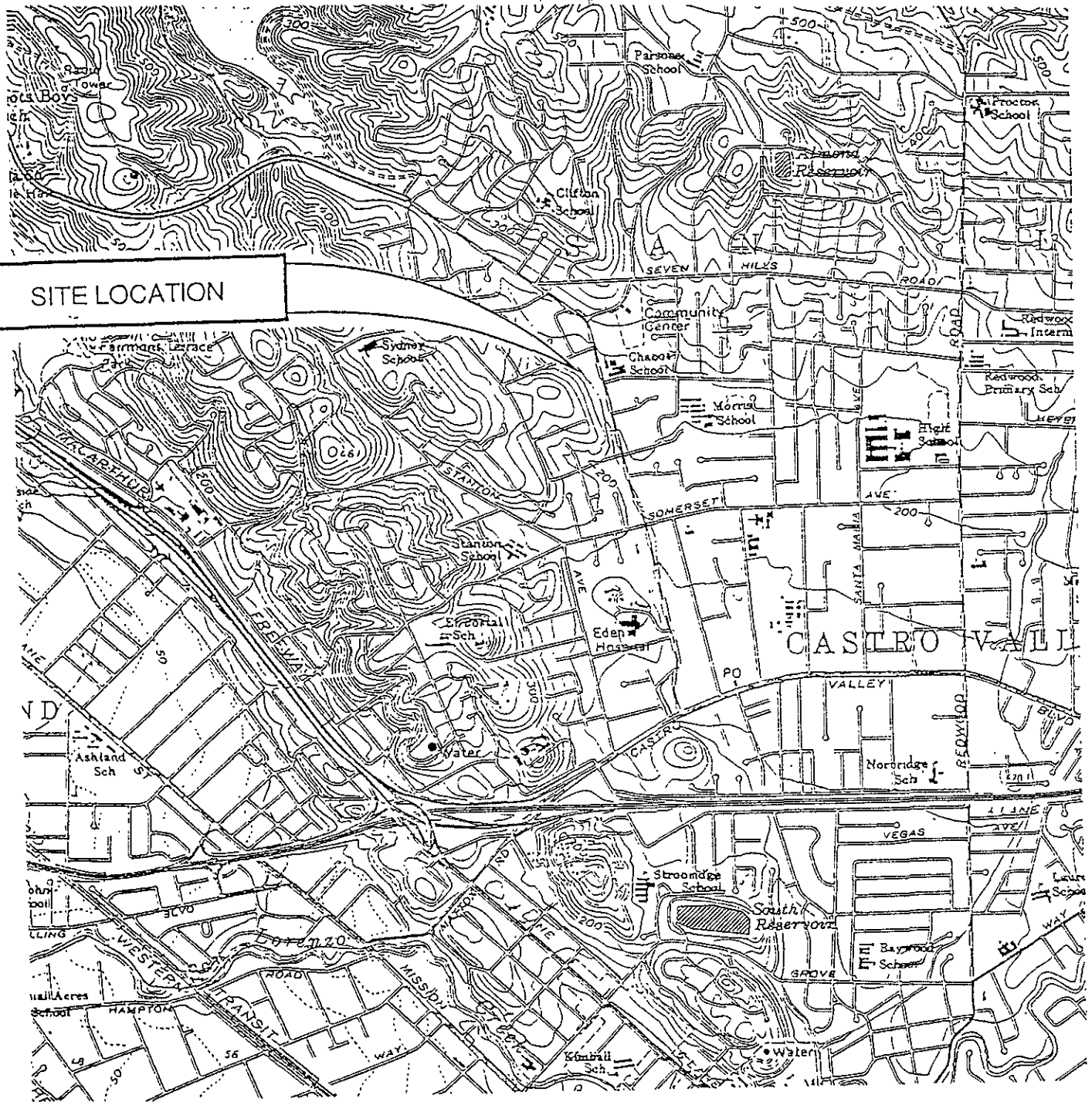

SOURCE: USGS 7.5 MINUTE SERIES (TOPOGRAPHIC)  
 TITLED: HAYWARD, CALIF. QUADRANGLE  
 PHOTOREVISED 1980



HYDR-  
 ENVIR-  
 ENVIRONMENTAL  
 TECHNOLOGIES, INC.

**SITE LOCATION MAP**  
 Former Hertlein Property  
 19051-19101 Lake Chabot Road  
 Castro Valley, CA

Figure  
 1  
 7-308 10/96

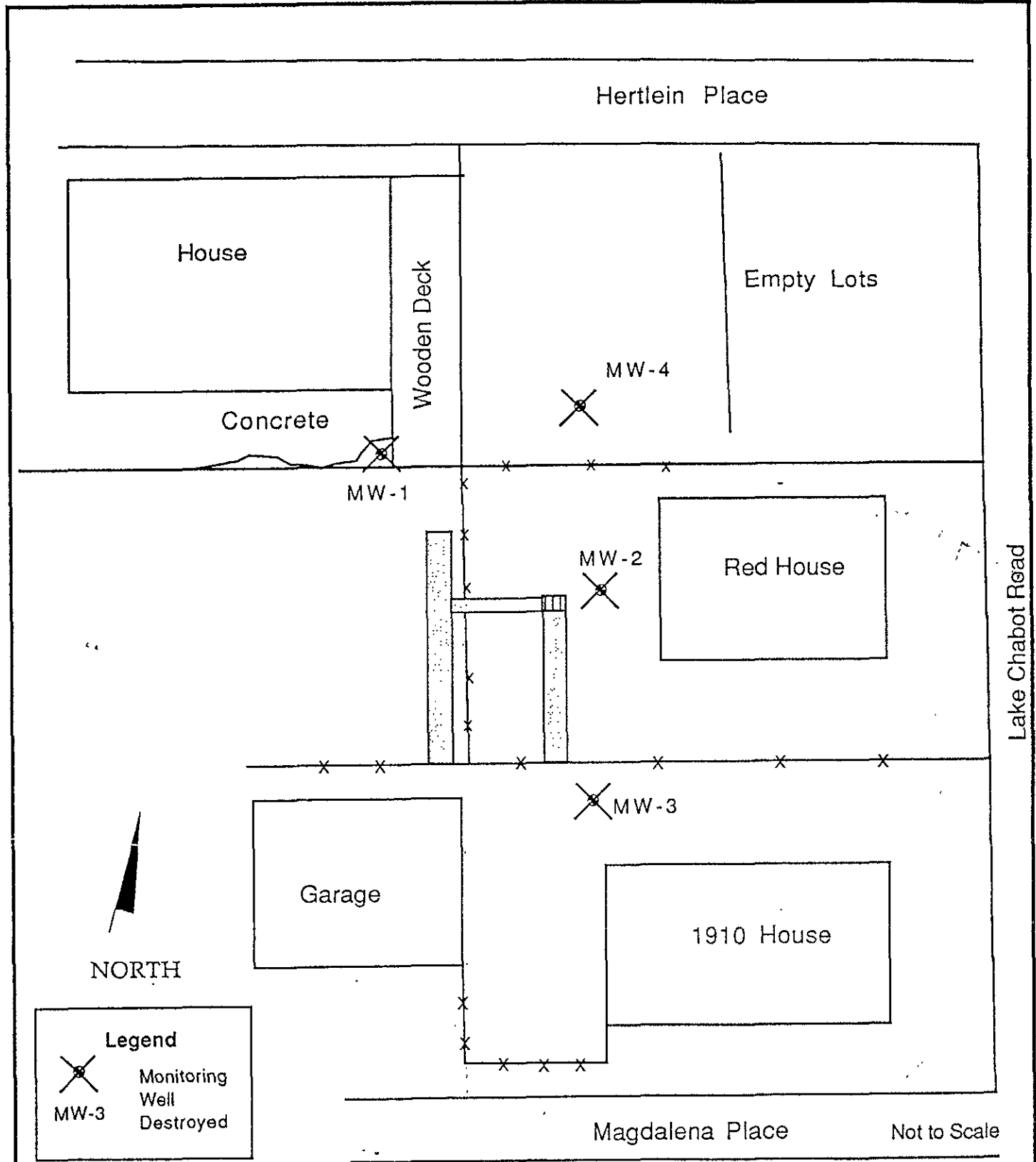

Lake Chabot Road

**Legend**

 Monitoring Well

 Destroyed

MW-3

**HYDR** -  
**ENVIR**  **NMENTAL**  
**TECHN**  **LOGIES, INC.**

**SITE PLAN**  
 Former Hertlein Property  
 19051-19101 Lake Chabot Road  
 Castro Valley, California

Figure  
**2**  
 7-308 11/96

ENVIRONMENTAL  
PROTECTION  
96 NOV 27 PM 1:24

ALAMEDA COUNTY  
HEALTH CARE SERVICES



AGENCY

DAVID J. KEARS, Agency Director

Alameda County CC4580  
Environmental Health Services  
1131 Harbor Bay Pkwy., #250  
Alameda CA 94502-6577  
(510)567-6700 FAX(510)337-9335

Std 4263

August 1, 1996

Henry R. and Mary M. Hertlein  
Former owners of 19051 Castro Valley Blvd./current owners of parcel nos. 84B-510-34 and 84B-510-35  
PO Box 824  
West Point CA 95255

**Subject: Well destruction request for 19051 Castro Valley Blvd, Castro Valley, CA 94546  
(including properties located at or adjacent to parcel numbers 84B-510-32, 84B-510-33,  
84B-510-34, 84B-510-35, 84B-510-36, and 84B-510-38)**

Dear Mr. and Ms. Hertlein:

The Alameda County Department of Environmental Health, Environmental Protection Division and the San Francisco Regional Water Quality Control Board have reviewed the case closure summary for the above referenced site and concur that no further action related to the release(s) from the former underground storage tank(s) is required at this time.

Please be advised that if there are no plans to continue groundwater monitoring, the four groundwater monitoring wells (MW-1, MW-2, MW-3, and MW-4) at the site must be properly decommissioned before our agency will issue the Remedial Action Completion Certification (closure letter). A report must be submitted to this office documenting the abandonment of the monitoring wells or a letter stating your intentions to continue groundwater monitoring at the site.

Well destruction permits may be obtained from Alameda County Flood Control and Water Conservation, Zone 7. Their telephone number is (510)484-2600. Additionally, you will need to notify this office 72 hours in advance of the well abandonment field activities.

Please call me at (510)567-6755 if you have questions.

Sincerely,

A handwritten signature in cursive script that reads "Amy Leech".

Amy Leech  
Hazardous Materials Specialist

c: David H. and Kathryn E. Miller, owners of parcel no. 84B-510-32  
Gregory and Rebecca Beaman, owners of parcel no. 84B-510-33 (3249 Hertlein Place)  
Helen Millen, owner of parcel no. 84B-510-36 (19125 Lake Chabot Road)  
Irmgard Divine, owner of parcel no. 84B-510-38 (3264 Magdalena Place)  
Kevin Graves, RWQCB  
Gordon Coleman - File(ALL)

Re: See Attached

Did not want to list personal addresses on the letter so here is a list of addresses for those to be copied:

David H. and Kathryn E. Miller, owners of parcel no. 84B-510-32  
3223 Hertlein Place, Castro Valley, CA 94546

Gregory and Rebecca Beaman, owners of parcel no. 84B-510-33 (3249 Hertlein Place)  
3249 Hertlein Place, Castro Valley, CA 94546

Helen Millen, owner of parcel no. 84B-510-36 (19125 Lake Chabot Road)  
19125 Lake Chabot Rd., Castro Valley, CA 94546

Irmgard Divine, owner of parcel no. 84B-510-38 (3264 Magdalena Place)  
8891 Oakmont Dr., Santa Rosa, CA 95409

Kevin Graves, RWQCB  
Gordon Coleman - File(ALL)

Thank You! Amy

ALAMEDA COUNTY  
HEALTH CARE SERVICES  
AGENCY



DAVID J. KEARS, Agency Director

RAFAT A. SHAHID, ASST. AGENCY DIRECTOR

STID 4263

DEPARTMENT OF ENVIRONMENTAL HEALTH  
State Water Resources Control Board  
Division of Clean Water Programs  
UST Local Oversight Program  
80 Swan Way, Rm 200  
Oakland, CA 94621  
(510) 271-4530

May 19, 1994

Mr. Henry Hertlein  
P.O. Box 824  
West Point, CA 95255

RE: HERTLEIN ELECTRIC, 19051 LAKE CHABOT ROAD, CASTRO VALLEY,  
ALAMEDA COUNTY

Dear Mr. Hertlein:

I have completed a tentative rereview of the case file for the referenced site, including the information submitted by Mr. Jon Hom, Jon C. Hom & Associates (JHA), under cover dated June 18, 1993. My review revealed the same data problems as discussed most recently in the June 18, 1992 correspondence from this office. Specifically, data from wells "MW-1" and "MW-2" have apparently been transposed on more than one occasion during the course of this investigation, making it unclear just when the data are being reported correctly, and when they are not. The genesis of this data problem appears to be a result of the sampling contractor using one designation for wells "MW-1" and "MW-2", and JHA the opposite. Such makes a substantial difference in how the data may be interpreted.

The cited June 18 letter requests that JHA tabulate and present the historic sampling data in a corrected fashion, and as a stand-alone report exhibit. I had hoped that this table was included with JHA's June 1993 submittal, but it was not. These data must be corrected. Otherwise, it is impossible to confidently interpret the status of this project as we must, and equally impossible to argue to the RWQCB why this, or any case with similar reporting problems, merits closure when the data are in question.

Please submit a tabulation of corrected sampling data for all historic sampling events. It is imperative that an evaluation also be presented discussing whether, in addition to the laboratory data being misreported, water elevation and gradient calculations were incorrectly reported as a result of the same well number misidentification. Our records further indicate the four wells at this site have not been sampled since June 1992. It is appropriate to sample these wells at this time to see if contaminant levels have attenuated to any appreciable degree over the course of the last two years. A significant change in contaminant levels, along with a correction of the remaining data, will go far to argue for case closure.



JCH

**JOHN C. HOM & ASSOCIATES, INC.**

1618 Second Street  
San Rafael, CA 94901-2707  
(415) 258-9027

June 18, 1993

Job Number 650.1

Department of Environmental Health  
Hazardous Materials Division  
Attention: Scott Seery  
80 Swan Way, Room 200  
Oakland, California 94621

Dear Mr Seery:

Gasoline Cleanup  
19051 Lake Chabot Road  
Castro Valley, California

This letter is in response to your letter of June 18, 1992. We originally drafted a response in August, 1992. However, the draft was never finalized and we apologize for the delay and oversight. Since our November 8, 1990 report, two additional samplings and testings were done by Net Pacific and the copies are attached.

The sampling and testing data by Net Pacific confirms that MW-2, MW-3, and MW-4 have shown non-detectible levels of gasoline, benzene, ethylbenzene, toluene, and xylene since February 11, 1991. In fact, the levels of the above have been slightly above the detectible levels since July 27, 1990. The toluene and xylene levels, up to 2.2 parts per billion, though detectible, are well below the action levels as set forth by the Regional Water Quality Board. We disagree with your assessment that MW-1 has exhibited elevated concentrations of total petroleum hydro-carbons. With the exception of the level of benzene, toluene, ethylbenzene, and xylene are below the action levels. We do agree with you that the benzene, because it is above the action level, is elevated. Two additional samplings taken and tested on November 21, 1991 and March 11, 1991 further show that MW-2, MW-3, and MW-4 have non-detectible levels of petroleum hydro-carbons. MW-1 continued to show detectible levels, and again, with only benzene above the action level. We are enclosing copies of the testing data for your reference.

We also understand that you requested a field map from Net Pacific and that this field map confirms our transposing of MW-1 and MW-2, shown on our Well Location Map. As far as transposing MW-1 and MW-2 are concerned, other parts of the report of November 8, 1991 substantiate the actual locations of the wells. This was transposed only on the November 8, 1991 Well Location Map.

owner: Henry R. + Mary M. Hertlein  
19051 Lake Club Rd  
Castro Valley 94546

DATE: 7-15-92  
TO : Local Oversight Program  
FROM: Scott  
SUBJ: Transfer of Eligible Oversight Case

Site name: Hertlein Electric  
Address: 19051 Lk. Club Rd city CV zip 94546

Closure plan attached? Y  N DepRef remaining \$ \_\_\_\_\_

DepRef Project # \_\_\_\_\_ STID #(if any) 4263

Number of Tanks: 1 removed?  Y N Date of removal 1986

Leak Report filed?  Y N Date of Discovery 1986 (report 12/14/88)

Samples received?  Y N Contamination: yes

Petroleum  Y N Types: Avgas Jet ~~leaded~~ unleaded Diesel  
fuel oil waste oil kerosene solvents

Monitoring wells on site 4 Monitoring schedule?  Y N

LUFT category 1 2  3 \* H S C A R W G O

Briefly describe the following:

Preliminary Assessment performed

Remedial Action \_\_\_\_\_

Post Remedial Action Monitoring \_\_\_\_\_

Enforcement Action \_\_\_\_\_

**W E E K L Y   I N S P E C T I O N   R E C O R D**  
**S E L F   C O N T A I N E D   B R E A T H I N G   A P P A R A T U S   C Y L I N D E R S**

Week of:      Cylinders Tight?      Follow Up Required?

---

Copy sent to H. Hartman 6/3/93

ALAMEDA COUNTY  
HEALTH CARE SERVICES

AGENCY

DAVID J. KEARS, Agency Director



RAFAT A. SHAHID, Assistant Agency Director

June 18, 1992

Mr. Jon C. Hom  
John C. Hom & Associates, Inc.  
1618 Second Street  
San Rafael, CA 94901-2707

DEPARTMENT OF ENVIRONMENTAL HEALTH  
Hazardous Materials Division  
80 Swan Way, Rm. 200  
Oakland, CA 94621  
(510) 271-4320

RE: 19051 LAKE CHABOT ROAD, CASTRO VALLEY

Dear Mr. Hom:

As we discussed during this afternoon's telephone conversation, the Department has completed review of the August 2 and November 8, 1991 Jon C. Hom & Associates, Inc. (JCH) quarterly ground water monitoring reports for the referenced site. We have also considered JCH's November 8, 1991 and May 5, 1992 requests that the Department review this case for potential closure.

Review of sampling data presented in reports submitted to date indicate that fuel hydrocarbons have impacted all of the on-site wells at some point during the investigation, except MW-4, located east of the former underground storage tank pit. Presented data indicates that one of the downgradient wells, designated "MW-1," has exhibited elevated concentrations of total petroleum hydrocarbons as gasoline (TPH-G), benzene, toluene, ethylbenzene, and total xylene isomers (BTEX) as recently as August 1991.

However, today you indicated that the data presented in the referenced August and November JCH reports misidentified the locations of wells designated MW-1 and -2 in those reports, transposing data reflecting the sampling results from one to the other. This problem had apparently occurred earlier in the investigation, and had been discussed at some length in the past. A letter from this department dated July 26, 1991 requested that designated well numbers be standardized between JCH and the sampling consultant, NET Pacific, Inc., to preclude this problem from occurring in the future. The obvious result of this problem is a significant reduction in our confidence that the data presented is correct and relevant.

We also understand that the subject wells have been sampled twice since the November 1991 report was issued: during December 1991 and March 1992. This data should be submitted forthwith, including any gradient information which may also have been generated, and field maps produced by the sampling technician during each sampling event, among the other elements comprising an appropriate quarterly monitoring report. This would include a corrected tabulation of all sampling results to date. Please provide this table as a stand-alone exhibit to the report, as opposed to presenting it in a reduced form on the site map, as in past reports. As we further discussed, field maps for the August 1991 sampling event must be provided at this time.

Mr. Jon Hom  
RE: 19051 Lake Chabot Road  
June 18, 1992  
Page 2 of 2

Upon receipt and review of the aforementioned data, the Department will consider the status of this case. However, until such time as you are notified otherwise, sampling and monitoring of the wells at the subject site shall continue on the requisite quarterly schedule previously established.

Please be advised that Section 2652(d) of Title 23, California Code of Regulations, requires that summary reports be submitted to the local agency every three months, or more frequently as directed by the local agency or regional water quality control board, for the duration of all environmental projects investigating a release from an underground storage tank. Please be further advised that this letter constitutes an official request for technical reports pursuant to California Water Code Section 13267(b). Failure to submit such reports may result in the assessment of civil penalties.

Please call me at 510/271-4320 should you have any questions.

Sincerely,



Scott O. Seery, CHMM  
Senior Hazardous Materials Specialist

cc Edgar Howell, Chief, Hazardous Materials Division  
Gil Jensen, Alameda County District Attorney's Office  
Rich Hiatt, RWQCB  
Howard Hatayama, DTSC  
Bob Bohman, Castro Valley Fire Department  
files

JCH

**JOHN C. HOM & ASSOCIATES, INC.**

1618 Second Street  
San Rafael, CA 94901-2707  
(415) 258-9027

May 5, 1992

Job Number 650.1

Scott Seery  
Department of Environmental Health  
80 Swan Way, Room 200  
Oakland, California 94621

Dear Mr Seery:

19051 Lake Chabot Road  
Castro Valley, California

*to Oct. 8, actually*

On October 8, 1991, we wrote to you concerning the possibility of terminating the testing at the subject property because the testing showed very little changes and no contamination downstream of the gasoline tank leak. We have not had a reply from your office regarding this matter and request that you respond. Our clients are anxious to close the subject.

We trust this provides the information you require at this time. If you have any questions, please call.

Yours very truly,

JOHN C HOM & ASSOCIATES, INC



*John C. Hom*  
John C Hom  
Civil Engineer - 28877  
Geotechnical Engineer - 412  
Certificates Expire 3/31/95

921007-0 0119:06

JCH/jbc

1 copy submitted

JCH

**JOHN C. HOM & ASSOCIATES, INC.**

1618 Second Street  
San Rafael, CA 94901-2707  
(415) 258-9027

August 2, 1991

Job Number 650.1

Scott Seery  
County of Alameda  
80 Swan Way, Room 200  
Oakland, California 94621

Dear Mr Seery:

Report  
Chemical Testing  
Groundwater Study  
19051 Lake Chabot Road  
Castro Valley, California

This report presents our quarterly report of the groundwater study for the property at 19051 Lake Chabot Road in Castro Valley, California. A previous report was presented on May 14, 1991. Since that time, we had Net Pacific conduct a water level reading and water sampling. Their field work is dated May 24, 1991. The chemical testing results are dated June 10, 1991 and a copy is attached. We have calculated the groundwater gradient using the three point method. The results are attached. We standardized the system using the monitor well notation by Net Pacific (MW-1 through MW-4). A tabulation of the chemical testing is also attached.

Based on the most recent testing results, it appears that the chemicals have been stabilized. The downstream wells (MW-1, MW-3, and MW-4) have shown little or no detectible amounts. The well nearest the source (MW-2) shows amounts of benzene above the action level.

We trust this provides the information you require at this time. If you have any questions, please call.

Yours very truly,

JOHN C HOM & ASSOCIATES, INC

91 AUG -5 PM 12:13

19051 Lake Chabot Road, continued  
August 2, 1991 - Job Number 650.1  
Scott Seery  
County of Alameda  
Page 2

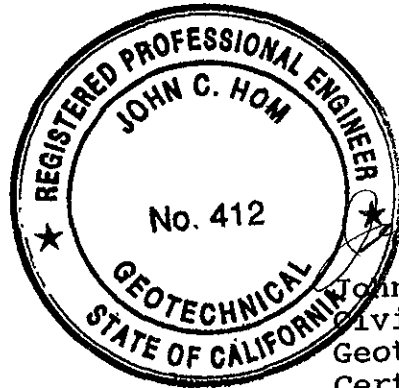

*John C. Hom*  
John C Hom  
Civil Engineer - 28877  
Geotechnical Engineer - 412  
Certificates Expire 3/31/95

JCH\jbc

3 copies submitted

- c: Fredric Divine Associates  
704 Mission Avenue  
San Rafael, California 94901
- c: Henry Hertlein  
19051 Lake Chabot Road  
Castro Valley, California 94546
- c: San Francisco Bay Region  
Water Quality Control Board  
Attention: Lester Feldman  
2101 Webster Street, Room 500  
Oakland, California 94612

**JCH**  
**JOHN C. HOM**  
& ASSOCIATES, INC.  
Geotechnical Consultants



JCH

**JOHN C. HOM & ASSOCIATES, INC.**

1618 Second Street  
San Rafael, CA 94901-2707  
(415) 258-9027

July 31, 1991

650.1

Scott Seerly  
County of Alameda  
80 Swan Way, Room 200  
Oakland, California 94621

Dear Mr Seerly:

Quarterly Report  
19051 Lake Chabot Road  
Castro Valley, California

We are in receipt of your letter of July 26, 1991. This transmittal is intended for your information only and not intended to be the quarterly report as you indicated in your letter. A quarterly report is forthcoming.

We trust this provides the information you require at this time. If you have any questions, please call.

Yours very truly,

JOHN C HOM & ASSOCIATES, INC

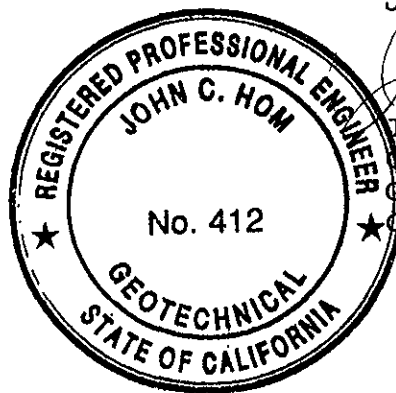

*John C. Hom*  
John C Hom  
Civil Engineer - 28877  
Geotechnical Engineer - 412  
Certificates Expire 3/31/95

JCH\jbc

1 copy submitted

c: Fredric Divine Associates  
704 Mission Avenue  
San Rafael, California 94901

91 AUG -2 PM 2:30

ALAMEDA COUNTY  
**HEALTH CARE SERVICES**

AGENCY  
DAVID J. KEARS, Agency Director



July 26, 1991

Mr. John Hom  
John C. Hom & Associates, Inc.  
1618 Second Street  
San Rafael, CA 94901-2707

DEPARTMENT OF ENVIRONMENTAL HEALTH  
Hazardous Materials Program  
80 Swan Way, Rm. 200  
Oakland, CA 94621  
(415)

RE: QUARTERLY REPORT; 19051 LAKE CHABOT ROAD, CASTRO VALLEY, ALAMEDA COUNTY

Dear Mr. Hom:

This Department is in receipt and has reviewed the July 23, 1991 John C. Hom and Associates, Inc. (JCH) quarterly report documenting sampling activities at the referenced Castro Valley site occurring during May 1991. Review of this document uncovered several deficiencies, as follows:

- 1) A copy of each quarterly report is to be provided to the San Francisco Bay Regional Water Quality Control Board (RWQCB), to the attention of Mr. Lester Feldman;
- 2) Each quarterly report is to include a map showing the locations of all wells at the site;
- 3) Each quarterly report is to provide ground water gradient maps and surveyed ground water elevation data;
- 4) Each quarterly report is to provide a chronology of all chemical analysis data and ground water elevation measurements to date. Such data is to be presented in tabular form to facilitate review of reports and recognize trends or fluctuations in site characteristics;
- 5) Each report is to present standardized number assignments for each well (i.e., MW-1, MW-2, etc.) that are consistent between the contractor doing the actual sampling and JCH, the report author. To date, each company has used a different numbering system for the wells, making review of the reports confusing and significantly increasing the potential for misinterpretation of data.

The items presented in this letter have been discussed with you on several occasions in the past, the most recent during a telephone conversation we shared July 3. Please submit the information described in items 1-5 within 10 days, or by August 5, 1991. Failure to provide these required elements in future reports will render such reports unacceptable, and will compromise this Department's ability to accept any subsequent reports from JCH.

Mr. John C. Hom  
RE: 19051 Lake Chabot Road, Castro Valley  
July 26, 1991  
Page 2 of 2

Should you have any questions, please call me at 415/271-4320.

Sincerely,

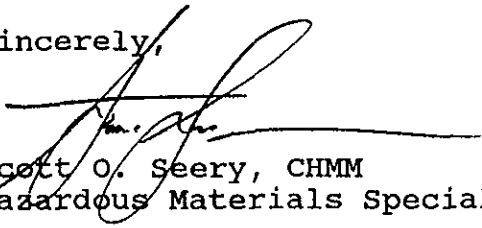

Scott O. Seery, CHMM  
Hazardous Materials Specialist

cc: Rafat A. Shahid, Assistant Agency Director, Environmental Health  
Edgar Howell, Chief, Hazardous Materials Division  
Gil Jensen, Alameda County District Attorney's Office  
Howard Hatayama, DHS  
Lester Feldman, RWQCB  
Bob Bohman, Castro Valley Fire Department  
Frederic Divine, Frederic Divine and Assoc.  
Henry Hertlein  
files

JCH

**JOHN C. HOM & ASSOCIATES, INC.**

1618 Second Street  
San Rafael, CA 94901-2707  
(415) 258-9027

91 MAY 16 AM 11:20

May 14, 1991

Job Number 650.1

Frederic Divine & Associates, Inc.  
Attention: Frederic Divine  
704 Mission Street  
San Rafael, CA 94901

Dear Mr. Divine:

Report  
Chemical Testing and  
Ground Water Study  
19051 Lake Chabot Road  
Castro Valley, California

This letter presents the results of reports for the ground water study we conducted for 19051 Lake Chabot Road in Castro Valley, California. We previously presented a report dated September 19, 1990, and a supplement dated October 20, 1990. This new report is based on additional water level readings, chemical testing, and ground water gradient analysis since October 20, 1990. Ground water readings and chemical testings were conducted on October 26, 1990 and February 1, 1991. The testing and ground water readings were conducted by NET Pacific and the results of the tests are attached. Our office provided the analysis for the ground water gradient. We analyzed the ground water flow based on the three point method. The calculations are attached.

**SUMMARY**

October 26, 1990

This analysis is based on the sampling of three wells. The ground water gradient about N 56° E. The chemical analysis indicate non-detectable levels for Boring 2. The downstream wells (Borings 1 and 3) show detectable levels of benzene, toluene, and xylene. The chemical test shows that the toluene and xylene are below the action level, and the benzene is slightly above the action level.

February 1, 1991

Since October 26, 1990, Mr. Hertlein located a well that was previously reported as missing. This well, in fact, was covered by 3-feet of fill. The well was extended above the existing ground surface for approximately 3-feet. The extension included extending the PVC pipe casing, grouting around the pipe, and providing a new cap and lock. This well, along with the

19051 Lake Chabot Road, continued  
May 14, 1991 - Job Number 650.1  
Frederic C. Divine  
Page 2

other 3-three wells, were sampled and ground water readings read. The analysis indicated that the ground water gradient is from Boring 2 towards Borings 1 and 3. Boring 2 shows a detectable level of benzene and ethylbenzene. Only the benzene was above the action limit. The down stream wells, 2 through 4, were not detectable.

We will continue to monitor these wells and will provide additional reports when the information becomes available.

We trust this provides the information you require at this time. If you have any questions, please call.

Yours very truly,

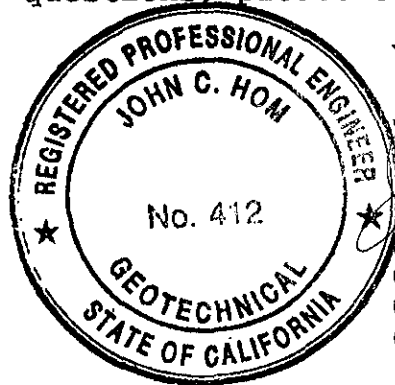

JOHN C HOM & ASSOCIATES, INC

*John C. Hom*  
John C Hom  
Civil Engineer - 28877  
Geotechnical Engineer - 412  
Certificates Expire 3/31/95

JCH\sz

3 copies submitted

**JCH**  
**JOHN C. HOM**  
& ASSOCIATES, INC.  
Geotechnical Consultants

ALAMEDA COUNTY  
HEALTH CARE SERVICES

AGENCY  
DAVID J. KEARS, Agency Director



DEPARTMENT OF ENVIRONMENTAL HEALTH  
Hazardous Materials Program  
80 Swan Way, Rm. 200  
Oakland, CA 94621  
(415)

Certified Mailer #P 367 604 367

April 26, 1991

Mr. Frederick Devine  
Frederick C. Devine Associates  
707 Mission Avenue  
San Carlos, CA 94901

RE: FORMER HERTLEIN ELECTRIC, TRACT 5100, 19051 LAKE CHABOT ROAD,  
CASTRO VALLEY

Dear Mr. Devine:

It has come to our attention that, as of this writing, you have not submitted the 1990 4th quarter monitoring report for the referenced site to this Department. The activities documented in the cited report are those occurring between October and December 1990, inclusive. These activities include monthly water level measurements, quarterly sample analyses (of 4 wells), and work associated with salvaging the "missing" well to the east. The report was due for submittal no later than February 1, 1991. Hence, this report is, as of this writing, 2 months and 26 days overdue.

You are directed to submit the noted 4th quarter 1990 report within 15 days of the date of this letter, or by May 11, 1991. The 1991 first quarter report (January - March) is due May 1, 1991.

Your attention is directed towards page 3, item 3, of the October 11, 1990 correspondence from this office which presents the appropriate schedule for report submittal.

Please be advised that this is a formal request for technical reports pursuant to California Water Code Section 13267 (b). Continued delays in the submittal of reports or initiating work may result in the referral of this case to the RWQCB for enforcement, possibly subjecting the responsible party to civil penalties to a maximum of \$1,000 per day. Any extensions of the stated deadlines, or modifications of the required tasks, must be confirmed in writing by either this agency or the RWQCB.

SS

**SENDER:** Complete Items 1 and 2 when additional services are desired, and complete items 3 and 4.  
 Put your address in 'RETURN TO' space on the reverse side. Failure to do this will prevent this card from being returned to you. The return receipt fee will provide you the name of the person delivered to and the date of delivery. For additional fees the following services are available. Consult postmaster for fees and check box(es) for additional service(s) requested.

1.  Show to whom delivered, date, and addressee's address. (Extra charge)      2.  Restricted Delivery. (Extra charge)

3. Article Addressed to: <b>Mr. Fred Devine Frederick C. Devine Assoc. 707 Mission Ave. San Carlos, CA 94901</b>	4. Article Number: <b>P 367 604 367</b>
	Type of Service: <input type="checkbox"/> Registered <input type="checkbox"/> Insured <input checked="" type="checkbox"/> Certified <input type="checkbox"/> COD <input type="checkbox"/> Express Mail <input type="checkbox"/> Return Receipt for Merchandise
Always obtain signature of addressee or agent and <b>DATE DELIVERED</b> .	
5. Signature -- Address <b>X</b>	8. Addressee's Address (ONLY if requested and fee paid)
6. Signature -- Agent <b>X [Signature]</b>	
7. Date of Delivery <b>5-2-91</b>	

PS Form 3811, Mar. 1988 \* U.S.G.P.O. 1988-212-865 DOMESTIC RETURN RECEIPT

P 367 604 367

RECEIPT FOR CERTIFIED MAIL

NO INSURANCE COVERAGE PROVIDED  
NOT FOR INTERNATIONAL MAIL

(See Reverse)

U.S.G.P.O. 1989-234-555

Sent to	<b>Mr. Fred Devine</b>
Street and No.	<b>FRED. DEVINE ASSOC. 707 MISSION AVE.</b>
P.O., State and ZIP Code	<b>SAN CARLOS, CA 94901</b>
Postage	\$
Certified Fee	
Special Delivery Fee	
Restricted Delivery Fee	
Return Receipt showing to whom and Date Delivered	
Return Receipt showing to whom, Date, and Address of Delivery	
TOTAL Postage and Fees	\$
Postmark or Date	

PS Form 3800, June 1985

Mr. Frederick Devine  
RE: 19051 Lake Chabot Road  
April 26, 1991  
Page 2 of 2

Please contact this Department at 415/271-4320 should you have any questions regarding the content of this letter.

Sincerely,

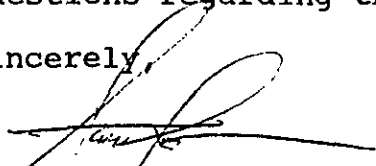

Scott O. Seery  
Hazardous Materials Specialist

cc: Rafat A. Shahid, Assistant Agency Director, Environmental Health  
Edgar Howell, Chief, Hazardous Materials Division  
Gil Jensen, Alameda County District Attorney's Office  
Howard Hatayama, DHS  
Lester Feldman, RWQCB  
Bob Bohman, Castro Valley Fire Department  
Jon Hom, Jon Hom and Associates  
Henry Hertlein  
files



HERTLEIN/DIVINE  
704 Mission Avenue San Rafael, CA 94901

90 DEC 10 PM 11:11

December 7, 1990

John Hom  
John Hom and Associates  
1618 Second Street  
San Rafael, Ca 94901

RE: Tracy 5100  
Castro Valley

Dear John:

Confirming our conversation: After extensive exploring with a backhoe, Henry was able to locate the missing monitoring well today. The locked cap is gone and the top is dinged up but the inner plastic cap is still on according to Henry. It is about 3' below the surface near the back of Lot 10. Apparently, the site contractor just filled right over it.

The exploration will be backfilled except right around the well. You have spoken to Scott Seery and the plan is to inspect the well and probably extend it to the new grade and backfill. When that work is complete, you will check water levels in all four wells and do a chemical analysis of this well. A month later you will check water levels again. At the quarterly point from the previous chemical testing, you will sample all four wells again even though the time period for this missing well will be shorter.

Very truly yours,

Fredric C. Divine  
Hertlein/Divine

cc: Scott Seery  
Henry Hertlein

FCD/cs

A R C H I T E C T S  
FREDRIC C. DIVINE ASSOCIATES

October 25, 1990

Scott Seery  
County of Alameda  
Department of Environmental Health  
80 Swan Way, Room 200  
Oakland, CA 94621

Re: Tract 5100

Dear Scott:

I am writing in response to your letter dated October 11. I will respond in general and I am including a letter and attachments from John Hom where his specific response was necessary. Following your item list:

1. These are in my copy of the report on plates 11 and 12. In the event that they were not in yours, John has included copies. He found one error that he has corrected in that the elevations were reversed.

2. The domestic well was removed by the site contractor in the spring of 1989 following county procedures. A copy of the permit was included in the report (see page J1). As we discussed, this well was gone before you and I ever met. It could not have been sampled as a part of the investigation. We have always said that Henry Hertlein took the samples for which you have lab data (see page 7 and appendix page K-1). He did this for his own verification that the well was clean and followed normal procedures outlined by John Hom for taking samples. The information is provided as additional downstream documentation on the site, but does not purport to be a sampling done by a registered laboratory or engineer. One of the investigative wells was in the area of contaminated soil discussed on page 9. The soil was removed and the well, necessarily, with it. This work occurred in late February 1989 (see appendix H). We are trying to verify the date the second investigative well was removed. You will note the only results from that well (appendix D, boring 9) indicate "not detected" for contaminants before the clean-up.

3. The report clearly presents detailed data on the wells and their construction. It does seem to miss the "developing" of the well and proper waiting period before sampling. John Hom's letter includes this data. I was actually on site when Pat Conway was going through this procedure.

4. John's letter includes the map requested.

5. The survey was done immediately after you requested it earlier this year by Ray Greenwood, the civil engineer for the project. The data was included on plates 5, 11, and 12.

6. All required samples were taken by NET following standard procedures. Apparently, John Hom should have requested them to report the QA/QC data, otherwise they don't. He includes it with his letter.

Finally, as to the additional tasks you require of us, I have left two messages for Steve Luquire, as you suggested, but have not received a call back. I have made clear to you that we apologize for John Hom's inability to produce a report in a timely fashion and then miss his own first 3 month schedule for sampling. We understand that this does not present us in the best light. However, in no discussion to this date has there been any mention of the need for monthly measuring and sampling. You had John's preliminary report and work plan in January and while requesting height to the hundredth of a foot you did not mention a problem with what we have always discussed - monitoring for a year at quarterly intervals. I find your request particularly disturbing as, to date, no evidence exists to indicate that the cleanup was not successful.

NET is scheduled for their next sampling on October 26. This will be 3 months from the last sampling and the third sampling of the investigation. I respectfully suggest that if this sampling continues the unbroken string of samplings within acceptable limits, the justification does not exist for the proposed program or it's extension to a year from now rather than approximately a year from the start. The purpose of the investigation is to verify that the clean-up was successful. To date all data suggests it was.

I am enclosing the requested check for \$755.80. Thank you for your continued patience and I look forward to hearing from you.

Very truly yours,

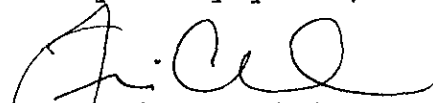

Fredric C. Divine  
Architect, AIA

Enclosures

cc: Henry Hertlein  
John Hom

FCD/cs

ALAMEDA COUNTY  
HEALTH CARE SERVICES

AGENCY

DAVID J. KEARS, Agency Director



Certified Mailer #P 062 128267

DEPARTMENT OF ENVIRONMENTAL HEALTH  
Hazardous Materials Program  
80 Swan Way, Rm. 200  
Oakland, CA 94621  
(415)

October 11, 1990

Mr. Frederick Divine  
Frederick C. Divine Associates  
707 Mission Avenue  
San Rafael, CA 94901

RE: REVIEW OF SEPTEMBER 19, 1990 PRELIMINARY SITE ASSESSMENT; FORMER  
HERTLEIN ELECTRIC PROPERTY, TRACT 5100, 19051 LAKE CHABOT ROAD,  
CASTRO VALLEY, ALAMEDA COUNTY

Dear Mr. Divine:

This Department is in receipt and has completed review of the September 19, 1990 Jon C. Hom & Associates, Inc. (JCH) preliminary site assessment (PSA) report entitled, "Report, Environmental Services, 19051 Lake Chabot Road, Castro Valley, California". This report documents work performed during the first half of 1990 at the referenced site.

The noted JCH report indicates that two (2) wells were installed on February 14, 1990; an additional well surviving from an earlier (1988?) investigation was reinstated as the last of three wells required for this phase of the investigation. Two (2) of the three wells installed during the previous investigation, and one domestic well, were apparently "removed" during grading associated with this development. Soil samples were collected from the two (2) borings advancement in February 1990 and analyzed for fuel hydrocarbon constituents. Water samples were collected February 22 and July 27, 1990 from all wells presently at the site, and analyzed for the same parameters as those selected for the soil samples.

During this Department's review, several areas requiring clarification or the submittal of supplemental information were identified, as follows:

- 1) Driller's logs associated with borings advanced during February 1990 are not provided. Only logs for borings completed August 26 and September 26, 1988 are included in this report;
- 2) Describe how and when the two investigative, and one domestic, wells were destroyed. Provide dates. As you may recall, the domestic well was to have been initially sampled during this phase of the investigation. (Note: The results of analyses performed upon a sample purported to be from this well are provided. The lab report is dated 09-05-88. No chain-of-custody document is provided.);

**SENDER:** Complete items 1 and 2 when additional services are desired, and complete items 3 and 4.

Put your address in **"RETURN TO"** space on the reverse side. Failure to do this will prevent this card from being returned to you. The return receipt fee will provide you the name of the person delivered to and the date of delivery. For additional fees the following services are available. Consult postmaster for fees and check box(es) for additional service(s) requested.

1.  Show to whom delivered, date, and addressee's address. (Extra charge)      2.  Restricted Delivery (Extra charge)

3. Article Addressed to:  
 Mr. Frederick Divine  
 Frederick C. Divine Associates  
 707 Mission Ave.  
 San Rafael, CA 94901

4. Article Number  
 P 062 128 267

Type of Service:  
 Registered       Insured  
 Certified       COD  
 Express Mail       Return Receipt for Merchandise

Always obtain signature of addressee or agent and **DATE DELIVERED.**

5. Signature - Address  
 X

6. Signature - Agent  
 X *ERIC K...* 05/15/88

7. Date of Delivery

8. Addressee's Address (ONLY if requested and fee paid)

PS Form 3811, Mar. 1988 \* U.S.G.P.O. 1988-212-865 DOMESTIC RETURN RECEIPT

P 062 128 267

**RECEIPT FOR CERTIFIED MAIL**  
 NO INSURANCE COVERAGE PROVIDED  
 NOT FOR INTERNATIONAL MAIL  
 (See Reverse)

Sent to	
Street and No	
P.O. State and ZIP Code	
Postage	S
Certified Fee	
Special Delivery Fee	
Restricted Delivery Fee	
Return Receipt showing to whom and Date Delivered	
Return Receipt showing to whom Date and Address of Delivery	
TOTAL Postage and Fees	S
Postmark or Date	

PS Form 3800, June 1985

Mr. Frederick Divine  
RE: 19051 Lake Chabot Road, Castro Valley  
October 11, 1990  
Page 2 of 3

- 3) Please indicate when the new wells, and preexisting well, were developed, the method employed, and how the adequacy of such development was gauged;
- 4) Provide groundwater gradient maps and calculations based upon depth-to-groundwater soundings collected during the February and July 1990 sampling events and the solution of three point problems. The data presented in the noted gradient maps must be based upon the initial well elevation survey to an established or designated datum, to the accuracy of 0.01 foot, and converted to elevations above mean sea level (MSL);
- 5) Discuss how, when, and by whom the wells were surveyed.
- 6) Quality control/quality assurance (QA/QC) samples appear (by their absence in the report) not to have been analyzed. All sampling events must include an adequate number of QA/QC samples, which may involve some combination of trip, field or sampler blanks, and spike samples. Laboratory reports must provide the results of the analyses of such samples. Please reference the State Water Resources Control Board LUFT Manual for specifics.

The noted information is to be submitted within 15 days, or by **October 27, 1990**. Without such information, the complete interpretation of the data presented in this and subsequent reports is difficult, as is the issuance of recommendations from this Department.

At this time, and in addition to requests made above for the submittal of information, the following tasks must also be performed following the protocol stated herein:

- 1) Water levels of each well must be measured and recorded monthly for the next year, **beginning October 1990**, and then quarterly thereafter. Such data is to be tabulated and presented on ground water gradient maps;
- 2) All wells are to be sampled monthly for the first quarter, **beginning October 1990**. The monthly sampling frequency may be reduced to quarterly after the first three months provided the concentrations of target compounds remain nondetectable (ND), or stabilize;

Mr. Frederick Divine  
RE: 19051 Lake Chabot Road, Castro Valley  
October 11, 1990  
Page 3 of 3

- 3) Summary reports are to be submitted quarterly to this Department and the RWQCB for the duration of this project, as designated by final "sign off" by the RWQCB. Such quarterly reports are to detail work performed during the reporting period, and are due the first day of the second month of each subsequent quarter (i.e., February 1, May 1, August 1, and November 1). **The next quarterly report is due February 1, 1991 and must document activities performed during the 4th quarter of 1990.**

Please be advised that this is a formal request for technical reports pursuant to California Water Code Section 13267(b). Failure to respond or a late response could result in the referral of this case to the RWQCB for enforcement, possibly subjecting the responsible party to civil penalties to a maximum of \$1,000 per day. Any extensions of stated deadlines, or the modifications of the required tasks, must be confirmed in writing by either this agency or the RWQCB.

Additionally, the account established to cover costs associated with the Department's oversight of this project is currently overdrawn, with a negative balance of \$255.80. Please remit a check payable to Alameda County totalling \$755.80 to cover this deficit and those costs incurred by this Department in the near future.

Should you have any questions regarding the content of this letter, please contact me at 415/271-4320.

Sincerely,

  
Scott O. Seery  
Hazardous Materials Specialist

cc: Rafat A. Shahid, Assistant Agency Director, Environmental Health  
Edgar Howell, Chief, Hazardous Materials Division  
Gil Jensen, Alameda County District Attorney's Office  
Howard Hatayama, DHS  
Lester Feldman, RWQCB  
Mike Hood, Alameda County Building and Inspection Department  
Leroy Todd, Alameda County Environmental Health, So. County  
Bob Bohman, Castro Valley Fire Department  
Jon Hom, JCH  
Henry Hertlein  
files

ALAMEDA COUNTY  
HEALTH CARE SERVICES

AGENCY

DAVID J. KEARS, Agency Director



Certified Mailer # P 062 128 279

DEPARTMENT OF ENVIRONMENTAL HEALTH  
Hazardous Materials Program  
80 Swan Way, Rm. 200  
Oakland, CA 94621  
(415)

September 28, 1990

Mr. Fredric Devine  
Fredric C. Devine Associates  
1214 Lincoln Avenue  
San Rafael, CA 94901

RE: FORMER HERTLEIN ELECTRIC PROPERTY, TRACT 5100, 19051 LAKE CHABOT  
ROAD, CASTRO VALLEY, ALAMEDA COUNTY

Dear Mr. Devine:

As we discussed August 3, 1990, this Department has yet to receive a copy of the Jon C. Hom and Associates, Inc. report documenting the installation of monitoring wells at the referenced site. This report would document the results of laboratory analyses performed upon soil samples collected during boring advancement, water samples collected from the wells once constructed and developed, and provide ground water table gradient maps, cross sections, and conclusions based upon professional judgement, among other elements. This Department has not communicated with Jon C. Hom Associates since June 29, 1990, at which time it was indicated that the referenced report would be submitted the following week.

You are directed to submit the noted well installation and sampling report, or reports, documenting all activities associated with this site investigation. This report(s) is due within 15 days, or by **October 14, 1990**. Your attention is directed to the San Francisco Bay Regional Water Quality Control Board (RWQCB) Staff Recommendations for the Initial Evaluation and Investigation of Underground Tanks, and State Water Resources Control Board Leaking Underground Fuel Tank (LUFT) Manual for specific requirements of such a report.

Please be advised that this is a formal request for technical reports pursuant to California Water Code Section 13267(b), and Section 2652(d), Subchapter 16 of Title 23, California Code of Regulations (CCR). Failure to respond to this request or a late response will result in the referral of this case to the RWQCB for enforcement action, possibly subjecting the responsible party to civil penalties to a maximum of \$1,000 per day of violation. Any extensions to stated deadlines, or modifications of required tasks, must be confirmed in writing by either this agency or the RWQCB.



**SENDER:** Complete items 1 and 2 when additional services are desired, and complete items 3 and 4. Put your address in "RETURN TO" Space on the reverse side. Failure to do this will prevent this card from being returned to you. The return receipt fee will provide you the name of the person delivered to and the date of delivery. For additional fees the following services are available. Consult postmaster for fees and check boxes for additional service(s) requested.

1.  Show to whom delivered, date, and addressee's address. (Extra charge) 2.  Restricted Delivery. (Extra charge)

3. Article Addressed to:  
Mr. Frederick Divine  
Frederick C. Divine Assoc.  
707 Mission Ave.  
San Rafael, CA 94901

4. Article Number  
P 062 128 266

Type of Service:  
 Registered  Insured  
 Certified  COD  
 Express Mail  Return Receipt for Merchandise

Always obtain signature of addressee or agent and DATE DELIVERED.

5. Signature -- Addressee  
X *Frederick Divine*

6. Signature -- Agent  
X

7. Date of Delivery  
9/16/90

8. Addressee's Address (ONLY if requested and prepaid)

MISSION RAFAEL STA

PS Form 3811, Mar. 1988 \* U.S.G.P.O. 1988-212-865 DOMESTIC RETURN RECEIPT

P 062 128 279

RECEIPT FOR CERTIFIED MAIL

NO INSURANCE COVERAGE PROVIDED  
NOT FOR INTERNATIONAL MAIL

(See Reverse)

PS Form 3800, June 1985

Sent to	
Street and No	
P.O. State and ZIP Code	
Postage	\$
Certified Fee	
Special Delivery Fee	
Restricted Delivery Fee	
Return Receipt showing to whom and Date Delivered	
Return Receipt showing to whom Date and Address of Delivery	
TOTAL: Postage and Fees	\$
Postmark or Date	

Mr. Fredric Devine  
RE: 19051 Lake Chabot Road, Tract 5100  
September 28, 1990  
Page 2 of 2

Should you have any questions regarding the content of this letter,  
you may call me at 415/271-4320.

Sincerely,

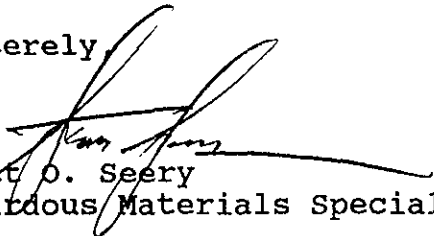

Scott O. Seery  
Hazardous Materials Specialist

cc: Rafat A. Shahid, Assistant Agency Director, Environmental Health  
Edgar Howell, Chief, Hazardous Materials Division  
Gil Jensen, Alameda County District Attorney's Office  
Howard Hatayama, DHS  
Lester Feldman, RWQCB  
Mike Hood, Alameda County Building and Inspection Department  
Leroy Todd, Alameda County Environmental Health, So. County  
Bob Bohman, Castro Valley Fire Department  
Jon Hom, Jon C. Hom and Associates, Inc.  
Henry Hertlein  
files

ALAMEDA COUNTY  
HEALTH CARE SERVICES

AGENCY  
DAVID J. KEARS, Agency Director



DEPARTMENT OF ENVIRONMENTAL HEALTH  
Hazardous Materials Program  
80 Swan Way, Rm. 200  
Oakland, CA 94621  
(415)

January 31 1990

Mr. John C. Hom  
John C. Hom & Associates, Inc.  
1618 Second Street  
San Rafael, CA 94901

RE: GROUNDWATER INVESTIGATION WORKPLAN PROPOSAL; 19051  
LAKE CHABOT ROAD, CASTRO VALLEY

Dear Mr. Hom:

We are in receipt and have completed review of the January 18, 1990 addendum to the John C. Hom & Associates, Inc. proposal dated October 27, 1989 for the investigation of subsurface contamination at the referenced site. We have accepted this work plan proposal with the following conditions:

- 1) Please submit well construction diagrams and well logs with your report following the completion of this phase of work;
- 2) Well slot interval placement must adequately accommodate seasonal groundwater fluctuations;
- 3) Disposal of auger cuttings and development water must be based upon the results of chemical analysis;
- 4) Wells must be surveyed to the accuracy of 0.01 foot to an established benchmark;
- 5) Groundwater depth should be measured using an electronic sounder or paste tape. Wells should be checked for the presence of free product and sheen (using an interface probe and/or paste tape) prior to both development and sampling;
- 6) The report must include groundwater gradient determinations based upon the solution of three-point problems;

Mr. John C. Hom  
RE: 19051 Lake Chabot Road  
January 31, 1990  
Page 2 of 2

- 7) Groundwater sampling must occur a minimum of 24-hours after well development. It is strongly recommended that a period of 72-hours pass between development and sampling, however, so that any low-density, immiscible organics present can stabilize, facilitating the identification of any floating product;
- 8) Wells must be installed under an appropriate Zone 7 permit. Please provide a copy of this permit with your report;
- 9) The on-site domestic well should be initially sampled during this first sampling episode, and tested for the same constituents for which the one existing and two new wells will be analyzed;
- 10) Trip or field blanks should be incorporated as part of a QA/QC program for each water sampling episode. These "blanks" should be analyzed for the same constituents as those collected from the on-site wells, and the results provided within your report.

Please contact this office when appropriate permits have been issued and work is scheduled to begin. We will expect a report to be submitted within 30-days of the completion of the field activities at this site.

As a reminder, copies of all proposals and reports are also to be submitted to the RWQCB to the attention of Lester Feldman. Should you have any questions, please call me at 415/271-4320.

Sincerely,

  
Scott O. Seery  
Hazardous Material Specialist

SOS:tln

cc: Rafat A Shahid, Assistant Agency Director, Alameda County  
Department of Environmental Health  
Gil Jensen, Alameda County District Attorney,  
Consumer and Environmental Protection Division  
Howard Hatayama, DHS  
Lester Feldman, RWQCB  
Mike Hood, Alameda County Building and Inspection Dept.  
Leroy Todd, Alameda County Environmental Health  
Department, South County  
Bob Bohman, Castro Valley Fire Dept.  
Fred Devine, Frederick C. Devine Associates  
Henry Hertlein  
Files

**FRÉDRIC C. DIVINE ASSOCIATES**

Architects  
704 Mission Avenue  
SAN RAFAEL, CALIFORNIA 94901

(415) 457-0220

**LETTER OF TRANSMITTAL**

TO

SCOTT SEERY  
E.O. HEATH  
80 SWAN WAY RM 200  
Oakland, Ca. 94621

DATE	7/31/89	JOB NO.	
ATTENTION			8/11/89
RE	TRACT 5100 CASTRO VALLEY		

WE ARE SENDING YOU  Attached  Under separate cover via \_\_\_\_\_ the following items:

- Shop drawings      Prints      Plans      Samples      Specifications  
 Copy of letter      Change order      \_\_\_\_\_

COPIES	DATE	NO.	DESCRIPTION
1	7/10/89		scope of work & diagram for monitoring 3 sheets

THESE ARE TRANSMITTED as checked below:

- For approval      Approved as submitted      Resubmit \_\_\_\_\_ copies for approval  
 For your use      Approved as noted      Submit \_\_\_\_\_ copies for distribution  
 As requested      Returned for corrections      Return \_\_\_\_\_ corrected prints  
 For review and comment      \_\_\_\_\_  
 FOR BIDS DUE \_\_\_\_\_ 19 \_\_\_\_\_  PRINTS RETURNED AFTER LOAN TO US

REMARKS Scott -  
 please review and approve or comment before we begin monitoring

COPY TO \_\_\_\_\_

SIGNED: Very truly yours  

JCH

**JOHN C. HOM & ASSOCIATES, INC.**

1618 Second Street  
San Rafael, CA 94901  
(415) 258-9027

July 10, 1989

Job Number 128.12

Henry Hertlein  
2215 National Avenue  
P. O. Box 3548  
Hayward, CA 94540-3548

Dear Mr Hertlein:

Proposal  
Geotechnical Investigation  
Monitoring Wells  
19051 Lake Chabot Road  
Castro Valley, California

This presents our proposal to install monitoring wells at the subject property. Installation of the monitoring wells is the result of our meeting with the County of Alameda, Water Quality Board, and the Architect. We previously installed and monitored three wells. One of the wells is still in place, MW-3. The approximate locations are shown on the attached plate.

**SCOPE**

We propose to explore the subsurface conditions and install monitoring wells at two new locations, as shown on the attached plate. The test holes and wells will be about 20-feet deep. Drilling will be accomplished with flight auger equipment. The samplers drilling equipment would be steam-cleaned before, during, and after the drilling process. Our Field Engineer would locate the test borings; inspect the operations; log the conditions encountered; and, obtain bulk and undisturbed core samples for visual examination, classification and laboratory testing. Selected samples would be laboratory tested to determine their chemical content, including hydrocarbons, benzene, toluene, xylene, and ethelbenzene. We would monitor the two new and one existing wells for a period of at least one year. During the monitoring process, water samples would be taken to test for the above chemicals. We would analyze the results of the field and laboratory work, and present our findings and recommendations in a written report including the following information:

Lake Chabot Road, continued  
10, 1989 - Job Number 128.12  
by Hertlein  
e 2

1. A description of the soil, rock, and ground water conditions observed.
2. A description of the well installation.
3. A description of site history and use.
4. Results of monitoring and the chemical testing.
5. Recommendations for soil and water clean-up, if appropriate.

~~Determination of contamination limits.~~

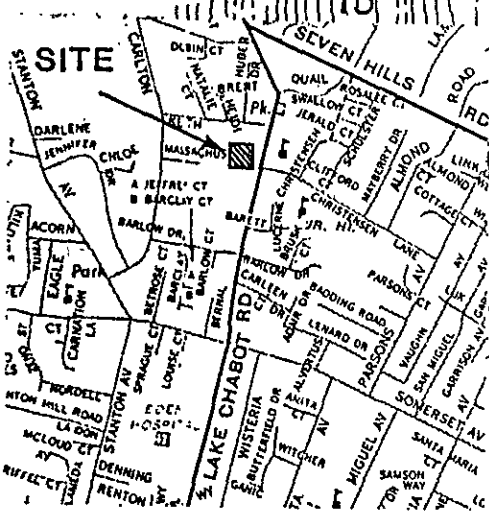
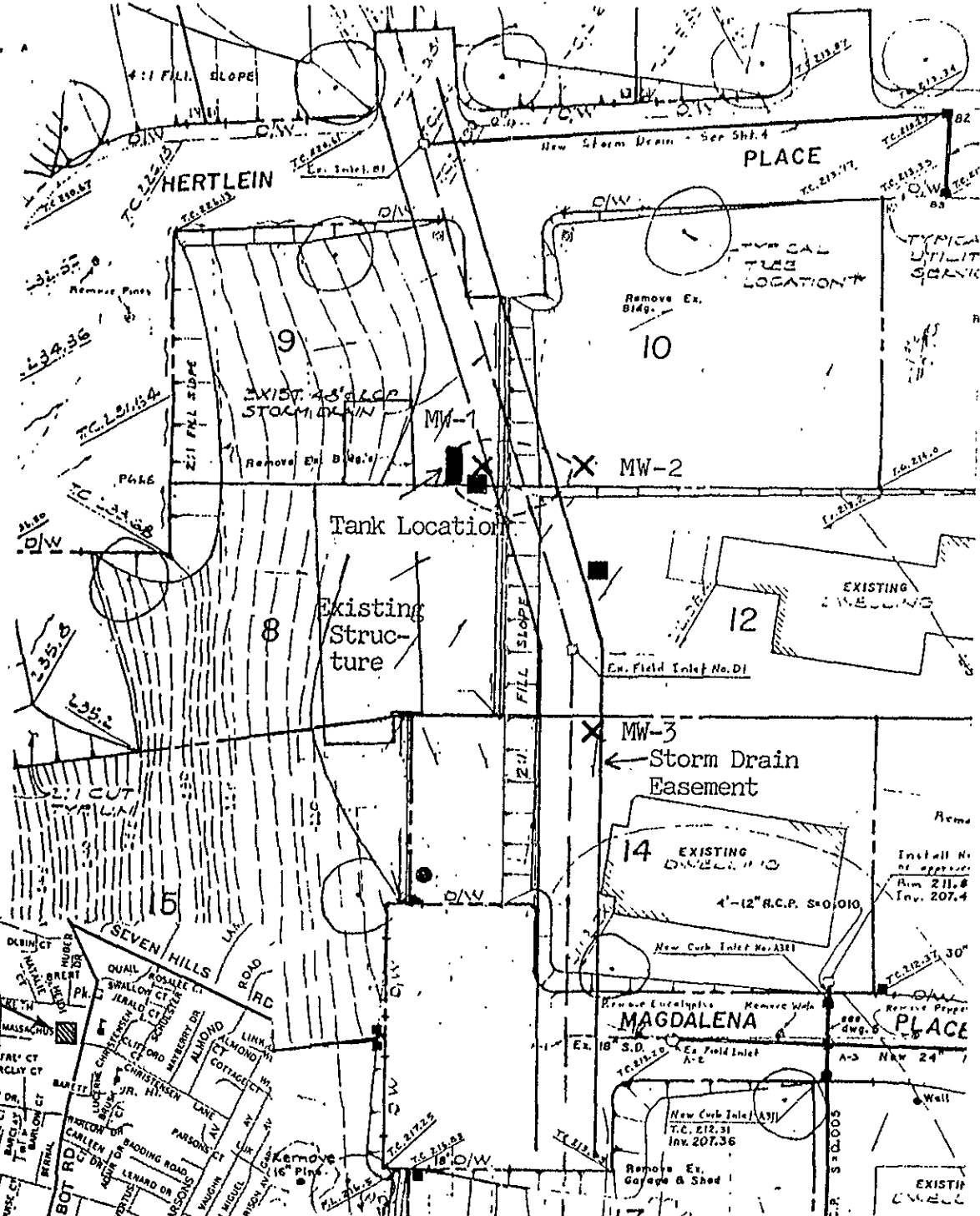

**EXPLANATION**

Scale 1"=40'

- Approximate Limits of Soil and Groundwater Contamination
- New Well Location
- █ Former Tank Location
- ✕ Monitoring Well, Test Boring
- Domestic Well

**VICINITY MAP**

**JCH**  
**JOHN C. HOM**  
 & ASSOCIATES, INC.  
 Geotechnical Consultants

Job No:  
 128.12  
 Appr:  
*JCH*  
 Date: 12/88

Test Boring and Monitoring Well  
 Location Plan  
 19051 Lake Chabot Road  
 Castro Valley, California

PLATE  
**1**



ALAMEDA COUNTY  
HEALTH CARE SERVICES

AGENCY  
DAVID J. KEARS, Agency Director



DEPARTMENT OF ENVIRONMENTAL HEALTH  
Hazardous Materials Program  
80 Swan Way, Rm. 200  
Oakland, CA 94621  
(415)

November 7, 1989

Mr. John C. Hom  
John C. Hom & Associates, Inc.  
1618 Second Street  
San Rafael, CA 94901

RE: GROUNDWATER INVESTIGATION WORKPLAN PROPOSAL, 19051 LAKE CHABOT  
ROAD, CASTRO VALLEY

Dear Mr. Hom:

This letter is in response to our review of the October 27, 1989 John C. Hom & Associates, Inc. workplan proposal for the investigation of subsurface contamination at the referenced site. The noted workplan may be approved for this stage of site contaminant assessment provided the following issues are adequately resolved:

- 1) Construction and placement of wells must adhere to the requirements of the "Regional Board Staff Recommendations for Initial Evaluation and Investigation of Underground Tanks." Therefore, proposals which address the installation of groundwater monitoring wells must include all requested information and follow the format outlined in the attached Appendix A, Workplan for Initial Subsurface Investigation, drafted by the RWQCB. Consequently, you must supplement your current proposal with those elements detailed in Sections IV through V, inclusive;
- 2) The site map, a component of Section IV(B) of Appendix A, should reflect current conditions on-site, including the locations of streets, lots, structures and utilities, as well as the proposed locations of all new wells;
- 3) Provide plans for monitoring the domestic well located on the property as well as for those to be installed or which are preexisting;

Mr. John C. Hom  
RE: 19501 Lake Chabot Rd.  
Castro Valley  
November 7, 1989  
Page 2 of 2

- 4) The Site Safety Plan, a requirement of Section V of Appendix A, must address the conditions specified under Part 1910.120(i)(2)(i), 29 CFR (attached);
- 5) Please specify the test methods proposed for the quantification of contaminants in samples collected during boring advancement and groundwater monitoring. These methods must be those accepted by the State Hazardous Waste Testing Laboratory Certification Program, and performed by laboratories approved for their use.

Please submit a timely response which adequately addresses the previous list of items. This submittal may be in the form of an addendum to the October 27 proposal. Additionally, please submit copies of all reports, proposals and addenda to the RWQCB (Attn: Lester Feldman), including the October 27 proposal.

Should you have any questions, please contact the undersigned at (415) 271-4320.

Sincerely,

  
Scott O. Seery  
Hazardous Materials Specialist

SOS:mam

Enclosures(3)

cc: Rafat A. Shahid, Assistant Agency Director, Department of Environmental Health  
Fred Devine, Frederick C. Devine Associates (w/ enclosures)  
Henry Hertlein  
Gil Jensen, Alameda County District Attorney, Consumer and Environmental Protection Division  
Howard Hatayama, DHS  
Lester Feldman, RWQCB  
Mike Hood, Alameda County Building and Inspection Department  
Leroy Todd, Alameda County Environmental Health Department, South County  
Bob Bohman, Castro Valley Fire Department  
Files

DEC 28 1988

# UNDERGROUND STORAGE TANK UNAUTHORIZED RELEASE (LEAK) CONTAMINATION SITE REPORT

EMERGENCY <input type="checkbox"/> YES <input checked="" type="checkbox"/> NO	HAS STATE OFFICE OF EMERGENCY SERVICES REPORT BEEN FILED? <input type="checkbox"/> YES <input checked="" type="checkbox"/> NO	<b>FOR LOCAL AGENCY USE ONLY</b> I HEREBY CERTIFY THAT I AM A DESIGNATED GOVERNMENT EMPLOYEE AND THAT I HAVE REPORTED THIS INFORMATION TO LOCAL OFFICIALS PURSUANT TO SECTION 26180.7 OF THE HEALTH AND SAFETY CODE.	
REPORT DATE 1_M 2_M 1_D 4_D 8_Y 8_Y	CASE #	SIGNED	DATE

REPORTED BY	NAME OF INDIVIDUAL FILING REPORT Patrick J. Conway	PHONE (415) 258-9027	SIGNATURE <i>Patrick J. Conway</i>
	REPRESENTING <input type="checkbox"/> LOCAL AGENCY <input checked="" type="checkbox"/> OWNER/OPERATOR <input type="checkbox"/> REGIONAL BOARD <input type="checkbox"/> OTHER	COMPANY OR AGENCY NAME John C. Hom and Associates	
	ADDRESS 1618 Second Street San Rafael California 95401		

RESPONSIBLE PARTY	NAME Henry Hertlein	CONTACT PERSON	PHONE (415) 537-9986
	ADDRESS 19051 Lake Chabot Road Castro Valley California 94546		

SITE LOCATION	FACILITY NAME (IF APPLICABLE)	OPERATOR Henry Hertlein	PHONE (415) 537-9986
	ADDRESS 19051 Lake Chabot Road Castro Valley California 94546		
	CROSS STREET Keith Avenue	TYPE OF AREA <input checked="" type="checkbox"/> RESIDENTIAL <input type="checkbox"/> COMMERCIAL <input type="checkbox"/> INDUSTRIAL <input type="checkbox"/> RURAL <input type="checkbox"/> OTHER	TYPE OF BUSINESS <input type="checkbox"/> FARM <input checked="" type="checkbox"/> OTHER Commercial

IMPLEMENTING AGENCIES	LOCAL AGENCY Alameda County Hazardous Materials	CONTACT PERSON Larry Seto	PHONE (415) 271-4320
	REGIONAL BOARD San Francisco Bay Regional Water Quality	Lisa McCann	PHONE (415) 464-1287

SUBSTANCES INVOLVED	(1) NAME Leaded Gasoline	QUANTITY LOST (GALLONS) DEC 28 1988	<input checked="" type="checkbox"/> UNKNOWN
	(2)		<input type="checkbox"/> UNKNOWN

DISCOVERY/ABATEMENT	DATE DISCOVERED 6_Y 5_Y	HOW DISCOVERED <input checked="" type="checkbox"/> INVENTORY CONTROL <input type="checkbox"/> SUBSURFACE MONITORING <input type="checkbox"/> NUISANCE CONDITIONS
	DATE DISCHARGE BEGAN 6_Y 4_Y	METHOD USED TO STOP DISCHARGE (CHECK ALL THAT APPLY) <input checked="" type="checkbox"/> REPLACE TANK <input type="checkbox"/> CLOSE TANK
	HAS DISCHARGE BEEN STOPPED? <input checked="" type="checkbox"/> YES <input type="checkbox"/> NO IF YES, DATE 6_Y 5_Y	<input type="checkbox"/> TANK TEST <input type="checkbox"/> TANK REMOVAL <input type="checkbox"/> OTHER Removed tank in 1986

SOURCE/CAUSE	SOURCE OF DISCHARGE <input checked="" type="checkbox"/> TANK LEAK <input type="checkbox"/> PIPING LEAK <input type="checkbox"/> OTHER	TANKS ONLY/CAPACITY 550 GAL.	MATERIAL <input checked="" type="checkbox"/> STEEL <input type="checkbox"/> FIBERGLASS <input type="checkbox"/> OTHER	CAUSE(S) <input type="checkbox"/> OVERFILL <input type="checkbox"/> RUPTURE/FAILURE <input type="checkbox"/> CORROSION <input type="checkbox"/> UNKNOWN <input checked="" type="checkbox"/> SPILL <input checked="" type="checkbox"/> OTHER Damaged
		AGE _____ YRS		

CASE TYPE	CHECK ONE ONLY <input type="checkbox"/> UNDETERMINED <input type="checkbox"/> SOIL ONLY <input checked="" type="checkbox"/> GROUNDWATER <input type="checkbox"/> DRINKING WATER - (CHECK ONLY IF WATER WELLS HAVE ACTUALLY BEEN AFFECTED)
-----------	--

CURRENT STATUS	CHECK ONE ONLY <input type="checkbox"/> SITE INVESTIGATION IN PROGRESS (DEFINING EXTENT OF PROBLEM) <input type="checkbox"/> CLEANUP IN PROGRESS <input type="checkbox"/> SIGNED OFF (CLEANUP COMPLETED OR UNNECESSARY) <input type="checkbox"/> NO ACTION TAKEN <input type="checkbox"/> POST CLEANUP MONITORING IN PROGRESS <input type="checkbox"/> NO FUNDS AVAILABLE TO PROCEED <input checked="" type="checkbox"/> EVALUATING CLEANUP ALTERNATIVES
----------------	---

REMEDIAL ACTION	CHECK APPROPRIATE ACTION(S) (SEE BACK FOR DETAILS) <input type="checkbox"/> CAP SITE (CD) <input type="checkbox"/> EXCAVATE & DISPOSE (ED) <input type="checkbox"/> REMOVE FREE PRODUCT (FP) <input type="checkbox"/> ENHANCED BIO DEGRADATION (IT) <input type="checkbox"/> CONTAINMENT BARRIER (CB) <input checked="" type="checkbox"/> EXCAVATE & TREAT (ET) <input checked="" type="checkbox"/> PUMP & TREAT GROUNDWATER (GT) <input type="checkbox"/> REPLACE SUPPLY (RS) <input type="checkbox"/> TREATMENT AT HOOKUP (HU) <input type="checkbox"/> NO ACTION REQUIRED (NA) <input type="checkbox"/> OTHER (OT)
-----------------	--

COMMENTS	
----------	--



SECTION C  
HAZARDOUS SUBSTANCES

C1. Please check if any of the following categories of hazardous substances is used or handled by your firm:

TOXIC	<input type="checkbox"/>	CORROSIVE	<input type="checkbox"/>
FLAMMABLE OR IGNITABLE	<input checked="" type="checkbox"/>	REACTIVE	<input type="checkbox"/>

C2. Please check the attached list for any of the chemical substances you receive, store, mix, treat, formulate, generate, manufacture, transport or dispose of, and enter each by the number identified on the list in the spaces below:

Sample:

11311	1811131								

CERTIFICATION

I hereby certify that the information on this form is to the best of my knowledge, true and complete

James Millen  
Signature  
Shop Manager  
Title

James Millen  
Typed or Printed Name  
7/10/87  
Date

Please return completed form to:

Alameda County Division of Environmental Health  
470-27th Street, Room 322  
Oakland, CA 94612  
(415) 874-7237

ALAMEDA COUNTY  
HEALTH CARE SERVICES



DAVID KEARS  
AGENCY  
Agency Director

GENERATOR

470-27th Street, Third Floor  
Oakland, California 94612  
(415)

SITE ID 1508  
NAME Hertlein Electric Inc.  
ADDRESS 19101 Lake Chabot Rd.

DATE 7-10-87  
PHONE 538-3458  
EPA ID  
CITY/ZIP Castro Valley, 94546

The marked items represent violations of the Calif. Administrative Code:  
General

- |                   |                                     |                             |       |                                    |
|-------------------|-------------------------------------|-----------------------------|-------|------------------------------------|
| 1.                | <input type="checkbox"/>            | Waste ID                    | 66471 | Comments: Waste solvent and sludge |
| 2.                | <input type="checkbox"/>            | EPA ID's                    | 66472 |                                    |
| 3.                | <input type="checkbox"/>            | >90 day Stor                | 66508 | disposal receipts must be kept     |
| 4.                | <input type="checkbox"/>            | Labels                      | 66504 | on the premises for three years.   |
| 5.                | <input type="checkbox"/>            | Biennial RPT                | 66493 |                                    |
| 6.                | <input checked="" type="checkbox"/> | Records                     | 66492 | Waste oil on the ground near       |
| Manifest          |                                     |                             |       |                                    |
| 7.                | <input type="checkbox"/>            | Correct                     | 66480 | the storm should be picked-up      |
| 8.                | <input type="checkbox"/>            | Copies sent                 | 66484 | and disposed of by a licensed      |
| 9.                | <input type="checkbox"/>            | Except RPT                  | 66484 | hazardous waste hauler.            |
| 10.               | <input type="checkbox"/>            | Copies Rec                  | 66492 |                                    |
| Misc              |                                     |                             |       |                                    |
| 11.               | <input type="checkbox"/>            | Treatment                   | 66371 |                                    |
| 12.               | <input type="checkbox"/>            | On-site Disp<br>H&S 25189.5 |       |                                    |
| 13.               | <input type="checkbox"/>            | ExHazWaste                  | 66570 |                                    |
| Prevention        |                                     |                             |       |                                    |
| 14.               | <input type="checkbox"/>            | Communica                   | 67121 |                                    |
| 15.               | <input type="checkbox"/>            | Aisle space                 | 67124 |                                    |
| 16.               | <input type="checkbox"/>            | Local Emer                  | 67126 |                                    |
| 17.               | <input type="checkbox"/>            | Maintenance                 | 67120 |                                    |
| 18.               | <input type="checkbox"/>            | Training                    | 67105 |                                    |
| Contingency       |                                     |                             |       |                                    |
| 19.               | <input type="checkbox"/>            | Prepared                    | 67140 |                                    |
| 20.               | <input type="checkbox"/>            | Name List                   | 67141 |                                    |
| 21.               | <input type="checkbox"/>            | Copies                      | 67141 |                                    |
| 22.               | <input type="checkbox"/>            | EmerCoorTng                 | 67144 |                                    |
| Containers, Tanks |                                     |                             |       |                                    |
| 23.               | <input type="checkbox"/>            | Condition                   | 67241 |                                    |
| 24.               | <input type="checkbox"/>            | Compatibility               | 67242 |                                    |
| 25.               | <input type="checkbox"/>            | Maintenance                 | 67243 |                                    |
| 26.               | <input type="checkbox"/>            | Inspection                  | 67244 |                                    |
| 27.               | <input type="checkbox"/>            | Buffer zone                 | 67246 |                                    |
| 28.               | <input type="checkbox"/>            | Tank Insp                   | 67259 |                                    |
| 29.               | <input type="checkbox"/>            | Closure                     | 67260 |                                    |
| 30.               | <input type="checkbox"/>            | Safe Store                  | 67261 |                                    |
| 31.               | <input type="checkbox"/>            | Freeboard                   | 67257 |                                    |
| 32.               | <input type="checkbox"/>            | Other                       |       |                                    |

CONTACT PERSON James Miller  
TITLE Shop Manager  
SIGN \_\_\_\_\_

INSPECTOR Lawrence Seto  
SIGN Lawrence Seto

## APPLICATION FOR PERMIT TO OPERATE UNDERGROUND STORAGE TANK

( ) 01 NEW PERMIT ( ) 05 RENEWED PERMIT ( ) 07 TANK CLOSED ( ) 09 DELETE FROM FILE (NO FEE)  
 ( ) 02 CONDITIONAL PERMIT ( ) 06 AMENDED PERMIT ( ) 08 MINOR CHANGE (NO SURCHARGE)

## I OWNER

NAME (CORPORATION, INDIVIDUAL OR PUBLIC AGENCY) HENRY R HERTLEIN		PUBLIC AGENCY ONLY ( ) 01 FED ( ) 02 STATE ( ) 03 LOCAL	
STREET ADDRESS 19051 LAKE CHABOT RD	CITY CASTRO VALLEY	STATE CA	ZIP 94546

## II FACILITY

FACILITY NAME HERLEIN ELECTRIC INC		DEALER/FOREMAN/SUPERVISOR	
STREET ADDRESS 19101 LAKE CHABOT RD		NEAREST CROSS STREET	
CITY CASTRO VALLEY		COUNTY ALAMEDA	ZIP 94546
MAILING ADDRESS P.O. BOX 2437		CITY CASTRO VALLEY	STATE CA ZIP 94546
PHONE W/AREA CODE 415-538-3456	TYPE OF BUSINESS ( ) 01 GASOLINE STATION (X) 02 OTHER ELECTRICAL CONTRACTOR		
NUMBER OF CONTAINERS 1	RURAL AREAS ONLY :	TOWNSHIP	RANGE SECTION

## III 24 HOUR EMERGENCY CONTACT PERSON

DAYS: NAME (LAST NAME FIRST) AND PHONE W/AREA CODE HENRY HERLEIN 415-538-3456	NIGHTS: NAME (LAST NAME FIRST) AND PHONE W/AREA CODE HENRY HERTLEIN 415-537-9986
--	---

COMPLETE THE FOLLOWING ON A SEPARATE FORM FOR EACH CONTAINER

## IV DESCRIPTION

A. (X) 01 TANK ( ) 04 OTHER:		CONTAINER NUMBER 1
B. MANUFACTURER (IF APPROPRIATE):	YEAR MFG:	C. YEAR INSTALLED (X) UNKNOWN
D. CONTAINER CAPACITY: 500 GALLONS ( ) UNKNOWN	E. DOES THE CONTAINER STORE: ( ) 01 WASTE (X) 02 PRODUCT	
F. DOES THE CONTAINER STORE MOTOR VEHICLE FUEL OR WASTE OIL ? (X) 01 YES ( ) 02 NO IF YES CHECK APPROPRIATE BOX(ES): (X) 01 UNLEADED ( ) 02 REGULAR ( ) 03 PREMIUM ( ) 04 DIESEL ( ) 05 WASTE OIL ( ) 06 OTHER		

## V CONTAINER CONSTRUCTION

A. THICKNESS OF PRIMARY CONTAINMENT: ( ) GAUGE ( ) INCHES ( ) CM (X) UNKNOWN
B. ( ) 01 VAULTED (LOCATED IN AN UNDERGROUND VAULT) (X) 02 NON-VAULTED ( ) 03 UNKNOWN
C. ( ) 01 DOUBLE WALLED (X) 02 SINGLE WALLED ( ) 03 LINED
D. (X) 01 CARBON STEEL ( ) 02 STAINLESS STEEL ( ) 03 FIBERGLASS ( ) 04 POLYVINYL CHLORIDE ( ) 05 CONCRETE ( ) 06 ALUMINUM ( ) 07 STEEL CLAD ( ) 08 BRONZE ( ) 09 COMPOSITE ( ) 10 NON-METALLIC ( ) 12 UNKNOWN ( ) 13 OTHER:

**CONTAINER CONSTRUCTION**

E.  01 RUBBER LINED  02 ALKYD LINING  03 EPOXY LINING  04 PHENOLIC LINING  05 GLASS LINING  
 07 UNLINED  08 UNKNOWN  09 OTHER:

F.  01 POLYETHYLENE WRAP  02 VINYL WRAPPING  03 CATHODIC PROTECTION  04 UNKNOWN  05 NONE  
 06 TAR OR ASPHALT  09 OTHER:

**VI PIPING**

A. ABOVEGROUND PIPING:  01 DOUBLE-WALLED PIPE  02 CONCRETE-LINED TRENCH  03 GRAVITY  
 (CHECK APPROPRIATE BOX(ES))  04 PRESSURE  05 SUCTION  06 UNKNOWN  07 NONE

B. UNDERGROUND PIPING:  01 DOUBLE-WALLED PIPE  02 CONCRETE-LINED TRENCH  03 GRAVITY  
 (CHECK APPROPRIATE BOX(ES))  04 PRESSURE  05 SUCTION  06 UNKNOWN  07 NONE

**VII LEAK DETECTION**

01 VISUAL  02 STOCK INVENTORY  04 VAPOR SNIFF WELLS  05 SENSOR INSTRUMENT  
 06 GROUND WATER MONITORING WELLS  07 PRESSURE TEST  09 NONE  10 OTHER:

**VIII CHEMICAL COMPOSITION OF MATERIALS STORED IN UNDERGROUND CONTAINERS**

IF YOU CHECKED YES TO IV-F YOU ARE NOT REQUIRED TO COMPLETE THIS SECTION

CURRENTLY STORED	PREVIOUSLY STORED	DELETE	CASH (IF KNOWN)	CHEMICAL (DO NOT USE COMMERCIAL NAME)
<input type="checkbox"/> 01	<input type="checkbox"/> 02	<input type="checkbox"/> 03		
<input type="checkbox"/> 01	<input type="checkbox"/> 02	<input type="checkbox"/> 03		
<input type="checkbox"/> 01	<input type="checkbox"/> 02	<input type="checkbox"/> 03		
<input type="checkbox"/> 01	<input type="checkbox"/> 02	<input type="checkbox"/> 03		
<input type="checkbox"/> 01	<input type="checkbox"/> 02	<input type="checkbox"/> 03		
<input type="checkbox"/> 01	<input type="checkbox"/> 02	<input type="checkbox"/> 03		
<input type="checkbox"/> 01	<input type="checkbox"/> 02	<input type="checkbox"/> 03		
<input type="checkbox"/> 01	<input type="checkbox"/> 02	<input type="checkbox"/> 03		
<input type="checkbox"/> 01	<input type="checkbox"/> 02	<input type="checkbox"/> 03		
<input type="checkbox"/> 01	<input type="checkbox"/> 02	<input type="checkbox"/> 03		

\* CHECK STATE BOARD CHEMICAL CODE LISTING FOR POSSIBLE SYNONYMS

IS CONTAINER LOCATED ON AN AGRICULTURAL FARM?  01 YES  02 NO

THIS FORM HAS BEEN COMPLETED UNDER THE PENALTY OF PERJURY AND, TO THE BEST OF MY KNOWLEDGE, IS TRUE AND CORRECT.

PERSON FILING (SIGNATURE) \_\_\_\_\_ PHONE W/AREA CODE \_\_\_\_\_

**FOR LOCAL AGENCY USE ONLY**

ADMINISTRATING AGENCY		CITY CODE		COUNTY CODE
CONTACT PERSON			PHONE W/AREA CODE	
DATE OF LAST INSPECTION	IN COMPLIANCE <input type="checkbox"/> 01 YES <input type="checkbox"/> 02 NO	PERMIT APPROVAL DATE	TRANSACTION DATE	LOCAL PERMIT ID #