

LOWNEYASSOCIATES

Environmental / Geotechnical / Engineering Services

405 Clyde Avenue, Mountain View, California 94043
PHONE (415) 967-2365 FAX (415) 967-2785

Fax Memorandum

-
- **To:** Mr. Scott Seery
 - **From:** Lowney Associates
Brock Foster
 - **Re:** Site safety plan
S&S Building Supply
701 Fremont Ave.
San Leandro
 - **Date:** October 24, 1994
 - **Job #:** 1063-1
 - **Fax No.** 510-337-9335
 - **Total Pages:** 5
-

Subject:

Dear Mr. Seery,

As you requested, here is our site safety plan for the above referenced site. We are scheduled to begin drilling on Thursday, October 27, 1994. If you have any questions, please call.

THANKS.

No Mail Copy to Follow.

Time Sent _____

Please notify us immediately if you have received this fax in error, Sender's Initials _____

LOWNEY ASSOCIATES SITE CHARACTERIZATION FORM FOR SITE SAFETY PLAN (SSP) DEVELOPMENT

Requested By Alameda County Health Care Services
 Date Requested 10/24/94 Date Needed 10/27/94
 District Name Zone 7 Water Agency Project Number 1063-1
 Job Duration 1 day Job Date 10/27/94
 New SSP (YES) NO Revision of SSP YES - NO

Site Description:

Site Name S & S Building Supply
 Site Location SAN LEANDRO, CA
 Client Contact LOWNEY ASSOCIATES - BLOCK FOSTER
 Phone Number 415-967-2365

TOPOGRAPHY OF AREA SURROUNDING SITE: (circle any that apply)

Hilly Flat Hummock Marshy

AFFECTED AREA:

Urban Rural Residential Industrial Commercial Other _____

BODIES OF WATER SURROUNDING SITE:

Stream River Pond Lake Bay Ocean None Other _____

PROPERTIES ABUTTING THE SITE:

North Commercial / Industrial
 South _____
 East _____
 West _____

Has this matter been reported to the safety coordinator or principal? Yes

Enclose a copy of the site location map and site map. On the site map, indicate the location of telephone, utilities, chemical storage area, and access/egress routes. On the site location map, indicate the location and route to the nearest medical facility.

Background:

History and nature of problem(s):
Formerly on-site 2 two 1,000 gal. gasoline USTs & dispenser island.
REMOVED IN 1989
LABORATORY ANALYSIS of soil samples collected beneath
the northern & southern ends of Tank B detected
TPH as gasoline AT 2,300 ppm & 2,600 ppm, respectively.
Beneath Tank A TPH as gasoline & BTEX compounds
were below laboratory detection limits.

(use reverse if more space s necessary)

Project Work Plan:

Are services being provided as a consequence of orders from or involvement by local, state, or federal health or environmental agencies?

Yes	No
X	

Project Objectives

Soil & Ground Water Quality Reconnaissance

Work Task: (give timetables for each task)

- (X) Drilling/Soil Boring DAY - 1
- () Excavation/Trenching _____
- (X) Monitoring Well Installation DAY - 1
- () Recovery Well Installation _____
- () Well Gauging 2
- (X) Well Development 48 hr after installation
- (X) Ground Water Sampling 48 hr after development
- (X) Soil Sampling Day - 1
- () Remediation System Installation (specify) _____
- () Other(s) (specify) _____

Safety-engineering controls incorporated into the design of remediation system(s)

Emergency Notifications:

- Local Police: 911 or If N/A (510) 638-2123
- State Police: 911 or If N/A (510) 286-1363
- Fire: 911 or If N/A (510) 638-2121
- Ambulance: 911 or If N/A 1-800-533-8100

Medical:

- Nearest Hospital: (510) Humana Hospital
- Telephone Number: 357-6500
- Directions to: Fremont Ave to Forest Blvd. Turn left (East) to Washington Ave turn left (North) to Dan Leandro (right) to E. 14th (right 1/2 mile)
- Back-up Hospital: Fairmont Hospital (510)-667-7800
- Directions to: Washington Ave (South) to 238 (East) to 280 (North) 1/2 mile after Manchester overpass on the right
- Poison Control Center: _____

Agency:

- Environmental Emergency: Waste Alert Hotline 1-800-698-6942
- Regional EPA Office: Toxic Substances Control Region 2 540-2122

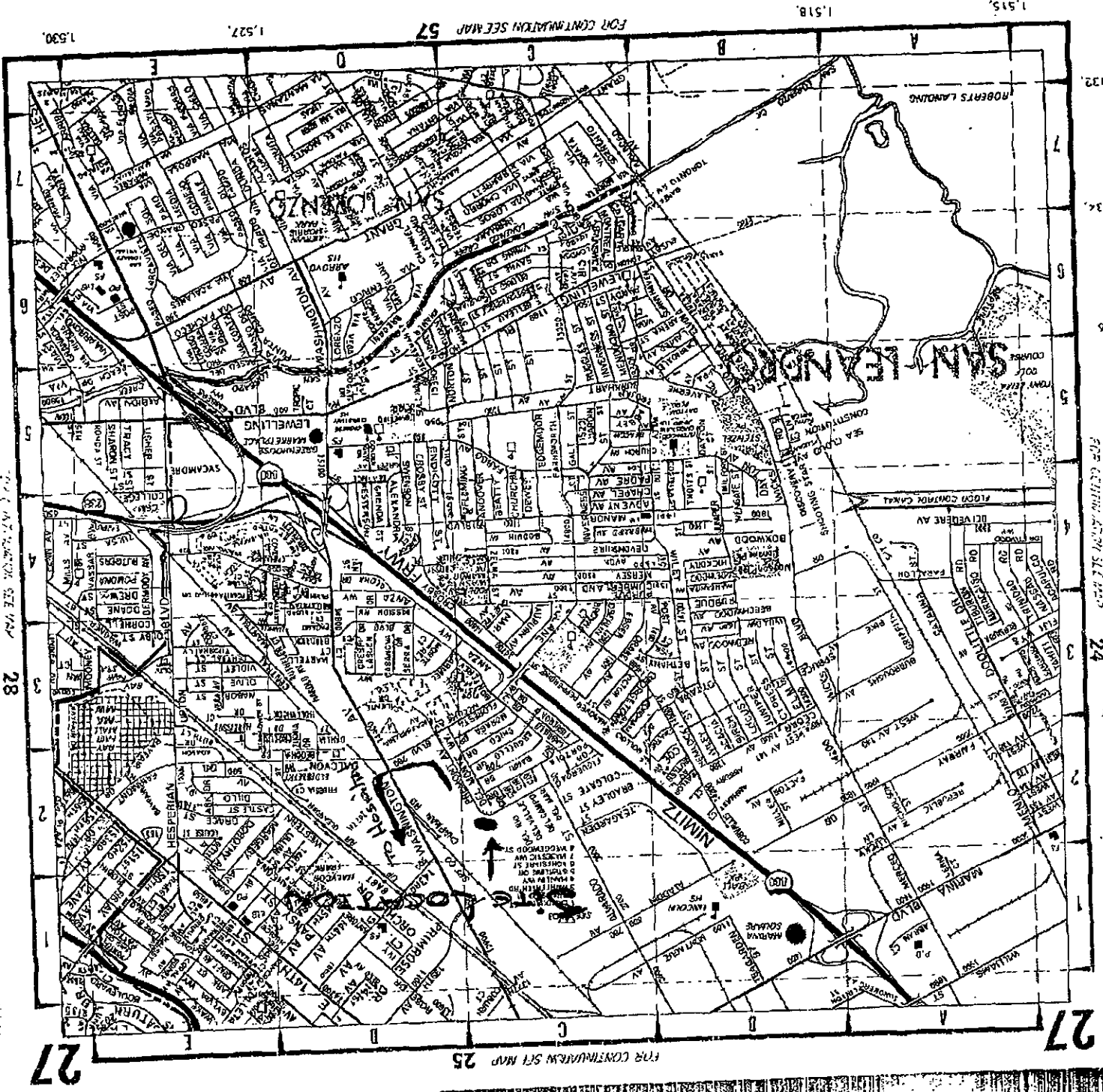
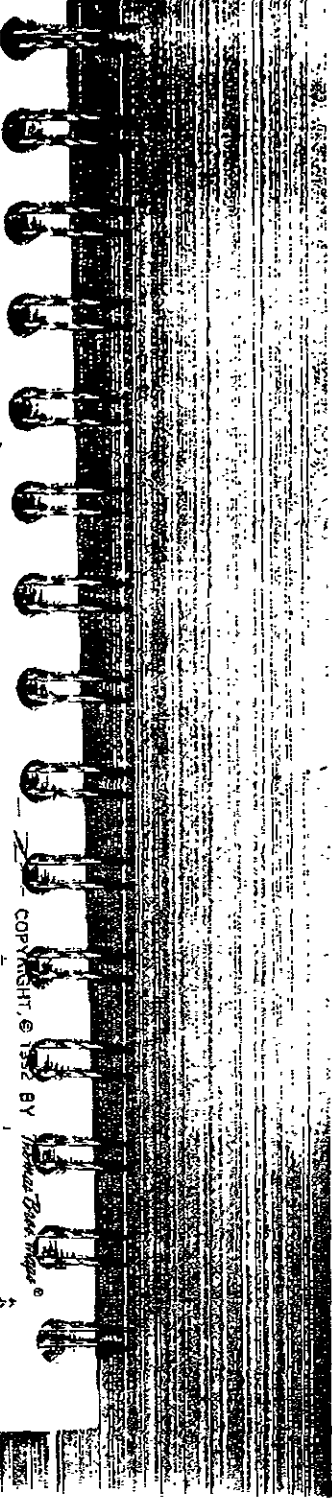

1.515

1.518

FOR CONTINUATION SEE MAP 57

1.527

1.530

FOR CONTINUATION SEE MAP 24

COPYRIGHT © 1992 BY *McGraw-Hill*

DETAIL

FOR CONTINUATION SEE MAP 28

ALAMEDA CO.

FOR CONTINUATION SEE MAP 25

27

27

15103379335 P.05
TO
FROM LOWNEY ASSOCIATES
17:05
OCT-24-1994



Approximate Direction
of Ground Water Flow

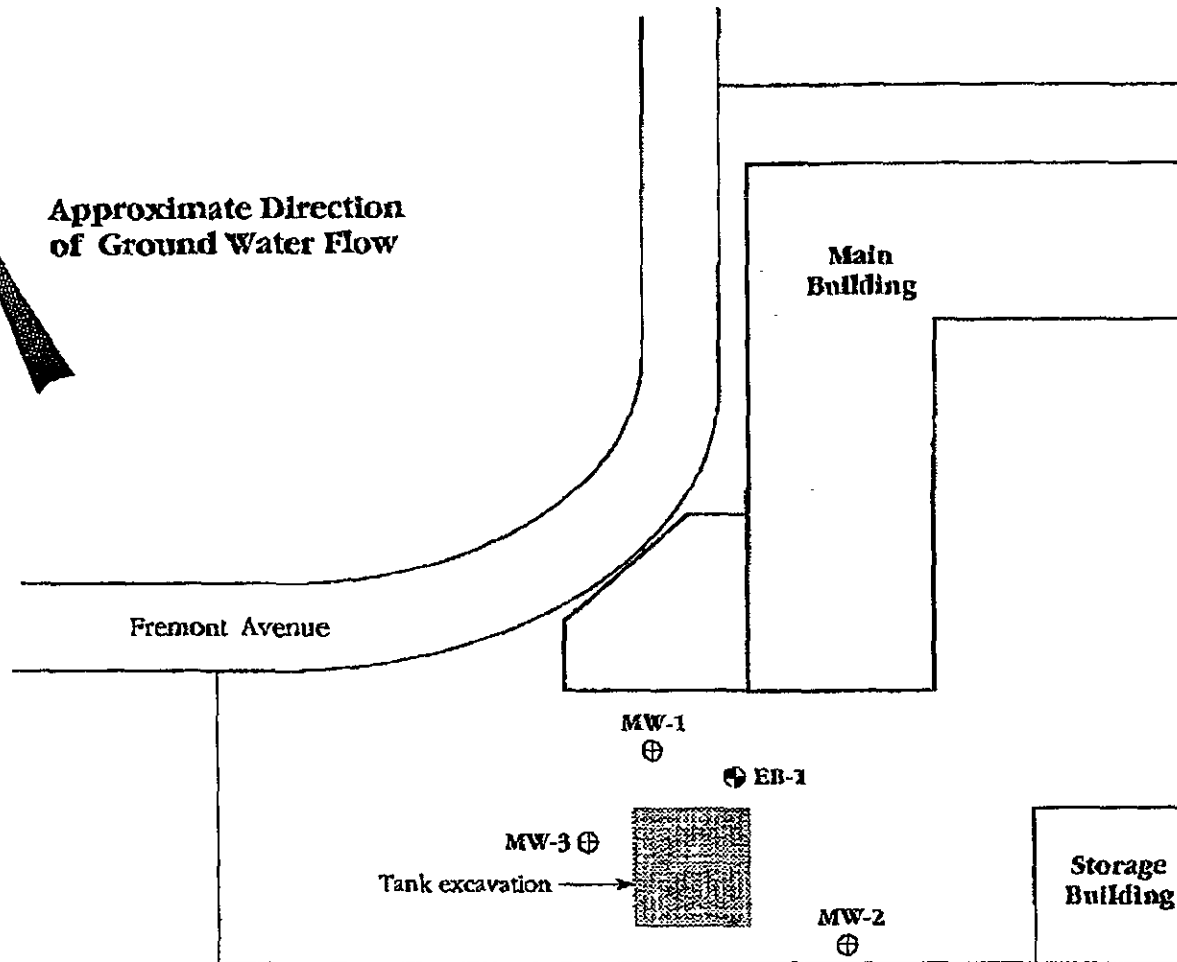

LEGEND

- ⊙ - Proposed exploratory boring location
- ⊕ - Proposed monitoring well location

Base by Aerial Photograph.

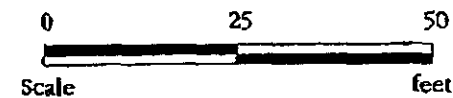

1063-1, 107 BB'EB

SITE PLAN

S & S BUILDING SUPPLY
San Leandro, California

LOWNEY ASSOCIATES
Environmental/Geotechnical/Engineering Services

FIGURE 1
1063-1, October 1994

Site Specific Exposures

Chemicals known or suspected to be on site.

CHEMICAL NAME	AIR (ppm)	SOIL (ppm)	GROUND-H ₂ O (ppm)
Gasoline x		7,600	
Benzene x		—	
Toluene x		—	
Xylene x		—	
TPH-Diesel			

Site Specific Exposures

Chemicals known or suspected to be on site.

NON-CHEMICAL HAZARDS: (circle any that apply)

- | | | |
|-------------------------------|-------------------------------|-------------------|
| Confined space | High crime area | Poisonous insects |
| <u>Drill rig</u> | Slip/fall hazards welding | Poisonous animals |
| Noise | Heat/cold stress | Dangerous animals |
| Traffic | Excavation > 5 ft. | Ticks |
| <u>Under ground utilities</u> | Trench > 4ft. | _____ |
| Overhead lines | Leaking containers electrical | |
| Backhoe | Hot surface | |
| Other construction equipment | Low light conditions | |
| _____ | Lifting hazards | |
| _____ | _____ | |

If confined space entry was checked above, of what type is the confined space?

Shed Manhole Basement Trench Excavated pit Subsurface vault Other _____

Chemicals utilized (if any) to perform on-site tasks: (include chemicals used to maintain equipment)

Project Organizational Structure

Project Team: (one person may carry out more than one job function)

Project Manager: STASAN FOSTER

Site Safety Officer: STASAN FOSTER

Field Team Leader: BRACK FOSTER

Emergency Notifications:

Soil cuttings and purged ground water silt be stored in EPA-approved 55-gallon drums, and kept on-site pending analytical results. Drums will be stored in an appropriate (out of the way) area or as desired by client. Drums will be labeled as to boring number, contents, date generated, and company name. The drum storage area will be designated by yellow barrier tape. Soil and ground water will be disposed at an appropriate disposal facility, if necessary (to be determined by analytical results and current regulations) and approved by client.

Soil samples collected in brass liners are used for borehole logging, and submitted to California DHS approved analytical laboratories for testing. Most soil samples submitted for laboratory analysis are properly disposed of by the lab. However, some labs send the remaining sample, following analysis, back to us for disposal. In addition, some soil samples are stored at our office for possible future analysis by an analytical laboratory. Soil samples kept at our office are temporarily stored in a refrigerator in our lab area. Samples that are no longer needed and known to contain non-detectable contaminant levels are disposed of in the trash. Samples that are no longer needed and known or suspected to contain detectable levels are grouped as follows: petroleum hydrocarbons, solvents, pesticides, and metals. These samples are temporarily stored in EPA approved 55-gallon drums located in a fenced off and locked area in our parking lot (away from the road). These samples will be disposed at an appropriate facility.

Personal Protective Equipment:

Hard hat, steel toed boots, eye protection and gloves. All Lowney Associates personnel have had the 40 hour OSHA class in Hazardous Waste Operations/Emergency Response.

Environmental Monitoring Equipment:

Organic Vapor Meter or FID.

Site Control Procedures:

All unnecessary persons will be kept at least 25 feet away from work area. The work area will be denoted with barricades or cones and barrier tape.

Decontamination Procedures:

Wash with soap and water.