

RUST ENVIRONMENT & INFRASTRUCTURE

RUST Environment & Infrastructure Inc.
 12 Metro Park Road
 Albany, NY 12205
 Tel. (518) 458-1313 • FAX (518) 458-2472

November 18, 1994

Joseph S. Moran, Esq.
 Assistant General Counsel - Environmental
 American National Can Company - 14C
 8770 West Bryn Mawr Avenue
 Chicago, IL 60631-3542

Post-It® Fax Note	7671	Date	# of pages ▶ 6
To	Barney Chan	From	Ed aluson
Co./Dept.		Co.	
Phone #		Phone #	
Fax #		Fax #	

Dear Mr. Moran:

Subject: Summary of Soil Remediation Activities - Building 12
 Former ANC Facility, Oakland, California

As a follow-up to our subsurface investigation of suspected soil contamination in the area of former Building #12 (summarized in a letter to you dated October 25, 1994), RUST Environment and Infrastructure, Inc. (RUST) directed HSR, Inc. to excavate potentially impacted soil underlying the northeast corner of that building. This letter provides you with a summary of those excavation activities and the results of post excavation samples that were collected.

Attached Figure 1 is the Extent of Impacted Soil Map copied from our October 25 letter. As shown on attached Figure 2, the limits of the excavation were nearly equal to that projected. Approximately 150 cubic yards of soil was excavated and stockpiled on polyethylene sheeting alongside soils excavated from Area 4, but in a separate stockpile.

RUST collected five (5) post excavation samples in a manner consistent with the approved Remedial Work Plan for Areas 2 and 4 to confirm that impacted soil had been removed to the maximum extent feasible. The samples were collected at intervals of 20 feet along the excavation walls (4 samples) and one sample was sufficient to test the floor of the excavation. The samples were analyzed for mineral spirits and for total petroleum hydrocarbons as gasoline (TPHg) by California LUFT methods. Samples were not tested for benzene, toluene, ethylbenzene, or xylenes as these specific compounds previously have been shown to be present in the groundwater flowing into this area from the Ekotek Lube property. Through volatilization off the floating product on the water table, detection of these compounds in Building #12 soil could as much reflect impacts from Ekotek Lube sources as they would the suspected Building #12 source (mineral spirits).

Mineral spirits were detected in post-excavation sample B12-2 at a concentration of 8.8 ppm, in sample B12-3 at a concentration of 0.8 ppm, and were not detected in the other three samples. TPHg was not detected in any of the five samples. These data demonstrate that the excavation activities were sufficient to effectively remediate the impacted soil to the maximum extent feasible.

What depths were B12-1 through B12-5 taken?



Joseph S. Moran, Esq.
November 18, 1994
Page 2

We feel that the building 12 excavation can now be backfilled, in accordance with the specifications outlined in the approved Areas 2 and 4 Remedial Work Plan. We would like to initiate backfilling activities as soon as possible, preferably on Monday, November 21, 1994, and therefore would appreciate a verbal approval by all parties involved as soon as possible so that we may proceed. Please contact me with any questions.

Very truly yours,



Edward W. Alusow
Senior Project Manager

Enclosures

cc: J. Peters, ANC
E. Rawlings, ANC
J. Kessler, HSA
R. Creps, PES
J. Renauer, KMART
R. Arulananthum, SFBRWQCB
B. Chan, ACDEH
S. Krival, DTSC



MW-7

2.91

FORMER BUILDING 12

1700

S-2 (4.0)

T-2 (2.0)

S-3 (4.0)

T-3 (5.0)

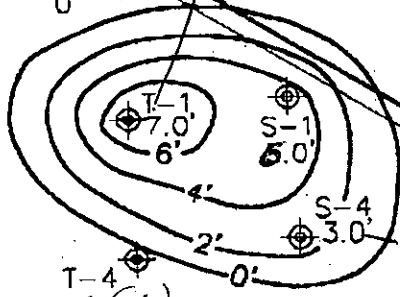

T-4 (5.0)

S-5 (5.0)

9.7

MW-1

LEGEND



SOIL BORING



BASE OF IMPACTED SOIL IN FEET BELOW GRADE

MW-7

EXISTING MONITORING WELL



DECOMMISSIONED WELL

SCALE IN FEET

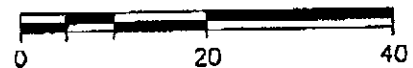

RUST ENVIRONMENT & INFRASTRUCTURE

EXTENT OF POTENTIAL SOIL CONTAMINATION

AMERICAN NATIONAL CAN COMPANY
FORMER OAKLAND CALIFORNIA PLANT

PROJECT NO. 35195.630

DATE 10/94

DWG. NO. 35195-0B

SCALE 1"=20'

FIGURE NO. 1

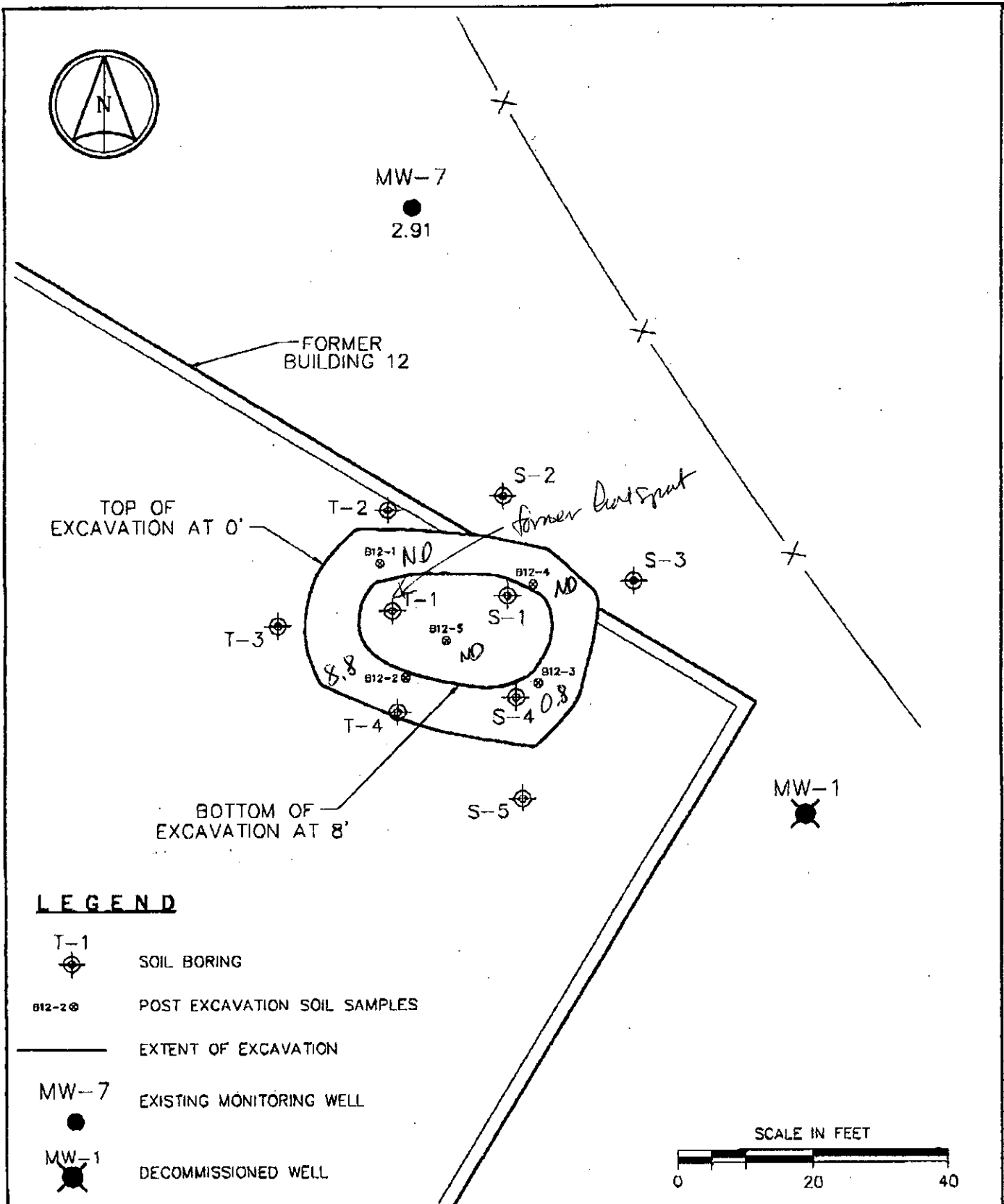

LEGEND



SOIL BORING



POST EXCAVATION SOIL SAMPLES

EXTENT OF EXCAVATION

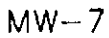

EXISTING MONITORING WELL



DECOMMISSIONED WELL

SCALE IN FEET

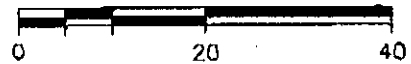

RUST ENVIRONMENT & INFRASTRUCTURE

EXTENT OF EXCAVATION AND LOCATION OF POST EXCAVATION SAMPLES
AMERICAN NATIONAL CAN COMPANY
FORMER OAKLAND CALIFORNIA PLANT

PROJECT NO. 35195.630

DATE 11/94

DWG. NO. 35195-09

SCALE 1"=20'

FIGURE NO. 2

**ANALYSIS DATA SHEET - TOTAL PETROLEUM HYDROCARBONS
(GASOLINE WITH BTEX)
ANAMETRIX, INC. - (408) 432-8192**

Anametrix W.O.: 9411151
Matrix : SOIL
Date Sampled : 11/11/94

Project Number : 35195.624
Date Released : 11/16/94

Reporting Limit	Sample I.D.# B12-1	Sample I.D.# B12-2	Sample I.D.# B12-3	Sample I.D.# B12-4	Sample I.D.# B12-5
COMPOUNDS (mg/Kg)	-01	-02	-03	-04	-05
Mineral Spirits	0.5	ND	8.8	0.8	ND
TPH as Gasoline	0.5	ND	ND	ND	ND
% Surrogate Recovery	113%	123%	113%	111%	118%
Instrument I.D.	HP21	HP21	HP21	HP21	HP21
Date Analyzed	11/14/94	11/15/94	11/15/94	11/15/94	11/15/94
RLMF	1	2.5	1	1	1

ND - Not detected at or above the practical quantitation limit for the method.
TPH_g - Total Petroleum Hydrocarbons as gasoline and mineral spirits determined by GC/FID using modified EPA Method 8015 following sample purge and trap by EPA Method 5030.
RLMF - Reporting Limit Multiplication Factor.

Anametrix control limits for surrogate p-Bromofluorobenzene recovery are 53-147%.

All testing procedures follow California Department of Health Services (Cal-DHS) approved methods.

Reggie Dawson 11/17/94
Analyst Date

Supervisor Date

ANALYSIS DATA SHEET - TOTAL PETROLEUM HYDROCARBONS
 (GASOLINE WITH BTEX)
 ANAMETRIX, INC. - (408) 432-8192

Anamatrix W.O.: 9411151
 Matrix : SOIL
 Date Sampled : 11/11/94

Project Number : 35195.624
 Date Released : 11/16/94

Reporting Limit	Sample I.D.#	Sample I.D.#
	BN1404E1	BN1405E1
COMPOUNDS (mg/Kg)	BLANK	BLANK
Mineral Spirits	ND	ND
TPH as Gasoline	ND	ND
% Surrogate Recovery	120%	116%
Instrument I.D.	HP21	HP21
Date Analyzed	11/14/94	11/15/94
RLMF	1	1

- ND - Not detected at or above the practical quantitation limit for the method.
- TPHg - Total Petroleum Hydrocarbons as gasoline and mineral spirits determined by GCFID using modified EPA Method 8015 following sample purge and trap by EPA Method 5030.
- RLMF - Reporting Limit Multiplication Factor.

Anamatrix control limits for surrogate p-Bromofluorobenzene recovery are 53-147%.

All testing procedures follow California Department of Health Services (Cal-DHS) approved methods.

Reggie Dawson 11/17/94
 Analyst Date

 Supervisor Date