

Figure 2. Monitoring Well Locations - Shell Service Station WIC #204-4380-0303, 318 South Livermore Avenue, Livermore, California

-
- Bacteria utilized for bioremediation might “get loose” and cause serious environmental and health problems

“The Monster Bug Syndrome”

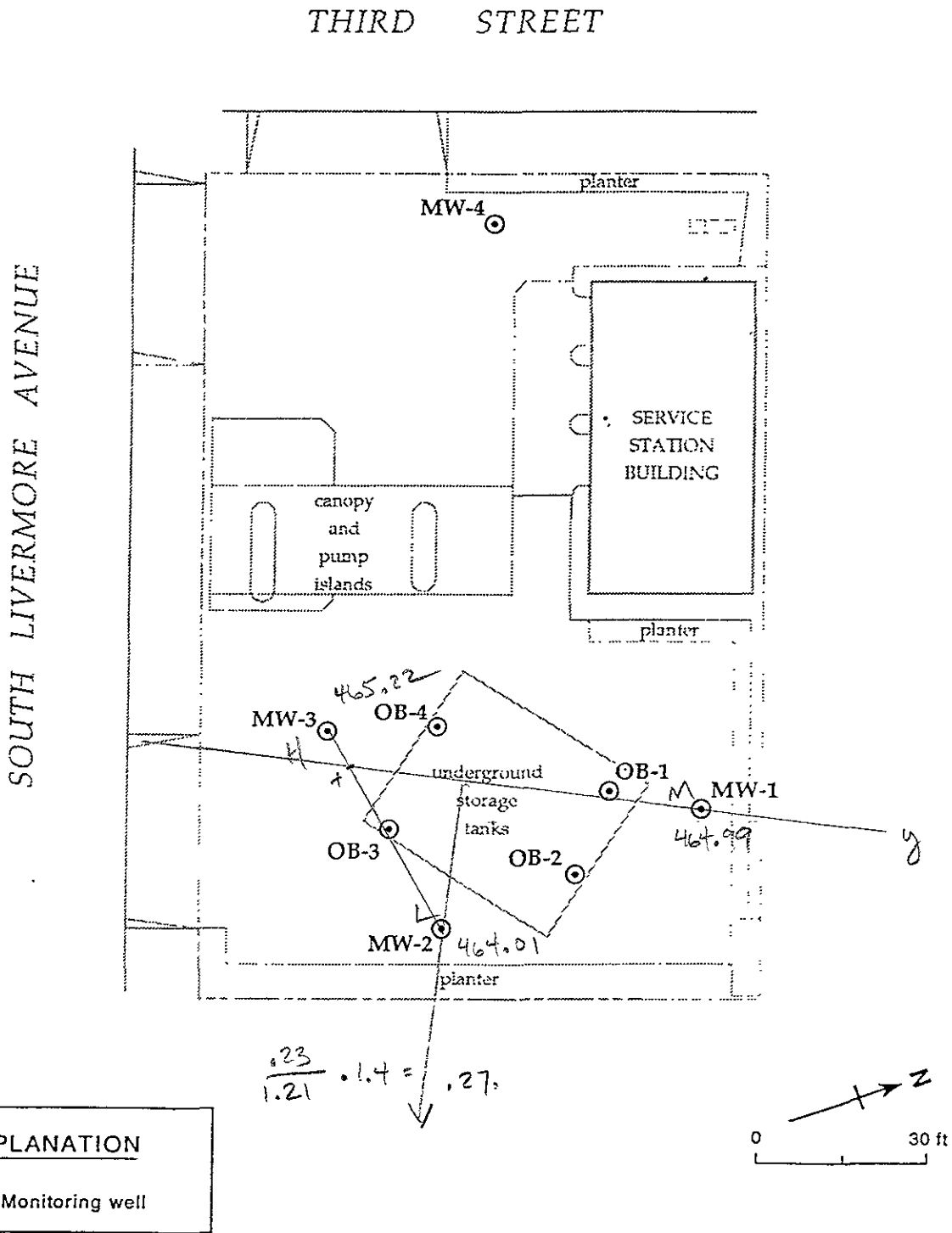

Figure 2. Monitoring Well Locations - Shell Service Station WIC #204-4380-0303, 318 South Livermore Avenue, Livermore, California

EMERGENCY VAN PERSONNEL SCHEDULE CHANGE

Alameda County Health Department
Hazardous Materials Division
80 Swan Way
Oakland, CA 94621

<u>SCHEDULED PERIOD</u>	<u>PERSON ORIGINALLY ASSIGNED</u>	<u>PERSON NOW ASSIGNED</u>

Person Originally Assigned (Signature): _____

Person Now Assigned (Signature): _____

Date: _____

Submit this form to the Supervising Hazardous Materials Specialist
5 days prior to the schedule change.

THIRD STREET

SOUTH LIVERMORE AVENUE

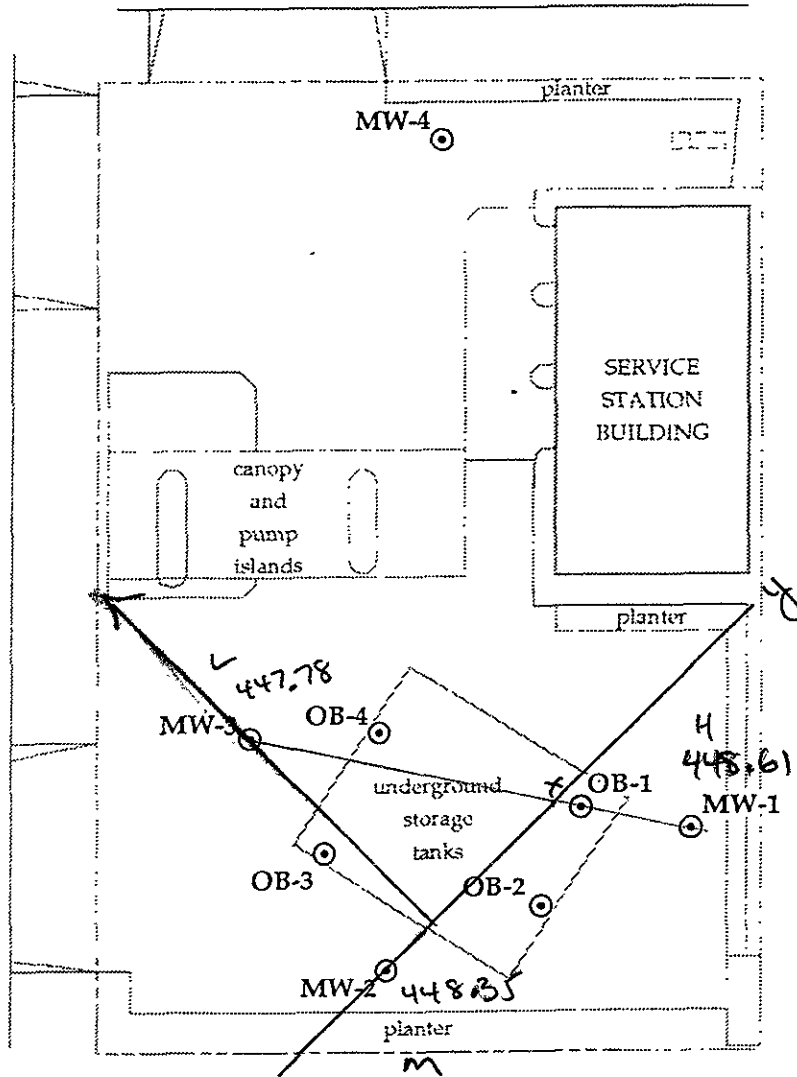

EXPLANATION

⊙ MW-1 Monitoring well

Jan 25, 1993

Figure 2. Monitoring Well Locations - Shell Service Station WIC #204-4380-0303, 318 South Livermore Avenue, Livermore, California

Microorganism Growth

Temperature Groups

- Mesophiles: Growth range = 18° - 45° C
- Thermophiles: Growth range = 45° - 85° C
- Psychrophiles: Growth range = 4° - 18° C

THIRD STREET

SOUTH LIVERMORE AVENUE

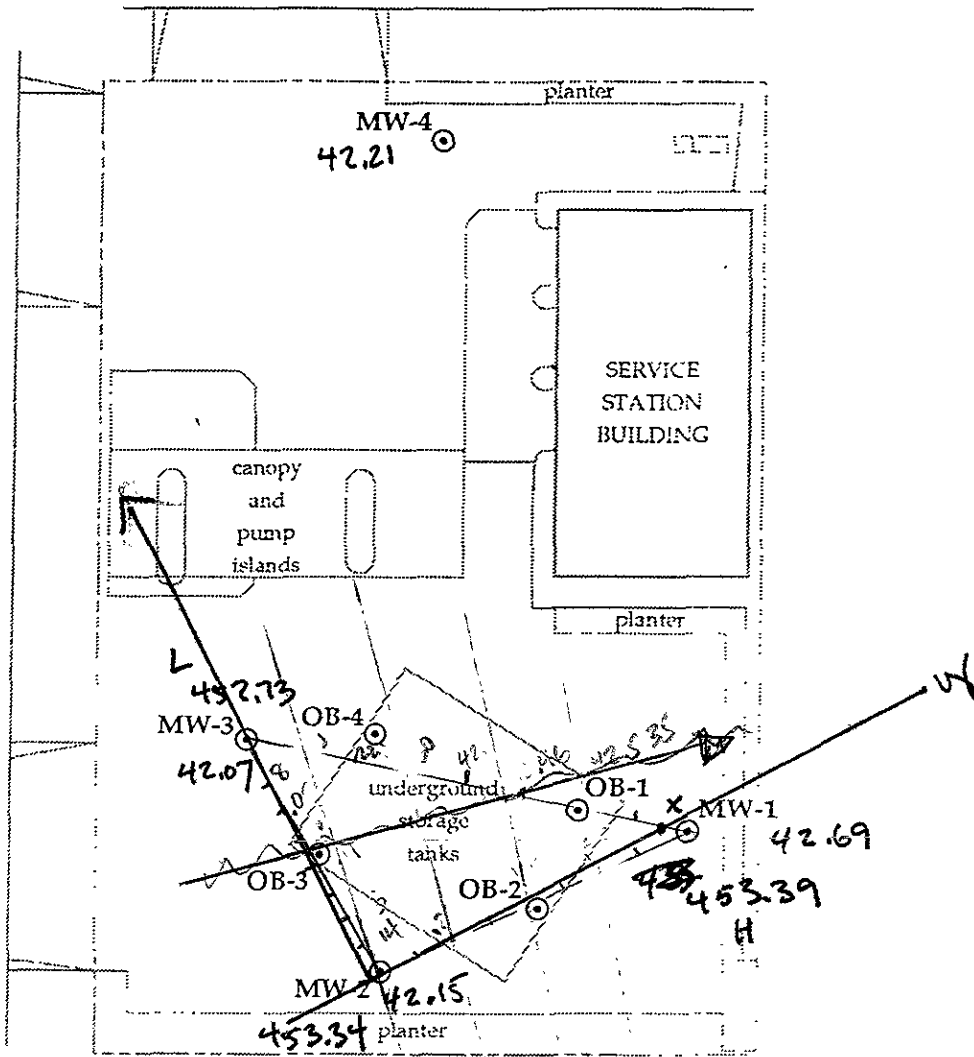

$$x = \frac{5 \text{ m} \cdot 2.35}{66 \cdot (1.28)} = \frac{11.75}{84.48} = 0.14$$

Gradient for 6/21/90

EXPLANATION

⊙ MW-1 Monitoring well

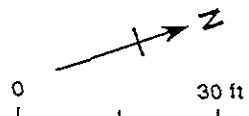

Figure 2. Monitoring Well Locations - Shell Service Station WIC #204-4380-0303, 318 South Livermore Avenue, Livermore, California

EMERGENCY VAN PERSONNEL SCHEDULE CHANGE

Alameda County Health Department
Hazardous Materials Division
80 Swan Way
Oakland, CA 94621

<u>SCHEDULED PERIOD</u>	<u>PERSON ORIGINALLY ASSIGNED</u>	<u>PERSON NOW ASSIGNED</u>

Person Originally Assigned (Signature): _____

Person Now Assigned (Signature): _____

Date: _____

Submit this form to the Supervising Hazardous Materials Specialist
5 days prior to the schedule change.

Rev. 10/89

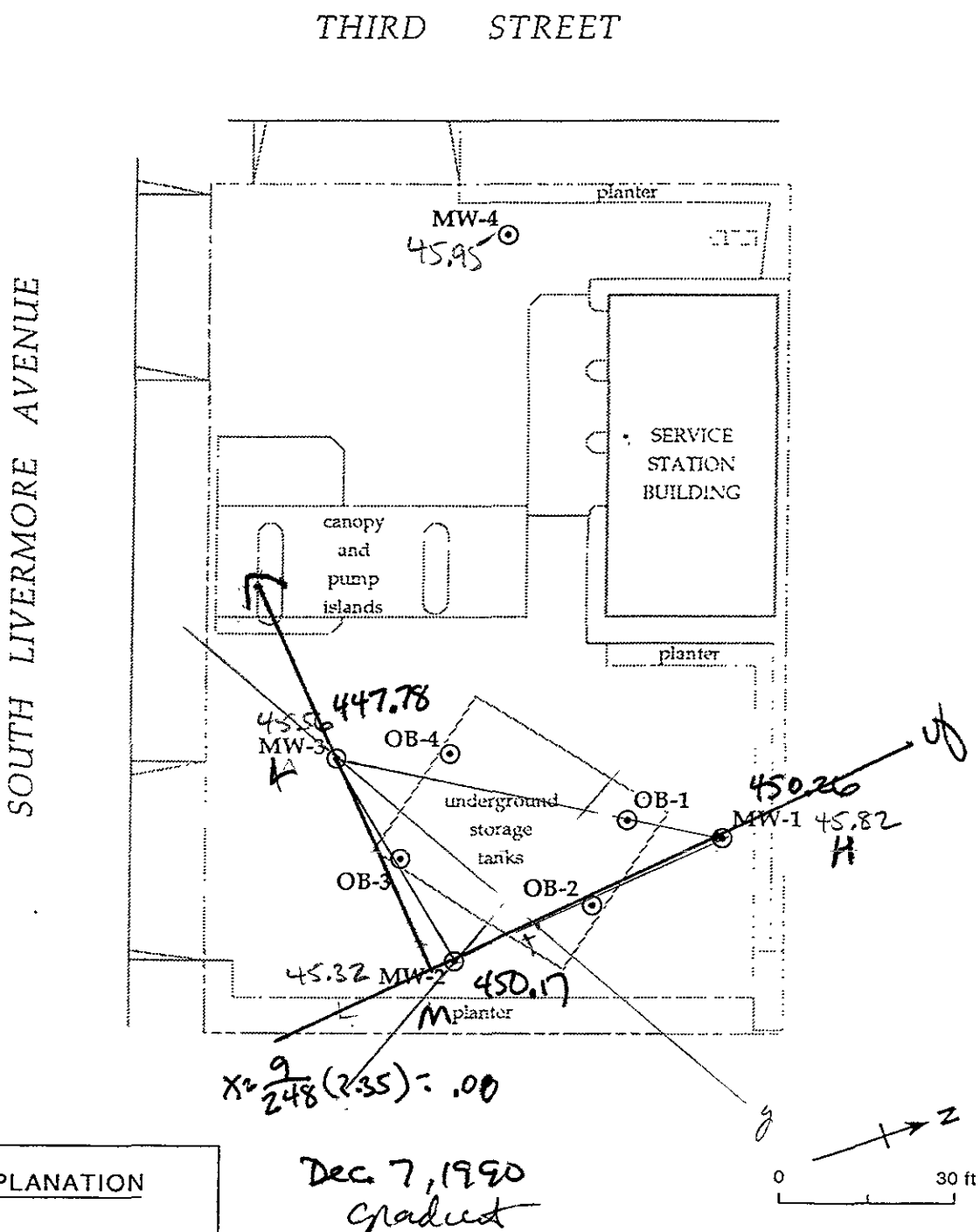

Figure 2. Monitoring Well Locations - Shell Service Station WIC #204-4380-0303, 318 South Livermore Avenue, Livermore, California

EMERGENCY VAN PERSONNEL SCHEDULE CHANGE

Alameda County Health Department
Hazardous Materials Division
80 Swan Way
Oakland, CA 94621

<u>SCHEDULED PERIOD</u>	<u>PERSON ORIGINALLY ASSIGNED</u>	<u>PERSON NOW ASSIGNED</u>

Person Originally Assigned (Signature): _____

Person Now Assigned (Signature): _____

Date: _____

Submit this form to the Supervising Hazardous Materials Specialist
5 days prior to the schedule change.

SOUTH LIVERMORE AVENUE

THIRD STREET

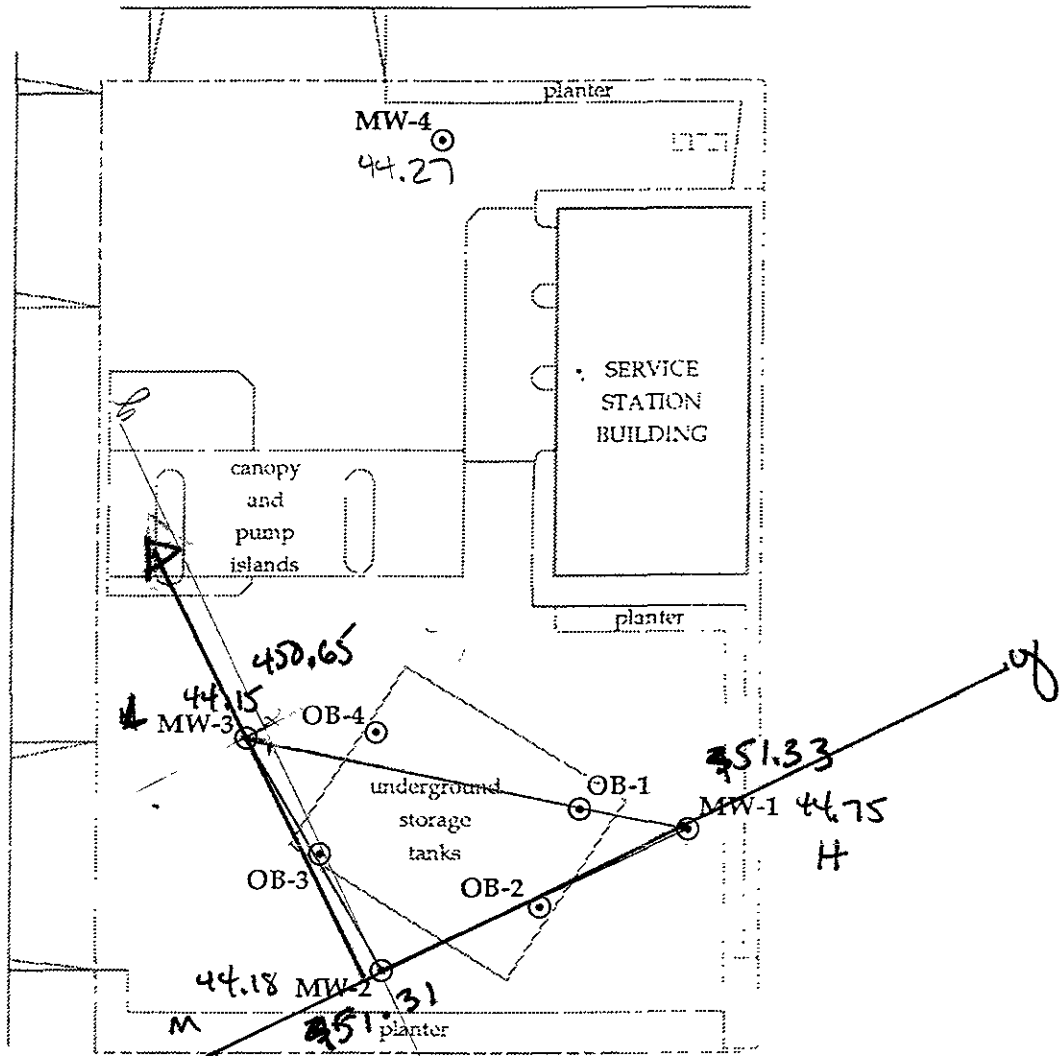

$$x \frac{2}{68} (2.3\%) = .07$$

sep 28, 1990
gradient

EXPLANATION

⊙ MW-1 Monitoring well

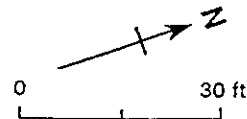

Figure 2. Monitoring Well Locations - Shell Service Station WIC #204-4380-0303, 318 South Livermore Avenue, Livermore, California

EMERGENCY VAN PERSONNEL SCHEDULE CHANGE

Alameda County Health Department
Hazardous Materials Division
80 Swan Way
Oakland, CA 94621

<u>SCHEDULED PERIOD</u>	<u>PERSON ORIGINALLY ASSIGNED</u>	<u>PERSON NOW ASSIGNED</u>

Person Originally Assigned (Signature): _____

Person Now Assigned (Signature): _____

Date: _____

Submit this form to the Supervising Hazardous Materials Specialist
5 days prior to the schedule change.

MONITORING WELL CONSTRUCTION DETAILS

PROJECT: 318 S. Livermore Ave. Shell

DATE: 5/29/90

PROJECT NO.: 89-041

WELL NO.: MW-1

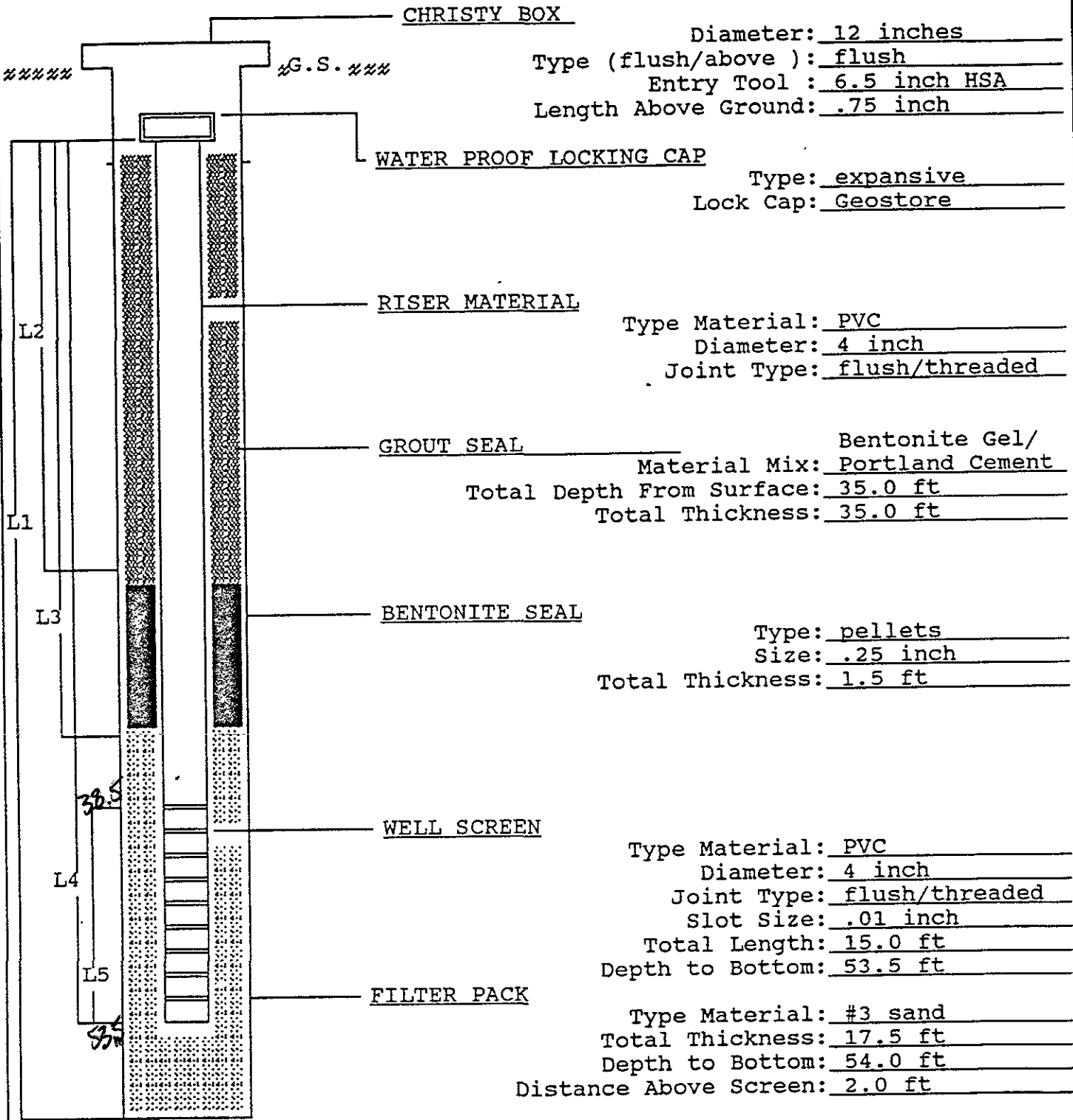

CHRISTY BOX
 Diameter: 12 inches
 Type (flush/above): flush
 Entry Tool : 6.5 inch HSA
 Length Above Ground: .75 inch

WATER PROOF LOCKING CAP
 Type: expansive
 Lock Cap: Geostore

RISER MATERIAL
 Type Material: PVC
 Diameter: 4 inch
 Joint Type: flush/threaded

GROUT SEAL
 Material Mix: Bentonite Gel/Portland Cement
 Total Depth From Surface: 35.0 ft
 Total Thickness: 35.0 ft

BENTONITE SEAL
 Type: pellets
 Size: .25 inch
 Total Thickness: 1.5 ft

WELL SCREEN
 Type Material: PVC
 Diameter: 4 inch
 Joint Type: flush/threaded
 Slot Size: .01 inch
 Total Length: 15.0 ft
 Depth to Bottom: 53.5 ft

FILTER PACK
 Type Material: #3 sand
 Total Thickness: 17.5 ft
 Depth to Bottom: 54.0 ft
 Distance Above Screen: 2.0 ft

- L1 54.0 ft
- L2 35.0 ft
- L3 36.5 ft
- L4 53.5 ft
- L5 15.0 ft

TOTAL DEPTH OF WELL: 54.0 ft
 TOTAL DEPTH OF BORING: 54.0 ft
 DIAMETER OF BORING: 7.0 inch
 METHOD OF DRILLING: HSA
 DATE STARTED: 5/29/90
 DATE COMPLETED: 5/30/90

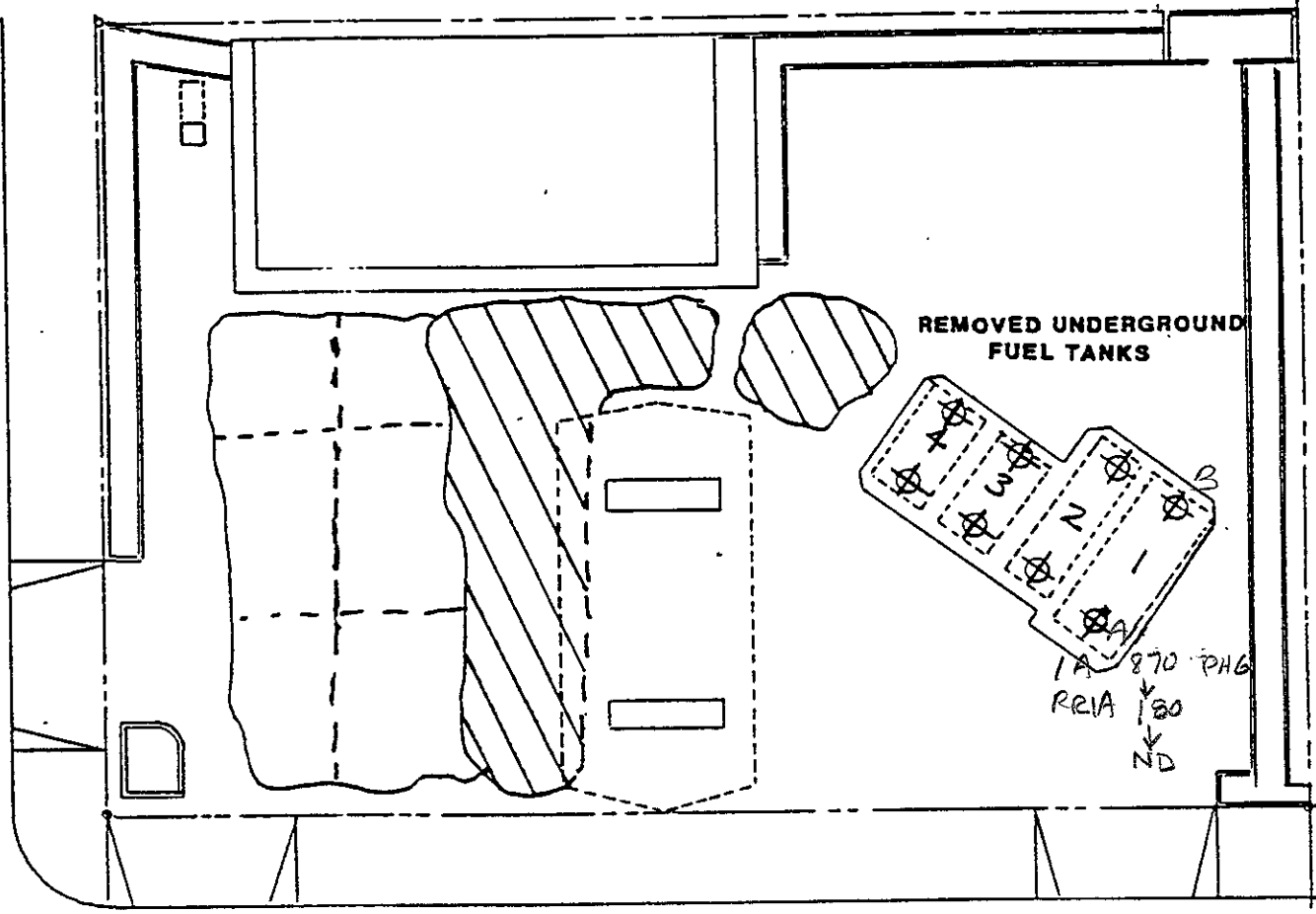

REMOVED UNDERGROUND FUEL TANKS

IA 870 PHG
REIA 180
ND



SOIL SAMPLE LOCATIONS

SAMPLE DATE
DECEMBER 5, 1989

SCALE
1" = 23'

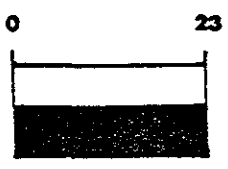

SITE MAP#2 Shell Service Station 318 South Livermore Ave. Livermore, Ca.	
AEGIS JOB NO. 89-041	
DRAWN BY: Ed Bernard	DATE: Dec. 18, 1989
REVIEWED BY:	DATE: