



State of California
CONTRACTORS STATE LICENSE BOARD
ACTIVE LICENSE



License Number 220793 Entity CORP

Business Name GETTLER RYAN INC

Classification(s) B HAZ C61/D40 A C57 C10

Expiration Date 05/31/1999



LOP - RECORD CHANGE REQUEST FORM

printed:
12/06/95

Mark Out What Needs Changing and Hand to LOP Data Entry
(Name/Address changes go to Annual Programs Data Entry)

Insp: EC

AGENCY # : 10000 SOURCE OF FUNDS: F SUBSTANCE: 8006619
 StID : 1976 LOC:
 SITE NAME: Livermore Avenue Shell DATE REPORTED : 12/14/89
 ADDRESS : 318 S Livermore Ave DATE CONFIRMED:
 CITY/ZIP : Livermore 94550 MULTIPLE RPs : N

SITE STATUS

CASE TYPE: S CONTRACT STATUS: 4 PRIOR CODE: EMERGENCY RESP:
 RP SEARCH: S DATE COMPLETED: 04/27/92
 PRELIMINARY ASMNT: C DATE UNDERWAY: 02/27/89 DATE COMPLETED: 05/25/95
 REM INVESTIGATION: DATE UNDERWAY: DATE COMPLETED:
 REMEDIAL ACTION: DATE UNDERWAY: DATE COMPLETED:
 POST REMED ACT MON: DATE UNDERWAY: DATE COMPLETED:

ENFORCEMENT ACTION TYPE: 1 DATE ENFORCEMENT ACTION TAKEN: 04/27/92
 LUFT FIELD MANUAL CONSID: 3HSCAWG
 CASE CLOSED: Y DATE CASE CLOSED: 12/08/95
 DATE EXCAVATION STARTED : 12/05/89 REMEDIAL ACTIONS TAKEN: ED

RESPONSIBLE PARTY INFORMATION

RP#1-CONTACT NAME: Kurt Miller
 COMPANY NAME: Shell Oil
 ADDRESS: P O Box 4023
 CITY/STATE: Concord, C A 94524

INSPECTOR VERIFICATION:

NAME _____ SIGNATURE _____ DATE _____

DATA ENTRY INPUT:

Name/Address Changes Only			Case Progress Changes	
ANNPCMS _____	LOP _____	DATE _____	LOP _____	DATE _____

ALAMEDA COUNTY
HEALTH CARE SERVICES

AGENCY
DAVID J. KEARS, Agency Director



RAFAT A. SHAHID, DIRECTOR

DEPARTMENT OF ENVIRONMENTAL HEALTH
1131 Harbor Bay Parkway
Alameda, CA 94502-6577
(510) 567-6777

StID 1976

September 13, 1995

Mr. Jeff Granberry
Shell Oil
P.O. Box 5278
Concord, CA 94520

RE: Well Decommission at 318 S. Livermore, Livermore, CA

Dear Mr. Granberry:

This office and the S.F. RWQCB have reviewed the case closure summary for the above referenced site and concur that no further action related to the underground tank release is required at this time. Before a remedial action completion letter is sent, the onsite monitoring wells (MW-1, 2, 3 and 4) should be decommissioned, if they will no longer be monitored. Please notify this office upon completion of well destruction so a closure letter can be issued.

If you have any questions, I can be reached at (510) 567-6762.

Sincerely,

eva chu
Hazardous Materials Specialist

cc: files



July 31, 1995

eva chu

Alameda County Department of Environmental Health
Hazardous Materials Division
1131 Harbor Bay Parkway, Second Floor
Alameda, California 94502-6577

02:08:11 - 50W 95
7/31/95 11:24 AM
ENVIRONMENTAL

Re: **Second Quarter 1995**
Shell Service Station
WIC #204-4380-0303
318 South Livermore Avenue
Livermore, California
WA Job #81-0613-205

Dear Ms. chu:

On behalf of Shell Oil Products Company, Weiss Associates (WA) has prepared this status report to satisfy the quarterly reporting requirements prescribed by California Administrative Code Title 23 Waters, Division 3, Chapter 16, Article 5, Section 2652.d. No characterization or abatement was conducted or requested for this site this quarter, and ground water sampling has ceased while your agency evaluates this site for closure. WA will continue to submit quarterly updates to your agency until closure is granted. I trust this submittal meets your needs. Please call me if you have any questions.

Sincerely,
Weiss Associates

Thomas Fojut
Project Geologist

cc: Dan Kirk, Shell Oil Products Company, PO Box 4023, Concord, California 94524

TF/:tf

J:\SHELL\0613\Q295.DOC



95 JUL 11 PM 12:15

TRANSMITTAL

DATE: July 10, 1995 **PROJECT #:** 81-0613

TO: Eva Chu **PHONE:**

COMPANY: Alameda County Department of Environmental Health **FAX:**
 1131 Harbor Bay Parkway, Second Floor
 Alameda, California 94502-6577

FROM: Tom Fojut, (510) 450-6120

SUBJECT: 318 South Livermore Avenue
 Livermore, California

VIA:	FAX:	AS:	FOR:
<input type="checkbox"/> Fax	# of pages: _____	<input type="checkbox"/> Per our phone call	<input checked="" type="checkbox"/> Your information
<input checked="" type="checkbox"/> 1 st Class Mail	(including this cover)	<input checked="" type="checkbox"/> You requested	<input type="checkbox"/> Return to you
<input type="checkbox"/> Overnight Delivery	<input type="checkbox"/> Hard Copy to follow	<input type="checkbox"/> Is required	<input type="checkbox"/> Your action
<input type="checkbox"/> UPS (Surface)		<input type="checkbox"/> We believe you may be interested	<input type="checkbox"/> Your review & comments
<input type="checkbox"/> Courier			

Please call (510) 450-6000 if there are any problems with transmission.

COMMENTS:

Eva:

I have enclosed copies of the manifests for the underground fuel tanks removed in 1989. Crosby and Overton is looking for the soil manifests, and Erikson, Inc. is searching their files for the manifest for the 1987 waste oil tank removal. I will forward these to you as soon as I receive them. Please call me if you have any questions.

cc: Dan Kirk, Shell Oil Products Company

FAX CONFIDENTIALITY NOTICE

The information contained in this transmission is confidential and only intended for the addressee. If you are not the intended recipient, you are hereby notified that any disclosure, copying, distribution or action taken in reliance on the contents of this facsimile transmittal is strictly prohibited. If you have received this facsimile in error, please call us immediately to arrange for the return of these documents.

89569406
 BAS4445

UNIFORM HAZARDOUS WASTE MANIFEST		1. Generator's US EPA ID No. C A D 9 8 4 4 0 3 0 5 8		Manifest Document No. 2 4 1 3 8		2. Page 1 of 1		Information in the shaded areas is not required by Federal law.			
3. Generator's Name and Mailing Address SHELL OIL COMPANY, PO BOX 4848 ANABEIM, CA 92803				GENERATING SITE SHELL STATION 318 S LIVERMORE LIVERMORE, CA 94550		A. State Manifest Document Number 89569406					
4. Generator's Phone (714) 520-3312				6. US EPA ID Number C A D 9 8 2 5 2 4 4 8 0		B. State Generator's ID TAX ID NO.					
5. Transporter 1 Company Name CROSBY & OVERTON EMI				8. US EPA ID Number		C. State Transporter's ID 002113					
7. Transporter 2 Company Name				8. US EPA ID Number		D. Transporter's Phone 415 633-0336					
9. Designated Facility Name and Site Address ERICKSON, INC. 255 PARK BLVD. RICHMOND, CA 94801				10. US EPA ID Number C A D 0 0 9 4 6 6 3 9 2		E. State Transporter's ID					
						F. Transporter's Phone					
						G. State Facility's ID					
						H. Facility's Phone 415/435-1593					
11. US DOT Description (Including Proper Shipping Name, Hazard Class, and ID Number)						12. Containers No. Type		13. Total Quantity		14. Unit Wt/Vol	
a. Waste Empty Underground Storage tank(s) "California Regulated Waste Only"						002 TP		12000		P	
b.										State Waste No. 512	
c.										EPA/Other	
d.										State	
										EPA/Other	
J. Additional Descriptions for Materials Listed Above WASTE EMPTY UNDERGROUND STORAGE TANK(S) ONCE CONTAINING GASOLINE 100% 1-5000 1-3000						K. Handling Codes for Wastes Listed Above a. b. c. d.					
15. Special Handling Instructions and Additional Information WEAR GLOVES WHEN HANDLING											
16. GENERATOR'S CERTIFICATION: I hereby declare that the contents of this consignment are fully and accurately described above by proper shipping name and are classified, packed, marked, and labeled, and are in all respects in proper condition for transport by highway according to applicable international and national government regulations. If I am a large quantity generator, I certify that I have a program in place to reduce the volume and toxicity of waste generated to the degree I have determined to be economically practicable and that I have selected the practicable method of treatment, storage, or disposal currently available to me which minimizes the present and future threat to human health and the environment. OR, if I am a small quantity generator, I have made a good faith effort to minimize my waste generation and select the best waste management method that is available to me and that I can afford.											
Printed/Typed Name STANLEY S. ROLLER						Signature <i>[Signature]</i>					
						ON BEHALF OF SHELL OIL CO. 11/20/89					
17. Transporter 1 Acknowledgement of Receipt of Materials											
Printed/Typed Name DENNIS WATKINS						Signature <i>[Signature]</i>					
						Month Day Year 11/20/89					
18. Transporter 2 Acknowledgement of Receipt of Materials											
Printed/Typed Name						Signature					
						Month Day Year					
19. Discrepancy Indication Space											
20. Facility Owner or Operator Certification of receipt of hazardous materials covered by this manifest except as noted in Item 19											
Printed/Typed Name						Signature					
						Month Day Year					

IN CASE OF AN EMERGENCY OF SPILL, CALL THE NATIONAL RESPONSE CENTER 1-800-424-8602; WITHIN CALIFORNIA CALL 1-800-852-7550

GENERATOR

TRANSPORTER

FACILITY

Do Not Write Below This Line

YELLOW GENERATOR RETAINS

BH 54495

UNIFORM HAZARDOUS WASTE MANIFEST		1. Generator's US EPA ID No. C A D 9 8 2 1 4 0 3 0 5 8	Manifest Document No. 2 0 1 5 8	2. Page 1 of 1	Information in the shaded areas is not required by Federal law.
3. Generator's Name and Mailing Address SHELL OIL COMPANY, PO BOX 4848 ANAHAIN, CA 92803		GENERATING SITE SHELL STATION 318 S LIVERMORE LIVERMORE, CA 94550		A. State Manifest Document Number 89569407	
4. Generator's Phone (714) 520-3312		6. US EPA ID Number C A D 9 8 2 5 2 1 4 4 8 0		B. State Generator's ID S H E L L O I L C O	
5. Transporter 1 Company Name CROSBY & OVERTON EMI		8. US EPA ID Number		C. State Transporter's ID 0 1 5 7 0 3	
7. Transporter 2 Company Name		8. US EPA ID Number		D. Transporter's Phone 415/633-0336	
9. Designated Facility Name and Site Address ERICKSON, INC 255 PARR BLVD RICHMOND, CA 94801		10. US EPA ID Number C A D 0 0 9 4 6 6 3 9 2		E. State Transporter's ID	
				F. Transporter's Phone	
				G. State Facility's ID	
				H. Facility's Phone 415/235-1393	
11. US DOT Description (including Proper Shipping Name, Hazard Class, and ID Number) a. Waste Empty underground storage tank(s) "California Regulated Waste Only"		12. Containers No. Type 0 0 2 T 1 P	13. Total Quantity 140 0 0 0	14. Unit: Wt/Vol	Waste No. State EPA/Other
b.					State EPA/Other
c.					State EPA/Other
d.					State EPA/Other
J. Additional Descriptions for Materials Listed Above WASTE EMPTY UNDERGROUND STORAGE TANK(S) ONCE CONTAINING GASOLINE 1000 1-8000 1-5000		K. Handling Codes for Wastes Listed Above a. b. c. d.			
15. Special Handling Instructions and Additional Information WEAR GLOVES WHEN HANDLING					
16. GENERATOR'S CERTIFICATION: I hereby declare that the contents of this consignment are fully and accurately described above by proper shipping name and are classified, packed, marked, and labeled, and are in all respects in proper condition for transport by highway according to applicable international and national government regulations. If I am a large quantity generator, I certify that I have a program in place to reduce the volume and toxicity of waste generated to the degree I have determined to be economically practicable and that I have selected the practicable method of treatment, storage, or disposal currently available to me which minimizes the present and future threat to human health and the environment; OR, if I am a small quantity generator, I have made a good faith effort to minimize my waste generation and select the best waste management method that is available to me and that I can afford.					
Printed/Typed Name STANLEY J. ROLLER		Signature		ON BEHALF OF SHELL OIL CO. 11/20/89	
17. Transporter 1 Acknowledgement of Receipt of Materials					
Printed/Typed Name DANIEL R. RAY		Signature		Month Day Year 11/20/89	
18. Transporter 2 Acknowledgement of Receipt of Materials					
Printed/Typed Name		Signature		Month Day Year	
19. Discrepancy Indication Space					
20. Facility Owner or Operator Certification of receipt of hazardous materials covered by this manifest except as noted in Item 19.					
Printed/Typed Name		Signature		Month Day Year	

IN CASE OF AN EMERGENCY OR SPILL, CALL THE NATIONAL RESPONSE CENTER 1-800-424-8802; WITHIN CALIFORNIA CALL 1-800-852-7560

89569407



Weiss Associates

Environmental and Geologic Services

5500 Shellmound Street, Emeryville, CA 94608-2411

Fax: 510-547-5043 Phone: 510-450-6000

ec
6/12/95

June 8, 1995

95 JUN -9 PM 2: 10
ENVIRONMENTAL
HEALTH DIVISION

Eva Chu
Alameda County Department of Environmental Health
Environmental Protection Division
1131 Harbor Bay Pkwy, Room 250
Alameda, CA 94502-6577

RE: ACDEH STID #1976
Shell Service Station
WIC # 204-4380-0303
318 South Livermore Avenue
Livermore, California
WA Job # 81-0613-205

Dear Ms. Chu:

This letter confirms our telephone conversation from yesterday regarding ceasing ground water sampling at the Shell station referenced above. We agreed that no further well gauging or sampling is necessary while your agency evaluates the case for closure. We are currently reviewing files at Shell Oil Products Company and Weiss Associates for information regarding soil and tanks previously removed from the site as you requested. Shell and WA appreciate your efforts to evaluate this case for closure. Please call me if you have any questions or need additional information.

Sincerely,
Weiss Associates

Thomas Fojut
Project Geologist

cc: Dan Kirk, Shell Oil Company, PO Box 4023, Concord, California 94524
Fran Thie, Blaine Tech Services, 985 Timothy Drive, San Jose, California 95133

J:\SHELL\0613\CORRESP\95\06CHUE1.DOC

ALAMEDA COUNTY
HEALTH CARE SERVICES



AGENCY
DAVID J. KEARS, Agency Director

RAFAT A. SHAHID, Assistant Agency Director

StID 1976
August 18, 1994

DEPARTMENT OF ENVIRONMENTAL HEALTH
Hazardous Materials Division
80 Swan Way, Rm. 200
Oakland, CA 94621
(510) 271-4320

Mr. Dan Kirk
Shell Oil
P.O.Box 5278
Concord, CA 94520

RE: Biannual Groundwater Sampling at 318 S. Livermore Ave

Dear Mr. Kirk:

I have completed review of Weiss Associates' August 1994 Second Quarter 1994 Activities at the above referenced site. Monitoring well MW-3 continues to exhibit low levels of TPH-G, and BTEX. Sampling in the past year has been performed in June and December. I would like to change the schedule so the wells are sampled in the spring and fall quarters. The next sampling events should be in February and August 1995. After August 1995 the site will be re-evaluated for possible site closure.

If you have any questions, please contact me at (510) 567-6762.

Sincerely,

eva chu
Hazardous Materials Specialist

cc: Michael Maley, Weiss Associates, 5500 Shellmound St,
Emeryville, CA 94608-2411
files

LOP - RECORD CHANGE REQUEST FORM

printed:
06/22/93

Mark Out What Needs Changing and Hand to LOP Data Entry
(Name/Address changes go to Annual Programs Data Entry)

AGENCY # : 10000 SOURCE OF FUNDS: F SUBSTANCE: 8006619
 StID : 1976
 SITE NAME: Livermore Avenue Shell DATE REPORTED : 12/14/89
 ADDRESS : 318 S. Livermore Ave. DATE CONFIRMED: -0-
 CITY/ZIP : Livermore 94550 MULTIPLE RPs : N

SITE STATUS

CASE TYPE: S CONTRACT STATUS: 4 EMERGENCY RESP: -0-
 RP SEARCH: S DATE COMPLETED: 04/27/92
 PRELIMINARY ASMNT: - DATE UNDERWAY: -0- DATE COMPLETED: -0-
 REM INVESTIGATION: - DATE UNDERWAY: -0- DATE COMPLETED: -0-
 REMEDIAL ACTION: - DATE UNDERWAY: -0- DATE COMPLETED: -0-
 POST REMED ACT MON:- DATE UNDERWAY: -0- DATE COMPLETED: -0-

ENFORCEMENT ACTION TYPE: 1 DATE ENFORCEMENT ACTION TAKEN: 04/27/92
 LUFT FIELD MANUAL CONSID: 2
 CASE CLOSED: - DATE CASE CLOSED: -0-
 DATE EXCAVATION STARTED : 12/05/89 REMEDIAL ACTIONS TAKEN: -0-

RESPONSIBLE PARTY INFORMATION

RP#1-CONTACT NAME: Kurt Miller
 COMPANY NAME: Shell Oil
 ADDRESS: P O Box 4023
 CITY/STATE: Concord, C A 94524

INSPECTOR VERIFICATION:

NAME _____ SIGNATURE _____ DATE _____

DATA ENTRY INPUT:

Name/Address Changes Only			Case Progress Changes	
ANNPGMS	LOP	DATE	LOP	DATE
_____	_____	_____	_____	_____



✓
8/25

92 AUG 21 10:08

August 21, 1992

Scott O. Seery
Alameda County Department of
Environmental Health
Hazardous Materials Division
80 Swan Way, Room 200
Oakland, CA 94621

Re: STID #1976
Shell Service Station
318 South Livermore Avenue
Livermore, California
WA Job #81-613-100

Dear Mr. Seery:

On behalf of Shell Oil Company, Weiss Associates (WA) is responding to your June 19, 1992 letter regarding quarterly monitoring and case closure at the station referenced above. You requested that Shell forward any reports documenting work at the site since October 1990 and resume quarterly ground water sampling. A brief site summary and responses to your requests are presented below.

Site Summary

In February 1989, Woodward-Clyde Consultants of Oakland, California drilled four soil borings adjacent to the former underground fuel tanks¹. A composite soil sample from each boring, composed of soil from between 4 and 16.5 ft depth, was analyzed for total petroleum hydrocarbons as gasoline (TPH-G) and benzene, ethylbenzene, toluene and xylenes (BETX). No TPH-G were detected in the samples.

¹ Woodward-Clyde Consultants, March 8, 1989, Letter-report prepared for Gettler-Ryan, Inc. regarding soil boring results for the Shell service station at 318 South Livermore Avenue, Livermore, California, 2 pages plus attachments.



In March 1989, Gettler-Ryan, Inc. of Hayward, California collected a soil sample from the backfill adjacent to the fill riser of one of the underground gasoline tanks². The sample contained 37,000 parts per million (ppm) TPH-G and 550 ppm total lead.

In November and December 1989, the four former underground fuel tanks were excavated and removed³. Aegis Environmental Consultants of Roseville, California collected soil samples from the bottom of the tank pit and the product line trenches. A soil sample from beneath one of the former tanks contained 190 ppm TPH-G, and native soil samples from the product line trenches contained up to 16 ppm TPH-G. Soil containing over 10 ppm hydrocarbons was excavated from the tank vicinity, aerated and disposed offsite.⁴

In May 1990, Aegis installed four ground water monitoring wells.⁵ No TPH-G were detected in soil samples from the borings for the wells, and no hydrocarbons were detected in ground water samples from the wells.

In October 1990, Aegis again sampled the four wells.⁶ No hydrocarbons were detected in any of the samples.

-
- ² Gettler-Ryan, Inc., March 30, 1989, Letter to Shell regarding soil sampling at the Shell service station at 318 South Livermore Avenue, Livermore, California, 1 page and 1 attachment.
 - ³ Aegis Environmental Consultants, Inc., February 18, 1990, Tank Closure Report and Hydrogeological Investigation Work Plan prepared for Shell for the Shell service station at 318 South Livermore Avenue, Livermore, California, 15 pages and 3 appendices.
 - ⁴ Aegis Environmental, Inc. January 31, 1991, Letter to the Regional Water Quality Control Board - San Francisco Bay Region requesting case closure for the Shell service station at 318 South Livermore Avenue, Livermore, California, 3 pages.
 - ⁵ Aegis Environmental Consultants, July 16, 1990, Hydrogeologic Investigation Results, report prepared for Shell regarding the Shell service station at 318 South Livermore Avenue, Livermore, California, 11 pages and 4 appendices.
 - ⁶ Sequoia Analytical, October 10, 1990, Analytic report prepared for Aegis regarding ground water samples from the Shell service station at 318 South Livermore Avenue, Livermore, California, 2 pages and 1 attachment.



File Review

WA reviewed Shell's files and contacted Aegis, Shell's previous consultant for this site, to assess whether any additional work had been conducted at this site since October 1990. No documents pertaining to environmental work were found.

Quarterly Monitoring

As requested in your letter, Shell will sample the four site wells quarterly for four quarters beginning the third quarter of 1992. Ground water samples will be collected each quarter in accordance with Alameda County Department of Environmental Health (ACDEH) guidelines. The samples will be analyzed at a state-certified analytical laboratory for TPH-G by modified EPA Method 8015, BETX by EPA Method 8020 and soluble lead by EPA Method 7421. We will submit quarterly reports to the ACDEH presenting the results of each sampling. Each report will include tables presenting analytical and ground water elevation data and a site map presenting the ground water gradient and flow direction.

Scott O. Seery
August 21, 1992

4

Weiss Associates



It is our understanding that the ACDEH and the Regional Water Quality Control Board will approve case closure if no hydrocarbons or soluble lead are detected above regulatory guidelines in ground water samples from the wells for four consecutive quarters. Please call us if you have any questions or comments.

Sincerely,
Weiss Associates

Thomas Fojut
Staff Geologist

N. Scott MacLeod
Project Geologist

TF/NSM:tf

E:\SHELL\613L1AU2.WP

cc: Dan Kirk, Shell Oil Company, P.O. Box 5278, Concord, California 95420-9998
Danielle Stephani, Livermore Fire Department, Hazardous Materials, 4550 East Avenue,
Livermore, California 94550
Gil Jensen, Alameda County District Attorney, 1225 Fallon St, Oakland, California 94612
Eddy So, Regional Water Quality Control Board - San Francisco Bay, 2101 Webster Street,
Oakland, California 94612

ALAMEDA COUNTY
HEALTH CARE SERVICES



AGENCY

DAVID J. KEARS, Agency Director

RAFAT A. SHAHID, Assistant Agency Director

StID 1976

June 19, 1992

Dan Kirk
Shell Oil
P.O. Box 5278
Concord, CA 94520

DEPARTMENT OF ENVIRONMENTAL HEALTH
Hazardous Materials Division
80 Swan Way, Rm. 200
Oakland, CA 94621
(510) 271-4320

**Subject: Groundwater Monitoring at Shell Service Station,
318 S. Livermore Ave., Livermore, CA 94550**

Dear Mr. Kirk:

This office has reviewed the case file of the above referenced site. The most recent summary report was dated January 31, 1991. The referenced report documents that groundwater samples were collected during June and October 1990. Samples were analyzed for total petroleum hydrocarbons as gasoline (TPH-G), benzene, toluene, ethylbenzene, and xylene (BTEX). All laboratory results were non-detectable for the target compounds.

The referenced January 31 report includes a request from your consultant, Aegis Environmental, Inc., that this case be closed. San Francisco Bay Regional Water Quality Control Board (RWQCB) policy requires that monitoring wells be monitored and sampled for a minimum of four consecutive quarters with non-detectable results for target compounds, before a case will be evaluated for closure.

At this time, we do not concur that case closure for this site is appropriate.

You must continue to monitor and sample the wells for TPH-G, BTEX and soluble lead (Note: analysis of soil samples previously collected from the underground storage tank pit indicated total lead of 550 parts per million (ppm) and soluble lead of 42 ppm.) Submit quarterly reports in a timely manner. Include in these reports analysis results, groundwater level, flow direction and gradient, among other elements. Also if there had been work performed at this site after October 1990 please submit reports for our review.

Please be advised that this is a formal request for technical reports pursuant to California Water Code Section 13267 (b). Failure to respond or a late response may result in referral of this case to the RWQCB, possibly subjecting responsible parties to civil penalties up to \$1,000 per day. Modification of required tasks or extensions of stated deadlines must be confirmed in writing by either this agency or the RWQCB.

Shell Service Station
318 S. Livermore Ave
June 19, 1992

Page 2

Should you have any questions regarding the contents of this letter or status of this case, please call Ms. Eva Chu at (510)271-4530.

Sincerely,

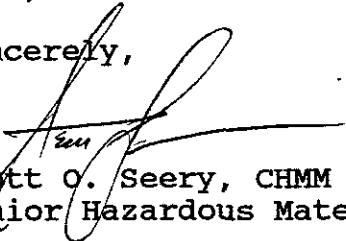
A handwritten signature in black ink, appearing to read "Scott O. Seery", is written over a horizontal line. The signature is stylized and cursive.

Scott O. Seery, CHMM
Senior Hazardous Materials Specialist

cc: Eddy So, RWQCB
Danielle Stephani, Livermore Fire Department
Gil Jensen, Alameda County District Attorney's Office
file

shell-lv

TE: month 3 date 31, 1992
TO : Local Oversight Program
FROM: Don Hwang
SUBJ: Transfer of Eligible Oversight Case

Site name: Shell
Address: 3184 Livermore City X Zip 94550
Closure plan attached? Y N DepRef remaining \$ _____
DepRef Project # 575 STID # (if any) 1976
Number of Tanks: 4 removed? Y N Date of removal 12/5/89
Leak Report filed? Y N Date of Discovery 12/14/89
Samples received? Y N Contamination: Soil Groundwater 870 ppm low/mod BP HC
Petroleum Y N Types: Avgas Jet leaded unleaded Diesel
fuel oil waste oil kerosene solvents
Monitoring wells on site 3 Monitoring schedule? Y N
LUFT category 1 2 3 * H S C A R W G O
Briefly describe the following:
Preliminary Assessment 7/16/90 soil samples from soil borings detection limit, water < det. limit
Remedial Action 10/2/90 water ND contain soil removed
Post Remedial Action Monitoring see 7/16/90
Enforcement Action _____

2.36
5-11-94
Questions!

Shell Oil Company



EAST BAY
MARKET DISTRICT
P.O. Box 4023
Concord, CA 94524
(415) 676-1414
DEC 19 PM 3:03

December 15, 1989

Mr. Lowell Miller
Alameda Co. Department of Environmental Health
80 Swan Way - Room 200
Oakland, CA. 94621

SUBJECT : SHELL STATION
318 SO. LIVERMORE AVE.
LIVERMORE, CA.

Dear Mr. Miller:

Enclosed is an UNDERGROUND STORAGE TANK UNAUTHORIZED RELEASE REPORT (FORM 5), Shell's UST FINANCIAL RESPONSIBILITY DOCUMENT and a copy of the report issued by Sequoia Analytical, presenting the findings of the soil tests conducted for underground tank removal at the subject location.

The investigation was conducted by AEGIS Environmental Consultants. AEGIS will prepare a report of their findings and forward a copy to your office.

Please contact me at (415) 676-1414, ext. 145 if you have any questions.

Very truly yours,

A handwritten signature in cursive script that reads "Stanley J. Roller".

Stanley J. Roller

Attachments

cc: Mr. Steven Ritchie, Regional Water Quality Control Board
Mr. E. Carlson, City of Livermore - Fire Department
Ms. Diane Lundquist, Shell Oil Co.
Ms. Lisa Foster, Shell Oil Co.
Mr. Jeff Hill, Shell Oil Co.
Aegis Environmental Consultants
Location File

UNDERGROUND STORAGE TANK UNAUTHORIZED RELEASE (LEAK) / CONTAMINATION SITE REPORT

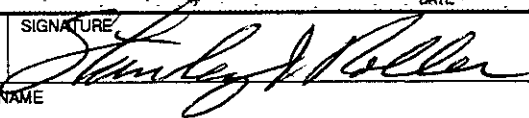
EMERGENCY <input type="checkbox"/> YES <input checked="" type="checkbox"/> NO		HAS STATE OFFICE OF EMERGENCY SERVICES REPORT BEEN FILED? <input type="checkbox"/> YES <input checked="" type="checkbox"/> NO		FOR LOCAL AGENCY USE ONLY I HEREBY CERTIFY THAT I AM A DESIGNATED GOVERNMENT EMPLOYEE AND THAT I HAVE REPORTED THIS INFORMATION TO LOCAL OFFICIALS PURSUANT TO SECTION 25180.7 OF THE HEALTH AND SAFETY CODE.		
REPORT DATE 1 2 M 1 5 D 8 9 Y		CASE #		SIGNED _____ DATE _____		
REPORTED BY	NAME OF INDIVIDUAL FILING REPORT STANLEY J. ROLLER		PHONE (415) 676-1414		SIGNATURE 	
	REPRESENTING <input type="checkbox"/> LOCAL AGENCY <input checked="" type="checkbox"/> OWNER/OPERATOR <input type="checkbox"/> REGIONAL BOARD <input type="checkbox"/> OTHER		COMPANY OR AGENCY NAME SHELL OIL CO.			
	ADDRESS P.O. BOX _____ STREET 4023 CITY CONCORD STATE CA ZIP 94524					
RESPONSIBLE PARTY	NAME SHELL OIL CO. <input type="checkbox"/> UNKNOWN		CONTACT PERSON STANLEY J. ROLLER		PHONE (415) 676-1414	
	ADDRESS P.O. BOX _____ STREET 4023 CITY CONCORD STATE CA ZIP 94524					
SITE LOCATION	FACILITY NAME (IF APPLICABLE) SHELL STATION		OPERATOR DONALD OCHSE		PHONE (415) 447-9097	
	ADDRESS 318 _____ STREET SO, LIVERMORE CITY CA COUNTY ALAMEDA ZIP 94550					
	CROSS STREET 3rd STREET		TYPE OF AREA <input checked="" type="checkbox"/> COMMERCIAL <input type="checkbox"/> INDUSTRIAL <input type="checkbox"/> RURAL <input type="checkbox"/> RESIDENTIAL <input type="checkbox"/> OTHER		TYPE OF BUSINESS <input type="checkbox"/> RETAIL FUEL STATION <input type="checkbox"/> FARM <input type="checkbox"/> OTHER	
IMPLEMENTING AGENCIES	LOCAL AGENCY ALAMEDA CO. ENVIRO. HEALTH		AGENCY NAME ALAMEDA CO. ENVIRO. HEALTH		CONTACT PERSON LOWELL MILLER	
	REGIONAL BOARD		PHONE ()		PHONE ()	
SUBSTANCES INVOLVED	(1) NAME GASOLINE		QUANTITY LOST (GALLONS) <input checked="" type="checkbox"/> UNKNOWN			
	(2)		<input type="checkbox"/> UNKNOWN			
DISCOVERY/ABATEMENT	DATE DISCOVERED 1 2 M 1 5 D 8 9 Y		HOW DISCOVERED <input type="checkbox"/> INVENTORY CONTROL <input type="checkbox"/> SUBSURFACE MONITORING <input type="checkbox"/> NUISANCE CONDITIONS <input type="checkbox"/> TANK TEST <input checked="" type="checkbox"/> TANK REMOVAL <input type="checkbox"/> OTHER			
	DATE DISCHARGE BEGAN <input checked="" type="checkbox"/> UNKNOWN		METHOD USED TO STOP DISCHARGE (CHECK ALL THAT APPLY) <input type="checkbox"/> REMOVE CONTENTS <input checked="" type="checkbox"/> REPLACE TANK <input type="checkbox"/> CLOSE TANK <input type="checkbox"/> REPAIR TANK <input type="checkbox"/> REPAIR PIPING <input type="checkbox"/> CHANGE PROCEDURE <input type="checkbox"/> OTHER			
	HAS DISCHARGE BEEN STOPPED? <input checked="" type="checkbox"/> YES <input type="checkbox"/> NO - IF YES, DATE _____					
SOURCE/CAUSE	SOURCE OF DISCHARGE <input type="checkbox"/> TANK LEAK <input checked="" type="checkbox"/> UNKNOWN		TANKS ONLY/CAPACITY 2-5000 GAL. 2-8000 GAL. AGE 24 YRS		MATERIAL <input type="checkbox"/> FIBERGLASS <input checked="" type="checkbox"/> STEEL <input type="checkbox"/> OTHER	
	<input type="checkbox"/> PIPING LEAK <input type="checkbox"/> OTHER		<input type="checkbox"/> UNKNOWN		CAUSE(S) <input type="checkbox"/> OVERFILL <input type="checkbox"/> RUPTURE/FAILURE <input type="checkbox"/> CORROSION <input checked="" type="checkbox"/> UNKNOWN <input type="checkbox"/> SPILL <input type="checkbox"/> OTHER	
CASE TYPE	CHECK ONE ONLY <input type="checkbox"/> UNDETERMINED <input checked="" type="checkbox"/> SOIL ONLY <input type="checkbox"/> GROUNDWATER <input type="checkbox"/> DRINKING WATER - (CHECK ONLY IF WATER WELLS HAVE ACTUALLY BEEN AFFECTED)					
CURRENT STATUS	CHECK ONE ONLY <input type="checkbox"/> SITE INVESTIGATION IN PROGRESS (DEFINING EXTENT OF PROBLEM) <input checked="" type="checkbox"/> CLEANUP IN PROGRESS <input type="checkbox"/> SIGNED OFF (CLEANUP COMPLETED OR UNNECESSARY) <input type="checkbox"/> NO ACTION TAKEN <input type="checkbox"/> POST CLEANUP MONITORING IN PROGRESS <input type="checkbox"/> NO FUNDS AVAILABLE TO PROCEED <input type="checkbox"/> EVALUATING CLEANUP ALTERNATIVES					
REMEDIAL ACTION	CHECK APPROPRIATE ACTION(S) (SEE BACK FOR DETAILS) <input type="checkbox"/> CAP SITE (CD) <input checked="" type="checkbox"/> EXCAVATE & DISPOSE (ED) <input type="checkbox"/> REMOVE FREE PRODUCT (FP) <input type="checkbox"/> ENHANCED BIO DEGRADATION (IT) <input type="checkbox"/> CONTAINMENT BARRIER (CB) <input type="checkbox"/> EXCAVATE & TREAT (ET) <input type="checkbox"/> PUMP & TREAT GROUNDWATER (GT) <input type="checkbox"/> REPLACE SUPPLY (RS) <input type="checkbox"/> TREATMENT AT HOOKUP (HU) <input type="checkbox"/> NO ACTION REQUIRED (NA) <input type="checkbox"/> OTHER (OT)					
COMMENTS	During Tank Removal contaminated soil was found by Regis Environmental Consultants, (see attached results)					

TELETYPE

TELEGRAM

MAIL

TO

Lowell Miller

AT

Alameda County Health Care Services

SUBJECT

additional fees, 318 S. Livermore St, Livermore, CA
Project # U552951

DATE

11-6-89

Dear Mr. Miller, per our telephone conversation enclosed please find check for difference in fees at referenced site for tank closure permit.

There are 2 5,000 gal UL tanks rather than ~~1~~ 1. Please call me at 916-782-2110 if there are any problems.

Alameda County project # U552951

Thanks

Clarke H. Owen / Regina

PLEASE REPLY TO

SIGNED

REDIFORM

45 461

POLY PAK (50 SETS)

4P461

USE REVERSE SIDE FOR YOUR ANSWER

THIS CERTIFICATE IS ISSUED AS A MATTER OF INFORMATION ONLY AND CONFERS NO RIGHTS UPON THE CERTIFICATE HOLDER. THIS CERTIFICATE DOES NOT AMEND, EXTEND OR ALTER THE COVERAGE AFFORDED BY THE POLICIES BELOW.

Putnam, Knudsen & Wieking, Inc.
P.O. Box 24205
Oakland, CA 94623

COMPANIES AFFORDING COVERAGE

CODE SUB-CODE

COMPANY LETTER	A	Fireman's Fund
COMPANY LETTER	B	Fireman's Fund
COMPANY LETTER	C	
COMPANY LETTER	D	Republic Indemnity
COMPANY LETTER	E	

COPY

INSURED
R. W. Johnston & Son
801 53rd Avenue
Oakland, CA 94601

COVERAGES

THIS IS TO CERTIFY THAT THE POLICIES OF INSURANCE LISTED BELOW HAVE BEEN ISSUED TO THE INSURED NAMED ABOVE FOR THE POLICY PERIOD INDICATED. NOTWITHSTANDING ANY REQUIREMENT, TERM OR CONDITION OF ANY CONTRACT OR OTHER DOCUMENT WITH RESPECT TO WHICH THIS CERTIFICATE MAY BE ISSUED OR MAY PERTAIN, THE INSURANCE AFFORDED BY THE POLICIES DESCRIBED HEREIN IS SUBJECT TO ALL THE TERMS, EXCLUSIONS AND CONDITIONS OF SUCH POLICIES. LIMITS SHOWN MAY HAVE BEEN REDUCED BY PAID CLAIMS

CO LTR	TYPE OF INSURANCE	POLICY NUMBER	POLICY EFFECTIVE DATE (MM/DD/YY)	POLICY EXPIRATION DATE (MM/DD/YY)	ALL LIMITS IN THOUSANDS															
A	GENERAL LIABILITY <input checked="" type="checkbox"/> COMMERCIAL GENERAL LIABILITY <input checked="" type="checkbox"/> CLAIMS MADE <input checked="" type="checkbox"/> OCCUR. <input type="checkbox"/> OWNER'S & CONTRACTOR'S PROT.	MXX80387571	09/01/89	09/01/90	GENERAL AGGREGATE	\$ 2,000														
	B				AUTOMOBILE LIABILITY <input checked="" type="checkbox"/> ANY AUTO <input type="checkbox"/> ALL OWNED AUTOS <input type="checkbox"/> SCHEDULED AUTOS <input checked="" type="checkbox"/> HIRED AUTOS <input checked="" type="checkbox"/> NON-OWNED AUTOS <input type="checkbox"/> GARAGE LIABILITY	MXA80068454	09/01/89	09/01/90	PRODUCTS-COMP/OPS AGGREGATE	\$ 2,000										
					D				WORKERS' COMPENSATION AND EMPLOYERS' LIABILITY	[90]PC989901	07/01/89	07/01/90	PERSONAL & ADVERTISING INJURY	\$ 1,000						
									OTHER				EXCESS LIAB: <input type="checkbox"/> OTHER THAN UMBRELLA FORM			EACH OCCURRENCE	\$			
													D			OTHER			AGGREGATE	\$
																STATUTORY			\$ 1,000 (EACH ACCIDENT)	
					\$ 1,000 (DISEASE-POLICY LIMIT)															
					\$ 1,000 (DISEASE-EACH EMPLOYEE)															

DESCRIPTION OF OPERATIONS/LOCATIONS/VEHICLES/RESTRICTIONS/SPECIAL ITEMS

RE: INSURED'S CALIFORNIA OPERATIONS.

JPW/LM/prs

FOR: SHELL SVC. STATION

318 S. Livermore Blvd. Livermore

CERTIFICATE HOLDER

ALAMEDA COUNTY HEALTH
HAZARDOUS MATERIALS DIV.
80 SWAN WAY
OAKLAND, CA 91621

CANCELLATION

SHOULD ANY OF THE ABOVE DESCRIBED POLICIES BE CANCELLED BEFORE THE EXPIRATION DATE THEREOF, THE ISSUING COMPANY WILL ENDEAVOR TO MAIL 10 DAYS WRITTEN NOTICE TO THE CERTIFICATE HOLDER NAMED TO THE LEFT BUT FAILURE TO MAIL SUCH NOTICE SHALL IMPOSE NO OBLIGATION OR LIABILITY OF ANY KIND UPON THE COMPANY, ITS AGENTS OR REPRESENTATIVES.

AUTHORIZED REPRESENTATIVE

[Signature]

ALAMEDA COUNTY HEALTH CARE SERVICES AGENCY
 DEPARTMENT OF ENVIRONMENTAL HEALTH
 HAZARDOUS MATERIALS DIVISION
 80 SWAN WAY, ROOM 200
 OAKLAND, CA 94621
 PHONE NO. 415/271-4320

ACCEPTED

DEPARTMENT OF ENVIRONMENTAL HEALTH
 RECEIVED
 TELEPHONE NO. 415/271-4320

These plans have been reviewed and found to be acceptable and are hereby approved for construction and to all the above listed parties. This approval is local. D. Parker of the Department of Environmental Health is the local representative of the State of California. A copy of this approval is being furnished to the local health officer. A copy of this approval is being furnished to the health officer. A copy of this approval is being furnished to the health officer. A copy of this approval is being furnished to the health officer.

Project #/ U552951
 Fee Paid \$663.
 Date 11/13/89

UNDERGROUND TANK CLOSURE/MODIFICATION PLANS

1. Business Name SHELL SERVICE STATION
 Business Owner SHELL OIL COMPANY
2. Site Address 318 So. LIVERMORE AVE
 city LIVERMORE, CA zip 94550 Phone (415) 447-9097
3. Mailing Address SHELL Oil Company ATTN: MATT FOSTER P.O. Box 4023
 city CONCORD, CA zip 94524 Phone 451-2799 ext 134
4. Land Owner SHELL Oil Company
 Address P.O. 4023 city, State Concord, CA zip 94524
5. EPA I.D. No. Not assigned yet/ Prior to removal
6. Contractor R.W. JOHNSTON & SON * Nick BURGIE
 Address 801 53RD AVE
 city OAKLAND, CA 94601 Phone (415) 261-9424
 License Type A, B ID# N/A
7. Consultant AEGIS ENVIRONMENTAL CONSULTANTS * CLARKE Owen
 Address 801 RIVERSIDE AVE SUITE C
 city ROSEVILLE, CA 95678 Phone (916) 782-2110

8. Contact Person for Investigation

Name CLARKE OWEN Title PROJECT MANAGER
Phone (916) 782-2110

9. Total No. of Tanks at facility 3/4

10. Have permit applications for all tanks been submitted to this office? Yes [] No []

11. State Registered Hazardous Waste Transporters/Facilities

a) Product/Waste Tranporter

Name CROSBY & OVERTON, INC EPA I.D. No. CAL 98254480
Address 8430 AMELIA STREET
city OAKLAND, State CA zip 94621

b) Rinsate Transporter

Name CROSBY & OVERTON, INC. EPA I.D. No. CAL 98254480
Address 8430 AMELIA STREET
city OAKLAND State CA zip 94621

c) Tank Transporter

Name CROSBY & OVERTON; INC. EPA I.D. No. CAL 98254480
Address 8430 AMELIA STREET
city OAKLAND State CA zip 94621

d) Tank Disposal Site

Name ERICKSON, TNC. EPA I.D. No. CAL 009466392
Address 255 Parr Blvd.
city RICHMOND State CA zip 94801

e) Contaminated Soil Transporter

Name CROSBY & OVERTON, INC. EPA I.D. No. CAL 98254480
Address 8430 AMELIA STREET
city OAKLAND State CA zip 94621

12. Sample Collector

Name TRACY SCHILLING; STAFF ENGINEER
 Company AEGIS ENVIRONMENTAL CONSULTANTS
 Address 801 RIVERSIDE AVE, SUITE C
 City ROSEVILLE State CA Zip 95678 Phone (916) 787-2110

13. Sampling Information for each tank or area

Tank or Area		Material sampled	Location & Depth
Capacity	Historic Contents (past 5 years)		
2X 5,000 gal.	Unleaded Gasoline	WILL BE SOIL	WILL BE NO MORE THAN 2' Below Tank Bottom on ea Tank over 2,000 gal
8,000 gal	Regular Gasoline	SOIL	
8,000 gal	Super. Unleaded Gas.	SOIL	

14. Have tanks or pipes leaked in the past? Yes [] No [] UNKNOWN [X]

If yes, describe. _____

15. NFPA methods used for rendering tank inert? Yes [X] No []

If yes, describe. CO₂ (DRY ICE)

An explosion proof combustible gas meter shall be used to verify tank inertness.

16. Laboratories

Name INTERNATIONAL TECHNOLOGY CORP.
 Address 2055 JUNCTION AVE.
 City SAN JOSE State CA Zip 95131
 State Certification No. 137

17. Chemical Methods to be used for Analyzing Samples

Contaminant Sought	EPA, DHS, or Other Sample Preparation Method Number	EPA, DHS, or Other Analysis Number
GASOLINE U/L PU/L	TPH G w/ BTX+E in SERIES Mod 8015/8020	
REG.	TPH G w/ BTX + E in SERIES Mod. 8015/8020 TOTAL Pb METHOD 7421	

18. Submit Site Safety Plan

19. Workman's Compensation: Yes No

Copy of Certificate enclosed? Yes No

Name of Insurer ON FILE w/ ALAMEDA COUNTY EHS
80 Swan Way
OAKLAND

20. Plot Plan submitted? Yes No

21. Deposit enclosed? Yes No

22. Please forward to this office the following information within 60 days after receipt of sample results.

- a) Chain of Custody Sheets
- b) Original Signed Laboratory Reports
- c) TSD to Generator copies of wastes shipped and received
- d) Attachment A summarizing laboratory results

I declare that to the best of my knowledge and belief the statements and information provided above are correct and true. I understand that information in addition to that provided above may be needed in order to obtain an approval from the Department of Environmental Health and that no work is to begin on this project until this plan is approved.

I understand that any changes in design, materials or equipment will void this plan if prior approval is not obtained.

I understand that all work performed during this project will be done in compliance with all applicable OSHA (Occupational Safety and Health Administration) requirements concerning personnel and safety.

I will notify the Department of Environmental Health at least two (2) working days (48 hours) after approval of this closure plan in advance to schedule any required inspections. I understand that site and worker safety are solely the responsibility of the property owner or his agent and that this responsibility is not shared nor assumed by the County of Alameda.

Signature of Contractor

Name (please type) R.W. JOHNSTON & SON

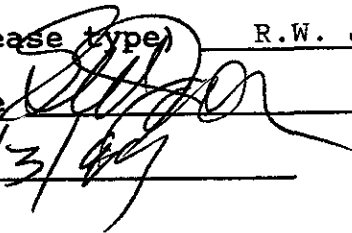
Signature 

Date 11/3/89

Signature of Site Owner or Operator

Name (please type) SHELL OIL COMPANY

Signature 

Date 11/3/89

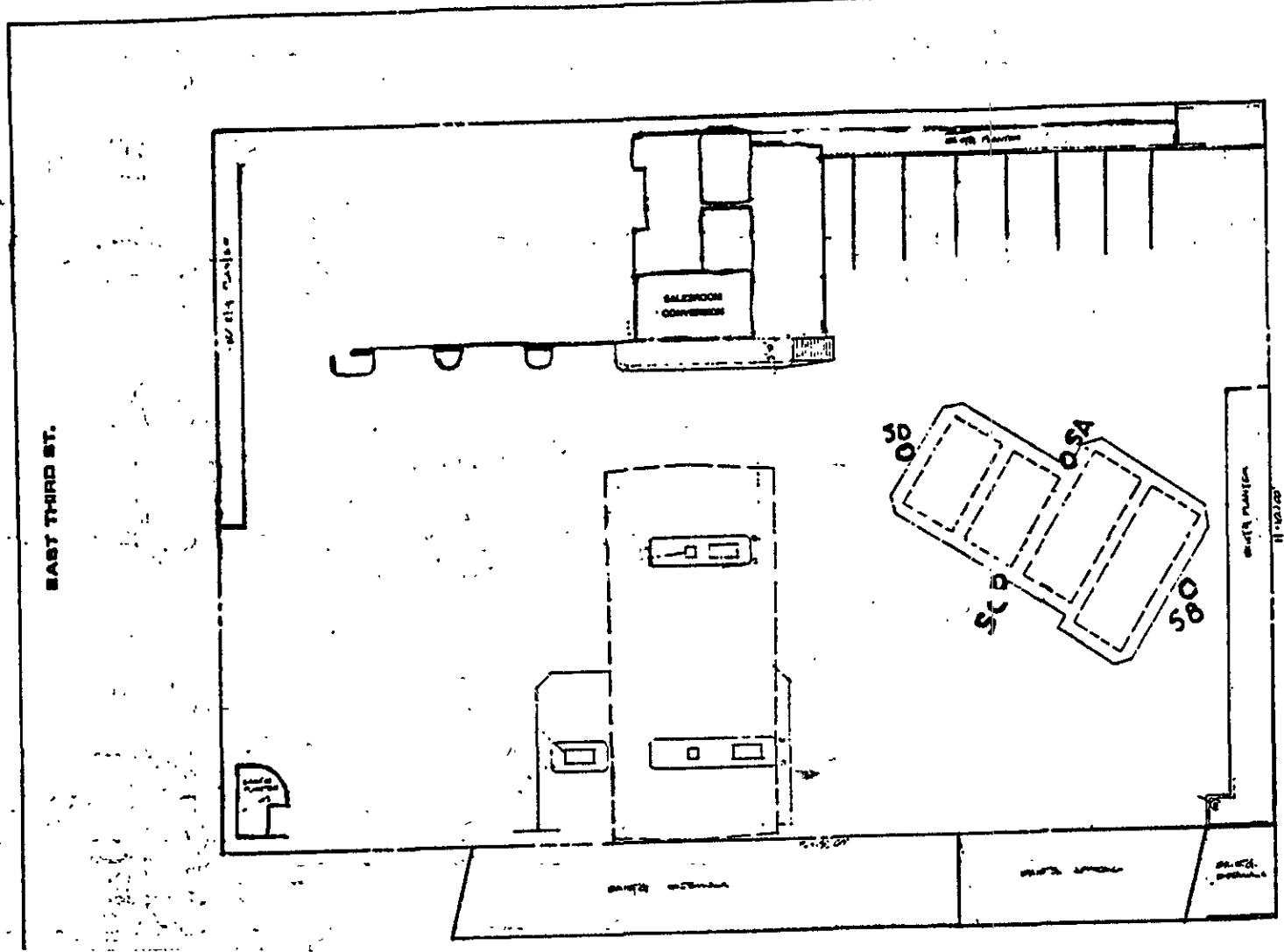

EAST THIRD ST.

SALESDROOM
CONVENIENCE

58
58A
58
58

SOUTH LIVERMORE AVE.

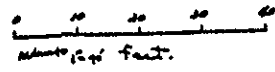

SITE MAP SHELL SERVICE STATION 318 So. Livermore Avenue Livermore, CA	
AEGIS JOB NO. 89-041	
DRAWN BY:	DATE:
REVIEWED BY:	DATE:

POST ON-SITE

FIELD INVESTIGATION TEAM
SITE HEALTH AND SAFETY PLAN

A. GENERAL INFORMATION

Client: SHELL OIL COMPANY

Aegis Project Number: 89-041

Site Name: Shell Service Station

Client Project Number: N/A

Street Address: 318 So. Livermore Ave, Livermore, CA

Plan Prepared by: Tracy Schilling

Date: 10/30/89

Approved by: Clarke Owen

Date: 11/2/89

Revised by:

Date:

Revision Approved by:

Date:

Objectives:

Phase I - Determine extent of petroleum hydrocarbons in
the soil.

Phase II -

Phase III -

Proposed Date of Investigation: 11/27/89

Hazard Summary/Level of Protection

A: _____ B: _____ C: _____ D: XX (with modifications)

B. SITE/WASTE CHARACTERISTICS

Waste/Contaminant Type(s): Liquid XX Soil Solid Sludge
 Gas

Characteristic(s): Corrosive XX Ignitable Radioactive
XX Volatile XX Toxic Reactive
 Unknown Other (Name):

Contaminant Source: Self serve retail gasoline station with three
underground fuel storage tanks.

Surrounding Features: Business District
-Rental Properties
-Commercial Properties

Status (active, inactive, unknown): Active

History (worker or non-worker injury; complaints from public;
previous agency action):

No known leaks or spills

C. HAZARD EVALUATION

Have all contaminants been identified that may be present on site?

Yes XX No _____ Unknown _____

List all chemicals below that have been identified or are suspected on site and their maximum concentrations in soil/water. Information on hazardous properties are listed in the appendix. For chemicals not shown in the appendix, enter the hazardous property information in the spaces provided.

<u>Chemical Name</u>	<u>Maximum Concentration :</u>	
	<u>In Soil</u>	<u>In Water</u>
Gasoline constituents	Unknown	NA

(ppm) = parts per million
(ppb) = parts per billion
NA =Not Applicable

Free product present? _____ Yes XX No

Type of product present: XX Leaded XX Unleaded _____ Diesel

P= results pending

D. SITE SAFETY WORK PLAN

PERSONNEL

<u>Team Member</u>	<u>Title</u>	<u>Responsibility</u>
Clarke Owen	Project Manager	Site Coordinator
Tracy Schilling	Staff Engineer	Project Engineer
Brian Garber	Geologist	Site Safety Officer

PERIMETER ESTABLISHED

Map/Sketch Attached?	Yes <u>xx</u>	No <u> </u>
Site Secured?	Yes <u> </u>	No <u>XX</u>
Perimeter Identified?	Yes <u>XX</u>	No <u> </u>
Zero line defined?	Yes <u> </u>	No <u>XX</u>
Free Product?	Yes <u> </u>	No <u> </u>
Dissolved Product?	Yes <u> </u>	No <u> </u>

INVESTIGATION-DERIVED MATERIAL DISPOSAL:

D1. PERSONAL SAFETY

SITE ENTRY PROCEDURES: Notify store manager

PERSONNEL PROTECTION:

Level of protection: A_____ B_____ C_____ D XX

Modifications:

1. All personnel must wear hard hat, safety shoes, safety glasses and/or face shield.
2. Neoprene gloves and tyvek/saranax suit should be worn if contact with contaminated water or soil is likely.
3. Hearing protection must be worn if noise levels prevent normal conversation at a distance of three feet. No smoking, eating, or drinking is allowed on site.
4. Respiratory protection is dependent on conditions listed in next section.
5. No personnel are to enter or approach any excavation area where there is a danger of wall collapse or confined space entry.

Surveillance Equipment and Materials:

<u>Instrumentation</u>	<u>Action Level</u>	<u>Action</u>
photoionization	5 units or 5 times background (breathing zone)	use halfmask respirator with organic cartridges
oxygen meter	<19. 5% oxygen	do not enter area or confined space until levels are reduced.
explosimeter	>10% LEL	eliminate all ignition sources and
	>20% LEL	reduce levels immediately or leave site.

First Aid Equipment: Standard first aid kit, portable eye wash.

First Aid Procedures:

Ingestion: DO NOT induce vomiting, summon medical help.

Inhalation: Move victim to fresh air, seek medical attention if needed.

Dermal Exposure: Remove contaminated clothing, flush with water.

DECONTAMINATION PROCEDURE:

Personnel: Flush exposed skin with soap and water.

WORK LIMITATIONS:(time of day, weather, heat/cold stress):

In high ambient temperatures, follow heat-stress precautions: Provide plenty of cool water and electrolytes (e.g., Gatorade), remove protective clothing during breaks: check resting pulse and increase number of breaks if pulse does not return to normal during work break.

In cold ambient temperatures (<35°F.), follow hypothermia precautions. Work may only progress during daylight hours or under conditions of adequate lighting.

ELECTRICAL HAZARDS:

Will be located by U.S.A. before drilling.

Maintain at least 10 feet clearance from overhead power lines. If unavoidably close to overhead or buried power lines, turn power off and lockout circuit breaker. Avoid standing in water when operating electrical equipment.

CONFINED SPACES:

Monitor organic vapors and oxygen before entering. If the following values are exceeded, do not enter.

1. Oxygen < 20.0%.
2. Total hydrocarbons > 5 ppm above background, if all air contaminants have not been identified.
3. Concentrations of specific air contaminants exceeding action levels in Section D, if all air contaminants have been identified.

If entering a confined space, monitor oxygen and organic vapors continuously.

AGENCIES CONTACTED IN UNDERGROUND UTILITY SEARCH:

SHELL OIL COMPANY
Underground Service Alert (USA)

E. EMERGENCY INFORMATION

LOCAL TELEPHONE NUMBERS (provide area codes):

Ambulance	911
Hospital Emergency Room	(415) 447-7000 (Valley Mem.)
Poison Control Center	1-800-523-2222
Fire Department	911
Airport	(415) 443-1600 (Municipal)
Explosives Unit	911

SITE RESOURCES:

Water supply available on site:	Yes <u>XX</u>	No <u> </u>
Telephone available on site:	Yes <u>XX</u>	No <u> </u>
Bathrooms available on site:	Yes <u>XX</u>	No <u> </u>
Other resources available on site:	Yes <u>XX</u>	No <u> </u>

If yes, identify: Electricity

If you answered "no" to any of the above questions, identify the closest available facility, and provide directions.

EMERGENCY CONTACTS

PHONE NO.

1. Project Manager: Clarke Owen	(916) 782-2110
2. Health and Safety Officer: Brian Garber	(916) 782-2110
4. Site Contact: Bert Russel	(916) 488-1309
5. Regulatory Contact: Lowell Miller	(415) 271-4320

F. EMERGENCY ROUTES

(Give name address, telephone number, directions, distance and time estimate, and map.)

HOSPITAL: Valley Memorial Hospital
1111 East Stanley Blvd., Livermore, CA
(415) 447-7000

North on So. Livermore Ave. through two stop lights to Railroad Ave.
Make a left onto Railroad Ave.
Railroad Ave. turns into Stanley Blvd.
Hospital is on the left side of the street across from K-mart.

Distance Approx.: 5 miles
Approx. travel time 10 minutes.

OTHER

G. HAZARD EVALUATION

PARAMETER PLOSIVITY	TLV (ppm)	OT (ppm)	IDLH (ppm)	VOLA- TILITY	SKIN HAZARD	EX-
Benzene	0.1	4	2,000	H	L	H
Ethylbenzene	100	NS	2,000	M	L	H
Toluene	100	2	2,000	M	L	H
Xylene	100	<1	10,000	H	M	H
Gasoline	300	NS	NS	H	L	H

KEY:

OT = Odor Threshold
 TL = Threshold Limit Value (Worker - 8 Hours)
 IDLH = Immediately Dangerous to Life and Health
 NS - None Specified H - High M - Medium
 NR - Not Reported L - Low U - Unknown

H. HAZARDOUS PROPERTY INFORMATION
Explanations and footnotes

Water solubility is expressed in different terms in different references. Many references use the term "insoluble" for materials that will not readily mix with water, such as gasoline. However, most of these materials are water soluble at the part per million or part per billion level. Gasoline for example, is insoluble in the gross sense, and will be found as a discreet layer on top of the ground water. But certain gasoline constituents, such as benzene, toluene, and xylene will also be found in solution in the ground water at the part per million or part per billion level.

- A. Water solubility expressed as 0.2g means 0.2 grams per 100 grams water at 20°C.
- B. Solubility of metals depends on the compound in which they are present.
- C. Several chlorinated hydrocarbons exhibit no flash point in conventional sense, but will burn in presence of high energy ignition source or will form explosive mixtures at temperatures above 200°F.
- D. Practically non-flammable under standard conditions.
- E. Expressed as mm Hg under standard conditions
- F. Explosive concentrations of airborne dust can occur in confined areas.
- G. Values for Threshold Limit Value - Time Weighted Average (TLV-TWA) are OSHA Permissible Exposure Limits (PEL) except where noted in H. and I.
- H. TLV - TWA adopted by the American Conference of Government Industrial Hygienists (ACGIH) which is lower than the OSHA PEL.
- I. TLV - TWA recommended by the National Institute for Occupational Safety and Health (NIOSH). A TLV or PEL has not been adopted by the ACGIH or OSHA.
- J.
 - A. - Corrosive
 - B. - Flammable
 - C. - Toxic
 - D. - Volatile

- E. - Reactive
- F. - Radioactive
- G. - Carcinogen
- H. - Infectious

K. Dermal Toxicity data is summarized in the following three categories:

1. Skin penetration

- A -negligible penetration (solid-polar)
- + B -slight penetration (solid-nonpolar)
- ++ C -moderate penetration(liquid-nonpolar)
- +++ D -high penetration (gas/liquid-nonpolar)

ROBERT H. LEE & ASSOCIATES, INC.
 900 Larkspur Landing Circle
 Suite 125
 LARKSPUR, CALIFORNIA 94939

LETTER OF TRANSMITTAL

(415) 461-8890

TO ALAMEDA CO. HEALTH
HAZARDOUS MATERIALS DIV.

DATE	7-5-89	JOB NO.	6837
ATTENTION	LOWELL MILLER		
RE	TANK REMOVAL & INSTALLATION		
	AT		
	SHELL SERVICE STATION		
	318 S. LIVERMORE AVE.		
	LIVERMORE, CA		

WE ARE SENDING YOU Attached Under separate cover via _____ the following items:

- Shop drawings Prints Plans Samples Specifications
 Copy of letter Change order _____

COPIES	DATE	NO.	DESCRIPTION

ALAMEDA COUNTY
 DEPT. OF ENVIRONMENTAL HEALTH
 HAZARDOUS MATERIALS

THESE ARE TRANSMITTED as checked below:

- For approval Approved as submitted Resubmit _____ copies for approval
 For your use Approved as noted Submit _____ copies for distribution
 As requested Returned for corrections Return _____ corrected prints
 For review and comment _____
 FOR BIDS DUE _____ 19____ PRINTS RETURNED AFTER LOAN TO US

REMARKS PER OUR TELEPHONE CONVERSATION ON 7-5-89
I'VE SENT YOU 3 COPIES OF PAGE 3 OF THE
CLOSURE PLAN SPECIFYING WHERE THE SOIL SAMPLES
WILL BE TAKEN. PLEASE ADVISED ME WHEN THE
PERMIT HAS BEEN APPROVED AND READY FOR PICK UP.

COPY TO _____

SIGNED: Lee E Swardson

12. Sample Collector

Name _____
 Company KAPREALIAN ENGINEERING
 Address P.O. Box 913
 City BENICA State CA Zip 94510 Phone (707) 746-6915

13. Sampling Information for each tank or area

Tank or Area		Material sampled	Location & Depth
Capacity	Historic Contents (past 5 years)		
5,000	GASOLINE	NATIVE SOIL	2 FEET BENEATH REMOVED TANK, 1 SAMPLE AT EACH END OF EACH TANK AND EVERY 20 LINEAR FEET FOR PIPING.
5,000	GASOLINE	"	
8,000	GASOLINE	"	
8,000	GASOLINE	"	

14. Have tanks or pipes leaked in the past? Yes [] No []

If yes, describe. UNKNOWN

15. NFPA methods used for rendering tank inert? Yes [X] No []

If yes, describe. ADDING 1.5 lbs. OF DRY ICE PER 100 GALLONS OF TANK CAPACITY.

An explosion proof combustible gas meter shall be used to verify tank inertness.

16. Laboratories

Name SEQUOIA ANALYTICAL LABS
 Address 2549 MIDDLEFIELD ROAD
 City REDWOOD CITY State CA Zip 94063
 State Certification No. 145

ROBERT H. LEE & ASSOCIATES, INC.
 900 Larkspur Landing Circle
 Suite 125
 LARKSPUR, CALIFORNIA 94939

LETTER OF TRANSMITTAL

(415) 461-8890

DATE	6-12-89	JOB NO.	6837
ATTENTION	DENNIS BYRNE		
RE.	TANK REMOVAL & INSTALLATION		
	AT		
	SHELL SERVICE STATION		
	318 S. LIVERMORE		
	LIVERMORE, CA		

TO ALAMEDA CO. HEALTH DEPT.
HAZARDOUS MATERIALS DIVISION
OAKLAND, CA

WE ARE SENDING YOU Attached Under separate cover via _____ the following items:

- Shop drawings Prints Plans Samples Specifications
 Copy of letter Change order _____

COPIES	DATE	NO.	DESCRIPTION
3			CLOSURE PLAN
3			SITE SAFETY PLAN
3		A-O	PLOT PLAN (SHOWING TANKS TO BE REMOVED)
3		SETS	TANK INSTALLATION
1			CK. FOR 831. ⁰⁰ FEE FOR REMOVAL (No. 3363)
1			CK FOR 663. ⁰⁰ FEE FOR INSTALLATION (No. 3364)

THESE ARE TRANSMITTED as checked below:

- For approval Approved as submitted Resubmit _____ copies for approval
 For your use Approved as noted Submit _____ copies for distribution
 As requested Returned for corrections Return _____ corrected prints
 For review and comment _____
 FOR BIDS DUE _____ 19 _____ PRINTS RETURNED AFTER LOAN TO US

REMARKS

PLEASE RETURN A RECEIPT FOR EACH CHECK TO ME.

LEE E. SWARDSON

COPY TO STAN ROLLER

SIGNED: Lee E. Swardson

Shell Oil Company

One Shell Plaza
P O Box 2463
Houston, Texas 77252

J. C. Jacobsen
Vice President
Finance

April 20, 1989

I am the chief financial officer of Shell Oil Company, P. O. Box 2463, Houston, Texas 77252. This letter is in support of the use of the financial test of self-insurance to demonstrate financial responsibility for taking corrective action and/or compensating third parties for bodily injury and property damage caused by sudden accidental releases and/or nonsudden accidental releases in the amount of at least \$1,000,000 per occurrence and \$2,000,000 annual aggregate arising from operating underground storage tanks (UST).

Underground storage tanks at the following facilities are assured by this financial test or a financial test under an authorized state program by this owner or operator:

All tanks are assured by this financial test:

See Attachment A for Retail Locations;
See Attachment B for Distribution Locations;
See Attachment C for Manufacturing Locations;
See Attachment D for All Other Locations.

A financial test is also used by this owner or operator to demonstrate evidence of financial responsibility in the following amounts under other EPA regulations or state programs authorized by EPA under 40 CFR Parts 271 and 145:

<u>EPA Regulations</u>	<u>California Amount</u>
Closure (Sec. 264.143 and Sec. 265.143)	\$ -
Post-Closure Care (Sec. 264.145 and Sec. 265.145)	\$ -
Liability Coverage (Sec. 264.147 and Sec. 265.147)	\$ -
Corrective Action (Sec. 264.101(b))	\$ -
Plugging and Abandonment (Sec. 144.63)	\$ -
Closure	\$39,702,351
*Post-Closure Care	\$42,451,345
Liability Coverage	\$10,000,000
Corrective Action	\$ -
Plugging and Abandonment	\$ 1,012,257
Total	\$93,165,953

*30 Year Post-Closure Care

BQM08901105 - 0001.0.0

This owner or operator has not received an adverse opinion, a disclaimer of opinion, or a "going concern" qualification from an independent auditor on his financial statements for the latest completed fiscal year*.

Alternative I

1. Amount of annual UST aggregate coverage being assured by a financial test, and/or guarantee.	\$	2,000,000	
2. Amount of corrective action, closure and post-closure care costs, liability coverage, and plugging and abandonment costs covered by a financial test, and/or guarantee.	\$	93,165,953	
3. Sum of lines 1 and 2.	\$	95,165,953	
4. Total tangible assets*.	\$	27,169,000,000	
5. Total liabilities*.	\$	11,788,000,000	
6. Tangible net worth* (subtract line 5 from line 4).	\$	15,381,000,000	
		<u>Yes</u>	<u>No</u>
7. Is line 6 at least \$10 million?		<u>X</u>	<u> </u>
8. Is line 6 at least 10 times line 3?		<u>X</u>	<u> </u>
9. Have financial statements for the latest fiscal year been filed with the Securities and Exchange Commission*?		<u>X</u>	<u> </u>
10. Have financial statements for the latest fiscal year been filed with the Energy Information Administration?		<u>N/A</u>	<u> </u>
11. Have financial statements for the latest fiscal year been filed with the Rural Electrification Administration?		<u>N/A</u>	<u> </u>
12. Has financial information been provided to Dun and Bradstreet, and has Dun and Bradstreet provided a financial strength rating of 4A or 5A?		<u> </u>	<u>X</u>

*Period ended December 31, 1988.

Alternative II

- 1. Amount of annual UST aggregate coverage being assured by a test and/or guarantee. \$
 - 2. Amount of corrective action, closure and post-closure care costs, liability coverage, and plugging and abandonment costs covered by a financial test, and/or guarantee. \$
 - 3. Sum of lines 1 and 2. \$
 - 4. Total tangible assets*. \$
 - 5. Total liabilities*. \$
 - 6. Tangible net worth (subtract line 5 from line 4)*. \$
 - 7. Total assets in the U.S. \$
- | | Yes | No |
|---|----------|-------|
| 8. Is line 6 at least \$10 million? | _____ | _____ |
| 9. Is line 6 at least 6 times line 3? | _____ | _____ |
| 10. Are at least 90 percent of assets located in the U.S. (if "No", complete line 11)? | _____ | _____ |
| 11. Is line 7 at least 6 times line 3 (fill in either lines 12-15 or lines 16-18)? | _____ | _____ |
| 12. Current assets. | \$ _____ | |
| 13. Current liabilities. | \$ _____ | |
| 14. Net working capital (subtract line 13 from line 12). | \$ _____ | |
| | Yes | No |
| 15. Is line 14 at least 6 times line 3? | _____ | _____ |
| 16. Current bond rating of most recent bond issue? | _____ | |
| 17. Name of rating service. | _____ | |
| 18. Date of maturity of bond. | _____ | |
| 19. Have financial statements for the latest fiscal year been filed with the SEC, the Energy Information Administration, or the Rural Electrification Administration? | _____ | _____ |

*Latest 1988

I hereby certify that the wording of this letter is identical* to the wording specified in 40 CFR Part 280.95(d) as such regulations were constituted on the date shown immediately below.

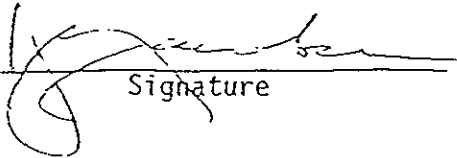

Signature

J. C. Jacobsen

Name

Vice President Finance

Title

April 20, 1989

Date

Attachments

*Typographical errors have been corrected; explanatory footnotes have been added where appropriate.

CERTIFICATION OF FINANCIAL RESPONSIBILITY

Shell Oil Company hereby certifies that it is in compliance with the requirements of Subpart H of 40 CFR Part 280.

The financial assurance mechanism used to demonstrate financial responsibility under Subpart H of 40 CFR Part 280 is as follows:

Financial test of self-insurance per 40 CFR Sec. 280.95.

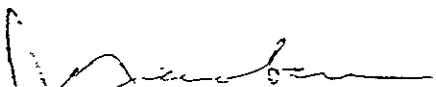

Shell Oil Company
J. C. Jacobsen
Vice President Finance
April 20, 1989



S. H. Hillman
April 20, 1989

CALIFORNIA REGIONAL WATER QUALITY CONTROL BOARD

SAN FRANCISCO BAY REGION

1111 JACKSON STREET, ROOM 6040

OAKLAND 94607

Phone Area Code 415
464-1235April 13, 1987
File No. 1123.64 (TJC)

TO: LOCAL AGENCIES IMPLEMENTING UNDERGROUND TANK PROGRAMS
RE: ADDITIONAL GUIDELINES FOR REMOVAL OF UNDERGROUND WASTE OIL TANKS

The purpose of this letter is to clarify the analytical procedures to be used for soil samples taken during waste oil tank removals as specified in my letter dated February 26, 1987.

The EPA Method 8240 analysis specified entails a search for a standard list of volatile priority-pollutants. In addition, the ten largest chromatographic peaks that are not included in the standard priority pollutant list should be identified.

If you have any questions please contact Peter Johnson of our Local Program Coordination Section at (415) 464-0838.

Sincerely,

Roger B. James
Executive Officer

cc: Local Agencies

Copy for Larry S.

CALIFORNIA REGIONAL WATER QUALITY CONTROL BOARD
SAN FRANCISCO BAY REGION
1111 JACKSON STREET, ROOM 6040
OAKLAND 94607

Phone: Area Code 415
464-1255



February 26, 1987
File No. 1123.64 (TJC)

TO: LOCAL AGENCIES IMPLEMENTING UNDERGROUND TANK PROGRAMS
RE: GUIDELINES FOR REMOVAL OF UNDERGROUND WASTE OIL TANKS

The purpose of this letter is to provide guidance to local agencies regarding the removal of underground waste oil tanks. The following guidelines are in addition to the investigation and cleanup procedures specified in our "Guidelines for Addressing Fuel Leaks", September 1985. Waste oil tanks are used to store a variety of motor oils, however other materials are often discharged to these tanks such as degreasing agents and cleaning solvents. We have discovered instances where chlorinated solvents have been released from waste oil tanks into the surrounding soil and groundwater. We have also found that the heavier oil fractions are more mobile than previously assumed.

A soil sample is required from beneath each waste oil tank that is removed. In general, one soil sample is sufficient for performing analytical tests for a standard size (500 gal.) waste oil tank. However, for larger tanks more samples may be necessary. All samples must be analyzed by a certified analytical laboratory, and should be accompanied by an appropriate chain of custody document. Various field measurements (visual observations, odor, combustible gas readings) may be helpful in evaluating the nature and extent of soil contamination, however, the use of these methods does not obviate the need for the laboratory analyses of soil samples in all cases.

The following analyses should be performed on soil samples taken from waste oil tank excavations.

1. TOTAL PETROLEUM HYDROCARBONS (TPH, high boiling fraction as specified in Attachment 2 of our Guidelines)
2. TOTAL OIL & GREASE (TOG, using solvent extraction {EPA Method 3550}, and gravimetric determination by Standard Method 503E)
3. VOLATILE ORGANIC COMPOUNDS (VOC's, using EPA method 8240, or 8010 and 8020)

\$ 3.00
Avoid Asphalt and Surfactants

The results of the above analyses will be used to determine if additional investigation and cleanup is required. One key element

of the investigation requirements, as described in the Guidelines, is the need to determine if groundwater has been impacted.

When soil samples reveal that total oil & grease (TOG), or total petroleum hydrocarbons (TPH) are in excess of 100 ppm, or if volatile organic compounds (VOC) are present in any detectable concentration, a soil boring/monitoring well must be installed. Specifications for the installation of soil borings and monitoring wells are contained in Attachment 1 of our Guidelines.

If you have any questions concerning this matter please contact Tom Callaghan at (415) 464-0787.

Sincerely,



Roger B. James
Executive Officer

cc: Local Agency List
Certified Laboratory List

RWQCB CHECKLIST FOR SOIL AND GROUNDWATER
SAMPLING DURING TANK REMOVAL

SITE NAME: _____
SITE ADDRESS: _____

YES NO N/A

- | | | | |
|--|-----|-----|-----|
| 1) Inventory records have been reviewed for the three month period prior to removal. | --- | --- | --- |
| 2) The tanks were visually inspected for holes or leakage upon removal. | --- | --- | --- |
| 3) The associated piping was visually inspected for holes or leaks. | --- | --- | --- |
| 4) The excavation was visually inspected for evidence of leakage (i.e. stained soil, free product). | --- | --- | --- |
| 5) Two soil samples for total petroleum hydrocarbons (TPH) analysis were obtained from beneath each fuel tank. | --- | --- | --- |
| 6) Appropriate sampling and handling techniques were used. | --- | --- | --- |
| 7) For waste oil tanks, one soil sample was collected from the most obviously contaminated area to be analyzed for TPH, oil/grease, and volatile organic compounds (EPA 8240). | --- | --- | --- |
| 8) A representative sample of the suspect fuel was obtained for laboratory test calibration. (If available) | --- | --- | --- |
| 9) In cases where a high water table exists resulting in water in the excavation, soil samples from the sidewalls and a water sample were obtained. | --- | --- | --- |
| 10) A site plan indicating sampling locations was prepared. | --- | --- | --- |
| 11) Samples were submitted to a certified laboratory using a chain of custody record which indicated the analysis to be performed. | --- | --- | --- |
| 12) An Unauthorized Release Form was completed and sent to the RWQCB for cases where detectable concentrations of contaminants were found. | --- | --- | --- |
| 13) Copies of the following documents were sent to the RWQCB: | | | |
| -Summary of the inventory review findings. | --- | --- | --- |
| -Visual inspection report. | --- | --- | --- |
| -Sampling and handling procedures. | --- | --- | --- |
| -Site plan with sampling locations. | --- | --- | --- |
| -Laboratory results with chain of custody records. | --- | --- | --- |
| -Other pertinent information or consultant reports. | --- | --- | --- |

COMMENTS: _____

ADDENDA TO SPECIFICATIONS
FOR PETROLEUM TANK INSTALLATION

VADJ. 11/11/11
10/11/11
11/11/11

1) TEST PROCEDURES

The General Contractor is to include in his bid the cost for completion of the following test procedures. Tests, with the exception of the Liquid Blockage and Pressure Decay Tests, are to be performed by Hunter Environmental. General Contractor to contact Jerry Wright, (800) 247-9014, to obtain quotes for inclusion in your bid submittal.

- A. Fill system with water after tanks have been backfilled. Prior to completion of top off and flooding of the vapor recovery lines, perform a liquid blockage and pressure decay test on the vapor lines using nitrogen.
- B. Upon successful completion of the nitrogen test complete filling of the system with water and perform a full system precision test. Precision testing must be completed with a dry annular space.
- C. Perform a 5 psi max. pressure test on the secondary containment lines.
- D. Pour concrete slabs and pump out water.
- E. Fill tanks with product. Energize and purge system.
- F. Perform a 50 psi min. Petro-tite line test on product lines.
- G. Upon successful completion of line test perform a Red Jacket Leak Detector Test.
- H. Perform a complete monitoring system test.

11/11/11
11/11/11

Notify all required agencies of successful completion of applicable tests and submit copies of results.

- a. County Health Department - Full System Precision Test results, Petro-tite Line Tests, and Secondary Containment Pressure Test.
- b. BAAQMD - Liquid Blockage and Pressure Decay Test.

Send copies of all tests to SHELL OIL COMPANY District Engineer.

- 2. UNDERGROUND TANKS

(Tanks also means all vent, vapor, and product lines). To assist the General Contractor in legally and properly removing and disposing of the gasoline and (if applicable) waste oil tanks, Shell will hire a directly paid Hazardous Waste Contractor (HWC). The HWC is also responsible for taking all soil samples and having them analyzed as required by Health, Fire, and Water Departments. General Contractor will coordinate site cleaning through Shell Engineering Department with the Hazardous Materials Contractor, Shell's Hazardous Materials Coordinator, and Shell Dispatch.

- A. Gasoline tanks will be pumped empty of all product that can be removed by a pump out truck and the product returned to Shell Distribution Facility. Shell Dispatch will assign pumper trucks for this task at Shell's expense.
- B. General Contractor will remove subpumps and drop tubes and disconnect dispenser from vapor and product lines. All product in the lines to be dumped into now empty fuel tanks.
- C. General Contractor shall also remove and dispose of water from annular spaces prior to removal of tanks.
- D. Hazardous Waste Contractor will wash out product lines and vapor recovery lines with at least two gallons of water per ten linear feet of line. All water/product mixture to be deposited in empty gasoline tanks with sufficient water under pressure to adequately degas tanks in accordance with local ordinances (use dry ice if necessary). The Hazardous Waste Contractor will execute and comply with the owner's/company's tank disposal procedures and with governmental authorities having jurisdiction over such work. Cleaning and removal shall at a minimum comply with NFPA Standard No. 327. Hazardous Materials Contractor will vacuum the water product mixture from the station site for delivery to Shell refinery. Hazardous Materials Coordinator will provide Bill of Lading for hauling.

NOTE: Do not introduce compressed air into lines for purpose of evacuating product from lines.

- E. General Contractor will remove tank slab and over burden to expose top of tanks and shall remove fill (drop) tube, disconnect fill, gauge, product, vent and vapor recovery lines.

- J. General Contractor shall excavate soil to extend directed by Hazardous Materials Contractor and place within barriers. A unit price shall be submitted for turning soil to promote aeration, as directed by Hazardous Materials Contractor. When soil is determined to be sufficiently aerated by the Shell Soil Engineer, it will be transported to Class III dump site by General Contractor. Submit unit price for soil hauling (see Unit Price List for complete list and description).

BID BREAKDOWNTANK REMOVALS

NOTE: This form must be completed and submitted as part of the Bid Quotation.

BASE BID

1. Trench, Excavation/Removal	\$ _____
2. Back-Fill with Pea Gravel	\$ _____
3. Gasoline/VR Plumbing	\$ _____
4. Electrical	\$ _____
5. Concrete	\$ _____
6. A.C. Paving	\$ _____
7. Dispenser Installation	\$ _____
8. Supervision	\$ _____
9. Overhead/Profit	\$ _____
TOTAL BID PRICE	\$ _____

In addition to the Base Bid, General Contractor shall supply price quotes for the following:

ALTERNATE BID

1. Soil Aeration (On Site)	
Loader	\$ _____/hr. Rate
Labor	\$ _____/hr. Rate
TOTAL	\$ _____/hr. Rate

2. Disposal Rate (Off Hauling)

Truck & Trailer
With Driver \$ _____/hr. Rate

Loader & Operator \$ _____/hr. Rate

TOTAL \$ /hr. Rate

3. Shoring - Cost per
lineal foot to provide
and install shoring
for tank hole: \$ _____ per lin. ft.

4. Backfill - Cost
per cu. yard for
crushed rock
backfill of
tank hole to
95% compaction: \$ _____ per cu. yd.