

710
ST 10 10 68

**EXXON COMPANY, U.S.A.
QUARTERLY SUMMARY REPORT**

October - December 1992

Date: December 31, 1992

RAS # 7-0236
6630 East 14th Street
Oakland, California
Proj. No. 30-0491-01

WORK PERFORMED THIS QUARTER

1. Completed quarterly ground water monitoring and sampling October 13, 1992.

**QUARTERLY GROUND WATER SAMPLING RESULTS (ug/L)
(SAMPLED 10/13/92)**

WELL ID	B	T	E	X	TPH G	TPH D	TOG	HVOC	↕
MW-1	<0.5	<0.5	<0.5	<0.5	<50	<50	<5000	ND	-
MW-2	97	2.6	97	53	3200	1900	<5000	ND	↓
MW-3	5.5	<0.5	4.6	1.1	1100	400	---	ND	↓
MW-4	<0.5	<0.5	<0.5	<0.5	<50	<80	---	---	-
MW-5	<0.5	<0.5	<0.5	<0.5	69	<50	---	---	-
MW-6	<0.5	<0.5	<0.5	<0.5	<50	<50	---	---	-
MW-7	0.8	<0.5	<0.5	2.5	670	94	---	---	↑

- ↕ Recent historical trend
- ↑ Concentrations generally increased from recent historical trend
- ↓ Concentrations generally decreased from recent historical trend
- Concentrations generally unchanged from recent historical trend
- Not analyzed
- ND Not detected at or above various detection limits

FREE PHASE PRODUCT RECOVERY

Not Applicable

WORK TO BE PERFORMED NEXT QUARTER

Activity	Estimated Completion Date
1. Conduct quarterly fluid-level monitoring and ground water sampling.	March 1993

WORK TO BE PERFORMED NEXT 12 MONTHS

Activity	Estimated Completion Date
1. Submit a proposal for subsurface testing and generation of a feasibility study/remedial work plan.	March 1993
2. Continue quarterly fluid-level monitoring, and ground water sampling.	December 1993

FOR EXXON INTERNAL USE ONLY:

Date Report Submitted: December 31, 1992
Quarter Ending: December 1992
Exxon RAS #: 7-0236

Regulatory Agencies Involved:

Agency	Contact
Alameda County Hazardous Materials Division	Britt Johnson
Regional Water Quality Control Board	Eddy So

Contract and Budget Information:

Consultant: Alton Geoscience

Project Manager: John DeGeorge
Project Number: 30-0491-01
Project Phase: Supplemental Site Investigation
Project Start Date: 8/91

Original Budget Authorized: \$17,050 (Preliminary Site Investigation)
Additional Budgets Approved: \$20,300 (Supplemental Site Investigation)
\$12,700 (Quarterly Sampling Program)

Total Budget Authorized to Date: \$50,050

Total Cost Spent to Date: \$46,000 (approximate)

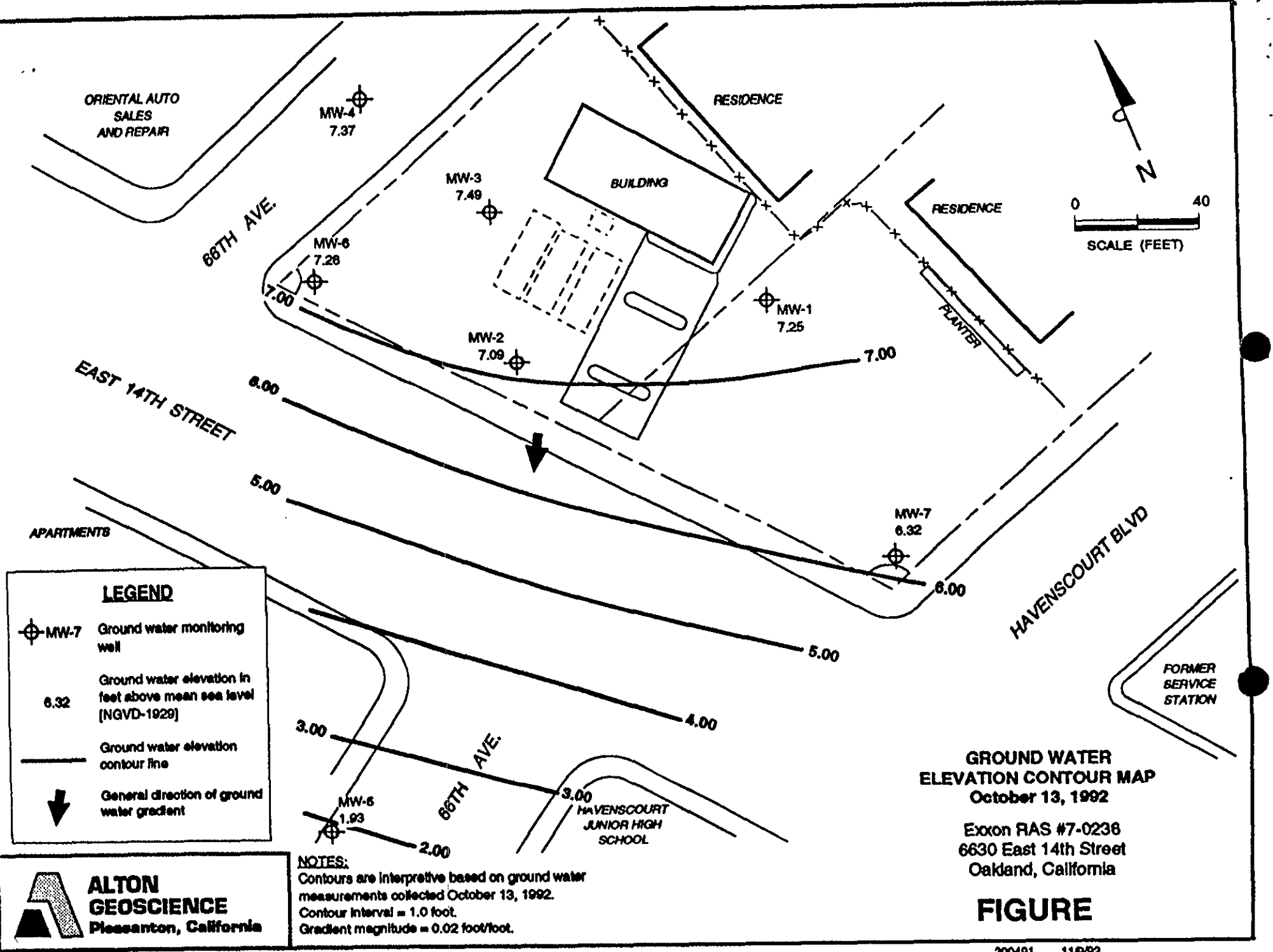

LEGEND

- MW-7 Ground water monitoring well
- 6.32 Ground water elevation in feet above mean sea level [NGVD-1929]
- Ground water elevation contour line
- General direction of ground water gradient

NOTES:
 Contours are interpretive based on ground water measurements collected October 13, 1992.
 Contour interval = 1.0 foot.
 Gradient magnitude = 0.02 foot/foot.

GROUND WATER ELEVATION CONTOUR MAP
 October 13, 1992

Exxon RAS #7-0236
 6630 East 14th Street
 Oakland, California

FIGURE

ALTON GEOSCIENCE
 Pleasanton, California

**EXXON COMPANY, U.S.A.
QUARTERLY SUMMARY REPORT**

July - September 1992

Date: October 5, 1992

5510
7068

RAS # 7-0236
6630 East 14th Street
Oakland, California
Proj. No. 30-0491-01

WORK PERFORMED THIS QUARTER

1. Completed quarterly ground water monitoring and sampling July 8, 1992.
2. Removed obstruction from monitoring well MW-5 on September 10, 1992.
3. Completed and mailed supplemental site investigation report June 17, 1992.

QUARTERLY GROUND WATER SAMPLING RESULTS (ug/L)
(SAMPLED 07/08/92)

WELL ID	B	T	E	X	TPH G	TPH D	TOG	HVOC	‡
MW-1	<0.5	<0.5	<0.5	<0.5	<50	<50	<5000	ND	-
MW-2	250	14	300	160	7000	2100	<5000	ND	↓
MW-3	<0.5	2.6	12	3.7	2900	960	<5000	ND	↑
MW-4	<0.5	<0.5	<0.5	<0.5	<50	<50	---	---	-
MW-5	---	---	---	---	---	---	---	---	-
MW-6	<0.5	<0.5	<0.5	<0.5	<50	<50	<5000	ND	-
MW-7	<0.5	<0.5	<0.5	<0.5	<50	<50	---	---	-

- ‡ Recent historical trend
- ↑ Concentrations generally increased from recent historical trend
- ↓ Concentrations generally decreased from recent historical trend
- Concentrations generally unchanged from recent historical trend
- Not analyzed
- ND Not detected at or above various detection limits

Exxon, 6630 E14th St., Oakland, 94621 - LOP 1068

Awaiting results of PSA done in April of 1992.

TP

FREE PHASE PRODUCT RECOVERY

Not Applicable

WORK TO BE PERFORMED NEXT QUARTER

Activity	Estimated Completion Date
1. Conduct quarterly fluid-level monitoring and ground water sampling.	October 1992

WORK TO BE PERFORMED NEXT 12 MONTHS

Activity	Estimated Completion Date
1. Submit a proposal for subsurface testing and generation of a feasibility study/remedial work plan.	March 1993
2. Continue quarterly fluid-level monitoring, and ground water sampling.	March 1993