

[ENVIRONMENTAL RESOLUTIONS, INC.]
[74 Digital Drive, Suite 6]
[Novato, CA 94949]
[(415) 382-5991]
[fax (415) 382-1856]

fax

To: Kevin Tinsley

Fax #: 510-337-9335

From: Marc Briggs

Date: June 25, 1997

Subject: Former Exxon Service Station 7-0236

Pages: 2

NOTE

Please call to discuss
Thanks for your time

6630 East 14th Street - MWM Properties
6000 - SMITH VRI

39-3246-27-1
39-3246-29

6630 East 14th
10 Crest Road
SAN ANSELMO CA
94960

6600 East 14th
~~3939~~
3939 WACNOT AV
CARMICHAEL CA
95608

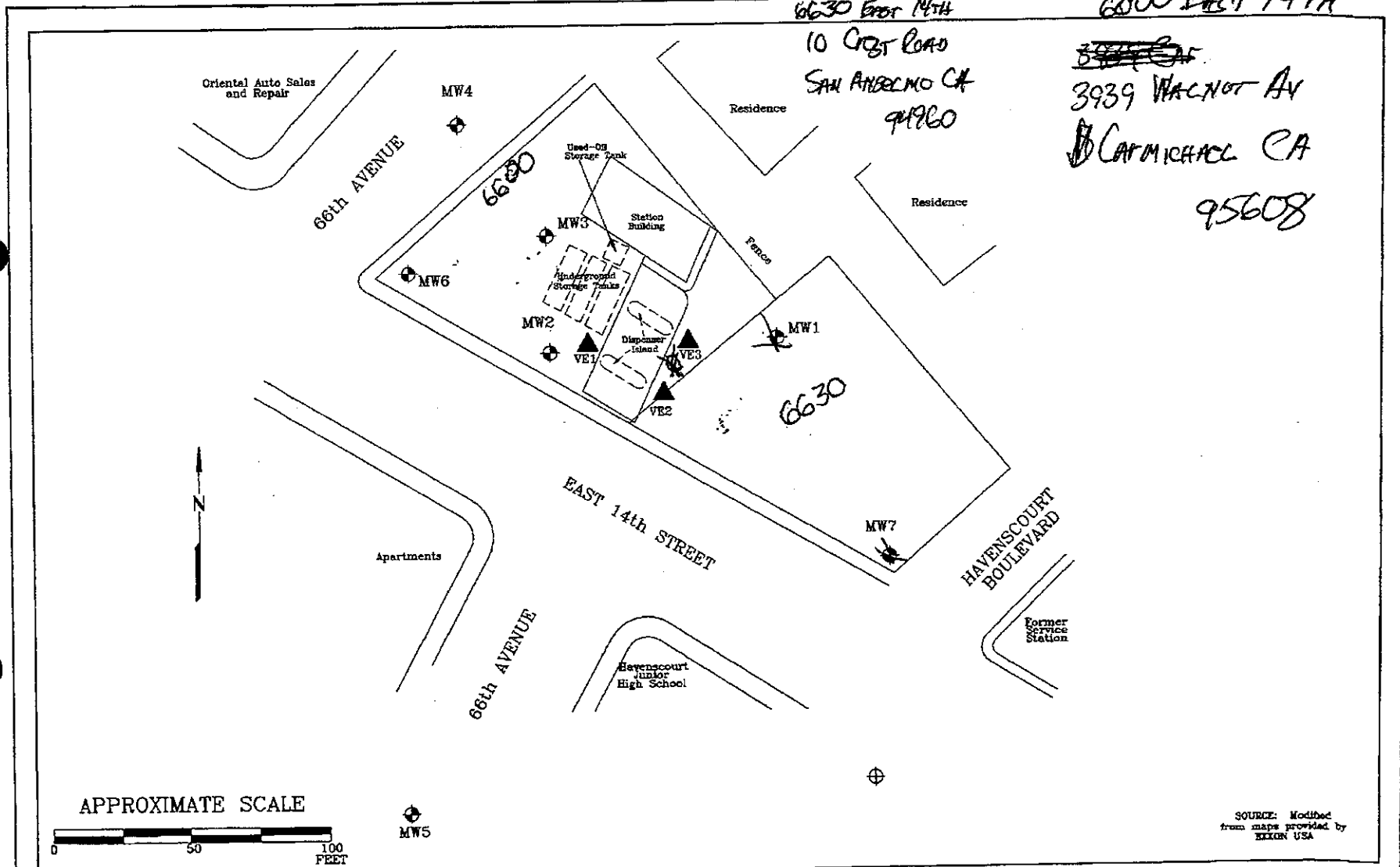

APPROXIMATE SCALE

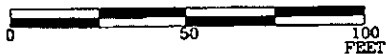

SOURCE: Modified from maps provided by EXXON USA

FN 20090002



GENERALIZED SITE PLAN

EXXON SERVICE STATION 7-0236
6630 East 14th Street
Oakland, California

EXPLANATION

- ⊕ Groundwater Monitoring Well
MW7
- ▲ Vapor Extraction Well
VE3
- ⊕ Proposed Groundwater Monitoring Well

PROJECT NO.

2009

PLATE

2

DATE: 9/16/96

002

ERI Novato Office

06/25/97 WED 10:51 FAX 1 415 382 1856

FAX TRANSMITTAL



RESNA, INC.
73 Digital Drive
Novato, California 94949
415/382-7400 Fax: 415/382-7415

Attn	Eva Chu
Organization	Alameda County Health Department
From	12/30/93
Date	Justin Power
Project Name/No.	Exxon 7-0236
No. Pages (including Transmittal)	3

Enclosed

Plates as requested.

Comments

If you have any trouble with this transmittal, please contact us at the above telephone number.

9796 **Fax to:** (510) 569 4757

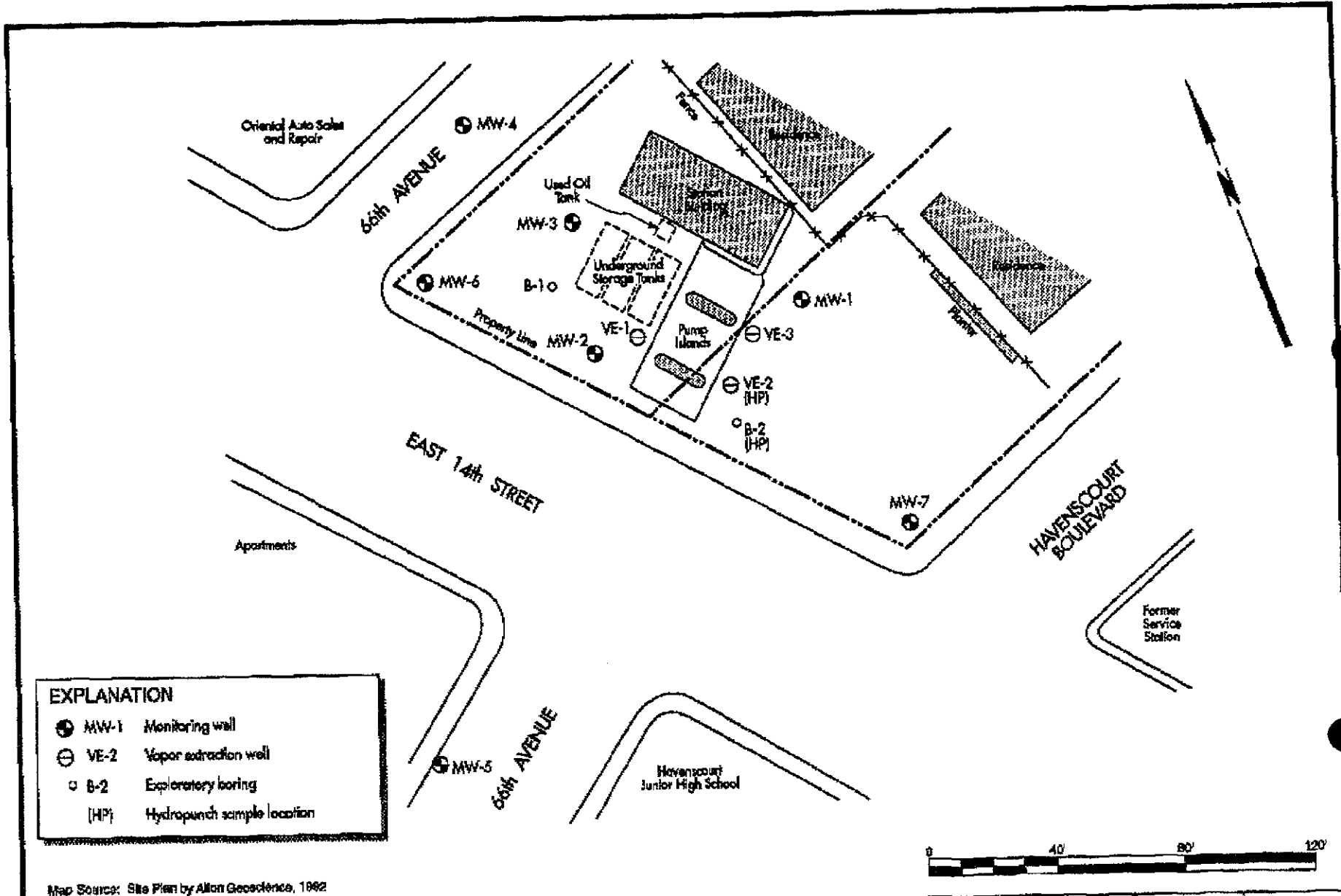

EXPLANATION	
●	MW-1 Monitoring well
⊖	VE-2 Vapor extraction well
○	B-2 Exploratory boring
(HP)	Hydropunch sample location

Map Source: Site Plan by Allon Geoscience, 1992

RESNA

PROJECT NO. 170079.06 12/93

GENERALIZED SITE PLAN
 Exxon Service Station No. 7-0236
 6530 East 14th Street
 Oakland, California

PLATE
2

III RESULTS

A. Magnetic Contours

Drawing 3 illustrates the magnetic contour map. There are many magnetic anomalies at the site. Most were caused by surface metal such as street lights and metal fencing or by utilities buried beneath the sidewalks. We found three small anomalies that indicated metal buried in the dirt lot. These anomalies appear too small to be a cluster of three tanks or a large single tank. It is possible that a small tank, such as a waste oil tank, might be the cause of any one of the three anomalies. Construction debris also could be the cause of the anomalies. The locations of the three anomalies were marked with wooden stakes at the site. The magnetic contour map shows the approximate location of the staked anomalies.

A short section of buried pipe was found at the site. The pipe was about 35 feet long and ran parallel to East 14th Street about 10 feet from the sidewalk. We could not determine if the pipe was an old product line. Its location was painted on the ground and is shown on Drawing 3.



EXPLANATION:

- MANHOLE COVER OR DRAIN
- CHRISTY BOX
- ⊛ LIGHT
- ⊙ POST OR SIGN
- ⊕ POWER POLE
- × VALVE
- ⊕ STAKED ANOMALY
- - - BURIED PIPE
- - - FENCE
- ⊕ MAGNETIC DATA POINT
- MAGNETIC CONTOUR

HAVENSCOURT BOULEVARD

EAST 14TH STREET

PIPE SECTION

SIDEWALK

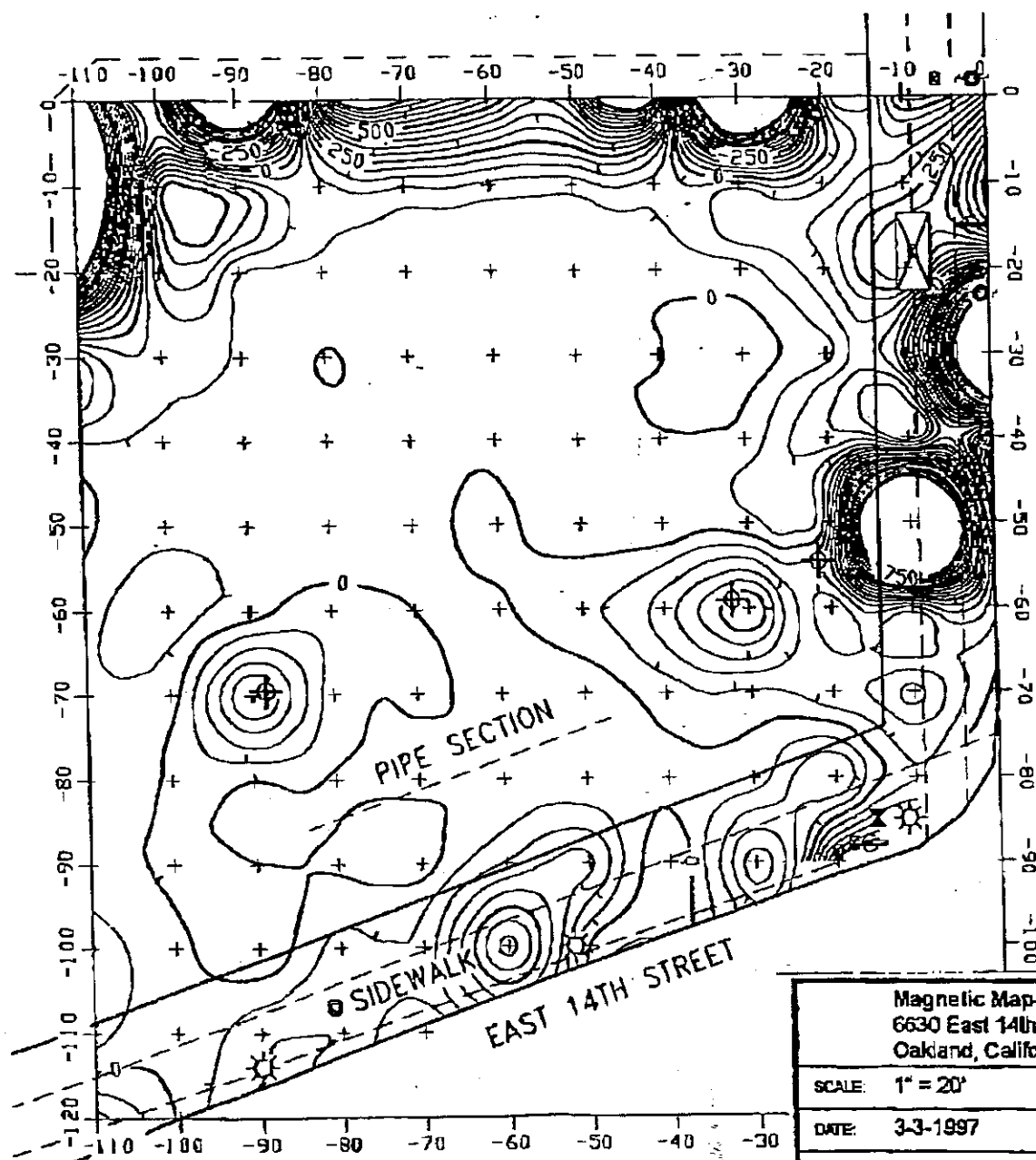

Magnetic Map-Former Exxon Station 7-0236
 6630 East 14th Street
 Oakland, California

SCALE: 1" = 20'	JOB NUMBER:	DRAWN BY: J.J.R.
DATE: 3-3-1997	103127-97	REVISED:

J R ASSOCIATES Civil and Environmental Geophysics
 1886 Emory Street, San Jose, CA (408) 293-7390

DRAWING NUMBER:
3

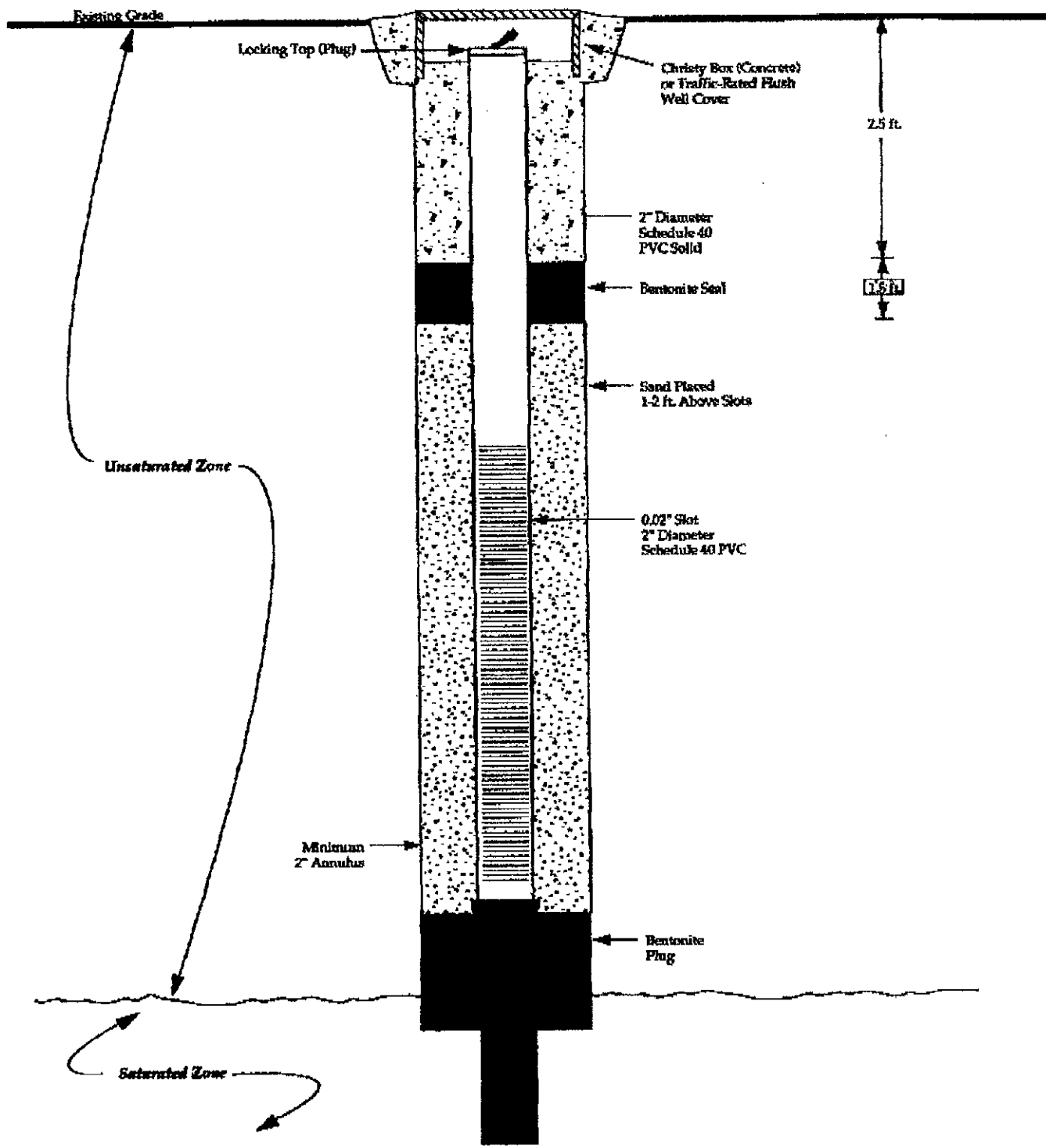

Illustration; Not To Scale

LEGEND

-  Groat
-  Sand

Typical Vapor Extraction Well Construction Details

FIGURE

3

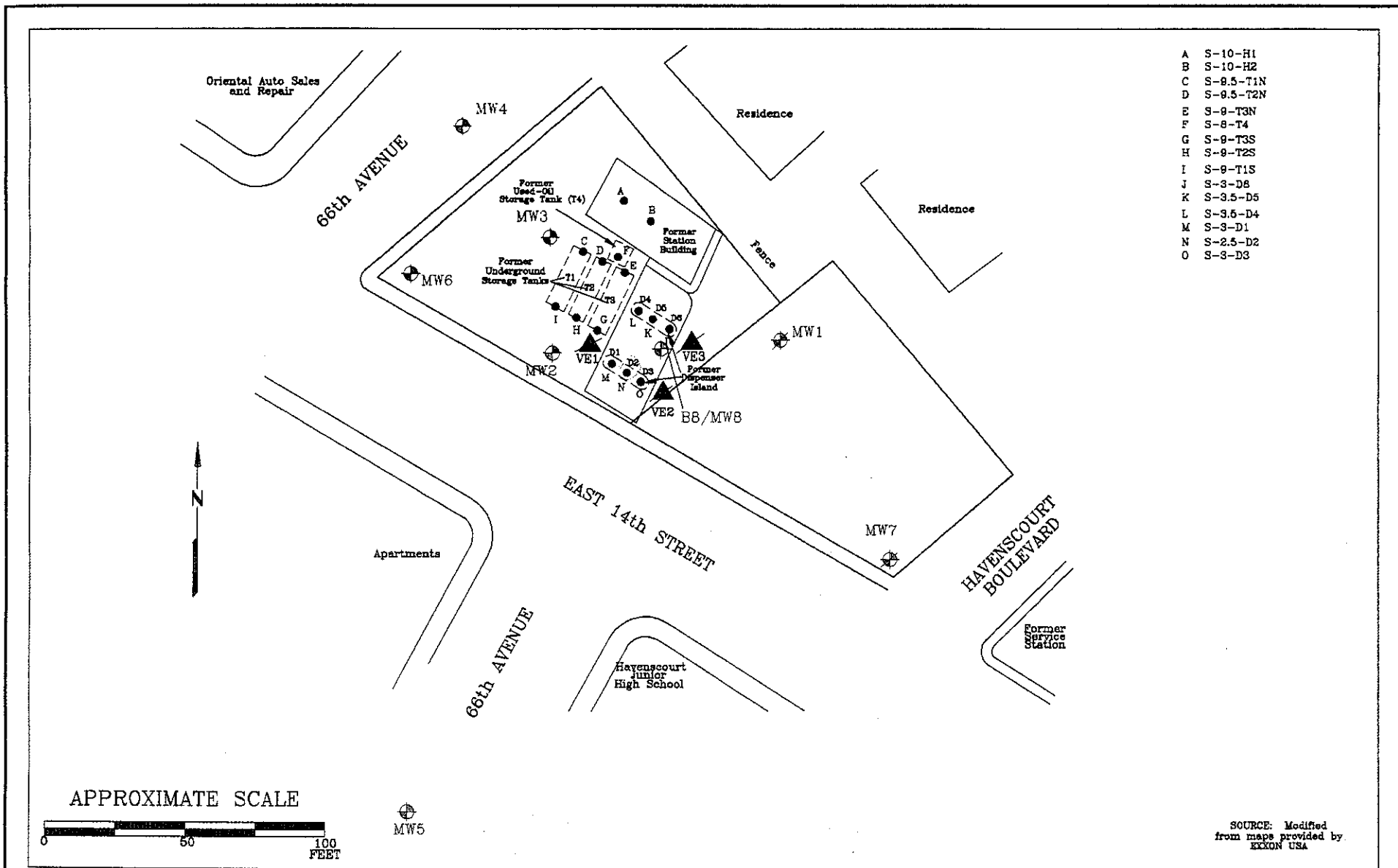

- A S-10-H1
- B S-10-H2
- C S-9.5-T1N
- D S-9.5-T2N
- E S-9-T3N
- F S-8-T4
- G S-9-T3S
- H S-9-T2S
- I S-9-T1S
- J S-3-D8
- K S-3.5-D5
- L S-3.5-D4
- M S-3-D1
- N S-2.5-D2
- O S-3-D3

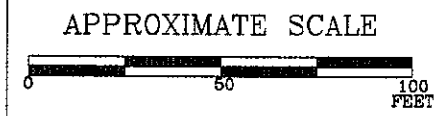

SOURCE: Modified from maps provided by EXXON USA

FN 20090002

<p>ERI ENVIRONMENTAL RESOLUTIONS, INC.</p>	<p>GENERALIZED SITE PLAN</p> <p>FORMER EXXON SERVICE STATION 7-0236 6630 East 14th Street Oakland, California</p>	<p>EXPLANATION</p> <ul style="list-style-type: none"> MW3 Groundwater Monitoring Well Groundwater Monitoring Well (Destroyed) VE3 Vapor Extraction Well (Destroyed) B8/MW8 Soil Boring/Groundwater Monitoring Well Soil Sample Location S-3-D3 Soil-Depth-Dispenser (T = Tank, H = Hoist) 	<p>PROJECT NO.</p> <p>2009</p>
			<p>PLATE</p> <p>2</p> <p>DATE: 2/11/97</p>

11/19/98 Meeting with Exxon and consultants to discuss 6600 E. 14th St., Oakland CA
Former Exxon station 7-0236

Items for discussion:

- Which wells have ORC socks in them? How about the addition of ORC into MW-3? Verify the sampling method for wells with ORC in them.
- What is the situation with the varying dissolved oxygen readings? How is the test done? Is it done down hole?
- What if any other parameters are being measured to demonstrate natural degradation is occurring?
- Is there still a source of TPH , BTEX and MTBE onsite in soil or gw?
- What should be done with the elevated MTBE concentrations in MW2? Utilities survey, subsurface borings?

Discuss the closure of sites with MTBE and the draft document from R. Arulanantham

October 9, 1998

ENVIRONMENTAL
PROTECTION

98 OCT 13 PM 4:30

Barney Chan
Alameda County Health Care Services
Environmental Health Services
Environmental Protection (LOP)
1131 Harbor Way Parkway, Suite 250
Alameda, CA 94502-6577

RE: 6600 East 14th Street and 6630 East 14th Street, Oakland

Dear Mr. Chan:

As we discussed in our telephone conversation on 10/7/98, we would like to develop 25 units of affordable family housing for very low income families at the above referenced address. Enclosed please find our proposed site plan. Since the future use will have different risks associated with it, we would like a risk assessment based on the use of the site for housing.

Please let me know how we should proceed. If you should have any questions or comments, please call me at 841-4410. Thank you for your time and attention.

Very truly yours,

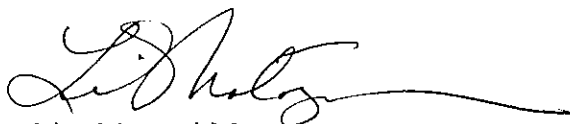

Lisa Masumi Motoyama
Project Manager

- ① Determine what well(s) will be kept & what wells will be destroyed & what wells will be replaced.
- ② Provide a Tier 1 or Tier 2 RBCA for soil + air exp to address air residential exposure (appear that there is minimal cont & risk)
- ③ Agree to monitoring plan - maintenance plan for wells
- ④ Notification of residual contamination to City of Oakland
- ? ⑤ Verification of magnetic anomalies on 6630 E 14th St

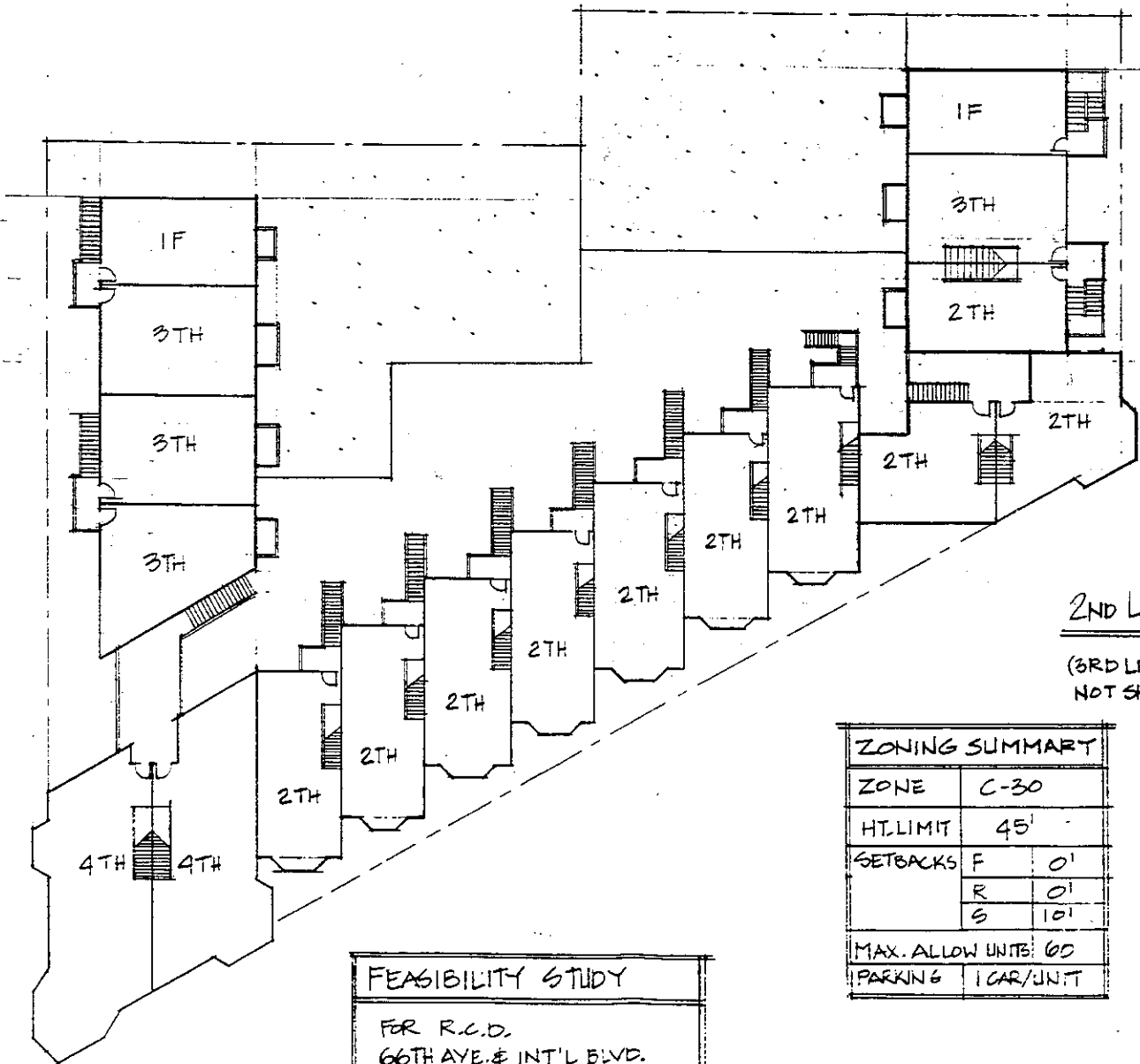

2ND LEVEL PLAN 1"=20'

(3RD LEVEL NOT SHOWN)

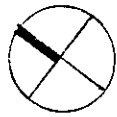





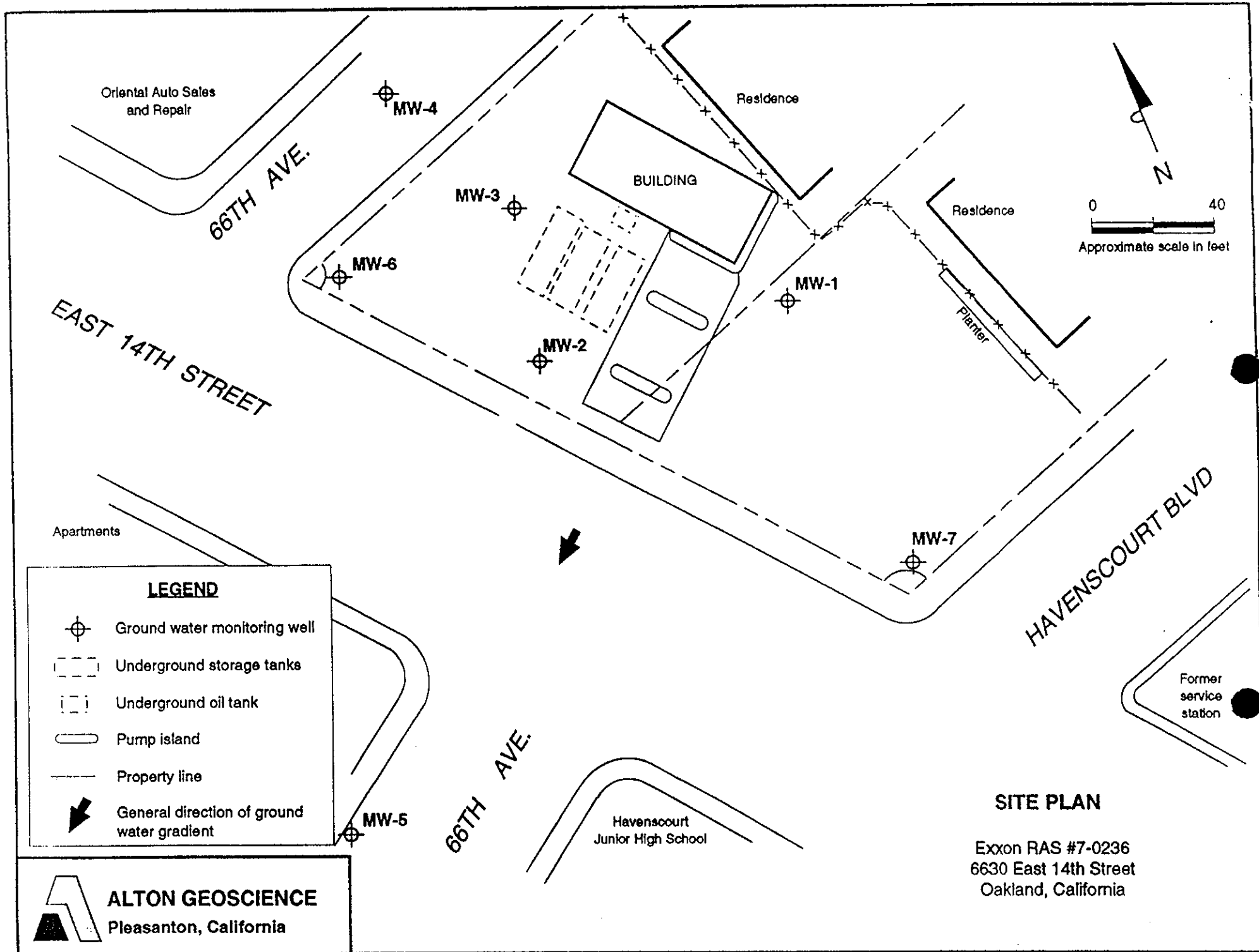

ZONING SUMMARY	
ZONE	C-30
HT. LIMIT	45'
SETBACKS	F 0'
	R 0'
	S 10'
MAX. ALLOW UNITS	60
PARKING	1 CAR/UNIT

FEASIBILITY STUDY
 FOR R.C.D.
 66TH AVE. & INT'L BLVD.
 PYATOK ASSOC. 9/28/95



LEGEND

-  Ground water monitoring well
-  Underground storage tanks
-  Underground oil tank
-  Pump island
-  Property line
-  General direction of ground water gradient



ALTON GEOSCIENCE
Pleasanton, California

SITE PLAN

Exxon RAS #7-0236
6630 East 14th Street
Oakland, California