

ENVIRONMENTAL  
PROTECTION  
97 JAN 14 PM 3:41

# HK2, INC./SEMCO

1751 LESLIE STREET • SAN MATEO, CA 94402 • (415) 572-8033 • (415) 572-9734 FAX

GENERAL ENGINEERING & ENVIRONMENTAL CONTRACTORS LICENSE NO. 719103 (A, B, C57, C61, D40, HAZ, ASB)

January 8, 1997

ref: 96-0234.8

Juliet Shin  
Alameda County Health Services  
1131 Harbor Bay Parkway, Suite 250  
Alameda, CA 94502-6577  
(510) 567-6700 Phone  
(510) 337-9335 Fax

re: Contaminated soil removal at 743 Santa Clara Avenue.

Dear Ms. Juliet Shin,

Enclosed is a report for the contaminated soil removal (over excavation) that took place at 743 Santa Clara Avenue.

Please let us know if you have any questions.

Sincerely,

HK2, Inc./SEMCO



Mark Dysert  
Environmental Specialist

cc: William Sheehan

**Phase III Report  
Over Excavation of Hydrocarbon Impacted Soil**

**Site Location:**

**743 Santa Clara Avenue  
Alameda, CA 94501**

**Prepared For:**

**William Sheehan  
1236 Bay Street  
Alameda, CA 94501  
(510) 522-0978**

**Submitted To:**

**Juliet Shin  
Alameda County Health Services  
1131 Harbor Bay Parkway, Suite 250  
Alameda, CA 94502-6577  
(510) 567-6700 Phone  
(510) 337-9335 Fax**

**Prepared By:**

**HK2, Inc./SEMCO  
1751 Leslis Street  
San Mateo, CA 94402  
(415) 572-8033 Phone  
(415) 572-9734 Fax**

**STID 5845**

**Job #96-0234.2**

### Over Excavation Activities Begin:

On November 7, 1996 over excavation began in the morning. During excavation a water line on the north side of the excavation was inadvertently broken. Approximately 110 gallons of water was pumped from the excavation into two 55-gallon drums. This water was disposed of December 13, 1996 under Manifest #96338321 by Evergreen Environmental Services. See Appendix B for copy of invoice with manifest number.

The clean fill material from the top of the former tank site was excavated and placed on a piece of visqueen. The original stockpiled material (from the tank removal) was reached at approximately 2' bgs. This material was removed from the excavation and placed on a separate piece of visqueen. As the material was removed from the excavation it was screened with a photo ionizer detector (PID) for contamination. All material that was obviously contaminated was placed directly in the back of HK2, Inc. truck for transportation Bay Area Soil, a class II recycle center. See Appendix B for copy of Non-Hazardous Material Manifest. The target depth of 9'+ bgs. was reached on the west and east ends of the excavation. After the pit was excavated down to 9'+ bgs. the soil beneath the sidewalk sloughed into the pit and the sidewalk collapsed. This caused a water line along the street side of the sidewalk to break and water to rush into the excavation. The water overflowed from the excavation and was diverted into the storm drain. The inspector, Ms Juliet Shin, noted in her notes that the water was not likely contaminated, because the leak was shallow (around 1' bgs) and went directly into the street without contacting the contaminated soil. Part of the excavation was backfilled for safety reasons. See Appendix for copy of inspector's notes.

On November 8, 1996 three soil samples were collected from the west end of the excavation. The soil samples were collected by pushing a 4" diameter PVC into the soil with the hydraulics from the backhoe. Hand augering was performed inside of the PVC because of the wet soil conditions. Soil samples were collected with a slide hammer. Ground water was found at 13' bgs. Soil sample *MID-W@12'* was collected 17' from the westerly property line and 5' from the curb line. This sample was collected at a depth of 12' bgs. Soil sample *2-MID-W@11'* was collected 12' 4" from the westerly property line and 5' from the curb line. This sample was collected at a depth of 11' bgs. Soil sample *4-MID-N@11.5'* was collected 14' 8" from the westerly property line and 8' from the curb line near the northerly edge of the excavation. This sample was collected at a depth of 11.5' bgs. See page 4 for site layout and soil sampling locations. The following is a summary of the sampling results.

ID #	Sample	TPH-D mg/Kg	Benzene mg/Kg	Toluene mg/Kg	Ethybenzene mg/Kg	Xylenes mg/Kg
4	MID-W@12"	1100	ND	.015	.070	.056
5	2-MID-W@11'	ND	ND	ND	ND	ND
6	4-MID-N@11.5'	ND	ND	ND	ND	ND

## CERTIFICATION

This report was prepared by HK2, Inc./SEMCO under the professional direction and review of the person whose name and seal are shown below.

The recommendations and professional opinions presented herein, are within the limits prescribed by the client and were prepared in accordance with generally accepted professional engineering and industrial hygiene practices. There is no other warranty either expressed or implied.

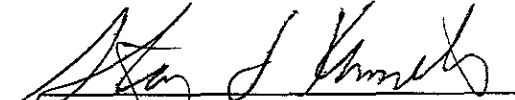
  
Stanley L. Klemetson, Ph. D., P.E.



**Report of Over Excavation of Hydrocarbon Impacted Soil**  
**743 Santa Clara Avenue**  
**Alameda, California**

**Introduction:**

HK2, Inc./SEMCO was contracted to remove one home heating oil underground storage tank (UST) from the residential site located at 743 Santa Clara Avenue in Alameda California. The UST was located beneath the sidewalk on the north side of Santa Clara Avenue. The tank was removed on September 17, 1996 under the direction of Juliet Shin of the Alameda County Environmental Health Services. Upon removal of the tank it was identified that the UST had at least two holes in the west end of the tank due to corrosion. The soil was sandy. There was some hydrocarbon odor and discoloration in the west end of the excavation. Two soil samples were collected from the excavation and one composite sample was collected from the excavated material. Soil sample #1-1500-D@9'WEST was collected from the west end of the excavation at 9' below ground surface (bgs). This sample had strong odor and discoloration and contained 4400 mg/Kg Total Petroleum Hydrocarbons as Diesel (TPH-D). Soil sample #2-1500-D@9' EAST was collected from the excavation at 9' bgs. This sample did not have any significant odor or discoloration and contained only 18 mg/Kg TPH-D. The sample collected from the stockpiled material contained only 24 mg/Kg TPH-D. This stockpiled soil was placed back in the excavation. A layer of 6 mil visqueen was placed in the excavation. The clean fill material was placed on top of the visqueen. The following is a summary of the sampling results from the UST removal.

ID #	Sample	TPH-D mg/Kg	Benzene mg/Kg	Toluene mg/Kg	Ethylbenzene mg/Kg	Xylenes mg/Kg
1	#1-1500-D@9'WEST	4400	.017	.029	.110	.110
2	#2-1500-D@9'EAST	18	ND	.007	.008	.04
3	SP-COMP	24	ND	ND	ND	ND

A letter dated September 23, 1996 was issued from Juliet Shin of the Alameda County Environmental Health Services. The letter basically stated that the soil from the west end of the excavation, that contained the highest levels of TPH-D, would have to be removed (over excavated) and disposed of at a class II soil recycling center. The objective was to remove the source of the soil contamination down to ~1,000 mg/Kg (ppm) TPH-D and have no BTEX. See Appendix for a copy of letter dated September 23, 1996.

On November 4, 1996 a work plan for the over excavation of the home heating oil tank site was submitted to Juliet Shin. On November 4, 1996 the work plan was accepted by Juliet Shin. See Appendix for copy of letters dated November 4, 1996.

All samples were collected in clean brass tubes, which were sealed with Teflon tape, pre-formed plastic end caps. The samples were labeled, entered onto a chain of custody and placed in an iced cooler for transportation to North State Environmental for the analysis of THP-D (EPA method 8015M) and BTEX (EPA method 8020). The sample results were adjusted for their moisture content. The analytical results can be found in Appendix A.

**Conclusion:**

There was a total of 11.9 tons of contaminated soil off hauled to Bay Area Soil for disposal. The remaining hydrocarbon impacted soil appears to be located in a small area. The two adjacent samples were clean. No additional excavation is anticipated at this site. The excavation was completely backfilled and the sidewalk surface was replaced.

This report was prepared from field technicians field notes, inspector's notes and analytical data pertaining to this site.

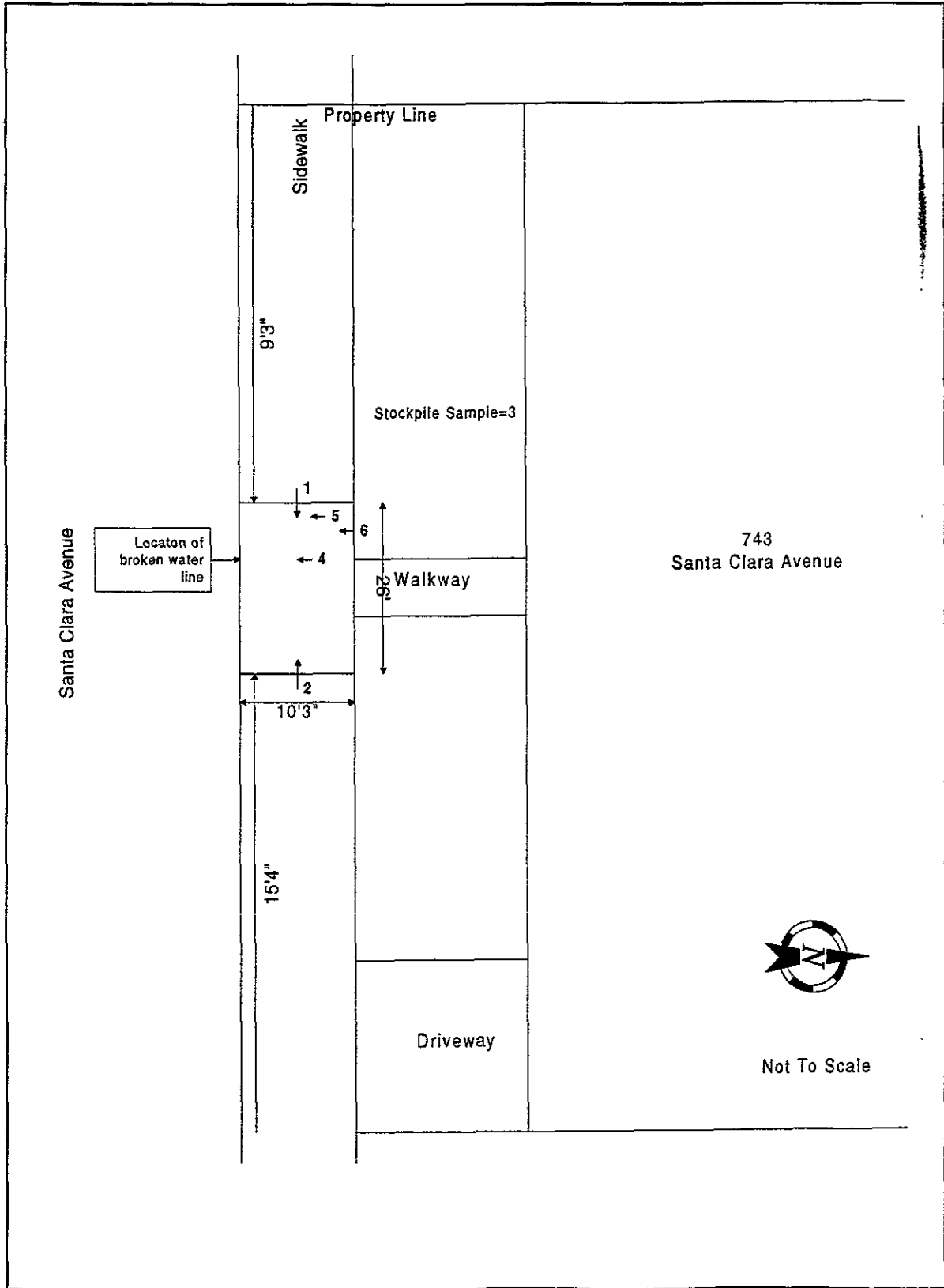

Site Layout and Soil Sampling Locations

## Appendices



**Appendix A**

**Analytical Data**



# North State Environmental Analytical Laboratory

## Chain of Custody/Request for Analysis 96-827

(415) 588-9652

Client: <i>HKA, INC / Semco</i>		Phone: <i>572-8033</i>		Report to: <i>HKA, INC</i>				Turnaround Time					
Mailing Address: <i>1751 Leslie St. San Mateo, CA 94402</i>				Billing to: <i>HKA, Inc.</i>				8 Hr <input type="checkbox"/>		24 Hr <input checked="" type="checkbox"/>			
Site Address: <i>743 Santa Clara Ave. Alameda</i>				PO# / Billing Reference: <i>96-0234.1</i>				40 Hr <input type="checkbox"/>		5 Days <input type="checkbox"/>			
Sampler: <i>Mark Dyer +</i>		Date: <i>11/8/96</i>						Other <input type="checkbox"/>					
Sample ID:	Sample Description	Container # / type	Sampling Time/Date	ANALYSIS REQUESTED								Remarks	
				TPH-D	TPH-G	BTEX	O-G						
	<i>MID-Well 1' (SOIL)</i>	<i>1 BRASS</i>	<i>11/6 10:15</i>										<i>HOLD</i>
<i>-1</i>	<i>MID-Well 2' (SOIL)</i>	<i>1 BRASS</i>	<i>11/6 10:30</i>	<i>X</i>		<i>X</i>							
<i>-2</i>	<i>2-MID-Well (SOIL)</i>	<i>1 BRASS</i>	<i>11/6 11:30</i>	<i>X</i>		<i>X</i>							
	<i>3-MID-Well 10.5' (SOIL)</i>	<i>1 BRASS</i>	<i>11/8 11:45</i>										<i>HOLD</i>
<i>-3</i>	<i>4-MID-Well 11.5' (SOIL)</i>	<i>1 BRASS</i>	<i>11/8 12:00</i>	<i>X</i>		<i>X</i>							
				NOTE * Adjust for moisture content of sample.									
Relinquished by: <i>Mark Dyer</i>		Date: <i>3:50</i> Time: <i>11/11/96</i>		Received by: <i>Edward L. ...</i>				Yes		No			
Relinquished by:		Date: Time:		Received by:				Were samples Preserved ?					
Relinquished by:		Date: Time:		Received in lab by:				In good condition ?					



North State Environmental  
Chemical Waste Disposal • Trucking • Consulting

## CERTIFICATE OF ANALYSIS

Lab No:	96-827	Date Sampled:	11-08-96
Client:	Semco/ 11K2	Date Analyzed:	11-14-96
Project:	743 Santa Clara Ave., Alameda	Date Reported:	11-21-96

Benzene, Toluene, Ethylbenzene and Xylenes by Method 8020  
Diesel range hydrocarbons by EPA method 8015M

SAMPLE NO	CLIENT ID	ANALYTE	METHOD	RESULT
96-827-01	MID-W @ 12' SOIL	Benzene	8020	ND
		Toluene	8020	0.015 mg/Kg
		Ethylbenzene	8020	0.070 mg/Kg
		Xylenes	8020	0.056 mg/Kg
		Diesel	8015M	1100 mg/Kg
96-827-02	2-MID-W @ 11' SOIL	Benzene	8020	ND
		Toluene	8020	ND
		Ethylbenzene	8020	ND
		Xylenes	8020	ND
		Diesel	8015M	ND
96-827-03	4-MID-N @ 11.5' SOIL	Benzene	8020	ND
		Toluene	8020	ND
		Ethylbenzene	8020	ND
		Xylenes	8020	ND
		Diesel	8015M	ND

### Quality Control/Quality Assurance Summary-Soil

Analyte	Method	Reporting Limit	Blank	MS/MSD Recovery	RPD
Benzene	8020	0.005 mg/Kg	ND	64	28
Toluene	8020	0.005 mg/Kg	ND	79	14
Ethylbenzene	8020	0.005 mg/Kg	ND	88	21
Xylenes	8020	0.010 mg/Kg	ND	91	23
Diesel	8015M	1 mg/Kg	ND	141	12

ELAP Certificate NO: 1753  
Reviewed and Approved:

John A. Murphy, Laboratory Director

**Appendix B**

**Miscellaneous**

BAY AREA SOIL DAILY SCALE LOG

DATE 11/7/96

TIME IN	TRUCK #	GROSS	TARE	NET	MAN. #	JOB #	TONS	DATE
---------	---------	-------	------	-----	--------	-------	------	------

1654	22	45850	22050	23800	20293	R-9705	11.9	
------	----	-------	-------	-------	-------	--------	------	--

						TOTAL	11.9	
--	--	--	--	--	--	-------	------	--

**NON-HAZARDOUS**

020293

**MATERIALS MANIFEST**

**GENERATOR**

Site Address 743 Santa Clara Court  
Mailing Camden - NJ  
Phone :( ) \_\_\_\_\_ Contact: \_\_\_\_\_

**TRANSPORTER**

Address \_\_\_\_\_  
Phone :( ) \_\_\_\_\_ Contact: \_\_\_\_\_

I hereby certify that the above named material was picked up at the generator site listed above.

Driver Name: X J. Man Signature \_\_\_\_\_  
Truck No: # 116 Ship Date: \_\_\_\_\_  
Time of Pick-Up: \_\_\_\_\_ Time of Delivery: \_\_\_\_\_

**Consultant/Owner**

Address HK 2 / 1751 7th St. N.  
Camden NJ 08105  
Phone :( ) \_\_\_\_\_ Contact: \_\_\_\_\_

I hereby certify that the above named material is consistent with the information presented in the Waste Characterization Form and Contaminated Soil Description Form, and has been properly described, classified and packaged, and is in proper condition for transport according to applicable regulation.

Name \_\_\_\_\_ Date: 11-7-96

**Recycling Facility**

**BAY AREA SOIL**  
2717 GOODRICK AVENUE RICHMOND, CA 94801

RECEIVED BY: [Signature]  
DATE: 11-7-96  
Control No: 8-4705

A COPY OF THIS SHEET MUST ACCOMPANY EVERY LOAD, AND MUST BE SUBMITTED AT THE GATE FOR ENTRY. ALL LOADS MUST BE SCHEDULED AT LEAST 24 HOURS IN ADVANCE. DELIVERIES MUST BE SCHEDULED ON A DAILY BASIS. ANY UNSCHEDULED LOADS MAY BE REFUSED AT THE GATE.



# Evergreen Environmental Services

dedicated to the protection of the environment

Bill of Lading / Invoice

To schedule a pickup, call

800-972-5284

Send payment to:

Evergreen

P.O. Box 45987

San Francisco, CA 94145

INVOICE

558055

7200 Central Ave., Newark, CA EPA# CAD982413262  
10712 Vernon Ave., Ontario CA EPA# CAL000027724

Date 12-13-96

### JOB LOCATION

### BILLING INFORMATION

NAME <b>WILLIAM SHEEHAN</b>	NAME <b>SEMCO</b>	CASH <input type="checkbox"/> CHECK <input type="checkbox"/>
ADDRESS <b>743 SANTA CLARA</b>	ADDRESS <b>1741 LESLIE ST.</b>	CUSTOMER CODE NO. <b>SEMCO6</b>
CITY STATE ZIP CO <b>ALAMEDA CA. 94501</b>	CITY STATE ZIP CO <b>SAN MATEO, CA. 94403</b>	PO #
PHONE NO. ( )	PHONE NO. ( )	PROFILE NO.
		CUSTOMER EPA ID NO. <b>CAL001061440</b>

PRODUCT	WASTE CODE	MANIFEST NUMBER	QUANTITY	UNITS	PRICE	AMOUNT
Used oil, Non-RCRA Hazardous Waste, Liquid	Lubricating Industrial CA 221					
Used Automotive Antifreeze, Non-RCRA Hazardous Waste, Liquid	CA 134					
RQ Waste Petroleum Oil NOS Combustible Liquid UN 1270 III (Oil contaminated with halogens)	CA 221 FO01 FO02					
Oil & Water, Non-RCRA Hazardous Waste, Liquid	CA221	<b>96338321</b>	<b>110</b>			
Waste Solids and Sludges						
Wash-out						
Drained Used Oil Filters						
Non-RCRA Hazardous Waste Solids (oily debris)	CA 223					
Empty Drums						
Transportation						
Other:						
Other:						
Other:						
Other:						
Other:						
Other:						
Other:						
Other:						
TEST	PASS <input type="checkbox"/>	FAIL <input type="checkbox"/>	PPM	Test		

Collection Station     Agricultural Source  
 Government Source     Industrial Source  
 Marine Source

## NET 7 DAYS TOTAL CHARGES

Accounting Office 510-795-4400 Please Pay From This Invoice

TSDF: Evergreen Oil, Inc.  
6880 Smith Avenue  
Newark, CA 94560  
EPA# CAD980887418

I hereby certify that all information submitted in this and all attached documents contains true and accurate descriptions of the waste. All relevant information regarding known or suspected hazards associated with the waste has been disclosed. This further serves as notification that the above liquid wastes are banned from land disposal pursuant to Title 22 Section 66268.7 (a)(10). I also acknowledge that I have read and agree to the terms on the reverse side of this form.

RIVER      ROUTE #      DRIVER SIGNATURE      GENERATOR'S SIGNATURE      PRINT NAME

ALAMEDA COUNTY  
HEALTH CARE SERVICES

AGENCY  
DAVID J. KEARS, Agency Director



ENVIRONMENTAL HEALTH SERVICES  
ENVIRONMENTAL PROTECTION (LOP)  
1131 Harbor Bay Parkway, Suite 250  
Alameda, CA 94502-6577  
(510) 567-6700  
FAX (510) 337-9335

September 23, 1996

Mr. William Sheehan  
1236 Bay Street  
Alameda, CA 94501

STID 5845

Re: Investigations at 743 Santa Clara Avenue, Alameda, CA 94501

Dear Mr. Sheehan,

One 1,500-gallon heating oil tank was recently removed from the above site. Analysis results of the soil samples collected from the tank excavation identified up to 4,400 parts per million (ppm) Total Petroleum Hydrocarbons as diesel (TPHd) and low levels of benzene, toluene, ethylbenzene, and total xylenes (BTEX). The highest concentrations of TPHd and BTEX were identified on the west side of the tank pit at 9-feet below ground surface (bgs).

Based on these analysis results and the attached Regional Water Quality Control Board (RWQCB) guidance memo on residential heating oil tanks, this office is requesting that you excavate the materials that were previously backfilled into the tank pit on the day of the tank removal, and that you attempt to remove/overexcavate the contaminated soil on the west side, to the extent feasible, where the highest contaminant concentrations were identified. Subsequent to overexcavation of the west side, two confirmation soil samples should be collected and analyzed for TPHd and BTEX. As stated in the attached RWQCB memo, the objective is to remove the source (soil contamination) down to ~1,000ppm TPHd and no BTEX. Additionally, if groundwater is observed in the tank during overexcavation activities, one "grab" groundwater sample should be collected and analyzed for TPHd and BTEX.

Lastly, this office is requesting that you complete the attached Unauthorized Release/Leak Report Form and submit it to this office prior to conducting the additional work. This is a standard State form that is required to be completed when petroleum contamination has been identified at a site.



Mr. William Sheehan  
Re: 743 Santa Clara Ave.  
September 23, 1996  
Page 2 of 2



If you have any questions or comments, please contact me at (510) 567-6763.

Sincerely,



Juliet Shin  
Senior Hazardous Materials Specialist

**ATTACHMENT**

cc:  Mark Dysert   
HK2, Inc./SEMCO  
1751 Leslie St.  
San Mateo, CA 94402

Acting Chief

# HK<sub>2</sub>, INC./SEMCO

GENERAL ENGINEERING & ENVIRONMENTAL CONTRACTORS • LICENSE NO. 719103 (A, B, C57, C61-D40, HAZ, ASB)  
1751 LESLIE STREET • SAN MATEO, CA 94402 • (415) 572-8033 • (415) 572-9734 FAX

---

November 4, 1996

REF: 96-0234.309

Juliet Shin  
Alameda County  
Dept. of Environmental Health  
1131 Harbor Bay Parkway  
Alameda, CA 94502  
(510) 567-6763  
(510) 337-9335 Fax

RE: Work Plan for Over-Excavation of Home Heating Oil Tank Site at 743 Santa Clara Avenue, Alameda, CA 94501.

Dear Ms. Shin:

HK<sub>2</sub>, Inc. /SEMCO (HK<sub>2</sub>) is pleased to submit a short work plan to complete the site remediation work you requested in your September 23, 1996 letter to William Sheehan.

Sample #1-1500-D@9' West contained 4400 mg/Kg of TPH-D and sample #2-1500-D@9' East contained 18 mg/Kg of TPH-D. The previously excavated soil contained 24 mg/Kg of TPH-D.

The proposed work will be to re-excavate the soil that was placed in the excavation and over-excavate the tank site on the westerly side to the extent possible. Two soil samples will be collected from the sidewall and/or bottom after the completion and analyzed for TPH-D and BTEX. The cleanup goals for the site are <1,000 mg/Kg TPH-D and no BTEX. Additionally, if groundwater is encountered a grab water sample will be collected and analyzed.

Juliet Shin  
File: 96-0234.309  
Page 2

The previously analyzed soil will be placed back in the excavation unless there is obvious staining. Any stained soil and the over-excavated soil will be transported to Bay Area Soils for treatment and disposal. Imported backfill material will be utilized to bring the excavation to grade.

The site work is scheduled for Thursday, November 7, 1996. The Unauthorized Release report was previously sent to you. Please let us know if you have any further questions.

Yours truly,



Stanley L. Klemetson, Ph.D., P.E.  
Vice President



ALAMEDA COUNTY  
HEALTH CARE SERVICES

AGENCY  
DAVID J. KEARS, Agency Director



Post-It™ bran. . transmittal memo 7871		# of pages > 1
To: Stanley Klemetson	From: Juliet Shin	
Co. HK2, Inc./SEMCO	Co. Alameda City	
Dept.	Phone # 510-567-6763	
Fax # 415-572-9734	Fax # 510-337-9335	

November 4, 1996

William & Ed Sheehan  
1236 Bay Street  
Alameda, CA 94501

ENVIRONMENTAL HEALTH SERVICES  
ENVIRONMENTAL PROTECTION (LOP)  
1131 Harbor Bay Parkway, Suite 250  
Alameda, CA 94502-6577  
(510) 567-6700  
FAX (510) 337-9335

STID 5845

Re: Overexcavation and sampling at 743 Santa Clara Avenue, Alameda, CA

Dear William & Ed Sheehan,

This office has reviewed HK2, Inc./SEMCO's workplan, dated November 4, 1996, for overexcavation of the western end of the former tank pit at the above site. The overexcavation will be conducted to determine whether the extent of soil contamination is limited, and, if groundwater is encountered, to determine whether there has been any impact to groundwater. Per the workplan, subsequent to the overexcavation, the soil that was backfilled into the pit on September 17, 1996 may be reused in the pit, except for soil that is obviously stained or contaminated. This obviously contaminated soil, along with the newly overexcavated soil, will be hauled off site to a certified disposal facility.

If you have any questions or comments, please contact me at (510) 567-6763.

Sincerely,

Juliet Shin  
Senior Hazardous Materials Specialist

cc: Stanley L. Klemetson  
HK2, Inc./SEMCO  
1751 Leslie Street  
San Matco, CA 94402

Acting Chief

white - env. health  
yellow - facility  
pink - files

# ALAMEDA COUNTY, DEPARTMENT OF ENVIRONMENTAL HEALTH

1131 Harbor Bay Pkwy  
Alameda CA 94502  
510/567-6700

## Hazardous Materials Inspection Form

II, III

Site ID # \_\_\_\_\_ Site Name Residential Today's Date 11/7/96  
Site Address 743 Santa Clara Ave.  
City Alameda Zip 94501 Phone \_\_\_\_\_

\_\_\_\_ MAX AMT stored > 500 lbs, 55 gal., 200 cft.?

### Inspection Categories:

- \_\_\_\_ I. Haz. Mat/Waste GENERATOR/TRANSPORTER
- \_\_\_\_ II. Hazardous Materials Business Plan, Acutely Hazardous Materials
- \_\_\_\_ III. Under ground Storage Tanks

\* Calif. Administration Code (CAC) or the Health & Safety Code (HS&C)

### Comments:

1st visit set to site in morning to observe excavation and the collection of two approximately 500 lbs samples from the west end of the former 1,500-gallon heating oil UST. During excavation a water line on the west end was broken and water rushed in and filled the tank out. The water began leaking into the soil, and I went out ahead and tried to pump as much of the water out as possible into 5-gallon jugs. The hole will be repaired after further excavation, if there is a chance about remaining should be excavated. The water from the line has been removed and existing on site to the fact that water did not run down from the tank and stayed at top of tank during leak. Also, water in it began to leak out. Water tank drain pipe was turned off. The west end was excavated down to 9-foot base, as measured in the p. and closed on west side for observation. Later, after the pit was excavated down to 9-foot base on both ends the sidewalk was undermined and the concrete along the sidewalk as well as the soil sloughed off into pit. The concrete fell on top of another water line and broke it. Water rushed into pit.

Contact Robert T. Sizer  
Title \_\_\_\_\_  
Signature \_\_\_\_\_

Inspector Juliet Shinn  
Signature \_\_\_\_\_

II, III

white - env. health  
yellow - facility  
pink - files

# ALAMEDA COUNTY, DEPARTMENT OF ENVIRONMENTAL HEALTH

1131 Harbor Bay Pkwy  
Alameda CA 94502  
510/567-6700

## Hazardous Materials Inspection Form

**II, III**

Site ID # \_\_\_\_\_ Site Name Residential Today's Date 11/7/96  
Site Address 743 Santa Clara Ave  
City Alameda Zip 94 Phone \_\_\_\_\_

MAX AMT stored > 500 lbs, 55 gal., 200 cft.?

**Inspection Categories:**

- I. Haz. Mat/Waste GENERATOR/TRANSPORTER
- II. Hazardous Materials Business Plan, Acutely Hazardous Materials
- III. Under ground Storage Tanks

\* Calif. Administration Code (CAC) or the Health & Safety Code (HS&C)

**Comments:**

and overblow. We directed water into street (storm drain). Water was not likely contaminated because tank was shallow & water went directly out to street without contacting contaminated soil. Part of tank pit was backfilled after water line was fixed, for safety reasons. In lieu of further excavation, hard known will be closed at street level as pit to try and determine extent of contamination.

<p><u>Alabogas</u></p> <p style="text-align: right;">walkway</p>	<p>Hard known will be closed at street level as pit to try and determine extent of contamination.</p> <p>not started. The pushing a PIC sign seen to observed depth + hard knowning.</p> <p>Block through it. Sample #1 was collected from ~12' bgs. Groundwater was observed at ~13' bgs. Soil was sandy w/ staining.</p> <p>Handwashing basin #2 location below 9-11' bgs was wet &amp; sandy, but no staining or odor.</p>
--	---

Santa Clara Ave

Contact Mark Vent  
Title Environmental Specialist  
Signature [Signature]

Inspector Juliet Shin  
Signature [Signature]

**II, III**

Page 3 of 3

white -env.health  
yellow -facility  
pink -files

# ALAMEDA COUNTY, DEPARTMENT OF ENVIRONMENTAL HEALTH

1131 Harbor Bay Pkwy.  
Suite 250  
Alameda, CA 94502-6577  
(510) 567-6700

## Hazardous Materials Inspection Form

II, III

Site ID # \_\_\_\_\_ Site Name Residential Today's Date 11/8/96

Site Address 743 Santa Clara Ave

City Alameda Zip 94501 Phone \_\_\_\_\_

MAX AMT stored > 500 lbs, 55 gal., 200 cft.?

### Inspection Categories:

- I. Haz. Mat/Waste GENERATOR/TRANSPORTER
- II. Business Plans, Acute Hazardous Materials
- III. Underground Tanks

\* Calif. Administration Code (CAC) or the Health & Safety Code (HS&C)

### Comments:

Sample from #2 location collected from ~11-foot d/s. Samples will have special protocol applied at lab to account for wetness of samples. Samples will be analyzed for TPHd and BTEX. Sample from #3 location collected at ~10.5' bgs. Sandy & wet, but no odors or staining. Another sample collected from ~11' bgs. Sandy wet soil + no odors/staining. Soil below was removed was hauled off site yesterday. Remaining cleaner soil will be backfilled.

### II.A BUSINESS PLANS (Title 19)

- 1. Immediate Reporting 2703
- 2. Bus. Plan Stds. 25503(b)
- 3. RR Cars > 30 days 25503.7
- 4. Inventory Information 25504(a)
- 5. Inventory Complete 2730
- 6. Emergency Response 25504(b)
- 7. Training 25504(c)
- 8. Deficiency 25505(a)
- 9. Modification 25505(b)

### II.B ACUTELY HAZ. MATLS

- 10. Registration Form Filed 25533(a)
- 11. Form Complete 25533(b)
- 12. RMPP Contents 25534(c)
- 13. Implement Sch. Req'd? (Y/N) \_\_\_\_\_
- 14. OffSite Conseq. Assess. 25524(c)
- 15. Probable Risk Assessment 25534(d)
- 16. Persons Responsible 25534(g)
- 17. Certification 25534(i)
- 18. Exemption Request? (Y/N) \_\_\_\_\_
- 19. Trade Secret Requested? 25538

### III. UNDERGROUND TANKS (Title 23)

- General
- 1. Permit Application 25284 (H&S)
  - 2. Pipeline Leak Detection 25292 (H&S)
  - 3. Records Maintenance 2712
  - 4. Release Report 2651
  - 5. Closure Plans 2670

- Monitoring for Existing Tanks
- 6. Method
    - 1) Monthly Test
    - 2) Daily Vadose
      - Semi-annual groundwater
      - One time soils
    - 3) Daily Vadose
      - One time soils
      - Annual tank test
    - 4) Monthly Gndwater
      - One time soils
    - 5) Daily inventory
      - Annual tank testing
      - Cont pipe leak det
      - Vadose/gndwater mon.
    - 6) Daily inventory
      - Annual tank testing
      - Cont pipe leak det
    - 7) Weekly Tank Gauge
      - Annual tank testing
    - 8) Annual Tank Testing
      - Daily inventory
    - 9) Other \_\_\_\_\_

- 7. Precs Tank Test 2643
  - Date: \_\_\_\_\_
- 8. Inventory Rec. 2644
- 9. Soil Testing . 2646
- 10. Ground Water. 2647

- New Tanks
- 11. Monitor Plan 2632
  - 12. Access. Secure 2634
  - 13. Plans Submit 2711
    - Date: \_\_\_\_\_
  - 14. As Built 2635
    - Date: \_\_\_\_\_

Rev 6/88

II, III

Contact: Mark Duput

Title: Environmental Specialist Inspector: Juliet Shin

Signature: Mark Duput Signature: Juliet Shin