

S E M C O  
ENVIRONMENTAL CONTRACTORS & GENERAL ENGINEERING  
1741 LESLIE STREET  
SAN MATEO, CALIFORNIA 94402

August 27, 1992

Mr. Scott Seery  
Alameda County  
Department of Environmental Health  
Hazardous Materials Division  
80 Swan Way, Room # 200  
Oakland, California 94621

Re: 20009 Meekland Avenue, Hayward

Dear Scott:

The following letter is intended to serve as a work plan for the re-sampling and removal of the product piping lines at the Fong property located at 20009 Meekland Avenue in Hayward.

Enclosed is a scale map that designates the former tank sites and the proposed resample points. On August 26, 1992, I contacted Juliet Shin by phone, and she informed me that 2 samples need to be taken at varying depths in each site, and after product line removal, one sample for every 20 feet.

SEMCO proposes to use a backhoe and a slot trench to sample in the gas tank excavation at -5' and -10'. These samples will be analyzed for TPH as gas, and BTXE. A similar program will be done for the waste oil tank with samples taken -3' & -6', with analysis for TPH as gas and diesel, BTXE, TOG & Organic Lead. The pipeline samples are indicated on the site map, and will be analyzed for TPH as gas and BTXE.

All samples will be taken under the direction of Alameda County Environmental Health, using clean brass cylinders, placed under a chain of custody and transported to Superior Precision Analytical for analysis.

If you have any questions, please give me a call.

*Notify this office 48 hrs before work is done.*

Sincerely,

*Other work on site? cannot?*  
*on additional site tanks, some to 15' deep. only done for 3' deep*  
Dave McCain *is authorized to sign?*



Dave McCain  
Project Supervisor  
SEMCO-SAN MATEO

License # 449864  
A, B, C-61/D40  
Hazardous Substances Certification

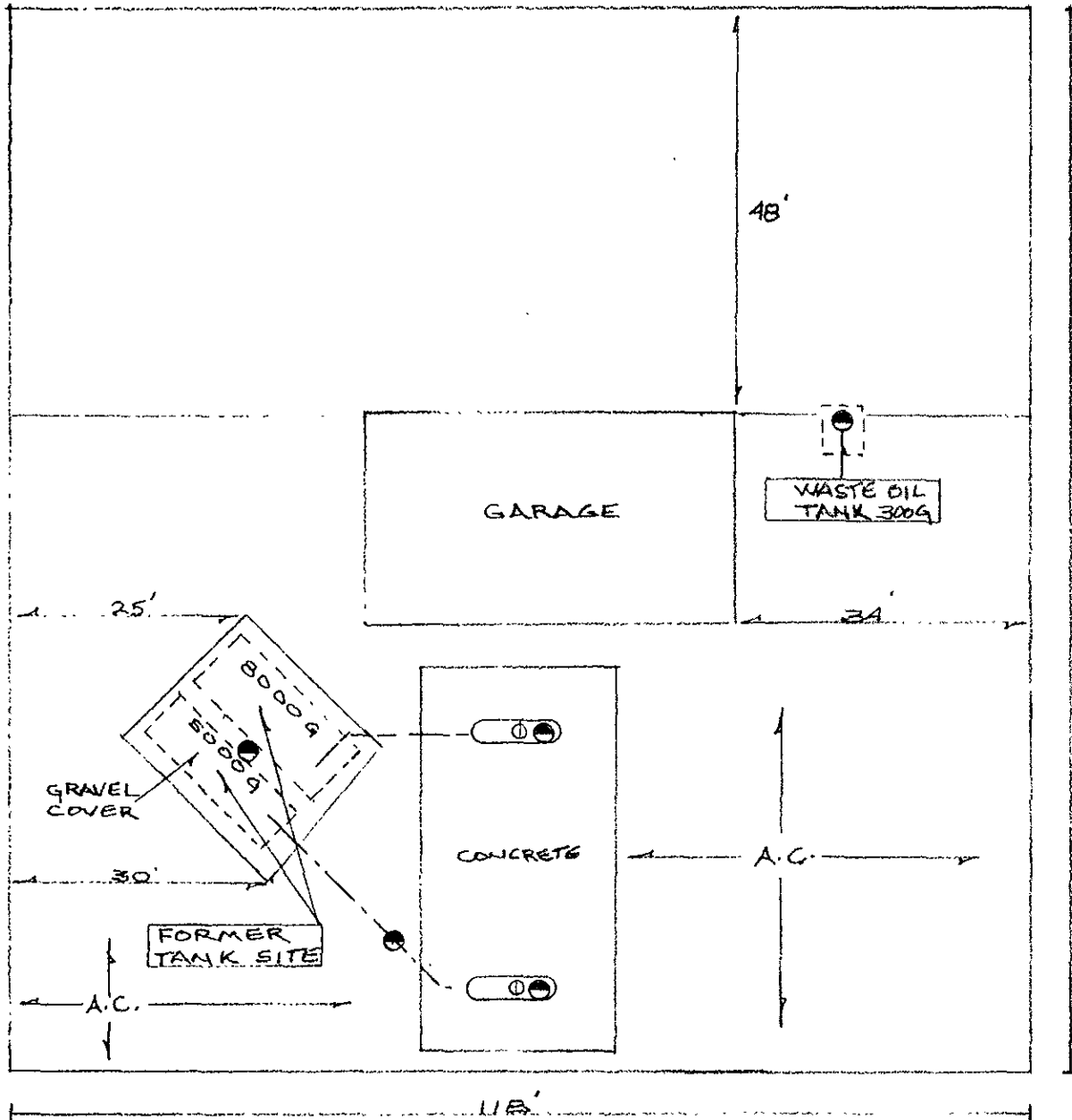
(800) 831-2344  
(415) 572-8033  
(415) 572-9734 FAX

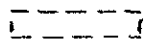
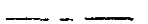

BLOSSUM WAY

LEGEND	
	FORMER TANK LOCATION
	PIPING
	PROPOSED SAMPLE LOCATIONS

FONGS AUTO  
 20009 MEEKLAND  
 HAYWARD CA  
 20 SCALE